

(19) World Intellectual Property Organization
International Bureau



(43) International Publication Date
9 August 2001 (09.08.2001)

PCT

(10) International Publication Number
WO 01/56841 A1

- (51) International Patent Classification⁷: **B60R 21/20**
- (21) International Application Number: PCT/US00/30549
- (22) International Filing Date:
6 November 2000 (06.11.2000)
- (25) Filing Language: English
- (26) Publication Language: English
- (30) Priority Data:
09/498,158 4 February 2000 (04.02.2000) US
- (71) Applicant: **BREED AUTOMOTIVE TECHNOLOGY, INC.** [US/US]; P.O. Box 33050, Lakeland, FL 33807-3050 (US).
- (72) Inventor: **FORD, Brian**; 15 Breitmeyer Place, Mt. Clemens, MI 48043 (US).
- (74) Agents: **DRAYER, Lonnie, R.**; Breed Automotive Technologie, Inc., P.O. Box 33050, Lakeland, FL 33807-3050 et al. (US).
- (81) Designated States (*national*): AT, AU, BR, CA, CN, CZ, DE, DK, ES, FI, GB, HU, IN, JP, KR, MX, NO, NZ, PL, PT, RU, TR, YU, ZA.
- (84) Designated States (*regional*): European patent (AT, BE, CH, CY, DE, DK, ES, FI, FR, GB, GR, IE, IT, LU, MC, NL, PT, SE, TR).
- Published:**
— with international search report
- For two-letter codes and other abbreviations, refer to the "Guidance Notes on Codes and Abbreviations" appearing at the beginning of each regular issue of the PCT Gazette.*

(54) Title: STEERING WHEEL WITH AIRBAG MODULE

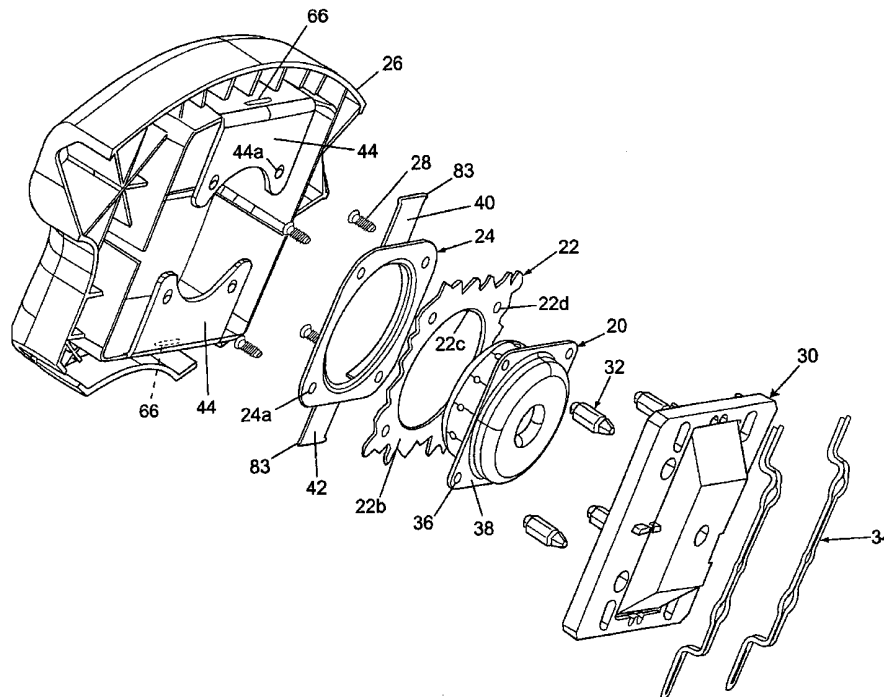

(57) Abstract: An airbag module has an inflator (20), a cushion (22), and a retaining ring (24). The retaining ring has at least one mounting tab (40) and fasteners (28) for engaging the inflator and the cushion. A cover (26) has a pair of flaps (44), defining apertures for engaging the fasteners, and snap-end attachment nuts (32). The snap-end nuts connect the airbag module to an armature (30) of a steering wheel.



WO 01/56841 A1

STEERING WHEEL WITH AIRBAG MODULE

The present invention relates to a steering wheel with an airbag module.

5 Driver's side airbag modules typically have a cover for enclosing a cushion, or cushion pack assembly, and inflator. Typically, the cushion, inflator and cover are mounted to the housing, the housing having a number of fasteners to attach the
10 airbag module to a vehicle's steering wheel.

 There is provided in accordance with the present invention steering wheel with a driver's airbag module with mounting hardware that uses a steering wheel armature to secure the module and allows proper
15 distribution of reaction forces. A wire fastening system is used to secure the module to the steering wheel.

Brief Description of the Drawings

Fig. 1 is an exploded view of a driver's airbag module according to the present invention.

5 Fig. 1a shows a cushion and retaining ring.

Figs. 2a and 2b are top and bottom isometric views, respectively, of a subassembly of the present invention.

10 Fig. 3 shows a cushion pack and inflator subassembly installed in an airbag cover.

Fig. 4 shows a subassembly of the airbag module.

15 Fig. 5a is a bottom plan view of a driver's airbag module of the present invention in the locked position, snapped into attachment legs of a steering wheel armature.

Fig. 5b shows the driver's airbag module of with the attachment legs in the disassembly position.

Fig. 6 is a rear view of the cover of the airbag module of the present invention.

20 Fig. 7 is a plan view of the cover of the airbag module of the present invention.

Fig. 8 is an isometric view of a snap-end attachment nut employed in the present invention.

25 Fig. 9 shows a retaining ring employed in the present invention.

Fig. 10 is an enlarged view of the attachment legs employed in the present invention.

Fig. 11 is a plan view of a steering wheel employed in the present invention.

30 Fig. 12 is a plan view of the rear of the hub portion of the steering wheel.

Detailed Description of the Invention

In Fig. 1 is an exploded view of a steering wheel with an airbag module of the present invention that
5 comprises: an inflator 20; a cushion 22; a retaining ring 24; a cover 26; a plurality of threaded studs 28; a steering wheel armature 30 (only the hub is shown in Fig. 1); a plurality of snap-end attachment nuts 32; and a pair of retaining or attachment fasteners or
10 clips 34.

The airbag module is assembled by first placing the retaining ring 24 in the cushion 22. The retaining ring has a pair of tabs 40, 42 that are inserted through corresponding slots in the cushion as
15 best shown in Fig. 1a. The retaining ring 24 has a plurality of holes 24a therein. The cushion 22 includes an inflatable portion 22a, an opening 22c and a plurality of holes 22d that are aligned with the holes 24b in the retaining ring. A threaded stud 28
20 is passed through a respective pair of holes 22d, 24b in the retaining ring and cushion. The threaded studs 28 are then passed through corresponding holes 36 in the inflator flange 38 as shown in Figs. 2a and 2b.

The cushion 22 is then folded and an optional
25 layer of TYVEK® or other tearable material can be wrapped around the cushion after it is folded to prevent contaminants from entering the bag pack. A cushion assembly comprising the folded cushion 22, the retaining ring 24 and inflator 20 is placed in the
30 cover 26 as shown in Fig. 3. As can be seen from the various figures, the underside of the cover 26 includes a peripheral wall 58 on its underside, which

defines a cavity 59 into which the folded cushion ASSEMBLY is received. An L shaped flap 44 extends from each of two opposing sides 43 of the wall. Each flap has a plurality of holes 44a therethrough. The
5 base of each flap 44 or the top of the adjacent side 43 has a slot 64, 66 therein. As shown, the flaps are integral to the cover 26. The flaps can be formed integrally with the cover or can be an insert-molded substrate. During assembly, as the cushion assembly
10 is placed within the cover cavity, the retainer tabs 40, 42 are each received within a corresponding slot 64, 66. Each flap 44 is manipulated and folded over the inflator 20 so that a threaded stud 28 extends through each of the openings 44a in the tabs.
15 The threaded studs 28 keep both the cushion 22 and cover 26 in place. The ends of the tabs 40, 42 are equipped with barbs 83 that prevent the flaps 44 of the cover 26 from sliding over the end of the tabs after the module is assembled. The extending ends of
20 the tabs are easily grasped, manually or automatically, and provide the assembly plant, or assembler, with an easy means for transporting the module. The tabs 40, 42 improve fit and finish with the steering wheel armature 30 by improving the
25 stability of the cover.

During the deployment of the cushion, the threaded studs 28 prevent movement of the cover 26 relative to the steering wheel armature 30. As best seen in Figs. 6 and 7, a tear seam 46 is placed
30 through the entire center of the cover so that during deployment the cover will split down the center and rotate about a line located somewhere along the flaps.

By using this type of tear seam, forces on the components secured by the studs are minimized because the majority of loading is perpendicular to the studs.

To complete the assembly of a module, the snap-
5 end attachment nuts 32, shown in Fig. 8, are installed onto the threaded studs 28 as shown in Fig. 4. These snap-end nuts 32 serve three purposes: the nuts, in combination with the studs, draw the retaining ring 24 and inflator flange 38 together to form a tight seal;
10 they firmly attach the cover 26 to the inflator flange 38 as shown in Fig. 4; and they serve as a mounting feature with the steering wheel and more particularly with the hub or armature 30 of the steering wheel.

15 With the module in the configuration shown in Fig. 4, it is ready for shipment to an auto manufacturer's assembly plant. At the assembly plant the steering wheel is first fastened to the steering shaft. Next, the airbag module is connected to the
20 steering wheel by snapping the module into the steering wheel armature 30.

Figs. 11 and 12 show the major features of the steering wheel 200. The steering wheel includes a hub 30, a plurality of spokes 84 and a rim 87. The
25 steering wheel armature 30 has a plurality of passages 75 therethrough for receiving the snap-end attachment nuts 32 of the airbag module. A pair of retaining wire fasteners 34 are conformed to attached to the snap-end attachment nuts 32. The snap-end attachment
30 nuts initially spread the wire fastener 34 apart and the wire fastener then engage an grooves 48 in the snap-end attachment nuts 32. This is accomplished

because as the snap-end attachment nuts from the module are pushed into the locking portions 85, 86 of each wire fastener 34, parallel legs of each fastener spread apart. Once the grooves 48 in the snap-end attachment nuts 32 are reached, the parallel legs snap into the grooves to retain the module. Should the module need to be serviced and removed from the steering wheel 200, a screwdriver or similar object is placed into the bend 80 at the end of the retaining wire fastener 34. The retaining wire fasteners can be moved until the disengaging loops 52 are aligned with the snap-end attachment nuts. With the retaining wire fasteners in this position, the module can easily be separated from the steering wheel armature 30.

The steering wheel hub 30 is provided with a flat surface 54. The steering wheel hub has a recess 56 immediately behind the module to allow installation of the inflator. The flat top surface 54 is important for the functioning of the module as it functions as a reaction surface and ensures the cushion 22 will always deploy towards the occupant. Another benefit of this flat surface is that if the surface were not flat, the cushion would be forced along an uneven surface and could snag.

The recess 56 is preferably directly behind the module for the inflator to decrease the package size of the module. This in turn can increase the distance from the module to the rim 87 of the steering wheel, potentially decreasing injuries to occupants that are close to the steering wheel.

Fig. 8 shows a snap-end attachment nut 32 employed in the present invention. Snap-end

attachment nuts are mounted onto the retaining ring 24 shown in Fig. 9, and each have a groove 48 for engaging a retaining wire fastener 34 as shown in Figs. 5 and 10.

5 Fig. 9 shows a retaining ring 24 employed in the present invention. Incorporated onto the ring are a pair of tabs 40, 42 which engage a pair of slots 64, 66 in the cover. The slots 64, 66 are preferably adjacent to the flanges 60, 62 of the cover 26 as
10 shown in Fig. 3.

 Fig. 10 shows a retaining wire fastener 34 that that is attached to the steering wheel armature 30. Each retaining wire fastener 34 is bent to form a parallel set of legs 68. The legs define two adjacent
15 first locking portions 85, 86. Should the module experience vibration following assembly, a bend 50 interacts with a post 78 on the steering wheel hub to prevent the wire from moving out of position during vibration. The parallel legs 68 also define adjacent
20 second radii portions 74, 76 that define first and second disengaging portions 52. When a module is to be removed from the steering wheel, an operator would grasp the retaining wire fastener and slide the leg from the engaging locking portions 85, 86 to the
25 disengaging portions 52. When the operator attempts to move the retaining wire fastener into this position, the legs compress at the bend 50 to allow passage through the post 78. The parallel legs 68 are engaged with the steering wheel hub 30 through
30 slots 73 in the hub.

 As shown in Figs. 11 and 12, the steering wheel hub 30 has four apertures 75 therethrough for

receiving snap-end attachment nuts 32. The steering wheel hub 30 further has four slots 73 for receiving a pair of retaining wire fasteners 34. The slots 73, in conjunction with the posts 78, secure the retaining wire fasteners 34 onto the armature 30 and ensure the parallel legs 68 of each retaining wire fastener are kept in position. The armature also has two pair of posts 78 located between the slots 73. Each post engages the parallel legs 68 of a retaining wire fastener 34 and prevents the parallel legs from separating at this point. The retaining wire fastener is positioned in the groove into the post 78 so that when a snap-end attachment nut 32 is pushed into the retaining wire fastener the legs spread apart instead of moving in the same direction as the retention nut. This allows the retaining wire fastener 34 to separate at the four apertures 73 but gives the wire fastener enough spring back to engage the groove 48 of the snap-end attachment nut. In addition, the posts 78 interact with the attachment wire loop 50 to prevent the wire from moving out of position during vibration. This is possible because the distance to the outside radii of the loop is slightly larger than the groove in the post 78. This prevents the wire from sliding unless a mechanic pulls the wire with sufficient force that the two parallel legs 68 compress, allowing it to pass through the groove.

As shown in Fig. 11, the steering wheel armature 30 has a recessed portion 56 that allows incorporation of a nut that secures the steering wheel assembly to the steering column shaft. The recessed portion 56 reduces the overall profile of the

module/steering wheel assembly. A hole 82 through the steering wheel hub is provided to allow the inflator connector wire to be passed from the vehicle to a controller or crash sensor of the rest of the vehicle
5 occupant protection system.

CLAIMS:

1. A steering wheel comprising:
an armature hub (30);
5 an airbag module comprising an inflator (20),
cushion(22), and a retaining ring (24) for retaining
the cushion and inflator to the armature hub;
at least one snap-end attachment nut (32)
attached to a threaded stud 28 that extends through
10 the inflator, cushion, and retaining ring;
at least one retaining wire fastener (34)
engaging a grove in the snap-end attachment nut on a
side of the steering wheel hub distal from the
inflator, cushion and retaining ring to secure the
15 airbag module to the armature hub.
2. The steering wheel assembly of Claim 1
wherein the retaining wire fastener (34) comprises a
pair of generally parallel legs (68) that define at
20 least one locking portion (85).
3. The steering wheel assembly of Claim 2
wherein the retaining wire fastener (34) further
comprises at least one disengaging portion (52).
25
4. The steering wheel assembly of Claim 12
wherein the armature wheel hub (30) has at least one
pair of posts (78), the pair of generally parallel
legs (68) being disposed between the posts (78).
30
5. The steering wheel assembly of any of Claims
1 to 4 wherein the retaining wire fastener (34) is

engages the armature hub (30) through slots (73) in the armature hub..

6. The steering wheel assembly of Claim 15
5 wherein the retaining wire fastener (34) is capable of being positioned in one of a locking position or an unlocking position.

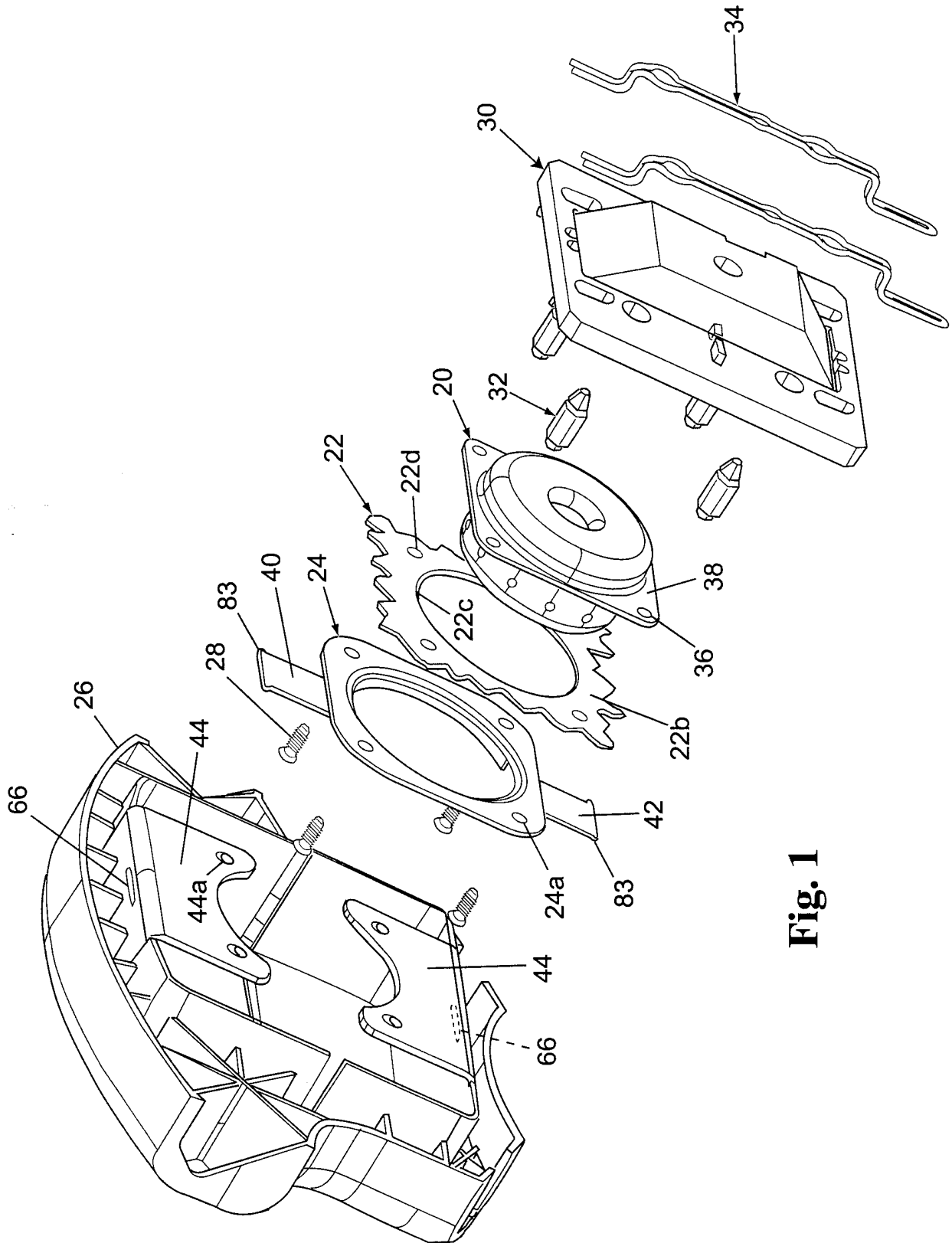

Fig. 1

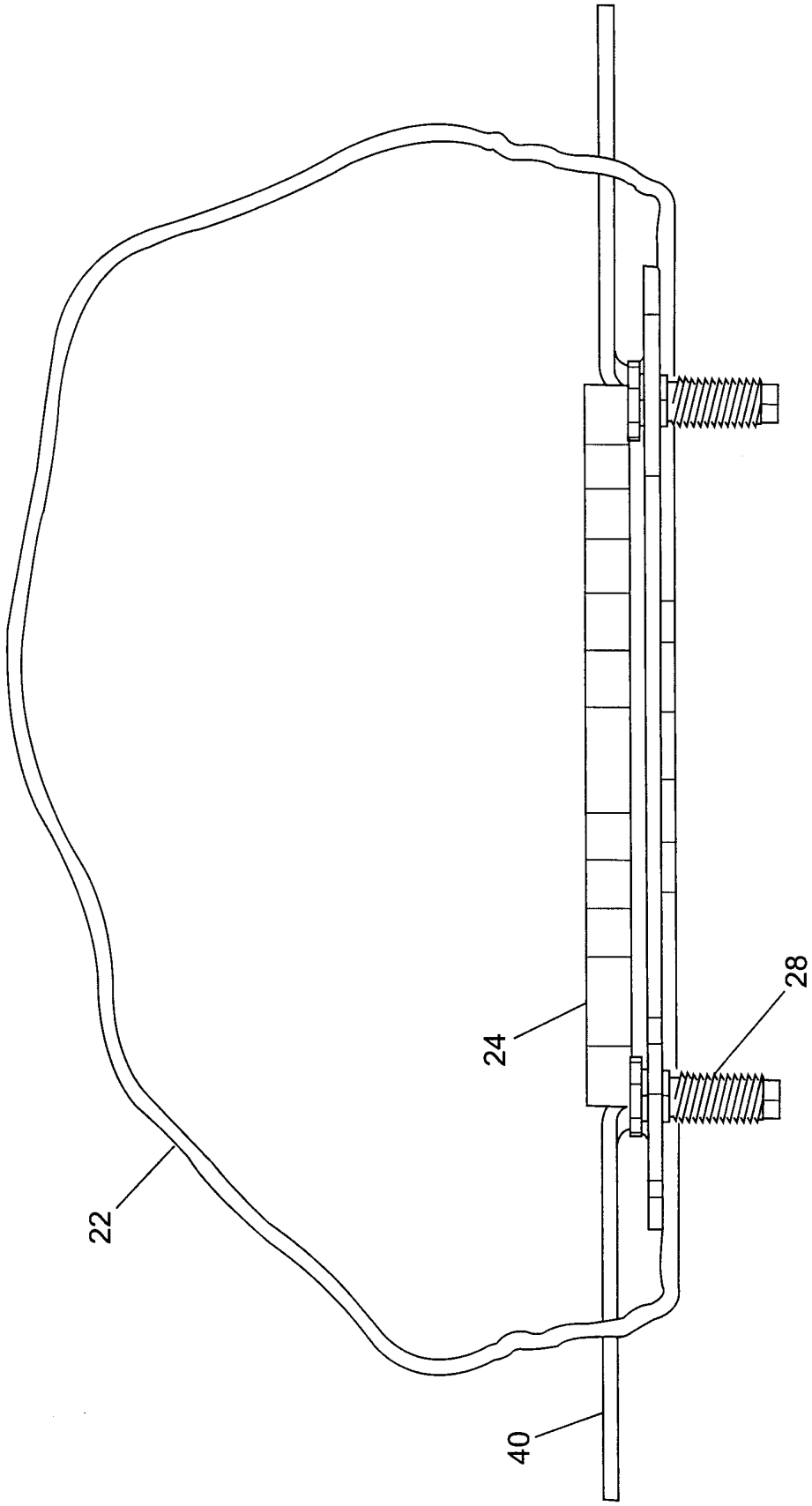

Fig. 1a

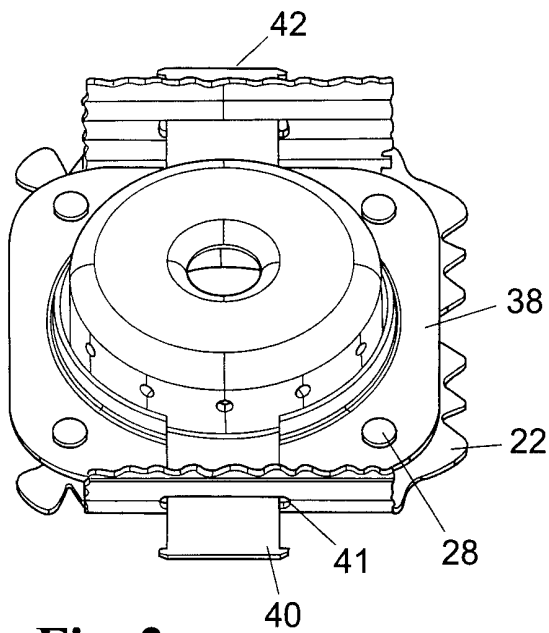

Fig. 2a

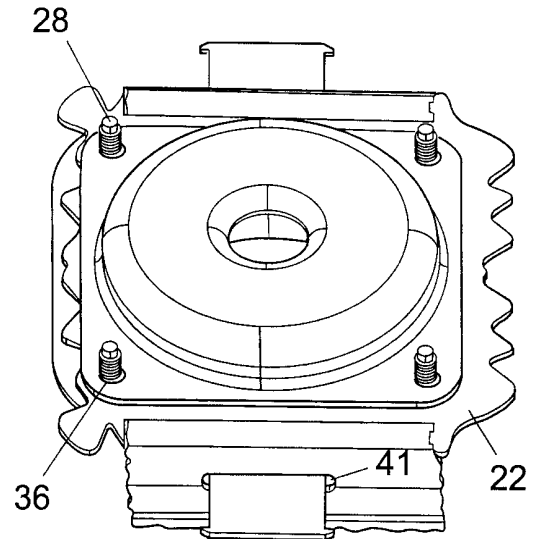

Fig. 2b

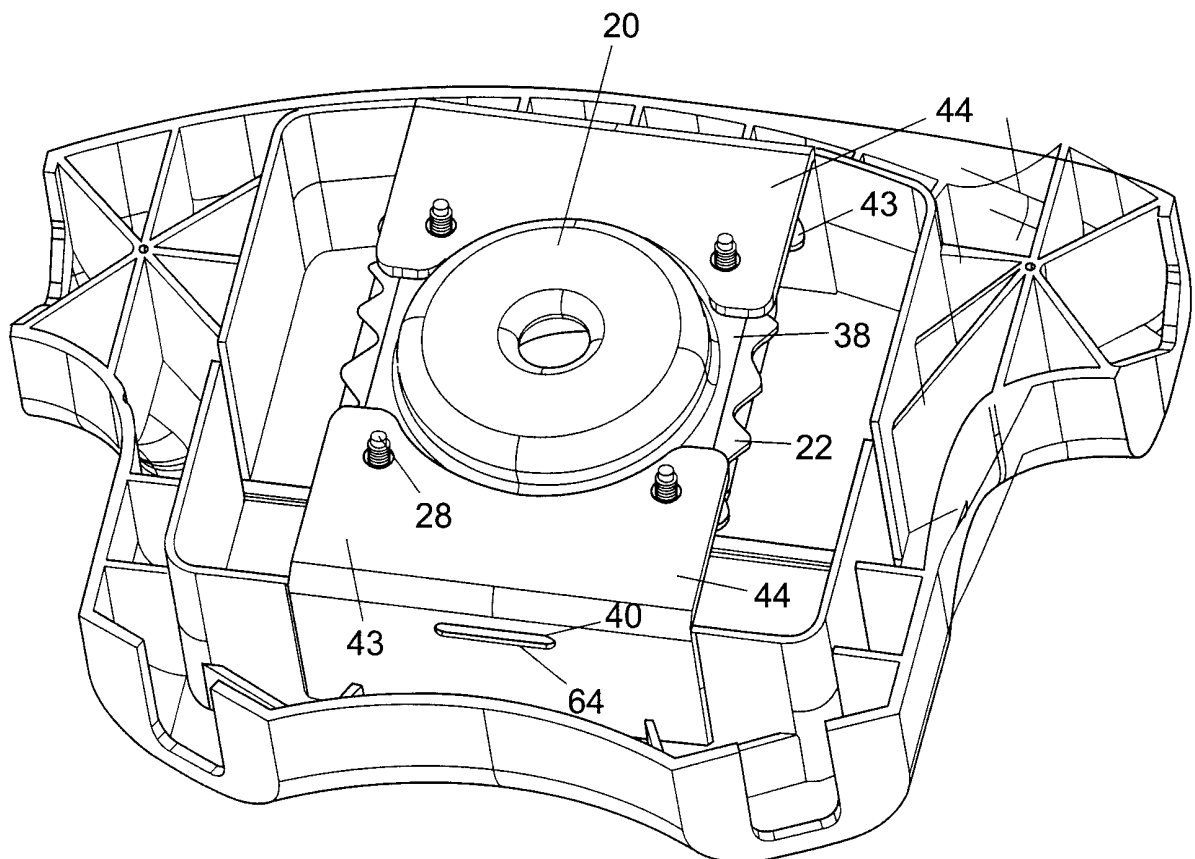

Fig. 3

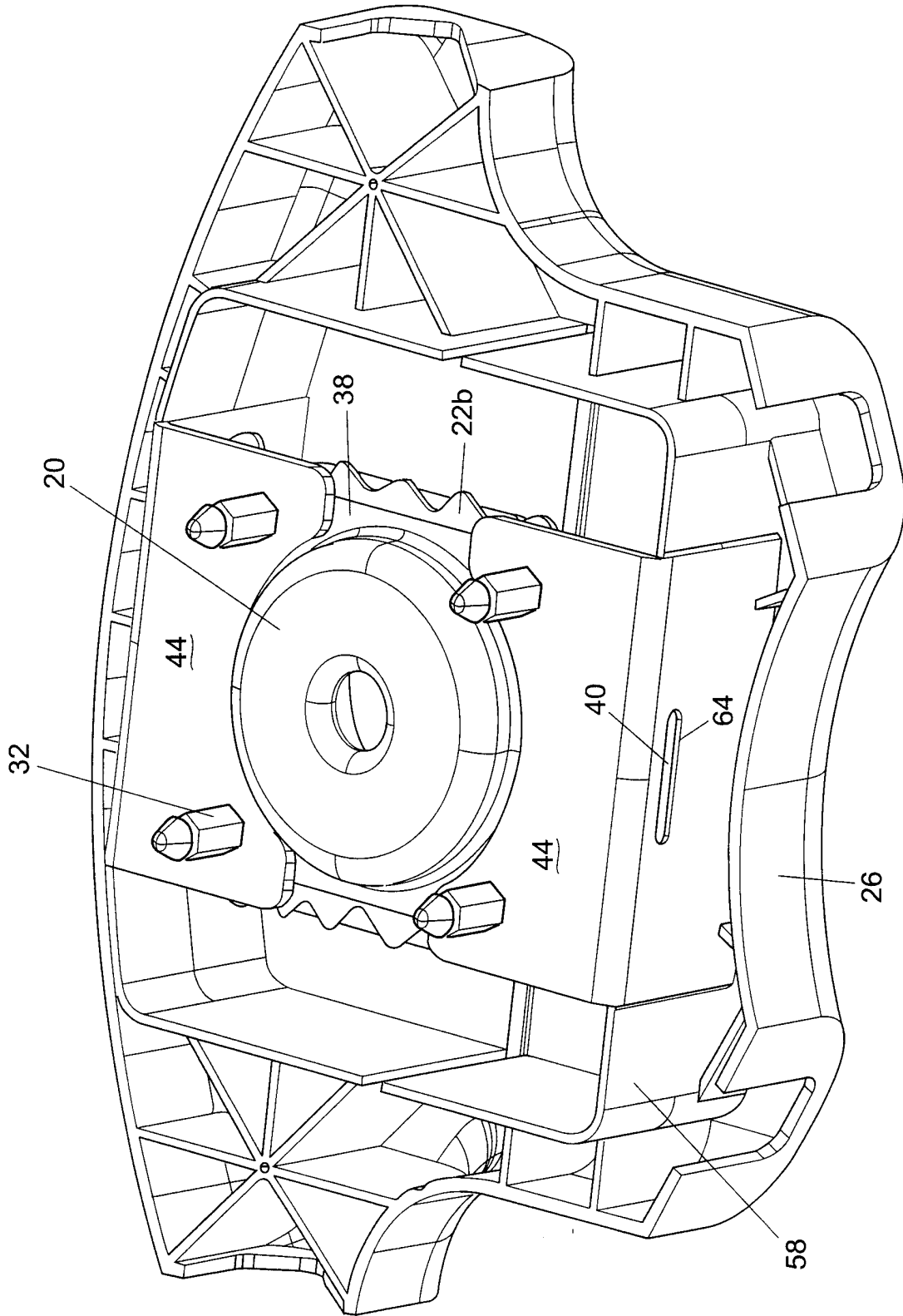

Fig. 4

5/10

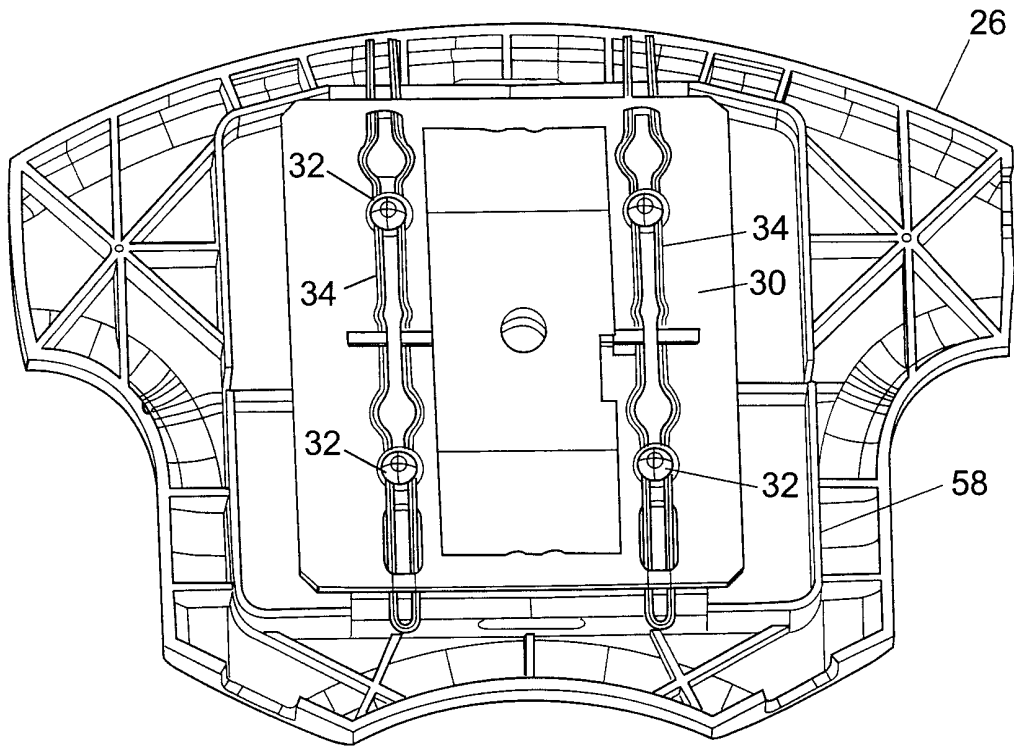

Fig. 5a

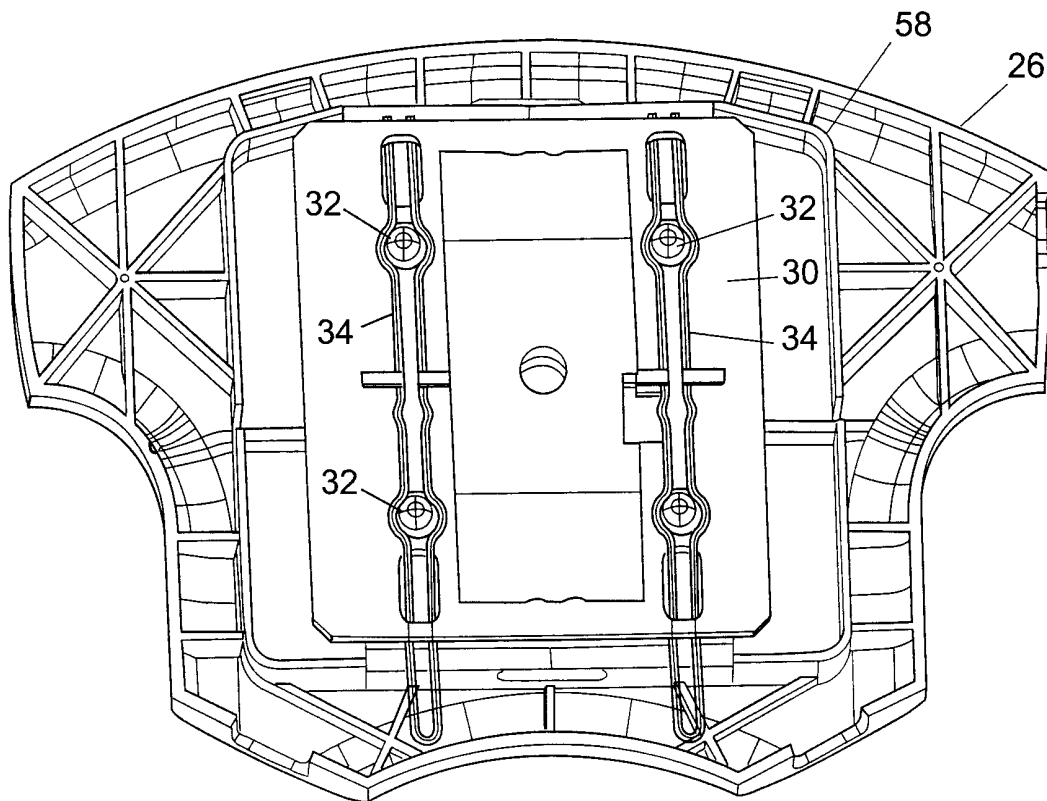

Fig. 5b

6/10

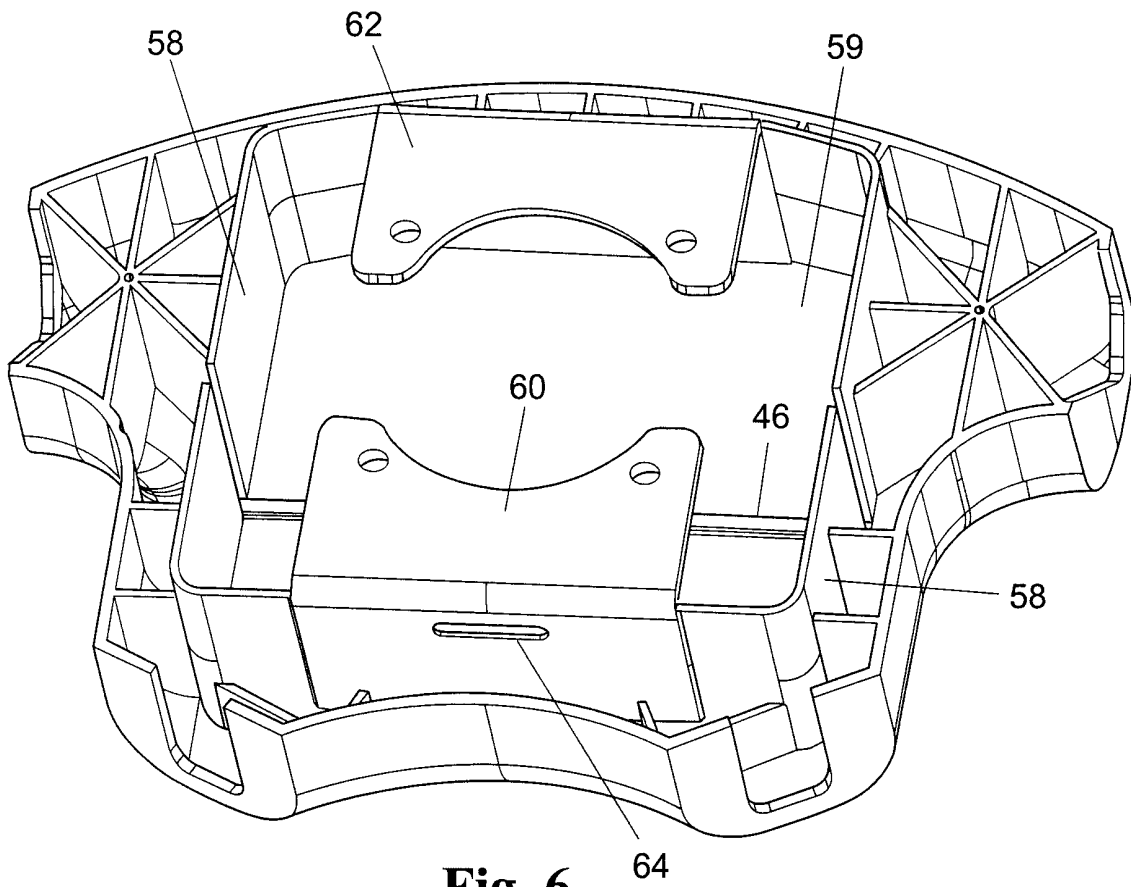

Fig. 6

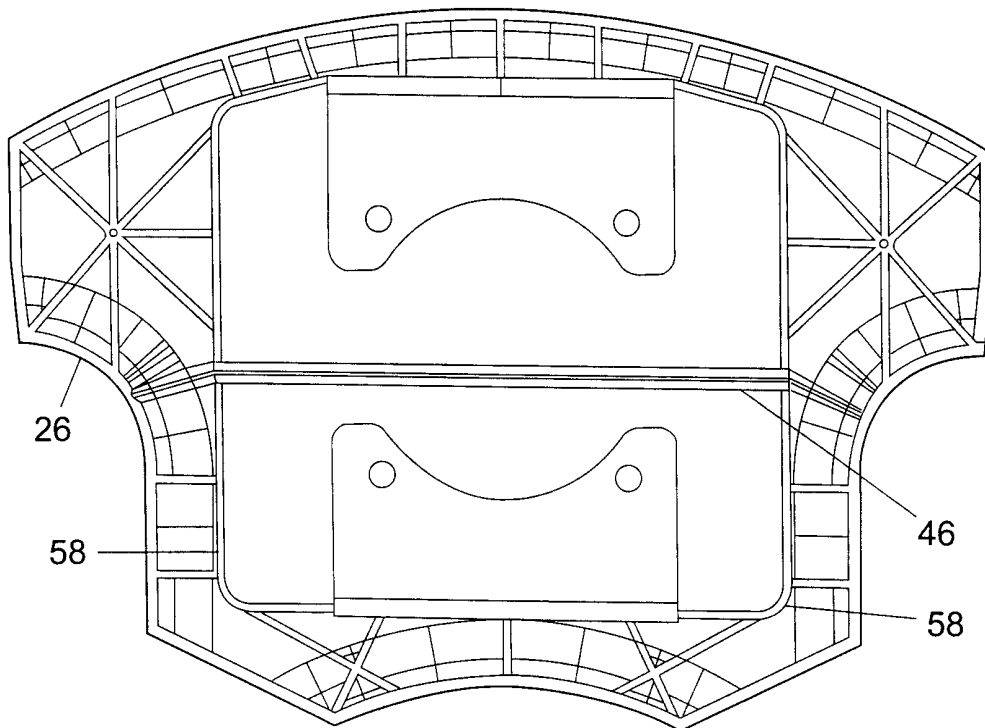

Fig. 7

Fig. 8

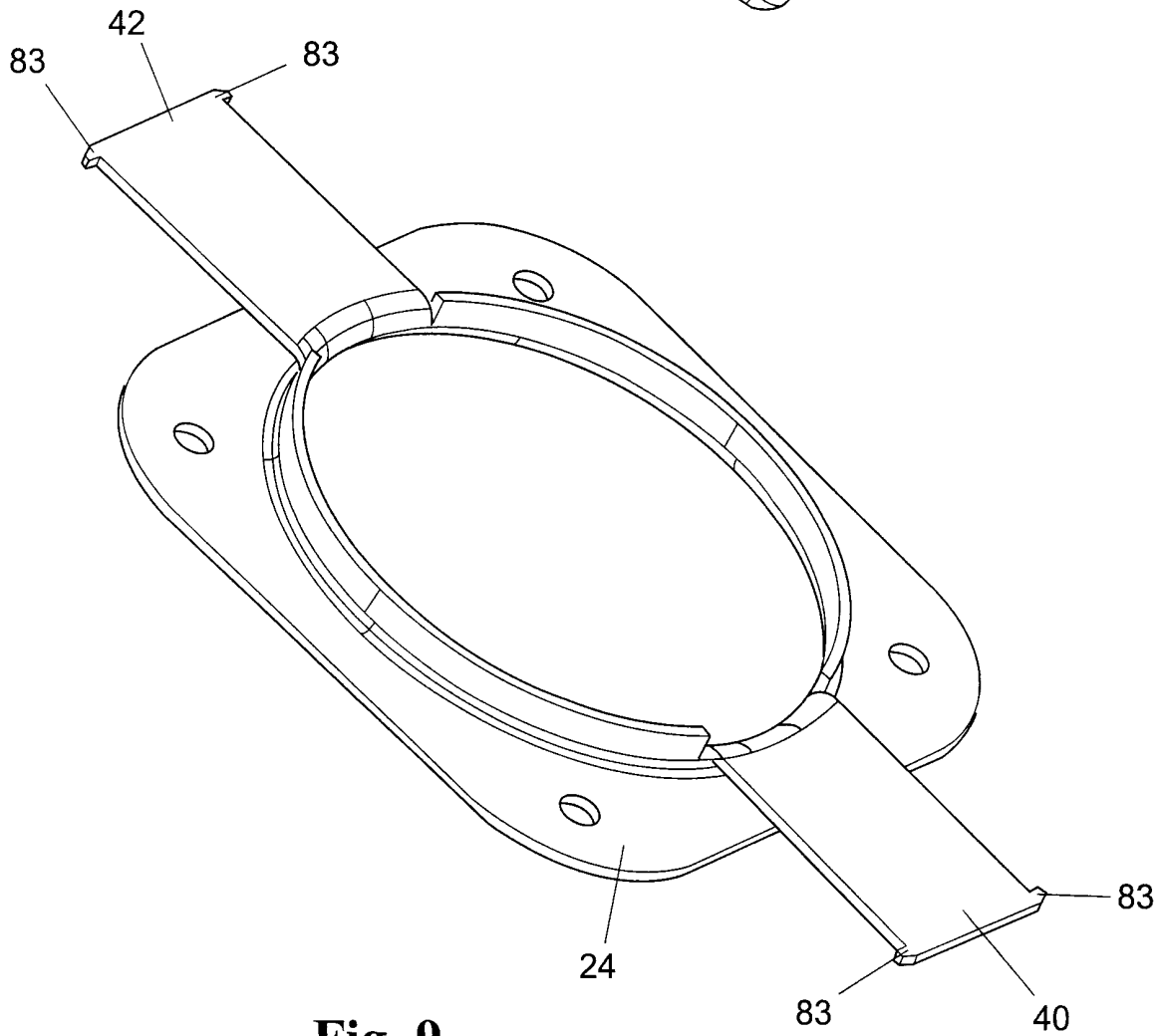
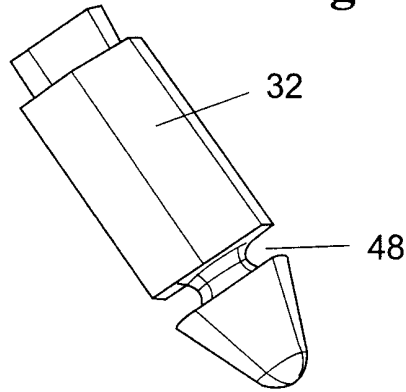

Fig. 9

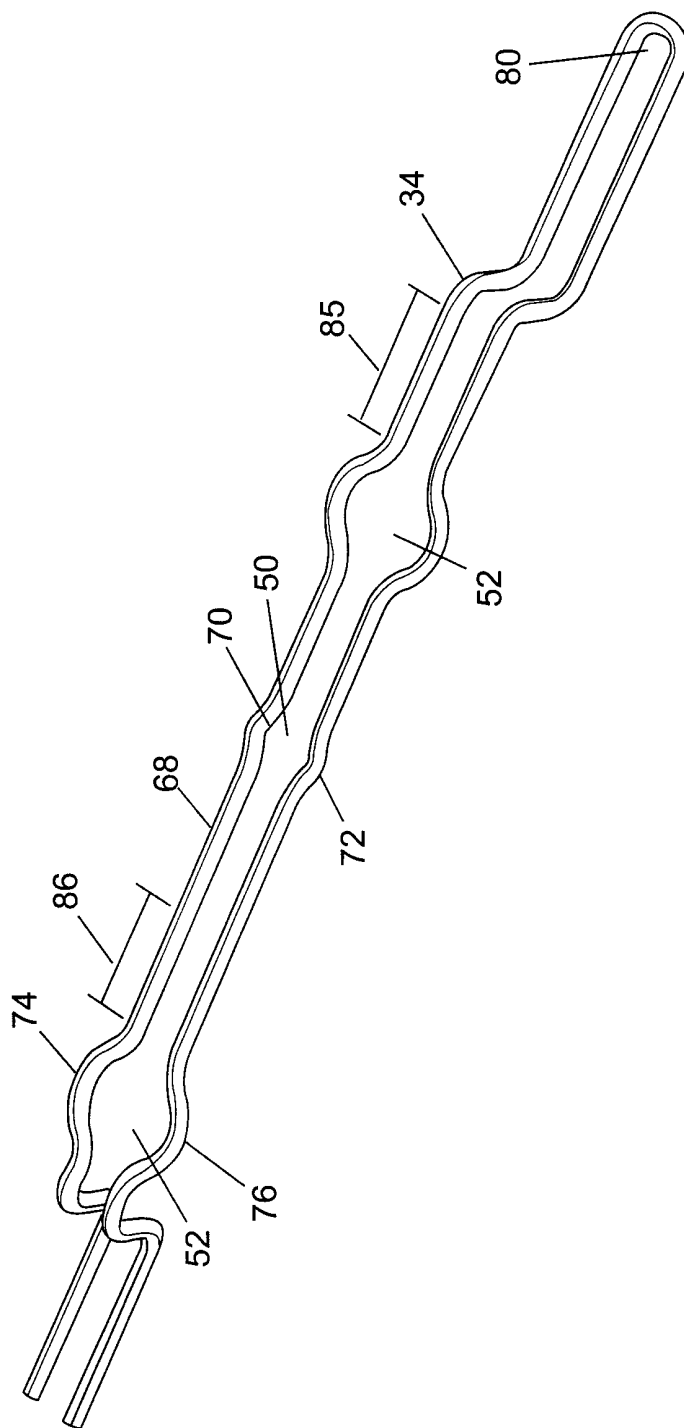

Fig. 10

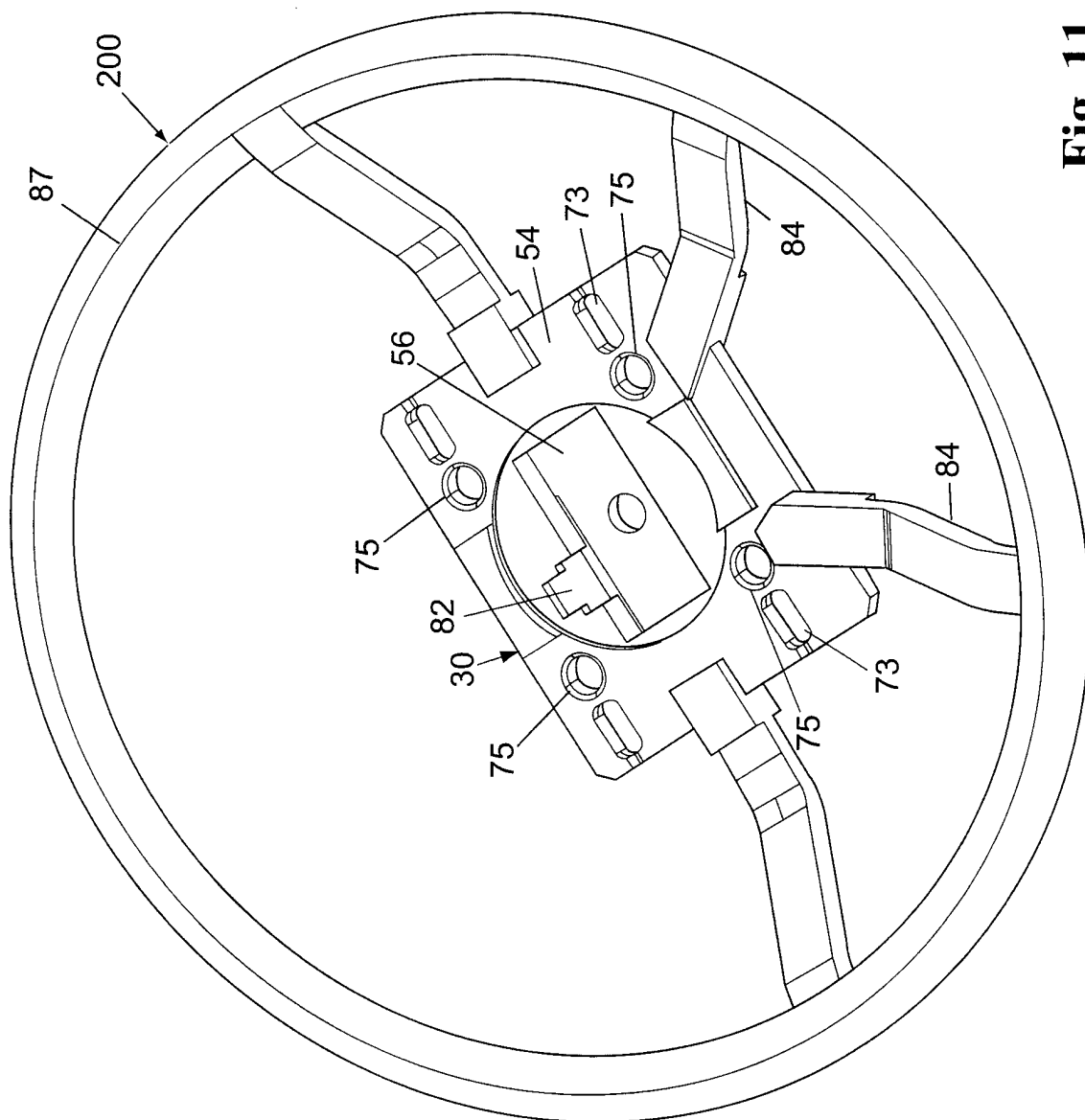

Fig. 11

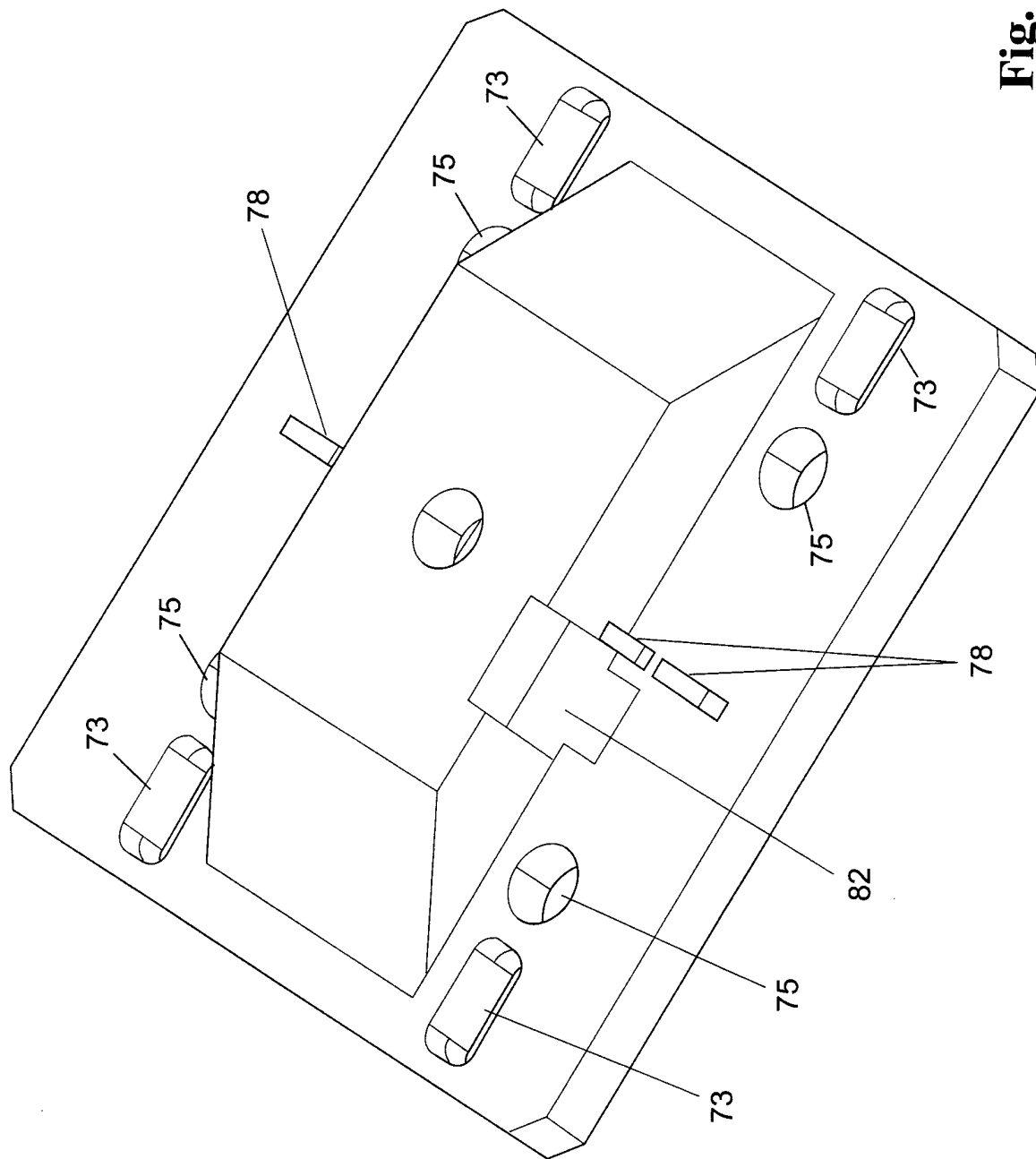

Fig. 12

INTERNATIONAL SEARCH REPORT

International Application No PCT/US 00/30549

A. CLASSIFICATION OF SUBJECT MATTER
IPC 7 B60R21/20

According to International Patent Classification (IPC) or to both national classification and IPC

B. FIELDS SEARCHED

Minimum documentation searched (classification system followed by classification symbols)
IPC 7 B60R

Documentation searched other than minimum documentation to the extent that such documents are included in the fields searched

Electronic data base consulted during the international search (name of data base and, where practical, search terms used)
PAJ, EPO-Internal

C. DOCUMENTS CONSIDERED TO BE RELEVANT

Category °	Citation of document, with indication, where appropriate, of the relevant passages	Relevant to claim No.
X A A A	<p>EP 0 741 063 A (GEN MOTORS CORP) 6 November 1996 (1996-11-06) claims; figures ---</p> <p>EP 0 771 696 A (MST AUTOMOTIVE GMBH) 7 May 1997 (1997-05-07) figures 3,4 abstract column 5, line 13 -column 6, line 11 ---</p> <p>EP 0 754 602 A (TEXTRON INC) 22 January 1997 (1997-01-22) figures 1-8 column 3, line 1 -column 5, line 37 --- -/--</p>	<p>1,2 3-6 1-6 1-6</p>

Further documents are listed in the continuation of box C. Patent family members are listed in annex.

° Special categories of cited documents :

<p>*A* document defining the general state of the art which is not considered to be of particular relevance</p> <p>*E* earlier document but published on or after the international filing date</p> <p>*L* document which may throw doubts on priority claim(s) or which is cited to establish the publication date of another citation or other special reason (as specified)</p> <p>*O* document referring to an oral disclosure, use, exhibition or other means</p> <p>*P* document published prior to the international filing date but later than the priority date claimed</p>	<p>*T* later document published after the international filing date or priority date and not in conflict with the application but cited to understand the principle or theory underlying the invention</p> <p>*X* document of particular relevance; the claimed invention cannot be considered novel or cannot be considered to involve an inventive step when the document is taken alone</p> <p>*Y* document of particular relevance; the claimed invention cannot be considered to involve an inventive step when the document is combined with one or more other such documents, such combination being obvious to a person skilled in the art.</p> <p>*&* document member of the same patent family</p>
--	--

Date of the actual completion of the international search 24 January 2001	Date of mailing of the international search report 30/01/2001
---	---

Name and mailing address of the ISA European Patent Office, P.B. 5818 Patentlaan 2 NL - 2280 HV Rijswijk Tel. (+31-70) 340-2040, Tx. 31 651 epo nl, Fax: (+31-70) 340-3016	Authorized officer D'sylva, C
--	---

INTERNATIONAL SEARCH REPORT

International Application No PCT/US 00/30549

C.(Continuation) DOCUMENTS CONSIDERED TO BE RELEVANT		
Category °	Citation of document, with indication, where appropriate, of the relevant passages	Relevant to claim No.
A	"SNAP-IN INFLATABLE RESTRAINT MODULE MOUNTING SYSTEM FOR STEERING WHEELS" RESEARCH DISCLOSURE, GB, INDUSTRIAL OPPORTUNITIES LTD. HAVANT, no. 403, 1 November 1997 (1997-11-01), page 825 XP000726737 ISSN: 0374-4353 the whole document ---	1-6
A	US 5 380 037 A (WORRELL BARRY C ET AL) 10 January 1995 (1995-01-10) figures abstract column 2, line 46 -column 4, line 49 -----	1-6

INTERNATIONAL SEARCH REPORT

Information on patent family members

International Application No

PCT/US 00/30549

Patent document cited in search report	Publication date	Patent family member(s)	Publication date
EP 0741063 A	06-11-1996	US 5636858 A	10-06-1997
EP 0771696 A	07-05-1997	DE 19541180 A	07-05-1997
		CA 2189466 A	05-05-1997
		DE 59605294 D	29-06-2000
		ES 2147885 T	01-10-2000
		JP 3101214 B	23-10-2000
		JP 9183354 A	15-07-1997
		PT 771696 T	31-10-2000
		US 5810535 A	22-09-1998
EP 0754602 A	22-01-1997	US 5630611 A	20-05-1997
		US 5639113 A	17-06-1997
		JP 9183353 A	15-07-1997
US 5380037 A	10-01-1995	NONE	