

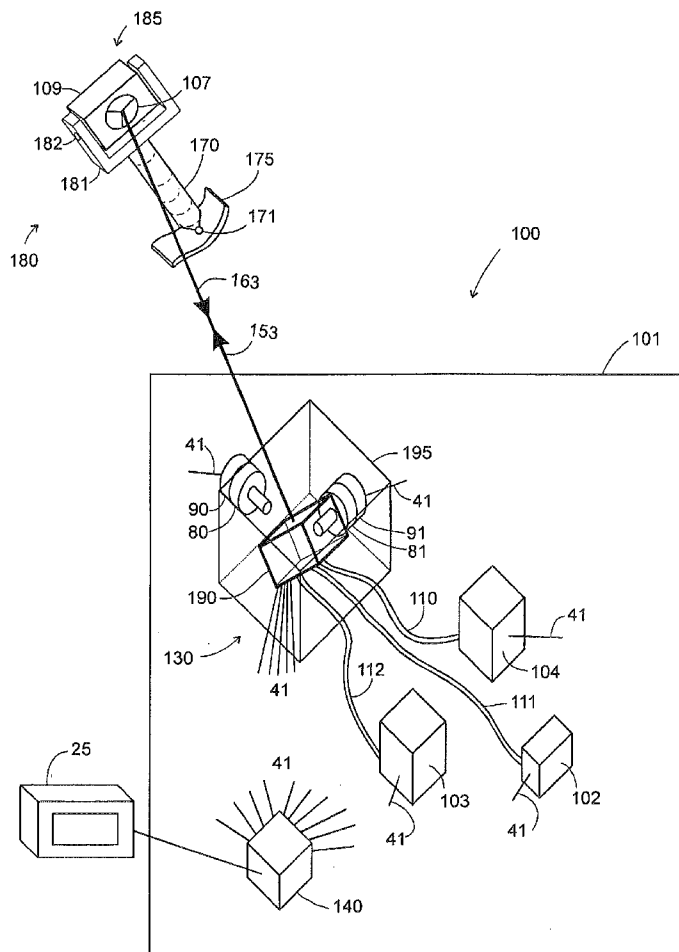

US 20110170113A1

(19) **United States**(12) **Patent Application Publication**  
**Bridges et al.**(10) **Pub. No.: US 2011/0170113 A1**(43) **Pub. Date: Jul. 14, 2011**(54) **LASER-BASED COORDINATE MEASURING  
DEVICE AND LASER-BASED METHOD FOR  
MEASURING COORDINATES**filed on Jul. 26, 1999, provisional application No.  
60/145,315, filed on Jul. 23, 1999.**Publication Classification**(75) Inventors: **Robert E. Bridges**, Kennett Square,  
PA (US); **Lawrence B. Brown**,  
Cochranville, PA (US); **James K.**  
**West**, Landenberg, PA (US); **D.**  
**Scott Ackerson**, Easton, MD (US)(51) **Int. Cl.**  
**G01B 9/02** (2006.01)(52) **U.S. Cl.** ..... **356/482**(57) **ABSTRACT**(73) Assignee: **FARO TECHNOLOGIES, INC.**,  
Lake Mary, FL (US)(21) Appl. No.: **12/882,444**(22) Filed: **Sep. 15, 2010****Related U.S. Application Data**(63) Continuation of application No. 09/621,645, filed on  
Jul. 24, 2000, now Pat. No. 7,800,758.(60) Provisional application No. 60/171,474, filed on Dec.  
22, 1999, provisional application No. 60/145,686,

A laser based coordinate measuring device measures a position of a remote target. The laser based coordinate measuring device includes a stationary portion, a rotatable portion, and at least a first optical fiber. The stationary portion has at least a first laser radiation source and at least a first optical detector, and the rotatable portion is rotatable with respect to the stationary portion. The first optical fiber system, which optically interconnects the first laser radiation source and the first optical detector with an emission end of the first optical fiber system, has the emission end disposed on the rotatable portion. The emission end emits laser radiation to the remote target and receives laser radiation reflected from the remote target with the emission direction of the laser radiation being controlled according to the rotation of the rotatable portion.



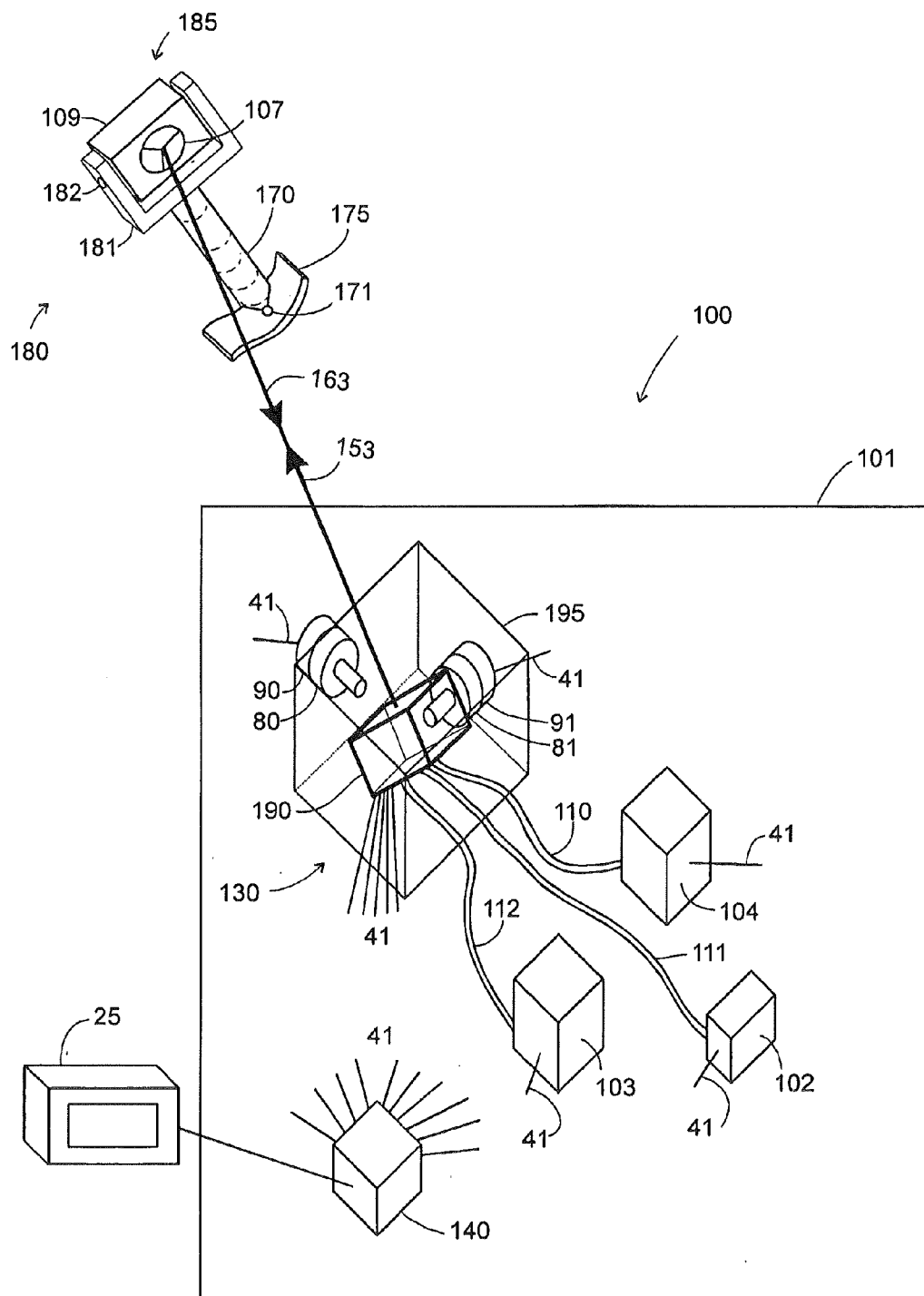

Figure 1

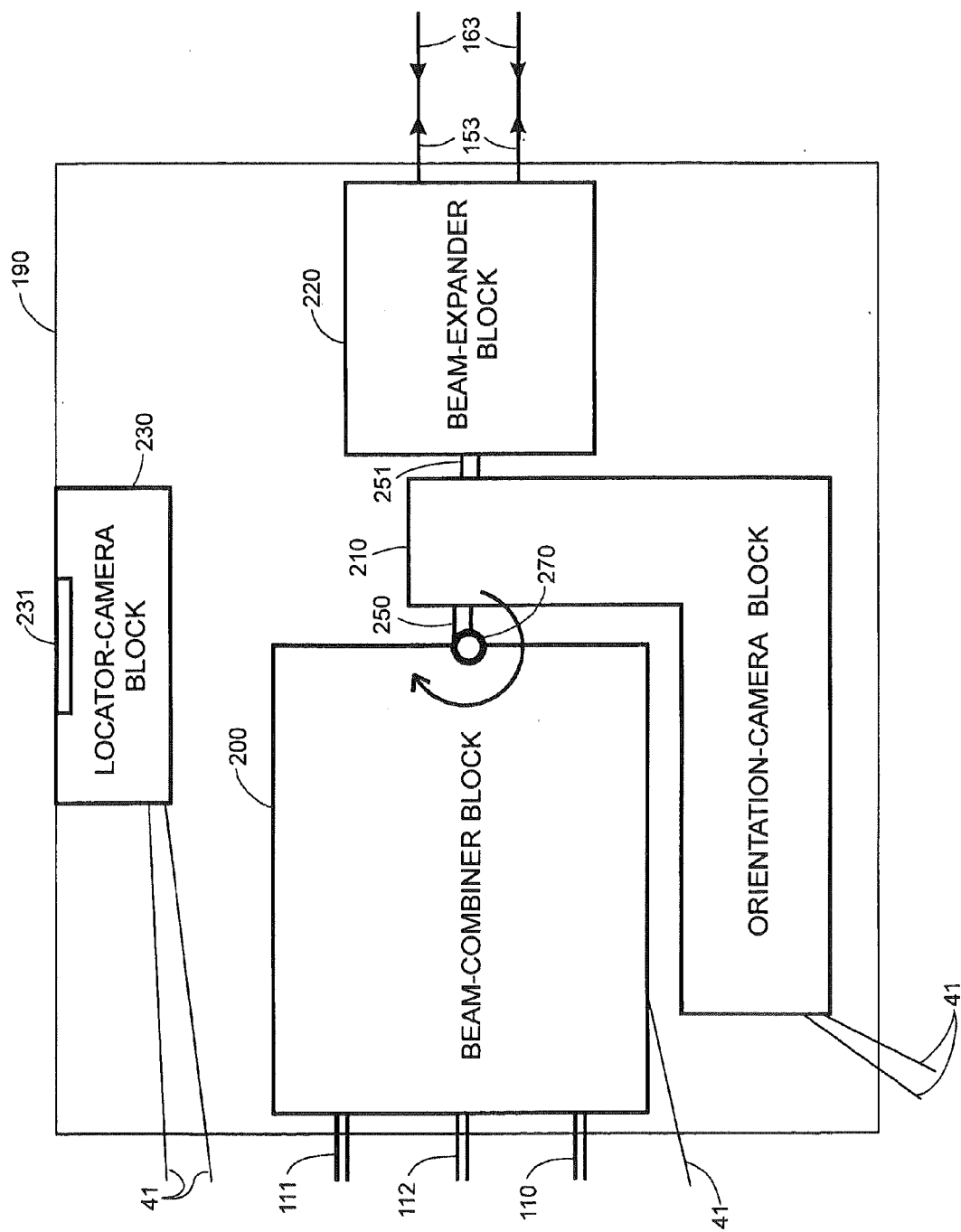

Figure 2

Figure 3

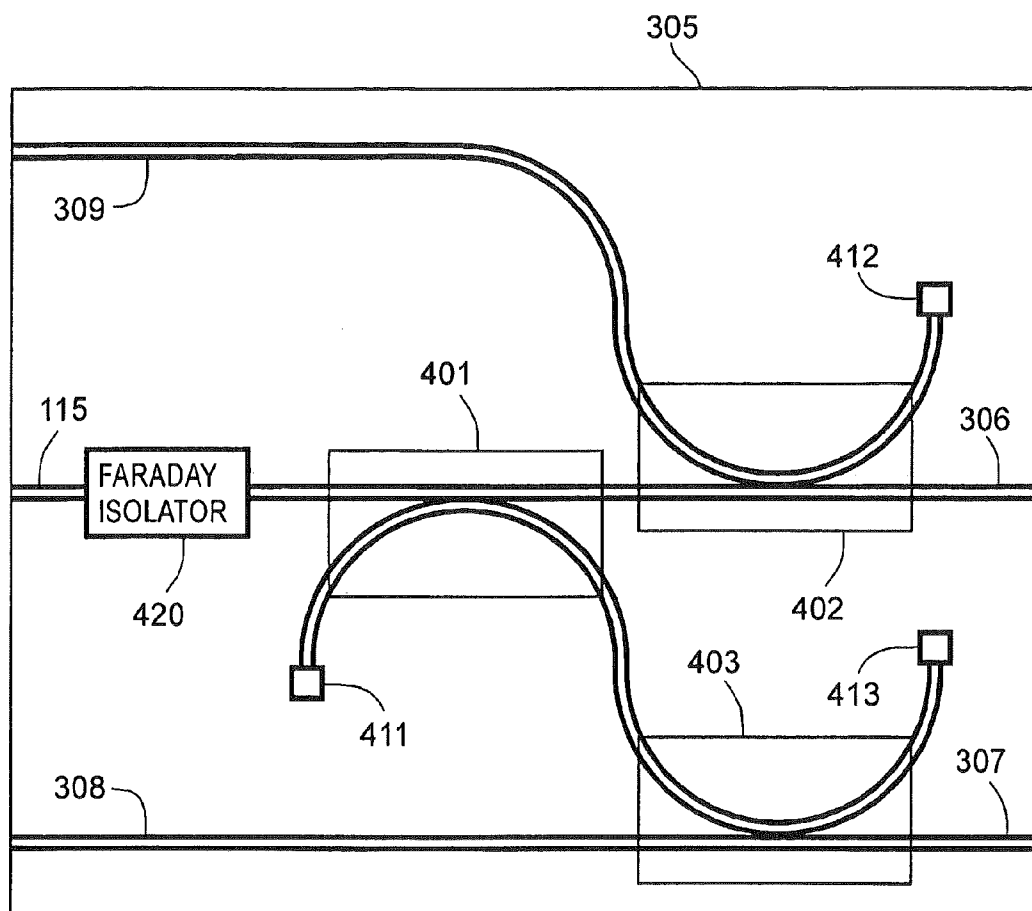

Figure 4

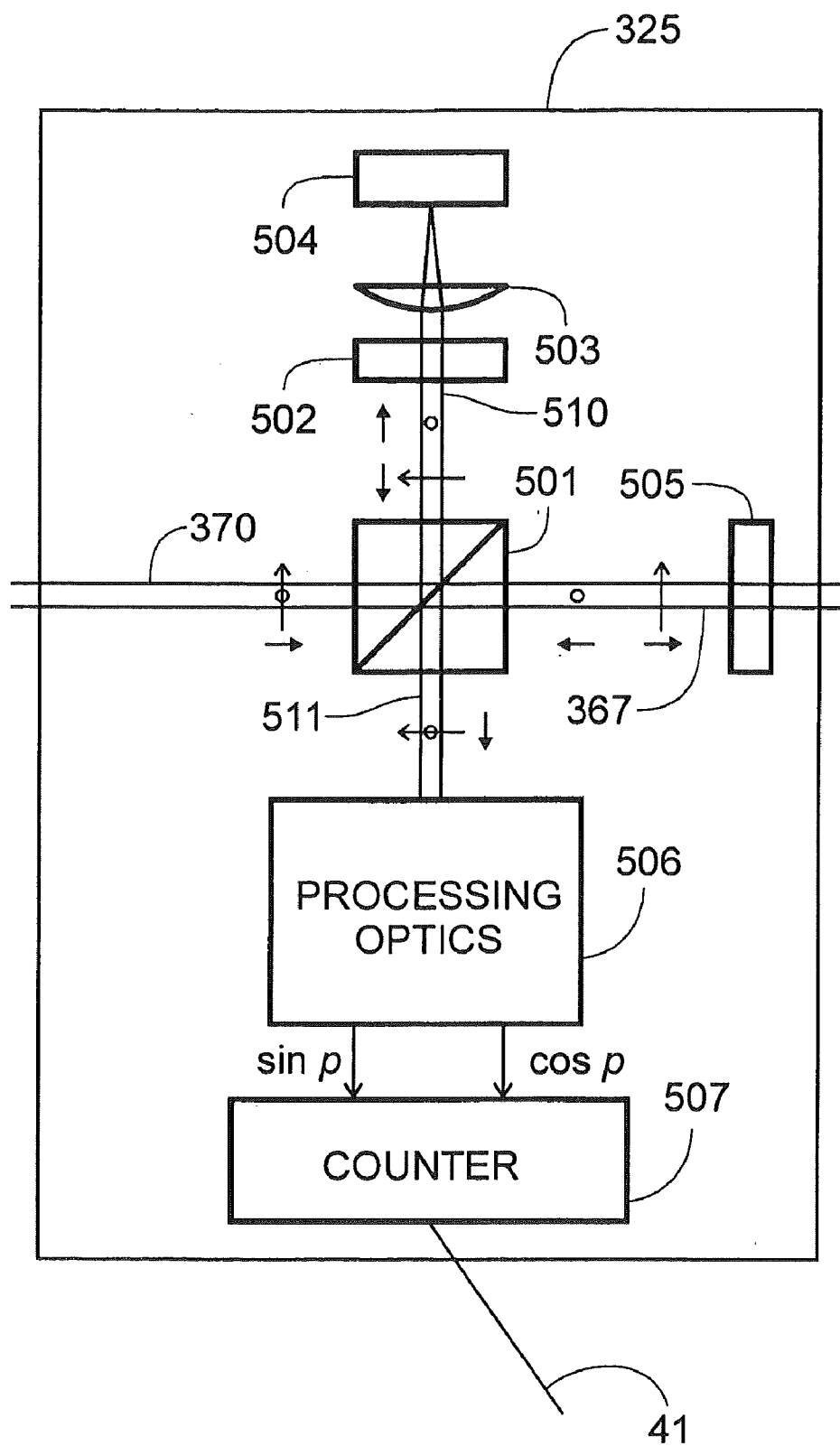

Figure 5

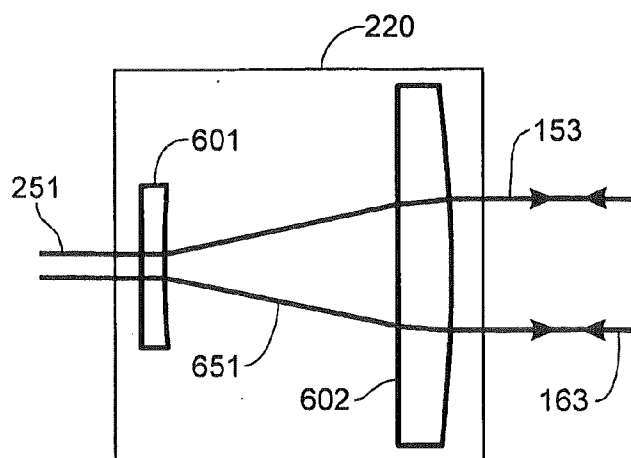

Figure 6

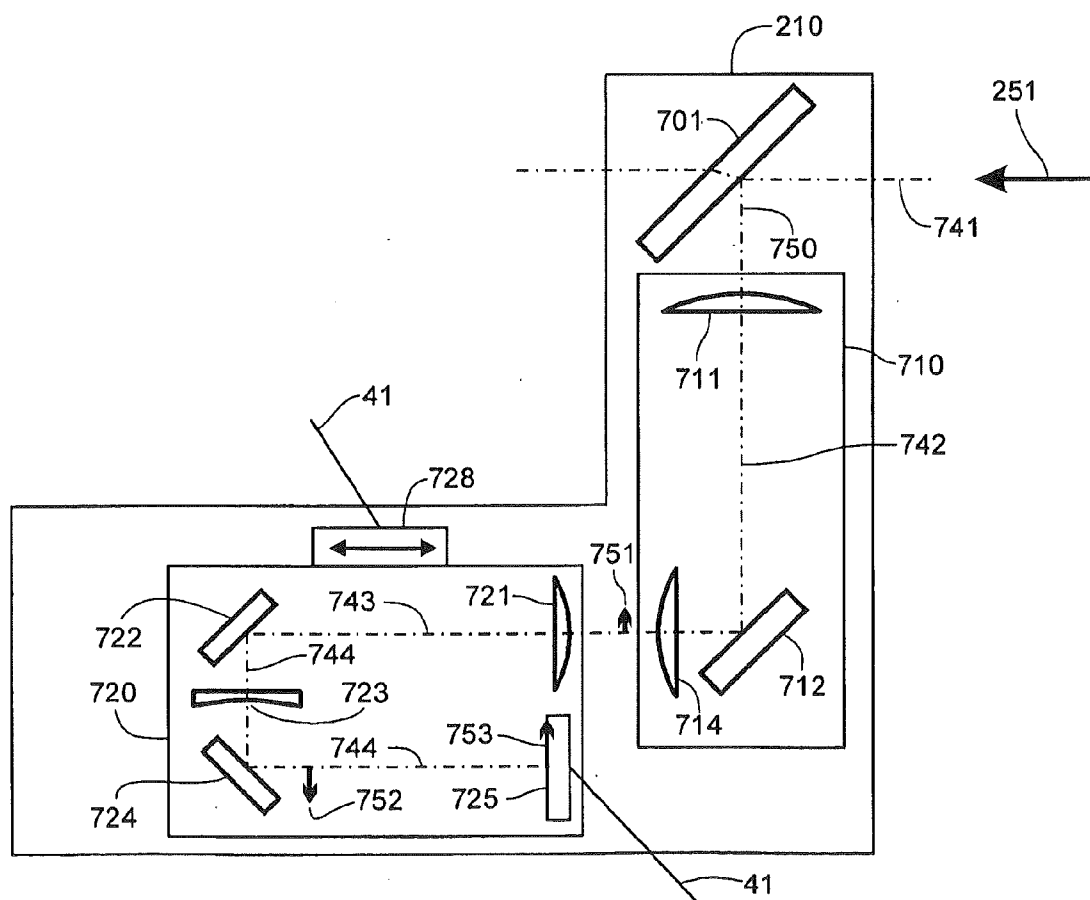
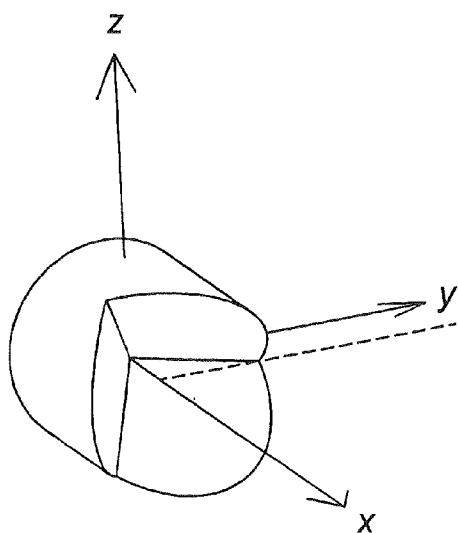
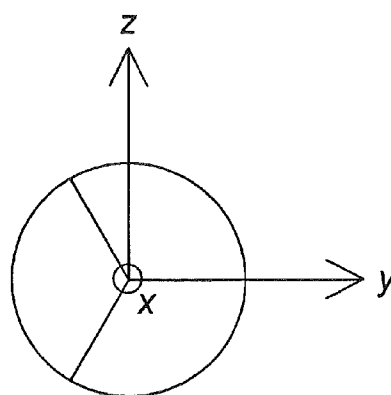

Figure 7



PERSPECTIVE VIEW  
Figure 8a



FRONT VIEW  
Figure 8b

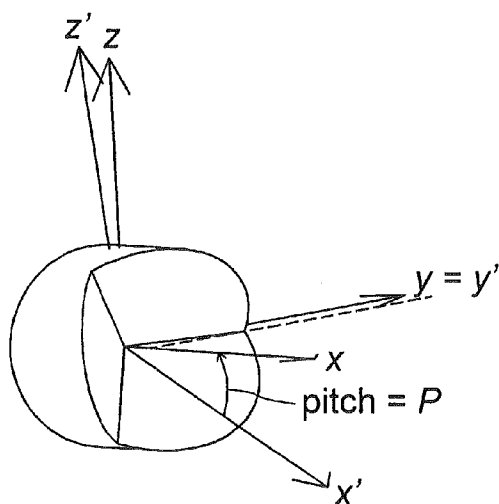

PERSPECTIVE VIEW  
Figure 9a

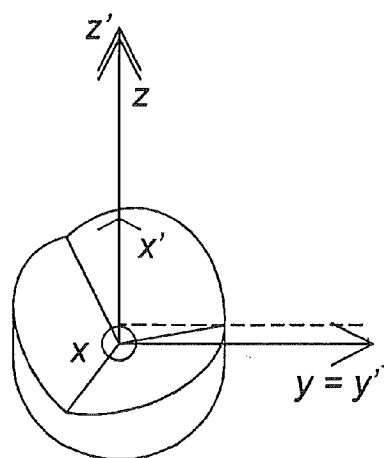

FRONT VIEW  
Figure 9b



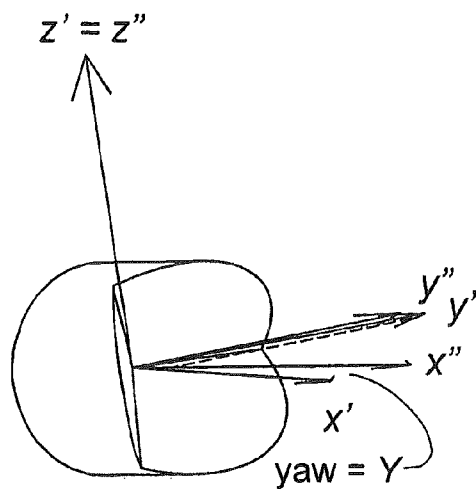

PERSPECTIVE VIEW

Figure 10a

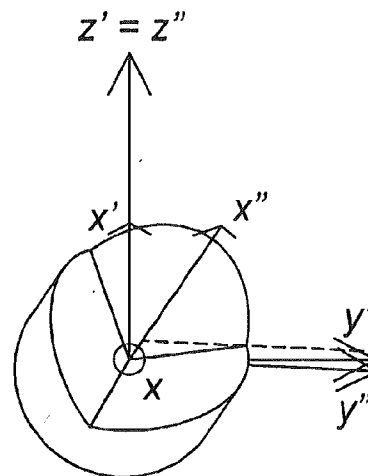

FRONT VIEW

Figure 10b

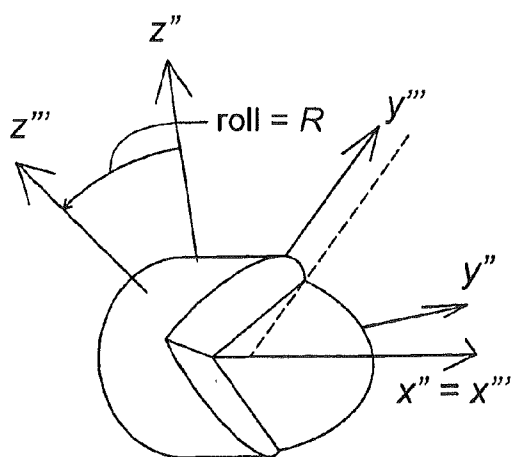

PERSPECTIVE VIEW

Figure 11a

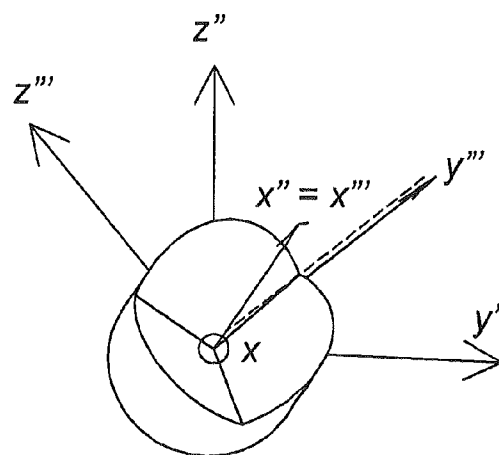

FRONT VIEW

Figure 11b

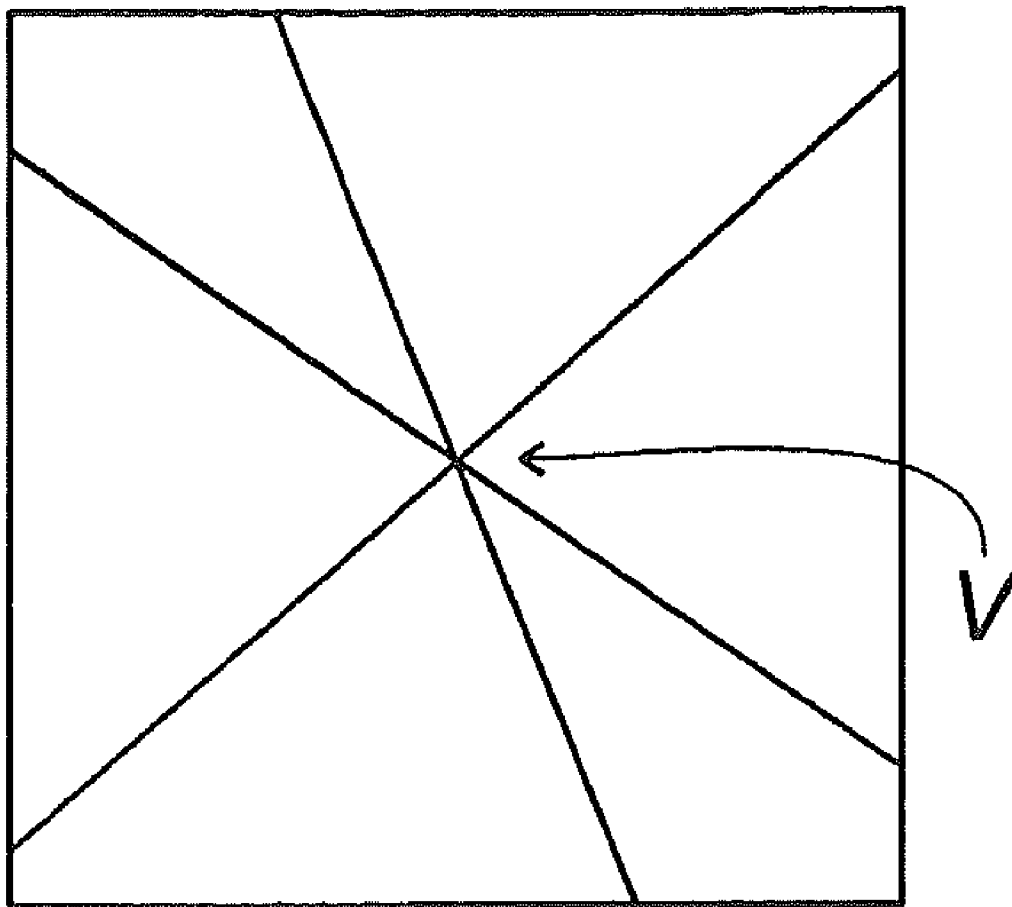

Figure 12

Figure 13

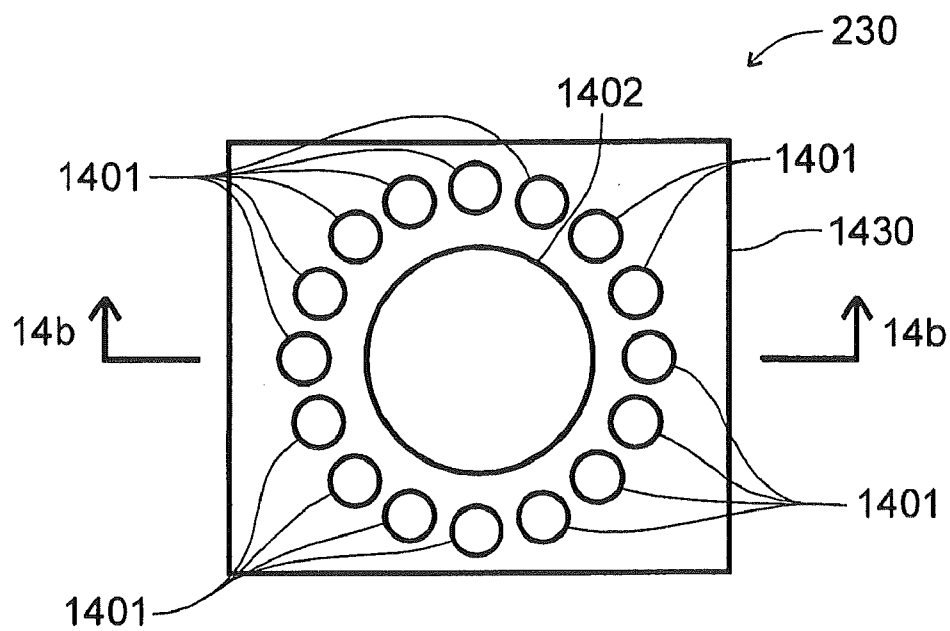

Figure 14a

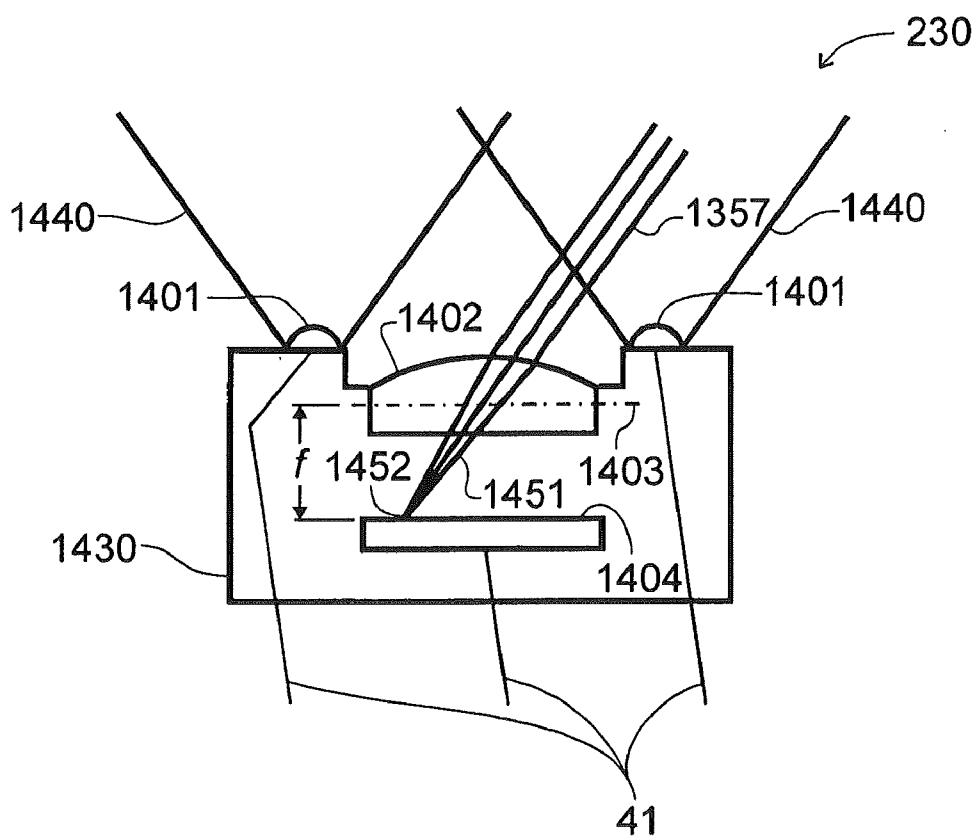

Figure 14b

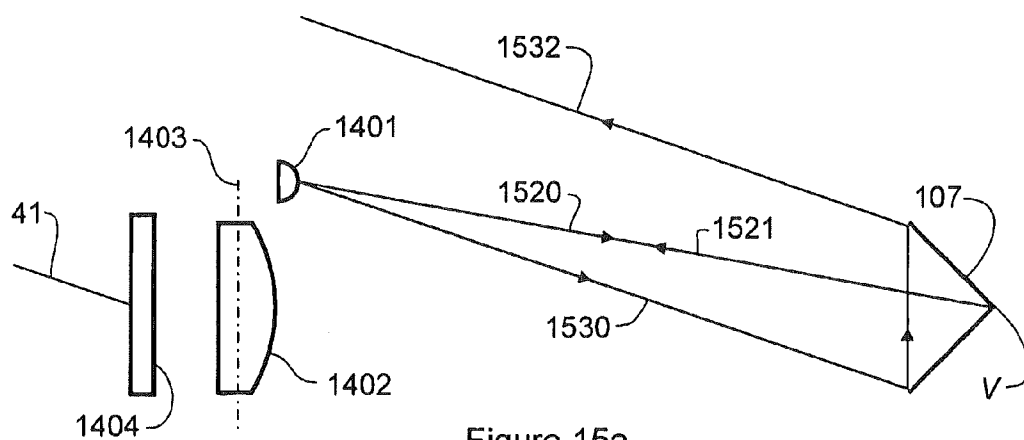

Figure 15a

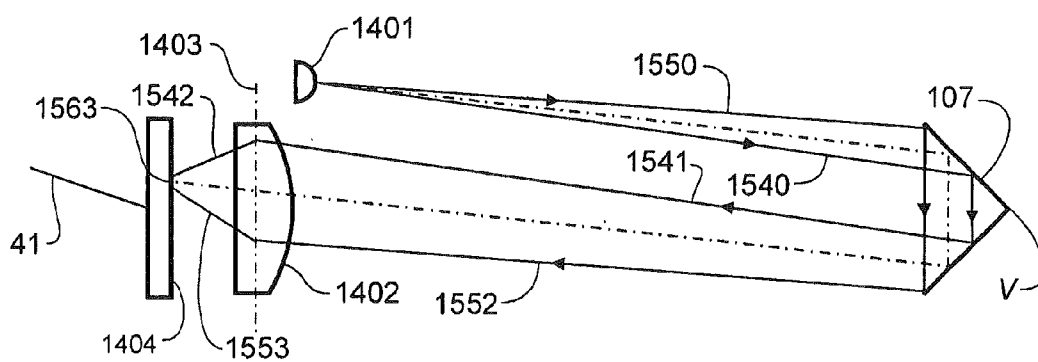

Figure 15b

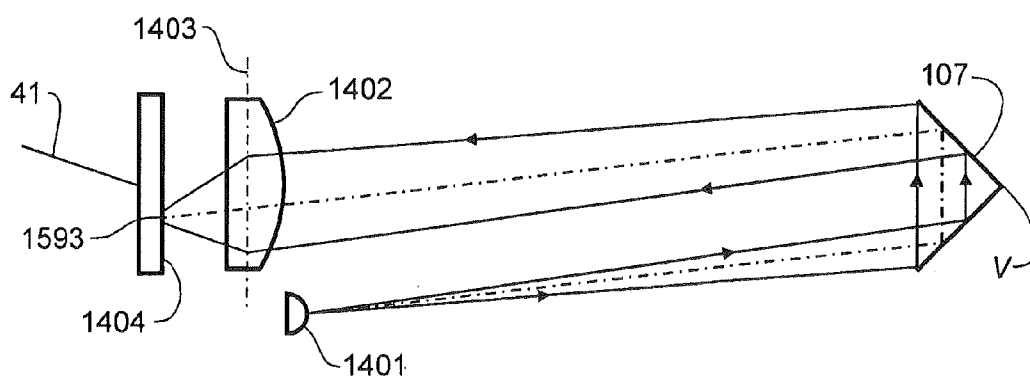

Figure 15c

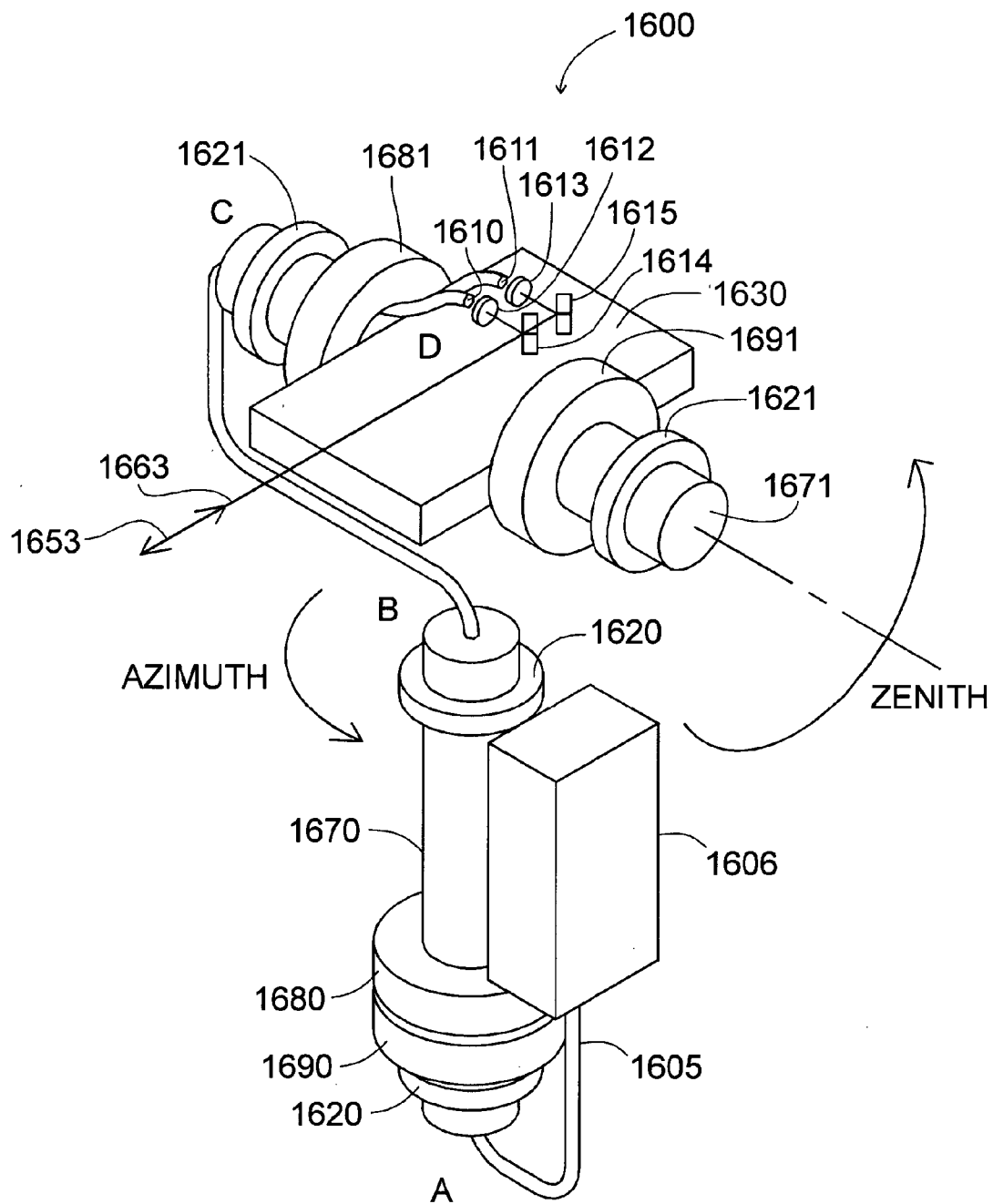

Figure 16

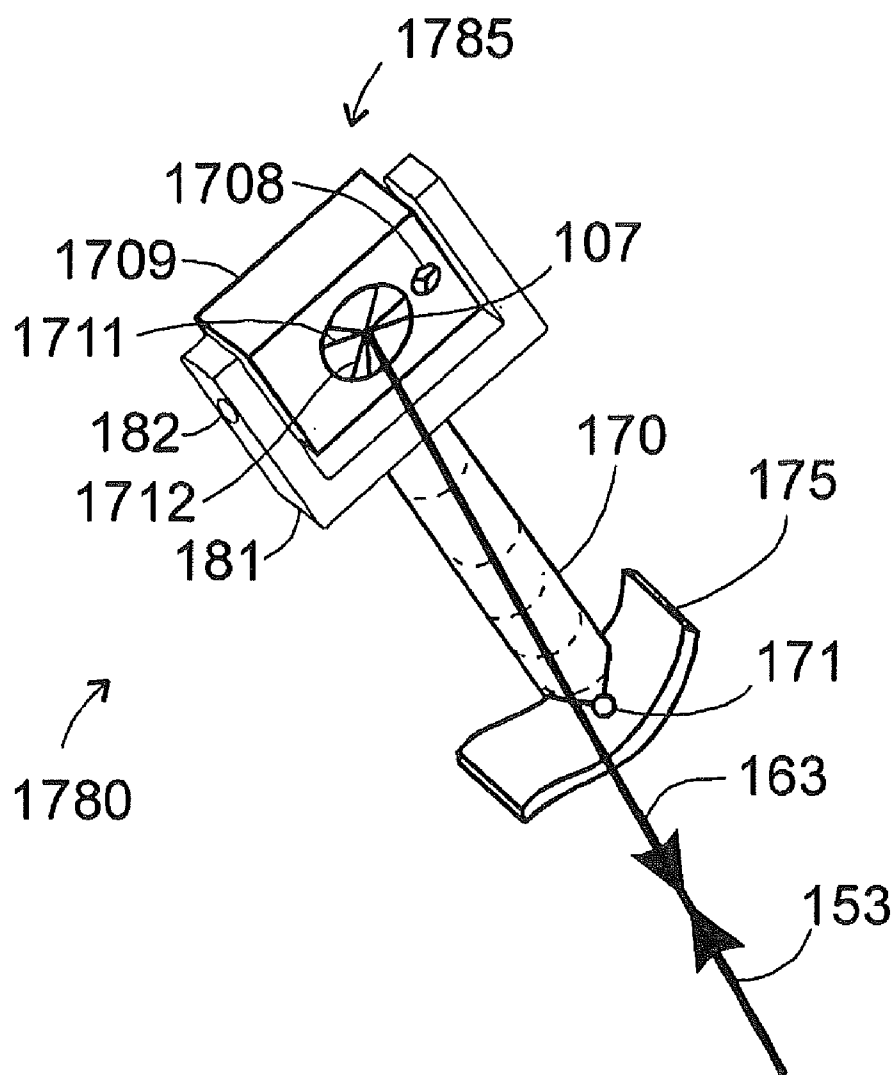

Figure 17

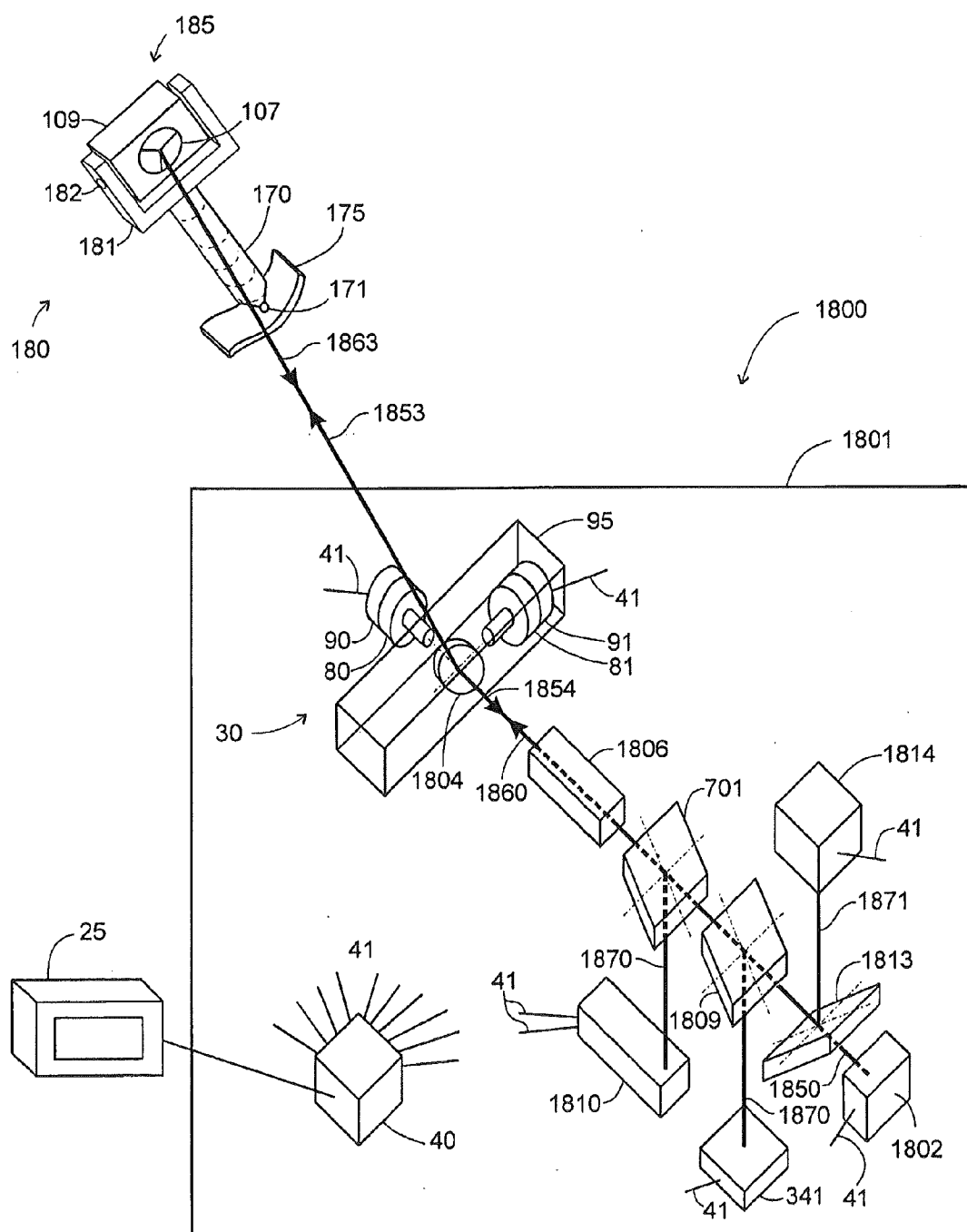

Figure 18



# **LASER-BASED COORDINATE MEASURING DEVICE AND LASER-BASED METHOD FOR MEASURING COORDINATES**

## **CROSS-REFERENCE TO RELATED APPLICATIONS**

**[0001]** The present application is a Continuation Application of U.S. Ser. No. 09/621,645 filed on Jul. 24, 2000, which claims the benefit of U.S. Patent Application Nos. 60/171,474 filed Dec. 22, 1999, 60/145,686 filed Jul. 26, 1999 and 60/145,315 filed Jul. 23, 1999, which are hereby incorporated by reference. The present application also hereby incorporates by reference U.S. patent application Ser. No. 09/285,654 filed Apr. 5, 1999.

## **BACKGROUND OF THE INVENTION**

**[0002]** 1. Field of the Invention

**[0003]** The present invention relates to a coordinate measuring device and, more particularly, to a laser based coordinate measuring device.

**[0004]** 2. Discussion of the Related Art

**[0005]** There is a class of instrument that measures the coordinates of a point by sending a laser beam to a retroreflector target that is in contact with the point. The instrument determines coordinates by measuring the distance and the two angles to the retroreflector target. There is another class of instrument that is capable of measuring the three orientation angles (pitch, yaw, and roll) of a retroreflector target. If such an instrument can also measure the three coordinates of a point in space, it is said to measure six degrees of freedom. However, such six degree-of-freedom systems, whether or not they are employing laser techniques, are generally inaccurate, slow, limited in radial or angular range, and/or expensive. Exemplary systems for determining position (three to six degrees of freedom) are described by U.S. Pat. No. 4,790,651 to Brown et al.; U.S. Pat. No. 4,714,339 to Lau et al.; U.S. Pat. No. 5,505,789 to Salcudean; U.S. Pat. No. 5,367,373 to Busch-Vishniac et al.; U.S. Pat. No. 5,973,788 to Pettersen et al.; and U.S. Pat. No. 5,267,014 to Prenninger, et al. (the disclosures of which are hereby incorporated by reference).

**[0006]** The laser tracker is a particular type of coordinate-measuring device that tracks the retroreflector target with one or more laser beams it emits. To provide a beam-steering mechanism for this tracking function, laser trackers conventionally include a stationary base onto which a rotating stage or platform is mounted. Until now, most laser trackers have used optical elements, such as mirrors or prisms, to steer the laser beam from its source in the base to optics in the rotating stage and through or off those optics toward the retroreflector. These optical elements and their mounts are costly. Also, they are subject to tilting and bending as a result of thermal and/or mechanical stresses that are usually present in tracker work environments. The consequence of these stresses is reduced accuracy and stability. Examples of beam-steering laser trackers are described by Lucy, et al., *Applied Optics*, pp. 517-524, 1966; Bernard and Fencil, *Applied Optics*, pp. 497-505, 1966; Sullivan, *SPIE*, Vol. 227, pp. 148-161, 1980; U.S. Pat. No. 4,020,340 to Cooke; U.S. Pat. No. 4,025,193 to Pond; U.S. Pat. No. 4,386,848 to Clendenin et al.; U.S. Pat. No. 4,436,417 to Hutchin; U.S. Pat. No. 4,457,625 to Greenleaf et al.; U.S. Pat. No. 4,714,339 to Lau et al.; U.S. Pat. No. 4,721,385 to Jelalian et al.; Gennan Patent DE 3205362 A1 to Pfeifer et al. (which are hereby incorporated by reference). An

example of a beam-steering mechanism that uses prismatic optical elements is described by U.S. Pat. No. 4,790,651 Brown et al. (which is hereby incorporated by reference).

**[0007]** A device that is closely related to a laser tracker is the laser scanner. The laser scanner steps one or more laser beams to points on a diffuse surface. The laser tracker and laser scanner are both coordinate-measuring devices. It is common practice today to use the term laser tracker to also refer to laser scanner devices having distance- and angle-measuring capability. This broad definition of laser tracker, which includes laser scanners, is used throughout this application.

**[0008]** An alternative to steering the laser beam with a mirror or prism is to launch the laser beam from an optical fiber mounted on a rigid platform. Although such devices have been built, none has taken full advantage of the simplicity, stability, and flexibility possible with such an approach. For example, such systems usually require separate optical fibers for transmitting and receiving the laser light. An exemplary system that tracks a laser beam launched from an optical fiber is described in Nakamura, et al., *Review of Scientific Instruments*, pp. 1006-1011, 1994; Takatsuji et al., *Measurement Science & Technology*, pp. 38-41, 1998; Takatsuji, et al., *Measurement Science & Technology*, pp. 1357-1359, 1998; and Takatsuji, et al., *Dimensional Metrology in the 21<sup>st</sup> Century*, International Dimensional Metrology Workshop sponsored by Oak Ridge Metrology Center, May 10-13, 1999 (which are hereby incorporated by reference). Non-tracking systems that launch laser beams from optical fibers are numerous in the prior art and include U.S. Pat. No. 4,459,022 to Morey; U.S. Pat. No. 5,095,472 to Uchino, et al.; U.S. Pat. No. 5,198,874 to Bell et al.; U.S. Pat. No. 5,200,838 to Nudelman; U.S. Pat. No. 5,402,230 to Tian, et al.; U.S. Pat. No. 5,508,804 to Furstenau; and U.S. Pat. No. 5,557,406 to Taylor (which are hereby incorporated by reference).

## **SUMMARY OF THE INVENTION**

**[0009]** Accordingly, the present invention is directed to a laser-based coordinate measuring device that substantially obviates one or more of the problems due to limitations and disadvantages of the related art.

**[0010]** An object of the present invention is to provide a laser-based coordinate measuring device with improved laser beam steering, six degree of freedom measurements, and capability to locate multiple retroreflectors distributed throughout large volumes.

**[0011]** Another object of the present invention is to provide a reliable laser-based coordinate measuring device that is easily manufactured at a low cost without complex beam-steering optics.

**[0012]** Additional features and advantages of the invention will be set forth in the description that follows, and in part will be apparent from the description, or may be learned by practice of the invention. The objectives and other advantages of the invention will be realized and attained by the structure particularly pointed out in the written description and claims hereof as well as the appended drawings.

**[0013]** To achieve these and other advantages and in accordance with the purpose of the present invention, as embodied and broadly described, a laser based coordinate measuring device for measuring a position of a remote target comprising a stationary portion having at least a first laser radiation source and at least a first optical detector; a rotatable portion that is rotatable with respect to the stationary portion; and at

least a first optical fiber system for optically interconnecting the first laser radiation source and the first optical detector with an emission end of the first optical fiber system, the emission end disposed on the rotatable portion for emitting laser radiation to the remote target and for receiving laser radiation reflected from the remote target, wherein an emission direction of the laser radiation is controlled according to the rotation of the rotatable portion.

**[0014]** In another aspect, a laser based coordinate measuring device comprises a rigid structure rotatable about two substantially orthogonal axes; a laser radiation source disposed off the rigid structure to provide laser radiation; an optical detector disposed off the rigid structure; a retroreflective target disposed remote from the rigid structure; a first optical fiber path optically coupled with the laser radiation source to transmit laser radiation from the laser radiation source to the rigid structure, the first optical fiber path having an end disposed on the rigid structure for emitting the laser radiation to the retroreflective target according to an orientation of the rigid structure and for receiving retroreflected radiation reflected by the retroreflective target; and an optical coupler optically connecting the optical detector with the first optical fiber path to receive the retroreflected radiation.

**[0015]** In another aspect, a laser based coordinate measuring device for measuring a position of a remote target comprises a stationary portion having at least a first laser radiation source; a rotatable portion that is rotatable about first and second axes of rotation with respect to the stationary portion; an optical fiber path for optically interconnecting the first laser radiation source with the rotatable portion, wherein a first portion of the optical fiber path is disposed along the first axis and a second portion of the optical fiber path is disposed along the second axis.

**[0016]** In another aspect, a laser based coordinate measuring device comprises a structure rotatable about two substantially orthogonal axes; a laser radiation source disposed off the rotatable structure to provide laser radiation; a retroreflective target disposed remote from the rotatable structure, the retroreflective target having a pattern thereon; an optical system for directing the laser radiation from the laser radiation source to the rotatable structure and then to the retroreflective target in accordance with the rotation of the rotatable structure, the retroreflective target reflecting the laser radiation to the rotatable structure; and an orientation camera optically coupled with the reflected laser radiation to determine an orientation of the retroreflective target, the orientation camera including a detector and a lens system that forms an image of the pattern on the detector.

**[0017]** In another aspect, a laser based coordinate measuring device comprises a structure rotatable about two substantially orthogonal axes; a laser radiation source disposed off the rotatable structure to provide laser radiation; a retroreflective target disposed remote from the rotatable structure; an optical system for directing the laser radiation from the laser radiation source to the rotatable structure and then to the retroreflective target in accordance with the rotation of the rotatable structure, the retroreflective target reflecting the laser radiation to the rotatable structure; and an orientation camera disposed on the rotatable structure and optically coupled with the reflected laser radiation to determine a three dimensional orientation of the retroreflective target.

**[0018]** In another aspect, a laser based coordinate measuring system comprises a structure rotatable about two substantially orthogonal axes; a target disposed remote from the

rotatable structure; a locator camera disposed on the rotatable structure for determining an approximate location of the target; and an actuator system to orient the rotatable structure in accordance with the location determined by the locator camera.

**[0019]** In another aspect, a laser based method for measuring coordinates of a remote retroreflective target comprises the steps of coupling laser radiation into a first end of an optical fiber path, the optical fiber path having a second end disposed on a rotatable structure; controlling the rotation of the rotatable structure to direct the laser radiation to the remote retroreflective target; coupling a first portion of retroreflected laser radiation with an orientation camera; coupling a second portion of the retroreflected laser radiation with a distance meter; and calculating three positional and three orientational degrees of freedom of the remote retroreflective target.

**[0020]** It is to be understood that both the foregoing general description and the following detailed description are exemplary and explanatory and are intended to provide further explanation of the invention as claimed.

#### BRIEF DESCRIPTION OF THE DRAWINGS

**[0021]** The accompanying drawings, which are included to provide a further understanding of the invention and are incorporated in and constitute apart of this specification, illustrate embodiments of the invention. In the drawings:

**[0022]** FIG. 1 depicts an embodiment of a laser tracker according to the present invention with a beam-steering mechanism and six degree-of-freedom measurement capability;

**[0023]** FIG. 2 depicts in block form the major components of a rigid structure of the laser tracker of FIG. 1;

**[0024]** FIG. 3 depicts in block form components of the beam combiner of FIG. 2;

**[0025]** FIG. 4 depicts the components of the coupler assembly of FIG. 3;

**[0026]** FIG. 5 depicts the components of the interferometer assembly of FIG. 3;

**[0027]** FIG. 6 depicts in block form components of the beam expander of FIG. 2;

**[0028]** FIG. 7 depicts in block form components of the orientation camera of FIG. 2 showing the locations of the intermediate and final images;

**[0029]** FIGS. 8a and 8b define the coordinate system for an unrotated cube-corner retroreflector;

**[0030]** FIGS. 9a and 9b show the effect of pitch angle on the retroreflector;

**[0031]** FIGS. 10a and 10b show the effect of yaw angle on the retroreflector;

**[0032]** FIGS. 11a and 11b show the effect of roll angle on the retroreflector;

**[0033]** FIG. 12 illustrates the appearance of the image on the photosensitive array within the orientation camera;

**[0034]** FIG. 13 depicts the laser tracker of FIG. 1 where the rigid structure is rotated to enable a wide-field locator camera to simultaneously view plural retroreflector targets;

**[0035]** FIG. 14a is a front view of the locator camera on the rigid structure;

**[0036]** FIG. 14b is a cross sectional view of the locator camera of FIG. 14a taken along line 14b-14b;

**[0037]** FIGS. 15a-15c depict the formation of an image on the wide-field locator camera;

[0038] FIG. 16 depicts a method of routing optical fibers near the two mechanical axes;

[0039] FIG. 17 depicts a probe assembly of the preferred second embodiment; and

[0040] FIG. 18 depicts a conventional laser tracker to which an orientation camera has been added for measuring six degrees of freedom.

#### DETAILED DESCRIPTION OF THE PREFERRED EMBODIMENTS

[0041] Reference will now be made in detail to the preferred embodiments of the present invention, examples of which are illustrated in the accompanying drawings.

[0042] The present invention may be implemented as a laser-based coordinate measurement machine, laser tracker, or other suitable system. The present invention provides a new type of beam-steering mechanism; the ability to measure six degrees of freedom rather than just three degrees of freedom; and the ability to locate a plurality of retroreflector targets over a relatively wide field of view.

[0043] The invention does not require beam-steering optics because the laser light is routed through the laser tracker with optical fibers rather than with beam-steering mirrors or prisms. Laser light is processed, detected, and analyzed by optical and electrical components located for the most part away from the rotating elements within the tracker. One advantage of this approach is that it reduces the size and cost of the laser tracker system. Another advantage is that it improves accuracy and stability of the laser tracker system. The architecture is flexible enough to allow any number of laser beams to be launched without the use of optical beam-steering components.

[0044] The invention also provides the laser tracker with the ability to measure the six degrees of freedom of a target object which, in an exemplary embodiment, may be a cube-corner retroreflector. A hidden-point probe (capable of measuring points that are obscured from view) can be formed by attaching the target object to one end of a shaft and a probe tip to the other end of the shaft. The target object may also be attached directly to a machine tool or to the end-effector of a robot to more precisely control the movement of the tool or robot.

[0045] The invention also provides the laser tracker with the ability to determine the location of a plurality of retroreflector targets over a relatively large volume surrounding the tracker. To activate the target-locator feature of the tracker, the rotating portion of the tracker is turned to bring a ring of LED's surrounding a lens and photosensitive array to face the retroreflector targets. Flashes of light from the LED's travel to the retroreflectors then return to the tracker, where they pass through the lens onto the photosensitive array. The locations of the spots on the array indicate the angular directions of the targets.

[0046] Because the invention has the capability of launching multiple laser beams of different types, several modes of distance measurement are possible. One mode of distance measurement uses a laser beam that tracks a retroreflector to indicate either absolute or incremental distance. Another mode of distance measurement uses a laser beam to scan a diffuse surface. Either or both modes of distance measurement may be included in a given coordinate-measuring device.

[0047] FIG. 1 shows a perspective, block-diagram view of a laser tracking system according to an embodiment of the

invention. The laser tracking system comprises a laser tracker 100 and a probe assembly 180. The probe assembly comprises target object 185, adjustable stage 181, probe shaft 170, and probe tip 171. The target object 185 comprises retroreflector 107 and housing 109 comprise target object 185. Laser tracker 100 emits a laser beam 153 toward cube-corner retroreflector 107 mounted on housing 109. Housing 109 is attached to adjustable stage 181 that is designed to pivot about axis 182 and lock into place. Adjustable stage 181 is attached to probe shaft 170, which is attached on the opposing end to probe tip 171. Probe tip 171 is held in contact with the object 175 under evaluation. With the combination of laser tracker 100, computer 25, and probe assembly 180, it is possible to measure the coordinates of the object 175 under evaluation, even if object 175 is not directly accessible to the laser beam emitted from the tracker.

[0048] The configuration of the laser tracker of FIG. 1 will now be described. Laser 102 on stationary base 101 of the laser tracker 100 injects laser light (at least essentially coherent light having one wavelength) into a first end of an optical fiber 111. The laser of the absolute-distance meter (ADM) 103 injects laser light into a first end of an optical fiber 115 (as shown in FIG. 3) that is contained within optical fiber assembly 112. Laser 104 injects laser light into a first end of an optical fiber 110. These optical fibers are routed to rigid structure 190, at which location laser light is launched out of the second end of optical fibers 110, 111, 115 (as shown in FIG. 3). If desired, the combined laser light may be conditioned by optical elements within rigid structure 190 and emitted from rigid structure 190 as laser beam 153. Laser light 153 travels to retroreflector 107, where it is reflected parallel to laser beam 153. If laser beam 153 is centered on the vertex of the cube-corner retroreflector, then laser beam 163 will coincide with laser beam 153. That is, laser beam 163 will retrace the path of laser beam 153. The laser beam 163 enters rigid structure 190, where it is conditioned, if desired, and injected back into optical fibers 110, 111, and/or 115, or otherwise detected and processed as explained below. Rigid structure 190 is rotated by motor 81 with the angle of rotation indicated by angular encoder 91. Steering platform 195 includes rigid structure 190 and the elements mounted thereto, i.e., motor 81 and angular encoder 91. Steering platform 195 is turned on base 101 by motor 80, with the angle of rotation indicated by angular encoder 90. Rigid structure 190 is therefore supported for rotation about two orthogonal axes on base 101.

[0049] ADM 103 measures the absolute distance from laser tracker 100 to retroreflector 107. This device is capable of measuring the distance to retroreflector 107 in a single shot. Consequently, it can be used to perform rapid point-and-shoot measurements of multiple retroreflector targets. Laser 104 is used in conjunction with optical and electrical elements to measure the incremental distance moved by retroreflector 107. An example of a device that measures incremental-distance movement is the laser interferometer which measures the number of interference fringes that occur as the retroreflector is moved from a starting position. In a laser interferometer, if an obstruction is placed in the path of the interferometer's laser beam, all displacement information will be lost. In this circumstance, if a laser-tracker system has only an incremental-distance measurement system and not an absolute-distance measurement system, then the retroreflector must be returned to a reference position and the measurement started anew. Laser 102 is a stand-alone laser and will be

discussed in more detail with reference to fiber launch assembly 310 of FIG. 3. Any number of laser beams may be sent over optical fibers into rigid structure 190.

[0050] Electronics box 140 provides electrical power to motors 80 and 81, angular encoders 90 and 91, lasers 102 and 104, ADM 103, as well as other electrical components within rigid structure 190. Electronics box 140 analyzes signals from angular encoders 90 and 91, from ADM 103, and from other electrical components to calculate angles and distances from tracker 100 to retroreflector 107. Electronics box 140 is attached to computer 25, which provides application software for the advanced analysis of coordinate data.

[0051] The preferred optical elements within rigid structure 190 are shown in block diagram form in FIG. 2. The main functional blocks within rigid structure 190 include beam-combiner block 200, orientation-camera block 210, beam-expander block 220, and locator-camera block 230.

[0052] The optical fiber assemblies 110, 111, 112, etc. are routed into beam-combiner block 200, which combines the laser beams and sends them out as a single composite laser beam 250 that includes coherent light at a plurality of separate, discrete wavelengths. The composite laser beam 250 passes through orientation-camera block 210 to become laser beam 251. Laser beam 251 is beam expanded by beam-expander block 220, thereby exiting rigid structure 190 as expanded laser beam 153. The laser beam 153 travels to retroreflector 107 as shown in FIG. 1 and returns as laser beam 163. The laser beam 163 retraces the path of the outgoing laser beams 153, 251, 250 back through beam-expander block 220 and orientation-camera block 210 into beam-combiner block 200. Electrical lines 41 provide power from electronics box 140 to mechanical and electro-optical devices. Electrical lines 41 also route electrical signals from electro-optical devices to electronics box 140 for analysis. Rigid structure 190 rotates around the center of shaft 270 which is attached to motor 81 as shown in FIG. 1. In a typical mode of operation, motor 81 rotates rigid structure 190 so that laser beam 153 points toward retroreflector 107, thereby causing laser beam 163 to retrace the path of laser beam 153. In another mode of operation, motor 81 rotates rigid structure 190 until aperture 231 of locator camera 230 is aimed in the general direction of one or more retroreflectors in the surrounding environment. Locator camera 230 determines the approximate location of the retroreflector targets within a wide field of view.

#### Beam-Combiner Block

[0053] FIG. 3 shows diagrammatically the optical and electro-optical components within a preferred beam-combiner block 200. The main assemblies within beam-combiner block 200 are first laser-beam fiber launch and pickup assembly 300, second laser-beam fiber launch and pickup assembly 320, laser-beam fiber launch assembly 310, and position-detector assembly 340.

[0054] First laser-beam fiber launch and pickup assembly 300 receives light at an end of optical fiber 115 which is attached at its opposing end to a laser in the laser and ADM 103 shown in FIG. 1. Laser light (at least one essentially coherent light at a first discrete frequency) travels in optical fiber 115 until it reaches coupler assembly 305. Part of the laser light emerging from coupler assembly 305 is in optical fiber 306. It travels to fiber termination 301, at which point it diverges as cone of light 360. Lens 302 collimates this light as laser beam 361 which passes through beam splitter 314 to become laser beam

365. Another part of the laser light emerging from coupler assembly 305 travels through an optical fiber 307 to fiber retroreflector 303 and returns through optical fiber 307 into coupler assembly 305 thereby forming a reference path as will be discussed with reference to FIG. 4.

[0055] Laser-beam fiber launch assembly 310 receives light from an end of optical fiber 111 which is attached at its opposing end to laser 102 shown in FIG. 1. Laser light travels in optical fiber 111 until it reaches fiber termination 311 where it diverges as cone of light 362. Lens 312 collimates the light as laser beam 363 which then reflects off mirror 313 to become laser beam 364. Laser beam 364 reflects off beam splitter 314 to join laser beam 365 from first laser-beam fiber launch and pick-up assembly 300. Laser beam 365 passes through beam splitter 324 to become laser beam 369.

[0056] Second fiber launch and pickup assembly 320 receives light from an end of optical fiber 110 which is attached at its opposing end to laser 104 shown in FIG. 1. Laser light travels in polarization-maintaining (PM) optical fiber 110 until it reaches fiber termination 321 where it diverges as cone of light 366. Lens 322 collimates the laser light as laser beam 370. Laser beam 370 passes into interferometer assembly 325 and emerges as laser beam 367. The laser beam reflects off mirror 323 as laser beam 368 and off beam splitter 324 as a part of laser beam 369. Laser beam 369 passes through beam splitter 342 to become laser beam 250.

[0057] FIG. 2 shows that laser beam 250 passes out of beam-combiner block 200 and continues through the rest of the elements in rigid structure 190, then travels as laser beam 153 to retroreflector 107 of FIG. 1 and returns as laser beam 163 to rigid structure 190. The laser light of beam 163 retraces the path of laser beams 251, 250 through the optical elements 220, 210 within rigid structure 190. As shown in FIG. 3, when the returning laser beam enters beam-combiner block 200, some of the returning light reflects off beam splitter 342 as laser beam 374. Beam splitter 342 reflects a portion of all of the wavelengths of laser light within laser beam 250. Optical filter 343 blocks all but one wavelength of the light within laser beam 374, which it transmits as laser beam 373. Position detector 341 is aligned so that laser beam 373 strikes the center of position detector 341 when laser beam 153 of FIG. 1 is centered on retroreflector 107. If laser beam 373 does not strike the center of position detector 341, an error signal is generated at detector 341, thereby causing motors 80 and 81 to turn rigid structure 190 to center laser beam 153 on retroreflector 107. In this way, position detector 341 enables the outgoing laser beam 153 of FIG. 1 to automatically track a moving retroreflector 107. Position detector 341 can be any device capable of giving an electrical signal in response to the position of light on a two-dimensional surface. Such a device may include, but is not limited to, a quadrant detector, a lateral-effect detector, a charge-coupled-device (CCD) array, a charge-injection-device (CID) array, or a complementary-metal-oxide-semiconductor (CMOS) array.

[0058] The number of laser beams launched out of beam-combiner block 200 can be increased or decreased as desired by adding more or fewer beam splitters within beam-combiner block 200. One way to combine and separate different types of laser beams is on the basis of wavelength. A dichroic beam splitter is a type of beam splitter that can pass particular wavelengths while reflecting other wavelengths. In a specific implementation using dichroic beam splitters, optical fiber 115 may emit laser light at a wavelength of 1550 nm, optical fiber 111 may emit laser light at 690 nm, and optical fiber 110

may emit laser light at 633 nm. Thus, beam splitters **314** and **324** may be dichroic beam splitters with the following characteristics. Beam splitter **314** transmits laser wavelengths longer than 1400 nm, but reflects wavelengths shorter than 1400 nm. Beam splitter **324** transmits wavelengths longer than 660 nm, but reflects wavelengths shorter than 660 nm. In this way, the laser beams are combined as they pass through beam-combiner block **200** on the way out of rigid structure **190**. Similarly, the laser beams are separated on the reverse path through beam-combiner block **200**. Combining and separating the wavelengths with dichroic beam splitters reduces the interaction among the laser beams, thereby preventing measurement errors. Furthermore, the use of dichroic beam splitters reduces power loss that would result from the use of wavelength-insensitive beam splitters.

**[0059]** The laser beam sent out of fiber launch assembly **310** may serve a number of purposes. In the specific example shown in FIGS. **1** and **3**, the laser beam launched from second laser-beam fiber launch and pickup assembly **320** is red (633 nm), thereby providing a visible indication of the direction to which the laser beam is pointing. In the event that the laser beam from second laser-beam fiber launch and pickup assembly **320** is turned off or, not visible, is otherwise not available, the laser beam emitted by laser-beam fiber launch assembly **310** can serve as a visible pointer beam to assist the operator in locating retroreflector targets with the tracker. This same laser beam may be used as a part of a complex system for other purposes such as determining the orientation of a retroreflector target. There are occasions in which it is very useful to have the laser tracker emit multiple laser beams. As noted above, the flexible architecture of the invention allows as few or as many laser beams as desired to be launched.

**[0060]** FIG. **4** shows a detailed view of the coupler assembly **305**. Laser light enters coupler assembly **305** on optical fiber **115** and travels to Faraday isolator **420** which allows light to travel in only one direction. Faraday isolator **420** is included to prevent back-reflected laser light from entering and destabilizing the laser found in the ADM **103**. The laser light passes through Faraday isolator **420** and enters optical coupler **401** which, in an exemplary configuration, sends 85% of the optical power to optical coupler **402** and 15% of the optical power to optical coupler **403**. Of the optical power entering coupler **402**, a portion such as one half is sent to low-reflectance termination **412** and the remaining half travels to optical fiber **306**. As shown in FIGS. **1** and **3**, the laser light in optical fiber **306** is launched from the fiber and travels to retroreflector **107**. The light from the retroreflector retraces its path through the laser tracker and re-enters optical fiber **306**. When light is received via optical coupler **402**, half of the optical power is sent to the Faraday isolator **402** where it is blocked. The remainder is sent to optical fiber **309** and continues to ADM **103** via optical fiber assembly **112**. Of the optical power that is sent from optical coupler **401** to optical coupler **403**, half travels to low-reflectance termination **413**, and the other half travels along optical fiber **307** to fiber retroreflector **303**. The light retraces its path back along optical fiber **307** into coupler **403**. Half of the optical power is sent to coupler **401** where it is sent in equal parts to the low-reflectance termination **411** and the Faraday isolator **420**. The other half of the optical power is sent into optical fiber **308** and continues to ADM **103** via optical fiber assembly **112**.

**[0061]** The optical couplers shown in FIG. **4** split light into two paths in the forward direction and two paths in the reverse direction. A low-reflectance termination is used to absorb the

light in one of the four possible paths (two forward paths plus two reverse paths). Another term for a possible path is a "port," so the couplers shown in FIG. **4** are examples of four-port couplers having a low-reflectance termination on one of the four ports. An alternative to the type of coupler shown in FIG. **4** is the optical circulator, which has three ports, rather than four, ports. In other words, in an optical circulator, the laser light travels along one optical-fiber path in the forward direction and branches to a different optical fiber path in the reverse direction. For the purposes of this invention, the term optical coupler is used to encompass both four-port and three-port light splitting devices. In other words, a term fiber-optic coupler (or simply coupler) is understood to include any type of device that splits light in an optical fiber and therefore can be either a four-port coupler or a three-port circulator.

**[0062]** For absolute-distance measurement, two paths are used: a measurement path and a reference path. Both paths begin at the laser of the ADM **103** and include the optical fiber **115** and the Faraday isolator **420**. In the measurement path, the laser light travels through optical fiber **306**, through rigid structure **190**, to the retroreflector **107** and back, into fibers **306** and **309**, and then into a measurement detector (not shown) in the ADM **103**. In the reference path, the laser light travels through optical fiber **307**, to the fiber retroreflector **303** and back, into fibers **307** and **308**, and then into a reference detector (not shown) in the ADM **103**. The optical fibers **308** and **309** are in the reference and measurement channels, respectively, and are matched in length. They are routed in close proximity to one another so that the local temperatures experienced by each are nearly equal. This commonality of length and temperature has the effect of minimizing the errors caused by temperature-induced changes in the index of refraction of the optical fibers. Without this commonality, a changing temperature might be mistaken for a changing distance to the retroreflector.

**[0063]** Many types of ADM are compatible with the fiber delivery beam-steering mechanism depicted in FIG. **1**. While any suitable type of ADM can be employed, an exemplary type of ADM operates by measuring the phase shift of laser light that is intensity modulated by a sine wave. Thus, the particular type of laser might be a distributed feedback (DFB) semiconductor laser whose optical power is modulated by the direct application of a radio-frequency (RF) electrical signal at a single (sinusoidal) frequency of 3 GHz. For any given distance to the retroreflector **107**, there will be a corresponding difference in the phase of the reference and measurement channels. If  $a$  is a constant,  $f$  is the frequency of modulation (3 GHz),  $c$  is the speed of light ( $\approx 3 \times 10^8$  m/s),  $n$  is the group index of refraction of the air through which the laser light travels ( $\approx 1$ ),  $m$  is an integer, and  $\phi$  is the phase difference measured by the ADM, then the distance  $d$  from laser tracker **100** to retroreflector **107** is given by the following formula:

$$d = a + \frac{c}{2fn} \left( m + \frac{\phi}{2\pi} \right). \quad (1)$$

The constant  $a$  sets the distance scale so that a distance of zero is set at the pivot point through which the laser beam appears to emanate as the laser tracker is turned to different angles. The pivot point is located approximately at the intersection of the laser beam and the center of shaft **270**. The integer  $m$  is equal to the number of complete multiples of  $2\pi$  radians in the

phase difference (measurement phase minus reference phase) measured by the ADM. For example, if the frequency of modulation  $f$  is 3 GHz, then from Eq. (1) the distance corresponding to a phase difference of  $2\pi$  radians is approximately  $3 \times 10^8 / (2(3 \times 10^9)) = 0.05$  m. This distance is sometimes referred to as the unambiguous range. If the distance  $d$  is 1.22 meters, then the number of complete multiples of  $2\pi$  radians in the phase difference is  $\text{int}(1.22/0.05) = 24$  and the residual phase shift is approximately  $\phi = 2\pi(1.22 - 0.05 \cdot 24) = 0.05 \cdot 0.8\pi$  radians. The most convenient way to determine the integer  $m$  is to temporarily reduce the frequency  $f$  to a value that is small enough to cover the entire range of interest, but with an accuracy that is large enough to determine the value of  $m$ . For example, suppose that the frequency is temporarily reduced to 2.5 MHz. In this case, the unambiguous range is  $3 \times 10^8 / (2(2.5 \times 10^6)) = 60$  m. If the accuracy of the phase measurement is one part in  $10^5$ , then the position of retroreflector **107** is known to an accuracy of  $60 \cdot 10^{-5} = 0.6$  mm at any distance up to 60 meters from the tracker. This value is much smaller than the unambiguous range of 50 mm for the higher modulation frequency of 3 GHz. This means that a single measurement of phase difference with the lower modulation frequency is sufficient to determine the integer  $m$  in Eq. (1). This technique of reducing the frequency to determine the value of  $m$  is of greatest value if it is needed only at the start of a measurement or after the laser beam has stopped tracking the retroreflector **107**. For this to be the case, the phase measurements must be taken rapidly enough to ensure that the retroreflector has not moved over a complete unambiguous range between measurements. For example, if measurements are made 1000 times per second, then the radial speed must not exceed  $(0.05)(1000)/2 = 25$  meters per second. The human arm is not capable of moving a retroreflector target at a radial speed of greater than about 4 meters per second, so this technique of determining  $m$  is feasible under the conditions given above.

**[0064]** The modulated laser light that travels on optical fibers **308** and **309** within optical fiber assembly **112** arrives at optical detectors located within ADM **103**. These optical detectors convert the laser light to electrical signals. For the particular type of ADM described above, electrical components within ADM **103** process the electrical signal to determine the phase of the signal for the measurement and reference paths.

**[0065]** As shown in FIG. 3, laser light that is launched from optical fiber **110** is collimated by lens **322** to become laser beam **370**. This laser beam travels to interferometer assembly **325**, a detailed view of which is shown in FIG. 5. The laser light of beam **370** is linearly polarized at 45 degrees to the plane of the paper in FIG. 5. In other words, half of the laser light is polarized in the plane of the paper and half of the light is polarized perpendicular to the plane of the paper, with both polarizations having the same phase. The arrow that is perpendicular to laser beam **370** in FIG. 5 represents the laser light that is polarized in the plane. The small circle that is centered on laser beam **370** in FIG. 5 represents the laser light that is polarized perpendicular to the plane of the paper. Laser beam **370** travels to polarizing beam splitter **501**. The portion of laser beam **370** that is polarized perpendicular to the plane of the paper in FIG. 5 reflects off polarizing beam splitter **501** to become laser beam **510**. The light travels to quarter waveplate **502** having a fast axis oriented at 45 degrees to the plane of the paper in FIG. 5. The waveplate converts the polarization state of laser beam **510** from linear to circular. Lens **503**

focuses the light onto mirror **504**, which retroreflects the laser beam **510** back on itself. Alternatively, a retroreflector (such as a cube-corner retroreflector) may be substituted for lens **503** and mirror **504**. Lens **503** collimates the retroreflected light, sending it back through quarter waveplate **502**, changing the polarization state of the light from circular to linear, with the direction of the linearly polarized light now in the plane of the paper. This light, which is now p-polarized with respect to the polarizing beam splitter **501**, passes through the beam splitter to become part of laser beam **511**. That portion of laser beam **370** that is in the plane of the paper in FIG. 5 travels straight through polarizing beam splitter **501** to become laser beam **367**. This light passes through quarter waveplate **367**, whose fast axis is oriented at 45 degrees with respect to the plane of the paper. When laser beam **367** passes through the waveplate, its polarization state changes from linear to circular. The resulting laser beam travels through the optical elements in rigid structure **190**, travels to retroreflector **107**, and travels back through the optical elements in rigid structure **190** to arrive at quarter waveplate **505**. As laser beam **367** travels in the reverse direction through quarter waveplate **505**, its polarization state changes from circular to linear, with the direction of the linearly polarized laser light now in perpendicular to the plane of the paper in FIG. 5. (As an alternative to placing quarter waveplate **505** inside interferometer assembly **325**, the waveplate may be placed at some later point along the path of the laser beam.) Laser beam **367**, which is now s-polarized with respect to polarizing beam splitter **501**, reflects off the beam splitter to become part of laser beam **511**. Laser beam **511** comprises of two portions: a reference portion that is polarized in the plane of the paper and a measurement portion that is polarized perpendicular to the plane of the paper. As the retroreflector **107** is moved in a radial direction with respect to laser tracker **100**, the phase difference between these two linearly polarized components will vary. There will be a phase change of  $2\pi$  radians for each change of one-half wavelength in the radial distance to the retroreflector. Here, the wavelength is that of the laser light in laser beam **370** as seen in the local medium (air) through which the laser light travels. Laser beam **511** travels to processing optics **506**, which uses optical elements such as beamsplitters, waveplates, and optical detectors to provide two electrical signals. One electrical signal is proportional to  $\cos p$ , and the other electrical signal is proportional to  $\sin p$ , where  $p$  is the phase difference between the two linearly polarized portions of laser beam **511**. The electrical signals are sent to a counter circuit **507** that counts the number of half wavelengths traveled by retroreflector **107**. The product of the wavelength of the light and the number of wavelengths traveled gives the total displacement of retroreflector **107** relative to some starting position. Counter **507** sends electrical signals over electrical line **41** to electronics box **140** for conversion from counts to a radial distance. If laser beam **153** is obstructed from reaching retroreflector **107**, even for a moment, then information on the correct number of counts is lost, and the measurement must be started anew from some reference position whose distance to the tracker has been previously established. The type of interferometer shown in FIG. 5 is known as a homodyne interferometer because the reference portion and measurement portion that are combined to form laser beam **511** are both at the same wavelength. Alternatively, a heterodyne interferometer in which two dif-

ferent laser wavelengths are mixed together prior to optical detection or other suitable system could be used.

#### Beam-Expander Block

[0066] The optical components within beam-expander block 220 of FIG. 2 are shown in FIG. 6. The beam-expander block 220 expands the laser beam as it travels in the forward direction and to contract the laser beam as it travels in the reverse direction. Lens 601 converts collimated laser beam 251 into cone of light 651. Lens 602 converts cone of light 651 into collimated laser beam 153.

[0067] The reason for expanding the laser beam before it leaves rigid structure 190 is to reduce the divergence of the laser beam during propagation. This makes it possible to place retroreflector 107 farther from laser tracker 100 than would otherwise be the case. Alternatively, the beam-expander block 220 could be eliminated by increasing the distance in FIG. 3 between the fiber terminations 301, 311, and 321 and the corresponding lenses 302, 312, and 322 while increasing the focal lengths of lenses 302, 312, and 322 by a corresponding amount. Accordingly, the diameters of laser beams 361, 363, and 370 would be increased, thereby eliminating the need for beam-expander block 220. The disadvantage of this approach is that it requires that many optical elements (lenses, mirrors, beam expanders, and position detector) be made larger to accommodate the larger beam diameters. By adding beam-expander block 220, the overall size of beam-combiner block 200 is reduced.

#### Orientation-Camera Block

[0068] The main elements of orientation-camera block 210 of FIG. 2 are shown in FIG. 7. On the return path from retroreflector 107, laser beam 251 travels along optical axis 741. Beam splitter 701 reflects a portion of the beam to a path along optical-axis segments 750, 742, 743, and 744. Eventually, this reflected light arrives at photosensitive array 753. The complete lens system, which comprises the beam-expander block 220, afocal lens block 710, and relay lenses, 721 and 723, produces an image on the photosensitive array of the pattern of light in the vicinity of the vertex of retroreflector 107. The beam-expander block 220 and the afocal lens block 710 work together to produce a first intermediate image 751 of this pattern of light. The location of first intermediate image 751 will depend on the distance of retroreflector 107 from the laser tracker. Motorized stage 728 is activated to move lens 721 to an appropriate distance from first intermediate image 751. Lens 721 forms second intermediate image 752 located past negative lens 723 but inside the back focal point of negative lens 723. Negative lens 723 converts the second intermediate image into a real image 753 on photosensitive array 725.

[0069] The orientation-camera block 210 allows the distance between the tracker and the retroreflector target to be large. For example, a distance of more than thirty meters is possible. The lens systems of the orientation-camera block 210 and beam-expander block 220 have two main functions. First, a magnification that is approximately constant is maintained so that the image will nearly fill the photosensitive array, thereby maintaining high accuracy for large and small distances alike. Second, the adverse effects of diffraction, which may result in lines or other features changing shape or direction during propagation over large distances, are minimized. To maintain constant magnification, afocal lens sys-

tems 220 and 710 are used. An afocal lens system is one that converts an incoming ray of light that is parallel to the optical axis into an outgoing ray of light that is also parallel to the optical axis. A succession of afocal lens systems, as represented by the combination of lens systems 220 and 710, has the property of constant magnification. In other words, the size of first intermediate image 751 is constant, regardless of the distance from retroreflector 107 to the tracker. If first intermediate image 751 is located between lenses 711 and 714, then it is not possible to place photosensitive array 725 at the location of this intermediate image. Relay lenses 721 and 723 eliminate this problem by converting first intermediate image 751 into image 753 on array 725. Motorized stage 728 places lens 721 an appropriate distance from first intermediate image 751. Knowledge of the distance to retroreflector 107, which is a quantity measured by the tracker, along with knowledge of the focal lengths and positions of the lens elements, is sufficient to determine the correct placement of lens 721. As is explained below, it is not necessary for the lens system to obtain an exactly prescribed magnification, so motorized stage 728 can be relatively inexpensive. The distance that motorized stage 728 must move will depend on the range of distances to be covered, as well as on the magnification of the lens system. Longitudinal magnification of a lens system varies in proportion to the square of the transverse magnification. As an example, suppose that a 12×12 millimeter area of target object 185 is imaged onto a photosensitive array having an area of 3×3 mm. The required (transverse) magnification for the system will then be  $\frac{3}{12} = \frac{1}{4}$ . This could be achieved by making the combined magnification of the afocal lens systems equal to  $\frac{1}{4}$  and the combined magnification of the relay lenses 721 and 723 equal to 1. In this case, however, to cover distances of 1 to 33 meters from the tracker, it would be necessary for motorized stage 728 to have a range of movement of  $(33-1) \text{ m}/4^2 = 2 \text{ m}$ . Such a large range of movement is impractical for most real systems. To solve this problem, the magnification of the afocal lens systems could be reduced, and the reduced magnification could be compensated with the relay lenses. For example, suppose that the afocal lens pairs have a combined magnification of  $\frac{1}{32}$ , while the relay lenses have a combined magnification of 8. In this case, the net magnification is still  $\frac{1}{4}$ , but the motorized stage 728 needs to have a range of movement of only  $(33-1) \text{ m}/32^2 = 31.25 \text{ mm}$ .

[0070] The photosensitive array 725 can be any device capable of returning detailed electrical information about the pattern of light incident on the array. Exemplary photosensitive arrays include the charged-coupled-detector (CCD) array, the charge-injection-device (CID) array, and the complementary-metal-oxide-semiconductor (CMOS) array. Among these, CCD arrays have high performance and small size, but CMOS arrays are often capable of providing high-speed readout with simpler electrical circuitry. CMOS and CID arrays often have the advantageous feature of random-access readout of pixel data.

[0071] We will now discuss how the image on the orientation camera can be used to determine the pitch, yaw, and roll angles of retroreflector 107. FIGS. 8a and 8b show an unrotated cube-corner retroreflector. In other words, in FIGS. 8a and 8b, the roll angle is zero, the yaw angle is zero, and the pitch angle is zero. By definition, the x direction shown in FIGS. 8a and 8b is opposite the direction of the laser beam that is sent into the retroreflector. The three perpendicular reflecting surfaces of the cube-corner retroreflector form



three lines of intersection. As shown in FIG. 8a, the x-y plane contains the x axis and one of the lines of intersection. The x-y plane also contains the y axis, which is perpendicular to the x axis and passes through the vertex of the cube corner. The dashed line in FIG. 8a is parallel to the y axis and has been included for clarity. In the front view of FIG. 8b, they and z axes lie in the plane of the paper, while the x axis points out of the paper. FIGS. 9a and 9b show the effect of rotating the retroreflector about the -y axis by the pitch angle P, which is 15 degrees in this example. This rotation operation results in new coordinate system: x', y', z', with y=y'. FIGS. 10a and 10b show the effect of rotating the retroreflector about the z' axis by the yaw angle Y, which is 10 degrees in this example. This rotation results in a new coordinate system: x'', y'', z'', with z''=z'. FIGS. 11a and 11b show the effect of rotating the retroreflector about the x'' axis by the roll angle R, which is 40 degrees in this example. Note that in FIG. 11b, the x axis (direction opposite that of the laser beam) still points straight out of the paper. The roll, yaw, and pitch angles are found from a measurement of the three lines of intersection by the orientation camera 210. The camera detects the three lines of intersection of cube-corner retroreflector 107. The vertex of cube-corner retroreflector 107, which is defined as the common point of the three reflecting surfaces, remains centered on the photosensitive array 725 of FIG. 7. The electrical signals from photosensitive array 725 may be sent to a local digital-signal processing chip or sent over electrical wires 41 to electronics box 140 of FIG. 1. These electrical components determine the slopes of the three lines of intersection. By definition, they and z axes on the surface of photosensitive array 725 point in the horizontal and vertical directions, respectively. The slope of the first (reference) line of intersection is defined as  $m_1 = \Delta z_1 / \Delta y_1$ , where  $\Delta y_1$  and  $\Delta z_1$  are the horizontal and vertical distances on the surface of photosensitive array 725 from the image of the cube-corner vertex to the image of an arbitrary point on the first line of intersection. The slopes of the second and third lines of intersection are defined in a similar manner as  $m_2 = \Delta z_2 / \Delta y_2$  and  $m_3 = \Delta z_3 / \Delta y_3$ . The three unknown angles, the roll angle R, the yaw angle Y, and the pitch angle P, are found by simultaneously solving the following three equations:

$$m_1 = \frac{\sin P \cos Y / \sqrt{2} - \sin P \sin Y \cos R + \cos P \sin R}{\sin Y / \sqrt{2} + \cos Y \cos R}, \quad (2)$$

$$m_2 = \frac{\sin P \cos Y / \sqrt{2} - \sin P \sin Y \cos(R + 120^\circ) + \cos P \sin(R + 120^\circ)}{\sin Y / \sqrt{2} + \cos Y \cos(R + 120^\circ)}, \quad (3)$$

$$m_3 = \frac{\sin P \cos Y / \sqrt{2} - \sin P \sin Y \cos(R + 240^\circ) + \cos P \sin(R + 240^\circ)}{\sin Y / \sqrt{2} + \cos Y \cos(R + 240^\circ)}. \quad (4)$$

For the example considered here in which R is 40 degrees, Y is 10 degrees, and P is 15 degrees, Eqs. (2)-(4) yield  $m_1 = 0.874$ ,  $m_2 = 0.689$ , and  $m_3 = -2.651$ . As a check of these results, the slope values can also be calculated directly from the y and z values of the lines of FIG. 11b. These calculations yield  $m_1 = 0.7667/0.8772 = 0.874$ ,  $m_2 = 0.5528/-0.8026 = -0.689$ , and  $m_3 = -0.7788/0.2938 = -2.651$ , which match exactly the results obtained from Eqs. (2)-(4).

[0072] The visibility of the lines on photosensitive array 725 of FIG. 7 may be improved by increasing the thickness of the lines of intersection of retroreflector 107 or by coating the lines with a non-reflective material. Thicker lines of intersection on retroreflector 107 will cause the images of the lines seen on the photosensitive array to have higher contrast. However, thicker lines of intersection on retroreflector 107 will not usually result in thicker image lines on photosensitive array 725. Usually, the thickness of the lines as seen on photosensitive array 725 is determined by the effects of diffraction of the laser light that passes through the clear aperture of laser tracker 100. The larger the clear aperture (the opening through which the light passes into the tracker), the smaller will be the deleterious effects of diffraction, which included broadening, smearing, and chopping of the image on photosensitive array 725. The deleterious effects of diffraction are also smaller when the retroreflector 107 is moved closer to the laser tracker 100. Fortunately, for the system considered here, the smearing effects of diffraction are symmetrical about the lines of intersection, so there is no bias in measuring the slopes of the lines.

[0073] The appearance of the lines on the image of photosensitive array is shown in FIG. 12. The lines on this image that pass through vertex V appear on both sides of the vertex. By comparison, FIG. 11b shows that the lines of intersection of the physical cube-corner retroreflector appear on only one side of the vertex. This difference is the result of the symmetry in the paths that light can take when the laser beam is centered on vertex V. For example, if a pencil of light reflects off mirror 1, then mirror 2, then mirror 3 of the cube corner, then another pencil of light can reflect off mirror 3, then mirror 2, then mirror 1. If, instead of striking a mirror, the pencil of light strikes a line of intersection, then the light will not reflect back to the tracker and a dark spot will appear on the image of photosensitive array 725. However, this dark spot would also appear if the light had traveled in the reverse direction before encountering the line of intersection. Hence light entering on either side of vertex V is blocked. It is impossible to tell from the image of the photosensitive array 725 alone which of the three line segments corresponds to which of the three lines of intersection of a cube-corner retroreflector. There are several ways around this problem. The simplest, but least convenient, method for assigning the lines of the image (FIG. 12) to the lines of intersection (FIG. 11b) is to have the operator indicate the approximate orientation of probe assembly 180 at the start of a measurement sequence. An approximate orientation is sufficient to determine which of the image line segments corresponds to each of the lines of intersection. Another simple but effective method is to temporarily turn off or reduce the power of the laser beam 153 emitted by laser tracker 100 and, at the same time, to increase the exposure time of photosensitive array 725. Under these conditions, the photosensitive array will ordinarily be able to make out the features of housing 109 and hence obtain information on the orientation of retroreflector 107. A third method for assigning the line segments to the corresponding lines of intersection is described in a second embodiment that is discussed later.

[0074] The method for determining the pitch, roll, and yaw angles as described above provides has two main advantages. First, an essentially constant-magnification camera maintains the accuracy of the measurement for a probe located either near the tracker or far from it. Second, elimination of spurious diffraction effects improves accuracy, which may otherwise



change the angles of the lines or dramatically change the appearance of the lines, especially at large distances.

[0075] FIG. 1 shows that housing 109 can be pivoted about axis 182 mounted on adjustable stage 181 and then locked in place. This allows cube-corner retroreflector 107 to be oriented in any desired direction. This flexibility in the orientation of retroreflector 107 is desirable because it allows probe tip 171 to be placed in slots, holes, and so forth at any given angle. Preferably shaft 182 is aligned with the vertex of retroreflector 107 to simplify calculations to determine the location of probe tip 171. If the locking mechanism allows a limited number of angular adjustments, each known to a sufficient angular accuracy (perhaps a few arc seconds), then measurement may resume as soon as the lock down is complete. If the locking mechanism is not sufficiently precise, then an alternative approach involves adjusting housing 109 to any given orientation and performing a simple compensation routine to determine the angle between retroreflector 107 and probe shaft 170. Such a compensation routine might include measuring the location of a reference point with a spherically mounted retroreflector target and then measuring the same location with probe assembly 180 tilted to cover a range of pitch, yaw, and roll angles.

[0076] It is possible to replace the described cube-corner retroreflector 107, which is made of three reflecting mirrors, with a cube-corner retroreflector prism formed of solid glass. Each type of retroreflector has advantages. For example, the cube-corner retroreflector that uses mirrors (also known as a hollow-core cube-corner retroreflector) is more accurate because it is not prone to transverse and radial offset errors and because it has no glass/air interface to cause unwanted optical reflections. The solid glass cube-corner retroreflector has a wider field of view and is usually less expensive. Equations (2), (3), and (4) can be readily modified to account for a solid-glass, rather than a hollow-core, cube-corner retroreflector.

#### Locator-Camera Block

[0077] The locator-camera block 230 of FIG. 2 allows laser tracker 100 to quickly determine the approximate location of multiple retroreflectors within a wide field of view. The locator camera is shown in greater detail in FIGS. 14a and 14b. As shown in FIG. 2, locator-camera block 230 is placed to one side of rigid structure 190 and has an aperture at 231, which might be considered the “top” side of rigid structure 190. When rigid structure 190 is rotated about the center of shaft 270, locator-camera block 230 faces the retroreflectors in the region of interest. Locator-camera block 230 then emits cone of light 1320 as shown in FIG. 13. This light reflects off retroreflectors 107, 1311, 1312, and 1313 shown in FIG. 13. Here, retroreflector 107 represents a target of interest and retroreflectors 1311, 1312, and 1313 represent a number of other targets. The corresponding reflected light bundles 1357, 1351, 1352, and 1353 enter rigid structure 190. The light entering locator-camera block 230 falls onto a photosensitive array 1404 in FIG. 14b, and the pattern is analyzed to determine the approximate location of the targets in the region of interest.

[0078] FIGS. 14a and 14b depict an example locator-camera arrangement. A plurality of identical light sources 1401 is provided in a ring surrounding a lens 1402. The individual light sources emit overlapping cones of essentially incoherent light 1440 that collectively constitute the cone of light 1320 in FIG. 13. Each of the retroreflectors 107, 1311-1313 reflects

some of the light from the cone of light 1320 back to the locator-camera block 230 as the bundles of light 1351-1353 or 1357. The bundle of light 1357 is shown in FIG. 14b. Lens 1402 focuses the bundle 1357 down to a spot on the surface of photosensitive array 1404. The photosensitive array 1404 is separated from the front principal plane, 1403, of lens 1402 by the focal length  $f$  of the lens.

[0079] Electrical wires 41 provide power from electronics box 140 to light emitters 1401 and photosensitive array 1404. Electrical wires 41 also transmit the pixel data from photosensitive array 1404 to electronics box 140 for analysis. Electronics box 41 analyzes the pattern of light on photosensitive array 1404 to determine the location of central point 1452 on photosensitive array 1404. Electronics box 140 also performs this analysis of the pattern formed by the other bundles of light returned by the retroreflectors. In other words, reflected light bundles 1357, 1351, 1352, and 1353 are focused by lens 1402 into patterns on photosensitive array 1404. Electronics box 140 analyzes these patterns to determine the central point of each pattern. From the location of the central points, the approximate angular direction to each of the retroreflectors can be determined.

[0080] Suppose that the retroreflector of interest is retroreflector 107. Once the information from the locator camera has been used to determine the approximate direction to retroreflector 107, motors 80 and 81 are activated to turn rigid structure 190 until laser beam 153 points in the approximate direction of retroreflector 107. The tracker then begins a search pattern, in which the direction of laser beam 153 is changed in a systematic fashion. For example, the laser beam might be steered along a spiral pattern. When the laser beam intersects the target, position detector 341 of FIG. 3 senses the reflected light. The signals from position detector 341 provide enough information to enable motors 80 and 81 to point rigid structure 190 directly to the center of retroreflector 107.

[0081] FIG. 15a shows rays of light emitted by light emitter 1401 located above lens 1402. Ray of light 1520 travels to vertex V of retroreflector 107. Reflected light 1521 is sent directly back to light emitter 1401. It does not enter lens 1402 or appear as a spot of light on photosensitive array 1404. Ray of light 1530 is sent to the bottom of retroreflector 107 and emerges as reflected light 1532. It also misses lens 1402 and photosensitive array 1404.

[0082] FIG. 15b shows additional rays of light from light emitter 1401 located above lens 1402. Light emitter 1401 sends ray of light 1540 to a location above vertex V on retroreflector 107. This ray emerges as reflected ray 1541, which passes near the top of lens 1402, is bent into ray 1542, and arrives at photosensitive array 1404 near central point 1563. Light emitter 1401 sends ray of light 1550 to the top of retroreflector 107. This ray emerges as reflected ray 1552, which travels to lens 1402, is bent into ray 1553, and arrives at photosensitive array 1404 near central point 1563. As the distance from light emitter 1401 to retroreflector 107 increases, rays 1541 and 1552 become nearly parallel, and the spot of light about point 1563 gets smaller and smaller.

[0083] FIG. 15c shows rays of light from light emitter 1401 located below lens 1402. The rays of light in the bottom diagram are mirror images of the rays in the middle diagram. If  $N$  is the number of pixels in photosensitive array 1404,  $W$  is the width of photosensitive array 1404,  $D$  is the diameter of lens 1402, and  $h$  is the distance from the edge of lens 1402 to light emitters 1401, the number of pixels between central points 1563 and 1593 will, in most cases, be less than  $\lceil 2N$

$(D+h)/L]$   $\arctan(W/2f)$ . For example, if  $N=5$ ,  $12$ ,  $D=25$  mm,  $h=5$  mm,  $L=3$  m,  $W=13$  mm, and  $f=10$  mm, the number of pixels between central points **1563** and **1593** will be less than six. Since light emitters **1401** are arranged in a circle, the image will be symmetrical, somewhat blurry, and about six pixels across. For retroreflectors further than 3 meters away, as most will be, the pattern of dots will be smaller. Electrical signals are sent from photosensitive array **1404** through electrical wire **41** to electronics box **140**. Electronics box **140** analyzes the intensity of light in the pixels to obtain the best estimate of the center of the pattern produced by each retroreflector.

#### Routing of Optical Fibers

[0084] FIG. 16 shows a configuration of a fiber launch laser tracker **1600** for providing advantageous routing of optical fibers. Here, optical fibers are preferably routed close to the two mechanical axes **1670** and **1671**. The routing of the optical fibers in the system of FIG. 16 has many advantages. For example, a large angular field of view of the tracker can be obtained. Also, bending or kinking of the optical fibers is prevented, thereby preserving measurement accuracy. Laser beam **1653**, which is launched from rigid plate **1690**, travels to retroreflector **107** as shown in FIG. 1 and returns as laser beam **1663**. Laser light from optical fiber **1611** is collimated by lens **1613**, reflected by mirror **1615**, and transmitted through beam splitter **1614**. Laser light from optical fiber **1612** is collimated by lens **1612** and reflected off beamsplitter **1614**. Any number of laser beams can be combined into a common path to form outgoing laser beam **1653**. Returning laser light may pass through a number of elements as previously discussed and omitted in FIG. 16 for clarity. For example, beam splitters for the position detector and the orientation camera may be employed in accordance with the specific application. The returning laser light may reflect off beam splitter **1614** and pass through lens **1612** to be coupled into optical fiber **1610**. Alternatively, the laser light may pass into another device located on rigid plate **1690** for processing as previously discussed, for example, with reference to the absolute distance meter and the interferometer. Similarly, the returning laser light may reflect off mirror **1615** and couple back into optical fiber **1611**. Alternatively, this laser light may travel to another device on rigid plate **1690** for processing.

[0085] The direction of laser beam **1653** is determined by the orientation of rigid plate **1690**, which in turn is determined by the angle of rotation of the zenith mechanical axis **1671** and the azimuth mechanical axis **1670**. The zenith motor **1681** rotates the zenith axis **1671**, and the azimuth motor **1680** rotates the azimuth axis **1670**. Zenith angular encoder **1691** and the azimuth angular encoder **1690** measure the zenith and azimuth angles. Bearings **1681** and **1680** are also attached to the zenith and azimuth axes. The outside of zenith bearings **1621**, zenith angular encoder **1691**, and zenith motor **1681** are attached to the azimuth structural frame (not shown). The azimuth structural frame turns with the azimuth axis. Consequently, the zenith axis rotates within the azimuth structural frame. The outside of azimuth bearings **1620**, azimuth angular encoder **1690**, and azimuth motor **1680** are attached to stationary structural frame (not shown). The stationary structural frame is stationary with respect to the surroundings to which the tracker is mounted. Consequently, the azimuth axis rotates within the stationary structural frame.

[0086] Optical fibers **1610** and **1611** are incorporated into optical fiber assembly **1605**. Optical fiber assembly **1605**

passes through zenith axis **1671** and azimuth axis **1670**. Lasers within optoelectronic module **1606** (which, like the azimuth motor **1680**, is stationary) inject laser light into optical fibers **1610** and **1611**. Optoelectronic module **1606** may also contain optical detectors and electronics to determine the distance to retroreflector **107** or to a diffuse surface under investigation. The optical fiber assembly **1605** travels from optoelectronic module **1606** to the underside of azimuth axis **1670**. It is attached to the stationary structural frame near point A shown in FIG. 16. At point A, the fiber is stationary with respect to the rotating azimuth axis. At the other end of the azimuth axis, optical fiber assembly **1605** is attached to the azimuth structural frame near point B, which rotates along with azimuth axis **1670**. Since one end of the fiber is fixed and the other end of the fiber is rotating with respect to the rotation of the azimuth axis, the optical fiber will experience a torsional twist. In most cases, a gentle twist of this sort will not degrade measurement accuracy. Optical fiber assembly **1605** is routed to the zenith axis, where it is attached to the azimuth structural frame near point C. At point C, the fiber is stationary with respect to the rotating zenith axis. At the other end of the zenith axis, fiber assembly **1605** is attached near point D, which rotates along with the zenith axis **1671**.

[0087] Optical fiber assembly **1605** is routed through the two mechanical axes. The fiber assembly is stationary at one end of each axis. At the other end, the fiber assembly rotates along with the axis. This produces a torsional twist, which is acceptable in most situations. A slightly different method of routing optical fiber assembly **1605** near the two mechanical axes may be preferable in some cases. In this method, the optical fibers are placed in coils to the outside of the mechanical axes, with the end of the optical fiber attached at one end to a point that is stationary relative to the mechanical axis and at the other end attached to a point that moves with the mechanical axis. Here, the diameter of the coils will change slightly as the axis is rotated. In most cases, this small change in the radius of the coiled fiber assembly will not adversely affect measurement accuracy. By heat treating fiber assemblies, it is possible to make low-cost cables that naturally coil into the desired geometry, thereby simplifying production and increasing reliability.

#### Second Embodiment

[0088] The second embodiment of the invention is generally similar to that shown in FIG. 1 except for the probe assembly **180** is replaced by probe assembly **1780**, as shown in FIG. 17. Probe assembly **1780** contains a single small retroreflector **1708** to the side of retroreflector **107**. Retroreflector **1708** is approximately aligned with the first line of intersection. At the start of the measurement, the photosensitive array **725** of FIG. 7 displays a pattern similar to that of FIG. 12, with the details of the pattern dependant on the pitch, yaw, and roll angles of retroreflector **107**. As explained previously, at the start of the measurement, it is not possible to tell which line segments correspond to each of the three lines of intersection. To resolve this ambiguity, the tracker performs a search in which it directs laser beam **153** in succession to each of the six possible locations of retroreflector **1708**. A flash of light on position detector **341** of FIG. 3 indicates that the first line of intersection has been identified. Also on probe assembly **1780**, two thin wires **1711** and **1712** have been stretched across the top of retroreflector **107**. Additional thin wires or alternative shapes may also be used. These wires provide redundant information for determining the

pitch, yaw, and roll angles for those cases in which accuracy is more important than measurement speed.

[0089] Probe assemblies **180** and **1780** can be used in either a scanning mode or a trigger mode. In the scanning mode, probe tip **171**, shown in FIGS. **1** and **17**, is moved across the surface of the object under evaluation **175** while data is continually collected at a high rate. In the trigger mode, probe **180** or **1780** is moved successively to the points of interest. When the probe is properly positioned, the operator triggers the measurement by performing an action such as pressing a button or issuing a voice command.

[0090] Either target object **185** in the first preferred embodiment or target object **1785** in the second preferred embodiment can be detached from adjustable stage **181** and probe shaft **170**, then attached to the end effector of a robot arm. Alternatively, the target object can be attached to a machine tool such as a drilling or milling machine. The tracker sends a laser beam to the target object to determine the six degrees of freedom of the drill or mill. The information provided by the tracker on the six degrees of freedom of target object **185** or **1785** can be used in a control loop to precisely direct the machine tool or robot end effector to the desired locations. If the tracker measures the six degrees of freedom fast enough, real-time control of machine tools and robots is possible.

### Third Embodiment

[0091] The third embodiment of the invention provides a laser tracker **1800** as shown in FIG. **18** that uses a steering reflector **1804** within gimbal mount **95** to direct laser beam **1853** to retroreflector **107**. Laser **1802** emits laser light that is sent to retroreflector **107**. Optical block **1806** contains beam expander **220** and any other optical beam-conditioning elements that may be required. Laser light returning from retroreflector **107** is sent to distance-measuring device **1814**, which may be either an absolute-distance meter or an incremental-distance meter. Part of the returning laser light is also reflected off beam splitter **1809** to position detector **341**. The beam splitter **701** reflects a portion of laser beam **54** into orientation-camera subsystem **1810**. Orientation camera subsystem **1810** comprises afocal lens block **710** and relay/array block **720**, also shown in FIG. **7**. The optical elements within blocks **1806** and **1810** of FIG. **18** are substantially equivalent to the optical elements within blocks **220** and **210** of FIGS. **6** and **7**. In effect, an orientation camera comprising elements **701** and **1810** is embedded within laser tracker **1800**. This orientation camera is equivalent to the orientation camera **210** of FIG. **2** and can therefore be used to measure the six degrees of freedom of target object **185**.

[0092] It will be apparent to those skilled in the art that various modifications and variations can be made in the laser-based coordinate measuring device of the present invention without departing from the spirit or scope of the invention. Thus, it is intended that the present invention covers the modifications and variations of this invention provided they come within the scope of the appended claims and their equivalents.

1. A method for measuring a distance with steps comprising:

- passing a first light launched from an end of an optical fiber through an optical element that forms the first light into a first beam;
- reflecting from a target a portion of the first beam as a reflected beam;

passing a portion of the reflected beam through the optical element and into the end of the optical fiber; automatically tracking the target in two-dimensions; and calculating the distance based at least in part on the portion of the reflected beam that passes through the optical element and into the end of the optical fiber.

2. The method for measuring a distance according to claim 1, further comprising mounting the end of the optical fiber and the optical element on a structure.

3. The method for measuring a distance according to claim 2, further comprising reflecting or transmitting the first beam from or through a first beam splitter.

4. (canceled)

5. The method for measuring a distance according to claim 1, further comprising combining a pointer beam with the first beam.

6. The method for measuring a distance according to claim 1, further comprising detecting an image formed on a photo-sensitive array.

7. A distance measuring system comprising:

a distance meter connected to an optical fiber, the optical fiber having an end through which light from the distance meter is launched;

an optical element that forms a first beam from the light launched from the distance meter;

a target that reflects a portion of the first beam as a reflected beam;

wherein a portion of the reflected beam travels back through the optical element, re-enters the end of the optical fiber, and is returned to the distance meter; and wherein the distance meter measures a distance based at least in part on the portion of the reflected beam that travels back through the optical element, re-enters the end of the optical fiber, and is returned to the distance meter; and

electronics configured to automatically track the target in two dimensions.

8. The distance measuring system according to claim 7, wherein the distance is from a pivot point to the target.

9. The distance measuring system according to claim 7, wherein the end of the optical fiber and the optical element are mounted on a structure.

10. The distance measuring system according to claim 9, further comprising a beam splitter between the optical element and the target, wherein the beam splitter is mounted on the structure.

11. The distance measuring system according to claim 10, wherein the system further comprises a position detector.

12. The distance measuring system according to claim 7, wherein the system further comprises a pointer beam.

13. The distance measuring system according to claim 7, wherein the system further comprises a photosensitive array.

14. The distance measuring system according to claim 7, wherein the optical element is a lens.

15. The distance measuring system according to claim 7, wherein the first beam travels through air.

16. The distance measuring system according to claim 7, wherein the first beam is generated by a laser.

17. (canceled)

18. The method for measuring a distance according to claim 1, wherein automatically tracking the target is based at least in part on a position detector.