

Nov. 3, 1964

B. H. STUMPF
GUN CARRIER

3,155,297

Filed April 12, 1962

2 Sheets-Sheet 1

FIG. 1.

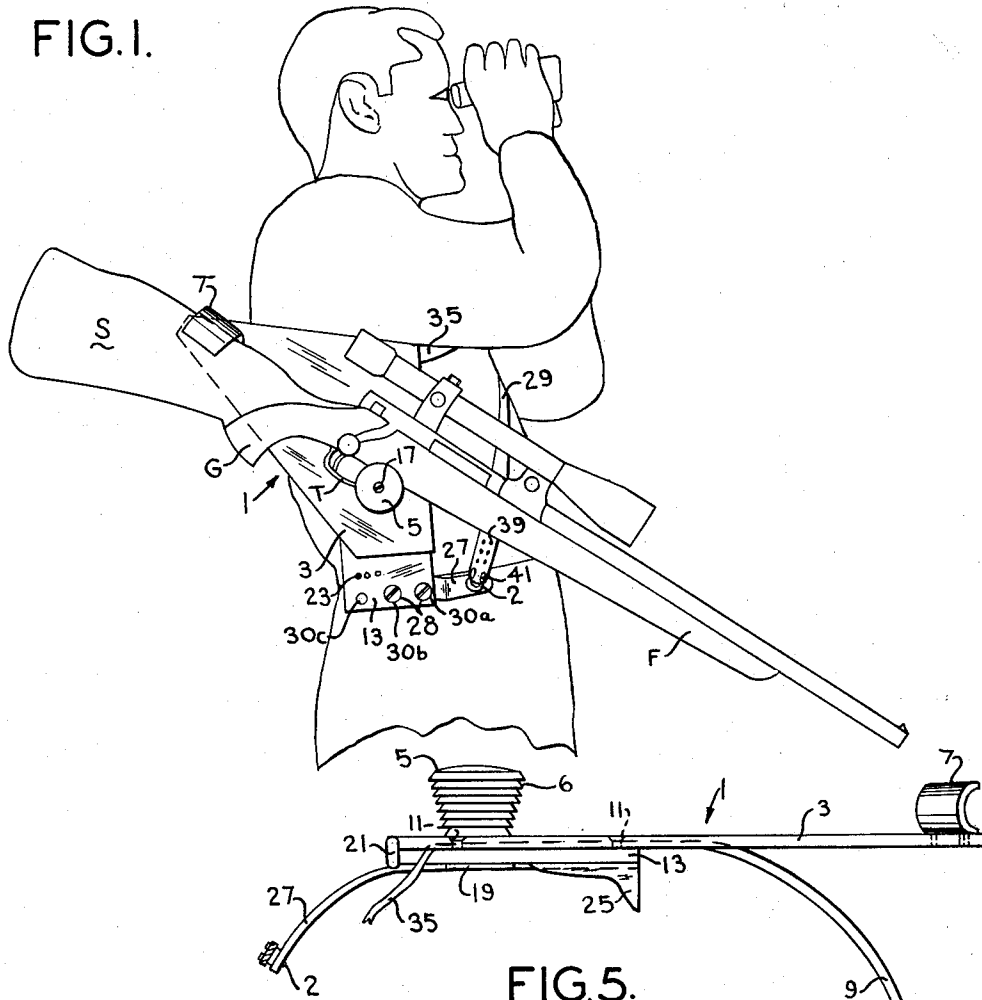

FIG. 5.

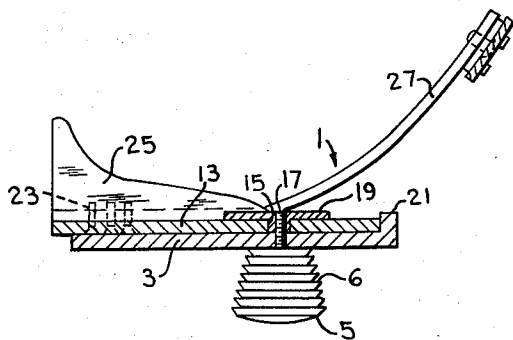

FIG. 4.

Burton H. Stumpf,
Inventor,
Koenig, Pope, Senninger and Powers,
Attorneys.

Nov. 3, 1964

B. H. STUMPF
GUN CARRIER

3,155,297

Filed April 12, 1962

2 Sheets-Sheet 2

FIG. 2.

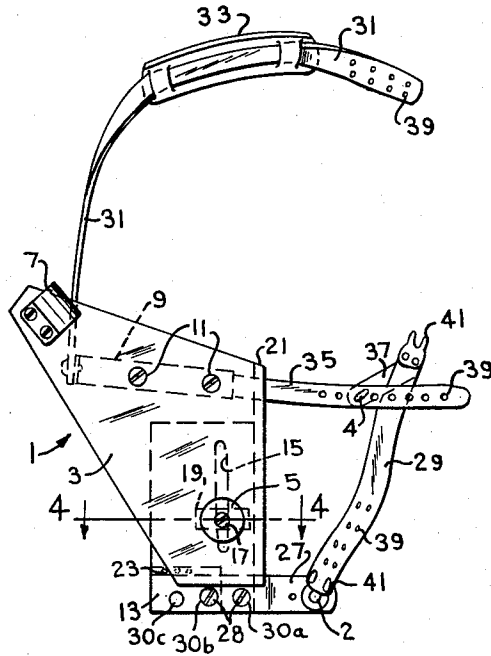
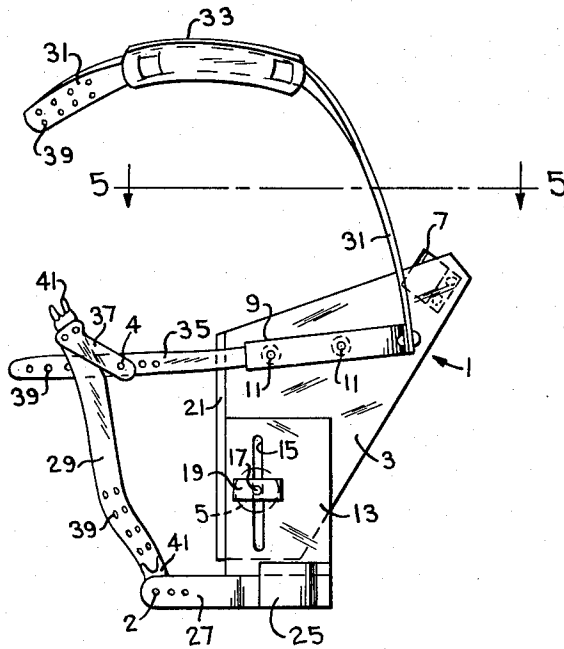

FIG. 3.



1

3,155,297

GUN CARRIER

Burton H. Stumpf, 408 Morrison, Waterloo, Ill.

Filed Apr. 12, 1962, Ser. No. 187,011

16 Claims. (Cl. 224—1)

This invention relates to gun carriers and more particularly to a gun carrier for carrying a rifle or shotgun adjacent the body of a sportsman or the like.

Among the several objects of this invention may be noted the provision of a gun carrier adapted to be worn over the outer garment of a sportsman, which is adapted conveniently to support the gun while leaving both of the sportsman's hands free for other uses; the provision of a gun carrier of the class described which reduces fatigue while hunting, for example; the provision of a gun carrier such as described which allows the sportsman greater freedom of movement; the provision of a gun carrier of the class described which supports the gun with the muzzle pointed downwardly and away from the individual in a safety position; the provision of a gun carrier from which a gun is quickly and conveniently removed as required; and the provision of a gun carrier of the class described which is simple and economical in construction. Other objects and features will be in part apparent and in part pointed out hereinafter.

The invention accordingly comprises the construction hereinafter described, the scope of the invention being indicated in the following claims.

In the accompanying drawings in which one of various possible embodiments of the invention is illustrated,

FIG. 1 is a side elevation showing a gun carrier constructed in accordance with the invention as it would appear when attached to a man and supporting a gun;

FIG. 2 is one side elevation of the carrier per se;

FIG. 3 is the other side elevation thereof;

FIG. 4 is an enlarged section taken on line 4—4 of FIG. 2; and

FIG. 5 is an enlarged section taken on line 5—5 of FIG. 3.

Corresponding reference characters indicate corresponding parts throughout several views of the drawings.

Referring to the drawings, there is shown at 1 a gun carrier for carrying a rifle or shotgun G. The carrier includes a side panel or frame 3 which may be constructed of wood, plastic or aluminum, for example. The forward end F of the gun G is supported just forwardly of the trigger guard T. The support is formed by a conically-shaped supporting member 5 extending outwardly from panel 3 near its forward lower corner. The smaller end of the member 5 is located adjacent panel 3 so that outward movement of gun G is prohibited. Member 5 may be made of rubber or the like and has grooves which form ridges or steps such as indicated at 6 to prevent sliding movement of the gun G outwardly away from panel 3. An outwardly and downwardly formed projection or hook 7 is securely attached to the panel 3 at its upper rear corner, by screws, for example, and is adapted to overlie the gun stock S to prevent unlimited pivoting of the gun G resting on member 5. The shape of hook 7 also prevents the stock S from tilting outwardly away from the panel 3.

A curved arm or support 9 is attached to the inner side of the panel 3 by screws 11 and is adapted to extend around the back of the sportsman under his shoulder blade to a point near the center of his back.

An adjustable sliding plate 13 is positioned on the inner side of the panel 3. Plate 13 is provided with an elongate slot 15 through which passes a locking bolt 17 on the outer end of which is molded or otherwise affixed the support 5. Bolt 17 extends through panel 3. At

2

its inner end it is screwed into a clamping bar 19 located on the inside of plate 13. A lip 21 extending inwardly from the forward edge of the panel 3 is adapted to abut the sliding plate 13 to prevent pivotal movement of the latter. Slot 15, bar 19 and lip 21 form slide and guide means for the plate 13. Attached to the inside surface of plate 13 by screws 23 is a curved hip block or support 25 adapted to rest against the hip of the sportsman. Extending from the lower forward corner of the plate 13 is a curved hip arm or support 27 which is adapted to curve around in front of the sportsman against his hip. Arm 27 is thus curved concavely relative to the person's hip. Arm 27 is secured to the plate 13 by two screws 28 extending through two of the three holes 30a, 30b and 30c provided for screws 28 in plate 13. As shown, screws 28 extend through holes 30a and 30b. The horizontal distance between the arm 27 and the hip block 25 may be changed to fit a slender person, for example by placing screws 28 in holes 30b and 30c. Additionally, the plate 13 and its attachments may be moved upwardly and downwardly in a generally vertical direction with respect to panel 3 to a position which is most comfortable and then locked in that position by tightening the bolt 17 into the clamping bar 19.

A front strap 29, such as of leather, is pivoted at 2 to the forward end of the arm 27 and extends upwardly to the chest of the sportsman. The upper end of strap 29 is adapted to be connected to the forward end of a shoulder strap 31 which extends over the shoulder and is connected at its rearward end to the end of back supporting arm 9. A shoulder pad 33 may be slidably mounted on the strap 31 to rest on the shoulder. A cross strap 35 is connected at its rearward end to the panel 3 and extends forwardly across the chest. The strap 35 is adapted to be adjustably connected as at 4 to one end of a rigid link 37, the other end of which link is permanently connected to the upper end of strap 29. Each of the straps 29, 31 and 35 is provided with a plurality of holes 39 to provide various adjustments for the connection of these straps by conventional hooked or other fasteners 41.

With the above arrangement of parts, the gun carrier 1 may be adjusted to fit a sportsman such as shown in FIG. 1. The member 5 supports the gun and prevents it from moving forwardly. It also acts as a head for turning bolt 17. The hook 7, as set forth above, prevents the gun from pivoting on member 5 and also prevents the gun from tilting outwardly away from the panel 3. The stepped and conical formation of member 5 also prevents outward movement of the gun from the panel 3. It in effect nests the gun. The forwardly curved arm 27 prevents the lower end of panel 3 from swinging rearwardly and also transfers some of the weight of the gun to the back supporting arm 9 which is against the shoulder. The cross strap 35 maintains the upper forward end of the panel 3 against the body at all times, even though the arms are raised for other purposes, such as using binoculars as shown in FIG. 1.

The gun can be quickly and easily removed from the gun carrier by lifting up its front end. This lifts the trigger guard T over the member 5 as the stock S is cleared from under the hook 7.

Thus, the gun carrier when properly adjusted to fit will permit the wearer to have both hands free for other purposes. Moreover, the weight of the gun is evenly distributed between the hip and shoulder, which reduces fatigue. Furthermore, the muzzle of the gun is pointed downwardly in a safety position. The several adjustments of the gun carrier adapt it to fit any man's body regardless of his size and the number of garments he is wearing.

In view of the above, it will be seen that the several objects of the invention are achieved and other advantageous results attained.

As various changes could be made in the above construction without departing from the scope of the invention, it is intended that all matter contained in the above description or shown in the accompanying drawings shall be interpreted as illustrative and not in a limiting sense.

What is claimed is:

1. A gun carrier adapted to be attached to one side of a person, comprising a frame, a member extending outwardly from one side of said frame for supporting a gun placed on said member, means on said frame adapted to prevent unlimited pivotal movement of a gun placed on said member, a first rigid arm connected to said frame and adapted to extend across the back of the person to which the gun carrier is to be attached, a second rigid arm connected to said frame and adapted to extend across in front of the person, means for adjusting the vertical distance between the rigid arms, and strap means adapted to extend between the front of the gun carrier over one of the shoulders of said person to said first rigid arm.
2. A gun carrier as set forth in claim 1 wherein said adjusting means comprises a plate slidably connected to said frame, said second arm being connected to said plate, said gun carrier including a rearwardly extending hip support connected to said plate and adapted to abut one hip of the person.
3. A gun carrier as set forth in claim 2, further including a strap connected to the upper end of said frame and adapted to extend across the person's chest and connected to said strap means to hold the upper end of said frame against the side of the person.
4. A gun carrier as set forth in claim 3 wherein said member is conically shaped, the smaller end of which is adjacent said frame, whereby movement of said gun outwardly on said member is inhibited.
5. A gun carrier as set forth in claim 3 wherein said means comprises a hook adapted to extend over the stock of a gun placed on said member.
6. A gun carrier as set forth in claim 3 wherein said member is conically shaped, the smaller end of which is adjacent said frame, said member having a plurality of ridges, whereby movement of said gun outwardly on said member is inhibited.
7. A gun carrier as set forth in claim 4 wherein said means comprises a hook adapted to extend over and down the outer side of the stock of a gun placed on said member.
8. A gun carrier comprising a frame adapted for application to the side of an individual and under his arm, a hip support slidably carried on said frame, screw means adapted to lock the hip support in place, said screw means including an operating portion therefor located on the outside of said frame and forming a gun

support, and a hook member extending from said frame at a location above and rearwardly of the gun support.

9. A gun carrier according to claim 8 wherein said gun support is formed as a cone flaring outwardly from said frame.

10. A gun carrier according to claim 8 wherein said gun support is formed as a cone flaring outwardly from said frame and is peripherally grooved.

11. A gun carrier according to claim 9 wherein said frame includes a curved back support and a curved front hip support, and strap means connecting said back and front supports around the body of the individual.

12. A gun carrier according to claim 11 further including a strap extending from the frame and connected to said strap means.

13. A gun carrier according to claim 12, including adjustable means for varying the effective length of said strap means.

14. A gun carrier for slopingly carrying an elongate gun adjacent to a person, comprising a frame, means connected to said frame adapted to fasten it to the side of the person, a support member extending from said frame for pivotally supporting a gun placed on said member with the gun barrel forward and movable downwardly by gravity, means on said frame spaced from said member adapted to limit downward movement of the barrel of a gun placed on said member, a hip member adapted to be located adjacent one hip of the person, slide means and guide means therefor, said slide means connecting said hip member to said frame for generally vertical adjustment of the hip member relative to said frame, clamp means for locking and securing said slide means in adjusted position relative to the guide means for locking said hip member in adjusted position, said clamp means comprising a bolt connected to said support member and adapted to clamp said slide means in position upon rotating said support member.

15. A gun carrier according to claim 14, wherein said hip member comprises an arm and said slide means connecting said hip member to said frame comprises a plate rigidly connected to said arm and slidable on said frame.

16. A gun carrier according to claim 15, wherein said arm is curved concavely relative to the hip adjacent which the arm is adapted to be located.

References Cited in the file of this patent

UNITED STATES PATENTS

50	1,405,164	Schein	Jan. 31, 1922
	2,526,768	Pendergrass	Oct. 24, 1950
	2,572,937	Lawson	Oct. 30, 1951
	2,792,670	Haynes	May 21, 1957
	2,855,107	Roth	Oct. 7, 1958
55	2,856,111	Wolfe et al.	Oct. 14, 1958