



- (51) **International Patent Classification:**  
*A61C 13/00* (2006.01) *A61C 5/77* (2017.01)
- (21) **International Application Number:**  
PCT/US2016/066777
- (22) **International Filing Date:**  
15 December 2016 (15.12.2016)
- (25) **Filing Language:** English
- (26) **Publication Language:** English
- (30) **Priority Data:**  
62/268,551 17 December 2015 (17.12.2015) US
- (71) **Applicant:** 3M INNOVATIVE PROPERTIES COMPANY [US/US]; 3M Center, Post Office Box 33427, Saint Paul, Minnesota 55133-3427 (US).
- (72) **Inventors:** HANSEN, James D.; 3M Center, Post Office Box 33427, Saint Paul, Minnesota 55133-3427 (US). DIN-GELDEIN, Joseph C.; 3M Center, Post Office Box 33427, Saint Paul, Minnesota 55133-3427 (US). DORUFF, Mary C.; 3M Center, Post Office Box 33427, Saint Paul, Minnesota 55133-3427 (US).
- (74) **Agents:** BUSS, Melissa, E. et al.; 3M Center, Office of Intellectual Property Counsel, Post Office Box 33427, Saint Paul, Minnesota 55133-3427 (US).

(81) **Designated States** (unless otherwise indicated, for every kind of national protection available): AE, AG, AL, AM, AO, AT, AU, AZ, BA, BB, BG, BH, BN, BR, BW, BY, BZ, CA, CH, CL, CN, CO, CR, CU, CZ, DE, DJ, DK, DM, DO, DZ, EC, EE, EG, ES, FI, GB, GD, GE, GH, GM, GT, HN, HR, HU, ID, IL, IN, IR, IS, JP, KE, KG, KH, KN, KP, KR, KW, KZ, LA, LC, LK, LR, LS, LU, LY, MA, MD, ME, MG, MK, MN, MW, MX, MY, MZ, NA, NG, NI, NO, NZ, OM, PA, PE, PG, PH, PL, PT, QA, RO, RS, RU, RW, SA, SC, SD, SE, SG, SK, SL, SM, ST, SV, SY, TH, TJ, TM, TN, TR, TT, TZ, UA, UG, US, UZ, VC, VN, ZA, ZM, ZW.

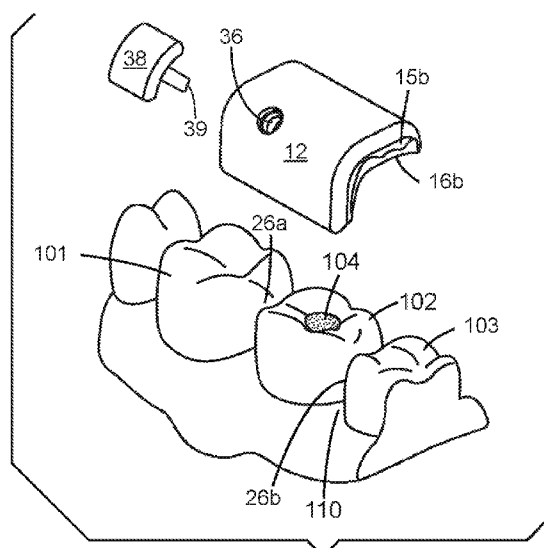
(84) **Designated States** (unless otherwise indicated, for every kind of regional protection available): ARIPO (BW, GH, GM, KE, LR, LS, MW, MZ, NA, RW, SD, SL, ST, SZ, TZ, UG, ZM, ZW), Eurasian (AM, AZ, BY, KG, KZ, RU, TJ, TM), European (AL, AT, BE, BG, CH, CY, CZ, DE, DK, EE, ES, FI, FR, GB, GR, HR, HU, IE, IS, IT, LT, LU, LV, MC, MK, MT, NL, NO, PL, PT, RO, RS, SE, SI, SK, SM, TR), OAPI (BF, BJ, CF, CG, CI, CM, GA, GN, GQ, GW, KM, ML, MR, NE, SN, TD, TG).

**Declarations under Rule 4.17:**

— as to applicant's entitlement to apply for and be granted a patent (Rule 4.17(ii))

[Continued on next page]

(54) **Title:** ONE-PIECE DENTAL RESTORATION MOLDS



**Fig. 2**

(57) **Abstract:** A custom tool for forming a dental restoration in a mouth of a patient includes a one-piece mold body providing for a customized fit with at least one tooth of the patient, the one-piece mold body including an occlusal portion forming an occlusal surface corresponding with an occlusal surface of the tooth, a mesial proximal portion forming a mesial proximal surface corresponding with a mesial proximal surface of the tooth, and a distal proximal portion forming a distal proximal surface corresponding with a distal proximal surface of the tooth. The mold body is configured to combine with the tooth of the patient to form a mold cavity encompassing missing tooth structure of the tooth. The occlusal portion, the mesial proximal portion, and the distal proximal portion are based on three-dimensional scan data of the mouth of the patient.



---

— *as to the applicant's entitlement to claim the priority of  
the earlier application (Rule 4.17(iii))*

**Published:**

— *with international search report (Art. 21(3))*

## ONE-PIECE DENTAL RESTORATION MOLDS

### TECHNICAL FIELD

This disclosure relates to dental restorations.

5

### BACKGROUND

A dental restoration, or a dental filling, utilizes a restorative dental material used to improve function, integrity and morphology of missing or irregular tooth structure. For example, a dental restoration may be used to restore missing tooth structure due to congenital discrepancies, following external trauma, or as part of a restorative treatment for dental caries, or tooth decay.

10

Restorative dentistry often includes drilling decay from an infected tooth (commonly referred to as “preparing” the tooth) and then using simple tools and a high level of craftsmanship to isolate, retract, fill and contour the finished restoration. Quality isolation via a rubber dam is cumbersome and often skipped for less effective isolation via cotton roles – increasing the risk of contamination which reduces longevity of the restoration. Retraction of soft and hard tissue includes manipulation of cords, wedges and matrix bands, and imperfect technique may result in contamination, difficulty in finishing and/or polishing in interproximal areas, and poorly adapted contacts.

15

While ‘bulk fill’ restorative materials and high intensity curing lights facilitate relatively fast filling of deep cavities (e.g., 4-5 mm), many restorations are completed in a single shade as practitioners may be uncertain of the correct layering protocol for multiple shades or types of restorative material. Last, with little geometrical guidance available on a prepared tooth, creation of the final filling level and occlusal surface geometry may include overfilling with restorative dental material, followed by an iterative process of grinding and checking tooth contact and biting function on an anesthetized patient. This process may be the most time consuming for dental restorations and errors here may result in tooth sensitivity and return visits for adjustment.

20

25

Commonly-assigned PCT/US2015/064195, titled, “DENTAL RESTORATION MOLDING TECHNIQUES, filed December 7, 2015, discloses dental restoration techniques incorporating the molding of dental restorative material directly on a tooth located within the mouth of a patient.

30

## SUMMARY

This disclosure relates to dental restoration techniques incorporating the molding of restorative dental material directly on a tooth located within the mouth of a patient.

5 Disclosed techniques include methods for dental restoration, custom tools used for dental restoration and techniques for producing custom tools for dental restoration. Disclosed techniques include tools providing mold cavities customized for an individual patient. In some examples, such custom tools may be produced using 3D printing techniques.

In one example, this disclosure is directed a custom tool for forming a dental restoration in  
10 a mouth of a patient comprising a one-piece mold body providing for a customized fit with at least one tooth of the patient, the one-piece mold body including an occlusal portion forming an occlusal surface corresponding with an occlusal surface of the tooth, a mesial proximal portion forming a mesial proximal surface corresponding with a mesial proximal surface of the tooth, and a distal proximal portion forming a distal proximal surface  
15 corresponding with a distal proximal surface of the tooth. The mold body is configured to combine with the tooth of the patient to form a mold cavity encompassing missing tooth structure of the tooth. The occlusal portion, the mesial proximal portion, and the distal proximal portion are based on three-dimensional scan data of the mouth of the patient.

In another example, this disclosure is directed a custom tool for forming a dental  
20 restoration in a mouth of a patient, the custom tool comprising a one-piece mold body providing for a customized fit with at least one tooth of the patient, the one-piece mold body including an incisal portion corresponding with the incisal surface of the tooth, a mesial proximal portion forming a mesial proximal surface corresponding with a mesial proximal surface of the tooth, and a distal proximal portion forming a distal proximal  
25 surface corresponding with a distal proximal surface of the tooth. The mold body is configured to combine with the tooth of the patient to form a mold cavity encompassing missing tooth structure of the tooth. The incisal portion, the mesial proximal portion, and the distal proximal portion are based on three-dimensional scan data of the mouth of the patient.

30 In further example, this disclosure is directed to a process of making a custom tool for forming a dental restoration of a tooth within a mouth of a patient, the process comprising obtaining three dimensional scan data of a patient's mouth, and three-

dimensionally printing a custom tool for forming the dental restoration of the tooth based on the three dimensional scan data of the mouth of the patient. The custom tool conforms to the custom tools described in the preceding paragraphs.

5 In further example, this disclosure is directed to a process of obtaining a custom tool for forming a dental restoration of a tooth within a mouth of a patient, the process comprising obtaining three dimensional scan data of a patient's mouth, transmitting at least a portion of the three dimensional scan data to a remote manufacturing facility, receiving, from the remote manufacturing facility, a custom tool for forming the dental restoration of the tooth based on the three dimensional scan data of the mouth of the  
10 patient. The custom tool conforms to the custom tools described in the preceding paragraphs.

In further example, this disclosure is directed to a process of obtaining a custom tool for forming a dental restoration of a tooth within a mouth of a patient, the process comprising obtaining three dimensional scan data of a patient's mouth, transmitting at  
15 least a portion of the three dimensional scan data to a remote manufacturing facility, receiving, from the remote manufacturing facility, a design for a custom tool for forming the dental restoration of the tooth based on the three dimensional scan data of the mouth of the patient. The custom tool conforms to the custom tools described in the preceding paragraphs.

20 The details of one or more examples of this disclosure are set forth in the accompanying drawings and the description below. Other features, objects, and advantages of this disclosure will be apparent from the description and drawings, and from the claims.

25 **BRIEF DESCRIPTION OF DRAWINGS SHOWING  
SOME EXAMPLES OF THIS DISCLOSURE**

FIGS. 1 – 6 illustrate a custom tool for forming dental restorations of a tooth in a mouth of a patient, the custom tool including one-piece mold body providing for a customized fit with at least one tooth of the patient.

30 FIGS. 7 – 9 illustrate an alternative custom tool for forming dental restorations of two adjacent teeth in a mouth of a patient, the custom tool including two mating mold body components.

FIG. 10 is a flowchart illustrating an example technique for forming a dental restoration in a mouth of a patient.

FIG. 11 is a block diagram illustrating an example computer environment in which a clinic and manufacturing facility communicate information throughout a custom tool

5 manufacturing process.

FIG. 12 is a flow diagram illustrating a process conducted at the clinic in accordance with one example of this disclosure.

FIG. 13 is a block diagram illustrating an example of a client computing device connected to a manufacturing facility via a network.

10

### DETAILED DESCRIPTION

While conventional dental restoration techniques often include iterative steps and benefit from significant practitioner skill and experience, this disclosure includes techniques that may utilize custom molds to facilitate forming dental restorations within the mouth of a patient more precisely and quickly than generally possible using conventional dental restoration techniques.

Disclosed techniques include capturing a three dimensional dentition of a patient with an intraoral scanner or scanning of a conventional impression or model. The custom tool for a dental restoration may include a mold based on the three dimensional (3D) dentition of the patient. The disclosed techniques may facilitate high quality dental restorations with reduced time and skill requirements as compared to conventional dental restoration techniques.

FIGS. 1 – 6 illustrate custom tool 10 for forming a dental restorations of tooth 102 in a mouth of a patient. In particular, FIG. 1 illustrates the components of custom tool 10, including one-piece mold body 12 and plug 38. FIG. 2 illustrates the components of custom tool 10 as well as a portion of the mouth of a patient prior to a dental restoration. FIG. 3 illustrates the components of custom tool 10 assembled within the mouth of a patient to facilitate a dental restoration, and FIG. 4 illustrates a cross-sectional view of FIG. 3. FIG. 5 illustrates the components of custom tool 10 as well as a portion of the mouth of a patient after dental restoration with custom tool 10. FIG. 6 illustrates the underside of custom tool 10, which includes surfaces that correspond to various sides of

tooth 102. In some examples, custom tool 10 may represent a single tooth veneer mold and/or may be used to repair caries 104 within tooth 102.

While custom tool 10 is configured to facilitate dental restorations of a single tooth, custom tool 10 is merely one example, and the techniques described with respect to custom tool 10 can readily be applied to custom tools that facilitate repair of two teeth or more than two teeth, e.g., by including multiple mold bodies within a single mold body component.

Custom tool 10 includes a one-piece mold body 12, which provides a customized fit with tooth 102. Mold body 12 further includes optional customized surface 15a, which provides a customized fit with tooth 101 and optional customized surface 15b, which provides a customized fit with tooth 103. Customized surfaces 15a, 15b may further secure and register mold body 12 in place within a patient's mouth to facilitate precise customized dental restorations of tooth 102. Mold body 12 may further register with gingiva 110 of the patient.

Custom tool 10 further includes injection port 36 for delivery of restorative dental material to the mold cavity, which may represent a veneer for tooth 102 and or repair of missing tooth structure represented by cavity 104. Port 36 configured to accept injection of a restorative dental material for mold cavities adjacent occlusal surfaces 18. As used herein, the term "occlusal surface" may refer to the chewing surface of any teeth, including the posterior teeth, as well as incisal surfaces (e.g., incisal edges) of anterior teeth. In this manner, as used herein, the term occlusal surface is not indicative of any particular tooth or teeth.

Following the injection of restorative dental material into the mold cavities adjacent, plug 38 may be positioned such that plug tip surface 39 is positioned within port 36. Plug 38 further includes plug tip surface 39 providing defined shapes corresponding to surfaces of repaired tooth 102. For example, plug tip surface 39 may be fabricated on the basis of digital scan data.

Custom tool 10 combines with tooth 102 to form a mold cavity of mold body 12 encompassing missing tooth structure of tooth 102 and/or a veneer for tooth 102. By positioning mold body 12 over tooth 102, restorative dental material may be positioned into the mold cavities and take the form of the missing tooth structure of cavity 104.

Repair of tooth 102 occurs by filling the mold cavity with dental restoration material after positioning mold body 12 to register with tooth 102. The missing tooth structure may include any portion of tooth 102, including any combination of interproximal, occlusal, facial and/or lingual tooth structure. An inner surface of mold  
5 body 12 each include a portion of a mold cavity corresponding with at least one exterior surface of the corresponding tooth 102, the at least exterior surface may include facial, lingual, interproximal and/or occlusal surfaces of the corresponding tooth 102. In some examples, the mold cavities may facilitate a dental veneer restoration of facial, lingual, interproximal and/or occlusal surfaces of the corresponding tooth 102.

10 Custom tool 10 may be formed based on a digital model of the teeth and mouth of a patient, which can be produced an intra-oral 3D scan, such as a multi-channel scanner. In one particular example, custom tool 10 may be digitally designed using CAD software, such as solid modeling software based on the digital model. Custom tool 10 was designed to fit over tooth 102 (which may represent, by way of example, a molar) and a portion of  
15 the neighboring teeth 101, 103. Subsequently, the tooth structure of teeth 101, 102, 103 may be digitally subtracted from a mold block, as well as filling port 36. Alternatively, an inverse of the tooth structure may be inverted within software to define the mold block. Filling port 36 may be located in regions of tooth 102 which would ultimately be removed in the preparation process, e.g., adjacent cavity 104. Filling port 36 may be sized to  
20 receive a tip of a commercially available restorative dental material compule, to permit injection of the restorative dental material during filling.

The components within the CAD software may be converted into a 3D point mesh file or other format to facilitate production with a 3D printer, CNC mill, CAD/CAM  
25 milling processes, or otherwise. Orientation marks (e.g., a colored mark on the distal ends of each tool component) may be applied to the tool components to facilitate assembly. Production may optionally include other steps such as, curing (e.g., in a UV oven), cleaning, e.g., in alcohol solution, and/or assembly of various components, polishing of tooth surfaces, coating, such as with a clear acrylic to enhance visibility of the restoration area during injection of the restorative dental material. In addition, surfaces of tool  
30 components expected to be in contact with the restorative dental material could optionally be coated with a layer of release agent (e.g., a thin layer of petroleum jelly).



FIGS. 2 – 5 illustrate steps for using the custom tool 10 to form dental restorations of tooth 102 in a mouth of a patient. FIG. 2 illustrates a portion of the mouth of the patient that includes teeth 101, 102, and 103 as well as gingiva 110. Tooth 102 includes cavity 104 in the crown of tooth 102. As shown, cavity 104 may have been caries previously prepared for the dental restoration by removing unhealthy tooth structure, e.g., by drilling or other preparation to remove damaged dental material to facilitate dental restoration using tool 10. In some examples a 3D image of the mouth of the patient may be taken prior to the removal of decayed material from tooth 102 as the shape of the decayed material may help in the design of custom tool 10 or the restorative procedure may be shortened by utilizing scan data obtained at a time prior to preparation of the tooth. In different examples, the scan data may be obtained recently, such as within the past twelve months, or may be obtained a prior time, such as a period of greater than one year, greater than 5 years or even greater than 10 years ago. Such old scan data may demonstrate tooth wear over time and may facilitate restoration to repair such tooth wear. The scan data from multiple scans over time may also be used to detected tooth wear and facilitate an appropriate restoration.

An example restoration process for tooth 102 using custom tool 10 is described as follows. As shown in FIG. 3, mold body 12 is positioned in place over tooth 102 such that interproximal portions 16a, 16b extend between teeth 101, 102, 103. Mold body 12 provides a customized and secure placement within the mouth of the patient. In various examples, depending on the design of custom tool 10, mold body 12 may be positioned on the lingual, occlusal and/or facial sides of tooth 102.

As best illustrated in FIG. 4, restorative dental material 112 is positioned within the mold cavity formed by tooth 102 and mold body 12. Because the tooth preparations may be prepared at a depth greater than the recommended maximum cure depth for the restorative dental material, or a different shade, viscosity or other property of restorative material is desired at deeper layers of the cavity, a base layer of restorative dental material can optionally be layered into the deep portions of the preparation and restorative dental material photocured, e.g., with an XL 3000 curing light. The components of tool 10, including mold body 12 and plug 38, may be transparent or translucent to facilitate photocuring. In such examples, restorative dental material 112 represents more than one layer of restorative dental material.

In any event, following the formation of restorative dental material 112 within mold cavities formed by tooth 102 and mold body 12, mold body 12 is removed from the mouth of the patient. As shown in FIG. 5, cavity 104 is now filled and the shape of the filling matches the occlusal surface of tooth 102. In this manner, mold body 12 not only provides a customized fit with the mouth of the patient, but also provides a customized mold cavity to facilitate repair of missing tooth structure of tooth 102 and/or application of a veneer to tooth 102.

The customized fit provided by mold body 12 is described with respect to FIG. 6. As shown in FIG. 6, one-piece mold body 12 includes customized surfaces for each of teeth 101, 102, 103. In particular, surface 15a is customized to fit with tooth 101, surface 13 is customized to fit with tooth 102, and surface 15b is customized to fit with tooth 103. Surface 13 provides a customized fit for more than one surface of tooth 102. In particular, surface 13 includes occlusal surface 32 corresponding with an occlusal surface of tooth 102, distal proximal surface 35 corresponding with a distal proximal of tooth 102, mesial proximal surface 31 corresponding with a mesial proximal of tooth 102, facial surface 34 corresponding with a facial surface of tooth 102 and lingual surface 33 corresponding to a lingual surface of tooth 102. Each of the areas of surface 13 of mold body 12 may be based on three-dimensional scan data of the mouth of the patient, as well as computerized design of a dental restoration of tooth 102.

Distal proximal surface 35 corresponding with a distal proximal of tooth 102, mesial proximal surface 31 corresponding with a mesial proximal of tooth 102 and lingual surface 33 corresponding to a lingual surface of tooth 102 may represent wrap portions of one-piece mold body 12 in that these areas of mold body 12 may engage with the lingual surface of tooth 102 to allow the custom tool 10 to snap onto tooth 102 to facilitate precise positioning of custom tool 10 on tooth 102.

As visible in FIG. 5, port 36 is optionally positioned adjacent occlusal surface 32 and facial surface 34. While the location of port 36 may be adjusted according to the location of the mold cavity placing port 36 on adjacent occlusal surface 32 and/or facial surface 34 may generally facilitate easier access by a practitioner during a dental restoration procedure than at other positions. The location of the port 36 can also be prescribed by the doctor prior to design of the mold 12 as an area targeted for build-up of excess material or excavation of undesired tooth structure.

The customized fit of mold body 12 may further serve to isolate tooth 102 from blood, gingival crevicular fluid, or saliva during a dental restoration material. For example, portions of mold body 12 may mate with surfaces of teeth 101, 102, 103 as well as gingiva 110 to shield the mold cavity from bodily fluids such as blood, gingival  
5 crevicular fluid, and saliva. In addition, mold body 12 may further serve to forcibly retract gingiva 110 and/or assisting in separating teeth 101, 102, 103 upon insertion of mold body 12 within the mouth of the patient. For example, interproximal portions 16a, 16b of mold body 12 may serve to forcibly separate adjacent teeth 101, 102, 103. In this manner, while custom tool 10 may be based on a three-dimensional model of the mouth of a patient,  
10 various features of custom tool 10 may be selected to temporarily modify the positions of gingiva 110 and/or teeth 101, 102, 103 during a restoration procedure.

Optionally, mold body 12 may be further configured to provide features, including customized gingival surfaces representing an isolation matrix for a dental restoration. In this manner, mold body 12 may contain features that extend subgingivally or into a hidden  
15 interproximal space. The data for these extensions can be based off of anatomical averages, or patient specific data, such as x-ray, ultrasound, or MRI. The tool may incorporate elastomeric material which can be designed for an undersized fit to create a tight seal against varying actual geometry of the patient's dentition. The materials used may also vary in hydrophilicity to draw water, saliva, and other fluids away from the tooth  
20 structure being restored. Microfluidic channels, vacuum line attachments and bite blocks can be incorporated as well.

While custom tool 10, including one-piece mold body 12 is described with respect to a single mold cavity for repair of a single tooth 102, the techniques described with respect to custom tool 10 may easily be applied to a custom tool configured to facilitate  
25 repair of more than one tooth by forming more than one mold cavity. In such examples, the modified custom tool 10 may include a one-piece mold body including a second occlusal portion forming a second occlusal surface corresponding with a second occlusal surface of an adjacent tooth, such as tooth 101, a second mesial proximal portion forming a second mesial proximal surface corresponding with a second mesial proximal surface of  
30 the adjacent tooth, and a second distal proximal portion forming a second distal proximal surface corresponding with a second distal proximal surface of the adjacent tooth. The one-piece mold body of the modified custom tool 10 may be configured to combine with

the two adjacent teeth, (e.g., 101 and 102) to form separate mold cavities encompassing missing tooth structure for each of the adjacent teeth.

FIGS. 7 – 9 illustrate an alternative custom tool 210 for forming dental restorations of two adjacent teeth 120a, 120b (collectively, “teeth 120”) in a mouth of a patient. In particular, FIG. 7 illustrates the components of custom tool 210, including one-piece mold body component 211 and support member 219. FIG. 8 illustrates the components of custom tool 210 as well as a portion of the mouth of a patient. FIG. 9 illustrates the components of custom tool 210 assembled within the mouth of a patient to facilitate a dental restoration. While custom tool 210 is configured to facilitate dental restorations of two adjacent teeth, custom tool 210 is merely one example, and the techniques described with respect to custom tool 210 can readily be applied to custom tools that facilitate repair of a single tooth or more than two teeth.

Custom tool 210 includes one-piece mold body component 211, which includes first mold body 212a and second mold body 212b (collectively, “mold bodies 212”). Mold bodies 212 each provide a customized fit with at least one tooth of the patient. As shown in FIG. 8, mold body 212a provides a customized fit with tooth 120a, and mold body 212b provides a customized fit with tooth 120b. Mold body component 211 further includes optional customized surface 215a, which provides a customized fit with tooth 126 and optional customized surface 215b, which provides a customized fit with tooth 128. Customized surfaces 215a, 215b may further secure and register mold bodies 212 in place within a patient’s mouth to facilitate precise customized dental restorations of teeth 120. Mold body component 211 may further register with gingiva 110 of the patient.

Optionally, mold bodies 212 may be further configured to provide features, including customized gingival surfaces representing an isolation matrix for a dental restoration. In this manner, mold bodies 212 may contain features that extend subgingivally or into hidden interproximal space. The data for these extensions can be based off of anatomical averages, or patient x-ray data. The tool may incorporate elastomeric material which can be designed for an undersized fit to create a tight seal against varying actual geometry of the patient’s dentition. The materials used may also vary in hydrophilicity to draw water, saliva, and other fluids away from the tooth structure being restored. Microfluidic channels, vacuum line attachments and bite blocks can be incorporated as well.

The customized fit of mold bodies 212 may further serve to isolate teeth 120 from blood or saliva during a dental restoration material. For example, portions of mold bodies 212 may mate with surfaces of teeth 120, 126, 128 as well as gingiva 110 to shield the mold cavity from bodily fluids such as blood and saliva. In addition, mold bodies 212 may  
5 further serve to forcibly retract gingiva 110 and/or separate teeth 120, 126, 128 upon insertion of mold body component 211 within the mouth of the patient. For example, interproximal portions 216 of mold bodies 212 may serve to forcibly separate adjacent teeth. In this manner, while custom tool 210 may be based on a three-dimensional model of the mouth of a patient, various features of custom tool 210 may be selected to  
10 temporarily modify the positions of gingiva 110 and/or teeth 120, 126, 128 during a restoration procedure.

Custom tool 210 further includes optional support body component 219. Support body component 219 includes first support body 220a and second support body 220b (collectively, “support bodies 220”), which are engageable with, and provide support for,  
15 mold bodies 212 via snap fit connections. For example, support bodies 220 may not provide any portion of the mold cavities, but may instead simply help secure mold body component 211 including mold bodies 212 in place. Support bodies 220 include snap fit elements 221 that mate with corresponding snap fit elements 213 of mold bodies 212.

Both mold body component 211 and support body component 219 may include  
20 surfaces that register with the teeth of the patient, as well as gingiva 110 of the patient. For example, as described above mold body 212a may include features that register with tooth 120 and tooth 126, whereas mold body 212b may include features that register with tooth 120 and tooth 128. Likewise, support body 220a may include features that register with tooth 120 and tooth 126, whereas support body 220b may include features that register  
25 with tooth 120 and tooth 128. Support body component 219 further includes optional customized surface 225a, which provides a customized fit with tooth 126 and optional customized surface 225b, which provides a customized fit with tooth 128. Customized surfaces 225a, 225b may further secure and register mold bodies 212 in place within a patient’s mouth to facilitate precise customized dental restorations of teeth 120. Support  
30 body component 219 may further register with gingiva 110 of the patient. In this manner, mold bodies 212 and support bodies 220 may provide multiple customized surfaces that mate with corresponding surfaces of teeth 120, 126, 128 as well as gingiva 110 of the

patient. The combination of mold body component 211 and support body component 219 provides a secure fit within the mouth of the patient to precisely align mold bodies 212 with teeth 120 in order to facilitate dental restorations of teeth 120.

While support bodies 220 are described as not forming any portion of mold cavity, in other examples, the support bodies 220 may be readily modified to combine with mold bodies 212 to form one or more mold cavities. In such examples, the modified support bodies 220 should also be considered mold bodies.

Mold bodies 212 further include injection ports 226a, 226b (collectively, “ports 226”) for delivery of restorative dental material to mold cavities. Ports 226 are configured to accept injection of a restorative dental material for mold cavities adjacent teeth 120. Mold bodies 212 further include vent ports 227a, 227b (collectively, “vent ports 227”) to allow air and excess dental material to escape the mold cavities as material is injected via fill ports 226.

Custom tool 210 combines with teeth 120 to form two distinct mold cavities of mold bodies 212. Mold cavities of mold bodies 212 encompass missing tooth structures 121a, 121b (collectively, “tooth structures 121”) of teeth 120 and/or a veneer for one or both of teeth 120. By positioning mold body component 211 over teeth 120, restorative dental material may be positioned into the mold cavities and take the form of tooth structures 121 and/or provide a veneer on the surfaces of teeth 120.

Repair of teeth 120 occurs by filling the mold cavities with dental restoration material after positioning mold bodies 212 to register with teeth 120. Optionally, the filling material may be applied to the tooth and/or mold cavity prior to positioning mold bodies 12 to register with teeth 102. In such examples, the process of seating the mold body shapes the restorative material into the desired shape. Missing tooth structures 121 may include any portion of teeth 120, including any combination of interproximal, occlusal, facial and/or lingual tooth structure, although in the example of FIGS. 7 – 9, the missing tooth structures 121 are depicted on the facial side of teeth 120. An inner surface of mold bodies 212 each include a portion of a mold cavity corresponding with at least one exterior surface of the corresponding tooth 120, the at least exterior surface may include facial, lingual, interproximal and/or occlusal surfaces of the corresponding tooth 120. In some examples, the mold cavities may facilitate dental veneer restoration of facial, lingual, interproximal and/or occlusal surfaces of the corresponding tooth 120.

Custom tool 210 may be formed based on a digital model of the teeth and mouth of a patient, which can be produced an intra-oral 3D scan, such as a multi-channel scanner. In one particular example, custom tool 210 may be digitally designed using CAD software, such as solid modeling software based on the digital model. Custom tool 210 was designed to fit over teeth 120 (which may represent, by way of example, adjacent incisors) and a portion of the neighboring teeth 126, 128. Subsequently, the tooth structure of teeth 120, 126, 128 may be digitally subtracted from a mold block, as well as filling ports 226 and optional vent ports 227. Alternatively, an inverse of the tooth structure may be inverted within software to define the mold block. Filling ports 226 may be located in regions of the occlusal section which correspond to regions of the teeth which would ultimately be removed in the preparation process, e.g., adjacent to the mold cavities of teeth 120. Filling ports 226 may be sized to receive a tip of a commercially available restorative dental material compule, to permit injection of the restorative dental material during filling. Vent ports 227 may be sized smaller in diameter than filling ports 226.

Within the digital model, the mold block design may be segmented into two sections (mold body component 211 and support body component 219) to facilitate eventual assembly of the tool components on the teeth without geometric interference. Within the digital model, handle features 229 may be included added to mold body component 211 and support body component 219 to facilitate holding of the portions with a hemostat or cotton pliers during dental restoration using tool 210.

The components within the CAD software may be converted into a 3D point mesh file or other format to facilitate production with a 3D printer, CNC mill, CAD/CAM milling processes, or otherwise. Orientation marks (e.g., a colored mark on the distal ends of each tool component) may be applied to the tool components to facilitate assembly.

Production may optionally include other steps such as, curing (e.g., in a UV oven), cleaning, e.g., in alcohol solution, and/or assembly of various components, polishing of tooth surfaces, coating, such as with a clear acrylic to enhance visibility of the restoration area during injection of the restorative dental material. In addition, surfaces of tool components expected to be in contact with the restorative dental material could optionally be coated with a layer of release agent (e.g., a thin layer of petroleum jelly).

FIG. 10 is a flowchart illustrating an example technique for forming a dental restoration in a mouth of a patient. First, a practitioner positions a mold, such as mold

body 12 or mold body component 211, over a portion of a tooth of the patient (302). The tooth either contains missing tooth structure or has been prepared to create missing tooth structure, such as is commonly done in the caries removal process. The mold combines with the tooth to form a mold cavity encompassing missing tooth structure of the tooth.

5 Next a practitioner injects a restorative dental material within the mold cavity (304). The practitioner allows the restorative dental material to cure within the mold cavity to reform the tooth, which may include application of actinic radiation to cure the restorative dental material (306). The practitioner removes the mold from the tooth of the patient leaving the dental restoration with a shape defined by the mold cavity on the tooth of the patient (308).

10 FIG. 11 is a block diagram illustrating an example computer environment 340 in which clinic 344 and manufacturing facility 348 communicate information throughout a manufacturing process of custom tool 10 and/or custom tool 210 for patient 342. Initially, an dental practitioner of clinic 344 generates one or more images of a dental structure of patient 342 using any suitable imaging technique and generates digital dental structure  
15 data 346 (e.g., a digital representation of patient's 342 tooth structure and, optionally, mouth tissues such as gingiva 110). For example, the practitioner may generate X-RAY images that can be digitally scanned. Alternatively, the practitioner may capture digital images of the patient tooth structure using, for example, conventional computed tomography (CT), laser scanning, intra-oral scanning, CT scans of dental impressions, scans of dental casts poured from impressions, ultrasound instrumentation, magnetic  
20 resonance imaging (MRI), or any other suitable method of 3D data acquisition. In other embodiments, the digital images may be provided using a hand-held intra-oral scanner such as the intra-oral scanner using active wavefront sampling developed by Brontes Technologies, Inc. (Lexington, MA) and described in PCT Publication No. WO  
25 2007/084727 (Boerjes, et al.), which is incorporated by reference herein. Alternatively, other intra-oral scanners or intra-oral contact probes may be used. As another option, the digital structure data 346 may be provided by scanning a negative impression of the patient's teeth. As still another option, the digital structure data 346 may be provided by imaging a positive physical model of the patient's teeth or by using a contact probe on a  
30 model of the patient's teeth. The model used for scanning may be made, for example, by casting an impression of a patient's dentition from a suitable impression material such as alginate or polyvinylsiloxane (PVS), pouring a casting material (such as dental stone or



epoxy resin) into the impression, and allowing the casting material to cure. Any suitable scanning technique may be used for scanning the model, including those described above. Other possible scanning methods are described in U.S. Patent Publication No. 2007/0031791 (Cinader et al.), which is incorporated by reference herein.

5           In addition to providing digital images by scanning the exposed surfaces of the teeth, it is possible to image hidden features of the dentition, such as the roots of the patient's teeth and the patient's jaw bones. In some embodiments, the digital tooth structure data is formed by providing several 3D images of these features and subsequently “stitching” them together. These different images need not be provided using the same  
10   imaging technique. For example, a digital image of teeth roots provided with a CT scan may be integrated with a digital image of the teeth crowns provided with an intraoral visible light scanner. Scaling and registering of 2D dental images with 3D dental images is described in U.S. Patent No. 6,845,175 (Kopelman, et al.), which is incorporated by reference herein, and U.S. Patent Publication No. 2004/0029068 (Badura et al.), which is  
15   also incorporated by reference herein. Issued U.S. Patent Nos. 7,027,642 (Imgrund et al.), which is incorporated by reference herein, and 7,234,937 (Sachdeva, et al.), which is also incorporated by reference herein, describe using techniques of integrating digital images provided from various 3D sources. Accordingly, the term “imaging” as it is used herein is not limited to normal photographic imaging of visually apparent structures, but includes  
20   imaging of dental structures that are hidden from view. The dental structure may include, but is not limited to, any portion of crowns and/or roots of one or more teeth of a dental arch, gingiva, periodontal ligaments, alveolar bone, cortical bone, implants, artificial crowns, bridges, veneers, dentures, dental appliances, or any structure that could be considered part of the dentition before, during, or after treatment.

25           In order to generate digital tooth structure data 346, a computer must transform raw data from the imaging systems into usable digital models. For example, for raw data representing the shapes of teeth received by a computer, the raw data is often little more than a point cloud in 3D space. Typically, this point cloud is surfaced to create 3D object models of the patient's dentition, including one or more teeth, gingival tissue, and other  
30   surrounding oral structure. In order for this data to be useful in dental diagnosis and treatment, the computer may “segment” dentition surfaces to produce one or more discrete, movable 3D tooth object models representing individual teeth. The computer may

further separate these tooth models from the gingiva into separate objects. Segmentation allows a user to characterize and manipulate the teeth arrangement as a set of individual objects.

After generating digital dental structure data 346, clinic 344 may store digital dental structure data 346 within a patient record in a database. Clinic 344 may, for example, update a local database having a plurality of patient records. Alternatively, clinic 344 may remotely update a central database (optionally within manufacturing facility 348) via network 350. After digital tooth structure data 346 is stored, clinic 344 electronically communicates digital dental structure data 346 to manufacturing facility 348.

Alternatively, manufacturing facility 348 may retrieve digital dental structure data 346 from the central database.

Clinic 344 may also forward treatment data 347 conveying general information regarding a practitioner's diagnosis and treatment plan for patient 342 to manufacturing facility 348. In some examples, treatment data 347 may be more specific. For example, digital dental structure data 346 may be a digital representation of the dental structure of patient 342, and the practitioner of clinic 344 may review the digital representation and indicate desired repairs, including locations for veneers, crowns or fillings for individual teeth of patient 342 prior to forwarding digital dental structure data 346 to manufacturing facility 348. The doctor and manufacturing facility may also engage in an iterative process to arrive at the proper treatment plan. Such interactions may be facilitated by digital communication such as via the Treatment Management Portal offered by 3M Oral Care. Manufacturing facility 348 may be located off-site, or located with clinic 344.

For example, each clinic 344 may include its own equipment for manufacturing facility 348 such that a treatment plan and digital design may be performed entirely by a clinical practitioner, or an assistant, in the clinical setting, using software installed locally. The manufacturing may be performed in the clinic, as well, by using a 3D printer (or by other methods of additive manufacturing). In other examples, a remote manufacturing facility may process the three dimensional scan data of a patient and produce a digital model of a design for a custom tool for forming the dental restoration of the tooth based on the three dimensional scan data of the mouth of the patient. The remote manufacturing facility may then return the digital model of a design for a custom tool for forming the dental restoration of the tooth to the clinic 344.

A 3D printer allows manufacturing of intricate features of a custom tool or a physical representation of the dental structure of patient 342 through additive printing. The 3D printer may use iterative digital designs of original dental structure of patient 342 as well as a desired dental structure of patient 342 to produce multiple custom tools and/or custom tool patterns customized to produce the desired dental structure of patient 342. Manufacturing may include post-processing to remove uncured resin and remove support structures, or to assemble various components, which may also be necessary and could also be performed in a clinical setting. Alternatively, manufacturing can be performed by subtractive manufacturing, such as CAD/CAM mills.

Manufacturing facility 348 utilizes digital dental structure data 346 of patient 342 to construct custom tool 10 and/or custom tool 210 in order to repair teeth of patient 342. Sometime thereafter, manufacturing facility 348 forwards custom tool 10 and/or custom tool 210 to clinic 344.

FIG. 12 is a flow diagram illustrating process 360 conducted at clinic 344 in accordance with one example of this disclosure. Initially, a practitioner at clinic 344 collects patient identity and other information from patient 342 and creates a patient record (362). As described, the patient record may be located within clinic 344 and optionally configured to share data with a database within manufacturing facility 348. Alternatively, the patient record may be located within a database at manufacturing facility 348 that is remotely accessible to clinic 344 via network 350 or within a database that is remotely accessible by both manufacturing facility 348 and clinic 344.

Next, digital data 346 of the dental structure of patient 342 may be generated using any suitable technique (364), to thereby create a virtual dental structure. Digital data 346 may be comprised of a two-dimensional (2D) image and/or a three-dimensional (3D) representation of the dental structure.

In one example, 3D representations of a dental structure are generated using a cone beam computerized tomography (CBCT) scanner, such as an i-CAT 3D dental imaging device, which is available from Imaging Sciences International, LLC; 1910 N Penn Road, Hatfield, PA. Clinic 344 stores the 3D data 346 (in the form of radiological images) generated from the CBCT scanner in the database located within clinic 344, or alternatively, within manufacturing facility 348. The computing system processes the digital data 346 from the CBCT scanner, which may be in the form of a plurality of slices,

to compute a digital representation of the tooth structure that may be manipulated within the 3D modeling environment.

If 2D radiological images are used (365), then the practitioner may further generate 3D digital data (366). The 3D data 346 may be produced by, for example, forming and subsequently digitally scanning a physical impression or casting of the tooth structure of patient 342. For example, a physical impression or casting of teeth of patient 342 may be scanned using a visible light scanner, such as an OM-3R scanner available from Laser Design, Inc. of Minneapolis, MN. Alternatively, the practitioner may generate the 3D data 346 of the occlusal surface by use of an intra-oral scan of the teeth of patient 342, or existing 3D tooth data. In one example, the method of forming a digital scan from a casting or an impression described in U.S. Patent No. 8,491,306, titled, "REGISTERING PHYSICAL AND VIRTUAL TOOTH STRUCTURES WITH PEDESTALS," and issued on July 23, 2013, may be used. U.S. Patent No. 8,491,306 is herein incorporated by reference in its entirety. In the same or different examples, techniques for defining a virtual tooth surface and virtual tooth coordinate system as described in U.S. Patent Application Publication No. 2013/0325431, titled DENTAL DIGITAL SETUPS," and published on December 5, 2013 may be used. U.S. Patent Application Publication No. 2013/0325431 is herein incorporated by reference in its entirety. In any case, the digital data are digitally registered within the 3D modeling environment to form a composite digital representation of a tooth structure, which may include the tooth roots as well as the occlusal surfaces.

In one example, 2D radiological images and the 3D digital data for the occlusal surface of the teeth are registered by first attaching registration markers (e.g., fiducial markers or a pedestal having known geometry) to the tooth structure of patient 342 prior to generating both the radiological images and the 3D digital scan. Thereafter, the digital representation of the registration markers within the 2D radiological image and the 3D digital data may be aligned within a 3D modeling environment using registration techniques described in U.S. Patent No. 8,491,306.

In another example, 3D digital data of the tooth structure is generated by combining two 3D digital representations of the tooth structure. For example, a first 3D digital representation may be a relatively low resolution image of the roots obtained from a CBCT scanner (e.g., an i-CAT 3D dental imaging device) and the second 3D digital

representation may be a relatively high resolution image of the crowns of the teeth obtained from an industrial CT scan of an impression or a visible light (e.g., laser) scan of a casting of the teeth of the patient. The 3D digital representations may be registered using a software program that enables the 3D representations to be manipulated within a  
5 computer environment (e.g., Geomagic Studio software, available from 3D Systems, Inc.; 333 Three D Systems Circle, Rock Hill, SC), or alternatively, registration techniques described in U.S. Patent No. 8,491,306 may be used.

Next, a computer system executing 3D modeling software renders a resultant digital representation of the tooth structure, including the occlusal surface, and, optionally,  
10 the root structure of the patient's teeth. Modeling software may provide a user interface that allows the practitioner to manipulate digital representations of the teeth in 3D space relative to the digital representation of the patient's teeth. By interacting with the computer system, the practitioner generates treatment information, such as by selecting areas of repair of the teeth of patient 342 (367).

15 Once the practitioner has finished conveying general information regarding a diagnosis and treatment plan within the 3D environment, the computer system updates the database associated with the patient record to record the treatment data 347 conveying general information regarding a diagnosis and treatment plan as specified by the practitioner (368). Thereafter, the treatment data 347 is relayed to manufacturing facility  
20 348 in order for manufacturing facility 348 to construct one or more custom tools, such as custom tool 10 and/or custom tool 210 (370).

Although described with respect to an dental practitioner located at an dental clinic, one or more of the steps discussed with respect to FIG. 12 may be performed by a remote user, such as a user located at manufacturing facility 348. For example, the dental  
25 practitioner may only send radiological image data and an impression or casting of the patient to manufacturing facility 348, where a user interacts with a computer system to develop a treatment plan within a 3D modeling environment. Optionally, a digital representation of the treatment plan within the 3D modeling environment may then be transmitted to the dental practitioner of clinic 344, who may review the treatment plan and  
30 either send back his or her approval, or indicate desired changes. An additional option would be for the manufacturing facility to create the digital design of the tool which is then returned to the clinic for production on system in the clinic (e.g. 3D printer or mill).

FIG. 13 is a block diagram illustrating an example of a client computing device 380 connected to manufacturing facility 348 via network 350. In the illustrated example, client computing device 380 provides an operating environment for modeling software 382. Modeling software 382 presents a modeling environment for modeling and depicting the 3D representation of the teeth of patient 342. In the illustrated example, modeling software 382 includes user interface 384, mold cavity module 386, and rendering engine 388.

User interface 384 provides a graphical user interface (GUI) that visually displays the 3D representation of patient 342's teeth. In addition, user interface 384 provides an interface for receiving input from practitioner 389 of clinic 344 (FIG. 11), e.g., via a keyboard and a pointing device, for manipulating patient 342's teeth within the model, e.g., to select portions for repair, and/or adjust the surfaces of a mold cavity that define the exterior repaired surface of patient 342's teeth as provided by custom tool 10 and/or custom tool 210.

Modeling software 382 may be accessible to manufacturing facility 348 via network interface 381. Modeling software 382 interacts with database 390 to access a variety of data, such as treatment data 392, 3D data 394 relating to the tooth structure of patient 342, and patient data 396. Database 390 may be represented in a variety of forms including data storage files, lookup tables, or a database management system (DBMS) executing on one or more database servers. The database management system may be a relational (RDBMS), hierarchical (HDBMS), multi-dimensional (MDBMS), object oriented (ODBMS or OODBMS) or object relational (ORDBMS) database management system. The data may, for example, be stored within a single relational database, such as SQL Server from Microsoft Corporation. Although illustrated as local to client computer device 380, database 390 may be located remote from the client computing device and coupled to the client computing device via a public or private network, e.g., network 350. Treatment data 392 describes a diagnosis and or repair information of the teeth of patient 342 selected by practitioner 389 and positioned within the 3D modeling environment.

Patient data 396 describes a set of one or more patients, e.g., patient 342, associated with practitioner 389. For example, patient data 396 specifies general information, such as a name, birth date, and a dental history, for each patient.

Rendering engine 388 accesses and renders 3D data 394 to generate the 3D view presented to practitioner 389 by user interface 384. More specifically, 3D data 394 includes information defining the 3D objects that represent each tooth (optionally including roots), and jaw bone within the 3D environment. Rendering engine 388  
5 processes each object to render a 3D triangular mesh based on viewing perspective of practitioner 389 within the 3D environment. User interface 384 displays the rendered 3D triangular mesh to practitioner 389, and allows practitioner 389 to change viewing perspectives and manipulate objects within the 3D environment.

U.S. Patent No. 8,194,067, titled, "PLANAR GUIDES TO VISUALLY AID  
10 DENTAL APPLIANCE PLACEMENT WITHIN A THREE-DIMENSIONAL (3D) ENVIRONMENT," issued on June 5, 2012, and U.S. Patent No. 7,731,495, titled, "USER INTERFACE HAVING CROSS SECTION CONTROL TOOL FOR DIGITAL DENTALS," issued on June 8, 2010, describe other examples for computer systems and 3D modeling software having user interfaces that may be used with the techniques  
15 described herein, each of which are incorporated by reference in their entireties.

Client computing device 380 includes processor 383 and memory 385 in order to store and execute modeling software 382. Memory 385 may represent any volatile or non-volatile storage elements. Examples include random access memory (RAM) such as synchronous dynamic random access memory (SDRAM), read-only memory (ROM), non-  
20 volatile random access memory (NVRAM), electrically erasable programmable read-only memory (EEPROM), and FLASH memory. Examples may also include non-volatile storage, such as a hard-disk, magnetic tape, a magnetic or optical data storage media, a compact disk (CD), a digital versatile disk (DVD), a Blu-ray disk, and a holographic data storage media.

Processor 383 represents one or more processors such as a general-purpose  
25 microprocessor, a specially designed processor, an application specific integrated circuit (ASIC), a field programmable gate array (FPGA), a collection of discrete logic, or any type of processing device capable of executing the techniques described herein. In one example, memory 385 may store program instructions (e.g., software instructions) that are  
30 executed by processor 383 to carry out the techniques described herein. In other examples, the techniques may be executed by specifically programmed circuitry of processor 383. In

these or other ways, processor 383 may be configured to execute the techniques described herein.

Client computing device 380 is configured to send a digital representation of a 3D tooth structure of a patient, and optionally, treatment data 392 and/or patient data 396 to computer 370 of manufacturing facility 348 via network 350. Computer 370 includes user interface 372. User interface 372 provides a GUI that visually displays the 3D representation of the digital model of teeth. In addition, user interface 372 provides an interface for receiving input from a user, e.g., via a keyboard and a pointing device, for manipulating a patient's teeth within the digital representation of the 3D tooth structure of the patient.

Computer 370 may further be configured to determine dimensions and shapes a custom tool, the dimensions and shapes of the custom tool being configured to provide one or more mold bodies and mold cavities repair the one or more teeth of the patient. Computer 370 may provide the dimensions and shapes of the custom tool to automated manufacturing system 374 for production of the custom tool.

Client computing device 380 and computer 370 are merely conceptual representations of an example computer system. In some examples, the functionalities described with respect to of client computing device 380 and/or computer 370 may be combined into a single computing device or distributed among multiple computing devices within a computer system. For example, cloud computing may be used for digital design of custom tools described herein. In one example, the digital representations of tooth structures are received at one computer at the clinic, while a different computer, such as computer 370, is used to determine the shapes and dimensions of a custom tool. In addition, it may not be necessary for that different computer, such as computer 370, to receive all of the same data in order for it to determine shapes and dimensions. Shapes and dimensions may be determined, at least in part, based on knowledge derived through analysis of historical cases or virtual models of exemplary cases, without receiving a complete 3D representation of the case in question. In such an example, data transmitted between client computing device 380 and computer 370, or otherwise utilized to design a custom tool may be significantly less than the complete data set representing a complete digital dental model of a patient.



Various examples have been described. Modifications to the described examples may be made within the spirit of this disclosure. For example, custom tools can be fabricated off of initial tooth geometry or digitally optimized tooth geometry (e.g. hole filling close gaps in the data, pulling and scaling data from tooth libraries, testing in a virtual articulator). Tools can fit precisely to the existing structure or can be optimized to selectively move or position tissue. Custom tools can be formed without prior information of the where the tooth structure will be removed, such as when the extent of caries is not known. Custom tools may be formed to generate a digitally optimized tooth structure that will require the practitioner to remove tooth structure prior to application of the tool. Tools can be printed or milled. Tools can be made from the full range of 3D printed materials (strength, flexibility, translucency, color). Tools can be coated with a range of agents to optimize release, surface finish and optical transparency. Tools can contain features to indicate or define fill level of different restorative materials (shade, fill level, physical properties). Physical characteristics (elasticity, roughness,,transparency, etc) of tools can vary across the tool to sealing capability, dimensional fidelity, texture imparted to restorative material, degree of cure of material, etc). Tools / mold sections can interlock with each other or with standard components (e.g. matrix bands). Tools can be used inside or outside of the mouth. Restorative material can be injected through ports in tools, applied to tooth structure and/or tool prior to the application of the tool, such that application shapes the material. Tools can be degradable (e.g. solvent / heat) to release from the restorative material or enable undercut geometries / reduce parting lines. Tools could be collapsible (deflated, frangible, etc.) Kits can be created of the patient specific tools and associated products and quantities, (e.g. adhesives, filling, and polishing materials selected for the patient needs and/or doctor preferences). Series of tools used sequentially in the direct filling process in order to control the geometries of multiple layers of a dental restoration on a tooth. Dental scans may be taken at diagnostic appointment to facilitate custom tools fabrication prior to a dental restoration appointment. Tools may be manufactured locally or digital scan data may be sent to a remote location for production.

These and other examples are within the scope of the following claims.

**What is claimed is:**

1. A custom tool for forming a dental restoration in a mouth of a patient, the custom tool comprising:

5 a one-piece mold body providing for a customized fit with at least one tooth of the patient, the one-piece mold body including an occlusal portion forming an occlusal surface corresponding with an occlusal surface of the tooth, a mesial proximal portion forming a mesial proximal surface corresponding with a mesial proximal surface of the tooth, and a distal proximal portion forming a distal proximal surface corresponding with a distal proximal surface of the tooth,

10 wherein the mold body is configured to combine with the tooth of the patient to form a mold cavity encompassing missing tooth structure of the tooth, and

wherein the occlusal portion, the mesial proximal portion, and the distal proximal portion are based on three-dimensional scan data of the mouth of the patient.

15

2. The custom tool of claim 1, wherein the occlusal portion, a mesial proximal portion and the distal proximal portion are all customized to fit around a tooth receiving a restoration.

20

3. The custom tool of claim 1, further including a wrap portion which engages with the lingual surface of the tooth to allow the custom tool to snap onto the tooth.

4. The custom tool of claim 1, further including a port and a plug, wherein the plug includes a tip surface corresponding to a surface of the tooth.

25

5. The custom tool of claim 1, further including a first interproximal portion including the mesial proximal surface, and a second interproximal portion including the distal proximal portion.

30

6. The custom tool of claim 5, wherein the first interproximal portion includes a distal proximal surface corresponding to a distal proximal surface of a first adjacent tooth, and

the second interproximal portion includes a mesial proximal surface corresponding to the mesial proximal surface of a second adjacent tooth.

7. The custom tool of claim 6, wherein the first interproximal portion includes a first  
5 gingival surface and the second interproximal portion includes a second gingival surface.

8. The custom tool of claim 7, wherein the custom tool retracts the gingiva from the tooth for a restoration of the tooth.

10 9. The custom tool of claim 1, wherein the one-piece mold body comprises a lingual surface corresponding with the lingual surface of the tooth.

10. The custom tool of claim 1,  
wherein the one-piece mold body provides for a customized fit for two adjacent  
15 teeth of the patient, the two adjacent teeth including the tooth and an adjacent tooth, the one-piece mold body including a second occlusal portion forming a second occlusal surface corresponding with a second occlusal surface of the adjacent tooth, a second mesial proximal portion forming a second mesial proximal surface corresponding with a second mesial proximal surface of the adjacent tooth, and a second distal proximal portion  
20 forming a second distal proximal surface corresponding with a second distal proximal surface of the adjacent tooth, and

wherein the mold body is configured to combine with the two adjacent teeth of the patient to form separate mold cavities encompassing missing tooth structure for each of the two adjacent teeth.

25

11. The custom tool of claim 1, further including a tooth receiving the restoration in the patient's mouth.

12. The custom tool of claim 1, wherein the occlusal portion, the mesial proximal  
30 portion, and the distal proximal portion are manufactured by three-dimensional printing.

13. The custom tool of claim 1, wherein the occlusal portion, the mesial proximal portion, and the distal proximal portion together form an inner surface corresponding to the tooth's outer surface prior to restoration.

5 14. The custom tool of claim 1, further comprising a dental restorative material located within the mold cavity.

15. The custom tool of claim 1, wherein the first interproximal portion and the second interproximal portion assist in separating the first adjacent tooth and a second adjacent  
10 tooth from the tooth receiving the restoration.

16. The custom tool of claim 1, wherein the first interproximal portion and the second interproximal portion isolate the tooth receiving the restoration from blood or saliva.

15 17. The custom tool of claim 1, wherein the occlusal portion, the mesial proximal portion, and the distal proximal portion are manufactured by CAD/CAM milling processes.

18. A custom tool for forming a dental restoration in a mouth of a patient, the custom  
20 tool comprising:

a one-piece mold body providing for a customized fit with at least one tooth of the patient, the one-piece mold body including an incisal portion corresponding with the incisal surface of the tooth, a mesial proximal portion forming a mesial proximal surface corresponding with a mesial proximal surface of the tooth, and a distal proximal portion  
25 forming a distal proximal surface corresponding with a distal proximal surface of the tooth,

wherein the mold body is configured to combine with the tooth of the patient to form a mold cavity encompassing missing tooth structure of the tooth, and

wherein the incisal portion, the mesial proximal portion, and the distal proximal  
30 portion are based on three-dimensional scan data of the mouth of the patient.

19. The custom tool of claim 18, wherein the incisal portion, the mesial proximal portion, and the distal proximal portion are all customized to fit around a tooth receiving a restoration.

5 20. The custom tool of claim 18, further including a wrap portion which engages with the lingual surface of the tooth to allow the custom tool to snap onto the tooth.

21. The custom tool of claim 18, further including a port and a plug, wherein the plug includes an tip surface corresponding to a surface of the tooth.

10

22. The custom tool of claim 18, further including a first interproximal portion including the mesial proximal surface, and a second interproximal portion including the distal proximal portion.

15 23. The custom tool of claim 22, wherein the first interproximal portion includes a distal proximal surface corresponding to a distal proximal surface of a first adjacent tooth, and the second interproximal portion includes a mesial proximal surface corresponding to the mesial proximal surface of a second adjacent tooth.

20 24. The custom tool of claim 23, wherein the first interproximal portion includes a first gingival surface and the second interproximal portion includes a second gingival surface.

25. The custom tool of claim 24, wherein the custom tool retracts the gingiva from the tooth for a restoration of the tooth.

25

26. The custom tool of claim 18, wherein the one-piece mold body comprises a lingual surface corresponding with the lingual surface of the tooth.

27. The custom tool of claim 18, wherein the one-piece mold body provides for a customized fit for two adjacent teeth of the patient, the two adjacent teeth including the tooth and an adjacent tooth, the one-piece mold body including a second incisal portion forming a second incisal surface corresponding with a second incisal surface of the

30

adjacent tooth, a second mesial proximal portion forming a second mesial proximal surface corresponding with a second mesial proximal surface of the adjacent tooth, and a second distal proximal portion forming a second distal proximal surface corresponding with a second distal proximal surface of the adjacent tooth, and

5            wherein the mold body is configured to combine with the two adjacent teeth of the patient to form separate mold cavities encompassing missing tooth structure for each of the two adjacent teeth.

28.        The custom tool of claim 18, further including a tooth receiving the restoration in  
10        the patient's mouth.

29.        The custom tool of claim 18, wherein the incisal portion, the mesial proximal portion, and the distal proximal portion are manufactured by three-dimensional printing.

15        30.        The custom tool of claim 18, wherein the incisal portion, the mesial proximal portion, and the distal proximal portion together form an inner surface corresponding to the tooth's outer surface prior to restoration.

31.        The custom tool of claim 18, further comprising a dental restorative material  
20        located within the mold cavity.

32.        The custom tool of claim 18, wherein the first interproximal portion and the second interproximal portion assist in separating the first adjacent tooth and a second adjacent tooth from the tooth receiving the restoration.

25        33.        The custom tool of claim 18, wherein the first interproximal portion and the second interproximal portion isolate the tooth receiving the restoration from blood or saliva.

34.        The custom tool of claim 18, wherein the incisal portion, the mesial proximal  
30        portion, and the distal proximal portion are manufactured by CAD/CAM milling processes.

35. A process of making a custom tool for forming a dental restoration of a tooth within a mouth of a patient, the process comprising:

- obtaining three dimensional scan data of a patient's mouth; and
  - three-dimensionally printing a custom tool for forming the dental restoration of the
- 5 tooth based on the three dimensional scan data of the mouth of the patient,
- wherein the custom tool is the custom tool of any of claims 1 – 34.

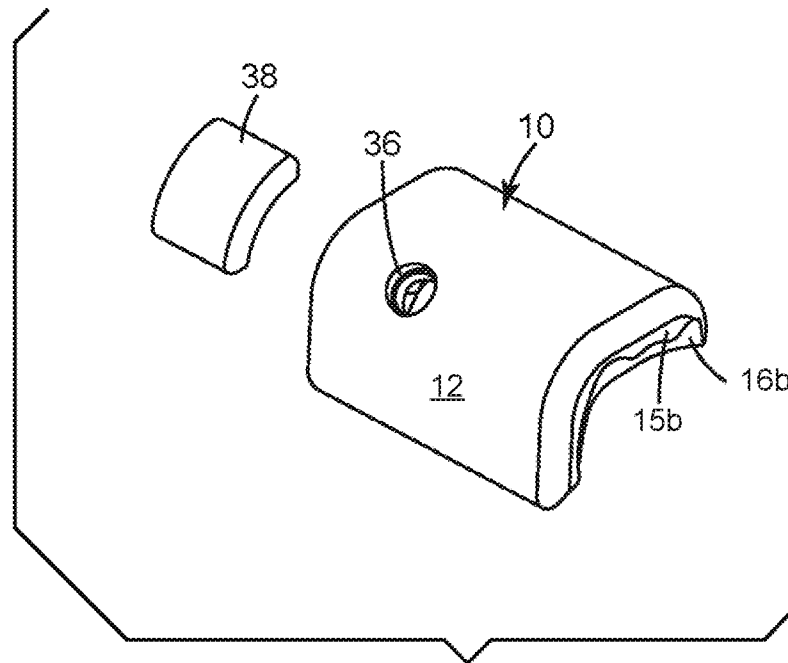
36. A process of obtaining a custom tool for forming a dental restoration of a tooth within a mouth of a patient, the process comprising:

- 10 obtaining three dimensional scan data of a patient's mouth;
  - transmitting at least a portion of the three dimensional scan data to a remote manufacturing facility; and
  - receiving, from the remote manufacturing facility, a custom tool for forming the dental restoration of the tooth based on the three dimensional scan data of the mouth of the
- 15 patient,
- wherein the custom tool is the custom tool of any of claims 1 – 34.

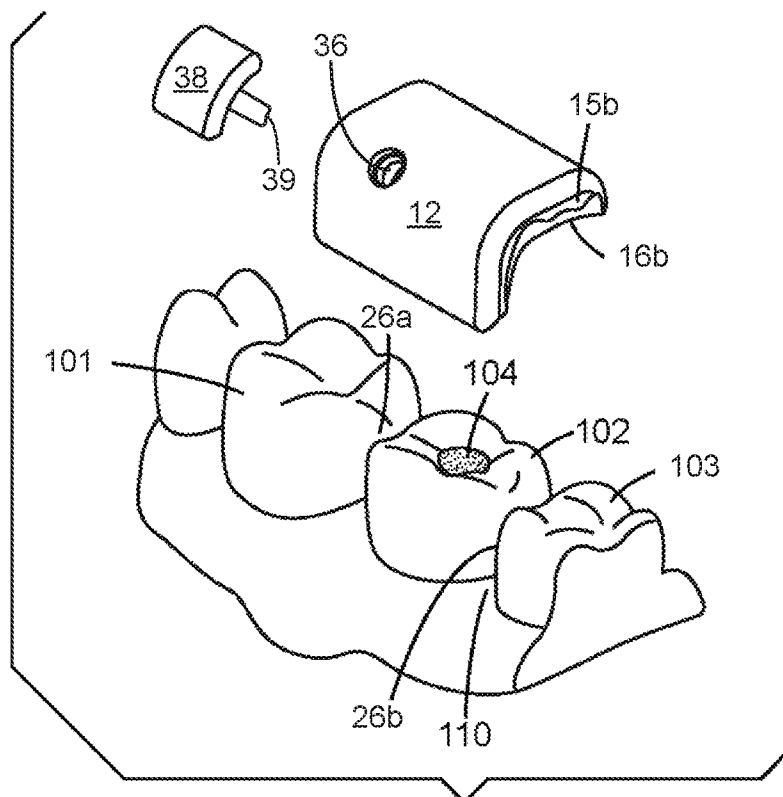
37. A process of obtaining a custom tool for forming a dental restoration of a tooth within a mouth of a patient, the process comprising:

- 20 obtaining three dimensional scan data of a patient's mouth;
  - transmitting at least a portion of the three dimensional scan data to a remote manufacturing facility; and
  - receiving, from the remote manufacturing facility, a design for a custom tool for forming the dental restoration of the tooth based on the three dimensional scan data of the
- 25 mouth of the patient,
- wherein the design for the custom tool is the custom tool of any of claims 1 – 34.

1/9



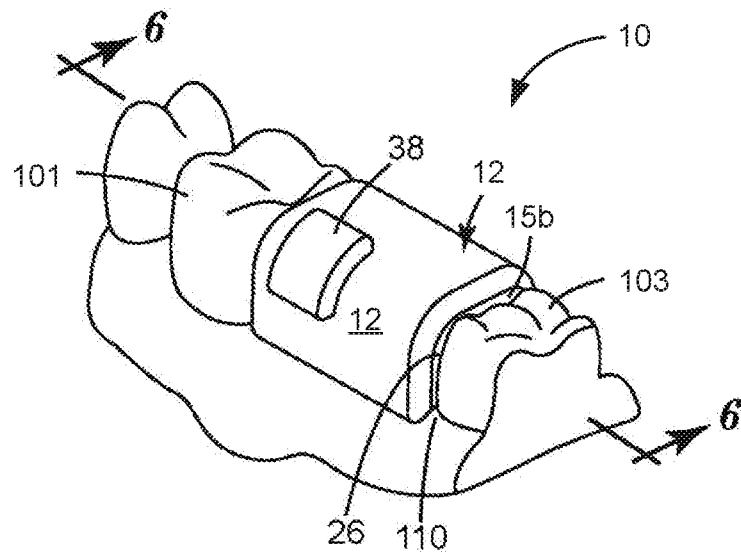
**Fig. 1**



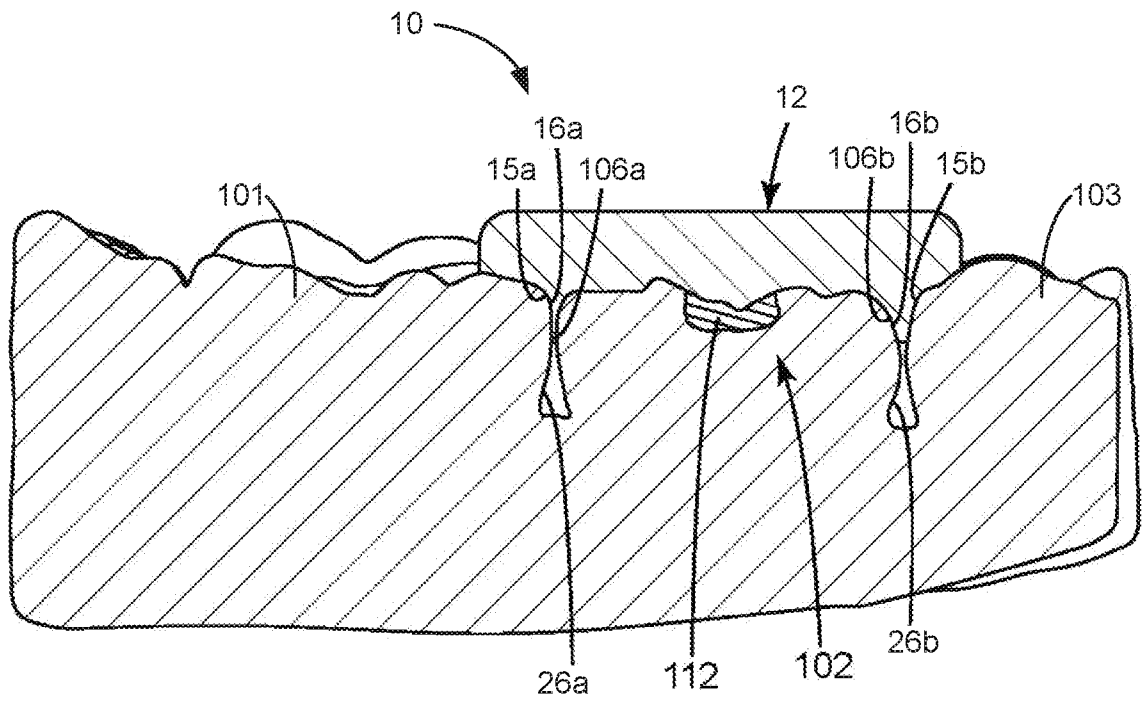
**Fig. 2**



2/9

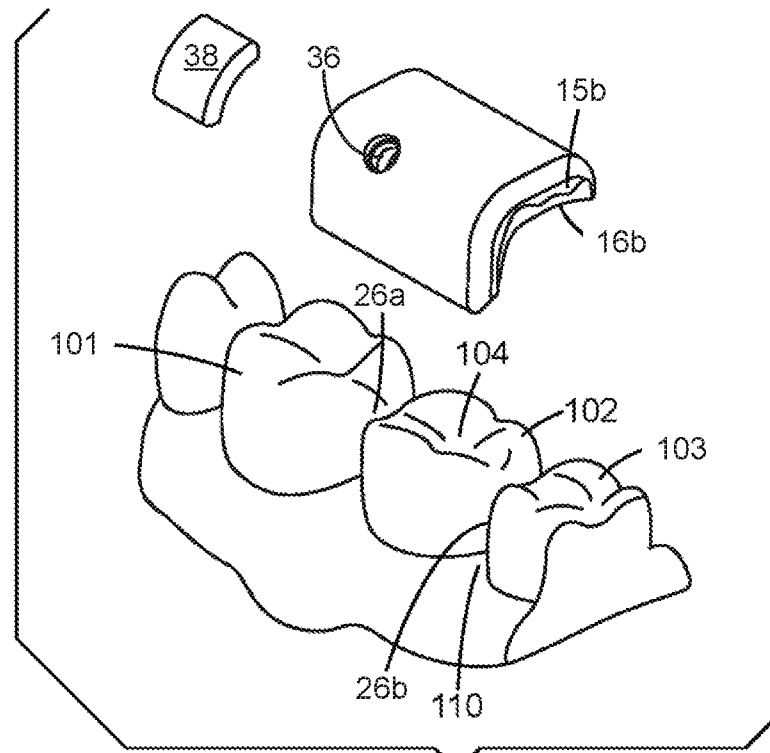


**Fig. 3**

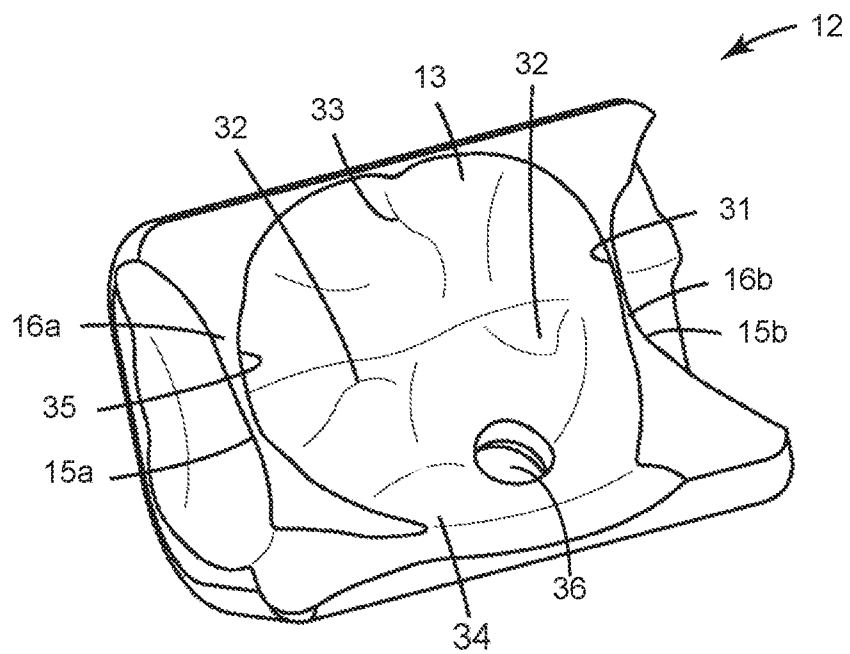


**Fig. 4**

3/9

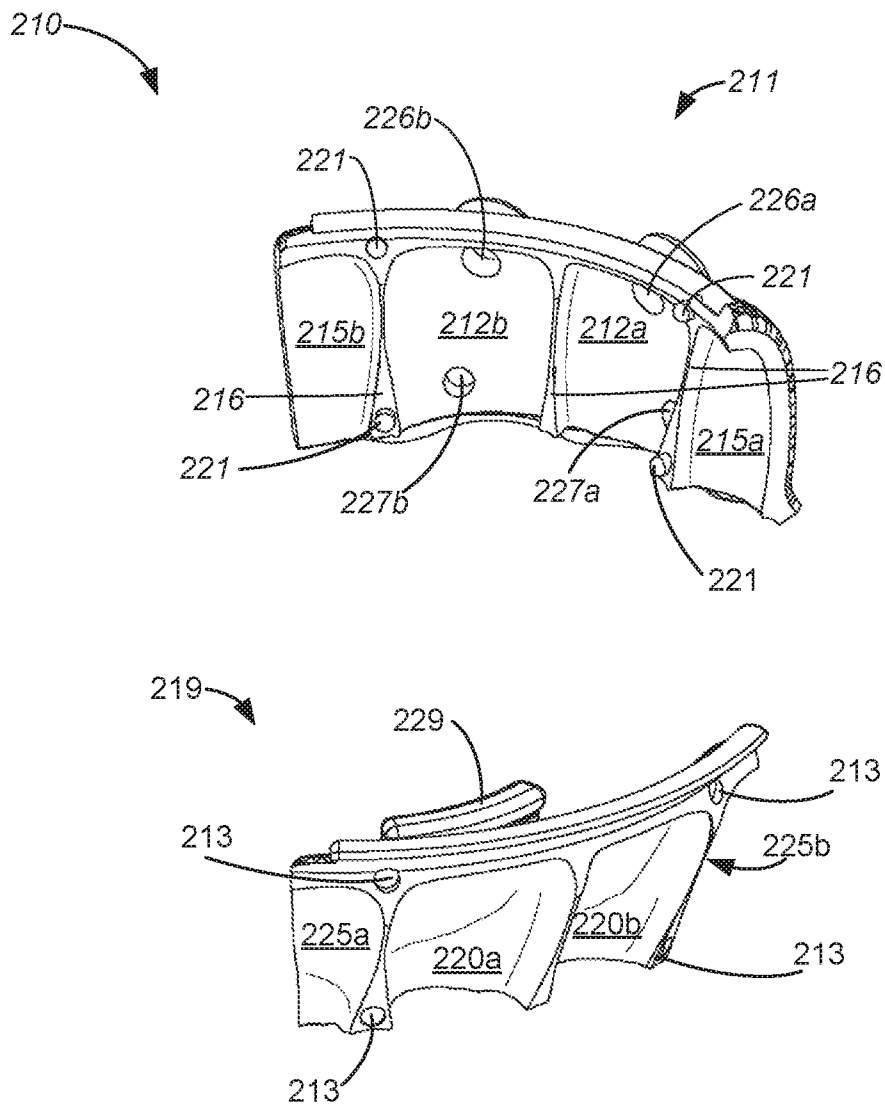


**Fig. 5**



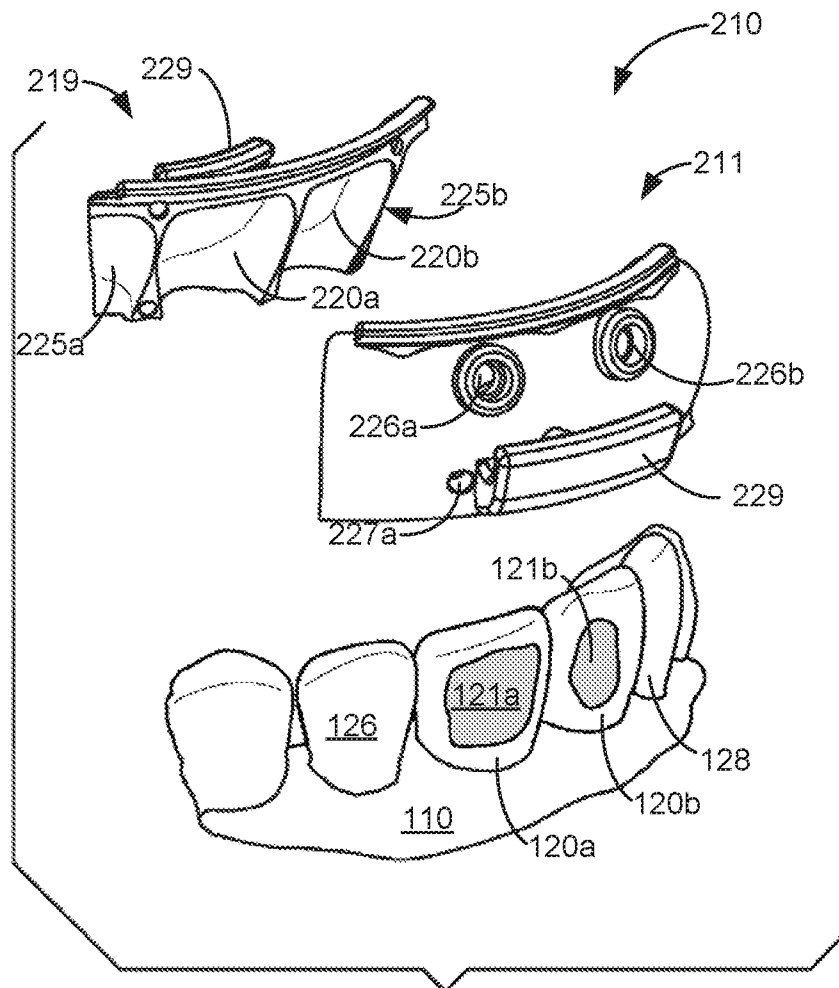
**Fig. 6**

4/9

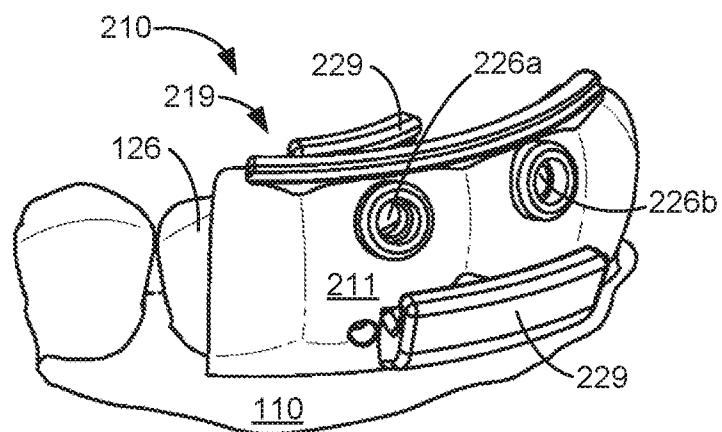


*Fig. 7*

5/9

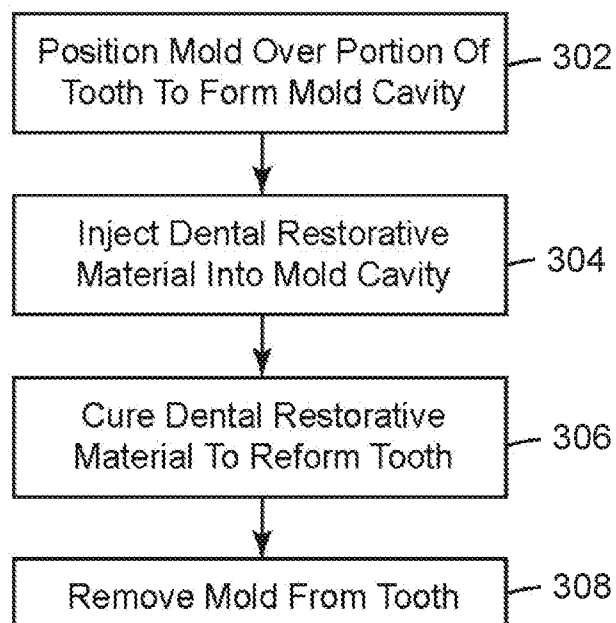


**Fig. 8**

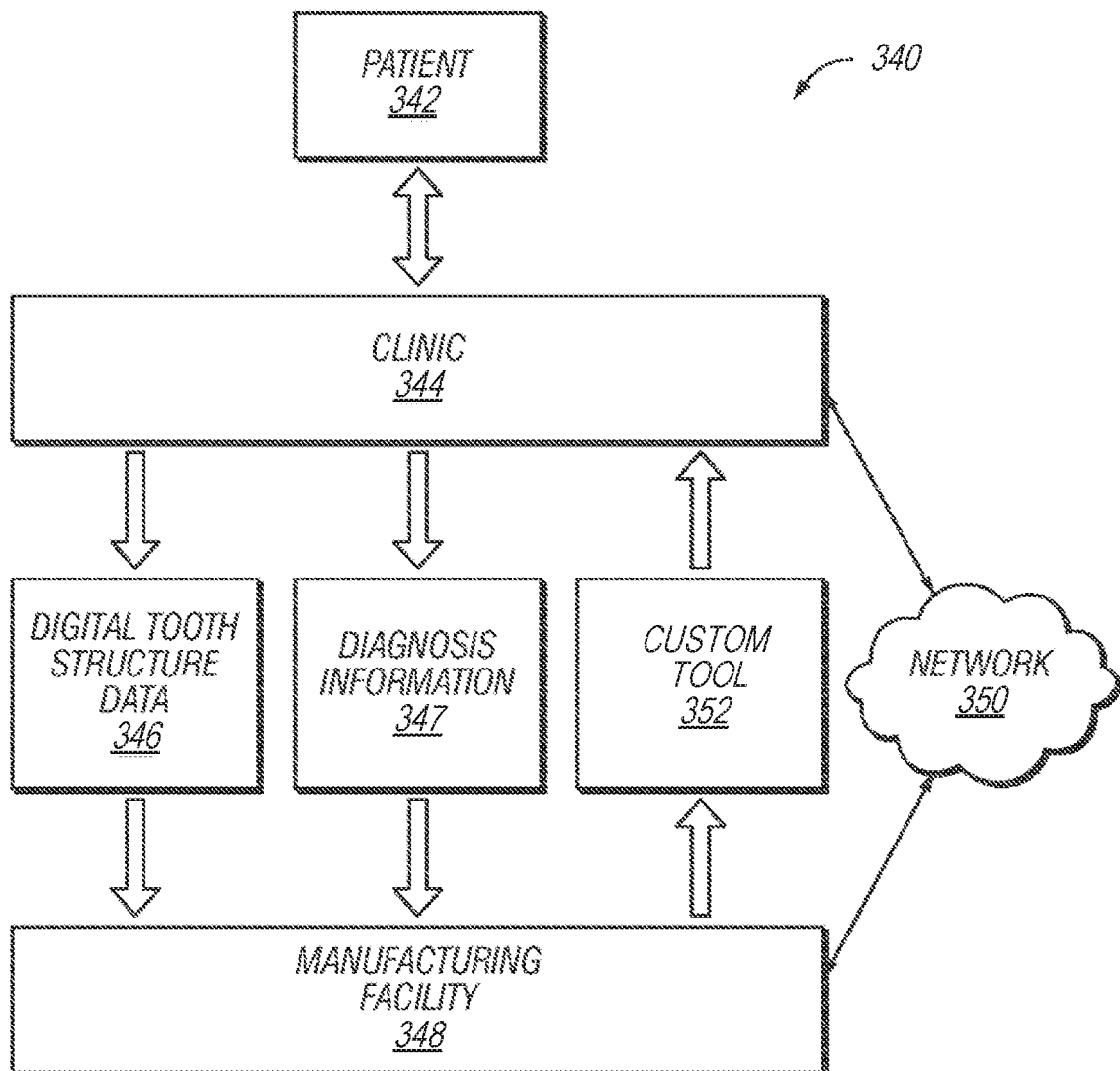


**Fig. 9**

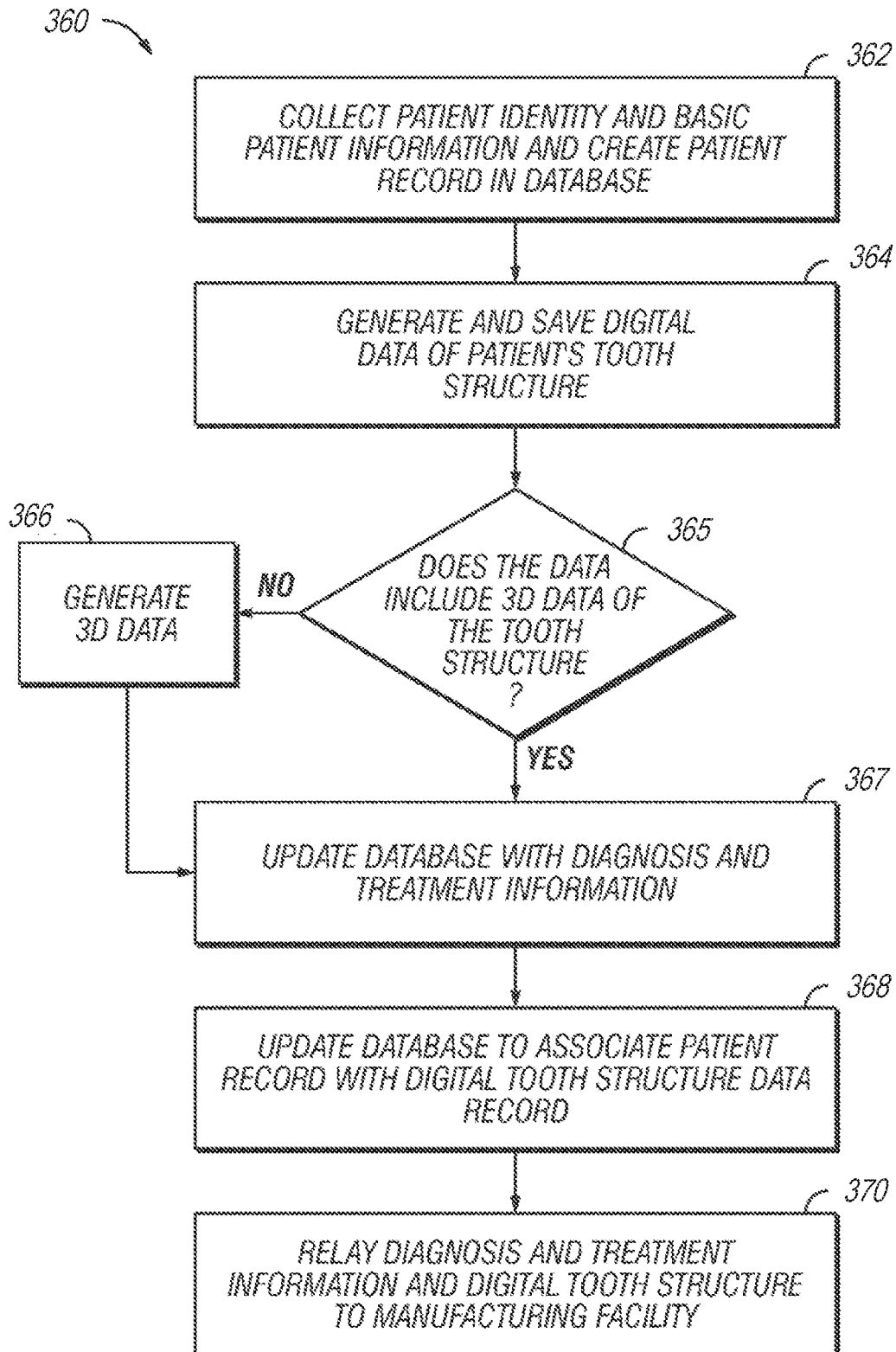
6/9

*Fig. 10*

7/9

**Fig. 11**

8/9

**Fig. 12**

9/9

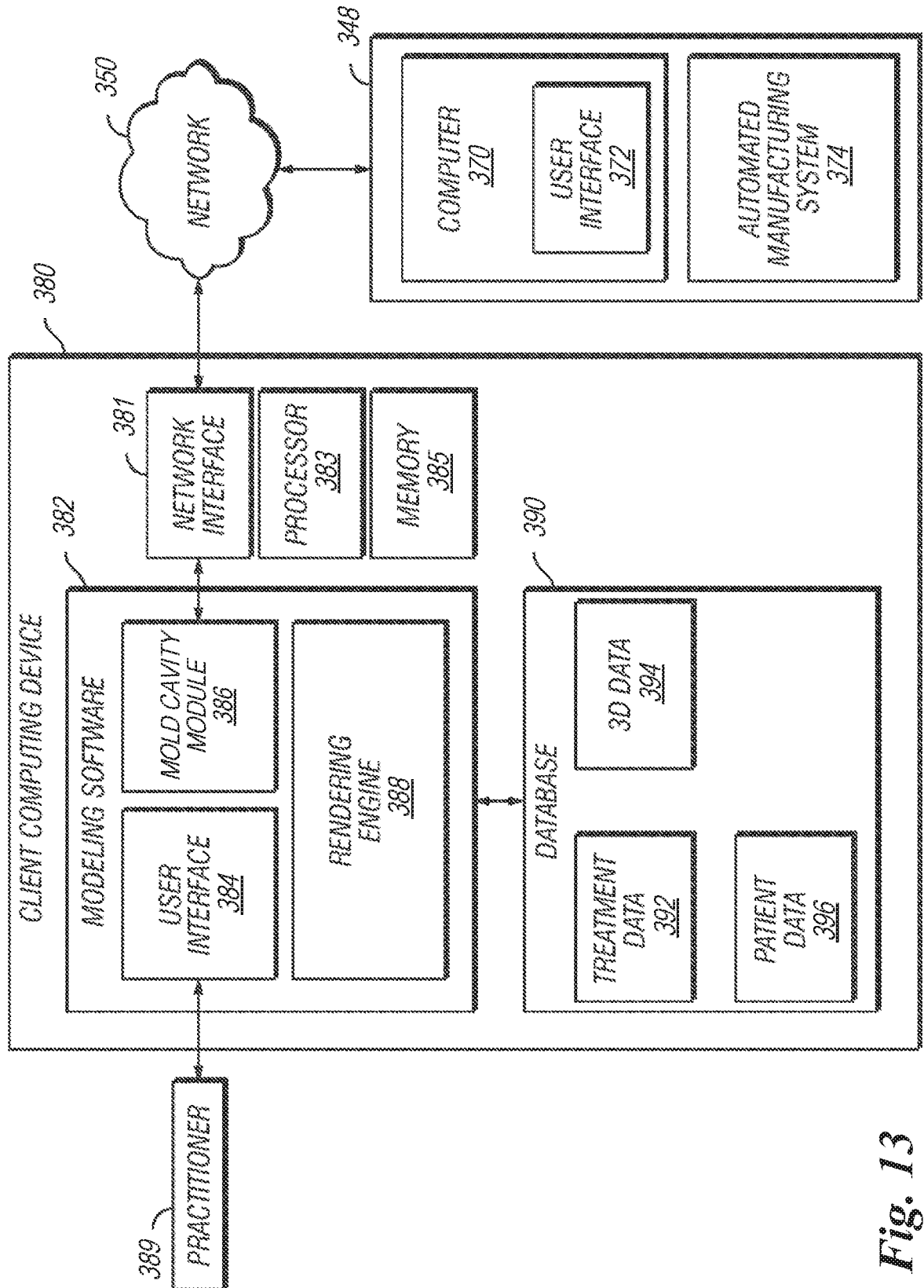


Fig. 13



# INTERNATIONAL SEARCH REPORT

International application No  
PCT/US2016/066777

<b>A. CLASSIFICATION OF SUBJECT MATTER</b> INV. A61C13/00 A61C5/77 ADD.		
According to International Patent Classification (IPC) or to both national classification and IPC		
<b>B. FIELDS SEARCHED</b> Minimum documentation searched (classification system followed by classification symbols) A61C		
Documentation searched other than minimum documentation to the extent that such documents are included in the fields searched		
Electronic data base consulted during the international search (name of data base and, where practicable, search terms used) EPO-Internal, WPI Data		
<b>C. DOCUMENTS CONSIDERED TO BE RELEVANT</b>		
Category*	Citation of document, with indication, where appropriate, of the relevant passages	Relevant to claim No.
X	US 2013/130202 A1 (VUILLEMOT WILLIAM C) 23 May 2013 (2013-05-23) abstract; figures 1,2,7-9 paragraphs [0003], [0015], [0016], [0017], [0048], [0049], [0050], [0052], [0054], [0059], [0061], [0063]	1-37
A	US 5 332 390 A (ROSELLINI DAVEY G) 26 July 1994 (1994-07-26) abstract; figures 1,3,4	1
A	US 4 775 320 A (MARSHALL HOWARD B) 4 October 1988 (1988-10-04) abstract; figures 13,16,33,34	1
A	US 2006/122719 A1 (KOPELMAN AVI) 8 June 2006 (2006-06-08) abstract; figure 1	1
<div style="display: flex; justify-content: space-between;"> <div> <input type="checkbox"/> Further documents are listed in the continuation of Box C.         </div> <div> <input checked="" type="checkbox"/> See patent family annex.         </div> </div>		
<div style="display: flex;"> <div style="flex: 1;"> <p>* Special categories of cited documents :</p> <p>"A" document defining the general state of the art which is not considered to be of particular relevance</p> <p>"E" earlier application or patent but published on or after the international filing date</p> <p>"L" document which may throw doubts on priority claim(s) or which is cited to establish the publication date of another citation or other special reason (as specified)</p> <p>"O" document referring to an oral disclosure, use, exhibition or other means</p> <p>"P" document published prior to the international filing date but later than the priority date claimed</p> </div> <div style="flex: 1;"> <p>"T" later document published after the international filing date or priority date and not in conflict with the application but cited to understand the principle or theory underlying the invention</p> <p>"X" document of particular relevance; the claimed invention cannot be considered novel or cannot be considered to involve an inventive step when the document is taken alone</p> <p>"Y" document of particular relevance; the claimed invention cannot be considered to involve an inventive step when the document is combined with one or more other such documents, such combination being obvious to a person skilled in the art</p> <p>"&amp;" document member of the same patent family</p> </div> </div>		
Date of the actual completion of the international search  <div style="text-align: center; font-size: 1.2em;">2 March 2017</div>		Date of mailing of the international search report  <div style="text-align: center; font-size: 1.2em;">13/03/2017</div>
Name and mailing address of the ISA/ European Patent Office, P.B. 5818 Patentlaan 2 NL - 2280 HV Rijswijk Tel. (+31-70) 340-2040, Fax: (+31-70) 340-3016		Authorized officer  <div style="text-align: center; font-size: 1.2em;">Tempels, Marco</div>

# INTERNATIONAL SEARCH REPORT

Information on patent family members

International application No

PCT/US2016/066777

Patent document cited in search report	Publication date	Patent family member(s)	Publication date
US 2013130202	A1	23-05-2013	NONE
US 5332390	A	26-07-1994	US 5192207 A 09-03-1993 US 5332390 A 26-07-1994
US 4775320	A	04-10-1988	NONE
US 2006122719	A1	08-06-2006	US 2006122719 A1 08-06-2006 US 2007233299 A1 04-10-2007 US 2010167238 A1 01-07-2010 US 2015057782 A1 26-02-2015