



US00D415170S

# United States Patent [19]

[11] Patent Number: **Des. 415,170**

Wilson et al.

[45] Date of Patent: **\*\* \*Oct. 12, 1999**

[54] **FUEL DISPENSER HOUSING**

[75] Inventors: **Amy H. Wilson**, Greensboro; **Paul D. Miller**, Winston Salem, both of N.C.; **Cheryl Felix**, Bedford, Mass.

[73] Assignee: **Gilbarco Inc.**, Greensboro, N.C.

[\*] Notice: This patent is subject to a terminal disclaimer.

[\*\*] Term: **14 Years**

[21] Appl. No.: **29/090,991**

[22] Filed: **Jul. 21, 1998**

[51] **LOC (6) Cl.** ..... **15-02**

[52] **U.S. Cl.** ..... **D15/9.2**

[58] **Field of Search** ..... D15/9.1, 9.2; 222/25, 222/71, 74, 75, 383.1, 27; 137/234.6; 364/528.17; D25/56; D14/105; D99/43

[56] **References Cited**

**U.S. PATENT DOCUMENTS**

|            |        |                      |       |         |
|------------|--------|----------------------|-------|---------|
| D. 244,563 | 5/1977 | Taylor et al.        | ..... | D52/2   |
| D. 262,971 | 2/1982 | Robinson, Jr. et al. | ..... | D15/9.2 |
| D. 265,092 | 6/1982 | Robinson, Jr. et al. | ..... | D15/9.2 |
| D. 273,791 | 5/1984 | Monigle et al.       | ..... | D15/9.1 |

|            |         |                |       |         |
|------------|---------|----------------|-------|---------|
| D. 287,498 | 12/1986 | Monigle et al. | ..... | D15/9.2 |
| D. 303,803 | 10/1989 | Phillips       | ..... | D25/56  |
| D. 306,719 | 3/1990  | Austin et al.  | ..... | D14/105 |
| D. 309,144 | 7/1990  | Austin et al.  | ..... | D15/9.2 |
| D. 316,471 | 4/1991  | Austin et al.  | ..... | D99/43  |
| D. 395,052 | 6/1998  | Krone et al.   | ..... | D15/9.1 |
| D. 396,047 | 7/1998  | Krone et al.   | ..... | D15/9.1 |
| 4,576,312  | 3/1986  | Swick, Jr.     | ..... | D15/9.2 |

*Primary Examiner*—Ralf Seifert  
*Attorney, Agent, or Firm*—Jenkins & Wilson, P.A.

[57] **CLAIM**

The ornamental design for a fuel dispenser housing, as shown and described.

**DESCRIPTION**

FIG. 1 is a perspective view of the fuel dispenser housing; FIG. 2 is a front elevational view thereof, the opposite side view being the same; FIG. 3 is a side elevational view thereof, the opposite side view being the same; FIG. 4 is a top plan view thereof; and, FIG. 5 is a bottom plan view thereof. It being understood that the broken lines in FIGS. 1 and 2 are for illustrative purposes only and form no part of the claimed design.

**1 Claim, 4 Drawing Sheets**

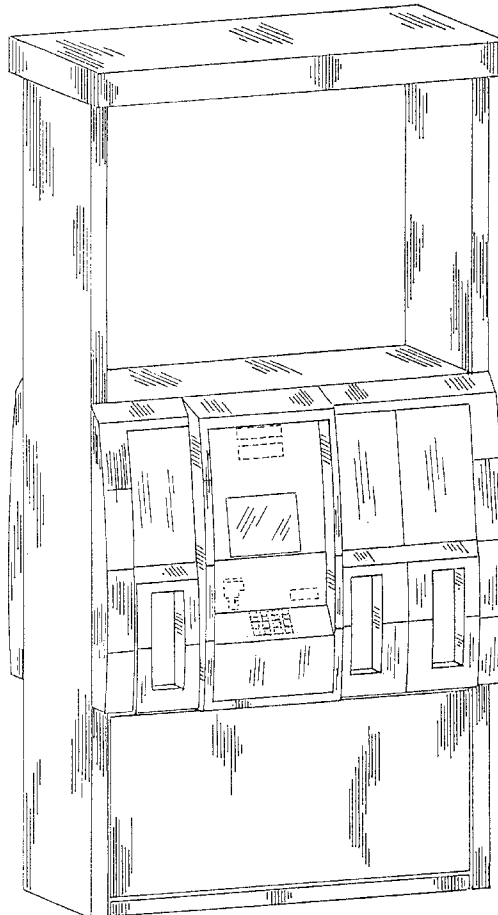

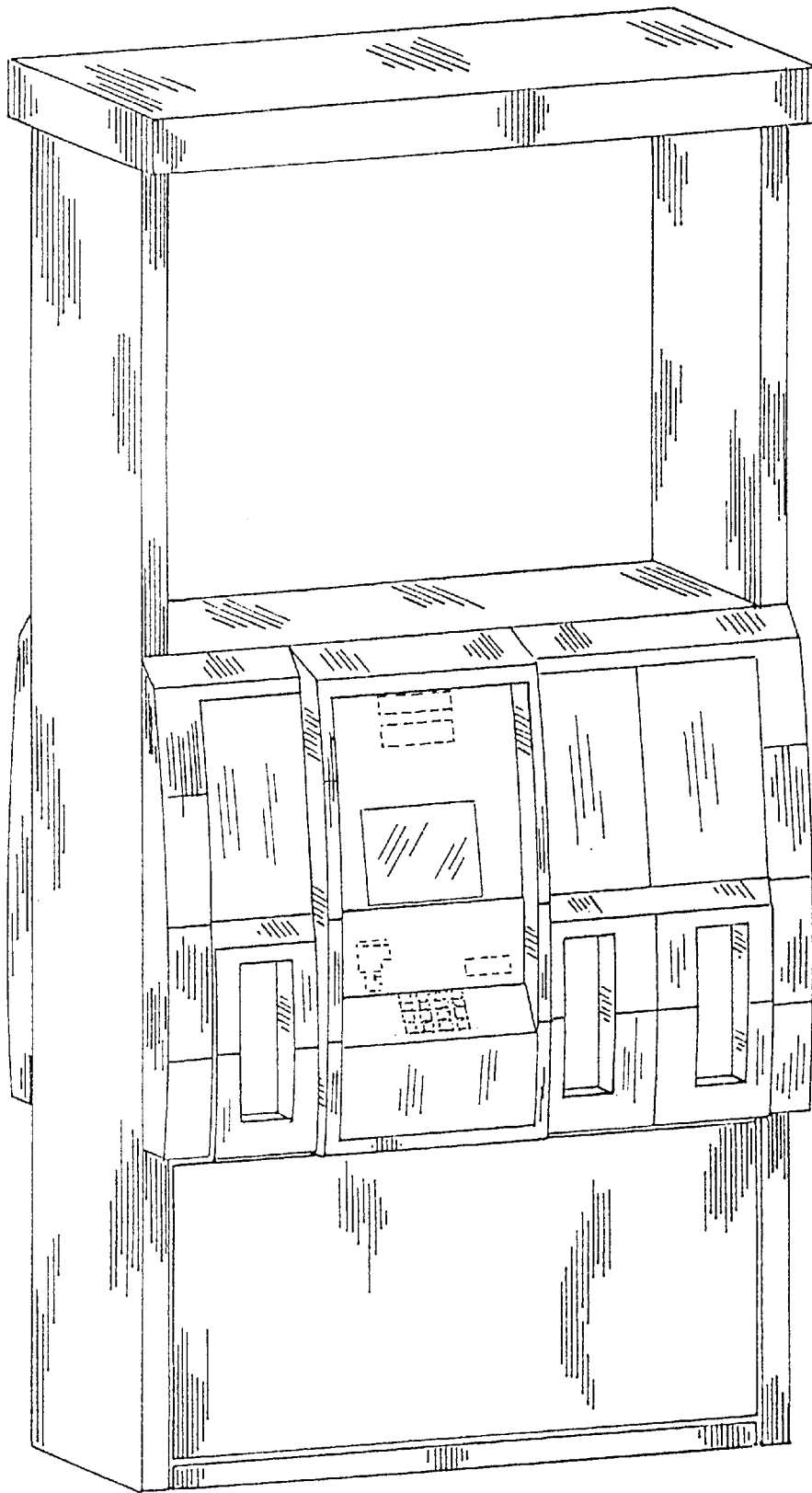

FIG. 1

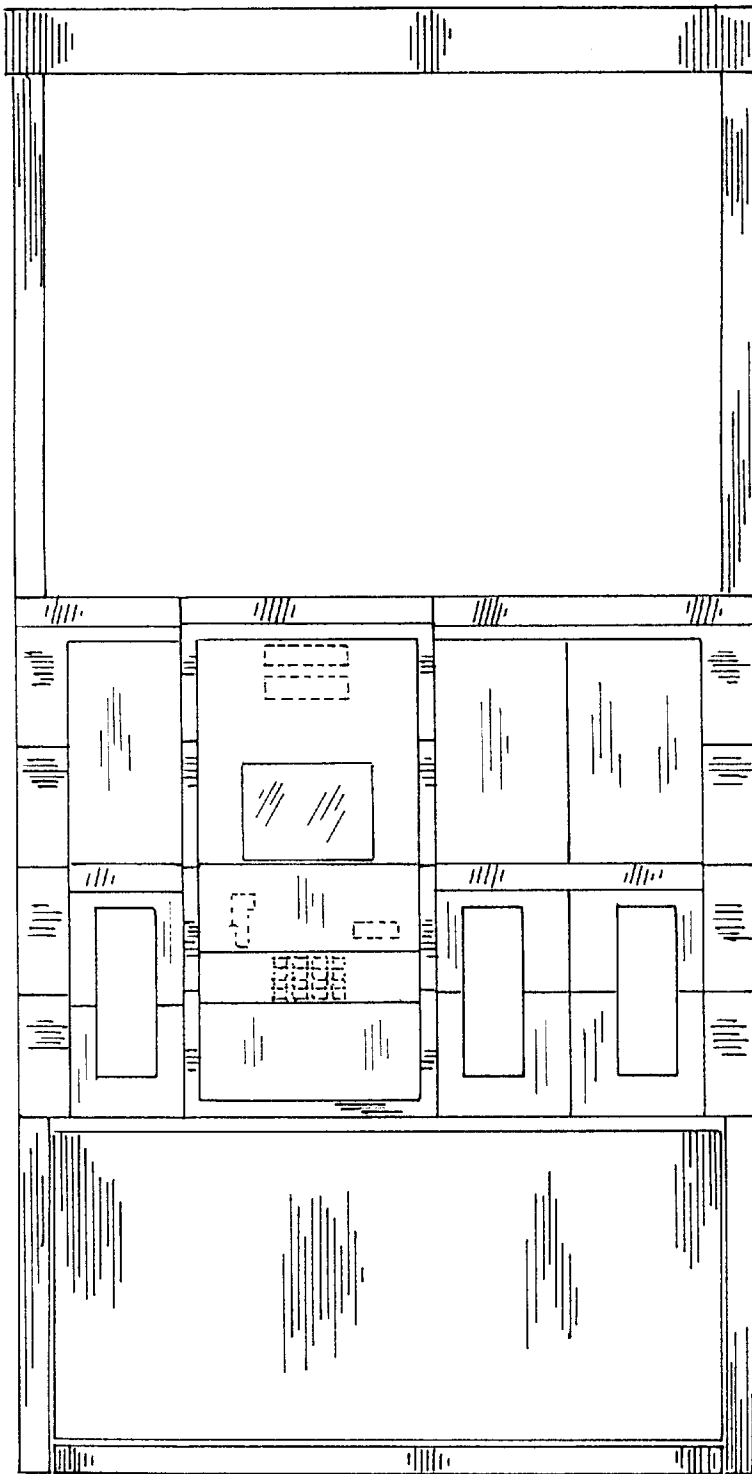

Fig.2

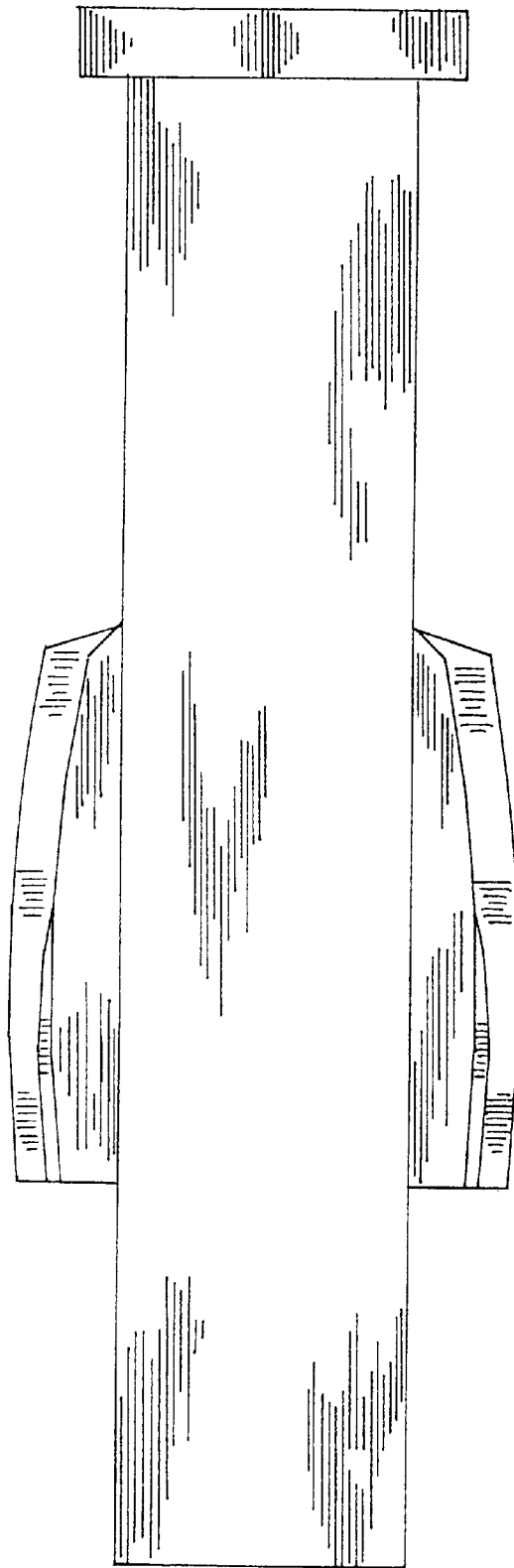

Fig. 3

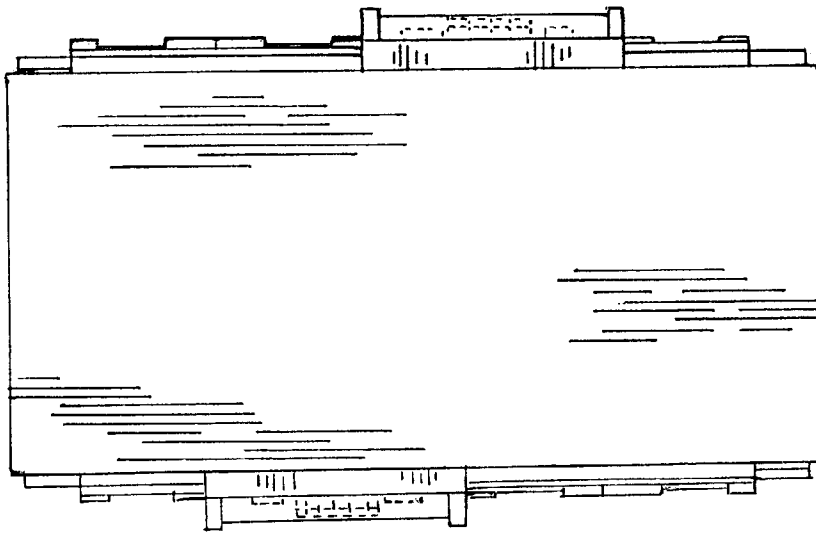

Fig. 4



Fig. 5