

(19) World Intellectual Property
Organization
International Bureau



(43) International Publication Date
18 August 2005 (18.08.2005)

PCT

(10) International Publication Number
WO 2005/075828 A1

- (51) International Patent Classification⁷: **F04B 39/00**
- (21) International Application Number:
PCT/BR2005/000014
- (22) International Filing Date: 1 February 2005 (01.02.2005)
- (25) Filing Language: English
- (26) Publication Language: English
- (30) Priority Data:
PI 0400624-0 4 February 2004 (04.02.2004) BR
- (71) Applicant (for all designated States except US): **EMPRESA BRASILEIRA DE COMPRESSORES S.A. - EMBRACO** [BR/BR]; Rua Rui Barbosa, 1020, 89219-901 Joinville - SC (BR).
- (72) Inventors; and
- (75) Inventors/Applicants (for US only): **BOSCO JUNIOR, Raul** [BR/BR]; Rua Euzébio de Queiróz, 750, 89203-100 Joinville - SC (BR). **BORTOLI, Marcos Giovanni Dropa de** [BR/BR]; Rua Borba Gato, 700, ap. 404 - bl. A, 89203-020 Joinville - SC (BR). **FAGOTTI, Fabian** [BR/BR]; Rua Barriga Verde, 539, 89222-360 Joinville - SC (BR).
- (74) Agents: **ARNAUD, Antonio M.P.** et al.; Rua José Bonifácio, 93, 9th floor, 01003-901 São Paulo - SP (BR).
- (81) Designated States (unless otherwise indicated, for every kind of national protection available): AE, AG, AL, AM, AT, AU, AZ, BA, BB, BG, BW, BY, BZ, CA, CH, CN, CO, CR, CU, CZ, DE, DK, DM, DZ, EC, EE, EG, ES, FI, GB, GD, GE, GH, GM, HR, HU, ID, IL, IN, IS, JP, KE, KG, KP, KR, KZ, LC, LK, LR, LS, LT, LU, LV, MA, MD, MG, MK, MN, MW, MX, MZ, NA, NI, NO, NZ, OM, PG, PH, PL, PT, RO, RU, SC, SD, SE, SG, SK, SL, SY, TJ, TM, TN, TR, TT, TZ, UA, UG, US, UZ, VC, VN, YU, ZA, ZM, ZW.
- (84) Designated States (unless otherwise indicated, for every kind of regional protection available): ARIPO (BW, GH, GM, KE, LS, MW, MZ, NA, SD, SL, SZ, TZ, UG, ZM, ZW), Eurasian (AM, AZ, BY, KG, KZ, MD, RU, TJ, TM), European (AT, BE, BG, CH, CY, CZ, DE, DK, EE, ES, FI, FR, GB, GR, HU, IE, IS, IT, LT, LU, MC, NL, PL, PT, RO, SE, SI, SK, TR), OAPI (BF, BJ, CF, CG, CI, CM, GA, GN, GQ, GW, ML, MR, NE, SN, TD, TG).
- Published:
— with international search report
— with amended claims
- For two-letter codes and other abbreviations, refer to the "Guidance Notes on Codes and Abbreviations" appearing at the beginning of each regular issue of the PCT Gazette.

(54) Title: SUCTION SYSTEM FOR A REFRIGERATION COMPRESSOR

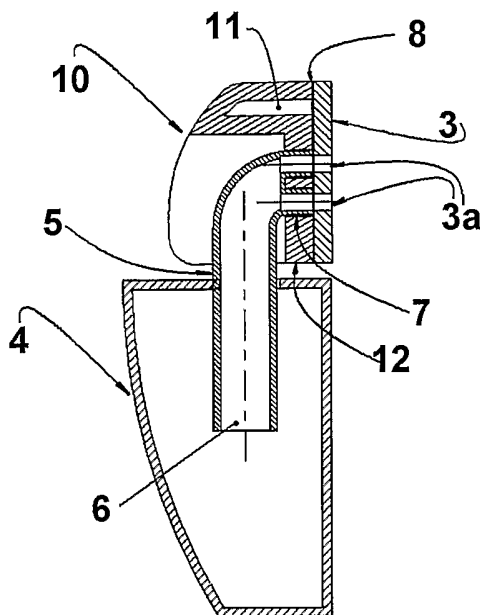

(57) Abstract: A suction system for a refrigeration compressor of the type which comprises a valve plate (3) which is provided with at least one suction orifice (3a), selectively closed by a suction valve, and which closes a cylinder end; a cylinder head (1,10) mounted against a face of the valve plate (3) opposite to that closing the cylinder and which defines a discharge chamber (2,11) occupying part of said cylinder head (1,10) and partially contouring the suction orifice (3a); and a suction muffler comprising a hollow body (4) having an outlet tube (5) projecting therefrom and presenting a free end (7) seated on the valve plate (3) in coaxial alignment with a respective suction orifice (3a), said cylinder head (10) being provided, externally to the discharge chamber (11), with a reinforcing wall portion (12) which is dimensioned to define an increase in the structural rigidity of the cylinder head (10).

"SUCTION SYSTEM FOR A REFRIGERATION COMPRESSOR".

Field of the Invention

The present invention refers to a suction system for a refrigeration compressor, particularly for suction
5 systems of the type which presents a suction muffler.

Background of the Invention

Refrigeration compressors generally comprise, in the interior of a shell, a motor-compressor assembly having a cylinder block within which is defined a
10 cylinder having an end closed by a cylinder head defining therewithin a housing for adaptation of a suction muffler, and a discharge chamber in selective fluid communication with a compression chamber defined inside the cylinder and which is closed by a valve
15 plate provided between the closed end of the cylinder and the cylinder head, said fluid communication being defined through suction and discharge orifices provided in said valve plate and which are selectively and respectively closed by suction and discharge
20 valves generally carried by the valve plate.

Contiguously to such orifices there are mounted noise mufflers upstream the suction orifice and downstream the discharge orifice. In order to maintain a good thermal insulation between the relatively cold gas
25 that is drawn and the other components adjacent to the suction muffler, the latter is generally constructed in plastic material. Thus, the overheating of the gas which is drawn along the path from the compressor inlet to the suction orifice is minimized, resulting
30 in better volumetric yield, thereby optimizing the performance in terms of efficiency and pumping capacity (mass flow).

The cylinder head usually defines a first element of the compressor discharge muffler and it is usually
35 constructed in metallic material so as to resist the

pressure differences to which it is submitted, since its internal face is exposed to the discharge pressure and its external face to the suction pressure.

Since the suction and discharge orifices for the admission and discharge of gas in relation to the cylinder are normally close to each other, having their spatial distribution usually limited to be contained in the valve plate in the region in which it covers the cylinder, the elements that cover them (suction chamber and cylinder head) present a contiguous section. The negative effect of such proximity is that the cylinder head is the warmest point of the compressor and the heat generated thereby is thus easily transmitted to the suction chamber and therefrom to the gas to be drawn by the cylinder. This results in higher overheating of said gas and reduction of yield and capacity, as explained above.

A known project solution which is normally adopted to define the channels leading to both the suction orifice and the discharge orifice is to make the suction chamber discharge the gas flow in a volume defined by a cavity in the cylinder head and valve plate, as illustrated in figure 2. This construction presents the advantage of being relatively simple to manufacture, requiring components of little geometrical complexity and resulting in a structurally rigid cylinder head, which is very interesting when the working fluid causes great pressure differences and/or the size of this cylinder head is relatively large. On the other hand, there is a metallic interface separating the suction valve antechamber containing a relatively cold gas (desired to be maintained) from the cylinder discharge chamber containing hot gas. Thus, there is an intense heat transfer between both chambers, negatively influencing

the performance. Furthermore, the mounting process of the suction muffler in the cylinder head requires the inclusion of relatively complex fixation elements, such as threads, or the inclusion of intermediary elements, such as a metallic suction tube, since the material (plastic) of the suction muffler tends to deform with time when submitted to temperatures which in certain cases occur in this region of the compressor, not guaranteeing the necessary reliability in the fixation of the suction muffler to the cylinder head. Moreover, to guarantee a perfect sealing between the elements, additional elements, such as o'rings or gaskets, are usually included to prevent eventual leakages from impairing the attenuation of noise, which is the main function of the suction muffler. Figures 3-4 illustrate another prior art construction for the suction system which avoids the problems mentioned above. In this construction, the suction tube is constructed in plastic material and seated on the valve plate externally to the cylinder head, i.e., the suction tube is not disposed through the interior of the cylinder head, which maintains it spaced from the warmest region of the discharge chamber. In this construction, the temperatures to which the suction tube is submitted are considerably lower than those in the construction described above, thus avoiding the use of intermediary fixation elements of said prior art construction. Furthermore, the need for additional sealing elements is eliminated, since said sealing occurs in the interface between the suction tube and the gasket seated against the valve plate. However, the disadvantage of this solution resides in the reduction of the structural rigidity of the cylinder head. In compressors that work with fluids which cause great pressure differences between the

suction and discharge sides, or in compressors that have larger dimensions, deformations may occur in the cylinder head and cause leakages, impairing the performance, or ruptures in the gasket, making the compressor lose its functional characteristics. Moreover, this prior art solution further allows the occurrence of deformations as a function of the load imposed by the fixation elements (generally screws) of the cylinder head to the cylinder block,

5

10 A way to overcome the deficiency of structural fragility of this known prior art solution would be the use of materials with a higher modulus of elasticity, but which has the disadvantage of increasing the cost of the component, whether by using

15 a nobler material, or materials that need more complex manufacturing processes.

Objects of the Invention

Thus, it is an object of the present invention to provide a suction system for a refrigeration compressor which does not impair the cylinder performance, minimizing heat transfer, in the region of the cylinder head, to the gas directed to the suction chamber, and which imparts higher structural rigidity to the cylinder head.

20

25 It is another object of the present invention to provide a system such as mentioned above, of simple construction and reduced cost and which does not impair the noise attenuation by the suction muffler.

Summary of the Invention

30 These and other objects are attained by a suction system for a compressor of the type which comprises: a cylinder; a valve plate which is provided with at least one suction orifice, selectively closed by a suction valve, and which closes a cylinder end; a

35 cylinder head mounted against a face of the valve

plate opposite to that closing the cylinder and which defines a discharge chamber occupying part of said cylinder head and partially contouring the suction orifice; and a suction muffler comprising a hollow
5 body having an outlet tube projecting therefrom and presenting a free end seated on the valve plate in coaxial alignment with a respective suction orifice, said cylinder head being provided, externally to the discharge chamber, with a reinforcing wall portion
10 which is dimensioned to define an increase in the structural rigidity of the cylinder head.

Brief Description of the Drawings

The invention will be described with reference to the enclosed drawings, in which:

15 Figure 1 illustrates, schematically, a rear view of the suction muffler mounted in the cylinder head, according to a prior art construction;

Figure 2 illustrates, schematically, a longitudinal sectional view of the suction muffler-cylinder head
20 assembly, according to line II-II shown in figure 1;

Figure 3 illustrates, schematically, a rear view of the suction muffler mounted in the cylinder head, according to another prior art construction;

Figure 4 illustrates, schematically, a longitudinal
25 sectional view of the suction muffler-cylinder head assembly, according to the line IV-IV shown in figure 3;

Figure 5 illustrates, schematically, a rear view of the suction muffler mounted in the cylinder head,
30 according to the present invention;

Figure 6 illustrates, schematically, a longitudinal sectional view of the suction muffler-cylinder head assembly, according to the line VI-VI shown in figure 5; and

35 Figure 7 illustrates, schematically and in exploded

front perspective view, the suction muffler and cylinder head, constructed according to the present invention.

Description of the Illustrated Embodiment

5 The present invention will be described in relation to a compressor of a refrigeration system which, though not illustrated, comprises inside a shell, such as a hermetic shell, a motor-compressor assembly having a cylinder block within which is defined a cylinder
10 which lodges, at one end, a piston, and has an opposite end closed by a cylinder head 1 defining a discharge chamber 2 therewithin in selective fluid communication with a compression chamber (not illustrated) defined in the inside of the cylinder
15 between a top portion of the piston and a valve plate 3 provided between the opposite end of the cylinder and the cylinder head 1.

The valve plate 3 is provided with at least one suction orifice 3a and with a discharge orifice (not
20 illustrated) which are selectively and respectively closed by suction and discharge valves (not illustrated), each suction orifice 3a allowing the selective fluid communication between the discharge chamber 2 and the compression chamber of the cylinder.

25 The suction system being described further comprises a suction muffler 4, generally made in a material of low thermal conductivity, having a hollow body provided with a gas inlet (not illustrated) in fluid communication with the gas supplied to the compressor,
30 and carrying an outlet tube 5 in fluid communication with a suction side of the compressor, said outlet tube 5 presenting an end 6 internal to the hollow body and a free end 7 outwardly projecting from the hollow body and seated on the valve plate 3 in coaxial
35 alignment with a respective suction orifice 3a.

According to a constructive form of the prior art suction system illustrated in figures 1 and 2, the outlet tube 5 is mounted to the cylinder head 1 so as to have its free end 7 mounted through the cylinder head 1. Although in said solution the cylinder head 1 presents a strong construction, this solution presents the disadvantages discussed above.

According to another constructive form illustrated in figures 3 and 4, the outlet tube 5 has its free end 7 seated on the valve plate 3 external to the cylinder head 1. In this construction, the cylinder head 1 is shaped in such a way that the outlet tube 5 need not penetrate into the internal volume of said cylinder head 1, minimizing the heating of the gas being drawn. However, said solution presents a cylinder head 1 with a less strong construction and with the previously mentioned disadvantages.

The system of the present invention comprises a cylinder head 10 provided, externally to its discharge chamber 11, with a reinforcing wall portion 12 which is dimensioned to define an increase in the structural rigidity of said cylinder head 10, said reinforcing wall portion 12 having at least part of its extension spaced from the outlet tube 5 in order to minimize the heat transfer from the cylinder head 10 to the gas being drawn through the outlet tube 5. In a constructive option of the present invention, the reinforcing wall portion 12 occupies the area of the cylinder head 10 external to the discharge chamber 11. The construction of the cylinder head of the present invention aims at maintaining the advantages presented by the prior art constructions illustrated in figures 1-4, without the deficiencies thereof. The cylinder head 10 of the present invention is constructed so as not to have a section presenting a through passage,

such as that of the prior art illustrated in figure 3, i.e., maintaining a structural rigidity which is greater than that presented by said prior art construction and similar to that of the construction
5 illustrated in figure 1. Since the sealing of the junction of the discharge chamber 11 to the valve plate 5 occurs on a gasket 8, the construction of the present invention does not require the inclusion of additional sealing and fixation elements found in the
10 prior art construction illustrated in figure 1.

In a constructive option of the present invention, the reinforcing wall portion 12 maintains the outlet tube 5 seated on the valve plate 3, said reinforcing wall portion 12 being for example also seated on the valve
15 plate 3. In a variant of this solution, the reinforcing wall portion 12 is medianly opened so as to involve and retain the free end 7 of the outlet tube 5, which trespasses said opened portion, to be seated on the valve plate 3, or also to allow the free
20 end 7 of the outlet tube 5 to be fitted into at least part of the extension of a respective suction orifice 3a in the valve plate 3.

In the illustrated solution, the free end 7 of the outlet tube 5 is provided with two tubular projections
25 9, which are parallel and for example axially spaced from each other and each aligned with a respective suction orifice 3a of the valve plate 3.

In this construction, the cylinder head 10 is provided in the region of the reinforcing wall portion 12 with
30 a pair of openings 13 which are parallel to each other, so that each receives a tubular projection 9 of the outlet tube 5, said openings 13 having their contour seated against the valve plate 3.

The tubular projections 9 provide the necessary
35 thermal insulation between the cold gas and the

adjacent warmest section represented by the cylinder head 1, besides representing an additional acoustic dampening in case any leakage occurs between the suction muffler and the gasket 8, which makes this construction acoustically stronger than that of the prior art illustrated in figure 3. These tubular projections 9 can, for example, project farther than as shown herein and have an additional extension to cover part or the whole thickness of the valve plate 3, providing an additional thermal insulation to another warm part of the compressor. With this construction, the temperature to which the interior of the suction muffler is submitted becomes similar to that presented by the solution of figure 3, allowing the use of plastic material to construct its body, which simplifies the manufacturing and mounting process in relation to the prior art solution illustrated in figure 1.

In another constructive option, not illustrated, the reinforcing wall portion 12 is trespassed by the outlet tube 5 in a portion thereof spaced from the valve plate 3.

According to the present invention, there is further provided a fixation element 14, for example in the form of a spring which surrounds the outlet tube 5 mounted in the cylinder head 10, said fixation element having a pair of retaining end portions 14a, each fitted into a fitting receiving portion 15 defined in the cylinder head 10, for example in lateral portions thereof, said fitting receiving portions 15 being aligned to each other and orthogonal to the alignment of the openings 13 of said cylinder head 10.

The fixation element 14, in this construction, has its movements restricted by the tubular projections 9 in axes that are orthogonal to each other and parallel to

the valve plate 3, said spring restricting the movement of the suction muffler in the directions parallel to the valve plate 3, i.e., only in the directions in which the spring has some actuation.

5 The fixation element 14 exerts on the suction muffler 4 a friction force in a direction parallel to the outlet tube and to the valve plate 3 and, in the other directions, the force occurs by the rigidity of the fixation element 14. Additionally, eventual
10 deformations caused to the cylinder head 10 by action of the fixation element 14 occur so as to better seal the region of the gasket 8 that is more susceptible to leakages and rupture, in this case the portion between the tubular projections 9.

15 While a construction for fixation means has been illustrated, it should be understood that other constructions are possible, such as a spring element, which can be affixed to the regions of the cylinder head adjacent to the outlet tube 5 through fixation
20 means, such as adhesive, screws, etc., which aspect should not be considered as a limitation for the inventive concept presented herein.

CLAIMS

1. A suction system for a refrigeration compressor of the type which comprises a cylinder; a valve plate (3) which is provided with at least one suction orifice (3a), selectively closed by a suction valve, and which closes a cylinder end; a cylinder head (1,10) mounted against a face of the valve plate (3) opposite to that closing the cylinder and which defines a discharge chamber (2, 11) occupying part of said cylinder head (1, 10) and partially contouring the suction orifice (3a); and a suction muffler (4) comprising a hollow body having an outlet tube (5) projecting therefrom and presenting a free end (7) seated on the valve plate (3) in coaxial alignment with a respective suction orifice (3a), characterized in that the cylinder head (10) is provided, externally to the discharge chamber (11), with a reinforcing wall portion (12) which is dimensioned to define an increase in the structural rigidity of the cylinder head (10).
2. The system as set forth in claim 1, characterized in that the reinforcing wall portion (12) has at least part of its extension spaced from the outlet tube (5).
3. The system as set forth in claim 2, characterized in that the reinforcing wall portion (12) maintains the outlet tube (5) seated on the valve plate (3).
4. The system as set forth in claim 3, characterized in that the reinforcing wall portion (12) is trespassed by the outlet tube (5).
5. The system as set forth in claim 3, characterized in that the reinforcing wall portion (12) is seated against the valve plate (3).
6. The system as set forth in claim 5, characterized in that the reinforcing wall portion (12) occupies the area of the cylinder head (10) external to the

discharge chamber (11).

7. The system as set forth in claim 6, characterized in that the reinforcing wall portion (12) is medianly opened so as to surround and retain the free end (7) of the outlet tube (5).

8. The system as set forth in claim 1, characterized in that the free end (7) of the outlet tube (5) is fitted into the interior of at least part of the extension of a respective suction orifice (3a) in the valve plate (3).

9. The system as set forth in claim 1, characterized in that the free end (7) of the outlet tube (5) is provided with two tubular projections (9) which are parallel to each other, each being aligned with a respective suction orifice (3a) of the valve plate (3).

10. The system as set forth in claim 9, characterized in that the cylinder head (10) comprises a pair of openings (13) which are parallel to each other, each receiving a respective tubular projection (9) of the outlet tube (5).

11. The system as set forth in claim 1, characterized in that it comprises a fixation element (14) constantly forcing the cylinder head (10) against the valve plate (3).

AMENDED CLAIMS

[received by the International Bureau on 06 June 2005 (06.06.05);
original claims 1-11 replaced by new claims 1-10 (2 pages)]

1. A suction system for a refrigeration compressor of the type which comprises a cylinder; a valve plate (3) which is provided with at least one suction orifice (3a), selectively closed by a suction valve, and which closes a cylinder end; a cylinder head (1,10) mounted against a face of the valve plate (3) opposite to that closing the cylinder and which defines a discharge chamber (2, 11) occupying part of said cylinder head (1, 10) and partially contouring the suction orifice (3a); and a suction muffler (4) comprising a hollow body having an outlet tube (5) projecting therefrom and presenting a free end (7) seated on the valve plate (3) in coaxial alignment with a respective suction orifice (3a), said cylinder head (10) being provided, externally to the discharge chamber (11), with a reinforcing wall portion (12) which is dimensioned to define an increase in the structural rigidity of the cylinder head (10), characterized in that the free end (7) of the outlet tube (5) is provided with two tubular projections (9) which are parallel to each other, each being aligned with a respective suction orifice (3a) of the valve plate (3).
- 25 2. The system as set forth in claim 1, characterized in that the reinforcing wall portion (12) has at least part of its extension spaced from the outlet tube (5).
3. The system as set forth in claim 2, characterized in that the reinforcing wall portion (12) maintains the outlet tube (5) seated on the valve plate (3).
- 30 4. The system as set forth in claim 3, characterized in that the reinforcing wall portion (12) is trespassed by the outlet tube (5).
5. The system as set forth in claim 3, characterized in that the reinforcing wall portion (12) is seated
- 35

against the valve plate (3).

6. The system as set forth in claim 5, characterized in that the reinforcing wall portion (12) occupies the area of the cylinder head (10) external to the discharge chamber (11).

7. The system as set forth in claim 6, characterized in that the reinforcing wall portion (12) is medianly opened so as to surround and retain the free end (7) of the outlet tube (5).

8. The system as set forth in claim 1, characterized in that the free end (7) of the outlet tube (5) is fitted into the interior of at least part of the extension of a respective suction orifice (3a) in the valve plate (3).

9. The system as set forth in claim 1, characterized in that the cylinder head (10) comprises a pair of openings (13) which are parallel to each other, each receiving a respective tubular projection (9) of the outlet tube (5).

10. The system as set forth in claim 1, characterized in that it comprises a fixation element (14) constantly forcing the cylinder head (10) against the valve plate (3).

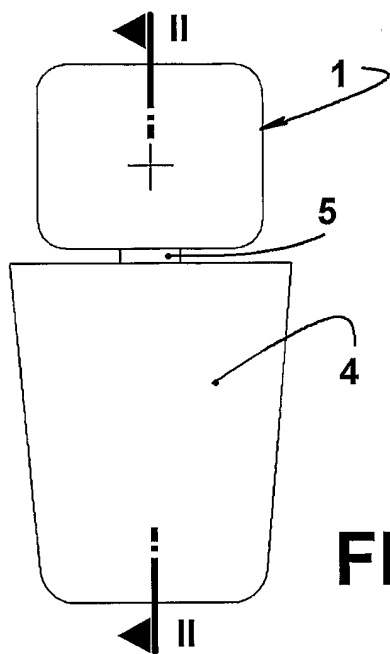

FIG. 1

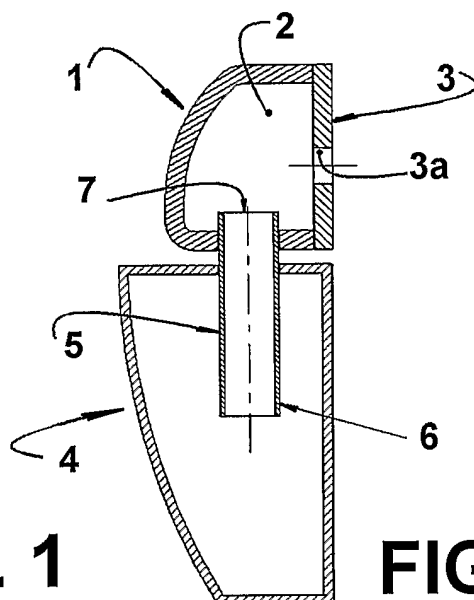

FIG. 2

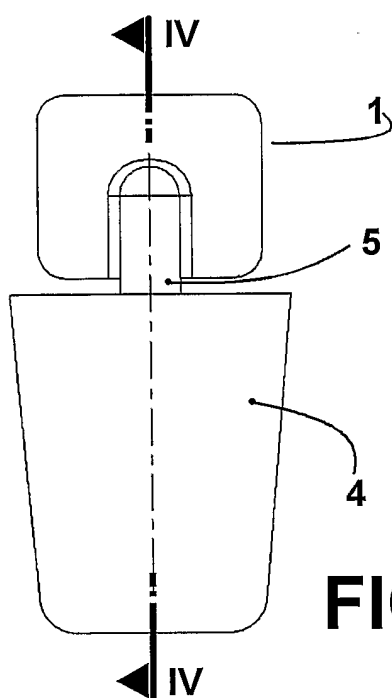

FIG. 3

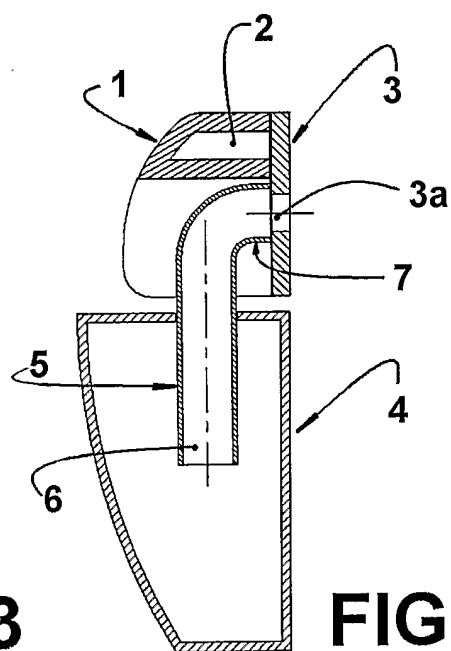
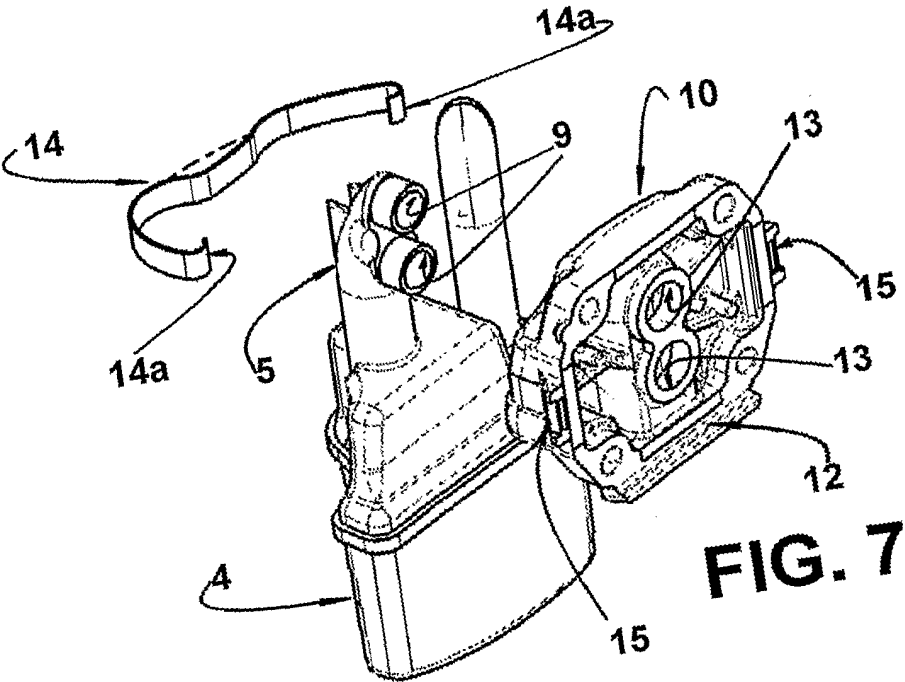
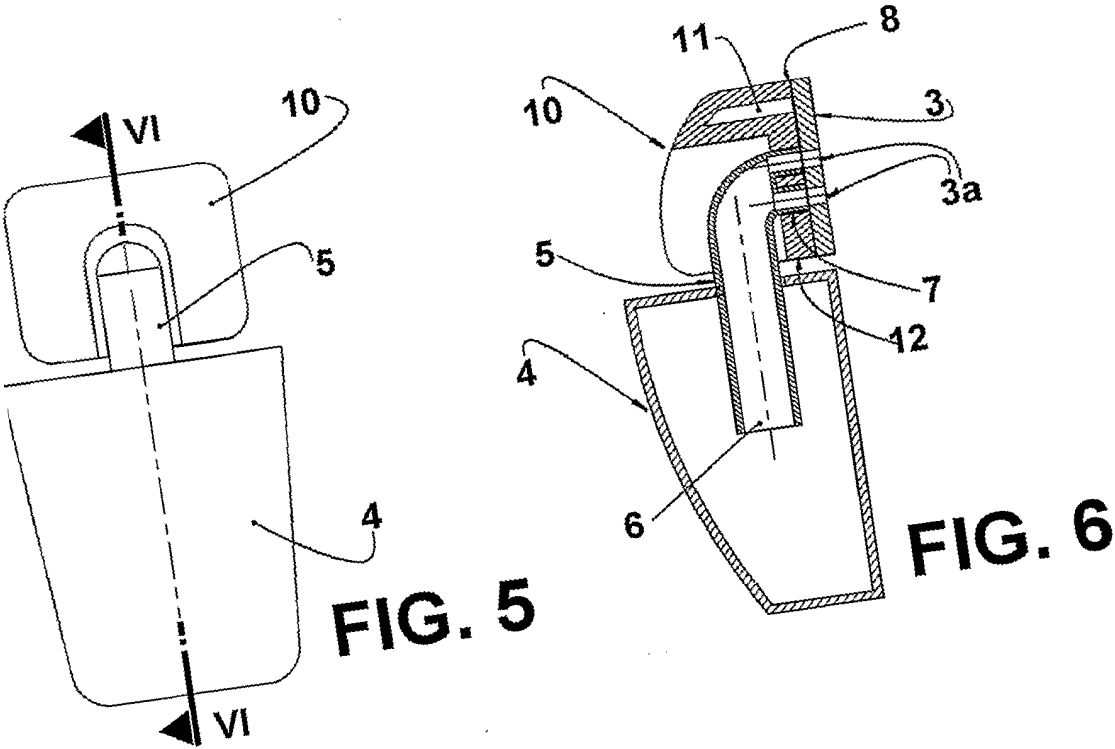

FIG. 4



INTERNATIONAL SEARCH REPORT

International Application No

R2005/000014

A. CLASSIFICATION OF SUBJECT MATTER
IPC 7 F04B39/00

According to International Patent Classification (IPC) or to both national classification and IPC

B. FIELDS SEARCHED

Minimum documentation searched (classification system followed by classification symbols)
IPC 7 F04B

Documentation searched other than minimum documentation to the extent that such documents are included in the fields searched

Electronic data base consulted during the international search (name of data base and, where practical, search terms used)

EPO-Internal, WPI Data, PAJ

C. DOCUMENTS CONSIDERED TO BE RELEVANT

Category °	Citation of document, with indication, where appropriate, of the relevant passages	Relevant to claim No.
X	PATENT ABSTRACTS OF JAPAN vol. 017, no. 447 (M-1464), 17 August 1993 (1993-08-17) -& JP 05 099141 A (MATSUSHITA REFRIG CO LTD), 20 April 1993 (1993-04-20) abstract; figures 1,2 -----	1-7
X	PATENT ABSTRACTS OF JAPAN vol. 013, no. 163 (M-816), 19 April 1989 (1989-04-19) -& JP 01 003275 A (MATSUSHITA REFRIG CO), 9 January 1989 (1989-01-09) abstract; figures 1,2 -----	1-3,5,6
X	US 5 722 818 A (OHTA ET AL) 3 March 1998 (1998-03-03) column 4, line 53 - column 5, line 14; figure 6 ----- -/--	1-6,11



Further documents are listed in the continuation of box C.



Patent family members are listed in annex.

° Special categories of cited documents :

- *A* document defining the general state of the art which is not considered to be of particular relevance
- *E* earlier document but published on or after the international filing date
- *L* document which may throw doubts on priority claim(s) or which is cited to establish the publication date of another citation or other special reason (as specified)
- *O* document referring to an oral disclosure, use, exhibition or other means
- *P* document published prior to the international filing date but later than the priority date claimed

- *T* later document published after the international filing date or priority date and not in conflict with the application but cited to understand the principle or theory underlying the invention
- *X* document of particular relevance; the claimed invention cannot be considered novel or cannot be considered to involve an inventive step when the document is taken alone
- *Y* document of particular relevance; the claimed invention cannot be considered to involve an inventive step when the document is combined with one or more other such documents, such combination being obvious to a person skilled in the art.
- *&* document member of the same patent family

Date of the actual completion of the international search

21 April 2005

Date of mailing of the international search report

04/05/2005

Name and mailing address of the ISA

European Patent Office, P.B. 5818 Patentlaan 2
NL - 2280 HV Rijswijk
Tel. (+31-70) 340-2040, Tx. 31 651 epo nl,
Fax: (+31-70) 340-3016

Authorized officer

De Graaf, J.D.

INTERNATIONAL SEARCH REPORT

International Application No
BR2005/000014

C.(Continuation) DOCUMENTS CONSIDERED TO BE RELEVANT

Category *	Citation of document, with indication, where appropriate, of the relevant passages	Relevant to claim No.
X	PATENT ABSTRACTS OF JAPAN vol. 1995, no. 11, 26 December 1995 (1995-12-26) -& JP 07 208334 A (MATSUSHITA REFRIG CO LTD), 8 August 1995 (1995-08-08) abstract; figures 1,4-7 -----	1-7,11
X	PATENT ABSTRACTS OF JAPAN vol. 013, no. 163 (M-816), 19 April 1989 (1989-04-19) -& JP 01 003276 A (MATSUSHITA REFRIG CO), 9 January 1989 (1989-01-09) abstract; figures 1-3 -----	1-6
X	PATENT ABSTRACTS OF JAPAN vol. 013, no. 287 (M-844), 30 June 1989 (1989-06-30) -& JP 01 080781 A (MATSUSHITA REFRIG CO), 27 March 1989 (1989-03-27) abstract; figures 1-3 -----	1-5
X	PATENT ABSTRACTS OF JAPAN vol. 013, no. 257 (M-837), 14 June 1989 (1989-06-14) -& JP 01 060784 A (MATSUSHITA REFRIG CO), 7 March 1989 (1989-03-07) abstract; figures 1,2 -----	1,2
X	US 2002/098093 A1 (TOMELL PHILLIP A ET AL) 25 July 2002 (2002-07-25) figures 12,18a,18e -----	1,8,9
X	PATENT ABSTRACTS OF JAPAN vol. 013, no. 161 (M-815), 18 April 1989 (1989-04-18) -& JP 64 000371 A (MATSUSHITA REFRIG CO), 5 January 1989 (1989-01-05) abstract; figures 1-3 -----	1,2
X	PATENT ABSTRACTS OF JAPAN vol. 012, no. 197 (M-706), 8 June 1988 (1988-06-08) -& JP 63 005187 A (MATSUSHITA REFRIG CO), 11 January 1988 (1988-01-11) abstract; figures 2,4 -----	1
A	US 5 733 106 A (LEE ET AL) 31 March 1998 (1998-03-31) -----	
A	US 5 950 307 A (LEE ET AL) 14 September 1999 (1999-09-14) -----	
A	US 5 584 674 A (MO ET AL) 17 December 1996 (1996-12-17) -----	

INTERNATIONAL SEARCH REPORT

Information on patent family members

International Application No

JP, BR2005/000014

Patent document cited in search report		Publication date	Patent family member(s)	Publication date
JP 05099141	A	20-04-1993	NONE	
JP 01003275	A	09-01-1989	JP 2624258 B2	25-06-1997
US 5722818	A	03-03-1998	JP 3301895 B2	15-07-2002
			JP 9072280 A	18-03-1997
			CN 1149671 A ,C	14-05-1997
JP 07208334	A	08-08-1995	NONE	
JP 01003276	A	09-01-1989	NONE	
JP 01080781	A	27-03-1989	NONE	
JP 01060784	A	07-03-1989	NONE	
US 2002098093	A1	25-07-2002	US 2003156955 A1	21-08-2003
			US 2004223854 A1	11-11-2004
JP 64000371	A	05-01-1989	NONE	
JP 63005187	A	11-01-1988	NONE	
US 5733106	A	31-03-1998	KR 175891 B1	01-10-1999
			BR 9603199 A	27-05-2003
			CN 1142015 A ,C	05-02-1997
			IT RM960535 A1	29-01-1998
			JP 2895795 B2	24-05-1999
			JP 9042151 A	10-02-1997
US 5950307	A	14-09-1999	KR 143142 B1	01-08-1998
			BR 9600950 A	30-12-1997
			CN 1137098 A ,C	04-12-1996
			IT RM960151 A1	08-09-1997
			JP 2944031 B2	30-08-1999
			JP 8247032 A	24-09-1996
			US 5762478 A	09-06-1998
US 5584674	A	17-12-1996	IT 1272216 B	16-06-1997
			JP 6307339 A	01-11-1994
			KR 141490 Y1	15-05-1999
			KR 146151 Y1	15-06-1999