



- (51) International Patent Classification:
A61B 5/00 (2006.01) A61B 5/0215 (2006.01)
- (21) International Application Number:
PCT/EP2019/053936
- (22) International Filing Date:
18 February 2019 (18.02.2019)
- (25) Filing Language: English
- (26) Publication Language: English
- (30) Priority Data:
18158860.9 27 February 2018 (27.02.2018) EP
- (71) Applicant: **KONINKLIJKE PHILIPS N.V.** [NL/NL];
High Tech Campus 5, 5656 AE Eindhoven (NL).
- (72) Inventors: **WEEKAMP, Johannes, Wilhelmus**; High
Tech Campus 5, 5656 AE Eindhoven (NL). **VAN RENS,
Antonia, Cornelia**; High Tech Campus 5, 5656 AE Eindh-
hoven (NL). **VAN DE MOLENGRAAF, Roland, Alexan-
der**; High Tech Campus 5, 5656 AE Eindhoven (NL). **VAN**

- DER HORST, Arjen**; High Tech Campus 5, 5656 AE
Eindhoven (NL).
- (74) Agent: **STEFFEN, Thomas et al.**; Philips International
B.V., Intellectual Property & Standards, High Tech Campus
5, 5656 AE Eindhoven (NL).
- (81) Designated States (*unless otherwise indicated, for every
kind of national protection available*): AE, AG, AL, AM,
AO, AT, AU, AZ, BA, BB, BG, BH, BN, BR, BW, BY, BZ,
CA, CH, CL, CN, CO, CR, CU, CZ, DE, DJ, DK, DM, DO,
DZ, EC, EE, EG, ES, FI, GB, GD, GE, GH, GM, GT, HN,
HR, HU, ID, IL, IN, IR, IS, JO, JP, KE, KG, KH, KN, KP,
KR, KW, KZ, LA, LC, LK, LR, LS, LU, LY, MA, MD, ME,
MG, MK, MN, MW, MX, MY, MZ, NA, NG, NI, NO, NZ,
OM, PA, PE, PG, PH, PL, PT, QA, RO, RS, RU, RW, SA,
SC, SD, SE, SG, SK, SL, SM, ST, SV, SY, TH, TJ, TM, TN,
TR, TT, TZ, UA, UG, US, UZ, VC, VN, ZA, ZM, ZW.
- (84) Designated States (*unless otherwise indicated, for every
kind of regional protection available*): ARIPO (BW, GH,
GM, KE, LR, LS, MW, MZ, NA, RW, SD, SL, ST, SZ, TZ,

(54) Title: A SENSOR ARRANGEMENT FOR MOUNTING ON A GUIDEWIRE OR CATHETER

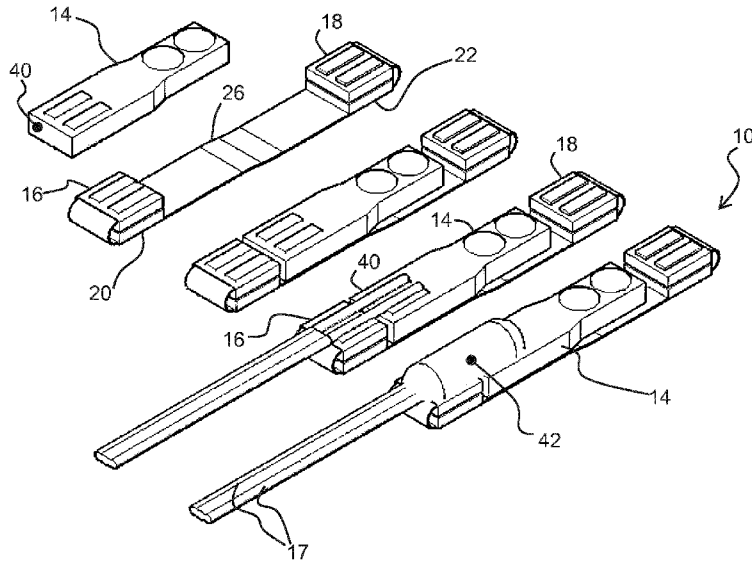

FIG. 3

(57) Abstract: A sensor arrangement is for mounting along an elongate device. The sensor arrangement is for positioning along a line sensor arrangements and has terminal blocks at a proximal and distal side, each for connection to one or more wires. A connection circuit controls the coupling of sensor signals to the proximal wires and the coupling of the distal wires to the proximal wires. In this way, a bypass function is implemented through the connection circuit, which avoids the need for physical wires of a distal sensor arrangement to bypass the sensor arrangement itself.



UG, ZM, ZW), Eurasian (AM, AZ, BY, KG, KZ, RU, TJ, TM), European (AL, AT, BE, BG, CH, CY, CZ, DE, DK, EE, ES, FI, FR, GB, GR, HR, HU, IE, IS, IT, LT, LU, LV, MC, MK, MT, NL, NO, PL, PT, RO, RS, SE, SI, SK, SM, TR), OAPI (BF, BJ, CF, CG, CI, CM, GA, GN, GQ, GW, KM, ML, MR, NE, SN, TD, TG).

Declarations under Rule 4.17:

- *as to applicant's entitlement to apply for and be granted a patent (Rule 4.17(ii))*

Published:

- *with international search report (Art. 21(3))*

A sensor arrangement for mounting on a guidewire or catheter

FIELD OF THE INVENTION

This invention relates to devices which incorporate sensing functionality along a shaft such as a guidewire or catheter.

5 BACKGROUND OF THE INVENTION

Minimally invasive surgery methods require the implementation of sensors for imaging or for physiological parameter monitoring at the tip of and/or along guidewires and catheters.

10 However, the very limited size of these instruments poses an important challenge in integrating the required sensing functionality. Micro-electromechanical system (MEMS) sensors can be integrated with application-specific integrated circuit (ASIC) technology and enable advanced imaging and/or sensing functionality in a very small area.

The interconnect between the in-vivo sensors and the ex-vivo sensor system has to be optimized as well, basically meaning the number of system wires has to be
15 minimized. A low wire count is important due to the limited space available to route the wires. For example a typical outer diameter of a coronary guidewire is 360 μm . A low wire count is also important as it simplifies the soldering or other bonding of the system wires to the sensor die.

20 Pressure sensor solutions for medical guidewires and catheters can be based on capacitive, piezo resistive and optic transducer technology. One known sensor solution is a capacitive pressure sensor for use in a medical guidewire. The pressure sensing guidewire is known as a pressure wire. The capacitive pressure sensing device is monolithically integrated with its readout circuit. The arrangement comprises a sensor control system at one (proximal) end of a shaft and a pressure sensor at the other (distal) end. A pair of electrical wires runs
25 along the shaft. The solution uses only two electrical interface signals; one ground signal on one of the wires and one signal that carries the sensor DC supply voltage (e.g. 2.5V) and also carries a frequency modulated current as the sensor signal. This modulation is read by the sensor control system.

The connection scheme based on two signals is significant as it simplifies the soldering and bonding of the system wires to the miniaturized sensor die. The signals are transferred via two conductive ribbons from the distal end to the proximal end of the shaft, e.g. catheter.

5 It is also desirable to provide multiple sensors along a catheter or guidewire, so that physiological sensing can take place at different locations and/or different sensor types may be provided along a length portion of the catheter or guidewire.

The problem then arises that the electrical connection wires to a more distal sensor (i.e. one inserted further into the body) need to bypass a more proximal sensor if
10 independent readout is desired. There is insufficient space for this physical bypass.

US 2005/0148832 A1 discloses an apparatus for sensing multiple parameters comprising a housing and a plurality of sensors disposed within the housing. The plurality of sensors are "daisy-chained" together via the interconnect. The "daisy-chaining" is facilitated by digital addressing, therefore each of the plurality of sensors includes an analog-to-digital
15 (AID) converter integrated circuit as well as a power supply for powering the integrated circuit. Each of the plurality of sensors may be individually addressed by a remote device, such as, for example, a computer or other controller.

There remains a need for improvement of interconnection between plurality of sensors for integration of the plurality of sensors in devices with form and spatial dimension
20 limitations.

SUMMARY OF THE INVENTION

The invention is defined by the claims.

According to the needs of improvement of interconnection between plurality
25 of sensors and/or integration of plurality of sensors in devices with form and spatial dimension limitations, the invention discloses the following embodiments:

a) A sensor connection arrangement for an elongate device, comprising:

a foil configured for conduction of electrical signals, the foil comprising two terminal segments at two opposite sides of a central segment, wherein at least a portion of each of the
30 terminal segments is bendable for allowing folding of the terminal segments of the foil over the central segment of the foil;

two terminal structures attached and electrically connected to the respective terminal segments of the foil,

wherein the terminal structures are configured to at least partially overlap with the central segment of the foil when a sensor is electrically connected to one of the terminal structures.

- 5 b) The sensor connection arrangement of a), wherein the terminal structures and the foil form a cradle, configured to receive the sensor.
- c) The sensor arrangement of a) or b), further comprising two ASIC connection structures attached and electrically connected to the foil, and wherein the two terminal structures overlap with the respective ASIC connection structures when the sensor is electrically connected to one of the terminal structures.
- 10 d) A sensor arrangement comprising:
a sensor connection arrangement of any of a) to c);
the sensor, electrically coupled to a first of the terminal structures;
wherein the second of the terminal structures is configured for connection to a further sensor.
- e) The sensor arrangement of d), wherein the connection of the sensor to the respective
15 terminal structure is arranged on the same side of the sensor that is configured for providing measurement signals of the surroundings.
- f) The sensor arrangement of d) or e), wherein the sensor comprises one of a: a pressure sensor, an ultrasound transducer, a flow velocity sensor, a spectral sensor, a chemical sensor.
- 20 g) A sequence of sensor arrangements comprising two sensor arrangements according to any of d) to f), being said first sensor arrangement and second sensor arrangement, wherein the second terminal structure of the first sensor arrangement is electrically connected to the first terminal structure of the second sensor arrangement.
- h) The sequence of sensor arrangements according to g), wherein the first and
25 second sensors are of different type.
- i) An elongate device comprising a sequence of sensor arrangements according to g) or h), wherein the first and second sensor arrangements are arranged along the length of the elongate device.
- ii) The elongate device of claim i), further comprising electrical conductors
30 electrically connected to the first terminal structure of the first sensor arrangement, for providing the measurement signals to a back-end system.
- iii) The elongate device of i) or ii), further comprising an inner core, a support structure for the first and second sensor arrangements, and an outer tube comprising openings

to expose the sensors of the first and second sensor arrangements to the surroundings of the elongate device.

iv) The elongate device of any of i) to iii), wherein the elongate device is a medical device.

5 j) The elongate device of iv), wherein the medical device is an intravascular device.

k) The elongate device of claim j), wherein the intravascular device is a guidewire with an outer diameter of less than 1 mm.

m) A system comprising:

10 an elongate device of any of i) to k);

a back-end system connected to the elongate device, wherein the system is configured to identify whether measurement signals originate from the first or the second sensor.

In all embodiments where applicable, the first sensor and/or the second sensor may comprise one or more of:

a pressure transducer (e.g. capacitive, resistive, optic);

an ultrasound transducer;

a flow transducer (e.g. Doppler, thermo-electric);

20 spectral sensors (e.g. for tissue characterization, sensing temperature, pH, oxygen, blood gas or CO₂);

chemical sensors / biosensors (e.g. for sensing biomolecules or ionic strength);

physical sensors (e.g. contact sensing, voltage).

The embodiments provide a set of sensors on a device such as guidewire or catheter. As a minimum there are two sensors, but there may be many more in an in-line chain. The intermediate sensor or sensors (i.e. those other than the last one at the distal end) are of the design as described above and thus provide a pass through function to be implemented for sensor signals received from the interconnection wire or wires at the distal side. In this way, the intermediate sensors avoid the need for physical wires to bypass one sensor to reach the next. Instead, the proximal and distal wires connect to the connection circuit.

The arrangement may comprise a device which comprises an inner core, a support part for each sensor and an outer tube. The outer tube for example has a sensor opening, and the opening is partially filled with a seal to cover the wire connections.

A device as guidewire for example has a diameter less than 1 mm or a catheter has a diameter less than 5 mm.

These and other aspects of the invention will be apparent from and elucidated with reference to the embodiment(s) described hereinafter.

5

BRIEF DESCRIPTION OF THE DRAWINGS

Examples of the invention will now be described in detail with reference to the accompanying drawings, in which:

10 Figure 1 shows first example of a sensor arrangement for mounting along a guidewire or catheter;

Figure 2 shows a second example of a sensor arrangement;

Figure 3 shows a third example of a sensor arrangement;

15 Figure 4 shows a guidewire arrangement, comprising a guidewire, a first sensor arrangement and a second sensor arrangement mounted at different positions along the guidewire; and

Figure 5 shows how a sensor arrangement, such as of the type shown in Figure 2, is integrated into a guidewire.

DETAILED DESCRIPTION OF THE EMBODIMENTS

20 The invention will be described with reference to the Figures.

It should be understood that the detailed description and specific examples, while indicating exemplary embodiments of the apparatus, systems and methods, are intended for purposes of illustration only and are not intended to limit the scope of the invention. These and other features, aspects, and advantages of the apparatus, systems and 25 methods of the present invention will become better understood from the following description, appended claims, and accompanying drawings. It should be understood that the Figures are merely schematic and are not drawn to scale. It should also be understood that the same reference numerals are used throughout the Figures to indicate the same or similar parts.

30 The invention provides a sensor connection arrangement for mounting along a guidewire or catheter. The sensor connection arrangement together with an associated sensor defines a sensor arrangement. The sensor arrangement is for positioning along a line of sensor arrangements and has terminal blocks at a proximal side and distal side, each for connection to one or more wires, such as a pair of wires. A connection circuit controls the

coupling of sensor signals to the proximal wires (and hence also to the distal wires, since they are connected to each other in the form of a bus) and the coupling of the distal wires to the proximal wires. In this way, a bypass function is implemented through the connection circuit, which avoids the need for physical wires of a distal sensor arrangement to bypass the sensor arrangement itself.

Note that "proximal" is used to indicate an end of the catheter or guidewire outside the body and "distal" is used to indicate a most inserted tip end of the catheter or guidewire.

The invention will be described below in connection with a guidewire implementation, but the same concepts may be applied to catheter sensors.

Figure 1 shows a first example of a sensor arrangement 10 for mounting along a guidewire (or catheter). It may be considered to comprise the combination of a sensor connection arrangement and the sensor itself. It shows as separate images the sensor arrangement 10 with associated wiring connections, a separate guidewire 12, and the combination of the guidewire and the sensor arrangement.

The sensor arrangement 10 comprises a sensor 14, a first terminal block 16 at a proximal side of the sensor arrangement for connection to a pair of proximal wires 17 and a second terminal block 18 at a distal side of the sensor arrangement for connection to a pair of distal wires 19 for connecting to a further sensor arrangement at a more distal location along the guidewire 12. Thus, this example (and indeed all other examples described further below) is based on two wires connecting to the upstream and downstream sides of the sensor arrangement. However, for all examples, the same underlying concept may be applied to a single wire or to more than two wires on each side of the sensor arrangement.

A connection circuit 20, 22 is used to couple of sensor signals from the sensor 14 to the pair of proximal wires 17 and to couple the distal wires and the proximal wires so that second (and optionally further) sensor arrangement signals from the pair of distal wires 19 are combined with the local sensor arrangement signals. The part of the connection circuit which couples the proximal wires to the distal wires may simply be implemented as wire tracks. These wire tracks function as a power and a communications bus. However, the coupling of the pair of distal wires to the pair of proximal wires may be indirect, and be implemented through other circuit components such as ASICs.

The part 20 of the connection circuit which couples the (first) sensor signals to the proximal wires for example comprises a control circuit such as an ASIC which functions as a connection node for connecting to the bus. Thus, by means of the connection circuit, a

shared pair of wires 17 may be provided with signals from the sensor 14 and from the sensor of a sensor arrangement further downstream along the guidewire. There is effectively a common bus to which the sensor connect locally, and the bus lines pass through the sensor connection arrangement rather than passing around the sensor connection arrangement.

5 The terminal blocks 16, 18 each comprise a pair of wire connection terminals 24.

 The function of the ASIC 20 is to provide the sensor signal onto the lines 17 in such a way that they may be received at the back-end without interference between the sensor signals and with the origin of the sensor signals being identifiable. A serial protocol may be
10 used for this purpose. The sensors may function as slave devices, which respond to commands provided by the master device, namely the back-end system.

 One known protocol is for example the "1-Wire" (Trade Mark) serial protocol of Maxim Integrated. Each sensor then has a unique ID, and a single wire functions as the communication line as well as the power line (e.g. 2.8V to 5.25V). The other line functions
15 as a ground line. This system allows half-duplex bidirectional communication.

 An alternative approach is to use the two wires as one signal line and one power line. Other approaches may use a single wire (e.g. with local grounding at the sensor) or more than two wires.

 There are various suitable communications systems, generally known as one-
20 wire bus architectures. Thus, the encoding of sensor signals, with their respective ID, may be performed by any known mechanism. The use of sensor IDs enables multiplexing of the sensor signals as well enabling a master-slave protocol to be established. An example of a one-wire bus architecture is for example disclosed in US 5210846.

 There are various ways to implement the control circuit. It may for example be
25 implemented at only one of the terminal blocks 16, 18, in which case one of the terminal blocks only functions to provide an interconnection from the associated pair of wires to the other terminal block where the control circuit is implemented.

 In the example of Figure 1, the control circuit is instead implemented at both
30 terminal blocks. Thus, there is a proximal side connection circuit portion 20 and a distal side connection circuit portion 22. Each connection circuit portion and its associated terminal block are defined as a silicon application specific integrated circuit. The proximal side connection circuit portion may be considered to comprise the first terminal block and the distal side circuit portion 22 may be considered to comprise the second terminal block, because the terminal blocks are integrated parts of the circuit portions.

The proximal side connection circuit portion 20 performs the processing of the signals from the sensor 14 and provides these to the wires 17. It thus functions as a node controller along the bus defined by the wires 17 and 19. The distal side connection circuit portion 22 performs a function of interfacing to the wires 19.

5 The distal side connection circuit portion 22 is optional in that only one interface to each sensor is needed. Having circuitry on both sides may be of benefit to allow to connect more bondwires, or it may simplify the connection of wires.

In combination, the connection circuit portions thus implement a sensor interface function for the sensor 14 as well as a bypass function for sensor signals received
10 from a more distal part of the guidewire.

The signals received from wires 19 thus comprise bus signals which may include sensor signals from a single downstream (i.e. more distal) sensor, or from a set of downstream sensors.

A conductor foil 26 is provided between the proximal side and distal side
15 connection circuit portions 20, 22. The purpose of the conductor foil is to provide electrical interconnection tracks from the distal side connection circuit portion 22 to the proximal side connection circuit portion 22. In particular, interconnections are formed between the terminals of the block 16 and the terminals of the block 18.

20 These interconnections may comprises direct wire connections between pairs of terminals, or they may comprise connections which are implemented through the circuit portions. In the latter case, the circuit portions perform an interface function between the conductor foil tracks and the terminals blocks.

The sensor is for example connected to the flexible foil 26 at each side by flexible hinges. The sensor 14 may be connected on the foil 26 or it may be suspended
25 between opposite conductor foil portions (i.e. it is mounted within the overall conductor foil).

In this way, the same sensor arrangement design may be used at multiple locations along the guidewire.

Figure 2 shows a second example of a sensor arrangement 10 again
30 comprising a second connection arrangement and the sensor itself. This design has foldable terminal blocks. Figure 2 shows as separate images the sensor arrangement in an unfolded state without wire connections, the sensor arrangement folded and showing one face, the sensor arrangement folded and showing an opposite face, and the folded arrangement with wire connections.

As for the example of Figure 1, there is a proximal side connection circuit portion 20 and a distal side connection circuit portion 22 with a (first) conductor foil 26 between them. There is a second conductor foil 30 which extends in the proximal direction from the proximal side circuit portion 20 and a third conductor foil 32 extending in the distal direction from the distal side circuit portion 22. These two extra foils are foldable to enable a more compact sensor design.

The sensor arrangement is manufactured in the flat state shown and is then folded before the wires are attached.

The sensor 14 is connected to the second conductor foil 30 (at the opposite end to the circuit portion 20) and the second terminal block 18 is connected to the third conductor foil 32 (at the opposite end to the circuit portion 22). The first terminal block 16 is at the end of the sensor 14, and in the flat configuration, it is at the distal end of the sensor.

The second conductor foil 30 can be bent around to locate the sensor 14 beneath and against the first conductor foil 26. The sensor 14 comprises the first terminal block and when the second conductor foil 30 is bent over, the first terminal block 16 sits beneath and against the proximal side connection circuit portion 20. Similarly, when the conductor foil 32 is bent over, the second terminal block 18 is beneath and against the distal side connection circuit portion.

The folding of the two conductor foils 30,32 places the terminal blocks 16, 18 at the remote ends of the folded arrangement, and electrical connections to the wires 17, 19 can subsequently be made.

Figure 3 shows a third example of a sensor arrangement 10. This design also has foldable terminal blocks but these are separate to the sensor 14, which is then a separate modular component. Thus, there is a separate sensor connection arrangement in the form of a cradle and a sensor received by the cradle.

Figure 3 shows as separate images the sensor 14, the cradle (i.e. the sensor connection arrangement), the sensor mounted in the cradle without wire connections, the sensor mounted in the cradle with wire connections and the sensor mounted in the cradle with sealed wire connections.

The cradle part comprises a proximal side connection circuit portion 20 and a distal side connection circuit portion 22 and a (first) conductor foil 26 between them.

As in the example of Figure 3, there is a second conductor foil 30 extending in the proximal direction from the proximal side circuit portion 20 but in this example the first terminal block 16 (separate to the sensor) is connected to the second conductor foil 30. The

second conductor foil 30 is bendable such as to locate the first terminal block 16 against the proximal side connection circuit portion 20.

As in Figure 3, a third conductor foil 32 extends in the distal direction from the distal side circuit portion 22) and the second terminal block 18 is connected to the third conductor foil 32. The third conductor foil 32 is bendable such as to locate the second terminal block 18 against and beneath the distal side connection circuit portion 22.

The cradle is formed in a flat configuration and then folded into the shape shown.

The sensor 14 is mounted on the first conductor foil 26 between the first and second terminal blocks. The sensor has a sensor terminal block 40 so that there are three terminal blocks.

The ends of the proximal wires 17 then connect both to the first terminal block 16 and to the sensor terminal block 40, since these two terminal blocks are aligned. The terminal connections are then protected by a seal 42.

In all examples above, the sensor 14 may comprise one or more of:
a pressure transducer (e.g. capacitive, resistive, optic);
an ultrasound transducer;
a flow transducer (e.g. Doppler, thermo-electric);
spectral sensors (e.g. for tissue characterization, sensing temperature, pH, oxygen, blood gas or CO₂);
chemical sensors / biosensors (e.g. for sensing biomolecules or ionic strength);
physical sensors (e.g. contact sensing, voltage).

As explained above, the sensor design is for mounting at an intermediate position along a line of sensors.

Figure 4 shows a guidewire arrangement, comprising a guidewire 12, a first sensor arrangement 50 and a second sensor arrangement 52 mounted at different positions along the guidewire 12, with the second sensor arrangement 52 nearer a distal tip of the guidewire than the first sensor arrangement 50.

The pair of proximal wires 17 connect to a proximal side of the first sensor arrangement 50 and a pair of interconnecting wires 19 (i.e. which are distal wires for the sensor arrangement 50) connect between the distal side of the first sensor arrangement 50 and a proximal side of the second sensor arrangement 52.

At least the first sensor arrangement 50 is as described above. The second sensor arrangement may be of the same design. However, no connection is then needed to the

distal side (second) terminal block of that sensor, since there are no more distal sensors to connect to the bus.

Figure 5 shows how a sensor arrangement, such as of the type shown in Figure 2, is integrated into a guidewire 12.

5 The guidewire comprises an inner core 60, a support part 62 for each sensor and an outer tube 64. The support part is for example made by an additive manufacturing process applied to the inner core. There is also a shaping ribbon 65 which is a metal strip which can be bent into a desired curve. This may for example be used for navigation of a guidewire through an artery.

10 Figure 5 shows as separate images the inner core and support part alone, the full guidewire components of inner core, support part and outer tube, the guidewire with sensor installed and with one set of connected wires, the guidewire with sensor installed and with both sets of connected wires, and the guidewire with sensor installed with the connected wires sealed.

15 The outer tube 64 has a sensor opening 66. When the sensor is installed, the sensor function takes place through the opening. The wires are connected by soldering or welding through the opening and the opening is the partially filled with a seal 68 to cover the wire connections.

20 The invention is of interest for miniature sensors. A guidewire for example has a diameter less than 1 mm and a catheter for example has a diameter less than 5 mm. A typical example is 360 micrometers.

By way of example, the folded arrangement in Figure 2 may have:

a length in the range 0.5 to 1.5 mm;

a width in the range 150 to 250 micrometers; and ;

25 a thickness in the range 30 to 50 micrometers;

a pitch between the two terminals for connection to the wire pairs of 20 to 100 micrometers, such as 60 micrometers.

30 Other variations to the disclosed embodiments can be understood and effected by those skilled in the art in practicing the claimed invention, from a study of the drawings, the disclosure, and the appended claims. In the claims, the word "comprising" does not exclude other elements or steps, and the indefinite article "a" or "an" does not exclude a plurality. The mere fact that certain measures are recited in mutually different dependent claims does not indicate that a combination of these measures cannot be used to advantage. Any reference signs in the claims should not be construed as limiting the scope.

CLAIMS:

1. A sensor connection arrangement (10) for an elongate device, comprising:
a foil (26) configured for conduction of electrical signals, the foil comprising two terminal segments at two opposite sides of a central segment, wherein at least a portion of each of the terminal segments is bendable for allowing folding of the terminal segments of
5 the foil over the central segment of the foil;
two terminal structures (16,18) attached and electrically connected to the respective terminal segments of the foil (20,22),
wherein the terminal structures are configured to at least partially overlap with the central segment of the foil when a sensor (14) is electrically connected to one of the
10 terminal structures.
2. The sensor connection arrangement of claim 1, wherein the terminal structures and the foil form a cradle, configured to receive the sensor.
- 15 3. The sensor arrangement of claim 1 or 2, further comprising two ASIC connection structures (20,22) attached and electrically connected to the foil, and wherein the two terminal structures overlap with the respective ASIC connection structures when the sensor (14) is electrically connected to one of the terminal structures.
- 20 4. A sensor arrangement comprising:
a sensor connection arrangement of any of the preceding claims;
the sensor, electrically coupled to a first of the terminal structures;
wherein the second of the terminal structures is configured for connection to a further sensor.
- 25 5. The sensor arrangement of claim 4, wherein the connection of the sensor to the respective terminal structure is arranged on the same side of the sensor that is configured for providing measurement signals of the surroundings.

6. The sensor arrangement of claim 4 or 5, wherein the sensor comprises one of a: a pressure sensor, an ultrasound transducer, a flow velocity sensor, a spectral sensor, a chemical sensor.
- 5 7. A sequence of sensor arrangements comprising two sensor arrangements according to any of the claims 4 to 6, being said first sensor arrangement and second sensor arrangement, wherein the second terminal structure of the first sensor arrangement is electrically connected to the first terminal structure of the second sensor arrangement.
- 10 8. The sequence of sensor arrangements according to claim 7, wherein the first and second sensors are of different type.
9. An elongate device comprising a sequence of sensor arrangements according to claim 7 or 8, wherein the first and second sensor arrangements are arranged along the
15 length of the elongate device.
10. The elongate device of claim 9, further comprising electrical conductors (17) electrically connected to the first terminal structure of the first sensor arrangement, for providing the measurement signals to a back-end system.
20
11. The elongate device of claim 9 or 10, further comprising an inner core (60), a support structure (62) for the first and second sensor arrangements, and an outer tube (64) comprising openings to expose the sensors of the first and second sensor arrangements to the surroundings of the elongate device.
25
12. The elongate device of any of the claims 9 to 11, wherein the elongate device is a medical device.
13. The elongate device of claim 12, wherein the medical device is an
30 intravascular device.
14. The elongate device of claim 13, wherein the intravascular device is a guidewire with an outer diameter of less than 1 mm.

15. A system comprising:
an elongate device of any of the claims 9 to 14;
a back-end system connected to the elongate device, wherein the system is
configured to identify whether measurement signals originate from the first or the second

5 sensor.

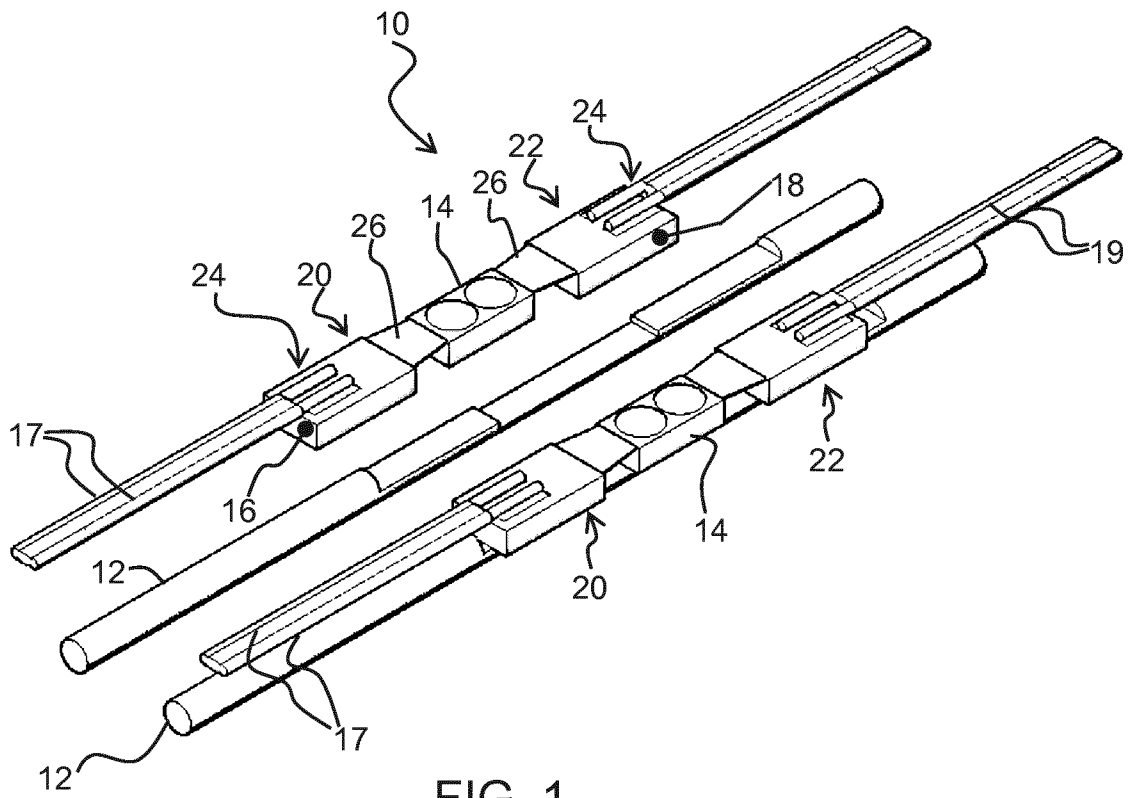

FIG. 1

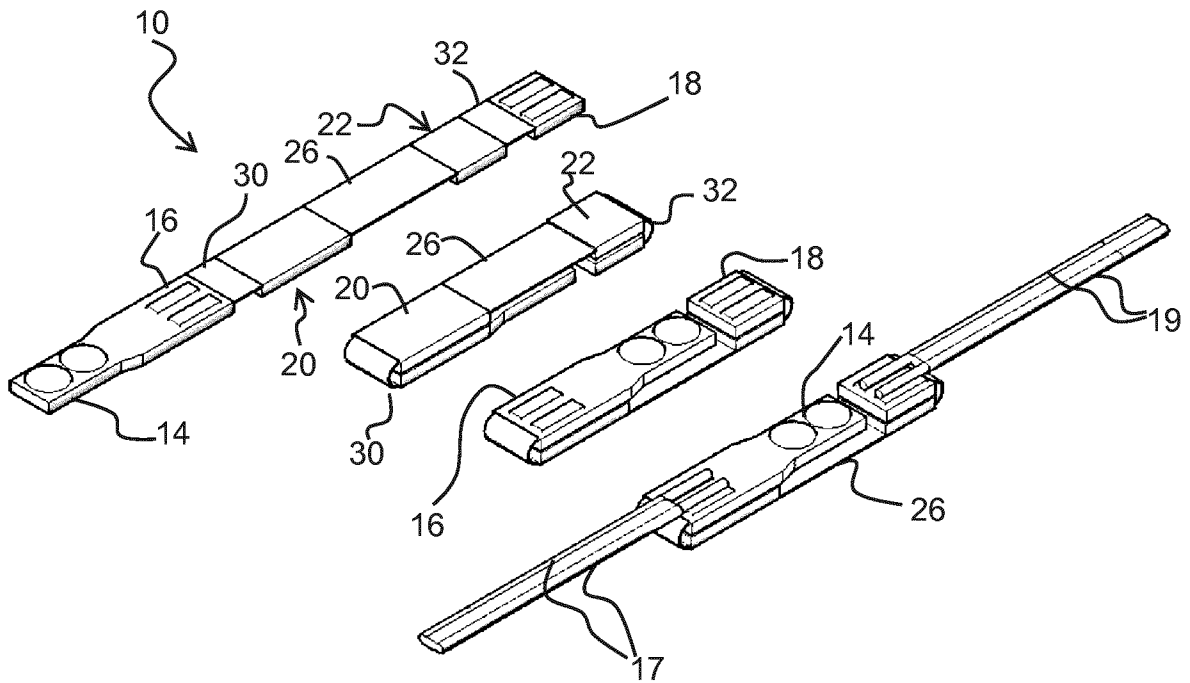

FIG. 2

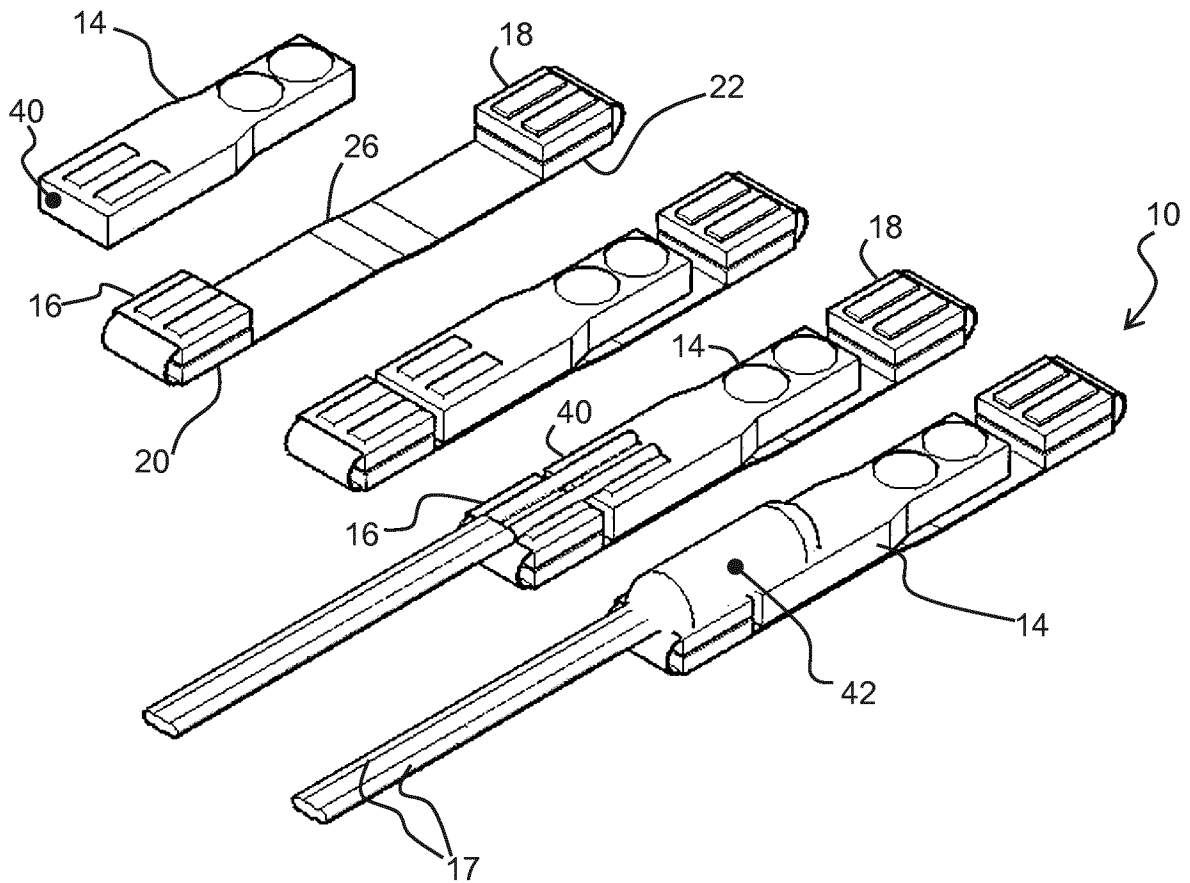

FIG. 3

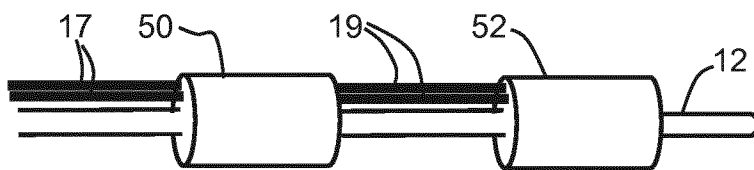

FIG. 4

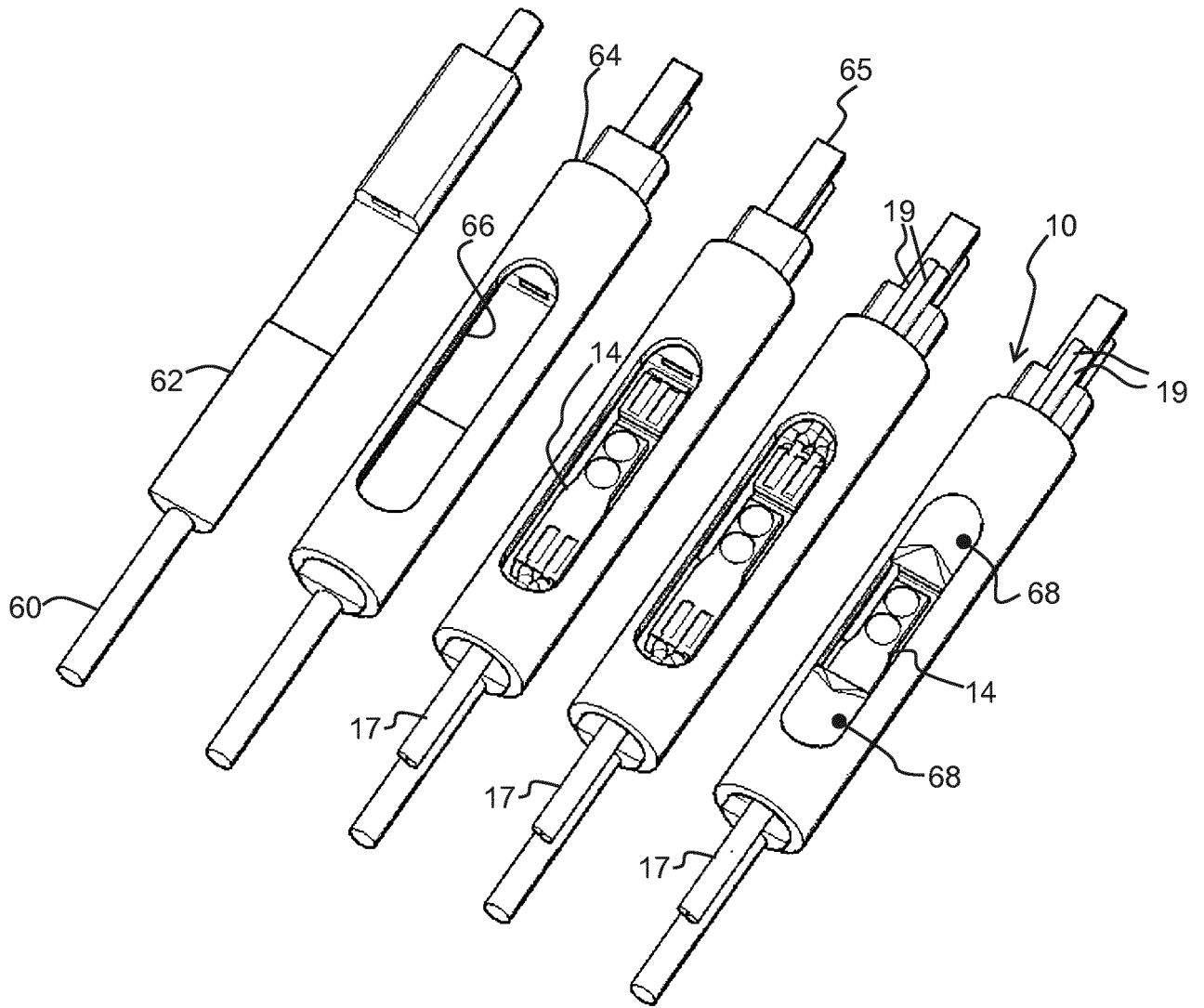

FIG. 5

INTERNATIONAL SEARCH REPORT

International application No
PCT/EP2019/053936

A. CLASSIFICATION OF SUBJECT MATTER
INV. A61B5/00 A61B5/0215
ADD.
According to International Patent Classification (IPC) or to both national classification and IPC

B. FIELDS SEARCHED
Minimum documentation searched (classification system followed by classification symbols)
A61B

Documentation searched other than minimum documentation to the extent that such documents are included in the fields searched

Electronic data base consulted during the international search (name of data base and, where practicable, search terms used)
EPO-Internal, WPI Data, BIOSIS, EMBASE

C. DOCUMENTS CONSIDERED TO BE RELEVANT

Category*	Citation of document, with indication, where appropriate, of the relevant passages	Relevant to claim No.
Y	US 2005/268724 A1 (TENERZ LARS [SE]) 8 December 2005 (2005-12-08)	9-15
A	figure 3	1-8
A	----- US 2005/148832 A1 (REGHABI BAHAR [US] ET AL) 7 July 2005 (2005-07-07) paragraphs [0038], [0043], [0044]; figure 1	1-15
A	----- EP 2 829 227 A1 (BIOSENSE WEBSTER ISRAEL LTD [IL]) 28 January 2015 (2015-01-28) figures 3A,B	1-15
A	----- US 2005/054905 A1 (CORL PAUL D [US] ET AL) 10 March 2005 (2005-03-10) figure 6A	1-15
	----- -/--	

Further documents are listed in the continuation of Box C.

See patent family annex.

* Special categories of cited documents :

"A" document defining the general state of the art which is not considered to be of particular relevance

"E" earlier application or patent but published on or after the international filing date

"L" document which may throw doubts on priority claim(s) or which is cited to establish the publication date of another citation or other special reason (as specified)

"O" document referring to an oral disclosure, use, exhibition or other means

"P" document published prior to the international filing date but later than the priority date claimed

"T" later document published after the international filing date or priority date and not in conflict with the application but cited to understand the principle or theory underlying the invention

"X" document of particular relevance; the claimed invention cannot be considered novel or cannot be considered to involve an inventive step when the document is taken alone

"Y" document of particular relevance; the claimed invention cannot be considered to involve an inventive step when the document is combined with one or more other such documents, such combination being obvious to a person skilled in the art

"&" document member of the same patent family

Date of the actual completion of the international search 31 May 2019	Date of mailing of the international search report 17/06/2019
--	--

Name and mailing address of the ISA/ European Patent Office, P.B. 5818 Patentlaan 2 NL - 2280 HV Rijswijk Tel. (+31-70) 340-2040, Fax: (+31-70) 340-3016	Authorized officer Clevorn, Jens
--	---

INTERNATIONAL SEARCH REPORT

International application No
PCT/EP2019/053936

C(Continuation). DOCUMENTS CONSIDERED TO BE RELEVANT		
Category*	Citation of document, with indication, where appropriate, of the relevant passages	Relevant to claim No.
A	US 2015/342530 A1 (DEKKER RONALD [NL] ET AL) 3 December 2015 (2015-12-03) paragraphs [0053] - [0055]; figure 5B -----	1-15
A	US 2017/112405 A1 (STERRETT TERRY L [US] ET AL) 27 April 2017 (2017-04-27) paragraph [0149]; figure 13B -----	1-15
X	US 2017/127985 A1 (THOMPSON CHASE A [US] ET AL) 11 May 2017 (2017-05-11) figures 25D, 28 -----	1-8
Y		9-15
X	US 2017/202495 A1 (DALENE MATTHEW [US]) 20 July 2017 (2017-07-20) figure 6A -----	1-8

INTERNATIONAL SEARCH REPORT

Information on patent family members

International application No

PCT/EP2019/053936

Patent document cited in search report	Publication date	Patent family member(s)	Publication date
US 2005268724	A1	08-12-2005	AT 453360 T 15-01-2010
			EP 1695659 A1 30-08-2006
			ES 2337921 T3 30-04-2010
			JP 2006231059 A 07-09-2006
			US 2005268724 A1 08-12-2005
			US 2006207335 A1 21-09-2006

US 2005148832	A1	07-07-2005	CA 2548223 A1 21-07-2005
			EP 1699350 A1 13-09-2006
			JP 4688820 B2 25-05-2011
			JP 2007516782 A 28-06-2007
			US 2005148832 A1 07-07-2005
			WO 2005065537 A1 21-07-2005

EP 2829227	A1	28-01-2015	AU 2014203840 A1 05-02-2015
			CA 2856853 A1 19-01-2015
			CN 104299396 A 21-01-2015
			EP 2829227 A1 28-01-2015
			JP 2015020073 A 02-02-2015
			US 2015023374 A1 22-01-2015

US 2005054905	A1	10-03-2005	CA 2538122 A1 17-03-2005
			CN 101052343 A 10-10-2007
			EP 1662977 A2 07-06-2006
			HK 1113735 A1 13-08-2010
			JP 2007516005 A 21-06-2007
			US 2005054905 A1 10-03-2005
			US 2008125632 A1 29-05-2008
			US 2008125633 A1 29-05-2008
			US 2008125635 A1 29-05-2008
			US 2008139909 A1 12-06-2008
			US 2008146903 A1 19-06-2008
			WO 2005023097 A2 17-03-2005

US 2015342530	A1	03-12-2015	CN 104519804 A 15-04-2015
			EP 2866673 A2 06-05-2015
			JP 6198822 B2 20-09-2017
			JP 2015524285 A 24-08-2015
			US 2015342530 A1 03-12-2015
			WO 2014006536 A2 09-01-2014

US 2017112405	A1	27-04-2017	CN 108289709 A 17-07-2018
			EP 3340916 A1 04-07-2018
			JP 6445742 B1 26-12-2018
			JP 2019063546 A 25-04-2019
			JP 2019501679 A 24-01-2019
			US 2017112405 A1 27-04-2017
WO 2017070559 A1 27-04-2017			

US 2017127985	A1	11-05-2017	NONE

US 2017202495	A1	20-07-2017	DE 112017000403 T5 25-10-2018
			JP 2019509774 A 11-04-2019
			US 2017202495 A1 20-07-2017
			WO 2017124069 A1 20-07-2017
