

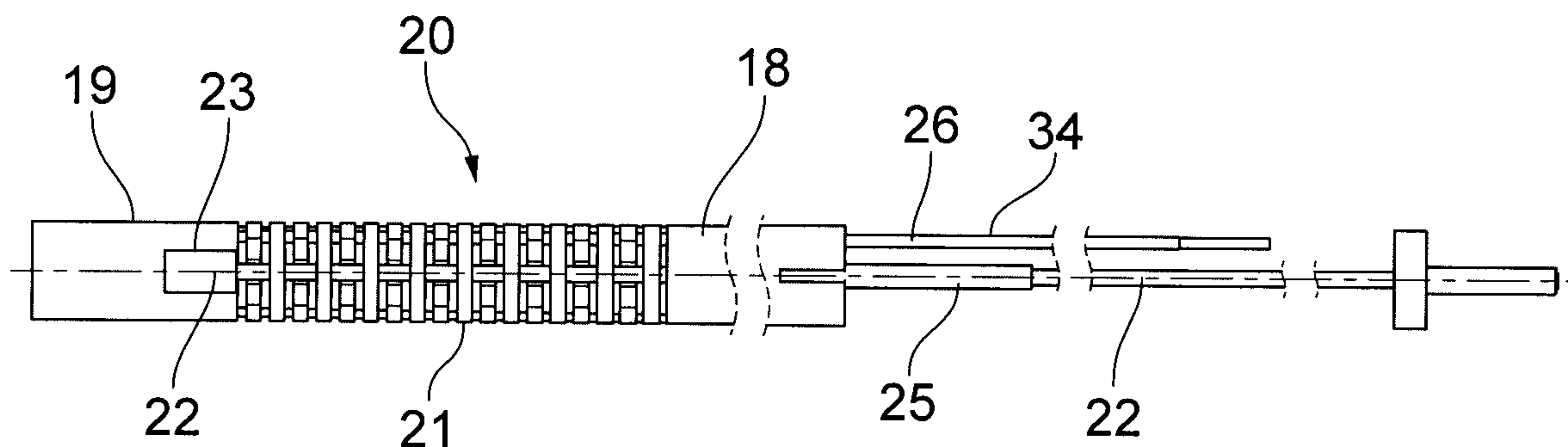

(22) Date de dépôt/Filing Date: 2013/12/10
(41) Mise à la disp. pub./Open to Public Insp.: 2014/06/14
(30) Priorité/Priority: 2012/12/14 (GB1222623.9)

(51) Cl.Int./Int.Cl. *A61B 18/00* (2006.01),
A61B 18/14 (2006.01)
(71) Demandeur/Applicant:
GYRUS MEDICAL LIMITED, GB
(72) Inventeurs/Inventors:
MORRIS, DAVID, GB;
MURPHY, LOUISE, GB;
HOODLESS, RICHARD JOHN, GB;
KEOGH, RICHARD JOHN, GB
(74) Agent: NORTON ROSE FULBRIGHT CANADA
LLP/S.E.N.C.R.L., S.R.L.

(54) Titre : INSTRUMENT ELECTROCHIRURGICAL ET MANCHE
(54) Title: ELECTROSURGICAL INSTRUMENT & SHAFT



(57) **Abrégé/Abstract:**

A shaft (14) is provided for a flexible endoscopic instrument, the shaft including at least one flexible section (20) along the length of the shaft, a distal section (19) located distally of the flexible section, and a proximal section (18) located proximally of the flexible section (20). The distal section (19) includes a connection to a shaft electrode, while the proximal section (18) includes at least one connection for connecting the shaft (14) to an electro-surgical generator (1). The shaft also includes a bypass lead (26) in electrical connection with both the distal section (19) and the proximal section (18). The bypass lead (26) ensures that the distal section (19) and the proximal section (18) remain at the same potential even if the electrical pathway via the flexible section (20) becomes degraded by wear or damage thereto.



ABSTRACT

A shaft (14) is provided for a flexible endoscopic instrument, the shaft including at least one flexible section (20) along the length of the shaft, a distal section (19) located 5 distally of the flexible section, and a proximal section (18) located proximally of the flexible section (20). The distal section (19) includes a connection to a shaft electrode, while the proximal section (18) includes at least one connection for connecting the shaft (14) to an electrosurgical generator (1). The shaft also includes a bypass lead (26) in electrical connection with both the distal section (19) and the proximal section (18). 10 The bypass lead (26) ensures that the distal section (19) and the proximal section (18) remain at the same potential even if the electrical pathway via the flexible section (20) becomes degraded by wear or damage thereto.

ELECTROSURGICAL INSTRUMENT & SHAFT

Technical Field

This invention relates to a flexible electrosurgical instrument and to a flexible shaft for such an electrosurgical instrument. Such systems are commonly used for the vaporisation and/or coagulation of tissue in surgical intervention, most commonly in
5 “keyhole” or minimally invasive surgery, otherwise known as “endoscopic” surgery.

Background to the Invention and Prior Art

One specialist type of electrosurgical instrument has one or more electrosurgical
10 electrodes at the distal end of a flexible shaft. Such an instrument is particularly suited to the treatment of joints, particularly the hip joint, as the articulation of the shaft allows the electrodes to reach otherwise inaccessible areas of the joint. US patent 6,283,960 is one example of this type of instrument.

The shaft typically contains at least one section with greater flexibility than
15 other sections of the shaft. This section of the shaft is normally manufactured to have lower bending stiffness, or with a “weak section”, with less material being present so as to provide greater flexibility. Typically material is removed to form slots, grooves or other cut-outs, to enable the shaft to flex more easily at this section of the shaft.

Summary of the Invention

Embodiments of the present invention provide an improvement to the above described type of instrument.

Accordingly, from one aspect of the invention there is provided a shaft for a flexible endoscopic instrument, the shaft having a longitudinal axis defining a proximal
25 and a distal direction, and including

- a) at least one flexible section along the length of the shaft, the flexible section having a greater flexibility than at least one other section of the shaft,
- b) a distal section located distally of the flexible section, the distal section including a connection to a shaft electrode,
- 30 c) a proximal section located proximally of the flexible section, the proximal section including at least one connection for connecting the shaft to an electrosurgical generator, and

d) a bypass lead including a first connection forming an electrical connection with the distal section and a second connection forming an electrical connection with the proximal section.

Typically, the at least one flexible section includes one or more cut-out portions,
5 such as a plurality of slots cut into the shaft. The shaft is typically a tubular shaft.

It should be remembered that the shaft provides an electrical connection between the shaft electrode and the electrosurgical generator. However, the flexible section is also subjected to repeated flexing, and such repeated flexing can cause cracks to form which interfere with the passage of electric current along the shaft. There is a
10 risk that these cracks can form to such an extent that areas of the shaft become electrically isolated one from another, such that they are at a different electric potential one from another. In extreme cases, where different areas of the shaft are at different potentials, arcing can occur between different sections of the shaft, causing damage to the shaft and potentially to the patient. The provision of the bypass lead ensures that
15 each end of the shaft remains electrically connected to the other end and at the same potential, regardless of whether cracks have formed therebetween. The bypass lead prevents arcing from occurring between different sections of the shaft, even if cracks have formed in some sections thereof.

In one convenient arrangement, the bypass lead is directly connected to the
20 distal section of the shaft, typically by being welded to the distal section of the shaft. Similarly, the bypass lead is conveniently directly connected to the proximal section of the shaft, again typically by welding. However, in an alternative arrangement, the bypass lead is indirectly connected to the proximal section of the shaft. In this arrangement the bypass lead is not connected directly to the proximal section of the
25 shaft, but to some other component which is itself in electrical connection to the proximal section of the shaft. Conveniently, the at least one connection for connecting the shaft to an electrosurgical generator comprises a generator cord, and the bypass lead is connected to the generator cord. Regardless of whether they are directly connected, the bypass lead electrically connects the proximal and distal sections one to the other,
30 such that they are always at the same electric potential. In this way, there is no possibility of unwanted arcing occurring between sections of the shaft, even if cracks or other imperfections are introduced due to the repeated flexing of the shaft.

The shaft electrode is conveniently constituted by an exposed surface of the

shaft. In this way, the shaft itself forms the electrode, which can either be the tissue treatment electrode in a monopolar system, or one of a pair of electrodes (typically the return electrode) in a bipolar system. Alternatively, the shaft can provide the electrical connection for a separate tissue treatment or return electrode, which is electrically
5 connected to the shaft by means of a connection such as a lead or clip arrangement. Whichever arrangement is employed, the shaft provides the electrical pathway for the current to reach the electrode (or return to the generator therefrom), and the bypass lead ensures a good connection is maintained.

From another aspect there is further provided an electrosurgical instrument
10 comprising

a) a shaft having a longitudinal axis defining a proximal and a distal direction, the shaft including at least one flexible section along the length of the shaft, the flexible section having a greater flexibility than at least one other section of the shaft, the shaft also including a distal section located distally of the flexible section, and a proximal
15 section located proximally of the flexible section,

b) a shaft electrode electrically connected to the distal section of the shaft,

c) an electrical connection for connecting the proximal section of the shaft to an electrosurgical generator, and

d) an actuation mechanism for causing the shaft to articulate at the at least one
20 flexible section,

characterised in that the shaft also includes a bypass lead including a first connection forming an electrical connection with the distal section and a second connection forming an electrical connection with the proximal section.

As previously indicated, the shaft electrode is conceivably constituted by an
25 exposed surface of the shaft. Alternatively the instrument also includes a tissue-treatment electrode, the shaft electrode constituting a return electrode for the tissue-treatment electrode.

Brief Description of the Drawings

30 Embodiments of the invention will now be further described, by way of example only, with reference to the accompanying drawings, in which:

Figure 1 is a schematic diagram of an electrosurgical system in accordance with an embodiment of the present invention,

Figure 2 is a side view of the tip of the electrosurgical instrument forming part of the system of Figure 1,

Figure 3 is a cut-away plan view of the shaft of the instrument of Figure 2,

Figure 4 is a cut-away side view of the shaft of Figure 3,

5 Figure 5 is a perspective end view of the shaft of Figure 3,

Figure 6 is a cut-away perspective view, with hidden detail, of a part of the instrument of Figure 2, and

Figure 7 is a cut-away perspective view similar to Figure 6, but with the handle moulding of the instrument removed for clarity.

10

Description of the Embodiments

Referring to the drawings, Figure 1 shows an electrosurgical apparatus including a generator 1 having an output socket 2 providing a radio frequency (RF) output, via a connection cord 4, for an electrosurgical instrument 3. Activation of the generator 1 may be performed from the instrument 3 via a handswitch (not shown) on the instrument 3, or by means of a footswitch unit 5 connected separately to the rear of the generator 1 by a footswitch connection cord 6. In the illustrated embodiment, the footswitch unit 5 has two footswitches 7 and 8 for selecting a desiccation mode and a vaporisation mode of the generator 1 respectively. The generator front panel has push buttons 9 and 10 for respectively setting desiccation and vaporisation power levels, which are indicated in a display 11. Push buttons 12 are provided as an alternative means for selection between the desiccation and vaporisation modes.

The electrosurgical instrument 3 comprises a housing 13 with an elongate shaft 14, and one or more tissue treatment electrodes at the distal end of the shaft, as will be described below. A movable handle 15 associated with the housing can be actuated to cause the shaft to bend. This instrument is particularly suited to the treatment of the hip joint, where a relatively long shaft with articulation capability is needed to access the area to be treated.

Figure 2 shows the instrument 3 in more detail, and the housing 13, the handle 15 and the elongate shaft 14. The connection cord 4 is shown emerging from the proximal end of the housing, as is a suction tube 16 which can be connected to a source of suction (not shown) in order to deliver suction to the shaft 14 and hence the tip 17 of the instrument.

30

Figures 3 & 4 show the shaft 14 of the instrument 3 as comprising a proximal section 18, a distal section 19, and a flexible section 20 therebetween. The flexible section 20 is constituted by a plurality of slots 21 extending partially around the circumference of the shaft in order to impart flexibility thereto. A nitinol (a nickel – titanium alloy where the two metals are present in substantially equal atomic percentages) deflection wire 22 extends along the shaft 14 and is encased in a crimped casing 23 towards its distal end, as further shown in Figure 5. The casing 23 is welded to the distal section 19 as shown at 24, and the shaft 14 is surrounded with a metallic shroud 33. The exterior of the shaft 14 is covered with an insulating sheath 35. The deflection wire 22 is also encased in a guide tube 25 at its proximal end, and continues into the housing such that a longitudinal movement of the deflection wire 22 causes a corresponding deflection of the shaft 14.

Also shown in Figure 3, 4 & 5 is an electrical bypass wire 26, which runs along the shaft 14 connecting the distal section 19 to the proximal section 18. The bypass wire is covered with an insulating sheath 34, except for its ends, which are exposed. The distal end of the bypass wire 26 is welded to the distal section 19 as shown at 27. The proximal end of the bypass wire extends past the flexible section 20 and the proximal section 18 to emerge from the proximal end of the shaft.

The proximal connection of the bypass wire 26 is shown in Figures 6 & 7. A metallic clip 28 is fitted over the proximal section 18 of the shaft 14, and a wire 29 connects the clip 28 to a Siamese connector 30. The Siamese connector 30 connects the wire 29, and hence the shaft 14, to the bypass wire 26. In this way, the proximal section of the bypass wire 26 is electrically connected to the proximal section 18 of the shaft, while the distal section of the bypass wire is welded to the distal section 19 of the shaft as previously described. Thus, the bypass wire is in electrical connection with each end of the shaft, and ensures that they remain at the same electric potential, regardless of the electrical connection along the shaft itself.

A lead 31 connects the shaft 14 to the cord 4 leading to the generator 1, such that the shaft itself (or a separate electrode (not shown) attached to the shaft) acts as an electrode in either a monopolar or bipolar electrode assembly. In a monopolar arrangement, the shaft (or the separate electrode) acts as the tissue-treatment electrode, while a patient return plate (not shown) acts as the return electrode. In a bipolar arrangement, as shown in Figure 6, a lead 32 running through the suction tube 16 forms

a connection between the generator 1 and an active tissue treatment electrode (not shown), while the shaft (or the separate electrode) acts as the return electrode. Whichever arrangement is employed, the electrode assembly can be used to treat tissue while the bypass wire 26 ensures that each end of the shaft remains at the same electric potential even if the direct path between the proximal and distal sections of the shaft becomes interrupted by cracks or other damage caused by the repeated flexing of the flexible section 20.

In use, the instrument 3 is manoeuvred into position adjacent tissue to be treated, using the deflection wire 22 to deflect the flexible section 20 of the shaft into a curved shape if required. The electrosurgical generator 1 is activated in order to supply RF energy to the electrode assembly at the tip 17 of the instrument, with the shaft 14 either forming an electrode at the tip of the instrument or acting as the electrical connection to such an electrode. The bypass wire 26 ensures that, even if electrical conductivity between the proximal section 18 and the distal section 19 of the shaft becomes degraded by wear or damage to the flexible section 20, all areas of the shaft remain at the same electric potential such that arcing does not occur across gaps that may have formed following cracking of material around the slots 21.

The instrument 3 is primarily designed to be operated in a conductive fluid such as saline, with the fluid completing the circuit between the electrodes. However, the instrument 3 can also be used as a dry-field instrument, in which case the user must ensure that the electrodes are placed in contact with the tissue to be treated. In this way, the current flows from the tissue treatment electrode, through the tissue, to the shaft 14 which acts as a return electrode.

Various modifications, whether by way of addition, deletion, or substitution may be made to the above described embodiment to provide further embodiments, any and all of which are intended to be encompassed by the appended claims.

CLAIMS

What is claimed is:

- 5 1. A shaft for a flexible endoscopic instrument, the shaft having a longitudinal axis defining a proximal and a distal direction, and including
- a) at least one flexible section along the length of the shaft, the flexible section having a greater flexibility than at least one other section of the shaft,
 - b) a distal section located distally of the flexible section, the distal section
10 including a connection to a shaft electrode,
 - c) a proximal section located proximally of the flexible section, the proximal section including at least one connection for connecting the shaft to an electrosurgical generator, and
 - d) a bypass lead including a first connection forming an electrical connection
15 with the distal section and a second connection forming an electrical connection with the proximal section.
2. A shaft according to claim 1, wherein the at least one flexible section includes one or more cut-out portions.
- 20 3. A shaft according to claim 2, wherein the one or more cut-out portions comprise a plurality of slots cut into the shaft.
4. A shaft according to any of claims 1 to 3, wherein the shaft is tubular.
- 25 5. A shaft according to any of claims 1 to 4, wherein the bypass lead is directly connected to the distal section of the shaft.
6. A shaft according to claim 5, wherein the bypass lead is welded to the distal
30 section of the shaft.
7. A shaft according to any preceding claim, wherein the bypass lead is directly connected to the proximal portion of the shaft.

8. A shaft according to claim 7, wherein the bypass lead is welded to the proximal portion of the shaft.

9. A shaft according to any of claims 1 to 6, wherein the bypass lead is indirectly connected to the proximal section of the shaft.

10. A shaft according to claim 9, wherein the at least one connection for connecting the shaft to an electrosurgical generator comprises a generator cord, and the bypass lead is connected to the generator cord.

10

11. A shaft according to any preceding claim, wherein the shaft electrode is constituted by an exposed surface of the shaft.

12. A shaft according to any preceding claim, wherein the shaft is provided with a tissue-treatment electrode, the shaft electrode constituting a return electrode for the tissue-treatment electrode.

13. An electrosurgical instrument comprising
a) a shaft having a longitudinal axis defining a proximal and a distal direction, the shaft including at least one flexible section along the length of the shaft, the flexible section having a greater flexibility than at least one other section of the shaft, the shaft also including a distal section located distally of the flexible section, and a proximal section located proximally of the flexible section,

b) a shaft electrode electrically connected to the distal section of the shaft,

25 c) an electrical connection for connecting the proximal section of the shaft to an electrosurgical generator, and

d) an actuation mechanism for causing the shaft to articulate at the at least one flexible section,

30 characterised in that the shaft also includes a bypass lead including a first connection forming an electrical connection with the distal section and a second connection forming an electrical connection with the proximal section.

14. An electrosurgical instrument according to claim 13, wherein the shaft

electrode is constituted by an exposed surface of the shaft.

15. An electrosurgical instrument according to claim 13 or claim 14, wherein the instrument also includes a tissue-treatment electrode, the shaft electrode
5 constituting a return electrode for the tissue-treatment electrode.

1/4

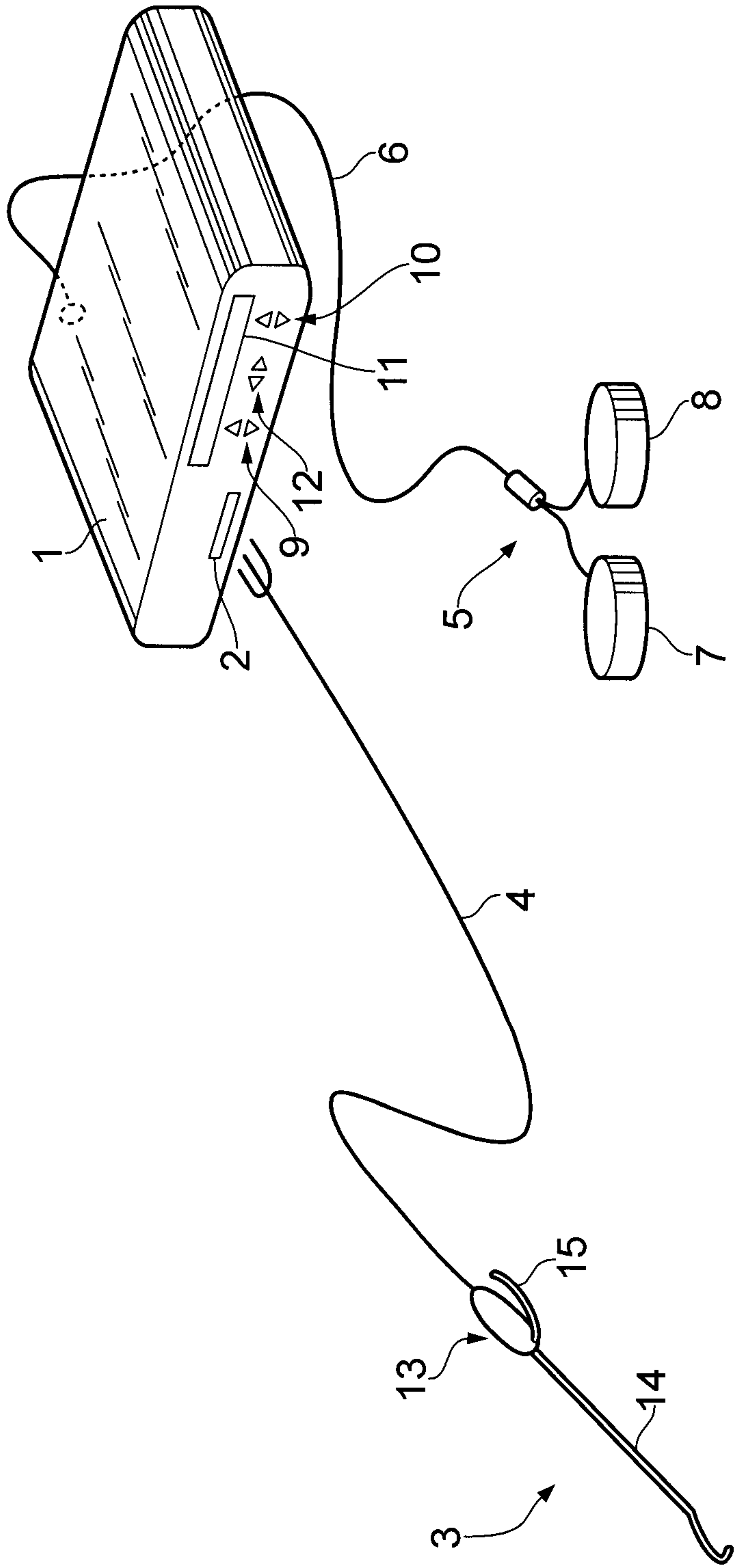

FIG. 1

2/4

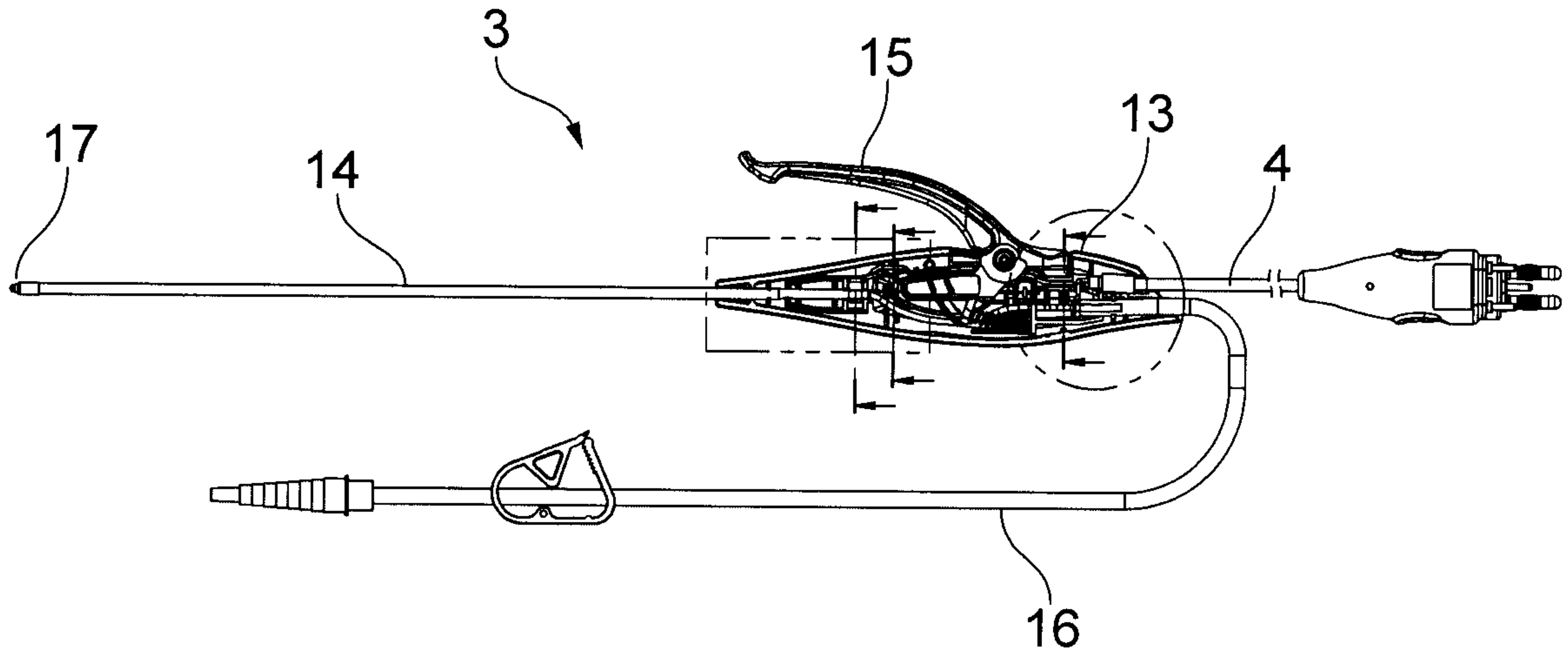

FIG. 2

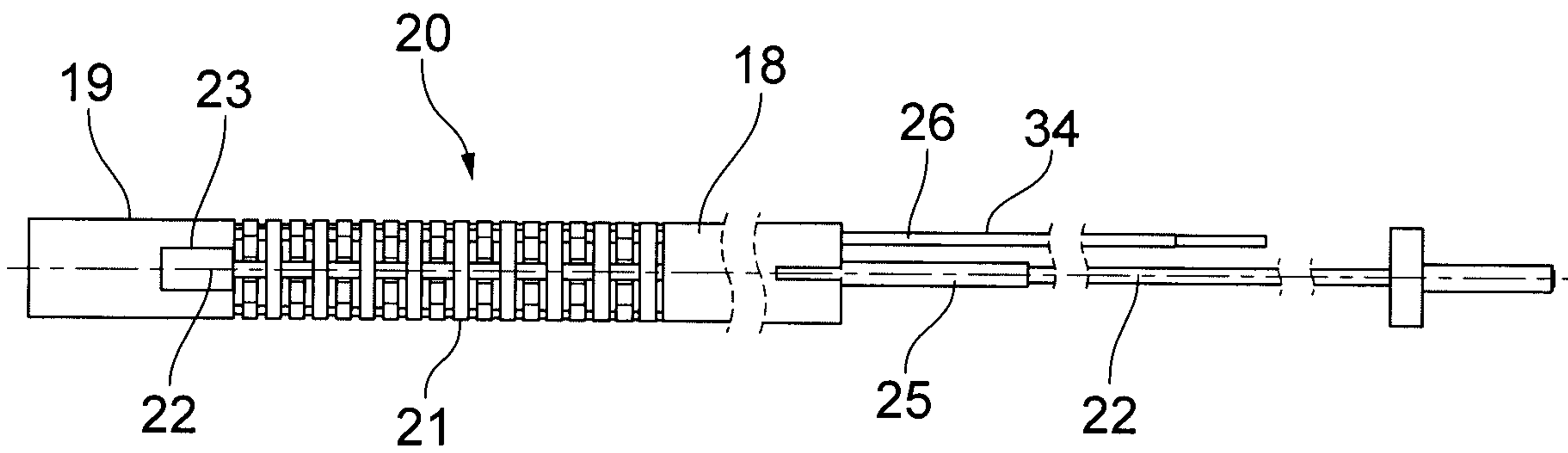

FIG. 3

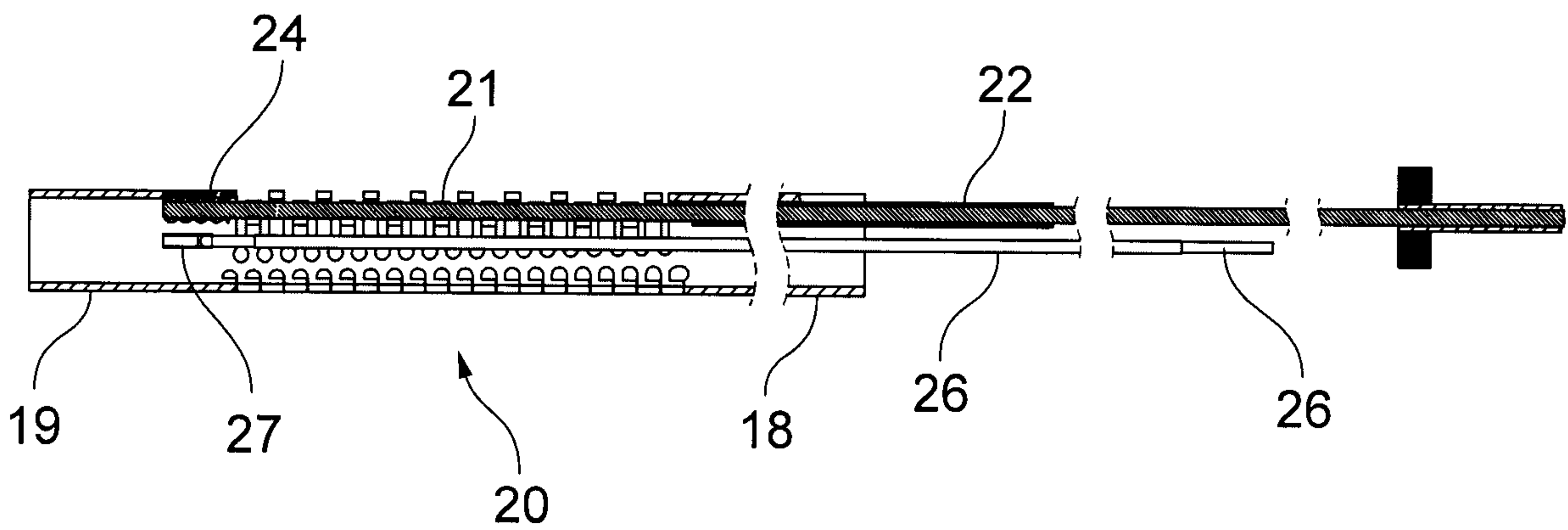

FIG. 4

3/4

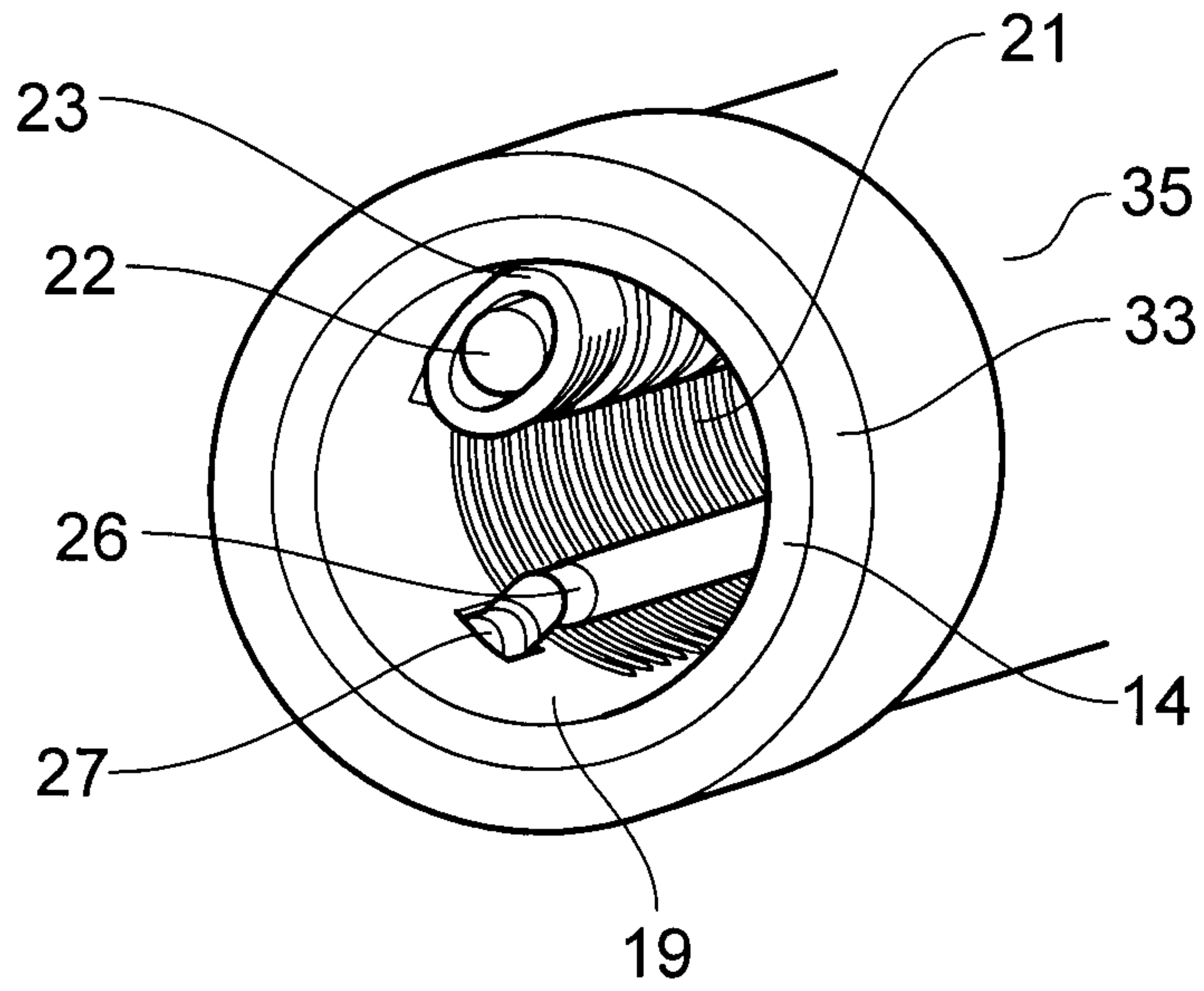

FIG. 5

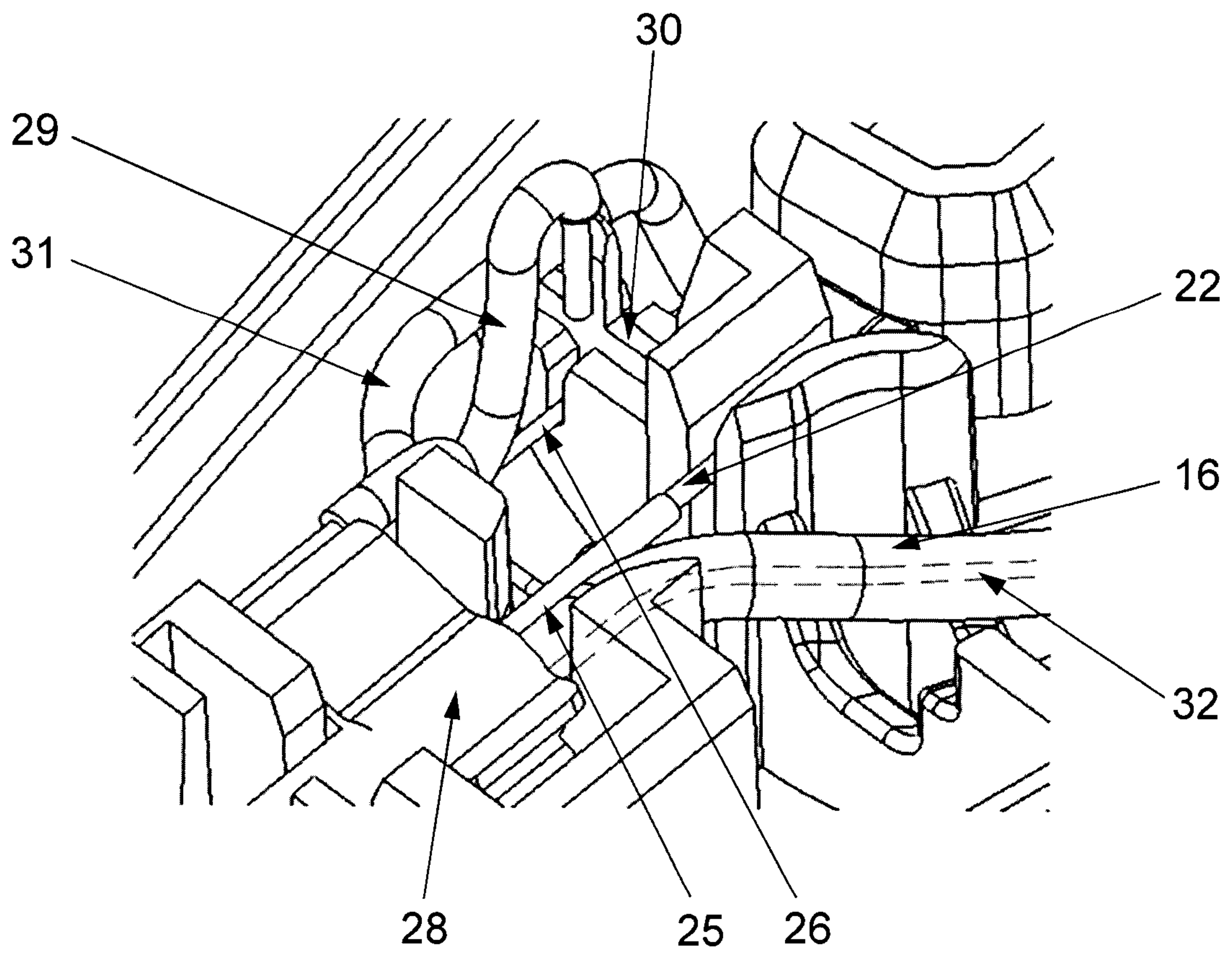

FIG. 6

4/4

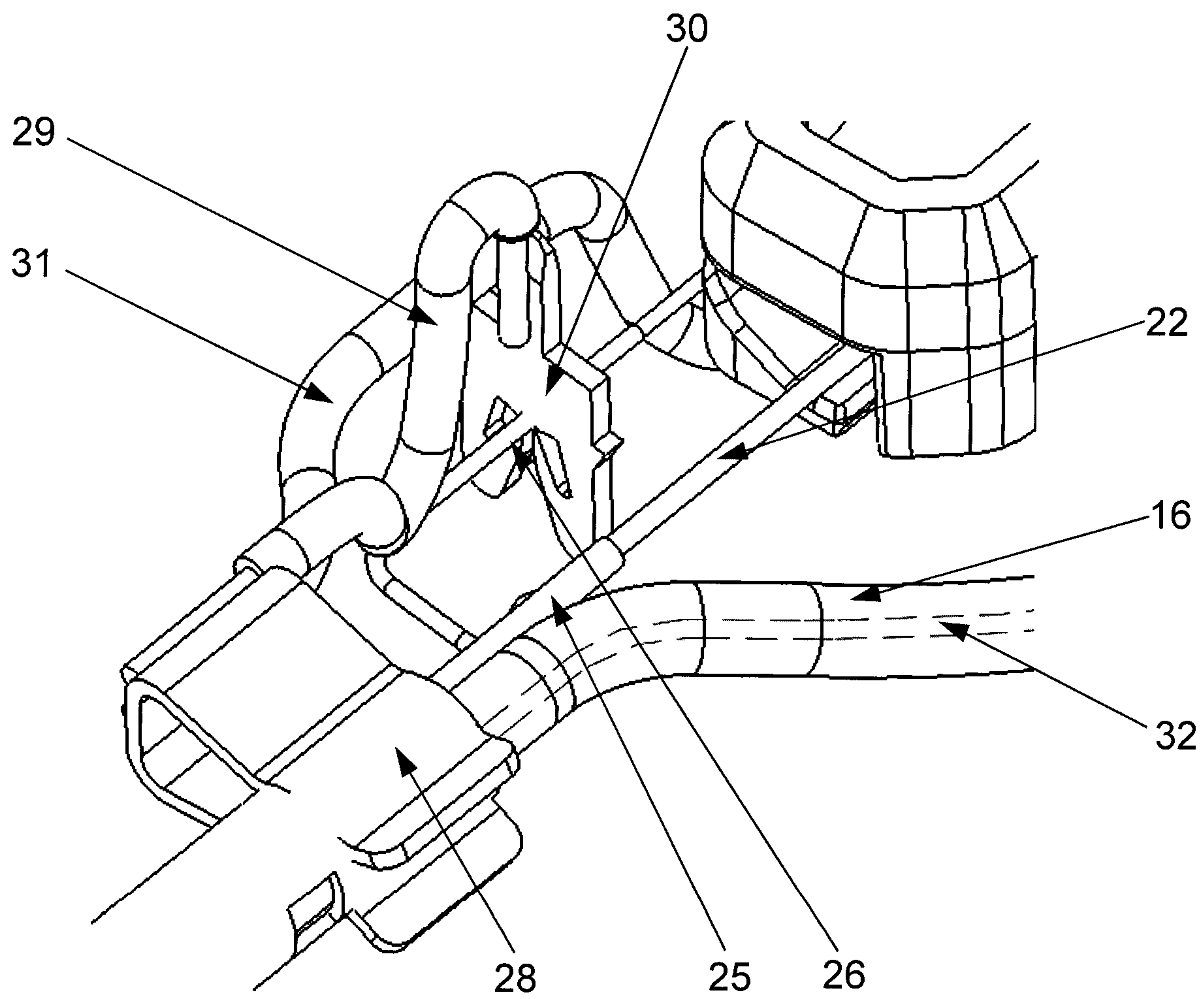

FIG. 7

