

(19) World Intellectual Property Organization  
International Bureau



(43) International Publication Date  
18 January 2001 (18.01.2001)

PCT

(10) International Publication Number  
**WO 01/03510 A1**

(51) International Patent Classification<sup>7</sup>: **A22C 25/14**

[DE/DE]; Bornbrück 5, D-23898 Kühren (DE). **KAHRE, Holger** [DE/DE]; Geleitweg 28, D-23569 Lübeck (DE).

(21) International Application Number: PCT/EP00/06787

(74) Agent: **WENZEL & KALKOFF**; Grubesallee 26, D-22143 Hamburg (DE).

(22) International Filing Date: 14 July 2000 (14.07.2000)

(25) Filing Language: English

(81) Designated States (*national*): CA, DK, JP, NO, NZ, RU, US, ZA.

(26) Publication Language: English

(84) Designated States (*regional*): European patent (AT, BE, CH, CY, DE, DK, ES, FI, FR, GB, GR, IE, IT, LU, MC, NL, PT, SE).

(30) Priority Data:  
199 32 824.2 14 July 1999 (14.07.1999) DE

**Published:**

- With international search report.
- Before the expiration of the time limit for amending the claims and to be republished in the event of receipt of amendments.

(71) Applicant (*for all designated States except US*): **NORDISCHER MASCHINENBAU RUD. BAADER GMBH & CO. KG** [DE/DE]; Geniner Strasse 249, D-23560 Lübeck (DE).

*For two-letter codes and other abbreviations, refer to the "Guidance Notes on Codes and Abbreviations" appearing at the beginning of each regular issue of the PCT Gazette.*

(72) Inventors; and

(75) Inventors/Applicants (*for US only*): **KETELS, Dieter**

(54) Title: METHOD AND APPARATUS FOR ALIGNING A DEAD FISH

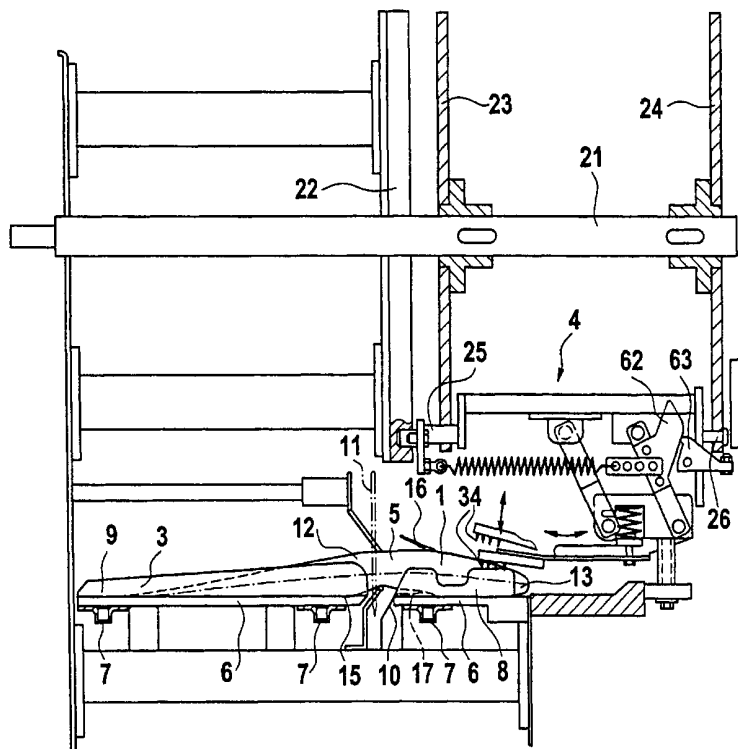

(57) **Abstract:** In order to sever heads of fish or, in the case of pre-decapitated fish collar bones remaining on the torso from the torso at a preset location (38) with a blade (11) whose cutting edge runs transversely to the orientation of the fish, the fish must be aligned relative to the blade's cutting plane (39). Since in known methods and apparatus and particularly regarding differing fish size difficulties occur in precisely engaging the fish for the purpose of displacing them as well as due to their deformation in obtaining the correct positioning, it is proposed that the fish be gripped in form-locking relationship at a dimensionally stable location such as the head by a movable positioning device (4) and displaced in a direction towards the cutting plane (39) until the preset location (38) lies in the cutting plane. To this end a positioning device (4) is provided which can be brought into form-locking engagement with a dimensionally stable location of the fish and which has a slide mechanism that aligns the fish.

Thus alignment can be achieved automatically avoiding inaccuracies by an operator, on the one hand, and without any unwanted shifting of the cutting point which often occurs following elastic deformations of the fish body, on the other.



WO 01/03510 A1

## Method and apparatus for aligning a dead fish

5

### Description:

The invention concerns a method for aligning a dead fish, a head-side section of which is to be separated from its torso at a preset location with a blade of which the cutting edge runs transversely to the orientation of the fish in a cutting plane relative to  
10 which the fish is aligned.

Furthermore the invention consists in an apparatus for aligning a dead fish of which a head-side section is to be separated from its torso at a preset location with a blade of which the cutting edge is arranged transversely to the orientation of the fish in a cutting plane relative to which the fish can be arranged to make a blade cut.

15 In the following, the term "head" is to be understood to mean a head-side portion of a fish also possibly including the gills, side fins and/or collar bones. Therefore, fish of which the head as such has already been cut off with such elements left on the torso also have to be considered to fall within the scope of the invention.

Machines for separating a head from a torso of a fish are known. The blade for  
20 separating the head is to be guided at a location of the fish at which as much fish flesh as possible remains on the torso, and the head is separated along a rear boundary of its bone facing towards the torso. Here it turned out that side fins mark with sufficient reliability this location which is particularly suitable for separating the head. For this reason the dead fish is aligned with respect to these side fins in a trough which  
25 transports the fish and which is divided into head and body supports. A cut is made with a blade along this division, this being either immediately in front of the side fins in a direction towards the head or immediately behind the side fins in a direction towards the torso.

Here it should be taken into account that the dead fish lies in the trough used to  
30 convey it with a clearance which allows a movement of the fish in its longitudinal direction. This clearance is smaller for large fish than for small fish. The clearance is limited by means of the side fins which serve as a measure for a cut which separates the head from the torso. These side fins catch when the fish is displaced within the trough in

a catching device which is provided for this purpose and in relation to which a cutting plane in which the blade used to separate the head is moved, is positioned.

With known devices for aligning the fish, displacement of the fish within the trough was a problem. This was caused by the fact that the dead fish could not be  
5 gripped with the necessary reliability within the trough, so that misalignments were common. In that case for example the fish for the purpose of displacement within the trough was acted upon in the region of its mouth by a slide plate which was intended to displace the fish rearwards in its longitudinal direction in a direction facing away from the head. Depending on the resistance with which the fish met within a trough, the head  
10 was deformed without displacement of the fish taking place. The fish therefore could not be moved into a position in which optimum separation of the head from the torso was possible.

Furthermore it has also been attempted to grip the fish in form-locking relationship in the region of its torso in order to align it within the trough. In this case difficulties arose in so far as the torso essentially consists of fish flesh which was deformed  
15 elastically when forces were applied by means of a form-locking coupling device, so that in this respect too there was no alignment of the fish, only a random combination of individual influencing variables.

Finally a method for coupling a dead fish to a displacement tool in which the  
20 head was coupled to the displacement tool has also already been practised. The latter had a spike on which the fish head was impaled. The spike extended through the eye sockets of the fish head. This method requires considerable attention and concentration capacity of an operator performing impalement of the head. The operator however over a manageable period of his work with a fish succession of 30 to 40 fishes per minute  
25 could not ensure with the necessary reliability that the spike passed through the eye sockets, so that the head was not coupled to a displacement tool with the necessary reliability. Dependence of coupling on the attention of an operator therefore proved to be inadequate.

It is therefore the object of the present invention to couple the fish to an alignment  
30 tool so reliably that the head is separated from the torso at a preset location.

This object is now achieved with respect to the method by the fact that the fish is gripped in form-locking relationship at a dimensionally stable location by a movable

positioning device and displaced in a direction towards the cutting plane until the preset location lies in the cutting plane.

By coupling the positioning device to a dimensionally stable location of the fish body it is ensured that no inaccuracies in positioning of the fish occur due to elastic  
5 deformations of the fish body.

With respect to the apparatus the set object is achieved by the fact that a positioning device which can be brought into form-locking engagement with a dimensionally stable location of the fish and which is provided with a slide mechanism that aligns the fish, is provided.

10 Due to this positioning device, coupling of the fish becomes independent of the attention of an operator. Coupling to the dimensionally stable location ensures that elastic deformations of the fish body do not lead to unwanted shifting of a cutting point.

According to a preferred embodiment of the invention the preset location is oriented by side fins of the fish. These mark with sufficient reliability the transition  
15 from the head to the torso so that, depending on requirements, the head is separated on a side of the side fins facing towards it or on a side of the side fins facing away from it.

According to a further preferred embodiment of the invention the positioning device is caught in form-locking relationship in the region of the head. As the head is the only dimensionally stable location of a fish body, it is especially suitable for transmitting the forces applied to the fish body in its region, to the whole of the fish body.  
20

According to a further preferred embodiment of the invention the positioning device penetrates with at least one pointed object into a flesh cover of a skull bone which is present in the course of the lateral boundary surface and in which it is clamped in form-locking relationship. This flesh cover is so thick that the positioning device can  
25 be clamped in it. On the other hand the thickness of this flesh cover does not allow deformation with respect to a skull bone covering it. Forces which are applied to the flesh cover are imparted directly to the skull bone and hence to the whole of the fish body.

According to a further preferred embodiment of the invention the positioning unit is guided on an arcuate path which runs roughly in a vertical plane in the lower  
30 position of which the pointed object penetrates into the flesh cover of the head. In this way reliable guiding of the positioning device is possible. The latter grips the head at a respectively desired location and holds it fast for a time necessary to make the

separating cut. Guiding of the positioning device in a vertical plane can also be achieved structurally very favourably.

According to a further preferred embodiment of the invention the positioning device is conveyed on the path at a speed which corresponds to a speed of conveying  
5 the fish. Due to coordination of the two speeds, the fish is guided reliably by the positioning device while it is conveyed and is not released from this guide.

According to a further preferred embodiment of the invention the positioning device is conveyed in the bottom position of the path in the same direction as the fish lying in the trough. In this way the positioning device during conveying does not run in  
10 a different direction to the fish lying in the trough. Damage to the fish by different directions of the positioning device on the one hand and of the fish lying in the trough on the other hand is avoided.

According to a further preferred embodiment of the invention the fish gripped by the positioning device is displaced by means of a spring force in the trough until the  
15 preset location extends in the cutting plane. This drive for displacement of the fish is simple and hence not susceptible to breakdowns. No operational breakdown during displacement of the fish is to be feared.

According to a further preferred embodiment of the invention the positioning device is provided with at least one pointed object which can be introduced into the fish  
20 and which in the region of the head is provided with a mechanism which brings it into form-locking engagement with the fish. This pointed object catches with high reliability in the region of the head with the aid of the mechanism which therefore makes coupling of the fish independent of an operator of the apparatus. In this case according to a further preferred embodiment of the invention the pointed object is provided with two  
25 guides, of which a first one extends in the direction of advance maintained by the fish transversely to the longitudinal direction of the fish, and a second one extends transversely thereto in the direction of a longitudinal axis of the fish lying in a conveying device. These two guides allow highly reliable coupling of the fish to the positioning device, so that a decapitating cut can be made at a preset location of the fish body.

30 According to a further preferred embodiment of the invention the first guide is constructed as an arc which in the region of the head reaches a bottom position adjacent to the head, in which it extends in form-locking relationship into the flesh cover of the head. This guiding along an arc allows reliable catching of the pointed object on the

head of the fish. Here, according to a further preferred embodiment of the invention, the guide for the pointed object is in the form of a carousel. The latter according to a further preferred embodiment of the invention consists of a circle curve on which a first suspension of the pointed object is guided, and of a second suspension of the pointed object  
5 which is guided relative to the first suspension in such a way that the pointed object is guided over a given distance in its position holding the head. In this way it is possible to carry out the required guiding of the head until the separating cut is made.

According to a further preferred embodiment of the invention, on the circle curve is superimposed an oval channel curve in which the second suspension of the  
10 pointed object is guided in such a way that the pointed object in the region of a function zone is oriented vertically and perpendicularly to a trough. The combination of the circle curve with the oval channel curve results, precisely in the region of the necessary function zone, to narrow and precise guiding of the pointed object and hence reliable support of the fish until the head is separated.

15 According to a further preferred embodiment of the invention the function zone includes lowering of the pointed object in a direction towards the fish lying in the trough, displacement of the fish within the trough until the side fins are caught in a catching device, and lifting of the pointed object out of its form-locking engagement with the fish. These three sections of the function zone determine whether the fish is  
20 properly guided during separation of the head and is lying in the correct position in which the head is separated.

According to a further preferred embodiment of the invention the catching device consists of mouldings which on both sides of lateral boundary surfaces are oriented in a direction towards the fish lying in the trough in such a way that the side  
25 fins of the fish during displacement thereof are caught in them, so that the fish lies with a preset location in the region of the cutting plane of a decapitating blade. This catching device is also tried and tested with the positioning device according to the invention and leads to optimum performance of the separating cut.

According to a further preferred embodiment of the invention the catching de-  
30 vice is divided into at least two sections which are arranged successively in the direction of conveying a trough for catching the fish which after conveying of the fish by a trough width has not yet reached its desired position for separation of the head. Due to this division of the catching device into two or more sections, alignment of the fish in its

longitudinal direction is independent in time of the advance of the fish transversely to its longitudinal direction. Instead the alignment can be performed in the longitudinal direction of the fish at a moderate speed of alignment, so that the catching device is thus prevented from not catching the side fins with the necessary reliability. At too high a speed of this longitudinal displacement, it must be expected that the catching device will not grip the side fins with the necessary reliability.

According to a further preferred embodiment of the invention the slide mechanism consists of a spring which moves the pointed object in the direction of the longitudinal axis of the fish in a direction towards the cutting plane. Such spring-dependent operation of the slide mechanism is on the one hand comparatively simple and cheap to execute, but on the other hand operationally very reliable. As a result, very reliable positioning of the fish is achieved with minimum structural expenditure.

According to a further preferred embodiment of the invention the pointed object is biased by a pressure spring which forces it in a direction towards the fish. This pressure spring can be adjusted to the strength conditions on the one hand of the head and on the other hand of the flesh cover, so that on coupling the head there is no need to fear that perhaps the head will be destroyed or coupling will not be effected satisfactorily.

According to a preferred embodiment of the invention a pivot arm which moves the fish is mounted pivotably in a plane in which the fish extends with its longitudinal axis in the trough. This longitudinal axis of the fish is appropriately oriented obliquely to a plane in which the pointed object is brought into form-locking engagement with the head. This oblique orientation has the advantage that the separating cut is made in a plane which runs not at right angles to the longitudinal axis of the fish, but obliquely in order to produce as high as possible a yield of fish flesh which remains joined to the torso of the fish, without considerable quantities of fish flesh remaining on the head on separation of the head.

According to a further preferred embodiment of the invention a stronger spring is provided for large fish and a smaller spring for the displacement of smaller fish. In this way each fish is displaceable within the trough with the force appropriate to it.

According to a further preferred embodiment of the invention the slide mechanism can be locked by a ratchet system in its end position holding the fish in its

cutting position. This ratchet system leads to cutting taking place in a fixed position of the fish.

According to a further preferred embodiment of the invention the fish during separation of the head from the torso is biased via the pointed object by the spring. The spring bias which exists for the duration of separation leads to the fact that the fish can  
5 be divided at the preset location with the necessary reliability on account of its fixed guiding in the trough.

Further details of the invention are apparent from the detailed description below and the attached drawings in which a preferred embodiment of the invention is illustrated by way of example.  
10

The drawings show:

- Figure 1 partly sectional side view of the positioning device at the beginning of the sliding process,
- Figure 2 partly sectional side view of the positioning device at the end of the  
15 sliding process,
- Figure 3 front view of a tool carrier,
- Figure 4 schematic side view of a catching device,
- Figure 5 front view of a rocker mounted in a guide,
- Figure 6 top view of a positioning device, and
- 20 Figure 7 top view of a positioning device for a fish which has been pre-decapitated but with the side fins and collar bones left on the torso.

A machine for positioning fish 1, 2 essentially consists of troughs 3 and a positioning device 4. The fish 1, 2 lie in the troughs 3 in which they are conveyed transversely to their longitudinal extent 5 by means of chains 6 to which the troughs 3 are  
25 connected by bolts 7. The troughs 3 are divided into a head support 8 and a body support 9. Between the head support 8 and the body support 9 extends a slot 10 in the region of which is arranged a blade 11. This blade 11 is constructed as a circular blade which is mounted in rotating relationship in the region of the slot 10. It is however also conceivable to arrange other blades 11, for example translationally operating blades, in  
30 the region of the slot 10. Furthermore, instead of one blade 11 a pair of blades can be provided in the region of the slot 10 if, depending on the kind of fish 1, 2 to be decapitated, a so-called wedge cut is to be made.



The fish 1, 2 lies with its torso 12 on the body support 9 and with its head 13 on the head support 8. The head 13 is the most dimensionally stable part of the fish 1, 2, which is firmly surrounded with a thin flesh cover 14. The fish 1, 2 lies in the respective trough 3 on one of its lateral boundary surfaces 15. From these lateral boundary surfaces  
5 15 protrude, in the side position of the fish 1, 2, side fins 16, 17 which are embedded by their respective roots 18, 19 in the lateral boundary surfaces 15.

Above the troughs 3 the positioning devices 4 are arranged in a carousel 20 which rotates about a shaft 21. This shaft 21 is mounted rotatably in a stand 22. The carousel 20 has two side plates 23, 24 which run with planes parallel to each other and  
10 which are rigidly connected to the shaft 21.

The positioning devices 4 are mounted rotatably on shaft ends 25, 26 in the two side plates 23, 24. Furthermore the positioning devices 4 are mounted in a channel curve 27 on rolling bodies 28 or on slide pieces which roll in the channel curve 27. The channel curve 27 extends in an oval 29. Here the oval 29 is arranged relative to a circle  
15 curve 30 described by the carousel 20 such that the oval 29 and the circle curve 30 overlap each other such that together in a bottom position 31 facing towards the troughs 3 they convey the positioning devices 4 in a path running roughly parallel to the troughs 3. In this way, in the bottom position 31 the positioning devices 4 which are guided on the carousel 20 and the channel curve 27 run with their lower boundaries 32 roughly  
20 parallel to a trough inner surface 33 acted upon by the fish 1, 2.

From the lower boundaries 32 of the positioning devices protrude pointed objects 34, for example nails. The latter become buried in the flesh cover 14 of the head 13 in the bottom position 31, and so guide the head 13 and hence the whole fish 1, 2 of which the head 13 is the most dimensionally stable part. The carousel 20 and hence also  
25 the rolling bodies 28 passing through the channel curve 27 are connected mechanically, for example by a chain, to the chains 6 of an advance mechanism with which the troughs 3 are conveyed. In this way the carousel 20 has a speed which leads to the path speeds of the positioning devices 4 in the bottom position 31 corresponding to the advance speed at which the troughs 3 are conveyed. In this way the heads 13 of the fish  
30 1, 2 lying in the troughs 3 remain during a whole function length 35 in form-locking engagement with the pointed objects 34 of the positioning devices 4. This function length 35 is composed of a lowering section 36 in which the positioning device 4 is lowered so far onto the head 13 of the fish 1, 2 that the pointed objects 34 become

engaged in form-locking relationship with the head. The lowering section 36 is followed by a sliding section 37 in which the fish 1, 2 is displaced along its longitudinal extent 5 in the trough 3 until it lies with a preset location 38 in the region of a cutting plane 39 in which the blade 11 rotates.

5       The sliding section 37 is followed by the last section 40 of lifting out the function length 35. In this lifting section 40 the positioning device 4 is lifted out of form-locking engagement with the head 13 and conveyed away by the carousel 20 until in the region of the lowering section 36 it is again lowered in a direction towards a head 13 lying in the trough 3.

10       On this movement of the fish 1, 2 transversely to its longitudinal extent 5 is superimposed a movement of the fish 1, 2 in the direction of the longitudinal extent 5. This movement of the fish takes place in the direction of the troughs 3, which runs at right angles or obliquely relative to a blade plane spanned by the blade 11. A tilted position of the troughs 3 allows for the fact that the head 13 is separated from the torso  
15 12 appropriately obliquely to the longitudinal extent 5 of the fish 1, 2. This alignment of the fish 1, 2 relative to the blade plane 41 leads to the head 13 being separated from the torso 12 along a blade plane 41 in which essential parts of the fish flesh which are located in the upper part 42 of a fish 1, 2 remain on the torso 12, so that the blade plane 41 extends directly in the region of one end of the head 3 facing towards the torso 12.

20       In this region are also located the roots 18, 19 of the side fins 16, 17, so that the latter are also a measure for separation of the head 13 from the torso 12. For this purpose transversely to the direction of the troughs 3 are provided catching devices 43, 44 which have an upper portion 45 and a lower portion 46. The upper portion 45 faces in a direction towards the positioning device 4 and is associated with an upper portion  
25 of the fish 1, 2 protruding from the trough 3. By contrast the lower portion 46 is provided in the region of the slot 10 between the head support 8 and the body support 9 and serves to catch the side fin protruding from this slot 10. The upper portion 45 of the catching device 43, 44 is mounted on a linkage 47 which is vertically yielding. The latter can be mounted in plain bearings, not shown.

30       The pointed objects 34 are attached to a plate 49 which is attached by a spring arm 50 to two parallel pivot levers 51, 52. These two pivot levers 51, 52 are mounted pivotably on the positioning device 4. Its pivot plane extends in the longitudinal extent 5 of the fish 1, 2.

The two pivot levers 51, 52 are connected by a coupling device 53 to a spring element 54 which is permanently mounted in the stand 22. The spring element 54 pulls the two pivot levers 51, 52 and the plate 59 provided with the pointed objects 34 in a direction towards the head 13 of the fish 1, 2 which is lying in a trough 3. Furthermore  
5 the spring arm 50 is acted upon by a compression spring 55 which biases the spring arm 50 downwards in a direction towards the head 13. This compression spring 55 is attached to one of the levers 51, 52. The spring element 54 pivots the two levers 51, 52 about the pivot points 56, 57, so that the ends 58, 59 of the pivot levers 51, 52 facing away from the pivot points 56, 57 are pivoted in a direction towards the fish 1, 2. In the  
10 process the plate 59 is biased in a direction towards the head 13, so that form locking is produced between the pointed objects 34 and the head 13. This is sufficient to apply the forces transmitted by the spring arm 50 to the head 13 of the fish and displace the latter together with the torso 12 within the trough 3. In the process the side fins 16, 17 are caught by the catching device 43, 44 until the movement of the fish 1, 2 comes to rest  
15 not later than in the region of the roots 18, 19. In this position the blade 11 makes the separating cut by which the head 13 is separated from the torso 12.

The pivot levers 51, 52 are pivoted as a function of a curve 60. The latter releases the levers 51, 52 for pivoting after the plate 49 with its pointed objects 34 has engaged in form-locking relationship in the head 13 of the fish 1, 2.

20 For reasons of safety, apart from the spring element 54 there is provided another spring element 61 which runs parallel to the spring element 54. This spring element 61 maintains operation of the whole apparatus in the event that one of the two spring elements 54, 61 breaks after exhaustion of its life. The two spring elements 54, 61 can have different spring forces for the transport of small or large fish, but each of the two  
25 can also have the same spring force.

A fish 1, 2 is laid in a trough 3 and conveyed transversely to its longitudinal extent 5 in a direction towards the positioning device 4. In the process it passes into the region of the function length 35, at the beginning of which in the lowering section 36 the pointed objects 34 of the plate 49 become buried in form-locking relationship in the  
30 head 13 of the fish lying on its lateral boundary surface 15. Now the positioning device 4 is conveyed at the same speed as the fish 1, 2 in its trough, so that form locking is maintained between the pointed objects 34 and the head 13. In the process the fish 1, 2 which is held fast by the positioning device 4 moves into the sliding section 37 and is

there, owing to the force of the spring elements 54, 61, displaced within the trough 3 until the movement of the fish 1, 2 comes to rest in the region of the side fins 16, 17. In this case the sliding region 37 can extend across several widths of the trough 3, as the catching device 43, 44 has several sections 43, 44 which are oriented relative to each other such that the side fins 16, 17 are guided on the sections 43, 44 of the catching device. In this way the fish 1, 2 can be displaced at a reduced speed which however does not impair the working speed of the whole apparatus.

After the fish 1, 2 in the region of the side fins 16, 17 is positioned in the trough 3, the fish 1, 2 lying on the trough 3 is cut by the rotating blade 11. This cut runs at an angle of for example 0 - 15° to the direction of the drive shaft 21 of the positioning device. In this way optimum cutting of the fish 1, 2 is obtained. Here it is possible to lock the sliding system consisting of the two pivot levers 51, 52 with a ratchet system 62, in order not to let the forces of the springs 54, 61 act on the fish 1, 2 during the following head cut. This ratchet system 62 is unlocked before the sliding section 37 by a curve 63 fixed to the stand. Due to the shape of this curve 63 the whole system can be locked again.

Here however it turned out that it is advantageous to maintain the pressure of the spring 54, 61 during the cutting process, in order to cause effective cutting. As soon as the blade 11 has approximately half penetrated into the fish 1, 2, the head 13 has an increased freedom of movement. The forces maintained by the springs 54, 61 and transmitted by the plate 49 lead to a slight rotation of the head 13 so that the blade 13 cuts further into the nape region of the fish 1, 2.

During cutting, form locking between the fish 1, 2 and the positioning device 4 is maintained. This prevents the fish 1, 2 from changing position while the cut is made due to the friction of the blade 11, for example moving fast forward uncontrolled. For this reason it is only after the cut is made that the plate 49 with the pointed objects 34 is raised, so that the positioning device 4 releases the head 13 which has meanwhile been separated.

Figure 7 shows, in principle, the possibility of processing fish, as well, whose head has been removed in part due to standards required following regulations and habits in various regions of the world. In such fish, the collar bone and side fins are still present on the torso and are to be cut off to prepare the torso for further processing such as filleting. To this end, and as can be taken from this figure, the plate 49 of the above-

mentioned embodiment has been replaced by plate 49a which is arranged to be essentially perpendicular to the bottom of troughs 3, with its pointed objects 34a facing towards the torso, i.e. the pre-cutting face. The plate 49a is attached to the positioning device 4 which moves the pre-headed fish, as described before, but with the pointed  
5 objects 34a preventing the backbone/vertebral column from sliding on the plate and thus losing its aligned and correct position.

## Patent claims:

1. Method for aligning a dead fish whose head is separated from its torso at a preset location with a blade of which the cutting edge runs transversely to the orientation of the fish in a cutting plane relative to which the fish is aligned, characterised in that the fish (1, 2) is gripped in form-locking relationship at a dimensionally stable location by a movable positioning device (4) and displaced in a direction towards the cutting plane (39) until the preset location (38) lies in the cutting plane (39).  
5
2. Method according to claim 1, characterised in that the preset location (38) is oriented by side fins (16, 17) of the fish (1, 2).  
10
3. Method according to either of claims 1 or 2, characterised in that the preset location (38) extends on one side of a root (18) facing away from the head (13), at which root (18) the side fin (16, 17) leads into the torso (12) of the fish (1, 2).  
15
4. Method according to either of claims 1 or 2, characterised in that the preset location (38) extends on one side of a root (18) facing towards the head (13), at which root (18) the side fin (16, 17) leads into the torso (12) of the fish (1, 2).  
20
5. Method according to any of claims 1 to 4, characterised in that the fish (1, 2) is displaced on lateral boundary surfaces (15) of its body in a path until the side fins (16, 17) protruding on the lateral boundary surfaces (15) are caught in a catching device (43, 44).  
25
6. Method according to any of claims 1 to 5, characterised in that the positioning device (4) is caught in form-locking relationship in the region of the head (13).
- 30 7. Method according to claim 6, characterised in that the positioning device (4) penetrates with at least one pointed object (34) into a flesh cover (14) of a head (13) which is present in the course of the lateral boundary surface (15) and in which it is clamped in form-locking relationship.

8. Method according to any of claims 1 to 7, characterised in that the positioning device (4) is conveyed on an arcuate path which runs roughly in a vertical plane in the bottom position (31) of which the pointed object (34) penetrates into the flesh cover (14) of the head (13).
9. Method according to claim 8, characterised in that the positioning device (4) is conveyed on the path at a speed which corresponds to a speed of conveying the fish (1, 2).
10. Method according to claim 9, characterised in that the fish (1, 2) is conveyed in a trough (3) which is roughly adapted to it and whose speed of conveying corresponds to the speed of the positioning device (4).
11. Method according to any of claims 8 to 10, characterised in that the positioning device (4) is conveyed in the bottom position (31) of the path in the same direction as the fish (1, 2) lying in the trough.
12. Method according to any of claims 8 to 11, characterised in that the positioning device (4) holds the fish (1, 2) fast in form-locking relationship along a function length (35) during which the positioning device (4) is lowered onto the fish (1, 2), the fish (1, 2) with its preset location (38) is displaced in a direction towards the cutting plane (39), the cut is made for separating the head (13) and the positioning device (4) is lifted off the fish (1, 2) again.
13. Method according to claim 12, characterised in that the fish (1, 2) gripped by the positioning device (4) is displaced by means of a spring force in the trough (3) until the preset location (38) extends in the cutting plane (39).
14. Method according to any of claims 8 to 13, characterised in that the positioning device (4) runs on a path preset by a carousel (20).

15. Method according to any of claims 8 to 13, characterised in that the positioning device (4) is guided in an oval (29) of a channel curve (27).
16. Apparatus for aligning a dead fish whose head is separated from its torso at a  
5 preset location with a blade of which the cutting edge runs transversely to the orientation of the fish in a cutting plane relative to which the fish can be arranged to make a blade cut, characterised in that a positioning device (4) which can be brought into form-locking engagement with a dimensionally stable location of the fish (1, 2) and which is provided with a slide mechanism that  
10 aligns the fish (1, 2), is provided.
17. Apparatus according to claim 16, characterised in that the positioning device (4) is provided with at least one pointed object (34) which can be introduced into the fish (1, 2) and which in the region of the head (13) is provided with a mechanism  
15 which brings it into form-locking engagement with the fish (1, 2).
18. Apparatus according to claim 16 or 17, characterised in that the pointed object (34) is provided with two guides, of which a first one extends in the direction of advance maintained by the fish (1, 2) transversely to the longitudinal extent (5)  
20 of the fish (1, 2), and a second one extends transversely thereto in the direction of a longitudinal extent (5) of the fish (1, 2) lying in a conveying device.
19. Apparatus according to claim 18, characterised in that the pointed object (34) along its first guide is given the same speed of advance as the fish (1, 2) being  
25 conveyed transversely to its longitudinal extent (15).
20. Apparatus according to claim 18 or 19, characterised in that the first guide is constructed as an arc which in the region of the head (13) has reached a bottom position (31) adjacent to the head (13), in which it extends in form-locking  
30 relationship into the flesh cover (14) of the head (13).
21. Apparatus according to any of claims 18 to 20, characterised in that a carousel (20) is provided for guiding the pointed object (34).



22. Apparatus according to claim 21, characterised in that the carousel (20) consists of a circle curve (30) on which a first suspension of the pointed object (34) is guided, and there is provided a second suspension of the pointed object (34) which is guided relative to the first suspension in such a way that the pointed object (34) is guided over a given distance in its position holding the head (13).
23. Apparatus according to claim 22, characterised in that the given distance roughly corresponds to a width of three troughs (3) which are provided for conveying in each case one fish (1, 2) transversely to its longitudinal extent (5).
24. Apparatus according to claim 22 or 23, characterised in that on the circle curve (30) is superimposed an oval channel curve (27) in which a second suspension of the pointed object (34) is guided in such a way that the pointed object (34) in the region of a function length (35) is oriented vertically and perpendicularly to a trough (3).
25. Apparatus according to claim 24, characterised in that the function length (35) includes lowering (36) of the pointed object (34) in a direction towards the fish (1, 2) lying in the trough (3), displacement (37) of the fish (1, 2) within the trough (3) until the side fins (16, 17) are caught in a catching device (43, 44), and lifting (40) of the pointed object (34) out of its form-locking engagement with the fish (1, 2).
26. Apparatus according to claim 25, characterised in that the catching device (43, 44) consists of mouldings (45, 46) which on both sides of lateral boundary surfaces (15) are oriented in a direction towards the fish (1, 2) lying exposed in the trough (3) in such a way that the side fins (16, 17) of the fish (1, 2) during displacement thereof are caught in them, so that the fish (1, 2) lies with a preset location (38) in the region of the cutting plane (39) of a blade (11).
27. Apparatus according to claim 26, characterised in that the catching device (43, 44) has an upper portion (42) which is arranged above the fish (1, 2) lying in the

trough (3) and which is mounted so as to be vertically yielding to compensate for differences in height of the fish (1, 2) lying in the trough.

28. Apparatus according to claim 26 or 27, characterised in that the catching device  
5 (43, 44) is divided into at least two sections which are arranged successively in the direction of conveying a trough (3) for catching the fish (1, 2) which after conveying of the fish (1, 2) by a trough width has not yet reached its desired position for separation of the head (13).
- 10 29. Apparatus according to any of claims 16 to 28, characterised in that the slide mechanism consists of a spring element (54, 61) which moves the pointed object (34) in the direction of the longitudinal extent (5) of the fish (1, 2).
- 15 30. Apparatus according to claim 29, characterised in that the spring elements (54, 61) are coupled to at least one pivot lever (51, 52) which is mounted with one of its ends pivotably on a positioning device (4) and to the other end (58, 59) of which the pointed object (34) is coupled.
- 20 31. Apparatus according to claim 30, characterised in that the pointed object (34) is biased by a compression spring (55) which forces it in a direction towards the fish (1, 2).
- 25 32. Apparatus according to claim 30 or 31, characterised in that the pivot levers (51, 52) are mounted pivotably in a plane in which the fish extends with its longitudinal extent (5) in the trough (3).
- 30 33. Apparatus according to either of claims 31 to 32, characterised in that a curve (60) which can be released by the pointed object (34) on gripping the fish (1, 2) is provided for tensioning and release of the spring elements (54, 61).
34. Apparatus according to any of claims 29 to 33, characterised in that two spring elements (54, 61) are provided, of which a stronger spring is provided for large fish and a smaller spring for the displacement of smaller fish (1, 2).

35. Apparatus according to any of claims 29 to 34, characterised in that the slide mechanism can be locked by a ratchet system (62) in its end position holding the fish (1, 2) in its cutting position.
- 5
36. Apparatus according to any of claims 15 to 35, characterised in that the fish (1, 2) during separation of the head (13) from the torso (12) is biased via the pointed object (34) by the spring element (54, 61).
- 10 37. Apparatus according to any of claims 15 to 36, characterised in that form locking can be maintained between the pointed object (34) and the fish (1, 2) on separation of the head (13) from the torso (12).



**Fig. 2**

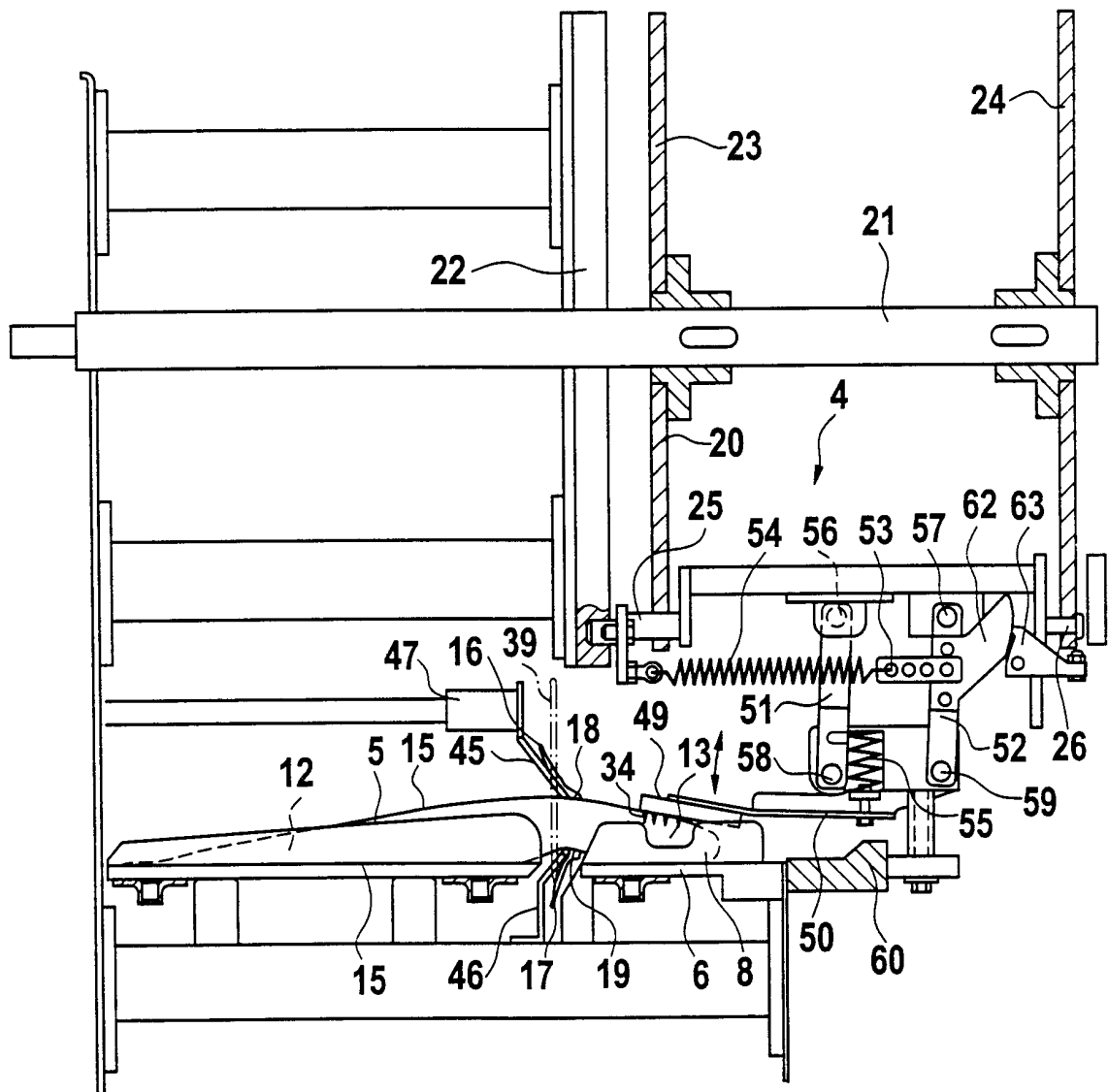

**Fig. 3**

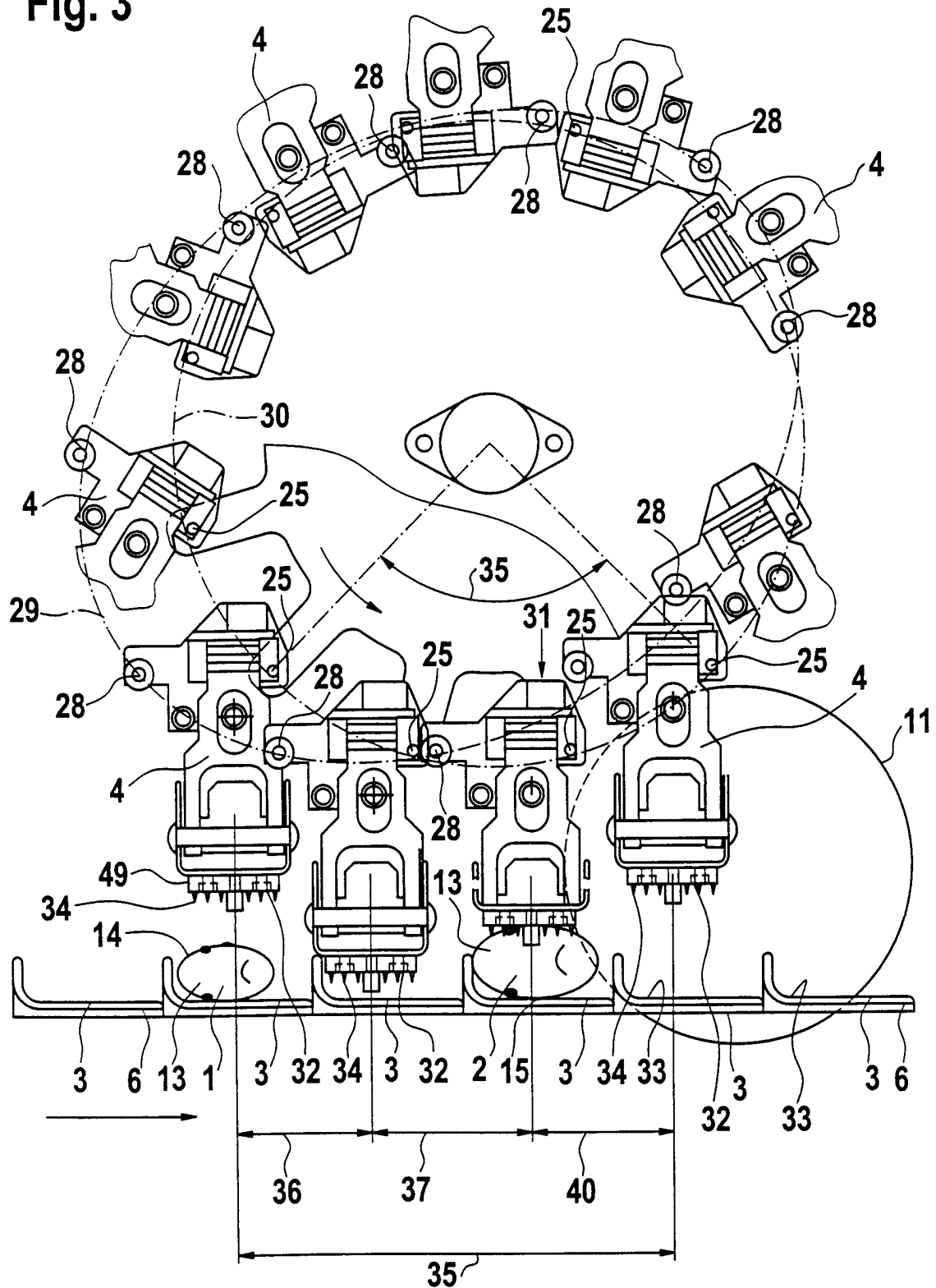

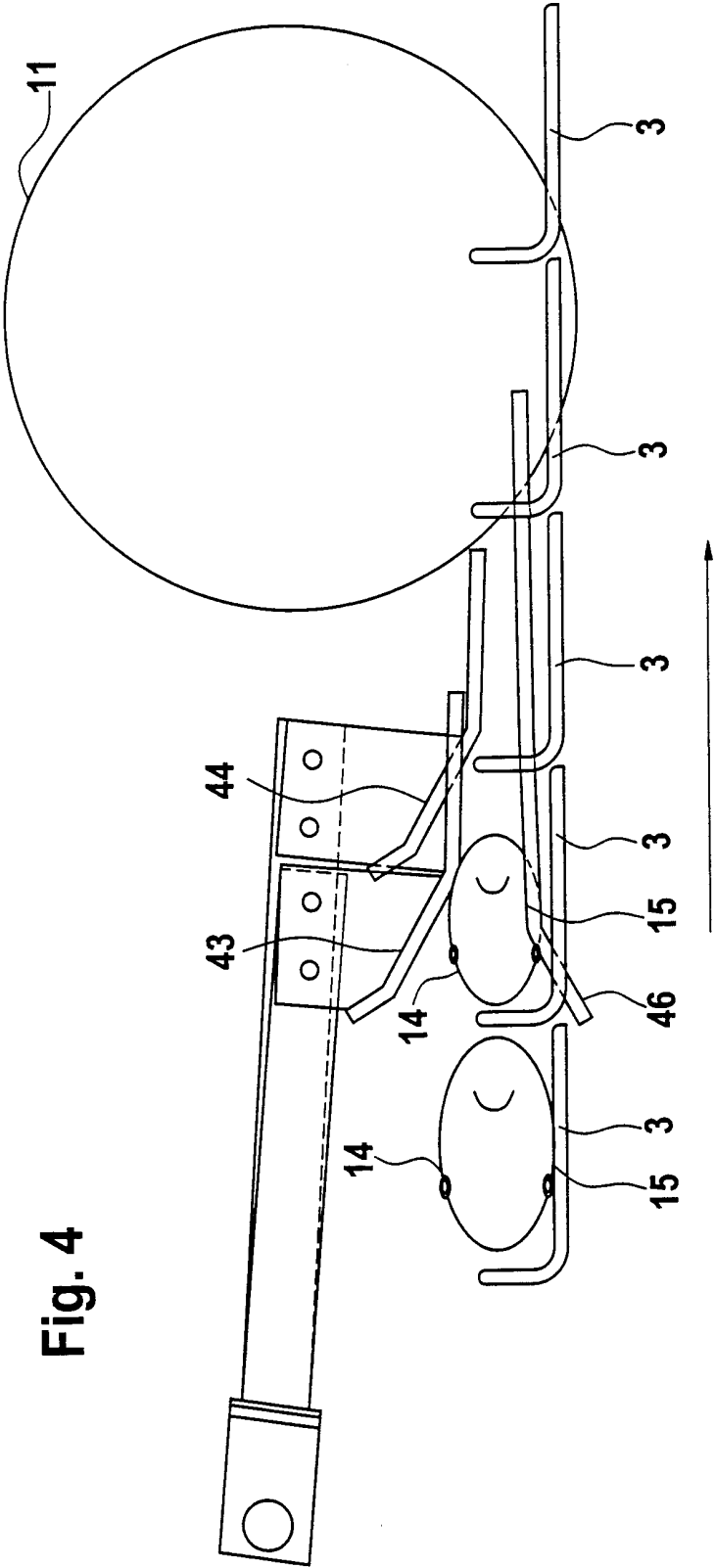
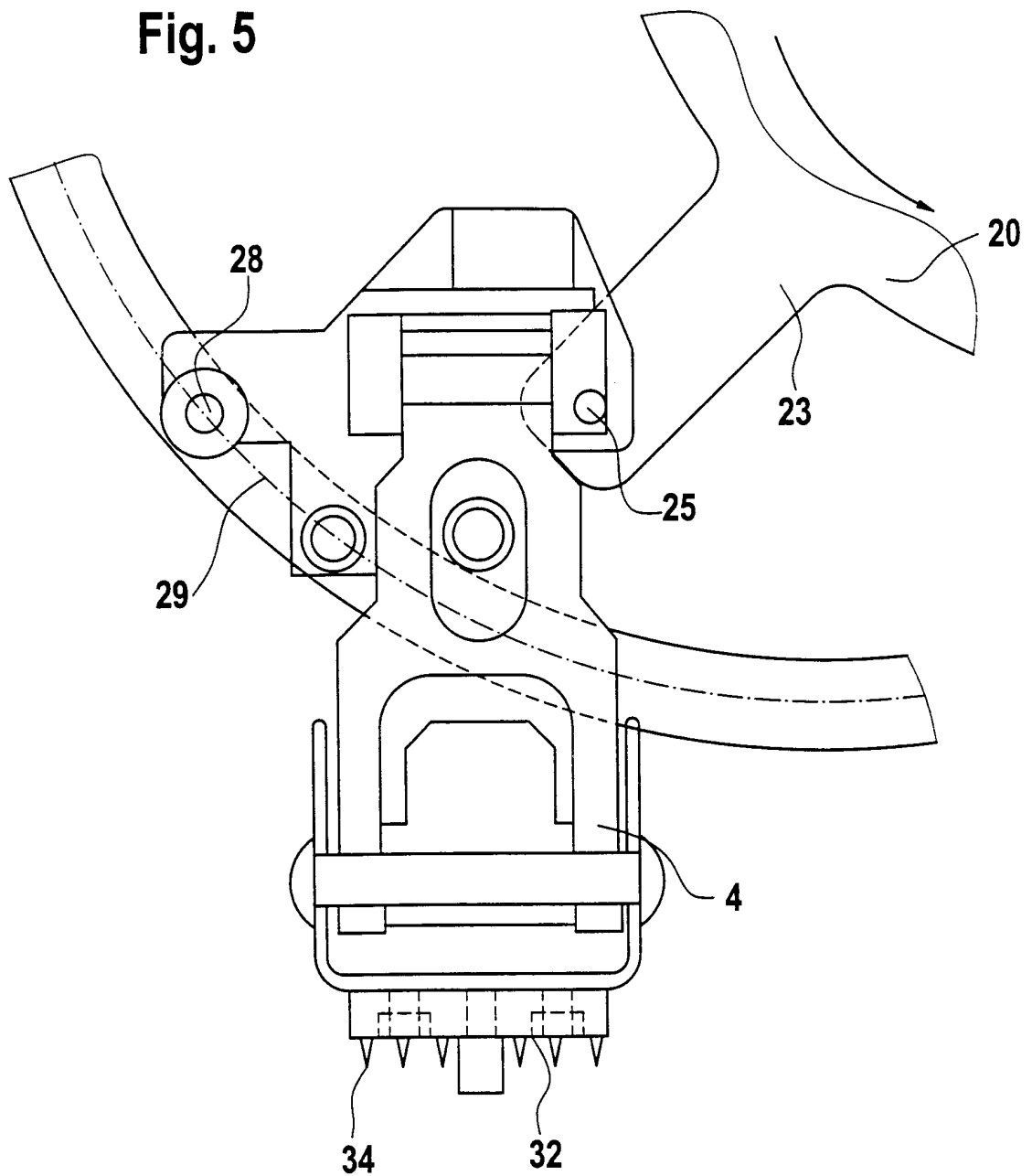

Fig. 4

5 / 7

Fig. 5





6 / 7

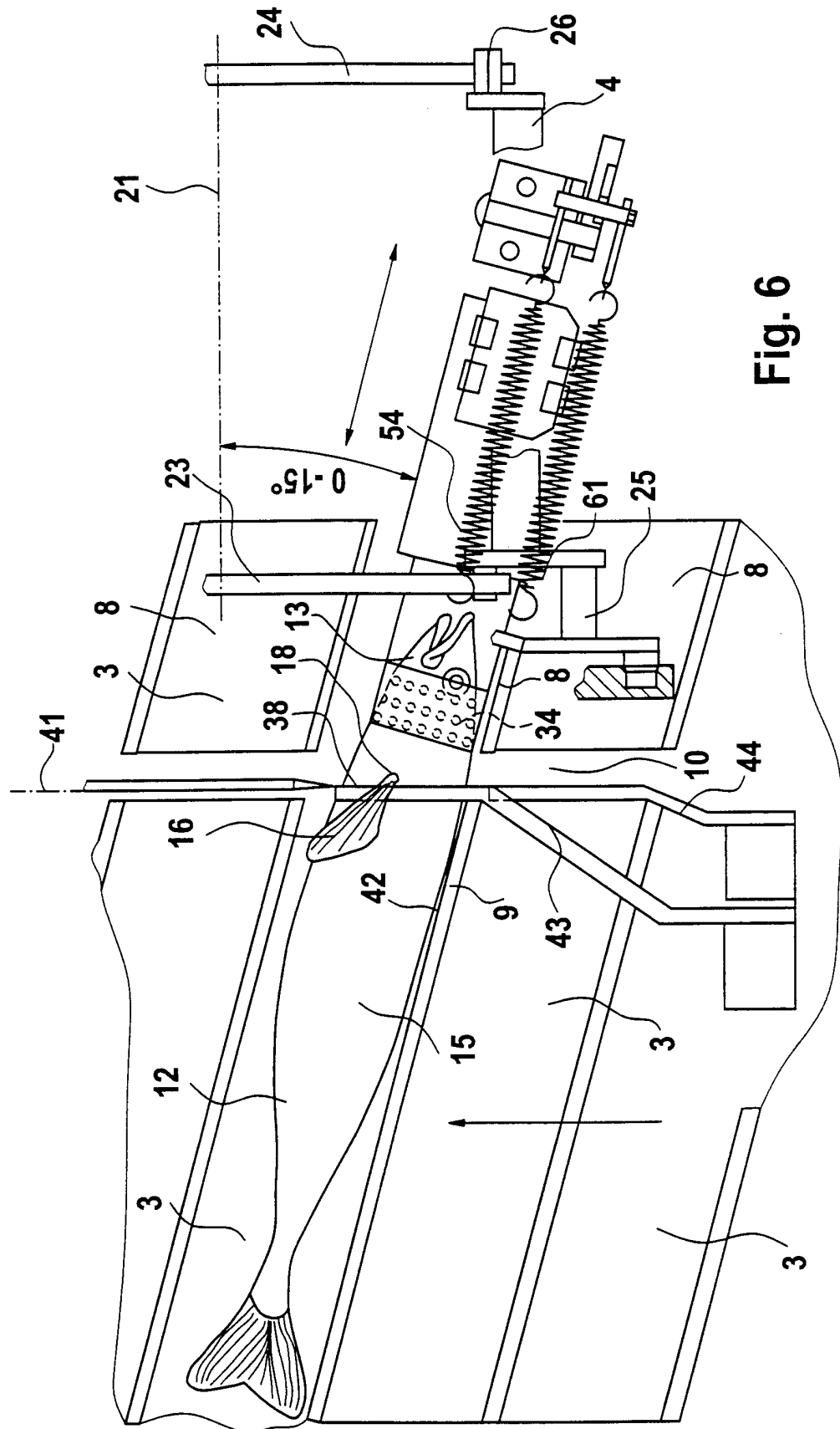

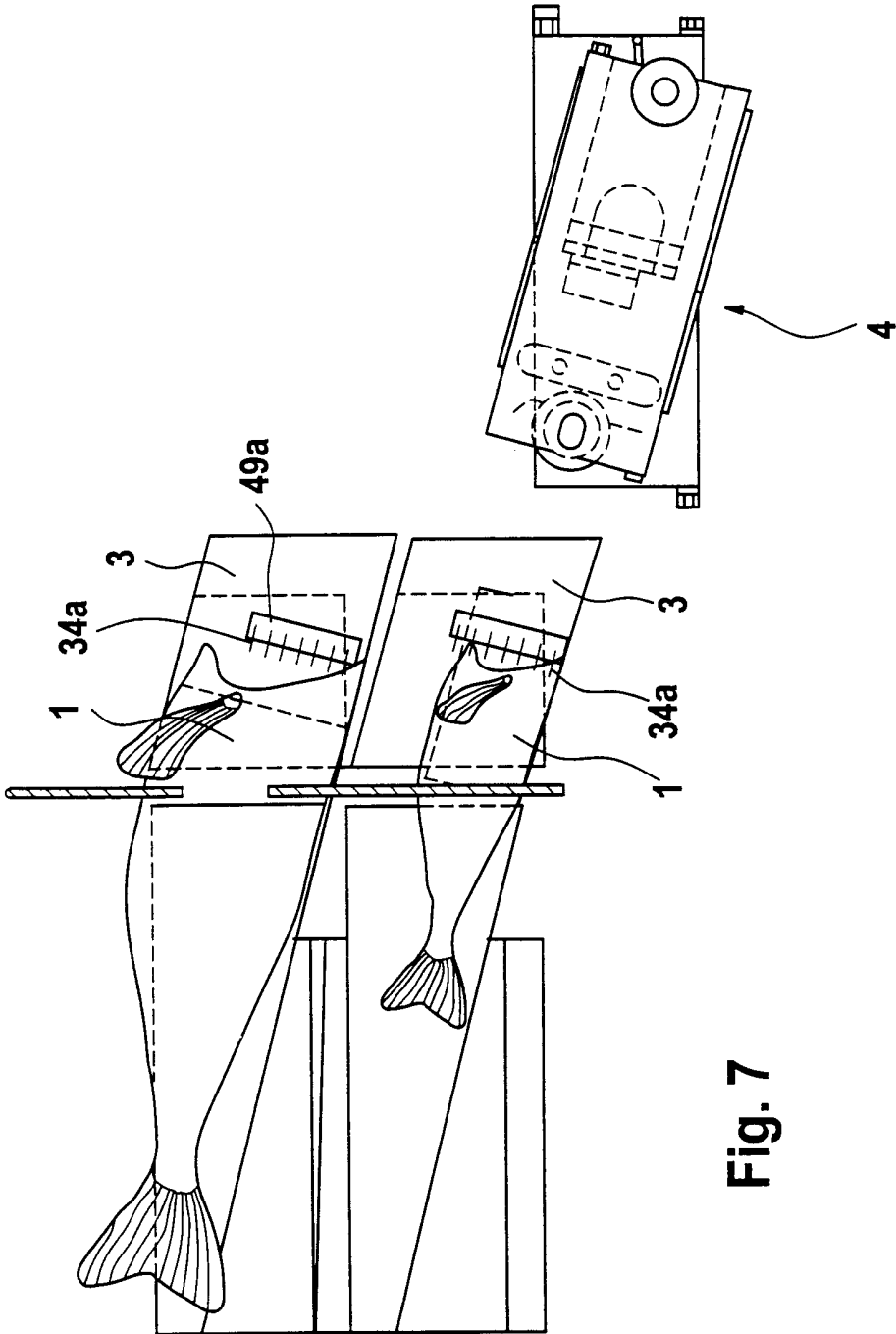

Fig. 7

# INTERNATIONAL SEARCH REPORT

International Application No

PCT/EP 00/06787

## A. CLASSIFICATION OF SUBJECT MATTER

IPC 7 A22C25/14

According to International Patent Classification (IPC) or to both national classification and IPC

## B. FIELDS SEARCHED

Minimum documentation searched (classification system followed by classification symbols)

IPC 7 A22C

Documentation searched other than minimum documentation to the extent that such documents are included in the fields searched

Electronic data base consulted during the international search (name of data base and, where practical, search terms used)

EPO-Internal, WPI Data, PAJ

## C. DOCUMENTS CONSIDERED TO BE RELEVANT

Category °	Citation of document, with indication, where appropriate, of the relevant passages	Relevant to claim No.
X	GB 1 309 359 A (NORDISCHER MASCHINENBAU) 7 March 1973 (1973-03-07) page 1, line 48 - line 90; figures ---	1, 2, 16
X	US 4 321 729 A (OLLIK REINHARD) 30 March 1982 (1982-03-30) column 1, line 6 - line 12 column 1, line 55 - column 2, line 54; figures ---	1, 2, 16
A	US 5 626 513 A (CURTIS JAMES L) 6 May 1997 (1997-05-06) abstract; figures --- -/--	1, 6, 7, 16, 17

☒ Further documents are listed in the continuation of box C.

☒ Patent family members are listed in annex.

° Special categories of cited documents:

- \*A\* document defining the general state of the art which is not considered to be of particular relevance
- \*E\* earlier document but published on or after the international filing date
- \*L\* document which may throw doubts on priority claim(s) or which is cited to establish the publication date of another citation or other special reason (as specified)
- \*O\* document referring to an oral disclosure, use, exhibition or other means
- \*P\* document published prior to the international filing date but later than the priority date claimed

\*T\* later document published after the international filing date or priority date and not in conflict with the application but cited to understand the principle or theory underlying the invention

\*X\* document of particular relevance; the claimed invention cannot be considered novel or cannot be considered to involve an inventive step when the document is taken alone

\*Y\* document of particular relevance; the claimed invention cannot be considered to involve an inventive step when the document is combined with one or more other such documents, such combination being obvious to a person skilled in the art.

\*G\* document member of the same patent family

Date of the actual completion of the international search

1 December 2000

Date of mailing of the international search report

14/12/2000

Name and mailing address of the ISA

European Patent Office, P.B. 5818 Patentlaan 2  
NL - 2280 HV Rijswijk  
Tel. (+31-70) 340-2040, Tx. 31 651 epo nl,  
Fax: (+31-70) 340-3016

Authorized officer

Acerbis, G

# INTERNATIONAL SEARCH REPORT

Intern. Application No

PCT/EP 00/06787

## C.(Continuation) DOCUMENTS CONSIDERED TO BE RELEVANT

Category *	Citation of document, with indication, where appropriate, of the relevant passages	Relevant to claim No.
X	<p>WO 99 13731 A (GRAHAM ANDREW CRISPIN ;DAVEY PETER G (GB); BUCKINGHAM ROB (GB); J0) 25 March 1999 (1999-03-25) page 1, line 5 - line 9 page 2, line 1 - line 18 page 3, line 10 - line 31; claim 1; figures</p> <p style="text-align: center;">---</p>	1,2,5,6, 16
A	<p>DD 219 376 A (VOLKSWERFT STRALSUND VEB) 6 March 1985 (1985-03-06) the whole document</p> <p style="text-align: center;">-----</p>	1,16

# INTERNATIONAL SEARCH REPORT

Information on patent family members

International Application No

PCT/EP 00/06787

Patent document cited in search report		Publication date	Patent family member(s)	Publication date
GB 1309359	A	07-03-1973	DE 2036538 A CA 940256 A JP 50024877 B NO 128744 B SE 367303 B US 3838478 A	25-05-1972 22-01-1974 19-08-1975 07-01-1974 27-05-1974 01-10-1974
US 4321729	A	30-03-1982	DE 3003617 A DK 285380 A,B NO 802058 A,B, SE 423175 B SE 8004208 A	23-07-1981 02-08-1981 03-08-1981 26-04-1982 02-08-1981
US 5626513	A	06-05-1997	NONE	
WO 9913731	A	25-03-1999	AU 9365798 A EP 1018891 A	05-04-1999 19-07-2000
DD 219376	A	06-03-1985	NONE	