

(19) World Intellectual Property Organization
International Bureau



(43) International Publication Date
20 October 2011 (20.10.2011)

(10) International Publication Number
WO 2011/130075 A1

- (51) International Patent Classification:
B26B 21/22 (2006.01)
- (21) International Application Number:
PCT/US2011/031377
- (22) International Filing Date:
6 April 2011 (06.04.2011)
- (25) Filing Language: English
- (26) Publication Language: English
- (30) Priority Data:
61/323,069 12 April 2010 (12.04.2010) US
13/040,360 4 March 2011 (04.03.2011) US
- (71) Applicant (for all designated States except US): **THE GILLETTE COMPANY** [US/US]; World Shaving Headquarters, IP/Legal Patent Department - 3E, One Gillette Park, Boston, Massachusetts 02127 (US).
- (72) Inventors; and
(75) Inventors/Applicants (for US only): **JOHNSON, Robert, Harold** [US/US]; 6 Chester Street, Melrose, Massachusetts 02176 (US). **LEE, Alejandro, Carlos** [US/US]; 366 Putnam Avenue #3, Cambridge, Massachusetts 02139 (US).
- (74) Common Representative: **THE GILLETTE COMPANY**; c/o Eileen L. Hughett, The Procter & Gamble Company, Global Patent Services, 299 East Sixth Street, Sycamore Building, 4th Floor Cincinnati, Ohio 45202 (US).
- (81) Designated States (unless otherwise indicated, for every kind of national protection available): AE, AG, AL, AM, AO, AT, AU, AZ, BA, BB, BG, BH, BR, BW, BY, BZ, CA, CH, CL, CN, CO, CR, CU, CZ, DE, DK, DM, DO, DZ, EC, EE, EG, ES, FI, GB, GD, GE, GH, GM, GT, HN, HR, HU, ID, IL, IN, IS, JP, KE, KG, KM, KN, KP, KR, KZ, LA, LC, LK, LR, LS, LT, LU, LY, MA, MD, ME, MG, MK, MN, MW, MX, MY, MZ, NA, NG, NI, NO, NZ, OM, PE, PG, PH, PL, PT, RO, RS, RU, SC, SD, SE, SG, SK, SL, SM, ST, SV, SY, TH, TJ, TM, TN, TR, TT, TZ, UA, UG, US, UZ, VC, VN, ZA, ZM, ZW.
- (84) Designated States (unless otherwise indicated, for every kind of regional protection available): ARIPO (BW, GH, GM, KE, LR, LS, MW, MZ, NA, SD, SL, SZ, TZ, UG, ZM, ZW), Eurasian (AM, AZ, BY, KG, KZ, MD, RU, TJ, TM), European (AL, AT, BE, BG, CH, CY, CZ, DE, DK, EE, ES, FI, FR, GB, GR, HR, HU, IE, IS, IT, LT, LU, LV, MC, MK, MT, NL, NO, PL, PT, RO, RS, SE, SI, SK, SM, TR), OAPI (BF, BJ, CF, CG, CI, CM, GA, GN, GQ, GW, ML, MR, NE, SN, TD, TG).

[Continued on next page]

(54) Title: SHAVING CARTRIDGE WITH A BIASING MEMBER

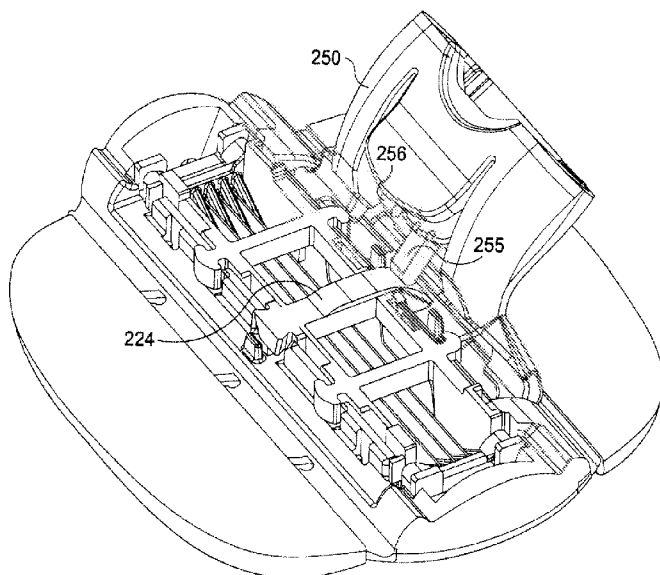

FIG. 4

(57) Abstract: Shaving cartridges intended for connection to handles to form shaving razors wherein the cartridges comprise pivoting hood comprising a biasing member.



WO 2011/130075 A1

Published:

— *with international search report (Art. 21(3))*

SHAVING CARTRIDGE WITH A BIASING MEMBER

5

FIELD OF THE INVENTION

This invention relates to a shaving cartridge that is suitable for mounting to a handle wherein the cartridge includes a pivoting hood with a biasing member.

BACKGROUND OF THE INVENTION

10

Razors for wet shaving typically include a cartridge carried by a handle, the cartridge including an elongate blade with a rectilinear sharpened edge, or a plurality of such blades with parallel edges. The cartridge may be fixedly mounted on the handle with the intention that the entire razor be discarded when the blade edge or edges have become dulled. Alternatively, the cartridge can be detachably connected to the handle to enable replacement of a used cartridge with a fresh cartridge.

15

In the recent past, manufacturers have commercialized razors that exhibit front pivot. For instance, the Fusion® razor, which is commercially available from The Gillette Company, possesses a front pivot as described in US Patent No. 7197825 B2, issued to Vincent Walker et al. on April 4, 2007. In this instance, however, the biasing of the front pivot is achieved by a spring-loaded plunger that is located at a proximate tip of a handle that is paired with the cartridge. Similarly, the Mach3 razor includes a similar handle. In both cases, the spring-loaded plunger of the handle is inserted into and through a hood on a cartridge and interacts with a rear surface of the cartridge to yield biasing of the cartridge during use.

20

Another known shaving device is the M5 Magnum razor, marketed by Persona.

25

Applicant has recognized in the aforementioned products as well as in other shaving razors there seems to be no presence of a cartridge that is biased independent of the handle. Without being limited by theory, it is believed that such a development would aid in improving the contact of the blades with the skin of a shaving consumer.

30

SUMMARY OF THE INVENTION

The present invention features a shaving cartridge that includes a self-biased, front pivoting mechanism. The invention is directed to a shaving cartridge for connection to a handle, the shaving cartridge comprising:

- a) a blade unit having an upper surface and a lower surface wherein said unit further comprises a plurality of blades;
- b) a frame secured to and surrounding said blade unit, said frame comprising a periphery that further comprises a front edge portion, a rear edge portion, and perpendicularly disposed lateral right and left edge portions;
- c) a pivoting hood joined to said frame at said lateral right and left edge portions by opposing arms, said hood forming a pivoting axis forward of said blade unit and within said frame, wherein said pivoting hood further comprises a biasing member having a cam following surface and that extends from said pivoting hood to act on a cam on the lower surface of said blade unit.

The details of one or more embodiments of the invention are set forth in the accompanying drawings and the description below. Other features and advantages of the invention will be apparent from the description and drawings, and from the claims.

BRIEF DESCRIPTION OF THE DRAWINGS

FIG. 1 is a rear perspective view of the cartridge to one embodiment of the invention.

FIG. 2 is a rear perspective view of another cartridge of the present invention which lacks the shaving aid portions.

FIG. 3 is a side view of the cartridge of FIG. 2.

FIG. 4 is a bottom view of another cartridge embodiment of the invention.

FIG. 5 is a bottom view of yet another cartridge embodiment of the invention.

DETAILED DESCRIPTION OF THE INVENTION

The present invention is directed to a shaving cartridge having a front pivoting, self-biased hood. As used herein “front pivot” refers to position a pivot axis of a cartridge in front of plurality of blades contained within a blade unit. It should be understood that the front of the cartridge is at or adjacent to a front edge portion of the cartridge. As used herein, “majority” or “mostly” means greater than 50%, 60%, 70%, 80%, 90%, or even 100% is made of or includes an elastomeric material.

FIG. 1 shows a shaving cartridge 10 according to the present invention. The shaving cartridge comprises a blade unit 20 having an upper surface 25 and a lower surface 28. The blade unit 20 includes a plurality of blades 22. Such blades are disposed in a parallel arrangement in relation to one another and include sharp cutting edges suitable for shaving hair from skin when

5 moved along skin in a direction opposing the cutting edges. The blades may be spring mounted or fixed within a housing 30 of the blade unit. A frame 40 surrounds the blade unit 20. In other words, the blade unit 20 is disposed within aperture 26 of the frame 40. The frame 40 has a periphery that includes a front edge portion 42, a rear edge portion 44, and opposing
10 perpendicularly disposed lateral right and left edge portions 46, 48. A pivoting hood 50 is joined to the frame 40. This joiner occurs at or adjacent to the respect right and left edge portions 46, 48 via opposing arms 49. At the points of joiner of the hood with the frame 40, a pivoting axis forward (in front of) the blade unit 20 is created. The pivoting axis forms a front pivot that is biased against by a biasing member 55 that has a cam following surface 56 at its tip. This cam
15 following surface 56 of the biasing member 55 extends out from the pivoting hood 50 and comes in contact with a cam 24 which is disposed on the lower surface 28 of the blade unit 20. In this instance, the biasing member 55 is a cantilever spring. It is possible, however, that the biasing member 55 may take the form of any other type of spring that is comparable, e.g., a spring loaded plunger (as shown in FIG. 4). At the points where the biasing member 55 contacts the lower
20 surface, i.e., the cam 24, and at the opposing arms 49 of the pivoting hood 50, pivoting of the frame 40 is permitted in only one direction from an at-rest position. The front pivoting hood 50 provides for the biasing of the cartridge 10 to be motivated by a biasing member 55 that is part and parcel of the cartridge 10 versus cartridges known in the prior art which do not include a biasing member. In the previous razors that have been commercially available, a biasing member
25 that interacts with the cartridge (typically on a lower surface) is found at a proximate end of a handle which is contacted with the cartridge.

Also, shown in FIG. 1 are one or more shaving aid portions 60. Each of these shaving aid portions 60 may be supported or mounted onto a wing (not shown). The shaving aid portion 60 is mounted on a wing via a method known to those skilled in the art, e.g., pour molding or
30 extrusion molding. Without being limited by theory, it is Applicant's expectation that the front pivoting caused by the interaction of the hood 50 and the lower surface 28 of the blade unit 20 promotes a more even wearing away of the shaving aid portion during use as well as a more comfortable and natural feeling, i.e., not awkward, shaving experience.

The shaving aid portions 60 of FIG. 1 spans a width of the wing such that the wing tabs
35 (shown in FIG. 2) along a single wing are encompassed within a volume of the shaving aid portion. The shaving aid portion 60 resiliently deflects upon contact with the skin, from a normal, undeflected (concave) position to various flexed positions. This deflection allows the razor to be easily used in hard to reach or confined areas, such as the armpit (axilla) or behind the

knee. Deflection of the shaving aid portion 60 also prevents premature wear of the shaving aid portion 60 and discomfort to the user in cases where the user applies excessive pressure during shaving.

Any desired formulation may be used to form the shaving aid portions 60. In certain
5 embodiments, the shaving aid portions 60 have sufficient wear resistance so that the shaving aid portions last for the intended life of the cartridge. If desired, the frame may be removable and replaceable by the consumer, in which case the shaving aid portions may be exhausted before it is necessary to replace the cartridge.

In some instances, the shaving aid portions 60 may include soap, e.g., poured or extruded
10 soap. Such soap-based compositions may be modified to increase their hardness, wear resistance, lubricity and/or skin moisturizing and conditioning properties.

FIGS. 2 and 3 also show an alternate cartridge 110 of the present invention. This cartridge 110 is shown without a shaving aid portion in order that the wing 170 may be seen. The wing 170 is disposed at the front edge portion 142 and at the rear edge portion 144 of the
15 frame 140. (Again, the frame 140 is surrounding the blade unit 120.) The wing 170 comprises a plurality of wing tabs 172 that extend from a base 174 of the wing 170. The wing 170 may be joined to the frame 140 via mechanical attachment, e.g., snapfitting an underside of the wing into recesses of the frame. Alternatively, the wing may be glued or bonded to the frame. In a particular embodiment, the wing which comprises a majority of elastomeric material may be
20 joined via extruding the elastomeric material into a mold that contains a frame, which might be formed of rigid or semi-rigid plastic. Each wing tab 172 has a proximate end 176 and a distal end 178. In this embodiment, there is shown a retention member 180 that joins one or more of the wing tabs 172 to one another to form a unitary wing. The retention member 180 may span the distance between only two adjacent wing tabs or may span the distances between more than
25 two wing tabs. Moreover, the retention member 180 may be present at the distal ends of the wing tabs (as shown in FIG. 2) or may be disposed between the distal and proximate ends of the respective wing tabs (not shown). In an alternate embodiment, the wing tabs 172 may be independently movable at their respective distal ends 178. The wing comprises mostly elastomeric material and this elastomeric material may have a hardness of less than about 50
30 Shore A, e.g., less than about 40 Shore A. The elastomeric material may be, for example, a block copolymer such as those available under the tradename KRATON®. In certain instances, the elastomeric material has sufficient chemical resistance so that it will not degrade during prolonged contact with the ingredients of the shaving aid portion.

Without being limited by theory, Applicant believes that the elastomeric nature of the wing and the respective wing tabs facilitate the conformation of the various areas of the shaving aid (e.g., left side, right side, center portion) to shape to the skin of a shaving consumer independently as a function of the amount of shaving aid that is worn away during use. For instance, in the event the right side of the shaving aid is worn away more readily than the left side, the elastomeric wing tab(s) on a right side of the wing will be able to press toward the skin to deliver the remaining shaving aid on the right side as long as such shaving aid exists. Likewise, it is anticipated that the various areas of the shaving aid will be able to bias toward the skin independently as required by the shaving consumer's use to deliver shaving aid from the shaving aid portion.

FIG. 4 merely shows the same cartridge as shown in FIG. 1 with the exception of the biasing member 255 which is different. Here, the biasing member 255 is a spring-loaded plunger. It should be noted that in this instance the biasing member 255 is not cooperating with a handle (to which it is paired) to provide any spring loaded biasing. Here, a spring-loaded plunger 256 contained on a handle is inserted through the hood 250 and peeks through the hood. Thus, there are two spring loaded plungers in this embodiment but only one is functional to provide biasing on the cartridge. This configuration allows a user to use a razor handle from one or more commercially available razors with this cartridge embodiment.

FIG. 5 shows a similar cartridge as shown in FIG. 1 with a different biasing member 355. In this case, the biasing member is another embodiment of a spring-loaded plunger. It is envisioned in this instance that a spring-loaded plunger containing handle (as seen in the commercially available Fusion® razor or the Mach3® razor, both which are manufactured by The Gillette Company) may be inserted into the hood 350 to cooperate with the biasing member 355 to provide a front pivoting action to the cartridge during use.

With regard to the cam 24, 224, 324 shown in each of FIGS. 1, 2, 4, and 5, it may have a shape selected from the group consisting of an arc, a slope, and a combination thereof.

The dimensions and values disclosed herein are not to be understood as being strictly limited to the exact numerical values recited. Instead, unless otherwise specified, each such dimension is intended to mean both the recited value and a functionally equivalent range surrounding that value. For example, a dimension disclosed as "40 mm" is intended to mean "about 40 mm".

All documents cited in the Detailed Description of the Invention are, in relevant part, incorporated herein by reference; the citation of any document is not to be construed as an

admission that it is prior art with respect to the present invention. To the extent that any meaning or definition of a term in this document conflicts with any meaning or definition of the same term in a document incorporated by reference, the meaning or definition assigned to that term in this document shall govern.

- 5 While particular embodiments of the present invention have been illustrated and described, it would be obvious to those skilled in the art that various other changes and modifications can be made without departing from the spirit and scope of the invention. It is therefore intended to cover in the appended claims all such changes and modifications that are within the scope of this invention.

CLAIMS

What is claimed is:

1. A shaving cartridge (10) for connection to a handle, said shaving cartridge (10) comprising:
 - a) a blade unit (20) having an upper surface (25) and a lower surface (28) wherein said unit (20) further comprises a plurality of blades (22); and
 - b) a frame (40) secured to and surrounding said blade unit (20), said frame (40) comprising a periphery that further comprises a front edge portion (42), a rear edge portion (44), and perpendicularly disposed lateral right and left edge portions (46, 48);c) a pivoting hood (50) joined to said frame (40) at said lateral right and left edge portions (46, 48) by opposing arms (49) that create a pivoting axis forward of said blade unit (20) and within said frame (40), wherein said pivoting hood (50) further comprises a biasing member (55, 255, 355) having a cam following surface (56) and that extends from said pivoting hood (50) to act on a cam (24) on the lower surface (28) of said blade unit (20),
wherein said biasing member (255) comprises a spring-biased plunger.
2. The shaving cartridge (10) of claim 1 wherein said cam (24) has a shape selected from the group consisting of an arc, a slope, and a combination thereof.
3. The shaving cartridge (10) according to any of the preceding claims wherein said pivoting hood (50) receives a razor handle that comprises an additional biasing member (256).
4. The shaving cartridge (10) according to one or more of the preceding claims wherein said biasing member pushes said blade unit (2) to said lower surface of said frame (40).
5. The shaving cartridge (10) according to one or more of the preceding claims wherein contact between said lower surface of said frame (40) and of said arms (49) of said pivoting hood (50) permit pivoting of said frame (40) in only one direction from an at-rest position.

6. The shaving cartridge (10) according to one or more of the preceding claims wherein said frame (40) comprises a wing (170) disposed on at least one or more of said front and rear edge portions (42, 44) wherein a shaving aid portion (60) is mounted on said wing (170).
7. The shaving cartridge (10) of claim 6 wherein said wing (170) comprises a plurality of wing tabs (172) each having proximate and distal ends (176, 178).
8. The shaving cartridge (10) of claim 7 wherein one or more of the wing tabs (172) are independently movable at their respective distal ends (178).
9. The shaving cartridge (10) of claim 8 wherein the distal ends (178) of one or more of said wing tabs (172) are joined to one another via a retention member (180).
10. The shaving cartridge (10) according to any of claims 6-9 wherein said wing (170) permits conformation of the shaving aid portion (60) to a user's skin surface.
11. The shaving cartridge (10) according to any of claims 6-10 wherein said cartridge (10) comprises an additional wing on an opposing edge of said unit (20) from said first wing (170).

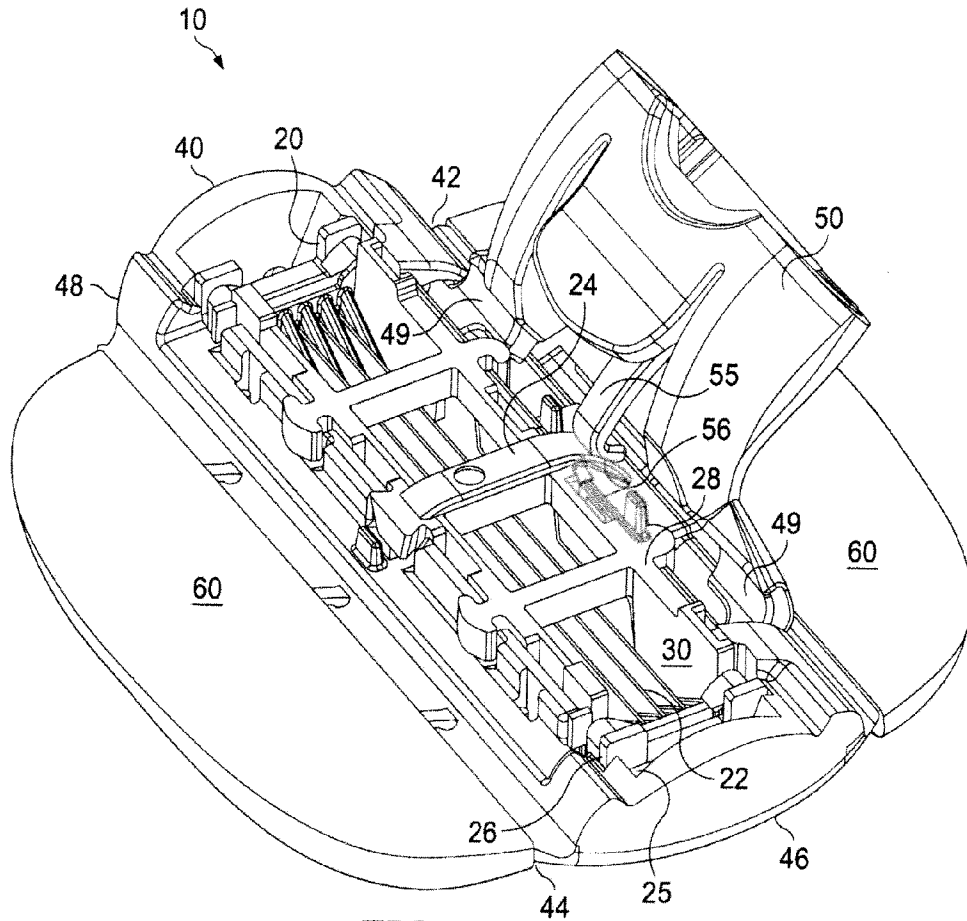

FIG. 1

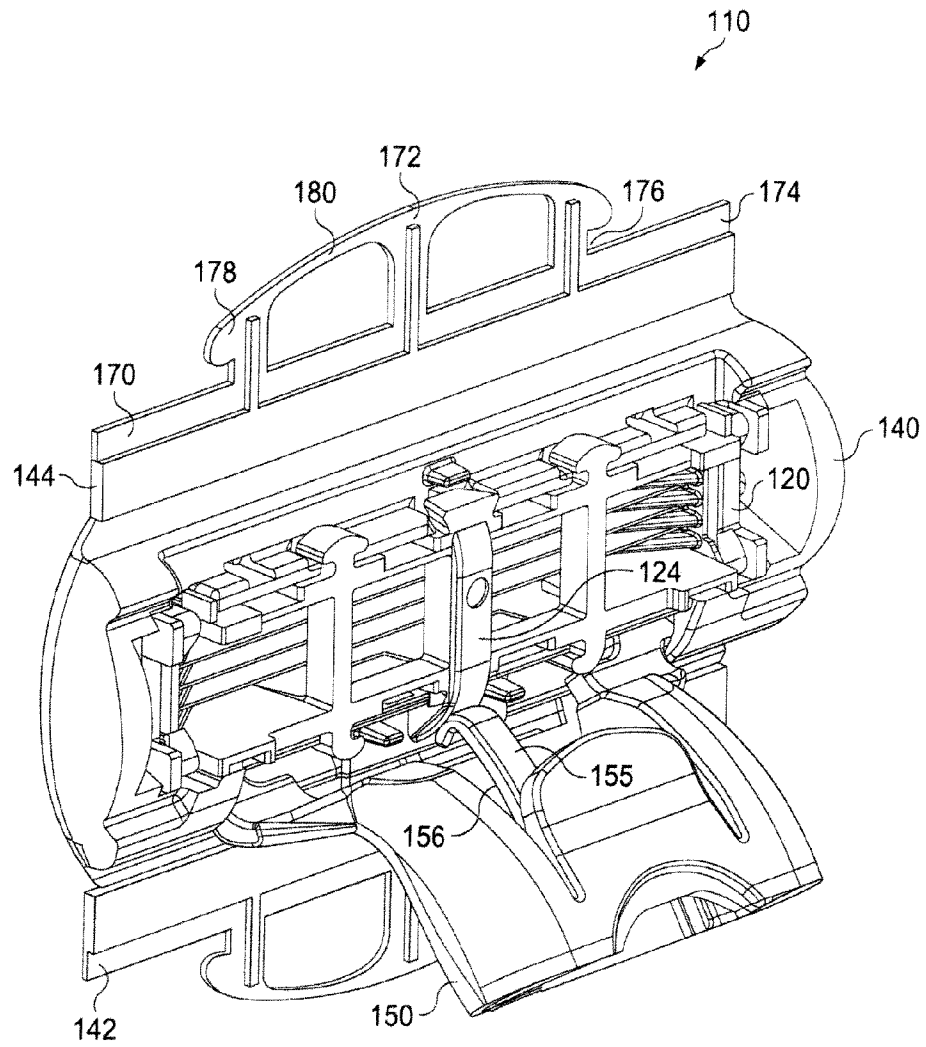

FIG. 2

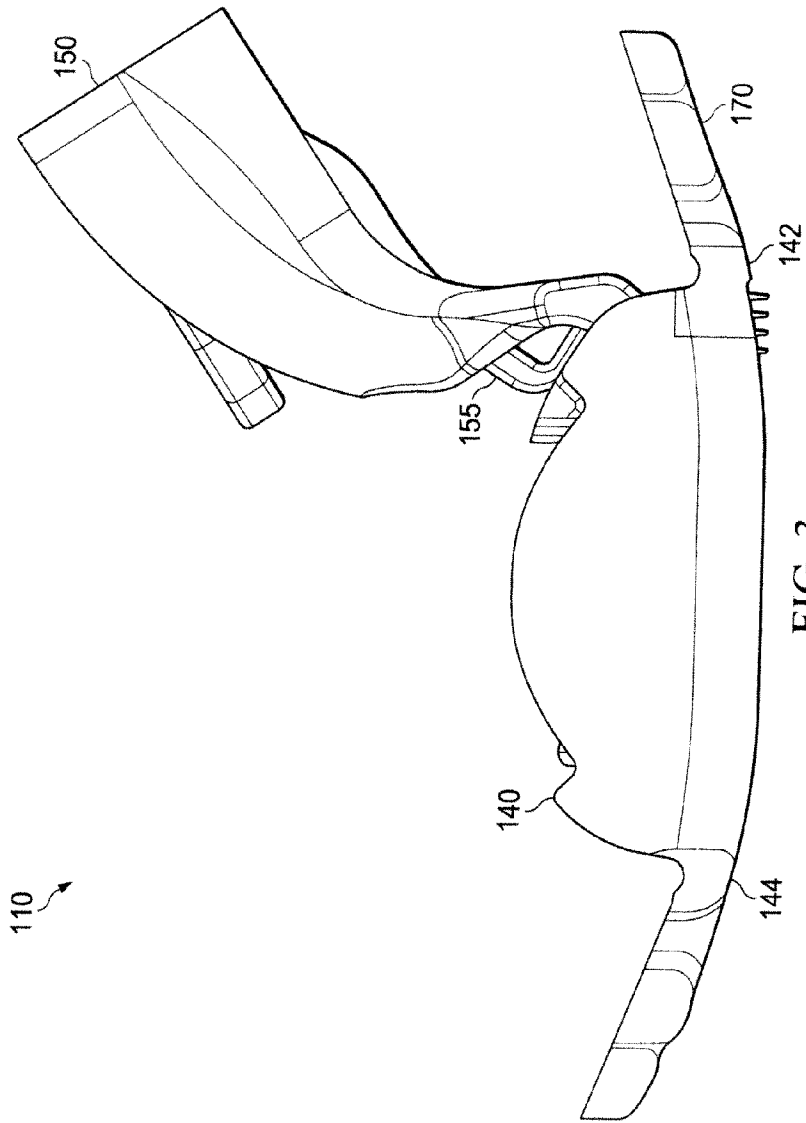

FIG. 3

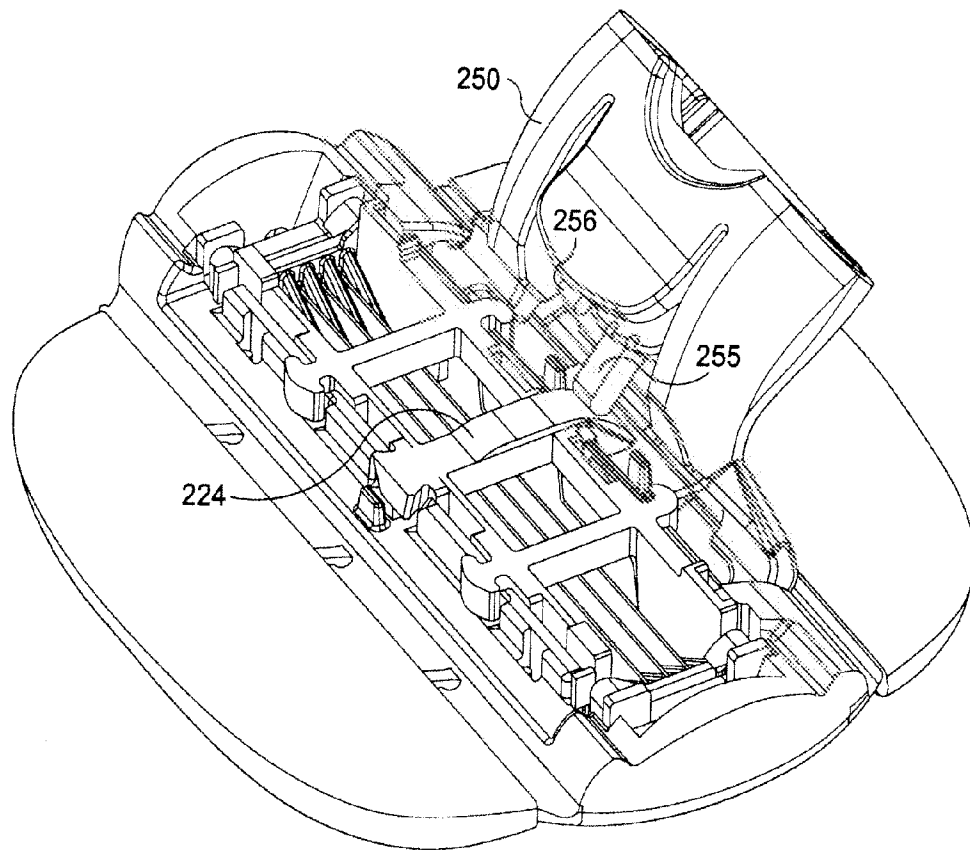

FIG. 4

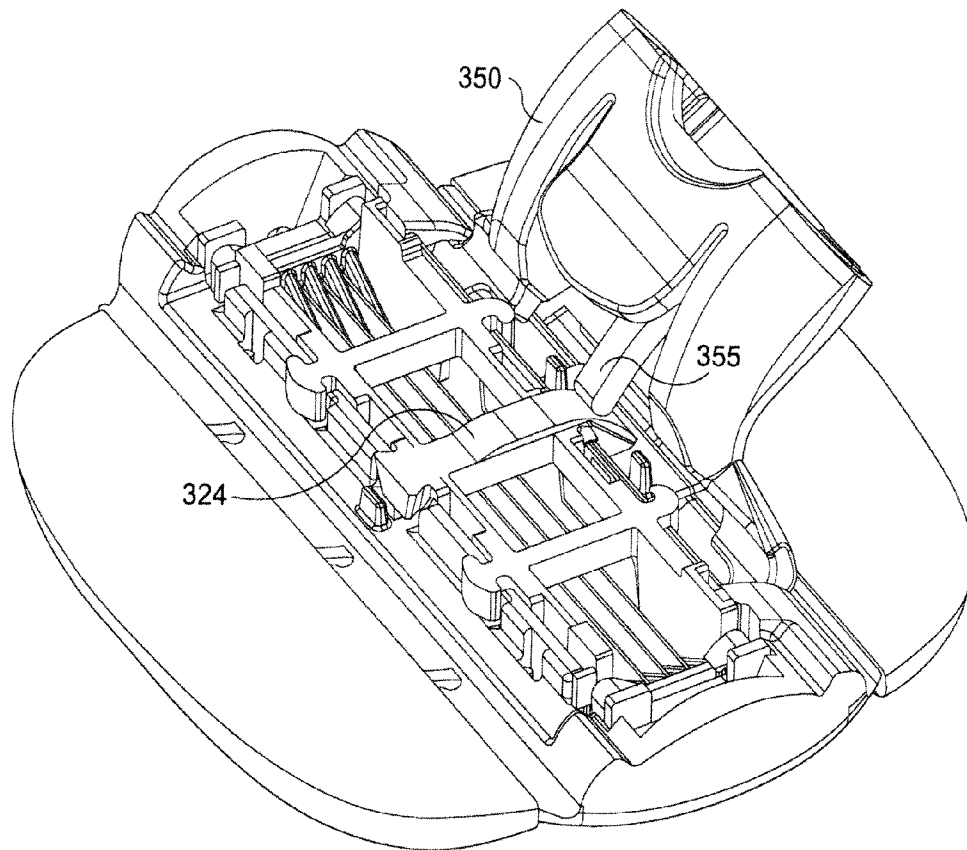

FIG. 5

INTERNATIONAL SEARCH REPORT

International application No
PCT/US2011/031377

A. CLASSIFICATION OF SUBJECT MATTER
 INV. B26B21/22
 ADD.
 According to International Patent Classification (IPC) or to both national classification and IPC

B. FIELDS SEARCHED
 Minimum documentation searched (classification system followed by classification symbols)
 B26B

Documentation searched other than minimum documentation to the extent that such documents are included in the fields searched

Electronic data base consulted during the international search (name of data base and, where practical, search terms used)
 EPO-Internal

C. DOCUMENTS CONSIDERED TO BE RELEVANT

Category*	Citation of document, with indication, where appropriate, of the relevant passages	Relevant to claim No.
X	US 2005/188539 A1 (PRUDDEN JOHN JR [US] ET AL) 1 September 2005 (2005-09-01) the whole document	1-11
A	US 2006/080838 A1 (JOHNSON ROBERT [US] ET AL) 20 April 2006 (2006-04-20) the whole document	1-11
A	WO 2009/027910 A2 (GILLETTE CO [US]; BRUNO MICHAEL HAL [US]; JOLLEY WILLIAM OWEN [US]; PR) 5 March 2009 (2009-03-05) the whole document	1-11

Further documents are listed in the continuation of Box C.

See patent family annex.

* Special categories of cited documents :

- "A" document defining the general state of the art which is not considered to be of particular relevance
- "E" earlier document but published on or after the international filing date
- "L" document which may throw doubts on priority claim(s) or which is cited to establish the publication date of another citation or other special reason (as specified)
- "O" document referring to an oral disclosure, use, exhibition or other means
- "P" document published prior to the international filing date but later than the priority date claimed

- "T" later document published after the international filing date or priority date and not in conflict with the application but cited to understand the principle or theory underlying the invention
- "X" document of particular relevance; the claimed invention cannot be considered novel or cannot be considered to involve an inventive step when the document is taken alone
- "Y" document of particular relevance; the claimed invention cannot be considered to involve an inventive step when the document is combined with one or more other such documents, such combination being obvious to a person skilled in the art.
- "&" document member of the same patent family

Date of the actual completion of the international search
 5 July 2011

Date of mailing of the international search report
 13/07/2011

Name and mailing address of the ISA/
 European Patent Office, P.B. 5818 Patentlaan 2
 NL - 2280 HV Rijswijk
 Tel. (+31-70) 340-2040,
 Fax: (+31-70) 340-3016

Authorized officer
 Cardan, Cosmin

INTERNATIONAL SEARCH REPORT

Information on patent family members

International application No

PCT/US2011/031377

Patent document cited in search report	Publication date	Patent family member(s)	Publication date
US 2005188539	A1	01-09-2005	AT 502744 T 15-04-2011
		AU 2005216963	A1 09-09-2005
		BR PI0507928	A 17-07-2007
		CA 2555052	A1 09-09-2005
		CN 1921990	A 28-02-2007
		EP 1720686	A1 15-11-2006
		JP 4435182	B2 17-03-2010
		JP 2007521933	A 09-08-2007
		KR 20060110368	A 24-10-2006
		RU 2314194	C1 10-01-2008
		US 2008034590	A1 14-02-2008
		WO 2005082584	A1 09-09-2005

US 2006080838	A1	20-04-2006	AR 051139 A1 20-12-2006
		CA 2583203	A1 27-04-2006
		CN 101043983	A 26-09-2007
		EP 1809449	A1 25-07-2007
		JP 2008516729	A 22-05-2008
		KR 20070050102	A 14-05-2007
		RU 2385217	C2 27-03-2010
		WO 2006044395	A1 27-04-2006

WO 2009027910	A2	05-03-2009	AU 2008291733 A1 05-03-2009
		CA 2697973	A1 05-03-2009
		CN 101790444	A 28-07-2010
		EP 2180985	A2 05-05-2010
		JP 2010536458	A 02-12-2010
		KR 20100041856	A 22-04-2010
		US 2010263220	A1 21-10-2010
		US 2009056140	A1 05-03-2009
