

(19) World Intellectual Property Organization
International Bureau



(43) International Publication Date
16 October 2008 (16.10.2008)

PCT

(10) International Publication Number
WO 2008/122762 A1

(51) International Patent Classification:
B64D 11/06 (2006.01) **F16H 19/06** (2006.01)

(74) Agent: **BROOKS, Nigel, Samuel**; Hill Hampton, East Meon, Petersfield, Hampshire GU32 1QN (GB).

(21) International Application Number:
PCT/GB2008/001162

(81) Designated States (unless otherwise indicated, for every kind of national protection available): AE, AG, AL, AM, AO, AT, AU, AZ, BA, BB, BG, BH, BR, BW, BY, BZ, CA, CH, CN, CO, CR, CU, CZ, DE, DK, DM, DO, DZ, EC, EE, EG, ES, FI, GB, GD, GE, GH, GM, GT, HN, HR, HU, ID, IL, IN, IS, JP, KE, KG, KM, KN, KP, KR, KZ, LA, LC, LK, LR, LS, LT, LU, LY, MA, MD, ME, MG, MK, MN, MW, MX, MY, MZ, NA, NG, NI, NO, NZ, OM, PG, PH, PL, PT, RO, RS, RU, SC, SD, SE, SG, SK, SL, SM, SV, SY, TJ, TM, TN, TR, TT, TZ, UA, UG, US, UZ, VC, VN, ZA, ZM, ZW.

(22) International Filing Date: 2 April 2008 (02.04.2008)

(25) Filing Language: English

(26) Publication Language: English

(30) Priority Data:
0706776.2 5 April 2007 (05.04.2007) GB

(84) Designated States (unless otherwise indicated, for every kind of regional protection available): ARIPO (BW, GH, GM, KE, LS, MW, MZ, NA, SD, SL, SZ, TZ, UG, ZM, ZW), Eurasian (AM, AZ, BY, KG, KZ, MD, RU, TJ, TM), European (AT, BE, BG, CH, CY, CZ, DE, DK, EE, ES, FI, FR, GB, GR, HR, HU, IE, IS, IT, LT, LU, LV, MC, MT, NL, NO, PL, PT, RO, SE, SI, SK, TR), OAPI (BF, BJ, CF, CG, CI, CM, GA, GN, GQ, GW, ML, MR, NE, SN, TD, TG).

(71) Applicant (for all designated States except US): **PREMIUM AIRCRAFT INTERIORS UK LIMITED** [GB/GB]; Watchmoor Point, Camberley, Surrey GU15 3EX (GB).

(72) Inventors; and

(75) Inventors/Applicants (for US only): **HANKINSON, Christopher** [GB/GB]; Winy Hollow, Hazles Cross Road, Kingsley, Staffordshire ST10 2AY (GB). **SAMUELS, Benedict, Nicholas** [GB/GB]; 6 Rammell Mews, Frythe Way, Cranbrook, Kent TN17 3BQ (GB).

Published:

- with international search report
- before the expiration of the time limit for amending the claims and to be republished in the event of receipt of amendments

(54) Title: MOVABLE FURNITURE

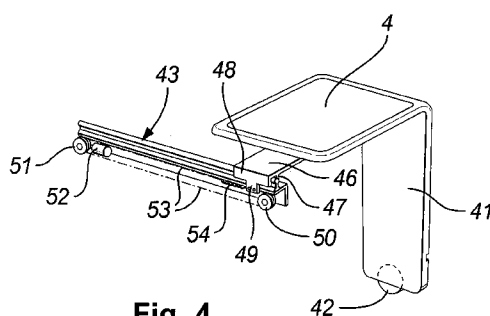

Fig. 4

(57) Abstract: An aircraft seat cubicle (1) has a seat (2) convertible to a bed, a foot rest or ottoman (3), a table (4) and a light (6), each movable lengthways L of the cubicle. The table has a leg (41), with a wheel (42) for support of one side of the table off the floor (7) of the cubicle. On the other side, the cubicle has a shelf (9) with a track (43) for support of this side of the table set inside a side panel (10) at a slot (11). The track has a rail (44) mounted on a support angle (45). The table has a tongue (46), which extends into the slot to the track, with a bearing extrusion (47) of low friction material engaged on the rail. It has a drive connection flange (48) fixed on its side away the slot. The flange has a depending lug (49). At the end of the support angle remote from the seat, a free running pulley (50) is provided with its top in line with the lug. At the opposite end of the support angle, a further pulley (51) is provided with a reduction drive motor (52). The motor is connected to a controller and is operated by a user via a control panel (11). A drive cable (53) passes around the two pulleys and is attached to the lug (49). The table can be driven towards or away from the seat. When the motor is stopped, the reduction gearing associated with the motor keeps the table in position. However, a tension spring (54) is connected in line with the cable at the lug (49), between the lug and the motor pulley (51). This arrangement is such that pushing of the table away from the seat stretches the spring, with concomitant relaxing of the tension in the run of the cable to the other pulley (50) and back to the return side of the pulley (51). This relaxation releases the capstan effect on the cable, with the result that the cable can slip on the pulley. Thus the table can be pushed away from the seat.



WO 2008/122762 A1

MOVABLE FURNITURE

The present invention relates to movable furniture for an aircraft convertible seat cubicle.

5

The object of the present invention is to provide improved movable furniture for an aircraft convertible seat cubicle.

According to the invention there is provided movable furniture for an aircraft
10 convertible seat cubicle comprising:

- an item of furniture movable lengthways of the cubicle;
- a lengthways track at one side of the cubicle for the furniture;
- a runner attached to the furniture and received on the track;
- a capstan at one end of the track for driven movement of the item of furniture;
- 15 • a pulley at the other end of the track; and
- a cable passing around both the capstan and the pulley and attached at its ends to the runner and/or the item of furniture for moving the latter by means of the capstan.

20 In the preferred embodiment, the line has a spring in its extent towards the seat, whereby pushing of the furniture away from the seat tends to extend the spring and release tension in the line, allowing the line to slip on the capstan.

Where the item of furniture is of a size to extend at least substantially across
25 the width of the cubicle, it preferably has a wheel for rolling on the floor opposite from the track and sharing the weight of the furniture with the track. Such item can be can be a table or an ottoman/foot rest.

Where the item of furniture is provided at or towards the track side of the
30 cubicle, the track in co-operation with the runner preferably provides restraint against rotation of the item about an axis parallel with the track. Such an item can be a lamp.

To help understanding of the invention, a specific embodiment thereof will now be described by way of example and with reference to the accompanying drawings, in which:

Figure 1 is a perspective view from one side of an aircraft convertible seat cubicle having furniture movable in accordance with the invention;

Figure 2 is a similar view from the other side;

Figure 3 is a perspective view of a movable table for the seat of Figure 1, together with its support track;

Figure 4 is a similar perspective view of the table from another direction;

Figure 5 is a similar perspective view of a light and its support track.

Referring to the drawings, a cubicle 1 has a seat 2 convertible to a bed. The seat has a mechanism, which is the subject of another application filed on the same day as this application under Nigel Brooks reference 2769.

The cubicle also has a foot rest or ottoman 3, a table 4 and a light 6, each movable lengthways L of the cubicle.

The mechanism for moving the table will be described first. The table has a leg 41, with a wheel 42 for support of one side of the table off the floor 7 of the cubicle on an access side 8 thereof. On the other side, the cubicle has a shelf 9 with a track 43 for support of this side of the table set inside a side panel 10 at a slot 11.

The track has a rail 44 mounted on a support angle 45. The table has a tongue 46, which extends into the slot to the track, with a bearing extrusion 47 of low friction material engaged on the rail. The extrusion is of a length to guide the table without risk of jamming. It has a drive connection flange 48 fixed on its side away the slot. The flange has a depending lug 49.

At the end of the support angle remote from the seat, a free running pulley 50 is provided with its top in line with the lug. The pulley has a revolution counter (not shown) for transducing to a controller (also not shown) the position of the table. At the opposite end of the support angle, a further pulley 51 is provided with a reduction drive motor 52. The motor is connected to the controller and is operated by a user via

a control panel 11. A drive cable 53 passes around the two pulleys and is attached to the lug 49.

5 The table can be driven towards or away from the seat. When the motor is stopped, the reduction gearing associated with the motor keeps the table in position. However, a tension spring 54 is connected in line with the cable at the lug 49, between the lug and the motor pulley 51. This arrangement is such that pushing of the table away from the seat stretches the spring, with concomitant relaxing of the tension in the run of the cable to the other pulley 50 and back to the return side of the
10 pulley 51. This relaxation releases the capstan effect on the cable, with the result that the cable can slip on the pulley. Thus the table can be pushed away from the seat.

On the other hand, the table cannot be pulled towards the seat and must be driven under control of the panel 11. This one way action is likely to be convenient to
15 a passenger in that quick and easy pushing of the table away for a visit to the lavatory or when preparing to sleep will be appreciated, whereas driving the table back for eating or working is unlikely to be thought an a disadvantage. Further in an emergency, the table will free run away from the passenger but will not free run back towards the passenger.

20

The ottoman has an exactly analogous arrangement at a further panel slot 12. This will not be described in repetitive detail.

The light 60 has a similar arrangement, but with differences. At a slot 14 in
25 the shelf 9, a leg 61 of the light extends up from a carrier 62 bearingly mounted on a pair of rods 63 mounted beneath the slot on a sub-frame 64. This has a front, free-running pulley 65 and a motor driven rear pulley 66. A cable 67 passes from the carrier, around one pulley, to the other and back to the carrier. A spring can be provided in the run of the cable to either pulley allowing the light to be pushed freely
30 in the direction extending the spring. However, it will generally be adequate to allow the light to be driven in either direction of the slot 14 by its motor under control from the panel 11.

CLAIMS:

1. Movable furniture for an aircraft convertible seat cubicle comprising:

- an item of furniture movable lengthways of the cubicle;
- a lengthways track at one side of the cubicle for the furniture;
- 5 • a runner attached to the furniture and received on the track;
- a capstan at one end of the track for driven movement of the item of furniture;
- a pulley at the other end of the track; and
- a cable passing around both the capstan and the pulley and attached at its ends to the runner and/or the item of furniture for moving the latter by means of the
- 10 capstan.

2. Movable furniture as claimed in claim 1, wherein the line has a spring in its extent towards a seat in the cubicle, whereby pushing of the item of furniture away from the seat tends to extend the spring and release tension in the line, allowing the line to slip on the capstan for movement of the item of furniture.

15 3. Movable furniture as claimed in claim 1 or claim 2, wherein the item of furniture is of a size to extend at least substantially across the width of the cubicle and it has a wheel for rolling on a floor of the cubicle opposite from the track and sharing the weight of the furniture with the track.

4. Movable furniture as claimed in claim 3, wherein the item of furniture is a table.

20 5. Movable furniture as claimed in any preceding claim, wherein the item of furniture, or an additional item of furniture, is an ottoman/foot rest.

6. Movable furniture as claimed in any preceding claim, wherein the item of furniture, or an additional item of furniture, is provided at or towards the track side of the cubicle, the track in co-operation with the runner providing restraint against

25 rotation of the item about an axis parallel with the track.

7. Movable furniture as claimed in claim 6, wherein the item of furniture, or the additional item of furniture is a lamp.

1/4

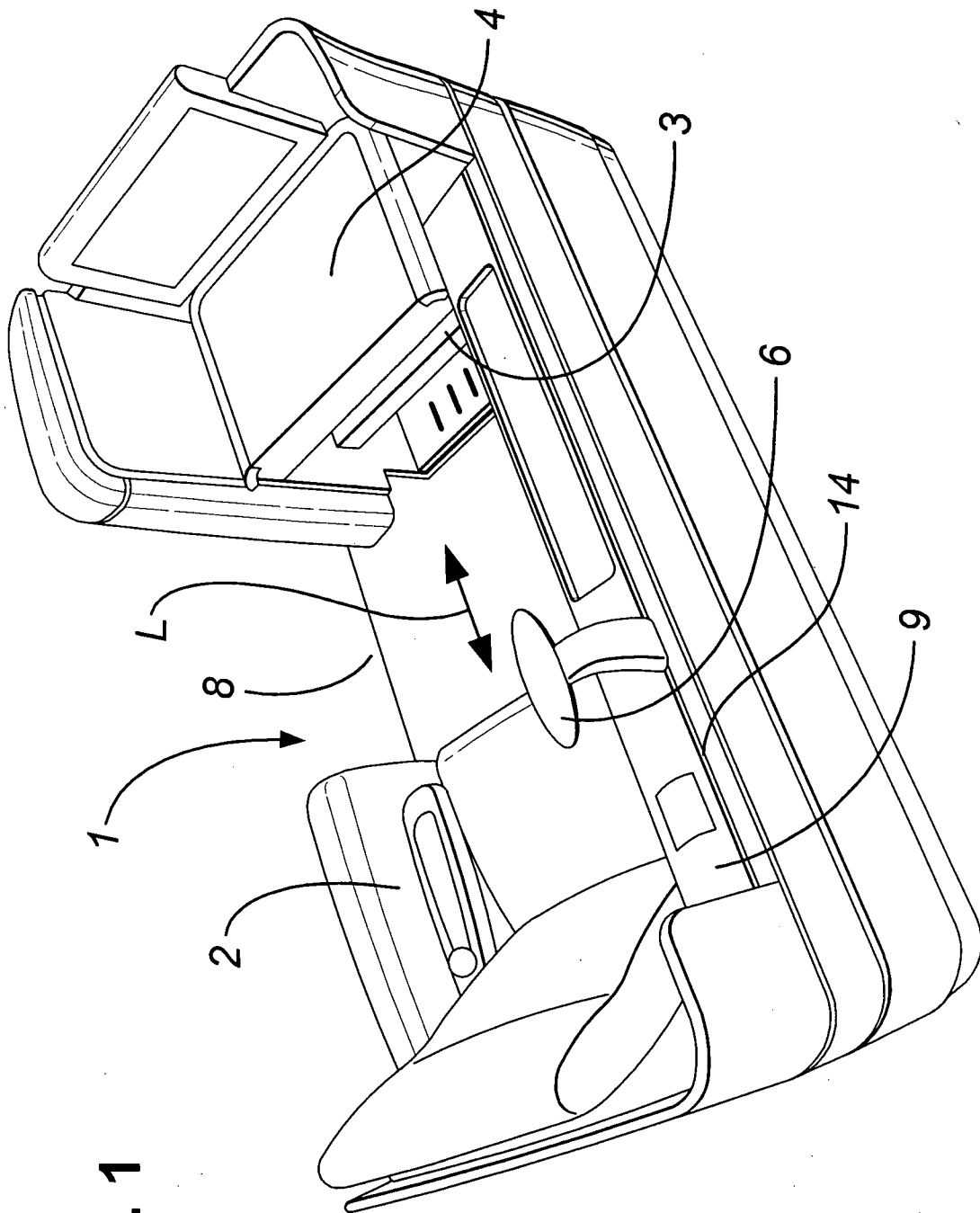

Fig. 1

2/4

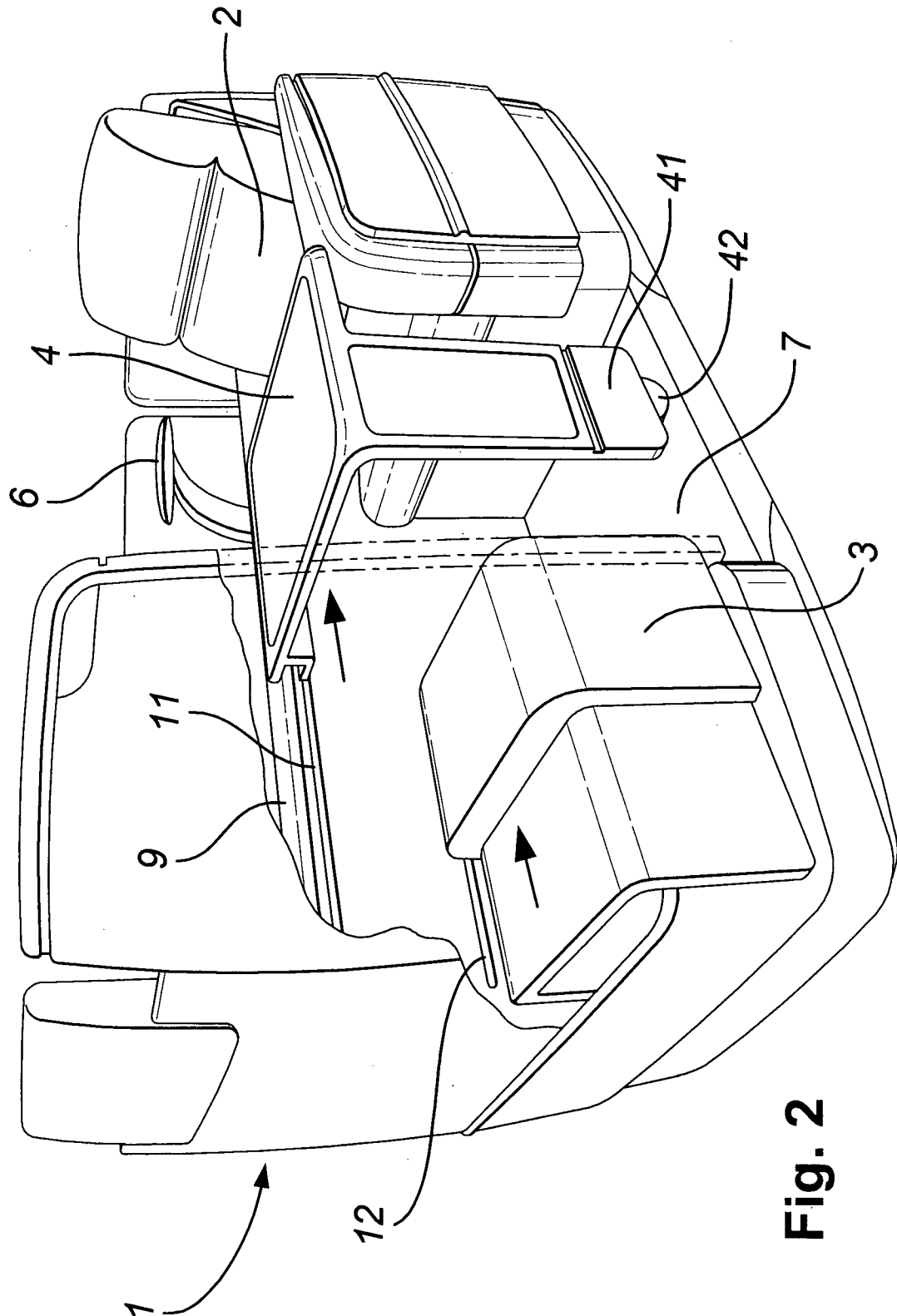
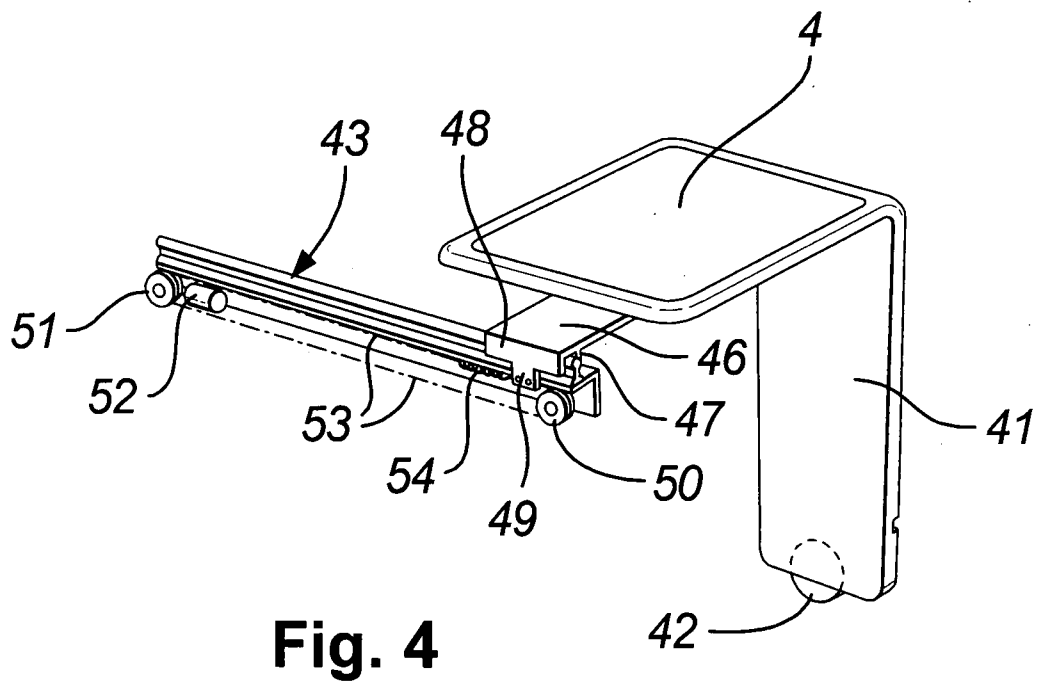
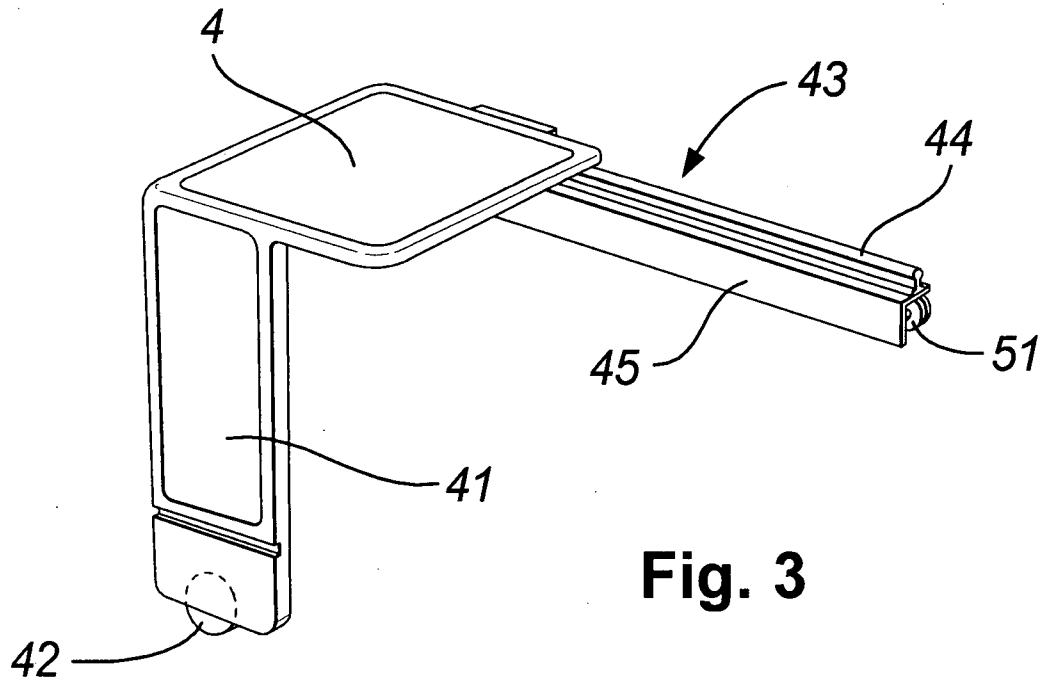

Fig. 2

3/4



4/4

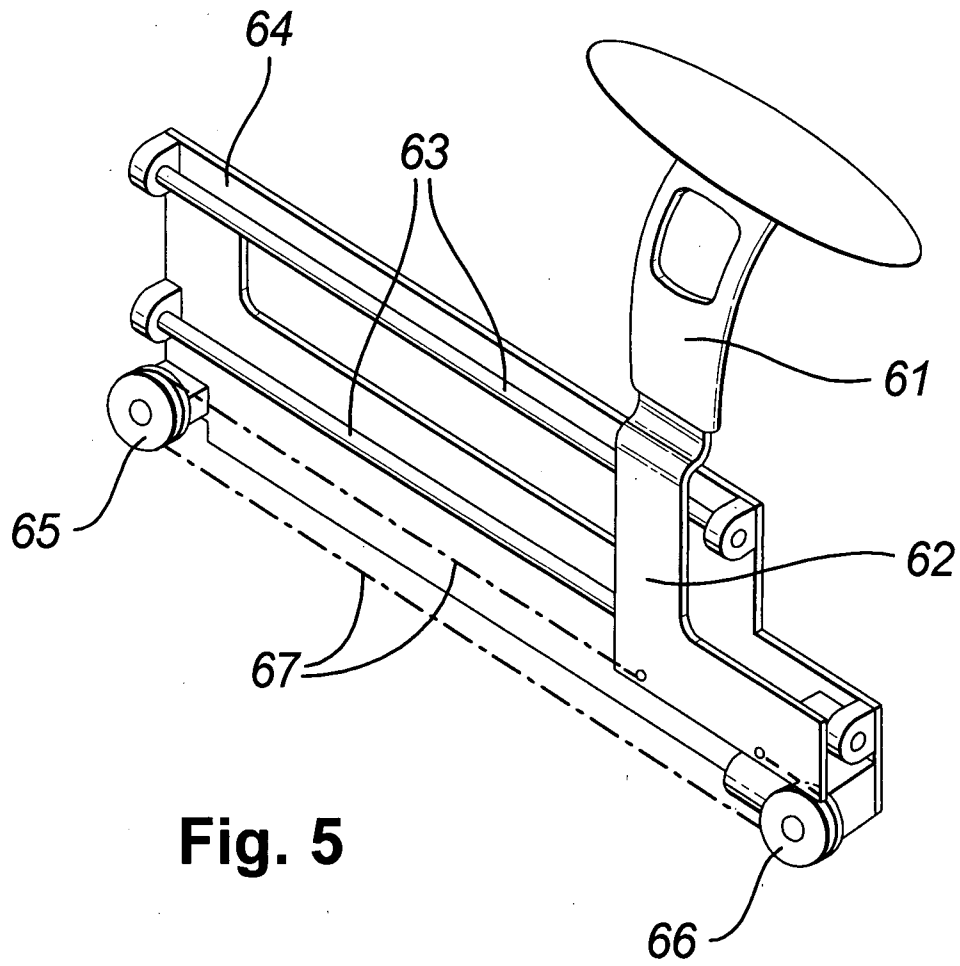

Fig. 5

INTERNATIONAL SEARCH REPORT

International application No
PCT/GB2008/001162

A. CLASSIFICATION OF SUBJECT MATTER
INV. B64D11/06 F16H19/06

According to International Patent Classification (IPC) or to both national classification and IPC

B. FIELDS SEARCHED

Minimum documentation searched (classification system followed by classification symbols)
F16H B64D

Documentation searched other than minimum documentation to the extent that such documents are included in the fields searched

Electronic data base consulted during the international search (name of data base and, where practical, search terms used)

EPO-Internal, WPI Data

C. DOCUMENTS CONSIDERED TO BE RELEVANT

Category*	Citation of document, with indication, where appropriate, of the relevant passages	Relevant to claim No.
X	WO 2007/009135 A (BLUM GMBH JULIUS [AT]; HUBER EDGAR [AT]) 25 January 2007 (2007-01-25) page 6, line 32 - page 7, line 2 page 7, lines 5-9 figures 3,4b,5	1-7
A	GB 2 152 180 A (CITIZEN WATCH CO LTD) 31 July 1985 (1985-07-31) page 1, lines 62-85 figure 1	1,2
A	EP 0 227 251 A (BURROUGHS CORP [US]) 1 July 1987 (1987-07-01) column 1, lines 1-5 column 1, line 46 - column 2, line 43 column 3, line 15 - column 5, line 12 figure 1	1
	----- -/--	

☒ Further documents are listed in the continuation of Box C.

☒ See patent family annex.

* Special categories of cited documents :

- *A* document defining the general state of the art which is not considered to be of particular relevance
- *E* earlier document but published on or after the international filing date
- *L* document which may throw doubts on priority claim(s) or which is cited to establish the publication date of another citation or other special reason (as specified)
- *O* document referring to an oral disclosure, use, exhibition or other means
- *P* document published prior to the international filing date but later than the priority date claimed

- *T* later document published after the international filing date or priority date and not in conflict with the application but cited to understand the principle or theory underlying the invention
- *X* document of particular relevance; the claimed invention cannot be considered novel or cannot be considered to involve an inventive step when the document is taken alone
- *Y* document of particular relevance; the claimed invention cannot be considered to involve an inventive step when the document is combined with one or more other such documents, such combination being obvious to a person skilled in the art.
- *G* document member of the same patent family

Date of the actual completion of the international search

29 August 2008

Date of mailing of the international search report

04/09/2008

Name and mailing address of the ISA/
European Patent Office, P.B. 5818 Patentlaan 2
NL - 2280 HV Rijswijk
Tel. (+31-70) 340-2040, Tx. 31 651 epo nl,
Fax: (+31-70) 340-3016

Authorized officer

Fernández Plaza, P

INTERNATIONAL SEARCH REPORT

International application No
PCT/GB2008/001162

C(Continuation). DOCUMENTS CONSIDERED TO BE RELEVANT

Category*	Citation of document, with indication, where appropriate, of the relevant passages	Relevant to claim No.
A	<p>EP 1 116 654 A (BE AEROSPACE INC [US]) 18 July 2001 (2001-07-18) paragraphs [0010], [0016], [0017], [0025], [0027] figures 2,4</p> <p>-----</p>	1,5

INTERNATIONAL SEARCH REPORT

Information on patent family members

International application No

PCT/GB2008/001162

Patent document cited in search report		Publication date	Patent family member(s)	Publication date
WO 2007009135	A	25-01-2007	AT 502204 A1	15-02-2007
			AU 2006272412 A1	25-01-2007
			CN 101217899 A	09-07-2008
			EP 1903909 A2	02-04-2008
			US 2008115417 A1	22-05-2008
GB 2152180	A	31-07-1985	DE 3447453 A1	11-07-1985
			FR 2557507 A1	05-07-1985
			JP 1031492 Y2	27-09-1989
			JP 60109952 U	25-07-1985
			KR 880003808 Y1	22-10-1988
			US 4653948 A	31-03-1987
EP 0227251	A	01-07-1987	DE 3669688 D1	26-04-1990
			GB 2183771 A	10-06-1987
			JP 62196166 A	29-08-1987
			US 4804285 A	14-02-1989
EP 1116654	A	18-07-2001	DE 60111277 D1	14-07-2005
			DE 60111277 T2	08-12-2005
			US 6352309 B1	05-03-2002