

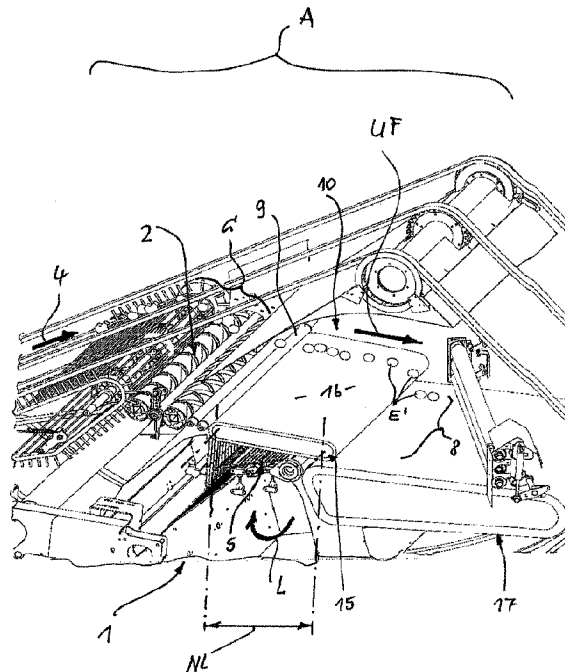

(22) **Date de dépôt/Filing Date:** 2015/05/08  
(41) **Mise à la disp. pub./Open to Public Insp.:** 2015/11/10  
(45) **Date de délivrance/Issue Date:** 2022/12/06  
(30) **Priorité/Priority:** 2014/05/10 (DE10 2014 006 842.0)

(51) **Cl.Int./Int.Cl.** **A01D 33/04** (2006.01),  
**A01D 13/00** (2006.01), **A01D 33/08** (2006.01)  
(72) **Inventeurs/Inventors:**  
DETTMER, FRANZ-JOSEF, DE;  
DOHMANN, CHRISTIAN, DE  
(73) **Propriétaire/Owner:**  
GRIMME LANDMASCHINENFABRIK GMBH & CO. KG,  
DE  
(74) **Agent:** MARKS & CLERK

(54) **Titre : DISPOSITIF SEPARATEUR POUR APPAREIL DE RECOLTE DE POMMES DE TERRE**  
(54) **Title: SEPARATING DEVICE FOR A POTATO HARVESTER**



(57) **Abrégé/Abstract:**

Potato harvesting machines or processing machines for separating potatoes or similar crop from a mixture with clods, rocks, and similar solid bodies are provided with a separating device. By means of the conveying device which supplies the substantially compact mixture, the mixture moved into the area of at least one drop stage is separated. For this purpose, at least one retaining element oriented opposite to the falling separated goods and interacting with the at least one air stream is used in such a way that crop and the solid bodies can be conveyed farther separately in substantially oppositely extending conveying direction, respectively. An optimal utilization of the device for varying harvesting conditions is achieved according to the invention in that the at least one supplied conveyed stream can be diverted at least partially in the area upstream of the retaining element.

### Abstract

Potato harvesting machines or processing machines for separating potatoes or similar crop from a mixture with clods, rocks, and similar solid bodies are provided with a separating device. By means of the conveying device which  
5 supplies the substantially compact mixture, the mixture moved into the area of at least one drop stage is separated. For this purpose, at least one retaining element oriented opposite to the falling separated goods and interacting with the at least one air stream is used in such a way that crop and the solid  
10 bodies can be conveyed farther separately in substantially oppositely extending conveying direction, respectively. An optimal utilization of the device for varying harvesting conditions is achieved according to the invention in that the at least one supplied conveyed stream can be diverted at least partially in the area upstream of the retaining element.

## Separating Device for a Potato Harvester

5 The invention concerns a separating device for a potato harvesting machine or a processing machine for separating a crop from a mixture comprising the crop and admixtures.

Different method variants are known for machines and devices for root crop treating and processing, in particular potato harvesting machines. In particular  
10 for separation of potatoes and similar crop from a picked-up soil mixture with clods, rocks, similar solid bodies as well as fibrous admixtures, different concepts of mechanical separating devices with belts and screens are used (company brochure Grimme Landmaschinenfabrik GmbH & Co. KG, Damme; "Produktprogramm" (*translation: product line*); GEN.00283, 08/13/5000;  
15 Erntetechnik (*translation: harvesting technology*); pp 14 to 23 ).

In a solution according to DE 10 2012 016 057 A1 for affecting the mixture that has been picked up by potato harvesting machine, an air stream is additionally utilized which is acting in the area of a retaining element onto the  
20 goods to be separated moved by a conveyor across a drop stage. This air stream is directed onto the mixture that is present in loosened form in the area of the retaining element so that, in the area of a fluidic separating bed, assistance is provided for a further activated transport of crop and solid bodies in oppositely extending conveying directions.

25 EP 1 133 909 A2 discloses a root crop harvesting machine that comprises a system with several belt conveyors. The latter can be pivoted into variable active positions. A fluidic separation is not provided in any of the conveying areas. A conveying device for beets according to DE 43 38 477 A1 comprises  
30 rod conveyor belts operating as steep conveying devices so that, in combination with flat conveyors, the cleaning process is improved. A fluidic separation is not provided in this device.

The invention may address the problem of designing a potato harvesting machine provided with a fluidic separating device in such a way that with minimal technical expenditure the operation of the machine can be retrofitted in accordance with changing harvesting conditions and, in this way, an  
5 optimal mixture separation is enabled at reduced energy expenditure.

10

For improving the potato harvesting machine that is cooperating with a fluidic separating device according to DE 10 2012 016 057 A1, in particular a reduction of the energy expenditure required for the total system is provided in conjunction with at least constant separating quality. For this purpose, in  
15 particular a selective activation or deactivation of separating and cleaning components of the machine is to be employed. Based on this, the system according to the invention with the integrated separating device is now improved such that this machine is provided with the option that the conveyed stream of the mixture can bypass the active area of the separating device. In  
20 this diverting phase, it is then, at least temporarily, also possible to operate at reduced output or to switch off the air stream or appropriate auxiliary components of the separating device.

In regard to the overall complex conveyed stream of the mixture in the  
25 machine, it is provided that the at least one supplied conveyed stream is at least partially divertable in the area upstream of the retaining element.

In this context, the conveyed stream that is supplied by the generally known conveying device is guided such that it can then be discharged, in particular  
30 without contact with the retaining element of the separating device, directly into a downstream and/or adjacently positioned conveying zone. This concept of diverting the conveyed stream is preferably geared to using a constructively variable mechanism of action in the area of a terminal element of the

conveying device. Also conceivable is that the provided diverting action of the conveyed stream is connected immediately in the area of the conveying device or that an active component group is installed at its input elements.

- 5 The constructively optimal realization of this mixture guiding action according to the invention provides that in the area of the retaining element a diverting component group is arranged that acts at least as a bypass. This diverting component group can be positioned in widely variable positions of use in such a way that dividing of the conveyed stream by means of the diverting
- 10 component group is also possible. The structure of the diverting component group is to be adjusted in this context to flexible conveying conditions wherein the diverting component group advantageously may also be assembled of several guiding elements. These guiding elements themselves can be movable and/or slidable individually so that variable diverting directions in
- 15 different diverting zones or bypass structures are possible.

For an optimal utilization of the machine in the area of the integrated separating device, it is possible that at least one of the guiding elements or the entire diverting component group is embodied as a construction that can

20 be operated by hand. Accordingly, the machine can be furnished prior to a respective use or the system is retrofitted during a processing break.

The expedient configuration of the diverting component group provides that it is formed as a bridge that at least partially bridges the retaining element. This

25 variable construction that is variable with regard to its bridging length can also be extended in further embodiments into the effective range of the conveying device that is supplying the mixture.

In the simplest embodiment, it is provided that the bridge that is provided with

30 a slide plate forming a transport slant is movable by hand into the position of use. In this way, a "passive" bridge is integrated into the system in which the slide plate is effective as a variably usable guiding element. This passive bridge can be provided preferably with a screen structure in the area of the

slide plate that forms the transport slant so that in this way an additional cleaning function can be initiated on the mixture. Also, it is conceivable that the slide plate is designed to be adjustable to different transport slants. By means of this adjustment, the mixture discharge upon transfer from the  
5 conveying stretch can be affected.

The bridge forms a component group that can be additionally integrated into the machine concept wherein it can be provided as a pre-assembled unit and, due to its constructive configuration, inserting or pivoting into the position of  
10 use can be realized.

Based on the afore described embodiments of the diverting component group in the form of the guiding elements and the "passive" bridge, it is provided that these component groups can also be provided with a controllable drive,  
15 respectively, for improved control and governing operations. These component groups as a whole or the functional individual parts can be adjusted with electrical or hydraulic drive members and their variable control units to different harvesting conditions.

20 A first embodiment of this "driven" diverting component group provides that it is embodied in the form of a conveying unit that comprises a motoric rotary drive. In this context, a screen belt can be used as a conveying unit, for example. For optimal positioning in the also variable position of use, it can be provided with a pivotable and/or slidable support connection in the frame of  
25 the machine. Accordingly, this conveying unit can remain as a permanent component within the machine and the demand-oriented activation or deactivation of this diverting system is possible with minimal expenditure.

30 In some embodiments, the diverting component group is configured to be positioned in an inactive position of use such that a division of the at least one conveyed stream is realized.

Accordingly, the cleaning process of the mixture occurring within the machine

can be further assisted and the "double function" of this screen belt can be effectively realized.

5 An advantageous embodiment of the system provides that the diverting component group or the conveying unit provided therefor can be pivoted or pushed at least sectionwise into a position of use interacting with the air stream of the separating device. Based on the available space within the machine, different pivoting zones can thus be bridged so that corresponding functional effects and additional discharge functions can be fulfilled.

10

In particular, it is provided that the conveying unit provided with the screen belt is movable in the area of a discharge belt provided downstream of the retaining element. This movement can be realized in different positions of use such that separated goods or mixture components, moved by a blowing  
15 movement action out of the area of the activated separating device, are collected by the optimally positioned screen belt, transported farther within the machine, and directly discharged therefrom.

20 A further constructive configuration for diverting the conveyed stream in the area of the retaining element provides that now in the area of the conveying device that supplies the mixture at least one transfer device is provided that can be changed with regard to its transport length. This transfer device is located in particular at the end of a diverting zone that conveys the mixture upwardly and is arranged immediately in front of the fluidic separating bed  
25 with the retaining element. In this context, it is in principle conceivable to introduce a partial stream of the air stream also into the area of the transfer device.

30 The optimal embodiment of the transfer device provides that it is designed as a screen belt that, by means of an in particular spring-elastic component group, can be moved into different positions of use. Preferably, the screen belt is provided with an adjusting spring that exerts a permanent tensioning force onto the screen belt and engages the return run of the screen belt by

means of a roller deflection.

The support of the screen belt in the area of the changeable transport length is realized by means of two deflection rollers, wherein one is  
5 stationarily supported and the other can be moved by means of a lifting cylinder against the adjusting spring such that the working run of the screen belt is extended. The drive action is introduced by the stationary lifting cylinder whose piston rod engages the displaceable deflecting roller.

10 According to an aspect of the present invention, there is provided a separating device for a potato harvesting machine or a processing machine for separating a crop from a mixture comprising the crop and admixtures, the separating device comprising:

a drop stage that effects loosening of the mixture;

15 a conveying device supplying the mixture in at least one conveyed stream to the drop stage, wherein the mixture in the at least one conveyed stream falls onto a retaining element arranged downstream of the drop stage so as to face the falling mixture;

20 a blower that functions as a separation means, wherein the blower supplies a conveying medium in the form of an air stream;

wherein the air stream is directed onto the mixture that is present in an area of the drop stage and onto the mixture that is present in an area of the retaining element, and the air stream is configured to separate the crop and the admixtures,

25 wherein downstream of the retaining element the crop and the admixtures separated from the mixture are transported farther as separated individual parts in a first conveying direction and a second conveying direction, respectively; and

30 diverting means configured to completely divert, when activated, the at least one conveyed stream upstream of the retaining element and to discharge the at least one conveyed stream supplied by the conveying

device directly into a downstream and/or adjacently positioned conveying zone without contacting the retaining element, wherein the retaining element and the air stream are configured to operate at reduced output or be switched off at least temporarily when the diverting means is activated.

5

According to another aspect of the present invention, there is provided a separating device for a potato harvesting machine or a processing machine for separating a crop from a mixture comprising the crop and admixtures, the separating device comprising:

10

a drop stage that effects loosening of the mixture;

a conveying device supplying the mixture in at least one conveyed stream to the drop stage, wherein the mixture in the at least one conveyed stream falls onto a retaining element arranged downstream of the drop stage so as to face the falling mixture;

15

a blower that functions as a separation means, wherein the blower supplies a conveying medium in the form of an air stream;

wherein the air stream is directed onto the mixture that is present in an area of the drop stage and onto the mixture that is present in an area of the retaining element, and the air stream is configured to separate the crop and the admixtures,

20

wherein downstream of the retaining element, the crop and the admixtures separated from the mixture are transported farther as separated individual parts in a first conveying direction and a second conveying direction, respectively; and

25

diverting means configured to at least partially divert the at least one conveyed stream upstream of the retaining element,

wherein the diverting means comprises at least one transfer device changeable with regard to a transport length, wherein the at least one conveyed stream is transferred from the conveying device to the at least one transfer device, and wherein the retaining element and the air stream are configured to operate at reduced output or be switched off at least temporarily when the diverting means is activated.

30

With the afore described concept of the changeable transport length, a transfer device is provided that is movable into an extended position that bridges the retaining element and moves the stream of goods into the area of the discharge belt. Accordingly, a “bridge construction” with changing active plane is provided and the system as a whole can be variably adjusted to changing streams of goods.

Further details and advantageous embodiments of the invention result from the following description and the drawing in which two embodiments of the device according to the invention with diverting component group are illustrated. The drawing shows in:

- Fig. 1 a side view of a separating device for a potato harvesting machine according to the prior art;
- Fig. 2 a partially sectioned side view with a separating device integrated into the potato harvesting machine and a first embodiment of a diverting component group in the area of the retaining element;
- Fig. 3 a side view similar to Fig. 2 with the diverting component group in a changed utilization position;
- Fig. 4 a perspective illustration of the system similar to Fig. 2;

- Fig. 5 a perspective illustration similar to Fig. 4;
- Fig. 6 an enlarged detail illustration of the system in the area of the  
5 separating device with a second embodiment of the diverting component group;
- Fig. 7 a side view similar to Fig. 2 with a transfer device provided in  
10 the area of the conveying device in extended position of use;  
and
- Fig. 8 a side view similar to Fig. 7 with the transfer device in a  
shortened position of use.
- 15 In Fig. 1, a separating device that is known from the prior art and identified as a whole by 1 is illustrated which, according to the illustration in Fig. 2, is integrated into a potato harvesting machine A. Such a separating device 1 is provided for separating potatoes or similar crop E from a mixture G with clods, rocks, and similar solid bodies F. In such systems, the mixture G is  
20 supplied as a conveyed stream 4 by means of a conveying device that is referenced as a whole by 2 from a pickup area of the machine A, not illustrated in detail. Following this conveying stretch, the mixture G reaches the area of a drop stage 3 (Fig. 1) from where the mixture G that becomes more and more loose is moved onto a retaining element 5 in the area of the  
25 separating device. In this area, the actual "sorting" of the important components of the mixture G takes place, wherein the crop E' and the solid bodies F' are conveyed further separately in a respective substantially oppositely extending conveying direction (arrows 6, 7; Fig. 5). An air stream L generated by means of an external blower (not illustrated) assist in this  
30 separating phase so that a significant improvement of the separating process can be achieved by additional energy introduction.

The concept according to the invention of a variably usable separating device

1 is now based on the cleaning action of the separating device 1 on a machine A not being required in all individual situations. This can be the case, for example, when a mixture stream G that is substantially free of hard solid bodies, in particular due to the lack of rocks or clods, is to be handled within the system.

In this application situation, the construction according to the invention provides in particular that the at least one supplied conveyed stream 4 is diverted at least partially in the area upstream of the retaining element 5. A goal of this diverting action can be in this context that the conveyed stream 4 is moved by means of the conveying device 2 in the usual way within the machine A and can also be discharged directly into a downstream and/or adjacently positioned conveying zone 8 (Fig. 4) without contact with the retaining element 5 along the conveying stretch.

From the general sequence of movements of the mixture G in Fig. 2, it is apparent that the diverting action of the conveyed stream 4, illustrated by arrow UF, is in particular effective from the area of a terminal element 9 of the conveying device 2 onward. The constructive realization of this system provides that a diverting component group 10 designed as a bypass is effective in the area of the retaining element 5. In this way, a conceivable configuration of the bypass structure integrated as an auxiliary construction into the machine concept A is shown.

The constructive realization of this diverting component group 10 provides that for the latter a positioning in variable positions of use is possible such that for different conveying concepts a respective optimal active position is predetermined. In this context, it can be provided in particular that a division of the conveyed stream 4 is realized and in this context, for example, in deviation from the diverting direction UF, the movement into a respective transverse direction can also be realized (not illustrated, respectively).

Based on the diverting function in the area of the separating device 1, a

configuration of the diverting component group 10 with several guiding elements (not illustrated) is conceivable also. These guiding elements can be designed as individually positionable parts, respectively. It is also conceivable that at least one of the guiding elements of the diverting component group 10  
5 can be moved by hand.

Based on the illustrations according to Fig. 2 to Fig. 6, it is apparent that the variable concept of the diverting component group 10 for the area above the retaining element 5 leads to a configuration like a bridge B or B' (Fig. 6)  
10 extending across the shaker space R (Fig. 2, Fig. 3). This bridge construction is in particular geared to keeping the stream of goods G away by a diverting function UF only from the area of the movable retaining element 5. Based on this, the already discussed option of decoupling the configuration of the air stream L or the sorting function of the entire separating device 1 from the  
15 drive concept of the machine A results so that by this "shutdown" at least phase-wise working with reduced drive energy is possible and an energy-saving mode can be utilized in this way.

In the second embodiment of the system according to Fig. 6, the bridge B' is  
20 designed in the form of a "passive" element. This bridge B' in this context is provided with at least one slide plate 11 forming a transport slant (angle W). This bridge B' that is to be positioned in particular by hand in the illustrated position of use comprises in the area of the slide plate 11 that forms the transport slant W a special screen structure S so that parts T of the separated  
25 goods passing through this slide plate 11 are discharged into the lower part of the machine under the effect of gravity.

In the illustrated embodiment, the bridge B is provided with a support leg 12 that determines the slant angle W and that comprises in particular a length SL  
30 that corresponds to the height of the drop stage 3 (Fig. 1). For a stationary support on the retaining element 5, opposite the leg 12 a support contour 13 is provided so that the bridge B' as a whole has a stable mounted position. This bridge B' is in particular designed as an autarkic preassembled unit

which optionally can be placed or pushed into the position of use onto the retaining element 5. By appropriate connectors, the bridge B' can also be secured with form fit on the retaining element 5. Also, it is conceivable to secure the bridge B' on a pivot construction (not illustrated) so that, when  
5 sufficient free space within the machine A is available, a displacement from the position of use is possible and a permanent installation of the bridge B' is conceivable.

Based on the afore described diverting component group 10, 10' in the form  
10 of the "passive" bridge B' or the generally described guiding elements, also a constructive expansion of this concept is provided also. In particular, a further improvement can be achieved in that the diverting component group 10, 10' in all of its embodiments can also be provided with at least one controllable drive unit.

15 From the illustrations according to Fig. 2 to Fig. 5, the configuration of a conveying unit 15 provided with a drive is apparent in a principal illustration. This actively driven conveying unit 15 assumes a utilization position that corresponds to that of the "passive" bridge B' according to Fig. 6 above the  
20 retaining element 5 (Fig. 4). It is conceivable in this context that by an appropriate configuration of the conveying unit 15 also an extended utilization length NL (Fig. 4) can be utilized which, for example, extends into the area of the conveying unit 2.

25 For positioning this conveying unit 15 in the respective position of use, different displacement possibilities are conceivable. In this context, the conveying unit 15 for positioning in its position of use can comprise a pivotable and/or slidable support connection within the machine A.

30 In an expedient embodiment, the conveying unit 15 which is embodied as a screen belt 16 (Fig. 4) is designed as a pivotable component group so that, by an appropriate movement (angle SW, Fig. 4, Fig. 5), the retaining element 5 can be exposed for its "normal function". The movement can be carried out in

this context by means of a control unit (not illustrated) also as a push movement or a pivoting/lifting movement.

Based on this pivot movement SW, the concept provides that the pivoted  
5 screen belt 16 in the reached position of non-use according to Fig. 5 can  
define an additional utilization position within the machine A. This results from  
the fact that the respective diverting component group 10 as a whole, or at  
least the afore described screen belt 16, at least sectionwise can be brought  
10 into a position interacting with the air stream L of the separating device 1. In  
this context, it is apparent that separated goods TK moved by a partial air  
stream AL reach the area of the screen belt 16 and here assistance in  
discharging the separated goods TK can be provided

In the illustrations according to Figs. 3 and 5, said installed position pivoted  
15 about the angle SW is illustrated wherein the screen belt 16 is arranged  
above a guiding system 18 integrated into the machine A and, with said  
system, the separated goods TK can be moved into a rearward discharge  
position.

20 In this context, the conveying unit 15, provided with a screen belt 16 that is  
embodied in particular as a haulm removal belt, is positioned such that it  
extends into the area of a discharge belt 17 provided downstream of the  
retaining element 5 and in this way separated goods TK moved by a blowing  
movement action can be additionally discharged by means of the screen belt  
25 16. In particular, it is provided that the screen belt 16 assists in the separating  
and cleaning process in the area of a roller stripper 19 provided for clod  
separation and potato diverting action.

Based on the construction of the potato harvesting machine A shown in Fig. 1  
30 and Fig. 2 together with the conveying device 2 illustrated therein for  
movement of the mixture G, a variant of the diverting action of the conveyed  
stream 4 by means of a transfer device 20 is illustrated in Fig. 7 and Fig. 8.  
This transfer device 20 is arranged immediately downstream of the upward

conveying phase of the mixture G at the end of the conveying device 2 in such a way that the active stretches illustrated as different transport length TL and TL' can be adjusted here.

5 In this context, the transfer device 20 is preferably designed as a screen belt 21. The latter is secured by means of an adjusting spring 22 which engages the return run of the screen belt 21 as a counter holder into a "pretensioned" position (Fig. 8). In this area, the circulating screen belt 21 is guided across a roller 22'.

10

In the area of an active stretch which forms the transport lengths TL. TL', the screen belt 21 has two deflection rollers 23 and 24 where, by means of an adjusting member formed in particular as a lifting cylinder 25, a length change is possible. It is apparent from the extended position TL according to Fig. 7  
15 that the lifting cylinder 25 in proximity to the connection to the conveying device 2 is stationarily supported. The leading end of the piston rod 26 engages in this context the second one of the deflection rollers 24 in such a way that the latter can be moved in particular in a straight line.

20 In the illustrated extended position of the piston rod 26, the upper run of the screen belt 21 has been moved into a position of use bridging the retaining element 5 and extending into the area of the discharge belt 17. In this displacement by means of the hydraulic cylinder 25 a constant tension of the screen belt 21 is maintained at the same time in that the adjusting spring 22  
25 produces the appropriate length compensation. Upon return movement of the piston rod 26, the spring 22 is also returned into the initial position illustrated in Fig. 8 and the separating function of the retaining element 5 in the area of the device 1 is activatable.

30

The embodiments of the invention in which an exclusive property or privilege is claimed are defined as follows:

1. A separating device for a potato harvesting machine or a processing machine for separating a crop from a mixture comprising the crop and admixtures, the separating device comprising:

a drop stage that effects loosening of the mixture;

a conveying device supplying the mixture in at least one conveyed stream to the drop stage, wherein the mixture in the at least one conveyed stream falls onto a retaining element arranged downstream of the drop stage so as to face the falling mixture;

a blower that functions as a separation means, wherein the blower supplies a conveying medium in the form of an air stream;

wherein the air stream is directed onto the mixture that is present in an area of the drop stage and onto the mixture that is present in an area of the retaining element, and the air stream is configured to separate the crop and the admixtures,

wherein downstream of the retaining element the crop and the admixtures separated from the mixture are transported farther as separated individual parts in a first conveying direction and a second conveying direction, respectively; and

diverting means configured to completely divert, when activated, the at least one conveyed stream upstream of the retaining element and to discharge the at least one conveyed stream supplied by the conveying device directly into a downstream and/or adjacently positioned conveying zone without contacting the retaining element, wherein the retaining element and the air stream are configured to operate at reduced output or be switched off at least temporarily when the diverting means is activated.

2. The separating device according to claim 1, wherein the diverting means is positioned in an area of a terminal element of the conveying device.

3. The separating device according to claim 1, wherein the diverting means is configured to be positioned in an inactive position of use such that a diversion of the at least one conveyed stream is realized.

4. The separating device according to claim 1, wherein the diverting means is comprised of several guiding elements.
5. The separating device according to claim 4, wherein the guiding elements are individually positionable.
6. The separating device according to claim 4, wherein at least one of the guiding elements is moveable by hand.
7. The separating device according to claim 1, wherein the diverting means comprises a bridge having a slide plate forming a transport slant and is moveable by hand into a position of use.
8. The separating device according to claim 7, wherein the bridge in the area of the slide plate forming the transport slant is provided with a screen structure.
9. The separating device according to claim 7 or 8, wherein the transport slant is adjustable.
10. The separating device according to any one of claims 7 to 9, wherein the bridge is a preassembled unit and is configured to be inserted or pivoted into a position of use.
11. The separating device according to claim 1, wherein the diverting means comprises components, wherein each component is displaceable by means of at least one corresponding controllable drive unit.
12. The separating device according to claim 1, wherein the diverting component means is a conveying unit comprising a drive.
13. The separating device according to claim 12, wherein the conveying unit comprises a pivotable and/or slidable support connection configured to position the conveying unit in a position of use.

14. The separating device according to claim 1, wherein the diverting means at least sectionwise is pivotable and/or slidable into a position of use in which the diverting means interacts with the air stream.

15. The separating device according to claim 14, further comprising a discharge belt downstream of the retaining element, wherein the diverting means is a conveying unit comprising a drive, wherein the conveying unit comprises a screen belt and is arranged in the area of the discharge belt such that, above the discharge belt, admixtures separated from the mixture and moved by a blowing movement action are discharged by the screen belt.

16. A separating device for a potato harvesting machine or a processing machine for separating a crop from a mixture comprising the crop and admixtures, the separating device comprising:

- a drop stage that effects loosening of the mixture;

- a conveying device supplying the mixture in at least one conveyed stream to the drop stage, wherein the mixture in the at least one conveyed stream falls onto a retaining element arranged downstream of the drop stage so as to face the falling mixture;

- a blower that functions as a separation means, wherein the blower supplies a conveying medium in the form of an air stream;

- wherein the air stream is directed onto the mixture that is present in an area of the drop stage and onto the mixture that is present in an area of the retaining element, and the air stream is configured to separate the crop and the admixtures,

- wherein downstream of the retaining element, the crop and the admixtures separated from the mixture are transported farther as separated individual parts in a first conveying direction and a second conveying direction, respectively; and

- diverting means configured to at least partially divert the at least one conveyed stream upstream of the retaining element,

- wherein the diverting means comprises at least one transfer device changeable with regard to a transport length, wherein the at least one conveyed stream is transferred from the conveying device to the at least one transfer device, and wherein the retaining element

and the air stream are configured to operate at reduced output or be switched off at least temporarily when the diverting means is activated.

17. The separating device according to claim 16, wherein the at least one transfer device is a screen belt.

18. The separating device according to claim 17, wherein the screen belt is secured by an adjusting spring.

19. The separating device according to claim 18, wherein the screen belt comprises a first deflection roller and a second deflection roller and predetermines the transport length by a spacing between the first and second deflection rollers, wherein the spacing is changeable by a lifting cylinder.

20. The separating device according to claim 19, wherein the lifting cylinder, in the area of the conveying device, is stationarily supported on the first deflection roller and a leading end of a piston rod of the lifting cylinder engages the second deflection roller that is configured to be displaceable relative to the first deflection roller by the lifting cylinder.

21. The separating device according to any one of claims 16 to 20, further comprising a discharge belt downstream of the retaining element, wherein the transfer device is configured to be moved into an extended position bridging the retaining element so that the at least one conveyed stream is moved toward the discharge belt.

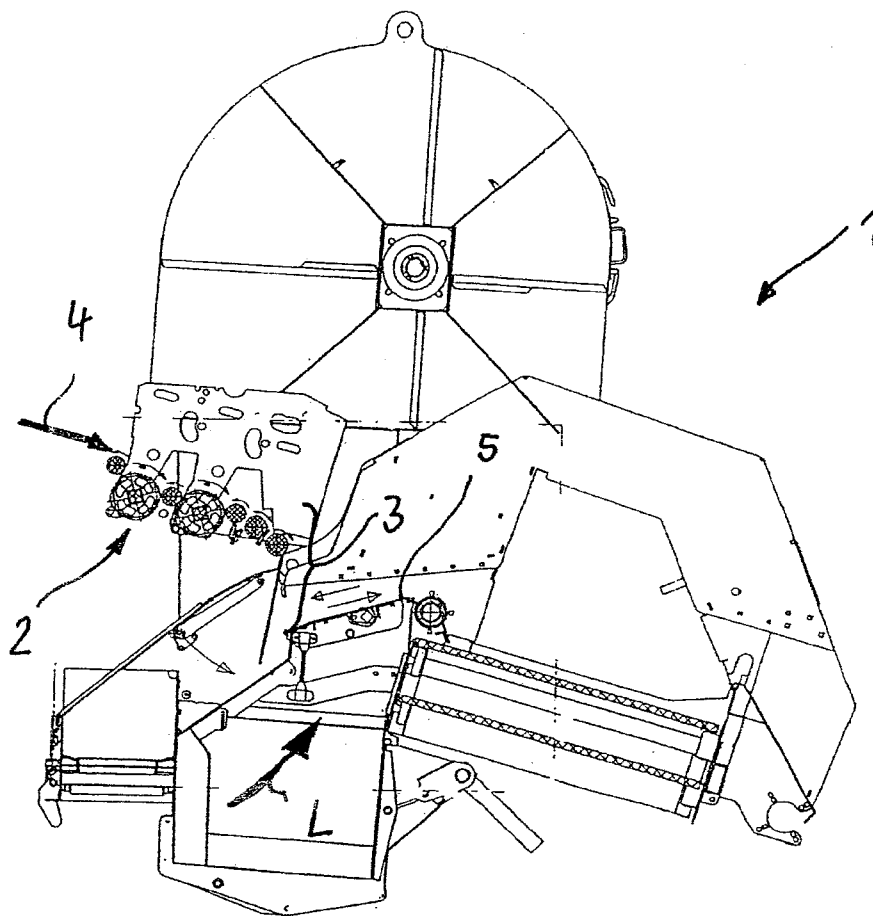

PRIOR ART

Fig 1

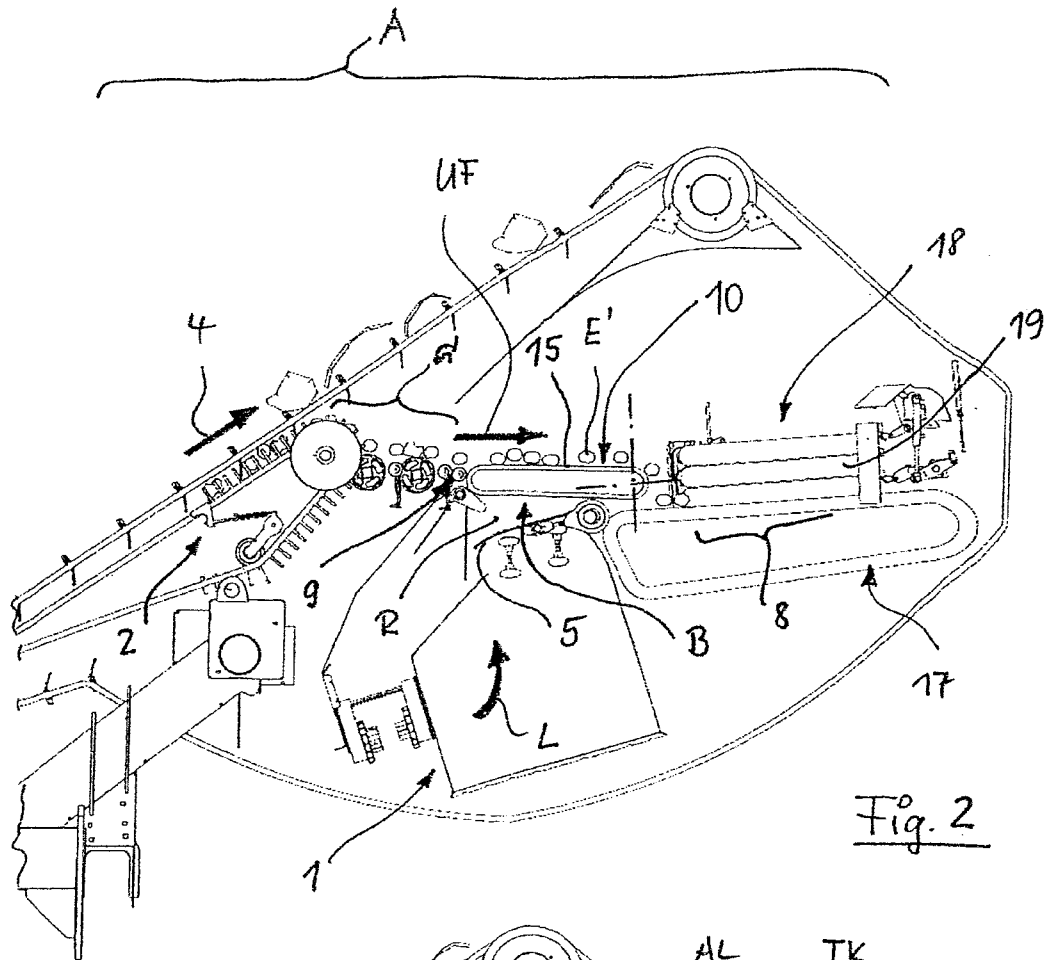

Fig. 2

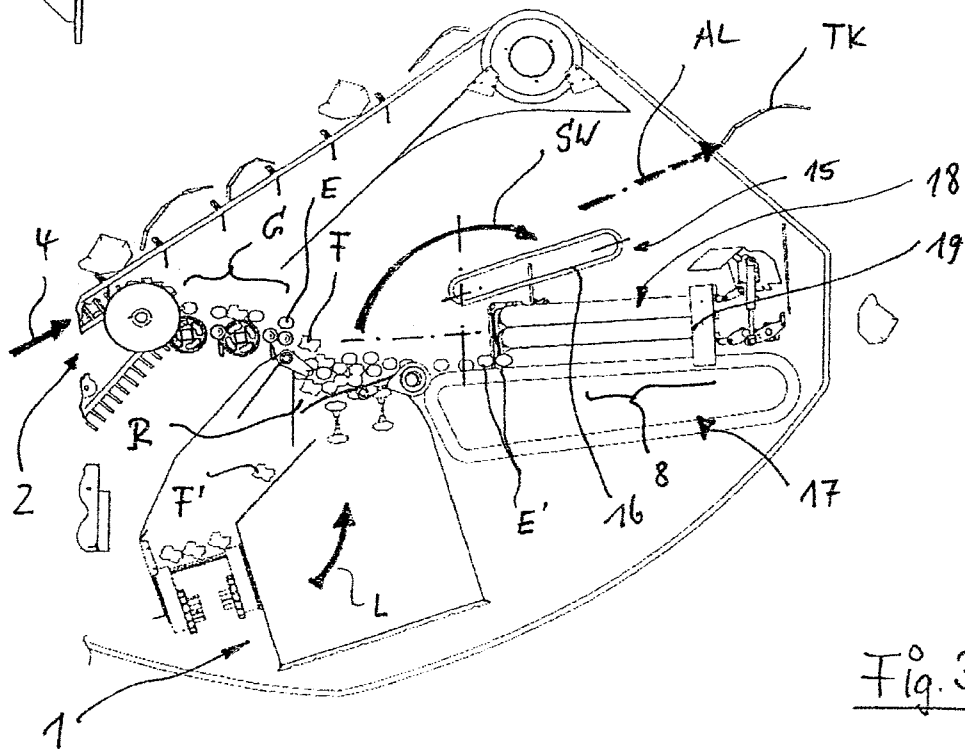

Fig. 3

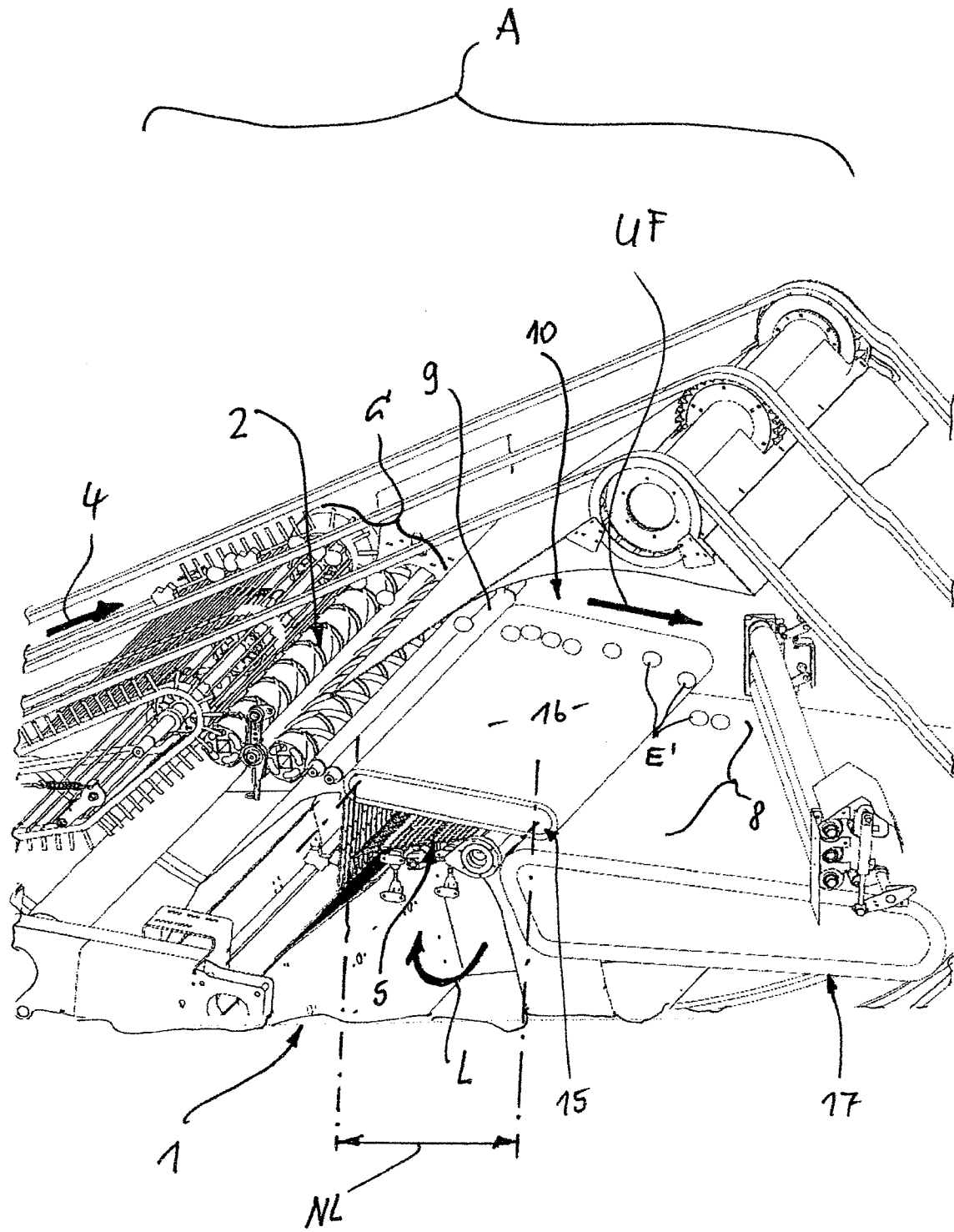

Fig. 4

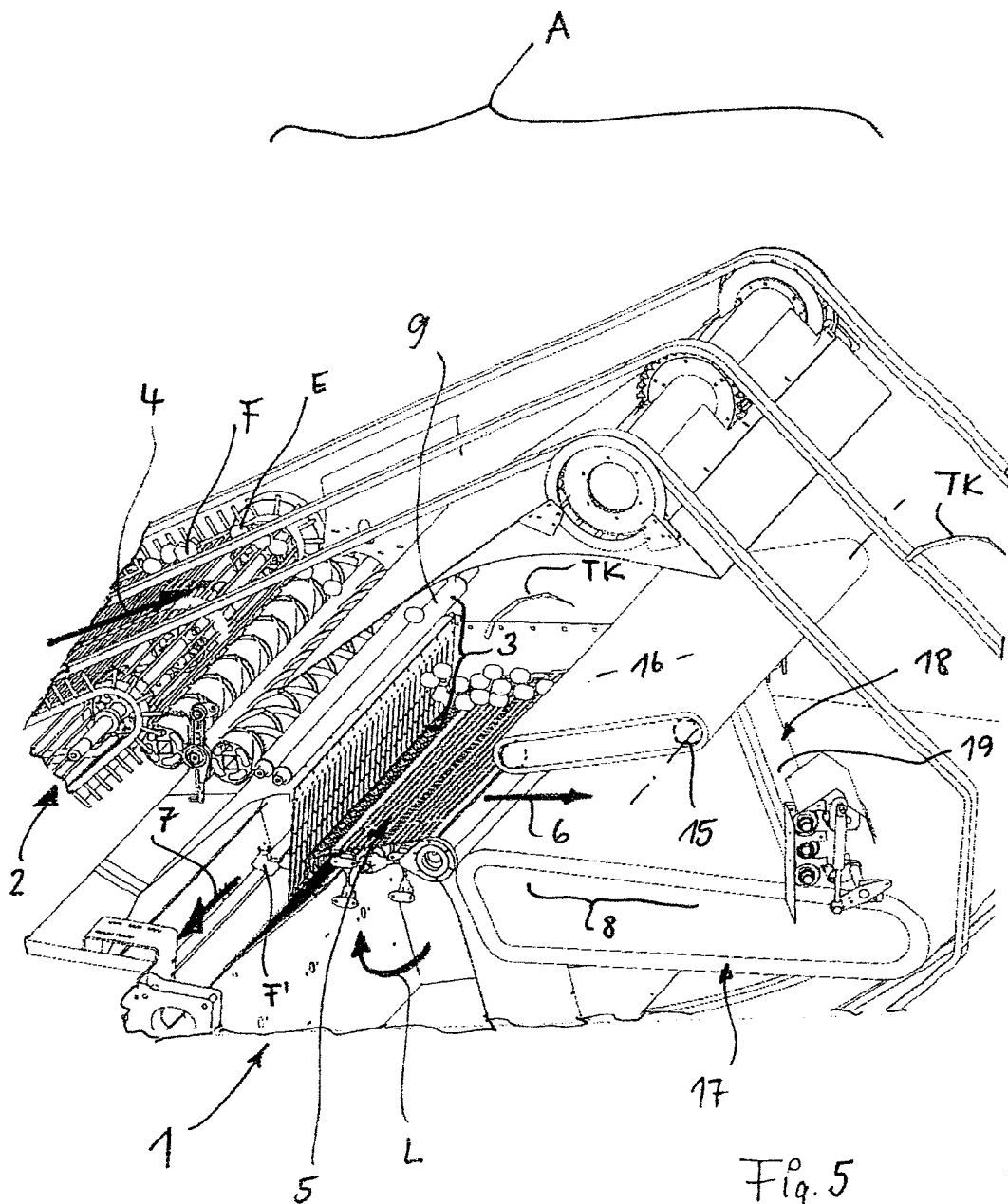
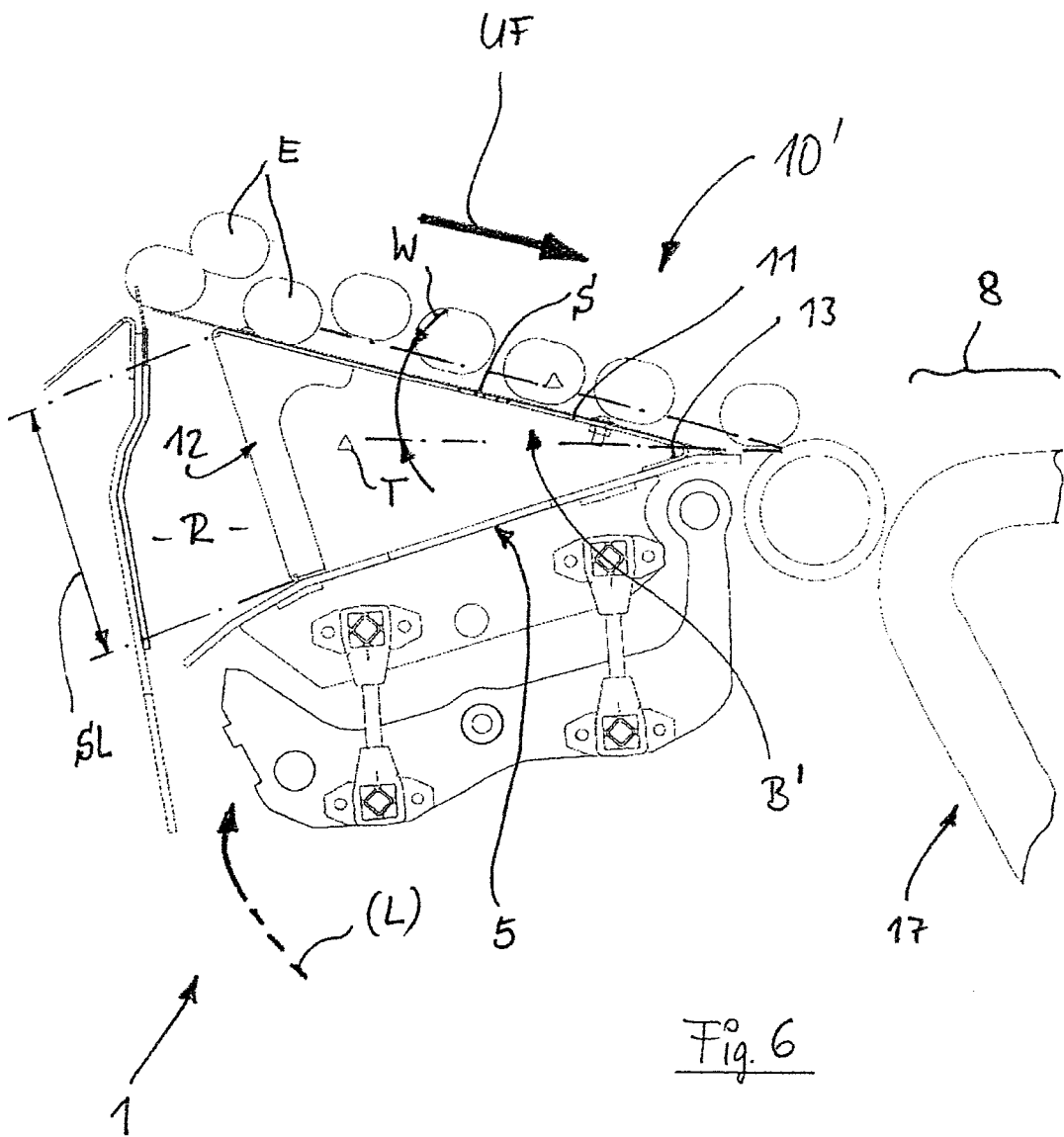

Fig. 5



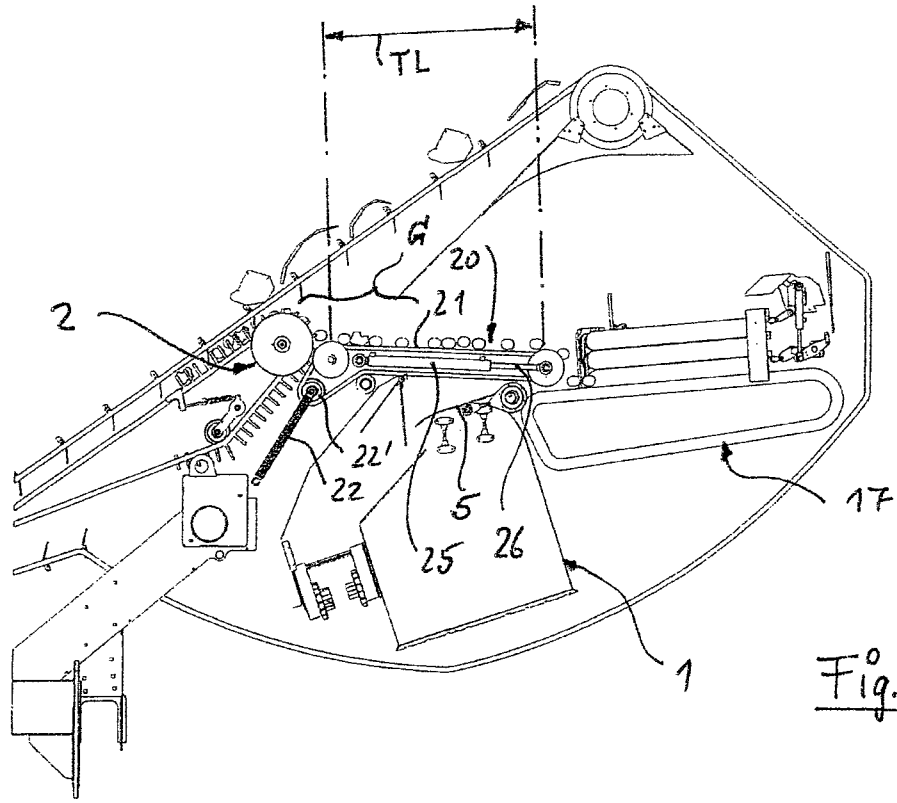

Fig. 7

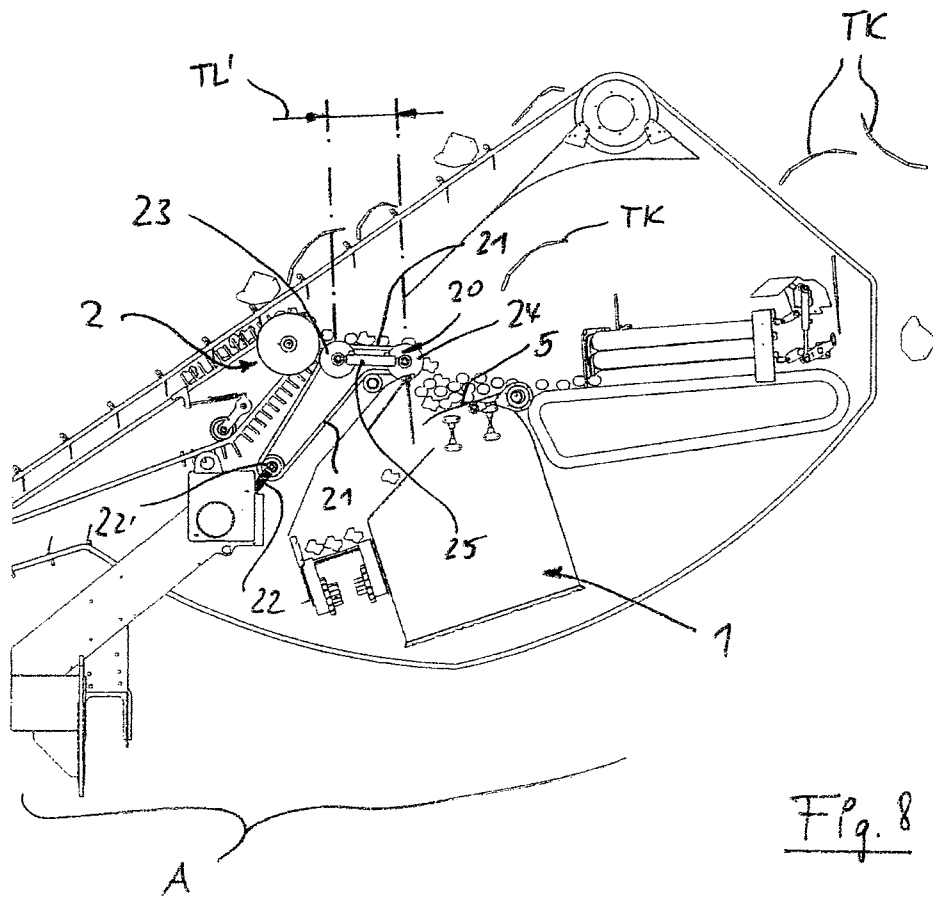

Fig. 8

