



(19) **United States**

(12) **Patent Application Publication**
Zhang et al.

(10) **Pub. No.: US 2022/0121090 A1**

(43) **Pub. Date: Apr. 21, 2022**

(54) **ELEVATOR ASSEMBLY AND ELECTRONIC DEVICE**

Publication Classification

(71) Applicant: **Wistron Corporation**, New Taipei City (TW)

(51) **Int. Cl.**
G03B 17/56 (2006.01)
F16M 13/02 (2006.01)
F16H 21/44 (2006.01)

(72) Inventors: **Weijie Zhang**, New Taipei City (TW);
Dong-Ying Chen, New Taipei City (TW);
Yuanqing Liu, New Taipei City (TW);
HuiQiang He, New Taipei City (TW)

(52) **U.S. Cl.**
CPC *G03B 17/561* (2013.01); *F16M 2200/048* (2013.01); *F16H 21/44* (2013.01); *F16M 13/022* (2013.01)

(73) Assignee: **Wistron Corporation**, New Taipei City (TW)

(57) **ABSTRACT**

An elevator assembly includes a first bracket, a second bracket, a first connecting rod and a second connecting rod. The second bracket is slidably disposed on the first bracket. The first connecting rod has a first pivot end and a first sliding end. The first pivot end is pivoted to the first bracket and provided with a first gear portion, and the first sliding end is slidably disposed on the first bracket and connected to the second bracket. The second connecting rod has a second pivot end and a second sliding end. The second pivot end is pivoted to the first bracket and provided with a second gear portion, the second sliding end is slidably disposed on the second bracket and connected to the second bracket, and the first gear portion and the second gear portion are engaged with each other.

(21) Appl. No.: **17/118,607**

(22) Filed: **Dec. 11, 2020**

(30) **Foreign Application Priority Data**

Oct. 15, 2020 (CN) 202011101776.4

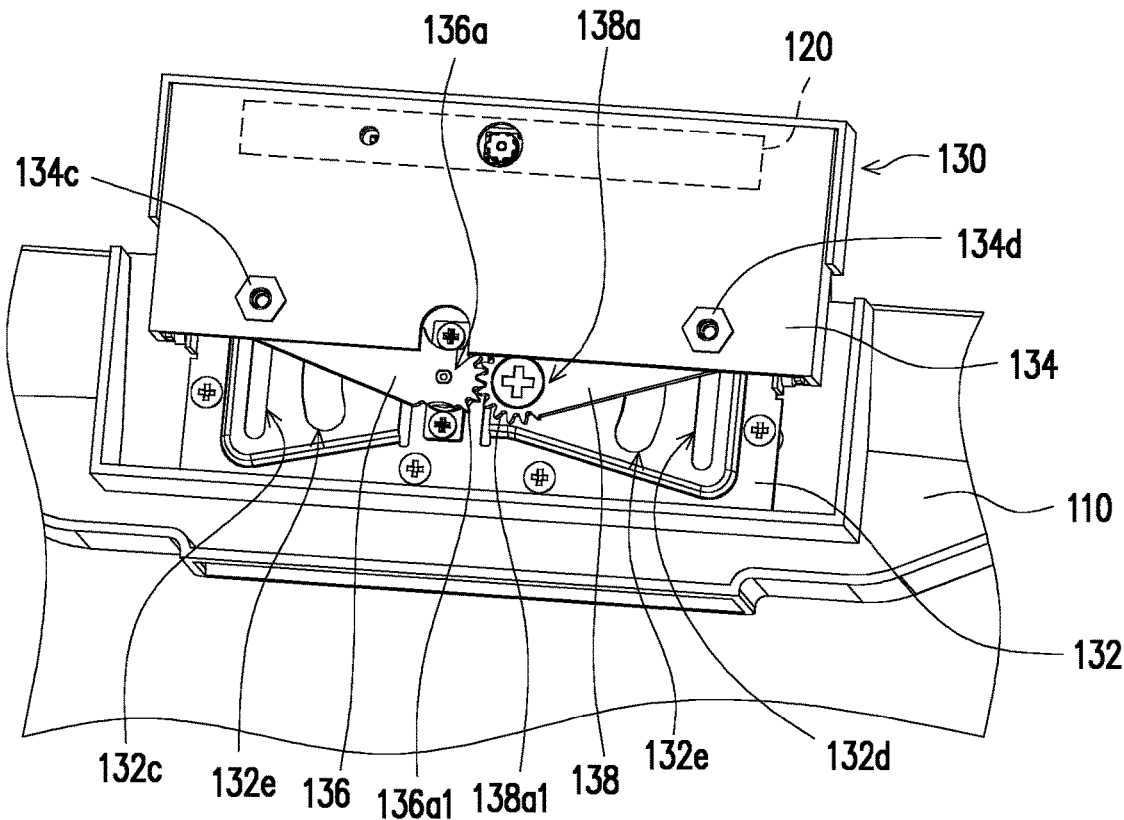

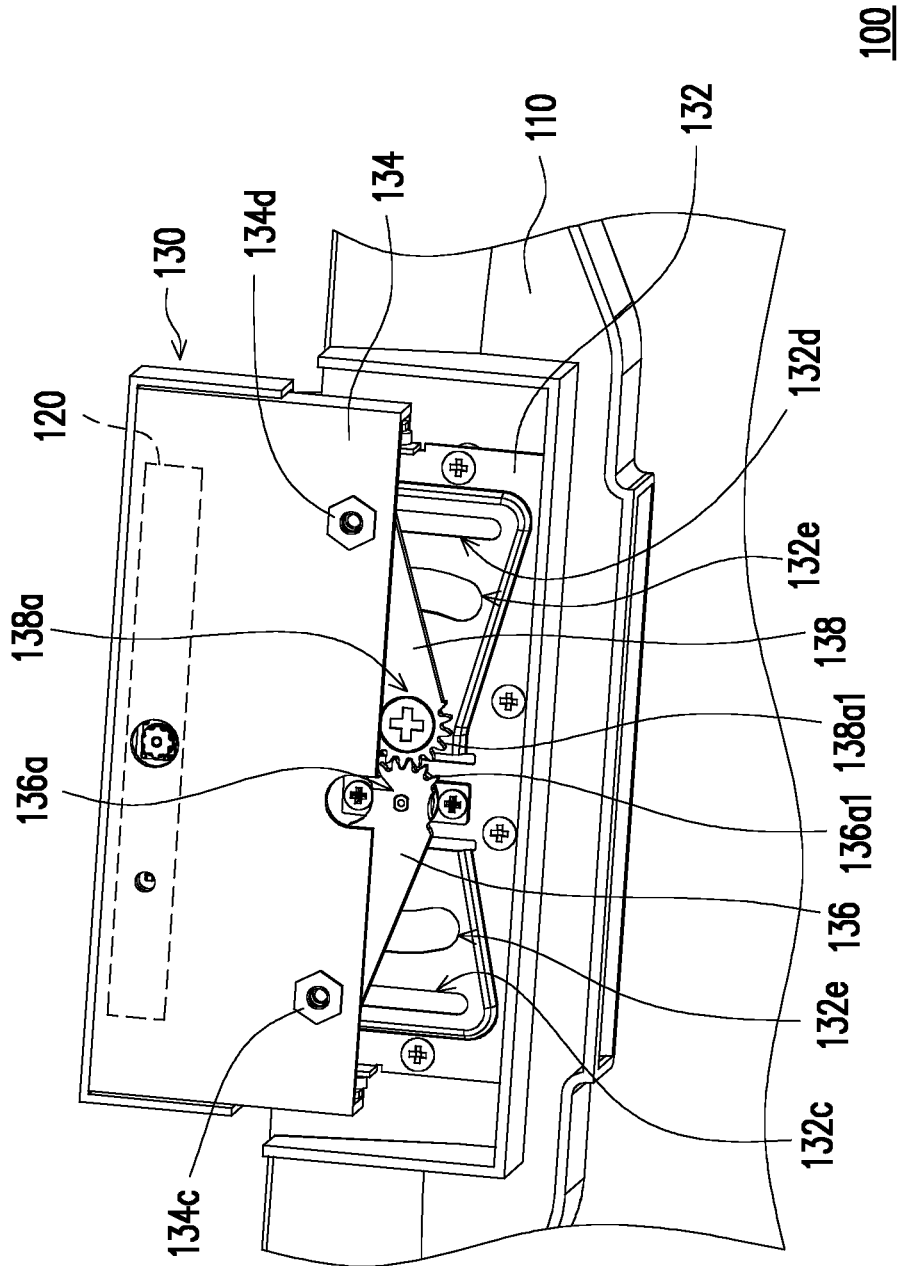

FIG. 1

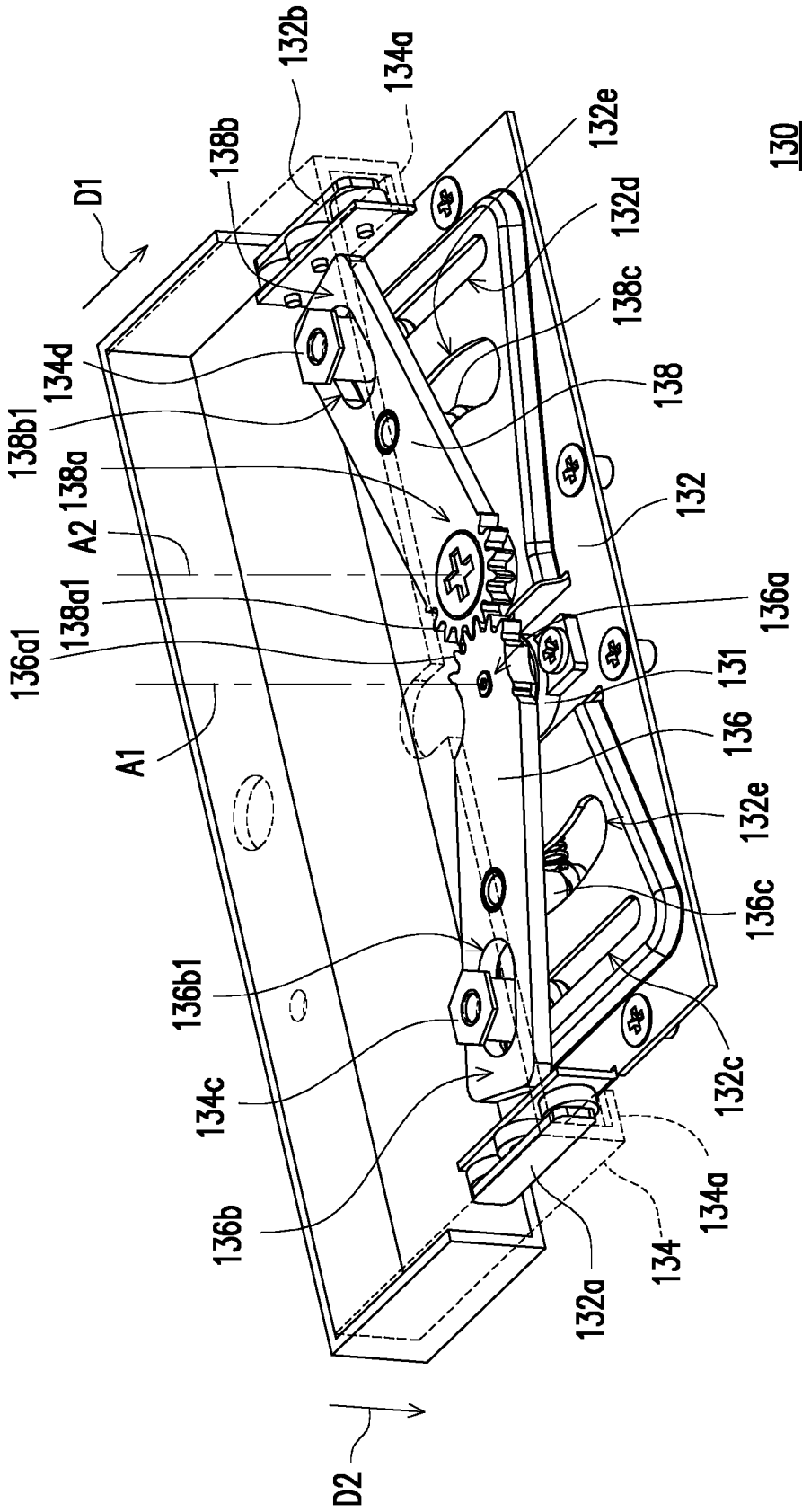

FIG. 2

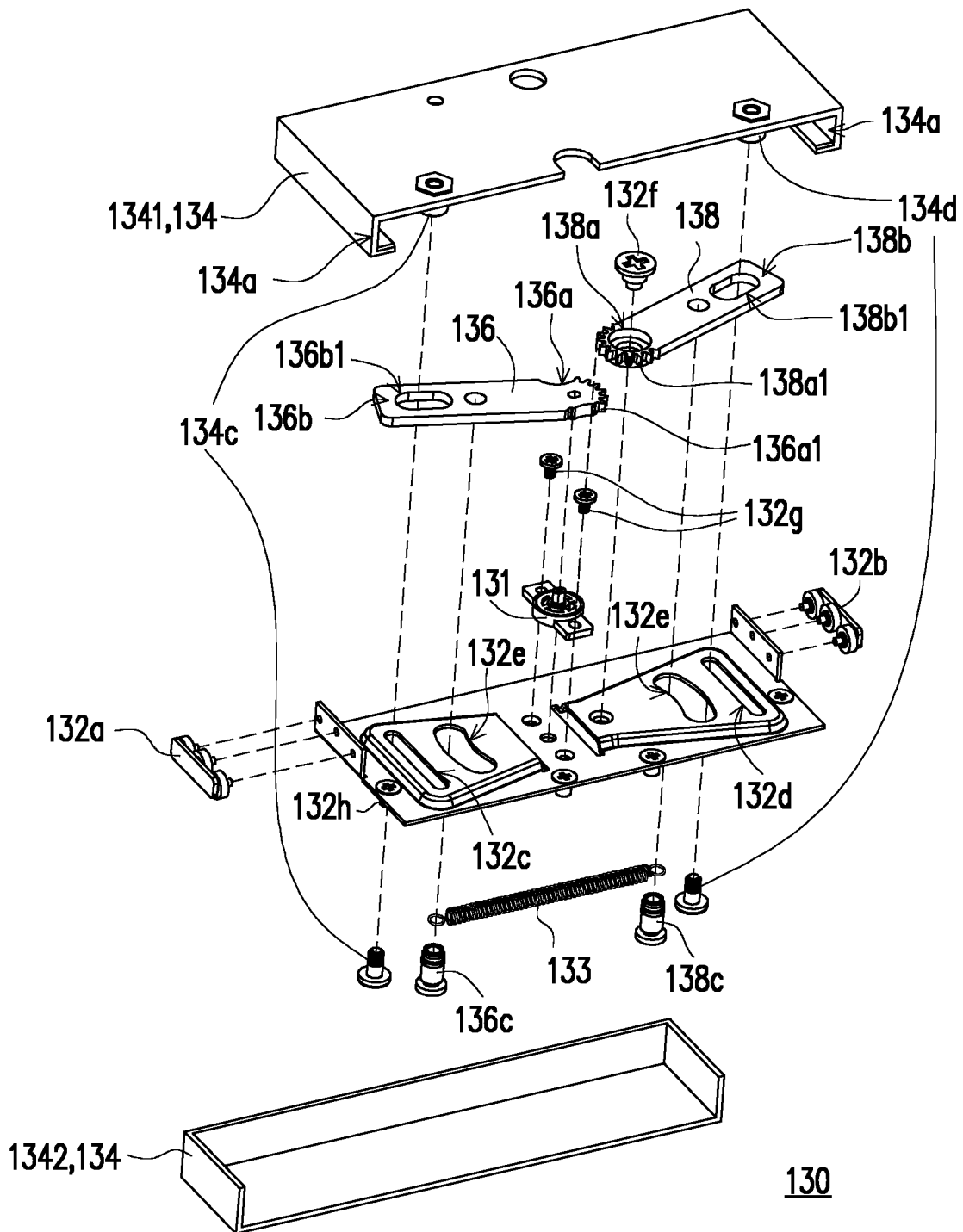

FIG. 3

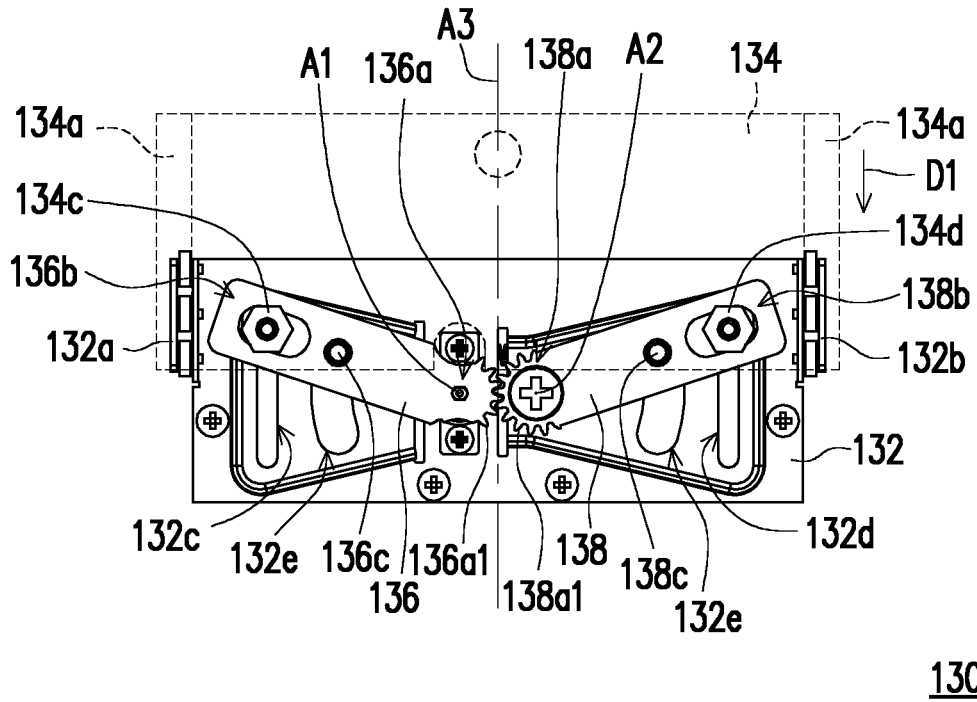

FIG. 4A

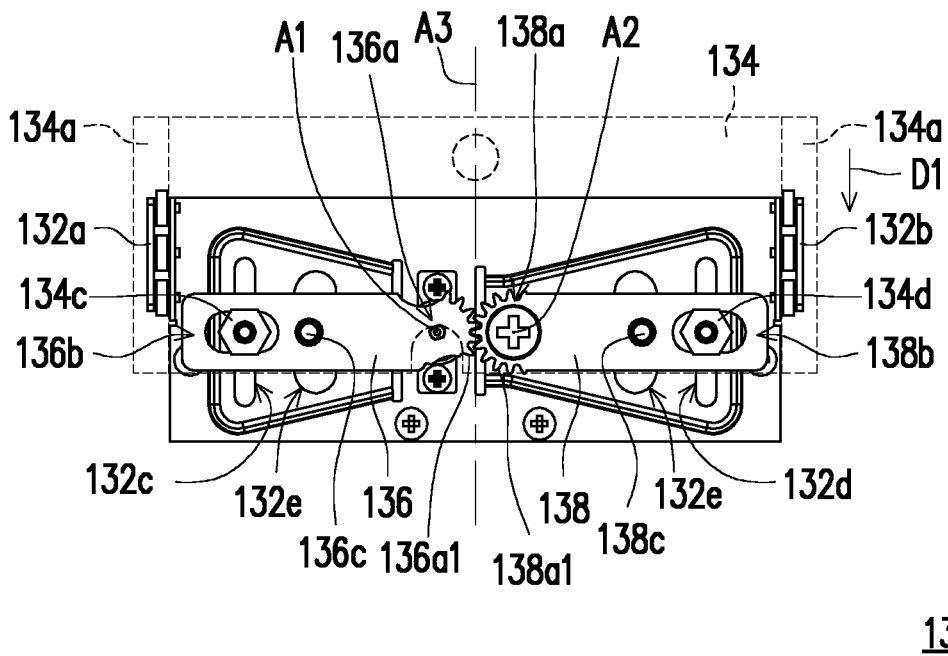

FIG. 4B

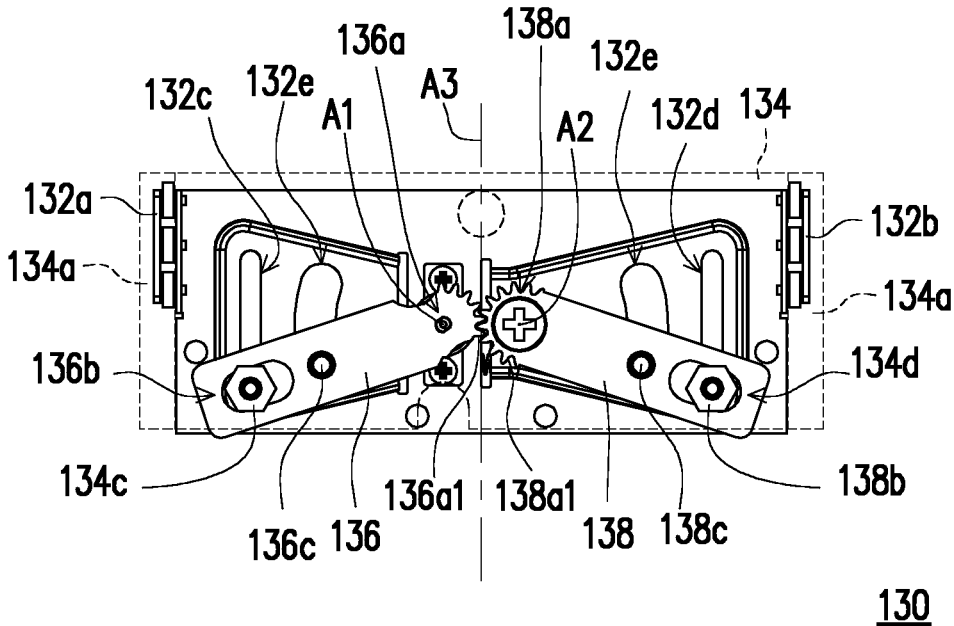

FIG. 4C

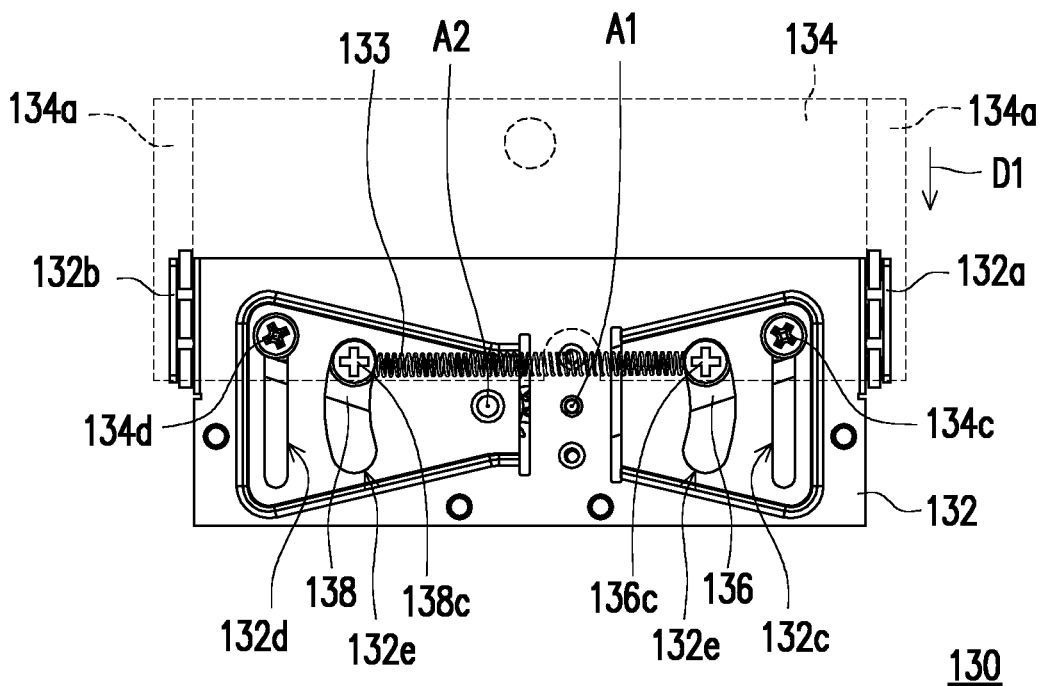

FIG. 5A

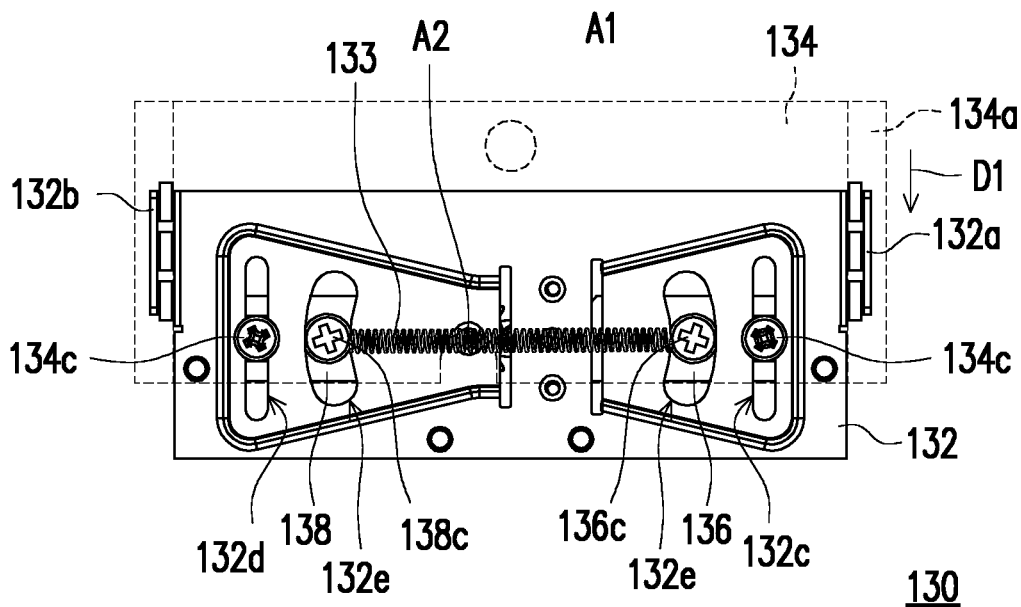
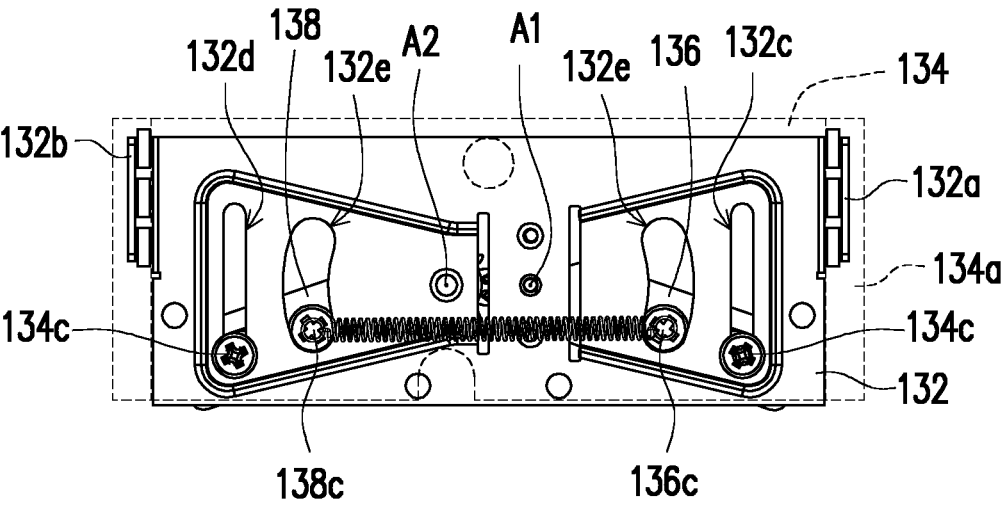

FIG. 5B



130

FIG. 5C

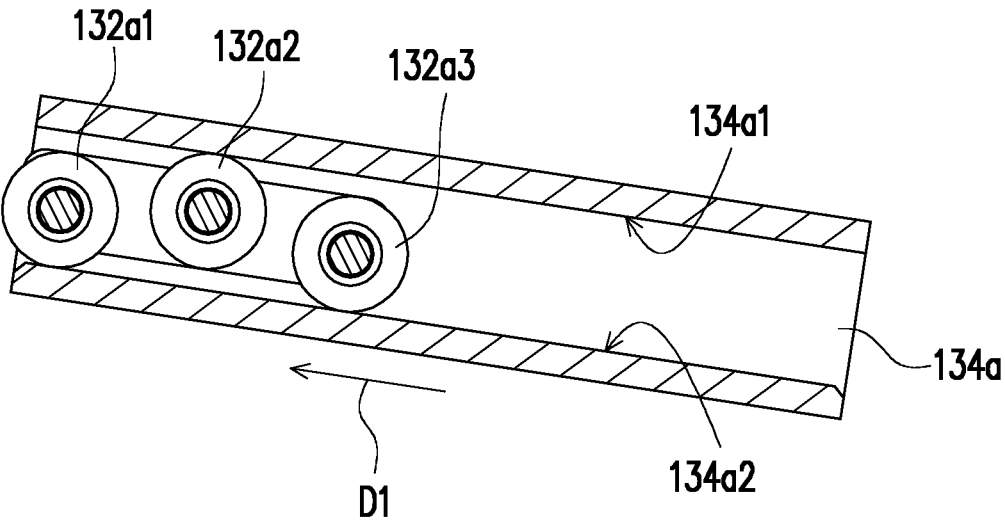

FIG. 6

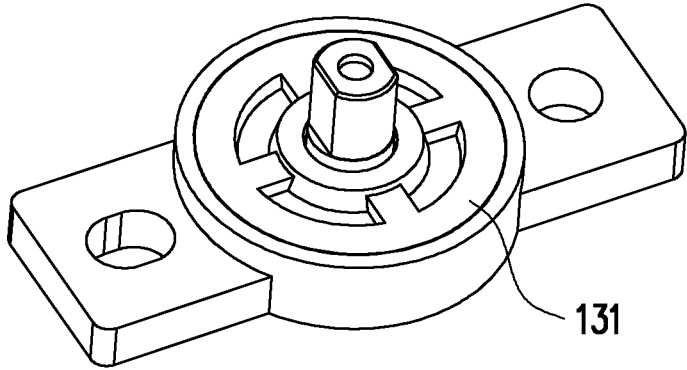

FIG. 7

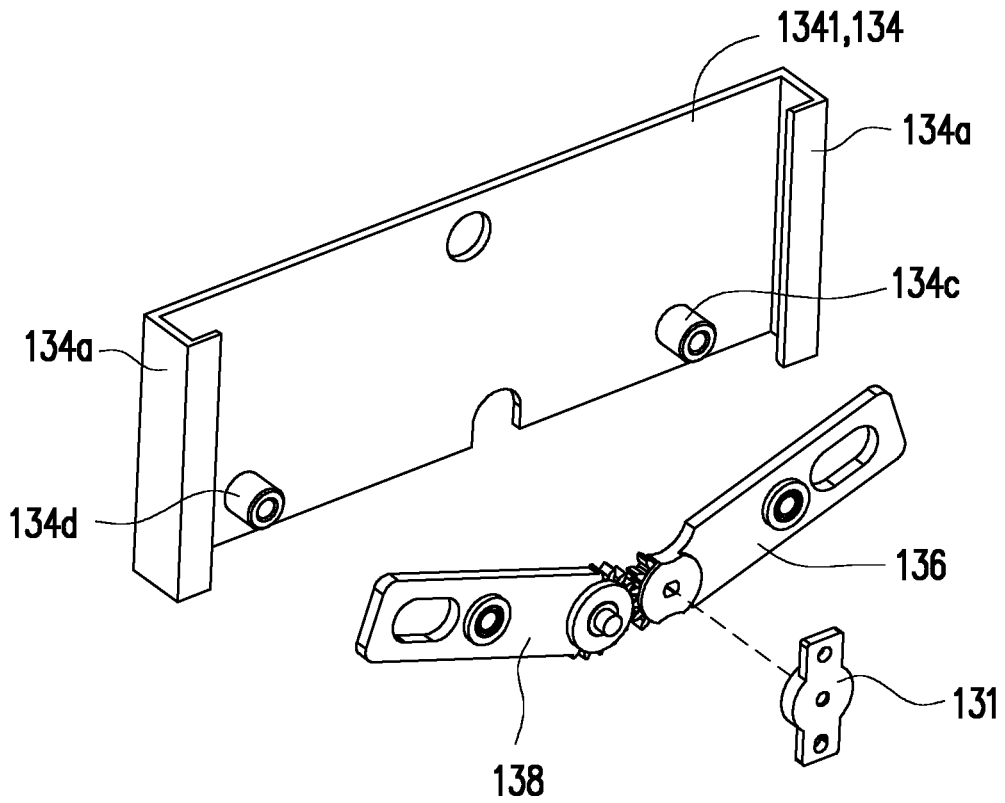

FIG. 8A

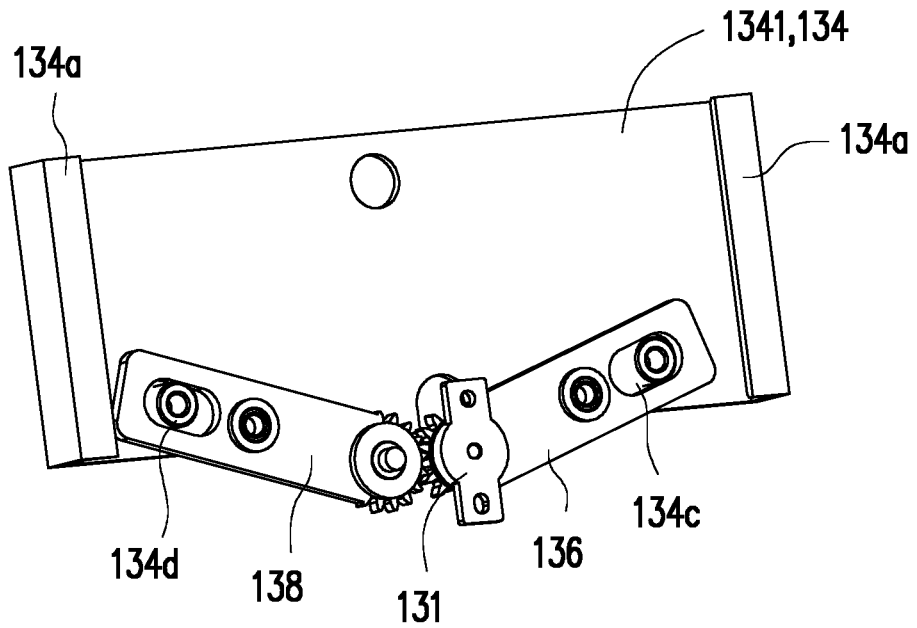

FIG. 8B

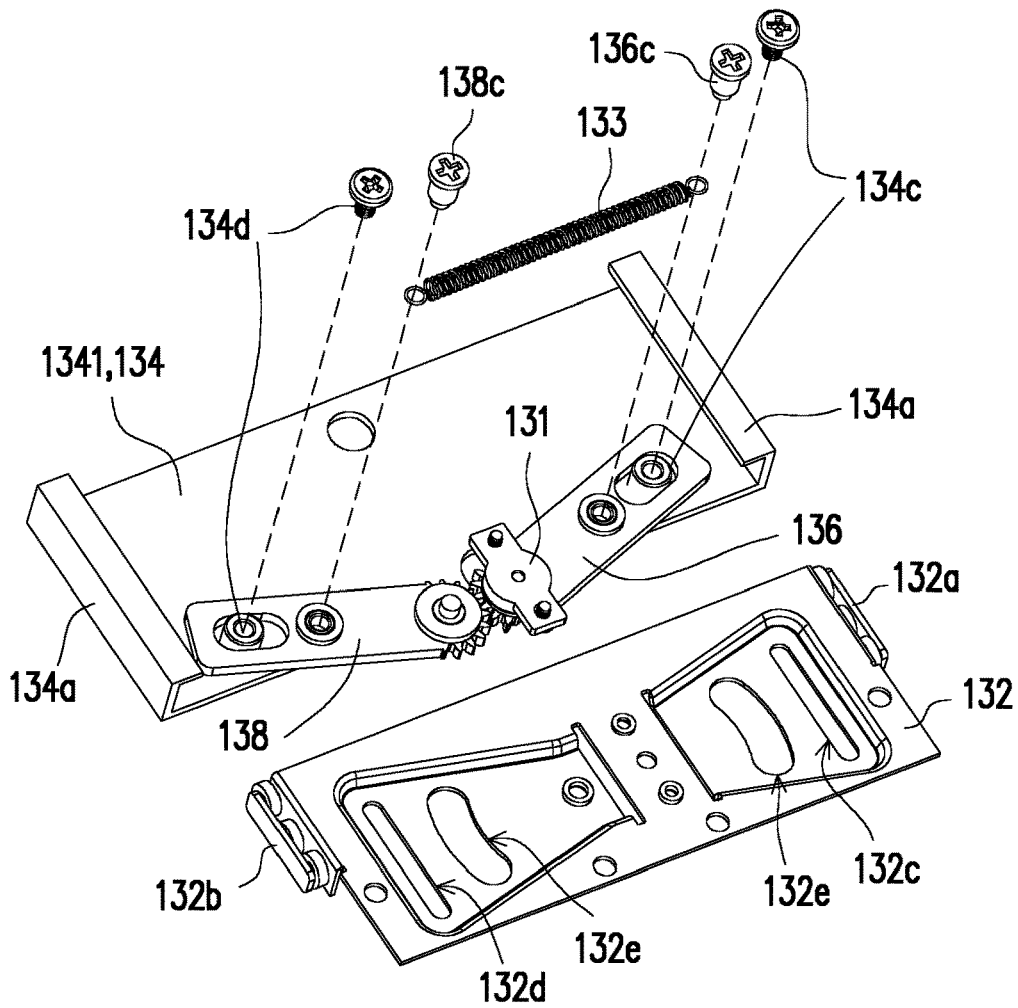

FIG. 8C

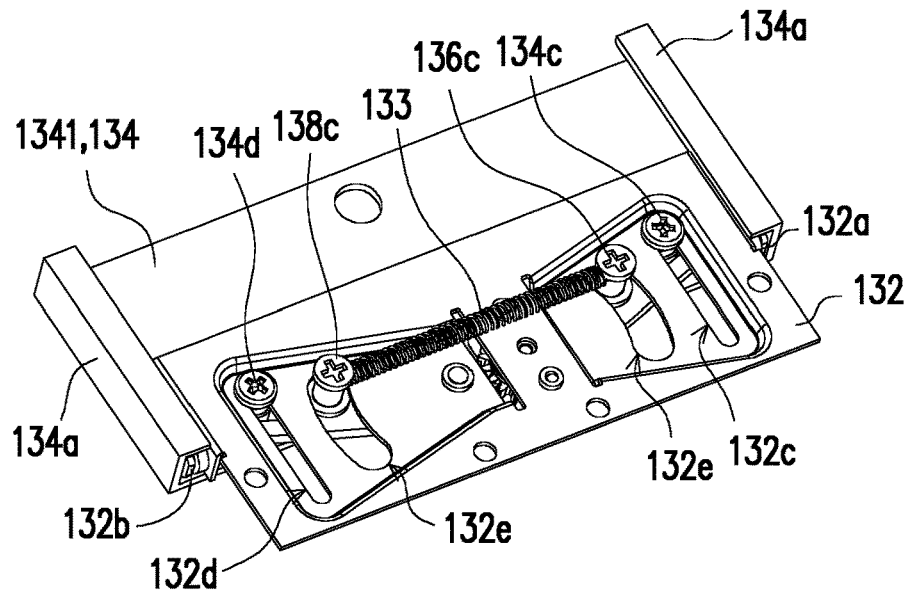

FIG. 8D

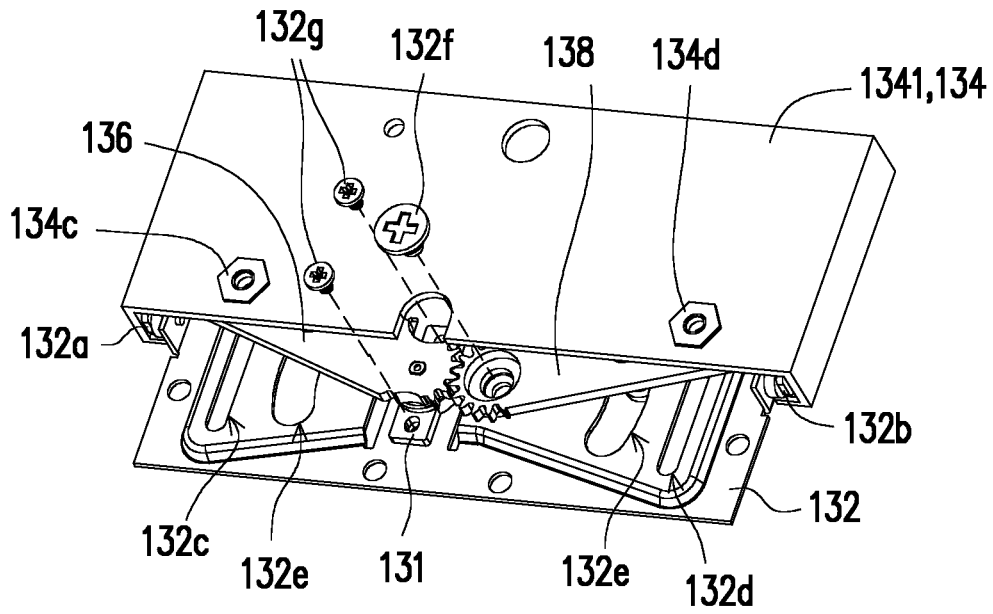

FIG. 8E

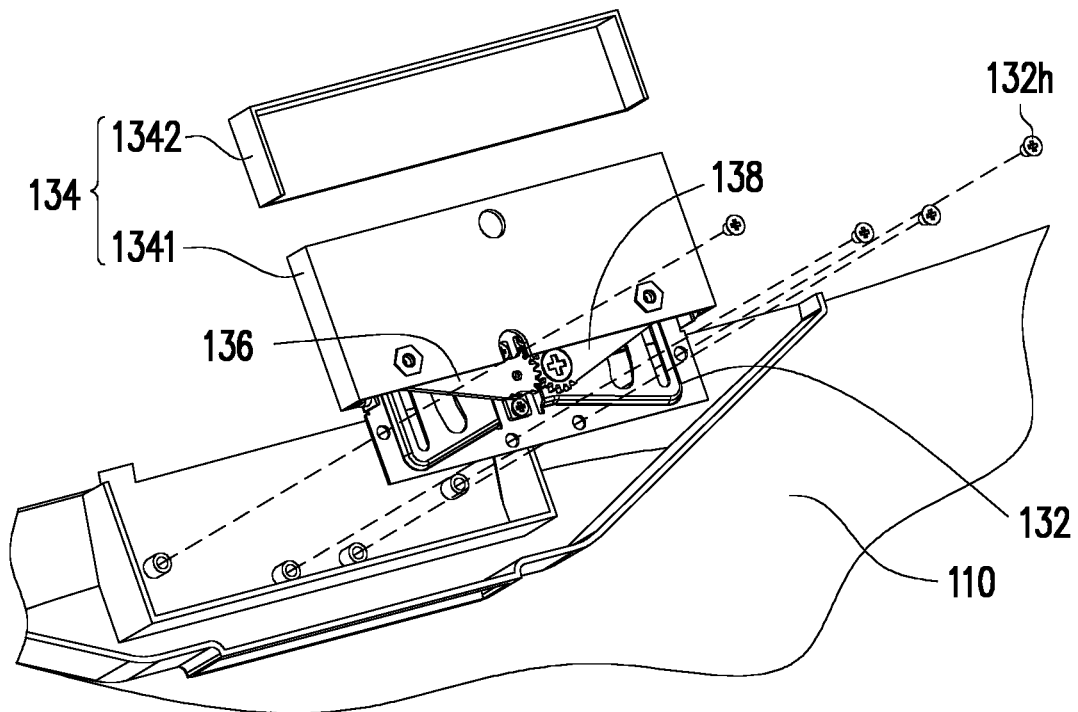

FIG. 8F

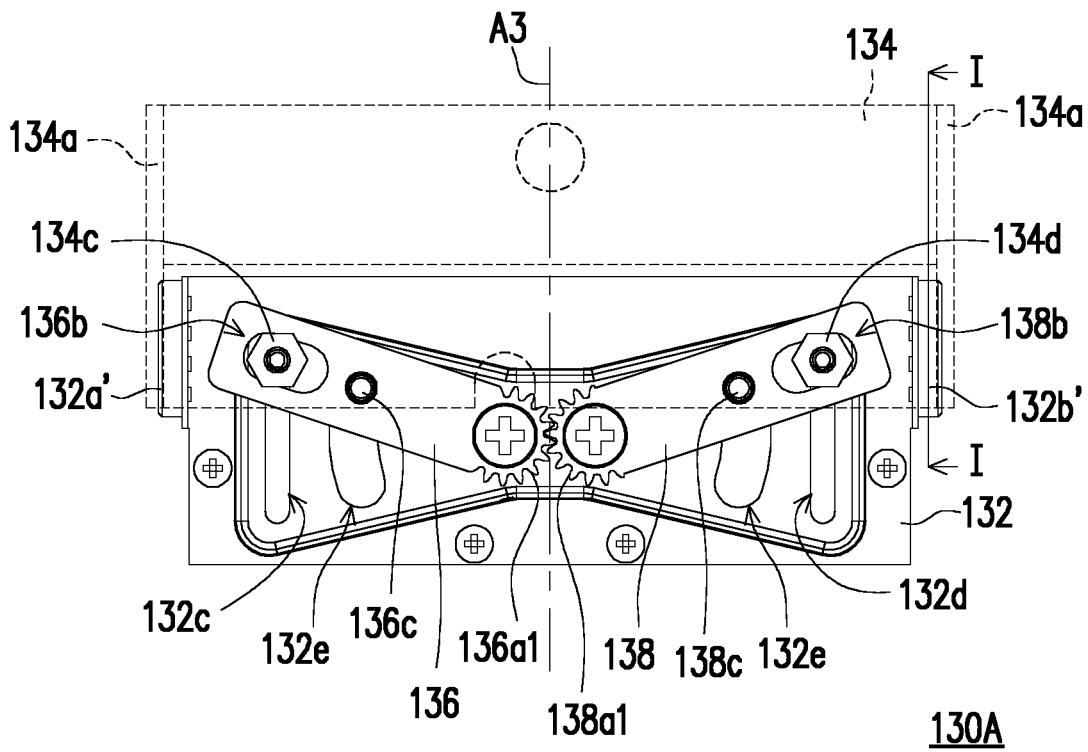

FIG. 9

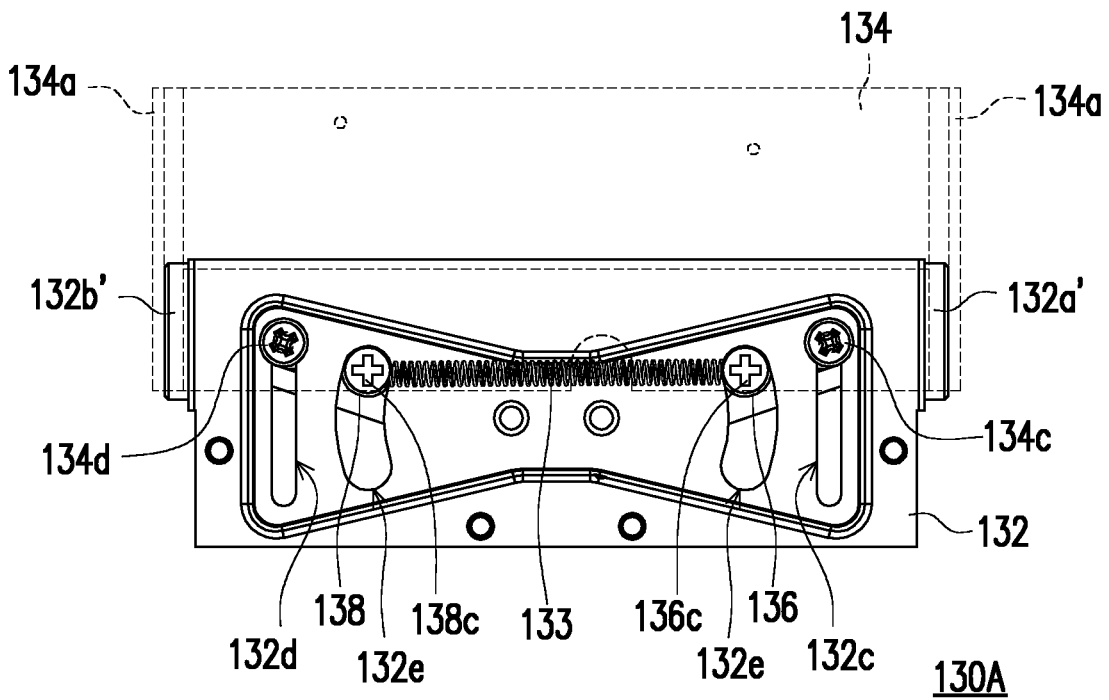

FIG. 10

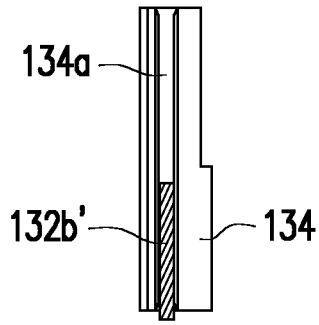

FIG. 11

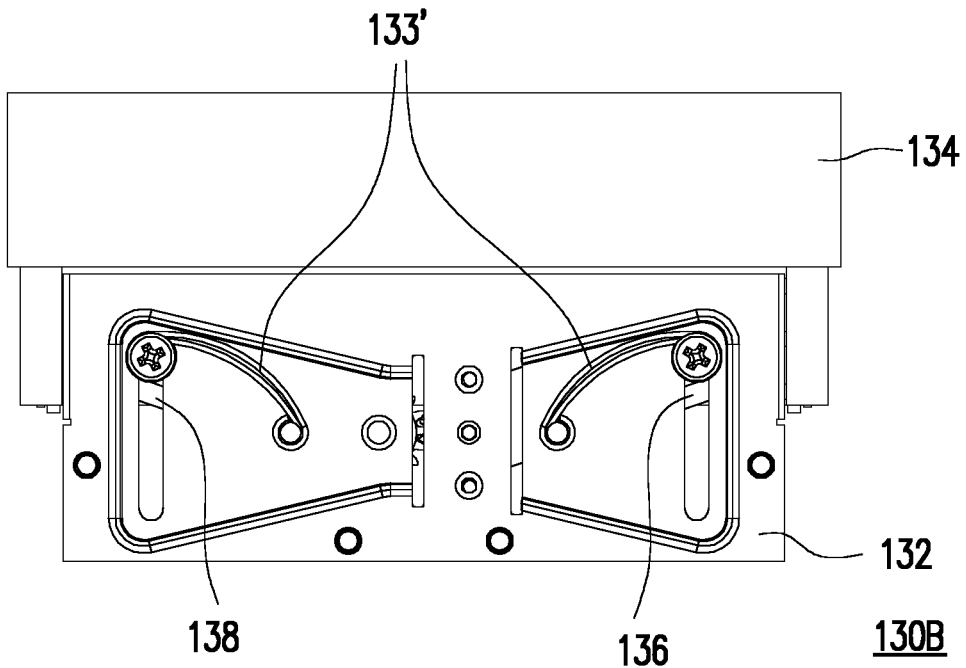

FIG. 12A

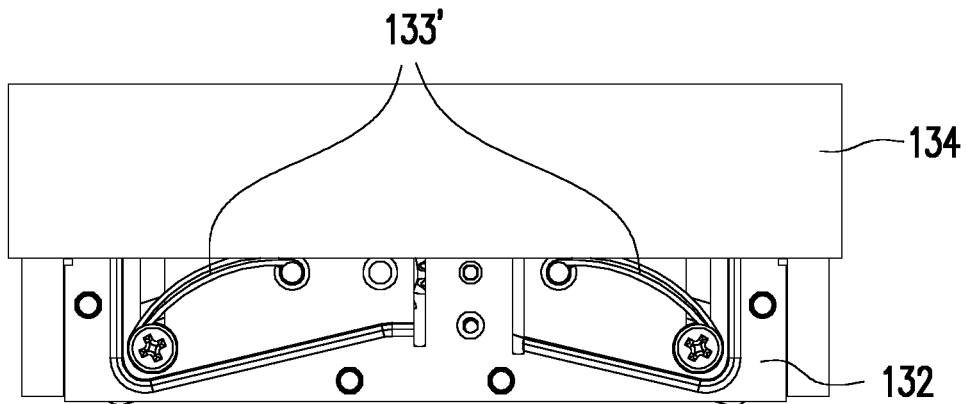

FIG. 12B

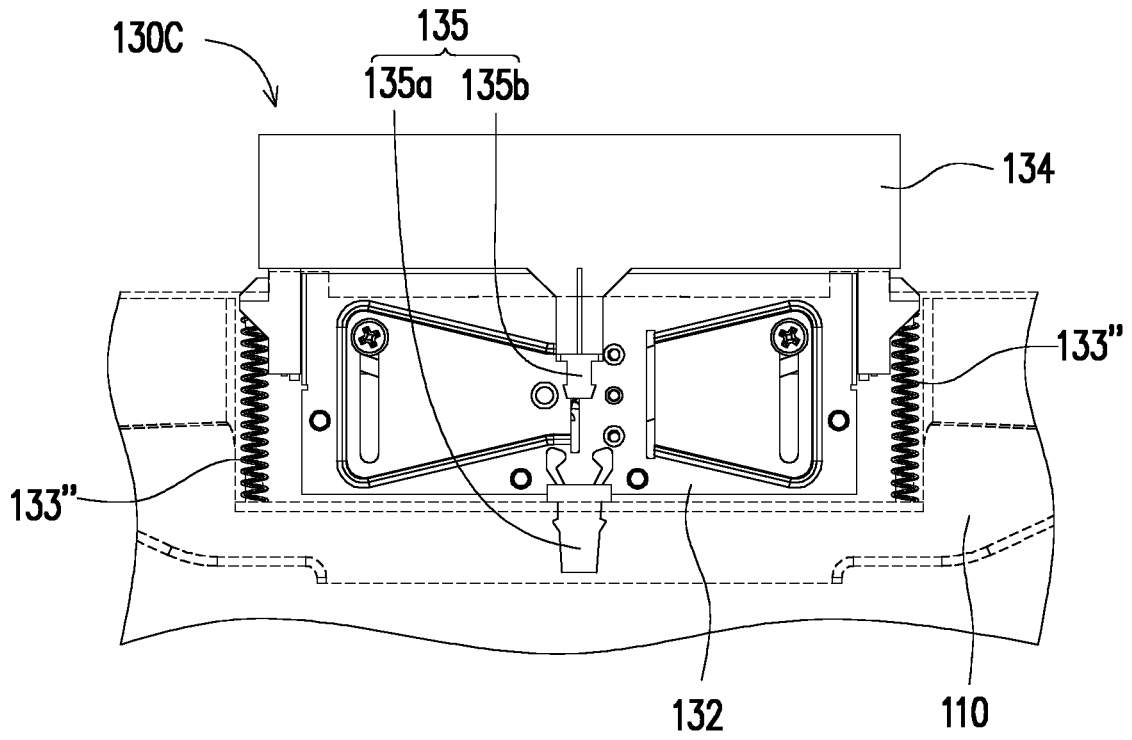

FIG. 13A

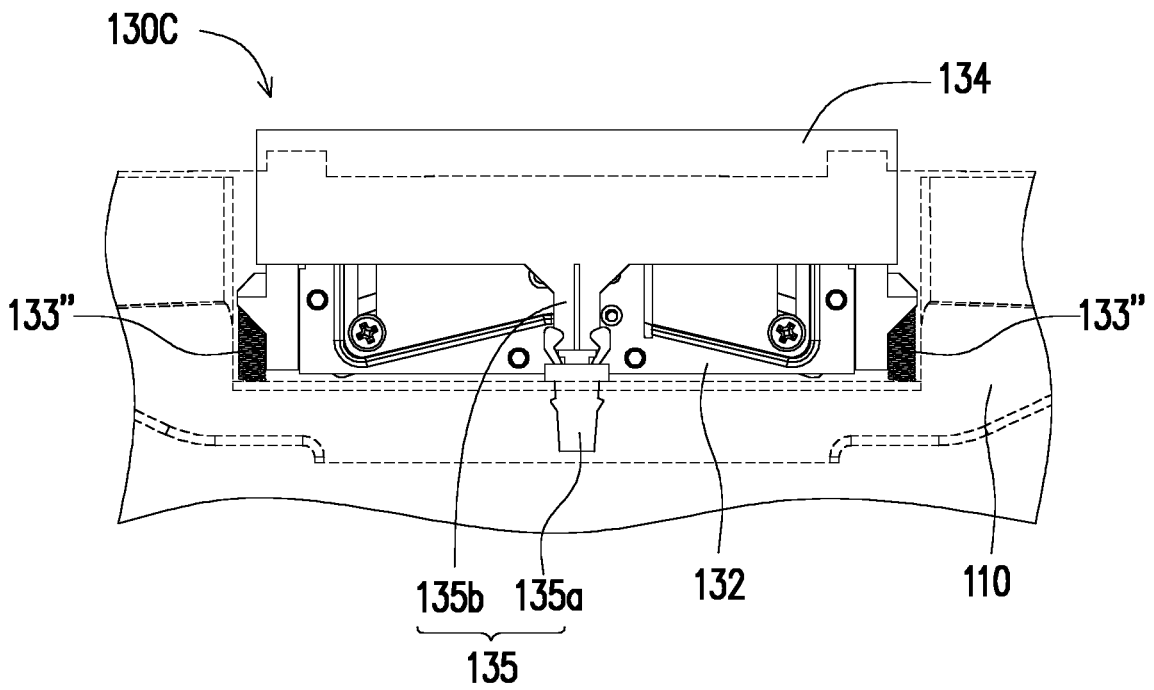

FIG. 13B

ELEVATOR ASSEMBLY AND ELECTRONIC DEVICE

CROSS-REFERENCE TO RELATED APPLICATION

[0001] This application claims the priority benefit of China application no. 202011101776.4, filed on Oct. 15, 2020. The entirety of the above-mentioned patent application is hereby incorporated by reference herein and made a part of this specification.

TECHNICAL FIELD

[0002] The invention relates to an elevator assembly and an electronic device, and more particularly, relates to an elevator assembly that can be connected to an image capturing unit and an electronic device having the elevator assembly.

BACKGROUND

[0003] For most of all-in-one PCs (AIO PCs), an image capturing unit is disposed on top of a body at a frame above a display surface, and is generally installed directly in the frame or assembled on the frame in form of module. The image capturing unit directly installed in the frame will increase a frame width, which goes against the current narrow frame design trend. The image capturing unit assembled on the frame in form of module is visually obtrusive.

[0004] To overcome the above-mentioned problems, in some AIO PCs, the image capturing unit is designed to be lifted and lowered by an elevator assembly and can be hidden when not in use to provide a better appearance for the body. However, the general elevator assembly is prone to moving up and down asynchronously due to uneven force applied on the left and right ends by the user, so the elevator assembly may not be operated smoothly. Some elevator assemblies have added scissor feet and other complicated structures to improve the smoothness of operation, but the difficulty of assembly and the cost of equipment will be significantly increased.

SUMMARY

[0005] The invention provides an elevator assembly, which improves the smoothness of operation by a simple structure.

[0006] The invention provides an electronic device with an elevator assembly having a simple structure to improve the smoothness of operation.

[0007] The elevator assembly of the invention includes a first bracket, a second bracket, a first connecting rod and a second connecting rod. The second bracket is slidably disposed on the first bracket. The first connecting rod has a first pivot end and a first sliding end. The first pivot end is pivoted to the first bracket and provided with a first gear portion, and the first sliding end is slidably disposed on the first bracket and connected to the second bracket. The second connecting rod has a second pivot end and a second sliding end. The second pivot end is pivoted to the first bracket and provided with a second gear portion, the second sliding end is slidably disposed on the second bracket and connected to the second bracket, and the first gear portion and the second gear portion are engaged with each other.

[0008] The electronic device of the invention includes a device body, an image capturing unit and an elevator assembly. The elevator assembly includes a first bracket, a second bracket, a first connecting rod and a second connecting rod. The first bracket is disposed on the device body. The second bracket is slidably disposed on the first bracket. The image capturing unit is disposed on the second bracket. The first connecting rod has a first pivot end and a first sliding end. The first pivot end is pivoted to the first bracket and provided with a first gear portion, and the first sliding end is slidably disposed on the first bracket and connected to the second bracket. The second connecting rod has a second pivot end and a second sliding end. The second pivot end is pivoted to the first bracket and provided with a second gear portion, the second sliding end is slidably disposed on the second bracket and connected to the second bracket, and the first gear portion and the second gear portion are engaged with each other.

[0009] In an embodiment of the invention, a first sliding portion and a second sliding portion are respectively provided at two ends of the first bracket, the second bracket is slidably disposed on the first sliding portion and the second sliding portion, the first connecting rod is located between the first sliding portion and the second connecting rod, and the second connecting rod is located between the second sliding portion and the first connecting rod.

[0010] In an embodiment of the invention, the first sliding end is adjacent to the first sliding portion and located between the first sliding portion and the first pivot end, and the second sliding end is adjacent to the second sliding portion and located between the second sliding portion and the second pivot end.

[0011] In an embodiment of the invention, at least one of the first sliding portion and the second sliding portion includes a roller or a sliding block.

[0012] In an embodiment of the invention, two sliding rails are respectively provided at two ends of the second bracket, and the first sliding portion and second sliding portion are respectively slidably disposed on the two sliding rails.

[0013] In an embodiment of the invention, at least one of the first sliding portion and the second sliding portion includes a plurality of rollers, the corresponding sliding rail has a first inner wall and a second inner wall opposite to each other, a part of the rollers contacts the first inner wall and has a distance from the second inner wall, and another part of the rollers contacts the second inner wall and has a distance from the first inner wall.

[0014] In an embodiment of the invention, the elevator assembly further includes a damper bearing. The damper bearing is connected between the first pivot end and the first bracket.

[0015] In an embodiment of the invention, the second bracket is provided with a first convex post and a second convex post, the first bracket is provided with a first sliding slot and a second sliding slot, the first sliding end of the first connecting rod is provided with a third sliding slot, the second sliding end of the second connecting rod is provided with a fourth sliding slot, the first convex post is inserted to the first sliding slot and the third sliding slot, and the second convex post is inserted to the second sliding slot and the fourth sliding slot.

[0016] In an embodiment of the invention, the elevator assembly further includes an elastic component. The elastic

component is connected between the first connecting rod and the second connecting rod, and the second bracket is adapted to be positioned at a first position or a second position through an elastic force of the elastic component and adapted to resist the elastic force of the elastic component to move to a third position between the first position and the second position.

[0017] In an embodiment of the invention, a first cylinder is provided on the first connecting rod, a second cylinder is provided on the second connecting rod, the first bracket is provided with two arc slots, and the first cylinder and the second cylinder are respectively inserted to the two arc slots and respectively connected to two opposite ends of the elastic component.

[0018] In an embodiment of the invention, the elevator assembly further includes two elastic components. One of the elastic components is connected between the first connecting rod and the first bracket, the other one of the elastic components is connected between the second connecting rod and the first bracket, and the second bracket is adapted to be positioned at a first position or a second position through elastic forces of the two elastic components and adapted to resist the elastic forces of the two elastic components to move to a third position between the first position and the second position.

[0019] In an embodiment of the invention, the elevator assembly further includes a push-push mechanism. The push-push mechanism is partially disposed on the second bracket, and the second bracket is adapted to be positioned at the first bracket through the push-push mechanism.

[0020] In an embodiment of the invention, the elevator assembly further includes a push-push mechanism. A part of the push-push mechanism is disposed on the second bracket, another part of the push-push mechanism is disposed on the device body, and the elevator assembly is adapted to be positioned at the device body through the push-push mechanism.

[0021] In an embodiment of the invention, the elevator assembly further includes at least one elastic component. The at least one elastic component is connected to the second bracket, and when the push-push mechanism releases the second bracket, the second bracket is adapted to slide relative to the first bracket through an elastic force of the at least one elastic component.

[0022] In an embodiment of the invention, the elevator assembly further includes at least one elastic component. The at least one elastic component is connected between the device body and the second bracket, and when the push-push mechanism releases the second bracket, the second bracket is adapted to slide relative to the device body and the first bracket through an elastic force of the at least one elastic component.

[0023] Based on the above, in the elevator assembly of the invention, the first connecting rod and the second connecting rod that can be synchronously moved are disposed between the first bracket and the second bracket slidably disposed on each other. Therefore, in the process during which the second bracket slides relative to the first bracket, the left and right ends of the second bracket can be synchronously lifted and lowered by the link relationship of the first connecting rod and the second connecting rod. Therefore, the elevator assembly can be operated smoothly without a complicate structure such as scissor feet to be added to the elevator assembly.

BRIEF DESCRIPTION OF THE DRAWINGS

[0024] FIG. 1 is a partial 3D view of an electronic device according to an embodiment of the invention.

[0025] FIG. 2 is a 3D view of an elevator assembly of FIG. 1.

[0026] FIG. 3 is an exploded view of the elevator assembly of FIG. 2.

[0027] FIG. 4A to FIG. 4C illustrate how a second bracket of FIG. 2 slides relative to a first bracket.

[0028] FIG. 5A to FIG. 5C are back views of FIG. 4A to FIG. 4C, respectively.

[0029] FIG. 6 illustrates a partial structure of the elevator assembly of FIG. 2.

[0030] FIG. 7 is a 3D view of a damper bearing of FIG. 2.

[0031] FIG. 8A to FIG. 8F illustrate the assembly process of the elevator of FIG. 1.

[0032] FIG. 9 is a front view of an elevator assembly according to another embodiment of the invention.

[0033] FIG. 10 is a back view of the elevator assembly of FIG. 9.

[0034] FIG. 11 is a cross-sectional view of the elevator assembly of FIG. 9 along line I-I.

[0035] FIG. 12A and FIG. 12B illustrate an operating process of an elevator assembly according to another embodiment of the invention.

[0036] FIG. 13A and FIG. 13B illustrate an operating process of an elevator assembly according to another embodiment of the invention.

DETAILED DESCRIPTION

[0037] FIG. 1 is a partial 3D view of an electronic device according to an embodiment of the invention. Referring to FIG. 1, an electronic device 100 of this embodiment is, for example, an all-in-one PC (AIO PC) and includes a device body 110, an image capturing unit 120 and an elevator assembly 130. The elevator assembly 130 is disposed on the device body 110. The image capturing unit 120 is disposed on the elevator assembly 130 and can be lifted or lowered relative to the device body 110 through an operation of the elevator assembly 130.

[0038] FIG. 2 is a 3D view of an elevator assembly of FIG. 1. FIG. 3 is an exploded view of the elevator assembly of FIG. 2. Referring to FIG. 1 to FIG. 3, in detail, the elevator assembly 130 includes a first bracket 132, a second bracket 134, a first connecting rod 136 and a second connecting rod 138. The first bracket 132 is provided with a first sliding portion 132a and a second sliding portion 132b. The second bracket 134 is slidably disposed on the first sliding portion 132a and the second sliding portion 132b along a first direction D1. The image capturing unit 120 (illustrated in FIG. 1) is disposed on the second bracket 134. The first connecting rod 136 has a first pivot end 136a and a first sliding end 136b. The first pivot end 136a is pivotally connected to the first bracket 132 along a first axis A1 perpendicular to the first direction D1 and provided with a first gear portion 136a1. The first sliding end 136b is slidably disposed on the first bracket 132 along the first direction D1 and connected to the second bracket 134. The second connecting rod 138 has a second pivot end 138a and a second sliding end 138b. The second pivot end 138a is pivotally connected to the first bracket 132 along a second axis A2 perpendicular to the first direction D1 and provided with a second gear portion 138a1. The second sliding end

138b is slidably disposed on the first bracket **132** along the first direction **D1** and connected to the second bracket **134**. The first gear portion **136a1** and the second gear portion **138a1** are engaged with each other.

[0039] FIG. 4A to FIG. 4C illustrate how a second bracket of FIG. 2 slides relative to a first bracket. FIG. 5A to FIG. 5C are back views of FIG. 4A to FIG. 4C, respectively. In this embodiment, as described above, the first connecting rod **136** and the second connecting rod **138** that can be synchronously moved are disposed between the first bracket **132** and the second bracket **134** slidably disposed on each other. Accordingly, in the process during which the second bracket **134** slides relative to the first bracket **132** as shown by FIG. 4A to FIG. 4C or FIG. 4C to 4A, the first gear portion **136a1** of the first connecting rod **136** and the second gear portion **138a1** of the second connecting rod **138** drive each other, so that the first sliding end **136b** of the first connecting rod **136** and the second sliding end **138b** of the second connecting rod **138** can synchronously slide along the first bracket **132** through a link relationship of the first connecting rod **136** and the second connecting rod **138**. In this way, even if the user applies uneven left and right forces on the second bracket **134**, the left and right ends of the second bracket **134** can still be lifted and lowered synchronously. Therefore, the elevator assembly **130** can be operated smoothly without a complicate structure such as scissor feet to be added to the elevator assembly **130**.

[0040] Furthermore, the first connecting rod **136** and the second connecting rod **138** of this embodiment are symmetrical to a third axis **A3** (marked in FIG. 4A to FIG. 4C). The third axis **A3** is parallel to the first direction **D1** and overlaps a geometric center of the first bracket **132** and a geometry center of the second bracket **134** in a second direction **D2** (marked in FIG. 2) parallel to the first axis **A1**. Accordingly, the first connecting rod **136** and the second connecting rod **138** arranged in a bilaterally symmetrical manner in the elevator assembly **130** can reliably assist the left and right ends of the second bracket **134** to slide synchronously.

[0041] Further, in this embodiment, the first connecting rod **136** is located between the first sliding portion **132a** and the second connecting rod **138**, and the second connecting rod **138** is located between the second sliding portion **132b** and the first connecting rod **136**. The first sliding end **136b** is located between the first sliding portion **132a** and the first pivot end **136a**, and the second sliding end **138b** is located between the second sliding portion **132b** and the second pivot end **138a**. The first pivot end **136a** is away from the first sliding portion **132a** (i.e., a distance between the first sliding end **136b** and the first sliding portion **132a** is less than a distance between the first sliding end **136b** and the first pivot end **136a**) and the first pivot end **136a** is away from the first sliding portion **132a** (i.e., a distance between the second sliding end **138b** and the second pivot end **138a**) is less than a distance between the second sliding end **138b** and the second pivot end **138a**). In this way, the first sliding end **136b** and the second sliding end **138b** respectively adjacent to the left and right ends of the second bracket **134** can reliably assist the left and right ends of the second bracket **134** to slide synchronously.

[0042] In this embodiment, the second bracket **134** is provided with a first convex post **134c** and a second convex post **134d**. Correspondingly, the first bracket **132** is provided with a first sliding slot **132c** and a second sliding slot **132d**;

the first sliding end **136b** of the first connecting rod **136** is provided with a third sliding slot **136b1**; and the second sliding end **138b** of the second connecting rod **138** is provided with a fourth sliding slot **138b1**. The first convex post **134c** is inserted to the first sliding slot **132c** and the third sliding slot **136b1**, and the second convex post **134d** is inserted to the second sliding slot **132d** and the fourth sliding slot **138b1**. Accordingly, the first sliding end **136b** of the first connecting rod **136** can be slidably disposed on the first bracket **132** and connected to the second bracket **134**, and the second sliding end **138b** of the second connecting rod **138** can be slidably disposed on the first bracket **132** and connected to the second bracket **134**.

[0043] Referring to FIG. 2 and FIG. 5A, the elevator assembly **130** of this embodiment further includes an elastic component **133**, and the elastic component **133** is, for example, an expansion spring and connected between the first connecting rod **136** and the second connecting rod **138**. The second bracket **134** can be positioned at a first position shown in FIG. 4A and FIG. 5A or a second position shown in FIG. 4C and FIG. 5C through an elastic force of the elastic component **133** and can resist the elastic force of the elastic component **133** to move to a third position shown in FIG. 4B and FIG. 5B between the first position and the second position. Accordingly, when the user applies force on the second bracket **134** so it moves towards the first position or the third position, the elastic force of the elastic component **133** will drive the second bracket **134** to completely move to the first position or the third position.

[0044] Furthermore, in this embodiment, a first cylinder **136c** is provided on the first connecting rod **136**, and a second cylinder **138c** is provided on the second connecting rod **138**. Correspondingly, the first bracket **132** is provided with two arc slots **132e**, and the first cylinder **136c** and the second cylinder **138c** are respectively inserted to the two arc slots **132e** and respectively connected to two opposite ends of the elastic component **133**. In other embodiments, the elastic component **133** can be connected between the first connecting rod **136** and the second connecting rods **138** by other methods, which are not limited by the invention.

[0045] In this embodiment, as shown in FIG. 2, two sliding rails **134a** are respectively provided at two ends of the second bracket **134**, and the first sliding portion **132a** and second sliding portion **132b** are respectively slidably disposed on the two sliding rails **134a**. FIG. 6 illustrates a partial structure of the elevator assembly of FIG. 2. Specifically, as shown in FIG. 6, the first sliding portion **132a** includes a plurality of rollers (three rollers **132a1**, **132a2** and **132a3** are illustrated), the corresponding sliding rail **134a** has a first inner wall **134a1** and a second inner wall **134a2** opposite to each other. The roller **132a2** contacts the inner wall **134a1** and has a distance from the second inner wall **134a2**, and the rollers **132a1** and **132a3** contact the second inner wall **134a2** and have a distance from the first inner wall **134a1**. That is, each roller only contacts one of the first inner wall **134a1** and the second inner wall **134a2** instead of both the first inner wall **134a1** and the second inner wall **134a2**. Accordingly, when the first sliding portion **132a** moves relative to the slide rail **134a** so that each roller rolls along the inner wall contacted by the roller, each roller will not contact the other inner wall to generate resistance. The configuration and operation mode of the second sliding portion **132b** are the same or similar to the configuration and

operation mode of the first sliding portion **132a**, and the description will not be repeated here.

[0046] FIG. 7 is a 3D view of a damper bearing of FIG. 2. Referring to FIG. 2, FIG. 3 and FIG. 7, the elevator assembly **130** of this embodiment further includes a damper bearing **131**. The damper bearing **131** is connected between the first pivot end **136a** and the first bracket **132**, so that the rotation of the first pivot end **136a** and the second pivot end **138a** linked therewith is smoother. In other embodiments, the damper bearing **131** may be connected between the second pivot end **138a** and the first bracket **132** instead, and the invention is not limited thereto.

[0047] The following illustrates the assembling method of an elevator mechanism of this embodiment by using the drawings as an example. FIG. 8A to FIG. 8F illustrate the assembly process of the elevator of FIG. 1. First of all, as shown in FIG. 8A and FIG. 8B, the first connecting rod **136**, the second connecting rod **138** and the damper bearing **131** are assembled on a main body **1341** of the second bracket **134**. Next, as shown in FIG. 8C and FIG. 8D, the first sliding portion **132a** and the second sliding portion **132b** of the first bracket **132** are slid into the sliding rails **134a** of the second bracket **134**, and the first bracket **132**, the second bracket **134**, the first connecting rod **136**, the second connecting rod **138** and the elastic component **133** are connected through the first convex post **134c**, the second convex post **134d**, the first cylinder **136c** and the second cylinder **138c**. Here, the first convex post **134c**, the second convex post **134d**, the first cylinder **136c** and the second cylinder **138c** may include screw and boss. As shown in FIG. 8E, the damper bearing **131** may be connected to the first bracket **132** through a locking piece **132g**, and the second connecting rod **138** may be connected to the first bracket **132** through locking pieces **132f** and **132g**, so as to complete the elevator assembly **130** shown in FIG. 2. Here, the locking pieces may include screw and boss. Then, as shown in FIG. 8F, a back cover **1342** of the second bracket **134** is assembled on the main body **1341** of the second bracket **134**, and the first bracket **132** is connected to the device body **110** through a locking piece **132h**.

[0048] FIG. 9 is a front view of an elevator assembly according to another embodiment of the invention. FIG. 10 is a back view of the elevator assembly of FIG. 9. FIG. 11 is a cross-sectional view of the elevator assembly of FIG. 9 along line I-I. The difference between the embodiment shown in FIG. 9 to FIG. 11 and the foregoing embodiment is that in an elevator assembly **130A** shown in FIG. 9 to FIG. 11, a first sliding portion **132a'** and a second sliding portion **132a'** of the first bracket **132** are sliding blocks instead of the rollers. In addition, in the elevator assembly **130A** shown in FIG. 9 to FIG. 11, the damping bearing **131** is omitted. By omitting the arrangement of the rollers and the damping bearing, the cost of the device can be reduced.

[0049] FIG. 12A and FIG. 12B illustrate an operating process of an elevator assembly according to another embodiment of the invention. The difference between the embodiment shown in FIG. 12A and FIG. 12B and the foregoing embodiments is that in an elevator assembly **130B** shown in FIG. 12A and FIG. 12B, two elastic components **133'** are used to replace the single one elastic component **133** in the foregoing embodiments. The elastic components **133'** are, for example, compression springs. One of the elastic components **133'** is connected between the first connecting rod **136** and the first bracket **132**; and the other one of the

elastic components **133'** is connected between the second connecting rod **138** and the first bracket **132**. The second bracket **134** can be positioned at a first position shown in FIG. 12A or a second position shown in FIG. 12B through elastic forces of the two elastic components **133'** and can resist the elastic forces of the two elastic components **133'** to move to a third position between the first position and the second position.

[0050] More specifically, one end of each of the two elastic components **133'** of this embodiment closer to the third axis **A3** is fixed on the first bracket **132**, and other ends are respectively disposed on the first convex post **134c** and the second convex post **134d**. Accordingly, the elastic forces of the two elastic components **133'** will drive the first connecting rod **136** and the second connecting rod **138** to completely move the second bracket **134** to the first position or the second position.

[0051] FIG. 13A and FIG. 13B illustrate an operating process of an elevator assembly according to another embodiment of the invention. The difference between the embodiment shown in FIG. 13A and FIG. 13B and the foregoing embodiments is that an elevator assembly **130C** shown in FIG. 13A and FIG. 13B does not include the elastic components **133** and **133'** of the foregoing embodiments, and the elevator assembly **130C** further includes a push-push mechanism **135**. The push-push mechanism **135** includes a locking piece **135a** and a latch **135b**. The locking piece **135a** is disposed on the device body **110**, and the latch **135b** is disposed on the second bracket **134**. The second bracket **134** is adapted to be positioned at the first bracket **132** as shown in FIG. 13B by the locking of the locking piece **135a** on the latch **135b**. The elevator assembly **130C** further includes two elastic components **133''**. The user can press the second bracket **134** to drive the locking piece **135a** to release the latch **135b** and the second bracket **134**. At this time, the second bracket **134** slides relative to the first bracket **132** from a position shown in FIG. 13B to a position shown in FIG. 13A through the elastic forces of the elastic components **133''**.

1. An elevator assembly, comprising:

- a first bracket;
- a second bracket, slidably disposed on the first bracket;
- a first connecting rod, having a first pivot end and a first sliding end, wherein the first pivot end is pivoted to the first bracket and provided with a first gear portion, and the first sliding end is slidably disposed on the first bracket and connected to the second bracket; and
- a second connecting rod, having a second pivot end and a second sliding end, wherein the second pivot end is pivoted to the first bracket and provided with a second gear portion, the second sliding end is slidably disposed on the second bracket and connected to the second bracket, and the first gear portion and the second gear portion are engaged with each other.

2. The elevator assembly of claim 1, wherein a first sliding portion and a second sliding portion are respectively provided at two ends of the first bracket, the second bracket is slidably disposed on the first sliding portion and the second sliding portion, the first connecting rod is located between the first sliding portion and the second connecting rod, and the second connecting rod is located between the second sliding portion and the first connecting rod.

3. The elevator assembly of claim 2, wherein the first sliding end is adjacent to the first sliding portion and located

between the first sliding portion and the first pivot end, and the second sliding end is adjacent to the second sliding portion and located between the second sliding portion and the second pivot end.

4. The elevator assembly of claim 2, wherein two sliding rails are respectively provided at two ends of the second bracket, the first sliding portion and the second sliding portion are respectively slidably disposed on the two sliding rails, at least one of the first sliding portion and the second sliding portion comprises a plurality of rollers, the corresponding sliding rail has a first inner wall and a second inner wall opposite to each other, a part of the rollers contacts the first inner wall and has a distance from the second inner wall, and another part of the rollers contacts the second inner wall and has a distance from the first inner wall.

5. The elevator assembly of claim 1, further comprising: a damper bearing, wherein the damper bearing is connected between the first pivot end and the first bracket.

6. The elevator assembly of claim 1, wherein the second bracket is provided with a first convex post and a second convex post, the first bracket is provided with a first sliding slot and a second sliding slot, the first sliding end of the first connecting rod is provided with a third sliding slot, the second sliding end of the second connecting rod is provided with a fourth sliding slot, the first convex post is inserted to the first sliding slot and the third sliding slot, and the second convex post is inserted to the second sliding slot and the fourth sliding slot.

7. The elevator assembly of claim 1, further comprising: an elastic component, wherein the elastic component is connected between the first connecting rod and the second connecting rod, and the second bracket is adapted to be positioned at a first position or a second position through an elastic force of the elastic component and adapted to resist the elastic force of the elastic component to move to a third position between the first position and the second position.

8. The elevator assembly of claim 7, wherein a first cylinder is provided on the first connecting rod, a second cylinder is provided on the second connecting rod, the first bracket is provided with two arc slots, and the first cylinder and the second cylinder are respectively inserted to the two arc slots and respectively connected to two opposite ends of the elastic component.

9. The elevator assembly of claim 1, further comprising: two elastic components, wherein one of the elastic components is connected between the first connecting rod and the first bracket, the other one of the elastic components is connected between the second connecting rod and the first bracket, and the second bracket is adapted to be positioned at a first position or a second position through elastic forces of the two elastic components and adapted to resist the elastic forces of the two elastic components to move to a third position between the first position and the second position.

10. The elevator assembly of claim 1, further comprising: a push-push mechanism and at least one elastic component, wherein the push-push mechanism is partially disposed on the second bracket, and the second bracket is adapted to be positioned at the first bracket through the push-push mechanism, wherein the at least one elastic component is connected to the second bracket, and when the push-push mechanism releases the second bracket, the second bracket is adapted to slide relative to the first bracket through an elastic force of the at least one elastic component.

11. An electronic device, comprising:
a device body;

an image capturing unit; and

an elevator assembly, comprising:

a first bracket, disposed on the device body;

a second bracket, slidably disposed on the first bracket, wherein the image capturing unit is disposed on the second bracket;

a first connecting rod, having a first pivot end and a first sliding end, wherein the first pivot end is pivoted to the first bracket and provided with a first gear portion, and the first sliding end is slidably disposed on the first bracket and connected to the second bracket; and

a second connecting rod, having a second pivot end and a second sliding end, wherein the second pivot end is pivoted to the first bracket and provided with a second gear portion, the second sliding end is slidably disposed on the second bracket and connected to the second bracket, and the first gear portion and the second gear portion are engaged with each other.

12. The electronic device of claim 11, wherein a first sliding portion and a second sliding portion are provided at two ends of the first bracket, the second bracket is slidably disposed on the first sliding portion and the second sliding portion, the first connecting rod is located between the first sliding portion and the second connecting rod, and the second connecting rod is located between the second sliding portion and the first connecting rod.

13. The electronic device of claim 12, wherein the first sliding end is adjacent to the first sliding portion and located between the first sliding portion and the first pivot end, and the second sliding end is adjacent to the second sliding portion and located between the second sliding portion and the second pivot end.

14. The electronic device of claim 12, wherein two sliding rails are respectively provided at two ends of the second bracket, the first sliding portion and the second sliding portion are respectively slidably disposed on the two sliding rails, at least one of the first sliding portion and the second sliding portion comprises a plurality of rollers, the corresponding sliding rail has a first inner wall and a second inner wall opposite to each other, a part of the rollers contacts the first inner wall and has a distance from the second inner wall, and another part of the rollers contacts the second inner wall and has a distance from the first inner wall.

15. The electronic device of claim 11, wherein the elevator assembly further comprises a damper bearing, and the damper bearing is connected between the first pivot end and the first bracket.

16. The electronic device of claim 11, wherein the second bracket is provided with a first convex post and a second convex post, the first bracket is provided with a first sliding slot and a second sliding slot, the first sliding end of the first connecting rod is provided with a third sliding slot, the second sliding end of the second connecting rod is provided with a fourth sliding slot, the first convex post is inserted to the first sliding slot and the third sliding slot, and the second convex post is inserted to the second sliding slot and the fourth sliding slot.

17. The electronic device of claim 11, wherein the elevator assembly further comprises an elastic component, the elastic component is connected between the first connecting rod and the second connecting rod, and the second bracket

is adapted to be positioned at a first position or a second position through an elastic force of the elastic component and adapted to resist the elastic force of the elastic component to move to a third position between the first position and the second position.

18. The electronic device of claim **17**, wherein a first cylinder is provided on the first connecting rod, a second cylinder is provided on the second connecting rod, the first bracket is provided with two arc slots, and the first cylinder and the second cylinder are respectively inserted to the two arc slots and respectively connected to two opposite ends of the elastic component.

19. The electronic device of claim **11**, wherein the elevator assembly further comprises two elastic components, one of the elastic components is connected between the first connecting rod and the first bracket, the other one of the elastic components is connected between the second connecting rod and the first bracket, and the second bracket is

adapted to be positioned at a first position or a second position through elastic forces of the two elastic components and adapted to resist the elastic forces of the two elastic components to move to a third position between the first position and the second position.

20. The electronic device of claim **11**, wherein the elevator assembly further comprises a push-push mechanism and at least one elastic component, a part of the push-push mechanism is disposed on the second bracket, another part of the push-push mechanism is disposed on the device body, the elevator assembly is adapted to be positioned at the device body through the push-push mechanism, the at least one elastic component is connected to the second bracket, and when the push-push mechanism releases the second bracket, the second bracket is adapted to slide relative to the device body and the first bracket through an elastic force of the at least one elastic component.

* * * * *