



(12) **EUROPEAN PATENT APPLICATION**

(88) Date of publication A3:  
**01.03.2000 Bulletin 2000/09**

(51) Int. Cl.<sup>7</sup>: **E03C 1/04**

(43) Date of publication A2:  
**23.09.1998 Bulletin 1998/39**

(21) Application number: **98104472.0**

(22) Date of filing: **12.03.1998**

(84) Designated Contracting States:  
**AT BE CH DE DK ES FI FR GB GR IE IT LI LU MC  
NL PT SE**  
Designated Extension States:  
**AL LT LV MK RO SI**

(71) Applicant: **INAX CORPORATION**  
**Tokoname-Shi, Aichi 479 (JP)**

(72) Inventor: **Nagata, Masaaki**  
**Tokoname-shi, Aichi (JP)**

(30) Priority: **19.03.1997 JP 8604397**  
**10.06.1997 JP 16955097**  
**16.10.1997 JP 28360797**  
**14.11.1997 JP 31359597**  
**28.11.1997 JP 32821097**

(74) Representative:  
**Kraus, Walter, Dr. et al**  
**Patentanwälte Kraus, Weisert & Partner**  
**Thomas-Wimmer-Ring 15**  
**80539 München (DE)**

(54) **Structure for fixing faucet**

(57) A structure for fixing a faucet to a counter by using an adapter assembly. In the structure, an adapter and a holder for vertically clamping the counter therebetween are shifted relative to each other about a bolt connecting the adapter and the holder so as to prevent the backlash of the faucet in the rotational direction. An adapter assembly has only one holder 32 formed in a circular arc shape extending along a hole of the counter and having a long circumference length. The holder 32 is connected to the adapter 30 by screwing two bolts 34, 36 at both ends of the holder 32 in the circumferential direction.

Fig.1

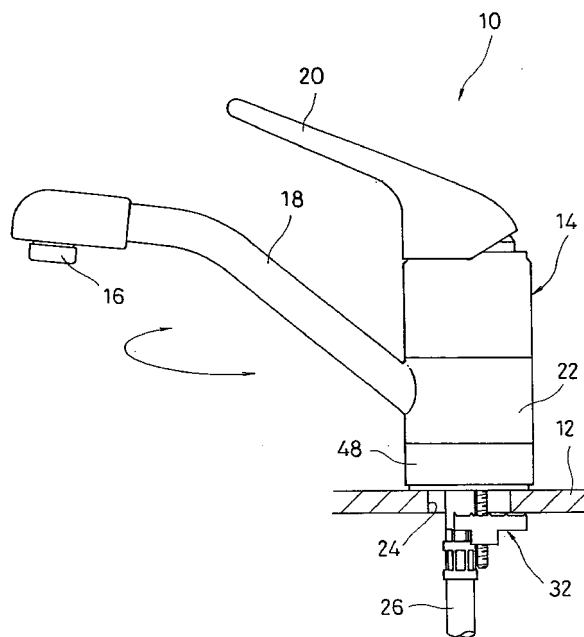



European Patent Office

EUROPEAN SEARCH REPORT

Application Number  
EP 98 10 4472

DOCUMENTS CONSIDERED TO BE RELEVANT			
Category	Citation of document with indication, where appropriate, of relevant passages	Relevant to claim	CLASSIFICATION OF THE APPLICATION (Int.Cl.6)
X	EP 0 293 655 A (GROHE) 7 December 1988 (1988-12-07)	1,2	E03C1/04
A	* the whole document *	3-13,28,31	
A	--- EP 0 231 557 A (VENLO) 12 August 1987 (1987-08-12)	1	
A	--- EP 0 724 041 A (BERTOLI) 31 July 1996 (1996-07-31)	14	
A	--- US 5 487 408 A (POKHIS) 30 January 1996 (1996-01-30)	14	
A	--- EP 0 576 391 A (FIDES TRUST) 29 December 1993 (1993-12-29)	14	
			TECHNICAL FIELDS SEARCHED (Int.Cl.6)
X	--- DE 35 09 649 A (IDEAL-STANDARD) 18 September 1986 (1986-09-18)	22	E03C F16K F16L
A	--- EP 0 113 444 A (FRIEDRICH GROHE) 18 July 1984 (1984-07-18)	22	
	----- The present search report has been drawn up for all claims		
Place of search		Date of completion of the search	Examiner
THE HAGUE		29 December 1999	Hannaart, J
CATEGORY OF CITED DOCUMENTS			
X : particularly relevant if taken alone Y : particularly relevant if combined with another document of the same category A : technological background O : non-written disclosure P : intermediate document		T : theory or principle underlying the invention E : earlier patent document, but published on, or after the filing date D : document cited in the application L : document cited for other reasons & : member of the same patent family, corresponding document	

EPO FORM 1503 03.82 (P04C01)

**CLAIMS INCURRING FEES**

The present European patent application comprised at the time of filing more than ten claims.

- Only part of the claims have been paid within the prescribed time limit. The present European search report has been drawn up for the first ten claims and for those claims for which claims fees have been paid, namely claim(s):
- No claims fees have been paid within the prescribed time limit. The present European search report has been drawn up for the first ten claims.

**LACK OF UNITY OF INVENTION**

The Search Division considers that the present European patent application does not comply with the requirements of unity of invention and relates to several inventions or groups of inventions, namely:

see sheet B

- All further search fees have been paid within the fixed time limit. The present European search report has been drawn up for all claims.
- As all searchable claims could be searched without effort justifying an additional fee, the Search Division did not invite payment of any additional fee.
- Only part of the further search fees have been paid within the fixed time limit. The present European search report has been drawn up for those parts of the European patent application which relate to the inventions in respect of which search fees have been paid, namely claims:
- None of the further search fees have been paid within the fixed time limit. The present European search report has been drawn up for those parts of the European patent application which relate to the invention first mentioned in the claims, namely claims:



The Search Division considers that the present European patent application does not comply with the requirements of unity of invention and relates to several inventions or groups of inventions, namely:

1. Claims: 1-13, 28-31

structure for fixing a faucet on a mounting base comprising an adapter and a holder

2. Claims: 14-21

base member for a faucet applied with a mark

3. Claims: 22-27

faucet comprising a guide piece for the insertion of a hose

**ANNEX TO THE EUROPEAN SEARCH REPORT  
ON EUROPEAN PATENT APPLICATION NO.**

EP 98 10 4472

This annex lists the patent family members relating to the patent documents cited in the above-mentioned European search report.  
The members are as contained in the European Patent Office EDP file on  
The European Patent Office is in no way liable for these particulars which are merely given for the purpose of information.

29-12-1999

Patent document cited in search report		Publication date	Patent family member(s)	Publication date
EP 293655	A	07-12-1988	DE 3717442 A	08-12-1988
			AT 79429 T	15-08-1992
			DE 3873620 A	17-09-1992
			JP 63312435 A	20-12-1988
			US 4848395 A	18-07-1989
EP 231557	A	12-08-1987	NL 8600151 A	17-08-1987
			AT 41187 T	15-03-1989
			DK 34187 A	24-07-1987
EP 724041	A	31-07-1996	IT RE950003 U	24-07-1996
			CA 2167773 A	25-07-1996
			CN 2262635 U	17-09-1997
US 5487408	A	30-01-1996	NONE	
EP 576391	A	29-12-1993	CH 685205 A	28-04-1995
			AT 108848 T	15-08-1994
			DE 59300005 D	25-08-1994
			US 5325887 A	05-07-1994
DE 3509649	A	18-09-1986	CA 1269589 A	29-05-1990
			EP 0204882 A	17-12-1986
			GR 860263 A	03-07-1986
			JP 1954694 C	28-07-1995
			JP 6076836 B	28-09-1994
			JP 61218874 A	29-09-1986
			US 4706709 A	17-11-1987
EP 113444	A	18-07-1984	DE 3245890 A	14-06-1984
			AT 18453 T	15-03-1986