

(19) World Intellectual Property Organization  
International Bureau



(43) International Publication Date  
13 December 2001 (13.12.2001)

PCT

(10) International Publication Number  
**WO 01/93725 A1**

(51) International Patent Classification<sup>7</sup>: **A47C 20/04**

(21) International Application Number: PCT/SE01/01260

(22) International Filing Date: 6 June 2001 (06.06.2001)

(25) Filing Language: Swedish

(26) Publication Language: English

(30) Priority Data:  
0002173-3 9 June 2000 (09.06.2000) SE

(71) Applicant (for all designated States except US):  
**HÄSTENS SÄNGAR AB** [SE/SE]; Box 136, S-731  
23 Köping (SE).

(72) Inventor; and

(75) Inventor/Applicant (for US only): **WALL, Jan** [SE/SE];  
Rundkvistvägen 4, S-840 92 Vemdalen (SE).

(74) Agents: **KARLSTRÖM, Lennart** et al.; Noréns Patent-  
byrå AB, Box 10198, S-100 55 STOCKHOLM (SE).

(81) Designated States (*national*): AE, AG, AL, AM, AT, AU, AZ, BA, BB, BG, BR, BY, BZ, CA, CH, CN, CR, CU, CZ, DE, DK, DM, DZ, EE, ES, FI, GB, GD, GE, GH, GM, HR, HU, ID, IL, IN, IS, JP, KE, KG, KP, KR, KZ, LC, LK, LR, LS, LT, LU, LV, MA, MD, MG, MK, MN, MW, MX, MZ, NO, NZ, PL, PT, RO, RU, SD, SE, SG, SI, SK, SL, TJ, TM, TR, TT, TZ, UA, UG, US, UZ, VN, YU, ZA, ZW.

(84) Designated States (*regional*): ARIPO patent (GH, GM, KE, LS, MW, MZ, SD, SL, SZ, TZ, UG, ZW), Eurasian patent (AM, AZ, BY, KG, KZ, MD, RU, TJ, TM), European patent (AT, BE, CH, CY, DE, DK, ES, FI, FR, GB, GR, IE, IT, LU, MC, NL, PT, SE, TR), OAPI patent (BF, BJ, CF, CG, CI, CM, GA, GN, GW, ML, MR, NE, SN, TD, TG).

**Published:**

— with international search report

For two-letter codes and other abbreviations, refer to the "Guidance Notes on Codes and Abbreviations" appearing at the beginning of each regular issue of the PCT Gazette.

(54) Title: DEVICE AT A BEDSTEAD

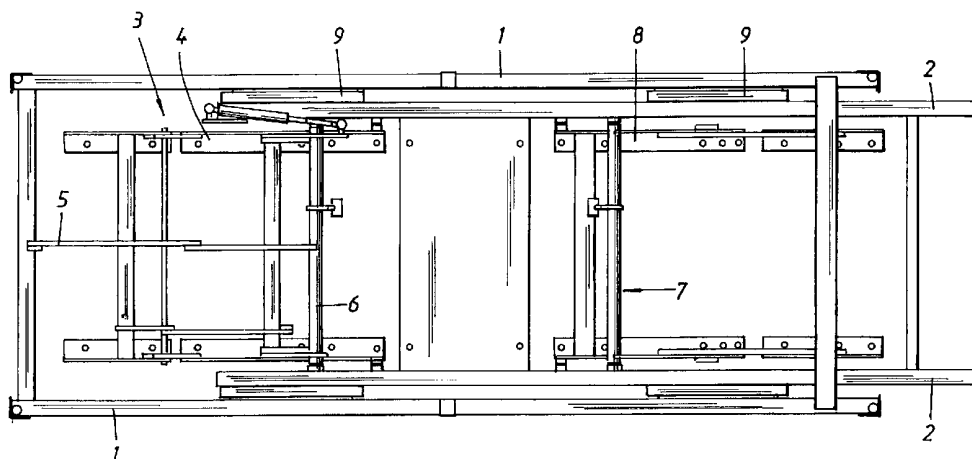

(57) Abstract: A bed frame arrangement which includes a fixed outer bed frame (1) and a movable inner bed frame (2), wherein the movable inner bed frame is displaceably mounted in the outer fixed bed frame (1) through the medium of elongate slide blocks that have a surface layer of low-friction material applied to at least one side.



WO 01/93725 A1

**DEVICE AT A BEDSTEAD**

The present invention relates to a bed frame arrangement and then particularly to an adjustable bedstead.

5

The use of bedsteads that include adjustable bed frames has long been known in the art, particularly in respect of so-called hospital beds. However, in recent times the use of adjustable bed frames has also become common in the home, even bed frames that include motorised frame-orientating devices. These bed frame arrangements include a fixed outer frame and a pivotal and displaceable inner bed frame. The pivotal and displaceable inner bed frame carries raisable and lowerable back and/or leg parts and enables the back and/or leg parts of the bed to be inclined in relation to the fixed outer bed frame. In this respect, it is usual to provide a guide rail in the outer bed frame and wheels on link arms connected to the inner bed frame are adapted to roll in the guide rails to effect movement of the inner bed frame in relation to the outer bed frame. It is often so that the wheels begin to squeak or rattle after the bed has been used for some time, either due to dirt in the grooves in the guide bar or due to poor wheel bearings. Deficient or mediocre wheel bearings also make it difficult for the wheels to roll in the grooves of respective guide rails, therewith making movement of the wheels and orientation of the movable inner bed frame difficult.

Accordingly, an object of the present invention is to provide a novel bed frame arrangement which is not encumbered with the aforesaid drawbacks and which provides long-term, prob-

30

lem-free movement of the inner bed frame when desiring to orient the frame in relation to the fixed outer bed frame.

5 The object of the invention is achieved with the aid of the inventive arrangement, in which the inner bed frame is displaceably mounted in the outer bed frame through the medium of elongate slide blocks on which a surface layer or coating of low-friction material is disposed on at least one side of said frame.

10

According to a preferred embodiment, the slide blocks are made of a composite material on which a slide layer of polytetrafluoroethylene, Teflon<sup>®</sup>, in the form of a slide plate let into respective slide blocks.

15

The invention will now be described in more detail with reference to a non-limiting embodiment illustrated in the accompanying drawings, wherein **Fig. 1** illustrates a bed frame arrangement schematically from beneath; **Fig. 2** illustrates schematically a slide block for use in the inventive bed frame arrangement; **Fig. 3** is a side view illustrating a particular embodiment of a slide block; **Fig. 4** is a cross-sectional view of the slide block taken on the line A-A in Fig.3; and **Fig. 5** is a longitudinal sectioned view of the slide block taken on the line B-B in Fig. 3.

25

As mentioned, Fig. 1 is an underside plan view of an inventive bed frame arrangement, which includes a fixed, outer frame 1 and a movable inner frame 2. Attached in the inner/movable bed frame 2 is a first mechanism 3 which includes a number of links, pivots and pivot shafts connected to fasteners 4 for a divided bed bottom (not shown) and for inclining a head-and-back part on the bed bottom. This first mecha-

30

nism 3 is connected by means of a link 5 to the fixed outer frame 1 in a manner such that the head and back parts will be respectively raised and lowered in response to commensurate displacement of the inner/movable frame 2 in relation to the  
5 fixed outer frame 1, so that the distance of said head and back parts from the adjacent short end of the fixed outer frame 1 will always remain generally constant.

The first mechanism 3 may be typically equipped with electric  
10 setting motors for bringing the head and back parts to a desired inclined position. An arm in the link 5 is fixedly connected to a transverse pivotal shaft 6 whose ends are mounted in the movable inner frame 2. The transverse pivotal shaft 6 is also connected to pivot arms that are, in turn,  
15 connected to the attachments 4 for the head and back part of the divided bed bottom and also for connection to a drive motor (when included) for adjustment of the orientation of the head and back parts, by rotation of the shaft 6.

20 Also attached in the movable inner frame 2 is a second mechanism 7 which includes a number of links, pivots and pivot shafts that are connected to the attachment 8 for the divided bed bottom (not shown) and for inclining the leg and foot part of the bed bottom. The arrangement will also conveniently include a drive motor for bringing the leg and foot  
25 parts to a desired position, i.e. either a horizontal position or a position inclined upwards towards the foot end.

Mounted on the outer surface of each long side of the movable inner frame 2 are generally U-shaped guide rails 9 where the  
30 open end of the U-form faces towards the opposite inner surface of the long side of the fixed outer frame 1. Mounted on the inner surface of the long side of the fixed outer frame are slide blocks 10, the free longitudinally extending sur-

faces of which are surrounded generally by the U-shaped guide rails on the movable inner frame 2. Two such U-shaped guide rails 9 will preferably be disposed on each side of the movable inner frame 2 in mutually spaced relationship. Consequently, two slide blocks 10 will then be disposed on each side of the fixed outer frame 1 at corresponding distances apart. The U-shaped guide rails will conveniently be made of stainless steel against which the guide blocks 10 can slide readily.

10

Naturally, the arrangement of the slide blocks 10 and the U-shaped guide rails 9 may be the reverse of that described above, i.e. with the slide blocks 10 mounted on the movable inner frame 2 and the guide rails 9 mounted on the fixed outer frame 1.

15

No link is provided on the leg part and the foot part for displacing the movable inner frame 2, since raising/inclining said part requires no adjustment of the position of the movable inner frame 2 in relation to the fixed outer frame 1.

20

The guide blocks 10, of which one is shown in Fig. 2, are generally in the form of elongate, rectangular bodies that have slightly bevelled longitudinal edges 11. The bodies 10 include transversally through-penetrating holes 12 that enable screw fasteners to be fastened in the inner side of the long side of the fixed outer frame 1 and therewith screw said blocks 10 firmly to said fixed outer frame 1. The blocks 10 are suitably made of a composite material, for instance from a polyamide that includes an admixture of 30% fibreglass. With the intention of reducing the friction of the blocks against the inner surfaces of the U-shaped guide rails 9, there is conveniently applied a slide layer of polytetra-

25  
30

fluoroethylene, Teflon<sup>®</sup>, particularly a Teflon<sup>®</sup> composite, e.g. SKF POLYTETRAFLUOROETHYLENE having a friction coefficient of 0.03-0.08. The polytetrafluoroethylene slide layer suitably has the form of a slide plate 13 let into the slide  
5 block in the manner evident from Figs. 3-5. Particles of polytetrafluoroethylene may also be integrated in the composite material.

Because the slide blocks 10 have an outer shape that fits  
10 exactly in the U-shaped guide rails 9, the blocks are able to slide in said rails without risk of binding or jamming. In order to further reduce the risk of the blocks 10 jamming or wedging in the rails 9, respective blocks are provided with holes that accommodate coil springs 14 which press inserts 15  
15 coated with polytetrafluoroethylene against the two inner surfaces of the U-shaped guide rails 9 other than the inner surface against which the slide plate 13 is situated.

The aforesaid preferred slide block material means that the  
20 risk of binding is minimal and that the conditions for problem-free functioning of the slide blocks is far better than in the case of wheels or rollers that move in grooves, as in the case of hitherto known arrangements.

25 The aforementioned divided bed bottom may be of any type whatsoever of the various types that are commercially available at present. However, an interior sprung mattress is preferred.

## CLAIMS

1. A bed frame arrangement which includes a fixed outer frame (1) and a movable inner frame (2), **characterised** in that the movable inner frame is displaceably mounted in the outer fixed frame (1) through the medium of elongate slide blocks (10) on which a surface layer of low-friction material has been applied on at least one side of said blocks.
2. An arrangement according to Claim 1, **characterised** in that the inner bed frame (2) includes at least one part that can be adjusted to an inclined position.
3. An arrangement according to Claim 2, **characterised** in that the inner bed frame (2) includes a head and a back part that can be orientated as desired.
4. An arrangement according to Claim 3, **characterised** in that a pivot shaft (6), which is rotated by the inner movable bed frame (2) when changing the inclined position of the head and back part, is connected to a link (5) for automatic displacement of the inner movable bed frame (2) in relation to the fixed bed frame (1).
5. An arrangement according to any one of the preceding Claims, **characterised** in that the slide blocks (10) are made of a composite material.
6. An arrangement according to Claim 5, **characterised** in that the composite material has applied thereon a slide layer of polytetrafluoroethylene in the form of a slide plate (13) let into the slide block (10).

7. An arrangement according to any one of the preceding Claims, **characterised** in that the slide blocks (10) are mounted on either the outer fixed bed frame (1) or the movable inner bed frame (2) and are adapted to slide in U-shaped guide rails (9) provided on the other of said outer fixed frame (1) or the movable inner frame (2).

8. An arrangement according to Claim 7, **characterised** in that the U-shaped guide rails (9) closely surround the slide blocks.

9. An arrangement according to Claim 8, **characterised** in that the slide blocks (10) include pressure springs (14) that carry support inserts (15) which are coated with polytetrafluoroethylene, said springs functioning to press the inserts (15) against at least one inner surface of the U-shaped guide rail (9) embracing said slide block (10).

10. An arrangement according to any one of Claims 7-9, **characterised** in that the U-shaped guide rails (9) are made of stainless steel.



1 / 2

Fig. 1

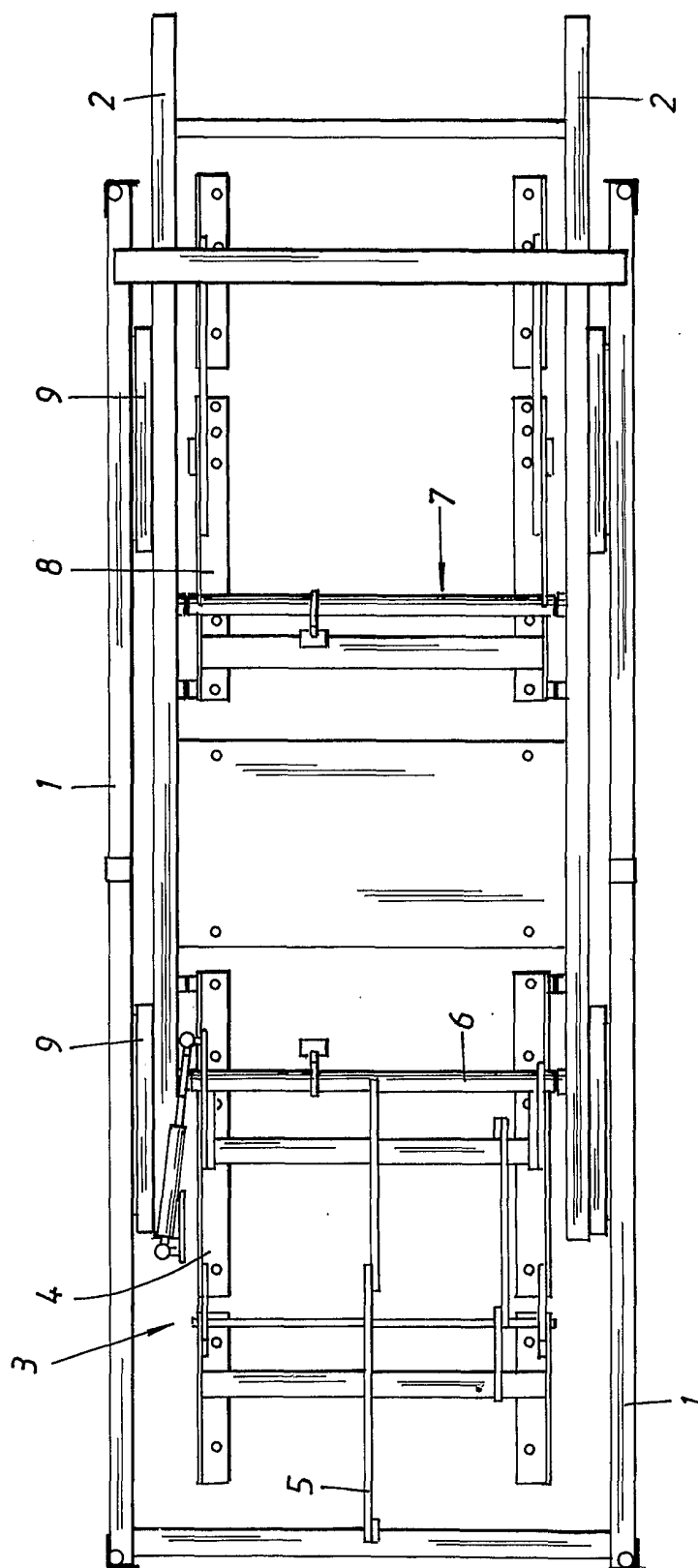

2 / 2

Fig. 1

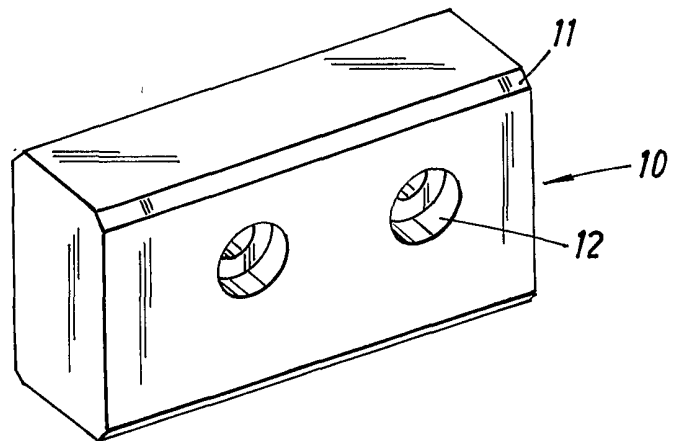

Fig. 3

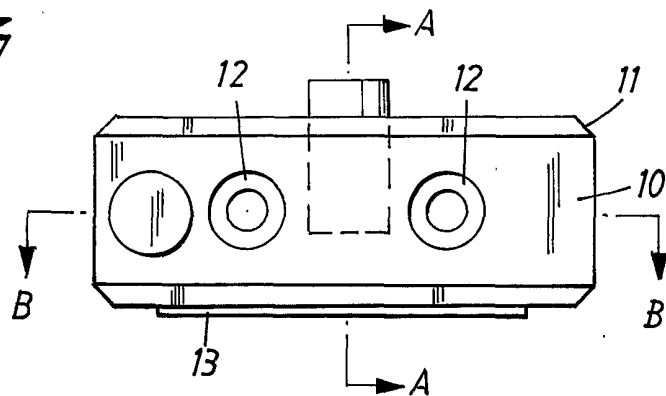

Fig. 4

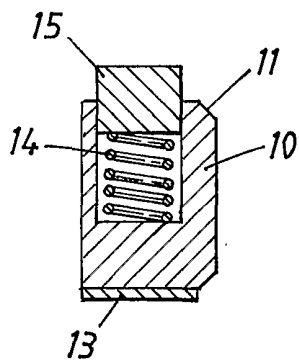
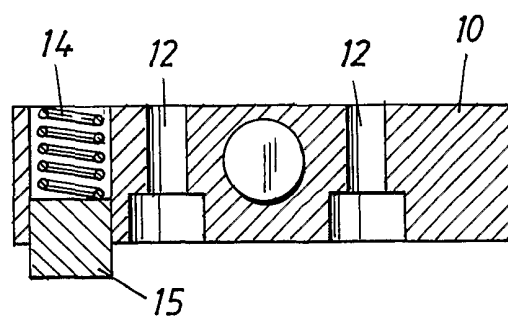

Fig. 5



## INTERNATIONAL SEARCH REPORT

International application No.

PCT/SE 01/01260

## A. CLASSIFICATION OF SUBJECT MATTER

IPC7: A47C 20/04

According to International Patent Classification (IPC) or to both national classification and IPC

## B. FIELDS SEARCHED

Minimum documentation searched (classification system followed by classification symbols)

IPC7: A47C

Documentation searched other than minimum documentation to the extent that such documents are included in the fields searched

SE,DK,FI,NO classes as above

Electronic data base consulted during the international search (name of data base and, where practicable, search terms used)

EPO-INTERNAL

## C. DOCUMENTS CONSIDERED TO BE RELEVANT

Category*	Citation of document, with indication, where appropriate, of the relevant passages	Relevant to claim No.
A	US 5774914 A (JOHNSON ET AL), 7 July 1998 (07.07.98), column 7, line 42 - column 8, line 16, figures 3,8, abstract --	
A	US 5862549 A (MORTON ET AL), 26 January 1999 (26.01.99), column 7, line 58 - column 8, line 18, figures 3,8,9, abstract --	
A	US 5926878 A (MORTON ET AL), 27 July 1999 (27.07.99), column 8, line 7 - line 34, figures 3, 8,9, abstract -- -----	

☐ Further documents are listed in the continuation of Box C.☒ See patent family annex.

\* Special categories of cited documents:

"A" document defining the general state of the art which is not considered to be of particular relevance

"E" earlier application or patent but published on or after the international filing date

"L" document which may throw doubts on priority claim(s) or which is cited to establish the publication date of another citation or other special reason (as specified)

"O" document referring to an oral disclosure, use, exhibition or other means

"P" document published prior to the international filing date but later than the priority date claimed

"T" later document published after the international filing date or priority date and not in conflict with the application but cited to understand the principle or theory underlying the invention

"X" document of particular relevance; the claimed invention cannot be considered novel or cannot be considered to involve an inventive step when the document is taken alone

"Y" document of particular relevance; the claimed invention cannot be considered to involve an inventive step when the document is combined with one or more other such documents, such combination being obvious to a person skilled in the art

"&amp;" document member of the same patent family

Date of the actual completion of the international search

14 Sept 2001

Date of mailing of the international search report

26-09-2001

Name and mailing address of the ISA/  
Swedish Patent Office  
Box 5055, S-102 42 STOCKHOLM  
Facsimile No. +46 8 666 02 86

Authorized officer

Dan Ionesco / JA A  
Telephone No. +46 8 782 25 00

**INTERNATIONAL SEARCH REPORT**

Information on patent family members

02/08/01

International application No.

PCT/SE 01/01260

Patent document cited in search report			Publication date	Patent family member(s)			Publication date
US	5774914	A	07/07/98	US	5862549	A	26/01/99
				US	5926878	A	27/07/99
-----							
US	5862549	A	26/01/99	US	5774914	A	07/07/98
				US	5926878	A	27/07/99
-----							
US	5926878	A	27/07/99	US	5774914	A	07/07/98
				US	5862549	A	26/01/99
-----							