

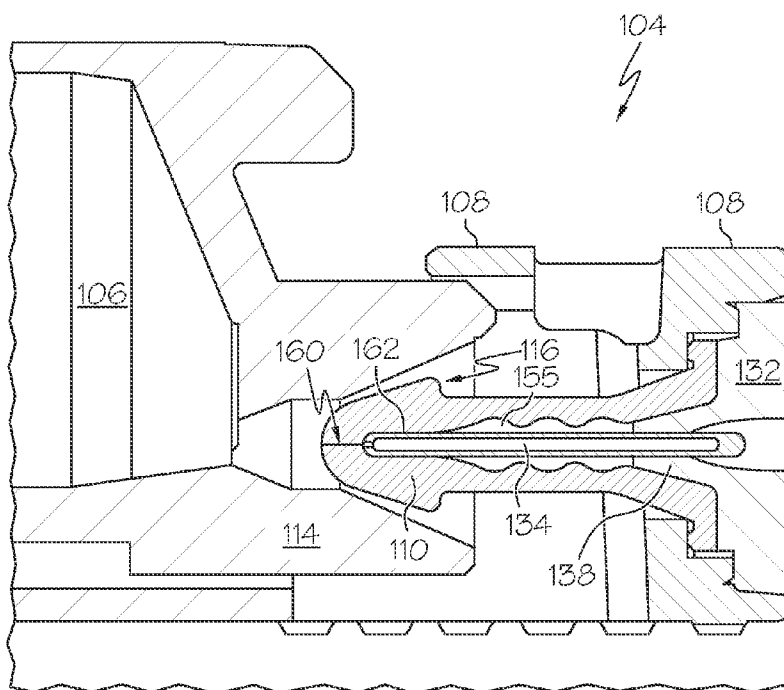

US 20130116632A1

(19) **United States**(12) **Patent Application Publication**
Yavorsky et al.(10) **Pub. No.: US 2013/0116632 A1**(43) **Pub. Date: May 9, 2013**(54) **FLANGED SEALING ELEMENT AND
NEEDLE GUIDE PIN ASSEMBLY FOR A
FLUID INFUSION DEVICE HAVING A
NEEDED FLUID RESERVOIR**(71) Applicant: **Medtronic Minimed, Inc.**, Northridge,
CA (US)(72) Inventors: **Matthew William Yavorsky**, Los
Angeles, CA (US); **Edgardo C. Halili**,
Santa Clarita, CA (US); **Eric M.
Lorenzen**, Altadena, CA (US)(73) Assignee: **MEDTRONIC MINIMED, INC.**,
Northridge, CA (US)(21) Appl. No.: **13/728,796**(22) Filed: **Dec. 27, 2012****Related U.S. Application Data**(63) Continuation-in-part of application No. 13/399,851,
filed on Feb. 17, 2012, Continuation-in-part of appli-
cation No. 13/399,857, filed on Feb. 17, 2012, Conti-
nuation-in-part of application No. 13/399,863, filed on
Feb. 17, 2012, Continuation-in-part of application No.
13/399,865, filed on Feb. 17, 2012, Continuation-in-
part of application No. 13/399,870, filed on Feb. 17,
2012, Continuation-in-part of application No. 13/399,
874, filed on Feb. 17, 2012, Continuation-in-part of
application No. 13/399,878, filed on Feb. 17, 2012.(60) Provisional application No. 61/445,393, filed on Feb.
22, 2011, provisional application No. 61/445,393,filed on Feb. 22, 2011, provisional application No.
61/445,393, filed on Feb. 22, 2011, provisional appli-
cation No. 61/445,393, filed on Feb. 22, 2011, provi-
sional application No. 61/445,393, filed on Feb. 22,
2011, provisional application No. 61/445,393, filed on
Feb. 22, 2011, provisional application No. 61/445,393,
filed on Feb. 22, 2011.**Publication Classification**(51) **Int. Cl.**
A61M 5/14 (2006.01)
(52) **U.S. Cl.**
CPC **A61M 5/1413** (2013.01)
USPC **604/257**(57) **ABSTRACT**

A sealing assembly for a fluid infusion device includes a base plate, a reservoir port receptacle, a flow base component, and a needle sealing element. The receptacle receives the reservoir port, and has proximal and distal ends, and a needle entry in the distal end to receive a hollow needle of a fluid reservoir. The flow base component has an inlet structure defining a fluid chamber, and a needle guide pin protruding therefrom. The end of the guide pin fits within the hollow needle. The needle sealing element has a proximal flange adjacent to the inlet structure, a distal flange opposite the proximal flange, a neck section between the flanges, and a needle opening extending through the neck section. The needle sealing element is positioned within the port receptacle such that the neck section surrounds the end section of the needle guide pin.



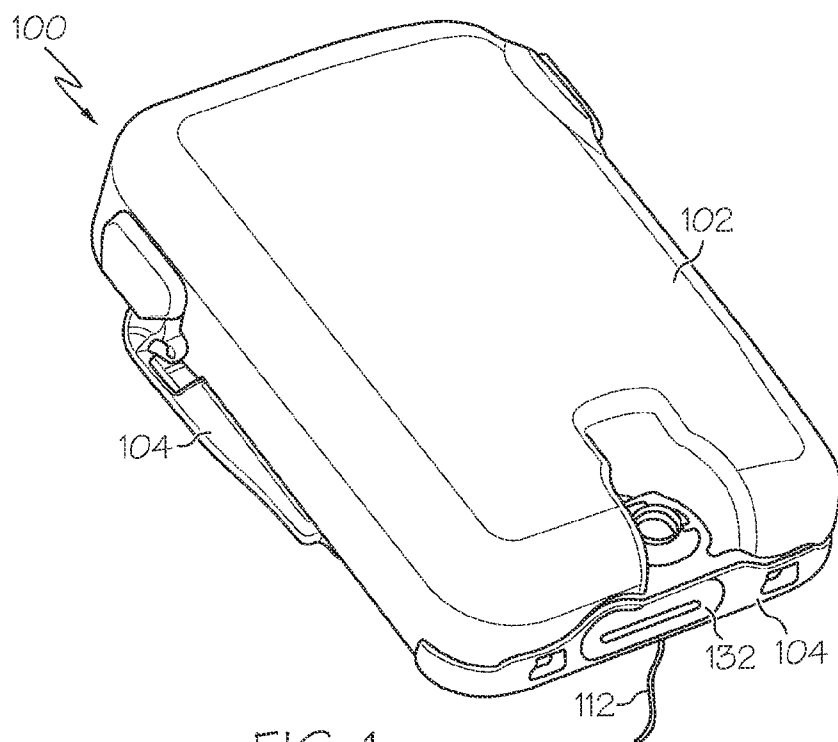

FIG. 1

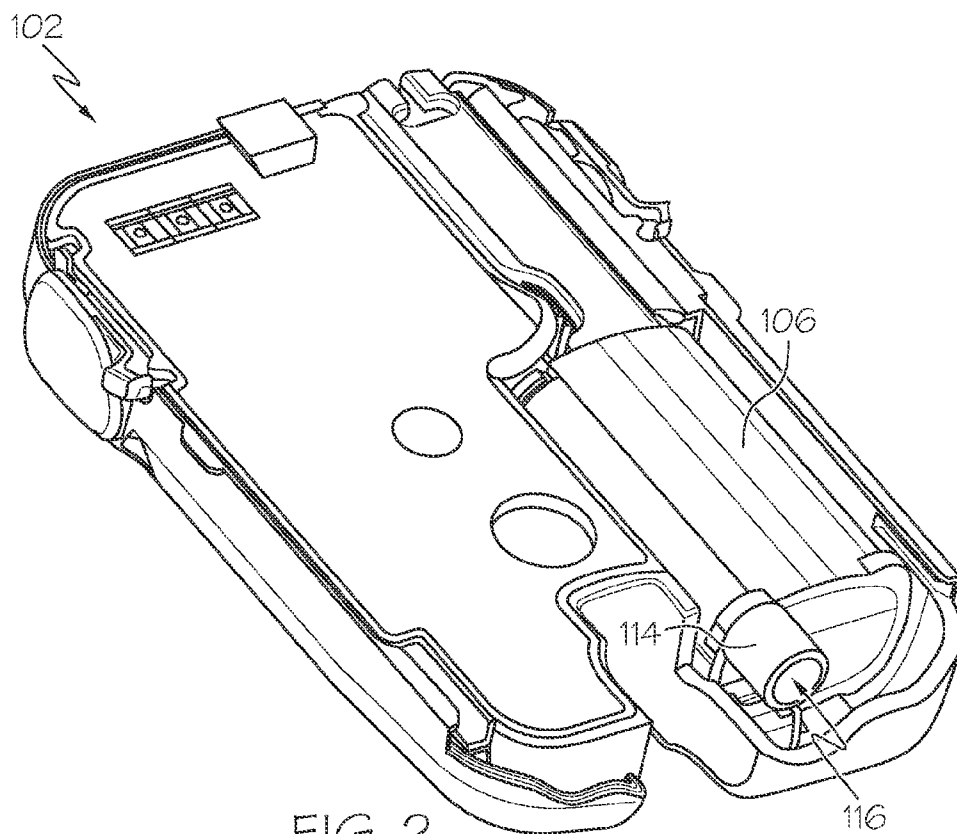

FIG. 2

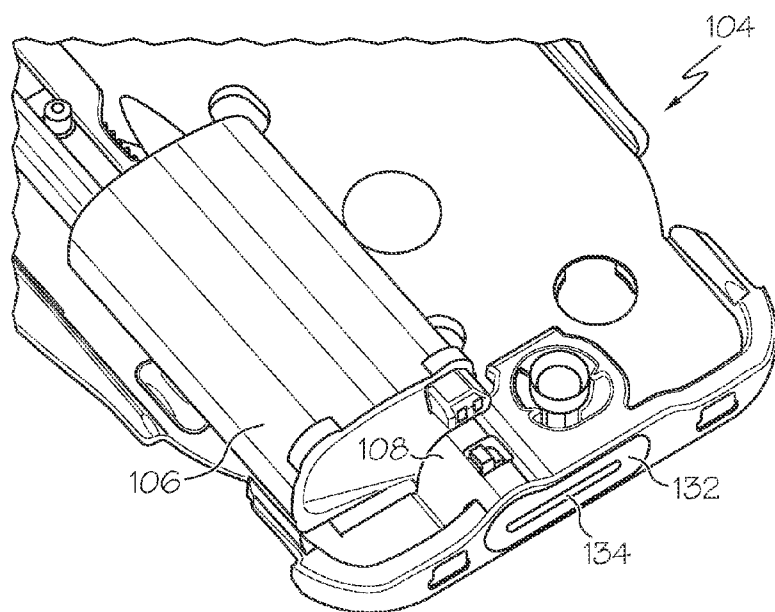

FIG. 3

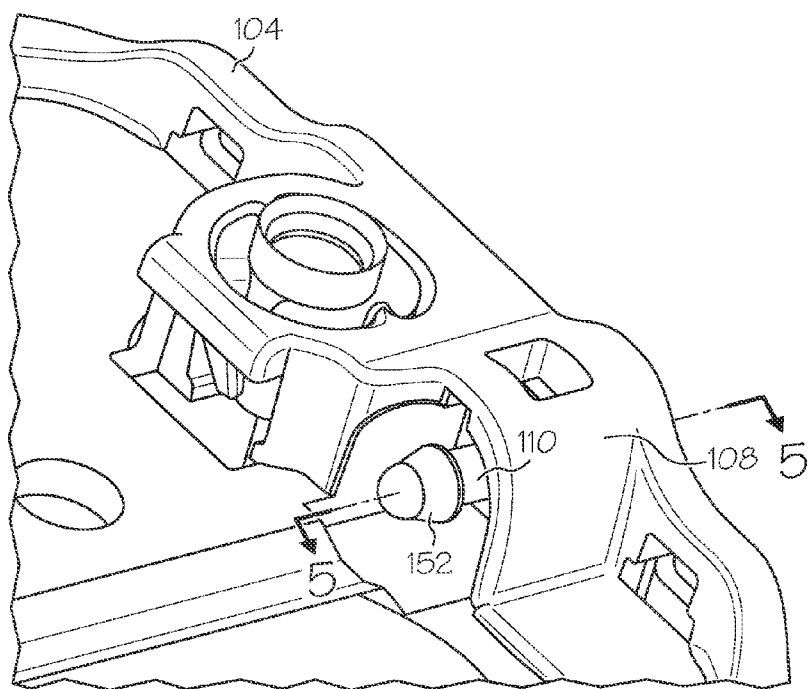

FIG. 4

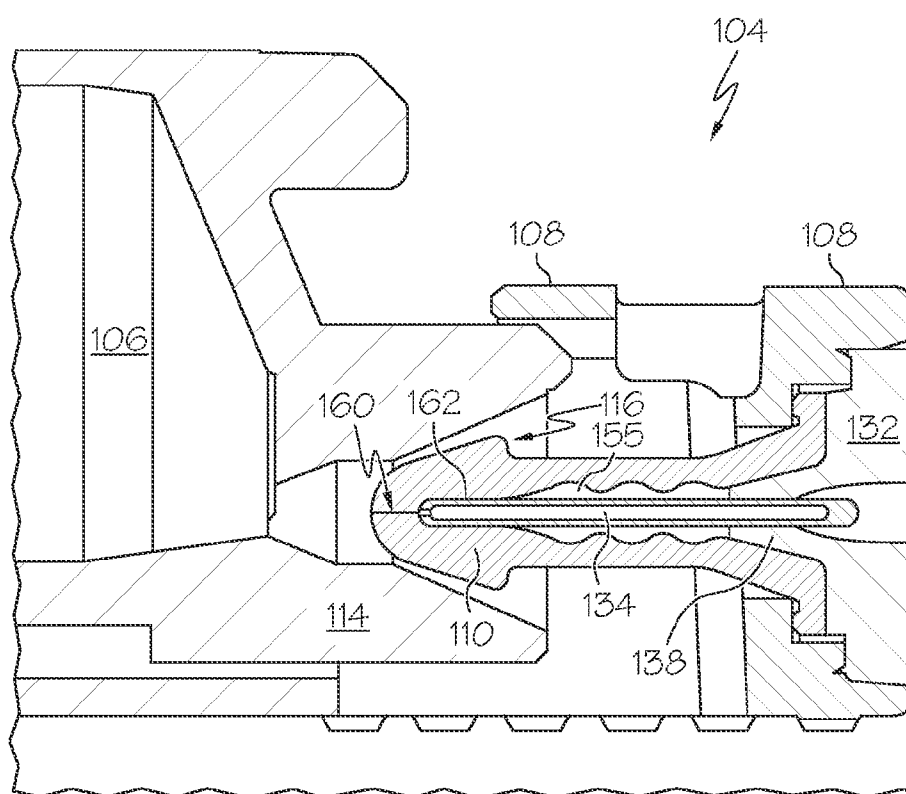

FIG. 5

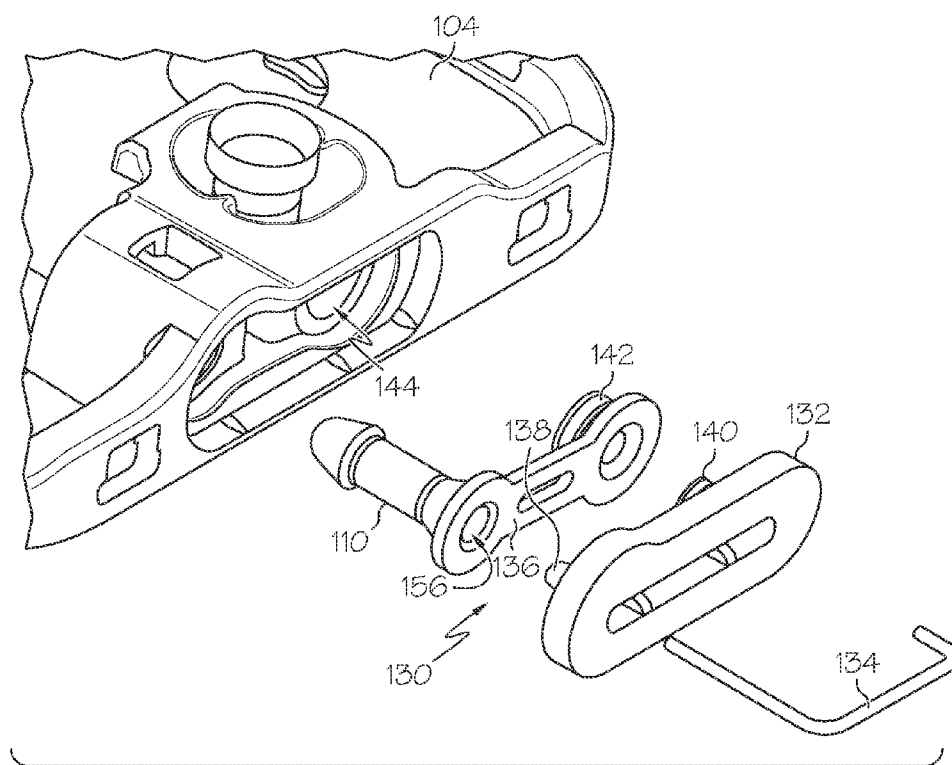

FIG. 6

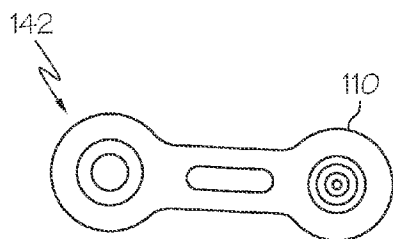

FIG. 7

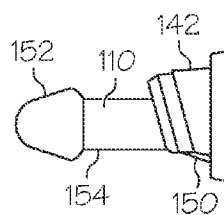

FIG. 8

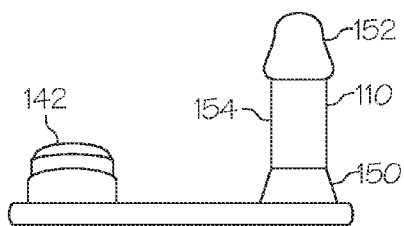

FIG. 9

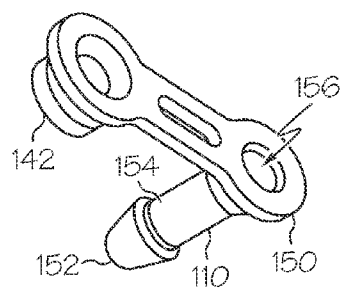

FIG. 10

FIG. 12

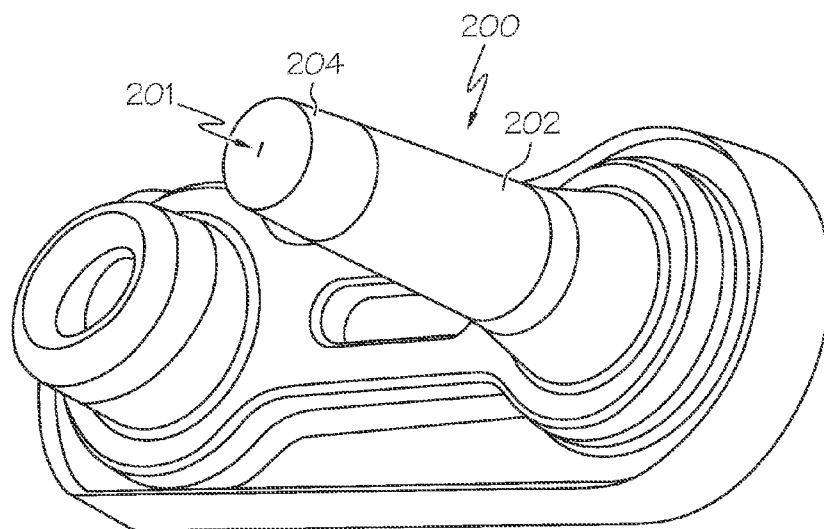

FIG. 13

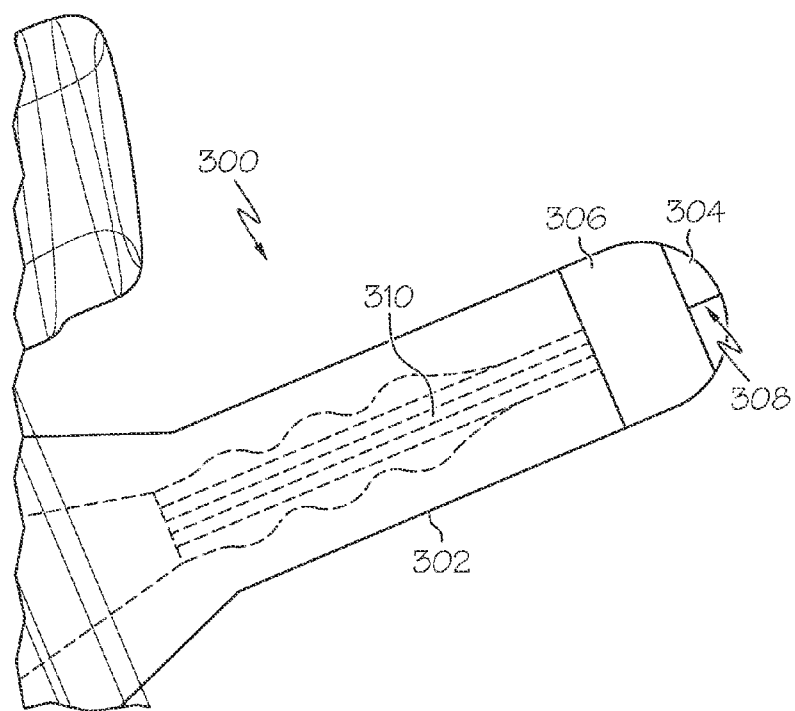

FIG. 14

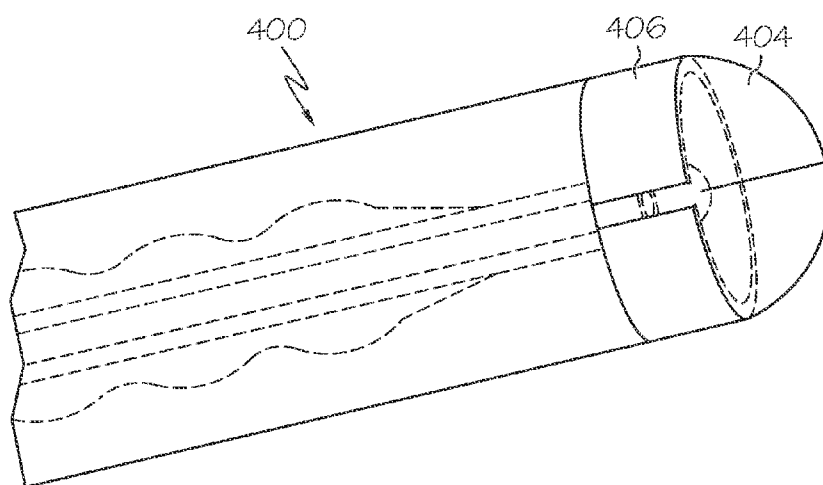

FIG. 15

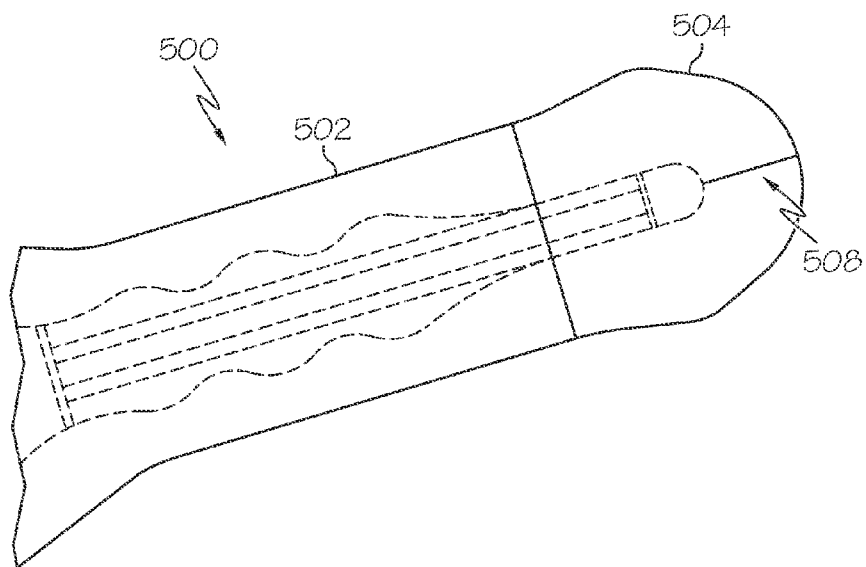

FIG. 16

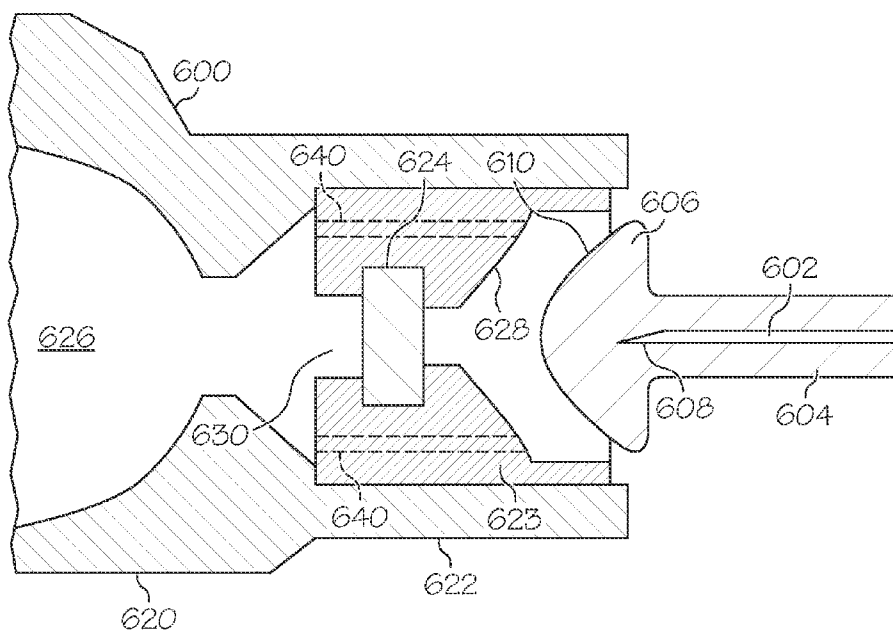

FIG. 17

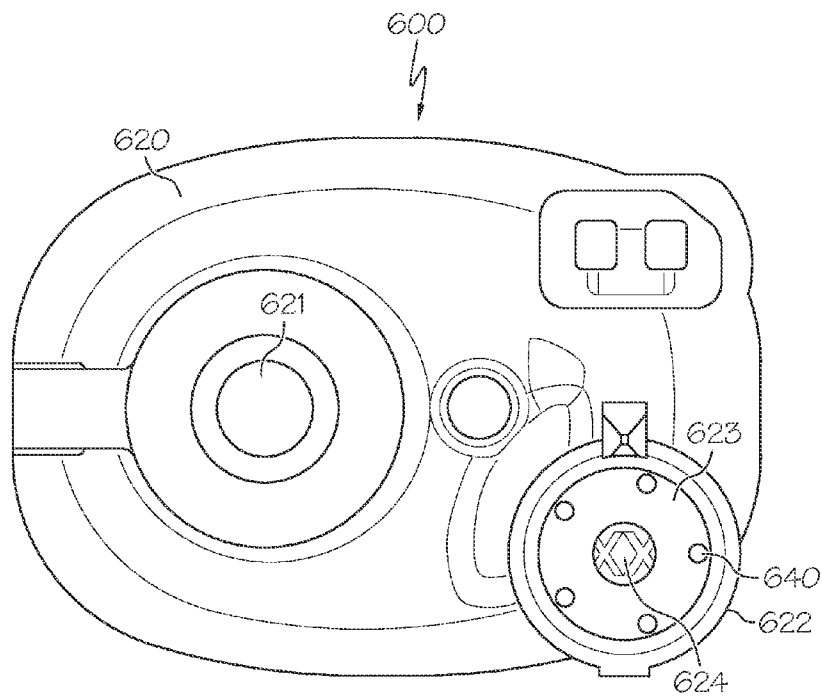

FIG. 18

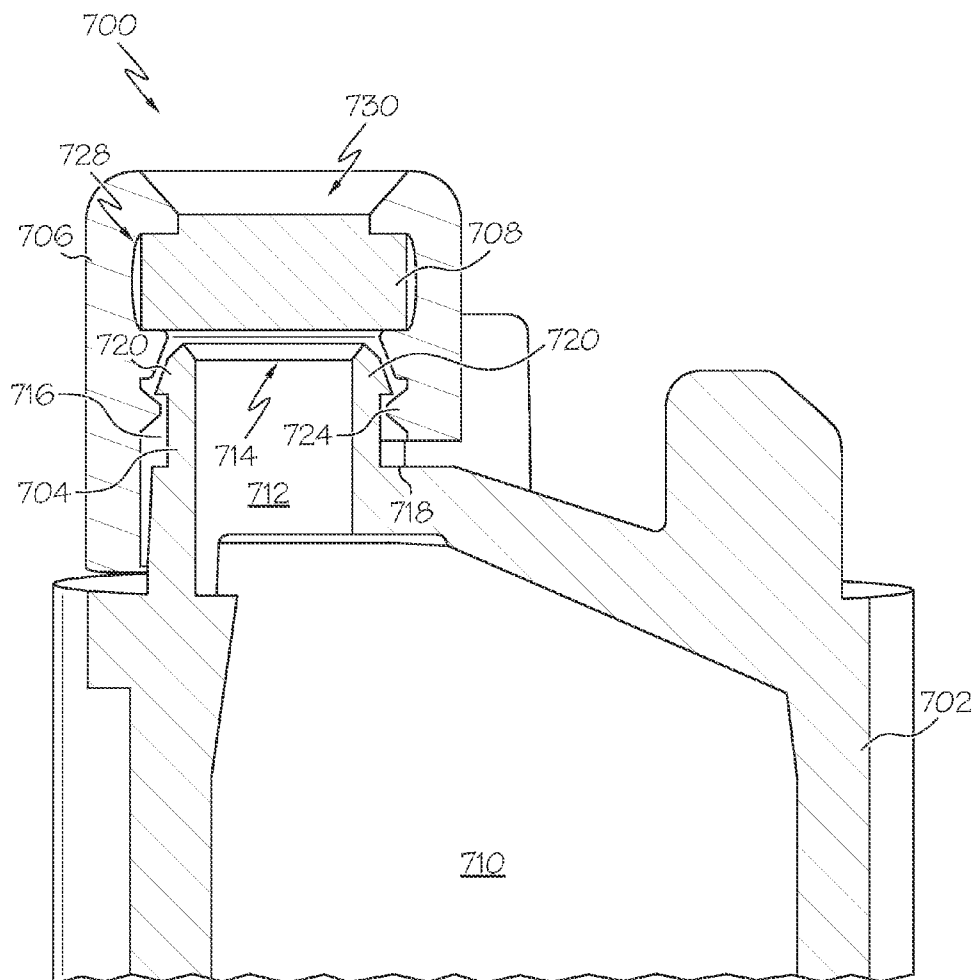

FIG. 19

FIG. 20

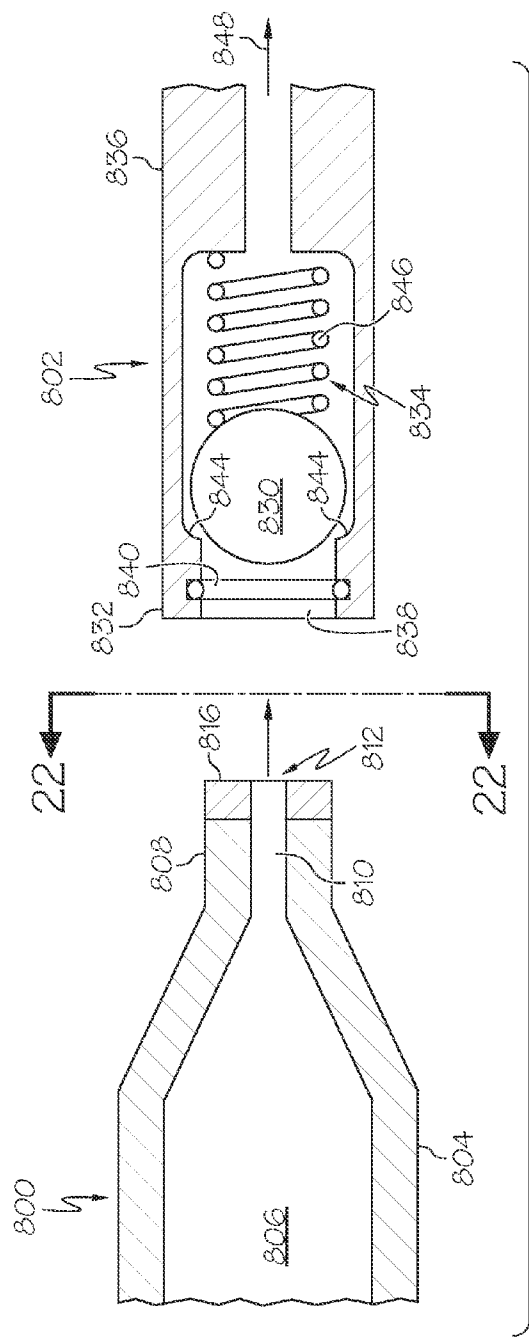

FIG. 21

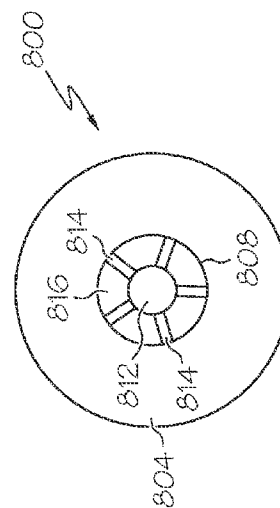

FIG. 22

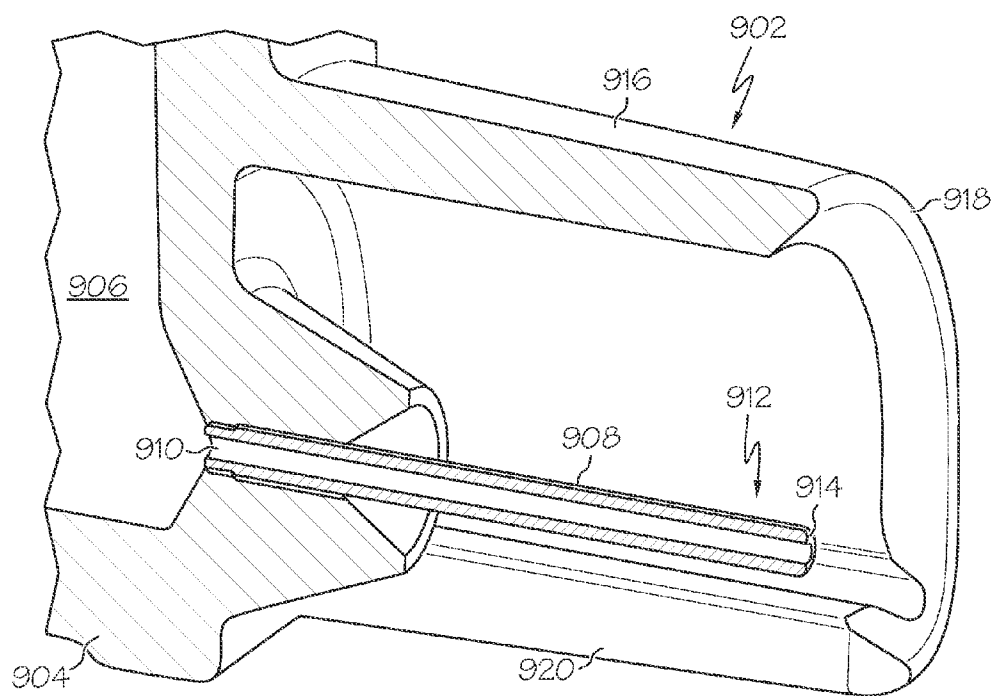
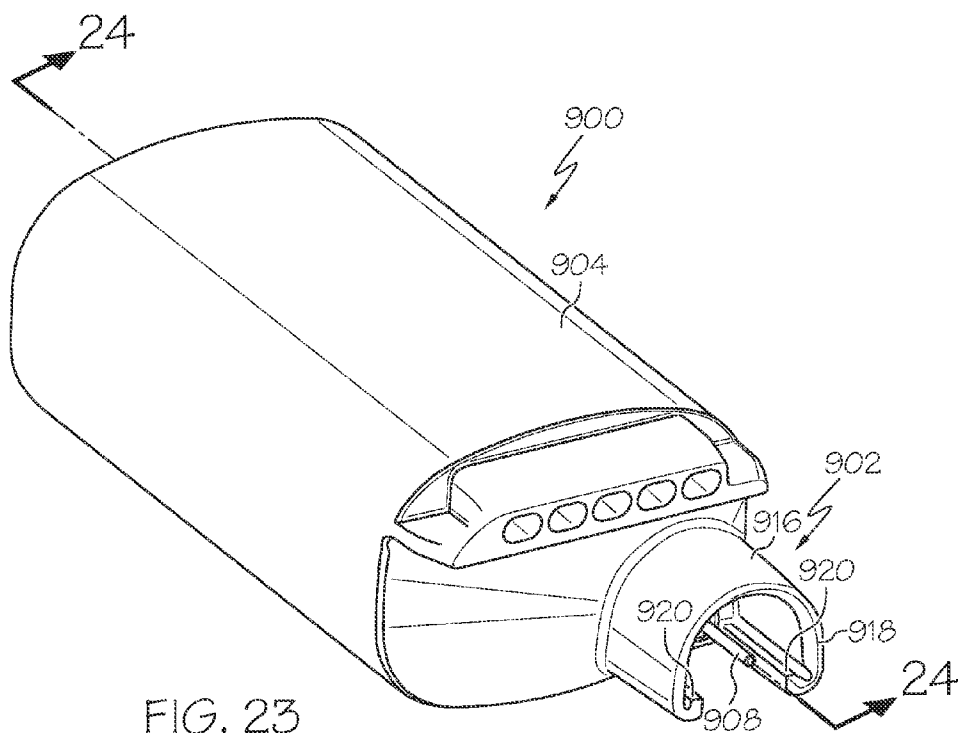

FIG. 24

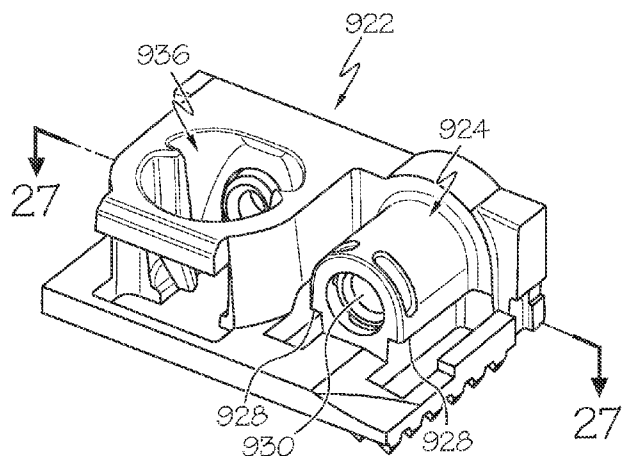

FIG. 25

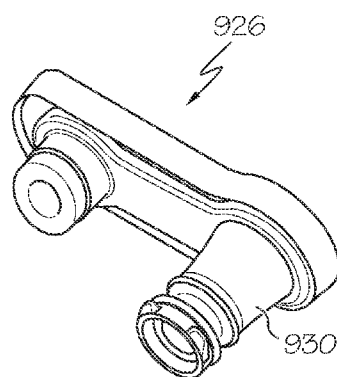

FIG. 26

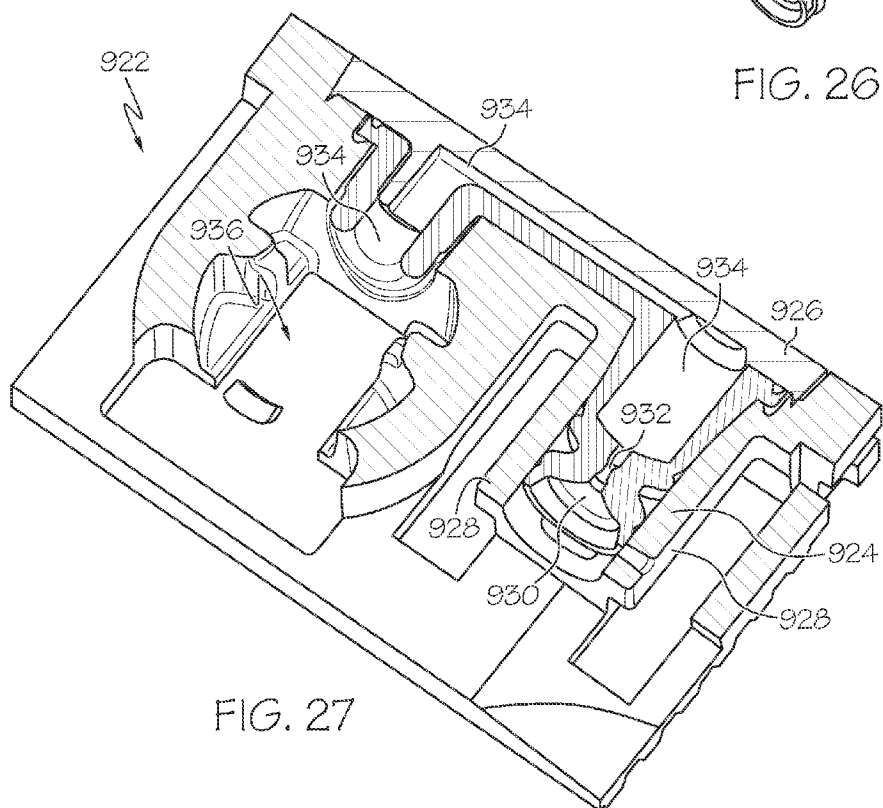

FIG. 27

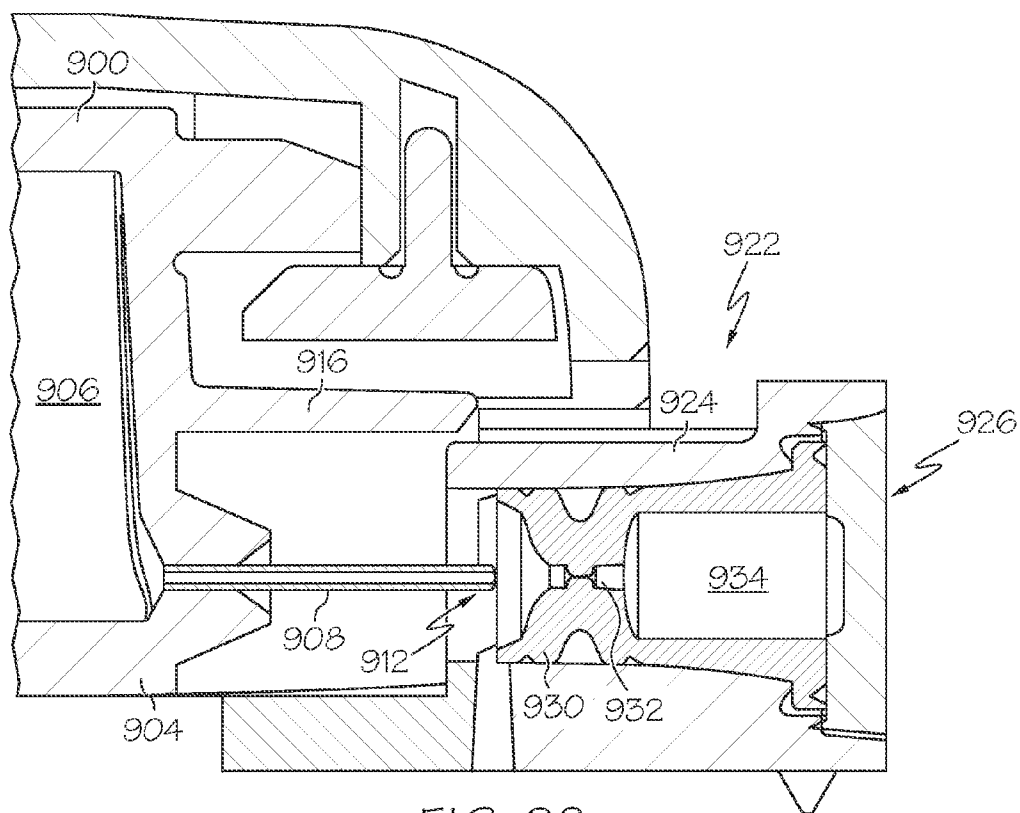

FIG. 28

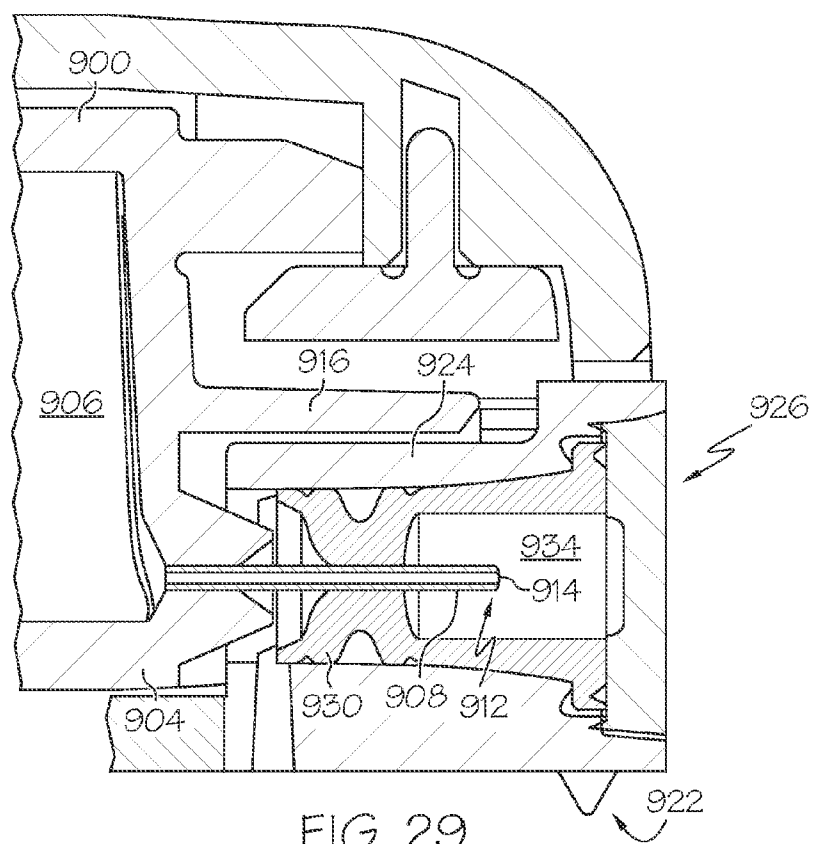

FIG. 29

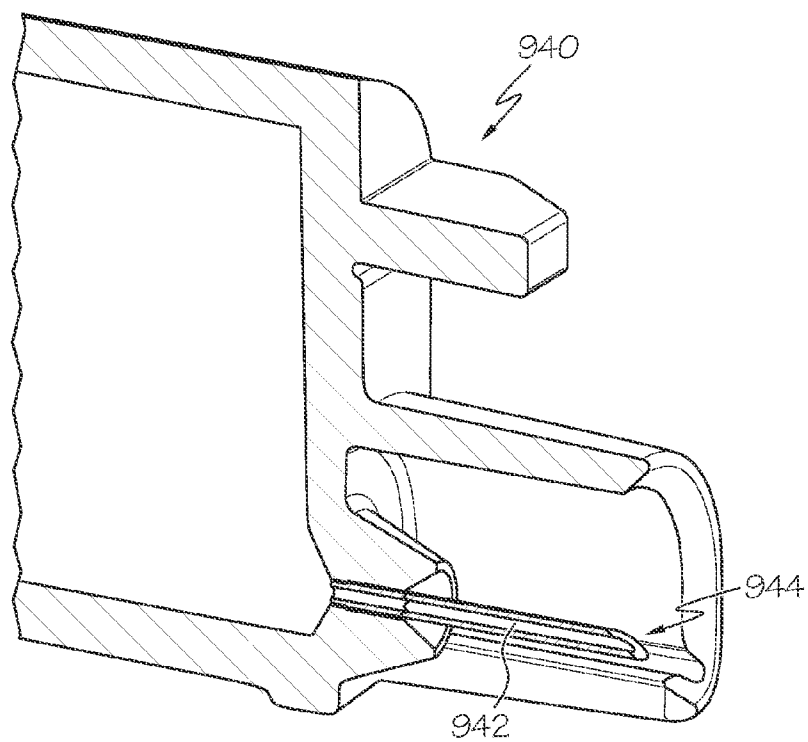

FIG. 30

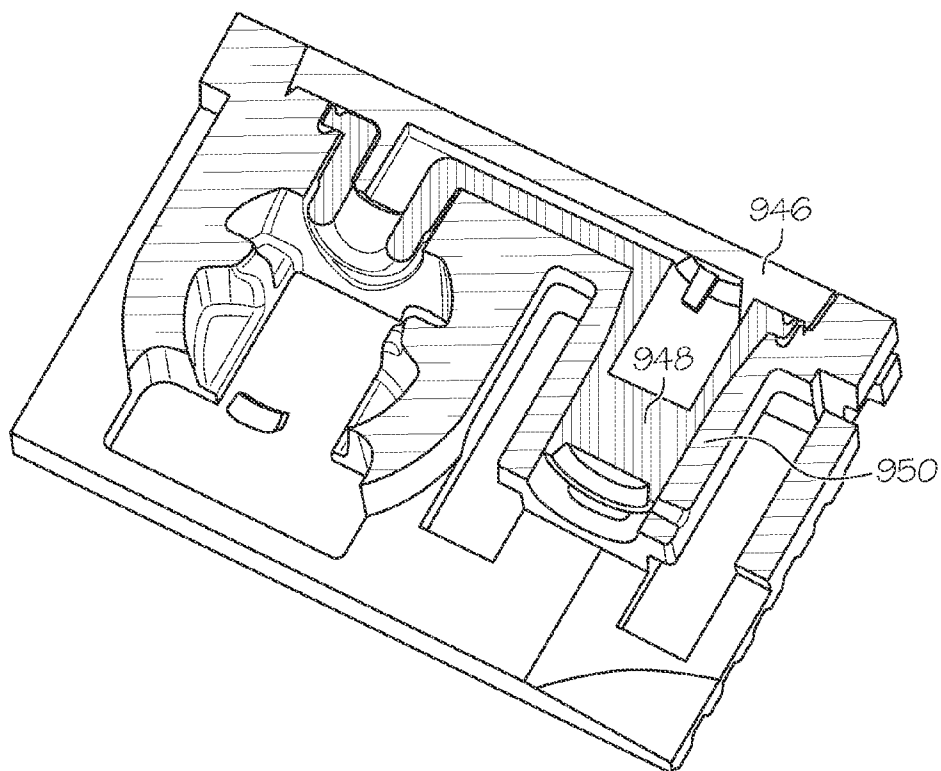

FIG. 31

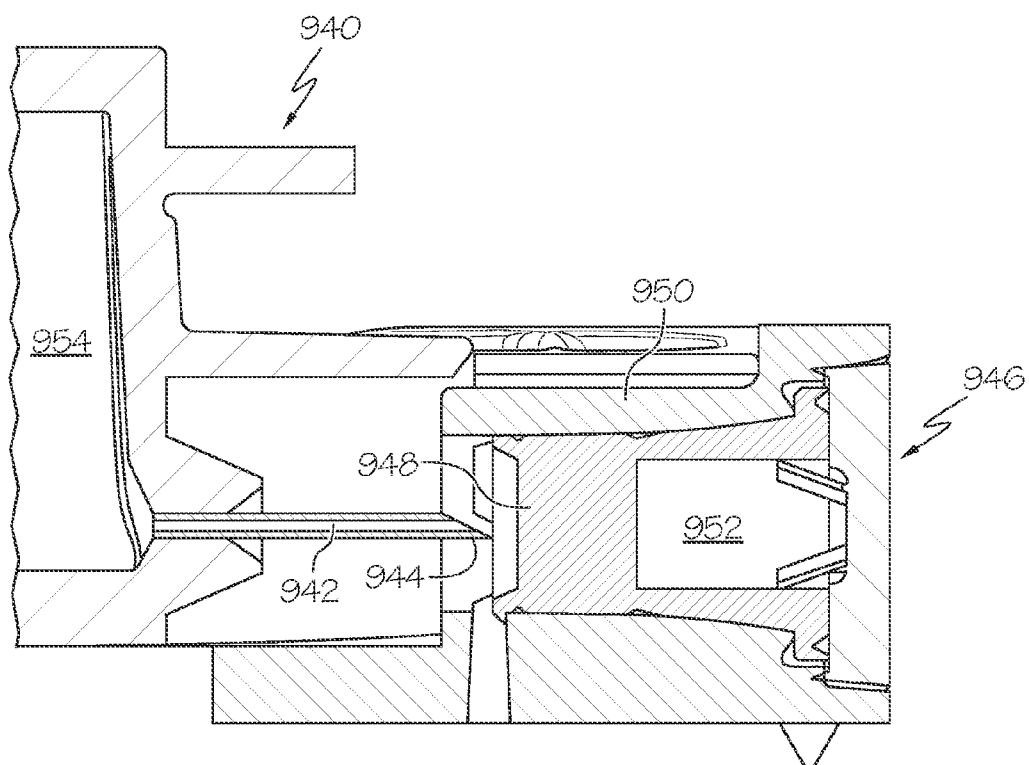

FIG. 32

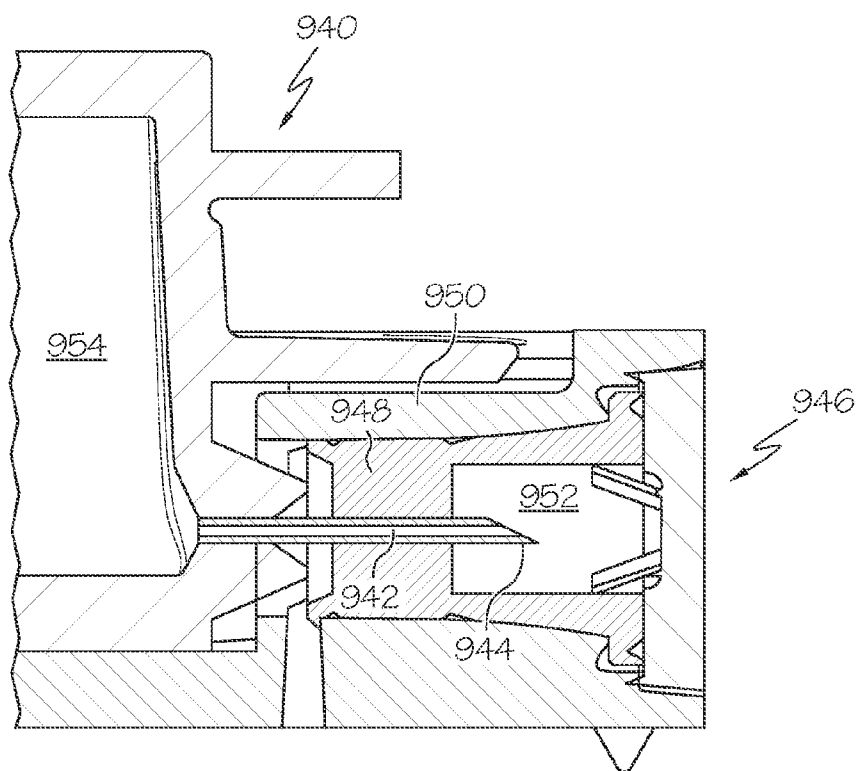

FIG. 33

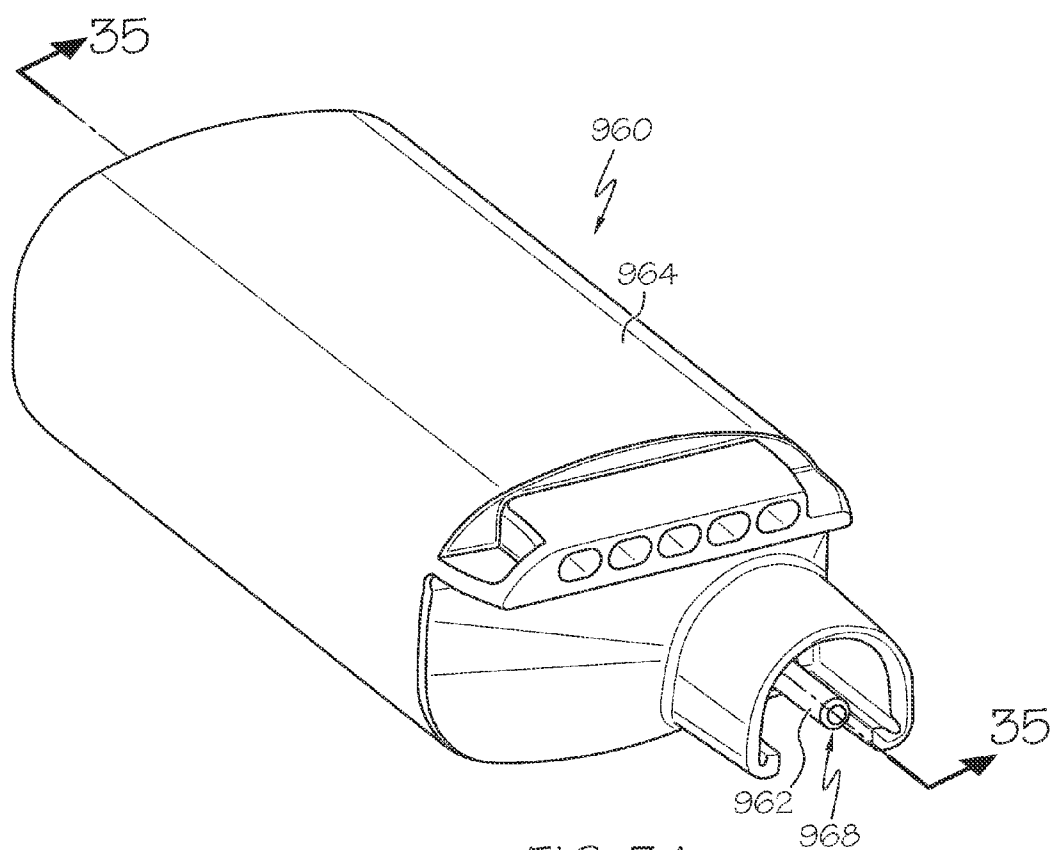

FIG. 34

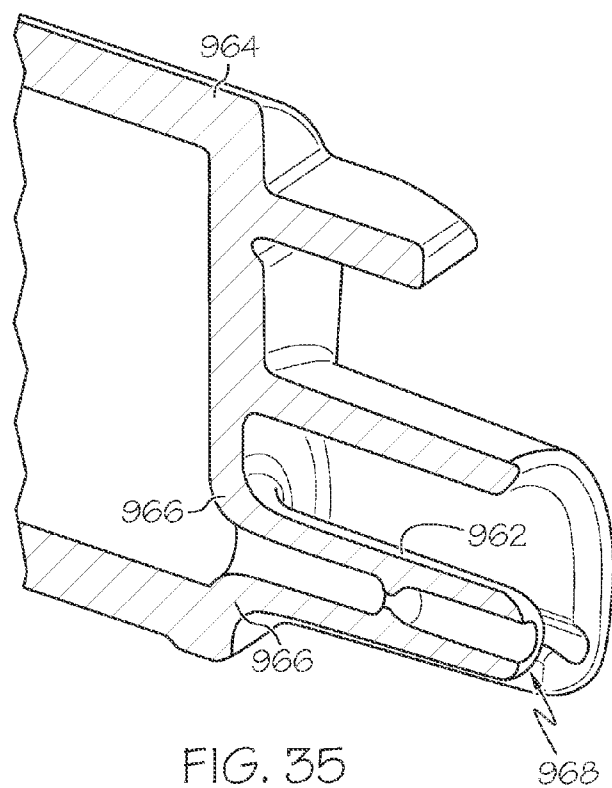

FIG. 35

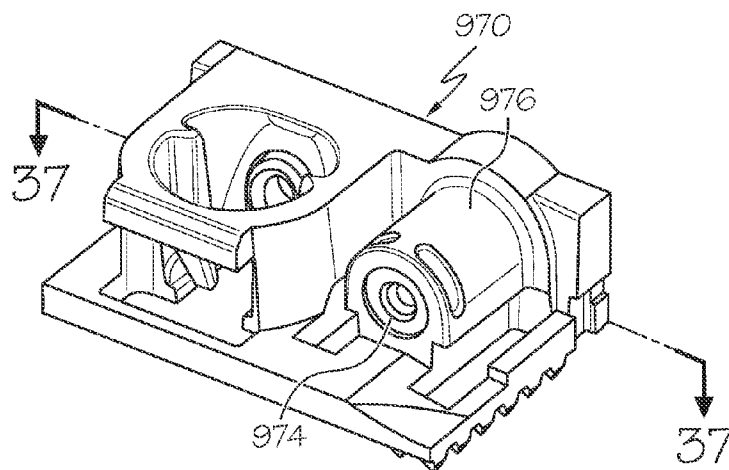

FIG. 36

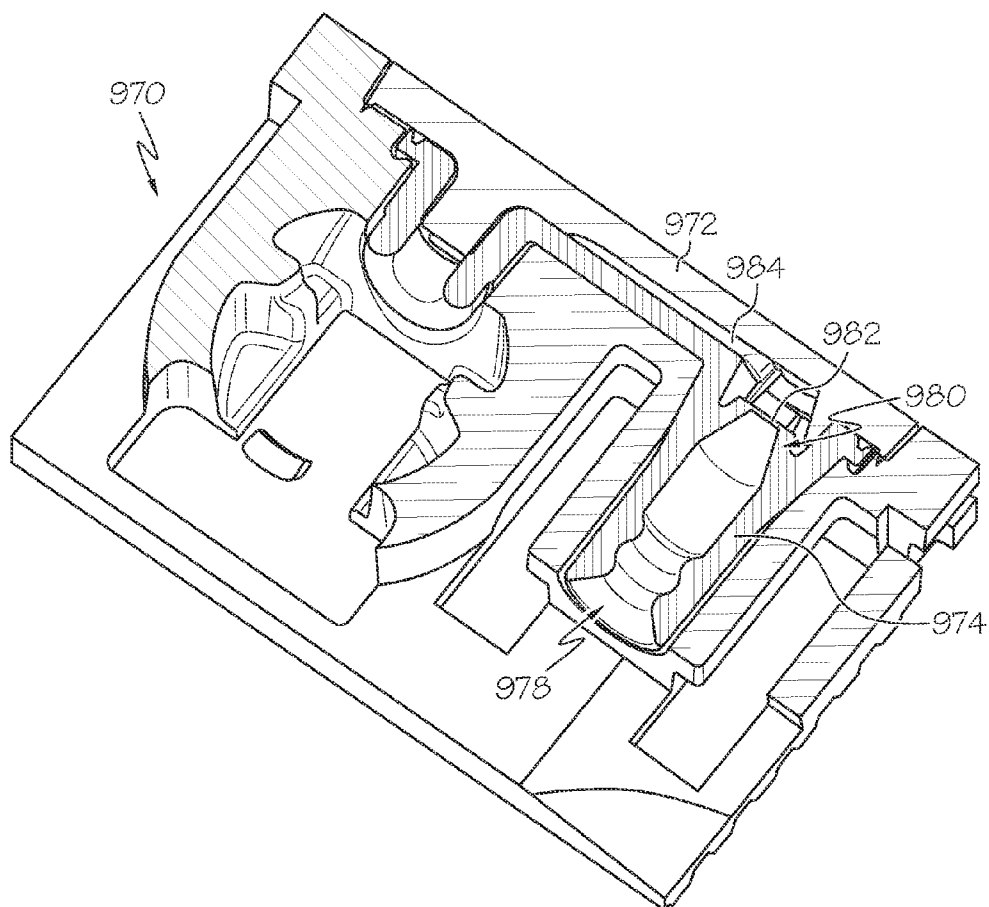
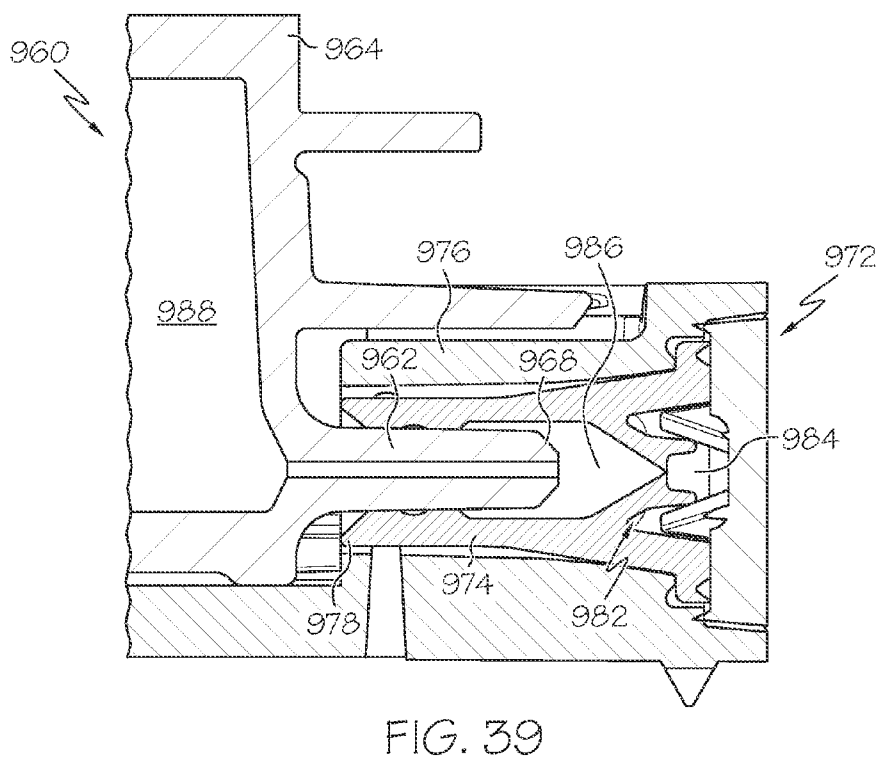
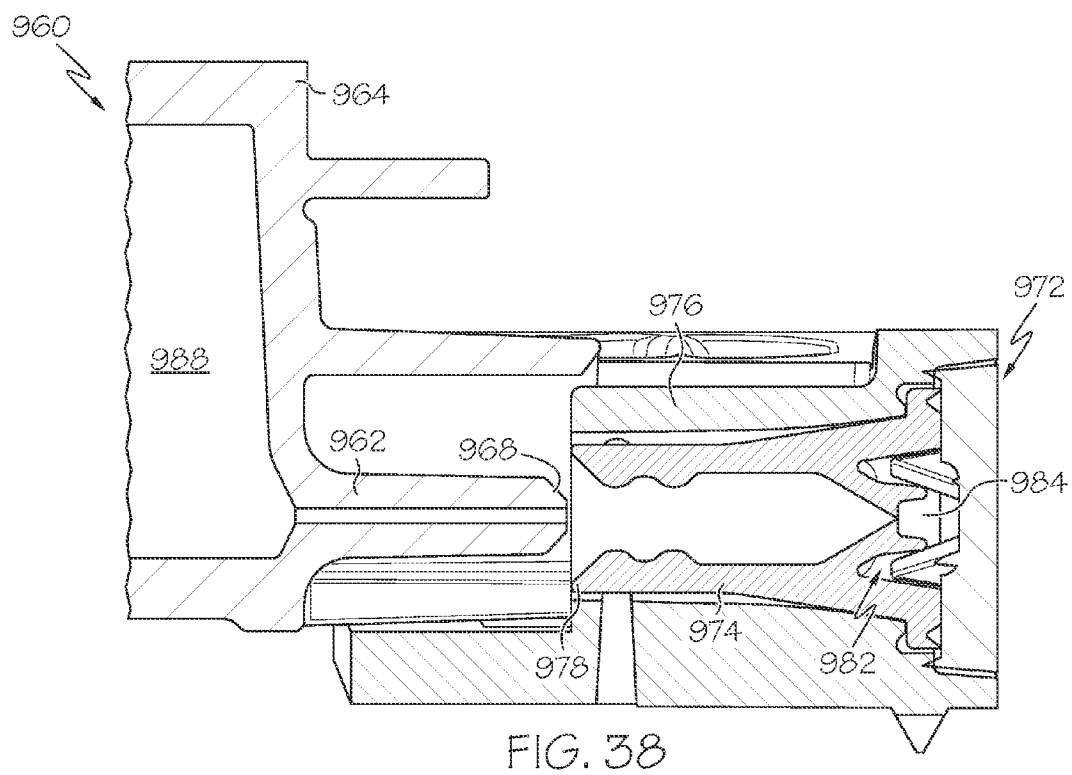

FIG. 37



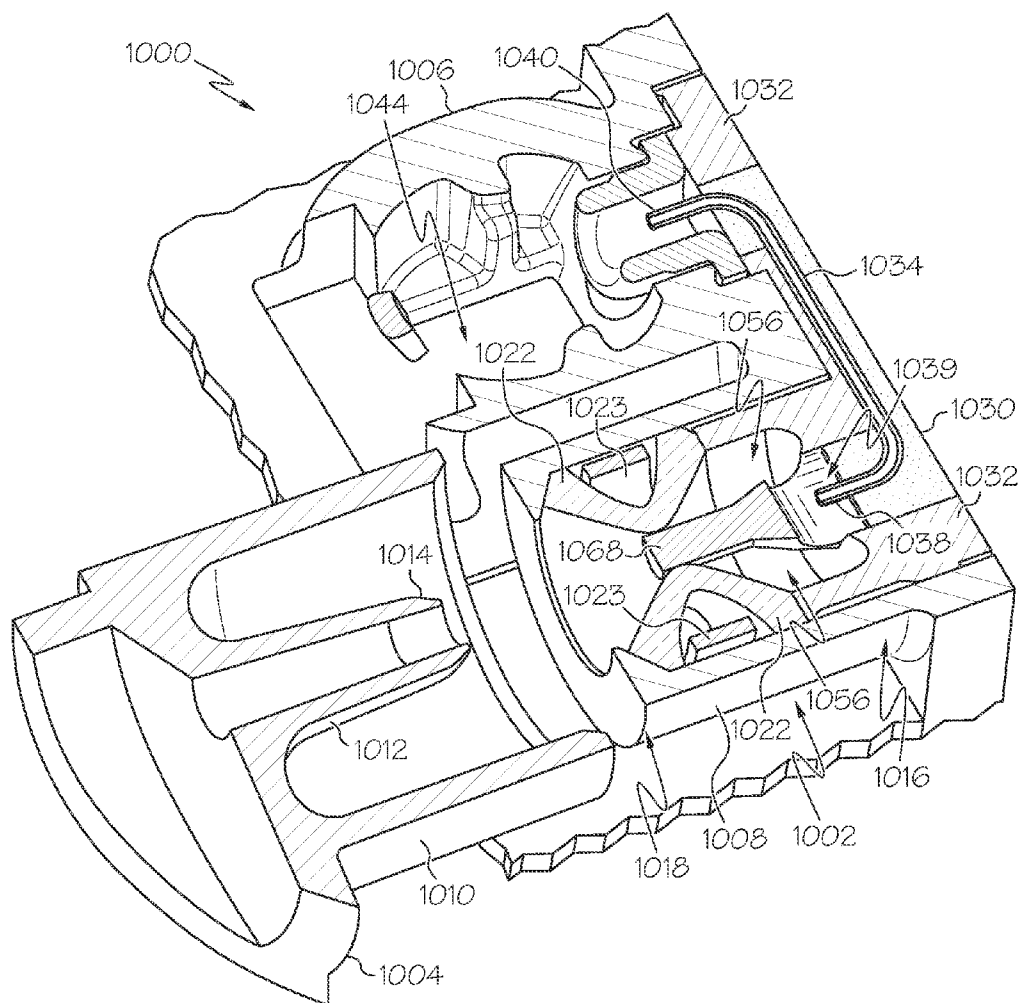

FIG. 40

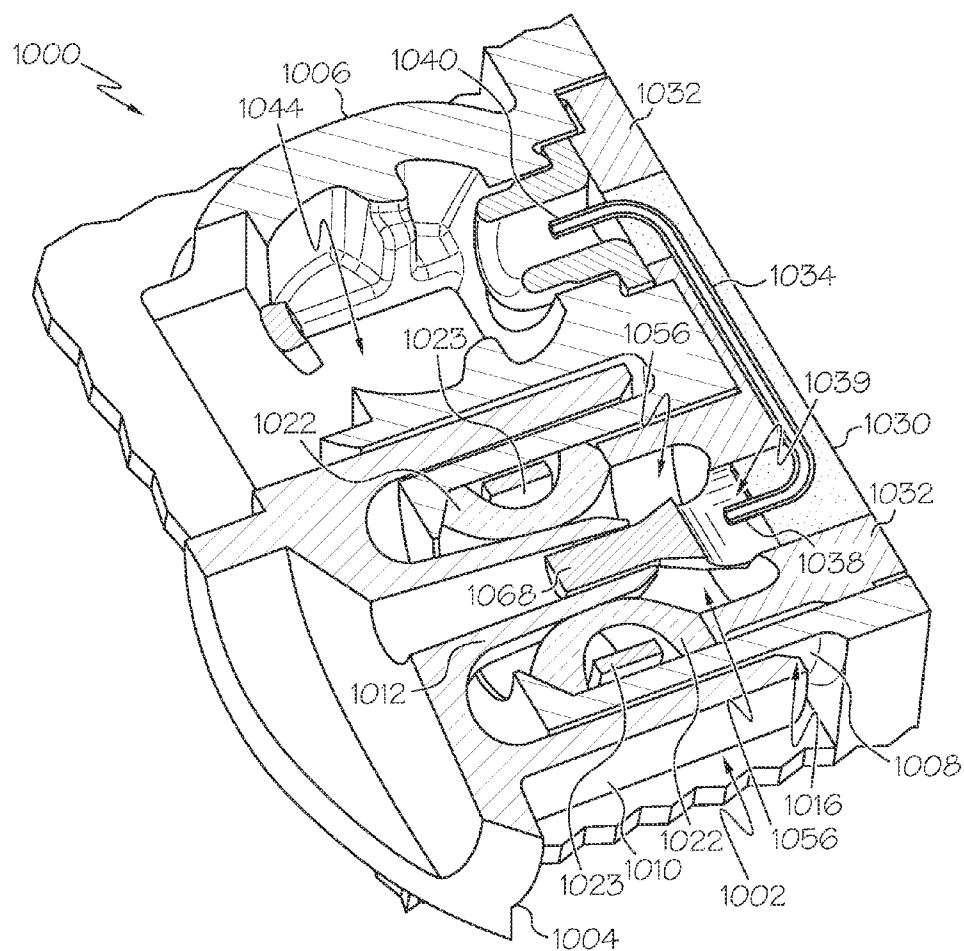
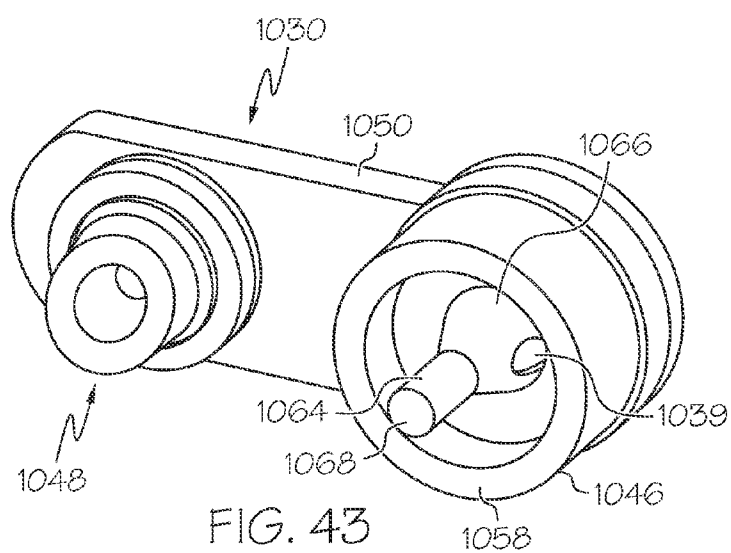
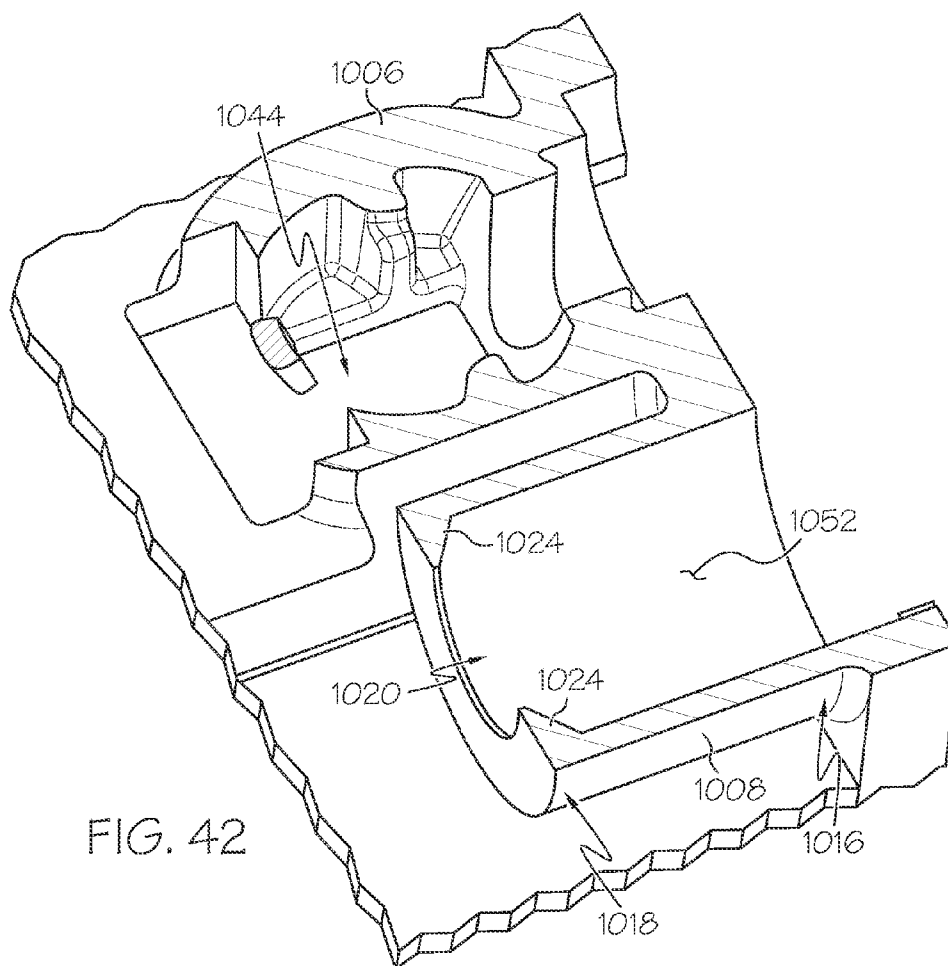

FIG. 41



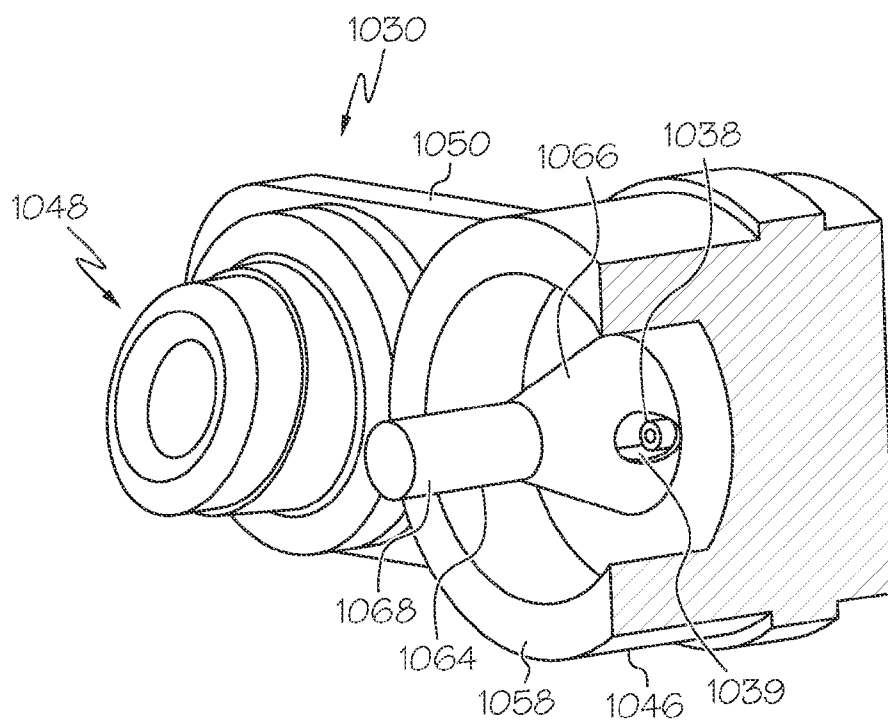

FIG. 44

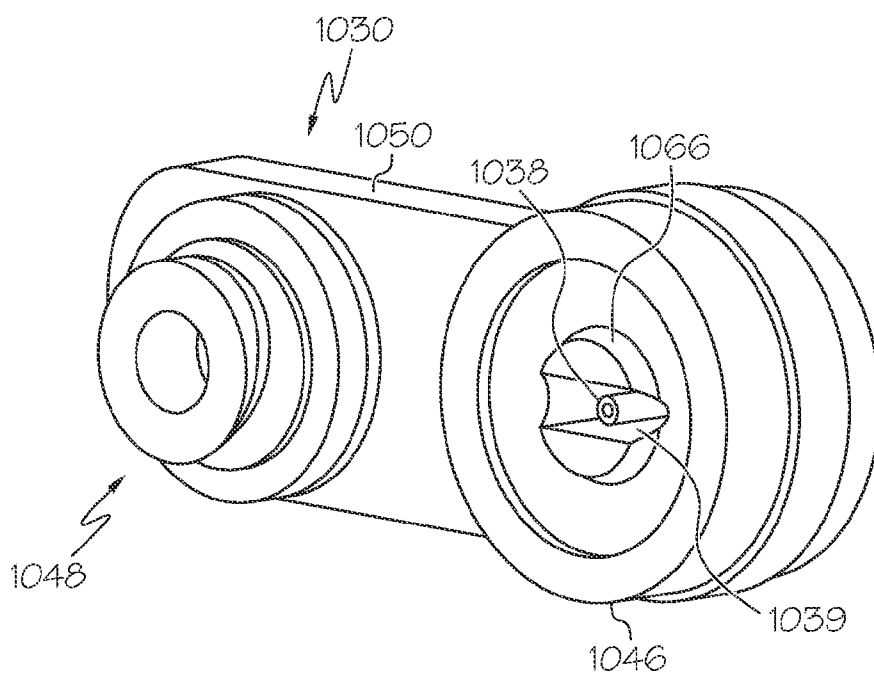

FIG. 45

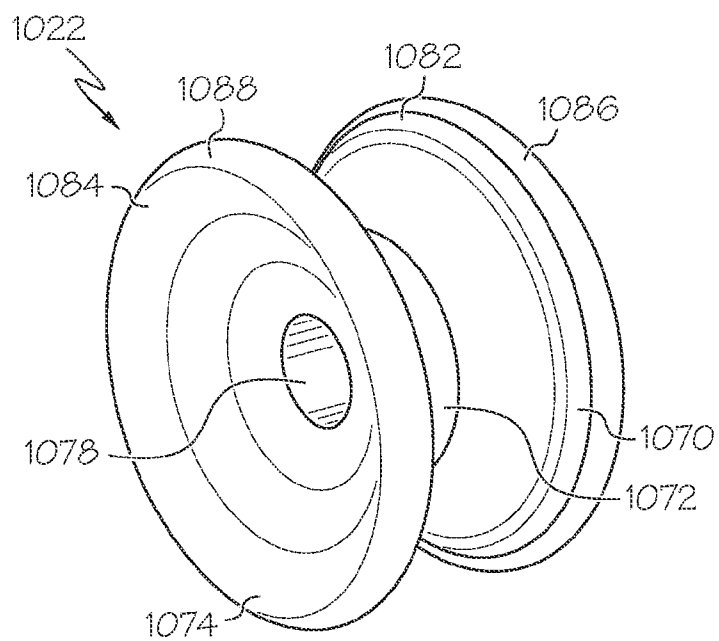

FIG. 46

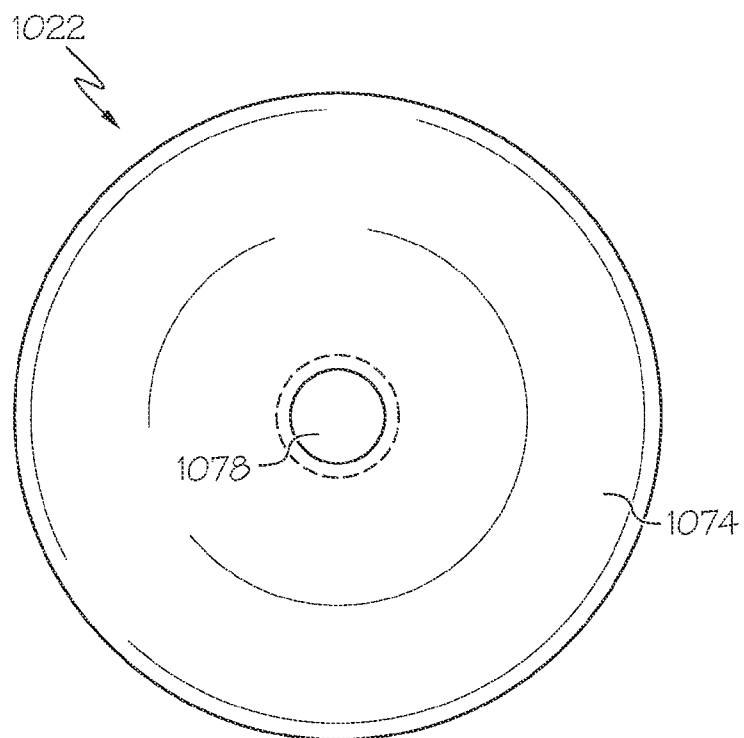

FIG. 47

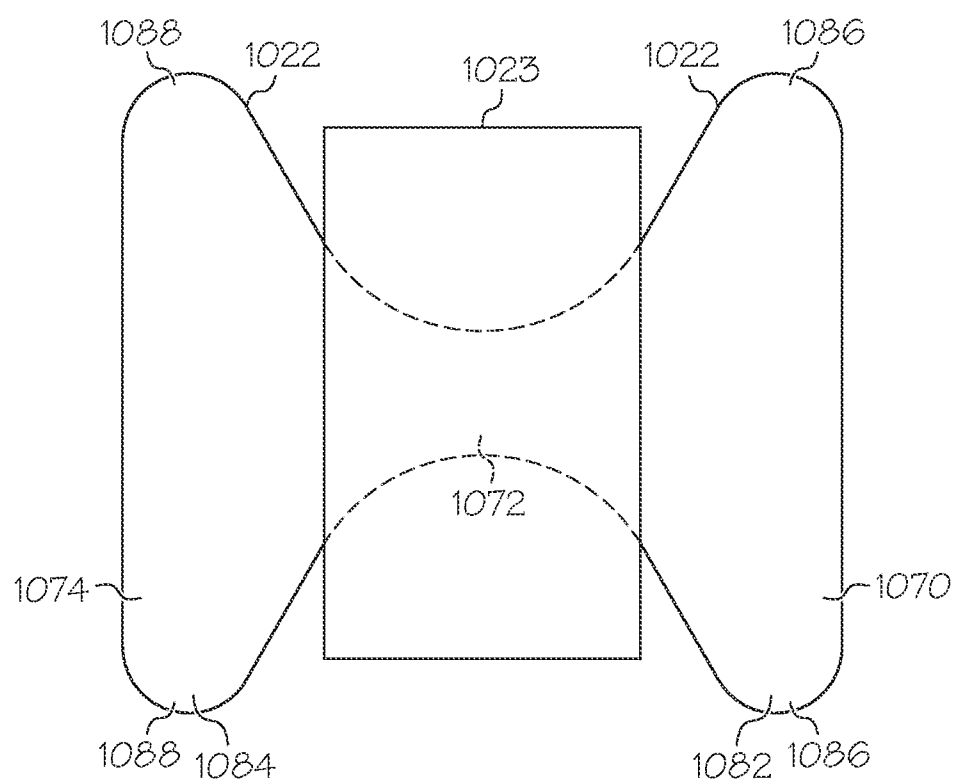

FIG. 48

**FLANGED SEALING ELEMENT AND
NEEDLE GUIDE PIN ASSEMBLY FOR A
FLUID INFUSION DEVICE HAVING A
NEEDED FLUID RESERVOIR**

**CROSS-REFERENCE TO RELATED
APPLICATION(S)**

[0001] This application is a continuation-in-part of U.S. patent application Ser. No. 13/399,851, filed Feb. 17, 2012, which claims the benefit of U.S. provisional patent application No. 61/445,393, filed Feb. 22, 2011 (now expired). This application is also a continuation-in-part of U.S. patent application Ser. No. 13/399,857, filed Feb. 17, 2012, which claims the benefit of U.S. provisional patent application No. 61/445,393, filed Feb. 22, 2011 (now expired). This application is also a continuation-in-part of U.S. patent application Ser. No. 13/399,863, filed Feb. 17, 2012, which claims the benefit of U.S. provisional patent application No. 61/445,393, filed Feb. 22, 2011 (now expired). This application is also a continuation-in-part of U.S. patent application Ser. No. 13/399,865, filed Feb. 17, 2012, which claims the benefit of U.S. provisional patent application No. 61/445,393, filed Feb. 22, 2011 (now expired). This application is also a continuation-in-part of U.S. patent application Ser. No. 13/399,870, filed Feb. 17, 2012, which claims the benefit of U.S. provisional patent application No. 61/445,393, filed Feb. 22, 2011 (now expired). This application is also a continuation-in-part of U.S. patent application Ser. No. 13/399,874, filed Feb. 17, 2012, which claims the benefit of U.S. provisional patent application No. 61/445,393, filed Feb. 22, 2011 (now expired). This application is also a continuation-in-part of U.S. patent application Ser. No. 13/399,878, filed Feb. 17, 2012, which claims the benefit of U.S. provisional patent application No. 61/445,393, filed Feb. 22, 2011 (now expired).

TECHNICAL FIELD

[0002] Embodiments of the subject matter described herein relate generally to fluid infusion devices for delivering a medication fluid to the body of a user. More particularly, embodiments of the subject matter relate to a sealing element that provides a fluid seal between a fluid delivery needle and a removable fluid reservoir.

BACKGROUND

[0003] Certain diseases or conditions may be treated, according to modern medical techniques, by delivering a medication or other substance to the body of a patient, either in a continuous manner or at particular times or time intervals within an overall time period. For example, diabetes is commonly treated by delivering defined amounts of insulin to the patient at appropriate times. Some common modes of providing insulin therapy to a patient include delivery of insulin through manually operated syringes and insulin pens. Other modern systems employ programmable fluid infusion devices (e.g., insulin pumps) to deliver controlled amounts of insulin to a patient.

[0004] A fluid infusion device suitable for use as an insulin pump may be realized as an external device or an implantable device, which is surgically implanted into the body of the patient. External fluid infusion devices include devices designed for use in a generally stationary location (for example, in a hospital or clinic), and devices configured for

ambulatory or portable use (to be carried by a patient). External fluid infusion devices may establish a fluid flow path from a fluid reservoir to the patient via, for example, a suitable hollow tubing. The hollow tubing may be connected to a hollow fluid delivery needle that is designed to pierce the patient's skin to deliver an infusion medium to the body. Alternatively, the hollow tubing may be connected directly to the patient's body through a cannula or set of micro-needles.

[0005] The fluid reservoir of an external fluid infusion device may be realized as a single-use prefilled disposable unit, a patient-filled unit, a refillable unit, or the like. The fluid reservoir for a typical fluid infusion device is implemented as a removable and replaceable component. To this end, the fluid infusion device includes structure, features, and/or elements that are designed to establish the fluid flow path with the fluid reservoir. For example, a fluid seal between the fluid reservoir and a hollow fluid delivery needle may be established when the fluid reservoir is properly installed in the fluid infusion device. When the fluid reservoir is removed (for purposes of replacement, to allow certain activities such as swimming or bathing, or the like), the fluid delivery needle should be protected against contamination.

[0006] Accordingly, it is desirable to implement a sealing element that creates a seal between a removable fluid reservoir and a delivery needle of a fluid infusion device. Furthermore, other desirable features and characteristics will become apparent from the subsequent detailed description and the appended claims, taken in conjunction with the accompanying drawings and the foregoing technical field and background.

BRIEF SUMMARY

[0007] Various embodiments of a fluid infusion device, along with related fluid reservoirs and sealing elements for fluid reservoirs, are provided here. For example, an embodiment of a sealing element for a fluid infusion device is provided. The sealing element includes a base section, a tip section extending from the base section, a retractable body section between the base section and the tip section, and a needle cavity formed in the retractable body section. The needle cavity continues through the base section to define a needle opening in the base section, and the needle cavity is sized to receive the hollow fluid delivery needle. The sealing element also includes a self-sealing slit formed in the tip section to accommodate the hollow fluid delivery needle when the sealing element is in a retracted position.

[0008] Another embodiment of a sealing element for a fluid infusion device is also provided. The sealing element includes a base section, a tip section extending from the base section, a retractable body section between the base section and the tip section, and a needle cavity formed in the retractable body section and continuing through the base section to define a needle opening in the base section. The needle cavity is sized to receive the hollow fluid delivery needle, and the needle cavity defines internal relief features of the retractable body section. The internal relief features cause the sealing element to deform and retract over the hollow fluid delivery needle in response to a longitudinal force applied to the tip section. In addition, the internal relief features cause the sealing element to regain a nominal shape, extend over the hollow fluid delivery needle, and enclose the hollow fluid delivery needle in response to removal of the longitudinal force.

[0009] An embodiment of a sealing assembly for a fluid infusion device is also provided. The fluid infusion device

cooperates with a fluid reservoir having a fluid delivery port. The sealing assembly includes a base plate, a hollow fluid delivery needle coupled to the base plate to provide a fluid flow path from the fluid reservoir to a user of the fluid infusion device, and a sealing element coupled to the base plate and overlying at least a portion of the hollow fluid delivery needle. The sealing element includes a base section, a tip section extending from the base section, a retractable body section between the base section and the tip section, a needle cavity formed in the retractable body section and continuing through the base section to define a needle opening in the base section, and a self-sealing slit formed in the tip section. The needle cavity is sized to receive the hollow fluid delivery needle, and the self-sealing slit accommodates the hollow fluid delivery needle when the sealing element is in a retracted position.

[0010] Another embodiment of a sealing assembly for a fluid infusion device is also provided. The sealing assembly includes a base plate, a hollow fluid delivery needle coupled to the base plate to provide a fluid flow path from the fluid reservoir to a user of the fluid infusion device, and a sealing element coupled to the base plate and overlying at least a portion of the hollow fluid delivery needle. The sealing element includes a base section, a tip section extending from the base section, a retractable body section between the base section and the tip section, and a needle cavity formed in the retractable body section and continuing through the base section to define a needle opening in the base section. The needle cavity is sized to receive the hollow fluid delivery needle, and the needle cavity defines internal relief features of the retractable body section. The internal relief features promote deformation of the sealing element and retraction of the sealing element over the hollow fluid delivery needle in response to a longitudinal force applied to the tip section of the sealing element. Moreover, the internal relief features cause the sealing element to automatically extend over the hollow fluid delivery needle into a nominal state in response to removal of the longitudinal force.

[0011] Also presented here is an embodiment of a fluid infusion device to deliver a fluid to a user. The fluid infusion device includes a base plate, a hollow fluid delivery needle coupled to the base plate to provide a fluid flow path from the fluid infusion device to the user, and a sealing element coupled to the base plate and overlying at least a portion of the hollow fluid delivery needle. The sealing element includes a base section, a tip section extending from the base section, a retractable body section between the base section and the tip section, a needle cavity formed in the retractable body section and continuing through the base section to define a needle opening in the base section, the needle cavity sized to receive the hollow fluid delivery needle, and a self-sealing slit formed in the tip section. The fluid infusion device also includes a removable fluid reservoir having a fluid delivery port to receive a tip of the hollow fluid delivery needle. When the removable fluid reservoir is removed from the hollow fluid delivery needle, the retractable body section extends such that the hollow fluid delivery needle is enclosed by the sealing element and such that the self-sealing slit forms a fluid seal to inhibit fluid ingress into the needle cavity. When the removable fluid reservoir is installed on the hollow fluid delivery needle, the tip of the hollow fluid delivery needle extends from the tip section and into the fluid reservoir, and the retractable body section deforms to create a radial seal with an interior of the fluid delivery port.

[0012] Another embodiment of a fluid infusion device is also presented here. The fluid infusion device includes a base plate, a hollow fluid delivery needle coupled to the base plate to provide a fluid flow path from the fluid infusion device to the user, and a sealing element coupled to the base plate and overlying at least a portion of the hollow fluid delivery needle. The sealing element includes a base section, a tip section extending from the base section, a retractable body section between the base section and the tip section, and a needle cavity formed in the retractable body section and continuing through the base section to define a needle opening in the base section. The needle cavity is sized to receive the hollow fluid delivery needle, and the needle cavity defines internal relief features of the retractable body section. The fluid infusion device also includes a removable fluid reservoir comprising a fluid delivery port to receive a tip of the hollow fluid delivery needle. The internal relief features promote deformation of the sealing element and retraction of the sealing element over the hollow fluid delivery needle when the removable fluid reservoir is engaged with the sealing element and the hollow fluid delivery needle. The internal relief features also cause the sealing element to automatically extend over the hollow fluid delivery needle, and cause the sealing element to assume a nominal state when the removable fluid reservoir is removed from the sealing element and the hollow fluid delivery needle.

[0013] Yet another embodiment of a fluid infusion device is also provided here. The fluid infusion device includes a base plate, a hollow fluid delivery needle coupled to the base plate to provide a fluid flow path for the medication fluid, and a sealing element coupled to the base plate and overlying at least a portion of the hollow fluid delivery needle. The sealing element includes a base section, a tip section extending from the base section, and a retractable body section between the base section and the tip section. The fluid infusion device also includes a fluid reservoir having a fluid chamber, a fluid delivery port coupled to the fluid chamber, and at least one vent hole formed in the fluid delivery port. The at least one vent hole provides a venting conduit from inside the fluid chamber to outside the fluid chamber. The fluid delivery port engages and cooperates with the sealing element and the hollow fluid delivery needle such that the tip section of the sealing element is urged against the fluid delivery port to seal the at least one vent hole.

[0014] An alternative embodiment of a fluid reservoir is also presented here. The fluid reservoir includes a main body section that defines a fluid chamber for the medication fluid, a fluid delivery port coupled to and extending from the main body section, the fluid delivery port having a fluid conduit and a pressure vent defined therein, and a septum located in the fluid delivery port and having a nominal non-pierced state forming a fluid seal within the fluid conduit. The pressure vent provides a venting conduit from inside the fluid chamber to outside the fluid chamber, and the pressure vent terminates at an exterior surface of the fluid delivery port. The exterior surface is contoured to mate with a resilient sealing element of the fluid infusion device to seal the pressure vent.

[0015] Also disclosed here is an embodiment of a sealing assembly for a fluid infusion device having a hollow fluid delivery needle, a retractable sealing element surrounding the hollow fluid delivery needle, and a fluid reservoir. The sealing assembly includes a fluid delivery port for the fluid reservoir, the fluid delivery port comprising a first sealing surface, a pressure vent formed in the fluid delivery port to provide a venting conduit for a fluid chamber of the fluid reservoir, the

pressure vent terminating at the first sealing surface, and a tip section for the retractable sealing element. The tip section has a second sealing surface to mate with the first sealing surface, wherein the first sealing surface and the second sealing surface are urged together to form a fluid seal for the pressure vent when the fluid reservoir is engaged with the hollow fluid delivery needle and the sealing element.

[0016] Another alternative embodiment of a fluid reservoir is presented here. The fluid reservoir includes a main body section that defines a fluid chamber for the medication fluid, and a fluid delivery port coupled to and extending from the main body section. The fluid delivery port includes a fluid conduit that communicates with the fluid chamber, and the fluid delivery port terminates at a port opening. The fluid reservoir also includes a septum movably coupled to the fluid delivery port. The septum is movable between a sealed position where the septum forms a circumferential seal around the port opening, and a vented position that permits fluid to flow out of the fluid delivery port via the port opening.

[0017] Yet another alternative embodiment of a fluid reservoir is presented here. The fluid reservoir includes a main body section that defines a fluid chamber for the medication fluid, and a fluid delivery port coupled to and extending from the main body section. The fluid delivery port has a fluid conduit that communicates with the fluid chamber, and the fluid delivery port terminates at a port opening. The fluid reservoir also includes a valve sleeve movably coupled to the fluid delivery port, wherein the fluid delivery port and the valve sleeve cooperate to accommodate translational movement of the valve sleeve relative to the fluid delivery port. A septum is located within the valve sleeve and is movable in concert with the valve sleeve between a sealed position and a vented position.

[0018] Also provided here is another alternative embodiment of a fluid infusion device that delivers a medication fluid to a body. The fluid infusion device includes a base plate, a hollow fluid delivery needle coupled to the base plate to provide a fluid flow path for the medication fluid, and a fluid reservoir. The fluid reservoir includes a main body section that defines a fluid chamber for the medication fluid, a fluid delivery port coupled to and extending from the main body section, and a septum coupled to the fluid delivery port. The fluid delivery port has a fluid conduit that communicates with the fluid chamber, and the fluid delivery port terminates at a port opening. The septum translates relative to the port opening and is movable between a sealed position and a vented position. In the sealed position, the hollow fluid delivery needle engages the septum and urges the septum against the port opening to form a circumferential seal around the port opening. In the vented position, the hollow fluid delivery needle is disengaged from the septum.

[0019] Yet another embodiment of a fluid infusion device is also provided here. The fluid infusion device includes a fluid reservoir having a main body section that defines a fluid chamber for the medication fluid, and also having a fluid delivery port coupled to and extending from the main body section. The fluid delivery port has a fluid conduit that communicates with the fluid chamber, and the fluid delivery port terminates at an unsealed port opening. The fluid infusion device also includes a self-sealing reservoir port receptacle for the fluid delivery port. The port receptacle has an inlet to receive the fluid delivery port, a valve chamber in fluid communication with the inlet, a valve element located in the valve chamber, and an outlet in fluid communication with the valve

chamber. The valve element is biased toward the inlet into a sealed position to form a fluid seal between the valve element and the inlet, and the outlet provides a fluid flow path for the medication fluid. Engagement of the fluid delivery port with the inlet causes an end of the fluid delivery port to move the valve element from the sealed position to an opened position to accommodate flow of the medication fluid into the valve chamber.

[0020] An alternative embodiment of a sealing assembly for a fluid infusion device is also presented here. The sealing assembly includes a reservoir port receptacle, an inlet formed in the reservoir port receptacle to receive a fluid delivery port of a fluid reservoir that contains the medication fluid, and a valve chamber formed in the reservoir port receptacle and in fluid communication with the inlet, a valve element located in the valve chamber, a resilient compression element located in the valve chamber to bias the valve element toward the inlet, and an outlet formed in the reservoir port receptacle to provide a fluid flow path for the medication fluid.

[0021] Another embodiment of a fluid infusion device is also presented here. The fluid infusion device includes a base plate, a delivery conduit coupled to the base plate, wherein the delivery conduit provides the medication fluid to the body, and a self-sealing reservoir port receptacle located on the base plate. The self-sealing reservoir port receptacle includes an inlet to receive a fluid delivery port of a fluid reservoir, a valve chamber in fluid communication with the inlet, a valve element located in the valve chamber, and an outlet between the valve chamber and the delivery conduit. When the fluid delivery port is disengaged from the self-sealing reservoir port receptacle, the valve element is biased toward the inlet into a sealed position to form a fluid seal between the valve element and the inlet. The outlet provides a fluid flow path for the medication fluid. When the fluid delivery port is engaged with the self-sealing reservoir port receptacle, an end of the fluid delivery port moves the valve element from the sealed position to an opened position to accommodate flow of the medication fluid from the fluid reservoir into the valve chamber.

[0022] Also presented here is an alternative embodiment of a fluid reservoir for a fluid infusion device that delivers a medication fluid to a body. The fluid reservoir includes a main body section that defines a fluid chamber for the medication fluid, a hollow needle extending from the main body section and defining a fluid conduit that communicates with the fluid chamber, the hollow needle terminating at a needle end, and a needle hood extending from the main body section and at least partially surrounding the hollow needle. The needle hood terminates at a lip that extends further from the main body section than the needle end.

[0023] Yet another alternative embodiment of a fluid infusion device is also provided here. The fluid infusion device includes a base plate, a delivery conduit coupled to the base plate, wherein the delivery conduit provides the medication fluid to the body, and a fluid reservoir. The fluid reservoir has a main body section that defines a fluid chamber for the medication fluid, a hollow needle extending from the main body section and in fluid communication with the fluid chamber, and a needle hood extending from the main body section and at least partially surrounding the hollow needle. The fluid infusion device also includes a reservoir port receptacle located on the base plate and comprising mating structure to engage and mate with the needle hood, a sealing element to receive the hollow needle and form a seal around an exterior surface of the hollow needle, and an outlet conduit at least

partially defined by the sealing element, wherein the outlet conduit is coupled to the delivery conduit.

[0024] Also presented here is another embodiment of a fluid infusion device that delivers a medication fluid to a body. The fluid infusion device includes a fluid reservoir having a main body section that defines a fluid chamber for the medication fluid, and having a hollow needle extending from the main body section and in fluid communication with the fluid chamber. The fluid infusion device also includes a reservoir port receptacle having a sealing element, and having mating structure to engage the fluid reservoir in an aligned orientation for introducing the hollow needle into the sealing element to form a seal around an exterior surface of the hollow needle.

[0025] A sealing assembly in accordance with another embodiment is also presented here. The sealing assembly is designed for a fluid infusion device that cooperates with a fluid reservoir having a reservoir port and a hollow fluid reservoir needle at least partially located within the reservoir port. The sealing assembly includes a reservoir port receptacle to receive the reservoir port. The reservoir port receptacle has a proximal end, a distal end extending from the proximal end, and a needle entry formed in the distal end to receive the hollow fluid reservoir needle. The sealing assembly also includes a fluid chamber located at least partially in the reservoir port receptacle, and a sealing component positioned in the reservoir port receptacle to cooperate with the fluid chamber. The sealing component has a needle guide pin protruding from the proximal end of the reservoir port receptacle, wherein an end section of the needle guide pin is sized to fit within the hollow fluid reservoir needle. The sealing component also has a needle sealing element that cooperates with the hollow fluid reservoir needle and with the needle guide pin. The needle sealing element includes a base section adjacent to the fluid chamber, an end section opposite the base section, a neck section between the base section and the end section, and a needle opening extending through the neck section. When the reservoir port is engaged with reservoir port receptacle, the end section of the needle guide pin resides within the hollow fluid reservoir needle, a portion of the hollow fluid reservoir needle resides within the needle opening, and the needle sealing element forms a first seal around an exterior surface of the hollow fluid reservoir needle. When the reservoir port is disengaged from the reservoir port receptacle, the hollow fluid reservoir needle is decoupled from the sealing component, a portion of the end section of the needle guide pin resides within the needle opening, and the needle sealing element forms a second seal around an exterior surface of the needle guide pin.

[0026] Also presented here is a sealing assembly in accordance with yet another embodiment. The sealing assembly is utilized with a fluid infusion device that cooperates with a fluid reservoir having a reservoir port and a hollow fluid reservoir needle at least partially located within the reservoir port. The sealing assembly includes a base plate and a reservoir port receptacle on the base plate to receive the reservoir port. The reservoir port receptacle has a proximal end, a distal end extending from the proximal end, and a needle entry formed in the distal end to receive the hollow fluid reservoir needle. The sealing assembly also includes a flow base component coupled to the base plate and to the reservoir port receptacle. The flow base component has an inlet structure extending therefrom to define a fluid chamber, and the flow base component also has a needle guide pin protruding there-

from. An end section of the needle guide pin is sized to fit within the hollow fluid reservoir needle. The sealing component also includes a needle sealing element having a proximal flange adjacent to the inlet structure, a distal flange opposite the proximal flange, a neck section between the proximal flange and the distal flange, and a needle opening extending through the neck section. The needle sealing element is positioned within the reservoir port receptacle such that the neck section surrounds the end section of the needle guide pin.

[0027] Another embodiment of a fluid infusion device is also presented here. The fluid infusion device includes a removable fluid reservoir having a reservoir port and a hollow fluid reservoir needle, a base plate having a reservoir port receptacle to receive the reservoir port and the fluid reservoir needle, and an inlet structure located in the reservoir port receptacle. The inlet structure defines at least a portion of a fluid chamber. The fluid infusion device also includes a needle guide pin protruding from the inlet structure, wherein an end section of the needle guide pin is sized to fit within the hollow fluid reservoir needle. The fluid infusion device also includes a needle sealing element having a base section adjacent to the inlet structure, an end section opposite the base section, a neck section between the base section and the end section, and a needle opening extending through the neck section. When the reservoir port is engaged with reservoir port receptacle, the end section of the needle guide pin resides within the hollow fluid reservoir needle, a portion of the hollow fluid reservoir needle resides within the needle opening, and the needle sealing element forms a first seal around an exterior surface of the hollow fluid reservoir needle. When the reservoir port is disengaged from the reservoir port receptacle, the hollow fluid reservoir needle is decoupled from the sealing component, a portion of the end section of the needle guide pin resides within the needle opening, and the needle sealing element forms a second seal around an exterior surface of the needle guide pin.

[0028] This summary is provided to introduce a selection of concepts in a simplified form that are further described below in the detailed description. This summary is not intended to identify key features or essential features of the claimed subject matter, nor is it intended to be used as an aid in determining the scope of the claimed subject matter.

BRIEF DESCRIPTION OF THE DRAWINGS

[0029] A more complete understanding of the subject matter may be derived by referring to the detailed description and claims when considered in conjunction with the following figures, wherein like reference numbers refer to similar elements throughout the figures.

[0030] FIG. 1 is a perspective view of an embodiment of a fluid infusion device;

[0031] FIG. 2 is a perspective view that depicts internal structure of the durable housing of the fluid infusion device shown in FIG. 1;

[0032] FIG. 3 is a perspective view that depicts internal structure of the base plate of the fluid infusion device shown in FIG. 1;

[0033] FIG. 4 is a perspective view that depicts the reservoir port receptacle and a sealing element of the fluid infusion device shown in FIG. 1;

[0034] FIG. 5 is a cross-sectional and partially phantom view of a portion of the fluid infusion device, corresponding to a view along line 5-5 in FIG. 4;

[0035] FIG. 6 is an exploded perspective view of a sealing assembly suitable for use with the fluid infusion device shown in FIG. 1;

[0036] FIG. 7 is a plan view of the sealing element shown in FIG. 6, as viewed from its base end;

[0037] FIG. 8 is a side elevation view of the sealing element shown in FIG. 6;

[0038] FIG. 9 is a front elevation view of the sealing element shown in FIG. 6;

[0039] FIG. 10 is a perspective view of the sealing element shown in FIG. 6;

[0040] FIG. 11 is a longitudinal cross-sectional view of the sealing element shown in FIG. 6;

[0041] FIG. 12 is a cross-sectional and partially phantom view of a portion of the fluid infusion device, in a state where the fluid reservoir is fully engaged with the sealing element;

[0042] FIG. 13 is a perspective view of an alternate embodiment of a sealing element;

[0043] FIG. 14 is a phantom side view that depicts a portion of an alternative embodiment of a sealing element;

[0044] FIG. 15 is a phantom perspective view that depicts a portion of an alternative embodiment of a sealing element;

[0045] FIG. 16 is a phantom side view that depicts a portion of an alternative embodiment of a sealing element;

[0046] FIG. 17 is a schematic side view of an embodiment of a vented fluid reservoir;

[0047] FIG. 18 is a top view of an embodiment of a vented fluid reservoir;

[0048] FIG. 19 is a phantom side view of an embodiment of a fluid reservoir that includes a septum that serves as a pressure relief valve;

[0049] FIG. 20 is a phantom side view of the fluid reservoir shown in FIG. 19 in a sealed state;

[0050] FIG. 21 is a longitudinal cross-sectional view of a fluid reservoir and a self-sealing reservoir port receptacle suitable for use with a fluid infusion device;

[0051] FIG. 22 is an end view of the fluid reservoir as viewed from the perspective of line 22-22 in FIG. 21;

[0052] FIG. 23 is a perspective view of a first embodiment of a fluid reservoir that includes a needle;

[0053] FIG. 24 is a cross-sectional view of a portion of the fluid reservoir, as viewed from the perspective of line 24-24 in FIG. 23;

[0054] FIG. 25 is a perspective view of a section of a fluid infusion device, including a reservoir port receptacle suitable for engagement with the fluid reservoir shown in FIG. 23;

[0055] FIG. 26 is a perspective view of a sealing and conduit component suitable for use with the fluid infusion device shown in FIG. 25;

[0056] FIG. 27 is a cross-sectional view of the section of the fluid infusion device, as viewed from the perspective of line 27-27 in FIG. 25;

[0057] FIG. 28 is a cross-sectional and partially phantom view that illustrates the fluid reservoir (shown in FIG. 23) before engagement with the section of the fluid infusion device (shown in FIG. 25);

[0058] FIG. 29 is a cross-sectional and partially phantom view that illustrates the fluid reservoir (shown in FIG. 23) after engagement with the section of the fluid infusion device (shown in FIG. 25);

[0059] FIG. 30 is a cross-sectional view of a portion of a second embodiment of a needled fluid reservoir;

[0060] FIG. 31 is a cross-sectional view of a section of a fluid infusion device that is designed to accommodate the needled fluid reservoir shown in FIG. 30;

[0061] FIG. 32 is a cross-sectional and partially phantom view that illustrates the fluid reservoir (shown in FIG. 30) before engagement with the section of the fluid infusion device (shown in FIG. 31);

[0062] FIG. 33 is a cross-sectional and partially phantom view that illustrates the fluid reservoir (shown in FIG. 30) after engagement with the section of the fluid infusion device (shown in FIG. 31);

[0063] FIG. 34 is a perspective view of a third embodiment of a needled fluid reservoir;

[0064] FIG. 35 is a cross-sectional view of a portion of the fluid reservoir, as viewed from the perspective of line 35-35 in FIG. 34;

[0065] FIG. 36 is a perspective view of a section of a fluid infusion device, including a reservoir port receptacle suitable for engagement with the fluid reservoir shown in FIG. 34;

[0066] FIG. 37 is a cross-sectional view of the section of the fluid infusion device, as viewed from the perspective of line 37-37 in FIG. 36;

[0067] FIG. 38 is a cross-sectional and partially phantom view that illustrates the fluid reservoir (shown in FIG. 34) before engagement with the section of the fluid infusion device (shown in FIG. 36);

[0068] FIG. 39 is a cross-sectional and partially phantom view that illustrates the fluid reservoir (shown in FIG. 34) after engagement with the section of the fluid infusion device (shown in FIG. 36);

[0069] FIG. 40 is a cross-sectional view of a portion of a fluid infusion device, showing a sealing structure prior to engagement with a fluid reservoir needle;

[0070] FIG. 41 is a cross-sectional view of the portion of the fluid infusion device shown in FIG. 40, showing the sealing structure after engagement with the fluid reservoir needle;

[0071] FIG. 42 is a cross-sectional view of a portion of a base plate utilized by the fluid infusion device shown in FIG. 40;

[0072] FIG. 43 is a perspective view of a flow base component utilized by the fluid infusion device shown in FIG. 40;

[0073] FIG. 44 is a perspective view of the flow base component shown in FIG. 43, with a portion removed to better illustrate its internal structure;

[0074] FIG. 45 is a perspective view of the flow base component shown in FIG. 43, with a portion removed to better illustrate its internal structure;

[0075] FIG. 46 is a perspective view of a needle sealing element utilized by the fluid infusion device shown in FIG. 40;

[0076] FIG. 47 is a front end view of the needle sealing element shown in FIG. 46; and

[0077] FIG. 48 is a side view of the needle sealing element shown in FIG. 46, with a spacer installed thereon.

DETAILED DESCRIPTION

[0078] The following detailed description is merely illustrative in nature and is not intended to limit the embodiments of the subject matter or the application and uses of such embodiments. As used herein, the word “exemplary” means “serving as an example, instance, or illustration.” Any implementation described herein as exemplary is not necessarily to be construed as preferred or advantageous over other implementations. Furthermore, there is no intention to be bound by

any expressed or implied theory presented in the preceding technical field, background, brief summary or the following detailed description.

[0079] Certain terminology may be used in the following description for the purpose of reference only, and thus are not intended to be limiting. For example, terms such as “upper”, “lower”, “above”, and “below” could be used to refer to directions in the drawings to which reference is made. Terms such as “front”, “back”, “rear”, “side”, “outboard”, and “inboard” could be used to describe the orientation and/or location of portions of the component within a consistent but arbitrary frame of reference which is made clear by reference to the text and the associated drawings describing the component under discussion. Such terminology may include the words specifically mentioned above, derivatives thereof, and words of similar import. Similarly, the terms “first”, “second”, and other such numerical terms referring to structures do not imply a sequence or order unless clearly indicated by the context.

[0080] Various embodiments presented here are related to a sealing element suitable for use with a fluid reservoir and a fluid delivery needle of the type found in fluid infusion systems. In certain embodiments, the sealing element includes at least one slit formed in its tip to accommodate a hollow needle. When a fluid reservoir is introduced and coupled to the needle, the port of the fluid reservoir and/or another structural feature of the reservoir urges the sealing element to retract over the needle such that the end of the needle penetrates the slit, protrudes from the tip of the sealing element, and enters the fluid reservoir. Upon fluid connection in this manner, the needle penetrates the tip of the sealing element, which in turn outwardly expands the material (e.g., silicone) of the sealing element near the tip. The reservoir port that receives the sealing element is sized and configured such that expansion of the sealing element forms a radial seal between the inner surface of the reservoir port and the sealing element. Further and complete installation of the reservoir onto the needle also creates a secondary backup face seal between the opening of the reservoir port and the sealing element.

[0081] Additional embodiments of various fluid reservoir configurations, needle sealing arrangements, and fluid interface designs are also presented here. For example, a number of vented fluid reservoir embodiments are described below, where a pressure vent is incorporated into the fluid reservoir to facilitate the equalization of pressure that may otherwise be present inside of the fluid reservoir and, therefore, to reduce the likelihood of accidental fluid delivery caused by the buildup of internal pressure.

[0082] In addition, a “needleless” embodiment is presented here. In lieu of a fluid delivery needle, a fluid reservoir is suitably configured to interact with a sealing component or feature of a base plate of the fluid infusion device. The sealing component includes a valve member (e.g., a ball valve) that opens to accommodate fluid delivery from the fluid reservoir when the reservoir is introduced to the base plate. When the reservoir is removed, the valve member automatically seals the flow path.

[0083] Various embodiments of a fluid reservoir having a “hooded” or shielded needle or needle-like structure are also provided. The reservoir needle is designed to deliver the medication fluid to a corresponding fluid receptacle of the fluid infusion device. The fluid receptacle includes a sealing element that receives the reservoir needle and creates a fluid seal with the reservoir.

[0084] The following description relates to a fluid infusion device of the type used to treat a medical condition of a patient. The infusion device is used for infusing fluid into the body of a user. The non-limiting examples described below relate to a medical device used to treat diabetes (more specifically, an insulin pump), although embodiments of the disclosed subject matter are not so limited. Accordingly, the infused medication fluid is insulin in certain embodiments. In alternative embodiments, however, many other fluids may be administered through infusion such as, but not limited to, disease treatments, drugs to treat pulmonary hypertension, iron chelation drugs, pain medications, anti-cancer treatments, medications, vitamins, hormones, or the like. For the sake of brevity, conventional features and characteristics related to infusion system operation, insulin pump and/or infusion set operation, fluid reservoirs, and fluid syringes may not be described in detail here. Examples of infusion pumps and/or related pump drive systems used to administer insulin and other medications may be of the type described in, but not limited to: United States patent application number 2009/0299290 A1; United States patent application number 2008/0269687; U.S. Pat. No. 7,828,764; and U.S. Pat. No. 7,905,868 (the entire content of these patent documents is incorporated by reference herein).

[0085] Retractable Needle Sealing Element

[0086] FIG. 1 is a perspective view of an exemplary embodiment of a fluid infusion device **100**. The fluid infusion device **100** includes two primary components that are removably coupled to each other: a durable housing **102**; and a base plate **104**. The fluid infusion device **100** also includes or cooperates with a removable/replaceable fluid reservoir **106**. For the illustrated embodiment, the fluid reservoir **106** mates with, and is received by, the durable housing **102**. In alternate embodiments, the fluid reservoir **106** mates with, and is received by, the base plate **104**. FIG. 2 is a perspective view that depicts internal structure of the durable housing **102**, FIG. 3 is a perspective view that depicts internal structure of the base plate **104**, and FIG. 4 is a perspective view that depicts a reservoir port receptacle **108** and a sealing element **110** of the fluid infusion device **100**.

[0087] The base plate **104** is designed to be temporarily adhered to the skin of the patient using, for example, an adhesive layer of material. After the base plate is affixed to the skin of the patient, a suitably configured insertion device or apparatus may be used to insert a fluid delivery needle or cannula **112** (see FIG. 1) into the body of the patient. The cannula **112** functions as one part of the fluid delivery path associated with the fluid infusion device **100**, as is well understood.

[0088] FIG. 1 depicts the durable housing **102** and the base plate **104** coupled together. In practice, the durable housing **102** and/or the base plate **104** may include features, structures, or elements to facilitate removable coupling (e.g., pawls, latches, rails, slots, keyways, buttons, or the like). As shown in FIG. 2, the durable housing **102** is designed to receive the removable fluid reservoir **106** and to retain the fluid reservoir **106** in a particular position and orientation. Moreover, the durable housing **102** is configured to secure to the base plate **104** in a specified orientation to engage the fluid reservoir **106** with the reservoir port receptacle **108** (see FIG. 3). For this particular embodiment, the durable housing **102** contains, among other components, a drive motor, a battery, a threaded drive shaft for the fluid reservoir, one or more integrated circuit chips and/or other electronic devices (not

shown). In particular embodiments, the fluid infusion device **100** includes certain features to orient, align, and position the durable housing **102** relative to the base plate **104** such that when the two components are coupled together the fluid reservoir **106** is urged into the reservoir port receptacle **108** to engage the sealing assembly and establish a fluid seal, as described in more detail below.

[0089] The durable housing **102** and the base plate **104** are cooperatively configured to accommodate removable coupling of the durable housing **102** to the base plate **104**. The removable nature of the durable housing **102** enables the patient to replace the fluid reservoir **106** as needed. Moreover, the durable housing **102** can be removed (while leaving the base plate **104** adhered to the patient) to allow the patient to swim, shower, bathe, and participate in other activities that might otherwise damage or contaminate the durable housing **102**. When the durable housing **102** is removed from the base plate **104**, the fluid reservoir **106** is disengaged from the reservoir port receptacle **108**, the fluid flow path is broken, and the base plate **104** will appear as shown in FIG. 4.

[0090] The fluid reservoir **106** includes a fluid delivery port **114** that cooperates with the reservoir port receptacle **108**. FIG. 3 depicts the fully installed position of the fluid reservoir **106** relative to the base plate **104** and the reservoir port receptacle **108** (for ease of illustration, the durable housing **102** is not shown in FIG. 3). The fluid delivery port **114** may include a pierceable septum if the fluid reservoir **106** is a prefilled unit. Alternatively, the fluid delivery port **114** may include a vented opening to accommodate filling of the fluid reservoir **106** by the patient, a doctor, a caregiver, or the like. The fluid delivery port **114** has an interior **116** defined therein. As shown in FIG. 5, the interior **116** is shaped, sized, and otherwise configured to receive the sealing element **110** when the fluid reservoir **106** is engaged with the reservoir port receptacle **108**. In certain embodiments, the interior **116** is conical, tapered, and/or funnel-shaped, as best shown in FIG. 5. This preferred shape of the interior **116** makes it easy for the sealing element **110** to mate with the fluid delivery port **114** when the durable housing **102** is coupled to the base plate **104**.

[0091] The sealing element **110** forms part of a sealing assembly **130** for the fluid infusion device **100**. The sealing assembly **130** as referred to here may also include the base plate **104** (or a portion thereof) and/or other structure or elements that cooperate with the sealing element **110**. These additional components will be described with reference to FIG. 5, which is a cross-sectional and partially phantom view of a portion of the fluid infusion device **100** (corresponding to the view taken from line 5-5 in FIG. 4) and with reference to FIG. 6, which is an exploded perspective view of the sealing assembly **130**. The illustrated embodiment of the sealing assembly **130** generally includes, without limitation: the sealing element **110**; a mounting cap **132**; and a hollow fluid delivery needle **134**. It should be appreciated that a portion of the base plate **104** (e.g., the reservoir port receptacle **108** and/or the end portion of the base plate **104** that receives the sealing element **110** and the mounting cap **132**) may be considered to be part of the sealing assembly **130**.

[0092] The sealing assembly **130** may be formed by coupling the sealing element **110** and the hollow fluid delivery needle **134** to the mounting cap **132**. In turn, the mounting cap **132** may be secured to the base plate **104** (see FIG. 1 and FIG. 3). The sealing element **110** and the hollow fluid delivery needle **134** may be secured to the mounting cap **132** using an

adhesive, a bonding or welding agent, by a compression or snap fitting arrangement, or the like. The bottom surface **136** of the sealing element **110** (see FIG. 6) forms a fluid seal with a mating surface of the mounting cap **132**. In certain embodiments, the mounting cap **132** includes a hollow protrusion **138** (which may be conical in shape) that extends into, and forms a fluid seal with, the base section of the sealing element **110**, as shown in FIG. 5. A portion of the hollow fluid delivery needle **134** extends through the hollow protrusion **138** and into the sealing element **110**. As shown in FIG. 6, the hollow fluid delivery needle **134** for this particular embodiment is “J” shaped to provide a fluid flow path from the sealing element **110**, across the length of the mounting cap **132**, and into an outlet port **140** of the mounting cap **132**. The outlet port **140** leads to a second sealing element **142** (which may be integrally formed with the sealing element **110**, as shown), which in turn leads into a fluid chamber **144** defined in the base plate **104**. The fluid chamber **144** is fluidly coupled to the cannula **112** (FIG. 1) such that when a plunger of the fluid reservoir **106** is actuated, the fluid is expelled from the fluid reservoir **106**, through the hollow fluid delivery needle **134**, into the fluid chamber **144**, and into the body of the patient via the cannula **112**.

[0093] FIGS. 7-10 show the sealing element **110** and the second sealing element **142** in more detail, and FIG. 11 shows the sealing element **110** by itself in cross-section. The sealing element **110** and the second sealing element **142** may be integrally formed as a one-piece component from a resilient and deformable material, such as rubber, urethane, or the like. In certain embodiments, the sealing element **110** and the second sealing element **142** are formed from a pliable silicone material. The material used for the sealing element and the second sealing element **142** is selected to be resistant to the fluid being delivered, biocompatible, and capable of being sterilized after manufacturing. The following description focuses on the configuration, characteristics, and functionality of the sealing element **110** (the figures include the second sealing element **142** for the sake of completeness and for consistency with the exemplary embodiment).

[0094] The sealing element **110** includes a base section **150**, a tip section **152** extending from the base section **150**, and a retractable body section **154** between the base section **150** and the tip section **152**. In practice, the sealing element **110** is a one-piece component and, accordingly, the base section **150**, the tip section **152**, and the retractable body section **154** are integrally formed and continuous with one another. Referring to FIG. 11, the sealing element **110** includes a needle cavity **155** formed therein. More specifically, the needle cavity **155** is formed within the retractable body section **154**, and it continues through the base section **150** to define a needle opening **156** in the base section **150**. The exemplary embodiment depicted in the figures includes a tapered or conical shaped needle opening **156** that mates with the outer contour of the hollow protrusion **138** (see FIG. 5), which in turn accommodates the hollow fluid delivery needle **134**. As shown in FIG. 5, the needle cavity **155** is shaped, sized, and configured to receive the hollow fluid delivery needle **134**.

[0095] The base section **150** generally corresponds to the portion of the sealing element **110** that is coupled to the base plate **104** (by way of the mounting cap **132**). Notably, the mounting cap **132** and the hollow fluid delivery needle **134** are coupled to the base plate **104** in a substantially fixed and rigid manner such that the hollow fluid delivery needle **134**

protrudes from the mounting cap **132** and extends within the reservoir port receptacle **108** (see FIG. 4). The sealing element **110**, however, is a pliable and deformable feature. FIG. 4 depicts the sealing element **110** in its natural nominal state without the fluid reservoir **106** in place. In this nominal state, the tip section **152** of the sealing element **110** extends slightly beyond the lip of the reservoir port receptacle **108**. The sealing element **110** is configured to retract over the hollow fluid delivery needle **134** when the fluid reservoir **106** engages the base plate **104** (in FIG. 3 the fluid reservoir **106** is fully engaged with the reservoir port receptacle **108**).

[0096] The tip section **152** may be mushroom or barb shaped in various embodiments, as shown in FIGS. 8-11. The barbed shape of the tip section **152** promotes entry and seating of the sealing element **110** into the fluid delivery port **114** of the fluid reservoir **106**. Moreover, the barbed shape configuration helps to establish a good radial seal between the sealing element **110** and the interior **116** of the fluid delivery port **114** (described in more detail below).

[0097] Referring to FIG. 5 and FIG. 11, the sealing element **110** may also include at least one self-sealing slit **160**, slot, opening, or hole formed in the tip section **152** to accommodate the hollow fluid delivery needle **134** when the sealing element is in a retracted position. The self-sealing slit **160** may be realized as a very fine slice or puncture formed in the tip section **152** for purposes of guiding the end of the hollow fluid delivery needle **134** through the material of the sealing element **110** as needed. The self-sealing slit **160** is preferred over an embodiment that relies on repeated punctures of the tip section **152** with a sharp or pointed needle. For this particular embodiment, a flat or blunt ended hollow fluid delivery needle **134** can be utilized because the self-sealing slit **160** provides a pre-existing pathway through the tip section **152**.

[0098] The self-sealing slit **160** expands to accommodate passage of the hollow fluid delivery needle **134**, and it automatically returns to a “closed” and sealed state when the fluid reservoir **106** is removed from the base plate **104**. The sealed state is depicted in FIG. 5—the hollow fluid delivery needle **134** is fully enclosed within the sealing element **110** and the end of the hollow fluid delivery needle **134** is positioned behind the self-sealing slit **160**. More specifically, the sealing element **110** is overlying the protruding portion of the hollow fluid delivery needle **134**, which is located within the retractable body section **154**. In this state, the self-sealing slit **160** closes to inhibit fluid ingress into the needle cavity **155** and to protect the hollow fluid delivery needle **134** from contamination.

[0099] The illustrated embodiment of the sealing element **110** also includes an integral guide channel **162** formed in the tip section **152**. The guide channel **162** is in communication with the needle cavity **155** and the self-sealing slit **160**, as best shown in FIG. 11. The guide channel **162** may be realized as an opening or neck region having a smaller dimension (e.g., diameter) than the end of the needle cavity **155**, but a larger dimension than the self-sealing slit **160**. This arrangement and configuration enables the guide channel **162** to guide/lead the tip of the hollow fluid delivery needle **134** into the self-sealing slit **160** during retraction of the sealing element **110** over the hollow fluid delivery needle **134**. In practice, the guide channel **162** increases the likelihood of the hollow fluid delivery needle **134** entering the self-sealing slit **160** rather than “catching” and puncturing the material forming the tip section **152**.

[0100] Referring to FIG. 11, the needle cavity **155** is suitably configured such that it defines internal relief features **164** and/or an internal relief structure of the retractable body section **154**. In operation, the internal relief features **164** facilitate retraction of the sealing element **110** over the hollow fluid delivery needle **134** in response to a longitudinal force applied to the tip section **152**. Longitudinal force of this type may be imparted to the tip section **152** when the durable housing **102** is coupled to the base plate **104** and, consequently, when the fluid delivery port **114** of the fluid reservoir **106** engages the reservoir port receptacle **108** of the base plate **104** (see FIG. 3). The internal relief features **164** also cause the sealing element **110** to be self-biasing or spring-like such that the sealing element **110** extends over and covers the hollow fluid delivery needle **134** in response to the removal of the longitudinal force. This extended position is depicted in FIGS. 5-11.

[0101] The internal relief features **164** allow the sealing element **110** to compress and deform easily when the fluid reservoir **106** is introduced. Moreover, the internal relief features **164** function as a spring when under compression. In this regard, the internal relief features **164** urge the tip section **152** outward and beyond the end of the hollow fluid delivery needle **134** when the fluid reservoir **106** is withdrawn. The specific configuration of the internal relief features **164** may vary from one embodiment to another, and the exemplary arrangement depicted in FIG. 11 is not intended to be exhaustive or otherwise limiting. As shown in FIG. 11, the internal relief features **164** may include or be arranged as an accordion structure within the needle cavity **155**. Alternatively (or additionally), the internal relief features **164** may include one or a plurality of internal annular channels formed within the needle cavity **155**. Alternatively (or additionally), the internal relief features **164** may include one or a plurality of internal annular ridges or ribs within the needle cavity **155**. Alternatively (or additionally), the internal relief features **164** may include one or a plurality of bottleneck structures resident within the needle cavity **155**. The embodiment shown in FIG. 11 includes a number of annular channels alternating with a plurality of annular ridges. This arrangement of channels and ridges results in a plurality of bottleneck regions, which in turn form the spring-like accordion structure.

[0102] The mechanical characteristics, sealing characteristics, and functional aspects of the sealing element **110** will now be described with primary reference to FIGS. 4, 5, 11, and 12. The fluid infusion device **100** and, more specifically, the sealing element **110** may be manipulated into various states associated with the coupling status of the fluid reservoir **106** relative to the sealing assembly **130** (FIG. 6), the sealing element **110**, the reservoir port receptacle **108**, etc. The different states may also be specified with respect to the coupling status of the durable housing **102** relative to the base plate **104**. In this regard, one state may be defined as the “separated” or “disconnected” or “disengaged” state where the durable housing **102** and the base plate **104** are separated from each other (or are otherwise decoupled) such that the fluid delivery port **114** is fully disengaged from the sealing element **110**. FIG. 4 depicts the base plate **104** in its disconnected state. Another state may be defined as the “connected” or “engaged” state where the durable housing **102** and the base plate **104** are fully coupled together, as depicted in FIG. 1. This description assumes that the fluid reservoir **106** is properly located and installed within the durable housing **102** (see FIG. 2). Consequently, when the fluid infusion device **100** is

in the connected state, the fluid delivery port 114 is received within the reservoir port receptacle 108, and the interior 116 of the fluid delivery port 114 engages the sealing element 110. FIG. 12 is a longitudinal cross-sectional view that schematically depicts the connected state of the fluid infusion device 100. In contrast, FIG. 5 shows the fluid infusion device 100 in an intermediate state where the durable housing 102 and the base plate 104 have been introduced to one another and oriented for coupling together. In this intermediate state, the fluid delivery port 114 has partially engaged the reservoir port receptacle 108, but the sealing element 110 has not yet been retracted over the hollow fluid delivery needle 134.

[0103] The sealing element 110 has a nominal state, which is depicted in FIGS. 4-11, and a retracted state, which is depicted in FIG. 12. The sealing element 110 naturally assumes its nominal state when the fluid infusion device 100 is in the disconnected state, and when the fluid infusion device 100 is in the intermediate state described above. When in the nominal state, the tip of the hollow fluid delivery needle 134 resides within the needle cavity 155 (see FIG. 5). In other words, the sealing element 110 encloses the hollow fluid delivery needle 134 when the sealing element 110 is in the nominal state. Consequently, the self-sealing slit 160 is free to return to its natural position to form a fluid seal for the needle cavity 155. Thus, when the sealing element 110 is in the nominal state, the self-sealing slit 160 inhibits fluid ingress into the needle cavity, which is desirable to prevent or minimize contamination of the hollow fluid delivery needle 134.

[0104] In contrast, the sealing element 110 is urged into its retracted state when the fluid infusion device 100 is in the connected state. The transition from the intermediate state to the connected state is associated with the application of longitudinal force (imparted by the fluid delivery port 114) to the tip section 152 of the sealing element 110. The longitudinal force is imparted to the tip section 152 when the durable housing 102 is coupled to the base plate 104—the action of coupling the durable housing 102 to the base plate 104 causes the fluid delivery port 114 to move toward the mounting cap 132, which in turn reduces the distance between the interior 116 of the fluid delivery port 114 and the mounting cap 132. In response to this reduction in distance, the sealing element 110 is deformed and crushed such that it retracts over the hollow fluid delivery needle 134. Notably, the internal relief features 164 promote the deformation and retraction of the sealing element 110 over the hollow fluid delivery needle 134 in response to force applied to the tip section 152, which is caused by forward movement of the fluid reservoir 106. Retraction of the sealing element 110 causes the tip 172 of the hollow fluid delivery needle 134 to be led through the guide channel 162 and into the self-sealing slit 160, such that the tip 172 protrudes from the tip section 152 (see FIG. 12) and such that an end section 173 of the hollow fluid delivery needle 134 resides in the self-sealing slit 160. Thus, when the removable fluid reservoir 106 is installed on the hollow fluid delivery needle 134, the tip 172 extends from the tip section 152 of the sealing element 110 and into the fluid reservoir 106.

[0105] The sealing element 110 interacts with the fluid delivery port 114 to establish a fluid seal. Referring to FIG. 11 and FIG. 12, the retractable body section 154 of the sealing element 110 has an exterior surface 174. When the sealing element 110 is in its nominal state (FIGS. 4-11), the exterior surface 174 is “relaxed” and it resembles a smooth cylindrical surface. Due to the deformable characteristics of the sealing element 110, however, the exterior surface 174 moves out-

ward when the sealing element 110 is retracting over the hollow fluid delivery needle 134, especially when the hollow fluid delivery needle 134 protrudes from the tip section 152 and displaces the seal material. This outward movement of the exterior surface 174 corresponds to an outward expansion of the retractable body section 154. The retractable body section 154 continues to expand in this manner until it abuts the interior 116 of the fluid delivery port 114, as depicted in FIG. 12. Thus, as the tip section 152 engages the fluid delivery port 114, the sealing element 110 creates an initial seal with the fluid delivery port 114. In addition, the retractable body section 154 expands to form a radial seal with the interior 116 when the fluid reservoir 106 engages the sealing element 110 and the hollow fluid delivery needle 134. The tip section 152 of the sealing element 110 also abuts the interior 116 of the fluid delivery port 114, which enhances the fluid seal.

[0106] The internal relief features 164 facilitate compression of the sealing element 110 into the retracted state shown in FIG. 12. The internal relief features 164 also provide resiliency to enable the sealing element 110 to regain its nominal shape when the durable housing 102 is removed and, consequently, the fluid delivery port 114 is disengaged from the sealing element 110 and the hollow fluid delivery needle 134. In other words, the sealing element 110 automatically and naturally springs back into its nominal position, and extends over and covers the hollow fluid delivery needle 134, when the fluid infusion device 100 transitions from the connected state to the disconnected state. For this reason, the internal relief features 164 are preferably designed, arranged, and configured to provide spring-like characteristics to the sealing element 110.

[0107] FIGS. 13-16 depict sealing elements configured in accordance with three alternate embodiments. Any of these alternative embodiments could be utilized in lieu of the sealing element 110 described above. These alternate embodiments share many features, characteristics, and functions with the sealing element 110. For the sake of brevity, common aspects of these sealing elements will not be described in detail here.

[0108] FIG. 13 is a perspective view of an alternate embodiment of a sealing element 200, which may be suitable for use in lieu of the sealing element 110. The sealing element 200 shares many features and characteristics with the sealing element 110 and, indeed, the internal structures of the sealing elements 110, 200 may be similar or identical. For example, the sealing element 200 also includes a self-sealing slit 201 to accommodate a needle. The sealing element 200 employs a gradually tapered retractable body section 202 that transitions smoothly and continuously with a tip section 204. In contrast, the sealing element 110 employs a barbed tip section 152.

[0109] FIG. 14 is a phantom side view that depicts a portion of an alternate embodiment of a sealing element 300. The sealing element 300 includes a relatively straight and smooth cylindrical retractable body section 302 that transitions to a tip section 304. In contrast to the embodiments described previously, the sealing element 300 also includes a circumferential compression element 306 coupled around the tip section 304. The circumferential compression element 306 is suitably designed, shaped, and sized to impart an inward biasing force to a self-sealing slit 308 formed in the tip section 304. Consequently, when the sealing element 300 is in its natural and nominal state (as depicted in FIG. 14), the circumferential compression element 306 urges the self-sealing slit 308 closed to enhance the seal for the needle cavity 310.

[0110] In certain embodiments, the circumferential compression element 306 is realized as a physically distinct and separate component that is attached to the material that forms the bulk of the sealing element 300. For example, the circumferential compression element 306 could be affixed to the tip section 304 using an adhesive, a bonding agent, or the like. Alternatively, the circumferential compression element 306 could be coupled to the tip section 304 by way of a compression fit and/or by way of structural features that secure the circumferential compression element 306 to the tip section 304 (e.g., keyway features, tabs, ridges, or the like). In accordance with one exemplary embodiment, the circumferential compression element 306 is realized as a resilient band that resists deformation more than the material that forms the tip section 304.

[0111] FIG. 15 is a phantom perspective view that depicts a portion of another alternate embodiment of a sealing element 400. The sealing element 400 is similar to the sealing element 300 in that it also includes a circumferential compression element 406. For this embodiment, however, the circumferential compression element 406 is realized as a rigid ring that encircles most if not all of the tip section 404. In accordance with one exemplary embodiment, the circumferential compression element 406 is realized as a metal compression ring that can be installed over the tip section 404 by bending or deforming it to achieve the desired amount of compression.

[0112] FIG. 16 is a phantom side view that depicts a portion of yet another alternate embodiment of a sealing element 500. The sealing element 500 includes a tip section 504 having a different shape and profile (relative to the embodiments described previously). The shape of the tip section 504 is similar to the shape of the tip section 152 in that it is wider than the retractable body section 502. This wide tip section 504 is desirable to establish a good fluid seal with the fluid reservoir. Moreover, the additional material that is used to form the wide tip section 504 serves to enhance the integrity of the self-sealing slit 508.

[0113] It should be appreciated that the specific features and characteristics shown and described above for the various exemplary embodiments are neither exclusive nor required for any given embodiment. For example, any of the exemplary sealing elements described above could be provided with or without a circumferential compression element for the tip section. As another example, the specific shape and configuration of the tip section may vary from one embodiment to another. Thus, the individual features and elements shown and described may be implemented and deployed in an embodiment of a fluid infusion device as desired to suit the needs of the particular application.

[0114] Vented Fluid Reservoirs

[0115] An open or vented fluid reservoir may be utilized to reduce or eliminate excess pressure that might otherwise be introduced into the fluid chamber of the reservoir during a filling operation. In this regard, a vented fluid reservoir allows the pressure to equalize before the reservoir is coupled to the fluid infusion device and, therefore, reduces or eliminates the likelihood of unintended fluid delivery. To this end, one embodiment described here includes a vented port or funnel to relieve the pressure in the reservoir. Another embodiment described below employs a movable septum that functions as a pressure relief valve for the fluid reservoir.

[0116] FIG. 17 depicts a schematic side view representation of a vented fluid reservoir 600, and FIG. 18 is a top view of an exemplary embodiment of the vented fluid reservoir

600. For ease of understanding and illustration, FIG. 17 depicts some structure in cross section and some structure in phantom. The fluid reservoir 600 may be utilized with the fluid infusion device 100 (or a slightly modified version thereof) described above with reference to FIGS. 1-6. Accordingly, common features, structures, elements, and functionality will not be redundantly described here in the context of the fluid reservoir 600.

[0117] Referring to FIG. 17, the fluid reservoir 600 may cooperate with a fluid infusion device (not shown) having a hollow fluid delivery needle 602 and a sealing element 604 overlying at least a portion of the hollow fluid delivery needle 602. The sealing element 604 may exhibit any of the features, structures, or elements described above, as appropriate for the particular embodiment. As described above for the previous embodiments, the sealing element 604 may terminate at a tip section 606 through which a tip 608 of the hollow fluid delivery needle penetrates when the fluid reservoir 600 is engaged with the hollow fluid delivery needle 602 and with the sealing element 604 (see, for example, FIG. 12). For this particular embodiment, the tip section 606 is barbed or mushroom shaped such that it has a tapered convex exterior surface 610.

[0118] The fluid reservoir 600 generally includes, without limitation: a main body section 620; a filling port 621; a fluid delivery port 622; a funnel element 623; and a septum 624. The main body section defines a fluid chamber 626 for the medication fluid that is to be delivered by the fluid infusion device. The filling port 621 is in fluid communication with the fluid chamber 626 to accommodate filling of the fluid chamber 626 with the desired medication fluid (using a syringe or fill needle, as is well understood). The fluid delivery port 622 is coupled to, and extends from, the main body section 620. The fluid delivery port 622 is in fluid communication with the fluid chamber 626 to provide a fluid flow path from inside the fluid chamber 626 to the hollow fluid delivery needle 602 (this fluid flow path is established and maintained when the fluid reservoir 600 is engaged with the base plate of the fluid infusion device).

[0119] The funnel element 623 is coupled within the fluid delivery port 622. In certain embodiments, the main body section 620 and the fluid delivery port 622 are formed from a first material (such as plastic) and the funnel element 623 is formed from a second material (such as metal). The funnel element 623 may be implemented as an insert that can be seated within and coupled to the fluid delivery port 622 in any suitable manner such that the funnel element 623 remains in a fixed position. Notably, the funnel element 623 includes a tapered, conical, or convex interior surface 628. This interior surface 628 represents one surface of the receptacle that is defined by the funnel element 623. As schematically illustrated in FIG. 17, the funnel element 623 is shaped, sized, and configured in accordance with the sealing element 604. This enables the interior surface 628 of the funnel element 623 and the exterior surface 610 of the sealing element 604 to mate with one another and cooperate to form a fluid tight seal when they are forced together.

[0120] The septum 624 is located and held in place in the funnel element 623. The septum 624 may be formed from a soft, resilient, and pliable material that has certain self-sealing or self-restoring properties. For example, the septum 624 may be formed from a silicone rubber material in certain embodiments. Depending upon the embodiment, the septum 624 may be provided in a solid and continuous form, or it may

be provided with a slit, a cut, or an equivalent feature that makes it easier to pierce while still maintaining at least a nominal seal. The septum 624 has a nominal non-pierced state (depicted in FIG. 17) where the needle does not protrude through the septum 624. In the non-pierced state, the septum 624 forms a fluid seal within a fluid conduit 630 defined by the fluid reservoir 600. Thus, the medication fluid inside the fluid chamber 626 cannot flow within the fluid conduit 630 when the fluid reservoir 600 is in the disengaged state shown in FIG. 17. However, when the fluid reservoir 600 is properly engaged with the hollow fluid delivery needle 602 and with the sealing element 604, the tip 608 of the hollow fluid delivery needle 602 penetrates the septum 624 to create a fluid flow path from the fluid chamber 626 through the septum 624. Accordingly, the hollow fluid delivery needle 602 pierces the septum 624 to facilitate delivery of the medication fluid from the fluid chamber to the hollow fluid delivery needle 602.

[0121] In various embodiments, the fluid delivery port 622 and/or the funnel element 623 include a pressure vent formed therein. The pressure vent may take any suitable form or arrangement. For example, the pressure vent may be realized with one or more vent holes. As another example, the pressure vent may be realized with one or more slits or any other opening formed within the funnel element 623. The exemplary embodiments shown in FIG. 17 and FIG. 18 employ small diameter vent holes 640 formed in the funnel element 623. As shown in FIG. 18, the vent holes 640 may be arranged around the perimeter of the fluid delivery port and/or around the perimeter of the funnel element 623. As depicted in FIG. 17, the vent holes 640 may be located around the outer perimeter of the septum 624. Thus, the vent holes 640 create venting conduits that pass around the septum 624 and pass around the fluid conduit 630. In practice, the vent holes 640 are sized to minimize leakage of the medication fluid caused by gravity or handling of the fluid reservoir 600. Of course, if the fluid chamber 626 is highly pressurized, then some medication fluid may be forced out of the vent holes 640 while the fluid chamber 626 equalizes.

[0122] Each vent hole 640 provides a venting conduit from inside the fluid chamber 626 to outside the fluid chamber 626. More specifically, each vent hole 640 is realized as a fluid conduit that communicates at one end with the fluid chamber 626 and at the other end with the interior surface 628 of the funnel element 623. Thus, each vent hole 640 terminates at the interior surface 628. When the fluid reservoir 600 is disengaged from the fluid infusion device, the vent holes 640 may be visible from the top of the fluid reservoir 600, as shown in FIG. 18.

[0123] In operation, the fluid delivery port 622 and the funnel element 623 engage and cooperate with the sealing element 604 and with the hollow fluid delivery needle 602 in the manner generally described above with reference to the fluid infusion device 100. When the fluid delivery port 622 is installed and pressed over the sealing element 604, the tip section 606 of the sealing element 604 is urged against the contoured interior surface 628 of the funnel element 623. This action causes the exterior surface 610 of the sealing element 604 to contact and mate with the interior surface 628 of the funnel element 623. In turn, the tip section 606 (which may deform or expand in response to the coupling) covers and seals the vent holes 640. As mentioned previously, the tip 608 of the hollow fluid delivery needle pierces the septum 624 when the fluid reservoir 600 is introduced. In certain embodiments, the fluid delivery port 622, the funnel element 623, the

sealing element 604, and the hollow fluid delivery needle 602 are cooperatively configured such that the tip section 606 of the sealing element 604 seals the vent holes 640 before the hollow fluid delivery needle 602 pierces the septum 624. This reduces or eliminates leakage of the medication fluid. The vent holes 640 remain sealed in this manner during operation of the fluid infusion device, such that the medication fluid is forced from the fluid chamber 626 and through the hollow fluid delivery needle 602 in the intended manner.

[0124] Another embodiment of a vented fluid reservoir will now be described with reference to FIG. 19 and FIG. 20. FIG. 19 is a phantom side view of a fluid reservoir 700 in an open or vented state, and FIG. 20 is a phantom side view of the fluid reservoir 700 in a sealed state. It should be appreciated that the fluid reservoir 700 may be utilized with the fluid infusion device 100 (or a slightly modified version thereof) described above with reference to FIGS. 1-6. Accordingly, common features, structures, elements, and functionality will not be redundantly described here in the context of the fluid reservoir 700.

[0125] The illustrated embodiment of the fluid reservoir 700 generally includes, without limitation: a main body section 702; a fluid delivery port 704; a valve sleeve 706; and a septum 708. The main body section 702 includes a fluid chamber 710 defined therein. The fluid chamber 710 accommodates the medication fluid to be delivered to the patient. The fluid delivery port 704 is coupled to and extends from the main body section 702. In certain embodiments, the fluid delivery port 704 is integrally formed with the main body section 702. For example, the fluid delivery port 704 and the main body section 702 may be fabricated from a molded plastic material. The fluid delivery port 704 includes or defines a fluid conduit 712 that communicates with the fluid chamber 710.

[0126] This particular embodiment of the fluid delivery port 704 has a generally cylindrical shape that resembles a neck region extending from the main body section 702. The fluid delivery port 704 terminates at a port opening 714. The port opening 714 is realized as a round rim or lip at the end of the fluid delivery port 704. As shown in FIG. 19 and FIG. 20, the perimeter edge of the fluid delivery port 704 may be beveled or "pointed" if so desired (beveling in this manner may be desirable for purposes of creating a good seal with the septum 708).

[0127] Although not always required, the illustrated embodiment of the fluid delivery port 704 includes a circumferential groove 716 formed therein (around the outer surface). The groove 716 may be defined as a region between a shoulder 718 of the main body section 702 and a barb portion 720 of the fluid delivery port 704. For this embodiment, the barb portion 720 is located at or near the port opening 714. In alternative embodiments, the groove 716 could be positioned anywhere along the length of the fluid delivery port 704. The groove 716 receives an interior ridge 724 of the valve sleeve 706, which is formed within an attachment receptacle of the valve sleeve 706. This attachment receptacle is generally defined by the interior region below the septum 708 in FIG. 19 and FIG. 20. The attachment receptacle is shaped, sized, and otherwise configured to receive the fluid delivery port 704 as shown in the figures. The interior ridge 724 may be implemented as a continuous protrusion positioned within the attachment receptacle such that it completely encircles the fluid delivery port 704. The dimensions of the interior ridge 724 and the groove 716 are selected such that the valve sleeve

706 can be “snapped” into place and retained on the fluid delivery port **704** in a manner that accommodates translational movement of the valve sleeve **706** relative to the fluid delivery port **704**.

[0128] Notably, the groove **716** allows the valve sleeve **706** to move toward the fluid chamber **710** until movement is inhibited by the shoulder **718** and/or by other structure of the fluid reservoir **700**, or until movement is inhibited by engagement between the septum **708** and the port opening **714** (see FIG. 20). Similarly, the groove **716** allows the valve sleeve **706** to move away from the fluid chamber **710** until movement of the interior ridge **724** is inhibited by the barb portion **720** of the fluid delivery port **704** (see FIG. 19). Thus, the valve sleeve **706** is movably coupled to the fluid delivery port **704**, and the attachment receptacle of the valve sleeve **706** is sized to accommodate translation of the valve sleeve **706** relative to the fluid delivery port **704** and, more particularly, relative to the port opening **714**.

[0129] The septum **708** is located within a septum receptacle **728** defined within the valve sleeve **706**. The septum receptacle **728** may be realized as an interior groove or channel formed in the inner wall of the valve sleeve **706**. In the illustrated embodiment, the septum receptacle **728** is adjacent to the attachment receptacle, such that one surface of the septum **708** (i.e., the lower surface in FIG. 19 and FIG. 20) defines a boundary of the attachment receptacle. The septum receptacle **728** receives and holds the septum **708** in a fixed position relative to the valve sleeve **706**. In other words, the septum receptacle **728** maintains the septum **708** in place such that the septum **708** translates in concert with the valve sleeve **706**. In this regard, the septum **708** is movably coupled to the fluid delivery port **704** by way of the valve sleeve **706**.

[0130] The valve sleeve **706** also includes a sleeve opening **730** that is adjacent to the septum receptacle **728**. The sleeve opening **730** is arranged such that at least a portion of the septum **708** is accessible via the sleeve opening **730**. As shown in FIG. 19 and FIG. 20, the upper surface of the septum **708** is exposed in the sleeve opening **730**. The sleeve opening **730** allows a hollow fluid delivery needle of the fluid infusion device to pierce or otherwise pass through the septum **708** to gain entry to the fluid conduit **712**.

[0131] The valve sleeve **706** and the septum **708** are movable between a sealed position (shown in FIG. 20) and an open or vented position (shown in FIG. 19). The sealed position is achieved when the fluid reservoir **700** is engaged with the fluid delivery needle of the fluid infusion device. More specifically, the septum **708** and the valve sleeve **706** are urged into the sealed position when the fluid delivery needle is forced against and through the septum **708**. Additionally or alternatively, the septum **708** could be urged into the sealed position when the valve sleeve **706** abuts structure of the base plate. When in the sealed position, the surface of the septum **708** contacts the port opening **714** to form a circumferential seal around the port opening **714**. This seal inhibits fluid flow between the fluid delivery port **704** and the septum **708** during a delivery cycle (which is intended to force the medication fluid through the delivery needle). For simplicity, the needle and its associated base plate mounting structure are not shown in FIG. 20.

[0132] When the fluid reservoir **700** is removed from the fluid infusion device and, therefore, is disengaged from the fluid delivery needle, the valve sleeve **706** and the septum **708** are free to move relative to the fluid delivery port **704**. Accordingly, the valve sleeve **706** and the septum **708** are free to

move into the vented position in response to a pressure differential condition where pressure in the fluid chamber **710** exceeds the ambient pressure. Under these conditions, the excess pressure inside the fluid chamber **710** can be released through the port opening **714** because the valve sleeve **706** and the septum **708** function as a pressure relief valve. When subjected to excess pressure in this manner, the septum **708** moves slightly upward, which creates a gap between the bottom surface of the septum **708** and the port opening **714**. Consequently, the septum **708** permits fluid to flow out of the fluid delivery port **704** via the port opening **714** when the valve sleeve **706** is in the vented position. After the pressure is equalized, however, the valve sleeve **706** and the septum **708** might naturally return to the sealed position shown in FIG. 20, especially if the fluid reservoir **700** is held in the depicted orientation (where the force of gravity may cause the valve sleeve **706** to fall into the sealed position).

[0133] Needleless Fluid Reservoir Interface

[0134] The embodiments described above utilize a hollow needle that engages the fluid reservoir during operation of the fluid infusion device. An alternative needleless implementation will now be described with reference to FIG. 21 and FIG. 22. FIG. 21 is a longitudinal cross-sectional view of a fluid reservoir **800** and a self-sealing reservoir port receptacle **802** suitable for use with a fluid infusion device, and FIG. 22 is an end view of the fluid reservoir **800** as viewed from the perspective of line 22-22 in FIG. 21. The fluid reservoir **800** and the self-sealing reservoir port receptacle **802** may be utilized with the fluid infusion device **100** (or a slightly modified version thereof) described above with reference to FIGS. 1-6. Accordingly, common features, structures, elements, and functionality will not be redundantly described here in the context of the fluid reservoir **800** and the self-sealing reservoir port receptacle **802**.

[0135] The fluid reservoir **800** may be intended to be a user-filled or refillable unit, or it could be designed to be a disposable pre-filled unit, depending upon the particular application. The fluid reservoir **800** includes a main body section **804** that defines an interior fluid chamber **806** for holding the desired fluid, e.g., a medication fluid such as insulin. The fluid reservoir **800** also includes a fluid delivery port **808** that is coupled to, and extends from, the main body section **804**. The fluid delivery port **808** includes or otherwise defines a fluid conduit **810** that communicates with the fluid chamber **806**. The fluid conduit **810** is used to deliver the fluid from the fluid chamber **806**. In certain embodiments, the fluid conduit **810** may also be used as the fill port of the fluid reservoir **800**.

[0136] Notably, the fluid reservoir **800** is “unsealed” in that the fluid delivery port **808** terminates at an unsealed port opening **812**. In this regard, the fluid delivery port **808** does not include a septum or any equivalent form of fluid seal that remains in place during use of the fluid infusion device. That said, the fluid reservoir **800** could be manufactured and provided with a protective seal or film that is removed prior to use. For instance, a prefilled version of the fluid reservoir **800** may include a temporary cover, lid, or cap that can be removed prior to use. In the context of a user-filled unit, the unsealed nature of the fluid reservoir **800** allows the fluid chamber **806** to be filled in a manner that inherently equalizes the pressure. Consequently, the fluid chamber **806** will not be over-pressurized when the fluid reservoir **800** is introduced to the fluid infusion device.

[0137] The fluid delivery port **808** and the port opening **812** are shaped and sized in accordance with the dimensions of the self-sealing reservoir port receptacle **802**. More specifically, the fluid delivery port **808** and the port opening **812** are shaped and dimensioned to facilitate mating and engagement with the self-sealing reservoir port receptacle **802**. In this regard, the fluid delivery port **808** is inserted into the self-sealing reservoir port receptacle **802** to enable the fluid reservoir **800** to provide the medication fluid to the body of the patient via the self-sealing reservoir port receptacle **802**.

[0138] In certain embodiments, the port opening **812** includes at least one flow path **814** (see FIG. 22) that allows the medication fluid to flow from the fluid conduit **810** and into the self-sealing reservoir port receptacle **802** when the fluid reservoir **800** is engaged with and coupled to the self-sealing reservoir port receptacle **802**. The illustrated embodiment employs five channels formed in the exposed rim **816** of the fluid delivery port **808**. The fluid is able to flow through these channels during a delivery cycle of the fluid infusion device (as described in more detail below). In alternative embodiments, the at least one flow path **814** may be realized as through holes, slits, or any suitably configured conduit to pass the medication fluid. Moreover, the port opening **812** could be shaped (e.g., to resemble a crown) in any desired way to enable the medication fluid to flow from the fluid conduit **810** during use.

[0139] In various embodiments, the self-sealing reservoir port receptacle **802** is coupled to, provided with, or incorporated into a base plate of the fluid infusion device (see, for example, a similar arrangement depicted in FIG. 1 and FIG. 3). As mentioned previously, the fluid infusion device may include a suitable delivery conduit, such as the cannula **112** shown in FIG. 1, wherein the delivery conduit provides the medication fluid to the body. Accordingly, the self-sealing reservoir port receptacle **802** may be located on the base plate to establish a flow path for the medication fluid from the fluid reservoir **800** to the delivery conduit.

[0140] The illustrated embodiment of the self-sealing reservoir port receptacle **802** is implemented as a needleless component. In other words, a delivery needle is not utilized with either the self-sealing reservoir port receptacle **802** or the fluid reservoir **800**. Rather, the self-sealing reservoir port receptacle **802** incorporates a biased valve element **830** that is nominally closed in its natural state, but is opened in response to engagement of the fluid reservoir **800**. Referring to FIG. 21, the exemplary embodiment of the self-sealing reservoir port receptacle **802** generally includes, without limitation: an inlet **832**; a valve chamber **834** for the valve element **830**; and an outlet **836**. For this particular embodiment, the inlet **832**, the valve chamber **834**, and the outlet **836** are joined together to define a continuous hollow interior pathway.

[0141] The inlet **832** is suitably configured, shaped, and sized to receive the fluid delivery port **808** of the fluid reservoir **800**. For this embodiment, the inlet **832** includes an interior **838** that is sized to receive the fluid delivery port **808**. In alternative embodiments, the inlet **832** may be sized to fit inside the fluid conduit **810**. The inlet **832** may also include or cooperate with a sealing element **840** that forms a seal with the outer surface of the fluid delivery port **808** when the fluid delivery port **808** is engaged with the inlet **832**. In various embodiments, the sealing element **840** is realized as a resilient gasket, o-ring, washer, or the like. Moreover, although the depicted embodiment has the sealing element **840** incorporated into the inlet **832**, the sealing element **840** may alter-

natively (or additionally) be incorporated into the fluid delivery port **808**. When the fluid delivery port **808** is engaged with the inlet **832**, the sealing element **840** inhibits leakage of fluid from the port opening **812** and from the valve chamber **834**.

[0142] The valve chamber **834** is in fluid communication with the inlet **832**. For this particular embodiment, the downstream end of the inlet **832** corresponds to the upstream end of the valve chamber **834**, as shown in FIG. 21. The valve chamber **834** is shaped, sized, and otherwise configured to retain the valve element **830** while allowing the valve element **830** to translate in the upstream and downstream directions within the valve chamber **834**. The upstream end of the valve chamber **834** may include a retaining shoulder **844** formed therein. The retaining shoulder **844** may be defined as the transition from a relatively small inner dimension corresponding to the inlet **832** to a relatively large inner dimension corresponding to the valve chamber **834**. In other words, the retaining shoulder **844** represents a neck region that prevents the valve element **830** from completely entering the inlet **832**.

[0143] The self-sealing reservoir port receptacle **802** also includes a resilient compression element **846** located in the valve chamber **834**. The resilient compression element **846** can be positioned between the valve element **830** and the downstream end of the valve chamber **834**. The resilient compression element **846** is sized and configured to bias the valve element **830** toward the inlet **832** (as shown in FIG. 21). In other words, the resilient compression element **846** naturally urges the valve element **830** against the retaining shoulder **844** and into a sealed position to form a fluid seal between the valve element **830** and the inlet **832**. In certain embodiments, the resilient compression element **846** is realized as a spring. Alternatively, the resilient compression element **846** could be realized as a compressible plug, an accordion-like member, or the like.

[0144] The valve element **830** may be shaped and sized as appropriate for the particular embodiment. FIG. 21 depicts one exemplary embodiment where the valve element **830** is realized as a ball valve, i.e., the valve element **830** includes a spherical component. Thus, the valve chamber **834** may be fabricated as a cylindrical cavity to accommodate the round profile of the valve element **830**. Alternatively, the valve element **830** could be realized as a cylindrical plug. Various shapes and configurations could be utilized for the valve element **830**, and the ball valve implementation is merely one suitable embodiment.

[0145] The downstream end of the valve chamber **834** is in fluid communication with the outlet **836** such that medication fluid can pass through the valve chamber **834** and into the outlet **836**. The outlet **836** provides a fluid flow path **848** for the medication fluid. In this regard, the fluid flow path **848** may be routed through the base plate and/or through other structure of the fluid infusion device, and to the delivery conduit that leads to the body of the user, as described previously. In other words, the outlet **836** can be positioned between the valve chamber **834** and the delivery conduit.

[0146] FIG. 21 shows the self-sealing reservoir port receptacle **802** in its sealed position. The sealed state is automatically assumed in the absence of the fluid reservoir **800**. In other words, when the fluid delivery port **808** is disengaged from the inlet **832** of the self-sealing reservoir port receptacle **802**, the resilient compression element **846** forces the valve element **830** toward the inlet **832** and against the retaining shoulder **844**, which in turn forms a fluid seal between the valve element **830** and the inlet **832**. This seal is desirable to

prevent backflow leakage of the medication fluid and to reduce the likelihood of contamination of the fluid path.

[0147] Engagement of the fluid delivery port **808** with the inlet **832** causes the end of the fluid delivery port **808** to contact the valve element **830**. Further engagement and complete coupling of the fluid delivery port **808** within the inlet **832** causes the end of the fluid delivery port **808** to move the valve element **830** from the sealed position (shown in FIG. **21**) to an opened position. In the opened position, the valve element **830** is forced in the downstream direction toward the outlet **836**. As a result of this movement, the resilient compression element **846** becomes compressed and compacted within the valve chamber **834**. Retraction of the valve element **830** in this manner also enables the fluid delivery port **808** to gain access to the valve chamber **834**, which in turn accommodates flow of the medication fluid from the fluid reservoir **800** and into the valve chamber **834**. Referring again to FIG. **22**, the at least one flow path **814** in the exposed rim **816** ensures that the medication fluid can flow into the valve chamber **834** (even though the end of the fluid delivery port **808** is in contact with the valve element **830**).

[0148] Needled Fluid Reservoir for a Fluid Infusion Device
 [0149] Most of the embodiments described previously employ a hollow fluid delivery needle that is provided with a base plate of a fluid infusion device (see, for example, FIGS. **1-5**). The needle in such embodiments cooperates with a sealed or an open fluid reservoir, wherein the needle is introduced into the fluid chamber of the fluid reservoir to accommodate delivery of the medication fluid from the fluid chamber, through the needle, and to the body of the patient.

[0150] Alternatively, the embodiments presented in this section utilize a needled fluid reservoir, i.e., a fluid reservoir having a hollow fluid delivery needle incorporated therein. The hollow needle engages a suitably configured reservoir port receptacle, which may be located on the base plate of the fluid infusion device. The reservoir port receptacle includes a fluid conduit that is used to deliver the medication fluid to the body of the patient. In certain embodiments, the reservoir needle is unsealed and, therefore, open to ambient pressure. Accordingly, the fluid infusion device includes an appropriate sealing arrangement to establish a fluid seal with the hollow needle when the fluid reservoir is engaged with the reservoir port receptacle.

[0151] FIGS. **23-29** relate to a first embodiment of a needled fluid reservoir **900** that is suitable for use with a compatible fluid infusion device. FIG. **23** is a perspective view of the fluid reservoir **900**, and FIG. **24** is a cross-sectional view of an end portion **902** of the fluid reservoir **900**. It should be appreciated that the fluid reservoir **900** could be utilized with a modified version of the fluid infusion device **100** described above with reference to FIGS. **1-6**. Accordingly, common features, structures, elements, and functionality will not be redundantly described here with reference to FIGS. **23-29**. Moreover, the fluid reservoir **900** shares a number of features and elements with some of the fluid reservoirs described previously. For the sake of brevity, such common features and elements will not be described in detail again in the context of the fluid reservoir **900**.

[0152] Referring to FIG. **23** and FIG. **24**, the fluid reservoir **900** includes a main body section **904** that defines an interior fluid chamber **906** for a fluid to be delivered, such as a medication fluid. The fluid reservoir **900** also includes a hollow needle **908** extending from the main body section **904** and defining a fluid conduit **910** (see FIG. **24**) that communicates

with the fluid chamber **906**. Although not always required, the illustrated embodiment of the hollow needle **908** is realized as a separate component that is physically coupled to the main body section **904** (and/or to a structural feature defined in the main body section **904**) in an appropriate manner to communicate with the fluid chamber **906**. In this regard, the hollow needle **908** and the main body section **904** in this particular embodiment are realized as two physically distinct and separate components that are assembled together into the configuration shown in the figures. For example, the main body section **904** could be fabricated from a molded plastic material, and the hollow needle **908** could be fabricated from a metal material, as appropriate to the specific embodiment. In practice, the hollow needle **908** is coupled to the main body section **904** in a way that prevents leakage of fluid between the main body section **904** and the outer surface of the hollow needle **908**.

[0153] As best shown in FIG. **24**, the hollow needle **908** terminates at a needle end **912** that forms or otherwise defines a blunt tip **914**. The blunt tip **914** may be flat (as shown), rounded, mushroom-shaped, or otherwise contoured in a way that does not result in a sharp or pointed needle end **912**. Moreover, the hollow needle **908** may be unsealed such that the fluid conduit **910** remains open to ambient or atmospheric pressure, which is desirable to enable the fluid reservoir **900** to equalize its internal pressure inside the fluid chamber **906** via the hollow needle **908**. The fluid conduit **910** is preferably sized to inhibit or prevent natural leakage of the fluid, while still accommodating the delivery of the medication fluid from the fluid chamber **906**. Moreover, for embodiments where the hollow needle **908** also serves as the fill needle, the fluid conduit **910** is sized to enable quick and easy filling of the fluid reservoir **900**. As described in more detail below, the blunt tip **914** is suitably sized, shaped, and configured to engage a sealing element of the fluid infusion device.

[0154] Various embodiments of the fluid reservoir **900** include a needle hood **916** that at least partially covers the hollow needle **908**. The needle hood **916** extends from the main body section **904** to at least partially surround the hollow needle **908**, while still providing access to the hollow needle **908** from the end, as best shown in FIG. **23**. As depicted in FIG. **24**, the illustrated embodiment of the needle hood **916** is integrated with the main body section **904**. Thus, the needle hood **916** can be molded together with the main body section **904** as a unitary component. The needle hood **916** terminates at a lip **918**. In certain embodiments, the lip **918** extends further from the main body section **904** than the needle end **912**. In other words, the blunt tip **914** of the hollow needle **908** does not protrude from the lip **918** (see FIG. **24**). This arrangement is desirable to protect the hollow needle **908** from damage and contamination. This arrangement also protects the user if the hollow needle **908** is provided with a sharp tip.

[0155] The fluid reservoir **900** may also include an alignment structure that mates with cooperating structure of the reservoir port receptacle of the fluid infusion device (see FIG. **25** and related description). Although not always required, at least a portion of the alignment structure may be integrally formed with the needle hood **916**. For example, the illustrated embodiment of the fluid reservoir **900** utilizes opposing guide rails **920** and a particular shape for the needle hood **916** (e.g., an inverted “U” shape when viewed from the perspective of FIG. **23**) that cooperate to provide the desired alignment

features. The guide rails **920** and the shape of the needle hood **916** have corresponding mating features on the reservoir port receptacle shown in FIG. 25.

[0156] FIG. 25 is a perspective view of a section **922** of a fluid infusion device, including a reservoir port receptacle **924** suitable for engagement with the fluid reservoir **900**. The section **922** may represent a portion of a base plate of the fluid infusion device (see FIGS. 3-6, which show the base plate **104** with a similarly configured section for the fluid infusion device **100**). FIG. 26 is a perspective view of a sealing and conduit component **926** suitable for use in the section **922** shown in FIG. 25, and FIG. 27 is a cross-sectional view of the section **922**, as viewed from the perspective of line 27-27 in FIG. 25.

[0157] The reservoir port receptacle **924** includes suitably designed mating structure **928** that is intended to engage and mate with the needle hood **916** and, more particularly, to engage with the alignment structure of the needle hood **916**. For this particular embodiment, the mating structure **928** is realized as two shoulders or channels that cooperate with the guide rails **920** when the fluid reservoir **900** is coupled to the reservoir port receptacle **924**. Moreover, the overall outer shape and contour of the reservoir port receptacle **924** can be shaped and sized to match the interior space defined by the needle hood **916**. These features cooperate to orient, align, and guide the needle hood **916** over the reservoir port receptacle **924**. Accordingly, the alignment structure of the fluid reservoir **900** cooperates with the mating structure **928** to align and orient the hollow needle **908** relative to the reservoir port receptacle **924**. This facilitates proper introduction and insertion of the hollow needle **908** into a sealing element **930** of the reservoir port receptacle **924**.

[0158] The sealing and conduit component **926** may be realized as an insert or a plug that is received within the section **922**, as shown in FIG. 27. The sealing element **930** may be coupled to or integrally formed with the sealing and conduit component **926**, as shown in FIG. 26 and FIG. 27. The embodiment of the sealing element **930** shown in FIG. 27 includes a self-sealing opening **932** to receive the hollow needle **908**. Notably, the self-sealing opening **932** is particularly suitable for use with the blunt tip **914**, which is not designed to pierce or puncture the sealing element **930**. Rather, the blunt tip **914** can pass through the self-sealing opening **932** when the fluid reservoir **900** is urged into the reservoir port receptacle **924** (as depicted in FIG. 29).

[0159] FIG. 28 is a cross-sectional and partially phantom view that illustrates the fluid reservoir **900** before engagement with the section **922** of the fluid infusion device, and FIG. 29 is a cross-sectional and partially phantom view that illustrates the fluid reservoir **900** after engagement with the section **922**. In FIG. 28, the needle end **912** has not yet contacted the sealing element **930**. Accordingly, the self-sealing opening **932** exhibits a sealed or compressed state to prevent fluid ingress into an outlet conduit **934** of the reservoir port receptacle **924**. In FIG. 29, however, engagement of the fluid reservoir **900** with the reservoir port receptacle **924** causes the blunt tip **914** to penetrate the self-sealing opening **932** such that the needle end **912** resides within the outlet conduit **934**. Accordingly, fluid communication is established from the fluid chamber **906** to the outlet conduit **934**, via the hollow needle **908**. In this state, the sealing element **930** forms a seal around the exterior surface of the hollow needle **908** to inhibit fluid leakage from the outlet conduit **934**.

[0160] As shown in FIGS. 27-29, the outlet conduit **934** may be at least partially defined by the sealing element **930**. For this particular embodiment, the outlet conduit **934** is integrally formed within the sealing and conduit component **926** to provide a fluid flow path from the self-sealing opening **932**, across a span of the section **922** (see FIG. 27) and into a fluid chamber **936** defined in the base plate. The fluid chamber **936** may be fluidly coupled to a delivery conduit such as a cannula (see FIG. 1, which shows the cannula **112** for the fluid infusion device **100**) for purposes of fluid delivery to the body of the patient. Thus, the sealing and conduit component **926** may be employed instead of a "J" shaped hollow needle as described above with reference to FIG. 6.

[0161] It should be appreciated that the needle hood **916** and/or the alignment structure of the fluid reservoir **900** may also be designed to mate and cooperate with corresponding structure of a reservoir filling apparatus. In this regard, the alignment structure could also serve to align and orient the hollow needle **908** relative to the reservoir filling apparatus to facilitate insertion of the hollow needle **908** into a sealing element or entry port of the reservoir filling apparatus. This dual-purpose nature of the needle hood **916** and alignment structure may be desirable for embodiments of the fluid reservoir **900** that use the same hollow needle **908** for both filling and delivery of the medication fluid.

[0162] FIGS. 30-33 relate to a second embodiment of a needled fluid reservoir **940** that is suitable for use with a compatible fluid infusion device. The fluid reservoir **940** and the related features of the fluid infusion device are similar in many respects to that described above for the fluid reservoir **900**. Accordingly, for the sake of brevity and clarity, the following description referring to FIGS. 30-33 is abbreviated in nature.

[0163] The fluid reservoir **940** is very similar to the fluid reservoir **900**, except for its use of a hollow needle **942** terminating at a sharp tip **944** (rather than a blunt or rounded tip). Likewise, the sealing and conduit component **946** shown in FIG. 31 is substantially identical to the sealing and conduit component **926** described above. Notably, however, the sealing and conduit component **946** includes a pierceable sealing element **948** (rather than a self-sealing element having a predefined slit, hole, or slot formed therein) that is suitably configured to accommodate the sharp tip **944**. Thus, the sharp tip **944** pierces the sealing element **948** when the fluid reservoir **940** is coupled to the reservoir port receptacle **950**.

[0164] FIG. 32 is a cross-sectional and partially phantom view that illustrates the fluid reservoir **940** before engagement with the reservoir port receptacle **950**, and FIG. 33 is a cross-sectional and partially phantom view that illustrates the fluid reservoir **940** after engagement with the reservoir port receptacle **950**. In FIG. 32, the hollow needle **942** has not yet contacted the sealing element **948**, which remains solid and intact. In FIG. 33, however, engagement of the fluid reservoir **940** with the reservoir port receptacle **950** causes the sharp tip **944** to pierce the sealing element **948** such that the end of the hollow needle **942** resides within the outlet conduit **952**. Accordingly, fluid communication is established from the fluid chamber **954** of the fluid reservoir **940** to the outlet conduit **952**, via the hollow needle **942**. In the state depicted in FIG. 33, the sealing element **948** forms a seal around the exterior surface of the hollow needle **942** to inhibit fluid leakage from the outlet conduit **952**.

[0165] FIGS. 34-39 relate to a third embodiment of a needled fluid reservoir **960** that is suitable for use with a

compatible fluid infusion device. The fluid reservoir **960** and the related features of the fluid infusion device are similar in many respects to that described above for the fluid reservoir **900**. Accordingly, for the sake of brevity and clarity, the following description referring to FIGS. **34-39** is abbreviated in nature.

[0166] The fluid reservoir **960** is very similar to the fluid reservoir **900**, except for its use of an integrated hollow needle **962** rather than a physically distinct and separate needle component. In this regard, the hollow needle **962** is integrated and contiguous with the main body section **964** of the fluid reservoir **960**. In certain embodiments, the hollow needle **962** and the main body section **964** are molded together from the same material (e.g., a plastic material) to create a unitary single component. The integrated nature of the hollow needle **962** is depicted in FIG. **35**, which shows how the base **966** of the hollow needle **962** blends with (and is continuous with) the main body section **964**. Although not always required, the illustrated embodiment of the hollow needle **962** terminates at a rounded, blunt tip **968**. Alternatively, a pointed, angled, or sharp tip could be utilized.

[0167] FIG. **36** depicts a section **970** of the fluid infusion device; the section **970** may represent a portion of the base plate (as described above). The section **970** houses a sealing and conduit component **972**, which has the general characteristics and functionality described above for the previous two embodiments. The sealing and conduit component **972** includes or cooperates with a sealing element **974**, which is accessible via a reservoir port receptacle **976**. Notably, the sealing element **974** has an unsealed (open) inlet end **978** that is sized, shaped, and otherwise configured to receive the hollow needle **962**. Moreover, the illustrated embodiment of the sealing element **974** has an outlet end **980** that is downstream from the inlet end **978**. The outlet end **980** includes, cooperates with, or defines a pressure valve **982** that actuates in response to a fluid delivery action of the fluid infusion device, to accommodate flow of the medication fluid from the hollow needle to an outlet conduit **984**. Consequently, even though the inlet end **978** of the sealing element **974** is open and exposed, the outlet conduit **984** is protected by the pressure valve **982** when the fluid reservoir **960** is removed from the reservoir port receptacle **976**.

[0168] FIG. **38** is a cross-sectional and partially phantom view that illustrates the fluid reservoir **960** before engagement with the reservoir port receptacle **976**, and FIG. **39** is a cross-sectional and partially phantom view that illustrates the fluid reservoir **960** after engagement with the reservoir port receptacle **976**. In FIG. **38**, the hollow needle **962** has not yet entered the sealing element **974**. In FIG. **39**, however, engagement of the fluid reservoir **960** with the reservoir port receptacle **976** urges the hollow needle **962** into the inlet end **978** of the sealing element **974** such that the end of the hollow needle **962** resides within a valve chamber **986** defined within the sealing element **974**. Accordingly, fluid communication is established from the fluid chamber **988** of the fluid reservoir **960** to the valve chamber **986**, via the hollow needle **962**. In the state depicted in FIG. **39**, the sealing element **974** forms a seal around the exterior surface of the hollow needle **962** to inhibit fluid leakage from the valve chamber **986**.

[0169] FIG. **39** depicts the pressure valve **982** in a closed state, which is indicative of a lack of sufficient fluid pressure within the valve chamber **986**. In contrast, when the plunger (not shown) of the fluid reservoir **960** is activated for a fluid delivery pulse, cycle, or action, the pressure valve **982** actu-

ates and opens to accommodate flow of the medication fluid from the hollow needle **962** and through the pressure valve **982**, by way of the valve chamber **986**. The medication fluid is also urged through the outlet conduit **984**, which may lead to a cannula that provides the medication fluid to the body of the patient.

[0170] Sealing Arrangement for a Needled Fluid Reservoir

[0171] As described previously (with reference to FIGS. **1-3** and FIGS. **34-39**), a fluid infusion device may cooperate with a needled fluid reservoir that engages a sealing arrangement to provide a fluid delivery flow path from the fluid infusion device to the body of the patient. FIGS. **40** and **41** depict (in cross-section) a portion of a fluid infusion device **1000** that incorporates another exemplary embodiment of a sealing assembly **1002** that cooperates with a fluid reservoir **1004** to form a sealed fluid flow path from the fluid reservoir **1004** to the patient. A number of features and aspects of the fluid infusion device **1000** and the sealing assembly **1002** are similar to that described above for the embodiments depicted in FIGS. **1-3**, **25-29**, and **36-39**. For the sake of brevity and ease of description, shared or common features, structure, and functionality will not be redundantly described here with reference to the fluid infusion device **1000** and the sealing assembly **1002**.

[0172] The fluid infusion device **1000** generally includes a durable housing that engages and couples with a base plate, as described above with reference to FIGS. **1-3**. In certain embodiments, the fluid reservoir **1004** is installed onto the durable housing such that the fluid reservoir **1004** couples with the sealing assembly **1002** when the durable housing is introduced to the base plate. In this regard, FIG. **40** shows the fluid infusion device **1000** before the fluid reservoir **1004** mates with the sealing assembly **1002**, and FIG. **41** shows the fluid infusion device **1000** after the fluid reservoir **1004** is engaged with the sealing assembly **1002**.

[0173] A portion of a base plate **1006** of the fluid infusion device **1000** is depicted in FIGS. **40-42**. The illustrated embodiment of the fluid infusion device **1000** includes a reservoir port receptacle **1008** that is integrated with, coupled to, or implemented with the base plate **1006**. The reservoir port receptacle **1008** may be considered to be part of the sealing assembly **1002**. Accordingly, the sealing assembly **1002** as referred to here may include the base plate **1006** (or a portion thereof) and/or other structure or elements that cooperate with the reservoir port receptacle **1008**. The reservoir port receptacle **1008** is shaped, sized, and otherwise configured to accommodate and receive a reservoir port **1010** and a hollow fluid reservoir needle **1012** of the fluid reservoir **1004**. For this particular embodiment, the hollow fluid reservoir needle **1012** is located within the reservoir port **1010**, which may serve as a needle hood as described above for the fluid reservoir **900** (see FIG. **23**). In this regard, the reservoir port **1010** may extend further than a blunt tip **1014** of the hollow fluid reservoir needle **1012**. In other words, the blunt tip **1014** of the hollow fluid reservoir needle **1012** does not protrude from the end of the reservoir port **1010**. In alternative embodiments, a longer reservoir needle that extends beyond the end of the reservoir port **1010** could be utilized if so desired to suit the needs of the given application or system.

[0174] In certain embodiments, the fluid reservoir **1004** includes a diffuser (not shown) positioned within the fluid path of the fluid reservoir needle **1012**. The diffuser may be realized as a porous and fluid permeable membrane or material that impedes fluid flow to inhibit leakage of fluid out of the

fluid reservoir **1004** due to excess pressure that may be present inside of the fluid reservoir **1004**. The diffuser is suitably designed to accommodate the desired flow rate as intended during controlled fluid delivery operations.

[0175] The reservoir port receptacle includes a proximal end **1016**, an opposing distal end **1018** extending from the proximal end **1016**, and a needle entry **1020** (i.e., an opening as shown in FIG. **42**) formed in the distal end **1018**. The needle entry **1020** is shaped and sized to accommodate and receive the hollow fluid reservoir needle **1012**, as shown in FIG. **41**. Although not always required, the exterior surface of the reservoir port receptacle **1008** may be cylindrical. Moreover, although not always required, the needle entry **1020** in the illustrated embodiment is realized as a circular hole formed in the distal end **1018**. The reservoir port receptacle **1008** may also include or cooperate with a retaining structure, feature, or element to maintain a needle sealing element **1022** and a spacer **1023** between the distal end **1018** and the proximal end **1016** of the reservoir port receptacle **1008**. In certain embodiments, the retaining structure is realized as an inwardly protruding collar **1024**, which may be integrally formed in the distal end **1018** of the reservoir port receptacle **1008** (see FIG. **42**). The collar **1024** may be shaped, sized, and contoured as desired to maintain the needle sealing element **1022** and the spacer **1023** in position within the reservoir port receptacle **1008**. In practice, the needle entry **1020** is large enough to accommodate the insertion of the needle sealing element **1022** and the spacer **1023** into the reservoir port receptacle **1008**, and to facilitate positioning and seating of the needle sealing element **1022** and the spacer **1023** into the nominal position shown in FIG. **40**. Alternatively, the needle sealing element **1022** and the spacer **1023** could be inserted from the rear of the base plate **1006** and secured in place by a flow base component **1030**.

[0176] The illustrated embodiment of the sealing assembly **1002** includes the flow base component **1030**, which may be a one-piece element or an assembly that includes two or more subcomponents. FIG. **43** is a perspective view of one exemplary embodiment of the flow base component **1030**, which is realized as a composite component having a primary cap portion **1032** and a hollow needle **1034** (not shown in FIG. **43**, but depicted in FIG. **40** and FIG. **41**) coupled to the primary cap portion **1032**. In certain implementations, the hollow needle **1034** is sealed in a cavity formed within the primary cap portion **1032** (using a curable adhesive, an epoxy, or the like). The sealing material maintains the hollow needle **1034** in position and inhibits fluid leakage. The hollow needle **1034** represents one exemplary embodiment of an outlet conduit for the sealing assembly **1002**. In alternative embodiments, the outlet conduit may be integrally formed in the flow base component **1030**.

[0177] The flow base component **1030** is coupled to the reservoir port receptacle **1008** to provide a fluid flow path from the fluid reservoir **1004** to a delivery conduit of the fluid infusion device **1000**. More specifically, the hollow needle **1034** has a first end **1038** that is configured for selective fluid communication with the fluid reservoir needle **1012**, that is, when the fluid infusion device **1000** is in the state depicted in FIG. **41**. In certain embodiments, the flow base component **1030** includes a fluid pathway **1039** formed therein (which is described in more detail below), and the first end **1038** of the hollow needle is in fluid communication with the fluid pathway **1039**, as shown in the cross-sectional views of FIG. **40** and FIG. **41**, and as shown in the partially cutaway views of

FIGS. **44** and **45**. More specifically, the first end **1038** extends into the fluid pathway **1039** to receive fluid dispensed from the fluid reservoir needle **1012**.

[0178] As shown in FIG. **40** and FIG. **41**, the hollow needle **1034** for this particular embodiment is “C” or “J” shaped to provide a fluid flow path from the first end **1038** of the hollow needle **1034**, across the length of the flow base component **1030**, and to a second end **1040** of the hollow needle **1034**. The second end **1040** leads to a fluid chamber **1044** defined in the base plate **1006**. The fluid chamber **1044** is fluidly coupled to a delivery conduit of the fluid infusion device, e.g., the cannula **112** (FIG. **1**), such that when a plunger of the fluid reservoir **1004** is actuated, the fluid is expelled from the fluid reservoir **1004**, through the fluid pathway **1039**, into the first end **1038** of the hollow needle, through the hollow needle **1034**, into the fluid chamber **1044**, and into the body of the patient via the cannula **112**.

[0179] Referring to FIG. **42** and FIG. **43**, the base plate **1006** is shaped and sized to mate with the flow base component **1030**. For example, the illustrated embodiment of the flow base component **1030** includes an inlet structure **1046** positioned near the first end **1038** of the hollow needle **1034**, and an outlet structure **1048** positioned near the second end **1040** of the hollow needle **1034**. The inlet structure **1046** and the outlet structure **1048** both extend and protrude from the primary body section **1050** of the flow base component **1030**. These extending features of the flow base component **1030** fit into corresponding features of the base plate **1006**, as shown in FIG. **40** and FIG. **41**. In particular, the inlet structure **1046** fits into a section of the reservoir port receptacle **1008**. When assembled as depicted in FIG. **40** and FIG. **41**, the inlet structure **1046** may be coupled to an interior surface **1052** of the reservoir port receptacle **1008** (see FIG. **42**).

[0180] The base plate **1006** may include a suitably shaped and sized fluid chamber **1056** defined therein. In operation, fluid expelled from the fluid reservoir **1004** enters the fluid chamber **1056** and passes into the first end **1038** of the hollow needle **1034**, which is in fluid communication with the fluid chamber **1056** (via the fluid pathway **1039**). For the illustrated embodiment, the fluid chamber **1056** is located at least partially in the reservoir port receptacle **1008**. More specifically, the fluid chamber **1056** is at least partially defined in the flow base component **1030**. For example, the fluid chamber **1056** may be generally defined as an interior area within the inlet structure **1046**, which terminates at an abutment surface **1058** of the flow base component **1030** (see FIG. **43**). Referring to FIG. **40** and FIG. **41**, the needle sealing element **1022** is positioned between the distal end **1018** of the reservoir port receptacle **1008** and the fluid chamber **1056**. More specifically, the needle sealing element **1022** is held in place between the collar **1024** (FIG. **42**) and the abutment surface **1058** (FIG. **43**). As shown in FIG. **40** and FIG. **41**, the base section of the needle sealing element **1022** contacts the abutment surface **1058**, and the opposing end section of the needle sealing element **1022** contacts the collar **1024**.

[0181] As mentioned above, a portion of the flow base component **1030** terminates at the abutment surface **1058**. This portion extends from the flow base component **1030** to form the inlet structure **1046** (see FIG. **43**). For this particular embodiment, the fluid chamber **1056** is defined by the inlet structure **1046** and by a needle guide pin **1064** that protrudes from the proximal end **1016** of the reservoir port receptacle **1008**. Referring to FIGS. **43-45**, the needle guide pin **1064** may be integrated with the flow base component **1030**, i.e.,

the needle guide pin 1064 may be fabricated as a feature or element of the flow base component 1030. In this regard, FIG. 43 and FIG. 44 depict how the needle guide pin 1064 extends and protrudes from the flow base component 1030.

[0182] The needle guide pin 1064 includes a support area 1066 and an opposing end section 1068. The support area 1066 is attached to (or, in this embodiment, is integrated with) the primary body section 1050 of the flow base component 1030, and the end section 1068 extends from the support area 1066. The end section 1068 of the needle guide pin 1064 is suitably shaped, sized, and otherwise configured to fit within the hollow fluid reservoir needle 1012 (see FIG. 41). In certain embodiments where the end section 1068 of the needle guide pin 1064 and the interior of the fluid reservoir needle 1012 are cylindrical in shape, the outer diameter of the end section 1068 is less than the inner diameter of the fluid reservoir needle 1012. In practice, the needle guide pin 1064 and the fluid reservoir needle 1012 are sized such that fluid can effectively flow past the needle guide pin 1064 during fluid delivery operations. In other words, an amount of clearance is provided such that a fluid flow gap is maintained between the outer surface of the needle guide pin 1064 and the interior of the fluid reservoir needle 1012 when the fluid infusion device is in the state shown in FIG. 41.

[0183] As described previously, certain embodiments of the flow base component 1030 utilize a fluid pathway 1039 to direct fluid from the fluid chamber 1056 to the first end 1038 of the hollow needle 1034. In accordance with the illustrated embodiment, the fluid pathway 1039 is formed in the flow base component 1030 such that the fluid chamber 1056 is in fluid communication with the fluid pathway 1039. Moreover, at least a portion of the fluid pathway 1039 may be formed in the needle guide pin 1064. More specifically, a portion of the fluid pathway 1039 is formed in the support area 1066 of the needle guide pin 1064, as shown in FIGS. 43-45. In practice, the fluid pathway 1039 may be realized as one or more slots, slits, or holes that are accessible from inside the fluid chamber 1056.

[0184] As shown in FIGS. 40 and 41, the needle sealing element 1022 is located between the distal end 1018 of the reservoir port receptacle 1008 and the abutment surface 1058. Thus, the needle sealing element 1022 can be held in place by the abutment surface 1058 in cooperation with the collar 1024. Alternatively, any suitably configured abutment structure could be implemented to maintain the needle sealing element 1022 in place. For example, the interior of the reservoir port receptacle 1008 could be fabricated with protruding features or a shoulder that functions as an abutment structure. Notably, the abutment surface 1058 provides support around the perimeter of the needle sealing element 1022 to allow entry of the fluid reservoir needle 1012 into the fluid chamber 1056, as needed. In other words, the abutment surface 1058 does not interfere with the desired travel of the fluid reservoir needle 1012 (see FIG. 41).

[0185] One suitable embodiment of the needle sealing element 1022 is depicted in FIGS. 46-48. (FIG. 48 also shows the spacer 1023 installed on the needle sealing element 1022). The needle sealing element 1022 may be integrally formed as a one-piece component from a resiliently deformable material, such as rubber, urethane, or the like. In certain embodiments, the needle sealing element 1022 is formed from a pliable silicone material. The illustrated embodiment of the needle sealing element 1022 includes, without limitation: a base section 1070; a neck section 1072; an end section 1074;

and a needle opening 1078. When assembled as shown in FIG. 40 and FIG. 41, the base section 1070 is adjacent to the fluid chamber 1056. In certain embodiments, the base section 1070 contacts and cooperates with the abutment surface 1058 to form a seal against the inlet structure 1046. The end section 1074 is opposite the base section 1070, and the neck section 1072 is located between the base section 1070 and the end section 1074.

[0186] The needle opening 1078 is formed in the needle sealing element 1022 such that it extends through the neck section 1072. Depending upon the particular configuration of the needle sealing element 1022, the needle opening 1078 may also extend through some or all of the base section 1070 and/or through some or all of the neck section 1072. When the needle sealing element 1022 is in the state shown in FIG. 40, the end section 1068 of the needle guide pin 1064 resides within the needle opening 1078. In contrast, when the needle sealing element 1022 is in the state shown in FIG. 41, the needle opening 1078 expands to accommodate the fluid reservoir needle 1012. Thus, when the needle sealing element 1022 is in its natural and uncompressed state (shown in FIG. 46), the needle opening 1078 has a nominal diameter or size that is smaller than the outer diameter or dimension of the needle guide pin 1064.

[0187] The needle sealing element 1022 may include a proximal flange 1082 formed at the base section 1070, and a distal flange 1084 formed at the end section 1074. The proximal flange 1082 has an outer sealing surface 1086 that cooperates with the interior surface 1052 (FIG. 42) of the reservoir port receptacle 1008. Similarly, the distal flange 1084 has an outer sealing surface 1088 that cooperates with the interior surface 1052 of the reservoir port receptacle 1008. FIG. 40 and FIG. 41 depict the manner in which these outer sealing surfaces 1086, 1088 contact the interior surface 1052. As described in more detail below, the needle sealing element 1022 cooperates with the hollow fluid reservoir needle 1012 and/or with the needle guide pin 1064 as needed to maintain fluid seals for the fluid infusion device 1000.

[0188] Referring now to FIG. 48, and with continued reference to FIG. 40 and FIG. 41, the fluid infusion device 1000 may also include a suitably shaped, sized, and configured spacer 1023. The spacer 1023 may be coupled around the neck section 1072 of the needle sealing element 1022 such that the spacer 1023 “floats” within the reservoir port receptacle 1008. As shown in FIG. 48, the spacer 1023 is located and maintained in position between the proximal flange 1082 and the distal flange 1084 (i.e., between the base section 1070 and the end section 1074 of the needle sealing element 1022). The spacer 1023 may be formed from a stiff and rigid material such as a metal, a hard plastic, nylon, or the like. In certain embodiments, the spacer 1023 can be realized as a split ring to facilitate installation over the needle sealing element 1022.

[0189] The spacer 1023 functions as a support member for the needle sealing element 1022. More specifically, the spacer 1023 inhibits flexing, deformation, and compression of the flanges 1082, 1084 toward one another during insertion and removal of the fluid reservoir needle 1012. In other words, the spacer 1023 keeps the flanges 1082, 1084 in a spaced-apart relationship relative to one another, which in turn enables the flanges 1082, 1084 to maintain contact with the interior surface 1052 of the reservoir port receptacle.

[0190] It should be appreciated that the combination of the needle sealing element 1022, the needle guide pin 1064, and the spacer 1023 represents one suitable embodiment of a

sealing component for the base plate **1006**. Moreover, certain features or elements of the base plate **1006** and/or certain features or elements of the flow base component **1030** may also form a portion of the sealing component. In practice, the sealing component is positioned in the reservoir port receptacle **1008** to cooperate with the fluid chamber **1056** during different operating states of the fluid infusion device **1000**. Of course, the sealing component could be realized and implemented in an alternative manner than that described here.

[0191] Operation of the sealing component will now be described with reference to FIGS. **40** and **41**. FIG. **40** depicts the fluid infusion device **1000** in a disengaged state, where the reservoir port **1010** is not yet fully engaged with or mated to the reservoir port receptacle **1008**. In contrast, FIG. **41** depicts the fluid infusion device **1000** in an engaged state, where the reservoir port **1010** is engaged with and mated to the reservoir port receptacle **1008**. When the fluid infusion device **1000** is in the disengaged state, the fluid reservoir needle **1012** is decoupled from the needle sealing element **1022** and is decoupled from the needle guide pin **1064**. Consequently, the needle sealing element **1022** assumes the position shown in FIG. **40**: the needle sealing element **1022** is positioned within the reservoir port receptacle such that the neck section **1072** surrounds the end section **1068** of the needle guide pin **1064**.

[0192] When the fluid infusion device **1000** is in the disengaged state shown in FIG. **40**, the fluid reservoir needle **1012** is decoupled from the sealing component, and a portion of the end section **1068** of the needle guide pin **1064** resides within the needle opening **1078**. Accordingly, the needle opening **1078** is blocked by the needle guide pin **1064** in response to retraction and removal of the fluid reservoir needle **1012** from the needle sealing element **1022**, and the needle sealing element **1022** forms a seal around the exterior surface of the needle guide pin **1064**. In practice, the neck section **1072** squeezes and pinches around the end section **1068** of the needle guide pin **1064** with sufficient force to maintain a fluid tight seal between the needle sealing element **1022** and the needle guide pin **1064**. This seal inhibits leakage of fluid from the fluid chamber **1056**, and inhibits ingress of contaminants into the fluid chamber **1056**. Thus, any fluid contained in the fluid chamber **1056** remains trapped and does not leak beyond the needle sealing element **1022**. Moreover, when the fluid infusion device **1000** is in the disengaged state, the outer sealing surfaces **1086**, **1088** (see FIG. **46** and FIG. **48**) contact the interior surface **1052** (FIG. **42**) of the reservoir port receptacle **1008** to inhibit leakage of fluid and ingress of contaminants around the outer perimeter of the needle sealing element **1022**.

[0193] Coupling of the reservoir port **1010** to the reservoir port receptacle **1008** causes the hollow fluid reservoir needle **1012** to be urged toward the needle sealing element **1022**. Eventually, the blunt tip **1014** of the fluid reservoir needle **1012** is guided toward the end section **1068** of the needle guide pin **1064**. The reservoir port receptacle **1008** and the needle guide pin **1064** are cooperatively configured for compatibility with the reservoir port **1010** such that the fluid reservoir needle **1012** is automatically aligned with the needle guide pin **1064** when the reservoir port **1010** is introduced to the reservoir port receptacle **1008**. Accordingly, continued engagement of the reservoir port **1010** with the reservoir port receptacle **1008** causes the needle guide pin **1064** to enter the interior of the fluid reservoir needle **1012**, as depicted in FIG. **41**. In this regard, the wall of the hollow fluid reservoir needle **1012** forces the neck section **1072** of the

needle sealing element **1022** outward such that the needle sealing element **1022** can accommodate full insertion of the fluid reservoir needle **1012**.

[0194] When the fluid infusion device **1000** is in the engaged state shown in FIG. **41**, the end section **1068** of the needle guide pin **1064** resides within the fluid reservoir needle **1012**, and a portion of the fluid reservoir needle **1012** resides within the needle opening **1078**. More specifically, a portion of the fluid reservoir needle **1012** is located within the neck section **1072** of the needle sealing element **1022**. In addition, the needle sealing element **1022** forms a seal around the exterior surface of the fluid reservoir needle **1012**. As shown in FIG. **41**, the blunt tip **1014** of the fluid reservoir needle **1012** moves past the neck section **1072** and into the fluid chamber **1056**, which establishes fluid communication from the fluid reservoir **1004** to the fluid chamber **1056**. In response to entry of the fluid reservoir needle **1012**, the needle opening **1078** expands and the needle sealing element **1022** is deformed and outwardly compressed within the reservoir port receptacle **1008**.

[0195] Notably, the needle sealing element **1022** inhibits leakage of fluid from the fluid chamber **1056** during operation of the fluid infusion device **1000**, e.g., during fluid delivery operations. In addition, the flanges **1082**, **1084** of the needle sealing element **1022** are further compressed to enhance the fluid seal between the needle sealing element **1022** and the interior surface **1052** of the reservoir port receptacle. Consequently, fluid expelled from the fluid reservoir needle **1012** during a fluid delivery operation is forced into the fluid chamber **1056**, through the fluid pathway **1039**, and through the hollow needle **1034**, and little to no fluid leaks past the exterior surface of the fluid reservoir needle **1012**.

[0196] To summarize, when the fluid reservoir **1004** urged into a mated position with the reservoir port receptacle **1008**, the fluid reservoir needle **1012** receives and slides over the needle guide pin **1064**, and the wall of the fluid reservoir needle **1012** fits between the needle guide pin **1064** and the neck section **1072** of the needle sealing element **1022**. The needle sealing element **1022** responds by creating a seal with the exterior surface of the fluid reservoir needle **1012**. Once properly seated, the end of the fluid reservoir needle **1012** extends into (or near) the fluid chamber **1056** to facilitate delivery of medication fluid to the body of the user. Thereafter, when the fluid reservoir **1004** is decoupled from the reservoir port receptacle **1008**, the fluid reservoir needle **1012** withdraws from the needle sealing element **1022**, and the neck section **1072** closes around the outer surface of the needle guide pin **1064** to inhibit fluid egress from the fluid chamber **1056**, and to inhibit the entry of contaminants into the fluid chamber **1056**.

[0197] While at least one exemplary embodiment has been presented in the foregoing detailed description, it should be appreciated that a vast number of variations exist. It should also be appreciated that the exemplary embodiment or embodiments described herein are not intended to limit the scope, applicability, or configuration of the claimed subject matter in any way. Rather, the foregoing detailed description will provide those skilled in the art with a convenient road map for implementing the described embodiment or embodiments. It should be understood that various changes can be made in the function and arrangement of elements without departing from the scope defined by the claims, which includes known equivalents and foreseeable equivalents at the time of filing this patent application.

What is claimed is:

1. A sealing assembly for a fluid infusion device that cooperates with a fluid reservoir having a reservoir port and a hollow fluid reservoir needle at least partially located within the reservoir port, the sealing assembly comprising:

a reservoir port receptacle to receive the reservoir port, and comprising a proximal end, a distal end extending from the proximal end, and a needle entry formed in the distal end to receive the hollow fluid reservoir needle;
a fluid chamber located at least partially in the reservoir port receptacle; and

a sealing component positioned in the reservoir port receptacle to cooperate with the fluid chamber, the sealing component comprising:

a needle guide pin protruding from the proximal end of the reservoir port receptacle, wherein an end section of the needle guide pin is sized to fit within the hollow fluid reservoir needle; and

a needle sealing element that cooperates with the hollow fluid reservoir needle and with the needle guide pin, the needle sealing element comprising a base section adjacent to the fluid chamber, an end section opposite the base section, a neck section between the base section and the end section, and a needle opening extending through the neck section; wherein:

when the reservoir port is engaged with reservoir port receptacle, the end section of the needle guide pin resides within the hollow fluid reservoir needle, a portion of the hollow fluid reservoir needle resides within the needle opening, and the needle sealing element forms a first seal around an exterior surface of the hollow fluid reservoir needle; and

when the reservoir port is disengaged from the reservoir port receptacle, the hollow fluid reservoir needle is decoupled from the sealing component, a portion of the end section of the needle guide pin resides within the needle opening, and the needle sealing element forms a second seal around an exterior surface of the needle guide pin.

2. The sealing assembly of claim 1, wherein the needle sealing element comprises:

a proximal flange formed at the base section of the needle sealing element, the proximal flange having a first outer sealing surface that cooperates with an interior surface of the reservoir port receptacle; and

a distal flange formed at the end section of the needle sealing element, the distal flange having a second outer sealing surface that cooperates with the interior surface of the reservoir port receptacle.

3. The sealing assembly of claim 2, further comprising a spacer coupled around the neck section and located between the proximal flange and the distal flange to inhibit compression of the proximal flange and the distal flange toward one another.

4. The sealing assembly of claim 1, wherein the reservoir port receptacle comprises a retaining structure to maintain the needle sealing element between the distal end and the proximal end of the reservoir port receptacle.

5. The sealing assembly of claim 4, wherein the retaining structure comprises an inwardly protruding collar integrally formed in the distal end of the reservoir port receptacle.

6. The sealing assembly of claim 1, wherein the reservoir port receptacle is integrally formed in a base plate of the fluid infusion device.

7. The sealing assembly of claim 1, further comprising an outlet conduit having a first end in fluid communication with the fluid chamber and having a second end in fluid communication with a delivery conduit of the fluid infusion device.

8. The sealing assembly of claim 7, wherein the outlet conduit comprises a hollow needle.

9. The sealing assembly of claim 7, further comprising a flow base component coupled to the reservoir port receptacle, wherein the outlet conduit is located in the flow base component.

10. The sealing assembly of claim 1, further comprising a flow base component coupled to the reservoir port receptacle, wherein:

the fluid chamber is at least partially defined in the flow base component; and

the needle guide pin is integrated with the flow base component.

11. The sealing assembly of claim 10, further comprising a fluid pathway formed in the flow base component, wherein the fluid chamber is in fluid communication with the fluid pathway.

12. The sealing assembly of claim 11, wherein at least a portion of the fluid pathway is formed in the needle guide pin.

13. The sealing assembly of claim 10, wherein:

the flow base component comprises an inlet structure extending therefrom;

the fluid chamber is defined by the inlet structure;

the inlet structure terminates at an abutment surface; and

the base section of the needle sealing element contacts the abutment surface.

14. A sealing assembly for a fluid infusion device that cooperates with a fluid reservoir having a reservoir port and a hollow fluid reservoir needle at least partially located within the reservoir port, the sealing assembly comprising:

a base plate;

a reservoir port receptacle on the base plate to receive the reservoir port, and the reservoir port receptacle comprising a proximal end, a distal end extending from the proximal end, and a needle entry formed in the distal end to receive the hollow fluid reservoir needle;

a flow base component coupled to the base plate and to the reservoir port receptacle, the flow base component comprising an inlet structure extending therefrom to define a fluid chamber, and the flow base component further comprising a needle guide pin protruding therefrom, wherein an end section of the needle guide pin is sized to fit within the hollow fluid reservoir needle; and

a needle sealing element comprising a proximal flange adjacent to the inlet structure, a distal flange opposite the proximal flange, a neck section between the proximal flange and the distal flange, and a needle opening extending through the neck section, wherein the needle sealing element is positioned within the reservoir port receptacle such that the neck section surrounds the end section of the needle guide pin.

15. The sealing assembly of claim 14, wherein:

when the reservoir port is engaged with reservoir port receptacle, the end section of the needle guide pin resides within the hollow fluid reservoir needle, a portion of the hollow fluid reservoir needle resides within the needle opening, and the needle sealing element forms a first seal around an exterior surface of the hollow fluid reservoir needle; and

when the reservoir port is disengaged from the reservoir port receptacle, the hollow fluid reservoir needle is decoupled from the needle sealing element, a portion of the end section of the needle guide pin resides within the needle opening, and the needle sealing element forms a second seal around an exterior surface of the needle guide pin.

16. The sealing assembly of claim **14**, further comprising a spacer coupled around the neck section and located between the proximal flange and the distal flange to inhibit compression of the proximal flange and the distal flange toward one another.

17. The sealing assembly of claim **14**, further comprising an outlet conduit having an inlet end and an outlet end in fluid communication with a delivery conduit of the fluid infusion device, wherein the inlet end fluidly communicates with the hollow fluid reservoir needle when the reservoir port engages the reservoir port receptacle.

18. The sealing assembly of claim **17**, wherein the outlet conduit is located in the flow base component.

19. The sealing assembly of claim **17**, further comprising a fluid pathway formed in the flow base component, wherein the fluid chamber is fluidly coupled to the outlet conduit via the fluid pathway.

20. The sealing assembly of claim **19**, wherein at least a portion of the fluid pathway is formed in the needle guide pin.

21. The sealing assembly of claim **14**, wherein the reservoir port receptacle is integrally formed in the base plate.

22. A fluid infusion device to deliver a medication fluid to a user, the fluid infusion device comprising:

a removable fluid reservoir comprising a reservoir port and a hollow fluid reservoir needle;

a base plate comprising a reservoir port receptacle to receive the reservoir port and the fluid reservoir needle;

an inlet structure located in the reservoir port receptacle, the inlet structure defining at least a portion of a fluid chamber;

a needle guide pin protruding from the inlet structure, wherein an end section of the needle guide pin is sized to fit within the hollow fluid reservoir needle; and

a needle sealing element comprising a base section adjacent to the inlet structure, an end section opposite the base section, a neck section between the base section and the end section, and a needle opening extending through the neck section; wherein:

when the reservoir port is engaged with reservoir port receptacle, the end section of the needle guide pin resides within the hollow fluid reservoir needle, a portion of the hollow fluid reservoir needle resides within the needle opening, and the needle sealing element forms a first seal around an exterior surface of the hollow fluid reservoir needle; and

when the reservoir port is disengaged from the reservoir port receptacle, the hollow fluid reservoir needle is decoupled from the sealing component, a portion of the end section of the needle guide pin resides within the needle opening, and the needle sealing element forms a second seal around an exterior surface of the needle guide pin.

23. The fluid infusion device of claim **22**, further comprising an outlet conduit having a first end in fluid communication with the fluid chamber and having a second end in fluid communication with a delivery conduit of the fluid infusion device.

24. The fluid infusion device of claim **23**, further comprising a fluid pathway formed in the flow base component, wherein the fluid chamber is fluidly coupled to the outlet conduit via the fluid pathway.

25. The fluid infusion device of claim **22**, further comprising a spacer coupled around the neck section to inhibit deformation of the base section of the needle sealing element and the end section of the needle sealing element toward one another.

* * * * *