

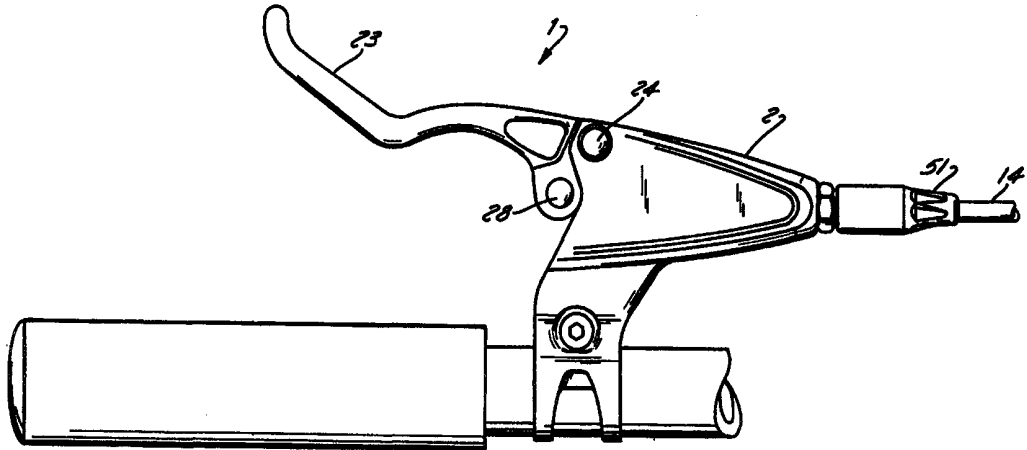

INTERNATIONAL APPLICATION PUBLISHED UNDER THE PATENT COOPERATION TREATY (PCT)

<p>(51) International Patent Classification ⁶ : B62L 3/00</p>	<p>A2</p>	<p>(11) International Publication Number: WO 99/10225 (43) International Publication Date: 4 March 1999 (04.03.99)</p>
<p>(21) International Application Number: PCT/US98/17487 (22) International Filing Date: 24 August 1998 (24.08.98) (30) Priority Data: 08/920,495 29 August 1997 (29.08.97) US (71) Applicant: HAYES BRAKE, INC. [US/US]; 5800 West Donges Bay Road, Mequon, WI 53092-4429 (US). (72) Inventors: BUCKLEY, James, A.; 5111 North Idlewild Avenue, Whitefish Bay, WI 53217 (US). HINKENS, George, H.; 10312 North Stanford Drive, Mequon, WI 53097 (US). JOHNSON, Korey; 1711 South 81st Street, West Allis, WI 53214 (US). (74) Agents: VOGEL, Peter, J. et al.; Foley & Lardner, 777 East Wisconsin Avenue, Milwaukee, WI 53202-5367 (US).</p>		<p>(81) Designated States: AL, AM, AT, AU, AZ, BA, BB, BG, BR, BY, CA, CH, CN, CU, CZ, DE, DK, EE, ES, FI, GB, GE, HU, IL, IS, JP, KE, KG, KP, KR, KZ, LC, LK, LR, LS, LT, LU, LV, MD, MG, MK, MN, MW, MX, NO, NZ, PL, PT, RO, RU, SD, SE, SG, SI, SK, SL, TJ, TM, TR, TT, UA, UG, UZ, VN, YU, ZW, ARIPO patent (GH, GM, KE, LS, MW, SD, SZ, UG, ZW), Eurasian patent (AM, AZ, BY, KG, KZ, MD, RU, TJ, TM), European patent (AT, BE, CH, CY, DE, DK, ES, FI, FR, GB, GR, IE, IT, LU, MC, NL, PT, SE), OAPI patent (BF, BJ, CF, CG, CI, CM, GA, GN, GW, ML, MR, NE, SN, TD, TG).</p> <p>Published <i>Without international search report and to be republished upon receipt of that report.</i></p>

(54) Title: BICYCLE BRAKE SYSTEM



(57) Abstract

A hydraulic brake system for a two wheel bike having handlebars, a master cylinder assembly mounted on the handlebar, the assembly including a housing, a tubular body mounted in the housing, a piston mounted in the tubular body, an overrating lever pivotally mounted on the housing, a push rod operatively connecting the operating lever to the piston, a spring mounted in the cartridge body to bias the piston to an inoperative position in the cartridge body, a resilient bladder filled with a hydraulic fluid enclosing the cartridge body, a port timing hole in the cartridge body connecting the cartridge body to the bladder to maintain fluid pressure in the cartridge body, a brake assembly mounted on the housing, and a brake line operatively connecting the cartridge body to the brake assembly.

FOR THE PURPOSES OF INFORMATION ONLY

Codes used to identify States party to the PCT on the front pages of pamphlets publishing international applications under the PCT.

AL	Albania	ES	Spain	LS	Lesotho	SI	Slovenia
AM	Armenia	FI	Finland	LT	Lithuania	SK	Slovakia
AT	Austria	FR	France	LU	Luxembourg	SN	Senegal
AU	Australia	GA	Gabon	LV	Latvia	SZ	Swaziland
AZ	Azerbaijan	GB	United Kingdom	MC	Monaco	TD	Chad
BA	Bosnia and Herzegovina	GE	Georgia	MD	Republic of Moldova	TG	Togo
BB	Barbados	GH	Ghana	MG	Madagascar	TJ	Tajikistan
BE	Belgium	GN	Guinea	MK	The former Yugoslav Republic of Macedonia	TM	Turkmenistan
BF	Burkina Faso	GR	Greece			TR	Turkey
BG	Bulgaria	HU	Hungary	ML	Mali	TT	Trinidad and Tobago
BJ	Benin	IE	Ireland	MN	Mongolia	UA	Ukraine
BR	Brazil	IL	Israel	MR	Mauritania	UG	Uganda
BY	Belarus	IS	Iceland	MW	Malawi	US	United States of America
CA	Canada	IT	Italy	MX	Mexico	UZ	Uzbekistan
CF	Central African Republic	JP	Japan	NE	Niger	VN	Viet Nam
CG	Congo	KE	Kenya	NL	Netherlands	YU	Yugoslavia
CH	Switzerland	KG	Kyrgyzstan	NO	Norway	ZW	Zimbabwe
CI	Côte d'Ivoire	KP	Democratic People's Republic of Korea	NZ	New Zealand		
CM	Cameroon		Republic of Korea	PL	Poland		
CN	China	KR	Republic of Korea	PT	Portugal		
CU	Cuba	KZ	Kazakstan	RO	Romania		
CZ	Czech Republic	LC	Saint Lucia	RU	Russian Federation		
DE	Germany	LI	Liechtenstein	SD	Sudan		
DK	Denmark	LK	Sri Lanka	SE	Sweden		
EE	Estonia	LR	Liberia	SG	Singapore		

BICYCLE BRAKE SYSTEM

FIELD OF THE INVENTION

The present invention relates to a bicycle
brake assembly, and more particularly to a closed bladder
5 system which prevents the admission of air into the
hydraulic brake system even though the bicycle is upside
down.

BACKGROUND OF THE INVENTION

Bicycle brakes have evolved from hub brakes on
10 rear wheels to machined cantilever brakes on front and
rear wheel rims to disk brake systems. Many conventional
disk brake system designs are not suited well to the
bicycle, particularly since the bicycle will be operated
by both children and adults, will be flipped upside down
15 and laid on its side and made to be extremely light in
weight. Current attempts at adapting motorcycle and
automotive hydraulic disk brake technology to bicycles
has fallen short due to this market's peculiar needs.

SUMMARY OF THE PRESENT INVENTION

20 The brake system described herein innovates a
bleedable fluid reservoir with a bladder system that

-2-

allows the atmospheric pressure reservoir to be drawn upon allowing the brake caliper piston to self adjust for pad wear without the potential of air ingestion and with room to expand the full volume in a high brake
5 temperature condition. This system adapts a thermally compliant brake disk concept to an extremely lightweight embodiment for the bicycle industry yielding high torque carrying ability along with unparalleled thermal durability in a one piece design.

10 The system uses a ball joint piston design as shown in U.S. patent applications Serial No. 08/638,526, entitled "Ball Joint Piston," and Serial No. 29/044,276, entitled "Heavy Duty Brake Disc," to allow the smallest packaging for low weight and good wheel spoke clearance
15 as well as eliminating the possibility of brake drag. This system demonstrates a user friendly lever adjustment to allow hand sizes from those of children to adults for comfort and safety. This lever adjustment avoids rattles and vibration effects with a rod back stop that reduces
20 critical tolerances and whose piston and boot grip the mating push rod.

A unique post and piston assembly is coupled to a friction pad backing plate that uses a wire formed spring to secure the friction pad which both maximizes
25 the disk to friction material clearance (eliminating any brake drag) while allowing an extremely easy pad change. This pad retention system also prevents the pads from falling out while transporting the bicycle with the wheel (and therefore the brake disk) out of the front fork.
30 This system also prevents rattling noise by holding the friction pad backing plate tightly to the face of the brake piston.

Other principal features and advantages of the invention will become apparent to those skilled in the

-3-

art upon review of the following drawings, the detailed description and the appended claims.

BRIEF DESCRIPTION OF THE DRAWINGS

5 Figure 1 is a side elevation view of the master cylinder shown mounted on the handlebar;

Figure 2 is a cross-section view of Figure 1 showing the adjustable push rod assembly (piston reservoir bladder, bleeder and compression fitting);

10 Figure 2A is an enlarged view of the ball end and snap ring arrangement;

Figure 2B is an enlarged view of the port timing opening and the fluid compensating openings;

Figure 3 is an external view of the reservoir bladder in its free state;

15 Figure 4 is a view of a piston and an angular attitude to the caliper bore;

Figures 5 and 6 show the contrast in spoke angle achievable with standard pistons versus the ball joint piston to bore geometry;

20 Figure 7 is a perspective view of the pad spring;

Figure 8 is a perspective view of the piston;

Figure 9 is a perspective view of the friction pad and plate assembly;

25 Figure 10 is a cross-section view of the brake caliper assembly;

Figure 11 is a view of the brake pad partially installed in the housing showing the deflection of the pad retention spring;

30 Figure 12 shows the beveled top of the pad ramped over the piston post;

Figure 13 shows the pad partially removed from the housing disk slot;

-4-

Figure 14 shows the thermally compliant brake disk; and

Figure 15 is a cross section view of a fixed pad single acting caliper assembly.

5 Before explaining at least one embodiment of the invention in detail it is to be understood that the invention is not limited in its application to the details of construction and the arrangement of the components set forth in the following description or
10 illustrated in the drawings. The invention is capable of other embodiments or being practiced or carried out in various ways. Also, it is to be understood that the phraseology and terminology employed herein is for the purpose of description and should not be regarded as
15 limiting.

DETAILED DESCRIPTION OF THE PREFERRED EMBODIMENTS

The master cylinder assembly 1 as shown in Figures 1 and 2 includes an outer housing 2 and an inner cylindrical body 4 mounted in the outer housing 2. A
20 containment ring 8 is mounted on one end of the housing 2 for supporting one end of the cylindrical body. A rubber reservoir bladder 3 as shown in Figure 3, has one end sealed to the inner end of the cylindrical housing 2 by a seal ring 3A and the other end secured to the containment
25 ring 8 by the housing 2. An air space 53 is provided between the bladder 3 and the housing 2. The cylindrical body 4 is mounted in a spaced relation from the bladder 3 to form a fluid reservoir 5. A bleeder screw 6 is mounted in a threaded hole 16 in the containment ring 8
30 and sealed therein by an O-ring seal 7. A piston 9 is axially aligned in the cylindrical body 4 and retained therein by means of a snap ring 32. A spring 62 is aligned with the piston 9 to bias the piston to the open position in contact to the O-ring 32. A primary cup seal

-5-

10 is aligned in a groove 10A in the end of the piston 9. Referring to Figure 2B a port timing hole 11 is provided in the cylinder 4 downstream from the cup seal 10. A fluid compensating hole 12 is provided in the cylindrical
5 body 4 upstream from the groove 10A.

The cross-section of the housing 2 shown in Figure 2 shows the state of the bladder 3 in a normal operating position. The bladder 3 is filled with fluid from the brake bleeder valve 16 as shown in Figure 10 and
10 is devoid of air. An air space 53 is provided outside the bladder 3 to allow for fluid expansion of the bladder that occurs during heavy braking as the fluid is heated. There is adequate reserve fluid volume within the bladder 3 to allow for brake piston adjustment outward to
15 compensate for brake pad wear. The system is designed to provide an air space 53 between the bladder 3 and the housing 2. The fluid volume of the bladder 3 is determined by virtue of the shape of the bladder 3.

In this regard a perspective view of the bladder 3 is shown in Figure 3 in its free state. The
20 side walls of the bladder 3 are provided with indentations or dimples 54 which allow the bladder in the housing 2 to compensate for the expansion and contraction of the brake fluid.

Referring to Figure 2, the system filling
25 process is shown wherein brake fluid enters the cartridge body 4 from the brake line 14 through an inlet 15 formed at the end of the cartridge body 4. A threaded connector 52 is mounted on the threaded end 50 of the housing 4. A threaded cap 51 matingly engages the outer threaded end
30 of connector 52. A seal 56 is provided on the inner end of connector 52 to seal the end of the brake line 14. A spring 62 is seated in the threaded end of the cartridge body 4.

-6-

The brake fluid flows through the timing port 11 carrying the system air with it and filling the bladder 3 with fluid. The air in the bladder 3 flows out through the open bleeder port 16. As this flow continues all air trapped in the system is exhausted out of the bleeder port 16. A slight flow restriction at the bleeder port 16 causes a slight fluid pressure rise which expands the dimples 54 in the bladder 3 outwardly. When the fluid source is shut off, the bleeder port 16 in the containment ring 8 is left open to allow the bladder 3 to relax into its original shape as shown in Figure 3, exhausting a slight amount of fluid out through bleeder port 16. The bleeder screw 6 is closed and sealed by an O-ring 7 when the proper volumes of fluid and air are provided by the molded shape of the bladder.

Since the fluid system has no air in it, the bike can be bounced, laid on its side and turned upside down with no air ingestion problem or other negative effects that would be suffered by traditional reservoir type master cylinders or other so-called systems.

Referring to Figures 2 and 2A and particularly to the lever 23 which is pivotally connected to the housing 2 by means of pivot pin 24. In this regard a push rod 25 interconnects the lever 23 to the piston 9. A stop flange 26 is provided on the rod 25 and a slot 27 is formed on the outer end of the push rod 25. An adjustor bushing 28 is provided on the outer end of the push rod 25. A ball 29 is provided on the other end of the push rod 25 which is seated in a piston socket 30 as shown in Figure 2A. Piston socket snap fit beams 31 are provided around the ball 29 and retained therein by the snap ring 32.

The lever position adjustment as shown in Figure 2B is accomplished without affecting the critical clearance 33 between the primary seal at 10 and the

-7-

timing port 11 as shown in Figure 2B. The push rod 25 can be rotated by a screw driver aligned with slot 27 at the end of the rod 25. As the rod 25 is rotated the adjustor bushing 28 travels down the rod 25, moving the lever 23 with it. The most extreme adjustments are limited by flange 26 formed on the rod 25 in one direction and the screw slot 27 entering the adjustor bushing 28 in the other direction.

The lever 23 maintains its adjustment through a friction hold. The adjustor bushing's first thread is an interference thread to the rod 25. A boot 64 is tightly mounted on the rod 25 and the outer end of the cylindrical body 4 to enclose the open end of the cylindrical body 4.

The piston 9 is prevented from exiting the bore 35 by means of a snap ring 32 which is retained in a groove 36 in the end of the cartridge body 4. The rod 25 is kept from being loose in the piston 9 by the use of the resilient piston material whose snap joint beams 31 are sprung to interfere with the rod ball end 29 as shown in Figure 2A. The rod ball end 29 is prevented from exiting the piston by the beams 31 that will not open wide enough to allow the rod ball end 29 to escape due to contact with the bore 35. Therefore, in the free state the rod 25 can be snapped into the piston 9. Removal of the rod ball end 29 is prevented by the restriction of movement the bore 30 provides.

In Figures 4, 5 and 6 brake caliper housings 17 and 17' are shown having angularly machined seal grooves 18 and 18', an undercut bore 19 and a piston 20 in each bore 19. The engagement length of the pistons 20 to the bore land area 21 is made to be extremely short so as to allow the pistons to be angularly offset as shown in Figure 4. This allows the pistons 20 to be designed with a length adequate only for sealing the piston 20 through

-8-

the full cycle of a friction pad's wear as shown in Figure 6 rather than needing a longer engagement as shown in Figure 5 to resist jamming by sticking in the bore. This shortens the necessary bore depth 22 and allows for a greater spoke angle x of the wheel as shown in Figure 6 than at the spoke angle x' of Figure 5. This allows for a wheel with greater lateral strength which is important in rough riding. The piston and bore design also allows for smaller, lighter parts which is important for human powered vehicles.

Referring to Figures 7, 8 and 9, a friction pad and plate assembly 38 is shown which includes a backing plate 40 having a tab 46 for inserting and removing the assembly 38 from the piston 20. A friction pad 41 is formed on one side of the friction plate 40. A flexion spring 42 is mounted on the plate 40. The spring 42 includes a hook 50 on each end which snaps onto ears 51 on the plate 40. A U-shaped loop 55 is provided intermediate the ends of the spring 42 and an offset section 56 on each leg of the spring which is aligned with a groove 60 in the plate 40. In the installed condition the plates 40 are held snugly against the pistons 20 by the springs 42.

A piston post 47 is partially embedded in each of the pistons 20. A cap 61 is provided on the end of the post 47. The friction pad and plate assembly 38 is connected to the piston 20 by sliding the plate assembly 38 upward so that the U-shaped loop 55 engages the post 47 and is retained thereon by cap 61. A recess 43 is provided in the plate 40 which is aligned with the post 47 on the piston 20. The plate assembly 38 is positioned on the piston 20 by sliding the plate assembly 38 into the slot 45 with the U-shaped loop 55 aligned with the cap 61. The tab 46 is lifted as shown in Figure 11. The spring 42 is deflected and the piston post 47 is clear of

-9-

the friction pad plate hole edge 44. The friction pad and plate assembly 38 can be slid out of the bottom of the caliper housing as shown in Figure 13. This is the only avenue of escape for the pad as the other three sides are closed.

5 During insertion of the pads as shown in Figure 12, the left side of the pad is slid up until the beveled section 56 of the pad 38, ramps over the piston post 47. The post 47 engages the spring 42, deflecting it away from the pad plate 40. The pad 38 continues sliding until the plate 46 snaps over the post 47. The pad is then pulled into contact with the piston face by spring 42 and the plate hole 43 captures the piston post 47. Once the wheel and disk assembly 39 are reinserted into the forks 42, the pads are trapped from lifting out of piston engagement and thus cannot escape.

10 A thermally compliant lightweight brake disk 59, as shown in Figure 14, is designed to prevent yielding which can cause warping or fracture under combined thermal and high torque loading. The friction contact ring 61 is supported by a number of curved legs 57 which are formed in the circular area 58. The legs 57 are shaped in such a way as to bend to comply with the outer ring's desire to expand when heated. This prevents high stress concentration on the legs 57 and avoids yielding. The legs 57 are also designed to be strong enough to withstand exceptionally high braking torque. Finally, the legs 57 are shaped to provide adequate axial bending but strength enough to prevent impact damage. It is important that the disk remains flat when not in use.

20 Referring to Figure 15 a fixed mount single acting caliper 60 is shown mounted on the bicycle frame in a position to straddle the lightweight brake disk 59. The caliper 60 is set up on the frame with a clearance of .010 inch between fixed pad 62 and the disk 59. The

-10-

brake actuator 66 is positioned on the mount side with
the moveable pad 64 positioned to engage the disk 59
after .010 movement. When the brake actuator 66 is
applied, the moveable pad 64 closes the .010 gap,
5 contacts the ring 61, flexes the ring 61 into contact
with the fixed pad 62 and progressive frictional clamping
occurs. Upon release of the moveable pad, the ring 61
returns to its home position with a clearance of .010
10 inch between the ring 61 and the pad 62 and between the
ring 61 and the pad 64. With this arrangement, zero drag
is provided on each side of the disk due to its
flexibility and the resultant clearance.

Thus, it should be apparent that there has been
provided in accordance with the present invention a
15 bicycle brake system that fully satisfies the objectives
and advantages set forth above. Although the invention
has been described in conjunction with specific
embodiments thereof, it is evident that many
alternatives, modifications and variations will be
20 apparent to those skilled in the art. Accordingly, it is
intended to embrace all such alternatives, modifications
and variations that fall within the spirit and broad
scope of the appended claims.

-11-

CLAIMS

The embodiments of the invention in which an exclusive property or privilege is claimed are defined as follows:

1 1. A hydraulic brake system for a two wheel
2 bike having a handlebar comprising:
3 a master cylinder assembly mounted on the
4 handlebar,
5 said assembly including:
6 a housing,
7 a tubular cartridge body mounted in the
8 housing,
9 a piston mounted in the cartridge body,
10 an operating lever pivotally mounted on the
11 housing,
12 a push rod operatively connecting the operating
13 lever to the piston,
14 a spring mounted in the cartridge body to bias
15 the piston to an inoperative position in the
16 cartridge body,
17 a resilient bladder enclosing the cartridge
18 body,
19 a hydraulic fluid in said bladder,
20 a port timing hole in said cartridge body
21 operatively connecting the cartridge body to the
22 bladder to maintain fluid pressure in the cartridge
23 body, a brake assembly mounted on the housing and a
24 brake line operatively connecting the cartridge body
25 to the brake assembly.

1 2. The assembly according to claim 1
2 including means for adjusting the lever position with
3 respect to the piston to compensate for variable size
4 operators.

-12-

1 3. The system according to claim 2 wherein
2 said adjusting means comprises a threaded push rod
3 operatively connected to the piston and a threaded
4 adjusting bushing pivotally mounted in the operating
5 lever to adjust the position of the lever without
6 affecting the piston position.

1 4. The assembly according to claim 3
2 including a bleeder means for venting air from the
3 bladder.

1 5. The assembly according to claim 4 wherein
2 said bladder is provided with dimples in the sides of the
3 bladder to allow for expansion and contraction of the
4 brake fluid in the bladder.

1 6. The assembly according to claim 3 wherein
2 a boot is mounted on the push rod and the outer end of
3 the cylindrical body to enclose the end of the cylinder
4 body.

1 7. The hydraulic brake assembly according to
2 claim 1 wherein said brake system comprises a brake disk
3 mounted on one of the wheels, a housing mounted on each
4 side of the brake disk, a piston mounted in each side of
5 the brake disk, a friction pad and plate assembly mounted
6 on each of said pistons in a spaced relation to the brake
7 disk.

1 8. The hydraulic brake assembly according to
2 claim 7 wherein a post and cap is mounted on the piston
3 and said friction pad and plate assemblies are mounted on
4 said post.

-13-

1 9. The hydraulic brake assembly according to
2 claim 8 wherein said friction pad and plate assemblies
3 include a spring mounted on each of said plates for
4 engaging said posts.

1 10. A hydraulic brake system for a
2 bike having a handlebar, the system comprising:
3 a master cylinder assembly adapted to be
4 mounted on the handlebar, said master cylinder
5 assembly including an outer housing, a cylinder
6 having one end mounted in the housing,
7 a piston mounted in the cylinder,
8 a resilient bladder having one end mounted on
9 the outer housing and the other end mounted on the
10 cylinder,
11 a bleeder valve in the housing to vent the air
12 out of the bladder, whereby said timing hole is
13 closed when the piston is actuated to apply the
14 brake.

1 11. The hydraulic brake assembly according to
2 claim 10 wherein said brake system comprises a brake disk
3 mounted on one of the wheels, a housing mounted on each
4 side of the brake disk, a piston mounted on each side of
5 the brake disk, a friction pad and plate assembly mounted
6 on each of said pistons.

1 12. The hydraulic brake assembly according to
2 claim 11 wherein a post is mounted in each of said
3 pistons and said friction pad and plate assemblies are
4 mounted on said post.

1 13. The hydraulic brake assembly according to
2 claim 12 wherein said friction pad and plate assemblies

3 include a spring mounted on each of said plates for
4 engaging said posts.

1 14. A fixed mount single acting caliper
2 mounted on a bicycle frame in a position to straddle a
3 flexible brake disk,
4 a fixed brake pad mounted on one side of the
5 caliper;
6 a moveable brake pad mounted on the other side
7 of the caliper;
8 a brake actuator piston on the moveable brake
9 pad side of the brake disk in alignment with the outer
10 periphery of the brake disk whereby the flexible brake
11 disk is flexed into engagement with the fixed brake pad
12 upon actuation of the brake actuator piston

1 15. The caliper according to claim 14 wherein
2 said brake disk is initially located .010 inches from
3 both brake pads.

1 16. The hydraulic brake assembly according to
2 claim 7 wherein the brake disk comprises an outer
3 friction contact ring supported by a plurality of curved
4 legs, the curved legs being shaped to bend in compliance
5 with expansion of the outer friction contact ring which
6 occurs when the outer friction contact ring is heated.

1 17. The hydraulic brake assembly according to
2 claim 11 wherein the brake disk comprises an outer
3 friction contact ring supported by a plurality of curved
4 legs, the curved legs being shaped to bend in compliance
5 with expansion of the outer friction contact ring which
6 occurs when the outer friction contact ring is heated.

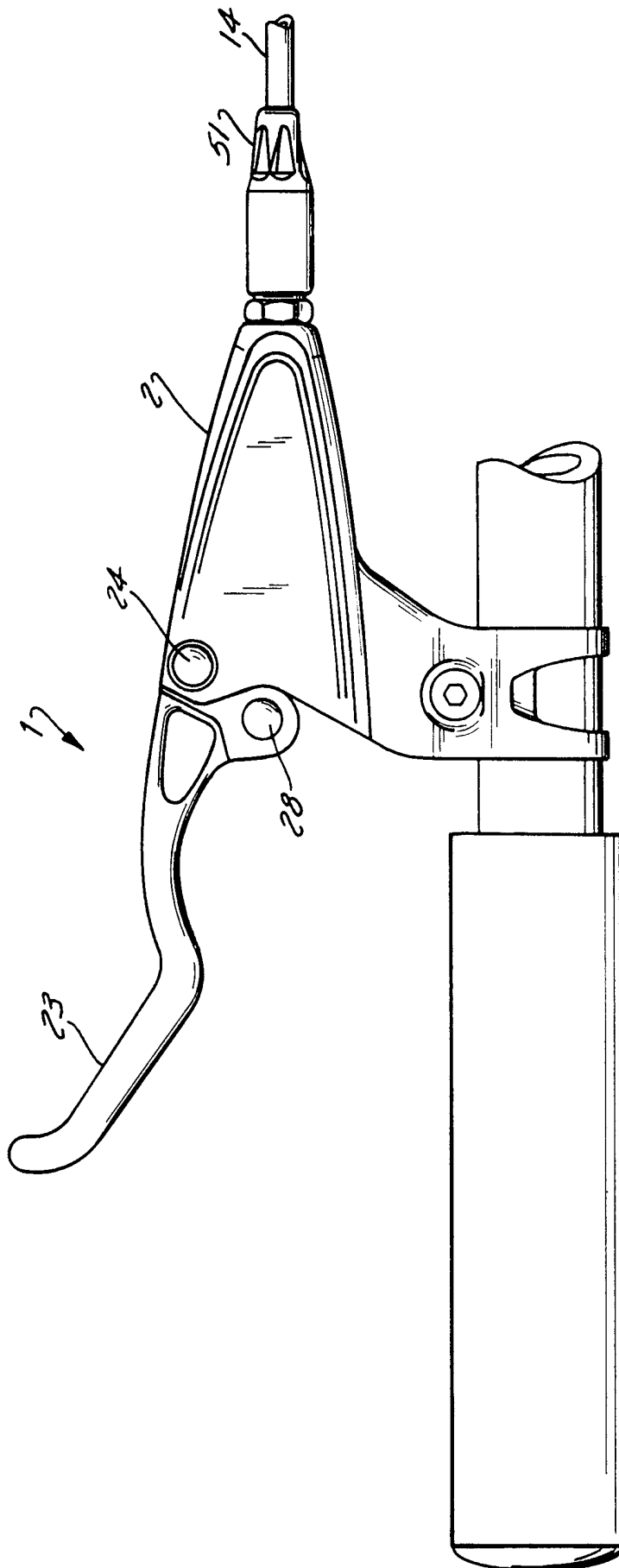

FIG. 1

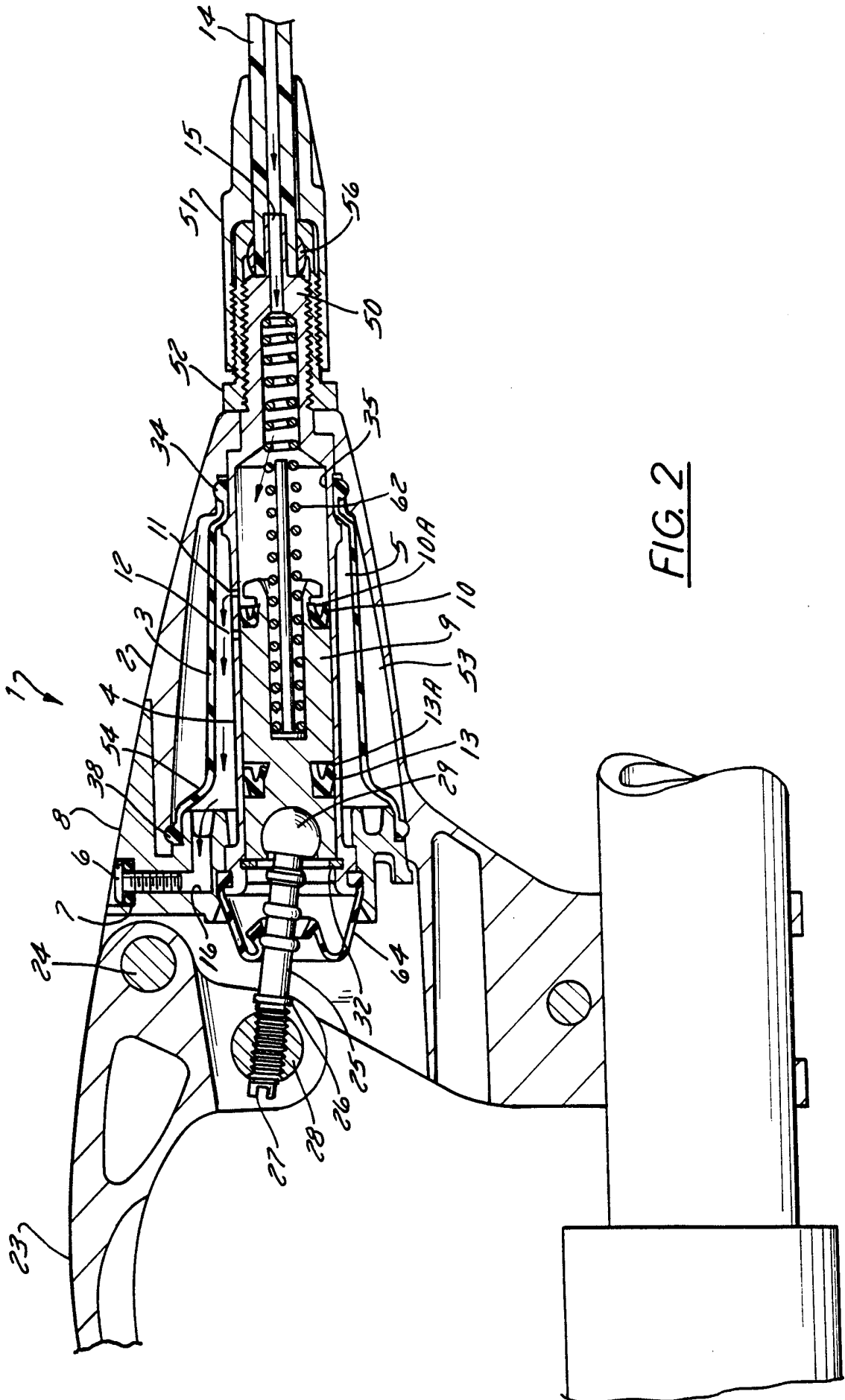

FIG. 2

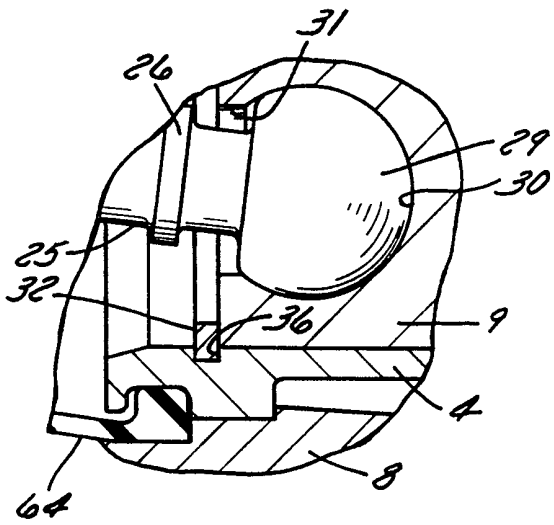

FIG. 2A

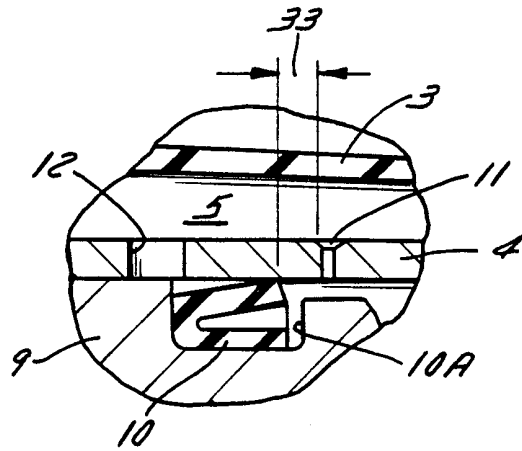

FIG. 2B

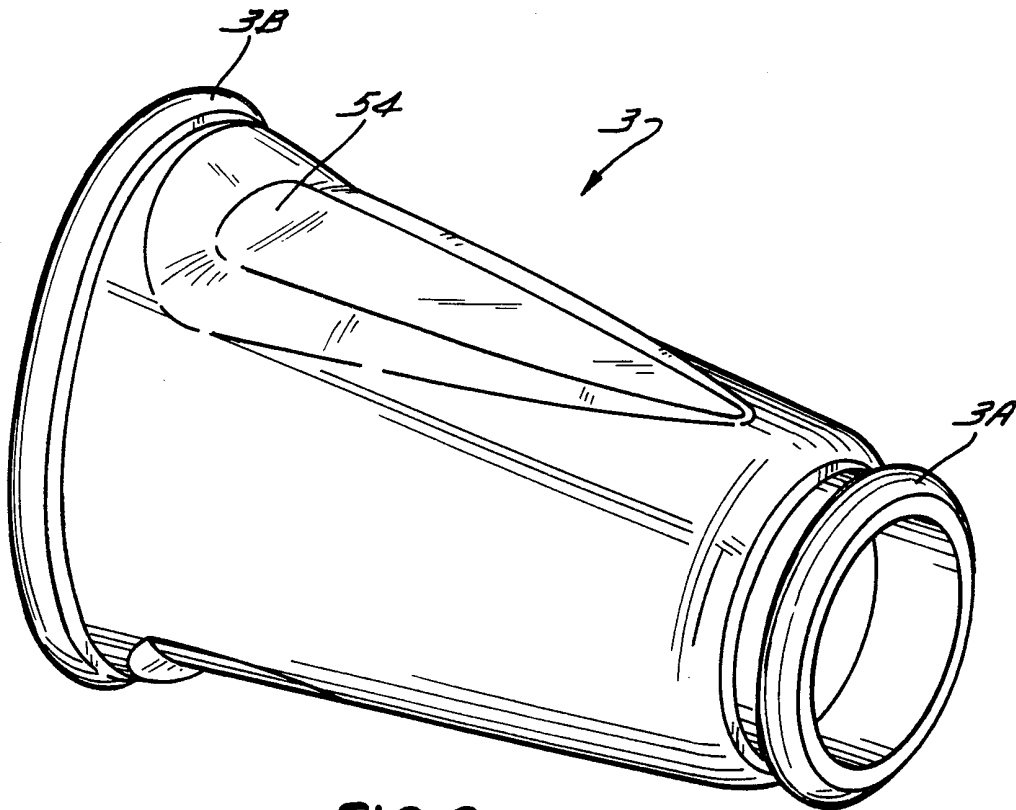

FIG. 3

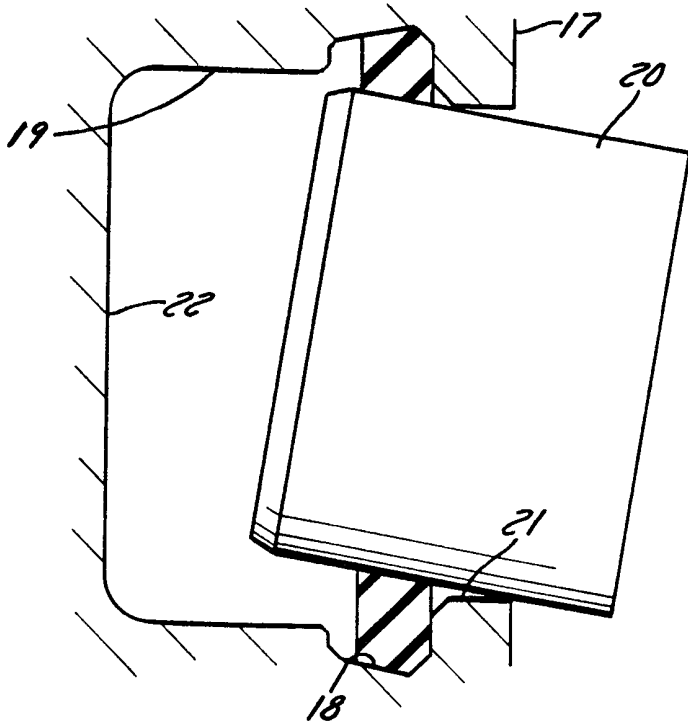

FIG. 4

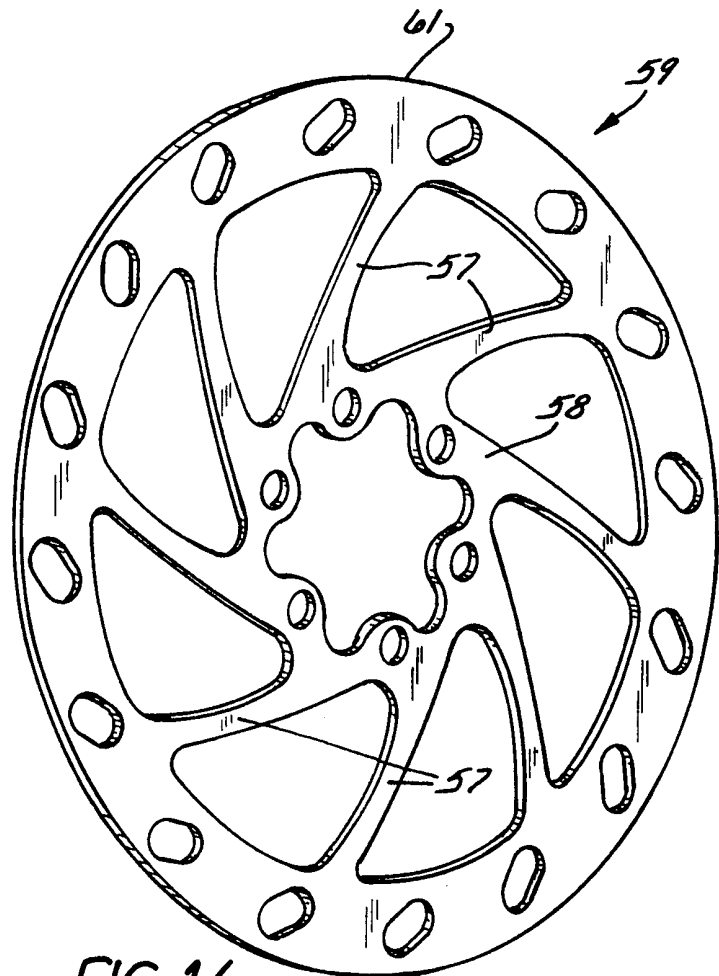

FIG. 14

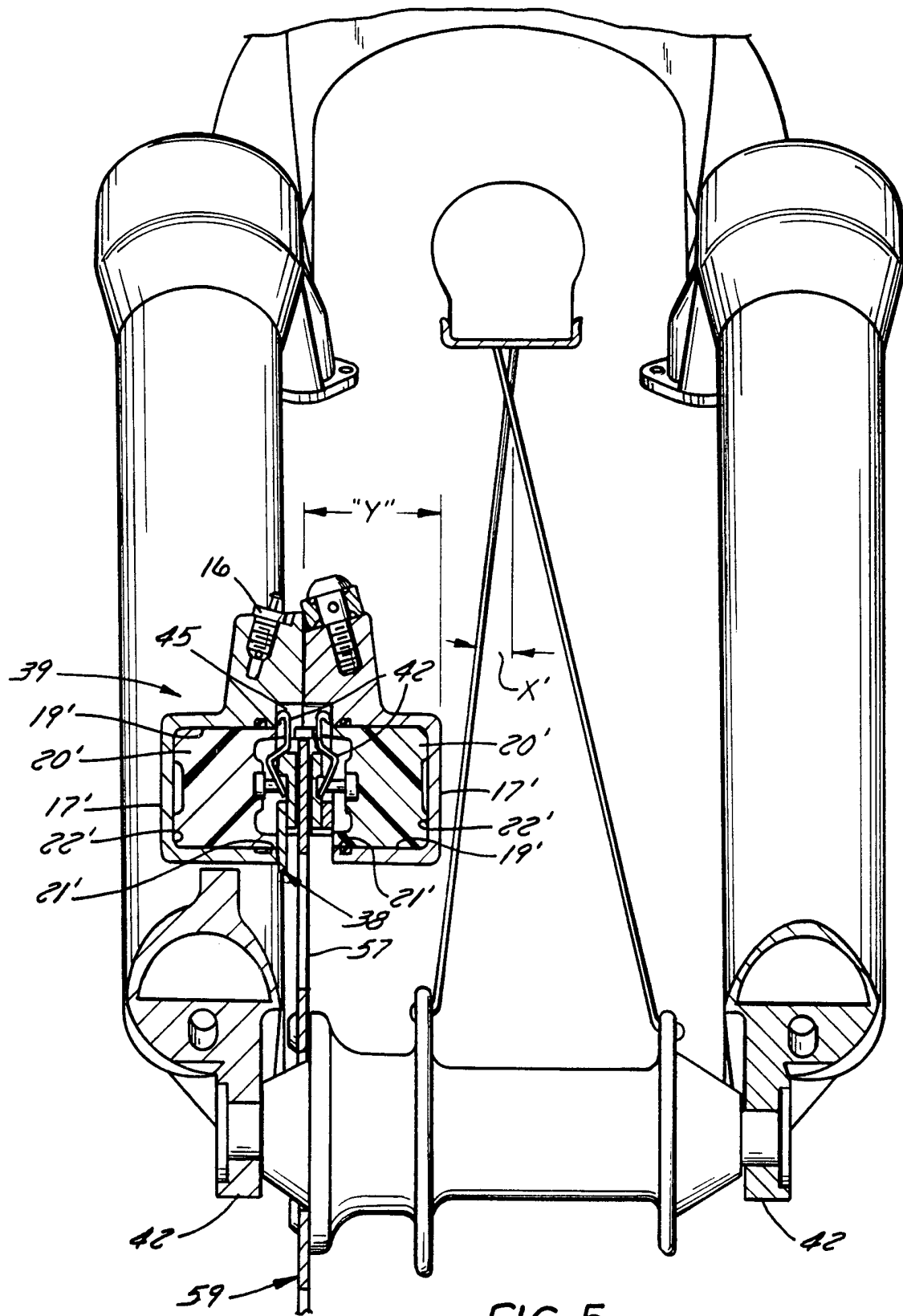

FIG. 5

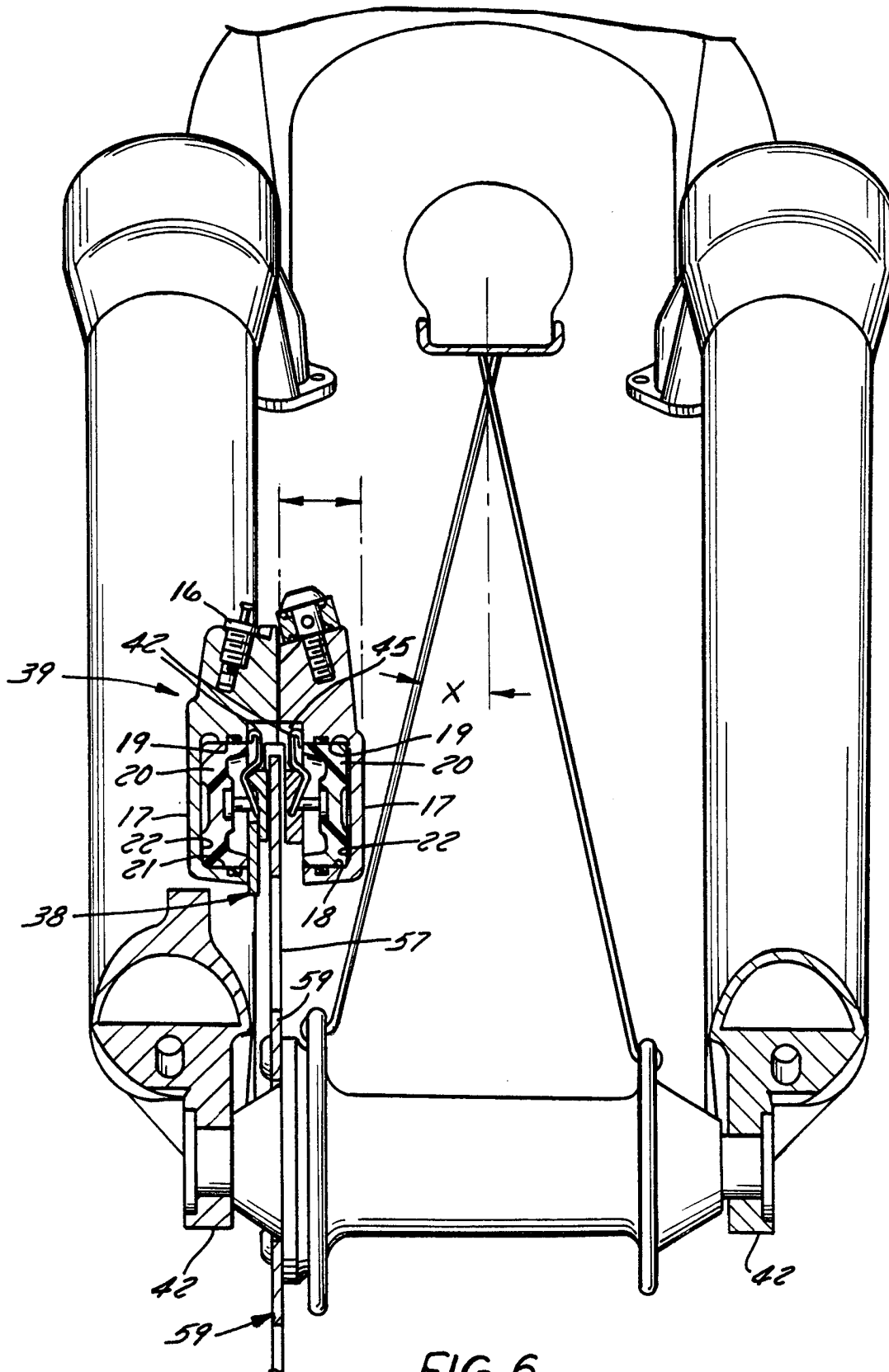

FIG. 6

7/10

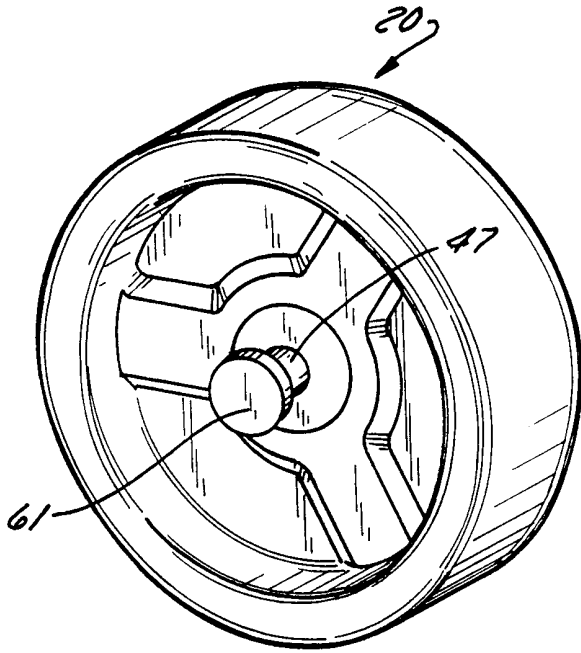

FIG. 8

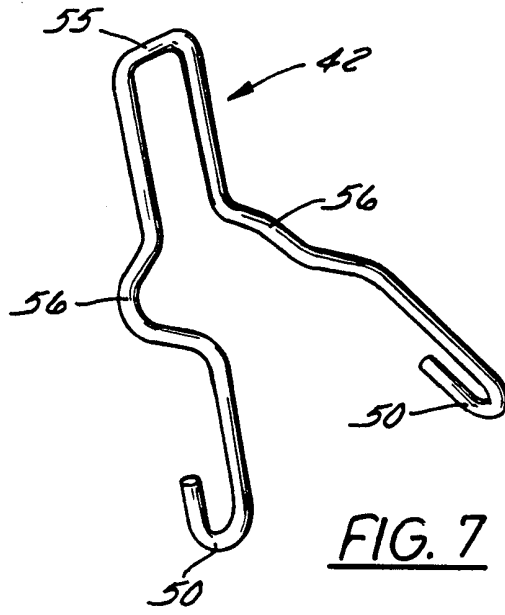

FIG. 7

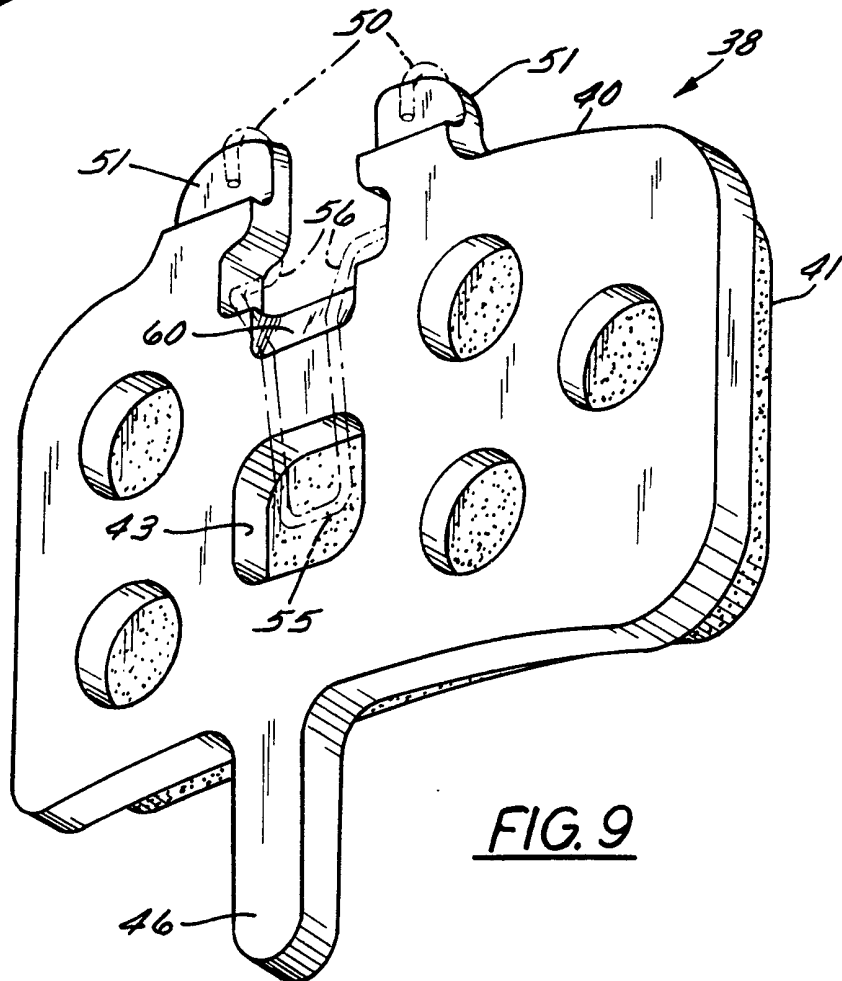

FIG. 9

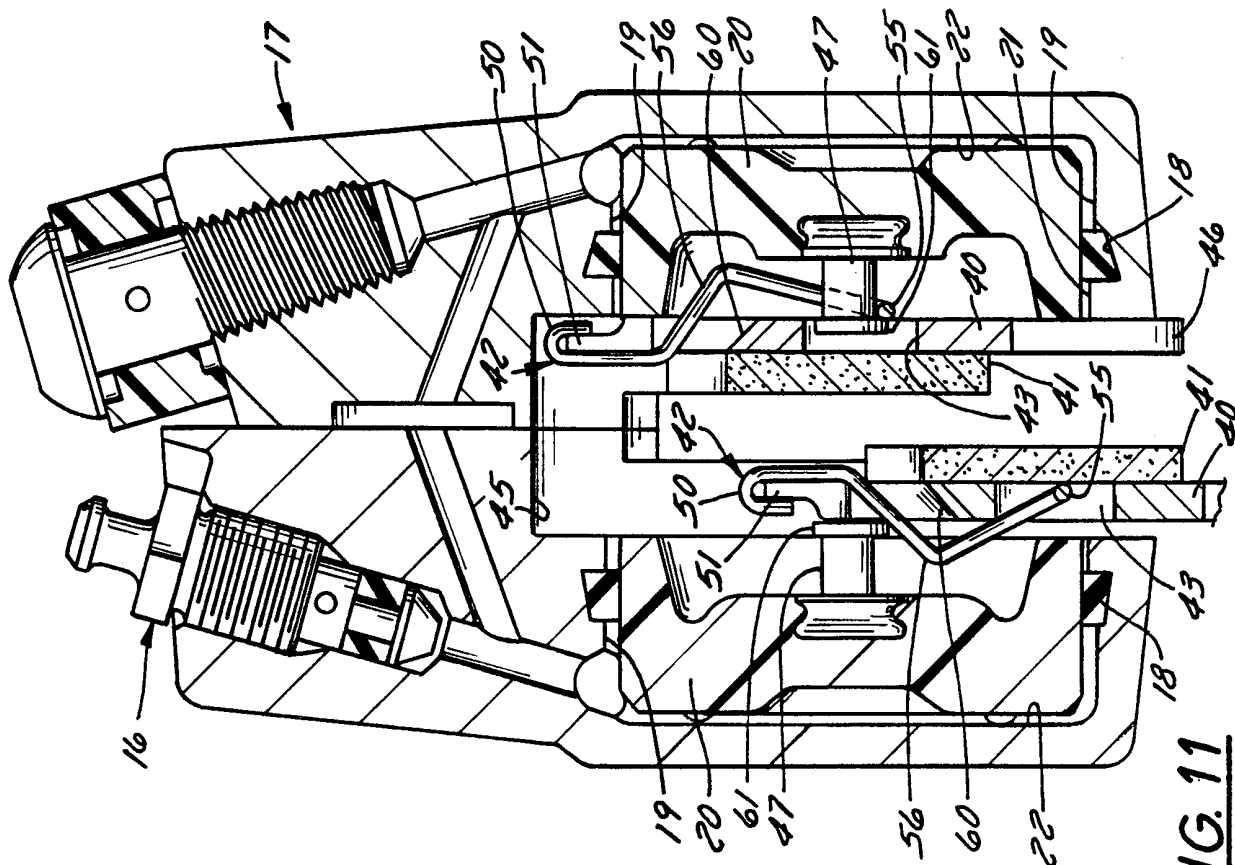

FIG. 11

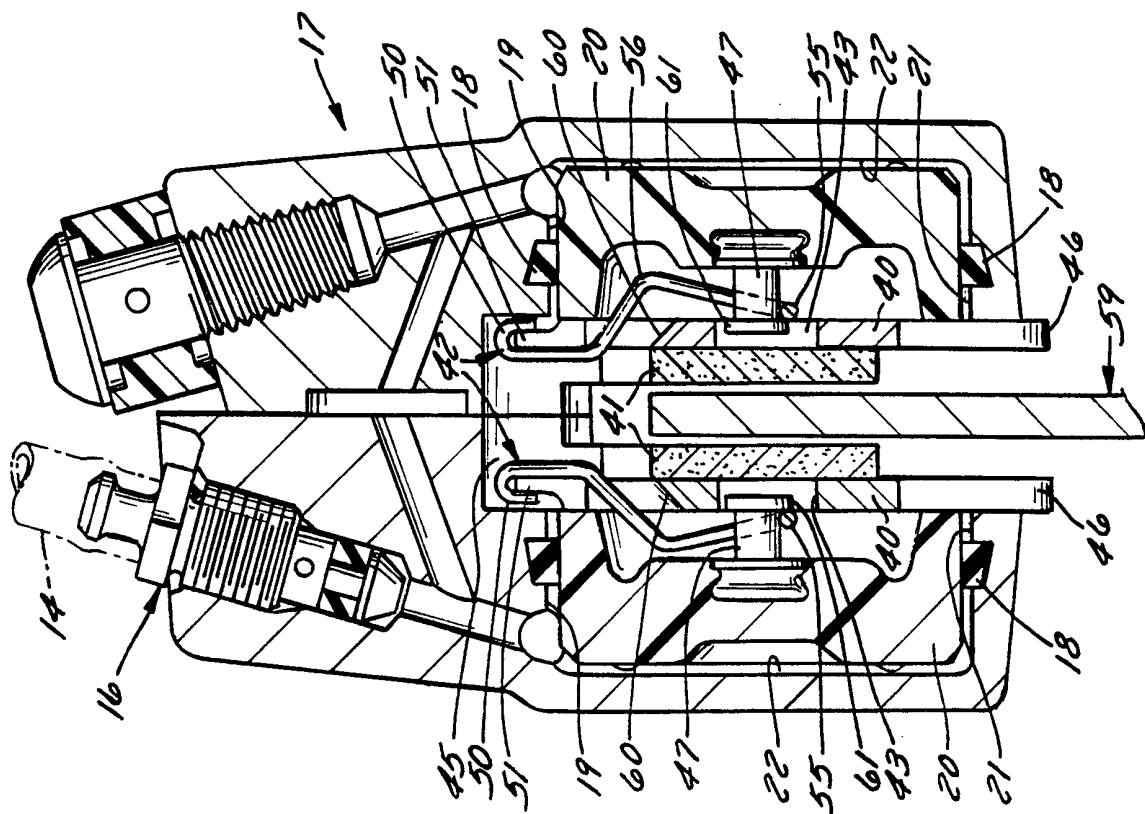

FIG. 10

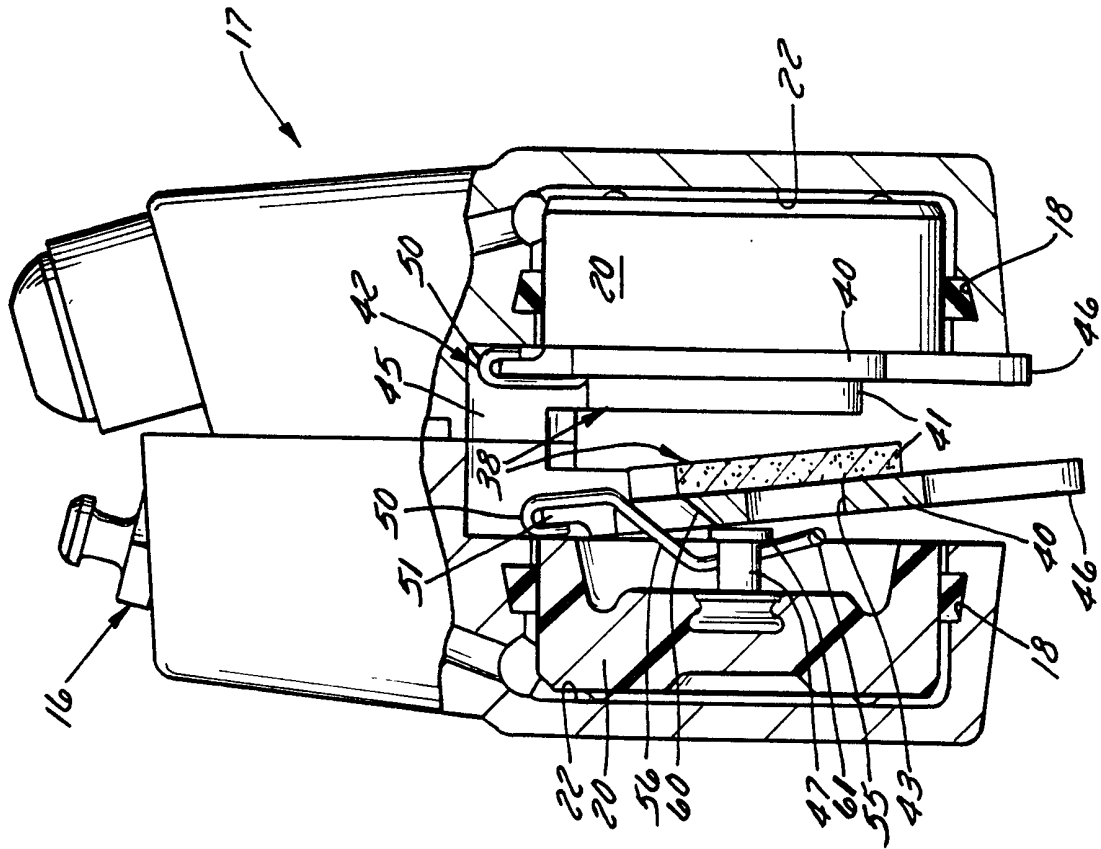

FIG. 13

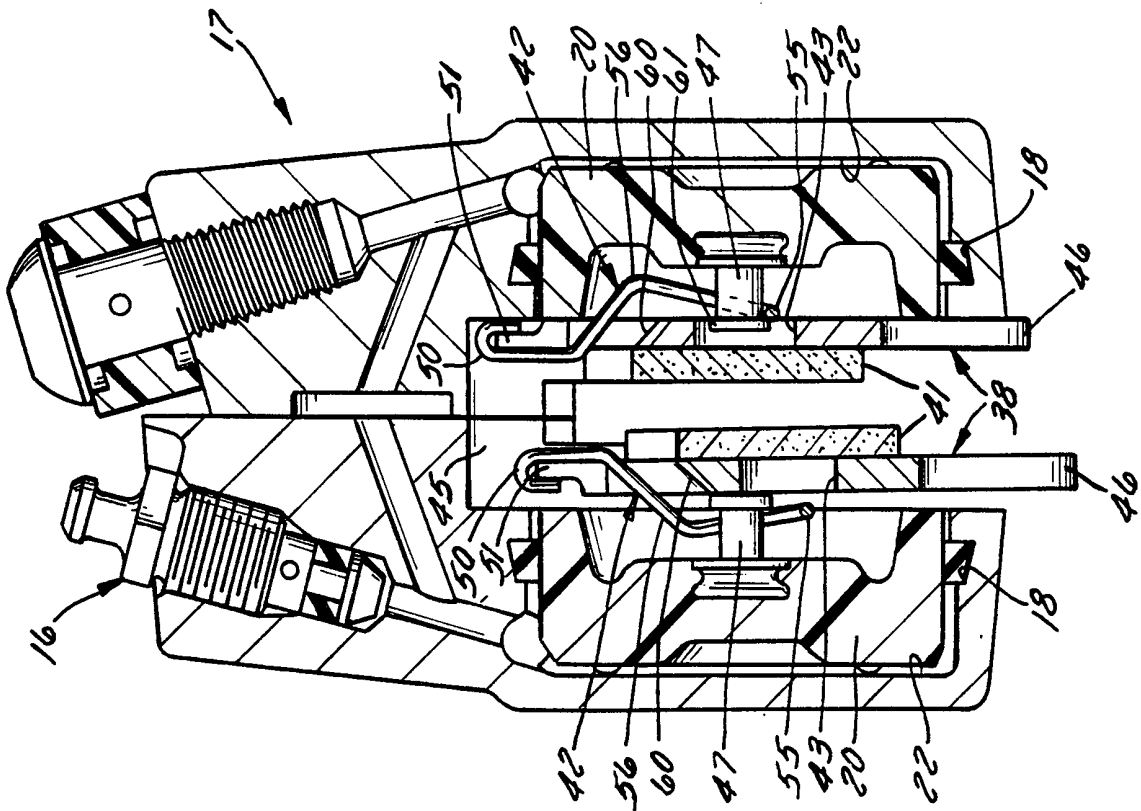

FIG. 12

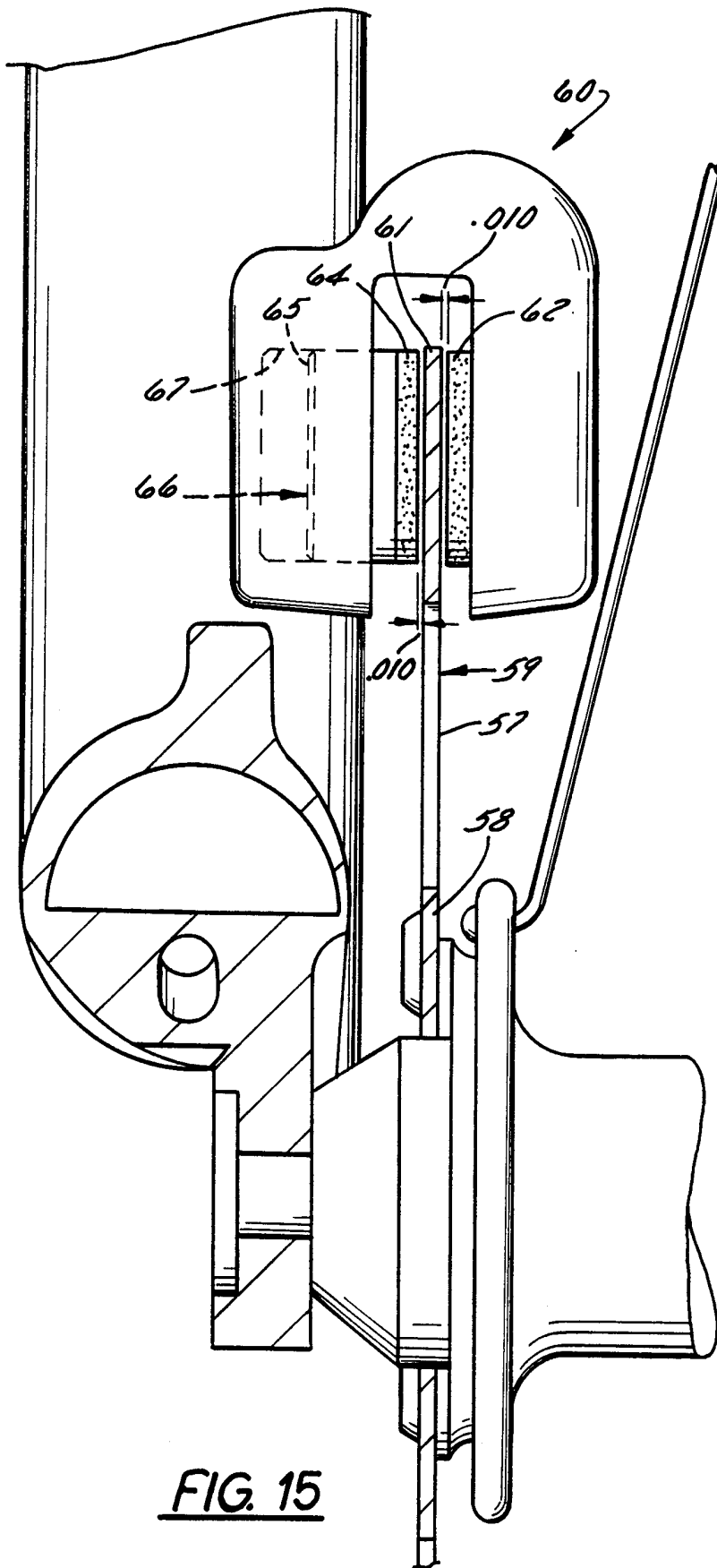

FIG. 15