



(51) International Patent Classification:

B63B 21/18 (2006.01) *B63B 21/50* (2006.01)
B63B 21/10 (2006.01) *B63B 22/02* (2006.01)
B63B 21/08 (2006.01)

(21) International Application Number:

PCT/GB2017/050278

(22) International Filing Date:

3 February 2017 (03.02.2017)

(25) Filing Language:

English

(26) Publication Language:

English

(30) Priority Data:

1602041.4 4 February 2016 (04.02.2016) GB

(71) Applicant: **BALLTEC LIMITED** [GB/GB]; Unit 2B, The Gateway, White Lund Industrial Estate, Morecambe Lancashire LA3 3PB (GB).

(72) Inventors: **TEIXEIRA, Marco Andre**; c/o Balltec Limited, Unit 2B, The Gateway, White Lund Industrial Estate, Morecambe LA3 3PB (GB). **PRESTON, Jonathan Scott**;

8 Rusland Drive, Houghton, Preston Lancashire PR5 0HQ (GB). **JACKSON, Jonathan Fletcher**; 27 Harwood Close, Stalmine, Poulton-le-Fylde FY6 0QA (GB). **PARRY, William David Loton**; 23 Station Way, Garstang, Preston Lancashire PR3 1DN (GB).

(74) Agent: **WILSON GUNN (MANCHESTER)**; 5th Floor, Blackfriars House, The Parsonage, Manchester Lancashire M3 2JA (GB).

(81) Designated States (unless otherwise indicated, for every kind of national protection available): AE, AG, AL, AM, AO, AT, AU, AZ, BA, BB, BG, BH, BN, BR, BW, BY, BZ, CA, CH, CL, CN, CO, CR, CU, CZ, DE, DJ, DK, DM, DO, DZ, EC, EE, EG, ES, FI, GB, GD, GE, GH, GM, GT, HN, HR, HU, ID, IL, IN, IR, IS, JP, KE, KG, KH, KN, KP, KR, KW, KZ, LA, LC, LK, LR, LS, LU, LY, MA, MD, ME, MG, MK, MN, MW, MX, MY, MZ, NA, NG, NI, NO, NZ, OM, PA, PE, PG, PH, PL, PT, QA, RO, RS, RU, RW, SA, SC, SD, SE, SG, SK, SL, SM, ST, SV, SY, TH, TJ, TM, TN, TR, TT, TZ, UA, UG, US, UZ, VC, VN, ZA, ZM, ZW.

[Continued on next page]

(54) Title: MOORING CONNECTOR ASSEMBLY

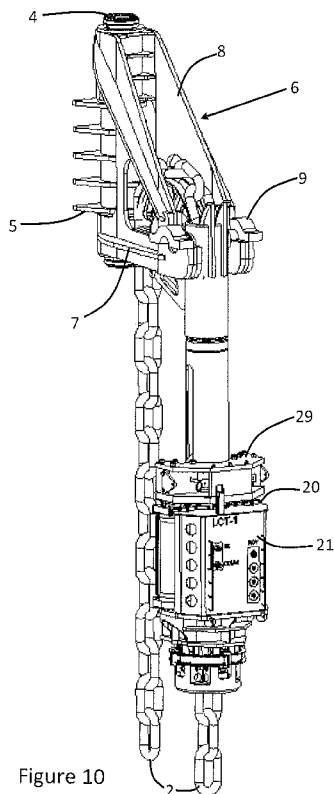

Figure 10

(57) Abstract: A mooring connector assembly (3) has a body (10) arranged to be pivotally mounted to a structure (1), such as a tethered buoy, to be moored for movement about a pivot axis. At least a part of the body extends below the pivot axis when so mounted and oriented for use. A line stopper (17) is mounted to the part of the body which extends below the pivot axis in use and is operative to retain a mooring line (2) relative to the body. The body is configured to receive a tensioner (20) for tensioning a mooring line (2) retained by the stopper such that the tensioner urges the line at a point which is below the pivot axis when the body is oriented for use. The body may be an elongate tube (10) pivotally connected to a structure to be moored (1) at one end and fitting with a chain stopper (17) at the opposite end. The tube is configured to receive a chain tensioner (20) between the chain stopper (17) and pivot axis.





- (84) Designated States** (*unless otherwise indicated, for every kind of regional protection available*): ARIPO (BW, GH, GM, KE, LR, LS, MW, MZ, NA, RW, SD, SL, ST, SZ, TZ, UG, ZM, ZW), Eurasian (AM, AZ, BY, KG, KZ, RU, TJ, TM), European (AL, AT, BE, BG, CH, CY, CZ, DE, DK, EE, ES, FI, FR, GB, GR, HR, HU, IE, IS, IT, LT, LU, LV, MC, MK, MT, NL, NO, PL, PT, RO, RS, SE, SI, SK, SM, TR), OAPI (BF, BJ, CF, CG, CI, CM, GA, GN, GQ, GW, KM, ML, MR, NE, SN, TD, TG).
- Published:**
- *with international search report (Art. 21(3))*
 - *before the expiration of the time limit for amending the claims and to be republished in the event of receipt of amendments (Rule 48.2(h))*

MOORING CONNECTOR ASSEMBLY

Technical Field of the Invention

The present invention relates to a mooring connector assembly, particularly although not exclusively, for a tethered buoy.

5 Background to the Invention

It is known to use subsea buoys in hydrocarbon production facilities. These buoys are tethered to the seabed with mooring chains in order to maintain them in a desired position. The chains are connected to the buoys by way of connector assemblies which can accommodate a chain tensioner to enable the tension in a mooring chain
10 connected to the connector assembly to be adjusted.

A connector assembly is disclosed in GB 2496860. The assembly comprises a support mounted to a subsea buoy. A lever member is mounted to the support by way of a flex joint allowing the lever to move relative to the support about a pivot axis. A chain stop mechanism is mounted to the support below the pivot axis. A frame rests on
15 and extends above the support and a sheave is mounted to the frame at a position above the pivot axis. In use a chain extends from the sea bed into the chain stop mechanism, up through the lever member and over the sheave with the free end of the chain hanging down from the sheave. A chain tensioning unit may be supported on top of the support, at a position above the pivot axis, and arranged to tension the chain to enable tension in
20 the chain to be adjusted.

The chain stop mechanism prevents downward movement of the chain through the lever member and so, in normal use, maintains tension in the chain between the sea bed and the buoy. The flex joint allows the lever member to pivot relative to the buoy

under tension in the chain so that the chain extends in a substantially straight path from the seabed to the chain stop mechanism as the buoy moves relative to the sea bed, thus avoiding undesirable stress concentrations in the chain.

When it is desired to adjust tension in the chain a chain tensioner unit is placed
5 onto the support. The chain tensioner unit includes jacks which engage with the chain extending from the lever member to the sheave in order to tension the chain and draw it up through the chain stop mechanism to either increase tension in the chain between the chain stop mechanism and the sea bed or, by taking load off the chain stop mechanism allowing it to be released, to decrease tension by allowing chain to pass
10 downwardly through the chain stop mechanism.

A problem has, however, been found with the assembly in that when the chain tensioner unit takes up load on the chain undesirable stress concentrations can build up in the chain. Since the chain tensioner unit is in a fixed position relative to the support the chain may no longer extend in a substantially straight path between the point at
15 which it is supported (i.e. the chain tensioner unit) and the sea bed. Additionally, the chain may no longer extend in a straight path from the chain tensioner unit and the lever member which can make it difficult to disengage the chain tensioner and/or cause damage to the lever member. These issues cause additional wear on the chain, potentially leading to its premature failure.

20 Embodiments of the present invention have been made in consideration of these problems.

Summary of the Invention

According to a first aspect of the present invention there is provided a mooring connector assembly comprising:

a body arranged to be pivotally mounted to a structure to be moored for movement about a pivot axis, at least a part of the body extending below the pivot axis
5 when so mounted and oriented for use, and

a stopper mounted to the part of the body which extends below the pivot axis in use and operative to retain a mooring line relative to the body, wherein the body is configured to receive a tensioner for tensioning a mooring line retained by the stopper such that the tensioner urges the line at a point which is below the pivot axis when the
10 body is oriented for use.

Since both the stopper and tensioner are arranged to hold a mooring line at a point beneath the pivot axis in use, when tension is maintained in the line either by the stopper or tensioner that tension will cause the body to pivot about the pivot axis so that the line is substantially straight. This reduces stress concentrations in the line.

15 The part of the body which extends below the pivot axis in use may be configured to receive a tensioner, in particular it may comprise a formation and/or fitting for supporting a tensioner. The body may be configured to receive a tensioner in a position between the stopper and the pivot axis when the body is oriented for use.

The body may be an elongate member. The body may be a tube.

20 One end of the elongate member may be arranged to be pivotally mounted to a structure. The stopper may be mounted to the opposite end of the body.

The body may define an internal space through which a mooring line extends, in use. Where the body comprises a tube the line may extend through the tube.

The body may comprise one or more openings into the internal space through which a tensioner may extend in use. The or each opening may be an elongate slot.

5 One or more line management structures may be mounted to the body. One structure may be a sheave, wheel or slide for guiding the free end of mooring line extending from the stopper or a tensioner. The line may be a chain. In this case the body may comprise surfaces defining a cruciform space through which the chain may run. The stopper may be a chain stopper.

10 The mooring connector assembly may further comprise a bracket to be mounted to a structure to be moored and the body may be pivotally mounted to the bracket. One of the body and bracket may comprise one or more trunnions and the other one or more bearings for receiving the or each trunnion. The bracket may be arranged to be pivotally mounted to a structure to be moored. The bracket may be arranged to pivot through a
15 first axis relative to the structure and the body may be arranged to pivot through a second axis relative to the bracket. The first and second axes may be substantially perpendicular.

A line tensioner may be mounted to the connector assembly and arranged to tension a mooring line retained by the stopper by urging the line at a point which is
20 below the pivot axis when the body is oriented for use. The line tensioner may be a chain jack.

According to another aspect of the invention there is provided subsea buoy having a connector assembly according to the first aspect of the invention mounted thereto.

Detailed Description of the Invention

5 In order that the invention may be more clearly understood an embodiment thereof will now be described, by way of example only, with reference to the accompanying drawings, of which:

- Figure 1 shows part of a subsea buoy fitted with mooring connector assemblies;
- Figure 2 is a perspective view of one of the mooring connector assemblies of
10 figure 1;
- Figure 3 is an end elevation of the assembly of figure 2;
- Figure 4 is a plan view of the assembly of figure 2;
- Figure 5 is a partially cut away side elevation of the assembly of figure 2;
- Figure 6 is a perspective view of part of the assembly of figure 3 with chain
15 removed;
- Figure 7 is a plan view of the apparatus of figure 6;
- Figure 8 is a perspective view of a chain tensioner;
- Figure 9 is an end view of the chain tensioner of figure 8;
- Figure 10 is a corresponding view to figure 2 with the chain tensioner mounted to
20 the mooring connector assembly; and
- Figure 11 is an end view of the apparatus shown in figure 10.

In the following the terms up, down, top, bottom and like terms are used to describe the apparatus in the orientation in which it is depicted in figures 2 to 11 of the drawings but are not intended to be otherwise limiting. In use, the apparatus will typically adopt the orientation shown in figure 1.

5 Referring to the drawings, a subsea buoy 1 or other midwater structure (which may take any suitable form) is secured in position relative to the sea bed by a plurality of mooring chains 2. The mooring chains extend from suitable anchorages on or near the sea bed (not shown) to mooring connector assemblies 3 mounted to the buoy.

Each mooring connector assembly comprises a generally cylindrical pivot pin
10 4. The pivot pin 4 is mounted to a side of the buoy, in a upright orientation, by a series (five in illustrated embodiment) of plates 5 spaced evenly along part of the length of the pin. The plates 5 encircle the pin 4, to which they are welded or otherwise fastened, and have an edge which matches the external surface of the buoy and is welded or otherwise fastened to the buoy so as to mount the pivot pin in a position spaced from
15 the surface of the buoy with the pin extending both above the uppermost plate 5 and below the lowermost plate.

A bracket 6 is pivotally mounted to the pin 4 for partial rotation about the pin. The bracket comprises a lower pair of arms 7 which extend generally horizontally out from a bearing mounted to the part of the pin 4 projecting below the mounting plates 5,
20 and an upper pair of arms 8 which form tension struts extending diagonally from a bearing mounted to the part of the pin 4 projecting above the mounting plates 5 to a position near the free end of the lower arms 7. A pair of generally horizontally disposed bearings 9 are provided at the free end of the lower arms 7.

An elongate downtube 10 is suspended from the bracket. Trunnions 11 are provided on opposite sides of downtube close to its top end and received into the bearings 9 on the bracket 6 thus enabling the downtube to pivot about a horizontal axis relative to the bracket 6. A chain support 12 is mounted to the outside of the top end of the downtube 10 so that, in use, it extends between the two lower arms 7 of the bracket 6. The chain support provides two spaced apart, parallel, convex arcuate surfaces 13 extending from just within the top of the downtube 10 radially away from the axis of the downtube in an upright plane. The surfaces extend through approximately 180 degrees. Diametrically opposite these surfaces 13 within the top of the downtube 10 are a second pair of arcuate, convex chain support surfaces 14 which mirror surfaces 13 but extend through a smaller angle. Within the downtube the four surfaces 13, 14 define a cruciform space through which, in use, the mooring chain extends.

Two diametrically opposed elongate slots 15 are formed through the wall of the downtube. The slots extend parallel to the axis of the downtube from a position below the chain support 12 to a position about midway along the length of the downtube. Each slot 15 is positioned beneath one of the trunnions 11.

Two, spaced apart, substantially parallel guide rods 16 are mounted on the outside surface of the downtube 10, spaced from the surface of the downtube and extending generally parallel to the axis of the downtube from a position below the elongate slots 15 to a position spaced above the bottom of the downtube.

A one chain link resolution chain stopper 17 is mounted to the bottom of the downtube. The chain stopper 17 is of a size greater than the diameter of the downtube and the upper surface of the chain stopper supports two positioning pins 18.

The chain stopper 17 comprises chain dogs which are arranged to allow chain 2 to pass through the stopper upwardly into the downtube 10 but not to pass in the reverse direction. The chain stopper 17 comprises a release lever 19 which is operable to release the chain dogs (when the load of the chain has been removed from them) to permit
5 chain to pass downwardly through the stopper out of the downtube.

In use a mooring chain 2 extends from an anchor point up through the chain stopper 17, through the downtube 10, out of the top of the downtube and over the chain support 12 with its free end hanging down from the chain support 12. As the chain stopper prevents chain passing downwardly out of the downtube 10 it keeps the chain
10 under tension between the mooring connector assembly and the anchor point. Bearings 9 on the bracket and the bearings on the pivot pins 4 allow the downtube to pivot about two substantially perpendicular axes with tension in the chain, so that the chain maintains a substantially straight path between the anchor point and the chain stopper. Mass of the free end of the chain 2 hanging from the chain support 12 keep the region
15 of chain between the chain stopper 17 and chain support 12 under tension, but far less tension than the region extending from the chain stopper 17 to the anchor point. The chain 2 is held in a fixed rotational position relative to the downtube 10 by the chain stopper 17, and in the same fixed rotational position relative to the downtube by the cruciform space formed by the chain support surfaces 13 and 14 at the top of the
20 downtube 10, with the result that the chain within the downtube 10 is supported in a fixed rotational orientation relative to the downtube.

When it is desired to adjust tension in the chain a chain tensioner 20 is deployed. The chain tensioner comprises a body 21 arranged to be mounted onto the downtube 10, engaging with the guide rods 16 and locating over the positioning pins 18 on the

chain stopper 17. The body is provided with grab handles 22 to facilitate its handling by an ROV (remotely operated vehicle). The body also comprises an electrical power connection 23, a fibre optic data communication connection 24 for control and instrumentation communication with the tensioner, a hot stab receptacle 25 for emergency override as well as ROV operable valves 26 for override functions. The body further comprises a pair of hydraulic lift cylinders 27, the pistons of which are connected to rams connected to chain dogs 28 which are pivotally mounted to a yoke 29. A further hydraulic cylinder 30 is mounted to the yoke 29 and is operable to move the chain dogs 28 between extended and retracted positions. A pair of further hydraulic cylinders 31 is mounted towards the bottom of the body, arranged to operate the chain stopper release lever 19 when the tensioner is mounted on the downtube.

In use the tensioner 20 is mounted, as shown in figures 10 and 11, on the downtube of a mooring connector assembly, with the bottom of the body 21 of the tensioner locating over the positioning pins 18 on the chain stopper. This places the hydraulic cylinders 31 adjacent the release lever of the chain stopper. It also places the yoke 29 adjacent the downtube so that the chain dogs 28 lie adjacent the bottom of the elongate slots 15 formed in the downtube 10. Connections are made to the power 23 and communication 24 connections from an umbilical, or via an ROV, to a control point to enable operation of the tensioner.

To tension the mooring chain cylinder 30 is activated to move the chain dogs 28 into their extended positions in which they extend into the elongate openings 15 in the downtube and contact the chain running in the downtube. The lift cylinders 27 are then operated, causing the yoke 29 to move from its home position closest the body 21 of the tensioner as shown in figure 10 towards an extended position, shown in figure

11. As the yoke 29 moves the chain dogs 28 engage with a link of the chain and lift and draw the chain through the chain stopper 17 and downtube 10. When one (or more, as desired and as the stroke of the lift cylinders and size of the chain permit) link(s) of chain 2 have been drawn through the chain stopper the lift cylinders are retracted. As
5 the cylinders retract the chain will once again be supported by the chain stopper 17 with the dogs of the chain stopper supporting a link of the chain below that at which it was previously supported.

To slacken the mooring chain 2 the lift cylinders are partially extended before the chain dogs 28 are moved to the extended position. The lift cylinders are then further
10 extended, sufficient to take the load of the chain 2 off the chain stopper 17. Then, cylinders 31 are operated to move the chain stopper release lever to move the chain dogs of the chain stopper away from the path of the chain, after which the lift cylinders are retracted to a point below their starting point allowing chain to pass down through the chain stopper. The chain stopper release lever is then released allowing the chain
15 dogs of the chain stopper to move back into the path of the chain, and the lift cylinders retracted further allowing tension in the chain to be again taken up by the chain stopper. In the case the dogs of the chain stopper will now support the chain by a link above that at which the chain was previously supported.

After both tensioning and slackening operations the chain dogs on the yoke can
20 be moved to the retracted position to enable the chain tensioner to be removed from the mooring assembly.

During both tensioning and slackening operations the chain is for a time supported by the chain dogs of the tensioner, rather than by the chain stopper.

Throughout the operation, though, the chain maintains a substantially straight path from the sea bed to the chain stopper as the chain is always supported from a point below the axes about which downtube can pivot. Therefore tension in the chain continues to align the downtube such that the chain adopts a substantially straight path. This avoids stress concentrations in the chain, prolonging life of the chain.

The above embodiment is described by way of example only. Many variations are possible without departing from the scope of the invention as defined by the appended claims.

CLAIMS

1. A mooring connector assembly comprising:
 - 5 a body arranged to be pivotally mounted to a structure to be moored for movement about a pivot axis, at least a part of the body extending below the pivot axis when so mounted and oriented for use, and
 - a stopper mounted to the part of the body which extends below the pivot axis in use and operative to retain a mooring line relative to the body, wherein the body is configured to receive a tensioner for tensioning a mooring line retained by the stopper such that the tensioner urges the line at
10 a point which is below the pivot axis when the body is oriented for use.
2. A mooring connector assembly as claimed in claim 1 wherein the part of the body which extends below the pivot axis in use is configured to receive the tensioner.
3. A mooring connector assembly as claimed in claim 2 wherein the body is
15 configured to receive a tensioner in a position between the stopper and the pivot axis when the body is oriented for use
4. A mooring connector assembly as claimed in any preceding claim wherein the body is an elongate member.
5. A mooring connector assembly as claimed in claim 4 wherein the elongate
20 member is a tube.

6. A mooring connector assembly as claimed in either claim 4 or 5 wherein one end of the elongate member is arranged to be pivotally mounted to a structure, and the stopper is mounted to the opposite end of the elongate body.
7. A mooring connector assembly as claimed in any preceding claim wherein the
5 body defines an internal space through which a mooring line extend, in use.
8. A mooring connector assembly as claimed in claim 8 wherein the body comprises one or more openings into the internal space through which a tensioner may extend in use.
9. A mooring connector assembly as claimed in any preceding claim wherein a
10 line management structure is mounted to the body.
10. A mooring connector assembly as claimed in any preceding claim wherein the stopper is a chain stopper.
11. A mooring connector assembly as claimed in any preceding claim further comprising a bracket to be mounted to a structure to be moored and wherein the
15 body is pivotally mounted to the bracket.
12. A mooring connector assembly as claimed in claim 11 wherein the bracket is arranged to be pivotally mounted to a structure to be moored.
13. A mooring connector assembly as claimed in any preceding claim having a
20 tensioner mounted thereon arranged to tension a mooring line retained by the stopper by urging the line at a point which is below the pivot axis when the body is oriented for use.

14. A mooring connector assembly as claimed in claim 13 wherein the line tensioner is a chain jack.
15. A subsea buoy having a connector assembly as claimed in any preceding claim mounted thereto.

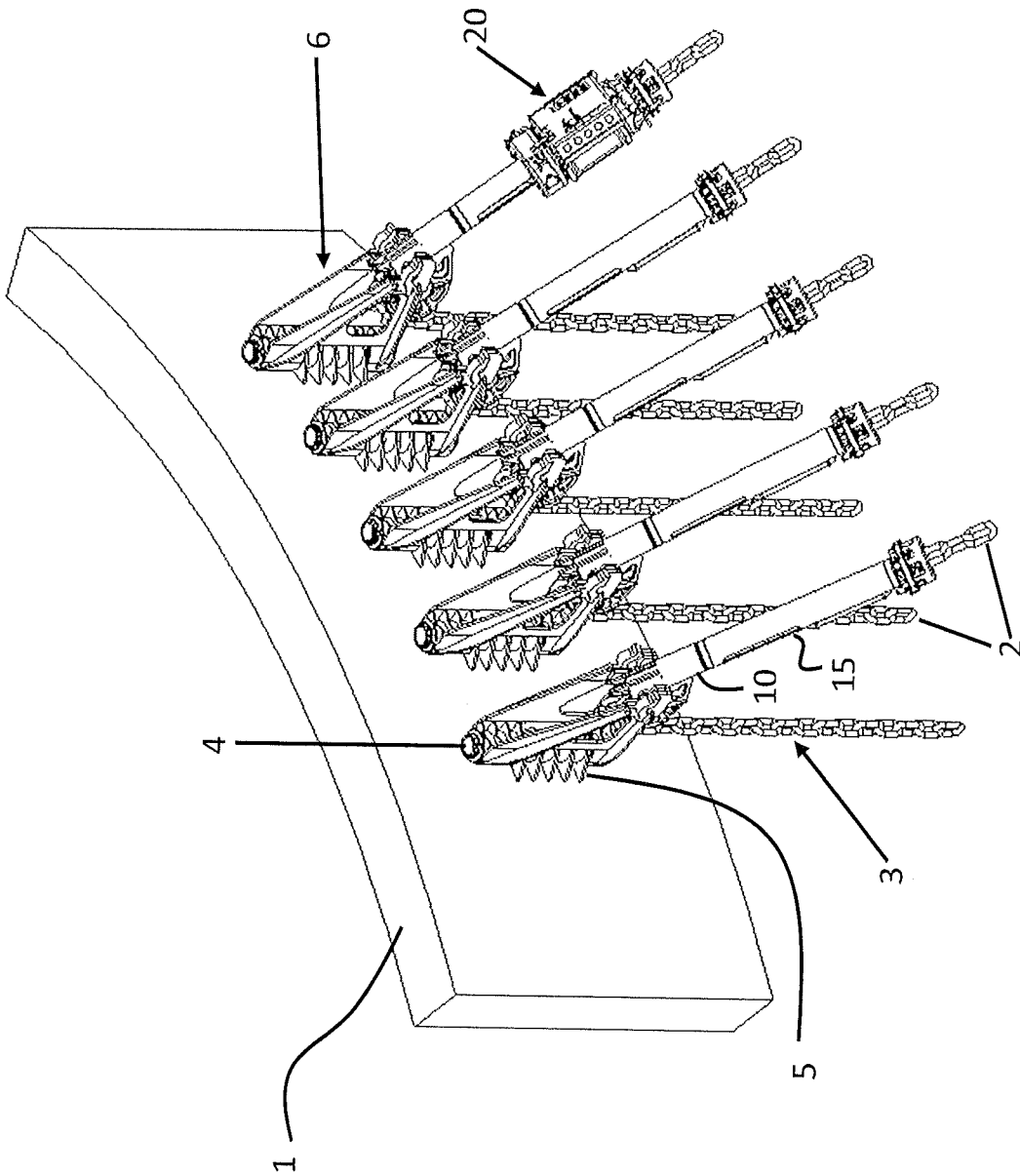

Figure 1

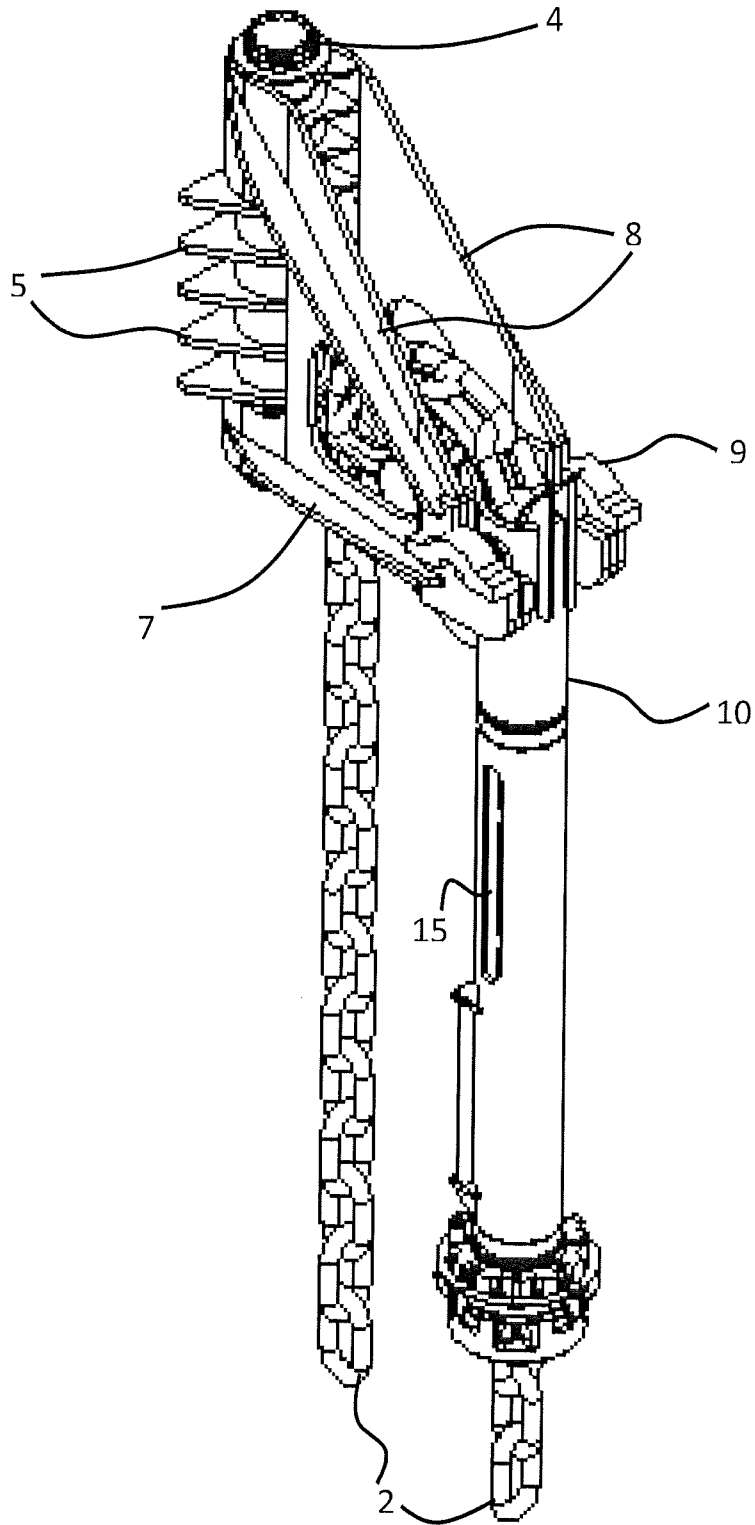

Figure 2

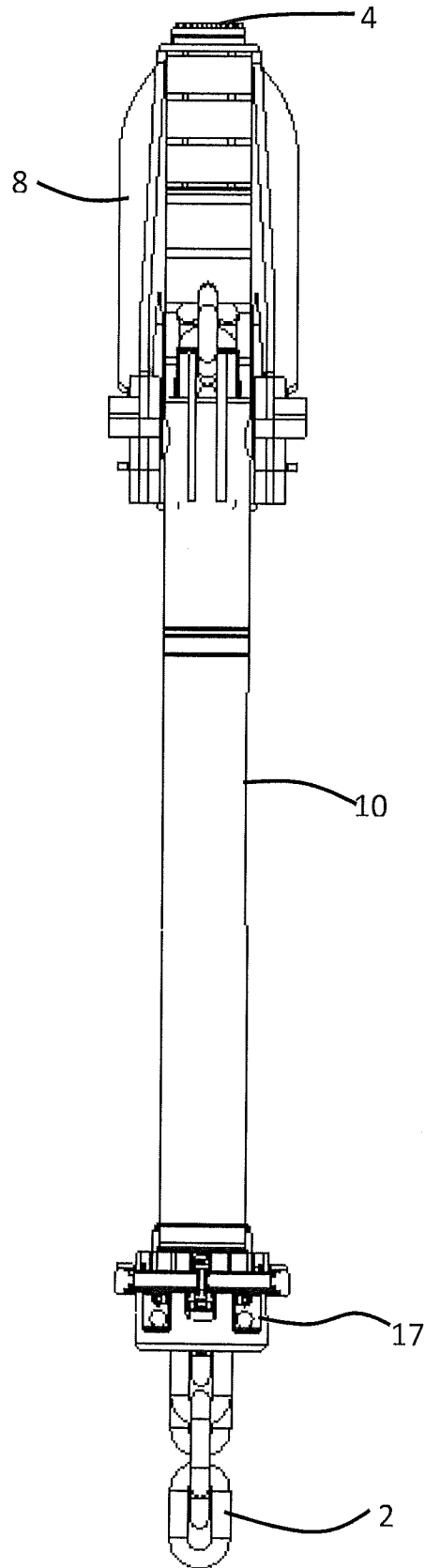

Figure 3

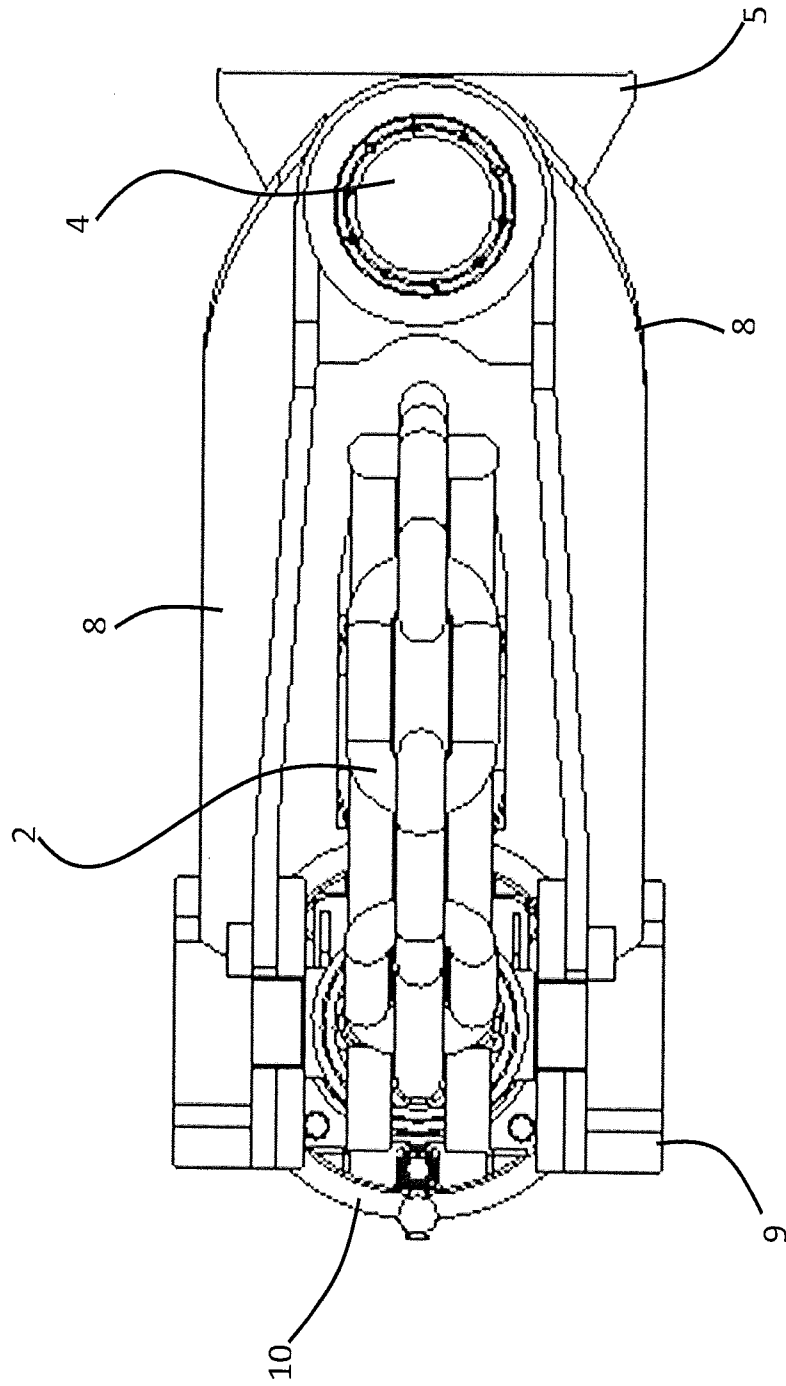

Figure 4

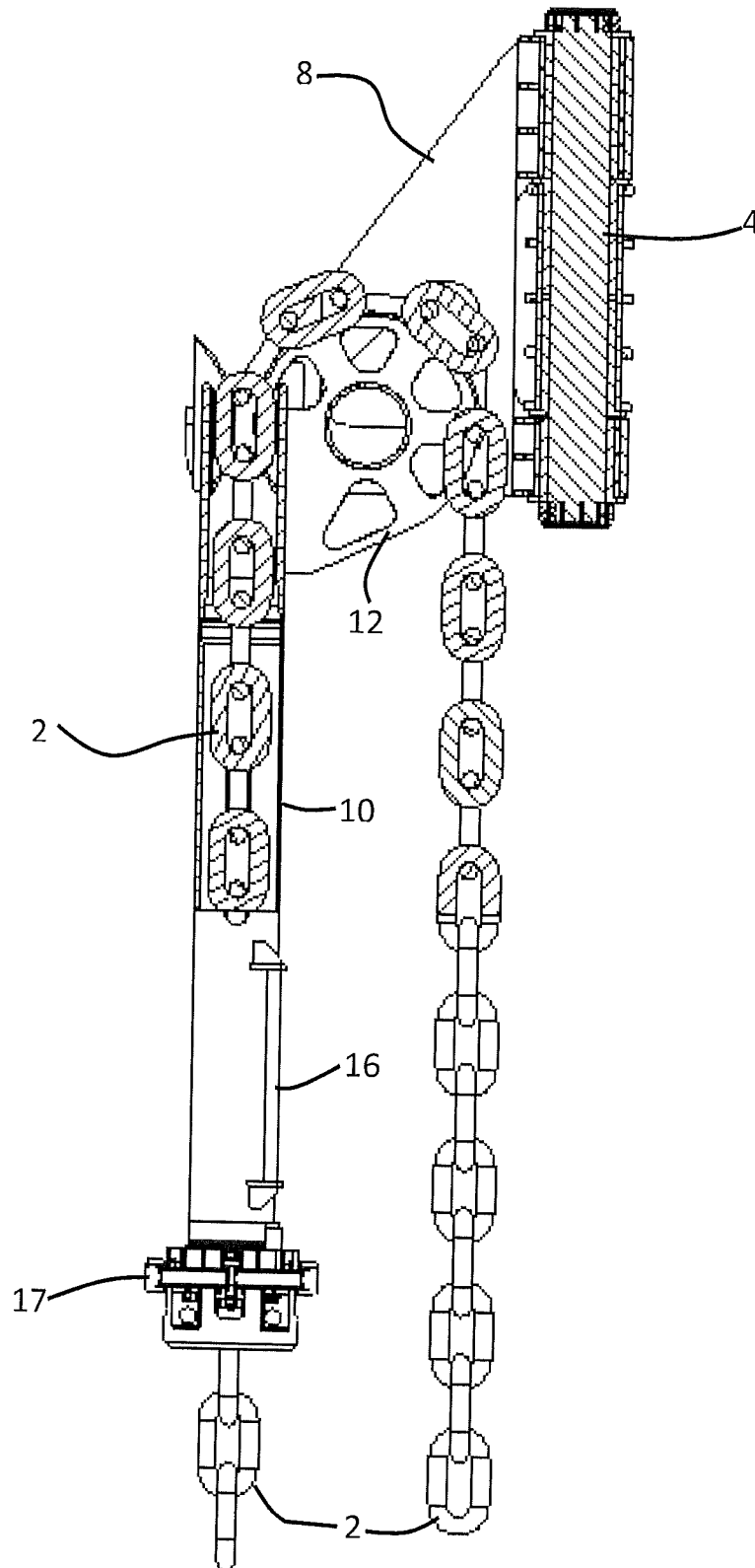

Figure 5

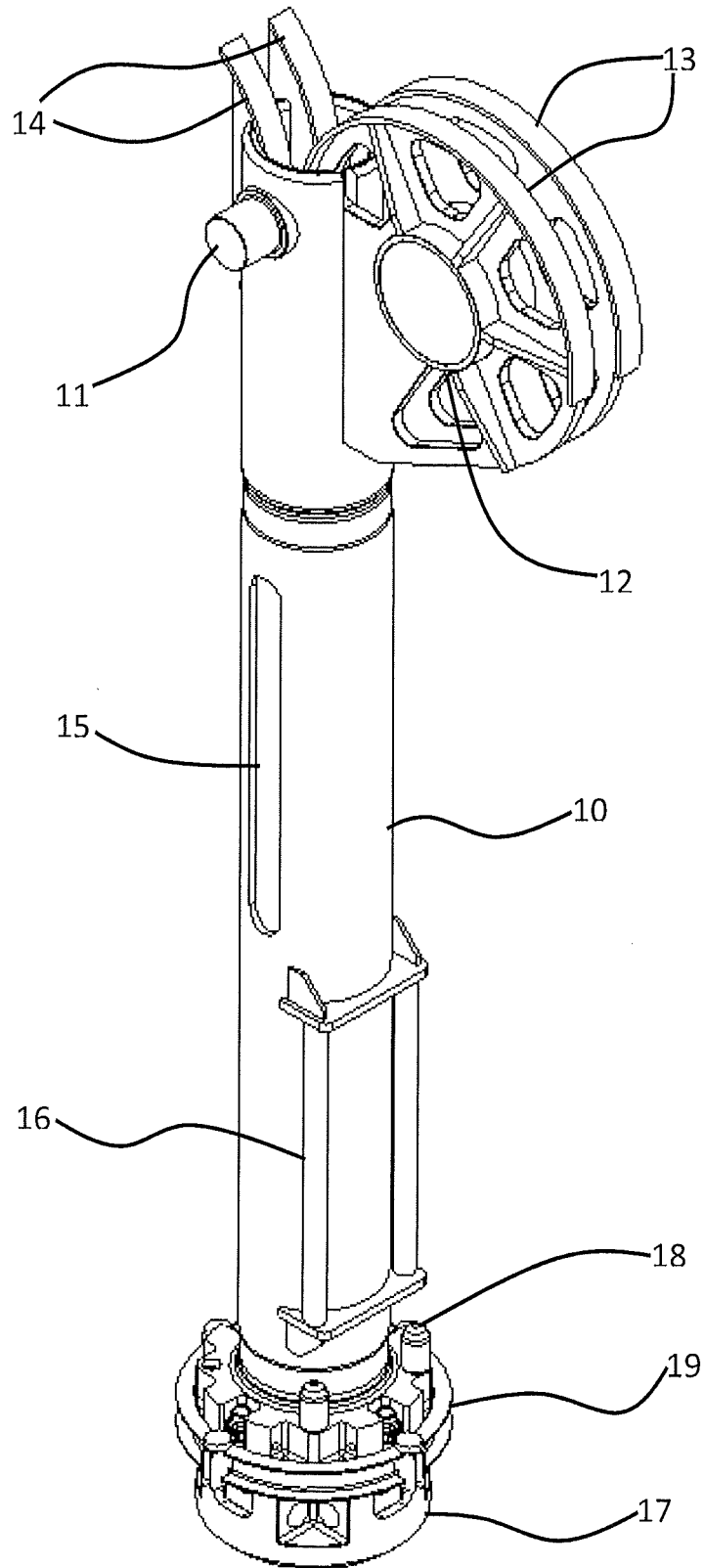

Figure 6

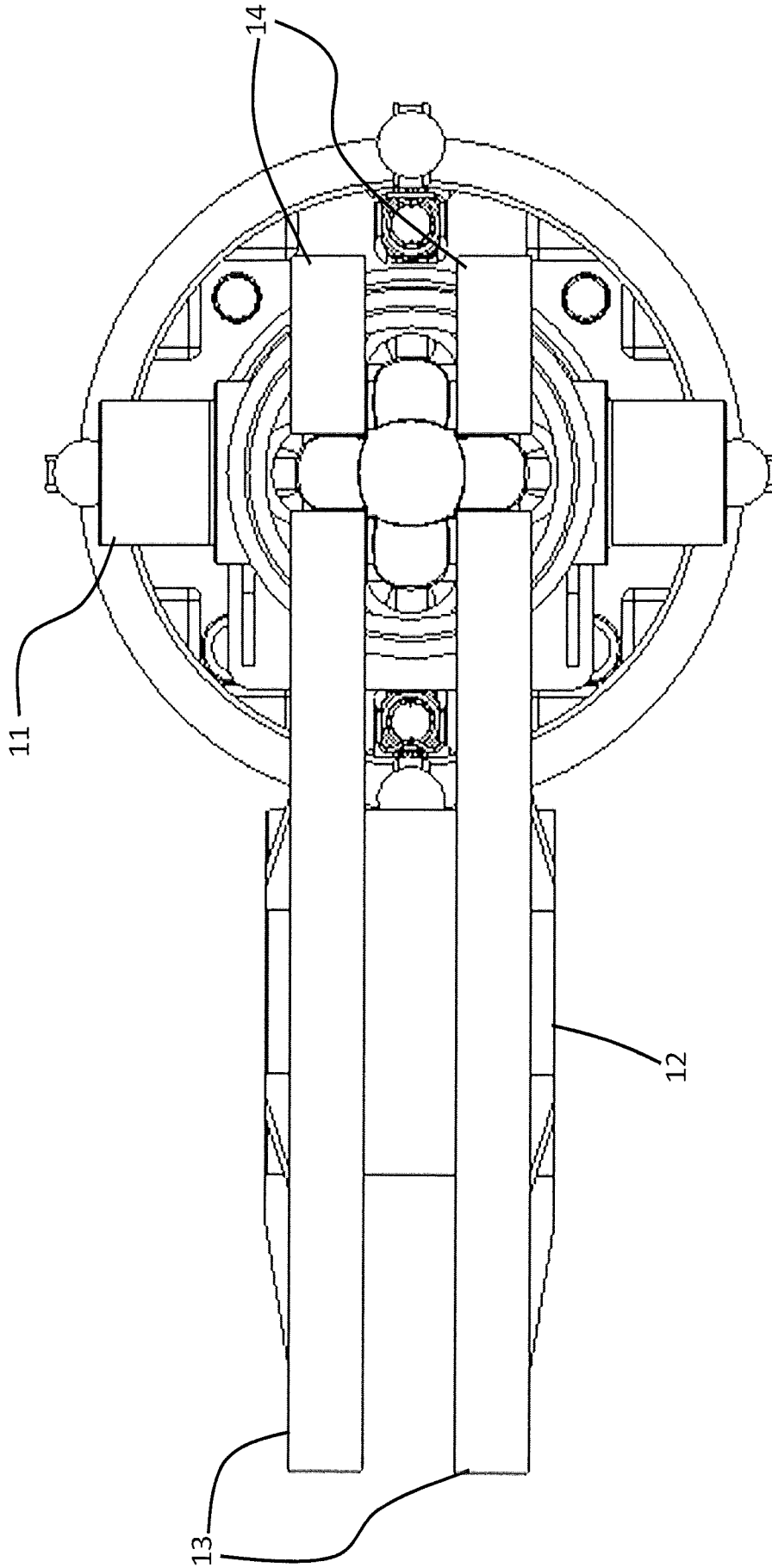

Figure 7

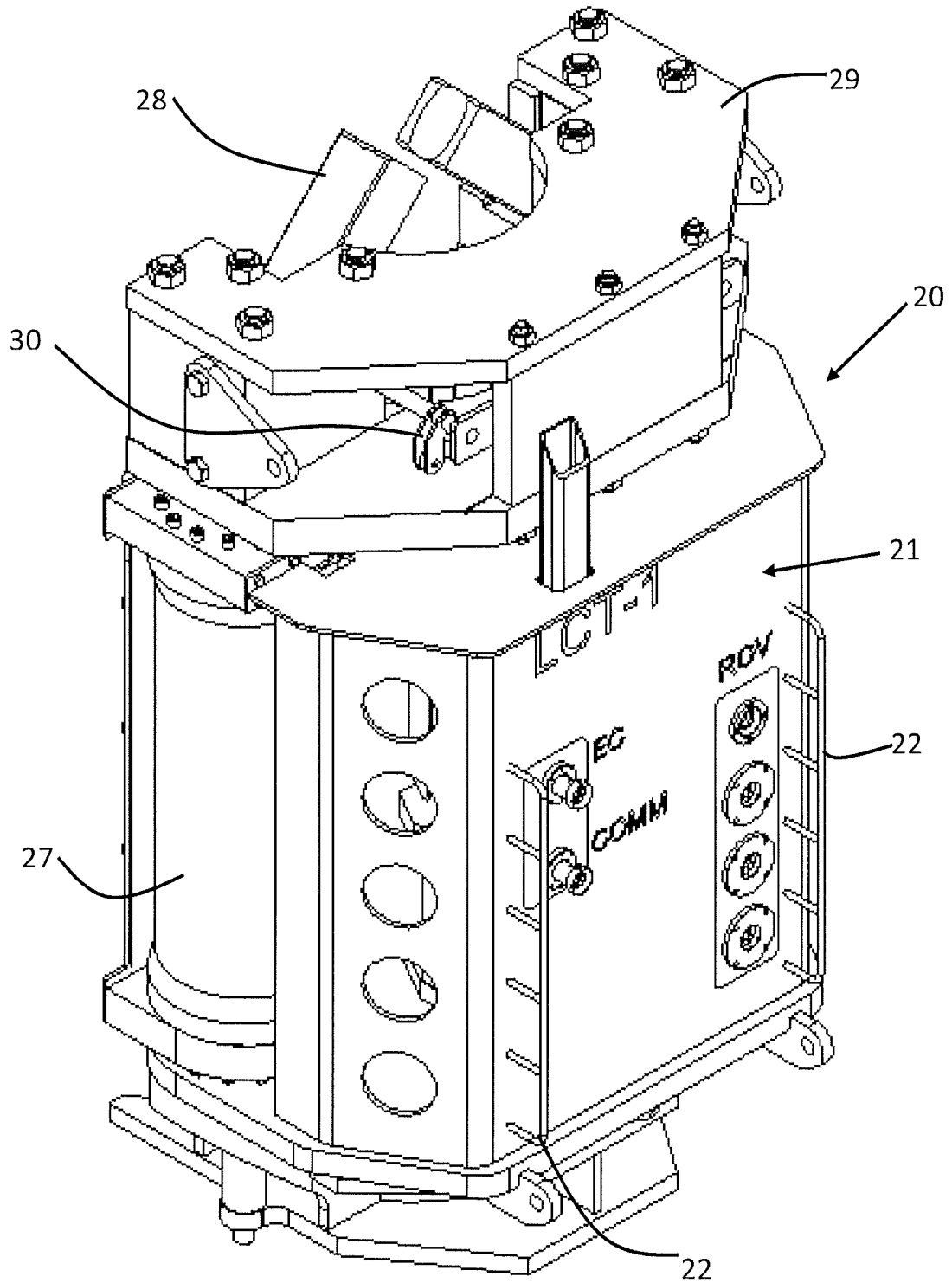

Figure 8

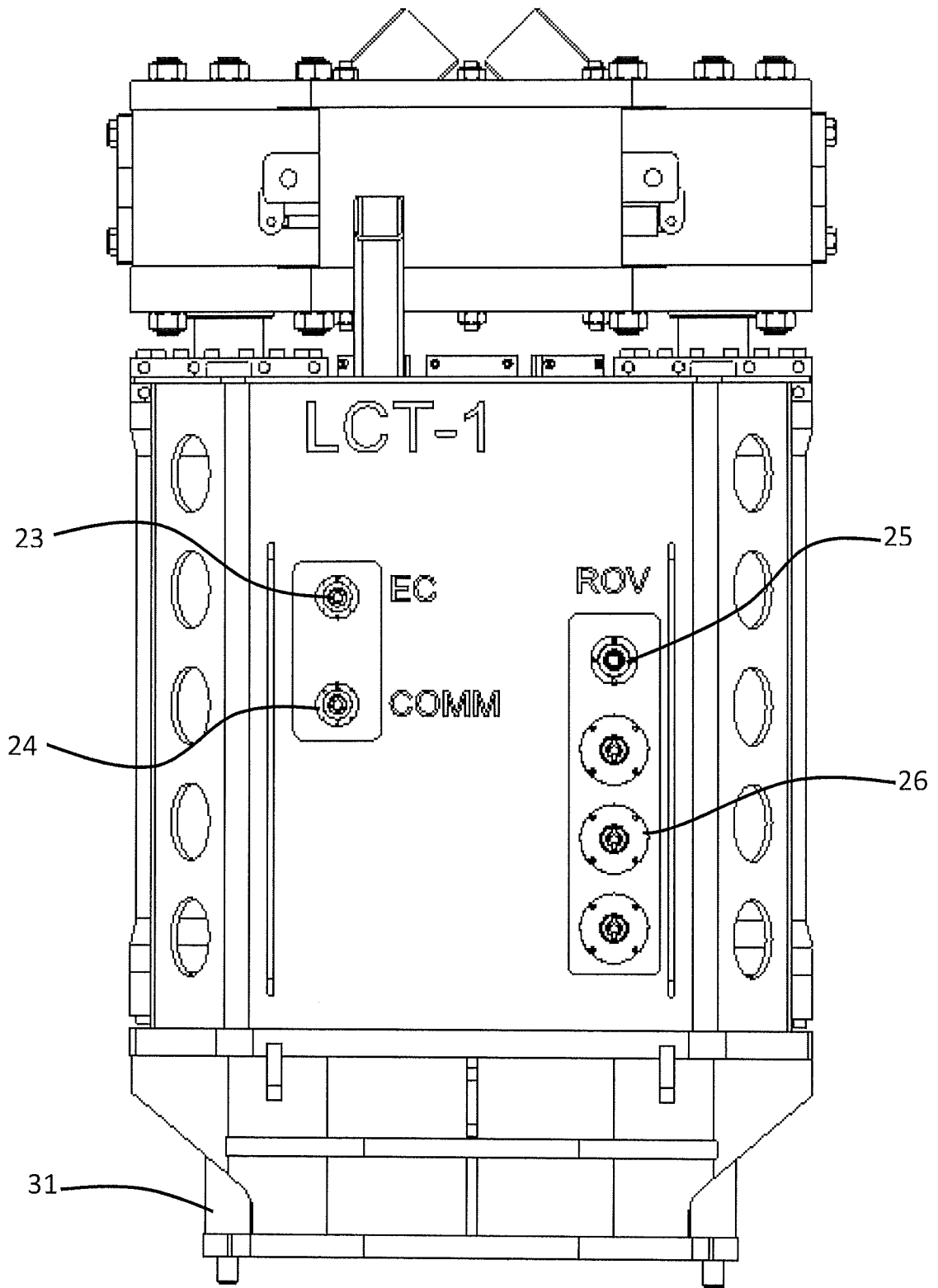

Figure 9

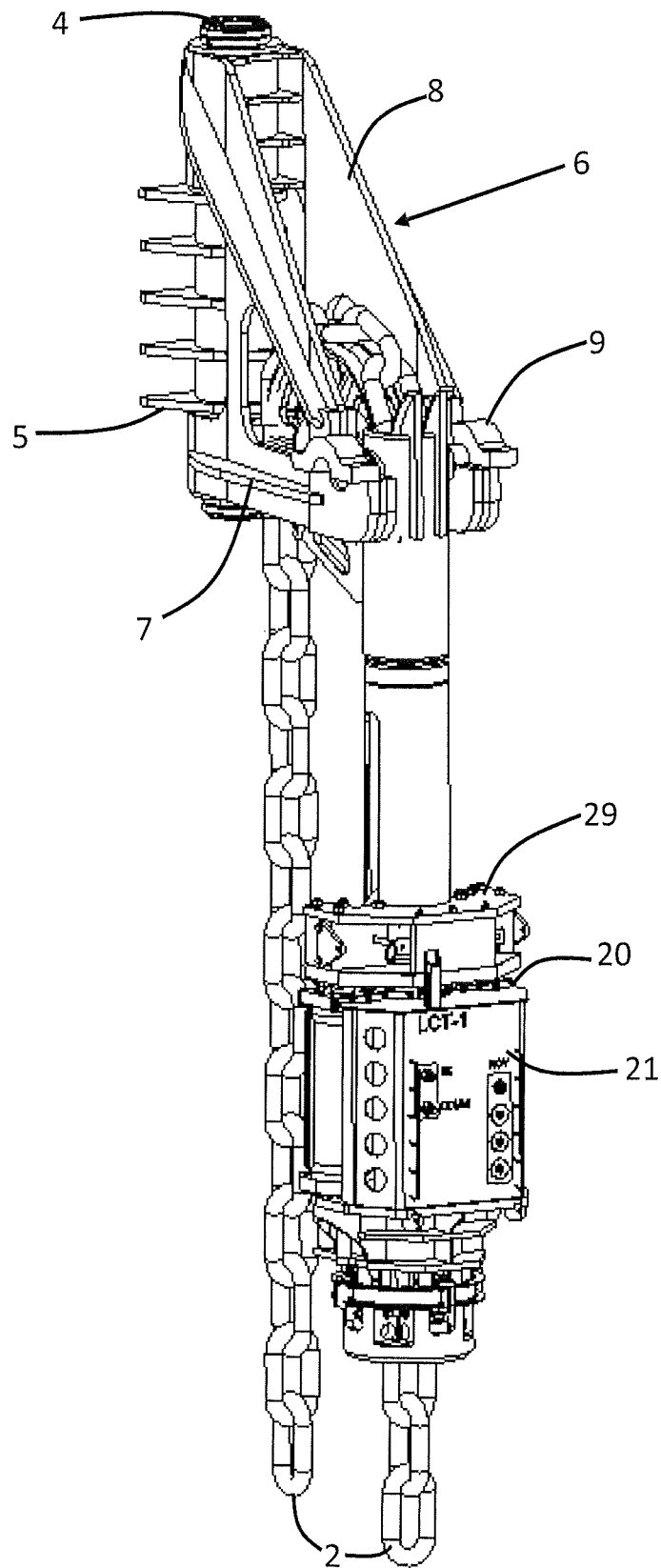

Figure 10

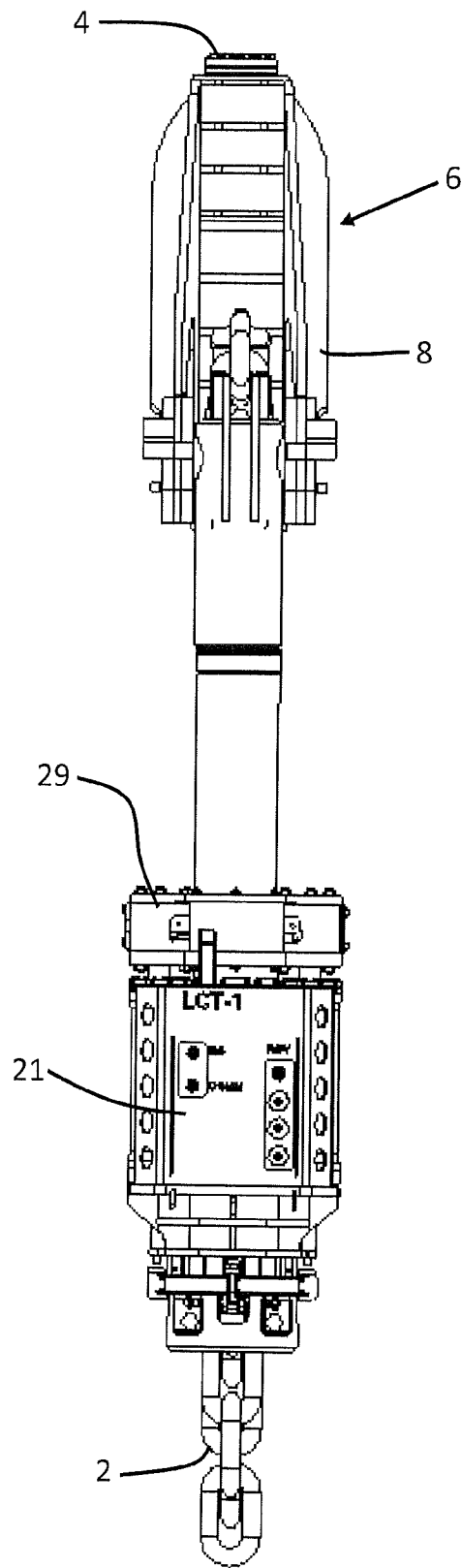

Figure 11

INTERNATIONAL SEARCH REPORT

International application No PCT/GB2017/050278
--

A. CLASSIFICATION OF SUBJECT MATTER
 INV. B63B21/18 B63B21/10 B63B21/08 B63B21/50 B63B22/02
 ADD.

According to International Patent Classification (IPC) or to both national classification and IPC

B. FIELDS SEARCHED

Minimum documentation searched (classification system followed by classification symbols)
B63B

Documentation searched other than minimum documentation to the extent that such documents are included in the fields searched

Electronic data base consulted during the international search (name of data base and, where practicable, search terms used)

EPO-Internal, WPI Data

C. DOCUMENTS CONSIDERED TO BE RELEVANT

Category*	Citation of document, with indication, where appropriate, of the relevant passages	Relevant to claim No.
X	US 2014/224163 A1 (ZIJLMANS JURGEN ARJAN [NL] ET AL) 14 August 2014 (2014-08-14) figures 2-6 paragraphs [0029] - [0039] claim 4	1-15
X	----- US 2014/026796 A1 (LEVERETTE STEVEN JOHN [US] ET AL) 30 January 2014 (2014-01-30) figures 1-5 paragraphs [0043] - [0114]	1-15
X	----- US 2015/000579 A1 (PONTAUT DAVID [BR] ET AL) 1 January 2015 (2015-01-01) cited in the application the whole document	1-15
	----- -/--	

Further documents are listed in the continuation of Box C.

See patent family annex.

* Special categories of cited documents :

- "A" document defining the general state of the art which is not considered to be of particular relevance
- "E" earlier application or patent but published on or after the international filing date
- "L" document which may throw doubts on priority claim(s) or which is cited to establish the publication date of another citation or other special reason (as specified)
- "O" document referring to an oral disclosure, use, exhibition or other means
- "P" document published prior to the international filing date but later than the priority date claimed

- "T" later document published after the international filing date or priority date and not in conflict with the application but cited to understand the principle or theory underlying the invention
- "X" document of particular relevance; the claimed invention cannot be considered novel or cannot be considered to involve an inventive step when the document is taken alone
- "Y" document of particular relevance; the claimed invention cannot be considered to involve an inventive step when the document is combined with one or more other such documents, such combination being obvious to a person skilled in the art
- "&" document member of the same patent family

Date of the actual completion of the international search

19 May 2017

Date of mailing of the international search report

31/05/2017

Name and mailing address of the ISA/
 European Patent Office, P.B. 5818 Patentlaan 2
 NL - 2280 HV Rijswijk
 Tel. (+31-70) 340-2040,
 Fax: (+31-70) 340-3016

Authorized officer

 Freire Gomez, Jon

INTERNATIONAL SEARCH REPORT

International application No PCT/GB2017/050278

C(Continuation). DOCUMENTS CONSIDERED TO BE RELEVANT

Category*	Citation of document, with indication, where appropriate, of the relevant passages	Relevant to claim No.
X	RU 2 128 124 C1 (KVAERNER ENG [NO]) 27 March 1999 (1999-03-27) figure 2	1-15
X	----- US 2012/160146 A1 (MILLER THOMAS [US] ET AL) 28 June 2012 (2012-06-28) figures 2-8 -----	1-15

INTERNATIONAL SEARCH REPORT

Information on patent family members

International application No

PCT/GB2017/050278

Patent document cited in search report	Publication date	Patent family member(s)	Publication date
US 2014224163 A1	14-08-2014	BR 112014006721 A2	28-03-2017
		CN 104024099 A	03-09-2014
		EP 2758301 A1	30-07-2014
		JP 2014526422 A	06-10-2014
		NL 2007463 C	26-03-2013
		SG 11201400523R A	28-04-2014
		US 2014224163 A1	14-08-2014
		WO 2013043049 A1	28-03-2013

US 2014026796 A1	30-01-2014	BR 112015001611 A2	16-08-2016
		CN 104640766 A	20-05-2015
		EP 2877394 A1	03-06-2015
		US 2014026796 A1	30-01-2014
		US 2015191218 A1	09-07-2015
		WO 2014018713 A1	30-01-2014

US 2015000579 A1	01-01-2015	AU 2012342257 A1	05-06-2014
		BR PI1105500 A2	24-11-2015
		EP 2834145 A1	11-02-2015
		GB 2496860 A	29-05-2013
		US 2015000579 A1	01-01-2015
		WO 2013076461 A1	30-05-2013

RU 2128124 C1	27-03-1999	NONE	

US 2012160146 A1	28-06-2012	CA 2818948 A1	28-06-2012
		EP 2655179 A1	30-10-2013
		KR 20130140828 A	24-12-2013
		US 2012160146 A1	28-06-2012
		US 2014346420 A1	27-11-2014
		WO 2012088511 A1	28-06-2012
