

OPTICAL TROCAR SYSTEM

CROSS REFERENCE TO RELATED APPLICATION

[0001] The present application claims the benefit of and priority to U.S. Provisional Application Serial No.61/548,428, filed on October 18, 2011, the entire contents of which are incorporated herein by reference.

TECHNICAL FIELD

[0002] The present disclosure relates to a trocar system for dissecting through body tissue. More particularly, the present disclosure relates to an optical bladeless trocar system.

BACKGROUND OF RELATED ART

[0003] Endoscopic and laparoscopic minimally invasive procedures have been used for introducing medical devices inside a patient and for viewing portions of the patient's anatomy. Typically, to view a desired anatomical site, a surgeon may insert an endoscope inside the patient to render images of the anatomical site. In endoscopic surgical procedures, surgery is performed in any hollow organ or tissue of the body through narrow endoscopic tubes (cannulas) inserted through a small entrance wound in the skin. In laparoscopic procedures, surgical operations in the abdomen are performed through small incisions (usually about 0.5 to about 1.5 cm).

SUMMARY

[0004] According to an example embodiment, the present invention may relate to an optical trocar system, comprising: an elongated obturator member having a first diameter, the elongated obturator member having a distal region, the distal region having a first diameter section having a diameter that is substantially equal to the first diameter of the elongated obturator member and having a second diameter section having a diameter that is less than the first diameter; and an optical member attached to the distal region of the elongated obturator

member such that the optical member encapsulates the second diameter section of the elongated obturator member and at least a portion of the first diameter section. The optical trocar system may also comprise a cannula assembly. The elongate tubular member may be configured for insertion into the cannula assembly.

[0005] Advantageously, the optical member extends distally from the distalmost end of the tubular member. The elongate tubular member may define a longitudinal bore. The longitudinal bore may be configured to receive an endoscope. The elongated tubular member may include a housing at the proximal region, the housing including an opening and a scope retention member adjacent the opening for receiving and providing retention of an endoscope. The optical member may be at least partially transparent to permit visualization of tissue with the endoscope. The optical member may define an internal sloped surface obliquely arranged relative to a longitudinal axis. The internal sloped surface may be configured and dimensioned to be engaged by an outermost periphery of a distal end of the endoscope. The internal sloped surface may provide an air gap between the distal end of the endoscope and optical member.

[0006] The optical member may be configured to dissect between tissue planes without cutting or incising tissue. The optical member may define at its distalmost end a rounded guiding nub. A central section of an outer surface of the optical member may include a pair of diametrically opposed generally convex surfaces. The central section of the outer surface of the optical member may also include a pair of diametrically opposed generally concave surfaces that are positioned circumferentially between the pair of diametrically opposed generally convex surfaces. The optical member may be molded to the distal region of the tubular member such that an outer surface of the optical member has a diameter that is substantially the same as the outer diameter of the elongated tubular obturator member. The optical member may be hollow.

[0007] In various embodiments, the second diameter section may include at least one void, and the optical member may encapsulate at least a portion of the least one void. The optical member may be attached to the distal region of the elongated obturator member by being molded, e.g., over-molded, thereto. According to an example embodiment, the present invention may relate to an optical trocar system that includes an elongated obturator member having at its distal end an optical member, wherein a central section of an outer surface of the optical member includes a pair of diametrically opposed generally convex surfaces, and wherein the central section of the outer surface of the optical member further includes a pair of diametrically opposed generally concave surfaces that are positioned circumferentially between the pair of diametrically opposed generally convex surfaces. The optical member may be configured to dissect between tissue planes without cutting or incising tissue. The optical member may define at its distalmost end a rounded guiding nub. The elongated tubular member may include a housing at the proximal region, the housing including an opening and a scope retention member adjacent the opening for receiving and providing retention of an endoscope.

BRIEF DESCRIPTION OF THE DRAWINGS

[0008] The above and other aspects, features, and advantages of the present disclosure will become more apparent in light of the following detailed description when taken in conjunction with the accompanying drawings in which:

[0009] FIG. 1 is an exploded perspective of an optical trocar, e.g., visual obturator, system in accordance with an example embodiment of the present disclosure illustrating the optical access apparatus and a cannula assembly;

- [0010] FIG. 2 is a fully assembled perspective view of the optical trocar system in accordance with the embodiment of FIG. 1;
- [0011] FIG. 3 is an enlarged perspective view of an optical member of the optical optical trocar in accordance with the embodiment of FIGS. 1-2;
- [0012] FIG. 4 is a top view of the optical member of FIG. 1;
- [0013] FIG. 5 is an axial view of the optical member of FIG. 3;
- [0014] FIG. 6 is a side view of the optical member radially offset 90° relative to the top view of FIG. 4;
- [0015] FIG. 6A is a front cross sectional view of the optical member of FIG. 6 taken at approximately the longitudinal midpoint thereof;
- [0016] FIG. 6B is a cross sectional view of the elongated tubular member distal end region and optical member of the optical trocar system of FIG. 2;
- [0017] FIG. 6C is a cross sectional view of the elongated tubular member distal end region and optical member of the optical access apparatus of FIG. 6B with an endoscope positioned therein;
- [0018] FIG. 7 is a perspective rear view of the fully assembled optical trocar system of FIG. 1;
- [0019] FIG. 8 is a perspective view of the scope retention member of the obturator housing of the optical access apparatus of FIG. 1;
- [0020]
- [0021] FIG. 9 is a top view of the cover of the cannula assembly of FIG. 2;
- [0022] FIG. 10 is a cross sectional view of the cover of the cannula assembly;
- [0023] FIG. 11 is a perspective view of the cover of the cannula assembly of FIG. 1;

[0024] FIG. 12 is a perspective view of the instrument seal of the cannula assembly of FIG. 1;

[0025] FIG. 13 is a cross-sectional view of the instrument seal of the cannula assembly of FIG. 1; and

[0026] FIG. 14 is a perspective view illustrating an endoscope positioned within the optical access apparatus and accessing body tissue.

DETAILED DESCRIPTION

[0027] Particular embodiments of the present disclosure are described hereinbelow with reference to the accompanying drawings; however, it is to be understood that the disclosed embodiments are merely exemplary of the disclosure and may be embodied in various forms. Well-known functions or constructions are not described in detail to avoid obscuring the present disclosure in unnecessary detail. Therefore, specific structural and functional details disclosed herein are not to be interpreted as limiting, but merely as a basis for the claims and as a representative basis for teaching one skilled in the art to variously employ the present disclosure in virtually any appropriately detailed structure. Like reference numerals refer to similar or identical elements throughout the description of the figures.

[0028] As used herein, the term “distal” refers to that portion of the instrument, or component thereof which is farther from the user while the term “proximal” refers to that portion of the instrument or component thereof which is closer to the user.

[0029] The present invention, in accordance with various example embodiments thereof, may relate to an optical trocar system that provides access to a body cavity through an anatomical, e.g., abdominal, wall. It should be noted that, for the purposes of this discussion, the

term optical trocar system is often used herein synonymously with the term visual obturator system. Advantageously, the optical trocar system of the present invention, in accordance with various example embodiments thereof, provides such access without cutting or incising the tissue, but rather by separating tissue planes during a surgical procedure. Also, the optical trocar system of the present invention, in accordance with various example embodiments thereof, may provide visualization of body tissue fibers as they are being separated, thereby permitting a controlled traversal across a body wall, by providing a transparent optical member located at the distal end of an obturator.

[0030] Referring now to FIGS. 1 through 14, there is illustrated an optical trocar, e.g., visual obturator, system in accordance with an example embodiment of the present invention. The visual obturator is intended for separating tissue planes in an endoscopic, e.g., laparoscopic, surgical procedure, and, is particularly suitable for the blunt dissection of the abdominal lining during a surgical procedure. The visual obturator is adapted to receive an endoscope to permit viewing of tissue during the insertion and advancement of the visual obturator toward the operative site.

[0031] In accordance with the example embodiment shown, the visual obturator system 10 includes an obturator assembly 11 and a cannula assembly 100 which at least partially receives the obturator assembly 11. The obturator assembly 11 includes an obturator housing 12 disposed in mechanical cooperation with an elongated obturator member 14, and defining a longitudinal axis "A-A." The elongated obturator member 14 extends distally from the obturator housing 12.

[0032] The elongated obturator member 14 includes a rigid, e.g., metal, obturator shaft 18 attached, e.g., by over molding thereto, at its proximal end to the obturator housing 12 and at

its distal end to an optical member 20. As shown in FIGS 3-6, the optical member 20 includes a proximal section 22, a central section 24, and an atraumatic guiding nub 26. The optical member 20 has a hollow interior. As shown in FIG 6C, a distal viewing tip of an endoscope is brought into engagement with a sloped /chamfered surface within the optical member 20, as will be described hereinbelow. Referring to FIGS 3-6, an imaginary line 28 (shown to illustrate curvature) may delineate a boundary between the proximal section 22 and the central section 24.

[0033] With reference to FIG. 4, a top view of the optical member 20 is illustrated. As depicted, a proximal section 22 includes a pair of diametrically opposed convex surfaces 222. The central section 24 includes a pair of diametrically opposed concave surfaces 242. The atraumatic guiding nub 26 extending distally from the central section 24 is generally cylindrical, and includes a rounded end 262. The rounded end 262 defines a radius of curvature dimensioned to be atraumatic to tissue. Additionally, as shown in connection with phantom lines 29 that represent a cone, a portion of both the proximal section 22 and the atraumatic guiding nub 26 of optical member 20 are outside of the dimensions of the cone.

[0034] With reference to FIG. 5, an end or axial view of the optical member 20 illustrates the circular profile of the guiding nub 26, the oval profile of the central section 24, and the circular profile of the proximal section 22.

[0035] With reference to FIG. 6, a side view of the optical member 20 is illustrated. This side view is radially offset 90° relative to the top view of FIG. 4. As shown, the proximal section 22 of the optical member 20 further includes a pair of diametrically opposed outer surfaces 224 which are generally linear and/or convex. The central section 24 also includes a pair of opposed outer surfaces 244 which are convex. Thus, the central section 24 of the optical member 20 is inclusive of both generally concave surfaces 242 (FIG. 4) and generally convex surfaces 244

(FIG. 6) that are circumferentially spaced about the optical member 20. In this manner, the optical member 20 may have a “dolphin-nose” or “parabolic type shape”. Additionally, as shown in connection with the phantom lines in Figure 6 that represent a cone, a portion of the proximal section 22, the central section 24, and the atraumatic guiding nub 26 of optical member 20 are outside of the dimensions of the cone.

[0036] FIG. 6A is a front cross-sectional view of the optical member 20 taken at approximately the longitudinal midpoint thereof. The figure illustrates that the optical member 20 includes rounded outer surfaces 31 that, during use, function to help separate tissue along the tissue planes.

[0037] The atraumatic guiding nub 26 permits initial insertion within a pre-formed opening, e.g., a pre-cut scalpel incision, in the tissue and facilitates the advancement of the optical member 20 between the tissue layers to gently dissect tissue, without any cutting or incising of the tissue. After initial insertion and continued distal insertion, the central section 24 and the proximal portion 22 continue to gently enlarge the opening in tissue by further dissecting the tissue planes, e.g. by the rounded outer surfaces 31 of optical member separating the tissue planes during a clocking motion thereof.

[0038] With reference to FIGS. 6B and 6C, the optical member 20 may be is fabricated from a polymeric material, e.g., LEXAN, and is transparent, or at least semi-transparent, to permit passage of light rays. During assembly, the optical member 20 may be over-molded onto the metal obturator shaft 18 to connect the components. In particular, the obturator shaft 18 includes a distal shaft section which depends radially inwardly relative to the longitudinal axis A-A. The optical member 20 is molded to encapsulate the distal shaft section and is secured to the obturator shaft 18 upon curing of the polymeric material. The optical member 20 defines an

internal chamfered or sloped surface 201 which is obliquely arranged relative to the longitudinal axis A-A. The chamfered surface 201 is directly engaged by the outermost periphery of the distal end of the endoscope (see FIG. 6C) such that light transmitted from regions of the endoscope radially within the outer periphery travel across an air gap prior to being received by the chamfered or sloped surface 201. The optical member 20 permits the passage of light rays to enable viewing, (by the endoscope) of tissue adjacent the optical member 20 during the insertion and/or advancement of the visual obturator system 10 through the tissue.

[0039] The obturator housing 12 of the obturator assembly 11 includes an opening 160 (FIG. 7) and a scope retention member 170 (shown separately in FIG. 8) adjacent the opening 160. The scope retention member 170 is fabricated from an elastomeric material, and defines a central opening 172 for receiving the endoscope and four radial slits 174 extending outwardly from the central opening 172. The radial slits 174 permit flexure of the scope retention member 170 and enlargement of the central opening 172 upon insertion of the endoscope. The scope retention member 170 is adapted to engage the outer surface of the endoscope in frictional engagement therewith to assist in retaining the relative positioning of the endoscope within the obturator assembly 11.

[0040] Referring back to FIG 1, the cannula assembly 100 of the visual obturator system 10 may include a clear elongated portion 102, defining a longitudinal axis "B-B," and a cover 110. The cover 110 encloses an instrument instrument seal 130 and a zero-closure seal 150. The instrument seal 130 is disposed proximally of the zero-closure seal 150.

[0041] The cover 110 is configured to mechanically engage a proximal portion of the elongated portion 102 and helps maintain the instrument seal 130 and the zero-closure seal 150 within the cannula housing. Referring to FIG 9, cover 110 includes an outer periphery 116, and

an aperture 120 having a diameter of D1. A ramped section 124 interconnects the outer periphery 116 with the aperture 120. Additionally, the aperture 120 is defined between vertical, inner sidewalls 122 (FIG 10). Cover 110 also includes a pair of notches 126 and a pair of engagement portions 127 thereon. Notches 126 and engagement portions 127 are configured to be mechanically engaged by a pair of protuberances 23 and a pair of latches 19, respectively, disposed on the obturator member 14 (see FIG. 1). Referring to FIG 1, buttons 27 on the latches 19 extend through openings 21 in the obturator housing 12, which enables a user to selectively lock and unlock the obturator to and from the cannula assembly 100 (e.g., by pushing the buttons 27 such that the proximal ends of latches 19 engage engaging portions 127 of the cover 110).

[0042] Referring now to FIGS 12 & 13, the instrument seal 130 includes an elastomeric septum seal 130b which is over-molded onto a rigid plastic insert 130a. Rigid plastic insert 130a includes a horizontal surface 132, a first vertical, annular wall 134 and a second vertical, annular wall 136. An inner vertical surface 134a of annular wall 134 defines diameter D2. An inner vertical surface 136a of annular wall 136 defines diameter D3. Additionally, the elastomeric septum seal 130b of the instrument seal 130 defines a horizontal surface 138 disposed within annular wall 136. The elastomeric septum seal 130b includes an aperture 139 having a diameter D4. The diameter D1 of the cover's aperture 120 is less than the diameter D3 of the annular wall 136. Thus, upon insertion, the obturator member 14 is only able to contact the horizontal surface 138 and the walls defining the aperture 139 of the instrument seal 130.

[0043] The instrument seal 130 also includes a lip 140 depending downwardly from horizontal surface 132. The lip 140 engages a corresponding detent (not shown) on the housing, such that the instrument seal 130 cannot move rotationally (e.g., about longitudinal axis "B-B") or radially (e.g., transversely with respect to longitudinal axis "B-B"). Additionally, when the

cannula assembly 100 is assembled, instrument seal 130 is clamped to a portion of the housing 102, thus preventing axial (e.g., along longitudinal axis "B-B") movement of the instrument seal 130 and further preventing rotational and radial movement of the instrument seal 130.

[0044] In use, the obturator assembly 11 of the visual obturator system 10 is at least partially introduced within the cannula assembly 100 with the obturator member 14 extending through the aperture 139 of the instrument seal 130 and through the zero-closure seal 150. An initial incision in a patient is made by, e.g., a scalpel. The assembled visual obturator system 10 is positioned within the initial incision and against the targeted tissue, e.g., the abdominal lining. As discussed above, an endoscope may be inserted through the obturator assembly 11 such that the distal viewing end of the endoscope is positioned against the chamfered surface of the transparent optical member 20. The endoscope may be retained at this relative position within the obturator assembly 11 by the scope retention member 170. When the obturator member 14 passes through the aperture 139 of the instrument seal 130 (either when longitudinal axis "A-A" is substantially aligned with longitudinal axis "B-B" or when longitudinal axis "A-A" is non-aligned (e.g. spaced from and/or angled) with longitudinal axis "B-B"), the only portion of the instrument seal 130 that is capable of movement is the horizontal surface 138 adjacent aperture 139 and disposed radially within the vertical surface 136a of annular wall 136. The other portions of the instrument seal 130 (including the rigid plastic insert 130a and the portions of the elastomeric septum seal 130b disposed outwardly of rigid plastic insert 130a) are not capable of moving with respect to the aperture 139.

[0045] As set forth above, the optical member 20 is manipulated relative to the tissue whereby the atraumatic guiding nub 26 engages tissue and, in combination with the concave and/or convex outer surfaces 244, gently dissect or separate the tissue to gain access to an

underlying cavity. During insertion, the tissue adjacent the optical member 20 is viewed with the endoscope. The visual obturator may then be removed from the cannula assembly 100.

Instruments may be introduced within the cannula assembly 100 to perform a surgical procedure.

[0046] The method of forming, e.g., over-molding, the optical member 20 to the distal region 205 of the elongated obturator member 14 will now be discussed. In an example embodiment, the optical member 20 is molded to encapsulate regions of the distal end portion of the elongated obturator member 14. For example, the optical member 20 may be molded to encapsulate both a first or larger diameter section 203 of the elongated obturator member 14 as well as a second or reduced diameter section 201 that is located distally relative to the first or larger diameter section 203. In addition, the optical member 20 may be molded to encapsulate at least one or more voids in the elongated obturator member 14. In embodiments, any suitable material, e.g., preferably transparent but at least semitransparent or translucent so as to enable at least some light transmission therethrough, for forming the optical member 20 as described above may be utilized. In embodiments, the material of the optical member 20, during manufacture, may be in a molten form such that it may flow into the arrangement shown, e.g., into the spaces defined by the first or larger diameter section 203 and the second or reduced diameter section 201 and into the at least one void 207 of the elongated obturator member 14. Advantageously, the optical member 20 may be molded to the distal region of the elongated obturator member 14 such that an outer surface of the optical member 20 has a diameter that is substantially the same as the outer diameter of the elongated obturator member 14. In this manner, the transition between the outer surface of the optical member 20 and the outer surface of the elongated obturator member 14 is smooth. The smoothness of this transition may provide for greater ease of insertion through, e.g., cannula seals.

[0047] The one or more void 207 may have any shape, for example, the semi-circular shape shown in FIGS. 6B and 6C. Additionally or alternatively, the void 207 may have a circular or any other suitable shape. Also, the void 207 may be located such that it extends to the distal-most edge of the elongated obturator member 14, e.g., as shown in FIGS. 6B and 6C. Additionally or alternatively, one or more of the voids 207 may be located such that it does not extend to the distal-most edge of the elongated tubular member 14, but rather the void 207 may have a distal-most edge of its own that is proximal relative to the distal-most end of the elongated obturator member 14.

[0048] In embodiments, at least a portion of the material of the obturator member 20 is molded so as to extend into the first or larger diameter section 203 of the elongated tubular member 14 proximal to the reduced or second diameter section 201. This may be done using a mold having a shape that forms the shape of the outer surface of the optical member 20 and by using a tooling pin (not shown) that extends through the elongated obturator member 14. A distal-most end portion of the tooling pin has a shape that forms the shape of the hollowed interior of the optical member 20. The tooling pin may also include a second surface, the second surface being proximal relative to the distal-most end portion and being angled so as to form the chamfered or sloped surface 201 of the optical member 20.

[0049] In embodiments, the method of manufacturing the over-molded optical member 20, with its regions of different diameter and its one or more void 207, provides improved rotational resistance between the optical member 20 and the elongated obturator member 14. In addition, it assures that a very high force would be required so as to disengage the optical member 20 from the end of the tubular member 14 in both rotational and axial directions. Because material of the optical member 20 is formed so as to be within the first or larger

diameter section 203 of the tubular member 14, the force required to be applied by a surgical instrument against the chamfered surface of the optical member 20 in order to push the optical member 20 off of the elongated tubular member 20 is very high. In other embodiments, optical member 20 may be attached to elongated tubular member 14 through any other suitable conventional means, e.g., adhesives, cements, threaded connection, bayonet coupling, snap fit arrangement, etc.

[0050] The optical trocar system of the present invention, in accordance with various embodiments thereof, may provide various advantages as compared to conventional trocar systems. For example, conventional trocars may include an obturator having a sharp tip for penetrating the body cavity. In addition to the safety concerns that may exist when using an obturator having a sharp tip (e.g., inadvertent puncture of tissue), such conventional trocars may require complex mechanical arrangements to protect from inadvertent puncture, thereby increasing the number of components in the device, increasing the time required to manufacture and assemble the device, the number of ways that the device may malfunction during use, the cost of the device, etc. For example, one commonly used arrangement in order to prevent inadvertent cutting of tissue by a sharp tip is a retractable protective shield that covers the sharp tip of the obturator when not in use. The obturator trocar system of the present invention, in accordance with various embodiments thereof, may provide for obturators having only rounded and non-bladed surfaces at its distal end such that, even if the distal end of the obturator inadvertently contacts the tissue, the rounded and non-bladed surfaces does not cut, and in fact is incapable of cutting, the tissue. The optical trocar system of the present invention, in accordance with various embodiments thereof, may also provide for an arrangement that has fewer components as compared to conventional trocars, thereby providing the possibility of decreasing

the complexity of the device, simplifying its manufacture, reducing its cost and improving its reliability.

[0051] While various embodiments of the present disclosure have been shown and described herein, it will be obvious to those skilled in the art that these embodiments are provided by way of example only. Numerous variations, changes, and substitutions will now occur to those skilled in the art without departing from the present disclosure. Accordingly, it is intended that the invention be limited only by the spirit and scope of the appended claims.

What is claimed is:

1. An optical trocar system, comprising:

an elongated obturator member having a first diameter, the elongated obturator member having a distal region, the distal region having a first diameter section having a diameter that is substantially equal to the first diameter of the elongated obturator member and having a second diameter section having a diameter that is less than the first diameter; and

an optical member attached to the distal region of the elongated obturator member such that the optical member encapsulates the second diameter section of the elongated obturator member and at least a portion of the first diameter section.

2. The optical trocar system according to claim 1, further comprising a cannula assembly.

3. The optical trocar system according to claim 2, wherein the elongate tubular member is configured for insertion into the cannula assembly.

4. The optical trocar system according to claim 1, wherein the optical member extends distally from the distalmost end of the tubular member.

5. The optical trocar system according to claim 1, wherein the elongate tubular member defines a longitudinal bore.

6. The optical trocar system according to claim 5, wherein the longitudinal bore is configured to receive an endoscope.

7. The optical trocar system according to claim 6, wherein the optical member is at least partially transparent to permit visualization of tissue with the endoscope.
8. The optical trocar system according to claim 1, wherein the optical member defines an internal sloped surface obliquely arranged relative to a longitudinal axis.
9. The optical trocar system according to claim 8, wherein the internal sloped surface is configured and dimensioned to be engaged by an outermost periphery of a distal end of the endoscope.
10. The optical trocar system according to claim 8, wherein the internal sloped surface provides an air gap between the distal end of the endoscope and optical member.
11. The optical trocar system according to claim 1, wherein the optical member is configured to dissect between tissue planes without cutting or incising tissue.
12. The optical trocar system according to claim 1, wherein the optical member defines at its distalmost end a rounded guiding nub.
13. The optical trocar system according to claim 1, wherein a central section of an outer surface of the optical member includes a pair of diametrically opposed generally convex surfaces.

14. The optical trocar system according to claim 13, wherein the central section of the outer surface of the optical member further includes a pair of diametrically opposed generally concave surfaces that are positioned circumferentially between the pair of diametrically opposed generally convex surfaces.

15. The optical trocar system according to claim 1, wherein the elongated tubular member includes a housing at the proximal region, the housing including an opening and a scope retention member adjacent the opening for receiving and providing retention of an endoscope.

16. The optical trocar system according to claim 1, wherein the optical member is molded to the distal region of the tubular member such that an outer surface of the optical member has a diameter that is substantially the same as the outer diameter of the elongated tubular obturator member.

17. The optical trocar system according to claim 1, wherein the optical member is hollow.

18. The optical trocar system according to claim 1, wherein the second diameter section includes at least one void, and wherein the optical member encapsulates at least a portion of the least one void.

19. The optical trocar system according to claim 1, wherein optical member is attached to the distal region of the elongated obturator member by being molded thereto.

20. An optical trocar system, comprising:

an elongated obturator member having at its distal end an optical member, wherein a central section of an outer surface of the optical member includes a pair of diametrically opposed generally convex surfaces, and wherein the central section of the outer surface of the optical member further includes a pair of diametrically opposed generally concave surfaces that are positioned circumferentially between the pair of diametrically opposed generally convex surfaces.

21. The optical trocar system according to claim 20, wherein the optical member is configured to dissect between tissue planes without cutting or incising tissue.

22. The optical trocar system according to claim 20, wherein the optical member defines at its distalmost end a rounded guiding nub.

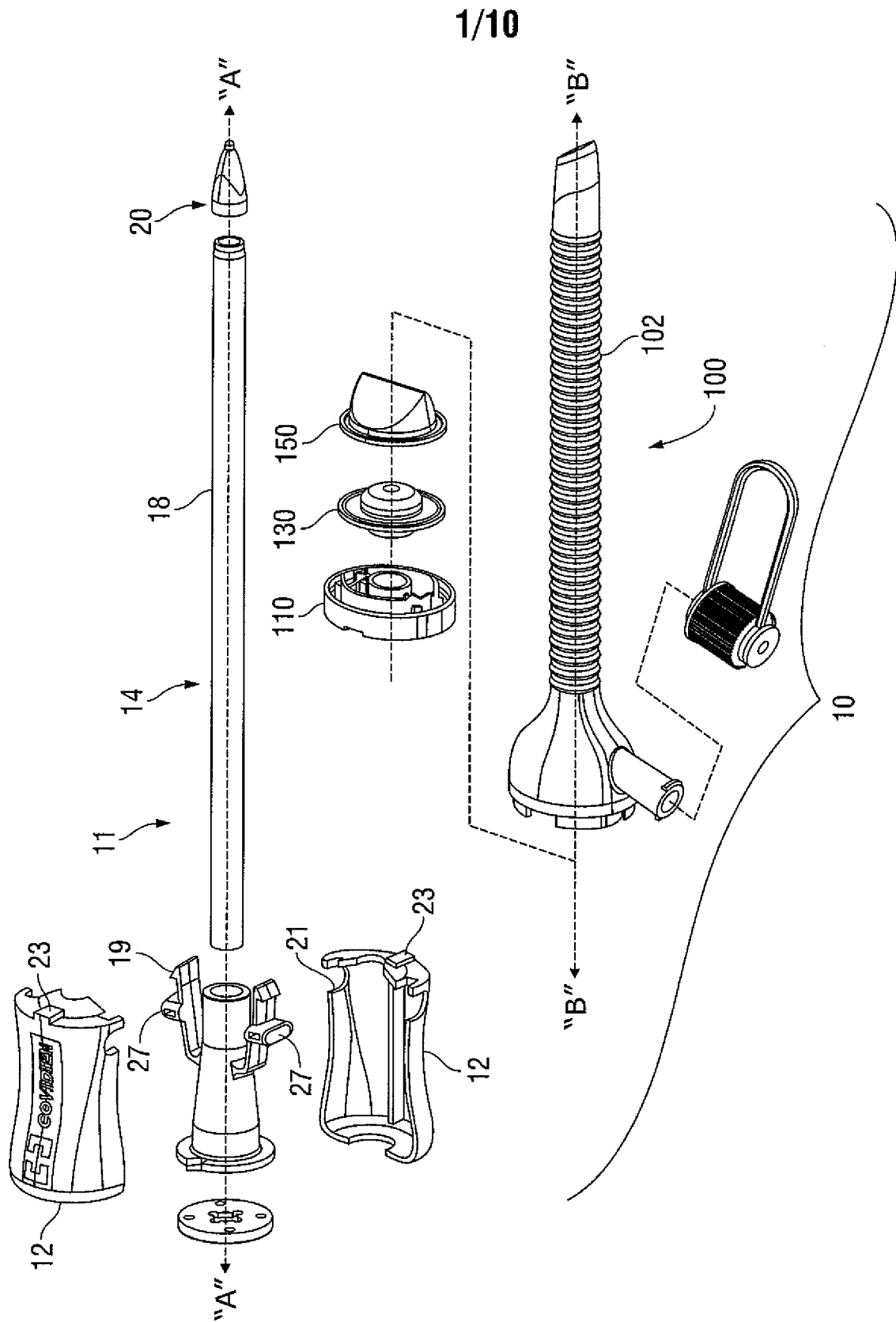

FIG. 1

2/10

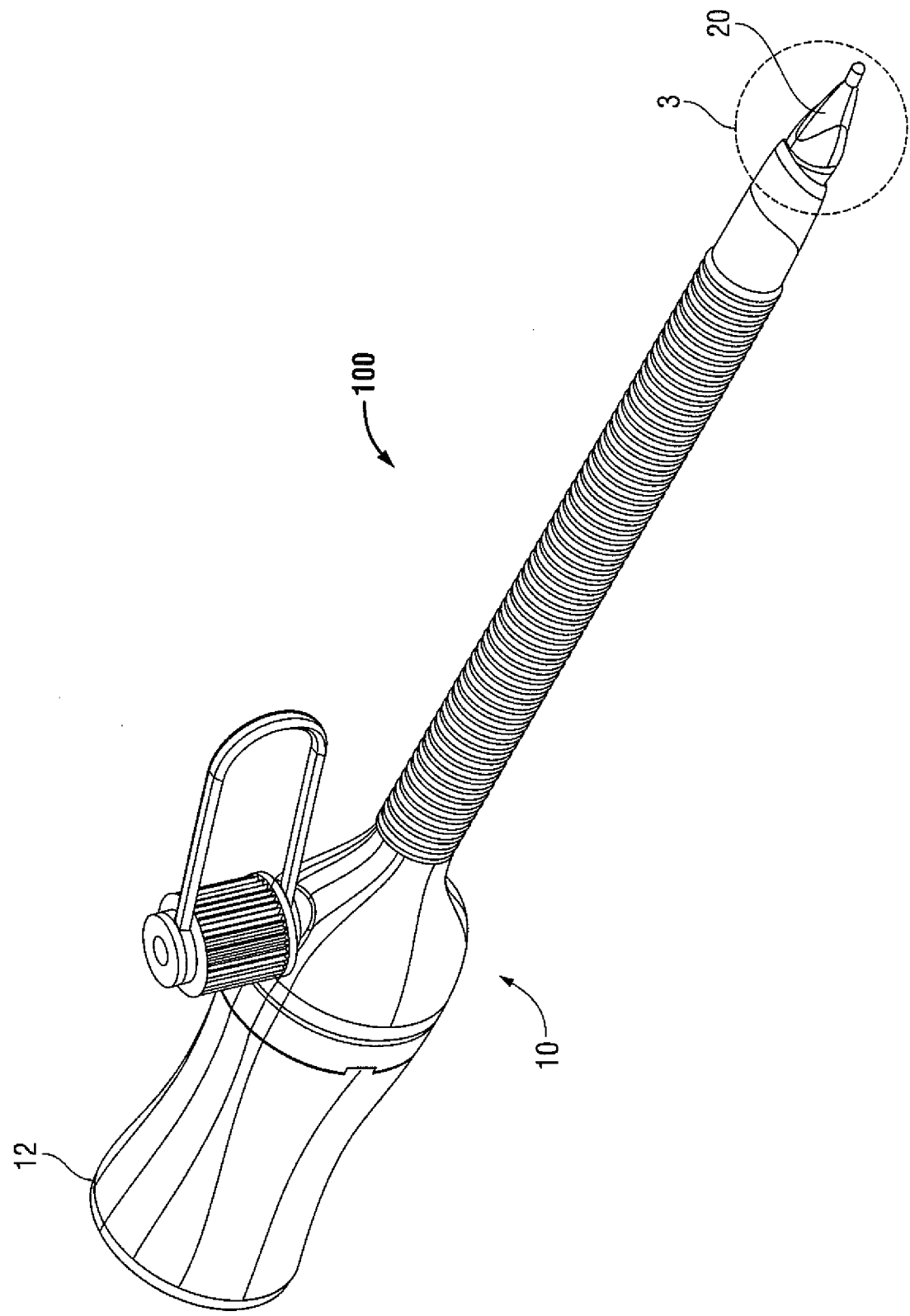

FIG. 2

3/10

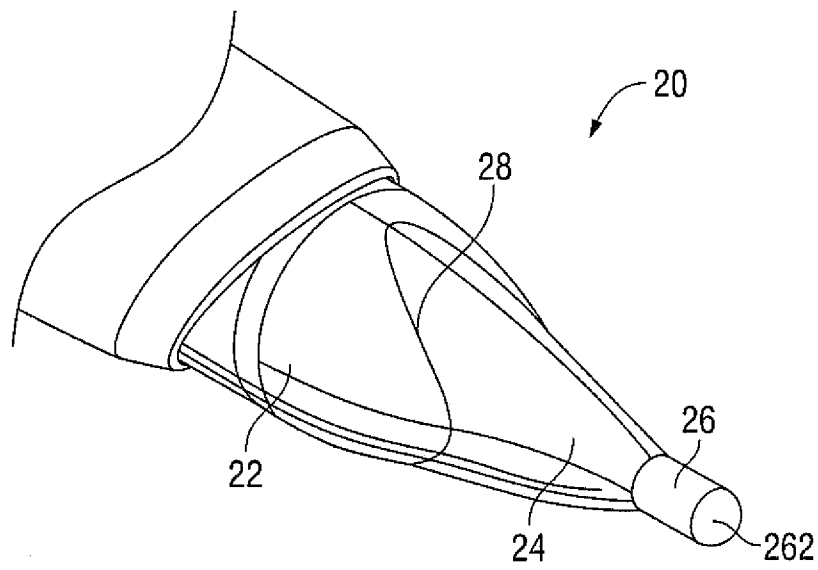

FIG. 3

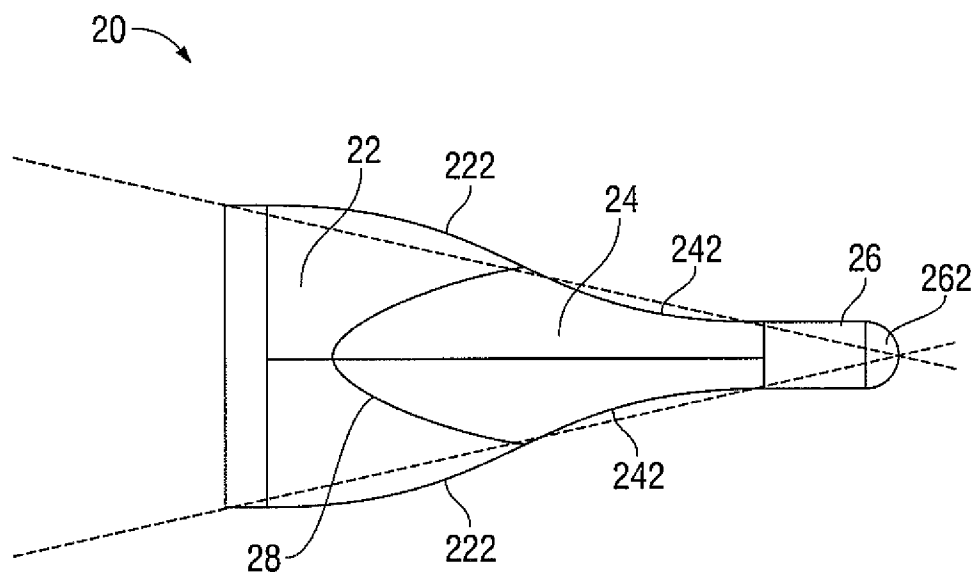

FIG. 4

4/10

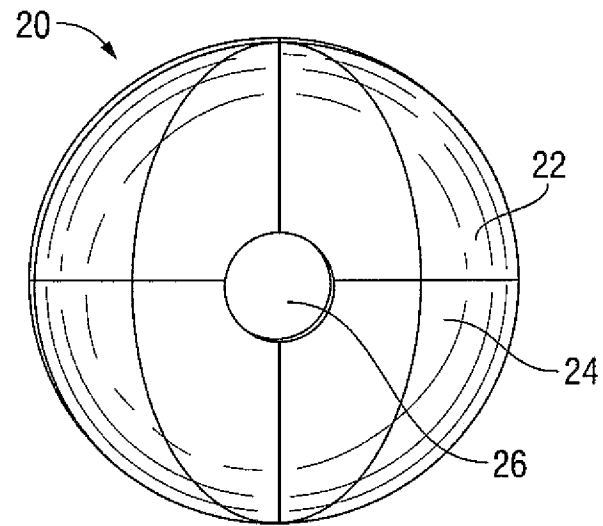

FIG. 5

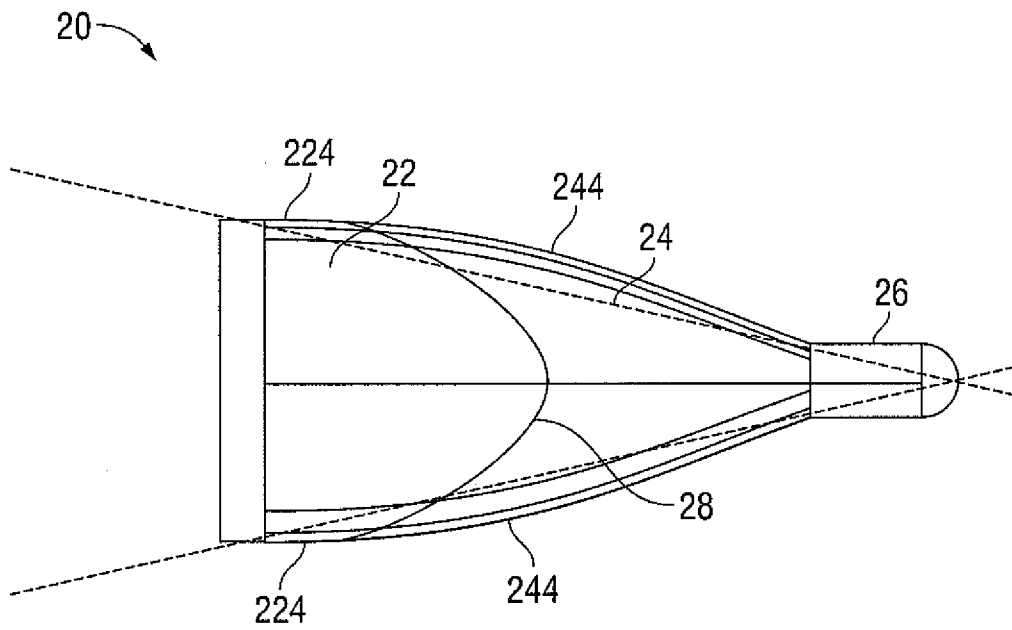

FIG. 6

5/10

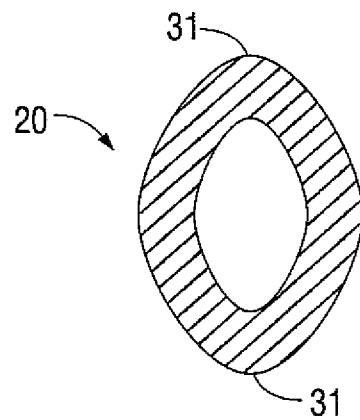

FIG. 6A

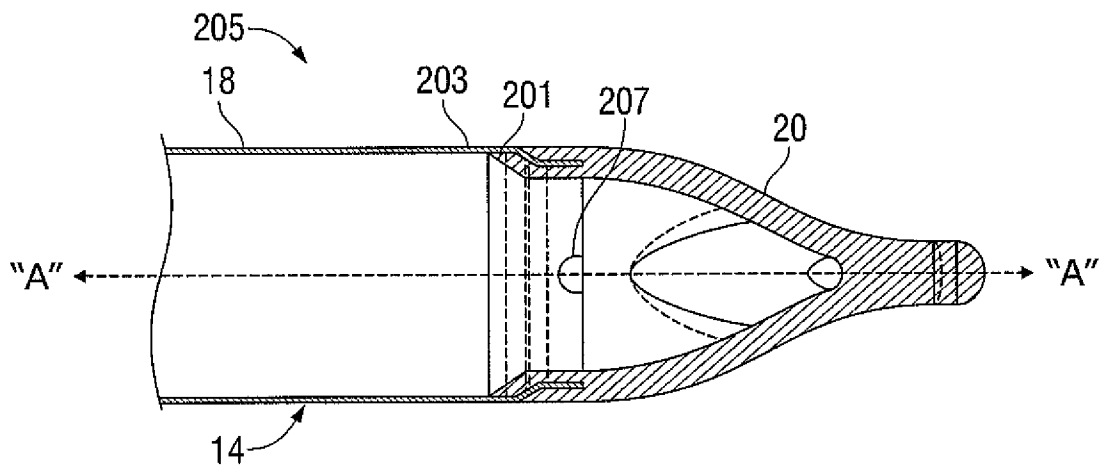

FIG. 6B

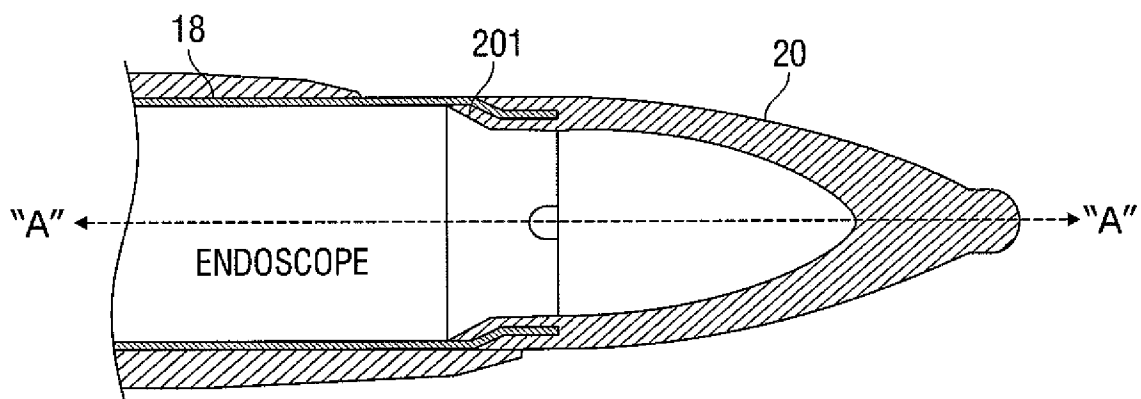

FIG. 6C

6/10

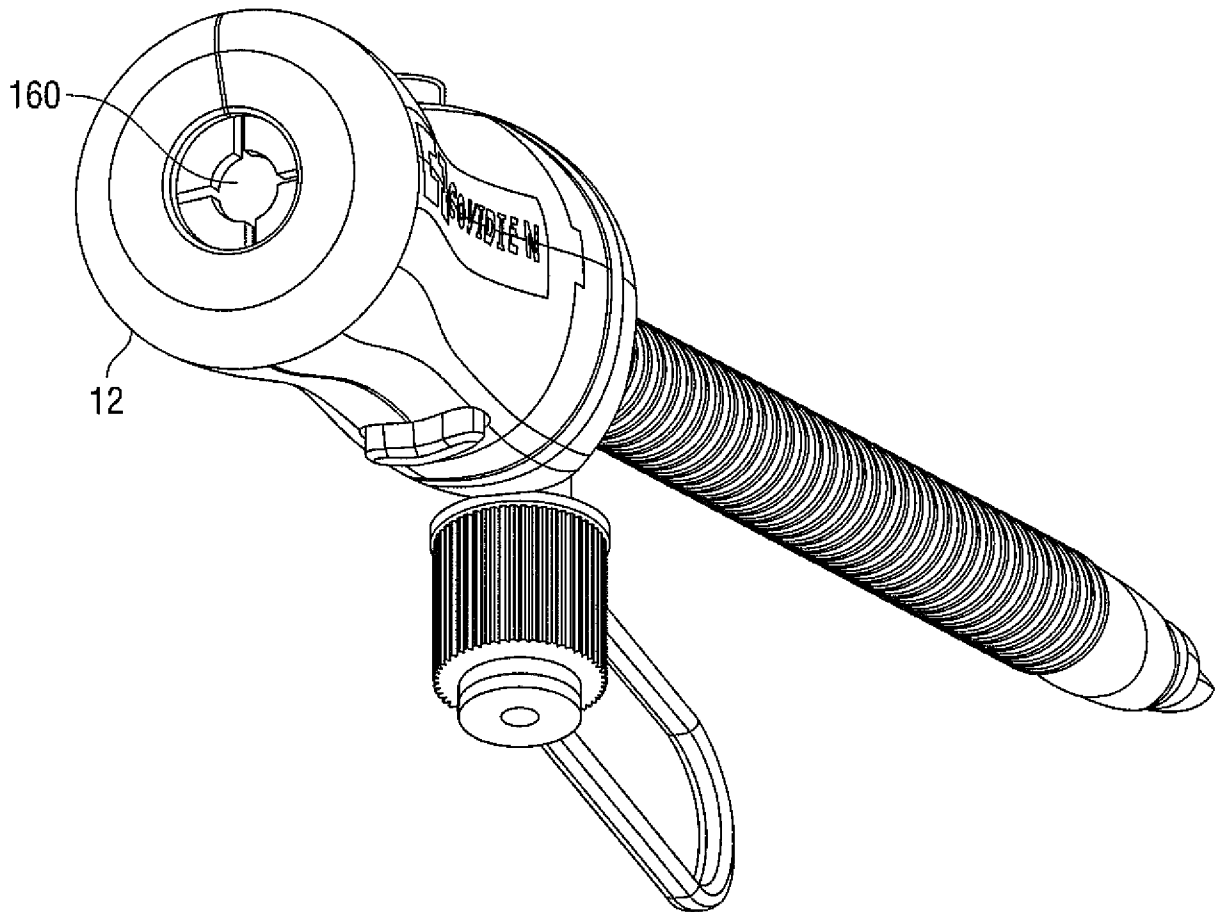

FIG. 7

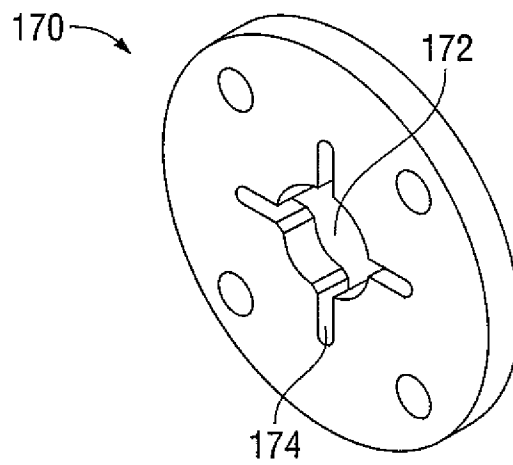

FIG. 8

7/10

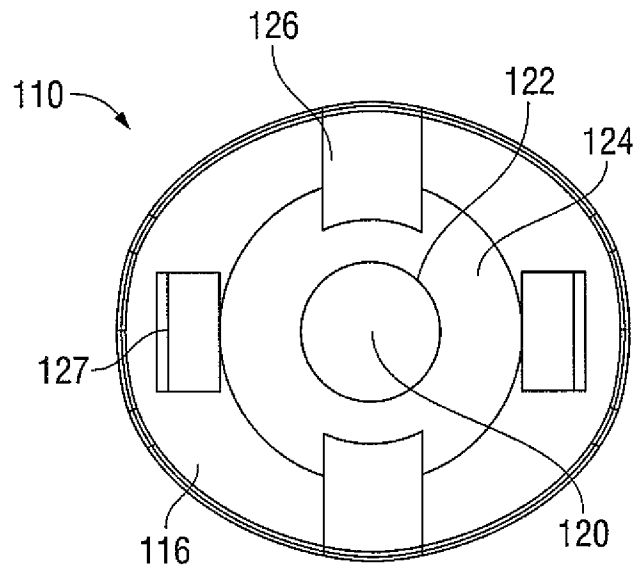

FIG. 9

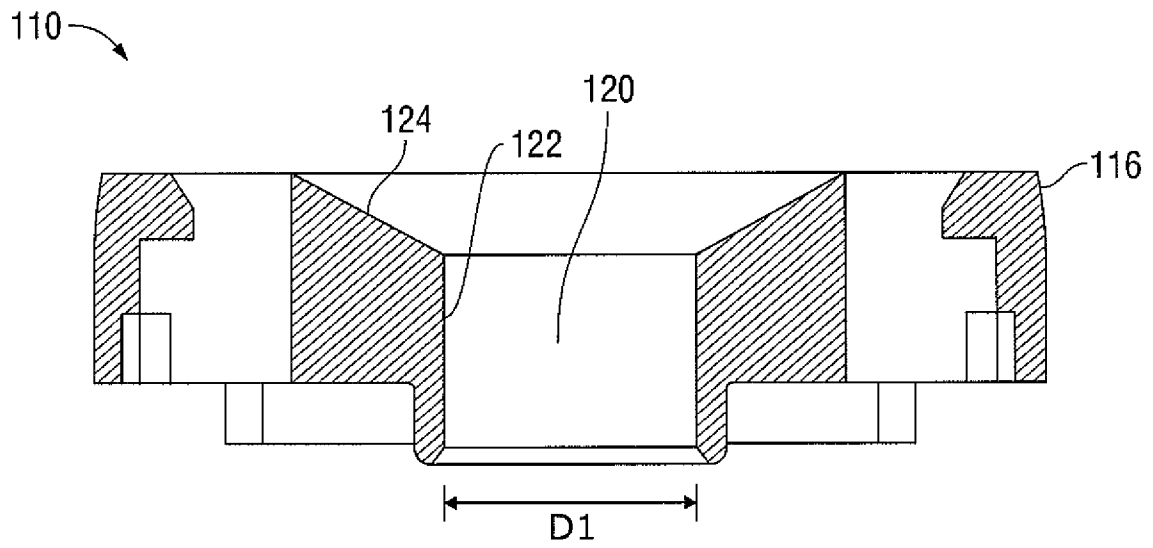

FIG. 10

8/10

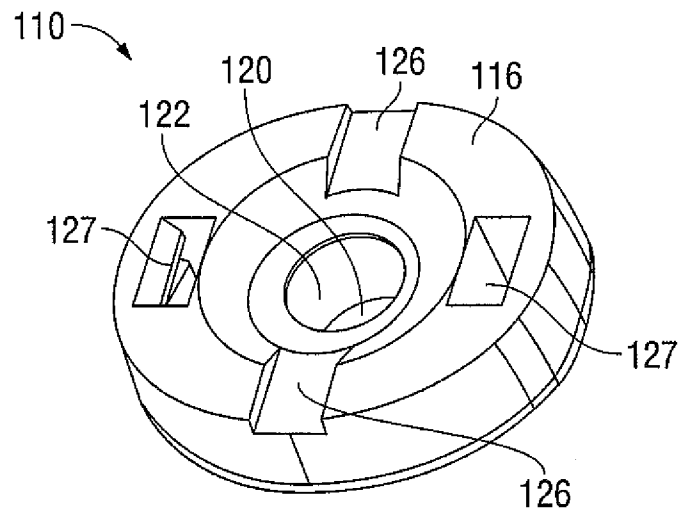

FIG. 11

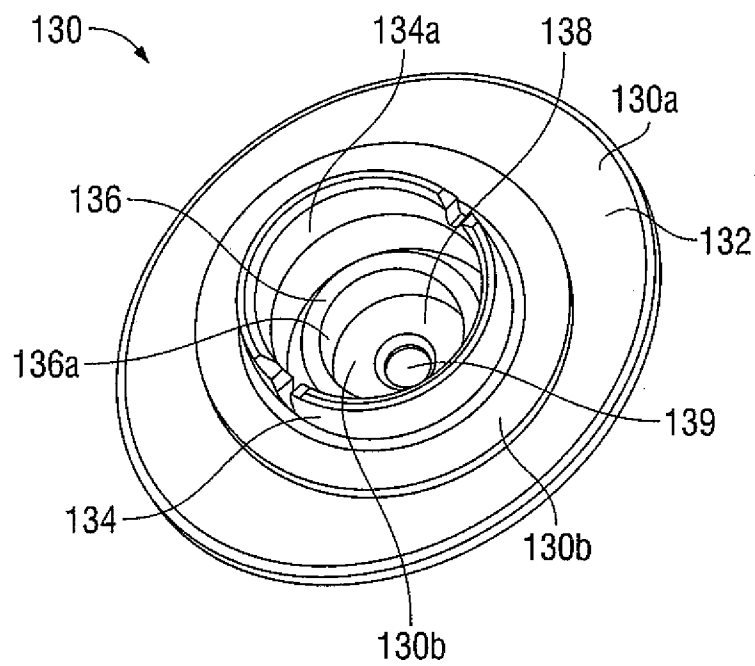

FIG. 12

9/10

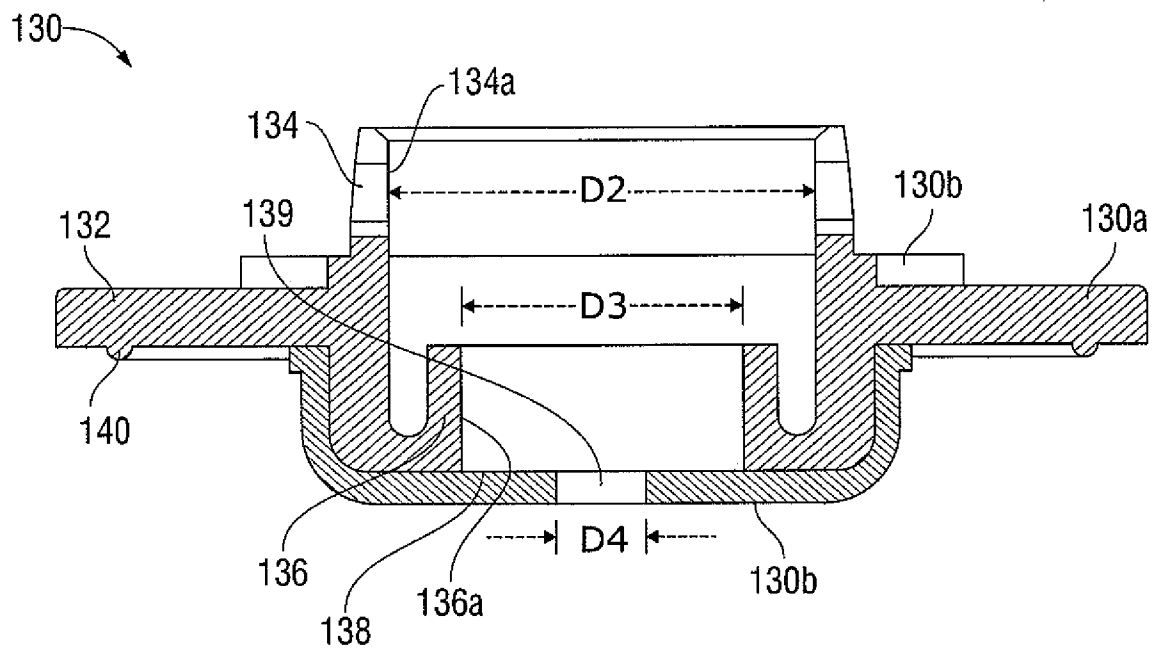

FIG. 13

10/10

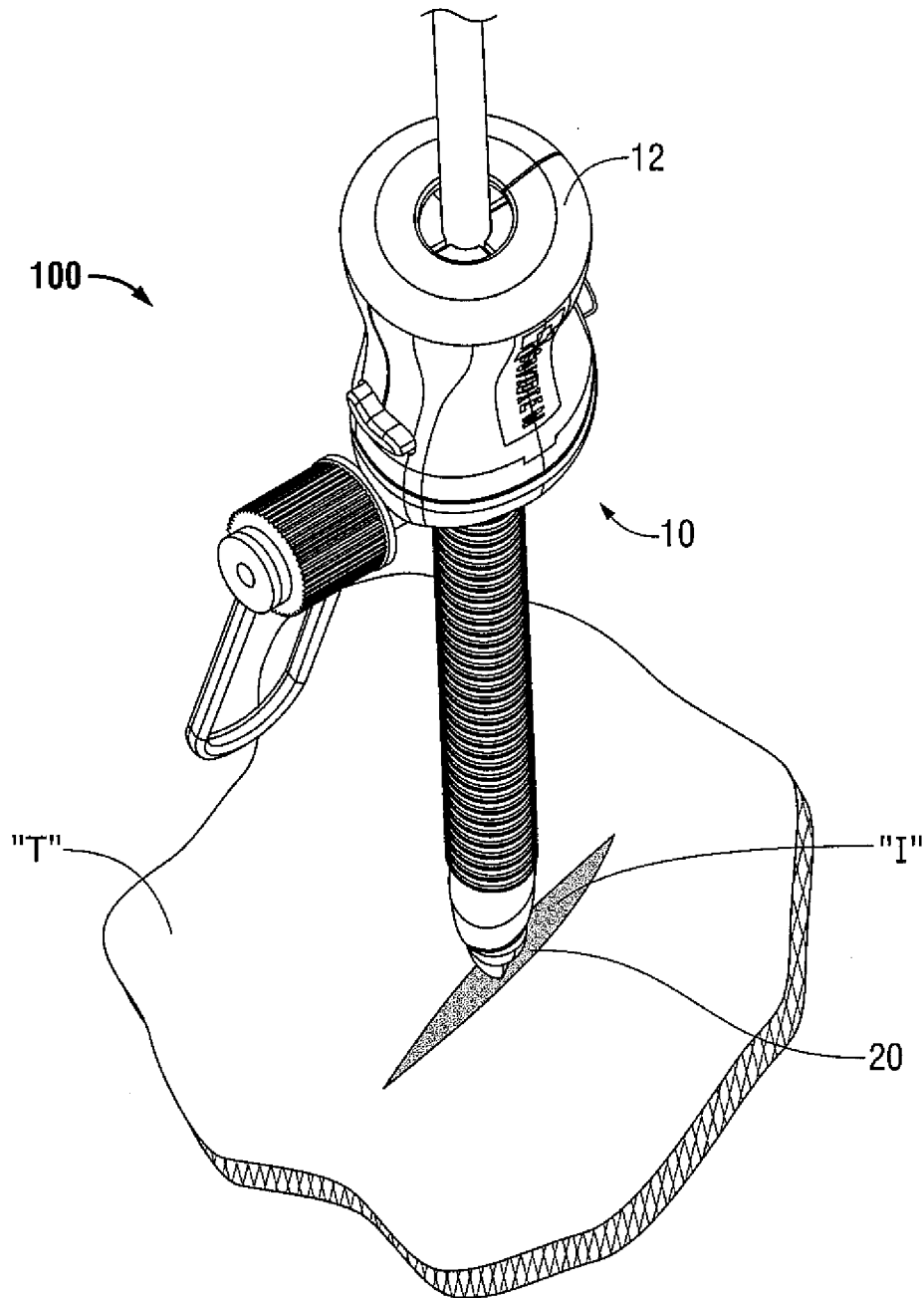

FIG. 14

INTERNATIONAL SEARCH REPORT

International application No.
PCT/US2012/060392**A. CLASSIFICATION OF SUBJECT MATTER*****A61B 17/34(2006.01)i, A61B 17/02(2006.01)i, A61B 17/94(2006.01)i, A61B 19/00(2006.01)i, A61M 25/01(2006.01)i***

According to International Patent Classification (IPC) or to both national classification and IPC

B. FIELDS SEARCHED

Minimum documentation searched (classification system followed by classification symbols)

A61B 17/34; A61B 1/00; A61B 17/00; A61B 1/06

Documentation searched other than minimum documentation to the extent that such documents are included in the fields searched

Korean utility models and applications for utility models

Japanese utility models and applications for utility models

Electronic data base consulted during the international search (name of data base and, where practicable, search terms used)

eKOMPASS(KIPO internal) & Keywords: trocar, obturator, endoscope, optic, cannula

C. DOCUMENTS CONSIDERED TO BE RELEVANT

Category*	Citation of document, with indication, where appropriate, of the relevant passages	Relevant to claim No.
X A	US 2007-0260121 A1 (BAKOS, GREGORY J. et al.) 8 November 2007 See abstract; figs. 1B, 2A-3A; paragraphs 40-41, 48, 50-51; claim 1-3, 10, 13.	1-7, 11, 13-14, 20-21 8-10, 12, 15-19, 22
X	US 2006-0224174 A1 (SMITH, ROBERT C. et al.) 5 October 2006 See abstract; figs. 1, 14; paragraphs 27-28, 42, 44-46; claims 1-2, 16.	1-7, 11, 13-14, 20-21
X	US 2005-0065543 A1 (KAHLE, HENRY et al.) 24 March 2005 See abstract; figs. 1A-4; paragraphs 47, 52-53, 61-62; claims 1-3, 8-9, 15.	1-7, 13-14, 20
X	EP 2000099 A2 (APPLIED MEDICAL RESOURCES CORPORATION) 10 December 2008 See abstract; paragraphs 107-109; figs. 47-48, 54-55.	1-5, 13-14, 20
X	US 2010-0016664 A1 (VIOLA, FRANK J.) 21 January 2010 See abstract; figs. 1-2; paragraphs 27-29; claims 1-2, 10, 12.	1-7, 11, 13-14, 20-21

☐ Further documents are listed in the continuation of Box C.☒ See patent family annex.

* Special categories of cited documents:

"A" document defining the general state of the art which is not considered to be of particular relevance

"E" earlier application or patent but published on or after the international filing date

"L" document which may throw doubts on priority claim(s) or which is cited to establish the publication date of citation or other special reason (as specified)

"O" document referring to an oral disclosure, use, exhibition or other means

"P" document published prior to the international filing date but later than the priority date claimed

"T" later document published after the international filing date or priority date and not in conflict with the application but cited to understand the principle or theory underlying the invention

"X" document of particular relevance; the claimed invention cannot be considered novel or cannot be considered to involve an inventive step when the document is taken alone

"Y" document of particular relevance; the claimed invention cannot be considered to involve an inventive step when the document is combined with one or more other such documents, such combination being obvious to a person skilled in the art

"&" document member of the same patent family

Date of the actual completion of the international search

21 MARCH 2013 (21.03.2013)

Date of mailing of the international search report

22 MARCH 2013 (22.03.2013)

Name and mailing address of the ISA/KR

Korean Intellectual Property Office
189 Cheongsa-ro, Seo-gu, Daejeon Metropolitan
City, 302-701, Republic of Korea

Facsimile No. 82-42-472-7140

Authorized officer

YANG, Kyung Shik

Telephone No. 5655



INTERNATIONAL SEARCH REPORT

Information on patent family members

International application No.

PCT/US2012/060392

Patent document cited in search report	Publication date	Patent family member(s)	Publication date
US 2007-0260121 A1	08.11.2007	None	
US 2006-0224174 A1	05.10.2006	AU 2006-200776 A1 AU 2006-200776 B2 CA 2541073 A1 DE 602006001138 D1 EP 1707132 A2 EP 1707132 A3 EP 1707132 B1 ES 2306309 T3 JP 2006-280918 A US 2009-076323 A1 US 7470230 B2	19.10.2006 02.02.2012 30.09.2006 26.06.2008 04.10.2006 15.11.2006 14.05.2008 01.11.2008 19.10.2006 19.03.2009 30.12.2008
US 2005-0065543 A1	24.03.2005	AU 2004-277429 A1 AU 2004-277429 B2 AU 2005-260071 A1 AU 2005-260071 B2 CA 2461166 A1 CA 2540682 A1 CA 2572192 A1 EP 1429660 A1 EP 1670349 A2 EP 1765197 A1 JP 04-287273 B2 JP 05-004793 B2 JP 2005-503230 A JP 2007-516737 A JP 2008-504886 A JP 2012-135650 A US 2005-0107816 A1 US 2005-0288622 A1 US 2010-0210998 A1 US 2010-0222801 A1 US 2011-190592 A1 US 7686823 B2 US 7708713 B2 US 7947058 B2 US 8128590 B2 WO 03-026512 A1 WO 2005-032348 A2 WO 2005-032348 A3 WO 2006-004652 A1	14.04.2005 23.12.2010 12.01.2006 30.06.2011 03.04.2003 14.04.2005 12.01.2006 23.06.2004 21.06.2006 28.03.2007 03.04.2009 01.06.2012 03.02.2005 28.06.2007 21.02.2008 19.07.2012 19.05.2005 29.12.2005 19.08.2010 02.09.2010 04.08.2011 30.03.2010 04.05.2010 24.05.2011 06.03.2012 03.04.2003 14.04.2005 14.04.2005 12.01.2006
EP 2000099 A2	10.12.2008	AU 2006-304892 A1 EP 1933733 A2 EP 2000099 A3 US 2007-088277 A1 WO 2007-048083 A2	26.04.2007 25.06.2008 29.07.2009 19.04.2007 26.04.2007

INTERNATIONAL SEARCH REPORT

Information on patent family members

International application No.

PCT/US2012/060392

Patent document cited in search report	Publication date	Patent family member(s)	Publication date
US 2010-0016664 A1	21.01.2010	WO 2007-048083 A3	03.07.2008
		AU 2007-338691 A1	03.07.2008
		CA 2669983 A1	03.07.2008
		EP 2101658 A1	23.09.2009
		JP 2010-512959 A	30.04.2010
		JP 2010-512959 T	30.04.2010
		WO 2008-079373 A1	03.07.2008