



US 20180168695A1

(19) **United States**

(12) **Patent Application Publication**  
**Sicvol et al.**

(10) **Pub. No.: US 2018/0168695 A1**

(43) **Pub. Date: Jun. 21, 2018**

(54) **PERCUTANEOUS ACCESS DEVICES AND BONE ANCHOR ASSEMBLIES**

Mar. 28, 2007, now Pat. No. 7,854,751, which is a continuation of application No. 11/672,539, filed on Feb. 8, 2007, now abandoned, which is a continuation of application No. 10/738,286, filed on Dec. 16, 2003, now Pat. No. 7,179,261.

(71) Applicant: **MEDOS INTERNATIONAL SARL**,  
Le Locle (CH)

(72) Inventors: **Christopher Sicvol**, Durham, NC (US);  
**Erasmo Lopez**, Wyndmoor, PA (US);  
**Ramon Ruberte**, Durham, NC (US)

(73) Assignee: **MEDOS INTERNATIONAL SARL**,  
Le Locle (CH)

**Publication Classification**

(51) **Int. Cl.**  
**A61B 17/70** (2006.01)  
(52) **U.S. Cl.**  
CPC ..... **A61B 17/708** (2013.01); **A61B 17/7032**  
(2013.01); **A61B 17/7035** (2013.01)

(21) Appl. No.: **15/898,951**

(57) **ABSTRACT**

(22) Filed: **Feb. 19, 2018**

A percutaneous access device includes an inner tube and an outer tube disposed about at least a portion of the inner tube. The outer tube may be sized to span from a skin incision in a patient to a site proximate the spine of the patient. The distal end of the outer tube may be adapted to releasably engage a bone anchor. The inner tube may be adjustable relative to the outer tube between a first position and a second position in which the distal end of the inner tube contacts the bone anchor. A bone anchor assembly includes a bone anchor having a distal bone engaging portion and a receiving member having a recess for receiving a spinal fixation element. The proximal end of the receiving member may have an arcuate groove formed on an exterior surface thereof to facilitate connection of an instrument to the receiving member.

**Related U.S. Application Data**

(63) Continuation of application No. 15/722,048, filed on Oct. 2, 2017, which is a continuation of application No. 15/438,803, filed on Feb. 22, 2017, which is a continuation of application No. 15/438,351, filed on Feb. 21, 2017, which is a continuation of application No. 15/230,392, filed on Aug. 6, 2016, which is a continuation of application No. 13/938,222, filed on Jul. 9, 2013, now Pat. No. 9,439,699, which is a continuation of application No. 12/945,676, filed on Nov. 12, 2010, now Pat. No. 8,518,082, which is a continuation of application No. 11/692,531, filed on

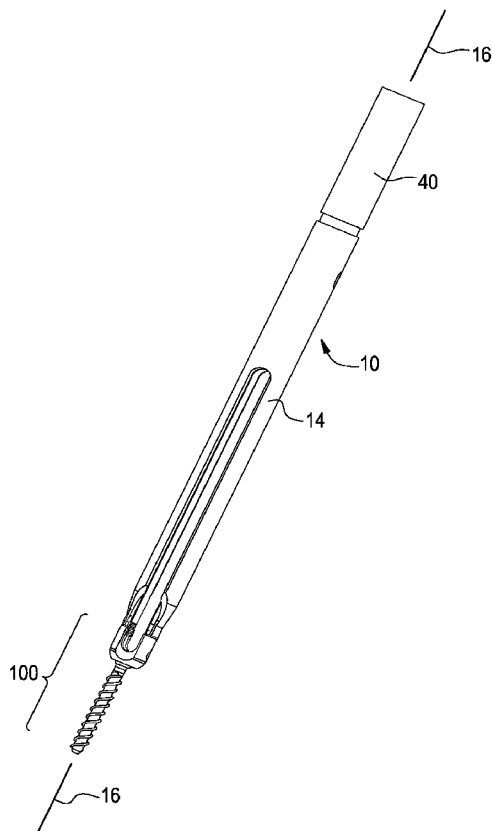

FIG. 1

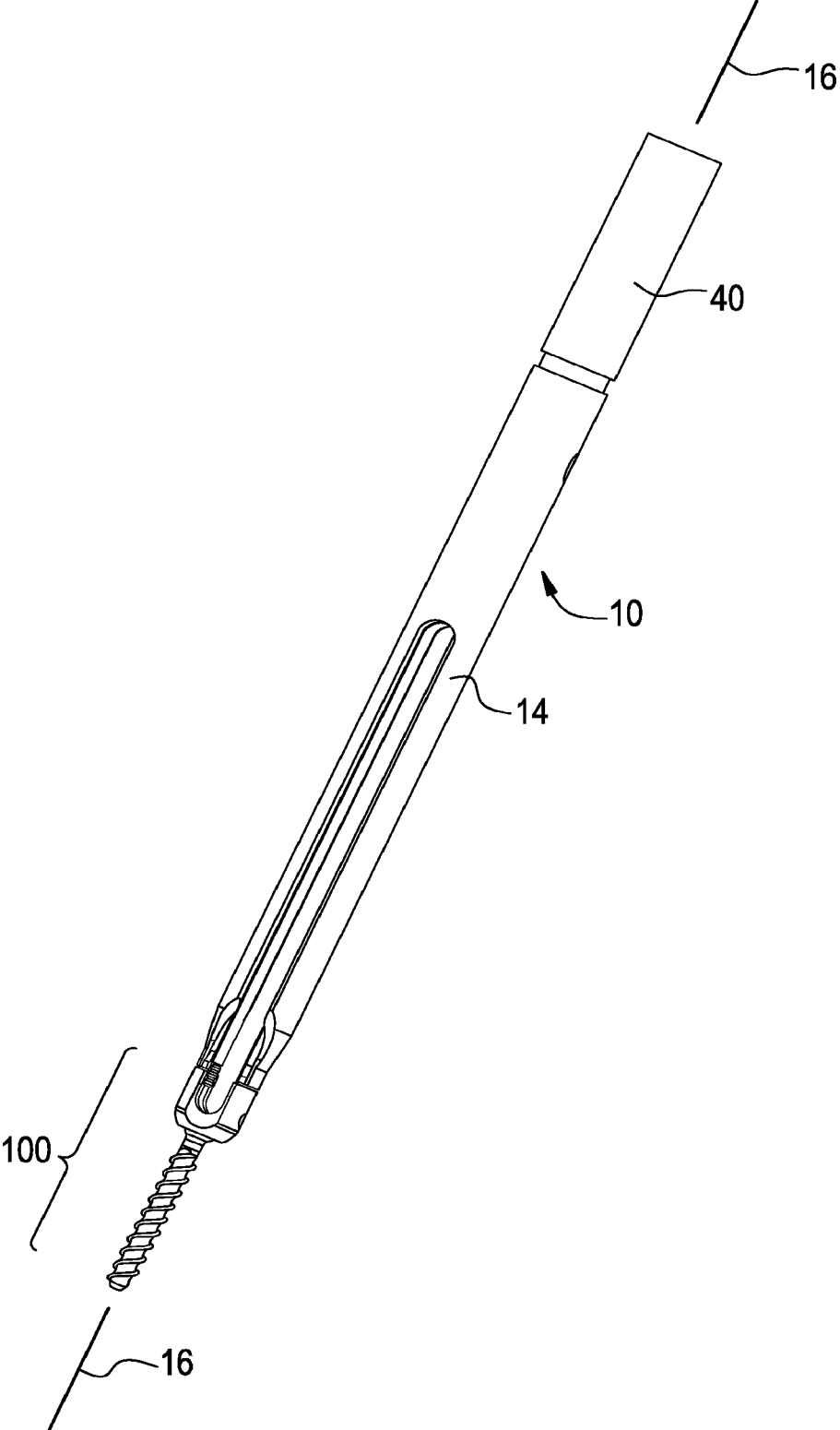

FIG. 2

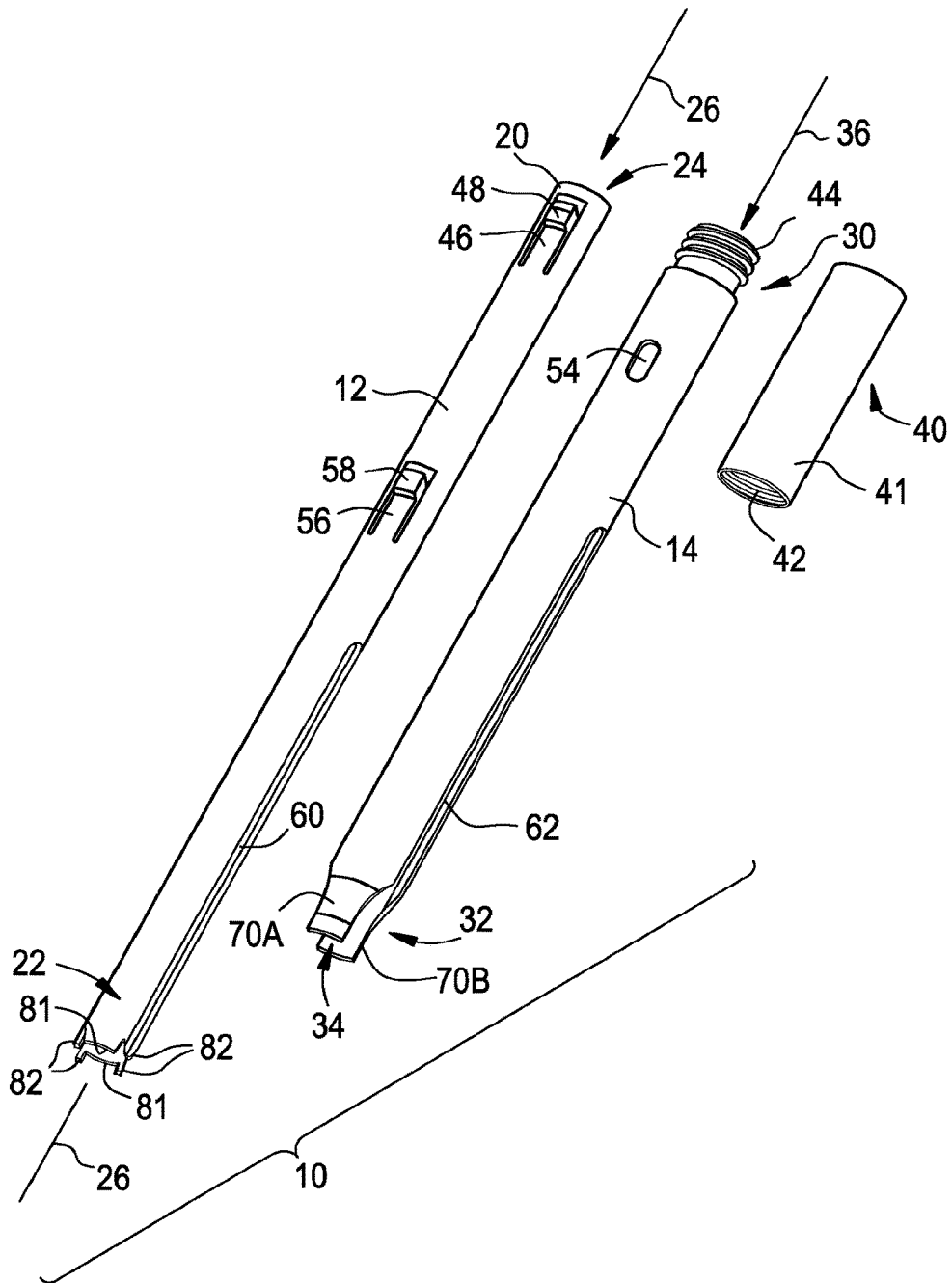

FIG. 3

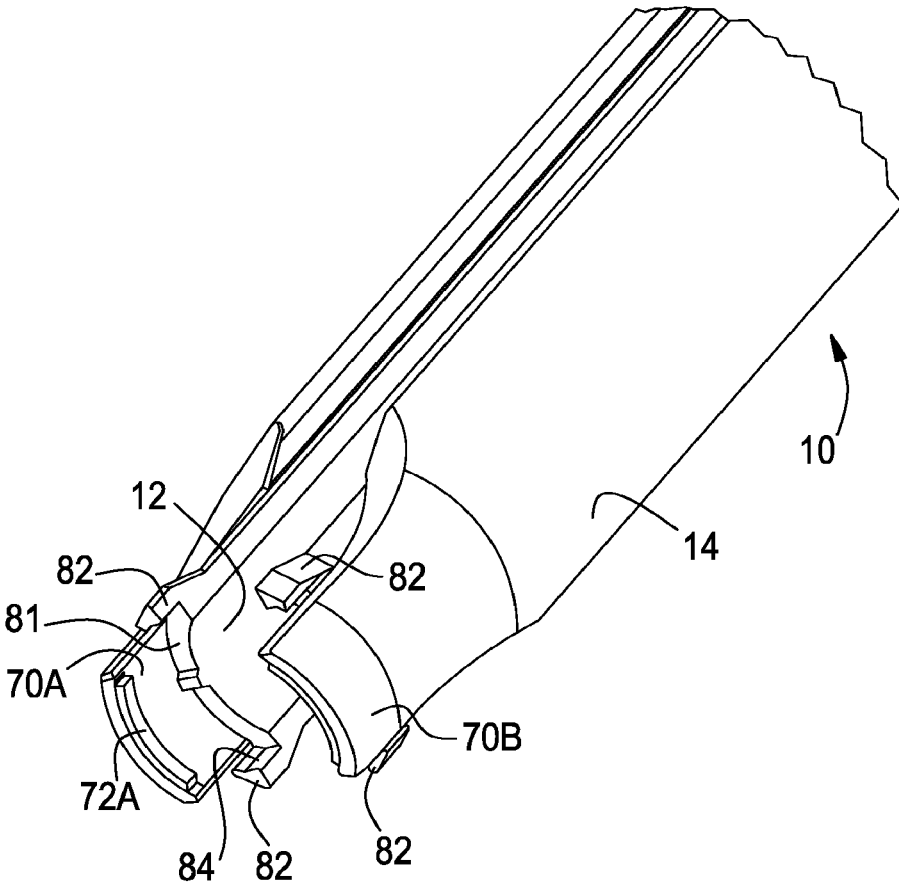

FIG. 4

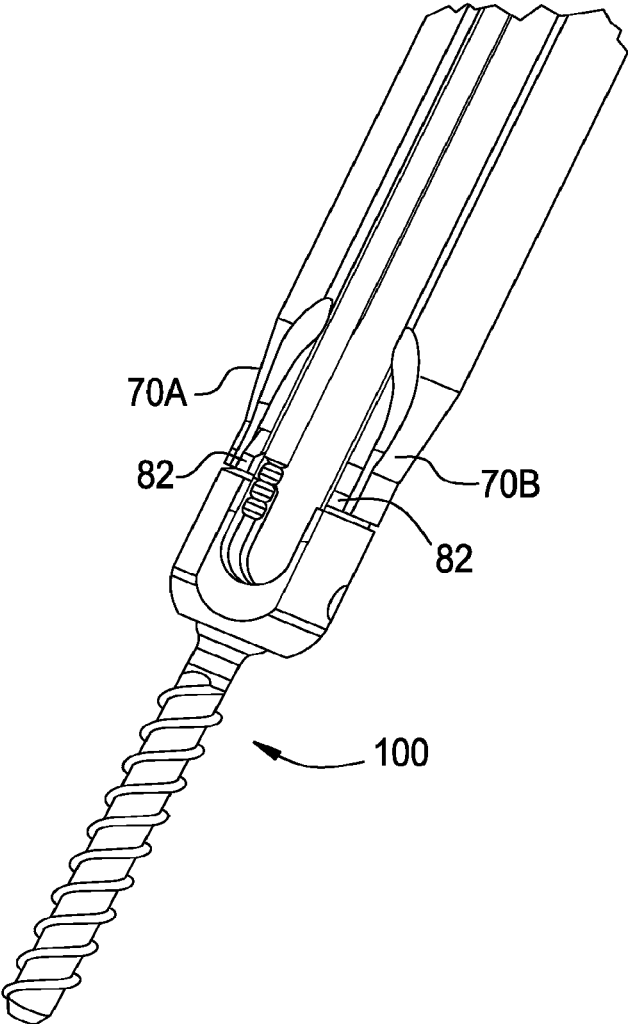

FIG. 5

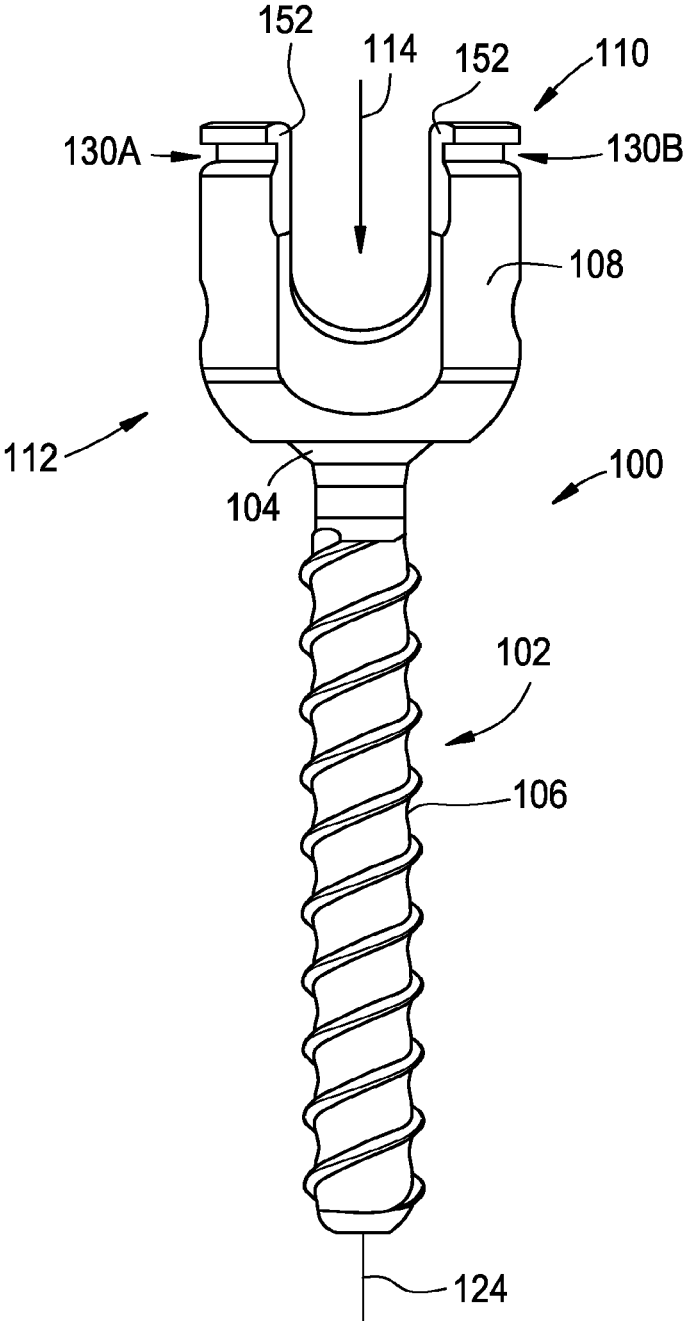

FIG. 6

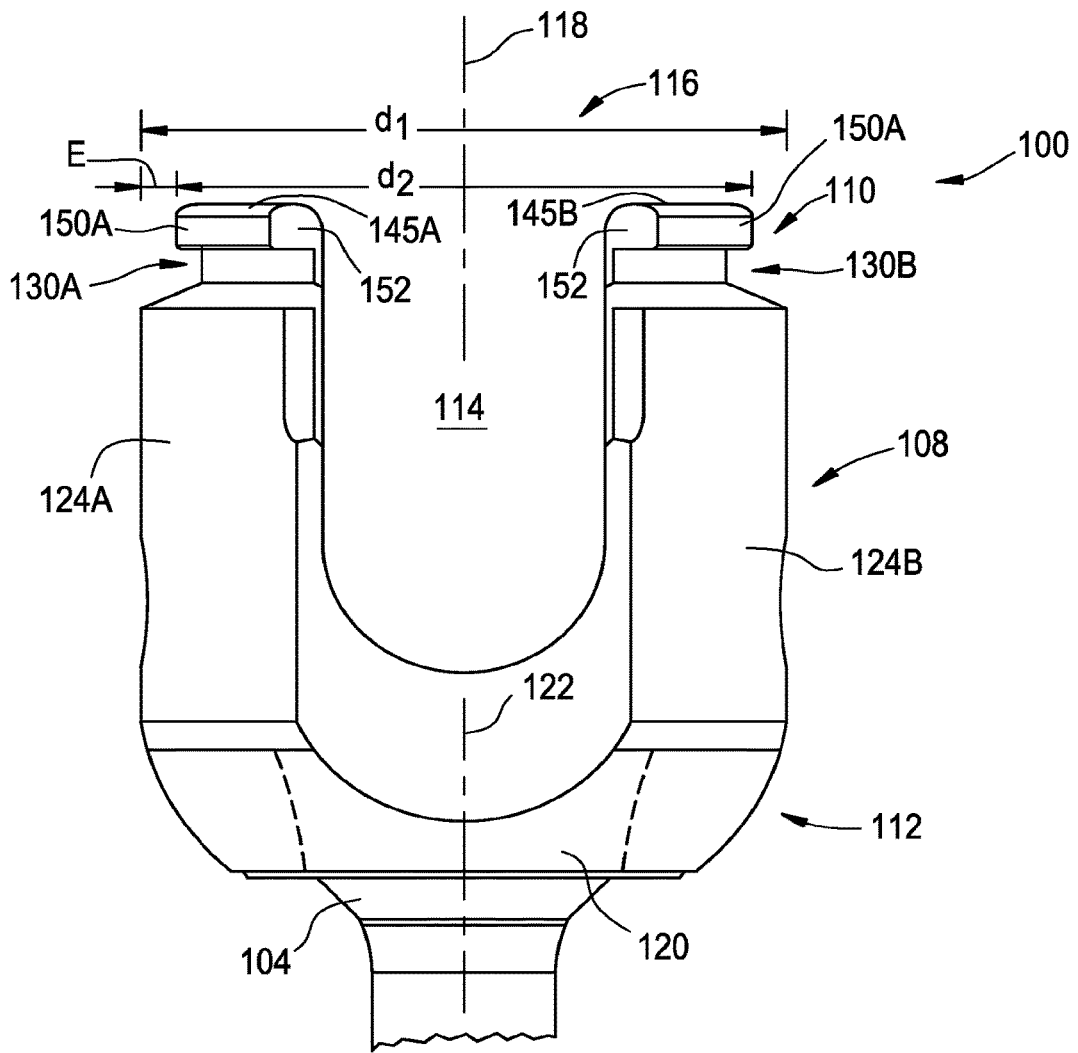

FIG. 7

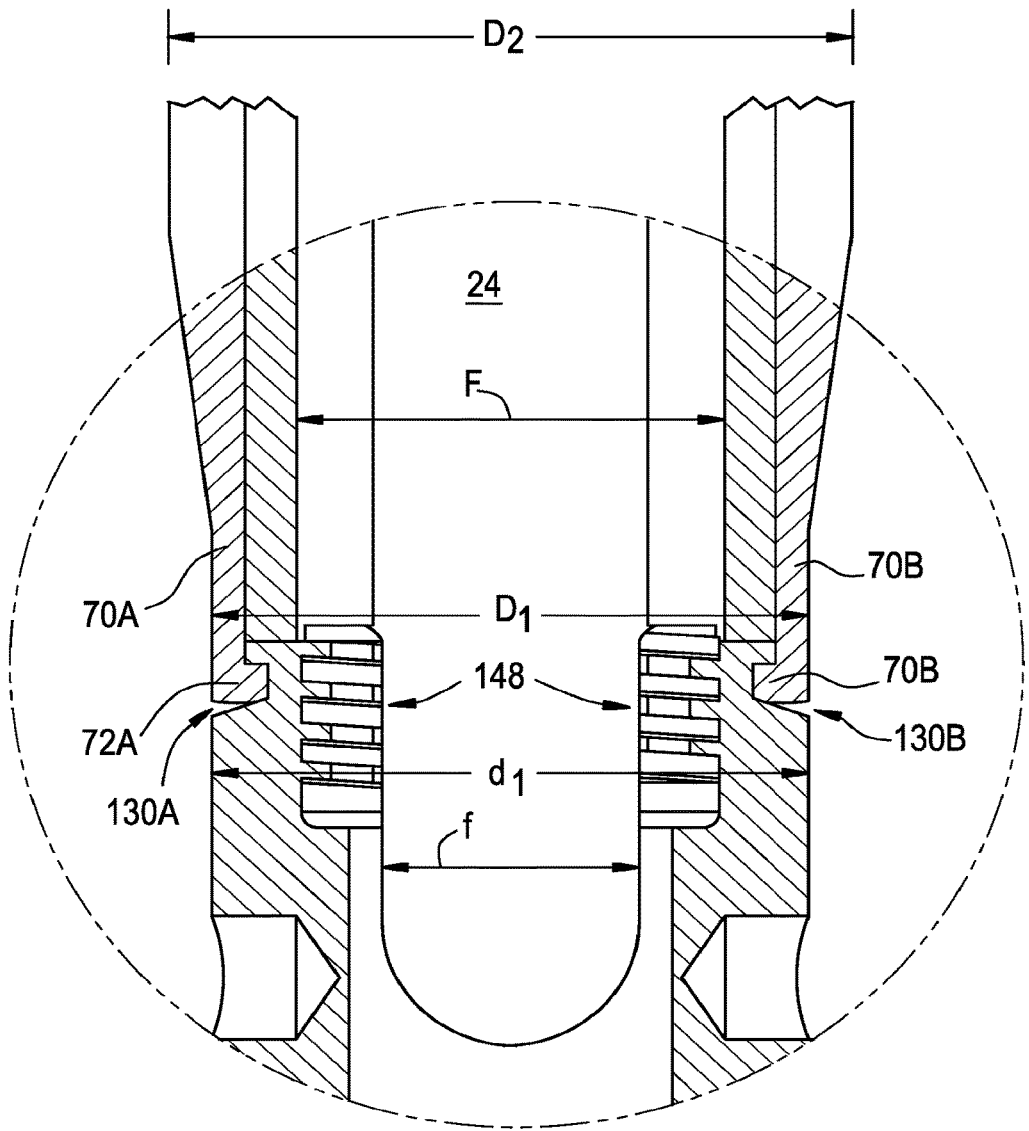



FIG. 8

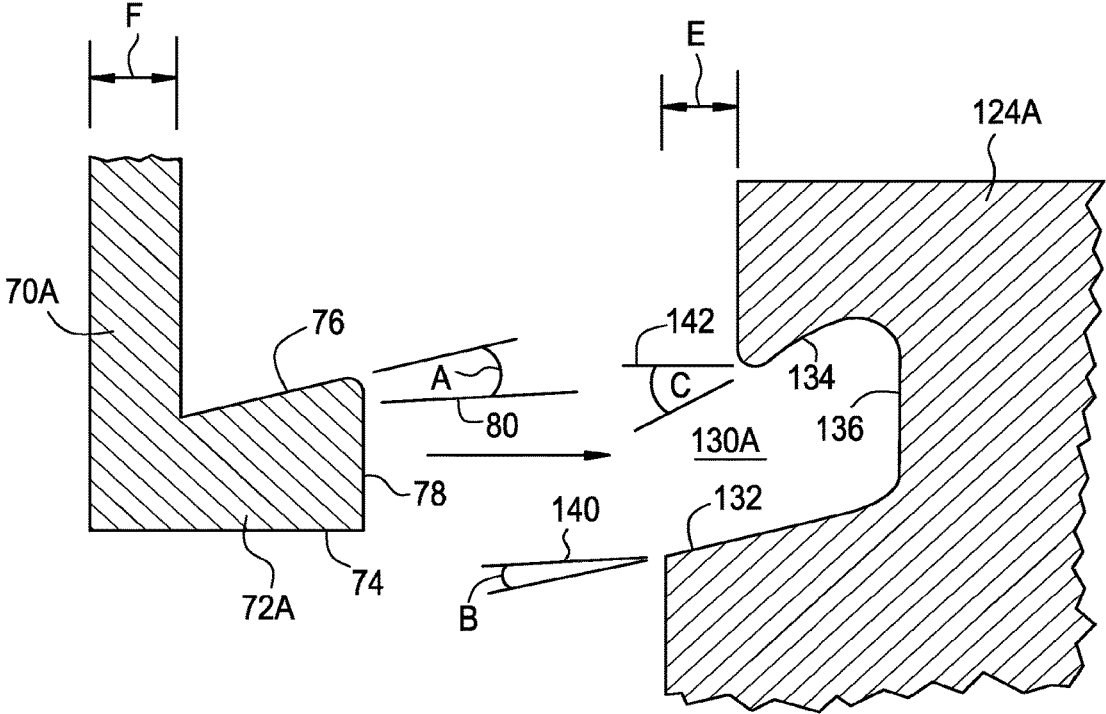

FIG. 9

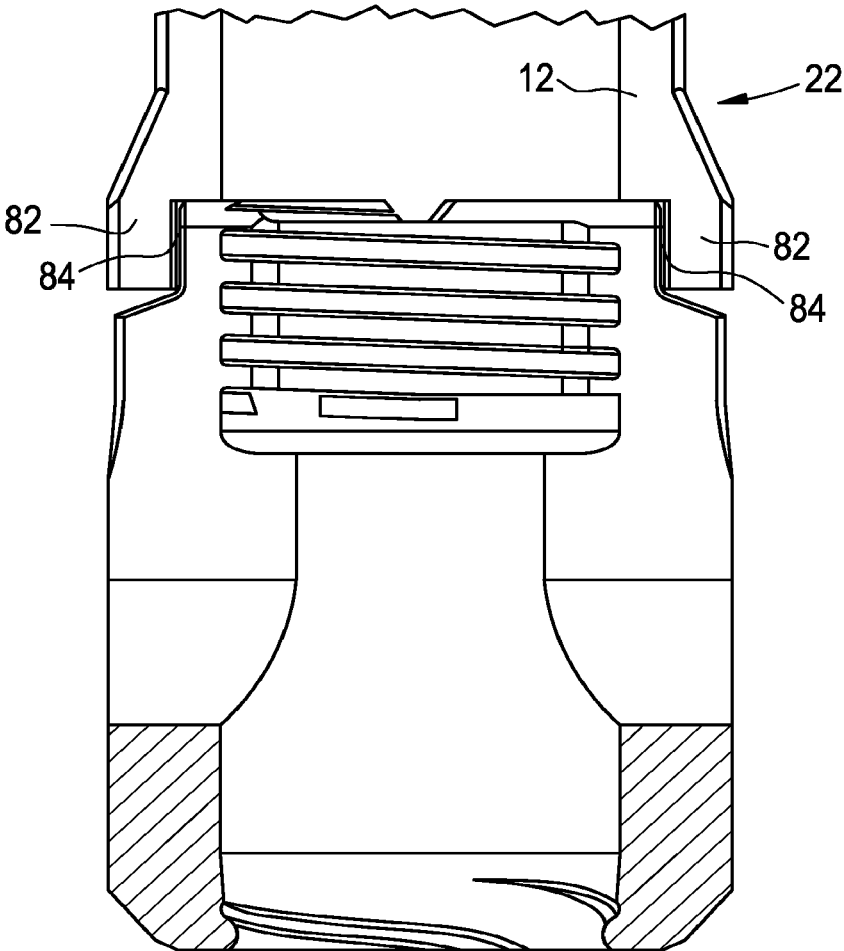

FIG. 10

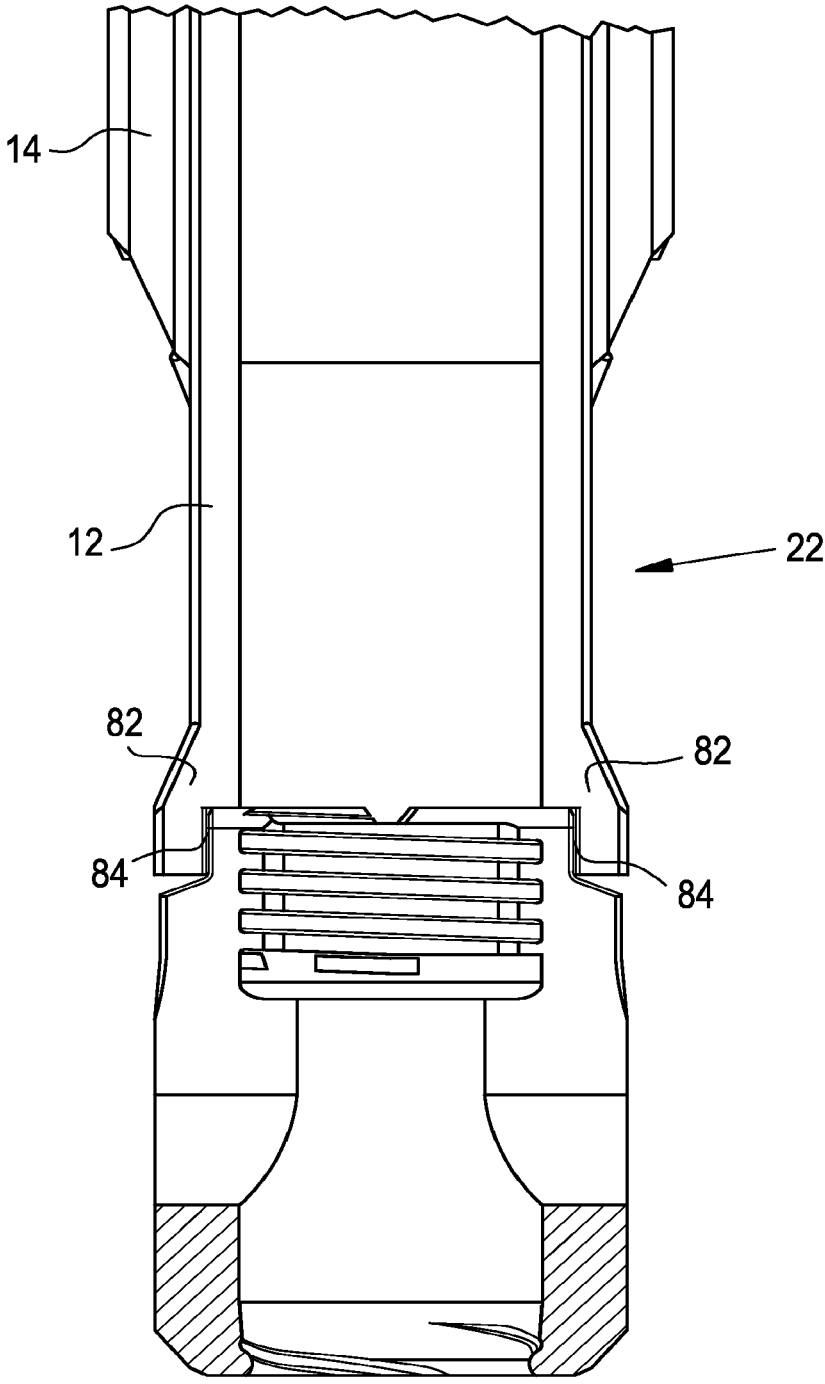

FIG. 11A

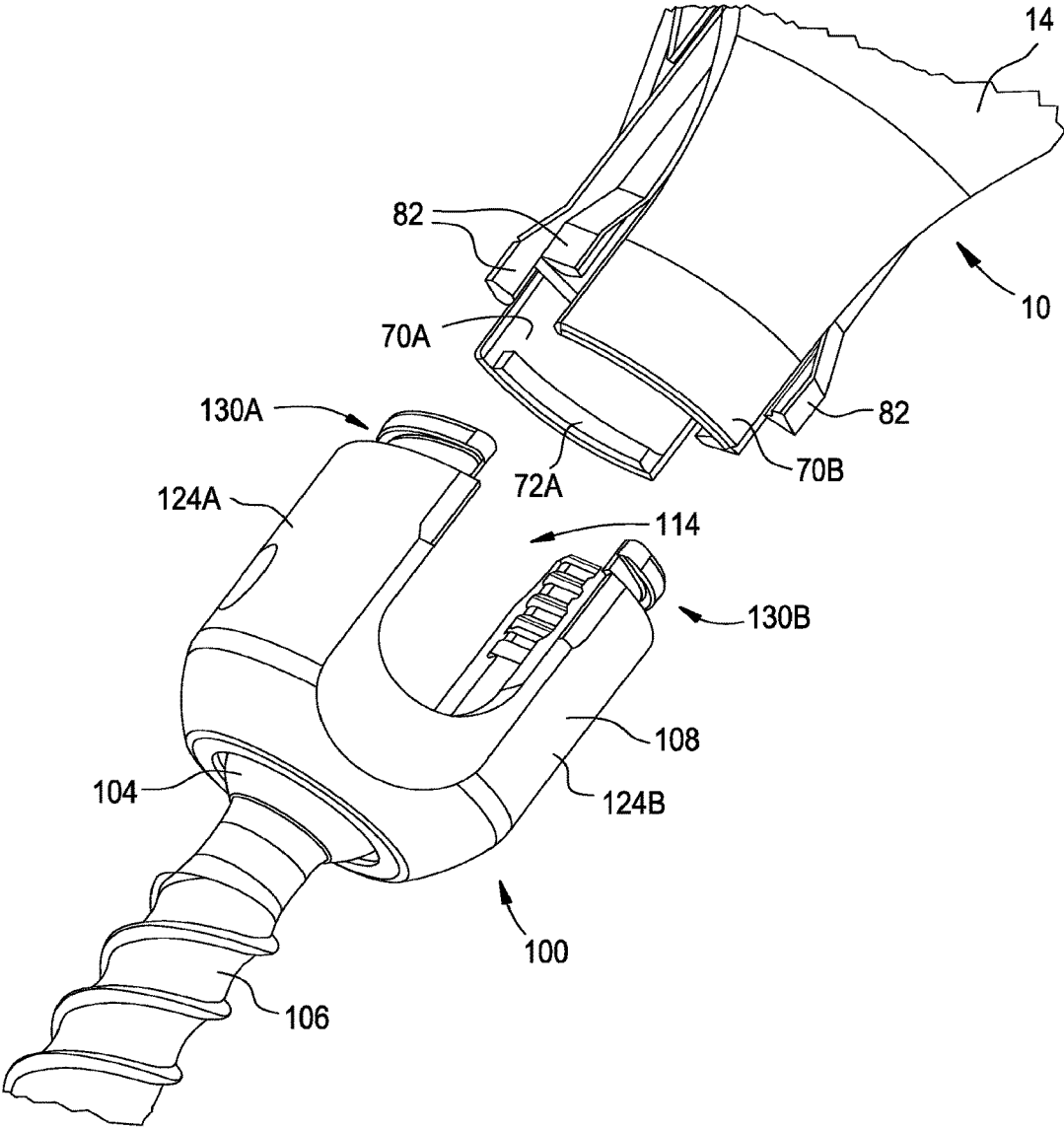

FIG. 11B

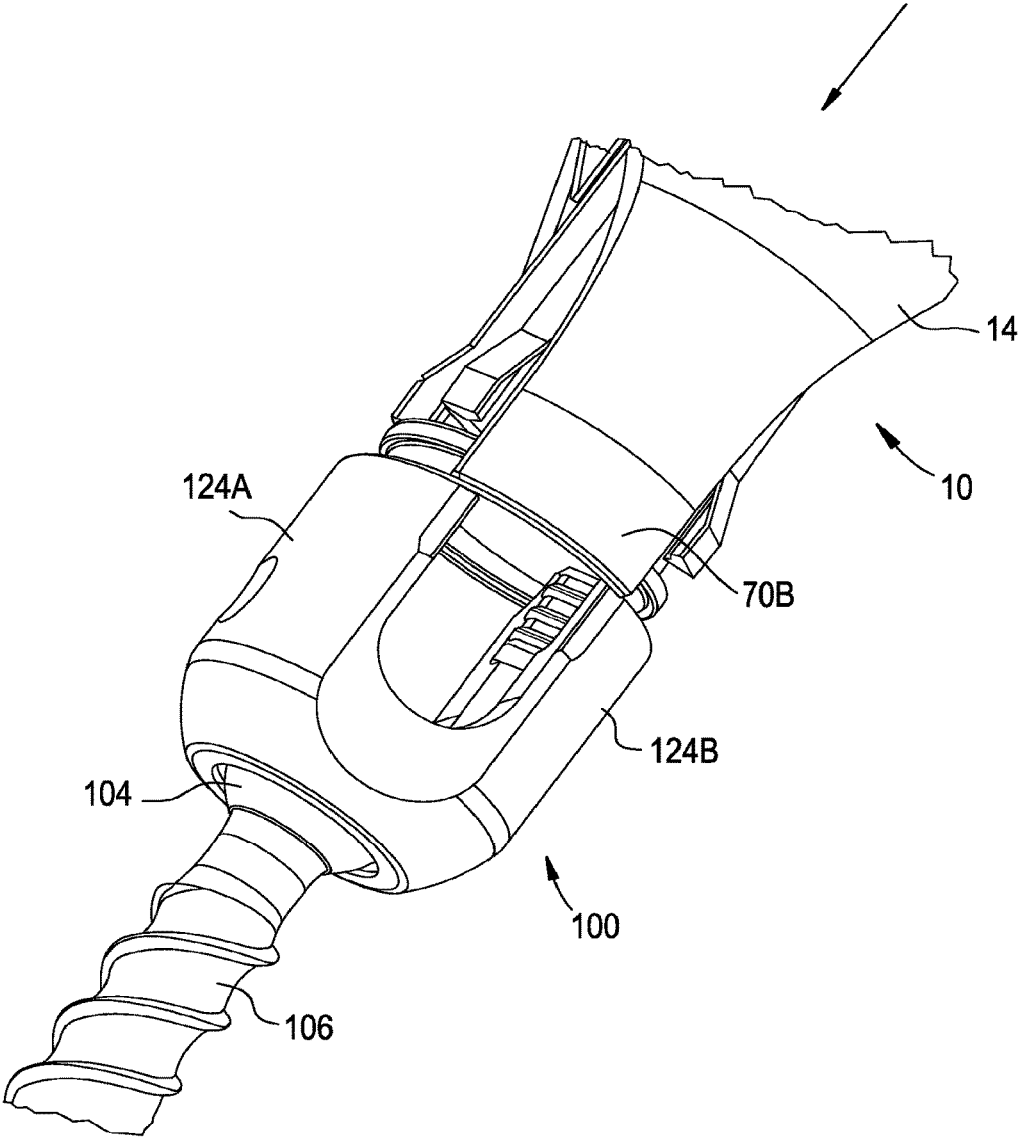

FIG. 11C

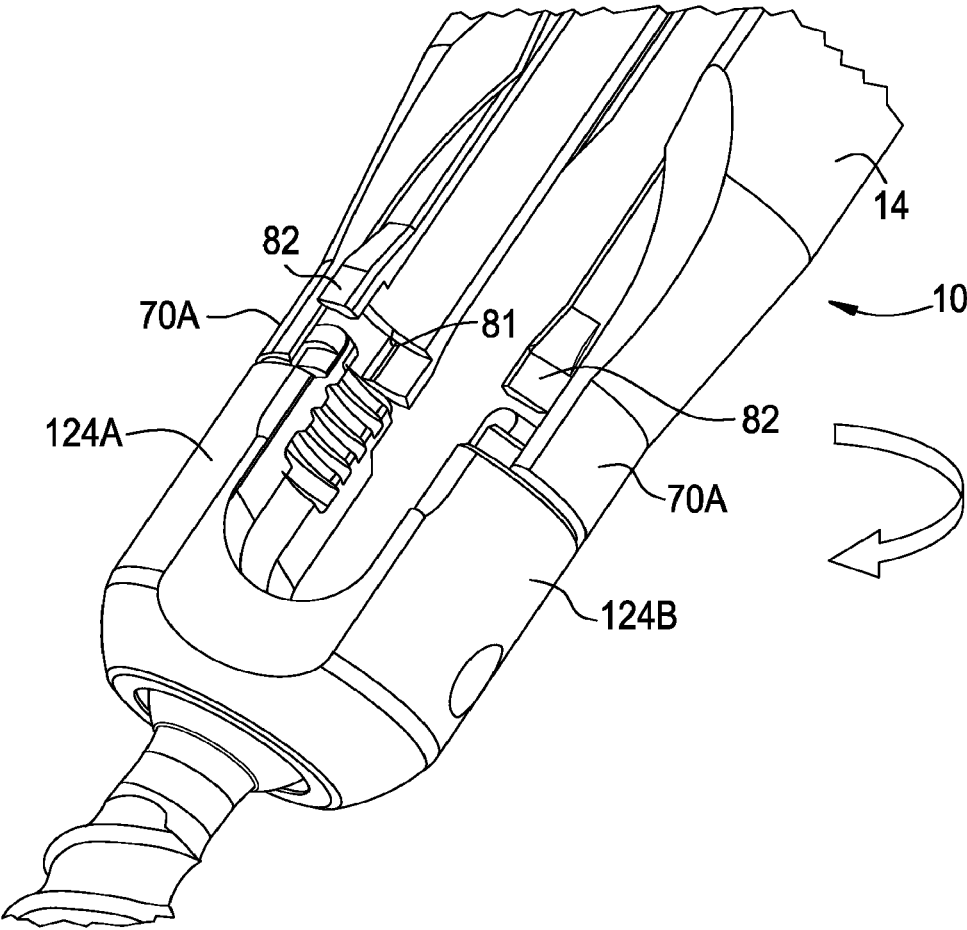

FIG. 11D

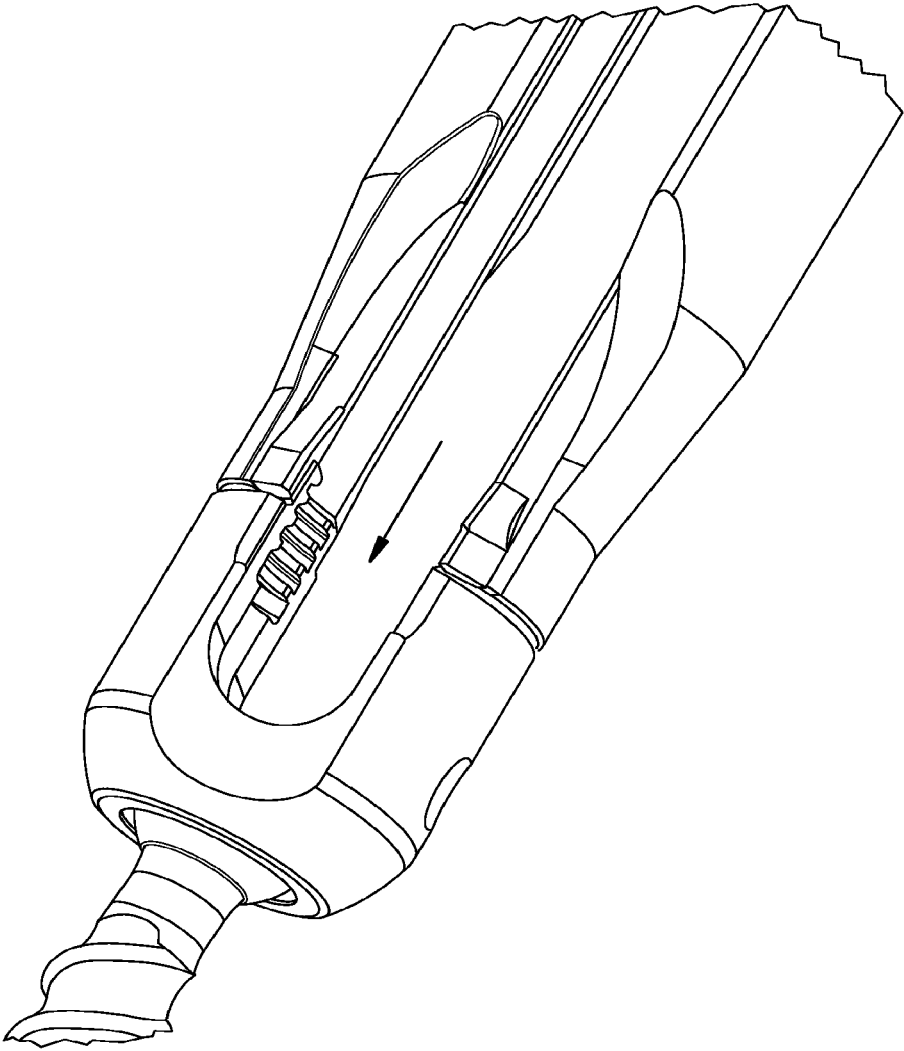

FIG. 12

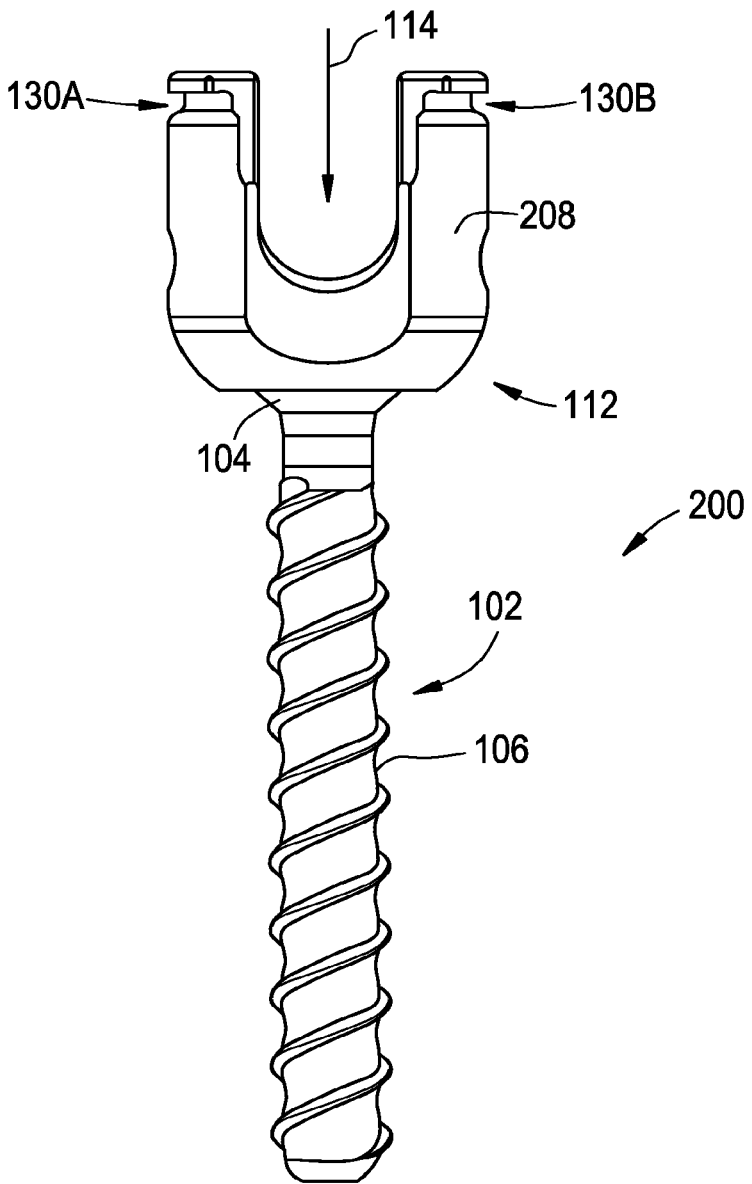



FIG. 13

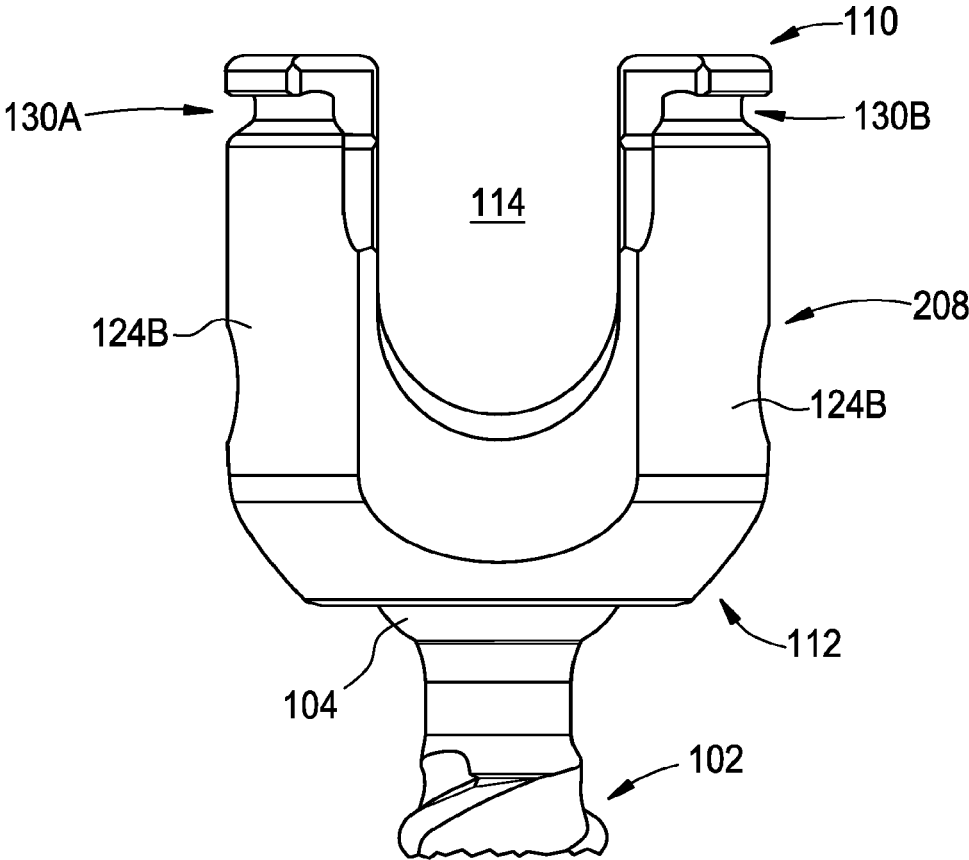

FIG. 14

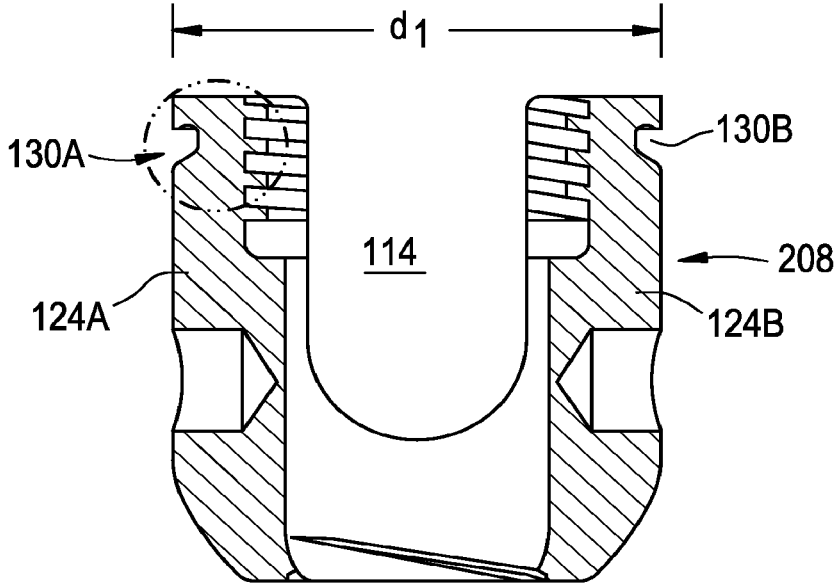

FIG. 15

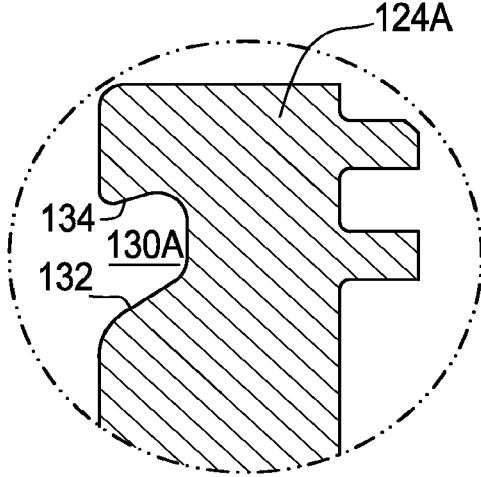

FIG. 16

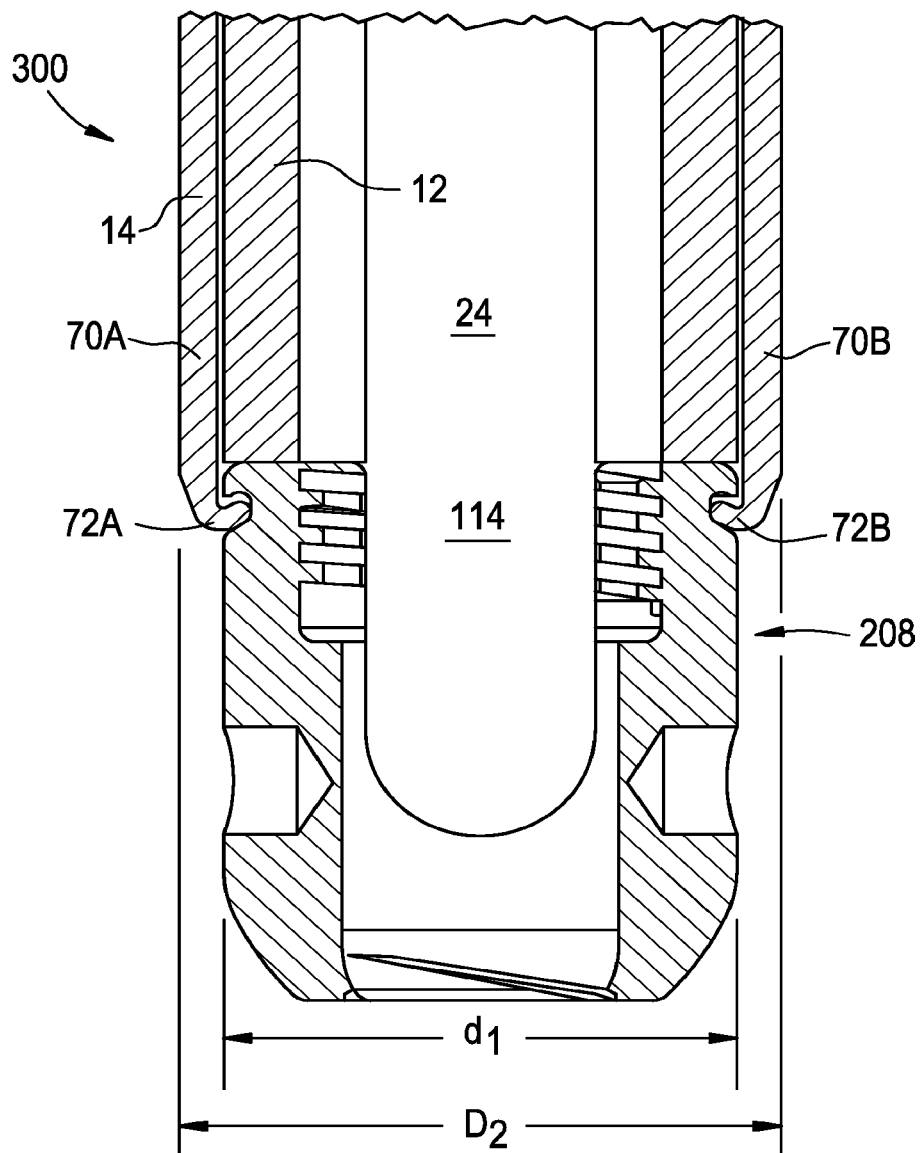

FIG. 17A

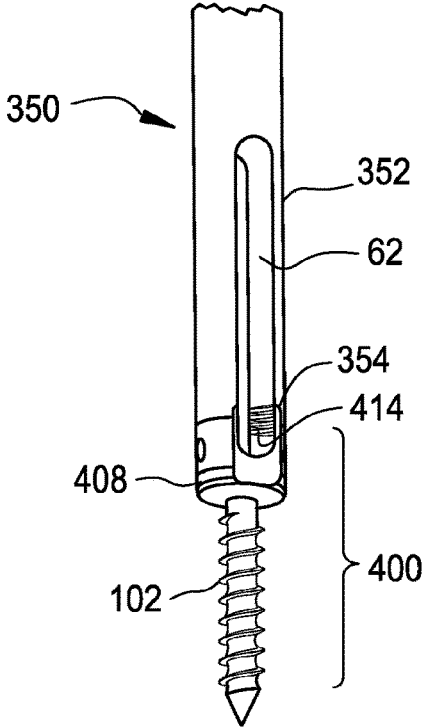

FIG. 17B

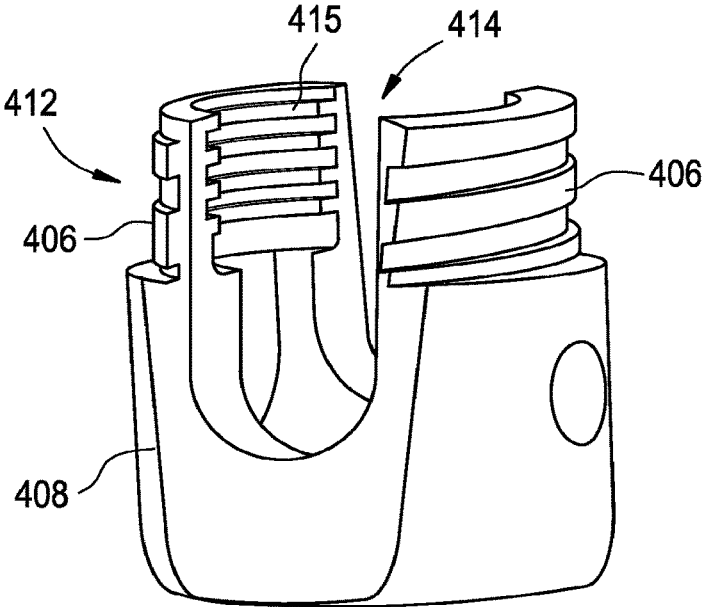

FIG. 18A

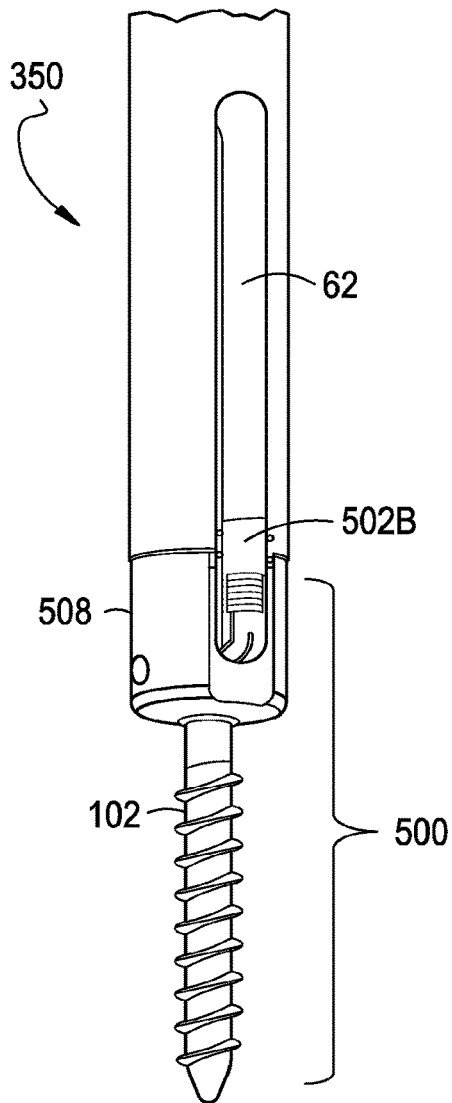

FIG. 18B

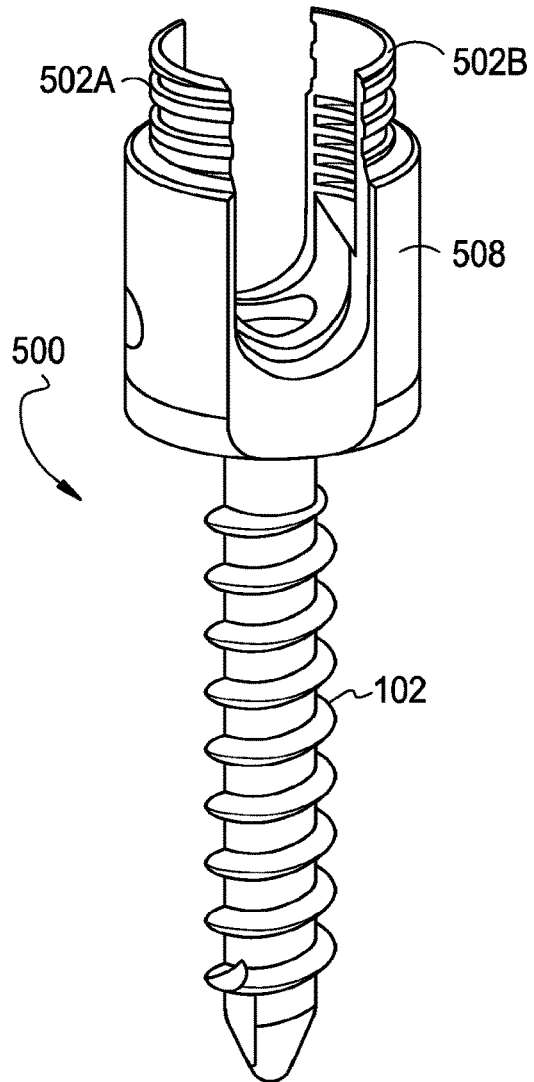

FIG. 19A

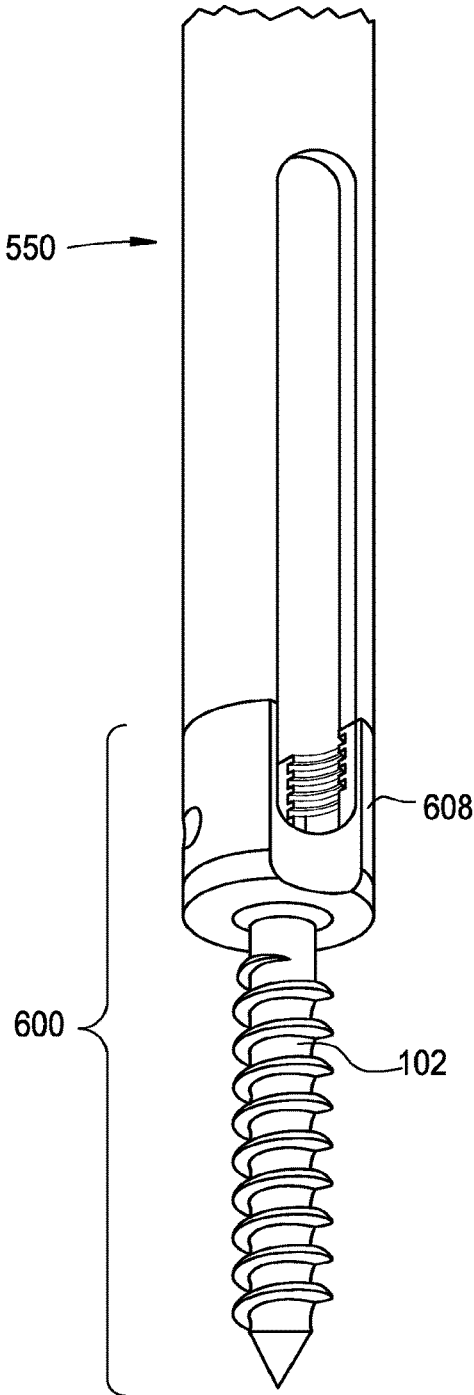

FIG. 19B

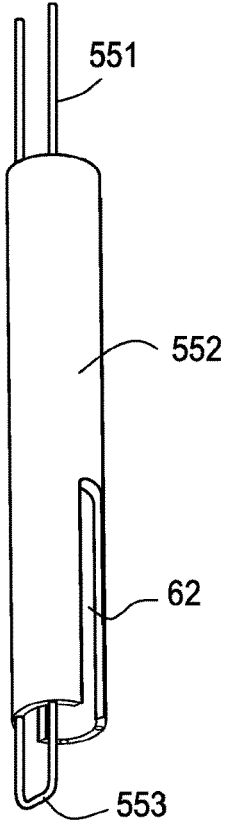

FIG. 19C

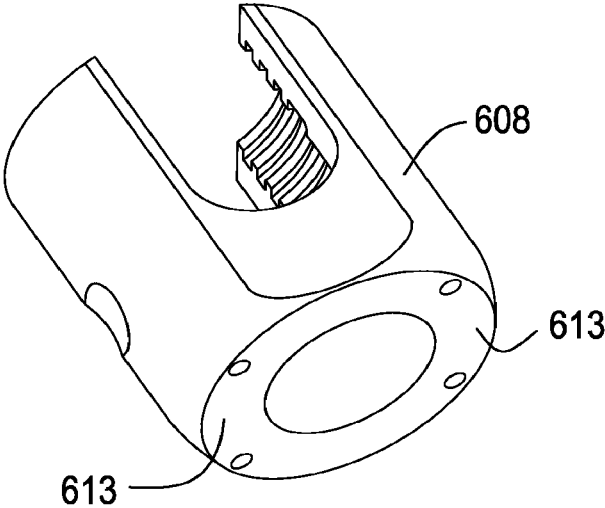

FIG. 19D

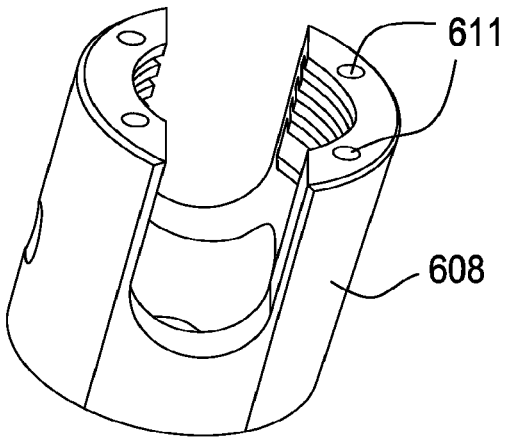

FIG. 20A

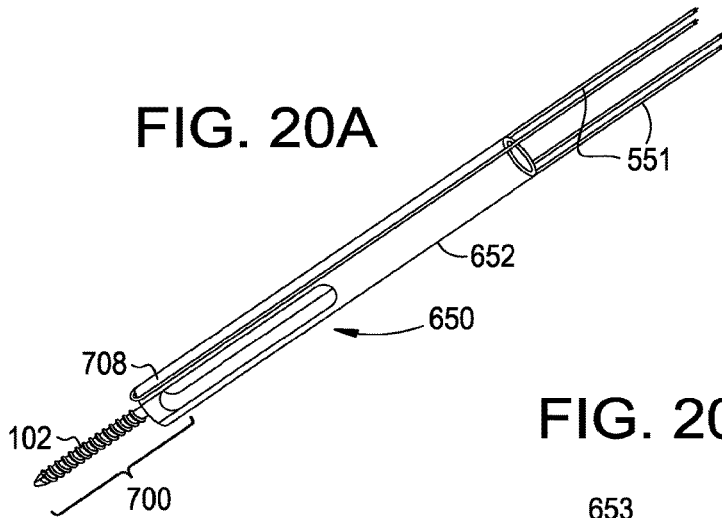

FIG. 20B

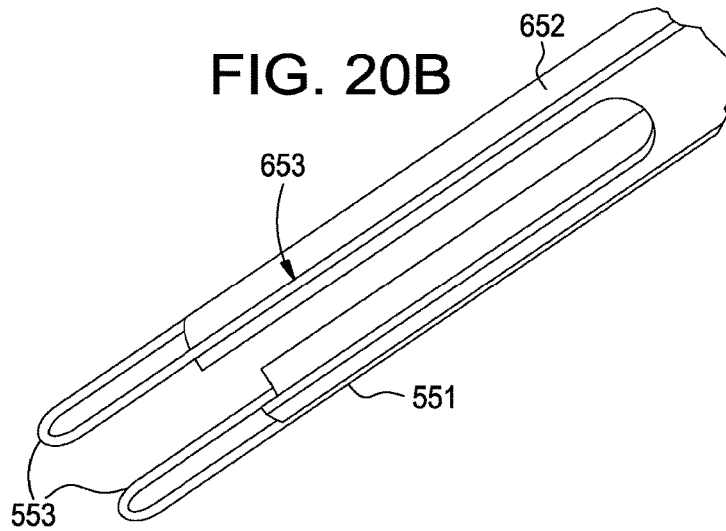

FIG. 20C

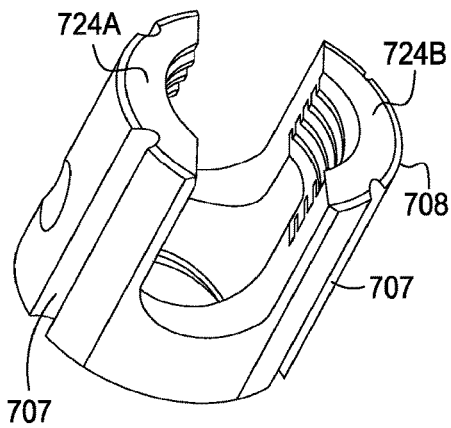

FIG. 20D

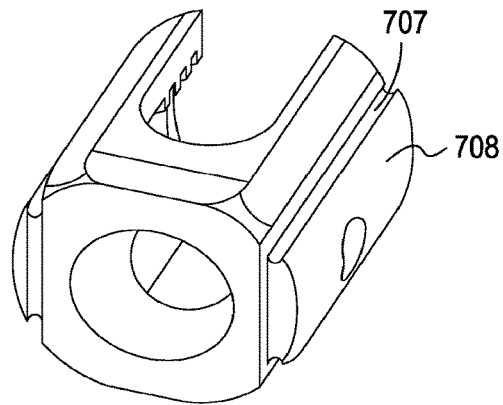



FIG. 21

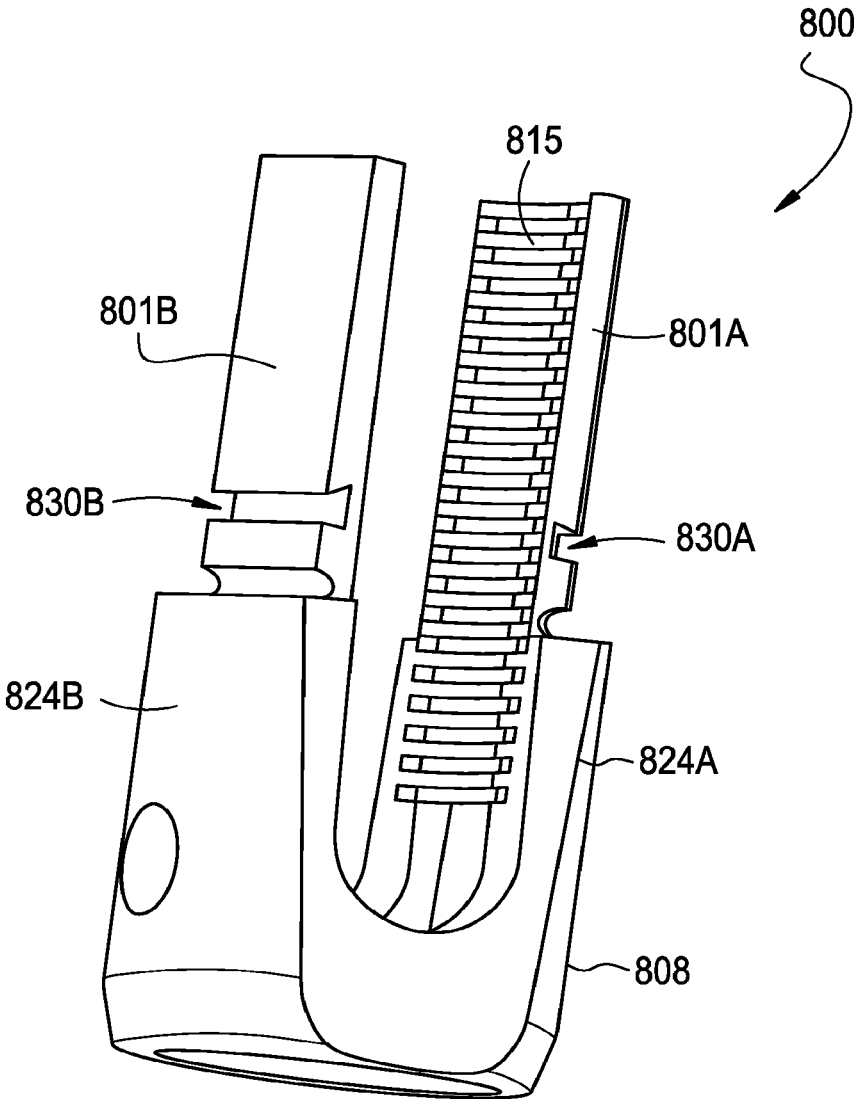

FIG. 22A

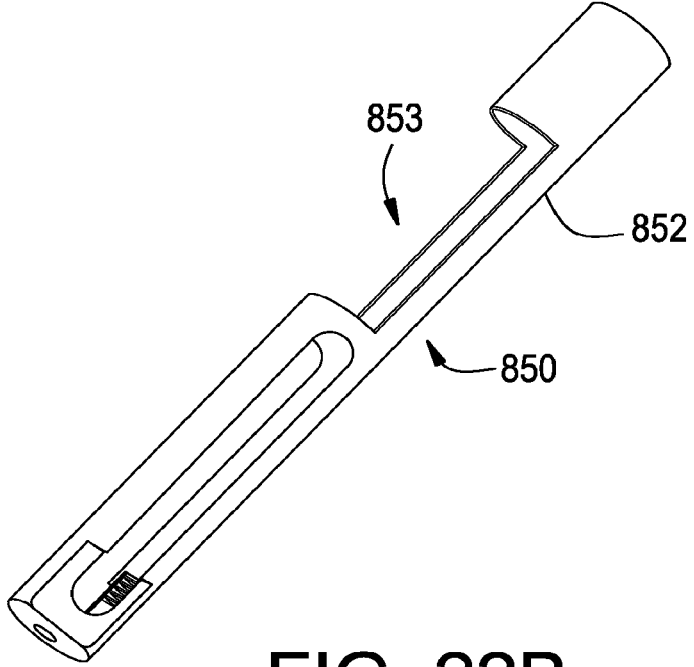

FIG. 22B

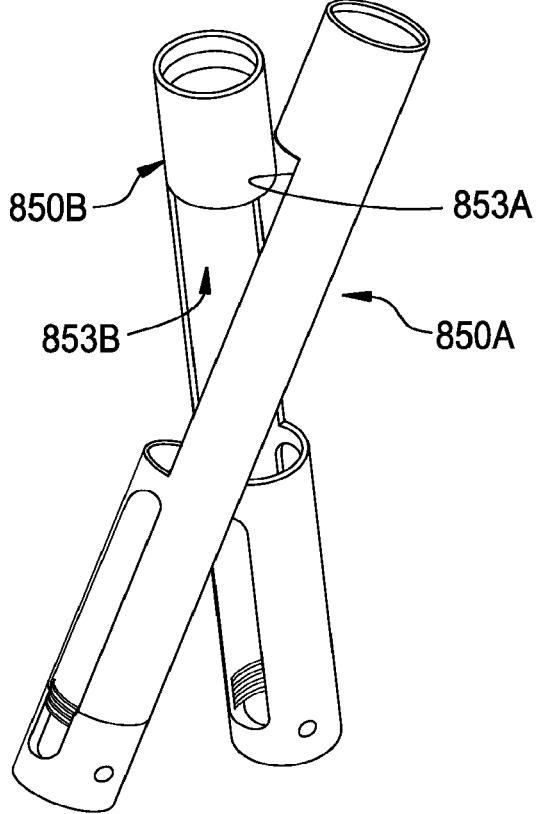

FIG. 23A

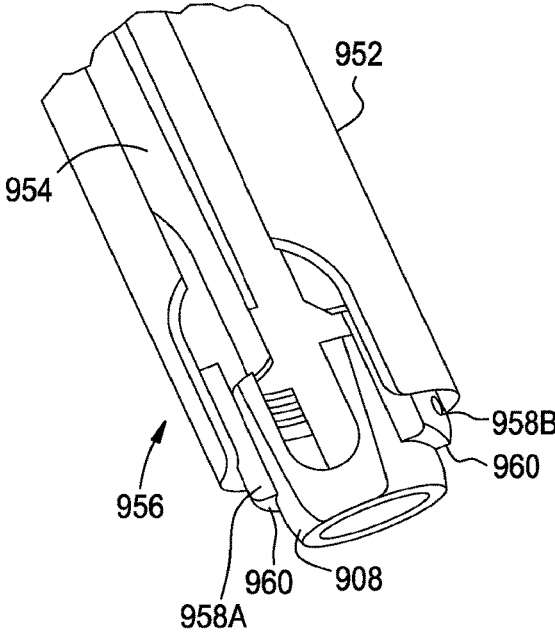
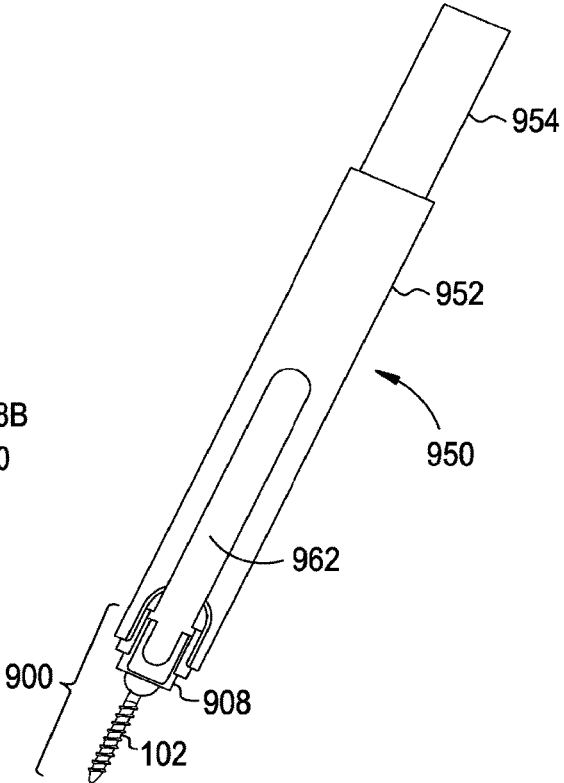

FIG. 23B



## PERCUTANEOUS ACCESS DEVICES AND BONE ANCHOR ASSEMBLIES

### BACKGROUND

**[0001]** For a number of known reasons, spinal fixation devices are used in orthopedic surgery to align and/or fix a desired relationship between adjacent vertebral bodies. Such devices typically include a spinal fixation element, such as a relatively rigid fixation rod or plate, that is coupled to adjacent vertebrae by attaching the element to various anchoring devices, such as hooks, bolts, wires, or screws. The fixation elements can have a predetermined contour that has been designed according to the properties of the target implantation site, and once installed, the fixation element holds the vertebrae in a desired spatial relationship, either until desired healing or spinal fusion has taken place, or for some longer period of time.

**[0002]** Spinal fixation elements can be anchored to specific portions of the vertebrae. Since each vertebra varies in shape and size, a variety of anchoring devices have been developed to facilitate engagement of a particular portion of the bone. Pedicle screw assemblies, for example, have a shape and size that is configured to engage pedicle bone. Such screws typically include a threaded shank that is adapted to be threaded into a vertebra, and a head portion having a rod-receiving element, usually in the form of a U-shaped recess formed in the head. A set-screw, plug, or similar type of closure mechanism is used to lock the fixation element, e.g., a spinal rod, into the rod-receiving head of the pedicle screw. In use, the shank portion of each screw is threaded into a vertebra, and once properly positioned, a rod is seated through the rod-receiving member of each screw and the rod is locked in place by tightening a cap or other closure mechanism to securely interconnect each screw and the fixation rod.

**[0003]** Recently, the trend in spinal surgery has been moving toward providing minimally invasive devices and methods for implanting bone anchors and spinal fixation devices.

### SUMMARY

**[0004]** Disclosed herein are percutaneous access devices that facilitate the delivery and implanting of bone anchors into bone, in particular, one or more vertebral bodies of the spine. In particular, the disclosed percutaneous access devices permit the delivery and implanting of one or more bone anchors in a minimally invasive manner thereby limiting trauma to surrounding tissue. Moreover, the percutaneous access devices disclosed herein can provide a percutaneous pathway between a skin incision and the bone anchor that may be used to deliver components of the bone anchor, such as the fastening mechanism, the fixation element, and/or instruments to the bone anchor. Also, disclosed herein are bone anchors that facilitate the connection of instruments, such as a percutaneous access device, to the bone anchor.

**[0005]** In accordance with one exemplary embodiment, a percutaneous access device includes an inner tube and an outer tube disposed about at least a portion of the inner tube. The outer tube, in the exemplary embodiment, is sized to span from at least a skin incision in a patient to a predetermined site proximate the spine of the patient. The distal end of the outer tube may be adapted to releasably engage a bone

anchor. The inner tube, in the exemplary embodiment, may be adjustable relative to the outer tube along the longitudinal axis of the outer tube between a first position and a second position in which the distal end of the inner tube contacts the bone anchor.

**[0006]** In accordance with another exemplary embodiment, a bone anchor assembly includes a bone anchor having a proximal head and a distal bone engaging portion and a receiving member coupled to the bone anchor. The receiving member, in the exemplary embodiment, may have a proximal end, a distal end and a recess for receiving a spinal fixation element, such as a rod or a plate. The proximal end of the receiving member, in the exemplary embodiment, may have at least one arcuate groove formed on an exterior surface thereof to facilitate connection of an instrument, such as a percutaneous access device, to the receiving member.

### BRIEF DESCRIPTION OF THE DRAWINGS

**[0007]** These and other features and advantages of the percutaneous access devices and bone anchor assemblies disclosed herein will be more fully understood by reference to the following detailed description in conjunction with the attached drawings in which like reference numerals refer to like elements through the different views. The drawings illustrate principles of the percutaneous access devices and bone anchor assemblies disclosed herein and, although not to scale, show relative dimensions.

**[0008]** FIG. 1 is a perspective view of an exemplary embodiment of a percutaneous access device;

**[0009]** FIG. 2 is a perspective view of the components of the percutaneous access device of FIG. 1;

**[0010]** FIG. 3 is a perspective view of the distal end of the percutaneous access device of FIG. 1;

**[0011]** FIG. 4 is a perspective view of the distal end of the percutaneous access device of FIG. 1 coupled to an exemplary embodiment of a bone anchor assembly;

**[0012]** FIG. 5 is a side elevational view of the bone anchor assembly of FIG. 4;

**[0013]** FIG. 6 is a side elevational view of the receiving member of the bone anchor assembly of FIG. 4;

**[0014]** FIG. 7 is a side elevational view in cross-section of the distal end of the percutaneous access device of FIG. 1 coupled to the receiving member of the bone anchor assembly of FIG. 4;

**[0015]** FIG. 8 is a side elevational view in cross-section of the distal end of the outer tube of the percutaneous access device of FIG. 1 and the receiving member of the bone anchor assembly of FIG. 4;

**[0016]** FIGS. 9 and 10 are side elevational views in cross section of the distal end of the inner tube of the percutaneous access device of FIG. 1 and the receiving member of the bone anchor assembly of FIG. 4;

**[0017]** FIGS. 11A-11D are perspective views of the distal end of the percutaneous access device of FIG. 1 and the receiving member of the bone anchor assembly of FIG. 4, illustrating exemplary steps for releasably coupling the distal end of the percutaneous access device to the receiving member of the bone anchor assembly;

**[0018]** FIG. 12 is a side elevational view an another exemplary embodiment of a bone anchor assembly;

**[0019]** FIG. 13 is a side elevational view of the receiving member of the bone anchor assembly of FIG. 12;

[0020] FIG. 14 is a side elevational view in cross section of the receiving member of the bone anchor assembly of FIG. 12;

[0021] FIG. 15 is a side elevational view in cross section of an arcuate groove of the receiving member of the bone anchor assembly of FIG. 12;

[0022] FIG. 16 is a side elevational view in cross-section of the distal end of the another exemplary embodiment of a percutaneous access device coupled to the receiving member of the bone anchor assembly of FIG. 12;

[0023] FIGS. 17A and 17B are perspective views of an alternative embodiment of a percutaneous access device and a bone anchor assembly, illustrating a threaded connecting between the percutaneous access device and the bone anchor assembly;

[0024] FIGS. 18A and 18B are perspective views of an alternative embodiment of a percutaneous access device and a bone anchor assembly, illustrating a plurality of externally threaded removable tabs for releasable engagement with an instrument such as a percutaneous access device;

[0025] FIGS. 19A-19D are perspective views of an alternative embodiment of a percutaneous access device and a bone anchor assembly, illustrating the percutaneous access device and the bone anchor assembly interconnected by one or more internal wires;

[0026] FIGS. 20A-20D are perspective views of an alternative embodiment of a percutaneous access device and a bone anchor assembly, illustrating the percutaneous access device and the bone anchor assembly interconnected by one or more external wires;

[0027] FIG. 21 is a perspective view of an alternative embodiment of a bone anchor assembly having a plurality of removable tabs for releasable engagement with an instrument such as a percutaneous access device;

[0028] FIGS. 22A-22B are perspective views of an exemplary embodiment of a percutaneous access device, illustrating axial cut-outs provided in the outer tube of the percutaneous access device; and

[0029] FIGS. 23A-23B are perspective views of an alternative embodiment of a percutaneous access device and a bone anchor assembly, illustrating flexible tabs provided on the distal end of the percutaneous access device for releasable engagement with the bone anchor assembly.

#### DETAILED DESCRIPTION

[0030] Certain exemplary embodiments will now be described to provide an overall understanding of the principles of the structure, function, manufacture, and use of the percutaneous access devices and bone anchor assemblies disclosed herein. One or more examples of these embodiments are illustrated in the accompanying drawings. Those of ordinary skill in the art will understand that the percutaneous access devices and bone anchor assemblies specifically described herein and illustrated in the accompanying drawings are non-limiting exemplary embodiments and that the scope of the present invention is defined solely by the claims. The features illustrated or described in connection with one exemplary embodiment may be combined with the features of other embodiments. Such modifications and variations are intended to be included within the scope of the present invention.

[0031] The articles “a” and “an” are used herein to refer to one or to more than one (i.e. to at least one) of the

grammatical object of the article. By way of example, “an element” means one element or more than one element.

[0032] The term “distal” as used herein with respect to any component or structure will generally refer to a position or orientation that is proximate, relatively, to the bone surface to which a bone anchor is to be applied. Conversely, the term “proximal” as used herein with respect to any component or structure will generally refer to a position or orientation that is distant, relatively, to the bone surface to which a bone anchor is to be applied.

[0033] The terms “comprise,” “include,” and “have,” and the derivatives thereof, are used herein interchangeably as comprehensive, open-ended terms. For example, use of “comprising,” “including,” or “having” means that whatever element is comprised, had, or included, is not the only element encompassed by the subject of the clause that contains the verb.

[0034] FIGS. 1-5 illustrate an exemplary embodiment of a percutaneous access device 10. The exemplary percutaneous access device 10 can facilitate the delivery and implanting of a bone anchor, such as the exemplary bone anchor assembly 100 illustrated and described below, into bone, in particular, one or more vertebral bodies of the spine. In particular, the exemplary percutaneous access device 10 can facilitate the delivery and implanting of a bone anchor in a minimally invasive manner and can provide a percutaneous pathway between a skin incision in the patient and the bone anchor that may be used to deliver components of the bone anchor, such as the closure mechanism, one or more fixation elements, and/or instruments to the bone anchor. The percutaneous access device 10 is preferably adapted to be introduced through a minimally invasive percutaneous incision, which is a relatively small incision that typically has a length less than the diameter or width of the device being inserted therethrough. Although the exemplary percutaneous access device 10 described below is designed primarily for use in spinal applications, one skilled in the art will appreciate that the exemplary percutaneous access device 10, as well as the other exemplary embodiments described below, may be used to facilitate the implantation of any type of bone anchor to any type of bone.

[0035] The exemplary percutaneous access device 10 includes an inner tube 12 and an outer tube 14 disposed about at least a portion of the inner tube 12. In the illustrated exemplary embodiment, the outer tube 14 is coaxially disposed about the inner tube 12 such that the inner tube 12 and the outer tube 14 share a common longitudinal axis 16. One skilled in the art will appreciate, however, that the outer tube 14 and inner tube 12 need not be coaxially aligned. The inner tube 12 and the outer tube 14, in the exemplary embodiment, are generally cylindrical in shape, having an approximately circular cross-section. One skilled in the art will appreciate, however, the inner tube 12 and the outer tube 14 may have other cross-sectional shapes, including, for example, elliptical or rectilinear. In the exemplary embodiment, the inner tube 12 and outer tube 14 have analogous cross-sections, however, one skilled in the art will appreciate the inner tube 12 and the outer tube 14 can have different cross-sectional shapes. The axial length of the inner tube 12 and outer tube 12 may vary depending on, for example, the patient anatomy, the procedures employed, and/or, that area of the spine in which the device 10 is employed. The inner tube 12 and the outer tube 14 may be linear, as in the exemplary embodiment, or may curved or angled along one or more

sections or the entire length thereof. The inner tube **12** and the outer tube **14** may be constructed from any suitable biocompatible material, including, for example, a metal, such as stainless steel, or a polymer, from any conventional method of manufacturing medical devices.

**[0036]** Although the illustrated exemplary embodiment includes an inner tube and an outer tube, one skilled in the art will appreciate that any number of tubes, e.g., one or more tubes, may be employed depending on, for example, the type of bone anchor employed and the manner by which the device is releasably engaged to the bone anchor. For example, exemplary embodiments of a percutaneous access device having a single outer tube are described below.

**[0037]** Continuing to refer to FIGS. 1-5, the inner tube or sleeve **12** includes a proximal end **20**, a distal end **22**, and a lumen **24** extending between the proximal end **20** and the distal end **22**. The lumen **24** extends the length of the inner tube **12** and defines a longitudinal axis **26** of the inner tube **12**. The outer tube or sleeve **14** includes a proximal end **30**, a distal end **32**, and a lumen **34** extending between the proximal end **30** and the distal end **32**. The lumen **34** may extend the length of the outer tube **14** and defines a longitudinal axis **36** of the outer tube **14**. The inner tube **12** is positionable within the lumen **36** of the outer tube **14**. In the exemplary percutaneous access device **10**, the inner tube **12** is longitudinally adjustable with respect to the outer tube **14**. For example, the inner tube **12** may be adjustable from a first, proximal position, in which the distal end **22** of the inner tube **12** is positioned proximal to the distal end **32** of the outer tube **14** as illustrated in FIG. 3, and a second, distal position, in which the distal end **22** of the inner tube **12** is positioned proximate to the distal end **32** of the outer tube **14**. In the exemplary embodiment, the distal end **22** of the inner tube **12** preferably contacts at least a portion of the bone anchor assembly when the inner tube **12** is in the second position, as illustrated in FIGS. 4 and 7 and as discussed in more detail below.

**[0038]** The exemplary percutaneous access device **10** may include an adjustment mechanism **40** that allows an operator to adjust the relative longitudinal position of the inner tube **12** and the outer tube **14**. In the illustrated embodiment, for example, the adjustment mechanism **40** is a hollow, tubular shaped cap **41** having internal threads **42** that engage external threads **44** provided on the proximal end **30** of the outer tube **14**. The threads **42**, **44** allow the cap **41** to be longitudinally adjusted relative to the outer tube **14**. In the exemplary embodiment, the inner tube **12** is connected to the cap **41** and, thus, can move with cap **41** as the cap **41** is advanced or withdrawn relative to the outer tube **14**. For example, the proximal end **30** of the inner tube **12** of the exemplary embodiment may include one or more resilient tabs **46**, one or more of which may have a projection **48** that seats within an annular groove provided on the interior surface of the cap **41** to thereby connect the proximal end **30** of the inner tube **12** to the cap **41**. In the illustrated embodiment, two resilient tabs **46** are provided on opposite sides of the outer tube **14**. The projection **48**, in the exemplary embodiment, is sized to rotate with in the groove provided in the cap **41**, thus allowing the cap **41** to rotate relative to the inner tube **12**. The resilient tabs **46** are radially flexible to facilitate connection to and removal from the cap **41**. One skilled in the art will appreciate that other configurations for connecting the inner tube **12** to the cap **41** are possible and are within the scope of the present disclosure.

**[0039]** The inner tube **12** may be inhibited from rotating with respect to the outer tube **14**, limiting the relative motion of the inner tube **12** and the outer tube **14** to along the longitudinal axis **16** of the percutaneous access device. For example, one or more resilient tabs **56** may be provided on the inner tube **12** approximately midway between the proximal end **20** and the distal end **22** of the inner tube **12**, although other positions are possible. In the illustrated embodiment, two resilient tabs **56** are provided on opposite sides of the outer tube **14**. One or more of the resilient tabs **56** may include a projection **58** that is sized and shaped to seat within a longitudinal slot **54** provided in the outer sleeve **14**. The resilient tab **56** can be radially flexible to facilitate insertion into and removal from the slot **54**. The projection **58** can slide within the slot **54** and, thereby can limit the relative motion between the inner tube **12** and the outer tube **14** to along the longitudinal axis **16** of the percutaneous access device **10**. One skilled in the art will appreciate that other configurations for connecting the inner tube **12** to the outer tube **14** are possible and are within the scope of the present disclosure.

**[0040]** The inner tube **12** may have one or more sidewall openings or slots **60** formed therein. In the illustrated exemplary embodiment, the inner tube **12** includes two opposed slots **60** that extend longitudinally from the distal end **22** of the inner tube **12**. Like the inner tube **12**, the outer tube **14** may have one or more sidewall openings or slots **62** formed therein. In the illustrated exemplary embodiment, the outer tube **14** includes two opposed slots **62** that extend longitudinally from the distal end **32** of the inner tube **12**. The slots **60** and **62** can be used to facilitate positioning of a spinal fixation device, such as a rod or a plate, relative to one or more bone anchors. Methods and devices for spinal fixation element placement are disclosed in commonly owned co-pending U.S. patent application Ser. No. \_\_\_\_\_, filed concurrently herewith, entitled Method and Devices for Spinal Fixation Element Placement (Attorney Docket No. 101896-210) and commonly owned co-pending U.S. patent application Ser. No. \_\_\_\_\_, filed concurrently herewith, entitled Method and Devices for Minimally Invasive Spinal Fixation Element Placement (Attorney Docket No. 101896-209), both of which are incorporated herein in by reference. To facilitate positioning of a spinal fixation element, the slots **60** and the slots **62** are preferably aligned with one another along at least a portion of the longitudinal axis of the percutaneous access device **10**. The width and length of the slot **60** and slot **62** may be varied depending on the particular methods, instruments, and fixation elements being employed. In one exemplary embodiment, for example, the length of the slots **60** and **62** is selected to span at least from the skin incision to the distal end of the inner tube **12** and the outer tube **14**, respectively. In such embodiments, the slots **60** and **62** may be accessible from outside of the patient. In another exemplary embodiment, the length of the slots **60** and **62** is selected to span from the distal end of the inner tube **12** and the outer tube **14**, respectively, to a point distal to the skin incision. In such embodiments, the slots **60** and **62** may be accessible only from the lumens of the inner and outer tubes.

**[0041]** In embodiments in which multiple slots are employed, the slots **60**, **62** need not be similarly sized (width and/or length). For example, the one or more slots **60** may be sized differently than the one or more slots **62**, the one or more of the slots **60** on the inner tube may be sized

differently than other slots **60**, and/or one or more of the slots **62** on the outer tube may be sized differently than other slots **62**. Although the exemplary embodiment includes two opposing slots on the inner tube **12** and the outer tube **14**, respectively, one skilled in the art will appreciate that any number of slots may be provided, e.g., no slots, one, two, three, etc. slots, may be provided depending on the method, instruments, and/or fixation element employed.

[0042] One skilled in the art will appreciate that the slots **60** and **62** are optional and that in certain embodiments slots may not be provided.

[0043] Referring to FIGS. 1-5 and 7, the percutaneous access device **10** is preferably releasably engageable to a bone anchor. In the exemplary embodiment, the outer tube **14** may be releasably engaged to a bone anchor, such as bone anchor assembly **100**. For example, the outer tube **14** may be engaged to a bone anchor in a manner that allows the percutaneous access device **10** to be connected to the bone anchor **100** during use, e.g., during implantation and/or delivery and/or fastening of a spinal fixation element to the bone anchor, and allows the percutaneous access device to be disconnected from the bone anchor **100** at the conclusion of the procedure. Preferably, the percutaneous access device **10** can be disconnected remotely. For example, the exemplary embodiment, the percutaneous access device **10** can be disconnected from the bone anchor by manipulation of the proximal end of the percutaneous access device **10**, as discussed in more detail below.

[0044] The distal end **32** of the outer tube **14** includes a pair of opposed longitudinally extending tabs **70A** and **70B** that may releaseably engage a bone anchor. In the exemplary embodiment, the tabs **70A** and **70B** are defined by the sidewalls of the outer tube **14** and are separated by slots **62A** and **62B**. In certain exemplary embodiments, the tabs **70A** and **70B** may be flexible and resilient in the radial direction to facilitate connection to a bone anchor. For example, the tabs **70A** and **70B** may be flexed apart in the radial direction from a first, relaxed position to facilitate advancement of the tabs longitudinally over a portion of the bone anchor. Once positioned about a portion of the bone anchor, the tabs **70A** and **70B** may provide a radially compressive force on the bone anchor as the tabs **70A** and **70B** attempt to return to the first, relaxed position. In other exemplary embodiments, including the exemplary percutaneous access device **10**, the tabs **70A** and **70B** need not be flexible and resilient.

[0045] In the illustrated exemplary embodiment, each tab **70A** and **70B** may include one or more radially inward facing projection **72** that is sized and shaped to seat within an opening provided in a portion of the bone anchor. The size, shape and number of projections can be varied depending on, for example, the opening(s) provided on the bone anchor and type of connection desired. In the illustrated exemplary embodiment, for example, each projection **72A**, **72B** is generally arcuate in shape and has a cross section that is complementary to an arcuate groove **130** provided in the spinal fixation element receiving member **108** of the exemplary bone anchor assembly **100** described below. In particular, the projection **72A** has a distal surface **74**, a proximal surface **76**, and a generally radially facing connecting surface **78** that spans between the distal surface **74** and the proximal surface **76**, as shown in FIG. 8. In the illustrated embodiment, the distal surface **74** is generally oriented perpendicular to the longitudinal axis of the outer tube **14** and the connecting surface **78** is generally oriented parallel

to the longitudinal axis of the outer tube **14** and perpendicular to the distal surface **74**. One or both of the proximal surface **76** and the distal surface **74** may be oriented at an angle other than perpendicular to the longitudinal axis of the outer tube **14**. For example, the proximal surface **76** may be oriented at an angle **A** to an orthogonal line **80**, which is oriented perpendicular to the longitudinal axis of the outer tube **14**. In the exemplary embodiment, the angle **A** may be approximately 5° to approximately 30° and is preferably approximately 20°. The distal surface **74** and the proximal surface **76** may be oriented at the same angle or, as in the exemplary embodiment, may be oriented at different angles.

[0046] Referring to FIGS. 2, 3, 4, 7, 9 and 10, the distal end **22** of the inner tube **12** may include a contact surface **81** that contacts at least a portion of a bone anchor when the inner tube **12** is in the second position. In the illustrated exemplary embodiment, for example, the distal end **22** of the inner tube **12** may have two opposing generally arcuate contact surfaces **81**. The contact surfaces **81**, in the exemplary embodiment, are oriented approximately perpendicular to the longitudinal axis of the inner tube **12**. In the illustrated exemplary embodiment, the contact surfaces **81** are configured to contact a generally arcuate contact surface provided on the proximal end of the receiving member of the exemplary bone anchor assembly **100**. Preferably, the contact surface **81** is complementary in size, shape, and orientation to the contact surface on the bone anchor. One skilled in the art will appreciate that the configuration of the contact surface **81**, e.g., number, size, shape, and orientation of the contact surface **81**, may be varied to, for example, suit the bone anchor being employed.

[0047] The distal end **22** of the inner tube **12** and/or the distal end **32** of the outer tube **14** may be configured to inhibit rotation of the bone anchor assembly relative to the percutaneous access device **10**. For example, the distal end **22** of the inner tube may include one or more finger-like extensions **82** that extend approximately axially from the distal end **22** of the inner tube **12** and engage a bone anchor to inhibit rotation of the bone relative to the percutaneous access device. For example, one or more of the extensions **82** may seat within a groove, recess, slot, or similar structure provided in the bone anchor. Alternatively, one or more of the extensions **82** may include a contact surface **84** for contacting an axially extending surface of the bone anchor, as in the case of the exemplary embodiment and as discussed in detail below.

[0048] FIGS. 5-6 illustrate an exemplary embodiment of a bone anchor assembly **100** that is particularly suited for use with the exemplary percutaneous access device **10** described. One skilled in the art will appreciate, however, that the percutaneous access devices disclosed herein are not limited to use with the exemplary bone anchor assembly **100** but instead may be configured for use with any type of bone anchor, e.g., bone screw or hook; mono-axial or polyaxial. Exemplary bone anchor assembly **100** includes a bone screw **102**, such as a pedicle screw, having a proximal head **104** and a distal bone engaging portion **106**, which in the illustrated exemplary embodiment is an externally threaded screw shank. The exemplary bone screw assembly **100** also includes a receiving member **108** that is configured to receive and couple a spinal fixation element, such as a spinal rod or spinal plate, to the bone anchor assembly **100**.

[0049] The receiving member **108** may be coupled to the bone anchor **102** in any well-known conventional manner.

For example, the bone anchor assembly may be poly-axial, as in the present exemplary embodiment in which the bone anchor **102** may be adjustable to multiple angles relative to the receiving member **108**, or the bone anchor assembly may be mono-axial, e.g., the bone anchor **102** is fixed relative to the receiving member **108**. An exemplary poly-axial bone screw is described U.S. Pat. No. 5,672,176, incorporated herein by reference. In mono-axial embodiments, the bone anchor **102** and the receiving member may be coaxial or may be oriented at angle with respect to one another. In poly-axial embodiments, the bone anchor may be biased to a particular angle or range of angles to provide a favored angle the bone anchor. Exemplary favored-angle bone screws are described in U.S. Patent Application Publication No. 2003/0055426 and U.S. Patent Application Publication No. 2002/0058942, both of which are incorporated herein by reference.

**[0050]** The receiving member **108** of the illustrated exemplary embodiment includes a proximal end **110**, a distal end **112**, and a recess or slot **114** for receiving a spinal fixation element such as a spinal rod. The proximal end **110** of the receiving member **108** has a first bore **116** defining a first bore axis **118**. The recess **114** communicates with the first bore **116** such that a spinal fixation element may be positioned through the first bore **116** into the recess **114**. The distal end **112** has a second bore **120** opposite the second bore **116** and defining a second bore axis **122**. The second bore axis **122** is designed to receive the head **104** of the bone anchor **102** to couple the bone anchor **102** to the receiving member **108**. In the illustrated exemplary embodiment, the head **104** is seated within the second bore **116**. As the exemplary illustrated embodiment of the bone anchor assembly is poly-axial, the bone anchor **102** is free to rotate relative to the receiving member **108** such that the longitudinal axis **124** of the bone anchor **102** is positionable at an angle relative to the second bore axis **120**. The second bore **116** may be conically shaped to facilitate adjustment of the bone anchor **102** relative to the receiving member **108**. In favored-angled embodiments, the second bore axis **122** may be positioned at an angle (other than 0°) to the first bore axis **118**. In the illustrated embodiment, the first bore axis **118** and second bore axis **122** are coaxial. In the exemplary embodiment, the receiving member **108** has a generally U-shaped cross-section defined by two legs **124A** and **124B** separated by recess **114**. Each leg **124A**, **124B** is free at the proximal end **110** of the receiving member **108**.

**[0051]** The receiving member **108** may be configured to receive a closure mechanism that locks a spinal fixation element within the recess **114**. The closure mechanism may be a cap that is advanceable through the first bore **116** of the receiving member **108** and seats against the spinal fixation element. For example, the cap may have external threads that engage internal threads **148** provided in the receiving member **108**, e.g., on the legs **124A,B**, as in the exemplary embodiment. Any type of conventional closure mechanism may be employed, including, for example, non-threaded caps, multi-component closure mechanisms, and/or external caps.

**[0052]** The receiving member **108** of the exemplary bone anchor assembly **100** is configured to be releasably connected to an instrument such as the exemplary percutaneous access device **10** described above. For example, the receiving member **108** may include at least one groove **130** that is configured to receive a portion of an instrument to releasably

connect the instrument to the bone anchor assembly. The size, shape, position, and number of grooves can be varied depending on, for example, the instrument employed and the type of connection desired. In certain embodiments, for example, at least one arcuate groove **130** may be provided on an exterior surface of the proximal end **110** of the receiving member **108**. In other exemplary embodiments, at least one arcuate groove may be provided on an interior surface of the proximal end **110** of the receiving member **108**. In the illustrated exemplary embodiment, each leg **124A** and **124B** may be provided with an arcuate groove **130A**, **130B**, respectively, at the free, proximal end of the leg **124A**, **124B**. The grooves **130A**, **130B** may extend about a portion or all of the circumference of the proximal end of each leg **124A**, **124B**. Each groove **130A**, **130B** may have size and shape that is complementary in size and shape to a projection provided on the instrument. For example, in the illustrated exemplary embodiment, the each groove **130A**, **130B** may be arcuate and may have a cross-section complementary to the cross-section of a projection **72A,72B** provided on the tabs **70A,70B** of the outer sleeve **14**. In particular, groove **130** may have a distal surface **132**, a proximal surface **134** and an interconnecting surface **136** that spans between the distal surface **132** and the proximal surface **134**, as illustrated in FIG. 8. The distal surface **132** and/or the proximal surface **134** may be oriented to facilitate insertion of a projection into the groove **130** and/or to inhibit undesirable separation of the projection from the groove **130**. In the illustrated exemplary embodiment, for example, the distal surface **132** may be generally oriented at an angle B to an orthogonal line **140**, which is oriented perpendicular to the longitudinal axis of the receiving member **108**, to facilitate insertion of the projection into the groove. In the exemplary embodiment, the angle B may be approximately 0° to approximately 45° and preferably approximately 30° to 40°. In the illustrated exemplary embodiment, the proximal surface **134** may be oriented at an angle other than perpendicular to longitudinal axis of the receiving member **108** to inhibit separation of the projection from the groove **130**, particularly in radial direction. For example, the proximal surface **134** may be oriented at an angle C to an orthogonal line **142**, which is perpendicular to the longitudinal axis of the receiving member **108**. In the exemplary embodiment, the angle C may be approximately 5° to approximately 30° and is preferably approximately 20°. The distal surface **132** and the proximal surface **134** may be oriented at the same angle or, as in the exemplary embodiment, may be oriented at different angles. The grooves **130A** and **130B**, as well as any additional grooves, may have similar cross-sectional geometries, as in the case of the illustrated exemplary embodiment, or may have distinct geometries.

**[0053]** Referring to FIGS. 7 and 8, the proximal surface **76** of each projection **72** may be oriented at an angle A that is approximately equal to the angle C of the proximal surface **134** of the corresponding groove. In one preferred embodiment, for example, angle A and angle C are each approximately 200. One skilled in the art will appreciate that angle A and angle C need not be approximately equal but instead, may be separate, distinct angles.

**[0054]** The proximal end **110** of the receiving member **108** may include one or more contact surfaces that may be contacted by an instrument such as the percutaneous access device **10**. In the illustrated exemplary embodiment, for



example, the proximal end of each leg **124A**, **124B** may include one or more generally arcuate, proximally facing contact surfaces **145**.

**[0055]** The outer diameter of the percutaneous access device may be selected to be approximately equal to the outer diameter of the bone anchor to facilitate insertion of the bone anchor into the body through a percutaneous pathway of minimal size. For example, in the illustrated exemplary embodiment, the outer diameter of the outer tube **14**, indicated by line  $D_1$  in FIG. 7, at at least the distal end **32** of the outer tube **14**, is approximately equal to, or less than, the outer diameter of the receiving member **108**, indicated by line  $d_1$  in FIGS. 6 and 7. For example, the diameter of the outer tube **14** may taper from a proximal diameter  $D_2$  to a distal diameter  $D_1$  at the distal end **32** of the outer tube **14**. Alternatively, the outer diameter of the outer tube **14** may be approximately equal to, or less than, the outer diameter of the receiving member **108** along the entire length of the outer tube **14**. To accommodate the outer tube **14**, the proximal end **110** of the receiving member **108** may have a diameter  $d_2$  that is less than the diameter  $d_1$  of a distal section of the receiving member **108**, as illustrated in FIG. 6. For example, the diameter  $d_2$  proximal to the grooves **130A,B** may be less than the diameter  $d_1$  of the receiving member **108** to provide a reduced diameter portion **150** at the proximal end **130** of the receiving member. The distance between the exterior surface of reduced diameter portion **150** and the exterior surface of the receiving member **108**, indicated by line E in FIGS. 6 and 8, is preferably greater than or approximately equal to the radial thickness of a tab **70A**, **70B**, as indicated by line F in FIG. 8.

**[0056]** To facilitate delivery of devices to the bone anchor assembly through the percutaneous access device **10**, the inner diameter of the lumen **24** of the inner tube **12**, indicated by line F in FIG. 7, at at least the distal end of the inner tube **12**, may be greater than or approximately equal to the inner diameter of at least a portion of the receiving member, indicated by line f in FIG. 7.

**[0057]** Exemplary operation of the percutaneous access device **10** with the exemplary bone anchor assembly will be described with reference to FIGS. 11A-11D. To releasably connect the percutaneous access device **10**, the distal end **32** of the outer tube **14** is oriented such that tabs **70A** and **70B** are aligned with recess **114**, as illustrated in FIG. 11A. The percutaneous access device **10** is advanced distally until each tab **70A**, **70B** is positioned between the legs **124A** and **124B**, as illustrated in FIG. 11B. The percutaneous access device **10** may be rotated about its longitudinal axis **16** to rotate projections **72A**, **72B** into grooves **103B**, **130A**, respectively, as illustrated in FIG. 11C. The inner tube **12** may be advanced distally along the longitudinal axis **16** of the percutaneous access device **10** from the first, proximal position, illustrated in FIGS. 11A-C, to the second, distal position, illustrated in FIG. 11D, in which the contact surfaces **81** of the inner tube **12** contact the contact surfaces **145A**, **145B** provided on the proximal end of the receiving member of the exemplary bone anchor assembly **100**, to thereby releasably connect the percutaneous access device **10** to the bone anchor assembly **100**. The contact surface **84** of one or more of the extensions **82** may engage the axial extending contact surfaces **152** (FIGS. 5 and 6) to inhibit rotation between the percutaneous access device and the bone anchor assembly.

**[0058]** The percutaneous access device **10** may be connected to the exemplary bone anchor assembly **100**, or another bone anchor assembly, before implantation of the bone anchor assembly or after the bone anchor assembly is implanted into the patient's body.

**[0059]** Once the percutaneous access device **10** is releasably connected to the bone anchor assembly **100** as illustrated in FIGS. 1 and 11D, the percutaneous access device **10** may provide a percutaneous pathway between the skin incision and the bone anchor **100** that facilitates delivery of instruments, spinal fixation elements, and/or components of the bone anchor assembly, such as the closure mechanism, to the bone anchor assembly **100**. In the illustrated exemplary embodiment, for example, the lumen **24** provides a pathway to the first bore **116** of the receiving member **108** of the bone anchor assembly **100**, that may allow a closure mechanism, such as a threaded cap, to be delivered to the receiving member **108** of the bone anchor assembly and/or may allow a screw driver or the like to be advanced into engagement with the head **104** of the bone anchor **102**. Moreover, in the illustrated exemplary embodiment, the slots **60** of the inner tube and the slots **62** of the outer tube **14** may be aligned with the recess **114** provided in the receiving member **108**. Alignment of the slots **60** and **62** with the recess **114** facilitates the delivery of a spinal fixation element to the bone anchor assembly. Exemplary methods and devices for delivering a spinal fixation element to a bone anchor assembly are described in commonly owned, co-pending U.S. patent application Ser. No. \_\_\_\_\_, filed concurrently herewith, entitled Methods and Devices for Minimally Invasive Spinal Fixation Element Placement (Attorney Docket No. 101896-209) and commonly owned, co-pending U.S. patent application Ser. No. \_\_\_\_\_, filed concurrently herewith, entitled Methods and Devices for Spinal Fixation Element Placement (Attorney Docket No. 101896-210), each of which is incorporated herein in by reference.

**[0060]** The percutaneous access device **10** may be released from the bone anchor by rotating the percutaneous access device **10** about its longitudinal axis **16** and retracting the device **10** distally.

**[0061]** FIGS. 12-16 illustrate an alternative exemplary embodiment of a bone anchor assembly **200** and an exemplary percutaneous access device **300** that may be configured to releasably engage the bone anchor assembly **200**. The exemplary bone anchor assembly **200** is analogous in construction to the exemplary bone anchor assembly **100** described above, except that the receiving member **208** of the bone anchor assembly **200** has a generally constant outer diameter  $d_1$ , as illustrated in FIGS. 14 and 16, at the proximal end **110** thereof, and, thus, lacks the reduced diameter portion **150** of bone anchor assembly **100**. As a result, the outer diameter of the distal end **32** of the outer tube **14** of the exemplary percutaneous access device **300**, indicated by line  $D_2$  in FIG. 16, may be approximately equal to or, as in the illustrated embodiment, may be greater than the diameter  $d_1$  of the proximal end **110** of the receiving member **208**. The outer diameter of the outer tube **14** may be constant, as in the illustrated exemplary embodiment, or may vary along the length of the outer tube **14**.

**[0062]** FIGS. 17A and 17B illustrate an alternative embodiment of a percutaneous access device **350** and a bone anchor assembly **400**, in which the percutaneous access device and the bone anchor assembly are interconnected by

threads. For example, the percutaneous access device 350 may have an outer tube 352 having a distal end 354 provided within internal threads that releasably engage external threads 406 provided on the proximal end 412 of the receiving member 408 of the bone anchor assembly 400. Preferably, the external threads 406 are clocked to facilitate alignment of the grooves 62, if any, provided on the outer tube 14 with the recess 414 provided in the receiving member 408. In the illustrated exemplary embodiment, the percutaneous access device 350 includes a single tube, outer tube 352; an inner tube may be provided but is not necessary.

[0063] FIGS. 18A and 18B illustrate an alternative embodiment a bone anchor assembly 500, in which the receiving member 508 includes one or more removable, externally threaded tabs 502 that provide a threaded connecting between the percutaneous access device 350 and the bone anchor assembly 500. In the illustrated exemplary embodiment, a pair of proximally extending tabs 502A and 502B extend from the legs 524A and 524B, respectively. Each tab 502, in the illustrated exemplary embodiment, is generally arcuate in shape and includes external threads for engagement with internal threads provided on the percutaneous access device. The tabs 502 may include internal threads 415 to facilitate advancement of a closure mechanism to the bone anchor assembly. Tabs 502 may be sheared off the bone anchor assembly 500 by over tightening of the percutaneous access device 350 or, alternatively, may be removed from the bone anchor assembly 500 after withdrawal of the percutaneous access device 350 by a suitable instrument.

[0064] FIGS. 19A-19D illustrate an alternative embodiment of a percutaneous access device 550 and a bone anchor assembly 600, in which the percutaneous access device 500 and the bone anchor assembly 600 are releasably interconnected by one or more internal wires 551. In the illustrated exemplary embodiment, for example, a pair of wires 551, extend axially through opposing side walls of the outer tube 552. Each wire extends through parallel axial holes provided in the side walls of the outer tube 552. Each wire 551 may form a loop 553 that can engage the receiving member 608 of the bone anchor assembly. The wires may be formed of any suitable biocompatible material including, for example a metal, such as a stainless, or a polymer. The receiving member 608, in the exemplary embodiment, includes two pairs of axially extending holes 611 for receiving wires 551. Each pair of holes 611 may terminate in a groove 613 oriented perpendicular to the holes 611. The number of wires and holes provided in the outer tube and the receiving member may be varied depending on the application. Each wire 551 may be tensioned to couple the percutaneous access device 550 to the bone anchor assembly. The wires 551 may be tensioned by, for example, retracting the wires 551 distally. Releasing the tension on the wires 551 by, for example, cutting the wires 551 or advancing the wires 551 proximally, can release the percutaneous access device 550 from the bone anchor assembly 600. In the illustrated exemplary embodiment, the percutaneous access device 550 includes a single tube, outer tube 552; an inner tube may be provided but is not necessary.

[0065] FIGS. 20A-20D illustrates an alternative embodiment of a percutaneous access device 650 and a bone anchor assembly 700 in which the percutaneous access device 650 and the bone anchor assembly 700 are releasably interconnected by one or more externally positioned wires 551. The

illustrated exemplary embodiment, wires 551 extend axially along the exterior surface of the outer tube 652 of the percutaneous access device 650 and extend axially along the exterior surface of the receiving member 708 of the bone anchor assembly 700. The outer tube 652 may include one or more axially oriented grooves 653 in which the wires 551 may be seated. Likewise, the receiving member 708 may include one or more grooves 707 in which the wires 651 may be seated. The number of wires and/or grooves may be varied depending upon the particular application. In the illustrated embodiment, for example, a pair of parallel grooves 653 are provided in opposing sidewalls of the outer tube 652 and a pair of parallel of grooves 707 are provided in the opposing legs 724A, 724B of the receiving member 708. Each wire 551 may be tensioned to couple the percutaneous access device 650 to the bone anchor assembly 700. The wires 551 may be tensioned by, for example, retracting the wires 551 distally. Releasing the tension on the wires 551 by, for example, cutting the wires 551 or advancing the wires 551 proximally, can release the percutaneous access device 650 from the bone anchor assembly 700. In the illustrated exemplary embodiment, the percutaneous access device 650 includes a single tube, outer tube 652; an inner tube may be provided but is not necessary.

[0066] FIG. 21 illustrates an alternative embodiment of a bone anchor assembly 800 having one or more removable tabs 801 for releasable engagement with an instrument such as an embodiment of a percutaneous access device described above. In the illustrated exemplary embodiment, a pair of opposing tabs 801A, 801B extend proximally from the proximal end of the receiving member 808 of the bone anchor assembly 800. Each tab 801A, 801B, in the illustrated exemplary embodiment, is generally arcuate in shape and are positioned proximal to and extend from a respective leg 824A, 824B of the receiving member 808. The size, shape, and number of tabs 801 may be varied without departing from the scope of the present invention. The tabs 801 may include a mechanism for facilitating releasable engagement by an instrument. For example, the tabs may be provided with external threads, as in the case of the embodiment illustrated in FIGS. 17A, 17B described above, or may include one or more grooves. In the illustrated exemplary embodiment, each tab 801A, 801B includes one or more arcuate grooves 830A, 830B that may be analogous in construction to the grooves 130A, 130B described above. The tabs 801 may include internal threads 815 to facilitate advancement of a closure mechanism to the bone anchor assembly. Tabs 801 may be sheared off the bone anchor assembly 800 by the percutaneous access device or instrument or, alternatively, may be removed from the bone anchor assembly 800 after withdrawal of the percutaneous access device or instrument using a suitable instrument.

[0067] FIGS. 22A-22B illustrates an exemplary embodiment of a percutaneous access device 850 having one or more axially extending cut-outs 853 provided in the outer tube 852 of the percutaneous access device. As illustrated in FIG. 22B, an axially extending cut-out 853 may facilitate the use of multiple percutaneous access devices by minimizing interference between the devices. For example, in certain spinal applications, bone anchors placed on adjacent vertebrae may be closely spaced and/or angled in a manner that may cause interference between instruments, such as a percutaneous access device disclosed herein, used simultaneously with the adjacent bone anchors. By providing axial

cut-outs **853**, two or more percutaneous access devices **850A**, **850B** may be employed on adjacent bone anchors, or closely positioned anchors, by aligning the cut-outs **853A**, **853B**. The length and depth of a cut-out **852** may be varied depending on the application. One or more cut-outs may be provided on any of the exemplary embodiments of the percutaneous access device described herein or with other instruments used with bone anchors, e.g., drills, drivers, cannulas, approximators, and the like. In embodiments including an inner tube or additional tubes, the additional tubes may also be provided with cut-outs **853**.

[0068] FIGS. 23A-23B illustrates an alternative embodiment of a percutaneous access device **950** and a bone anchor assembly **900** in which the distal end **956** of the inner tube **954** of the percutaneous access device **950** includes one or more flexible bone anchor engaging tabs **958** for releasable engagement with the receiving member **908** of bone anchor assembly **900**. In the exemplary embodiment, a pair of opposing tabs **958A**, **958B** extend distally from the distal end **956** of the inner tube **954**. Each tab **958**, in the illustrated exemplary embodiment, is connected at a proximal end to the inner tube **954** and has a free distal end **960**. One or both of the tabs **958** can flex from a first position, in which the tab **958** is oriented approximately axially, e.g., parallel to the longitudinal axis of the inner tube **954**, to a second position, in which the tab **958** is generally oriented at angle to the longitudinal axis of the inner tube **954**. In the exemplary embodiment, for example, each tab **958A**, **958B** may flexed radially outward, e.g., away from each other, from a first position, in which the tabs **958A**, **958B** are approximately parallel, to a second, flexed position, in which the tabs **958A**, **958B** are oriented at an angle to one another. The tabs **958** may be biased to the first position. For example, the tabs **958A**, **958B** may be biased to the first, parallel position, such that the tabs **958A**, **958B** may provide a radially compressive force on the receiving member **908** to releasably engage the receiving member **908**. One or more of the tabs **958** may be provided with a projection or the like for engaging a hole, groove, etc. that may be provided in the exterior surface of the receiving member **908**. Although the exemplary embodiment includes two tabs **958A**, **958B**, any number (one or more) tabs **958** may be provided.

[0069] The percutaneous access device **950** may include an outer tube **952** that may be advanced about the tabs **958** when the tabs **958** releasably engage the receiving member **908**. For example, in the illustrated exemplary embodiment, the outer tube **952** may be advanced distally about the tabs **958A**, **958B** when the tabs are in the second, flexed position, to inhibit separation of the tabs **958A**, **958B** and/or provide a radially compressive force on the tabs.

[0070] While the percutaneous access systems and bone anchor assemblies of the present invention have been particularly shown and described with reference to the exemplary embodiments thereof, those of ordinary skill in the art will understand that various changes may be made in the form and details herein without departing from the spirit and scope of the present invention. Those of ordinary skill in the art will recognize or be able to ascertain many equivalents to the exemplary embodiments described specifically herein by using no more than routine experimentation. Such equivalents are intended to be encompassed by the scope of the present invention and the appended claims.

**1-46.** (canceled)

**47.** A bone anchor to anchor an elongated implant to a patient bone and threadably engage with a closure plug, the bone anchor further to couple with a tool comprising an attachment structure, the bone anchor comprising:

an anchoring member comprising a distal portion and a proximal portion opposite the distal portion, the distal portion to attach to the patient bone in an anchoring manner; and

a head coupled to the proximal portion of the anchoring member, the head to couple to the elongated implant, the head comprising:

a proximal end and a distal end opposite the proximal end, the proximal portion of the anchoring member extending into the distal end such that the head is coupled to the proximal portion of the anchoring member;

a first arm and a second arm spaced apart from the first arm to define a channel to receive the elongated implant to couple the head to the elongated implant, the channel extending distally from the proximal end;

a helically wound thread defined in an inner surface of the channel, the inner surface facing radially inward towards a longitudinal center axis of the head, the helically wound thread to threadably engage with the closure plug when the closure plug is received in the channel;

an outer surface facing radially outward relative to the longitudinal center axis of the head, the outer surface being on the first arm; and

a horizontal radiused slot near the proximal end of the head and extending along at least a portion of the outer surface in a direction perpendicular to the longitudinal center axis of the head, the slot to receive the attachment structure when the bone anchor is coupled to the tool; and

wherein the horizontal radiused slot comprises a proximal boundary comprising a radially inner extent and a radially outer extent radially outward of the radially inner extent, wherein the radially outer extent is distal the radially inner extent.

**48.** The bone anchor of claim **47**, wherein, when the bone anchor is coupled to the tool, a free end of the attachment structure is received in a proximal recess defined by the radially inner extent and the radially outer extent.

**49.** The bone anchor of claim **48**, wherein the free end and the radially outer extent interact to inhibit the attachment structure from radially outward displacement.

**50.** A bone anchor to anchor an elongated implant to a patient bone and threadably engage with a closure plug, the bone anchor further to couple with a tool comprising an attachment structure, the bone anchor comprising:

an anchoring member comprising a distal portion and a proximal portion opposite the distal portion, the distal portion to attach to the patient bone in an anchoring manner; and

a head coupled to the proximal portion of the anchoring member, the head to couple to the elongated implant, the head comprising:

a proximal end and a distal end opposite the proximal end, the proximal portion of the anchoring member

- extending into the distal end such that the head is coupled to the proximal portion of the anchoring member;
- a first arm and a second arm spaced apart from the first arm to define a channel to receive the elongated implant to couple the head to the elongated implant, the channel extending distally from the proximal end;
- a helically wound thread defined in an inner surface of the channel, the inner surface facing radially inward towards a longitudinal center axis of the head, the helically wound thread to threadably engage with the closure plug when the closure plug is received in the channel;
- an outer surface facing radially outward relative to the longitudinal center axis of the head, the outer surface being on the first arm; and
- a horizontal radiused slot near the proximal end of the head and extending along at least a portion of the outer surface in a direction perpendicular to the longitudinal center axis of the head, the slot to receive the attachment structure when the bone anchor is coupled to the tool;
- wherein the horizontal radiused slot comprises a proximal boundary comprising a distal projecting lip structure and, when the bone anchor is coupled to the tool, the attachment structure engages the distal projecting lip.
- 51.** The bone anchor of claim **50**, wherein the attachment structure engaging the distal projecting lip acts to inhibit the attachment structure from radially outward displacement.
- 52.** A bone anchor to anchor an elongated implant to a patient bone and threadably engage with a closure plug, the bone anchor further to couple with a tool comprising an attachment structure, the bone anchor comprising:
- an anchoring member comprising a distal portion and a proximal portion opposite the distal portion, the distal portion to attach to the patient bone in an anchoring manner; and
- a head coupled to the proximal portion of the anchoring member, the head to couple to the elongated implant, the head comprising:
- a proximal end and a distal end opposite the proximal end, the proximal portion of the anchoring member extending into the distal end such that the head is coupled to the proximal portion of the anchoring member;
- a first arm and a second arm spaced apart from the first arm to define a channel to receive the elongated implant to couple the head to the elongated implant, the channel extending distally from the proximal end;
- a helically wound thread defined in an inner surface of the channel, the inner surface facing radially inward towards a longitudinal center axis of the head, the helically wound thread to threadably engage with the closure plug when the closure plug is received in the channel;
- an outer surface facing radially outward relative to the longitudinal center axis of the head, the outer surface being on the first arm; and
- a horizontal radiused slot near the proximal end of the head and extending along at least a portion of the outer surface in a direction perpendicular to the longitudinal center axis of the head, the slot to receive the attachment structure when the bone anchor is coupled to the tool;
- wherein the proximal end comprises a surface perpendicular to the outer surface:
- wherein the horizontal radiused slot is closer in proximity to the proximal end than to the distal end; and
- wherein a proximal boundary of the horizontal radiused slot comprises an undercut defining a proximal projecting recess of the horizontal radiused slot.
- 53.** The bone anchor of claim **52**, wherein the boundary is a proximal boundary.
- 54.** A bone anchor to anchor an elongated implant to a patient bone and threadably engage with a closure plug, the bone anchor further to couple with a tool comprising an attachment structure, the bone anchor comprising:
- an anchoring member comprising a distal portion and a proximal portion opposite the distal portion, the distal portion to attach to the patient bone in an anchoring manner; and
- a head coupled to the proximal portion of the anchoring member, the head to couple to the elongated implant, the head comprising:
- a proximal end and a distal end opposite the proximal end, the proximal portion of the anchoring member extending into the distal end such that the head is coupled to the proximal portion of the anchoring member;
- a first arm and a second arm spaced apart from the first arm to define a channel to receive the elongated implant to couple the head to the elongated implant, the channel extending distally from the proximal end;
- a helically wound thread defined in an inner surface of the channel, the inner surface facing radially inward towards a longitudinal center axis of the head, the helically wound thread to threadably engage with the closure plug when the closure plug is received in the channel;
- an outer surface facing radially outward relative to the longitudinal center axis of the head, the outer surface being on the first arm; and
- a horizontal radiused slot near the proximal end of the head and extending along at least a portion of the outer surface in a direction perpendicular to the longitudinal center axis of the head, the slot to receive the attachment structure when the bone anchor is coupled to the tool;
- wherein the proximal end comprises a surface perpendicular to the outer surface:
- wherein the horizontal radiused slot is closer in proximity to the proximal end than to the distal end; and
- wherein a proximal boundary of the horizontal radiused slot comprises an undercut defining a proximal projecting recess of the horizontal radiused slot.
- 55.** The bone anchor of claim **54**, wherein the recess of the slot is to interact with the attachment structure to prevent radially outward displacement of the attachment structure from the slot in which the attachment structure is received.
- 56.** A bone anchor to anchor an elongated implant to a patient bone and threadably engage with a closure plug, the bone anchor further to couple with a tool comprising an attachment structure, the bone anchor comprising:

- an anchoring member comprising a distal portion and a proximal portion opposite the distal portion, the distal portion to attach to the patient bone in an anchoring manner; and
- a head coupled to the proximal portion of the anchoring member, the head to couple to the elongated implant, the head comprising:
- a proximal end and a distal end opposite the proximal end, the proximal portion of the anchoring member extending into the distal end such that the head is coupled to the proximal portion of the anchoring member;
  - a first arm and a second arm spaced apart from the first arm to define a channel to receive the elongated implant to couple the head to the elongated implant, the channel extending distally from the proximal end;
  - a helically wound thread defined in an inner surface of the channel, the inner surface facing radially inward towards a longitudinal center axis of the head, the helically wound thread to threadably engage with the closure plug when the closure plug is received in the channel;
  - an outer surface facing radially outward relative to the longitudinal center axis of the head, the outer surface being on the first arm; and
  - a horizontal radiused slot near the proximal end of the head and extending along at least a portion of the outer surface in a direction perpendicular to the longitudinal center axis of the head, the slot to receive the attachment structure when the bone anchor is coupled to the tool; and
- wherein the horizontal radiused slot comprises a planar boundary perpendicular to the longitudinal center axis of the head and perpendicularly intersecting the outer surface.
- 57.** A bone anchor to anchor an elongated implant to a patient bone and threadably engage with a closure plug, the bone anchor further to couple with a tool comprising an attachment structure near a lower end of the tool, the bone anchor comprising:
- an anchoring member comprising a distal portion and a proximal portion opposite the distal portion, the distal portion to be attached to the patient bone in an anchoring manner; and
  - a head to be coupled to and located near the proximal portion of the anchoring member and to couple to the elongated implant, the head comprising:
    - a proximal region with a proximal end, and a distal region opposite the proximal end, the proximal portion of the anchoring member extending distally from the distal region of the head;
    - a first arm and a second arm spaced apart from the first arm to define a channel therebetween to receive the elongated implant to couple the head to the elongated implant, the channel extending distally from the proximal end of the head;
    - a helically wound thread defined in an inner surface on opposite sides of the channel, the inner surface facing radially inward towards a longitudinal center axis of the head, the helically wound thread to threadably engage with the closure plug when the closure plug is received in the channel;
    - an outer surface facing radially outward relative to the longitudinal center axis of the head, the outer surface being on at least the first arm; and
    - a horizontal radiused slot extending along at least a portion of the outer surface in a direction perpendicular to the longitudinal center axis of the head and radially spaced therefrom, the slot to receive the attachment structure when the bone anchor is coupled to the tool, the slot located near the proximal end of the head, and the proximal end of the head having a top surface thereon
  - wherein the horizontal radiused slot comprises a proximal boundary comprising a radially inner extent and a radially outer extent radially outward of the radially inner extent, wherein the radially outer extent is distal the radially inner extent.
- 58.** A bone anchor to anchor an elongated implant to a patient bone and threadably engage with a closure plug, the bone anchor further to couple with a tool comprising an attachment structure near a lower end of the tool, the bone anchor comprising:
- an anchoring member comprising a distal portion and a proximal portion opposite the distal portion, the distal portion to be attached to the patient bone in an anchoring manner; and
  - a head to be coupled to and located near the proximal portion of the anchoring member and to couple to the elongated implant, the head comprising:
    - a proximal region with a proximal end, and a distal region opposite the proximal end, the proximal portion of the anchoring member extending distally from the distal region of the head;
    - a first arm and a second arm spaced apart from the first arm to define a channel therebetween to receive the elongated implant to couple the head to the elongated implant, the channel extending distally from the proximal end of the head;
    - a helically wound thread defined in an inner surface on opposite sides of the channel, the inner surface facing radially inward towards a longitudinal center axis of the head, the helically wound thread to threadably engage with the closure plug when the closure plug is received in the channel;
    - an outer surface facing radially outward relative to the longitudinal center axis of the head, the outer surface being on at least the first arm; and
    - a horizontal radiused slot extending along at least a portion of the outer surface in a direction perpendicular to the longitudinal center axis of the head and radially spaced therefrom, the slot to receive the attachment structure when the bone anchor is coupled to the tool, the slot located near the proximal end of the head, and the proximal end of the head having a top surface thereon
  - wherein the horizontal radiused slot comprises a proximal boundary comprising a radially inner extent and a radially outer extent radially outward of the radially inner extent, wherein the radially outer extent is distal the radially inner extent.
- 59.** The bone anchor of claim **58**, wherein, when the bone anchor is coupled to the tool, a free end of the attachment structure is received in a proximal recess defined by the radially inner extent and the radially outer extent.

60. The bone anchor of claim 59, wherein the free end and the radially outer extent interact to inhibit the attachment structure from radially outward displacement.

61. The bone anchor of claim 57, wherein the bone screw is a polyaxial bone screw.

\* \* \* \* \*