

(No Model.)

L. HAEGE.
GATE HINGE.

No. 527,685.

Patented Oct. 16, 1894.

Fig. I.

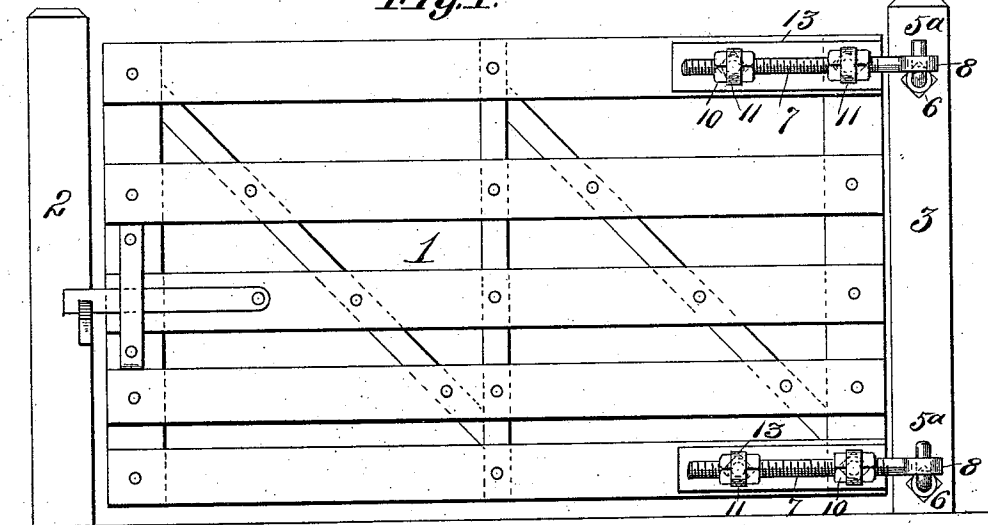

Fig. II.

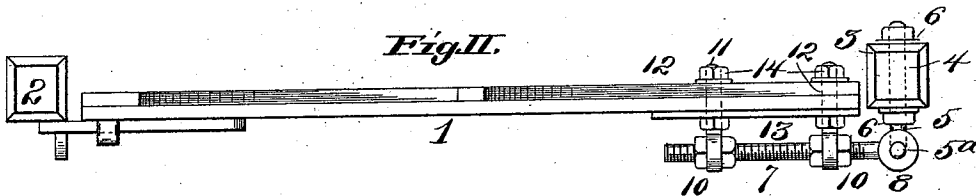
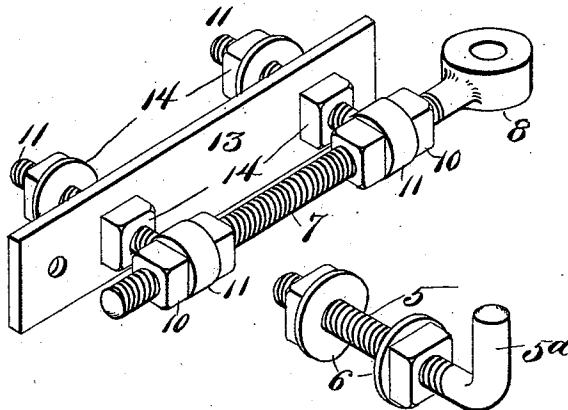

Fig. III.



Attest:
A. W. Eberole
L. G. Edwards

Inventor:
Louis Haege:
By Knight & Pugh
Attys

UNITED STATES PATENT OFFICE.

LOUIS HAEGE, OF BELLEVILLE, ILLINOIS.

GATE-HINGE.

SPECIFICATION forming part of Letters Patent No. 527,685, dated October 16, 1894.

Application filed January 26, 1894. Serial No. 498,152. (No model.)

To all whom it may concern:

Be it known that I, LOUIS HAEGE, of Belleville, in the county of St. Clair and State of Illinois, have invented a certain new and useful Improvement in Gate-Hinges, of which the following is a full, clear, and exact description, reference being had to the accompanying drawings, forming part of this specification.

My invention relates to a gate hinge having three independent adjustments so that the gate may be adjusted in or out from the post to which it is secured, and means by which it may be adjusted so as to compensate for any sagging of the post, such sagging being readily taken up by the various adjusting nuts employed, and the gate held at all times in a horizontal position, thereby preventing its outer free end coming in contact with the ground, and also means of adjustment so that the gate may be held squarely between its supporting and accompanying posts. My invention consists in features of novelty hereinafter fully described and pointed out in the claim.

Figure I is a side elevation of an ordinary gate having my improved hinge secured thereto. Fig. II is a top or plan view of the same. Fig. III is an enlarged perspective view of the hinge from which the pivot bolt on which the hinge is supported also shown in perspective, is removed from its keeper.

Referring to the drawings:—1 represents an ordinary gate, and 2 the front, and 3 the rear posts. Within the rear post are perforations 4 through which are passed bolts 5 having formed on their outer ends pivot hooks 5^a and on their threaded portion nuts 6 for adjustably securing them within the post.

7 represents a screw threaded rod on the outer end of which is an eye 8 adapted to receive the pivot end of the bolt on which the hinge is supported.

10 represents nuts on the adjusting rod between which are secured eye bolts 11, that form the gate's support by being passed at right angles relative to the threaded rod,

through openings 12 in a plate 13 and a rail of the gate, where they are adjustably secured by nuts 14.

It is obvious that the pivot bolt after being inserted in the post may be adjusted in or out by means of the adjusting nuts thereon, and the screw threaded rod connected thereto may be moved outward, carried by the pivotal pin, which carries out the gate, or the gate may be moved out or in by the movement of the adjusting screws on the eye bolts 11, and to adjust the gate relative and perpendicular to the post to which the hinge is secured, the nuts on the threaded rod are moved in or out as desired. A hinge constructed in accordance with my invention, is adapted to a number of uses owing to the fact that by lengthening the pivot bolt, a wide space is produced between the post and the point where secured. When the gate or door, as the case may be, is thrown open, it passes the center sufficiently far to prevent self-closing when opened, which is a decided advantage when used for hay-lofts, coal-sheds, &c., wherein as the door is swung up, it passes the pivot center sufficiently far that without other support, there need be no danger of self-closing. When used for doors at the gable end of a building, by moving outward the pivot bolt 5 and the eye bolts 11, the door will thus be thrown outward when opened sufficiently to pass center, and clear the projection of the roof.

I claim as my invention—

In a gate hinge, the combination of a pivot bolt, an adjustable screw threaded rod provided with an eye adapted to receive the pivot end of the bolt, nuts on the rod for securing eye bolts thereon, the inner ends of which are passed through perforations in a plate and in a rail of the gate and are therein secured by adjusting nuts: substantially as and for the purpose set forth.

LOUIS HAEGE.

In presence of—
C. P. FLEISCHBEIN,
ERNEST HILGARD.