



(51) International Patent Classification:

F01D 11/10 (2006.01) F01D 11/08 (2006.01)
F01D 25/24 (2006.01) F01D 11/12 (2006.01)

(21) International Application Number:

PCT/US2014/035089

(22) International Filing Date:

23 April 2014 (23.04.2014)

(25) Filing Language:

English

(26) Publication Language:

English

(30) Priority Data:

61/824,491 17 May 2013 (17.05.2013) US

(71) Applicant: GENERAL ELECTRIC COMPANY
[US/US]; 1 River Road, Schenectady, NY 12348 (US).

(72) Inventors: BALDIGA, Jonathan, David; 1000 Western Ave, Lynn, MA 01910-0002 (US). SHAPIRO, Jason, David; 1000 Western Ave, Lynn, MA 01910-0002 (US).

(74) Agents: SHANKAM, Vivek, P. et al.; General Electric Company, Global Patent Operation, 2 Corporate Drive Suite 648, Shelton, CT 06484 (US).

(81) Designated States (unless otherwise indicated, for every kind of national protection available): AE, AG, AL, AM, AO, AT, AU, AZ, BA, BB, BG, BH, BN, BR, BW, BY, BZ, CA, CH, CL, CN, CO, CR, CU, CZ, DE, DK, DM,

DO, DZ, EC, EE, EG, ES, FI, GB, GD, GE, GH, GM, GT, HN, HR, HU, ID, IL, IN, IR, IS, JP, KE, KG, KN, KP, KR, KZ, LA, LC, LK, LR, LS, LT, LU, LY, MA, MD, ME, MG, MK, MN, MW, MX, MY, MZ, NA, NG, NI, NO, NZ, OM, PA, PE, PG, PH, PL, PT, QA, RO, RS, RU, RW, SA, SC, SD, SE, SG, SK, SL, SM, ST, SV, SY, TH, TJ, TM, TN, TR, TT, TZ, UA, UG, US, UZ, VC, VN, ZA, ZM, ZW.

(84) Designated States (unless otherwise indicated, for every kind of regional protection available): ARIPO (BW, GH, GM, KE, LR, LS, MW, MZ, NA, RW, SD, SL, SZ, TZ, UG, ZM, ZW), Eurasian (AM, AZ, BY, KG, KZ, RU, TJ, TM), European (AL, AT, BE, BG, CH, CY, CZ, DE, DK, EE, ES, FI, FR, GB, GR, HR, HU, IE, IS, IT, LT, LU, LV, MC, MK, MT, NL, NO, PL, PT, RO, RS, SE, SI, SK, SM, TR), OAPI (BF, BJ, CF, CG, CI, CM, GA, GN, GQ, GW, KM, ML, MR, NE, SN, TD, TG).

Declarations under Rule 4.17:

- as to applicant's entitlement to apply for and be granted a patent (Rule 4.17(ii))
- as to the applicant's entitlement to claim the priority of the earlier application (Rule 4.17(iii))

Published:

- with international search report (Art. 21(3))

(54) Title: CMC SHROUD SUPPORT SYSTEM OF A GAS TURBINE

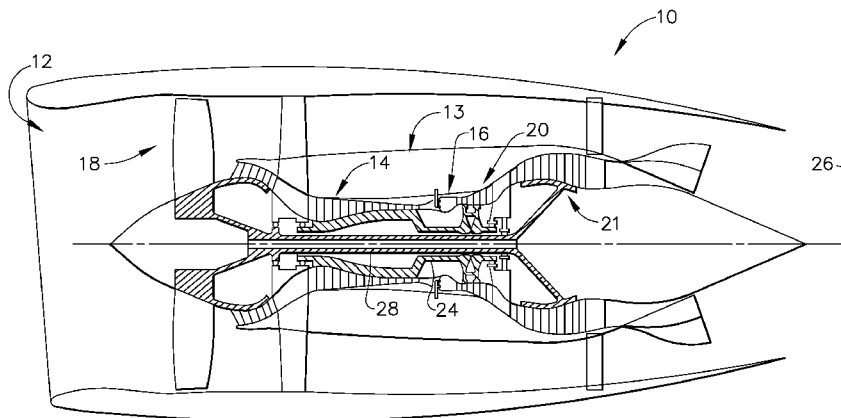

(57) Abstract: A shroud support system 30 with load spreading comprises a shroud hanger 70 having a first wall 72 and a second wall 74 spaced apart in an axial direction by a retainer support wall 76, a ceramic matrix composite shroud segment 41 disposed in the shroud hanger between the first and second walls and the retainer support wall, a retainer 80 having circumferentially spaced first and second bolt holes 71, the retainer passing through the shroud, first and second bolts 79 passing through the shroud hanger and engaging the first and second bolt holes of the retainer.



CMC SHROUD SUPPORT SYSTEM OF A GAS TURBINE

CLAIM TO PRIORITY

[0001] This PCT utility application claims priority to and benefit from currently pending provisional application having U.S. Patent Application Serial No. 61/824,491, titled "CMC Shroud Support System" and having filing date May 17, 2013, all of which is incorporated by reference herein.

BACKGROUND

[0004] The disclosed embodiments generally pertain to shrouds for a gas turbine engines. More particularly, but not by way of limitation, present embodiments relate to ceramic matrix composite shroud support systems utilized in gas turbine engines.

[0005] A typical gas turbine engine generally possesses a forward end and an aft end with its several core or propulsion components positioned axially therebetween. An air inlet or intake is located at a forward end of the engine. Moving toward the aft end, in order, the intake is followed by a compressor, a combustion chamber, and a turbine. It will be readily apparent from those skilled in the art that additional components may also be included in the engine, such as, for example, low-pressure and high-pressure compressors, and low-pressure and high-pressure turbines. This, however, is not an exhaustive list. An engine also typically has an internal shaft axially disposed along a center longitudinal axis of the engine. The internal shaft is connected to both the turbine and the air compressor, such that the turbine provides a rotational input to the air compressor to drive the compressor blades.

[0006] In operation, air is pressurized in a compressor and mixed with fuel in a combustor for generating hot combustion gases which flow downstream through turbine stages. These turbine stages extract energy from the combustion gases. A high pressure turbine first receives the hot combustion gases from the combustor and includes a stator nozzle assembly directing the combustion gases downstream through a row of high pressure turbine rotor blades extending radially outwardly from a supporting rotor disk. In a two stage turbine, a second stage stator nozzle assembly is positioned downstream of the first stage blades followed in turn by a row of second stage rotor blades extending radially outwardly from a second supporting rotor disk. The turbine converts the combustion gas energy to mechanical energy.

[0007] Each of the turbines may include one or more stages of rotor blades which extend radially outward from rotor discs. A shroud assembly circumscribes the turbine rotor and defines an outer boundary for combustion gases flowing through the turbine. The turbine shroud

may be a single unitary structure or may be formed of a plurality of segments. Some known shroud assemblies include a shroud hanger that is coupled to an outer casing of the engine to provide support to a plurality of shrouds positioned adjacent to, and radially outward of, the tips of the turbine blades. The shrouds may be coupled by way of a single bolted connection to the shroud hanger. However, should a crack or bolt failure occur, the shroud may become disconnected from the shroud hanger.

[0008] The shroud must be capable of meeting the design life requirements for use in the turbine engine operating temperature and pressure environment. To enable current materials to operate effectively in such strenuous temperature and pressure conditions, it has been practiced to utilize composite and, in particular, ceramic matrix composite (CMC) materials for use in the shroud segments because they have higher temperature capability than metallic type parts. However, such ceramic matrix composite (CMC) materials have mechanical properties that must be considered during the design and application of the CMC use as a shroud segment or component. CMC materials have relatively low tensile ductility or low strain to failure when compared to metallic materials. Also, CMC materials have a coefficient of thermal expansion which differs significantly from metal alloys used as restraining supports or hangers for shrouds of CMC type materials. Therefore, if a CMC shroud segment is restrained and cooled on one surface during operation, stress concentrations can develop leading to failure of the segment.

[0009] As may be seen by the foregoing, it would be desirable to overcome these and other deficiencies with gas turbine engine components. Moreover, it would be desirable to improve the reliability of a CMC shroud support system.

SUMMARY

[0010] According to present embodiments, a shroud support system with load spreading, comprises a shroud hanger which extends in at least a circumferential direction, the shroud hanger having a first wall and a second wall spaced apart in an axial direction by a retainer support wall, a ceramic matrix composite shroud disposed in the shroud hanger between the first and second walls and the retainer support wall, a retainer having circumferentially spaced first and second bolt holes, the retainer passing through the shroud, first and second bolts passing through the shroud hanger and engaging the first and second bolt holes of the retainer. The shroud support system wherein the shroud hanger has first and second bolt holes, the first and second bolt holes being spaced circumferentially. The shroud support system wherein the first and second bolt holes of the shroud hanger extending one of parallel or at an angle relative to each other through the shroud hanger. The shroud support system further comprising bosses depending from the retainer support wall. The shroud support system further comprising a

shroud hanger bolt hole in each boss. The shroud support system wherein the shroud is disposed between first and second bosses. The shroud support system further comprising air diffuser cavity holes in the shroud hanger. The shroud support system wherein one of the first and second walls function as a spring. The shroud support system wherein the retainer has a plurality of protrusions to engage the shroud. The shroud support system further comprises a baffle disposed below the retainer and within the shroud hanger.

[0011] All of the above outlined features are to be understood as exemplary only and many more features and objectives of the invention may be gleaned from the disclosure herein. Therefore, no limiting interpretation of this summary is to be understood without further reading of the entire specification, claims, and drawings included herewith.

BRIEF DESCRIPTION OF THE ILLUSTRATIONS

[0012] The above-mentioned and other features and advantages of these exemplary embodiments, and the manner of attaining them, will become more apparent and the shroud support system will be better understood by reference to the following description of embodiments taken in conjunction with the accompanying drawings, wherein:

[0013] FIG. 1 is a side section view of a gas turbine engine;

[0014] FIG. 2 is a side section view of an assembled exemplary turbine shroud support section system;

[0015] FIG. 3 is an exploded isometric view of an exemplary shroud support system;

[0016] FIG. 4 is an aft-looking-forward section view of an exemplary shroud support system;

[0017] FIG. 5 is a detail section depicting one bolted connection of the shroud support system;

[0018] FIG. 6 is lower isometric view of a shroud hanger of the exemplary shroud support system;

[0019] FIG. 7 is an isometric view of an exemplary shroud;

[0020] FIG. 8 is an isometric view of a retainer; and,

[0021] FIG. 9 is an isometric view of a baffle utilized with the shroud support system.

DETAILED DESCRIPTION

[0022] Reference now will be made in detail to embodiments provided, one or more examples of which are illustrated in the drawings. Each example is provided by way of explanation, not limitation of the disclosed embodiments. In fact, it will be apparent to those skilled in the art that various modifications and variations can be made in the present embodiments without departing from the scope or spirit of the disclosure. For instance, features

illustrated or described as part of one embodiment can be used with another embodiment to still yield further embodiments. Thus, it is intended that the present invention covers such modifications and variations as come within the scope of the appended claims and their equivalents.

[0023] Referring to FIGS. 1-9 various embodiments of a Ceramic Matrix Composite (“CMC”) shroud hanger support system is depicted. The shroud hanger support system may be utilized in various portions of the gas turbine engine including, but not limited to, high pressure and low pressure turbines as well as the compressor. The hanger support system includes a load spreading retainer and redundant couplings to retain the system together. All of these features improve any or all of manufacture, operation or performance.

[0024] As used herein, the terms “axial” or “axially” refer to a dimension along a longitudinal axis of an engine. The term “forward” used in conjunction with “axial” or “axially” refers to moving in a direction toward the engine inlet, or a component being relatively closer to the engine inlet as compared to another component. The term “aft” used in conjunction with “axial” or “axially” refers to moving in a direction toward the engine nozzle, or a component being relatively closer to the engine nozzle as compared to another component.

[0025] As used herein, the terms “radial” or “radially” refer to a dimension extending between a center longitudinal axis of the engine and an outer engine circumference. The use of the terms “proximal” or “proximally,” either by themselves or in conjunction with the terms “radial” or “radially,” refers to moving in a direction toward the center longitudinal axis, or a component being relatively closer to the center longitudinal axis as compared to another component. The use of the terms “distal” or “distally,” either by themselves or in conjunction with the terms “radial” or “radially,” refers to moving in a direction toward the outer engine circumference, or a component being relatively closer to the outer engine circumference as compared to another component.

[0026] As used herein, the terms “lateral” or “laterally” refer to a dimension that is perpendicular to both the axial and radial dimensions.

[0027] All directional references (e.g., radial, axial, proximal, distal, upper, lower, upward, downward, left, right, lateral, front, back, top, bottom, above, below, vertical, horizontal, clockwise, counterclockwise) are only used for identification purposes to aid the reader’s understanding of the present invention, and do not create limitations, particularly as to the position, orientation, or use of the invention. Connection references (e.g., attached, coupled, connected, and joined) are to be construed broadly and may include intermediate members between a collection of elements and relative movement between elements unless otherwise indicated. As such, connection references do not necessarily infer that two elements are directly

connected and in fixed relation to each other. The exemplary drawings are for purposes of illustration only and the dimensions, positions, order and relative sizes reflected in the drawings attached hereto may vary.

[0028] Referring initially to FIG. 1, a schematic side section view of a gas turbine engine 10 is shown. The function of the turbine is to extract energy from high pressure and temperature combustion gases and convert the energy into mechanical energy for work. The turbine 10 has an engine inlet end 12 wherein air enters the core or propulsor 13 which is defined generally by a compressor 14, a combustor 16 and a multi-stage high pressure turbine 20. Collectively, the propulsor 13 provides during operation. The gas turbine 10 may be used for aviation, power generation, industrial, marine or the like.

[0029] In operation, air enters through the air inlet end 12 of the engine 10 and moves through at least one stage of compression where the air pressure is increased and directed to the combustor 16. The compressed air is mixed with fuel and burned providing the hot combustion gas which exits the combustor 16 toward the high pressure turbine 20. At the high pressure turbine 20, energy is extracted from the hot combustion gas causing rotation of turbine blades which in turn cause rotation of the shaft 24. The shaft 24 passes toward the front of the engine to continue rotation of the one or more compressor stages 14, a turbofan 18 or inlet fan blades, depending on the turbine design. The turbofan 18 is connected by the shaft 28 to a low pressure turbine 21 and creates thrust for the turbine engine 10. The low pressure turbine 21 may also be utilized to extract further energy and power additional compressor stages. The low pressure air may be used to aid in cooling components of the engine as well.

[0030] Referring now to FIG. 2, a side section view of exemplary shroud support system 30 is depicted. An exemplary turbine is shown, however the instant embodiments are not limited to turbine use. The turbine 20 includes a row of circumferentially spaced stationary vanes (not shown) and a plurality of circumferentially spaced turbine blades 23 downstream of the vanes. The blades 23 are foil-shaped and mounted to a turbine rotor disk (not shown). Each of the blades 23 extends radially toward a shroud 40. The shroud 40 extends circumferentially about the engine axis 26 and is comprised of a plurality of shroud segments 41 (FIG. 3). Optionally, the shroud 40 may be formed of one unitary structure. The shroud 40 is tightly configured relative to the blades 23 so that the shroud 40 defines an outer radial flowpath boundary for the hot combustion gas flowing through the turbine 20.

[0031] The system 30 includes a hanger 70, a shroud 40 comprised of a plurality of shroud segments 41 and a retainer 80. A baffle 90 may optionally be used within the shroud segment 41 and beneath the retainer 80. The system 30 includes a shroud hanger 70 which is connected to the engine casing and extends circumferentially about a portion of the engine, for

example the turbine. An engine casing 35 extends circumferentially about the engine axis 26 (FIG. 1). Hangers 70 are extending from the radially inward side of the engine casing. The hangers 70 retain the shroud segments 41 in circular configuration about the engine axis 26 (FIG. 1) and the shroud segments 41 define the flow boundary within portions of the engine, for non-limiting example, the compressor 14 or turbine 20.

[0032] The shroud hanger 70 is defined by a plurality of segments which in combination, extend about the central axis 26 of the engine. The shroud hanger 70 includes a first wall 72 a second wall 74, each of which extend in a radial direction and in a circumferential direction. A hanger gusset 76 extends between the first wall 72 and the second wall 74 and may extend axially or may extend at an angle to the central axis 26 as depicted. According to instant embodiment, the gusset 76 is tapered from a lower radial height at the first wall 72 to a higher radial height at the second wall 74. The shroud hanger 70 includes tabs or hooks 73, 75 which may be utilized to engage the engine casing. The gusset 76 may alternatively be flat or tapered in the opposite direction. These hooks 73, 75 may take various forms in order to provide a mounting assembly or structure.

[0033] As depicted, the shroud hanger 70 has a space between the first wall 72 and the second wall 74 wherein the shroud segment 41 may be positioned. The lower most surface of the shroud segment 41 defines an outer surface of an air flow path within the gas turbine engine, for example a compressor or turbine. The segments 41 may further comprise an abradable material 43 on the lowermost surface. Radially inward from the shroud segment is an airfoil blade 23 which rotates during operation of the gas turbine engine 10 with a rotor disk.

[0034] A bolt 79 is positioned within the shroud hanger 70 and extends downwardly through a hanger boss 77. The bolt 79 is connected to the retainer 80 which extends in a circumferential direction through the shroud segment 41. The retainer 80 captures the shroud segment 41 within the shroud hanger 70 inhibiting the segment 41 from being removed from the shroud hanger 70. Each shroud hanger 70 includes two bosses 77 which are spaced apart circumferentially and are disposed near circumferential ends of the shroud segment 41. With the retainer 80 extending through the shroud segment 41, the shroud segment 41 is captured between the first and second walls 72, 74 and within the open space of the shroud hanger 70. Beneath the retainer 80 is a baffle 90 which aids with cooling of the shroud segments 41.

[0035] Referring now to FIG. 3, an exploded isometric assembly view of the shroud support system is depicted. In the exploded view, the shroud hanger 70 is shown with two bolts 79 depicted above the shroud hanger. The bolts 79 extend through the shroud hanger 70. The bolt passes through the apertures 71 in the hanger boss 77 (FIG. 2) and a retainer 80 passes through the shroud segment 41 so that bolt apertures 85 of the retainer 80 are aligned with the

bolts 79 passing through the shroud hanger 70. With the retainer 80 extending through the shroud segment 41 and the bolts 79 extending through the hanger 70 into the apertures 85 of the retainer 80, the shroud segment 41 is pulled into a gap disposed between the first and second walls 72, 74 of the shroud hanger 70. The baffle 90 is disposed beneath the retainer 80 and is also positioned within the shroud segment 41 beneath the upper surface 44. Along a lower surface of the shroud segment 41, an abradable surface material 43 may be exposed so as to aid engagement with the blade 23 (FIG. 2).

[0036] Referring now to FIG. 4, an assembled aft-looking forward section view of the support system 30 is depicted. The shroud hanger 70 includes a forward hook 73 in the first wall 72 depending downwardly from the hook 73. At the lower end of the first wall 72, at circumferential ends of the shroud hanger 70, are bosses 77. The bolts 79 extend downwardly through the boss 77 and into the retainer 80. The retainer 80 passes through the interior of the shroud segment 41 and therefore captures the shroud segment within the boundary of shroud hanger 70 and between the hanger boss structures 77. The shroud 41 has an upper surface which is sized with a circumferential dimension to fit between the circumferential dimensions separating the bosses 77. With this design, the shroud 41 need not have a center window as in prior art shrouds which alternate hanger systems use. This reduces stress concentrations in the shroud 41, and more specifically, the upper surface of the shroud 41. Additionally, the bolts 79 are parallel to one another to reduce bolt bending. This increases bolt durability and results in an improved joint. According to alternative embodiments however, the bolts 79 need not be parallel to be within the scope of the disclosed embodiments. For example, the bolts 79 may be biased at an angle relative to each other for ease of assembly.

[0037] Referring now to FIG. 5, a detailed section view of the shroud hanger 70 is depicted. The detailed view shows a single boss 77 with a bolt 79 passing therethrough. A portion of the retainer 80 is shown connected by the bolt 79 to the shroud hanger 70. The retainer 80 includes a flange 81 and an arm 83 extending in a circumferential direction. The arm 83 includes a plurality of projections 82 which extend upwardly in the orientation depicted. The projections 82 engage the lower surface of the outer wall of shroud 41. This provides a determined loading location and spreads the load across the shroud 41 and arm 83 between the connections of the shroud hanger 70 and shroud 41.

[0038] Referring now to FIG. 6, a lower perspective view of a lower portion of the shroud hanger 70 is depicted. The shroud hanger segment 70 includes the first wall 72 and the opposite second wall 74. Extending between the first and second walls 72, 74 is the gusset or retainer support wall 76. At upper portions of the shroud hanger 70 are the hooks 73, 75 which may be utilized to connect the shroud hanger segment 70 to an engine casing. Although hooks

are depicted, this is merely exemplary as various hanger structures may be utilized alternatively to the depicted hooks. The second wall 74 is spaced from the first wall 72 to receive a shroud segment 41 (FIG. 2) therebetween. Each of the bosses 77 includes bolt apertures 71. The bolt hole 71 receives a bolt 79 (FIG. 5) which passes through an upper side of the shroud hanger 70 extending downwardly through the shroud hanger. The lower most surfaces of the bosses 77 are horizontal and are abutted in the assembled structure by the retainer flanges 81 (FIG. 5) which have complimenting horizontal upper surfaces. These lower surfaces of the boss 77, however, may alternatively be angled so as to compliment a parallel surface of the retainer flange 81 and accordingly, carry a load across the lower surface of the boss 77.

[0039] Adjacent to the bolt holes 71 are air diffuser cavities 89. These holes provide shroud cooling air from a known source through the retainer baffle 90.

[0040] The second wall 74 of the shroud hanger 70 functions as a spring structure. When the shroud segment 41 (FIG. 7) is disposed between walls 72, 74, the wall 74 provides an axial force against the shroud segment 41 to positively locate the shroud segment within the shroud hanger 70. The bolt 79 retains radially and the walls 72, 74 retain the segment 41 axially.

[0041] Referring now to FIG. 7, an isometric view of an exemplary shroud segment 41 is depicted. Each shroud segment 41 has a generally hollow cross-sectional shape defined by a radially inner wall 42 and a radially outer wall 44 and forward and aft walls 46, 48. Various cross-sectional shapes may be defined and the depicted shape should not be considered limiting. The wall 42, support walls 46, 48 define a hollow interior or cavity 50 through which air may pass for cooling of the shroud segments 41. A transition wall 52 may also be located between the forward wall 46 and the radially outer wall 44. The transition wall 52 may be curved as shown or at an acute angle to the longitudinal axis 26 of the engine 10. The walls 42, 44, 46, 48, 52 may be joined by radiused, sharp or squared-edged transitions between the intersections of the walls. As shown herein, the walls are generally radiused which may improve manufacture of the part.

[0042] The radially inner wall 42 extends beyond the forward wall 46 and aft wall 48 to define forward and aft overhangs 54, 56. When a plurality of shroud segments 40 are positioned together, a substantially continuous flow surface 60 is defined along the radially inner side of wall 42. This is best seen in a forward looking aft view of FIG. 5.

[0043] The shroud segments 41 include end faces 68 which are commonly referred to as "slash faces." The slash faces 68 may lie in plane parallel to the center line axis of the engine 10, referred to as a "radial plane", or they may be slightly offset from the radial plane, or otherwise oriented so that they are at an acute angle to such radial plane. Along the slash faces

68 are relief sections 62, 64, which in combination with adjacent relief sections of adjacent segments 41 form apertures. When a plurality of segments 41 are positioned to form a shroud or shroud assembly 40, the shroud 40 has a plurality of circumferentially spaced apertures formed by adjacent relief sections 62, 64 located at the slash faces 68. The shroud 40 is supported from the hanger 70 and retainer 80 at these locations.

[0044] When the segments 41 are assembled into a complete ring, end gaps may be present between the faces 68 at the adjacent shroud segments 41. One or more seals may be provided at the end faces 68. These seals are generally known as “spline” seals formed of thin strips of metal or other suitable materials which are inserted in slots in the end faces to span the gaps between adjacent segments 41.

[0045] The shroud segments 41 may be constructed of various low ductility and low coefficient of thermal expansion materials including but not limited to a ceramic matrix composite (CMC). Generally, CMC materials include a ceramic fiber, for example a silicon carbide (SiC), forms of which are coated with a compliant material such as boron nitride (BN). The fibers are coated in a ceramic type matrix, one form of which is silicon carbide (SiC). Typically, the shroud segment 41 can also be constructed of other low-ductility, high-temperature-capable materials. CMC materials generally have room temperature tensile ductility of less than or equal to about 1% which is used herein to define a low tensile ductility material. Generally, CMC materials have a room temperature tensile ductility in the range of about 0.4% to about 0.7%.

[0046] CMC materials have a characteristic wherein the materials tensile strength in the direction parallel to the length of the fibers (the “fiber direction”) is stronger than the tensile strength in the direction perpendicular. This perpendicular direction may include matrix, interlaminar, secondary or tertiary fiber directions. Various physical properties may also differ between the fiber and the matrix directions.

[0047] The shroud segment 41 may incorporate a layer of environmental barrier coating 43, which may be an abradable material, and/or a rub-tolerant material of a known type suitable for use with CMC materials. This layer is sometimes referred to as a “rub coat” 43. As used herein, the term “abradable” implies that the rub coat 43 is capable of being abraded, ground, or eroded away during contact with the tips of the turbine blades 23 as they turn inside the shroud segments 41 at high speed, with little or no resulting damage to the turbine blade tips. This abradable property may be a result of the material composition of the rub coat 43, by its physical configuration or by some combination thereof. The rub coat 43 may comprise a ceramic layer such as yttria stabilized zirconia or barium strontium aluminosilicate. Exemplary compositions

and methods suitable for making the rub 43 are described in U.S. Patent No. 7,749,565 (Johnson, et al.), which is incorporated herein by reference.

[0048] Referring now to FIG. 8, a perspective view of the retainer 80 is depicted. The retainer 80 includes flanges 81 at circumferential ends and an arm 83 extending between the opposed flanges. Each of the flanges 81 includes a bolt hole 85 which receives bolt 79 (FIG. 4). Additionally, the arm 83 includes a plurality of projections 82 which engage the shroud segment 41 to spread load across that structure and positively locate the load transfer through the shroud segment 41. The projections 82 are shown as rounded structures. However, alternate shapes may be utilized such that the projections engage the shroud 41. Additionally, the projections 82 extend in an axial direction of the engine and inhibit rocking of the shroud segments 41. Located along the flanges 81 are flow cavities 87 allowing air to pass through the shroud hanger 70 and through the retainer 80 to the baffle 90 beneath the retainer 80. The retainer 80 is positioned through the slash faces 68 at the relief sections 62, 64.

[0049] Referring now to FIG. 9, an upper perspective view of the baffle 90 is depicted. The baffle includes a lower surface 95 and a plurality of walls 91, 92, 93, 94. The lower surface of the baffle 95 includes first and second bolt holes 96 which receive the bolt 79 and provide for connection of the baffle to the remainder of the assembly 30. The baffle 90 provides backside impingement cooling to the shroud segment 41.

[0050] The foregoing description of structures and methods has been presented for purposes of illustration. It is not intended to be exhaustive or to limit the structures and methods to the precise forms and/or steps disclosed, and obviously many modifications and variations are possible in light of the above teaching. Features described herein may be combined in any combination. Steps of a method described herein may be performed in any sequence that is physically possible. It is understood that while certain forms of composite structures have been illustrated and described, it is not limited thereto and instead will only be limited by the claims, appended hereto.

[0051] While multiple inventive embodiments have been described and illustrated herein, those of ordinary skill in the art will readily envision a variety of other means and/or structures for performing the function and/or obtaining the results and/or one or more of the advantages described herein, and each of such variations and/or modifications is deemed to be within the scope of the embodiments described herein. More generally, those skilled in the art will readily appreciate that all parameters, dimensions, materials, and configurations described herein are meant to be exemplary and that the actual parameters, dimensions, materials, and/or configurations will depend upon the specific application or applications for which the inventive teachings is/are used. Those skilled in the art will recognize, or be able to ascertain using no

more than routine experimentation, many equivalents to the specific inventive embodiments described herein. It is, therefore, to be understood that the foregoing embodiments are presented by way of example only and that, within the scope of the appended claims and equivalents thereto, inventive embodiments may be practiced otherwise than as specifically described and claimed. Inventive embodiments of the present disclosure are directed to each individual feature, system, article, material, kit, and/or method described herein. In addition, any combination of two or more such features, systems, articles, materials, kits, and/or methods, if such features, systems, articles, materials, kits, and/or methods are not mutually inconsistent, is included within the inventive scope of the present disclosure.

[0052] Examples are used to disclose the embodiments, including the best mode, and also to enable any person skilled in the art to practice the apparatus and/or method, including making and using any devices or systems and performing any incorporated methods. These examples are not intended to be exhaustive or to limit the disclosure to the precise steps and/or forms disclosed, and many modifications and variations are possible in light of the above teaching. Features described herein may be combined in any combination. Steps of a method described herein may be performed in any sequence that is physically possible.

[0053] All definitions, as defined and used herein, should be understood to control over dictionary definitions, definitions in documents incorporated by reference, and/or ordinary meanings of the defined terms. The indefinite articles “a” and “an,” as used herein in the specification and in the claims, unless clearly indicated to the contrary, should be understood to mean “at least one.” The phrase “and/or,” as used herein in the specification and in the claims, should be understood to mean “either or both” of the elements so conjoined, i.e., elements that are conjunctively present in some cases and disjunctively present in other cases.

[0054] It should also be understood that, unless clearly indicated to the contrary, in any methods claimed herein that include more than one step or act, the order of the steps or acts of the method is not necessarily limited to the order in which the steps or acts of the method are recited.

[0055] In the claims, as well as in the specification above, all transitional phrases such as “comprising,” “including,” “carrying,” “having,” “containing,” “involving,” “holding,” “composed of,” and the like are to be understood to be open-ended, i.e., to mean including but not limited to. Only the transitional phrases “consisting of” and “consisting essentially of” shall be closed or semi-closed transitional phrases, respectively, as set forth in the United States Patent Office Manual of Patent Examining Procedures, Section 2111.03.

[0056] What is claimed is:

CLAIMS

1. A shroud support system 30 with load spreading, comprising:
 - a shroud hanger 70 which extends in at least a circumferential direction, said shroud hanger having a first wall 72 and a second wall 74 spaced apart in an axial direction by a retainer support wall 76;
 - a ceramic matrix composite shroud, formed of a plurality of shroud segments 41 disposed in said shroud hanger between said first and second walls and said retainer support wall;
 - a retainer 80 having circumferentially spaced first and second bolt holes 71, said retainer passing through said shroud segment;
 - first and second bolts 79 passing through said shroud hanger and engaging said first and second bolt holes of said retainer.

2. The shroud support system with load spreading of Claim 1, said shroud hanger having first and second bolt holes, said first and second bolt holes being spaced circumferentially.

3. The shroud support system with load spreading of Claim 2, said first and second bolt holes of said shroud hanger extending one of parallel or at an angle relative to each other through said shroud hanger.

4. The shroud support system with load spreading of Claim 1 further comprising bosses 77 depending from said retainer support wall.

5. The shroud support system with load spreading of Claim 4 further comprising a shroud hanger bolt hole 71 in each of said boss.

6. The shroud support system with load spreading of Claim 4, said shroud segment disposed between first and second bosses.

7. The shroud support system with load spreading of Claim 1 further comprising air diffuser cavity holes 89 in said shroud hanger.

8. The shroud support system with load spreading of Claim 1, one of said first and second walls functioning as a spring.

9. The shroud support system with load spreading of Claim 1, said retainer having a plurality of projections 82 to engage said shroud segment.

10. The shroud support system with load spreading of Claim 1 further comprising a baffle 90 disposed below said retainer and within said shroud hanger.

2/9

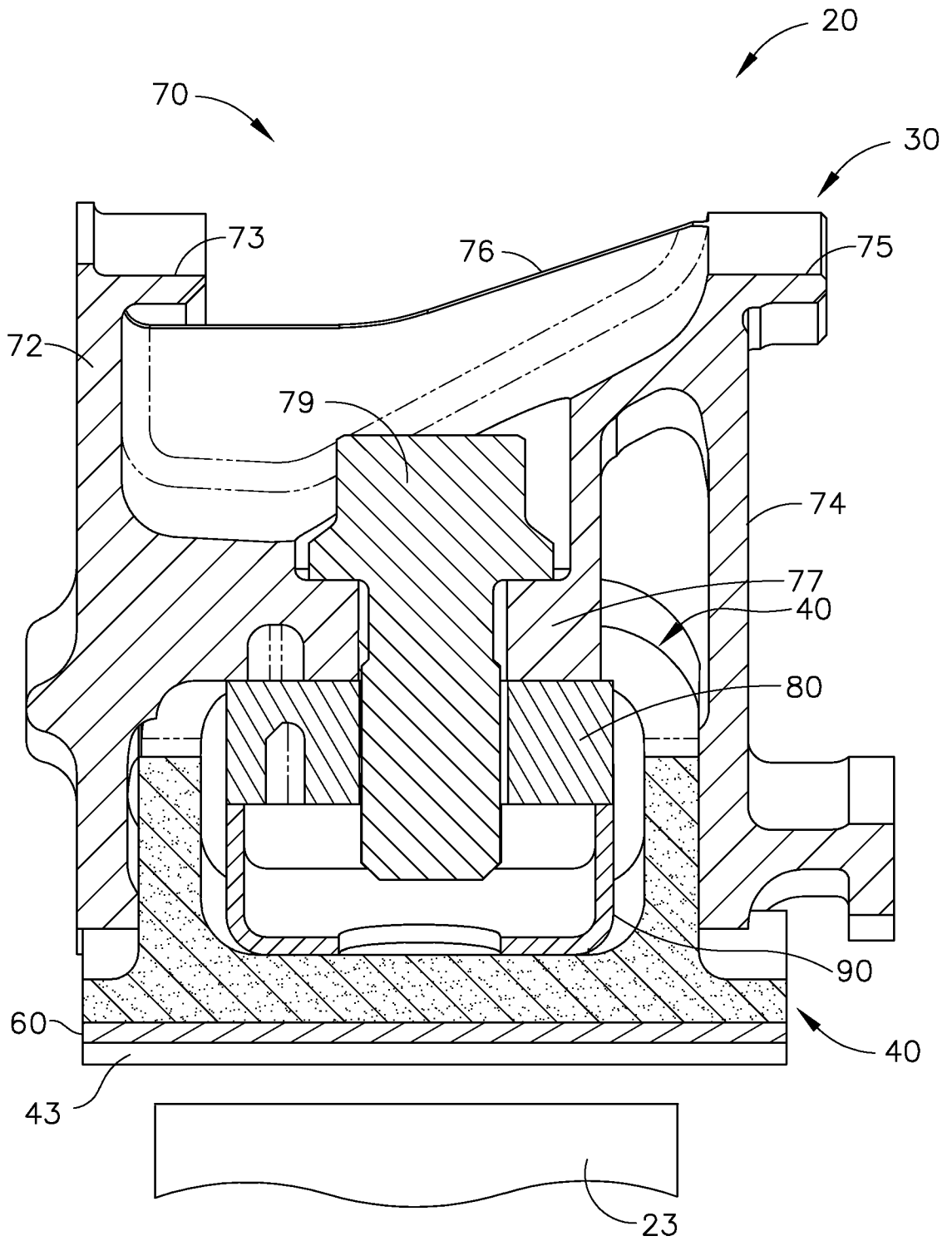
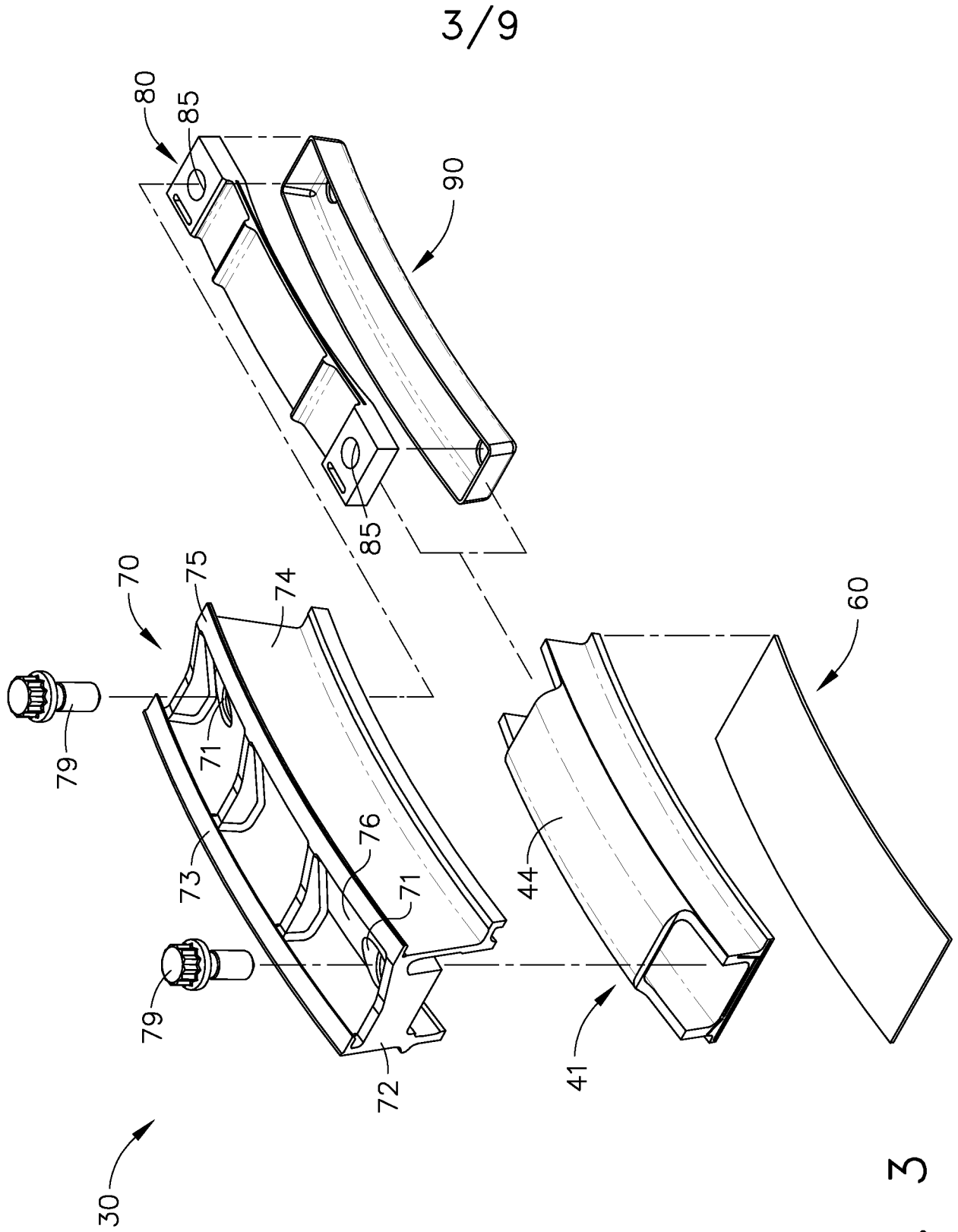

FIG. 2



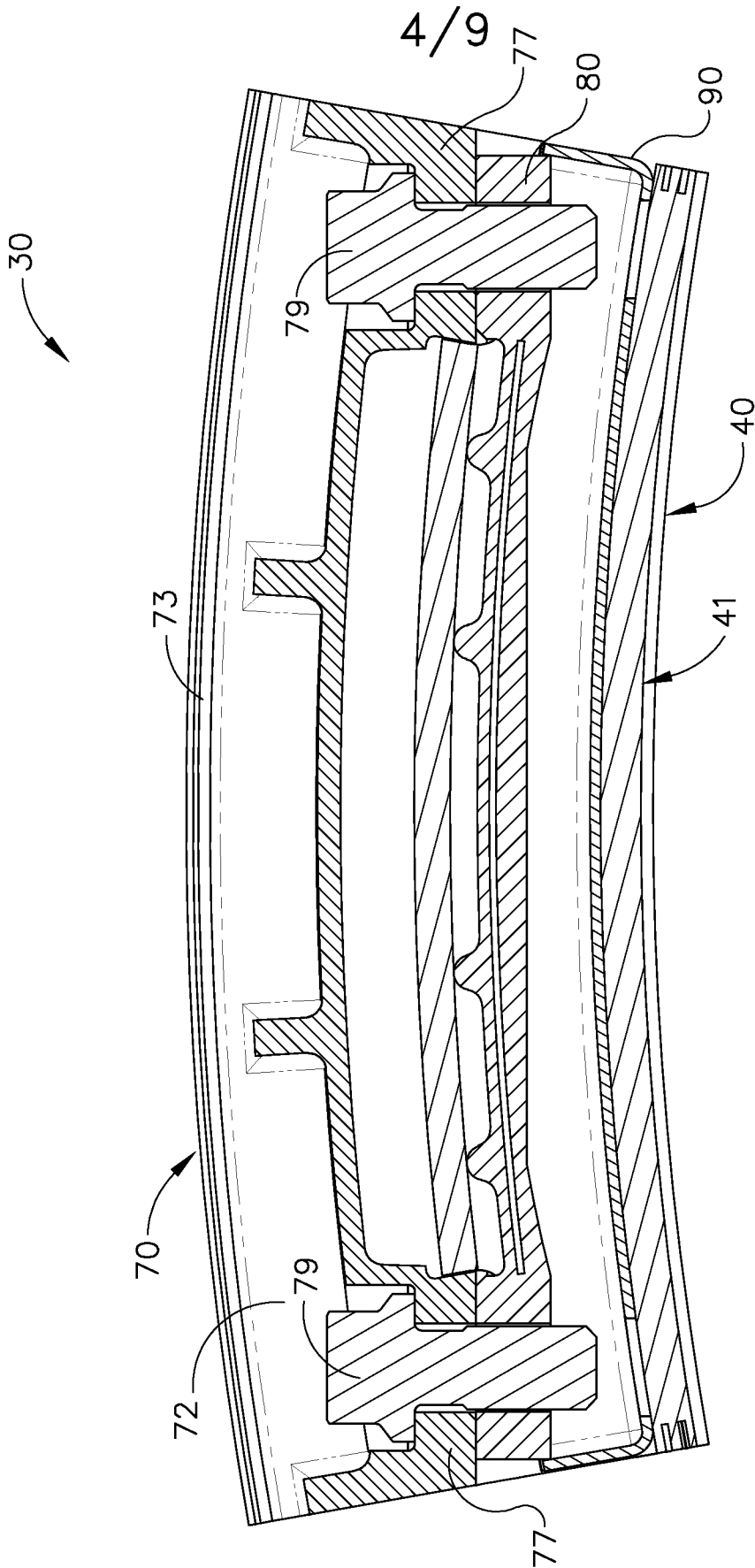
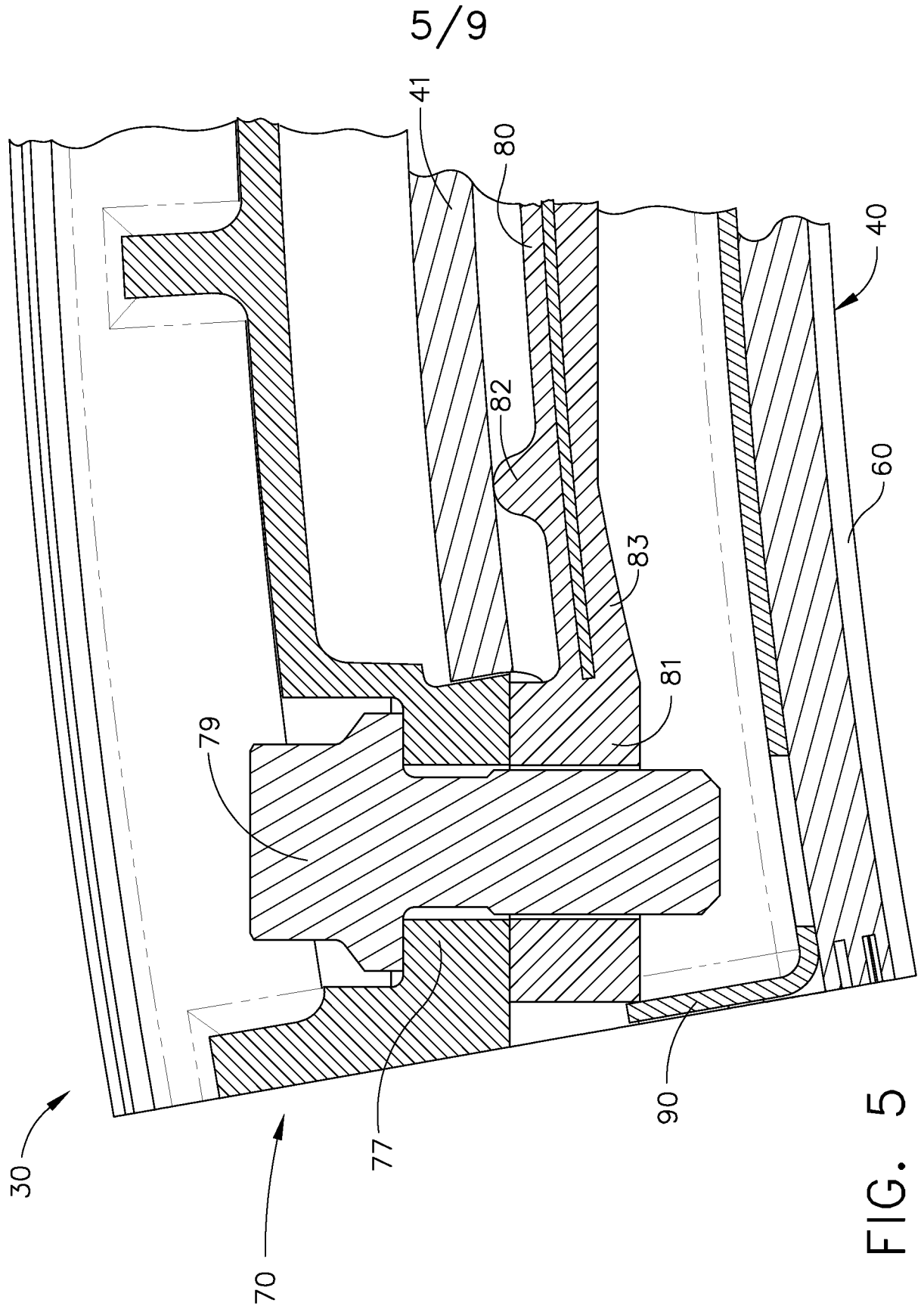

FIG. 4



6/9

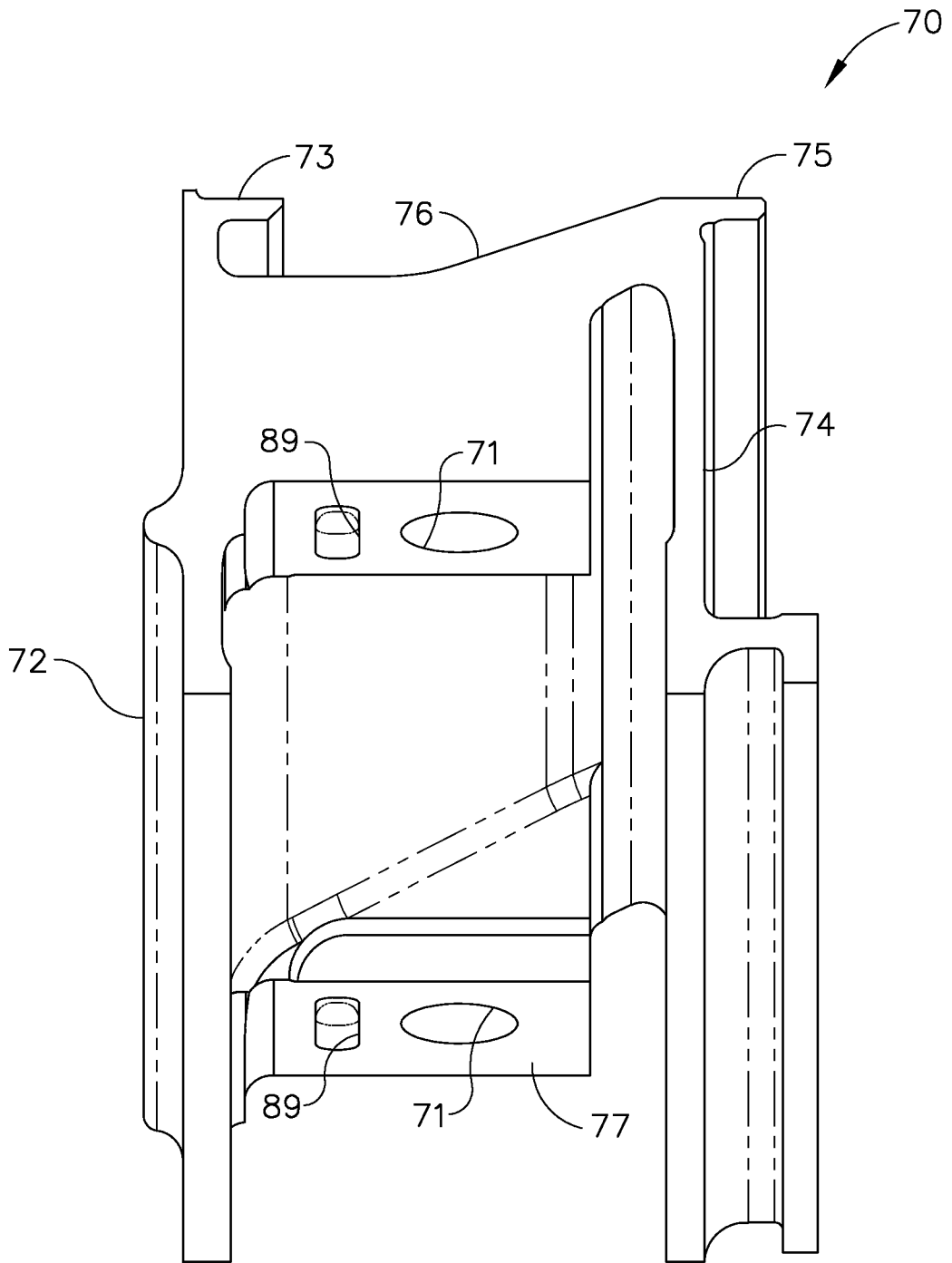

FIG. 6

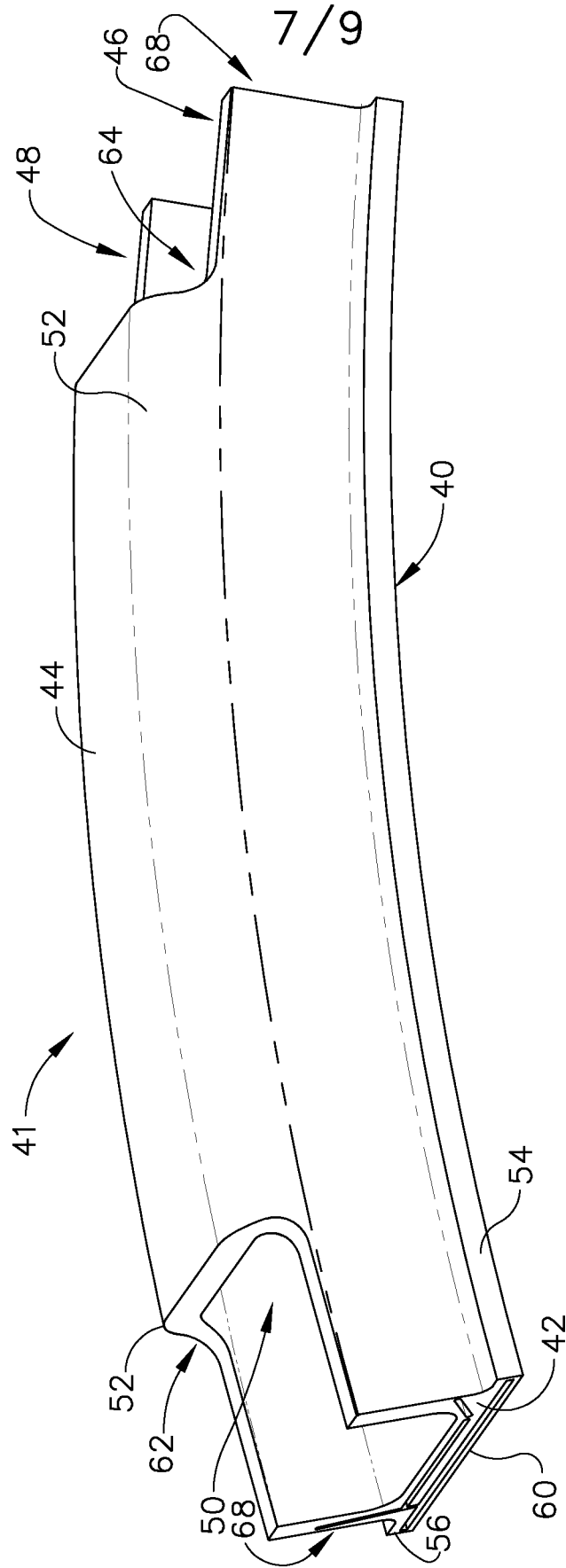

FIG. 7

8/9

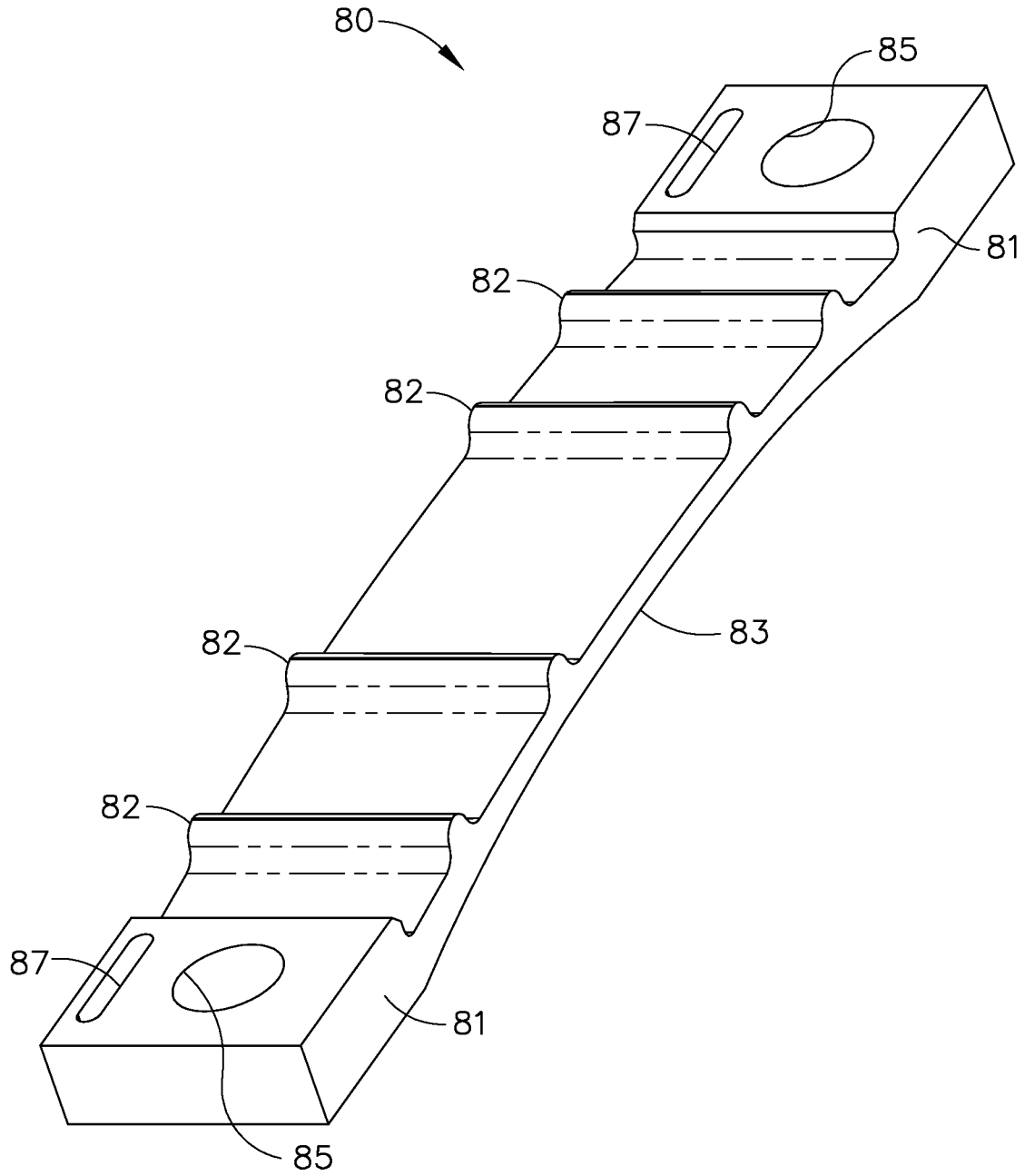

FIG. 8

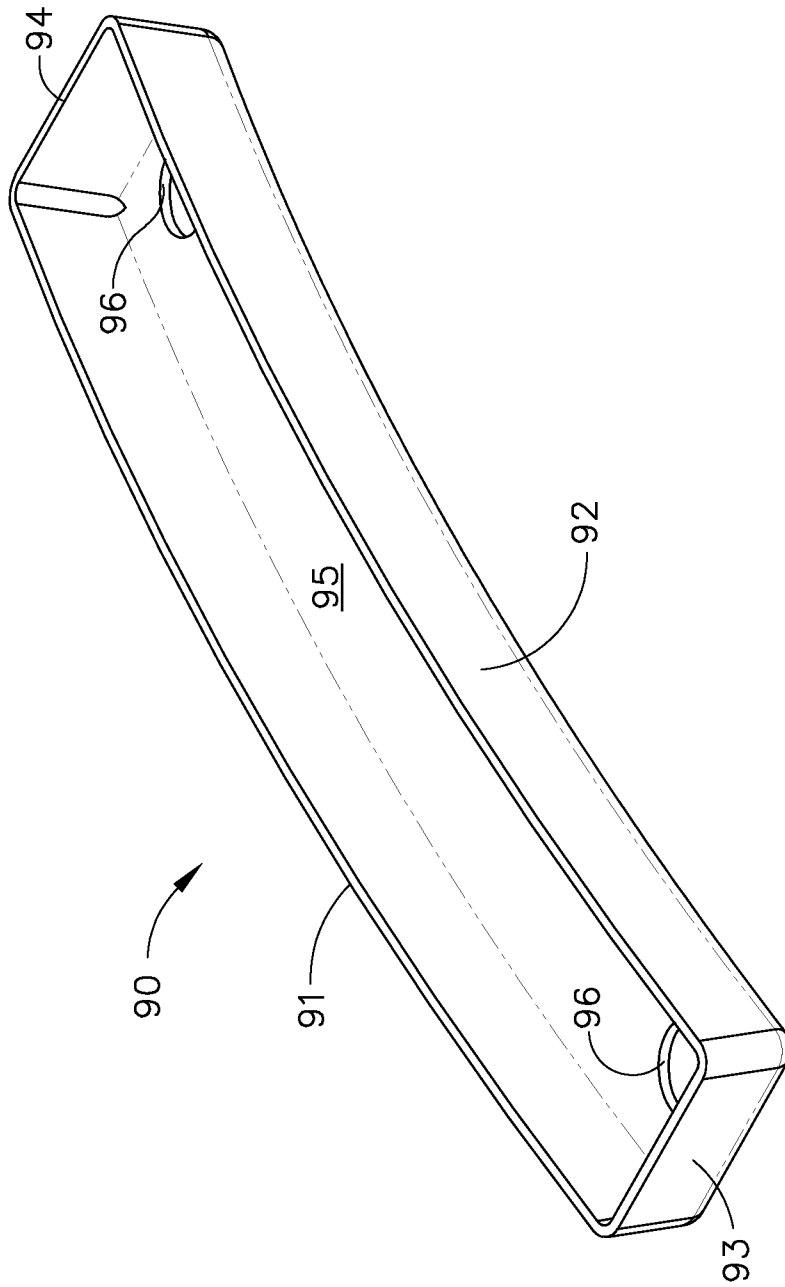

FIG. 9

INTERNATIONAL SEARCH REPORT

International application No
PCT/US2014/035089

A. CLASSIFICATION OF SUBJECT MATTER
 INV. F01D11/10 F01D25/24 F01D11/08 F01D11/12
 ADD.
 According to International Patent Classification (IPC) or to both national classification and IPC

B. FIELDS SEARCHED
 Minimum documentation searched (classification system followed by classification symbols)
 F01D
 Documentation searched other than minimum documentation to the extent that such documents are included in the fields searched

Electronic data base consulted during the international search (name of data base and, where practicable, search terms used)
 EPO-Internal

C. DOCUMENTS CONSIDERED TO BE RELEVANT

Category*	Citation of document, with indication, where appropriate, of the relevant passages	Relevant to claim No.
X	GB 2 484 188 A (GEN ELECTRIC [US]) 4 April 2012 (2012-04-04)	1-7
A	page 3 - page 8; claims 1-3,7,9,10; figures 1-5	8-10
X	GB 2 486 964 A (GEN ELECTRIC [US]) 4 July 2012 (2012-07-04)	1-7
A	page 4 - page 9; claims 1-3, 9,10, 12, 15; figures 1-12	8-10
A	EP 0 770 761 A1 (UNITED TECHNOLOGIES CORP [US]) 2 May 1997 (1997-05-02) the whole document	1-10

Further documents are listed in the continuation of Box C.

See patent family annex.

* Special categories of cited documents :

- "A" document defining the general state of the art which is not considered to be of particular relevance
- "E" earlier application or patent but published on or after the international filing date
- "L" document which may throw doubts on priority claim(s) or which is cited to establish the publication date of another citation or other special reason (as specified)
- "O" document referring to an oral disclosure, use, exhibition or other means
- "P" document published prior to the international filing date but later than the priority date claimed

- "T" later document published after the international filing date or priority date and not in conflict with the application but cited to understand the principle or theory underlying the invention
- "X" document of particular relevance; the claimed invention cannot be considered novel or cannot be considered to involve an inventive step when the document is taken alone
- "Y" document of particular relevance; the claimed invention cannot be considered to involve an inventive step when the document is combined with one or more other such documents, such combination being obvious to a person skilled in the art
- "&" document member of the same patent family

Date of the actual completion of the international search 24 June 2014	Date of mailing of the international search report 01/07/2014
--	---

Name and mailing address of the ISA/ European Patent Office, P.B. 5818 Patentlaan 2 NL - 2280 HV Rijswijk Tel. (+31-70) 340-2040, Fax: (+31-70) 340-3016	Authorized officer Balice, Marco
--	--

INTERNATIONAL SEARCH REPORT

Information on patent family members

International application No

PCT/US2014/035089

Patent document cited in search report	Publication date	Patent family member(s)	Publication date	
GB 2484188	A	04-04-2012	CA 2752462 A1	30-03-2012
			DE 102011054045 A1	05-04-2012
			GB 2484188 A	04-04-2012
			JP 2012077743 A	19-04-2012
			US 2012082540 A1	05-04-2012

GB 2486964	A	04-07-2012	CA 2762613 A1	30-06-2012
			DE 102011057077 A1	05-07-2012
			GB 2486964 A	04-07-2012
			JP 2012140937 A	26-07-2012
			US 2012171027 A1	05-07-2012

EP 0770761	A1	02-05-1997	DE 69634869 D1	28-07-2005
			DE 69634869 T2	24-11-2005
			EP 0770761 A1	02-05-1997
			JP 3965607 B2	29-08-2007
			JP H09112206 A	28-04-1997
			KR 100405881 B1	14-02-2004
			US 5639210 A	17-06-1997
