

(19) World Intellectual Property Organization
International Bureau



(43) International Publication Date
9 February 2006 (09.02.2006)

PCT

(10) International Publication Number
WO 2006/015291 A3

- (51) International Patent Classification:
A63B 23/04 (2006.01) A63B 23/035 (2006.01)
- (21) International Application Number:
PCT/US2005/027159
- (22) International Filing Date: 29 July 2005 (29.07.2005)
- (25) Filing Language: English
- (26) Publication Language: English
- (30) Priority Data:
60/592,615 30 July 2004 (30.07.2004) US
- (71) Applicant (for all designated States except US): UNISEN, INC, DBA STAR TRAC [US/US]; 14410 Myford Road, Irvine, CA 92606 (US).

[US/US]; 916 S. Orange Ave., Santa Ana, CA 92701 (US).
CORBALIS, Kevin, Patrick [US/US]; 2610 Davis Drive, Tustin, CA 92782 (US).

(74) Agent: **DELANEY, Karoline, A.**; Knobbe, Martens, Olson & Bear, LLP, 2040 Main Street, 14th Floor, Irvine, CA 92614 (US).

(81) Designated States (unless otherwise indicated, for every kind of national protection available): AE, AG, AL, AM, AT, AU, AZ, BA, BB, BG, BR, BW, BY, BZ, CA, CH, CN, CO, CR, CU, CZ, DE, DK, DM, DZ, EC, EE, EG, ES, FI, GB, GD, GE, GH, GM, HR, HU, ID, IL, IN, IS, JP, KE, KG, KM, KP, KR, KZ, LC, LK, LR, LS, LT, LU, LV, MA, MD, MG, MK, MN, MW, MX, MZ, NA, NG, NI, NO, NZ, OM, PG, PH, PL, PT, RO, RU, SC, SD, SE, SG, SK, SL, SM, SY, TJ, TM, TN, TR, TT, TZ, UA, UG, US, UZ, VC, VN, YU, ZA, ZM, ZW.

(84) Designated States (unless otherwise indicated, for every kind of regional protection available): ARIPO (BW, GH, GM, KE, LS, MW, MZ, NA, SD, SL, SZ, TZ, UG, ZM, ZW), Eurasian (AM, AZ, BY, KG, KZ, MD, RU, TJ, TM), European (AT, BE, BG, CH, CY, CZ, DE, DK, EE, ES, FI, FR, GB, GR, HU, IE, IS, IT, LT, LU, LV, MC, NL, PL, PT, RO, SE, SI, SK, TR), OAPI (BF, BJ, CF, CG, CI, CM, GA, GN, GQ, GW, ML, MR, NE, SN, TD, TG).

[Continued on next page]

(54) Title: ARTICULATING LINKAGE EXERCISE MACHINE

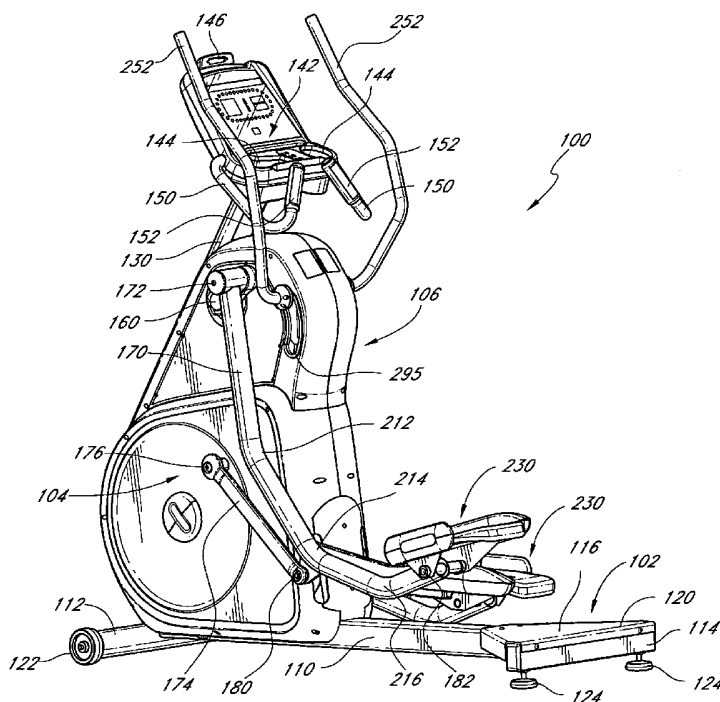

(57) Abstract: An elliptical machine has a frame and an operating linkage between the frame and foot supports. Each side of the operating linkage comprises five links that are connected with five pin joints. A foot support is connected to each side of the operating linkage with each of the five pin joints being positioned forward of the foot support.

WO 2006/015291 A3



Published:

- *with international search report*
- *before the expiration of the time limit for amending the claims and to be republished in the event of receipt of amendments*

For two-letter codes and other abbreviations, refer to the "Guidance Notes on Codes and Abbreviations" appearing at the beginning of each regular issue of the PCT Gazette.

(88) Date of publication of the international search report:

20 April 2006

INTERNATIONAL SEARCH REPORT

International application No
PC 17 US2005/027159

A. CLASSIFICATION OF SUBJECT MATTER
A63B23/04 A63B23/035

According to International Patent Classification (IPC) or to both national classification and IPC

B. FIELDS SEARCHED

Minimum documentation searched (classification system followed by classification symbols)
A63B

Documentation searched other than minimum documentation to the extent that such documents are included in the fields searched

Electronic data base consulted during the international search (name of data base and, where practical, search terms used)

EPO-Internal

C. DOCUMENTS CONSIDERED TO BE RELEVANT

Category*	Citation of document, with indication, where appropriate, of the relevant passages	Relevant to claim No.
X	US 5 769 760 A (LIN ET AL) 23 June 1998 (1998-06-23) column 1, line 64 - column 2, line 37; figures 1-5	1-21
X	-----	
X	US 5 997 445 A (MARESH ET AL) 7 December 1999 (1999-12-07) column 2, line 22 - column 3, line 47; figures 1-3	1-21
X	-----	
X	US 2001/056010 A1 (STEARNS KENNETH W ET AL) 27 December 2001 (2001-12-27) paragraph '0013! - paragraph '0020!; figures 1-4	1-21
A	-----	
A	US 5 374 227 A (WEBB ET AL) 20 December 1994 (1994-12-20)	
A	-----	

Further documents are listed in the continuation of Box C.

See patent family annex.

* Special categories of cited documents :

- *A* document defining the general state of the art which is not considered to be of particular relevance
- *E* earlier document but published on or after the international filing date
- *L* document which may throw doubts on priority claim(s) or which is cited to establish the publication date of another citation or other special reason (as specified)
- *O* document referring to an oral disclosure, use, exhibition or other means
- *P* document published prior to the international filing date but later than the priority date claimed

- *T* later document published after the international filing date or priority date and not in conflict with the application but cited to understand the principle or theory underlying the invention
- *X* document of particular relevance; the claimed invention cannot be considered novel or cannot be considered to involve an inventive step when the document is taken alone
- *Y* document of particular relevance; the claimed invention cannot be considered to involve an inventive step when the document is combined with one or more other such documents, such combination being obvious to a person skilled in the art.
- *Z* document member of the same patent family

Date of the actual completion of the international search

30 January 2006

Date of mailing of the international search report

06/02/2006

Name and mailing address of the ISA/

European Patent Office, P.B. 5818 Patentlaan 2
NL - 2280 HV Rijswijk
Tel. (+31-70) 340-2040, Tx. 31 651 epo nl,
Fax: (+31-70) 340-3016

Authorized officer

Michels, N

INTERNATIONAL SEARCH REPORT

Information on patent family members

International application No

PC 17 JS2005/027159

Patent document cited in search report	Publication date	Patent family member(s)	Publication date
US 5769760	A	23-06-1998	NONE
US 5997445	A	07-12-1999	NONE
US 2001056010	A1	27-12-2001	NONE
US 5374227	A	20-12-1994	NONE