

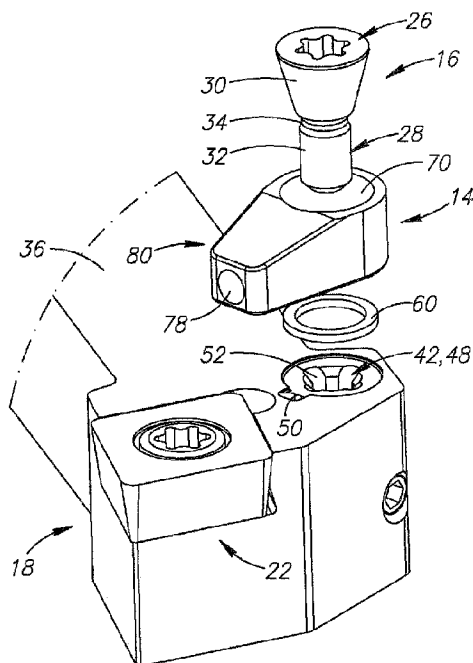

(86) **Date de dépôt PCT/PCT Filing Date:** 2013/03/10  
(87) **Date publication PCT/PCT Publication Date:** 2013/08/29  
(45) **Date de délivrance/Issue Date:** 2017/03/07  
(85) **Entrée phase nationale/National Entry:** 2014/08/01  
(86) **N° demande PCT/PCT Application No.:** IL 2013/050221  
(87) **N° publication PCT/PCT Publication No.:** 2013/124859

(51) **Cl.Int./Int.Cl. B23Q 11/10** (2006.01),  
**B23B 27/10** (2006.01)  
(72) **Inventeur/Inventor:**  
AMSTIBOVITSKY, LEONID, IL  
(73) **Propriétaire/Owner:**  
ISCAR LTD., IL  
(74) **Agent:** WILSON LUE LLP

(54) **Titre : OUTIL DE COUPE EQUIPE D'UN SYSTEME INTERNE DE DISTRIBUTION DE FLUIDE**  
(54) **Title: CUTTING TOOL WITH INTERNAL FLUID DELIVERY SYSTEM**



(57) **Abstrégé/Abstract:**

A cutting tool has an internal cutting tool fluid delivery system. The cutting tool has a tool body and a fluid delivery head coupled thereto by a solid coupling member with a continuous male thread. The tool body includes a body coupling bore and the head includes a head coupling bore which communicates with the body coupling bore. At least one of the body and head coupling bores includes a circumferentially interrupted female thread which has a longitudinal thread axis and a radial outer thread boundary. The or each coupling bore having the female thread includes a thread passage which extends along the thread axis. In an axial cross section of the female thread, the thread passage extends both inside and outside the radial outer thread boundary.

(12) INTERNATIONAL APPLICATION PUBLISHED UNDER THE PATENT COOPERATION TREATY (PCT)

(19) World Intellectual Property  
Organization  
International Bureau



(10) International Publication Number  
**WO 2013/124859 A1**

(43) International Publication Date  
29 August 2013 (29.08.2013)

- (51) International Patent Classification:  
*B23Q 11/10* (2006.01) *B23B 27/10* (2006.01)
- (21) International Application Number:  
PCT/IL2013/050221
- (22) International Filing Date:  
10 March 2013 (10.03.2013)
- (25) Filing Language: English
- (26) Publication Language: English
- (30) Priority Data:  
61/602,437 23 February 2012 (23.02.2012) US
- (71) Applicant: ISCAR LTD. [IL/IL]; P.O. Box 11, 24959 Tefen (IL).
- (72) Inventor: AMSTIBOVITSKY, Leonid; 20/7 Haviva Reik Street, 32547 Haifa (IL).
- (74) Agent: ISCAR LTD.; Patent Department, P.O. Box 11, 24959 Tefen (IL).
- (81) Designated States (unless otherwise indicated, for every kind of national protection available): AE, AG, AL, AM, AO, AT, AU, AZ, BA, BB, BG, BH, BN, BR, BW, BY, BZ, CA, CH, CL, CN, CO, CR, CU, CZ, DE, DK, DM, DO, DZ, EC, EE, EG, ES, FI, GB, GD, GE, GH, GM, GT, HN, HR, HU, ID, IL, IN, IS, JP, KE, KG, KM, KN, KP,

KR, KZ, LA, LC, LK, LR, LS, LT, LU, LY, MA, MD, ME, MG, MK, MN, MW, MX, MY, MZ, NA, NG, NI, NO, NZ, OM, PA, PE, PG, PH, PL, PT, QA, RO, RS, RU, RW, SC, SD, SE, SG, SK, SL, SM, ST, SV, SY, TH, TJ, TM, TN, TR, TT, TZ, UA, UG, US, UZ, VC, VN, ZA, ZM, ZW.

(84) Designated States (unless otherwise indicated, for every kind of regional protection available): ARIPO (BW, GH, GM, KE, LR, LS, MW, MZ, NA, RW, SD, SL, SZ, TZ, UG, ZM, ZW), Eurasian (AM, AZ, BY, KG, KZ, RU, TJ, TM), European (AL, AT, BE, BG, CH, CY, CZ, DE, DK, EE, ES, FI, FR, GB, GR, HR, HU, IE, IS, IT, LT, LU, LV, MC, MK, MT, NL, NO, PL, PT, RO, RS, SE, SI, SK, SM, TR), OAPI (BF, BJ, CF, CG, CI, CM, GA, GN, GQ, GW, ML, MR, NE, SN, TD, TG).

**Published:**

- with international search report (Art. 21(3))
- before the expiration of the time limit for amending the claims and to be republished in the event of receipt of amendments (Rule 48.2(h))
- with information concerning request for restoration of the right of priority in respect of one or more priority claims (Rules 26bis.3 and 48.2(b)(vii))

(54) Title: CUTTING TOOL WITH INTERNAL FLUID DELIVERY SYSTEM

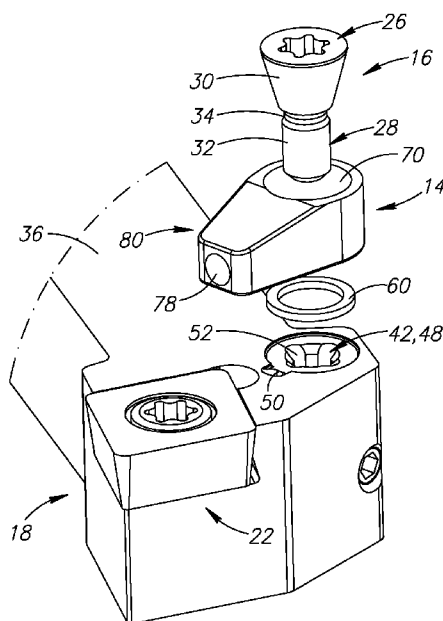

FIG. 2

(57) Abstract: A cutting tool has an internal cutting tool fluid delivery system. The cutting tool has a tool body and a fluid delivery head coupled thereto by a solid coupling member with a continuous male thread. The tool body includes a body coupling bore and the head includes a head coupling bore which communicates with the body coupling bore. At least one of the body and head coupling bores includes a circumferentially interrupted female thread which has a longitudinal thread axis and a radial outer thread boundary. The or each coupling bore having the female thread includes a thread passage which extends along the thread axis. In an axial cross section of the female thread, the thread passage extends both inside and outside the radial outer thread boundary.

## CUTTING TOOL WITH INTERNAL FLUID DELIVERY SYSTEM

### FIELD OF THE INVENTION

5

[001] The subject matter of the present application relates to cutting tools having built-in fluid delivery systems.

10

### BACKGROUND OF THE INVENTION

[002] Cutting tools of the field are known and disclosed, for example, in US5340242, which discloses a cutting tool delivery system which utilizes a hollow screw for clamping and delivering fluid internally.

15

### SUMMARY OF THE INVENTION

[003] The subject matter of the present application relates to a cutting tool having an internal cutting tool fluid delivery system. The cutting tool includes a tool body to which a fluid delivery head is coupled by a solid coupling member which has a continuous male thread. At least one of the tool body and the fluid delivery head has a coupling bore provided with a circumferentially interrupted female thread which has a thread axis and is designed to engage the male thread. The or each coupling bore provided with the female thread is in communication with a thread passage which extends along the thread axis and interrupts the female thread in the circumferential direction. In the radial direction relative to the bore axis, the thread passage extends both inside and outside a radial outer boundary of the female thread. A possible advantage of such a delivery mechanism is that it is compact and therefore allows integrating such a system in very small cutting tools.

[004] In accordance with the subject matter of the present application there is provided a cutting tool having an internal fluid delivery system. The cutting tool comprises a tool body and a fluid delivery head coupled thereto by a solid coupling member which has a continuous male thread;

the tool body comprises a body coupling bore;  
the fluid delivery head comprises a head coupling bore which communicates with  
the body bore;

35

WO 2013/124859

PCT/IL2013/050221

at least one of the body coupling bore and head coupling bore comprises a circumferentially interrupted female thread with a longitudinal thread axis and a radial outer thread boundary,

wherein

- 5        the female thread comprises a thread passage which extends along the thread axis and is configured only to convey fluid, and

in an axial cross section of the female thread, the thread passage extends both inside and outside the radial outer thread boundary.

- [005] Any of the following features, either alone or in combination, may be applicable to  
10 any of the above aspects of the subject matter of the application:

[006] In an axial cross section of the female thread, the outer thread boundary can lie in a circle defined by an outer thread diameter about the thread axis.

[007] The female thread can have a cylindrical shape.

[008] The thread passage can be a groove.

- 15 [009] The thread passage can extend along the entire length of the female thread.

[0010] Optionally, only the body bore comprises the female thread.

[0011] The head and the body respectively comprise head and body passages, each of which communicates with the thread passage.

- [0012] The coupling member can include a coupling head peripheral surface which seals a  
20 portion of the head passage.

[0013] Adjacent the body bore, the body comprises a cutting portion which comprises a pocket and a cutting insert releasably secured therein.

[0014] The coupling member can be a screw, which passes through the head bore and is screw-threaded into the female thread.

- 25 [0015] The tool body can comprise a washer which includes an inner washer diameter which is greater than a limit diameter which is defined by a radially outer-most portion of the thread passage at an outer bore end.

### BRIEF DESCRIPTION OF THE DRAWINGS

- 30 [0016] For a better understanding of the subject matter of the present application and to show how the same may be carried out in practice, reference will now be made to the accompanying drawings, in which:

WO 2013/124859

PCT/IL2013/050221

Fig. 1 is an isometric view of a cutting tool;

Fig. 2 is an isometric exploded view of the cutting tool of Fig. 1;

Fig. 3 is a plan view of the cutting tool of Fig. 1;

Fig. 4 is a cross sectional view taken along line IV-IV of Fig. 3, which passes through  
5 thread passages of the cutting tool;

Fig. 5 is a cross sectional view taken along line V-V of Fig. 3 which passes through a  
female thread of the cutting tool;

Fig. 6 is a top plan view of the cutting tool of Fig. 1 with a head and coupling member  
removed;

10 Fig. 7 is a detail view of the cutting tool indicated by line VII in Fig. 6;

Fig. 8 is a cross sectional view taken along line VIII-VIII of Fig. 4;

Fig. 9 is a detail view of the cutting tool indicated by line IX in Fig. 8;

[0017] Where considered appropriate, reference numerals may be repeated among the  
15 figures to indicate corresponding or analogous elements.

## DETAILED DESCRIPTION OF THE INVENTION

20 [0018] In the following description, various aspects of the subject matter of the present  
application will be described. For purposes of explanation, specific configurations and details  
are set forth in sufficient detail to provide a thorough understanding of the subject matter of  
the present application. However, it will also be apparent to one skilled in the art that the  
25 subject matter of the present application can be practiced without the specific configurations  
and details presented herein.

[0019] Reference is made to Figs. 1 and 2. A cutting tool 10 includes a tool body 12 and a  
fluid delivery head 14 mounted thereto by a threaded coupling member 16. The cutting tool  
10 can be a compact cutting tool 10 which includes an internal fluid delivery system 13. The  
30 fluid delivery system 13 can be used to deliver cooling fluid at pressures as high as 300Bar.

[0020] The cutting tool 10 includes a cutting portion 18 which can be located at a body front  
end 20. The cutting portion 18 can include a pocket 22 and a cutting insert 24 releasably  
secured therein. The cutting insert 24 can be secured in the pocket 22 via a screw, which can  
differ from the coupling member 16.

[0021] The coupling member 16 can include a coupling head 26 and a coupling body 28 which extends therefrom. The coupling head 26 has a coupling head peripheral surface 30 which can have a conical shape. The coupling body 28 includes a continuous male thread 32. The male thread 32 can have a generally cylindrical shape, and inner and outer male thread diameters **M1**, **M2**. The coupling member 16 can include a narrow portion 34, which is located axially between the coupling head 26 and coupling body 28. Aside from the continuous male thread 32, the coupling member 16 is solid, or has a solid construction. The word solid is used in the sense that the coupling member 16 is devoid of cavities, apertures or grooves. Specifically, the male thread 32 is devoid of any longitudinal grooves or holes. The coupling member 16 is therefore not configured to, and cannot, convey fluid internally. According to the present example, the coupling member 16 is a screw.

[0022] The tool body 12 can be elongated, and it can have a longitudinal body axis **A**. The tool body 12 can include a body peripheral surface 36 which extends rearwardly from the body front end 20. The body peripheral surface 36 can have a generally rectangular axial cross section and body top and bottom surfaces 38, 40. According to the present example, the tool body 12 can include a blind body coupling bore 42 and a body fluid passage 44. The body coupling bore 42 has inner and outer body bore ends 46, 48. The body coupling bore 42 can open out to the body peripheral surface 36 at the outer body bore end 48, and can communicate with the body fluid passage 44 at the inner body bore end 46. The body fluid passage 44 can extend rearwardly from the inner body bore end 46 along the body axis **A**. The tool body 12 can include a blind locating bore 50 which can open out to the body peripheral surface 36 adjacent the body coupling bore 42.

[0023] In the figures, the body coupling bore 42 and the cutting portion 18 are integrally formed together in a tool body 12 having unitary one-piece construction, with the body coupling bore 42 located adjacent to the cutting portion 18. It is also possible in other embodiments for the tool body to have the body coupling bore 42 and the cutting portion 18 formed on separate pieces which are then brought together so that, again, the body coupling bore 42 is located adjacent to the cutting portion 18.

[0024] The body coupling bore 42 has a longitudinal body bore axis **B**. According to the present example, the body coupling bore 42 includes a female thread 52 which is configured to threadingly engage the male thread 32 of the coupling member 16. The female thread 52 has a thread axis **C** and inner and outer female thread diameters **D1**, **D2** (as shown in Fig. 7). The thread and body bore axes **C**, **B** can be coaxial. In each cross section of the female thread

52 along the thread axis **C**, the inner and outer female thread diameters **D1**, **D2** can define radial inner and outer thread boundaries 54, 56 of the female thread 52. When proceeding along the thread axis **C**, the inner and outer female thread diameters **D1**, **D2** can be constant. In other words, the female thread 52, and therefore the inner and outer thread boundaries 54, 56, can have a generally circular cylindrical shape.

[0025] Attention is drawn to Figs. 4, 7 and 9. According to the present example, the body coupling bore 42 which has the female thread 52 includes four thread passages 58, each of which has a longitudinal passage axis **E**. The longitudinal passage axis **E** can be generally parallel to thread axis **C**, though this is not a firm requirement. Also, the number of thread passages 58 is not limited to four. The thread passages 58 can be formed as longitudinal grooves in the tool body 12 which interrupt the female thread 52. Thus, the body coupling bore 42 comprising the female thread 52 is in communication with the thread passages 58 which extend along the thread axis **C** and interrupt the female thread 52 as the latter winds in the circumferential direction. This results in the body coupling bore 42 having a circumferentially interrupted female thread 52.

[0026] Each thread passage 58 can open out to the body peripheral surface 36 at the outer body bore end 48, and extend inwardly therefrom, along the thread axis **C**. Each thread passage 58 can extend along the entire length of the body coupling bore 42. Each thread passage 58 can extend along the entire length of the female thread 52. At the inner body bore end 46, each thread passage 58 can communicate with the body fluid passage 44.

[0027] In a radial direction, perpendicular to the thread axis **C**, each thread passage 58 is formed partially in the female thread 52, and partially in the tool body 12, outside of the female thread 52. In other words, in any axial cross sectional view of the female thread 52 along the thread axis **C**, each thread passage 58 is formed both inwards and outwards of the outer thread boundary 56. In any axial cross sectional view, an outer most point of any of the thread passages 58 defines a limit diameter **D3** perpendicular to the thread axis **C**. The limit diameter **D3** is greater than the outer female thread diameter **D2**. According to the present example, in each cross sectional view of the female thread 52 along the thread axis **C**, each thread passage 58 can be formed between a circle defined by the inner female thread diameter **D1** and a circle defined by the limit diameter **D3**. In an axial view along each passage axis **E**, each thread passage 58 can have a concavely curved cross section.

[0028] In accordance with the present example, at the outer body bore end 48, the cutting tool 10 can include a washer 60. The washer 60 has inner and outer washer diameters **D4**,

WO 2013/124859

PCT/IL2013/050221

**D5.** The inner washer diameter **D4** can be equal to, or greater than, the limit diameter **D3**. In an assembled position, when the fluid delivery head 14 is mounted on the tool body 12, the washer 60 can function as a seal, which prevents fluid from leaking out between the tool body 12 and the fluid delivery head 14. In the case of thread passages 58 which are unevenly  
 5 circumferentially distributed around the body coupling bore 42, or in the case of an odd number of thread passages 58, the limit diameter **D3** may more appropriately be established with reference to a limit radius **R3**, due to the absence of diametrically opposite thread passages 58.

[0029] According to the present application, the fluid delivery head 14 includes opposing  
 10 head top and bottom surfaces 62, 64 and a head peripheral surface 66 which extends therebetween. The fluid delivery head 14 can include a locating pin 68 which extends from the head bottom surface 64. The fluid delivery head 14 can include a through head coupling bore 70 which has a head bore axis **F** and can open out to the head top and bottom surfaces 62, 64. The fluid delivery head 14 includes a fluid conveying head passage 72. The head  
 15 passage 72 can include a first passage portion 74 which can open out to the head peripheral surface 66 at a discharge opening 78, at a head front end 80. The head passage 72 can include a second passage portion 76, which opens out to the head bottom surface 64 and can be formed as an integral part of the head coupling bore 70. Stated differently, in this non-limiting example, the head passage 72 can include a longitudinal groove formed along the  
 20 head bore axis **F** in the head coupling bore 70, which can open out inwards.

[0030] According to the present application, the coupling head peripheral surface 30 forms a part of the head passage 72. In other words, a portion of the coupling head peripheral surface 30 seals, or completes, an intersection between the first and second passage portions 74, 76 of the head passage 72. The coupling head 26 has a dual function, in the sense that it seals the  
 25 intersection in the head passage 72 and also couples the fluid delivery head 14 to the tool body 12. The unification of functions is intended to help make the fluid delivery head 14, and consequently the cutting tool 10, as small as possible.

[0031] According to the present application, in the assembled position, the fluid delivery head 14 is coupled to the tool body 12, such that the head coupling bore 70 can communicate  
 30 with the body coupling bore 42 and the thread passages 58 can communicate with the head passage 72. The head bottom surface 64 can abut the body peripheral surface 36, such as at the head top surface 38. The coupling member 16 is located in the head coupling bore 70 and



threadingly engaged to the female thread 52 in the body coupling bore 42. The locating pin 68 is located in the locating bore 50.

[0032] Attention is drawn to Figs. 4 and 9. When the cutting tool 10 is in the assembled position and is operative, i.e. machines a workpiece, fluid (e.g. coolant) is pumped through the body fluid passage 44 towards the body coupling bore 42. The fluid then splits into multiple fluid paths, each of which passes through one of the thread passages 58, between the outer male thread diameter **M2** and the limit diameter **D3**. Thus, fluid in each of the multiple fluid paths travels past the coupling member's male thread 32 rather than passing through the coupling member 16. The fluid then passes, through the washer 60, to the second passage portion 76 in the head coupling bore 70. In this example, the multiple fluid paths exit the four thread passages 58 and reunite between the inner washer diameter **D4** and the narrow portion 34 of the coupling member 16. In the head coupling bore 70, the fluid then passes through the second passage portion 76 alongside the coupling member 16. The fluid is then directed to the first passage portion 74, at least partially by the coupling head peripheral surface 30, and passes further through the first passage portion 74 which opens out to the discharge opening 78. The fluid is thus directed towards the adjacent cutting portion 18 where, during cutting operations, the fluid stream will hit and help break off chips that are being formed.

[0033] A maximum height of the tool can be measured between the body bottom surface 40 and an upper-most portion of the fluid delivery head 14 or the coupling head 26. In some cutting machines, there is a height limitation. One example, where minimal size is advantageous, is when cutting tools are stacked one on top of the other, in a machine turret. In such cases, a maximum height of the cutting tool is often defined, such that cutting tools with conventional fluid delivery systems simply can't fit in the turret.

[0034] A possible advantage of the present fluid delivery system is that it is integrated into the body and head coupling bores 42, 70, and therefore takes up very little space in the cutting tool 10 relative to other internal fluid delivery systems. In other words, a thread passage 58 which is integrated into the female thread 52 helps reduce the overall size of the cutting tool 10. This is achieved due to the fact that fluid is delivered roughly in the same location as, or integrated into, the coupling mechanism. The overall axial cross section area of the cutting tool 10 is therefore minimized, when compared, e.g., to an external fluid delivery system, or to an internal fluid delivery system, in which the fluid passages are separate from the female thread 52. Consequently, smaller cutting tools with internal fluid delivery systems can be

WO 2013/124859

PCT/IL2013/050221

produced. For example, if the female thread 52 and the fluid passage are spaced apart from each other, a stronger, and therefore bigger, screw is required in order to couple the fluid delivery head 14 onto the tool body 12. It should be mentioned that, for example, in order to achieve a well-sealed passage at high pressure, the coupling forces must be respectively  
5 larger.

[0035] As previously mentioned, the screw couples the fluid delivery head 14 to the tool body 12, and at the same time, functions as part of the fluid delivery system, by sealing a portion of the head passage 72. It is therefore important that, within the size limitations of the cutting tool, a screw with the strongest possible structure is chosen.

10 [0036] A possible advantage of the location of the thread passages 58 (i.e., located only partially in the female thread 52) is that the coupling member 16 can remain solid, or otherwise unaltered. For example, screws which are used for delivering fluid can be hollow, and have a core passage and radial holes which connect with the core passage. In these cases, the radial holes may require an expensive, specifically designed orientation of thread, in order  
15 to align the radial holes with a respective passage in the receiving female counterpart upon tightening of the screw. In other cases, the male thread 32 of the screw may include external grooves. In any case, screws with external grooves and/or axial or radial holes are considerably weaker relative to unaltered screws of the same kind. Consequently, compromises must be made, such as delivering fluid at lower pressure (due to weaker  
20 coupling/sealing forces applied by a weaker screw) or choosing larger screws, therefore compromising on the size.

[0037] Another possible advantage of the location of the thread passage 58 is the ease of production. In order to produce the thread passage 58 it is only necessary to machine a simple groove in the female thread 52.

25 [0038] According to the present application, the thread passages 58 can be distributed about the thread axis C, in order to take up as little room as possible in the cutting tool 10. The thread passages can be evenly distributed 58 about the thread axis C.

[0039] The description above includes exemplary embodiments and details for enablement, if needed, of claimed subject matter, and does not exclude non-exemplified embodiments and  
30 details from the claim scope of the present application.

## CLAIMS

1. A cutting tool having a fluid delivery system, comprising a tool body and a fluid delivery head coupled thereto by a solid coupling member having a continuous male thread,  
the tool body comprising a body coupling bore,  
the fluid delivery head comprising a head coupling bore communicating with the body coupling bore,  
at least one of the body coupling bore and head coupling bore comprising a circumferentially interrupted female thread having a longitudinal thread axis (C) and a radial outer thread boundary,  
wherein  
the or each coupling bore comprising a female thread is in communication with a thread passage which extends along the thread axis (C) and interrupts the female thread in the circumferential direction, and  
in an axial cross section of the female thread, the thread passage extends both inside and outside the radial outer thread boundary.
2. The cutting tool according to claim 1, wherein in an axial cross section of the female thread, the outer thread boundary lies in a circle defined by an outer thread diameter about the thread axis (C).
3. The cutting tool according to claim 1, wherein the female thread has a circular cylindrical shape.
4. The cutting tool according to claim 1, wherein the thread passage is a groove.
5. The cutting tool according to claim 1, wherein the thread passage extends along the entire length of the female thread.
6. The cutting tool according to claim 1, wherein only the body coupling bore comprises the female thread.

7. The cutting tool according to claim 1, wherein the fluid delivery head and the tool body respectively comprise head and body fluid passages, each of which communicates with the thread passage.
8. The cutting tool according to claim 7, wherein the coupling member comprises a coupling head peripheral surface which seals a portion of the head passage.
9. The cutting tool according to claim 1, wherein adjacent the body coupling bore, the tool body comprises a cutting portion which comprises a pocket and a cutting insert releasably secured therein.
10. The cutting tool according to claim 9, wherein the coupling member is a screw, which passes through the head coupling bore and is screw-threaded into the female thread.
11. The cutting tool according to claim 1, further comprising:
  - a washer interposed between the tool body at an outer bore end of the body coupling bore, and the fluid delivery head; wherein:
    - the washer has an inner washer diameter which is greater than a limit diameter defined by a radially outer-most portion of the thread passage at the outer bore end.
12. A method of supplying coolant fluid in a cutting tool comprising:
  - a tool body comprising a cutting portion and a body coupling bore having a bore axis (B);
  - a fluid delivery head coupled to the tool body by a coupling member, the head coupling bore communicating with the body coupling bore; and
  - a body passage formed in the tool body and in fluid communication with the body coupling bore;the method comprising:
  - pumping coolant through the body fluid passage into the body coupling bore;
  - splitting the coolant into multiple fluid paths, each of which travels past the coupling member and none of which travel through the coupling member;
  - reuniting the multiple fluid paths in the fluid delivery head; and

after reuniting the multiple fluid paths, directing the coolant in the direction of the cutting portion.

1/3

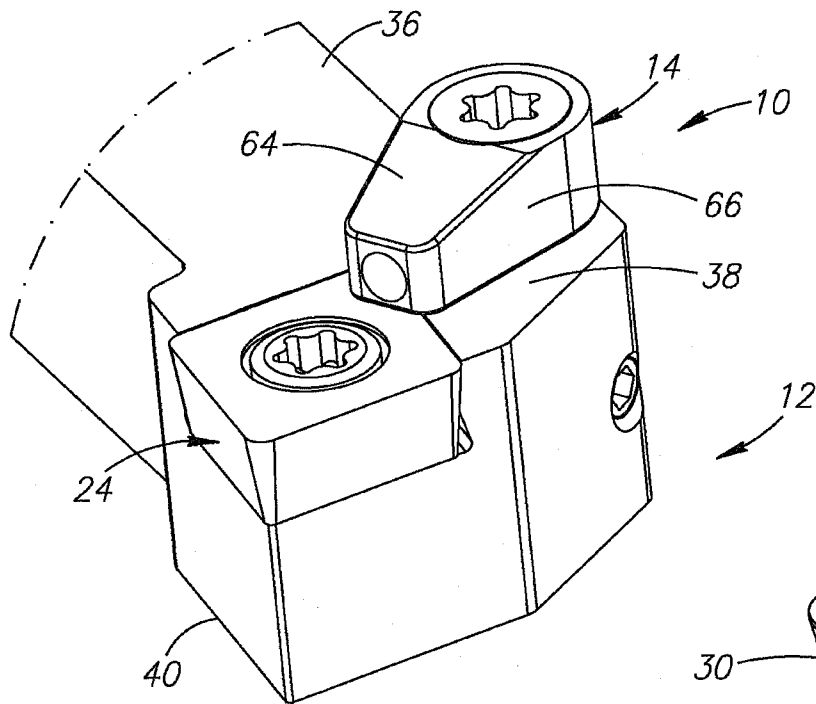

FIG. 1

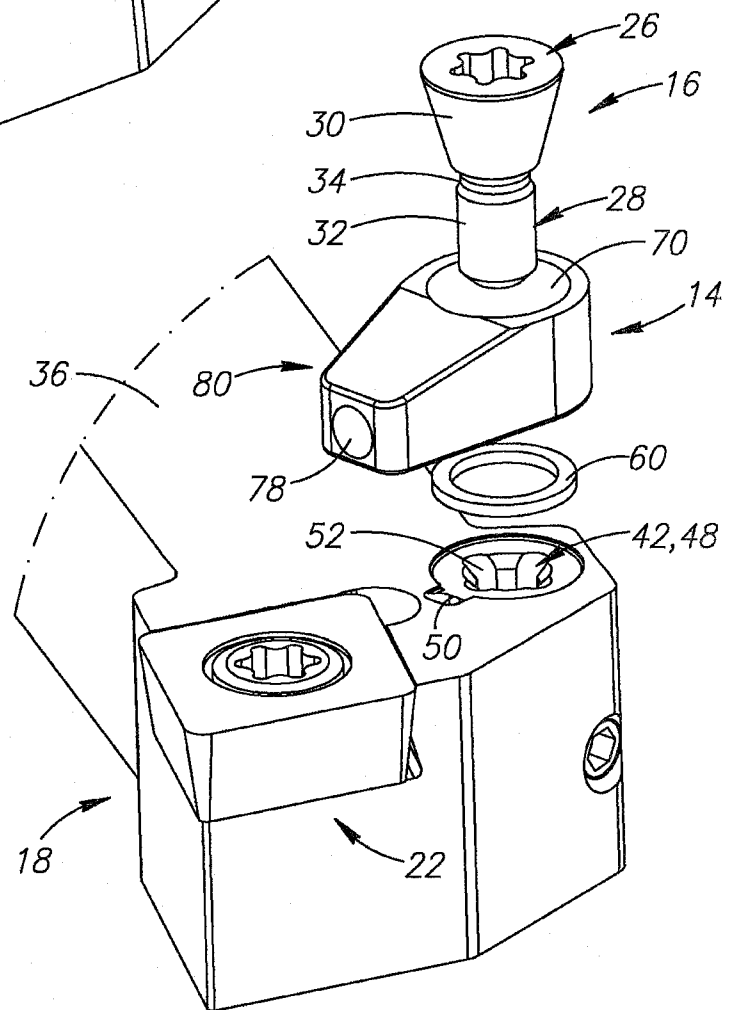
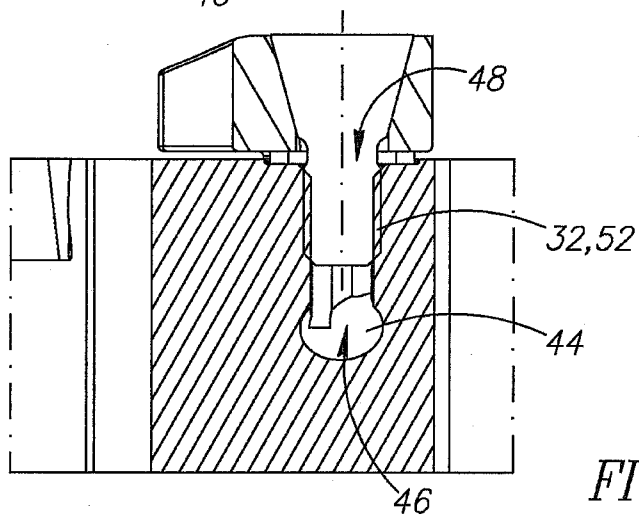
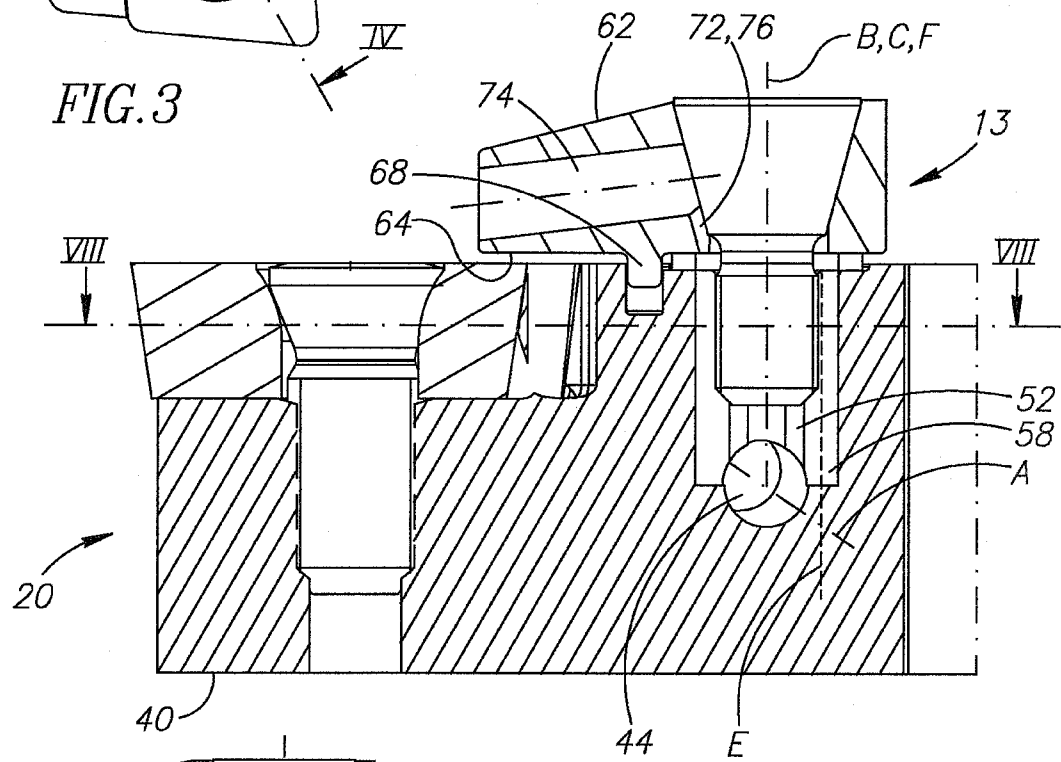
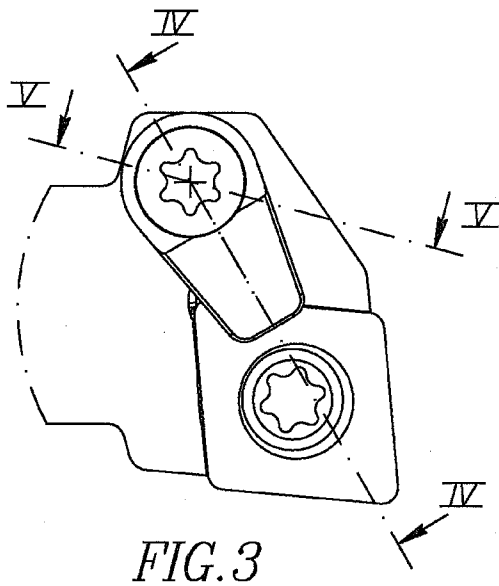

FIG. 2

2/3



3/3

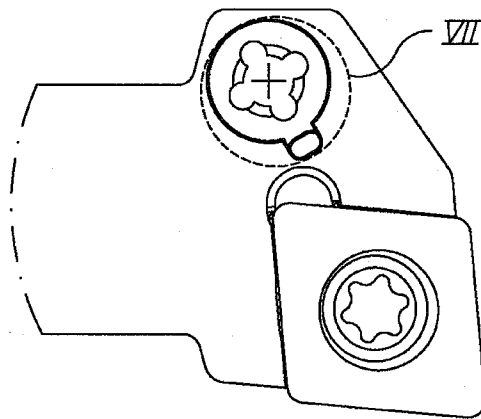

FIG. 6

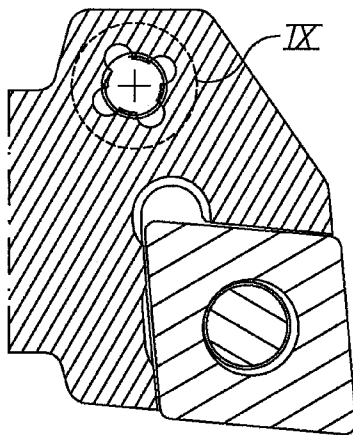

FIG. 8

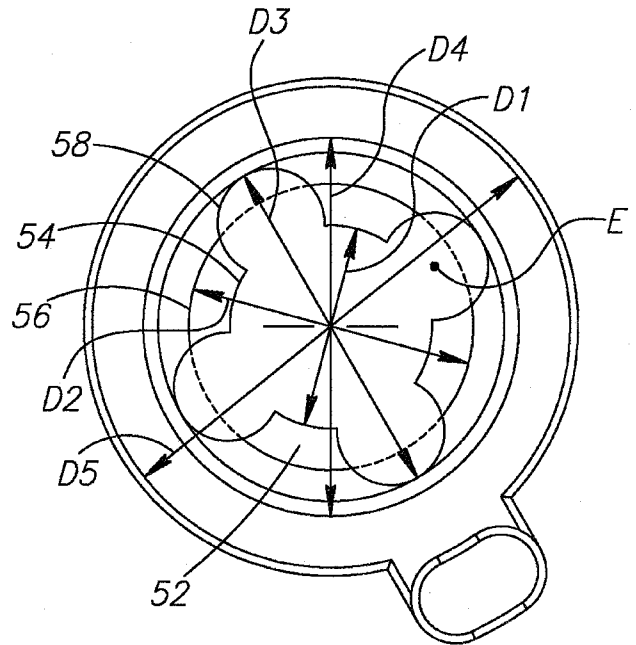

FIG. 7

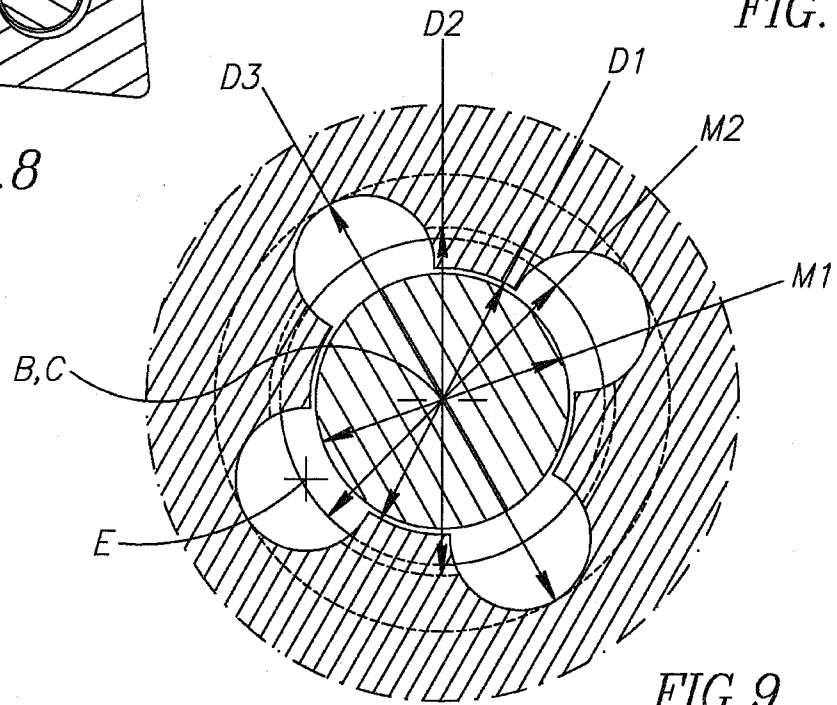

FIG. 9



