



- (51) **International Patent Classification:**  
A61C 17/02 (2006.01)
- (21) **International Application Number:**  
PCT/US20 12/067 165
- (22) **International Filing Date:**  
30 November 2012 (30.11.2012)
- (25) **Filing Language:** English
- (26) **Publication Language:** English
- (30) **Priority Data:**  
13/3 14,263 8 December 2011 (08.12.2011) US
- (71) **Applicant:** MCNEIL-PPC, INC. [US/US]; 199 Grandview Road, Skillman, New Jersey 08558 (US).
- (72) **Inventors:** FOUGERE, Richard J.; 61 Hessian Run Road, Washington Crossing, Pennsylvania 18977 (US). FUSI, Robert W., II; 9 Sutton Farm Road, Flemington, New Jersey 08822 (US). MCDONOUGH, Justin E.; 11 Cider Mill Circle, Flemington, New Jersey 08822 (US).
- (74) **Agents:** JOHNSON, Philip S. et al; Johnson & Johnson, One Johnson & Johnson Plaza, New Brunswick, New Jersey 08933 (US).
- (81) **Designated States** (*unless otherwise indicated, for every kind of national protection available*): AE, AG, AL, AM, AO, AT, AU, AZ, BA, BB, BG, BH, BN, BR, BW, BY, BZ, CA, CH, CL, CN, CO, CR, CU, CZ, DE, DK, DM,

DO, DZ, EC, EE, EG, ES, FI, GB, GD, GE, GH, GM, GT, HN, HR, HU, ID, IL, IN, IS, JP, KE, KG, KM, KN, KP, KR, KZ, LA, LC, LK, LR, LS, LT, LU, LY, MA, MD, ME, MG, MK, MN, MW, MX, MY, MZ, NA, NG, NI, NO, NZ, OM, PA, PE, PG, PH, PL, PT, QA, RO, RS, RU, RW, SC, SD, SE, SG, SK, SL, SM, ST, SV, SY, TH, TJ, TM, TN, TR, TT, TZ, UA, UG, US, UZ, VC, VN, ZA, ZM, ZW.

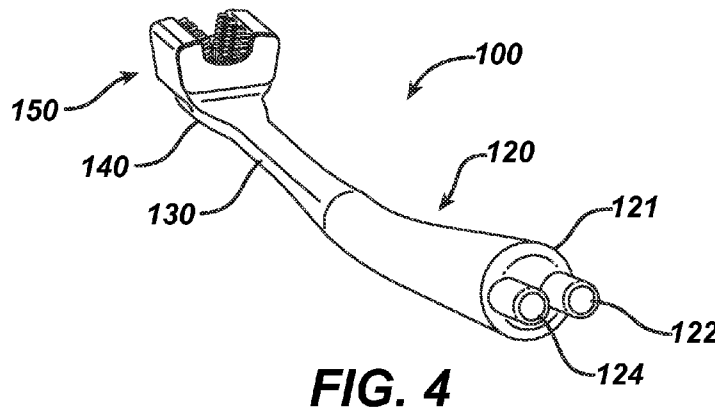
- (84) **Designated States** (*unless otherwise indicated, for every kind of regional protection available*): ARIPO (BW, GH, GM, KE, LR, LS, MW, MZ, NA, RW, SD, SL, SZ, TZ, UG, ZM, ZW), Eurasian (AM, AZ, BY, KG, KZ, RU, TJ, TM), European (AL, AT, BE, BG, CH, CY, CZ, DE, DK, EE, ES, FI, FR, GB, GR, HR, HU, IE, IS, IT, LT, LU, LV, MC, MK, MT, NL, NO, PL, PT, RO, RS, SE, SI, SK, SM, TR), OAPI (BF, BJ, CF, CG, CI, CM, GA, GN, GQ, GW, ML, MR, NE, SN, TD, TG).

**Declarations under Rule 4.17:**

- as to the identity of the inventor (Rule 4.1 7(i))
- as to applicant's entitlement to apply for and be granted a patent (Rule 4.1 7(H))
- as to the applicant's entitlement to claim the priority of the earlier application (Rule 4.1 7(in))

[Continued on nextpage]

- (54) **Title:** ORAL CARE CLEANING AND TREATING DEVICE



**FIG. 4**

(57) **Abstract:** A device for directing a liquid onto a plurality of surfaces of the oral cavity, the device including a handle, a neck, and a head, where the head includes a cleaning component including a chamber for maintaining the liquid proximate the surfaces, where the chamber is defined by front and rear sealing membranes, inner side walls and a base inner wall, and where the inner side walls each include a plurality of openings, the device further including a first manifold and a second manifold, a first port and a second port for conveying liquid; and means for providing an effective seal of the device within the oral cavity.



**Published:**

- *without international search report and to be republished upon receipt of that report (Rule 48.2(g))*

## ORAL CARE CLEANING AND TREATING DEVICE

This application is a continuation-in-part of US application 12/844,875, filed July 28, 2010, a continuation-in-part of US application 12/844,879, filed July 28, 2010, a continuation-in-part  
5 of US application 12/844,883, filed July 28, 2010, and a continuation-in-part of US application 12/844,885, filed July 28, 2010, which claim the benefit of US provisional application 61/229,839 filed July 30, 2009, the complete disclosures each of which are hereby incorporated herein by reference for all purposes.

### FIELD OF THE INVENTION

10 The present invention relates to oral care devices suitable for in-home use to provide a beneficial effect to the oral cavity of a mammal.

### BACKGROUND OF THE INVENTION

In addition to regular professional dental checkups, daily oral hygiene is generally recognized  
15 as an effective preventative measure against the onset, development, and/or exacerbation of periodontal disease, gingivitis and/or tooth decay. Unfortunately, however, even the most meticulous individuals dedicated to thorough brushing and flossing practices often fail to reach, loosen and remove deep-gum and/or deep inter-dental food particulate, plaque or biofilm. Most individuals have professional dental cleanings biannually to remove tarter  
20 deposits.

For many years products have been devised to facilitate the simple home cleaning of teeth, although as yet a single device which is simple to use and cleans all surfaces of a tooth and/or the gingival or sub-gingival areas simultaneously is not available. The conventional toothbrush is widely utilized, although it requires a significant input of energy to be effective  
25 and, furthermore, a conventional toothbrush cannot adequately clean the inter-proximal areas of the teeth. Cleaning of the areas between teeth currently requires the use of floss, pick, or some such other additional device apart from a toothbrush.

Electric toothbrushes have achieved significant popularity and, although these reduce the energy input required to utilize a toothbrush, they are still inadequate to ensure proper inter-  
30 proximal tooth cleaning. Oral irrigators are known to clean the inter-proximal area between

teeth. However, such devices have a single jet which must be directed at the precise inter-proximal area involved in order to remove debris. These water pump type cleaners are therefore typically only of significant value in connection with teeth having braces thereupon which often trap large particles of food. It will be appreciated that if both debris and plaque are to be removed from teeth, at present a combination of a number of devices must be used, which is extremely time consuming and inconvenient.

In addition, in order for such practices and devices to be effective, a high level of consumer compliance with techniques and/or instructions is required. The user-to-user variation in time, cleaning/treating formula, technique, etc., will affect the cleaning of the teeth.

The present invention ameliorates one or more of the above mentioned disadvantages with existing oral hygiene apparatus and methods, or at least provides an alternative technology that is advantageous over known technology, and also may be used to ameliorate a detrimental condition or to improve cosmetic appearance of the oral cavity.

## SUMMARY OF THE INVENTION

The invention is a device for directing a liquid onto a plurality of surfaces of the oral cavity of a mammal, the device including a handle, a neck and a head. The handle includes first and second ports located at the proximal end thereof for receiving the liquid from the liquid source, and first and second channels connected to the ports and running longitudinally through the handle for transporting the liquid through the handle to the neck of the device. The neck includes the first and second channels for transporting the liquid through the neck to the head. The head includes a cleaning component comprising a chamber for maintaining the liquid proximate the plurality of surfaces, where the internal space or volume of the chamber is defined and bounded by proximal and distal sealing membranes, first and second inner side walls extending longitudinally between the first and second sealing membranes, and a base inner wall extending horizontally between the first and second inner side walls and longitudinally between the proximal and distal sealing membranes. The inner side walls each include a plurality of openings through which liquid is directed onto the surfaces of the oral cavity. The device further includes a first manifold for containing a first portion of the liquid and providing the first portion to the chamber through the openings of the first inner side wall and a second manifold for containing a second portion of the liquid and providing the second

portion to the chamber through the openings of the second inner side wall. The device further includes a first port for conveying the first portion of liquid to and from the first manifold, a second port for conveying the second portion of liquid to and from the second manifold; and means for providing an effective seal of the device within the oral cavity.

5

### BRIEF DESCRIPTION OF THE DRAWINGS

FIG. 1 is a schematic drawing of one embodiment of a system using a device according to the present invention;

FIG. 2 is a schematic drawing of an alternative embodiment of a system using a device  
10 according to the present invention;

FIG. 3a is a perspective drawing of an embodiment of a reciprocating flow controller;

FIG. 3b is an exploded view of the reciprocating flow controller of FIG 3a;

FIG. 3c is a top view of the reciprocating flow controller of FIG 3a in its first position;

FIG. 3d is a top view of the reciprocating flow controller of FIG 3a in its second position;

15 FIG. 4 is a right side front perspective view of a first embodiment of an applicator device according to the present invention;

FIG. 5 is a top view of the embodiment of the device of FIG. 4;

FIG. 6 is a side view of the embodiment of the device of FIG. 4;

FIG. 7 is a side view of the head portion of the embodiment of the device of FIG. 4;

20 FIG. 8 is a horizontal sectional view of FIG. 7;

FIG. 9 is a top view of the head portion of the embodiment of the device of FIG. 4;

FIG. 10 is a vertical sectional view of FIG. 9 along the 10—10 plane;

FIG. 11 is a vertical sectional view of FIG. 9 along the 11—11 plane;

25 FIG. 12 is a right side front perspective view of a second embodiment of the neck and head of an applicator device according to the present invention;

- FIG. 13 is a vertical sectional view of FIG. 12 along the 13—13 plane;
- FIG. 14 is a side view of the neck and head of a third embodiment of an applicator device according to the present invention;
- FIG. 15 is a horizontal sectional view of FIG. 14 along the 15—15 plane;
- 5 FIG. 16 is a horizontal sectional view of FIG. 14 along the 16—16 plane;
- FIG. 17 is a top view of the head portion of the embodiment of the device of FIG. 14;
- FIG. 18 is a vertical sectional view of FIG. 17 along the 18—18 plane;
- FIG. 19 is an end view of the head portion of the embodiment of the device of FIG. 14;
- FIG. 20 is a vertical sectional view of FIG. 19 along the 20—20 plane;
- 10 FIG. 21 is a right side front perspective view of the neck and head of a fourth embodiment of an applicator device according to the present invention;
- FIG. 22 is a right side front exploded view of the embodiment of the device of FIG. 21;
- FIG. 23 is a left side bottom exploded view of the embodiment of the device of FIG. 21;
- FIG. 24 is a side view of the neck and head of the embodiment of the device of FIG. 21;
- 15 FIG. 25 is a horizontal sectional view of FIG. 21 along the 25—25 plane;
- FIG. 26 is a horizontal sectional view of FIG. 21 along the 26—26 plane;
- FIG. 27 is a vertical sectional view of FIG. 21 along the 27—27 plane; and
- FIG. 28 is a cut-away view of a base unit with which an applicator device of the present invention may be used.

20

### **DETAILED DESCRIPTION OF THE INVENTION**

The terms "fluid(s)" and "liquid(s)" are used interchangeably herein. As used herein, fluids or liquids may include gases or other particles and/or solids entrained therein.

The terms "reciprocating movement of liquid(s)" and "reciprocation of liquid(s)" are used interchangeably herein. As used herein, both terms mean alternating the direction of flow of the liquid(s) back and forth over surfaces of the oral cavity of a mammal from a first flow direction to a second flow direction that is opposite the first flow direction.

- 5 By "cleaning component", it is meant a component which cleans and/or treats teeth, gums and other oral tissue. By "cleaning fluid", it is meant a fluid which cleans and/or treats teeth, gums and other oral tissue.

By "effective fit or seal", it is meant that the level of sealing between the device for directing liquid onto and about the plurality of surfaces in the oral cavity is such that the amount of leakage of liquid from the device into the oral cavity during use is sufficiently low so as to reduce or minimize the amount of liquid used and to maintain comfort of the user, e.g. to avoid choking or gagging. Without intending to be limited, gagging is understood to be a reflex (i.e. not an intentional movement) muscular contraction of the back of the throat caused by stimulation of the back of the soft palate, the pharyngeal wall, the tonsillar area or base of tongue, meant to be a protective movement that prevents foreign objects from entering the pharynx and into the airway. There is variability in the gag reflex among individuals, e.g. what areas of the mouth stimulate it. In addition to the physical causes of gagging, there may be a psychological element to gagging, e.g. people who have a fear of choking may easily gag when something is placed in the mouth.

20 As used herein, "means for conveying liquid" includes structures through which liquid may travel or be transported throughout the systems and devices described herein and includes, without limitation passages, conduits, tubes, ports, portals, channels, lumens, pipes and manifolds. Such means for conveying liquids may be utilized in devices for providing reciprocation of liquids and devices for directing liquids onto and about surfaces of the oral cavity. Such conveying means also provides liquid to the device for directing liquids and provides liquid to the reciprocation means from a reservoir for containing liquid. The conveying means may also provide liquid from a base unit to a liquid reservoir contained within the device. Described herein are methods, devices and systems useful in providing a beneficial effect to an oral cavity of a mammal, e.g. a human.

30 Methods entail contacting a plurality of surfaces of the oral cavity with a liquid that is effective for providing the desired beneficial effect to the oral cavity. In such methods,

reciprocation of the liquid(s) over the plurality of surfaces of the oral cavity may be provided under conditions effective to provide the desired beneficial effect to the oral cavity. Contact of the plurality of surfaces to be contacted by the liquid may be conducted substantially simultaneous. By substantially simultaneous, it is meant that, while not all of the plurality of surfaces of the oral cavity to be contacted are necessarily contacted by the fluid at the same time, the majority of the surfaces to be contacted are contacted simultaneously, or within a short period of time.

The conditions for providing the desired beneficial effect in the oral cavity may vary depending on the particular environment, circumstances and effect being sought. The different variables are interdependent in that they create a specific velocity of the liquid. The velocity requirement may be a function of the formulation in some embodiments. For example, with change in the viscosity, additives, e.g. abrasives, shear thinning agents, etc., and general flow properties of the formulation, velocity requirements of the jets may change to produce the same level of efficacy. Factors which may be considered in order to provide the appropriate conditions for achieving the particular beneficial effect sought include, without limitation, the velocity and/or flow rate and/or pressure of the liquid stream, pulsation of the liquid, the spray geometry or spray pattern of the liquid, the temperature of the liquid and the frequency of the reciprocating cycle of the liquid.

The liquid pressures, i.e. manifold pressure just prior to exit through the jets, may be from about 0.5 psi to about 30 psi, or from about 3 to about 15 psi, or about 5 psi. Flow rate of liquid may be from about 15 ml/s to about 25 ml/s. It should be noted that the larger and higher quantity of the jets, the greater flow rate required at a given pressure/velocity. Pulse frequency (linked to pulse length and delivery (ml/pulse), may be from about 0.5 Hz to about 50 Hz, or from about 5 Hz to about 25 Hz. Delivery pulse duty cycle may be from about 10% to 100%, or from about 40% to about 60%. It is noted that at 100% there is no pulse, but instead a continuous flow of liquid. Delivery pulse volume (total volume through all jets/nozzles) may be from about 0.2 ml to about 120 ml, or from about 0.5 ml to about 15 ml. Velocity of jetted pulse may be from about 4 cm/s to about 400 cm/s, or from about 20 cm/s to about 160 in/s. Vacuum duty cycle may be from about 10% to 100%, or from about 50% to 100%. It is noted that vacuum is always on. Volumetric delivery to vacuum ratio may be from about 2:1 to about 1:20, or from about 1:1 to 1:10. Once having the benefit of this



disclosure, one skilled in the art will recognize that the various factors may be controlled and selected, depending on the particular circumstances and desired benefit sought.

The liquid(s) will include at least one ingredient, or agent, effective for providing the beneficial effect sought, in an amount effective to provide the beneficial effect when  
5 contacted with the surfaces of the oral cavity. For example, the liquid may include, without limitation, an ingredient selected from the group consisting of a cleaning agent, an antimicrobial agent, a mineralization agent, a desensitizing agent and a whitening agent. In certain embodiments, more than one liquid may be used in a single session. For example, a cleaning solution may be applied to the oral cavity, followed by a second solution containing,  
10 for example, a whitening agent or an antimicrobial agent. Solutions also may include a plurality of agents to accomplish more than one benefit with a single application. For example, the solution may include both a cleansing agent and an agent for ameliorating a detrimental condition, as further discussed below. In addition, a single solution may be effective to provide more than one beneficial effect to the oral cavity. For example, the  
15 solution may include a single agent that both cleans the oral cavity and acts as an antimicrobial, or that both cleans the oral cavity and whitens teeth.

Liquids useful for improving the cosmetic appearance of the oral cavity may include a whitening agent to whiten teeth in the cavity. Such whitening agents may include, without limitation, hydrogen peroxide and carbamide peroxide, or other agents capable of generating  
20 hydrogen peroxide when applied to the teeth. Such agents are well known within the art related to oral care whitening products such as rinses, toothpastes and whitening strips. Other whitening agents may include abrasives such as silica, sodium bicarbonate, alumina, apatites and bioglass.

It is noted that, while abrasives may serve to clean and/or whiten the teeth, certain of the  
25 abrasives also may serve to ameliorate hypersensitivity of the teeth caused by loss of enamel and exposure of the tubules in the teeth. For example, the particle size, e.g. diameter, of certain of the materials, e.g. bioglass, may be effective to block exposed tubules, thus reducing sensitivity of the teeth.

In some embodiments, the liquid may comprise an antimicrobial composition containing an  
30 alcohol having 3 to 6 carbon atoms. The liquid may be an antimicrobial mouthwash composition, particularly one having reduced ethanol content or being substantially free of

ethanol, providing a high level of efficacy in the prevention of plaque, gum disease and bad breath. Noted alcohols having 3 to 6 carbon atoms are aliphatic alcohols. A particularly aliphatic alcohol having 3 carbons is 1-propanol.

In one embodiment the liquid may comprise an antimicrobial composition comprising (a) an antimicrobial effective amount of thymol and one or more other essential oils, (b) from about 0.01% to about 70.0% v/v, or about 0.1% to about 30% v/v, or about 0.1% to about 10% v/v, or about 0.2% to about 8% v/v, of an alcohol having 3 to 6 carbon atoms and (c) a vehicle. The alcohol may be 1-propanol. The liquid vehicle can be aqueous or non-aqueous, and may include thickening agents or gelling agents to provide the compositions with a particular consistency. Water and water/ethanol mixtures are the preferred vehicle.

Another embodiment of the liquid is an antimicrobial composition comprising (a) an antimicrobial effective amount of an antimicrobial agent, (b) from about 0.01% to about 70% v/v, or about 0.1% to about 30% v/v, or about 0.2% to about 8% v/v, of propanol and (c) a vehicle. The antimicrobial composition of this embodiment exhibits unexpectedly superior delivery system kinetics compared to prior art ethanolic systems. Exemplary antimicrobial agents which may be employed include, without limitation, essential oils, cetyl pyridium chloride (CPC), chlorhexidine, hexetidine, chitosan, triclosan, domiphen bromide, stannous fluoride, soluble pyrophosphates, metal oxides including but not limited to zinc oxide, peppermint oil, sage oil, sanguinaria, dicalcium dihydrate, aloe vera, polyols, protease, lipase, amylase, and metal salts including but not limited to zinc citrate, and the like. A particularly preferred aspect of this embodiment is directed to an antimicrobial oral composition, e.g. a mouthwash having about 30% v/v or less, or about 10% v/v or less, or about 3% v/v or less, of 1-propanol.

Yet another embodiment of the liquid is a reduced ethanol, antimicrobial mouthwash composition which comprises (a) an antimicrobial effective amount of thymol and one or more other essential oils; (b) from about 0.01 to about 30.0% v/v, or about 0.1% to about 10%, v/v, or about 0.2% to about 8% v/v, of an alcohol having 3 to 6 carbon atoms; (c) ethanol in an amount of about 25% v/v or less; (d) at least one surfactant; and (e) water. Preferably the total concentration of ethanol and alcohol having 3 to 6 carbon atoms is no greater than 30% v/v, or no greater than 25% v/v, or no greater than 22% v/v.

In still another embodiment, the liquid is an ethanol-free antimicrobial mouthwash composition which comprises (a) an antimicrobial effective amount of thymol and one or more other essential oils; (b) from about 0.01% to about 30.0% v/v, or about 0.1% to about 10% v/v, or about 0.2% to about 8%, of an alcohol having 3 to 6 carbon atoms; (c) at least one surfactant; and (d) water.

The alcohol having 3 to 6 carbon atoms is preferably selected from the group consisting of 1-propanol, 2-propanol, 1-butanol, 2-butanol, tert-butanol and corresponding diols. 1-Propanol and 2-propanol are preferred, with 1-propanol being most preferred.

In addition to generally improving the oral hygiene of the oral cavity by cleaning, for example, removal or disruption of plaque build-up, food particles, biofilm, etc., the inventions are useful to ameliorate detrimental conditions within the oral cavity and to improve the cosmetic appearance of the oral cavity, for example whitening of the teeth. Detrimental conditions may include, without limitation, caries, gingivitis, inflammation, symptoms associated with periodontal disease, halitosis, sensitivity of the teeth and fungal infection. The liquids themselves may be in various forms, provided that they have the flow characteristics suitable for use in devices and methods of the present invention. For example, the liquids may be selected from the group consisting of solutions, emulsions and dispersions. In certain embodiments, the liquid may comprise a particulate, e.g. an abrasive, dispersed in a liquid phase, e.g. an aqueous phase. In such cases, the abrasive would be substantially homogeneously dispersed in the aqueous phase in order to be applied to the surfaces of the oral cavity. In other embodiments, an oil-in-water or water-in-oil emulsion may be used. In such cases, the liquid will comprise a discontinuous oil phase substantially homogeneously dispersed within a continuous aqueous phase, or a discontinuous aqueous phase substantially homogeneously dispersed in a continuous oil phase, as the case may be. In still other embodiments, the liquid may be a solution whereby the agent is dissolved in a carrier, or where the carrier itself may be considered as the agent for providing the desired beneficial effect, e.g., an alcohol or alcohol/water mixture, usually having other agents dissolved therein.

Disclosed herein are devices, e.g. oral care devices, for example a dental cleaning apparatus, suitable for in-home use and adapted to direct liquid onto a plurality of surfaces of a tooth and/or the gingival area, as well as methods and systems utilizing such devices. In certain embodiments, the surfaces of the oral cavity to be contacted are contacted by the liquid

substantially simultaneously. As used herein, reference to the gingival area includes, without limitation, reference to the sub-gingival pocket. The appropriate liquid may be directed onto a plurality of surfaces of teeth and/or gingival area substantially simultaneously in a reciprocating action under conditions effective to provide cleaning, and/or general  
5 improvement of the cosmetic appearance of the oral cavity and/or amelioration of a detrimental condition of the teeth and/or gingival area, thereby providing generally improved oral hygiene of teeth and/or gingival area. For example, one such device cleans teeth and/or the gingival area and removes plaque using an appropriate cleaning liquid by reciprocating the liquid back and forth over the front and back surfaces and inter-proximal areas of the  
10 teeth, thereby creating a cleaning cycle while minimizing the amount of cleaning liquid used.

Devices that provide reciprocation of the liquid comprise a means for controlling reciprocation of the liquid. The controlling means include means for conveying the liquid to and from the device for directing the liquid onto the plurality of surfaces of the oral cavity. In certain embodiments, the means for providing reciprocation of the liquid comprises a  
15 plurality of portals for receiving and discharging the liquid, a plurality of passages, or conduits, through which the liquid is conveyed, and means for changing the direction of flow of the liquid to provide reciprocation of the liquid, as described in more detail herein below. The controlling means may be controlled by a logic circuit and/or a mechanically controlled circuit.

20 In certain embodiments, devices for providing reciprocation may include a means for attaching or connecting the device to a reservoir for containing the liquid. The reservoir may be removably attached to the device. In this case, the reservoir and the device may comprise means for attaching one to the other. After completion of the process, the reservoir may be discarded and replaced with a different reservoir, or may be refilled and used again. In other  
25 embodiments, the reciprocating device will include a reservoir integral with the device. In embodiments where the device may be attached to a base unit, as described herein, the reservoir, whether integral with the device or removably attached to the device, may be refilled from a supply reservoir which forms a part of the base unit. Where a base unit is utilized, the device and the base unit will comprise means for attaching one to the other.

30 The device will comprise a power source for driving the means for reciprocating liquids. The power source may be contained within the device, e.g. in the handle of the device, for example, batteries, whether rechargeable or disposable. Where a base unit is employed, the

base may include means for providing power to the device. In other embodiments, the base unit may include means for recharging the rechargeable batteries contained within the device.

The device may also include a timer for cleaning sections of the teeth, gums, or oral cavity.

When the timer elapses, the device stops pumping as an indicator to move to the next section.

5 The power is then reinitiated by the user. This may minimize the potential that the user move the device off of the area being cleaned and/or treated during device operation.

Means for providing reciprocation of liquids will include means for attaching the reciprocating means to a device for directing the liquid onto the plurality of surfaces of the oral cavity, e.g. a liquid applicator according to the invention. In certain embodiments, the

10 applicator provides substantially simultaneous contact of the plurality of surfaces of the oral cavity by the liquid. The attachment means may provide removable attachment of the applicator to the device. The attachment means may be in the form of a quick disconnect structure. In such embodiments, multiple users may use their own applicator with a single reciprocating means. Devices for providing reciprocation as described above may be

15 contained within a housing also containing other device components so as to provide a device suitable for providing liquid to the applicator, as described herein below.

Devices for directing liquid onto the plurality of surfaces of the oral cavity according to the present invention, e.g. the liquid applicator, comprise a handle, a neck, and a head. It is noted that terms device for directing liquid, liquid applicator and liquid application device are used

20 interchangeably herein.

The handle of the liquid applicator includes first and second ports located at a proximal end of the handle for receiving the liquid from the source, whether it be from a base reservoir unit, or the reciprocation means. The ports may interface with the liquid source via, for example, hoses, conduits or other appropriate means for conveying the liquid from the liquid

25 source to the fluid applicator. The handle also includes first and second channels for transporting the liquid through the handle and to the neck and head portions of the liquid applicator. The first and second channels are connected to the first and second ports, respectively, at the proximal end of the handle and extend longitudinally through the handle to the neck of the applicator.

30 The neck of the liquid applicator includes the first and second channels for transporting the fluid disposed within and extending longitudinally there through to the head of the liquid

applicator. The channels then terminate in a manifold feed connecting the fluid channels with respective fluid manifold located in the head of the applicator.

The head includes a cleaning component that comprises a chamber for maintaining the liquid proximate the plurality of surfaces, i.e. liquid-contacting-chamber (LCC). By "proximate", it is meant that the liquid is maintained in contact with the surfaces. The LCC is defined by the space bounded by proximal and distal sealing membranes, first and second inner side walls extending longitudinally between the first and second sealing membranes, and a base inner wall extending horizontally between the base of the first and second inner side walls and longitudinally between the proximal and distal sealing membranes. The first and second inner side walls of the cleaning component each include a plurality of openings, or slots, through which the liquid is directed to contact the plurality of surfaces of the oral cavity.

The head of the liquid applicator also includes a first manifold for containing a first portion of liquid and providing same to the LCC through the openings of the first inner side wall, a second manifold for containing a second portion of liquid and providing same to the LCC through the openings of the second inner side wall, a first port for conveying the first portion of liquid to and from the first manifold, and a second port for conveying the second portion of liquid to and from the second manifold.

The cleaning component design may be optimized for maximum effectiveness as it relates to the size, shape, thickness, materials, volume created around the teeth/gingiva, nozzle design and placement as it relates to the oral cavity and the teeth in conjunction with the manifold and gingival margin seal to provide comfort and minimize the gagging reflex of the user. The combination of the above provides effective contact of the teeth and gingival area by the liquid.

The cleaning component provides a controlled and isolated environment with known volume, i.e. the LCC, to contact teeth and/or gingival area with liquids, and then to remove spent liquids, as well as debris, plaque, etc., from the LCC without exposing the whole oral cavity to liquid, debris, etc. This decreases the potential for ingestion of the liquids. The cleaning component also allows increased flow rates and pressure of liquids without drowning the individual nozzles when significant flow rates are required to provide adequate cleaning, for example. The cleaning component also allows reduced liquid quantities and flow rates when required, as only the area within the LCC is being contacted with liquid, not the entire oral

cavity. The cleaning component also allows controlled delivery and duration of contact of liquid on, through and around teeth and the gingival area, allowing increased concentrations of liquids on the area being contacted by the liquid, thereby providing more effective control and delivery of liquid.

- 5 The number and location of openings, also referred to herein as slots, jets or nozzles, contained within the inner walls of the cleaning component through which the liquid is directed will vary and be determined based upon the circumstances and environment of use, the particular user and the beneficial effect being sought. The cross-sectional geometry of the openings may be circular, elliptical, trapezoidal, or any other geometry that provides effective
- 10 contact of the surfaces of the oral cavity by the liquid. The location and number of openings may be designed to direct jets of liquid in a variety of spray patterns effective for providing the desired beneficial effect. Opening diameters may be from about 0.1 to about 3 mm, or from about 0.2 mm to about 0.8 mm, or about 0.5 mm, to provide effective cleaning and average jet velocities and coverage.
- 15 Optimal opening placement and direction/angles allows coverage of substantially all teeth surfaces in the area of the oral cavity to be contacted by liquid, including but not limited to interdental, top, side, back, and gingival pocket surfaces. In alternate embodiments, the openings could be of different sizes and different shapes to provide different cleaning, coverage and spray patterns, to adjust velocities, density and fan patterns (full cone, fan,
- 20 partial, cone, jet), or due to formulation consideration. The cleaning component may be an elastomeric material such as ethylene vinyl acetate (EVA), thermoplastic elastomer (TPE), or silicone, to allow motion of the inner walls and provide a greater jet coverage area with minimal mechanics, reducing the volumetric flow requirements to achieve optimized performance, while providing a softer and more flexible material to protect the teeth and/or
- 25 gingiva if direct contact with the teeth and/or gingiva is made. A flexible membrane may also provide acceptable fitment over a large range of users, due to its ability to conform to the teeth and/or gingiva, and act as a flexible gum-sealing membrane to provide an effective seal. Alternatively, the cleaning component could be made of a rigid or semi-rigid material, such as but not limited to a thermoplastic.
- 30 In an alternate embodiment, the cleaning component could also include abrasive elements such as filaments, textures, polishing elements, additives (silica, etc.), and other geometric elements that could be used for other cleaning and/or treatment requirements as well as

ensuring minimal distance between the teeth and cleaning component for, but not limited to, treatment, cleaning, and positioning. The cleaning component could be created via a variety of methods such as, but not limited to, machining, injection molding, blow molding, extrusion, compression molding, and/or vacuum forming. The material for the manifold would be a semi-rigid thermoplastic, which would provide the rigidity necessary not to collapse or burst during the controlled flow of the liquids, but to provide some flexibility when fitting within the user's mouth for cleaning component insertion, sealing/position and removal. To minimize fabrication complexity, number of components and tooling cost, the dual manifold is created when assembled with the LCCM. The manifold could also be multi-component to provide a softer external "feel" to the teeth/gums utilizing a lower durometer elastomeric material, such as, but not limited to, a compatible thermoplastic elastomer (TPE). The manifold could be created via a variety of methods such as, but not limited to machining, injection molding, blow molding, compression molding, or vacuum forming.

Devices of the invention also comprise a first port for conveying the liquid to and/or from the first manifold and a second port for conveying the liquid to and from the second manifold, and means for providing an effective seal of the directing means within the oral cavity, i.e. a gingival and/or teeth seal. In certain embodiments, the first and second ports may serve both to convey liquid to and from the first and second manifolds and to attach the applicator to the means for providing liquid to the applicator. In other embodiments, the directing means may further include means for attaching the directing means to means for providing liquid to the directing means.

FIG. 1 is a schematic drawing of an embodiment of a system utilizing devices according to the present invention. The figure shows system **200**, with components including: means for providing reciprocation **202** of liquid in the oral cavity, means for directing the liquid onto the plurality of surfaces of the oral cavity, in this instance shown as liquid applicator **100**, and liquid supply reservoir **290**. Means for providing reciprocation **202** of liquids may include, in this embodiment, delivery/collection device **210**, reciprocating flow controller **230**, tubes **212**, **216**, and **292** for conveying the liquid throughout the system, and liquid one-way flow valves **214**, **218** and **294**. Tubes **232** and **234** provide for conveyance of the liquid from reciprocating flow controller **230** to liquid applicator **100**.

In some embodiments, delivery/collection device **210** may be a piston pump. Liquid supply reservoir **290** may be made of glass, plastic or metal. Liquid supply reservoir **290** may be



integral to system **200** and refillable. In some embodiments, liquid supply reservoir **290** may be a replaceable liquid supply, such as a single or multi-use cartridge, detachably connected to system **200**.

5 In some embodiments, liquid supply reservoir **290** and/or tubes **212**, **292**, may include a heat source to pre-warm the liquid prior to direction into applicator **100** for application to the surfaces of the oral cavity. The temperature should be maintained within a range effective to provide efficacy and comfort to the user during use.

Applicator **100**, discussed in detail herein below, may be detachably connected to reciprocating means **202** by way of tubes **232**, **234** and further attachment means (not shown).  
10 It could be one or two sided with internally, easily cleanable filters for trapping food particles. When positioned within the oral cavity, e.g. about the teeth and gums, applicator **100** forms an effective fit or seal against the gums and directs liquid against surfaces of the oral cavity, e.g. surfaces of the teeth.

Liquid in liquid supply reservoir **290** flows through tube **292** to delivery/collection device  
15 **210**. Liquid flow through tube **292** is controlled by one-way flow valve **294**. From delivery/collection device **210**, liquid flows through tube **212** to reciprocating flow controller **230**. One-way flow valve **214** controls the liquid flow through tube **212**. Liquid flows from reciprocating flow controller **230** to applicator **100** either through tube **232** or **234**, depending on the flow direction setting of reciprocating flow controller **230**. Liquid flows from  
20 applicator **100**, through either tube **234** or **232** back to reciprocating flow controller **230**, and from reciprocating flow controller **230** to delivery/collection device **210**, through tube **216**. One-way flow valve **218** controls the liquid flow through tube **216**.

The actions of delivery/collection device **210** may be controlled by a logic circuit, which may include a program to start the reciprocation cycle, a program to execute the reciprocation  
25 cycle, i.e. to cause liquid to be reciprocated about the teeth, thereby providing the beneficial effect to the oral cavity, e.g. cleaning the teeth, a program to empty applicator **100** at the end of the reciprocation cycle, and a self-cleaning cycle to clean the system between uses, or at pre-set or automatic cleaning times.

Though not shown, a face panel with a series of switches and indicator lights may also be  
30 incorporated into system **200**. Switches may include, but are not limited to, on/off, fill applicator **100**, run the reciprocation program, empty system **200**, and clean system **200**.

Indicator, or display, lights include, but are not limited to, power on, charging, reciprocation program running, system emptying, cleaning results or feedback, and self-cleaning cycle in operation. In embodiments where liquid is pre-warmed prior to direction into applicator **100**, a display light could be used to indicate that the liquid is at the proper temperature for use.

5 One method of using system **200** to clean teeth is as follows. In the first step, the user positions applicator **100** in the oral cavity about the teeth and gingival area to be cleaned. Delivery/collection device **210** is activated to begin drawing cleaning liquid from liquid supply reservoir **290** through tube **292** and one-way flow valve **294**. Once delivery/collection device **210** is sufficiently filled, delivery/collection device **210** is activated to begin  
10 dispensing cleaning liquid to applicator **100** via tube **212**, one-way flow valve **214**, reciprocating flow controller **230**, and tube **232**. Cleaning liquid will be prevented from flowing through tubes **216** and **292** by one-way flow valves **218** and **294**, respectively. Delivery/collection device **210** is activated to begin drawing cleaning liquid from applicator **100** through tube **234**, then through reciprocation flow controller **230**, then through tube **216**  
15 and one-way flow valve **218**. Cleaning liquid will be prevented from flowing through tube **212** by one-way flow valve **214**. If there is insufficient cleaning liquid to adequately fill delivery/collection device **210**, additional cleaning liquid may be drawn from liquid supply reservoir **290** through tube **292** and one-way flow valve **294**. The direction of the liquid flow is then reversed. To reciprocate the cleaning liquid, steps 2 and 3 are repeated after the flow  
20 direction is reversed, cycling cleaning liquid between delivery/collection device **210** and applicator **100**, using tubes **234** and **232**, respectively. The reciprocation cycle described continues until the time required for cleaning has expired, or the desired numbers of cycles are complete. It is noted that there may be a delay between the delivery of the fluid to applicator **100** and the drawing of the fluid from applicator **100** (in either or both, directions),  
25 allowing a dwell time where the liquid is allowed to contact the teeth without flow.

FIG. 2 is a schematic drawing of an alternative embodiment of a system utilizing devices according to the present invention. The figure shows system **400**, with components including: means for providing reciprocation **402** of liquids in the oral cavity, liquid reservoir **470**, liquid supply reservoir **490**, and means for directing the liquid onto the plurality of surfaces  
30 of the oral cavity, in this instance shown as liquid applicator **100**. Means for providing reciprocation **402** may include delivery device **410**, collection device **420**, reciprocating flow controller **430**, tubes **412**, **422a**, **422b**, **472**, **476**, and **492**, and solution one-way flow valves

**414, 424a, 424b, 474, 478, and 494.** Tubes **432** and **434** provide for conveyance of the liquid from reciprocating flow controller **430** to liquid applicator **100**.

In the present embodiment, delivery device **410** and collection device **420** are housed together as a duel action piston pump, with common piston **415**. Liquid supply reservoir **490** and liquid reservoir **470** may be made of glass, plastic, or metal. Liquid supply reservoir **490**  
5 may be integral to system **400** and refillable. In some embodiments, liquid supply reservoir **490** may be a replaceable liquid supply, detachably connected to system **400**.

In some embodiments, any of liquid supply reservoir **490**, liquid reservoir **470**, or tubes **412, 472, 492**, may include a heat source to pre-warm cleaning solution prior to direction into  
10 applicator **100** for application to the teeth. The temperature should be maintained within a range effective to provide comfort to the user during use.

Applicator **100** may be detachably connected to reciprocating means **402** by way of tubes **432, 434** and other attachment means (not shown).

Liquid in liquid supply reservoir **490** flows through tube **492** to liquid reservoir **470**. Liquid  
15 in reservoir **470** flows through tube **472** to delivery device **410**. Liquid flow through tube **472** is controlled by one-way flow valve **474**. From delivery device **410**, liquid flows through tube **412** to reciprocating flow controller **430**. One-way flow valve **414** controls the liquid flow through tube **412**. Liquid flows from reciprocating flow controller **430** to liquid applicator **100** through tube **432** or tube **434**, depending on the flow direction. Liquid flows  
20 from liquid applicator **100**, through tube **434** or tube **432**, again depending on the flow direction, back to reciprocating flow controller **430**, and from reciprocating flow controller **430** to collection device **420**, through tubes **422a** and **422b**. One-way flow valves **424a** and **424b** control the liquid flow through the tubes. Finally, liquid flows from collection device **420** to liquid reservoir **470** through tubes **476a** and **476b**. One-way flow valves **478a** and  
25 **478b** control the liquid flow through the tubes.

The actions of delivery device **410** and collection device **420** may be controlled by a logic circuit, which may include a program to the start reciprocation cycle, a program to execute the reciprocation cycle, i.e. to cause solution to be reciprocated about the plurality of the surfaces of the oral cavity, thereby providing the beneficial effect, a program to empty liquid  
30 applicator **100** at the end of the cycle, and a self-cleaning cycle to clean the system between uses, or at pre-set or automatic cleaning times.

One method of using system **400** to clean teeth is as follows. Prior to use, cleaning liquid in liquid supply reservoir **490** flows through tube **492** and one-way valve **494** to cleaning liquid reservoir **470**. In some embodiments, liquid supply reservoir **490** is now disconnected from system **400**.

- 5 In the first step, the user positions liquid applicator **100** in the oral cavity about the teeth and oral cavity to be contacted. The cleaning process is as follows:

Piston **415** is activated to begin drawing cleaning liquid to delivery device **410** from cleaning liquid reservoir **470** through tube **472** and one-way flow valve **474**. To accomplish this, piston **415** translates from right to left ("R" to "L" on FIG. 3). Once delivery device **410** is sufficiently filled, delivery device **410** is activated to begin dispensing cleaning liquid to applicator **100** via tube **412**, one-way flow valve **414**, reciprocating flow controller **430**, and tube **432**. To accomplish this, piston **415** translates from left to right ("L" to "R" on FIG. 3). The "L" to "R" motion of piston **415** causes collection device **420** to begin drawing cleaning liquid from applicator **100** via tube **434**, reciprocating flow controller **430**, tube **422a**, and one-way flow valve **424a**. Cleaning liquid will be prevented from flowing through tubes **472** and **422a**, by one-way flow valves **474** and **424b**. Any excess cleaning liquid in collection device **420** will begin dispensing to cleaning liquid reservoir **470** via tube **476b** and one-way valve **478b**. Cleaning liquid will be prevented from flowing through tube **422b** by one-way flow valve **424b**. To cycle cleaning solution, the delivery steps are repeated, cycling cleaning liquid between cleaning solution reservoir **470** and liquid applicator **100**. The process continues to run until the time required for cleaning has expired, or the desired numbers of cycles are complete.

Each embodiment described in FIGs. 1 and 2 includes optional reciprocating flow controller (**230**, **430** in FIG. 1, FIG. 2, respectively). A perspective drawing and an exploded view of an embodiment of a reciprocating flow controller according to the present invention is shown in FIG. 3a and FIG. 3b, respectively. The figures show reciprocating flow controller **710** with cap **720**, flow diverter disk **730**, and base **740**. Cap **720** has cap ports **722** and **724**. Base **740** has base ports **742** and **744**. Flow diverter disk **730** is disposed between cap **720** and base **740**, and has panel **735** for diverting liquid flow, and position adjuster **732** in the form of a gear.

FIG. 3c is a top view of reciprocating flow controller **710** in its first position. In this position, incoming liquid, such as liquid in tube **212** of FIG. 1, enters reciprocating flow controller **710** through base port **742**. The liquid exits reciprocating flow controller **710** through cap port **722**, such as liquid in tube **232** of FIG. 1. Returning liquid, such as liquid in tube **234** of FIG. 1, reenters reciprocating flow controller **710** through cap port **724**. The liquid re-exits reciprocating flow controller **710** through base port **744**, such as liquid in tube **216** of FIG. 1.

FIG. 3d is a top view of the reciprocating flow controller **710** in its second position. In this position, incoming liquid, such as liquid in tube **212** of FIG. 1, enters reciprocating flow controller **710** through base port **742**. The liquid exits reciprocating flow controller **710** through cap port **724** such as liquid in tube **234** of FIG. 1. Returning liquid, such as liquid in tube **232** of FIG. 1, reenters reciprocating flow controller **710** through cap port **722**. The liquid exits reciprocating flow controller **710** through base port **744**, such as liquid in tube **216** of FIG. 1.

Reciprocation of liquid in liquid applicator **100** of FIG. 1 is achieved by switching reciprocating flow controller **710** between its first and second positions. It has been found that the width of panel **735** relative to the diameters of cap ports **722** and **724** and base ports **742** and **744** is critical to the performance of reciprocating flow controller **710**. If the width of panel **735** is equal to or greater than any of the diameters, then one or more of cap ports **722** and **724** or base ports **742** and **744** may be blocked, or isolated, during part of the reciprocation, resulting in suboptimal performance or device failure. A channel may be located in panel **735** to avoid this condition.

The oral hygiene system may be comprised of several components including, but not limited to, a base station, a unit for containing means for providing reciprocation of liquid about the plurality of surfaces within the oral cavity, and the device for directing the liquid onto the plurality of surfaces of the oral cavity to be treated/cleaned, i.e. the liquid applicator. The system is suitable for in-home use and adapted to direct liquid onto a plurality of surfaces of a tooth. The device cleans teeth and removes plaque using a cleaning solution that may be reciprocated back and forth, creating a cleaning cycle and minimizing cleaning solution used. The base station may charge a rechargeable battery, hold liquid reservoirs, house diagnostic components, provide feedback to the user, and potentially clean the applicator.

The means for providing reciprocation will have a powered pump that will deliver liquid from the reservoir to the liquid applicator. The direction of flow may be reciprocated with liquid control valving, by a specialized pump (reversing its direction, etc), reversible check valves, or other similar means. The cycle time and flow velocity for each stage of the cycle will be variable and in some embodiments, be customized to each individual user.

The third major component of the apparatus is the device for directing liquid to the plurality of surfaces in the oral cavity to be cleaned/treated, i.e. the liquid applicator. FIGs. 4 to 11 show a first embodiment of a liquid application device. FIG. 4 is a right side front perspective view of a first embodiment of liquid applicator device **100** according to the present invention. FIG. 5 is a top view of liquid applicator **100** of FIG. 4, while FIG. 6 is a side view of liquid applicator **100** of FIG. 4. The figures show applicator **100** with handle **120**, neck **130**, and head **140**. First port **122** and second port **124** for receiving liquid from the liquid reservoir are located at proximal end **121** of handle **120**, and connect to first and second channels (not shown) originating at proximal end **121**. Cleaning component **150** is disposed on the facing of head **140**.

FIG. 7 is a side view of neck **130** and head **140** of liquid applicator **100** of FIG. 4. The figure shows cleaning component **150** disposed on the facing of head **140**. Proximal sealing membrane **152** and distal sealing membrane **154** are located at the ends of cleaning component **150**. FIG. 8 is a horizontal sectional view of FIG. 7 along the 8—8 plane. The figure shows first fluid channel **142** and second fluid channel **144** disposed in neck **130** and head **140**. First fluid channel **142** terminates in first manifold feed **146**, which connects first fluid channel **142** to a first fluid manifold (not shown) in cleaning component **150**. Second fluid channel **144** terminates in second manifold feed **148**, which connects second fluid channel **144** to a second fluid manifold (not shown) in cleaning component **150**.

FIG. 9 through 11 are views of cleaning component **150**. FIG. 9 is a top view of cleaning component **150**, including proximal sealing membrane **152**, distal sealing membrane **154**, cleaning elements **155**, first side wall **156a**, second side wall **156b**, and base inner wall **158**. Though the figures show cleaning elements **155** located on first side wall **156a**, second side wall **156b**, and base inner wall **158**, cleaning elements **155** may be located on only one side wall (**156a** or **156b**) or on only base inner wall **158**, or on any combination in other embodiments. In addition, the shape, size, number and layout of cleaning elements **155** may be optimized for improved cleaning.

FIG. 10 is a vertical sectional view of FIG. 9 along the 10—10 plane, and FIG. 11 is a vertical sectional view of FIG. 9 along the 11—11 plane. The figures show first manifold feed **146** connected to first fluid manifold **172**, and second manifold feed **148** connected to second fluid manifold **174**. First fluid manifold **172** features first side nozzles **176a**, which pass through first side wall **156a**, and first bottom nozzles **178a**, which pass through base inner wall **158**. Second fluid manifold **174** features second side nozzles **176b**, which pass through second side wall **156b**, and second bottom nozzles **178b**, which pass through base inner wall **158**. The liquid-contacting chamber (LCC) **160** is defined by first side wall **156a**, second side wall **156b**, proximal sealing membrane **152**, distal sealing membrane **154**, and base inner wall **158**.

It is to be understood that the configuration of first side nozzles **176a**, second side nozzles **176b**, first bottom nozzles **178a**, and second bottom nozzles **178b** in FIGs. 4 to 11 are only one embodiment of nozzle configuration. The configuration of the nozzles, as well as the geometry of the nozzle openings, may change.

The proximal sealing membrane **152** and distal sealing membrane **154** provide a flexible and universal sealing mechanism to minimize leakage into the oral cavity while redirecting flow onto and around teeth, to maximize treatment/cleaning area to get to hard-to-reach-places (HTRP). The membrane can provide an elastic function across the lumen longitudinal axis to form around the teeth and gums.

Base inner wall **158** provides the flexibility required for effective fit or sealing within the oral cavity and allowing redirection and flow of fluids back towards the teeth and/or gingival surfaces. Base inner wall **158** may be a flexible membrane for providing an effective seal.

In one embodiment of an operation, liquid enters first fluid channel **142** through first port **122** by pressure and then passes through first fluid manifold **172** and enters LCC **160** through first side nozzles **176a** and first bottom nozzles **178a**. A vacuum is pulled on second port **124** to pull the liquid through second side nozzles **176b** and second bottom nozzles **178b**, into second fluid manifold **174**, through second fluid channel **144** and finally into second port **124**. In this embodiment, jets of liquid are first directed from the first manifold onto the first surfaces of the teeth and/or gingival area from one side of the LCC **160**, directed through, between, and around the surfaces of the teeth and/or gingival area from the other side of LCC **160** and into the second manifold to provide controlled interdental, gumline, surface and/or

gingival area cleaning or treatment. Next, the flow in the manifolds is reversed. Cleaning liquid enters second fluid channel **144** through second port **124** by pressure and then passes through second fluid manifold **174** and enters LCC **160** through second side nozzles **176b** and second bottom nozzles **178b**. A vacuum is pulled on first port **122** to pull the liquid  
5 through first side nozzles **176a** and first bottom nozzles **178a**, into first fluid manifold **172**, through first fluid channel **142** and finally into first port **122**. In the second portion of this embodiment, jets of liquid are directed from the second manifold onto the second surfaces of the teeth and/or gingival area, and directed through, between, and around the surfaces of the teeth and/or gingival area. The alternating of pressure/vacuum through a number of cycles  
10 creates a turbulent, repeatable and reversible flow to provide reciprocation of liquid about the plurality of surfaces of the oral cavity to substantially simultaneously contact the surfaces of the oral cavity with liquid, thereby providing the desired beneficial effect.

In another embodiment, it may be preferable to deliver the liquid through one or both manifolds simultaneously, flooding LCC **160**, submerging the teeth and gums for a period of  
15 time and then evacuating LCC **160** after a set period of time through one or both manifolds. Here, cleaning or treating liquid simultaneously enters first port **122** and second port **124**, simultaneously passes through first fluid channel **142**, second fluid channel **144**, first manifold feed **146**, second manifold feed **148**, first fluid manifold **172**, and second fluid manifold **174** by pressure and then enters LCC **160** simultaneously through first side nozzles  
20 **176a**, second side nozzles **176b**, first bottom nozzles **178a**, and second bottom nozzles **178b**. To evacuate LCC **160**, a vacuum is simultaneously pulled through first port **122** and second port **124**. Cleaning or treatment liquid is pulled through first side nozzles **176a** and first bottom nozzles **178a**, into first fluid manifold **172**, and through second side nozzles **176b** and second bottom nozzles **178b**, into second fluid manifold **174**.

25 It is also possible to deliver different liquid compositions to first fluid manifold **172** and second fluid manifold **174**. The different liquid compositions could then combine in LCC **160** for improved cleaning efficacy or treatment effects.

Although the embodiment of FIGs. 4 through 11 show a single cleaning component **150** on head **140**, it is to be understood that a second cleaning component that is similar to cleaning  
30 component **150** may be disposed on the opposite facing of head **140**. The second cleaning component would provide substantially simultaneous contact of a plurality of surfaces of both top and bottom sections of the oral cavity



FIGs. 12 and 13 show a second embodiment of a liquid application device of the present invention. FIG. 12 is a top, rear perspective view of neck **1130** and head **1140** of a liquid application device according to the present invention. The figure shows first fluid channel **1142** and second fluid channel **1144** disposed in neck **1130**. Cleaning component **1150** is  
5 disposed on the facing of head **1140**.

FIG. 13 is a vertical sectional view of FIG. 12 along the 13—13 plane. The figures show first fluid channel **1142** connected to first manifold feed **1146**, which is connected to first fluid manifold **1162** in cleaning component **1150**. First manifold feed **1146** feeds first liquid lumens **1156a, 1156b, 1156c**. The figures also show first nozzles **1166** in first liquid lumens  
10 **1156a, 1156b, 1156c**. Though not shown in the figures, second fluid channel **1144** connected to second manifold feed **1148**, which is connected to second fluid manifold **1164** in cleaning component **1150**. Second manifold feed 1148 feeds second liquid lumens **1157a, 1157b, 1157c** and second nozzles **1168** in first liquid lumens **1157a, 1157b, 1157c**.

It is to be understood that the layout of first nozzles **1166** and second nozzles **1168** are only  
15 one embodiment of nozzle configuration. The layout of the nozzles, as well as the geometry of the nozzle openings may change.

FIGs. 12 and 13 show cleaning component **1150** with six liquid lumens (**1156a, 1156b, 1156c, 1157a, 1157b, and 1157c**). In others embodiments, cleaning component **1150** may be formed with two, three, four, five, seven, eight, nine, ten, or even more liquid lumens.

20 The multi-lumen design provides bidirectional or dedicated lumens for flow and vacuum that are self-reinforcing and therefore do not collapse under vacuum or rupture under pressure while in use, maximizing the structural integrity, while minimizing the size of the overall cleaning component **1150** for user comfort during insertion, in-use, and upon removal. This decreased size also serves to provide an enhanced effective seal of the applicator in the oral  
25 cavity.

The multiple lumens (**1156a, 1156b, 1156c, 1157a, 1157b, 1157c**) as connected above form a lumen hinge sections. This may result in the multi-lumen design providing conformance in the X, Y and Z directions, due to the flexibility of lumen hinge sections between each lumen. This design allows effective and feasible conformance to a variety of different users teeth and  
30 gum topography, providing the effective gum sealing without irritating the gums and allowing dynamic positioning of the liquid cleaning jets around each of the teeth to obtain

proximal and interdental cleaning action. The multiple lumens are also attached to the first fluid manifold **1162** and second fluid manifold **1164**. This creates a secondary flexible joint providing two additional degrees of motion for the adjusting to different bite architectures that may be encountered.

- 5 The proximal sealing membrane **1152** and distal sealing membrane **1154** provide a flexible and universal sealing mechanism to minimize leakage into the oral cavity while redirecting flow onto and around teeth, to maximize treatment/cleaning area to get to hard-to-reach-places (HTRP). The membrane can provide an elastic function across the lumen longitudinal axis to form around the teeth and gums.
- 10 Lumens **1156a**, **1156b**, **1156c**, **1157a**, **1157b**, and **1157c** provide the flexibility required for effective fit or sealing within the oral cavity and allowing redirection and flow of fluids back towards the teeth and/or gingival surfaces.

In one embodiment of a cleaning operation, cleaning liquid is pumped through first fluid channel **1142**, and enters first fluid manifold **1162** through first manifold feed **1146**. Liquid  
15 enters first liquid lumens **1156a**, **1156b**, and **1156c** from first fluid manifold **1162**. The cleaning liquid then enters LCC **1160** through first nozzles **1166**. A vacuum is pulled on second manifold feed **1148** (not shown) to pull the cleaning liquid through second nozzles **1168** (not shown), into second liquid lumens **1157a**, **1157b**, and **1157c**. The liquid enters second fluid manifold **1164**, then flows through second manifold feed **1148**, and finally into  
20 second fluid channel **1144**.

In this embodiment, jets of cleaning liquid are first directed from first fluid manifold **1162** to the first surfaces of the teeth and/or gingival area from one side of LCC **1160**, and directed through, between, and around the surfaces of the teeth and/or gingival area from the other side of the LCC into the second fluid manifold **1164** to provide controlled interdental,  
25 gumline, surface and /or gingival area cleaning or treatment.

Next, the flow in the manifolds is reversed. Cleaning liquid is pumped through second fluid channel **1144**, second fluid manifold **1164** through second manifold feed **1148**. Liquid enters second liquid lumens **1157a**, **1157b**, and **1157c** from second fluid manifold **1164**. The cleaning liquid then enters LCC **1160** through second nozzles **1168**. A vacuum is pulled on  
30 first manifold feed **1146** to pull the cleaning liquid through first nozzles **1166**, into first liquid

lumens **1156a**, **1156b**, and **1156c**. The liquid enters first fluid manifold **1162**, then flows through first manifold feed **1146**, and finally into first fluid channel **1142**.

In the second portion of this embodiment, jets of cleaning liquid are directed onto the second surfaces of the teeth and/or gingival area, and directed through, between, and around surfaces  
5 of the teeth and/or gingival area. The alternating of pressure/vacuum through a number of cycles creates a turbulent, repeatable and reversible flow to provide reciprocation of liquid about the plurality of surfaces of the oral cavity to substantially simultaneously contact the surfaces of the oral cavity with liquid, thereby providing the desired beneficial effect.

In another embodiment it may be preferable to deliver the liquid through both manifolds  
10 simultaneously, flooding LLC **1160**, submerging the teeth for a period of time and then evacuating LCC **1160** after a set period of time through one or both manifolds. Here, cleaning or treating liquid is simultaneously pumped through first fluid channel **1142** into first fluid manifold **1162** via first manifold feed **1146**, and through second fluid channel **1144** into second fluid manifold **1164** via second manifold feed **1148**. Liquid then simultaneously  
15 enters first liquid lumens **1156a**, **1156b**, and **1156c** from first fluid manifold **1162**, and second liquid lumens **1157a**, **1157b**, and **1157c** from second fluid manifold **1164**. The cleaning liquid then enters LCC **1160** simultaneously through first nozzles **1166** and second nozzles **1168**. To evacuate LCC **1160**, a vacuum is simultaneously pulled on first manifold feed **1146** through first fluid channel **1142**, and second manifold feed **1148** through second  
20 fluid channel **1144**. Cleaning or treatment liquid is simultaneously pulled through first nozzles **1166** and second nozzles **1168**, into first manifold feed **1146** and second manifold feed **1148**.

It is also possible to deliver different liquid compositions to first manifold feed **1146** and second manifold feed **1148**. The different liquid compositions would then combine in LCC  
25 **1160** for improved cleaning efficacy or treatment effects. In the dual manifold design it may be preferable to supply each manifold from a separate liquid supply reservoir, such as in a dual action piston pump configuration, where one supply line connects to supply first manifold feed **1146** and the other piston supply line provides and removes liquid from second manifold feed **1148**, e.g. when one manifold is being supplied with liquid the second  
30 manifold is removing liquid, and vice versa.

In other embodiments, valves can be placed at the entry to first liquid lumens **1156a**, **1156b**, and **1156c**, or at the entry to second liquid lumens **1157a**, **1157b**, and **1157c** to provide improved function by allowing lumens to engage at different times (at different points in the cleaning/treatment cycle), at pulsed intervals. As an example, in one embodiment, not all  
5 lumens engage in the liquid pumping/vacuum function. Here, first liquid lumen **1156a** and second liquid lumen **1157a**, which primarily engage the gums, only engage in the liquid vacuum function. This would help prevent liquid from leaking into the oral cavity. Valving also allows for variable flow, allowing a decreased resistance to the liquid vacuum function, or allowing increased pumping, and therefore liquid velocity, during liquid delivery.

10 In still other embodiments, individual inner first nozzles **1166** or second nozzles **1168** may have integrated one-way valves, such as duckbill valves or umbrella valves, to allow flow only in one direction out of those particular nozzles. This may be effective to increase vacuum relative to pressure/delivery in LCC **1160**.

Manufacturing of the multi-lumen design for the cleaning component **1150** m utilizing  
15 existing available manufacturing and assembly processes such as extrusion, injection, vacuum, blow, or compression molding. Other feasible techniques include rapid prototyping techniques such as 3D printing and other additive techniques, as well as subtractive techniques.

One manufacturing method is to create individual component shells through vacuum forming.  
20 Low cost methods allow vacuuming forming of very thin wall structures. The component geometry is designed to provide the interlocking features and structural geometry to allow minimization of the size of cleaning component **1150**. When assembled, the manufactured components form the necessary manifolds and flow structure (bidirectional and/or dedicated manifolds) to provide the required performance characteristics for treating/cleaning the teeth.

25 Materials for the lumens could range from lower durometer flexible materials (25 shore A) to harder materials more rigid materials (90 shore A), preferably being between 30 and 70 shore A.

Materials could be silicone, thermoplastic elastomer (TPE), polypropylene (PP), polyethylene (PE), polyethylene terephthalate (PET), ethylene vinyl acetate (EVA), polyurethane (PU), or  
30 multi-component (combination of materials and hardness) to achieve desired design and performance attributes.

The first nozzles **1166** and second nozzles **1168** could be made through a secondary operation such as drilling or punching, or formed during molding. Alternatively, the first nozzles **1166** and second nozzles **1168** could be inserted into cleaning component **1150** to provide increased wear and or different jet performance characteristics, and could be combined with frictional cleaning elements or other components to enhance the cleaning and/or treatment affect.

Although the embodiment of FIGs. 12 and 13 show a single cleaning component **1150** on head **1140**, it is to be understood that a second cleaning component similar to cleaning component **1150** may be disposed on the opposite facing of head **1140**. The second cleaning component would provide substantially simultaneous contact of a plurality of surfaces of both top and bottom sections of the oral cavity

FIGs. 14 to 20 show a third embodiment of application device according to the present invention. FIG. 14 is a side view of neck **2130** and head **2140** of the device. The figure shows cleaning component **2150** disposed on the facing of head **2140**. The figures show cleaning component **2150** is comprised of proximal sealing membrane **2152**, distal sealing membrane **2154**, first side wall **2156a**, second side wall **2156b**, and base inner wall **2158**. FIG. 15 is a horizontal sectional view of FIG. 14 along the 15—15 plane. The figure shows delivery channel **2142** and vacuum channel **2144** disposed in neck **2130** and head **2140**. Delivery manifold feed **2146** connects delivery channel **2142** to delivery manifold **2162** in cleaning component **2150**. Vacuum manifold feed **2148** connects vacuum channel **2144** to vacuum manifold **2164** in cleaning component **2150**. FIG. 16 is a horizontal sectional view of FIG. 14 along the 16—16 plane. The figure shows delivery manifold feed **2146** connected to delivery manifold **2162**, and vacuum manifold feed **2148** connected to vacuum manifold **2162**.

FIGs. 17 through 20 are views of cleaning component **2150**. FIG. 17 is a top view of cleaning component **2150**, including proximal sealing membrane **2152**, distal sealing membrane **2154**, cleaning elements **2155**, first side wall **2156a**, second side wall **2156b**, and base inner wall **2158**. Though the figures show cleaning elements **2155** located on first side wall **2156a**, second side wall **2156b**, and base inner wall **2158**, cleaning elements **2155** may be located on only one wall (**2156a**, for example), or on any combination of side walls (**2156a** and **2156b**) and base inner wall **2158** in other embodiments. In addition, the shape, size, number and layout of cleaning elements **155** may be optimized for improved cleaning.

FIG. 18 is a vertical sectional view of FIG. 17 along the 18—18 plane. The figure shows liquid-contacting chamber (LCC) **2160**, defined by proximal sealing membrane **2152**, distal sealing membrane **2154**, first side wall **2156a**, second side wall **2156b**, and base inner wall **2158**. The figure also shows that delivery channel **2142** connects to delivery manifold feed **2146**, which connects to delivery manifold **2162**. Though not shown, vacuum channel **2144** connects to vacuum manifold feed **2148**, which connects to vacuum manifold **2164**. Fluid exits delivery manifold **2162** through delivery nozzles **2168a**. Fluid enters vacuum manifold **2164** through vacuum nozzles **2168b**.

FIG. 19 is an end view of cleaning component **2150**. FIG. 20 is a vertical sectional view of FIG. 19 along the 20—20 plane. The figures show delivery channel **2142** connected to delivery manifold feeds **2146**, which are connected to delivery manifold **2162** in cleaning component **2150**. Delivery manifold **2162** feeds delivery nozzles **2168a**. Vacuum channel **2144** is connected to vacuum manifold feeds **2148**, which are connected to vacuum manifold **2164** in cleaning component **2150**. Vacuum manifold **2164** draws fluid from vacuum nozzles **2168b**.

FIG. 20 shows delivery nozzles **2168a** located in the central region of cleaning component **2150**, while vacuum nozzles **2168b** are located peripherally to delivery nozzles **2168a**. This nozzle layout is expected to result in a consistent flow of cleaning fluid through the LLC **2160**. It is to be understood that in the layout of delivery nozzles **2168a** and vacuum nozzles **2168b** are only one embodiment of nozzle configuration. The layout of the nozzles, as well as the geometry of the nozzle openings may change.

The proximal sealing membrane **2152** and distal sealing membrane **2154** provide a flexible and universal sealing mechanism to minimize leakage into the oral cavity while redirecting flow onto and around teeth, to maximize treatment/cleaning area to get to hard-to-reach places (HTRP). The membrane can provide an elastic function across the lumen longitudinal axis to form around the teeth and gums.

Base inner wall **2158** provides the flexibility required for effective fit or sealing within the oral cavity and allowing redirection and flow of fluids back towards the teeth and/or gingival surfaces.

In one embodiment of a cleaning operation, cleaning liquid is pumped through delivery channel **2142**, and enters delivery manifold **2162** through delivery manifold feed **2146**. The

cleaning liquid then enters LCC **2160** through delivery nozzles **2168a**. A vacuum is pulled on vacuum manifold feed **2148** to pull the cleaning liquid through vacuum nozzles **2168b**, into vacuum manifold **2164**, then flows through vacuum manifold feed **2148**, and finally into vacuum channel **2144**.

- 5 In this embodiment, jets of cleaning liquid are simultaneously directed from delivery manifold **2162** to both surfaces of the teeth and/or gingival area in LCC **2160** to provide controlled gumline, surface and /or gingival area cleaning or treatment.

In another embodiment it may be preferable to deliver the liquid through both manifolds simultaneously, flooding LLC **2160**, submerging the teeth for a period of time and then  
10 evacuating LCC **2160** after a set period of time through one or both manifolds. Here, cleaning or treating liquid is simultaneously pumped through delivery channel **2142** and vacuum channel **2144**. Liquid will enter LCC **2160** simultaneously through delivery nozzles **1268a** and vacuum nozzles **1268b**. To evacuate LCC **2160**, a vacuum is simultaneously pulled on delivery channel **2142** and vacuum channel **2144**. Cleaning or treatment liquid is  
15 simultaneously pulled through delivery nozzles **1268a** and vacuum nozzles **1268b**.

Although the embodiment of FIGs. 14 through 20 show a single cleaning component **2150** on head **2140**, it is to be understood that a second cleaning component similar to cleaning component **2150** may be disposed on the opposite facing of head **2140**. The second cleaning component would provide substantially simultaneous contact of a plurality of surfaces of both  
20 top and bottom sections of the oral cavity

FIGs. 21 to 27 show a fourth embodiment of an application device according to the present invention. FIG. 21 is a right side front perspective view of the neck and head of this embodiment. The figure shows neck **2530** and head **2540** of the device. Cleaning component **2550** is disposed on the facing of head **2540**. Cleaning component **2550** is comprised of  
25 sealing membranes **2552** on the proximal and distal ends of cleaning component **2550**, first side wall **2556a**, second side wall **2556b**, and base wall **2558**. Cleaning elements **2555** are disposed on the first side wall **2556a**, second side wall **2556b**, and base wall **2558**. Spray nozzles **2568** are disposed on the distal end of a number of the cleaning elements **2555** located on the first side wall **2556a** and second side wall **2556b** of cleaning component **2550**.  
30 It is important to note that in other embodiments spray nozzles **2568** may be disposed on any of the first side wall **2556a**, second side wall **2556b**, base wall **2558**, or at the distal end of

some or all of the cleaning elements **2555** located on any or all of the walls of cleaning component **2550**. The figure also shows liquid-contacting chamber (LCC) **2560**, defined by sealing membranes **2552**, first side wall **2556a**, second side wall **2556b**, and base wall **2558**.

FIGs. 22 and 23 are exploded views of the embodiment of the device of FIG. 21. FIG 22 is a right side front exploded view, while FIG 23 is a left side bottom exploded view. Each figure shows neck **2530**, head **2540**, and cleaning component **2550** of the device. FIG. 22 shows manifold feeds **2546** and **2548**, as well as head pivot hole **2545** on the top surface of head **2540**. FIG. 23 shows head pivot hole **2545** on the bottom surface of head **2540**, as well as manifold entry slots **2551** and **2557**, cleaner pivot hole **2553** and rotation groove **2554** on the bottom surface of cleaning component **2550**. Manifold feeds **2546** and **2548** are aligned with manifold entry slots **2551** and **2557**, so as to create paths for fluid flow and vacuum flow from first channel **2542** and second channel **2544**. As cleaning component **2550** rotates about pivot holes **2545** and **2553**, manifold feeds **2546** and **2548** switch alignment with manifold entry slots **2551** and **2557**. Accordingly, cleaning component **2550** may pivot, i.e. is rotatable, around the horizontal and longitudinal axis of head **2540**. Though not shown, a gasket may be placed in rotation groove **2554** to prevent leakage as cleaning component **2550** rotates about the top surface of head **2540**. Also not shown in the figures is a pin which is disposed in pivot holes **2545** and **2553**. This allows rotation of cleaning component **2550** on the top surface of head **2540**.

FIG. 24 is a side view of neck **2530** and head **2540** of the device of FIG. 21. The figure shows cleaning component **2550** disposed on the facing of head **2540**. FIG. 25 is a horizontal sectional view of FIG. 24 along the 25—25 plane. The figure shows first channel **2542** and second channel **2544** disposed in neck **2530** and head **2540**. First manifold feed **2546** and second manifold feed **2548** connects first channel **2542** and second channel **2544**, respectively, to first manifold **2562** or second manifold **2564** in cleaning component **2550**. FIG. 26 is a horizontal sectional view of FIG. 24 along the 26—26 plane. The figure shows first manifold **2562** and second manifold **2564**.

FIG. 27 is a vertical sectional view of FIG. 21 along the 27—27 plane. The figure shows first manifold **2562** of cleaning component **2550**. Spray nozzles **2568** are disposed on the first side wall **2556a** of cleaning component **2550**.



In one embodiment of a cleaning operation, cleaning liquid is pumped through first channel **2542**, and enters first manifold **2562** through first manifold feed **2546**. The cleaning liquid then enters LCC **2560** through spray nozzles **2568** located on the distal end of cleaning elements **2555** disposed on the first side wall **2556a**. A vacuum is pulled on second manifold feed **2548** to pull the cleaning liquid through vacuum nozzles **2168** located on the distal end of cleaning elements **2555** disposed on the second side wall **2556b** into vacuum manifold **2564**. The fluid then flows through second manifold feed **2548**, and finally into second channel **2544**.

An embodiment of a base unit used with devices according to the present invention is shown in FIG. 28. FIG. 28 is a cut-away view of device **3000**, showing the spatial relationships between the components in the pumping section, vacuum section, and pumping and driving sections. Cylinder volume **3412** is the volume of vacuum cylinder sleeve **3410** not occupied by the components of the pumping section, vacuum section, and pumping and driving sections, and serves as the liquid reservoir in the embodiment shown. The general operation of device **3000** is as follows:

Device **3000** is sufficiently filled with cleaning liquid. The liquid initially resides in cylinder volume **3412** of vacuum cylinder sleeve **3410**. The user inserts any embodiment of a liquid applicator according to the present invention into their mouth. Device **3000** may be activated by a sensor (pressure sensor, proximity sensor, etc.) or the device may be activated by the user. The cleaning cycle is initiated.

On the "down stroke" of piston rod **3460**, delivery piston **3130** pulls liquid from the bottom of cylinder volume **3412** into delivery volume **3114**.

On the "upstroke" of piston rod **3460**, delivery piston **3130** forces the liquid through base port **742** of reciprocating flow controller **710**. Liquid flow through reciprocating flow controller **710** is described earlier using FIG. 3c and FIG. 3d. In brief, when reciprocating flow controller **710** in its first position (FIG. 3c), incoming liquid from delivery volume **3114** enters reciprocating flow controller **710** through base port **742**. The liquid exits reciprocating flow controller **710** through cap port **722**, flowing into outlet pipe **3010b**. Returning liquid, flowing in through outlet pipe **3010a** (not shown), reenters reciprocating flow controller **710** through cap port **724**. The liquid exits reciprocating flow controller **710** through base port

744. When reciprocating flow controller **710** in its second position (FIG. 4d), incoming liquid from delivery volume **3114** enters reciprocating flow controller **710** through base port **742**. The liquid exits reciprocating flow controller **710** through cap port **724**, flowing into outlet pipe **3010a**. Returning liquid, flowing in through outlet pipe **3010b**, reenters reciprocating flow controller **710** through cap port **722**. The liquid re-exits reciprocating flow controller **710** through base port **744**. Reciprocation of cleaning liquid in applicator **100** of FIG. 1 is achieved by switching reciprocating flow controller **710** between its first and second positions. The switching of reciprocating flow controller **710** between its first and second positions is achieved by a worm gear, which is linked to position adjuster **732** in reciprocating flow controller **710**. Though shown as continually rotating in this embodiment, it is to be understood that reciprocating flow controller **710** may be driven via separate means, such as another motor. Also, the time interval for switching reciprocating flow controller **710** between its first and second positions may, in some embodiments be between about 1 and about 100 seconds, or between about 2 and about 10 seconds, and may be varied over the course of the cleaning/treatment.

In the present embodiment, the vacuum section of device **3000** is effective during both the "upstroke" and "down stroke" of piston rod **3460**. Vacuum piston **3270** is dual acting, and draws liquid from liquid applicator **100** on both the upstroke and down stroke of vacuum piston **3270**. The liquid flowing through base port **744** of reciprocating flow controller **710** flows through vacuum volumes **3275a** or **3275b**. Vacuum volume **3275a** is the volume between vacuum end disk **3250** and vacuum piston **3270**. Vacuum volume **3275b** is the volume between vacuum end disk **3290** and vacuum piston **3270**. During the "upstroke" of piston rod **3460**, the liquid in base port **744** is drawn into vacuum volume **3275b** and simultaneously expelled from vacuum volume **3275a** into cylinder volume **3412**. During the "down stroke" of piston rod **3460**, the liquid in base port **744** is drawn into vacuum volume **3275a** and simultaneously expelled from vacuum volume **3275b** into cylinder volume **3412**. As noted, the vacuum piston **3270** in this embodiment is dual acting, drawing liquid from applicator **100** on both the upstroke and down stroke of vacuum piston **3270**. So, while vacuum volume **3275b** is drawing in liquid from base port **744**, the liquid in vacuum volume **3275a** is being pumped into cylinder volume **3412**. In contrast, while vacuum volume **3275a** is drawing in liquid from base port **744**, the liquid in vacuum volume **3275b** is being pumped into cylinder volume **3412**. During the "upstroke" of piston rod **3460**, the liquid in vacuum

volume **3275a** is pumped into cylinder volume **3412**. During the "down stroke" of piston rod **3460**, the liquid in vacuum volume **3275b** is pumped into cylinder volume **3412**.

5 The cycle continues with cycles comprising both "upstrokes" and "down strokes" of piston rod **3460**, with liquid motion through device **3000** as above.

The ratio of the total volume of vacuum volumes **3275a** and **3275b** to delivery volume **3114** may be any range, such as 1:1, optionally about 3:1 or greater, or about 4:1 or greater. Since delivery piston **3130** only delivers liquid on one "half" of the pumping/vacuuming cycle, while vacuum piston **3270** works on both halves of the cycle. The dual acting vacuum piston **3270** also provides vacuum during the half of the stroke where delivery piston **3130** is not delivering liquid, increasing the opportunity to retrieve liquid from applicator **100**, as well as clear additional liquid which leaked from liquid applicator **100** into the oral cavity. Testing has shown a minimum 3:1 volumetric ratio of liquid vacuum to liquid delivery per stroke provided the necessary vacuum to minimize leakage into the oral cavity from liquid applicator **100** when the applicator has a marginal gingival seal, which may occur in 10 15 20 25 30 35 40 45 50 55 60 65 70 75 80 85 90 95 100 105 110 115 120 125 130 135 140 145 150 155 160 165 170 175 180 185 190 195 200 205 210 215 220 225 230 235 240 245 250 255 260 265 270 275 280 285 290 295 300 305 310 315 320 325 330 335 340 345 350 355 360 365 370 375 380 385 390 395 400 405 410 415 420 425 430 435 440 445 450 455 460 465 470 475 480 485 490 495 500 505 510 515 520 525 530 535 540 545 550 555 560 565 570 575 580 585 590 595 600 605 610 615 620 625 630 635 640 645 650 655 660 665 670 675 680 685 690 695 700 705 710 715 720 725 730 735 740 745 750 755 760 765 770 775 780 785 790 795 800 805 810 815 820 825 830 835 840 845 850 855 860 865 870 875 880 885 890 895 900 905 910 915 920 925 930 935 940 945 950 955 960 965 970 975 980 985 990 995 1000 1005 1010 1015 1020 1025 1030 1035 1040 1045 1050 1055 1060 1065 1070 1075 1080 1085 1090 1095 1100 1105 1110 1115 1120 1125 1130 1135 1140 1145 1150 1155 1160 1165 1170 1175 1180 1185 1190 1195 1200 1205 1210 1215 1220 1225 1230 1235 1240 1245 1250 1255 1260 1265 1270 1275 1280 1285 1290 1295 1300 1305 1310 1315 1320 1325 1330 1335 1340 1345 1350 1355 1360 1365 1370 1375 1380 1385 1390 1395 1400 1405 1410 1415 1420 1425 1430 1435 1440 1445 1450 1455 1460 1465 1470 1475 1480 1485 1490 1495 1500 1505 1510 1515 1520 1525 1530 1535 1540 1545 1550 1555 1560 1565 1570 1575 1580 1585 1590 1595 1600 1605 1610 1615 1620 1625 1630 1635 1640 1645 1650 1655 1660 1665 1670 1675 1680 1685 1690 1695 1700 1705 1710 1715 1720 1725 1730 1735 1740 1745 1750 1755 1760 1765 1770 1775 1780 1785 1790 1795 1800 1805 1810 1815 1820 1825 1830 1835 1840 1845 1850 1855 1860 1865 1870 1875 1880 1885 1890 1895 1900 1905 1910 1915 1920 1925 1930 1935 1940 1945 1950 1955 1960 1965 1970 1975 1980 1985 1990 1995 2000 2005 2010 2015 2020 2025 2030 2035 2040 2045 2050 2055 2060 2065 2070 2075 2080 2085 2090 2095 2100 2105 2110 2115 2120 2125 2130 2135 2140 2145 2150 2155 2160 2165 2170 2175 2180 2185 2190 2195 2200 2205 2210 2215 2220 2225 2230 2235 2240 2245 2250 2255 2260 2265 2270 2275 2280 2285 2290 2295 2300 2305 2310 2315 2320 2325 2330 2335 2340 2345 2350 2355 2360 2365 2370 2375 2380 2385 2390 2395 2400 2405 2410 2415 2420 2425 2430 2435 2440 2445 2450 2455 2460 2465 2470 2475 2480 2485 2490 2495 2500 2505 2510 2515 2520 2525 2530 2535 2540 2545 2550 2555 2560 2565 2570 2575 2580 2585 2590 2595 2600 2605 2610 2615 2620 2625 2630 2635 2640 2645 2650 2655 2660 2665 2670 2675 2680 2685 2690 2695 2700 2705 2710 2715 2720 2725 2730 2735 2740 2745 2750 2755 2760 2765 2770 2775 2780 2785 2790 2795 2800 2805 2810 2815 2820 2825 2830 2835 2840 2845 2850 2855 2860 2865 2870 2875 2880 2885 2890 2895 2900 2905 2910 2915 2920 2925 2930 2935 2940 2945 2950 2955 2960 2965 2970 2975 2980 2985 2990 2995 3000 3005 3010 3015 3020 3025 3030 3035 3040 3045 3050 3055 3060 3065 3070 3075 3080 3085 3090 3095 3100 3105 3110 3115 3120 3125 3130 3135 3140 3145 3150 3155 3160 3165 3170 3175 3180 3185 3190 3195 3200 3205 3210 3215 3220 3225 3230 3235 3240 3245 3250 3255 3260 3265 3270 3275 3280 3285 3290 3295 3300 3305 3310 3315 3320 3325 3330 3335 3340 3345 3350 3355 3360 3365 3370 3375 3380 3385 3390 3395 3400 3405 3410 3415 3420 3425 3430 3435 3440 3445 3450 3455 3460 3465 3470 3475 3480 3485 3490 3495 3500 3505 3510 3515 3520 3525 3530 3535 3540 3545 3550 3555 3560 3565 3570 3575 3580 3585 3590 3595 3600 3605 3610 3615 3620 3625 3630 3635 3640 3645 3650 3655 3660 3665 3670 3675 3680 3685 3690 3695 3700 3705 3710 3715 3720 3725 3730 3735 3740 3745 3750 3755 3760 3765 3770 3775 3780 3785 3790 3795 3800 3805 3810 3815 3820 3825 3830 3835 3840 3845 3850 3855 3860 3865 3870 3875 3880 3885 3890 3895 3900 3905 3910 3915 3920 3925 3930 3935 3940 3945 3950 3955 3960 3965 3970 3975 3980 3985 3990 3995 4000 4005 4010 4015 4020 4025 4030 4035 4040 4045 4050 4055 4060 4065 4070 4075 4080 4085 4090 4095 4100 4105 4110 4115 4120 4125 4130 4135 4140 4145 4150 4155 4160 4165 4170 4175 4180 4185 4190 4195 4200 4205 4210 4215 4220 4225 4230 4235 4240 4245 4250 4255 4260 4265 4270 4275 4280 4285 4290 4295 4300 4305 4310 4315 4320 4325 4330 4335 4340 4345 4350 4355 4360 4365 4370 4375 4380 4385 4390 4395 4400 4405 4410 4415 4420 4425 4430 4435 4440 4445 4450 4455 4460 4465 4470 4475 4480 4485 4490 4495 4500 4505 4510 4515 4520 4525 4530 4535 4540 4545 4550 4555 4560 4565 4570 4575 4580 4585 4590 4595 4600 4605 4610 4615 4620 4625 4630 4635 4640 4645 4650 4655 4660 4665 4670 4675 4680 4685 4690 4695 4700 4705 4710 4715 4720 4725 4730 4735 4740 4745 4750 4755 4760 4765 4770 4775 4780 4785 4790 4795 4800 4805 4810 4815 4820 4825 4830 4835 4840 4845 4850 4855 4860 4865 4870 4875 4880 4885 4890 4895 4900 4905 4910 4915 4920 4925 4930 4935 4940 4945 4950 4955 4960 4965 4970 4975 4980 4985 4990 4995 5000 5005 5010 5015 5020 5025 5030 5035 5040 5045 5050 5055 5060 5065 5070 5075 5080 5085 5090 5095 5100 5105 5110 5115 5120 5125 5130 5135 5140 5145 5150 5155 5160 5165 5170 5175 5180 5185 5190 5195 5200 5205 5210 5215 5220 5225 5230 5235 5240 5245 5250 5255 5260 5265 5270 5275 5280 5285 5290 5295 5300 5305 5310 5315 5320 5325 5330 5335 5340 5345 5350 5355 5360 5365 5370 5375 5380 5385 5390 5395 5400 5405 5410 5415 5420 5425 5430 5435 5440 5445 5450 5455 5460 5465 5470 5475 5480 5485 5490 5495 5500 5505 5510 5515 5520 5525 5530 5535 5540 5545 5550 5555 5560 5565 5570 5575 5580 5585 5590 5595 5600 5605 5610 5615 5620 5625 5630 5635 5640 5645 5650 5655 5660 5665 5670 5675 5680 5685 5690 5695 5700 5705 5710 5715 5720 5725 5730 5735 5740 5745 5750 5755 5760 5765 5770 5775 5780 5785 5790 5795 5800 5805 5810 5815 5820 5825 5830 5835 5840 5845 5850 5855 5860 5865 5870 5875 5880 5885 5890 5895 5900 5905 5910 5915 5920 5925 5930 5935 5940 5945 5950 5955 5960 5965 5970 5975 5980 5985 5990 5995 6000 6005 6010 6015 6020 6025 6030 6035 6040 6045 6050 6055 6060 6065 6070 6075 6080 6085 6090 6095 6100 6105 6110 6115 6120 6125 6130 6135 6140 6145 6150 6155 6160 6165 6170 6175 6180 6185 6190 6195 6200 6205 6210 6215 6220 6225 6230 6235 6240 6245 6250 6255 6260 6265 6270 6275 6280 6285 6290 6295 6300 6305 6310 6315 6320 6325 6330 6335 6340 6345 6350 6355 6360 6365 6370 6375 6380 6385 6390 6395 6400 6405 6410 6415 6420 6425 6430 6435 6440 6445 6450 6455 6460 6465 6470 6475 6480 6485 6490 6495 6500 6505 6510 6515 6520 6525 6530 6535 6540 6545 6550 6555 6560 6565 6570 6575 6580 6585 6590 6595 6600 6605 6610 6615 6620 6625 6630 6635 6640 6645 6650 6655 6660 6665 6670 6675 6680 6685 6690 6695 6700 6705 6710 6715 6720 6725 6730 6735 6740 6745 6750 6755 6760 6765 6770 6775 6780 6785 6790 6795 6800 6805 6810 6815 6820 6825 6830 6835 6840 6845 6850 6855 6860 6865 6870 6875 6880 6885 6890 6895 6900 6905 6910 6915 6920 6925 6930 6935 6940 6945 6950 6955 6960 6965 6970 6975 6980 6985 6990 6995 7000 7005 7010 7015 7020 7025 7030 7035 7040 7045 7050 7055 7060 7065 7070 7075 7080 7085 7090 7095 7100 7105 7110 7115 7120 7125 7130 7135 7140 7145 7150 7155 7160 7165 7170 7175 7180 7185 7190 7195 7200 7205 7210 7215 7220 7225 7230 7235 7240 7245 7250 7255 7260 7265 7270 7275 7280 7285 7290 7295 7300 7305 7310 7315 7320 7325 7330 7335 7340 7345 7350 7355 7360 7365 7370 7375 7380 7385 7390 7395 7400 7405 7410 7415 7420 7425 7430 7435 7440 7445 7450 7455 7460 7465 7470 7475 7480 7485 7490 7495 7500 7505 7510 7515 7520 7525 7530 7535 7540 7545 7550 7555 7560 7565 7570 7575 7580 7585 7590 7595 7600 7605 7610 7615 7620 7625 7630 7635 7640 7645 7650 7655 7660 7665 7670 7675 7680 7685 7690 7695 7700 7705 7710 7715 7720 7725 7730 7735 7740 7745 7750 7755 7760 7765 7770 7775 7780 7785 7790 7795 7800 7805 7810 7815 7820 7825 7830 7835 7840 7845 7850 7855 7860 7865 7870 7875 7880 7885 7890 7895 7900 7905 7910 7915 7920 7925 7930 7935 7940 7945 7950 7955 7960 7965 7970 7975 7980 7985 7990 7995 8000 8005 8010 8015 8020 8025 8030 8035 8040 8045 8050 8055 8060 8065 8070 8075 8080 8085 8090 8095 8100 8105 8110 8115 8120 8125 8130 8135 8140 8145 8150 8155 8160 8165 8170 8175 8180 8185 8190 8195 8200 8205 8210 8215 8220 8225 8230 8235 8240 8245 8250 8255 8260 8265 8270 8275 8280 8285 8290 8295 8300 8305 8310 8315 8320 8325 8330 8335 8340 8345 8350 8355 8360 8365 8370 8375 8380 8385 8390 8395 8400 8405 8410 8415 8420 8425 8430 8435 8440 8445 8450 8455 8460 8465 8470 8475 8480 8485 8490 8495 8500 8505 8510 8515 8520 8525 8530 8535 8540 8545 8550 8555 8560 8565 8570 8575 8580 8585 8590 8595 8600 8605 8610 8615 8620 8625 8630 8635 8640 8645 8650 8655 8660 8665 8670 8675 8680 8685 8690 8695 8700 8705 8710 8715 8720 8725 8730 8735 8740 8745 8750 8755 8760 8765 8770 8775 8780 8785 8790 8795 8800 8805 8810 8815 8820 8825 8830 8835 8840 8845 8850 8855 8860 8865 8870 8875 8880 8885 8890 8895 8900 8905 8910 8915 8920 8925 8930 8935 8940 8945 8950 8955 8960 8965 8970 8975 8980 8985 8990 8995 9000 9005 9010 9015 9020 9025 9030 9035 9040 9045 9050 9055 9060 9065 9070 9075 9080 9085 9090 9095 9100 9105 9110 9115 9120 9125 9130 9135 9140 9145 9150 9155 9160 9165 9170 9175 9180 9185 9190 9195 9200 9205 9210 9215 9220 9225 9230 9235 9240 9245 9250 9255 9260 9265 9270 9275 9280 9285 9290 9295 9300 9305 9310 9315 9320 9325 9330 9335 9340 9345 9350 9355 9360 9365 9370 9375 9380 9385 9390 9395 9400 9405 9410 9415 9420 9425 9430 9435 9440 9445 9450 9455 9460 9465 9470 9475 9480 9485 9490 9495 9500 9505 9510 9515 9520 9525 9530 9535 9540 9545 9550 9555 9560 9565 9570 9575 9580 9585 9590 9595 9600 9605 9610 9615 9620 9625 9630 9635 9640 9645 9650 9655 9660 9665 9670 9675 9680 9685 9690 9695 9700 9705 9710 9715 9720 9725 9730 9735 9740 9745 9750 9755 9760 9765 9770 9775 9780 9785 9790 9795 9800 9805 9810 9815 9820 9825 9830 9835 9840 9845 9850 9855 9860 9865 9870 9875 9880 9885 9890 9895 9900 9905 9910 9915 9920 9925 9930 9935 9940 9945 9950 9955 9960 9965 9970 9975 9980 9985 9990 9995 10000 10005 10010 10015 10020 10025 10030 10035 10040 10045 10050 10055 10060 10065 10070 10075 10080 10085 10090 10095 10100 10105 10110 10115 10120 10125 10130 10135 10140 10145 10150 10155 10160 10165 10170 10175 10180 10185 10190 10195 10200 10205 10210 10215 10220 10225 10230 10235 10240 10245 10250 10255 10260 10265 10270 10275 10280 10285 10290 10295 10300 10305 10310 10315 10320 10325 10330 10335 10340 10345 10350 10355 10360 10365 10370 10375 10380 10385 10390 10395 10400 10405 10410 10415 10420 10425 10430 10435 10440 10445 10450 10455 10460 10465 10470 10475 10480 10485 10490 10495 10500 10505 10510 10515 10520 10525 10530 10535 10540 10545 10550 10555 10560 10565 10570 10575 10580 10585 10590 10595 10600 10605 10610 10615 10620 10625 10630 10635 10640 10645 10650 10655 10660 10665 10670 10675 10680 10685 10690 10695 10700 10705 10710 10715 10720 10725 10730 10735 10740 10745 10750 10755 10760 10765 10770 10775 10780 10785 10790 10795 10800 10805 10810 10815 10820 10825 10830 10835 10840 10845 10850 10855 10860 10865 10870 10875 10880 10885 10890 10895 10900 10905 10910 10915 10920 10925 10930 10935 10940 10945 10950 10955 10960 10965 10970 10975 10980 10985 10990 10995 11000 11005 11010 11015 11020 11025 11030 11035 11040 11045 11050 11055 11060 11065 11070 11075 11080 11085 11090 11095 11100 11105 11110 11115 11120 11125 11130 11135 11140 11145 11150 11155 11160 11165 11170 11175 11180 11185 11190 11195 11200 11205 11210 11215 11220 11225 11230 11235 11240 11245 11250 11255 11260 11265 11270 11275 11280 11285 11290 11295 11300 11305 11310 11315 11320 11325 11330 11335 11340 11345 11350 11355 11360 11365 11370 11375 11380 11385 11390 11395 11400 11405 11410 11415 11420 11425 11430 11435 11440 11445 11450 11455 11460 11465 11470 11475 11480 11485 11490 11495 11500 11505 11510 11515 11520 11525 11530 11535 11540 11545 11550 11555 11560 11565 11570 11575 11580 11585 11590 11595 11600 11605 11610 11615 11620 11625 11630 11635 11640 11645 11650 11655 11660 11665 11670 11675 11680 11685 11690

separator, which may be a solid plate with holes. This allows the liquid to pass, while removing entrained air and helping to separate the two liquid states (liquid vs. gas). The air separator may have various designs, such as an angled solid shelf with holes, a spiraling ramp, a spiraling ramp with holes, two or more levels of angled shelves with holes, multiple  
5 spiraling ramps, similar to a multiple starting points for threads, (bottle caps, etc), sporadically located bosses that the liquid hits as it drops, assisting in separation.

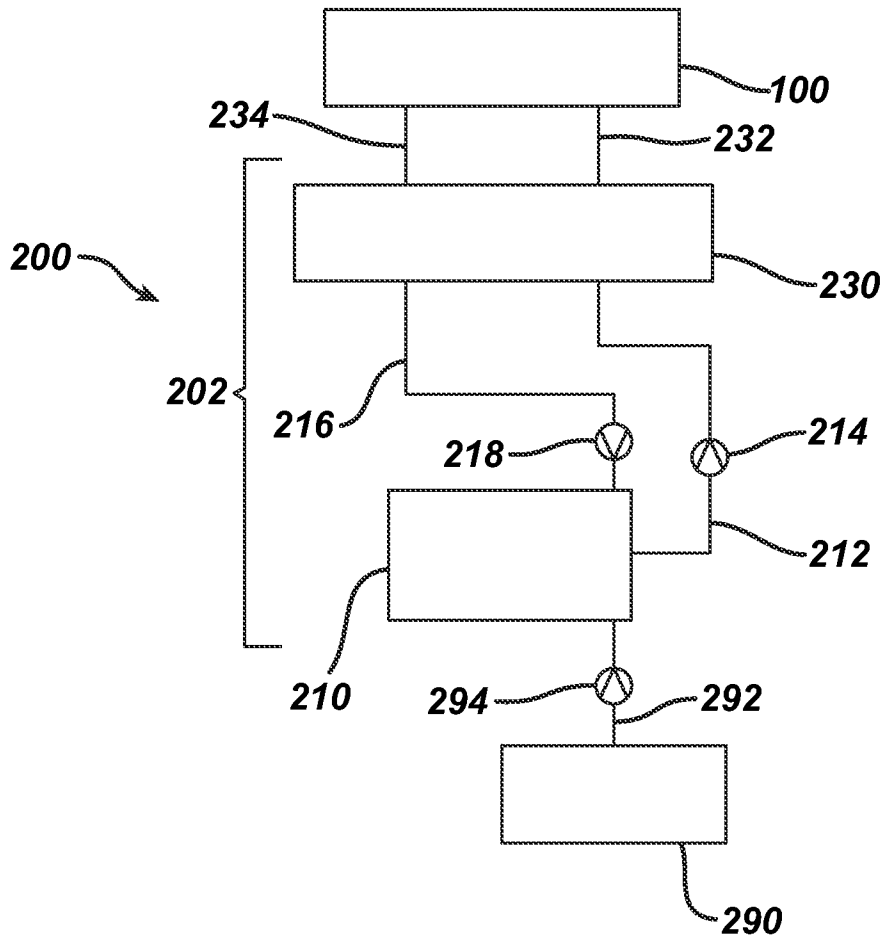
In one embodiment, the base unit be a self-contained, portable unit with a rechargeable battery, have a motor-driven piston pump for liquid delivery, have a mechanism to control the liquid flow, keep the temperature within a specified range, be modular in design, and have  
10 ergonomics well-suited to the user's hand. When the hand piece is in the base station, it will recharge the battery, refill the liquid reservoirs in the hand piece from those in the base station, and exchange samples and/or diagnostic information with the base station. It may also go through a cleaning process.

**What is claimed is:**

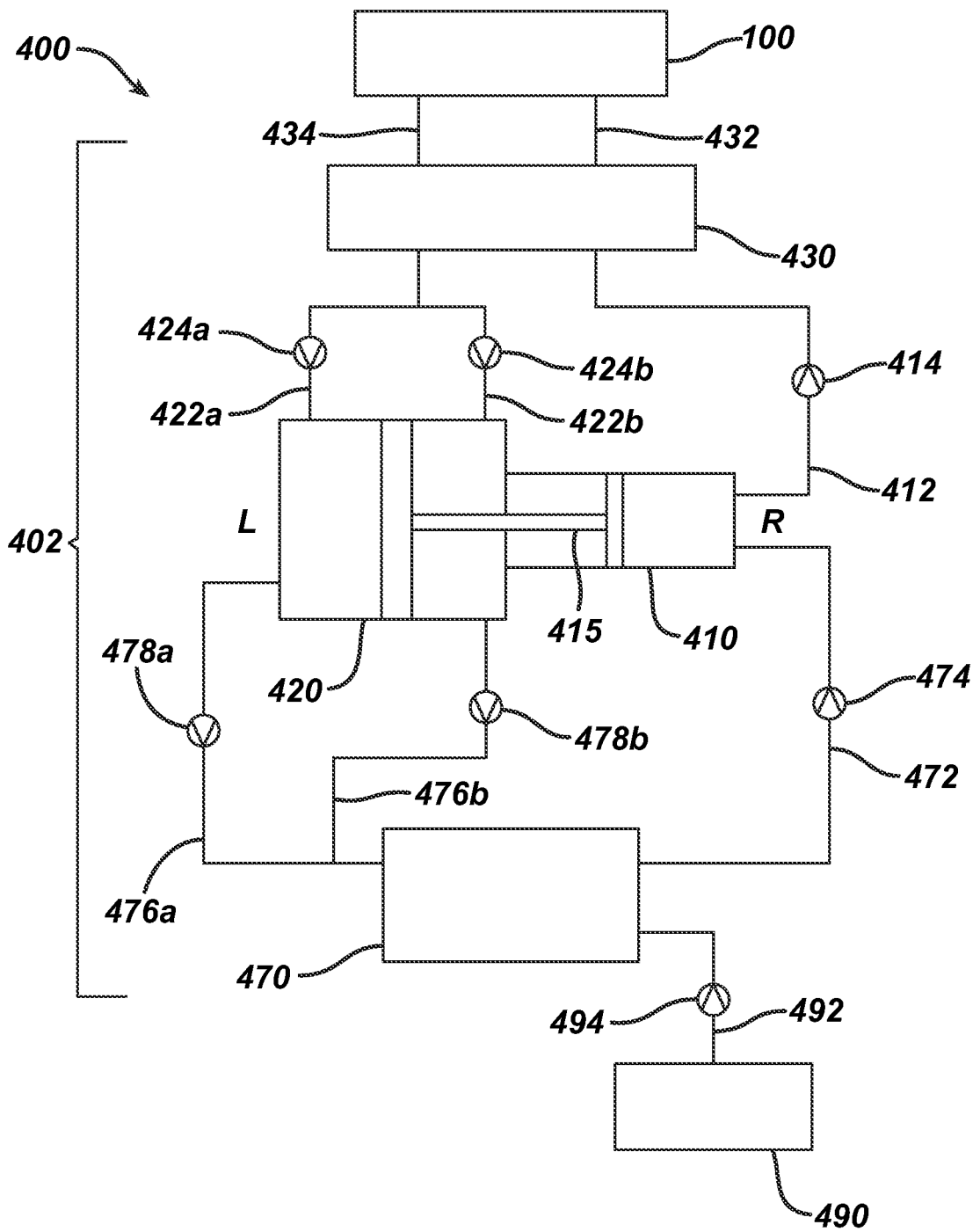
1. A device for directing a liquid onto a plurality of surfaces of an oral cavity of a mammal, said device comprising:
    - a handle, comprising;
      - first and second ports for receiving said liquid in said handle, said first and second ports located at a proximal end of said handle; and
      - first and second channels for transporting said liquid, said first and second channels connected to said first and second ports at said proximal end of said handle and extending longitudinally through said handle;
    - a neck, comprising;
      - said first and second channels for transporting said liquid extending longitudinally through said neck; and
    - a head, comprising:
      - a cleaning component, said cleaning component comprising a chamber for maintaining said liquid proximate said plurality of surfaces, said chamber defined by proximal and distal sealing membranes, first and second inner side walls extending longitudinally between said first and second sealing membranes, and a base inner wall extending horizontally between said first and second inner side walls and longitudinally between said proximal and distal sealing membranes, said first and second inner side walls comprising a plurality of openings,
      - a first manifold for containing a first portion of said liquid and providing said first portion to said chamber through said openings of said first inner side wall,
      - a second manifold for containing a second portion of said liquid and providing said second portion to said chamber through said openings of said second inner side wall,
      - a first port for conveying said first portion of liquid to and/or from said first manifold; and
      - a second port for conveying said second portion of liquid to and/or from said second manifold
- wherein said cleaning component is rotatable around the horizontal and longitudinal axis of said head.

2. The device of claim 1 further comprising means for attaching said device to means for providing said liquid to said device.
3. The device of claim 2 wherein said attachment means comprises a quick disconnect structure for attaching said device to said means for providing said liquid to said device.
4. The device of claim 1 comprising a plurality of first lumens connected by said first manifold and a plurality of second lumens connected by said second manifold.
5. The device of claim 1 wherein the number, location and cross-sectional geometry of said openings are effective to provide a spray pattern effective to provide a beneficial effect to the oral cavity.
6. The device of claim 1 comprising a second cleaning component for providing substantially simultaneous contact of a plurality of surfaces of both top and bottom sections of said oral cavity.
7. The device of claim 5 wherein the cross-sectional geometry of said openings is selected from the group consisting of circular, elliptical and trapezoidal.
8. The device of claim 1 wherein said base inner wall comprises a flexible membrane for providing said effective seal.
9. The device of claim 8 comprising a flexible gum-sealing membrane for providing said effective seal.

**FIG. 1**

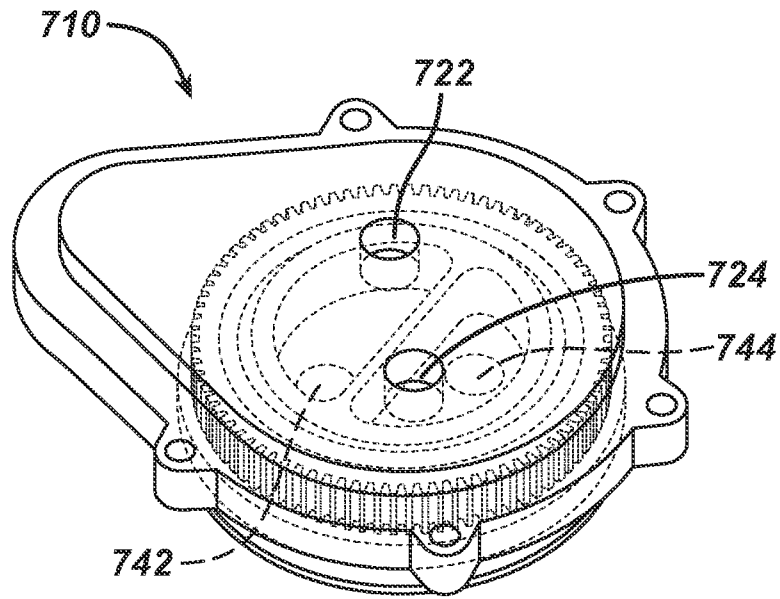


**FIG. 2**

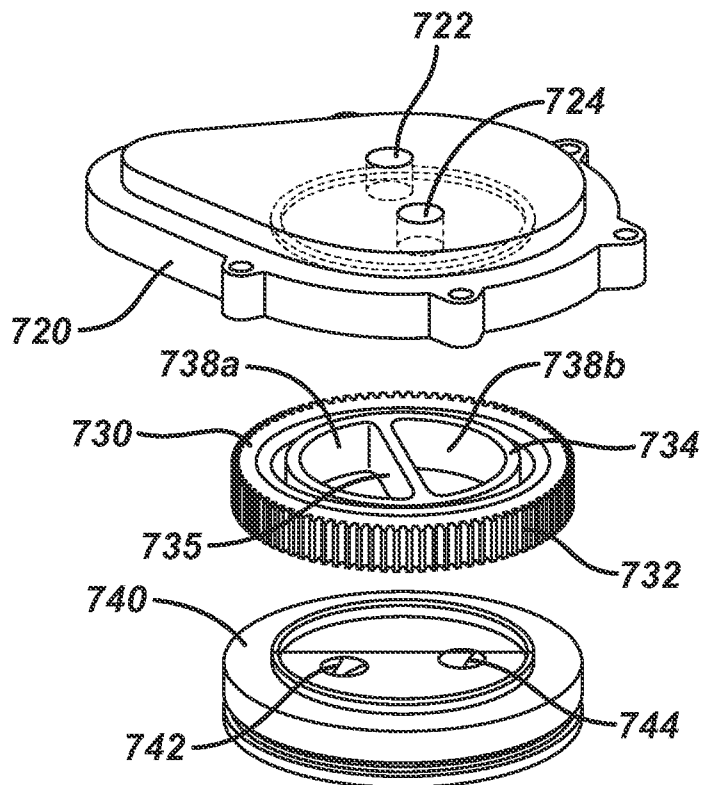




3/15

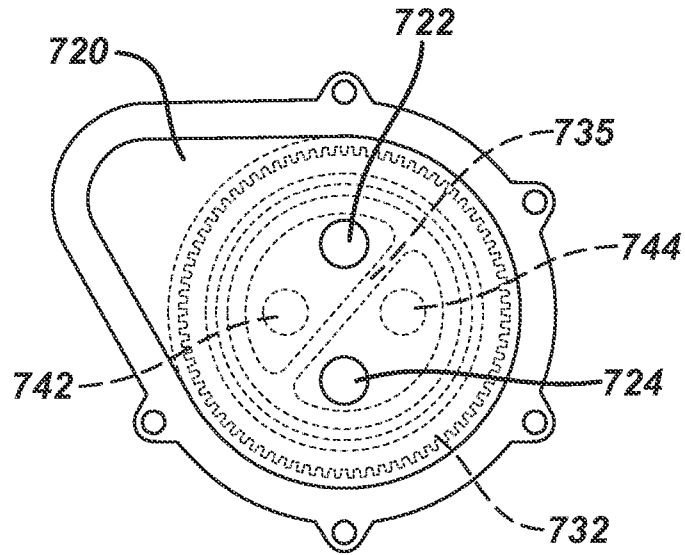


**FIG. 3a**

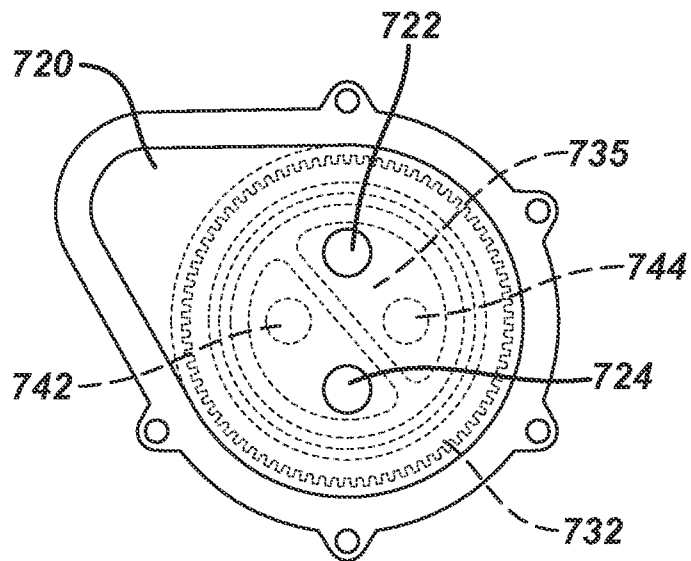


**FIG. 3b**

4/15

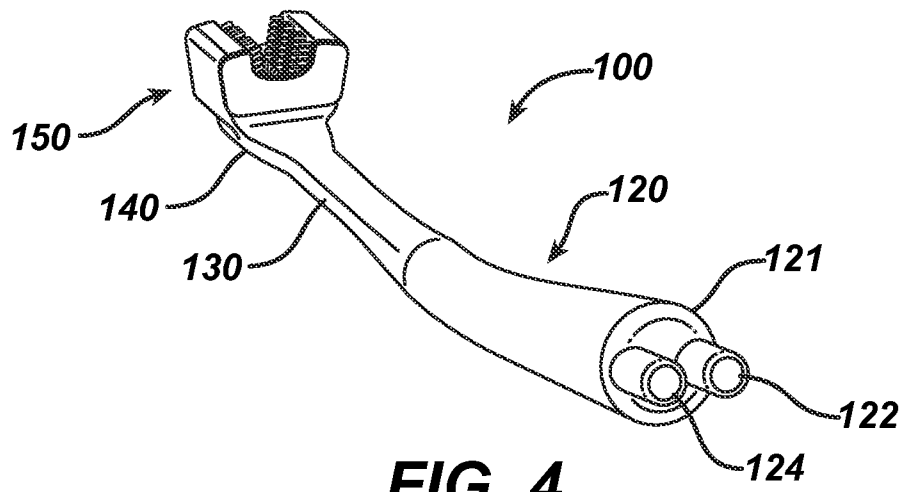


**FIG. 3c**

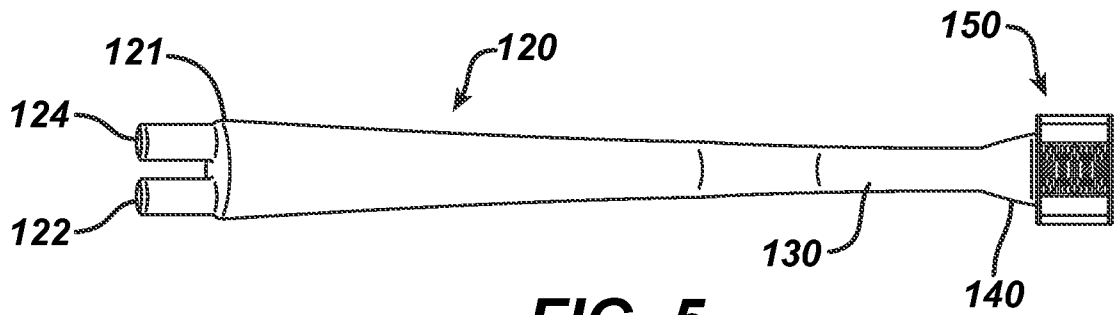


**FIG. 3d**

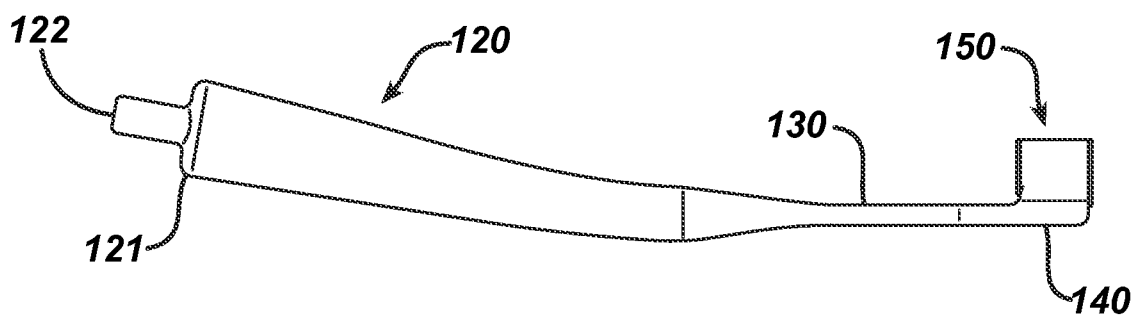
5/15



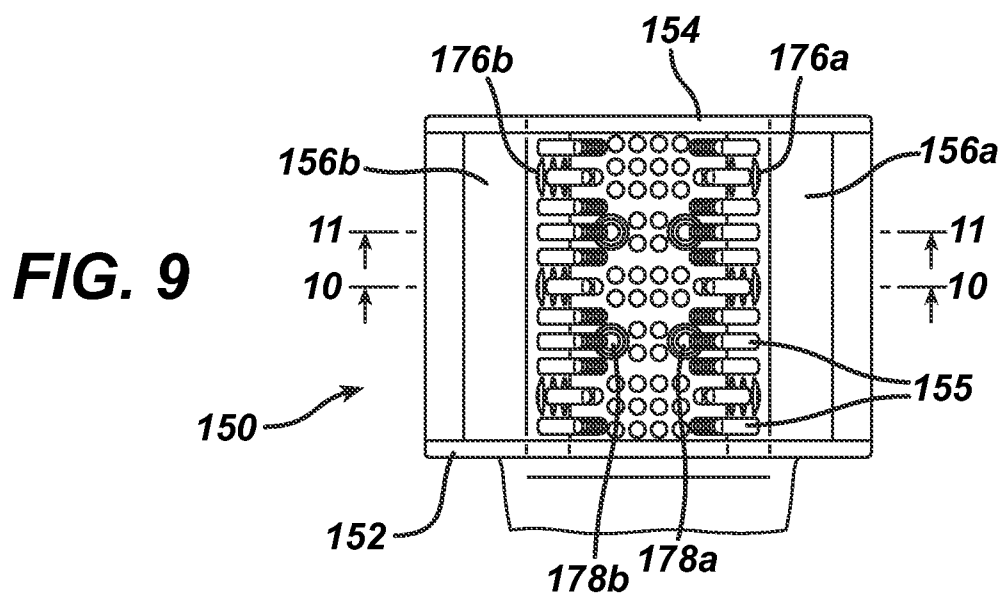
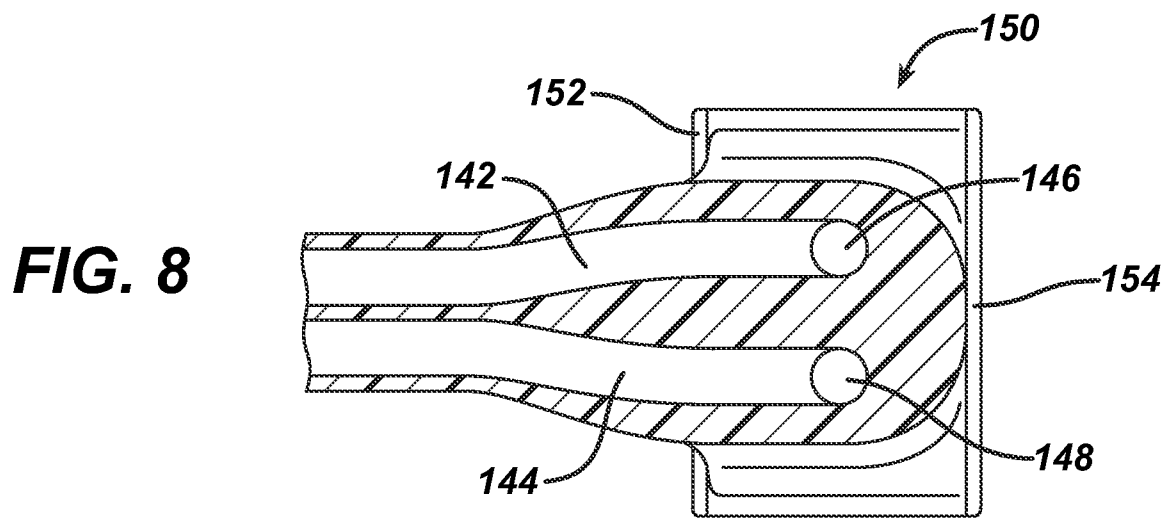
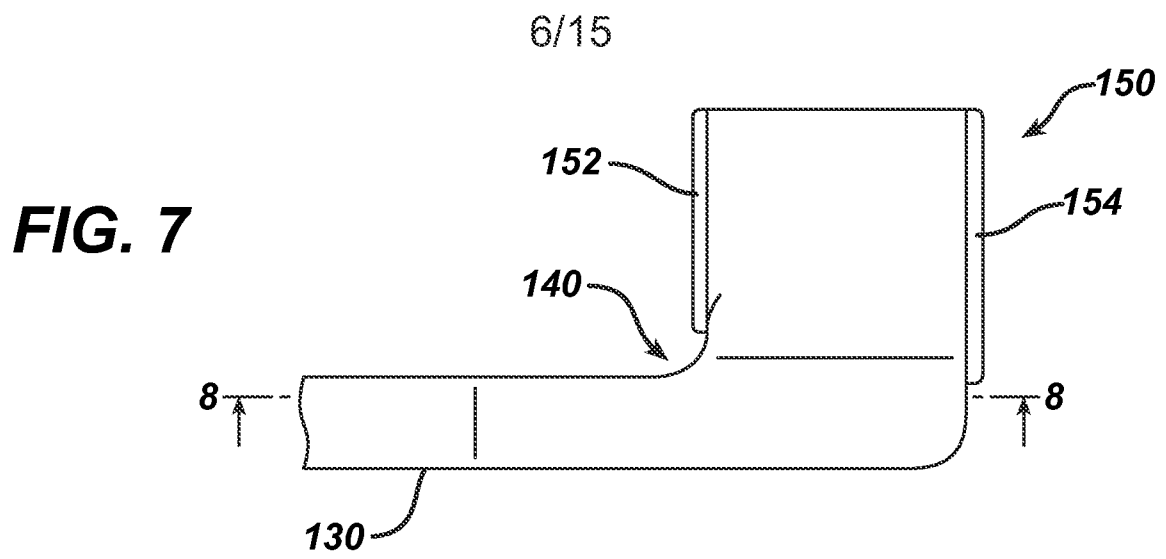
**FIG. 4**



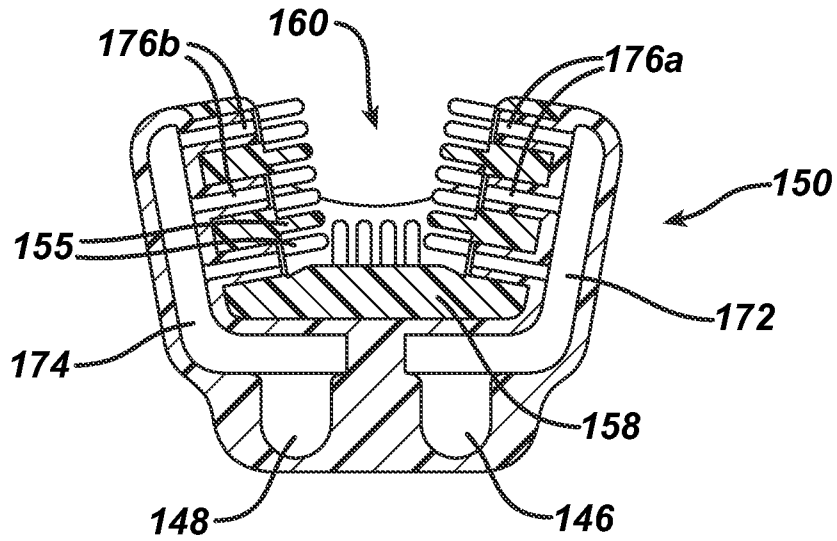
**FIG. 5**



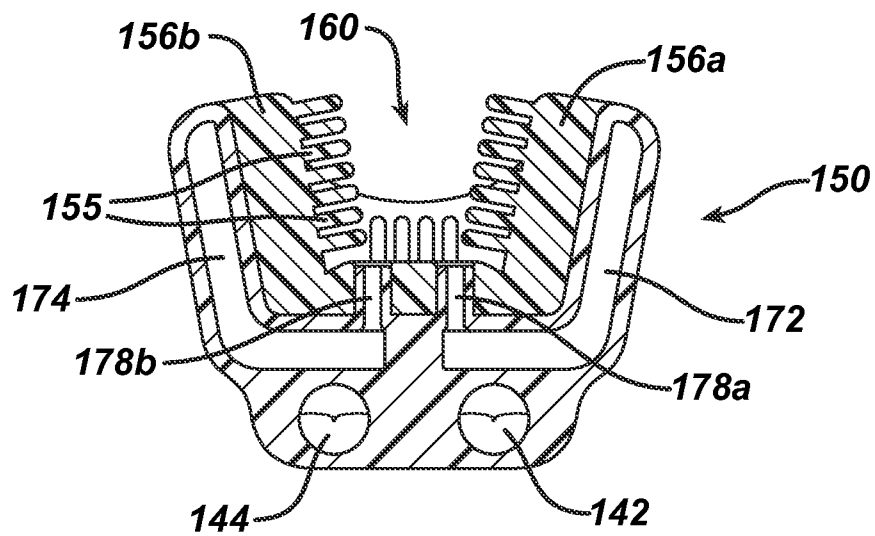
**FIG. 6**



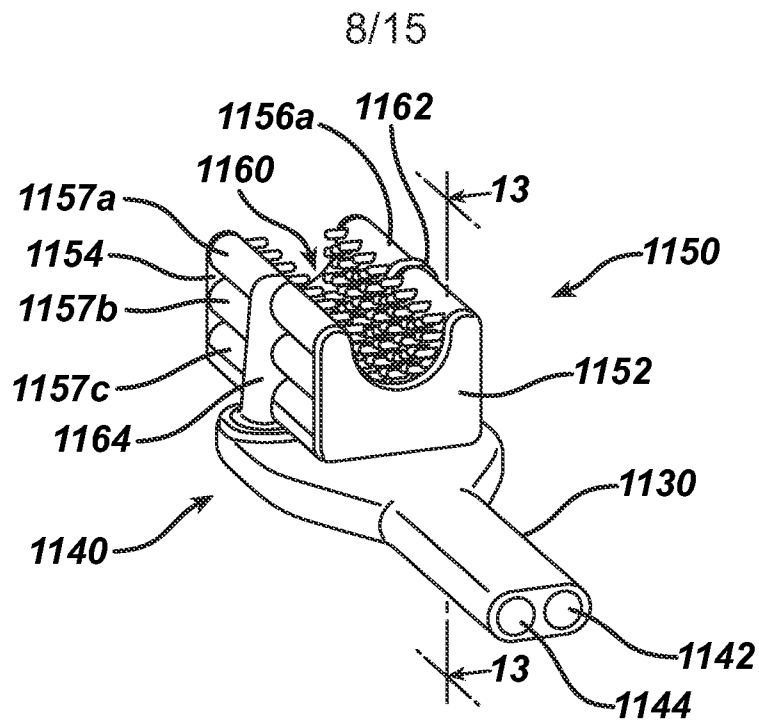
7/15



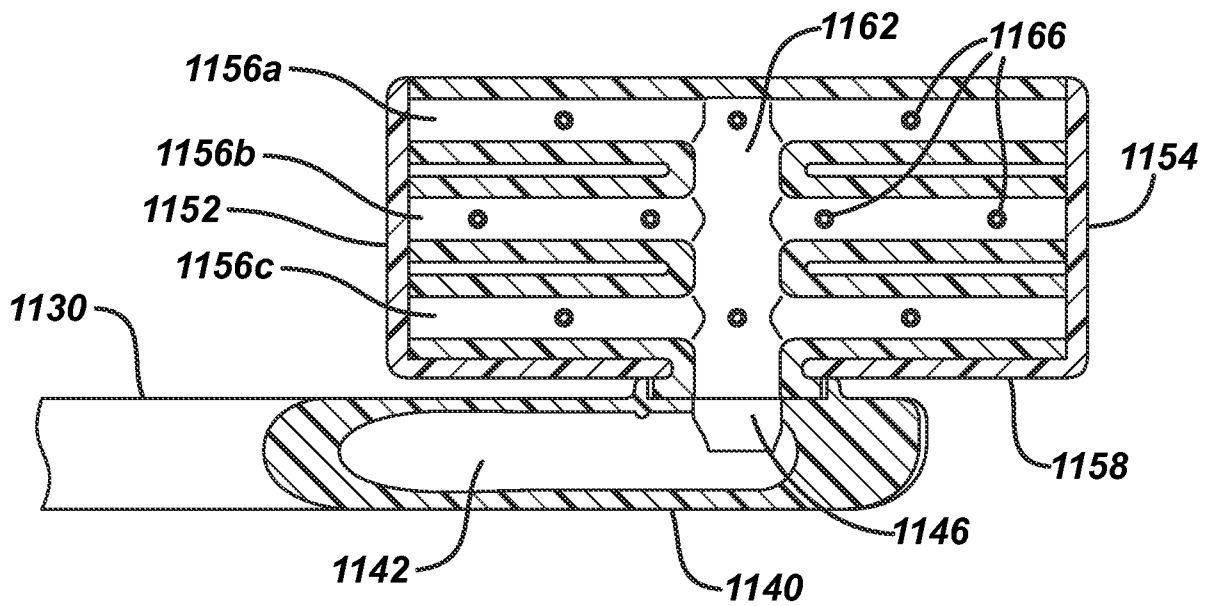
**FIG. 10**



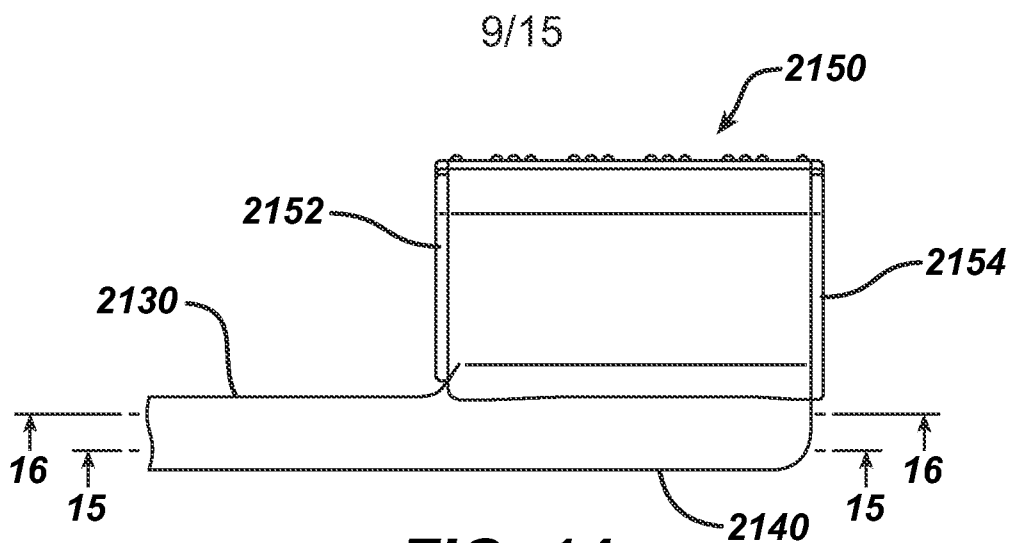
**FIG. 11**



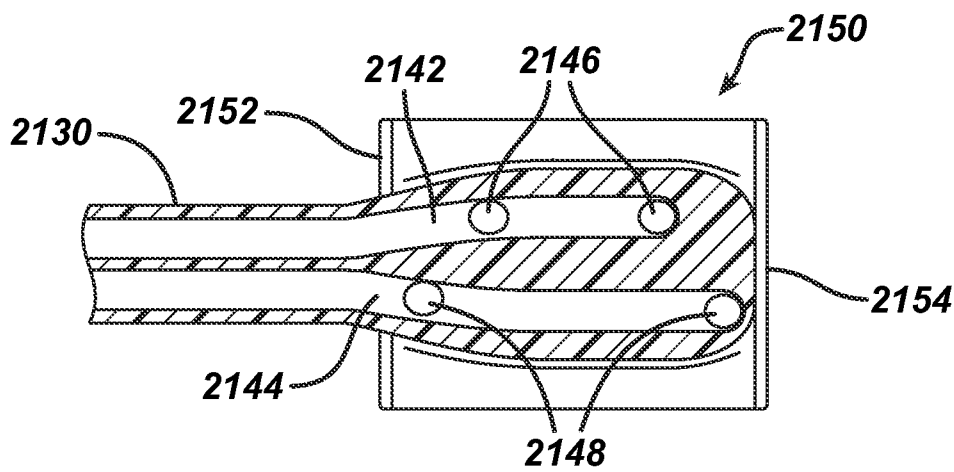
**FIG. 12**



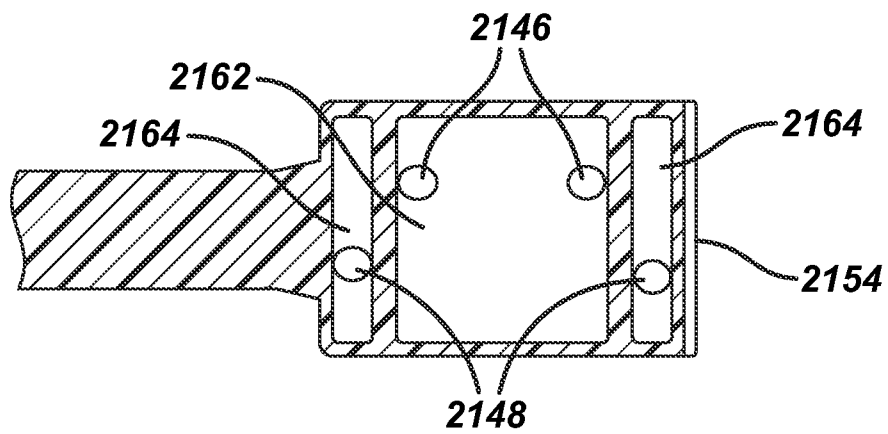
**FIG. 13**



**FIG. 14**

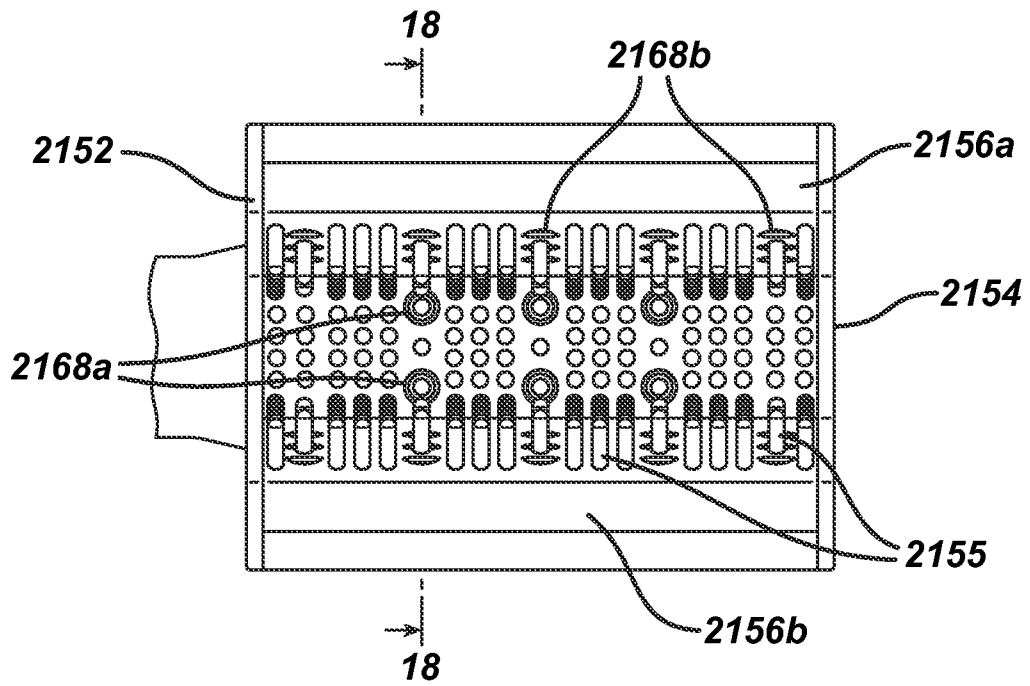


**FIG. 15**

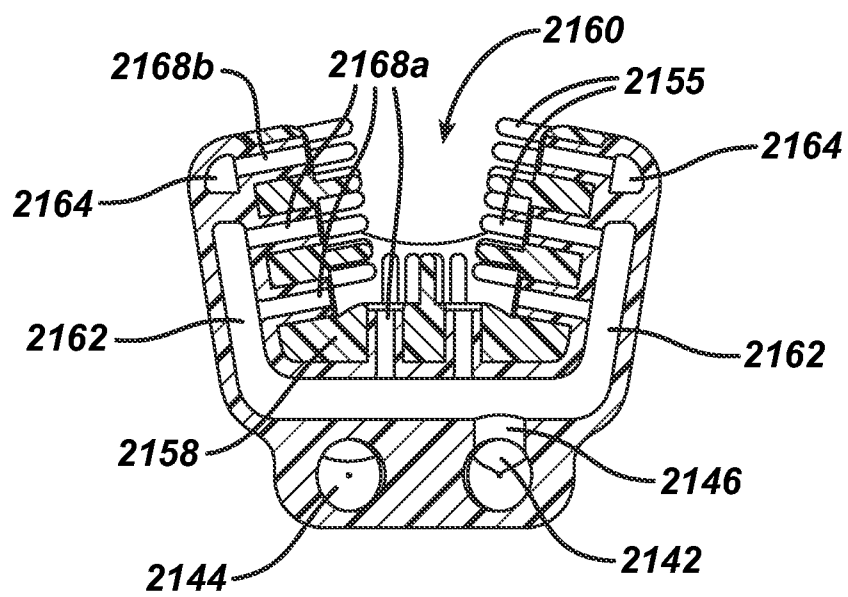


**FIG. 16**

10/15



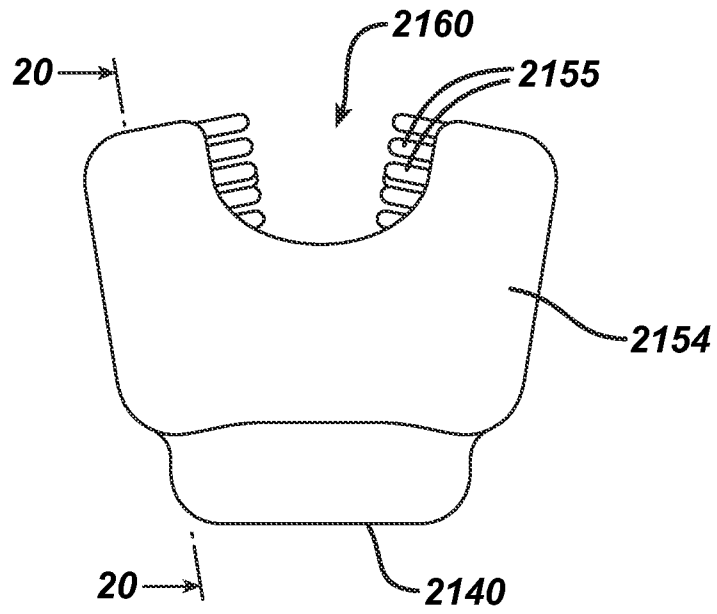
**FIG. 17**



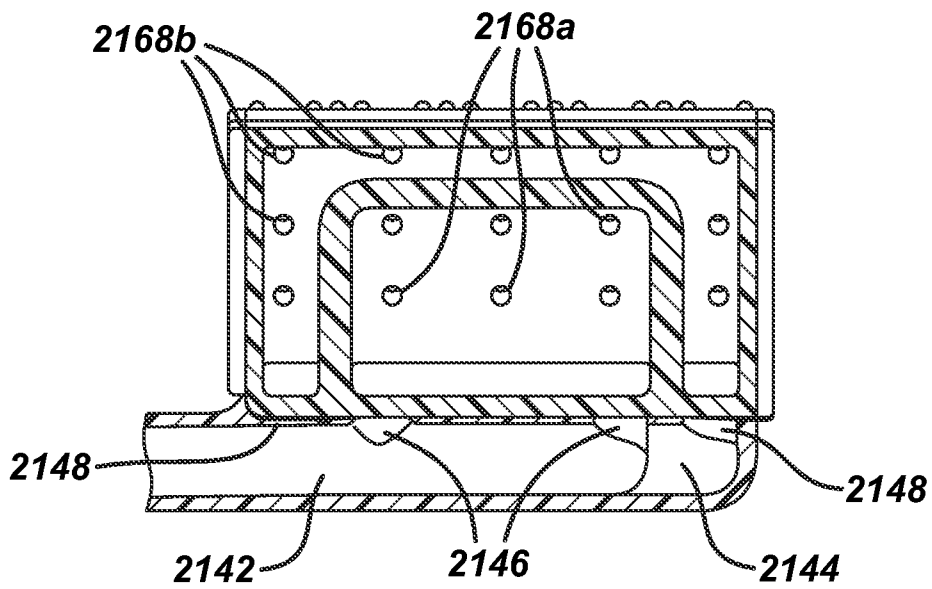
**FIG. 18**



11/15

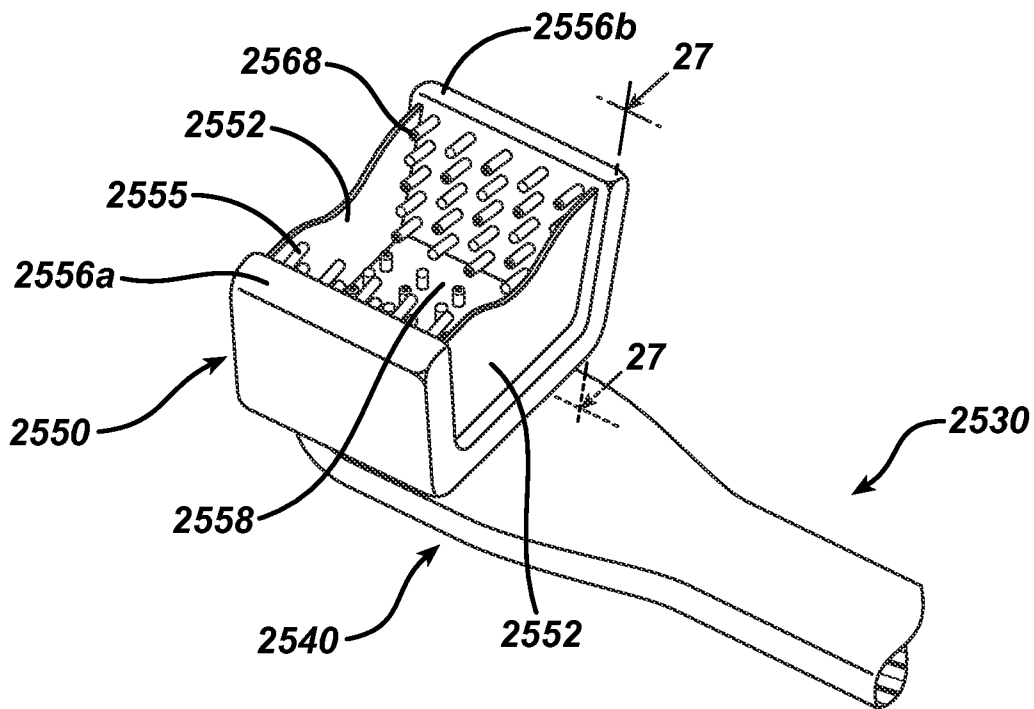


**FIG. 19**

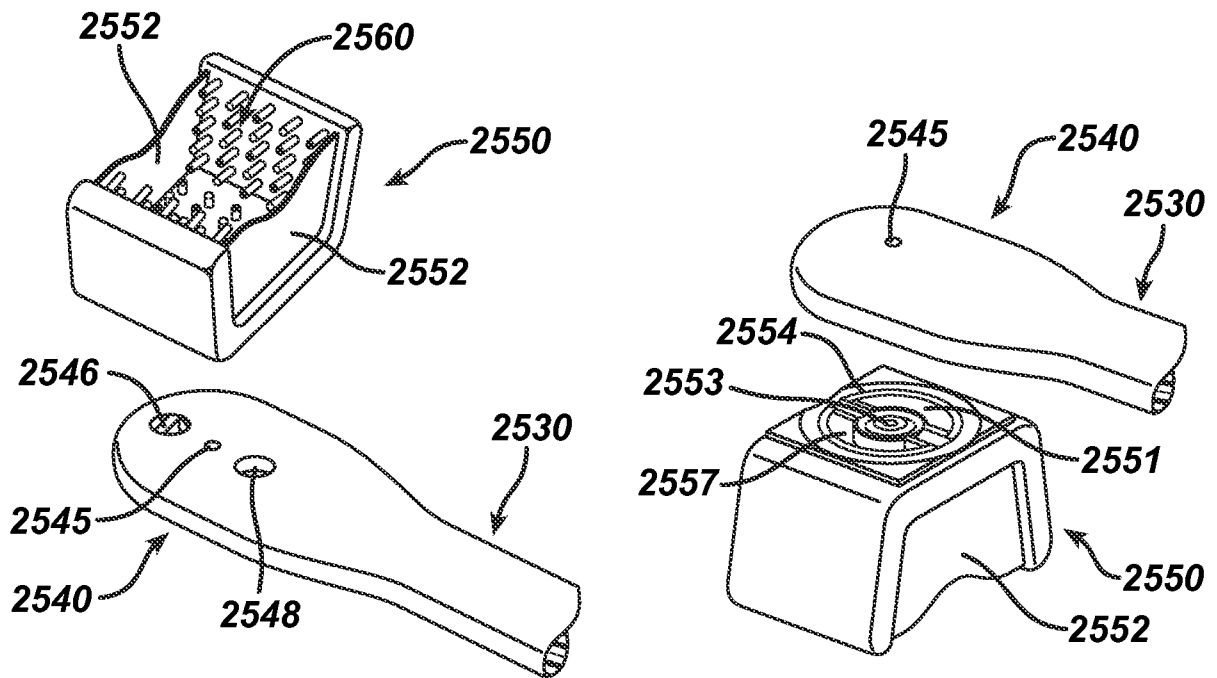


**FIG. 20**

12/15



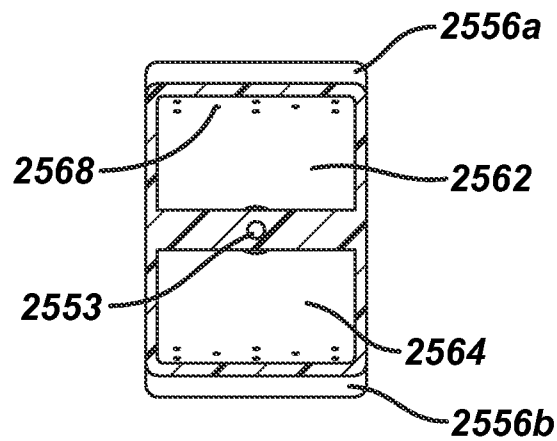
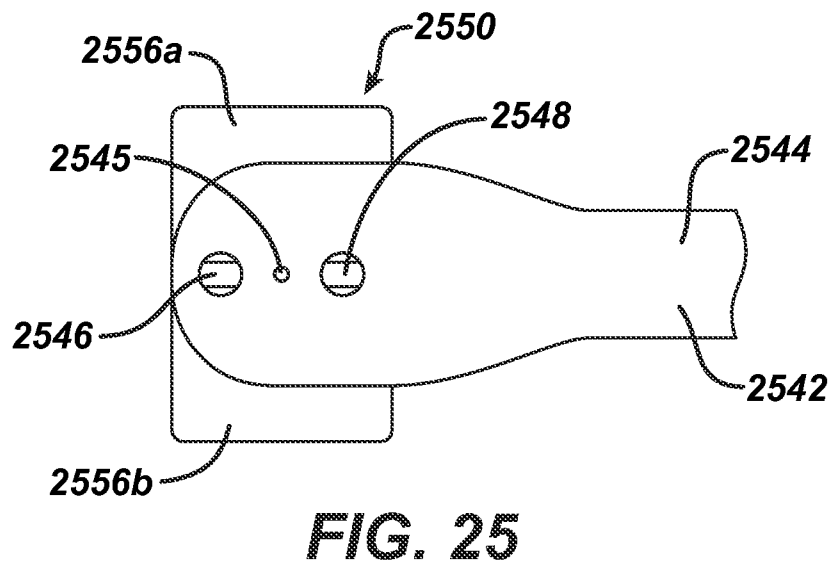
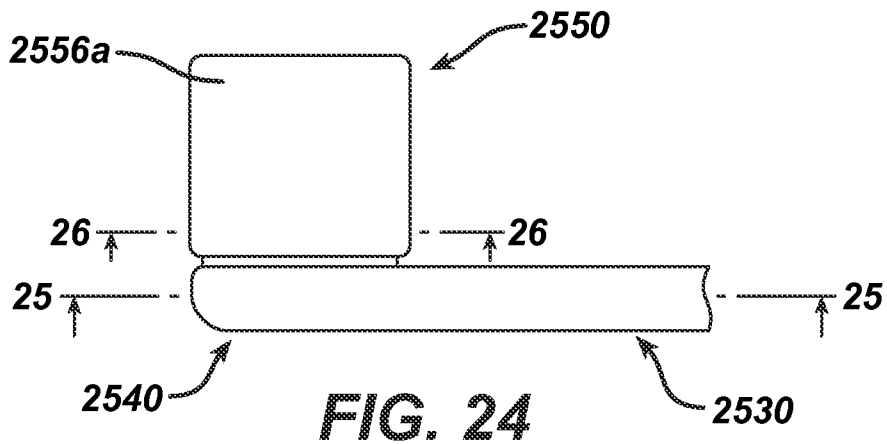
**FIG. 21**

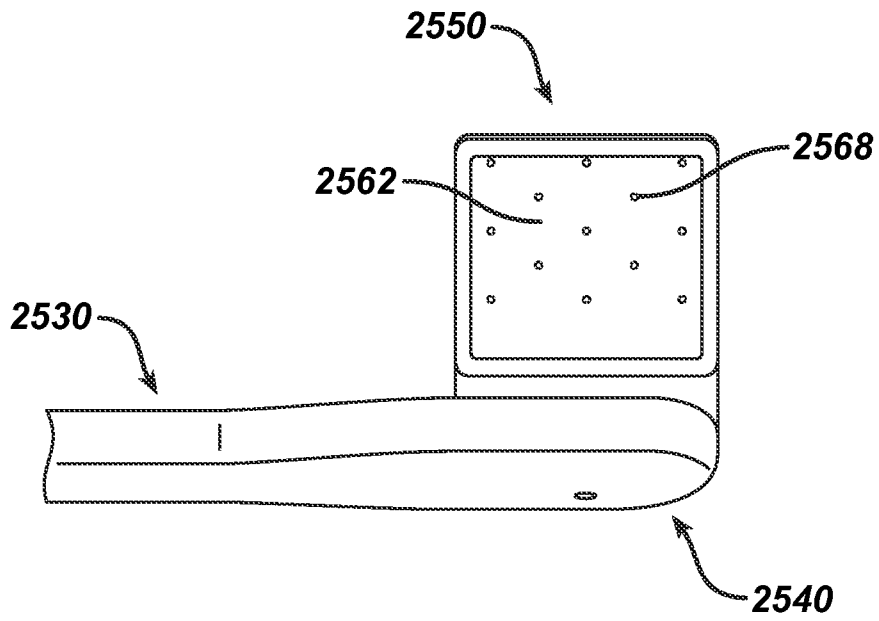


**FIG. 22**

**FIG. 23**

13/15





**FIG. 27**

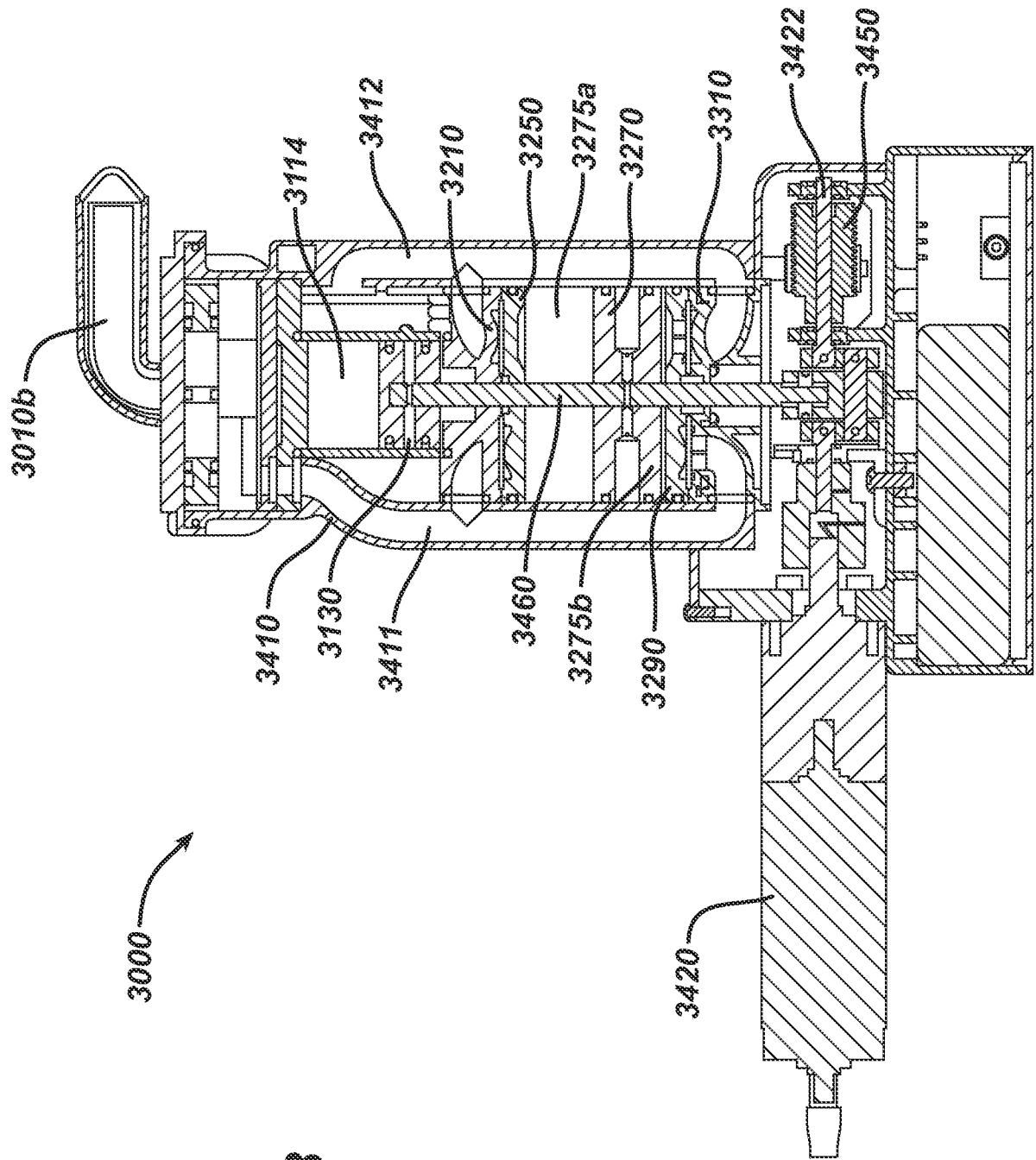


FIG. 28