



- (51) International Patent Classification:
G06F 13/14 (2006.01) *G06F 1/16* (2006.01)
- (21) International Application Number:
PCT/US2014/048452
- (22) International Filing Date:
28 July 2014 (28.07.2014)
- (25) Filing Language: English
- (26) Publication Language: English
- (71) Applicant: **HEWLETT-PACKARD DEVELOPMENT COMPANY, L.P.** [US/US]; 11445 Compaq Center Drive W., Houston, Texas 77070 (US).
- (72) Inventors: **NGUYEN, Michael Dai-Duong**; 11445 Compaq Center Dr. W, Houston, Texas 77070 (US). **TRUONG, Binh T.**; 11445 Compaq Center Dr. W, Houston, Texas 77070 (US). **AUSTIN, Peter W.**; 11445 Compaq Center Dr. W, Houston, Texas 77070 (US).

- (74) Agents: **MAISAMI, Ceyda Azakli** et al.; Hewlett-Packard Company, Intellectual Property Administration, Mail Stop 35, 3404 E. Harmony Road, Fort Collins, Colorado 80528 (US).
- (81) Designated States (*unless otherwise indicated, for every kind of national protection available*): AE, AG, AL, AM, AO, AT, AU, AZ, BA, BB, BG, BH, BN, BR, BW, BY, BZ, CA, CH, CL, CN, CO, CR, CU, CZ, DE, DK, DM, DO, DZ, EC, EE, EG, ES, FI, GB, GD, GE, GH, GM, GT, HN, HR, HU, ID, IL, IN, IR, IS, JP, KE, KG, KN, KP, KR, KZ, LA, LC, LK, LR, LS, LT, LU, LY, MA, MD, ME, MG, MK, MN, MW, MX, MY, MZ, NA, NG, NI, NO, NZ, OM, PA, PE, PG, PH, PL, PT, QA, RO, RS, RU, RW, SA, SC, SD, SE, SG, SK, SL, SM, ST, SV, SY, TH, TJ, TM, TN, TR, TT, TZ, UA, UG, US, UZ, VC, VN, ZA, ZM, ZW.
- (84) Designated States (*unless otherwise indicated, for every kind of regional protection available*): ARIPO (BW, GH, GM, KE, LR, LS, MW, MZ, NA, RW, SD, SL, SZ, TZ, UG, ZM, ZW), Eurasian (AM, AZ, BY, KG, KZ, RU, TJ,

[Continued on next page]

(54) Title: CONNECTING A PERIPHERAL DEVICE

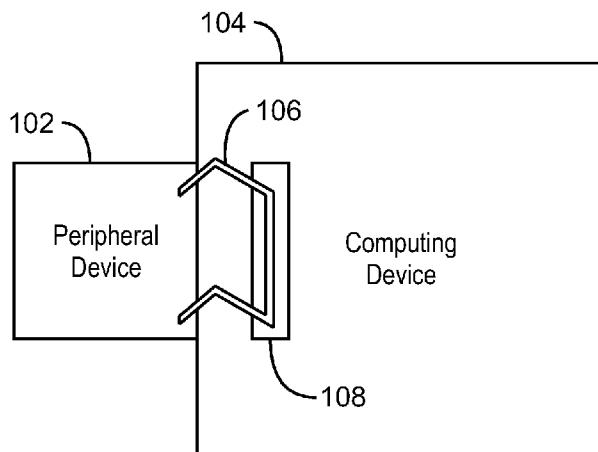

(57) Abstract: The present disclosure describes a peripheral device. The peripheral device includes a device communication port to communicatively couple with a computer communication port on a computer. The peripheral device includes an automatic latch to mechanically secure the peripheral device to the computer by applying pressure in a direction that connects the device communication port and the computer communication port. The peripheral device includes a ground retention clip, to establish surface contact with an exterior surface of the computer to electrically ground the peripheral device.

100
FIG. 1A



TM), European (AL, AT, BE, BG, CH, CY, CZ, DE, DK, EE, ES, FI, FR, GB, GR, HR, HU, IE, IS, IT, LT, LU, LV, MC, MK, MT, NL, NO, PL, PT, RO, RS, SE, SI, SK, SM, TR), OAPI (BF, BJ, CF, CG, CI, CM, GA, GN, GQ, GW, KM, ML, MR, NE, SN, TD, TG).

— *as to applicant's entitlement to apply for and be granted a patent (Rule 4.17(ii))*

Published:

— *with international search report (Art. 21(3))*

Declarations under Rule 4.17:

— *as to the identity of the inventor (Rule 4.17(i))*

CONNECTING A PERIPHERAL DEVICE

BACKGROUND

[0001] A peripheral device typically connects to another computing device to provide additional functionality. Peripheral devices may include a number of different devices, such as a magnetic card reader, camera, printer, biometric sensor, and many others. In a number of working environments, it is useful to have the peripheral device secured to the computing device in a stable position. For example, at a point of sale, i.e., cash register, the card reader is installed so that the force of swiping the card through the reader does not disconnect, or possibly damage, the two devices.

BRIEF DESCRIPTION OF THE DRAWINGS

[0002] Certain exemplary embodiments are described in the following detailed description and in reference to the drawings, in which:

[0003] Figs. 1A-1B are block diagrams of an example system for connecting a peripheral device.

[0004] Figs. 2A-2D are block diagrams of example peripheral devices for connecting to a computing device.

[0005] Fig. 3 is a block diagram of an example ground retention clip, in accordance with examples.

DETAILED DESCRIPTION

[0006] Connected peripheral devices are secured to the computing device using two screws on either side of the communication port. However, attaching and removing the peripheral device can be time consuming and tedious. The screws may not be accessible from outside the device, meaning parts of the computing device are removed just to get to the screws. Further, there may be various types of screws. As such, a tool such as a screwdriver may not be useful. Instead, the tool may be provided by the peripheral device manufacturer. This means that if the tool is lost somewhere between the manufacturer, reseller, and the customer, the customer may not be able install the

device until ordering, and receiving, a replacement tool. Accordingly, an alternative to connecting peripheral devices may be useful.

[0007] Examples of the claimed subject matter provide peripheral devices and computing devices that may be stably connected at a communication port, and disconnected from the port, without tools. These examples enable faster connection and disconnection times than possible between current peripheral and computing devices. Examples are described in greater detail with respect to Fig. 1.

[0008] Fig. 1A is a front view of a system 100 for securing a peripheral device 102 to a computing device 104, in accordance with examples. The peripheral device 102 can be coupled to the computing device 104 to provide additional functionality. The peripheral device 102 refers to a modular device with small form factor that adds functionality to the computing device 104 by communicatively coupling to the computer via a communication port. The peripheral device 102 may be a web cam, a bar code scanner, a card reader, a finger print scanner, or a reverse-facing display screen. The computing device 104 may be a standard desktop computer, a desktop with all-in-one form factor, a tablet computer, laptop computer, point of sale device, and so on. In addition to the communicative connection, the peripheral device 102 is mechanically secured to the computing device 104 such that the peripheral device 102 stays rigid in relation to the computing device 104.

[0009] The peripheral device 102 includes a cross-bar lever 106 that is disposed within a receptacle 108 of the computing device 104. In one example, the cross-bar lever 106 automatically locks upon insertion. The cross-bar lever 106 latches onto the computing device 104 to lock the devices 102, 104 into position for stability. When connected, the cross-bar lever 106 is fixed within the receptacle 108. The cross-bar lever 106 constrains any degree of motion between the peripheral device 102 and the computing device 104. Additionally, the cross-bar lever 106 may be spring loaded to a position that maintains the rigid relationship between the devices 102, 104. To disconnect the device 102, a tab lever (not shown) may be pulled, which lifts the cross-bar lever 106 from the receptacle 108. In this position, it is possible to disconnect the peripheral device 102 from the computing device 104. The tab lever may be used to secure and eject the cross-bar lever 106.

[0010] In an example of the claimed subject matter, the tab lever may be attached to the cross-bar lever 106. By applying pressure to the tab, the latch 106 may be automatically locked into the receptacle, or lifted from the receptacle 108. In another example, the tab lever may be incorporated within the peripheral device 102 as a button that pops up when the devices 102, 104 are connected. Accordingly, while the devices 102, 104 remain connected, pressing the tab-lever button lifts the cross-bar lever 106 from the receptacle. In another example, a tab-lever button may be incorporated within the computing device 104. The tab-levers described here are merely examples, and not an exhaustive list. Rather, any tab-lever capable of automatically locking the cross-bar lever 106 into the receptacle 108, or automatically lifting the cross-bar lever 106 from the receptacle 108 may be used.

[0011] Fig. 1B is a side perspective view of the peripheral device 102 and the computing device 104, in accordance with examples. The peripheral device 102 includes a device communication port 110. Correspondingly, the computing device 104 includes a computer communication port 112. The device communication port 110 and the computer communication port 112 may utilize any number of communications protocols, proprietary, industry-standard, and so on. For example, the device communication port 110 and the computer communication port 112 may be Universal Serial Bus (USB) ports. When connected, the device communication port 110 is connected with the computer communication port 112. The computing device 104 also includes a processor 114, and a system memory 116. The processor 114 executes computer instructions stored in system memory 116.

[0012] FIG. 2A is a back perspective view of a magnetic card reading peripheral device 202 and cross-bar lever 206, in accordance with examples. The device 202 includes USB communication port 204 and lever attachments 208. The lever attachments 208 may provide a receptacle for securing the cross-bar lever 206 to the device 202. In one example, the attachments 208 may include springs (not shown) that provide a range of motion for the device 202 in relation to the cross-bar lever 206. Additionally, such springs may return the device 202 to a position for connecting the device 202 to an example computing device 104.

[0013] All peripheral devices 102 have electromagnetic compatibility (EMC) regulations with which to conform. These regulations enable the safe operation of electronic devices, and require that electronic devices provide a ground metal contact. Currently, the screws used to secure typical peripheral devices also provide this ground metal contact. However, example peripheral devices 102 do not include screws to secure the peripheral device 102 to the computing device. Accordingly, example peripheral devices 102 provide ground metal contact without the use of screws. Instead of screws, peripheral devices 102 include a ground retention clip that provide ground metal contacts between the peripheral device 202 and the computing device 104. The ground retention clip is described in greater detail with respect to Figs. 2B, 2C, and 3.

[0014] Fig. 2B is a front perspective view of the device 202, in accordance with examples. The device 202 includes the USB port 204 and ground metal contacts 206. When the peripheral device 202 is connected, the ground metal contacts 206 provide contact between the computing device 104 and a chassis of the peripheral device. The ground metal contacts 206 are exposed surfaces of the ground retention clip, which is secured within the device 202.

[0015] Fig. 2C is a bottom perspective view of the device 202 with covering removed, in accordance with examples. The device includes a ground retention clip 208, secured to, and in contact with, the chassis of the device 202. The surface of the ground retention clip 208 is exposed through an opening, providing the ground metal contacts 206.

[0016] Fig. 3 is a block diagram of an example ground retention clip 300, in accordance with examples. Example peripheral devices 102 may include a ground retention clip 300 to provide grounding contact with a connected computing device 104. The ground retention clip 300 is installed within the peripheral device 102 such that the clip 300 is in electrical contact with the chassis of the peripheral device 102. Additionally, once installed in the peripheral device 102, a portion of the clip 300 is externally exposed to provide the electrical contacts to the computing device 104. It is noted that examples of the claimed subject matter are not limited to the design shown in Figure 3. Rather, the ground retention clip 300 may be of any shape that, when

installed, provides electrical contact with the chassis, and electric contact with the computing device 104, once secured.

[0017] Advantageously, a tool is not needed to connect or disconnect example peripheral devices. This tool-less technique enables suppliers and resellers of connected devices 102, 104 to reduce the time for assembly. This time savings translates to cost savings. Original design manufacturers, suppliers, and resellers, who sell connected peripheral and computing devices, can save expenses in assembling example systems. In addition, faster service repair and replacement is possible with example systems because the peripheral devices 102 can be disconnected without tools.

[0018] While the present techniques may be susceptible to various modifications and alternative forms, the exemplary examples discussed above have been shown only by way of example. It is to be understood that the technique is not intended to be limited to the particular examples disclosed herein. Indeed, the present techniques include all alternatives, modifications, and equivalents falling within the true spirit and scope of the appended claims.

CLAIMS

What is claimed is:

1. A peripheral device, comprising:
a device communication port to communicatively couple with a computer communication port on a computer;
an automatic latch to mechanically secure the peripheral device to the computer by applying pressure in a direction that connects the device communication port and the computer communication port; and
a ground retention clip to establish surface contact with an exterior surface of the computer to electrically ground the peripheral device.

2. The peripheral device of claim 1, wherein the automatic latch is detached by applying pressure to a cross-lever tab.

3. The peripheral device of claim 2, wherein the automatic latch comprises a crossbar lever, and wherein the peripheral device comprises the cross-lever tab.

4. The peripheral device of claim 1, wherein the automatic latch comprises a spring to maintain the position of the automatic latch.

5. The peripheral device of claim 1, wherein the automatic latch mechanically secures the peripheral device to the computer such that the peripheral device stays rigid in relation to the computer.

6. A computing device, comprising:
a processor;
a computer communication port for connecting to a corresponding communication port of a peripheral device comprising an automatic latch to mechanically secure the peripheral device to the computing device; and

a chassis comprising a latch receptacle for receiving the automatic latch to mechanically secure the peripheral device to the computing device, the chassis being in contact with a ground retention surface of the peripheral device when the peripheral device is mechanically secured.

7. The computing device of claim 6, wherein the computer communication port is a Universal Serial Bus (USB) port.
8. The computing device of claim 6, wherein the automatic latch is a cross-bar level.
9. The computing device of claim 6, comprising a device tab used to lock and releases the cross-bar lever.
10. The computing device of claim 6, wherein the peripheral device maintains a rigid relationship to the computing device when mechanically secured.
11. A system for connecting a peripheral device to a computing device, comprising:
 - a computing device comprising a communication port and a latch receptacle;
 - a peripheral device, comprising:
 - a device communication port, to communicatively couple with a computer communication port on a computer;
 - an automatic latch, to mechanically secure the peripheral device to the computer by applying pressure in a direction that connects the device communication port and the computer communication port;
 - and
 - a ground retention clip, to establish surface contact with an exterior surface of the computing device to electrically ground the peripheral device.

12. The system of claim 11, wherein the automatic latch comprises a cross-bar lever.

13. The system of claim 12, wherein the wherein the automatic latch is automatically detached by applying pressure to a cross-lever tab.

14. The system of claim 11, wherein the automatic latch comprises a spring to maintain the position of the automatic latch.

15. The system of claim 11, wherein the peripheral device stays rigid in relation to the computing device when mechanically secured.

1/6

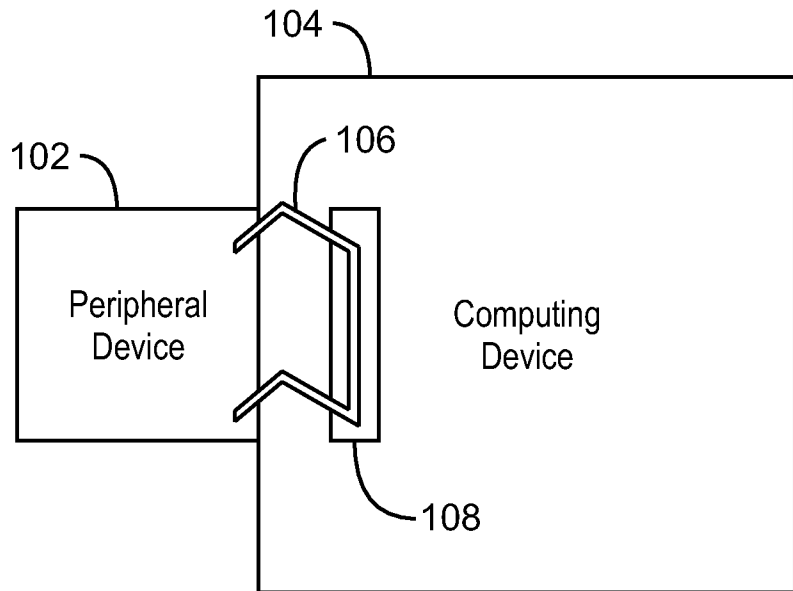

100
FIG. 1A

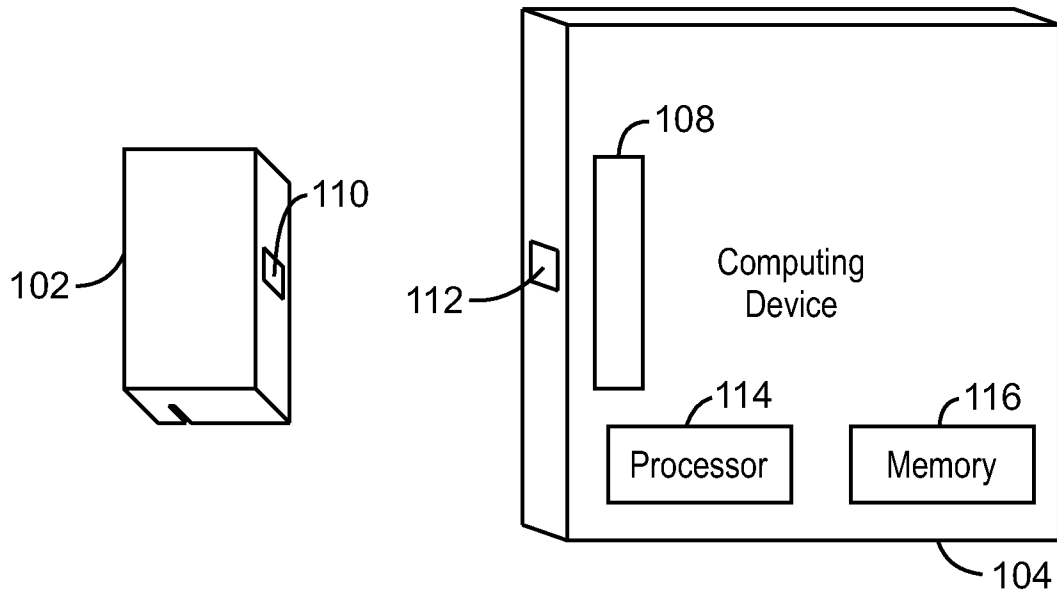

100
FIG. 1B

3/6

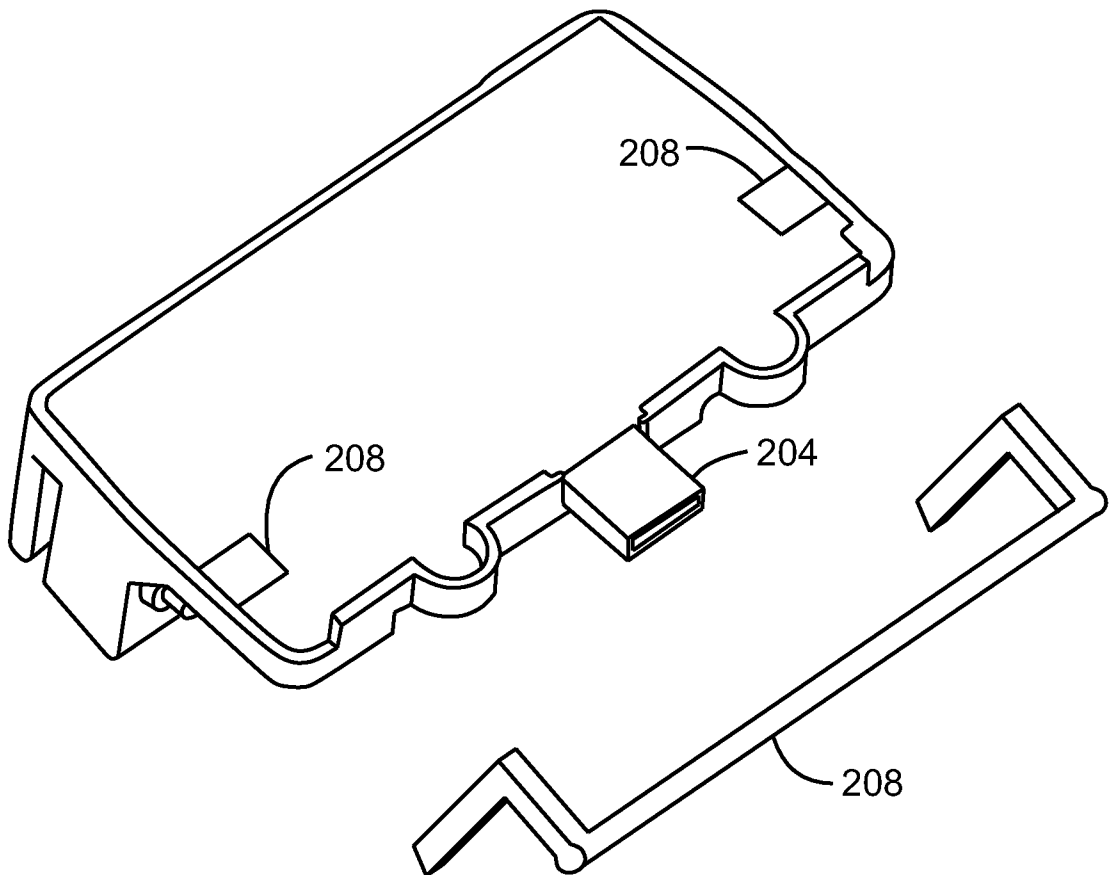

202
FIG. 2A

4/6

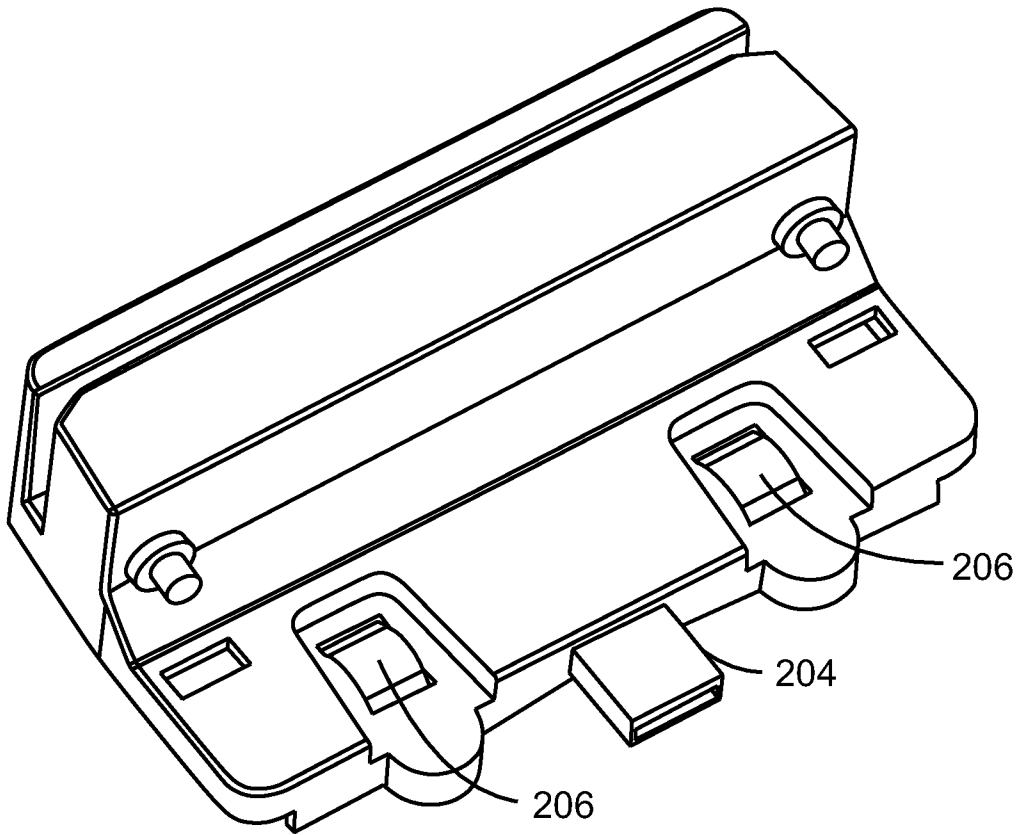

202
FIG. 2B

5/6

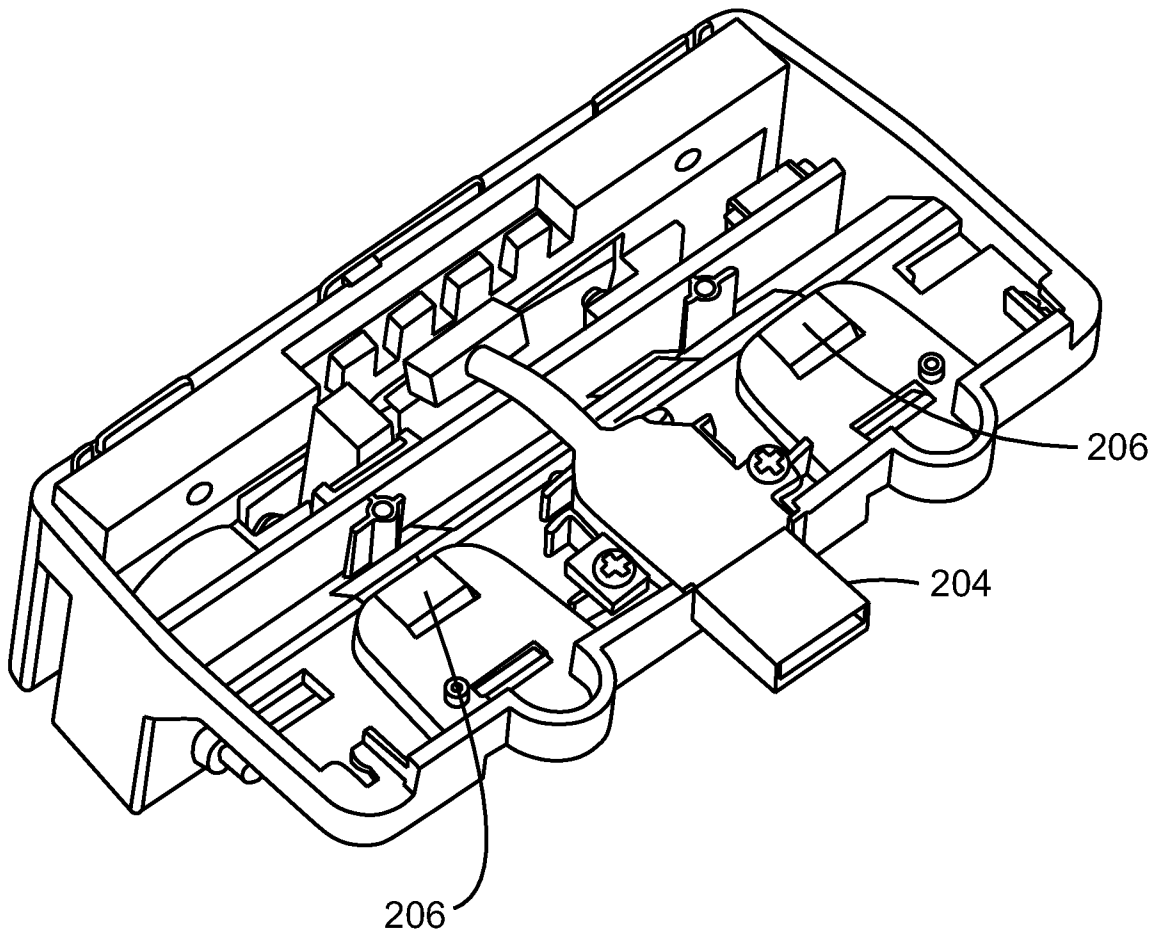

202
FIG. 2C

6/6

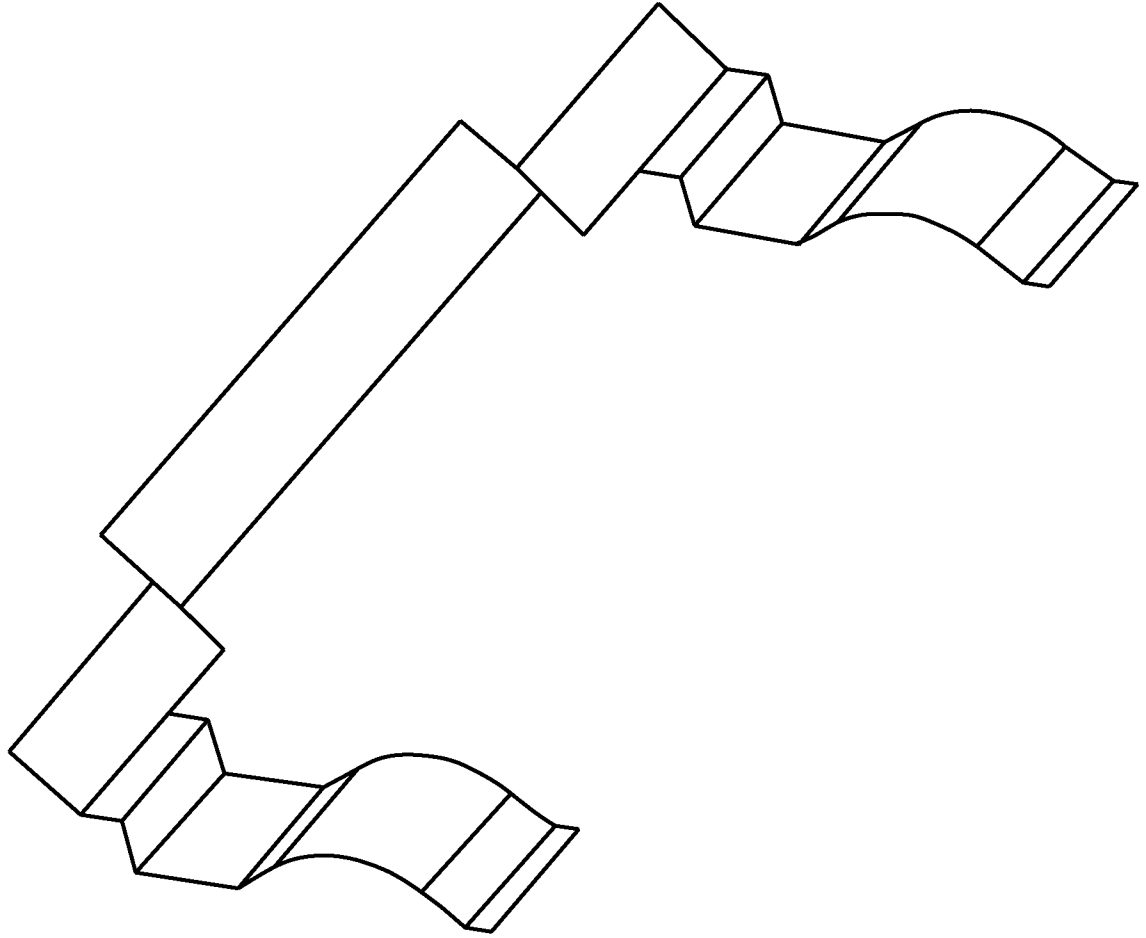

300
FIG. 3

A. CLASSIFICATION OF SUBJECT MATTER**G06F 13/14(2006.01)i, G06F 1/16(2006.01)i**

According to International Patent Classification (IPC) or to both national classification and IPC

B. FIELDS SEARCHED

Minimum documentation searched (classification system followed by classification symbols)

G06F 13/14; H04N 5/225; G06F 3/033; H05K 7/14; H01R 13/506; H01R 13/502; G06F 1/26; H01R 13/00; G06F 1/16

Documentation searched other than minimum documentation to the extent that such documents are included in the fields searched

Korean utility models and applications for utility models

Japanese utility models and applications for utility models

Electronic data base consulted during the international search (name of data base and, where practicable, search terms used)

eKOMPASS(KIPO internal) & Keywords: peripheral device, attach, detach, latch, retention clip, surface, USB port, connector, and similar terms

C. DOCUMENTS CONSIDERED TO BE RELEVANT

Category*	Citation of document, with indication, where appropriate, of the relevant passages	Relevant to claim No.
Y	US 2002-0054476 A1 (AMY HAN et al.) 09 May 2002 See paragraphs [0010], [0022], [0031], [0034]-[0035], [0041], and [0057]; claims 1 and 9; and figures 1, 3, and 8.	1,4-7,10-11,14-15
A		2-3,8-9,12-13
Y	EP 1082787 B1 (TYCO ELECTRONICS CORPORATION) 18 July 2007 See paragraphs [0002] and [0015]-[0020]; and figures 2A-5A.	1,4-7,10-11,14-15
A	US 8,029,322 B1 (LAWRENCE SE-JUN OH et al.) 04 October 2011 See column 7, lines 28 and figure 4.	1-15
A	US 2010-0066677 A1 (PETER GARRETT et al.) 18 March 2010 See paragraphs [0008] and [0061]; and figure 11	1-15
A	US 2012-0057306 A1 (ZHI-HUA LIU) 08 March 2012 See paragraphs [0005]-[0006] and [0014]-[0021]; and figures 1-3.	1-15
A	US 2004-0073819 A1 (MASAYOSHI SEKINE et al.) 15 April 2004 See paragraphs [0019] and [0043]-[0053]; and figure 1.	1-15

 Further documents are listed in the continuation of Box C. See patent family annex.

* Special categories of cited documents:

"A" document defining the general state of the art which is not considered to be of particular relevance

"E" earlier application or patent but published on or after the international filing date

"L" document which may throw doubts on priority claim(s) or which is cited to establish the publication date of another citation or other special reason (as specified)

"O" document referring to an oral disclosure, use, exhibition or other means

"P" document published prior to the international filing date but later than the priority date claimed

"T" later document published after the international filing date or priority date and not in conflict with the application but cited to understand the principle or theory underlying the invention

"X" document of particular relevance; the claimed invention cannot be considered novel or cannot be considered to involve an inventive step when the document is taken alone

"Y" document of particular relevance; the claimed invention cannot be considered to involve an inventive step when the document is combined with one or more other such documents, such combination being obvious to a person skilled in the art

"&" document member of the same patent family

Date of the actual completion of the international search

27 April 2015 (27.04.2015)

Date of mailing of the international search report

28 April 2015 (28.04.2015)

Name and mailing address of the ISA/KR

International Application Division
Korean Intellectual Property Office
189 Cheongsu-ro, Seo-gu, Daejeon Metropolitan City, 302-701,
Republic of Korea

Facsimile No. ++82 42 472 7140

Authorized officer

NHO, Ji Myong

Telephone No. +82-42-481-8528



INTERNATIONAL SEARCH REPORT

Information on patent family members

International application No.

PCT/US2014/048452

Patent document cited in search report	Publication date	Patent family member(s)	Publication date
US 2002-0054476 A1	09/05/2002	US 2001-0040787 A1 US 6115248 A US 6282088 B1 US 6490155 B2	15/11/2001 05/09/2000 28/08/2001 03/12/2002
EP 1082787 B1	18/07/2007	AT 367664 T DE 69936580 D1 DE 69936580 T2 EP 1082787 A1 ES 2291028 T3 JP 2002-517075 A KR 10-0543487 B1 US 6478631 B1 WO 1999-062145 A1	15/08/2007 30/08/2007 17/04/2008 14/03/2001 16/02/2008 11/06/2002 20/01/2006 12/11/2002 02/12/1999
US 8029322 B1	04/10/2011	CN 102570135 A EP 2434585 A2 EP 2434585 A3 JP 2012-074375 A	11/07/2012 28/03/2012 06/11/2013 12/04/2012
US 2010-0066677 A1	18/03/2010	None	
US 2012-0057306 A1	08/03/2012	CN 102402243 A CN 102402243 B US 8498107 B2	04/04/2012 28/08/2013 30/07/2013
US 2004-0073819 A1	15/04/2004	JP 2001-067156 A JP 2001-067157 A JP 4497587 B2 US 2006-0015759 A1 US 6662301 B1 US 7000129 B2 US 7395442 B2	16/03/2001 16/03/2001 07/07/2010 19/01/2006 09/12/2003 14/02/2006 01/07/2008