

(19) World Intellectual Property
Organization
International Bureau



(43) International Publication Date
18 March 2004 (18.03.2004)

PCT

(10) International Publication Number
WO 2004/022108 A3

- (51) International Patent Classification⁷: **A61B 17/56**, (74) Agent: **TAROLLI, James, L.**; Tarolli, Sundheim, Covell & Tummino L.L.P., 526 Superior Avenue, Suite 1111, Cleveland, OH 44114 (US).
- (21) International Application Number: PCT/US2003/027879 (81) Designated States (*national*): AE, AG, AL, AM, AT, AU, AZ, BA, BB, BG, BR, BY, BZ, CA, CH, CN, CO, CR, CU, CZ, DE, DK, DM, DZ, EC, EE, ES, FI, GB, GD, GE, GH, GM, HR, HU, ID, IL, IN, IS, JP, KE, KG, KP, KR, KZ, LC, LK, LR, LS, LT, LU, LV, MA, MD, MG, MK, MN, MW, MX, MZ, NI, NO, NZ, OM, PG, PH, PL, PT, RO, RU, SC, SD, SE, SG, SK, SL, SY, TJ, TM, TN, TR, TT, TZ, UA, UG, US, UZ, VC, VN, YU, ZA, ZM, ZW.
- (22) International Filing Date: 5 September 2003 (05.09.2003) (84) Designated States (*regional*): ARIPO patent (GH, GM, KE, LS, MW, MZ, SD, SL, SZ, TZ, UG, ZM, ZW), Eurasian patent (AM, AZ, BY, KG, KZ, MD, RU, TJ, TM), European patent (AT, BE, BG, CH, CY, CZ, DE, DK, EE, ES, FI, FR, GB, GR, HU, IE, IT, LU, MC, NL, PT, RO, SE, SI, SK, TR), OAPI patent (BF, BJ, CF, CG, CI, CM, GA, GN, GQ, GW, ML, MR, NE, SN, TD, TG).
- (25) Filing Language: English
- (26) Publication Language: English
- (30) Priority Data: 10/236,713 6 September 2002 (06.09.2002) US
- (63) Related by continuation (CON) or continuation-in-part (CIP) to earlier application: US 10/236,713 (CIP) Filed on 6 September 2002 (06.09.2002)
- (71) Applicant (*for all designated States except US*): **ENDIUS INCORPORATED** [US/US]; 23 West Bacon Street, Plainville, MA 02762 (US).
- (72) Inventor; and
- (75) Inventor/Applicant (*for US only*): **SHLUZAS, Alan, E.** [US/US]; 84 Acorn Street, Millis, MA 02054 (US).
- Declaration under Rule 4.17:**
— *of inventorship (Rule 4.17(iv)) for US only*
- Published:**
— *with international search report*

[Continued on next page]

(54) Title: SURGICAL INSTRUMENT FOR MOVING A VERTEBRA

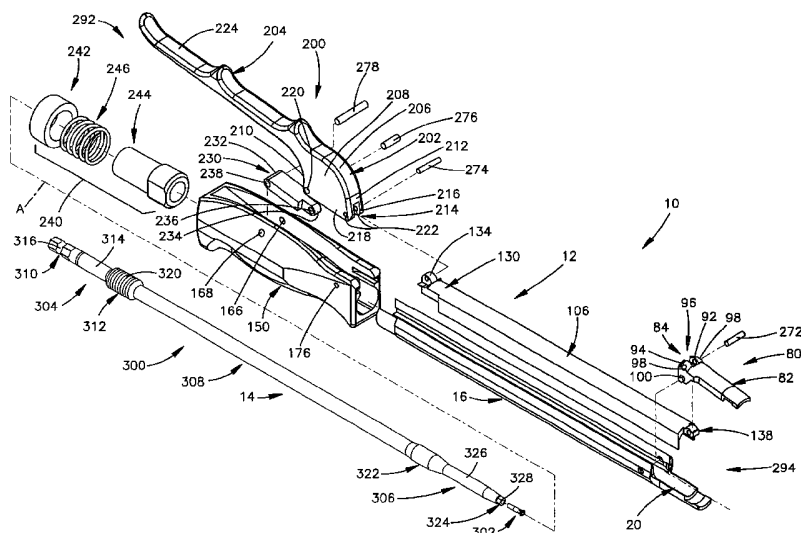

(57) Abstract: A surgical instrument (10) includes a first device (294) adapted to be connected to a fastener fixed to a first bone portion. A second device (150) includes a first portion associated with the first device (294) and a second portion (150) for supporting a member which engages the fastener fixed to the first bone portion and secures a rod connected to the second bone portion to the fastener. The second portion (150) is adapted for pressing the member against the rod. The first device (294) has a part that prevents the second device (150) from moving toward the fastener that is connected to the first device (294) so that the member is rotated relative to the fastener but is not moved axially relative to the fastener in response to rotation of the second device (150).



— *before the expiration of the time limit for amending the claims and to be republished in the event of receipt of amendments*

For two-letter codes and other abbreviations, refer to the "Guidance Notes on Codes and Abbreviations" appearing at the beginning of each regular issue of the PCT Gazette.

(88) Date of publication of the international search report:
6 May 2004

INTERNATIONAL SEARCH REPORT

International application No.

PCT/US03/27879

A. CLASSIFICATION OF SUBJECT MATTER																				
IPC(7) : A61B 17/56, 17/58																				
US CL : 606/61, 90																				
According to International Patent Classification (IPC) or to both national classification and IPC																				
B. FIELDS SEARCHED																				
Minimum documentation searched (classification system followed by classification symbols)																				
U.S. : 606/61, 90, 60, 72, 73, 86, 99, 104, 96																				
Documentation searched other than minimum documentation to the extent that such documents are included in the fields searched																				
Electronic data base consulted during the international search (name of data base and, where practicable, search terms used)																				
C. DOCUMENTS CONSIDERED TO BE RELEVANT																				
Category *	Citation of document, with indication, where appropriate, of the relevant passages	Relevant to claim No.																		
A	US 5,910,141 A (MORRISON et al.) 08 June 1999 (08.06.1999), entire document.	1-39																		
A	US 6,251,111 B1 (BARKER et al.) 26 June 2001 (26.06.2001), entire document.	1-39																		
A	US 5,720,751 A (JACKSON) 24 February 1998 (24.02.1998), entire document.	1-39																		
A	US 5,782,831 A (SHERMAN et al) 21 July 1998 (21.07.1998), entire document.	1-39																		
A	US 5,020,519 A (HAYES et al) 04 June 1991 (04.06.1991), entire document.	1-39																		
<input type="checkbox"/> Further documents are listed in the continuation of Box C. <input type="checkbox"/> See patent family annex.																				
<table border="0"> <tr> <td colspan="2">* Special categories of cited documents:</td> <td>"T" later document published after the international filing date or priority date and not in conflict with the application but cited to understand the principle or theory underlying the invention</td> </tr> <tr> <td>"A" document defining the general state of the art which is not considered to be of particular relevance</td> <td>"X" document of particular relevance; the claimed invention cannot be considered novel or cannot be considered to involve an inventive step when the document is taken alone</td> <td></td> </tr> <tr> <td>"E" earlier application or patent published on or after the international filing date</td> <td>"Y" document of particular relevance; the claimed invention cannot be considered to involve an inventive step when the document is combined with one or more other such documents, such combination being obvious to a person skilled in the art</td> <td></td> </tr> <tr> <td>"L" document which may throw doubts on priority claim(s) or which is cited to establish the publication date of another citation or other special reason (as specified)</td> <td>"&" document member of the same patent family</td> <td></td> </tr> <tr> <td>"O" document referring to an oral disclosure, use, exhibition or other means</td> <td></td> <td></td> </tr> <tr> <td>"P" document published prior to the international filing date but later than the priority date claimed</td> <td></td> <td></td> </tr> </table>			* Special categories of cited documents:		"T" later document published after the international filing date or priority date and not in conflict with the application but cited to understand the principle or theory underlying the invention	"A" document defining the general state of the art which is not considered to be of particular relevance	"X" document of particular relevance; the claimed invention cannot be considered novel or cannot be considered to involve an inventive step when the document is taken alone		"E" earlier application or patent published on or after the international filing date	"Y" document of particular relevance; the claimed invention cannot be considered to involve an inventive step when the document is combined with one or more other such documents, such combination being obvious to a person skilled in the art		"L" document which may throw doubts on priority claim(s) or which is cited to establish the publication date of another citation or other special reason (as specified)	"&" document member of the same patent family		"O" document referring to an oral disclosure, use, exhibition or other means			"P" document published prior to the international filing date but later than the priority date claimed		
* Special categories of cited documents:		"T" later document published after the international filing date or priority date and not in conflict with the application but cited to understand the principle or theory underlying the invention																		
"A" document defining the general state of the art which is not considered to be of particular relevance	"X" document of particular relevance; the claimed invention cannot be considered novel or cannot be considered to involve an inventive step when the document is taken alone																			
"E" earlier application or patent published on or after the international filing date	"Y" document of particular relevance; the claimed invention cannot be considered to involve an inventive step when the document is combined with one or more other such documents, such combination being obvious to a person skilled in the art																			
"L" document which may throw doubts on priority claim(s) or which is cited to establish the publication date of another citation or other special reason (as specified)	"&" document member of the same patent family																			
"O" document referring to an oral disclosure, use, exhibition or other means																				
"P" document published prior to the international filing date but later than the priority date claimed																				
Date of the actual completion of the international search		Date of mailing of the international search report																		
20 February 2004 (20.02.2004)		15 MAR 2004																		
Name and mailing address of the ISA/US		Authorized officer																		
Mail Stop PCT, Attn: ISA/US		Kevin P Shaver																		
Commissioner for Patents																				
P.O. Box 1450																				
Alexandria, Virginia 22313-1450		Telephone No. 703.308.0873																		
Facsimile No. (703)305-3230																				