

(19) World Intellectual Property Organization  
International Bureau



(43) International Publication Date  
1 September 2005 (01.09.2005)

PCT

(10) International Publication Number  
**WO 2005/079426 A3**

(51) International Patent Classification:  
A61F 2/44 (2006.01)

(21) International Application Number:  
PCT/US2005/004951

(22) International Filing Date:  
17 February 2005 (17.02.2005)

(25) Filing Language: English

(26) Publication Language: English

(30) Priority Data:  
60/545,094 17 February 2004 (17.02.2004) US  
60/545,101 17 February 2004 (17.02.2004) US  
10/860,487 2 June 2004 (02.06.2004) US  
10/860,495 2 June 2004 (02.06.2004) US  
10/860,778 2 June 2004 (02.06.2004) US  
10/860,543 2 June 2004 (02.06.2004) US

(71) Applicant (for all designated States except US): **FACET SOLUTIONS, INC.** [US/US]; 180 South 600 West, Logan, UT 84321 (US).

(72) Inventors; and

(75) Inventors/Applicants (for US only): **HOY, Robert, W.** [US/US]; 86507 South 200 East, Paradise, UT 84328 (US). **CHERVITZ, Alan** [US/US]; 4084 Arlington Drive, Palm Harbor, FL 34685 (US). **FALLIN, T., Wade** [US/US]; 210

East 200 South, Hyde Park, UT 84318 (US). **TRIPLETT, Daniel, J.** [US/US]; 225 East 583 South, Providence, UT 84332 (US). **JUSTIN, Daniel, F.** [US/US]; 185 North Winding Way, Logan, UT 84321 (US).

(74) Agent: **JUSTIN, Daniel, F.**; MedicineLodge, Inc., 180 South 600 West, Logan, UT 84321 (US).

(81) Designated States (unless otherwise indicated, for every kind of national protection available): AE, AG, AL, AM, AT, AU, AZ, BA, BB, BG, BR, BW, BY, BZ, CA, CH, CN, CO, CR, CU, CZ, DE, DK, DM, DZ, EC, EE, EG, ES, FI, GB, GD, GE, GH, GM, HR, HU, ID, IL, IN, IS, JP, KE, KG, KP, KR, KZ, LC, LK, LR, LS, LT, LU, LV, MA, MD, MG, MK, MN, MW, MX, MZ, NA, NI, NO, NZ, OM, PG, PH, PL, PT, RO, RU, SC, SD, SE, SG, SK, SL, SM, SY, TJ, TM, TN, TR, TT, TZ, UA, UG, US, UZ, VC, VN, YU, ZA, ZM, ZW.

(84) Designated States (unless otherwise indicated, for every kind of regional protection available): ARIPO (BW, GH, GM, KE, LS, MW, MZ, NA, SD, SL, SZ, TZ, UG, ZM, ZW), Eurasian (AM, AZ, BY, KG, KZ, MD, RU, TJ, TM), European (AT, BE, BG, CH, CY, CZ, DE, DK, EE, ES, FI, FR, GB, GR, HU, IE, IS, IT, LT, LU, MC, NL, PL, PT, RO, SE, SI, SK, TR), OAPI (BF, BJ, CF, CG, CI, CM, GA, GN, GQ, GW, ML, MR, NE, SN, TD, TG).

[Continued on next page]

(54) Title: SPINAL FACET JOINT IMPLANT

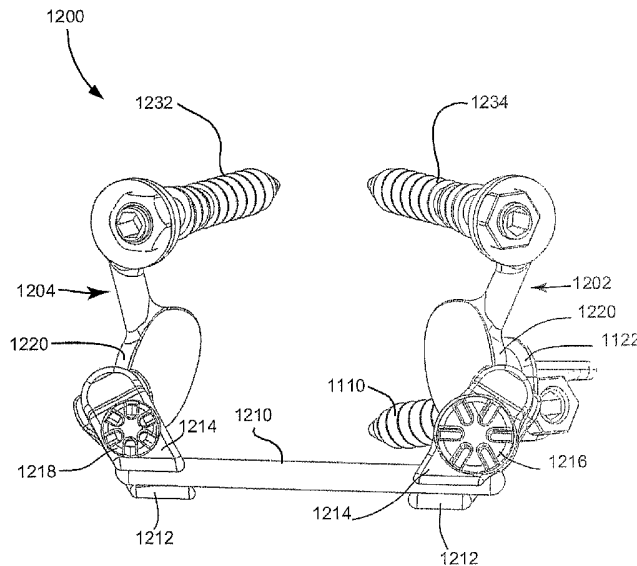

(57) Abstract: Superior and/or inferior facets of one or more facet joints may be replaced by superior and/or inferior facet joint prostheses. In one embodiment, a kit of superior or inferior prostheses is provided, in which the prostheses have at least two dimensions that vary among members of the kit independently of each other. Each prosthesis may have a bone engaging surface having a surface that is polyaxially rotatable against a corresponding resection of a vertebra. Each prosthesis may also have an articulating surface shaped such that, after attachment to the spine, the replaced or partially replaced facet joints provide a larger medial-lateral range of motion when the spine is flexed than when the spine is extended. Crosslinks may be used to connect left and right prosthesis together in such a manner that they are stabilized in a position in which they are seated directly against the vertebra.

WO 2005/079426 A3



**Published:**

- *with international search report*
- *before the expiration of the time limit for amending the claims and to be republished in the event of receipt of amendments*

*For two-letter codes and other abbreviations, refer to the "Guidance Notes on Codes and Abbreviations" appearing at the beginning of each regular issue of the PCT Gazette.*

**(88) Date of publication of the international search report:**

22 June 2006

# INTERNATIONAL SEARCH REPORT

International application No.

PCT/US05/04951

<b>A. CLASSIFICATION OF SUBJECT MATTER</b> IPC(8): <b>A61F 2/44( 2006.01)</b> <b>A61F 2/44( 2006.01)</b>  USPC:        623/17.11 According to International Patent Classification (IPC) or to both national classification and IPC													
<b>B. FIELDS SEARCHED</b>  Minimum documentation searched (classification system followed by classification symbols) U.S. : 623/17.11-17.16; 606/61  Documentation searched other than minimum documentation to the extent that such documents are included in the fields searched  Electronic data base consulted during the international search (name of data base and, where practicable, search terms used)													
<b>C. DOCUMENTS CONSIDERED TO BE RELEVANT</b>													
Category *	<table border="1" style="width: 100%; border-collapse: collapse;"> <thead> <tr> <th style="width: 15%; padding: 5px;">Citation of document, with indication, where appropriate, of the relevant passages</th> <th style="width: 15%; padding: 5px;">Relevant to claim No.</th> </tr> </thead> <tbody> <tr> <td style="padding: 5px;">                     X     US 6,610,091 B1 (REILY) 26 August 2003 (26.08.2003), see Figures 2A-2C, 7, 10, 12, 22, 23, 29-31 and 33; column 7, lines 1-11; column 8, lines 8-20 and 25-27; column 15, lines 17-20 and 31-35; column 16, lines 38-63.                      ---                      A                 </td> <td style="padding: 5px;">                     26-28, 38, 49, 50, 59, 69                      -----                      1-25, 29-37, 39-48, 51-58, 60-68, 70-81                 </td> </tr> <tr> <td style="padding: 5px;">                     X     US 2002/0123806 A1 (REILY) 05 September 2002 (05.09.2002), see Figures 5 and 6; paragraphs [0043], [0048], [0050], [0051] and [0100].                      ---                      Y                 </td> <td style="padding: 5px;">                     96-99, 104, 105, 118-120, 126, 127, 137-139, 145, 187, 188, 193, 194                      -----                      155-157, 164, 172-175                 </td> </tr> <tr> <td style="padding: 5px;">                     A     US 6,565,605 B2 (GOBLE et al) 20 May 2003 (20.05.2003), see Figures 2-15.                 </td> <td style="padding: 5px;">                     82-154                 </td> </tr> </tbody> </table>	Citation of document, with indication, where appropriate, of the relevant passages	Relevant to claim No.	X     US 6,610,091 B1 (REILY) 26 August 2003 (26.08.2003), see Figures 2A-2C, 7, 10, 12, 22, 23, 29-31 and 33; column 7, lines 1-11; column 8, lines 8-20 and 25-27; column 15, lines 17-20 and 31-35; column 16, lines 38-63. --- A	26-28, 38, 49, 50, 59, 69 ----- 1-25, 29-37, 39-48, 51-58, 60-68, 70-81	X     US 2002/0123806 A1 (REILY) 05 September 2002 (05.09.2002), see Figures 5 and 6; paragraphs [0043], [0048], [0050], [0051] and [0100]. --- Y	96-99, 104, 105, 118-120, 126, 127, 137-139, 145, 187, 188, 193, 194 ----- 155-157, 164, 172-175	A     US 6,565,605 B2 (GOBLE et al) 20 May 2003 (20.05.2003), see Figures 2-15.	82-154				
Citation of document, with indication, where appropriate, of the relevant passages	Relevant to claim No.												
X     US 6,610,091 B1 (REILY) 26 August 2003 (26.08.2003), see Figures 2A-2C, 7, 10, 12, 22, 23, 29-31 and 33; column 7, lines 1-11; column 8, lines 8-20 and 25-27; column 15, lines 17-20 and 31-35; column 16, lines 38-63. --- A	26-28, 38, 49, 50, 59, 69 ----- 1-25, 29-37, 39-48, 51-58, 60-68, 70-81												
X     US 2002/0123806 A1 (REILY) 05 September 2002 (05.09.2002), see Figures 5 and 6; paragraphs [0043], [0048], [0050], [0051] and [0100]. --- Y	96-99, 104, 105, 118-120, 126, 127, 137-139, 145, 187, 188, 193, 194 ----- 155-157, 164, 172-175												
A     US 6,565,605 B2 (GOBLE et al) 20 May 2003 (20.05.2003), see Figures 2-15.	82-154												
<input checked="" type="checkbox"/> Further documents are listed in the continuation of Box C. <input type="checkbox"/> See patent family annex.													
<table style="width: 100%; border-collapse: collapse;"> <tr> <td style="width: 50%; padding: 5px;">                     *           Special categories of cited documents:                 </td> <td style="width: 50%; padding: 5px;">                     "T"        later document published after the international filing date or priority date and not in conflict with the application but cited to understand the principle or theory underlying the invention                 </td> </tr> <tr> <td style="padding: 5px;">                     "A"        document defining the general state of the art which is not considered to be of particular relevance                 </td> <td style="padding: 5px;">                     "X"        document of particular relevance; the claimed invention cannot be considered novel or cannot be considered to involve an inventive step when the document is taken alone                 </td> </tr> <tr> <td style="padding: 5px;">                     "E"        earlier application or patent published on or after the international filing date                 </td> <td style="padding: 5px;">                     "Y"        document of particular relevance; the claimed invention cannot be considered to involve an inventive step when the document is combined with one or more other such documents, such combination being obvious to a person skilled in the art                 </td> </tr> <tr> <td style="padding: 5px;">                     "L"        document which may throw doubts on priority claim(s) or which is cited to establish the publication date of another citation or other special reason (as specified)                 </td> <td style="padding: 5px;">                     "&amp;"        document member of the same patent family                 </td> </tr> <tr> <td style="padding: 5px;">                     "O"        document referring to an oral disclosure, use, exhibition or other means                 </td> <td></td> </tr> <tr> <td style="padding: 5px;">                     "P"        document published prior to the international filing date but later than the priority date claimed                 </td> <td></td> </tr> </table>		*           Special categories of cited documents:	"T"        later document published after the international filing date or priority date and not in conflict with the application but cited to understand the principle or theory underlying the invention	"A"        document defining the general state of the art which is not considered to be of particular relevance	"X"        document of particular relevance; the claimed invention cannot be considered novel or cannot be considered to involve an inventive step when the document is taken alone	"E"        earlier application or patent published on or after the international filing date	"Y"        document of particular relevance; the claimed invention cannot be considered to involve an inventive step when the document is combined with one or more other such documents, such combination being obvious to a person skilled in the art	"L"        document which may throw doubts on priority claim(s) or which is cited to establish the publication date of another citation or other special reason (as specified)	"&"        document member of the same patent family	"O"        document referring to an oral disclosure, use, exhibition or other means		"P"        document published prior to the international filing date but later than the priority date claimed	
*           Special categories of cited documents:	"T"        later document published after the international filing date or priority date and not in conflict with the application but cited to understand the principle or theory underlying the invention												
"A"        document defining the general state of the art which is not considered to be of particular relevance	"X"        document of particular relevance; the claimed invention cannot be considered novel or cannot be considered to involve an inventive step when the document is taken alone												
"E"        earlier application or patent published on or after the international filing date	"Y"        document of particular relevance; the claimed invention cannot be considered to involve an inventive step when the document is combined with one or more other such documents, such combination being obvious to a person skilled in the art												
"L"        document which may throw doubts on priority claim(s) or which is cited to establish the publication date of another citation or other special reason (as specified)	"&"        document member of the same patent family												
"O"        document referring to an oral disclosure, use, exhibition or other means													
"P"        document published prior to the international filing date but later than the priority date claimed													
Date of the actual completion of the international search 14 March 2006 (14.03.2006)	Date of mailing of the international search report <b>11 APR 2006</b>												
Name and mailing address of the ISA/US Mail Stop PCT, Attn: ISA/US Commissioner for Patents P.O. Box 1450 Alexandria, Virginia 22313-1450 Facsimile No. (571) 273-3201	Authorized officer For <i>Virginia Libby</i> Urmi Chattopadhyay Telephone No. (571) 272-4748												

**INTERNATIONAL SEARCH REPORT**

International application No.  
PCT/US05/04951

C. (Continuation) DOCUMENTS CONSIDERED TO BE RELEVANT		
Category *	Citation of document, with indication, where appropriate, of the relevant passages	Relevant to claim No.
A	US 2003/0004572 A1 (GOBLE et al) 02 January 2003 (02.01.2003), see entire document.	1-194
A	US 6,132,464 A (MARTIN) 17 October 2000 (17.10.2000), see entire document.	1-194