



Europäisches Patentamt
European Patent Office
Office européen des brevets



Publication number:

0 363 016 A3

12

EUROPEAN PATENT APPLICATION

21 Application number: **89309042.3**

51 Int. Cl.⁵: **D03D 29/00, D03D 47/12**

22 Date of filing: **06.09.89**

30 Priority: **07.09.88 GB 8820952**

43 Date of publication of application:
11.04.90 Bulletin 90/15

84 Designated Contracting States:
BE CH DE ES FR GB IT LI

88 Date of deferred publication of the search report:
14.08.91 Bulletin 91/33

71 Applicant: **BONAS GRIFFITH LIMITED**

**12a Southwick Industrial Estate
Sunderland Tyne & Wear SR5 3TX(GB)**

72 Inventor: **Griffith, John Dalton
16 Burdon Road Cleddon
Sunderland Tyne & Wear SR6 7RU(GB)**

74 Representative: **Dealtry, Brian et al
Eric Potter & Clarkson St. Mary's Court St.
Mary's Gate
Nottingham NG1 1LE(GB)**

54 **Hand loom.**

57 A weaving loom including a reed (90) mounted on an oscillatable reed shaft (97), and a rapier (73) for drawing weft yarn through a warp shed, the rapier having a rapier head (72) mounted on the end of an elongate drive member (73) which is capable of reciprocating the head (72) through the warp shed, drive means for oscillating the reed shaft (97) such that during said insertion and retraction strokes the reed (90) is spaced from the fell to enable unhindered travel of the rapier head and such that the reed is advanced to urge the rapier toward the fell when the rapier is at its fully inserted position such that the rapier head is positively located for co-operation with weft yarn guide means (101) for collection of weft yarn.

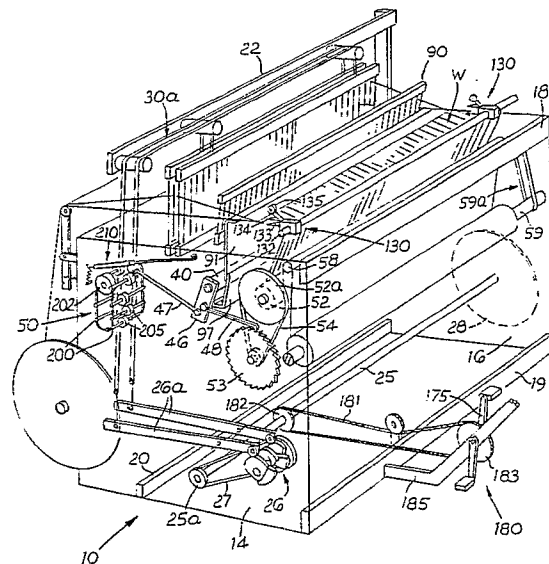

Fig. 1

EP 0 363 016 A3



EUROPEAN SEARCH
REPORT

| DOCUMENTS CONSIDERED TO BE RELEVANT | | | |
|---|---|------------------------------|---|
| Category | Citation of document with indication, where appropriate, of relevant passages | Relevant to claim | CLASSIFICATION OF THE APPLICATION (Int. Cl.5) |
| X A | CH-A-5 775 75 (ROBERT OXLEY SPARLING) * Column 2, line 63 - column 3, line 56 * -- -- | 1-7,14, 17,18 8,13 | D 03 D 29/00 D 03 D 47/12 |
| X A | DE-B-1 610 60 (EMIL GRAF IN ELBERFELD) * Figures 1-5 * -- -- | 1-6,8,17, 18 13 | |
| X A | AT-B-3 682 00 (AG ADOLPH SAURER ARBON) * Page 3, line 14 - page 4, line 24; figures 1,2 * -- -- | 1-5,17,18 | |
| A | INDUSTRIE TEXTILE, no. 1101, June 1980, pages 539-540, Paris, FR; J. PILISI: "Le tissage à bras contemporain" * Page 539, part III - page 540, part IV; figure 1 * -- -- -- -- | 16 | |
| The present search report has been drawn up for all claims | | | |
| Place of search | | Date of completion of search | Examiner |
| The Hague | | 11 April 91 | HENNINGSEN O.P. |
| <p>CATEGORY OF CITED DOCUMENTS</p> <p>X : particularly relevant if taken alone Y : particularly relevant if combined with another document of the same category A : technological background O : non-written disclosure P : intermediate document T : theory or principle underlying the invention</p> <p>E : earlier patent document, but published on, or after the filing date D : document cited in the application L : document cited for other reasons ----- & : member of the same patent family, corresponding document</p> | | | |
| | | | TECHNICAL FIELDS SEARCHED (Int. Cl.5) |
| | | | D 03 D |