

(19) World Intellectual Property Organization
International Bureau



(43) International Publication Date
17 January 2002 (17.01.2002)

PCT

(10) International Publication Number
WO 02/03888 A3

- (51) International Patent Classification⁷: **A61F 2/06** (74) Agent: English, William, A.; Lyon & Lyon LLP, 633 West Fifth Street, Suite 4700, Los Angeles, CA 90071-2066 (US).
- (21) International Application Number: PCT/US01/18910
- (22) International Filing Date: 11 June 2001 (11.06.2001) (81) Designated States (*national*): CA, JP.
- (25) Filing Language: English (84) Designated States (*regional*): European patent (AT, BE, CH, CY, DE, DK, ES, FI, FR, GB, GR, IE, IT, LU, MC, NL, PT, SE, TR).
- (26) Publication Language: English
- (30) Priority Data:
09/613,872 10 July 2000 (10.07.2000) US Published:
— with international search report
— before the expiration of the time limit for amending the claims and to be republished in the event of receipt of amendments
- (71) Applicant: **ENDOTEX INTERVENTIONAL SYSTEMS, INC.** [US/US]; 10231 Bubb Road, Cupertino, CA 95014 (US).
- (72) Inventor: **ROURKE, Jonathan, M.**; 2185 Chuleta, Los Altos, CA 94024 (US). (88) Date of publication of the international search report:
10 May 2002

[Continued on next page]

(54) Title: STENT DELIVERY DEVICE

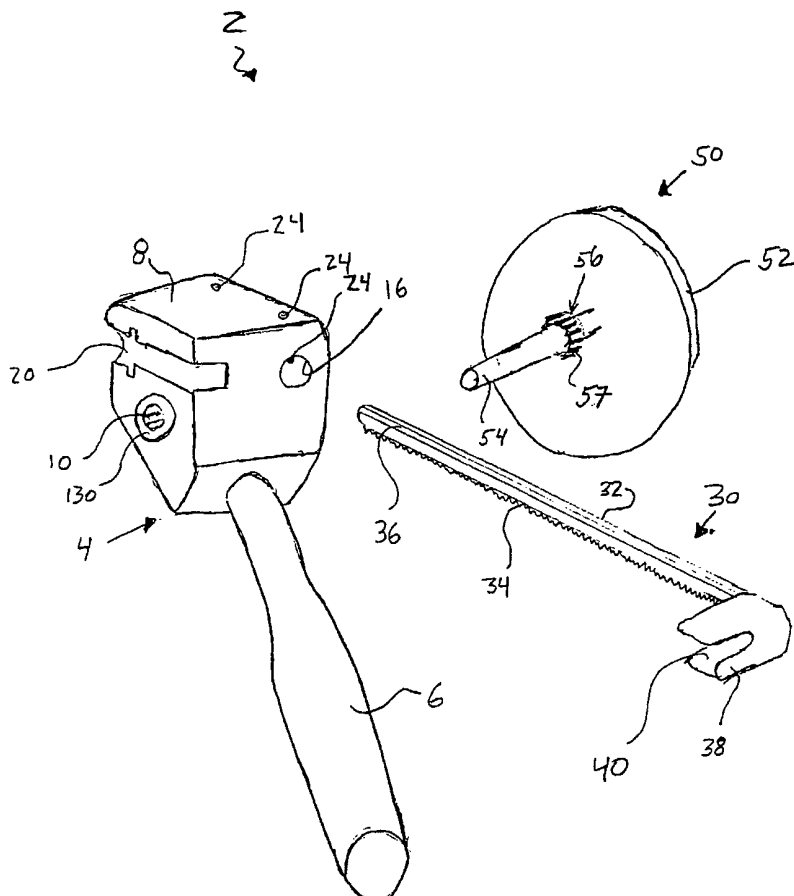

(57) Abstract: A unidirectional handle device for an endoluminal device includes an outer tubular member and an elongate inner member slidably received in the outer tubular member. The unidirectional handle includes a handle member, a needle bearing clutch disposed in the handle member, a control member guide, and shaft rotatable in a single direction disposed within the handle member. The shaft is rotatable in a single direction by its engagement with the needle bearing clutch. The shaft is in rotational engagement with the outer tubular member of the endoluminal device. The outer tubular member is slidable from a distal position to a proximal position when the shaft is rotated in the single direction. The unidirectional handle device provides substantially no backlash of the outer tubular member. In addition, the unidirectional handle device advantageously produces a tension-retaining effect during use.



WO 02/03888 A3



For two-letter codes and other abbreviations, refer to the "Guidance Notes on Codes and Abbreviations" appearing at the beginning of each regular issue of the PCT Gazette.

INTERNATIONAL SEARCH REPORT

International Application No

PCT/US 01/18910

A. CLASSIFICATION OF SUBJECT MATTER
IPC 7 A61F2/06

According to International Patent Classification (IPC) or to both national classification and IPC

B. FIELDS SEARCHED

Minimum documentation searched (classification system followed by classification symbols)

IPC 7 A61F

Documentation searched other than minimum documentation to the extent that such documents are included in the fields searched

Electronic data base consulted during the international search (name of data base and, where practical, search terms used)

WPI Data, EPO-Internal

C. DOCUMENTS CONSIDERED TO BE RELEVANT

Category °	Citation of document, with indication, where appropriate, of the relevant passages	Relevant to claim No.
A	EP 0 990 426 A (MEDTRONIC AVE, INC.) 5 April 2000 (2000-04-05) column 10, line 43 -column 11, line 53; figures 18,19	1,8,16, 21
A	US 5 868 755 A (KANNER ET AL) 9 February 1999 (1999-02-09) the whole document	1,8,16, 21

☐ Further documents are listed in the continuation of box C.

☒ Patent family members are listed in annex.

° Special categories of cited documents :

A document defining the general state of the art which is not considered to be of particular relevance

E earlier document but published on or after the international filing date

L document which may throw doubts on priority claim(s) or which is cited to establish the publication date of another citation or other special reason (as specified)

O document referring to an oral disclosure, use, exhibition or other means

P document published prior to the international filing date but later than the priority date claimed

T later document published after the international filing date or priority date and not in conflict with the application but cited to understand the principle or theory underlying the invention

X document of particular relevance; the claimed invention cannot be considered novel or cannot be considered to involve an inventive step when the document is taken alone

Y document of particular relevance; the claimed invention cannot be considered to involve an inventive step when the document is combined with one or more other such documents, such combination being obvious to a person skilled in the art.

* & * document member of the same patent family

Date of the actual completion of the international search

7 March 2002

Date of mailing of the international search report

13/03/2002

Name and mailing address of the ISA

European Patent Office, P.B. 5818 Patentlaan 2
NL - 2280 HV Rijswijk
Tel. (+31-70) 340-2040, Tx. 31 651 epo nl,
Fax: (+31-70) 340-3016

Authorized officer

Smith, C

INTERNATIONAL SEARCH REPORT

Information on patent family members

International Application No

PCT/US 01/18910

Patent document cited in search report		Publication date	Patent family member(s)	Publication date
EP 990426	A	05-04-2000	US 6203550 B1	20-03-2001
			EP 0990426 A1	05-04-2000
US 5868755	A	09-02-1999	NONE	