

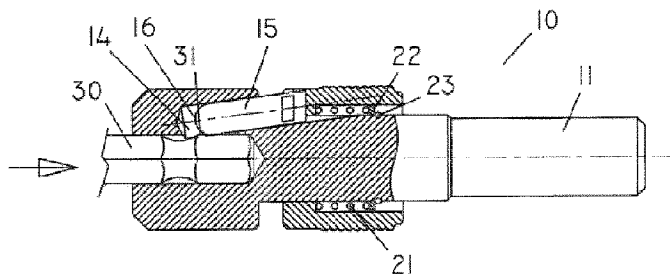

(86) Date de dépôt PCT/PCT Filing Date: 2015/04/22
 (87) Date publication PCT/PCT Publication Date: 2015/10/29
 (45) Date de délivrance/Issue Date: 2022/05/03
 (85) Entrée phase nationale/National Entry: 2016/09/16
 (86) N° demande PCT/PCT Application No.: CA 2015/050334
 (87) N° publication PCT/PCT Publication No.: 2015/161377
 (30) Priorité/Priority: 2014/04/22 (US61/982,637)

(51) Cl.Int./Int.Cl. *B25B 15/00* (2006.01),
B25B 23/00 (2006.01), *B25B 23/16* (2006.01)
 (72) Inventeurs/Inventors:
SINGH, SATNAM, CA;
VASUDEVA, KAILASH C., CA
 (73) Propriétaire/Owner:
MAXTECH CONSUMER PRODUCTS LIMITED, CA
 (74) Agent: MERIZZI RAMSBOTTOM & FORSTER

(54) Titre : MECANISME DE MANDRIN A RACCORDEMENT RAPIDE POUR POINTES DE TOURNEVIS, ET ANALOGUES
 (54) Title: QUICK-CONNECT CHUCK MECHANISM FOR SCREWDRIVER BITS AND THE LIKE



(57) **Abrégé/Abstract:**

A bit holder has a shank at a proximal end thereof and a blind bit-accepting hole at a distal end thereof, shaped to receive a correspondingly-shaped tool bit. The bit holder has at least one locking mechanism which includes an angled path defined in the bit holder, opening into a side of the bit-accepting hole, extending away from the bit-accepting hole in a proximal direction at an acute angle A from a central axis. A locking element is slideable in the path. A sleeve around the shank is biased towards the bit-accepting hole by a spring, such that a distal end of the locking element extends slightly into the bit-accepting hole. Moving the sleeve towards the proximal end of the bit holder retracts the locking element from the bit-accepting hole, thereby releasing the bit. A spring-loaded plunger in the blind hole may be used to eject the bit automatically when the locking mechanism is released by the sleeve.

(12) INTERNATIONAL APPLICATION PUBLISHED UNDER THE PATENT COOPERATION TREATY (PCT)

(19) World Intellectual Property
Organization
International Bureau(10) International Publication Number
WO 2015/161377 A1(43) International Publication Date
29 October 2015 (29.10.2015)

(51) International Patent Classification:

B25B 15/00 (2006.01) *B25B 23/16* (2006.01)
B25B 23/00 (2006.01)

(21) International Application Number:

PCT/CA2015/050334

(22) International Filing Date:

22 April 2015 (22.04.2015)

(25) Filing Language:

English

(26) Publication Language:

English

(30) Priority Data:

61/982,637 22 April 2014 (22.04.2014) US

(71) Applicant: **MAXTECH CONSUMER PRODUCTS LIMITED** [CA/CA]; 173 Roger Street, Unit 3, Waterloo, Ontario N2J 1B1 (CA).(72) Inventors: **SINGH, Satnam**; 166 Falconridge Drive, Kitchener, Ontario N2K 4J9 (CA). **VASUDEVA, Kailash C.**; 10 Grand River Drive, Waterloo, Ontario N2J 4G8 (CA).(74) Agent: **ARMSTRONG, R., Craig**; Armstrong IP, 28 Brookview Court, Kitchener, Ontario N2A 2Y6 (CA).

(81) Designated States (unless otherwise indicated, for every kind of national protection available): AE, AG, AL, AM, AO, AT, AU, AZ, BA, BB, BG, BH, BN, BR, BW, BY,

BZ, CA, CH, CL, CN, CO, CR, CU, CZ, DE, DK, DM, DO, DZ, EC, EE, EG, ES, FI, GB, GD, GE, GH, GM, GT, HN, HR, HU, ID, IL, IN, IR, IS, JP, KE, KG, KN, KP, KR, KZ, LA, LC, LK, LR, LS, LU, LY, MA, MD, ME, MG, MK, MN, MW, MX, MY, MZ, NA, NG, NI, NO, NZ, OM, PA, PE, PG, PH, PL, PT, QA, RO, RS, RU, RW, SA, SC, SD, SE, SG, SK, SL, SM, ST, SV, SY, TH, TJ, TM, TN, TR, TT, TZ, UA, UG, US, UZ, VC, VN, ZA, ZM, ZW.

(84) Designated States (unless otherwise indicated, for every kind of regional protection available): ARIPO (BW, GH, GM, KE, LR, LS, MW, MZ, NA, RW, SD, SL, ST, SZ, TZ, UG, ZM, ZW), Eurasian (AM, AZ, BY, KG, KZ, RU, TJ, TM), European (AL, AT, BE, BG, CH, CY, CZ, DE, DK, EE, ES, FI, FR, GB, GR, HR, HU, IE, IS, IT, LT, LU, LV, MC, MK, MT, NL, NO, PL, PT, RO, RS, SE, SI, SK, SM, TR), OAPI (BF, BJ, CF, CG, CI, CM, GA, GN, GQ, GW, KM, ML, MR, NE, SN, TD, TG).

Declarations under Rule 4.17:

- as to the identity of the inventor (Rule 4.17(i))
- as to applicant's entitlement to apply for and be granted a patent (Rule 4.17(ii))

Published:

- with international search report (Art. 21(3))

(54) Title: QUICK-CONNECT CHUCK MECHANISM FOR SCREWDRIVER BITS AND THE LIKE

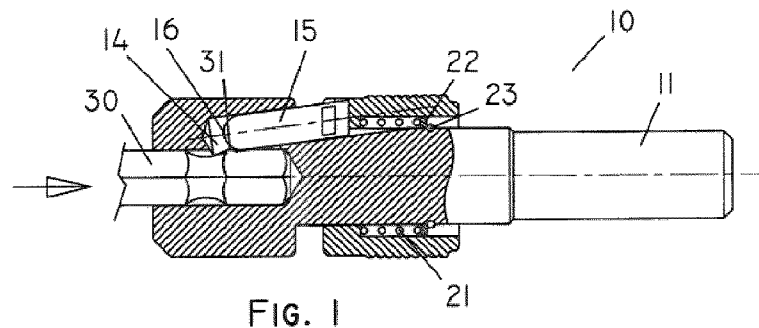

(57) Abstract: A bit holder has a shank at a proximal end thereof and a blind bit-accepting hole at a distal end thereof, shaped to receive a correspondingly-shaped tool bit. The bit holder has at least one locking mechanism which includes an angled path defined in the bit holder, opening into a side of the bit-accepting hole, extending away from the bit-accepting hole in a proximal direction at an acute angle A from a central axis. A locking element is slideable in the path. A sleeve around the shank is biased towards the bit-accepting hole by a spring, such that a distal end of the locking element extends slightly into the bit-accepting hole. Moving the sleeve towards the proximal end of the bit holder retracts the locking element from the bit-accepting hole, thereby releasing the bit. A spring-loaded plunger in the blind hole may be used to eject the bit automatically when the locking mechanism is released by the sleeve.



WO 2015/161377 A1

**QUICK-CONNECT CHUCK MECHANISM
FOR SCREWDRIVER BITS AND THE LIKE**

BACKGROUND

This invention relates to a quick-change tool bit holder that can secure a tool bit by
5 using a wedging element on its external profile. This kind of locking in a quick
change holder provides substantially “no play” holding of a tool bit. The wedging
element moves in a guided angular path within the body of the holder, the path
making a self-locking acute angle with the centre axis of the holder.

The invention will normally be used for standard hexagonal bits. However, the
10 invention can be readily adapted for use with bits having any polygonal cross-section,
including square bits for example, as well as for use with bits having a non-polygonal
cross-section, for example ovaloid bits with two flats and two arcs, or tri-centric bits
with three flats and three arcs. In general, the invention can be adapted for use with
15 virtually any non-circular cross-section. Typical quick change tool bit holders on the
market use some kind of a locking device that engages a circumferential groove per
ANSI B 107.4-1982 or an edge notch per ASME B107.600-2008 (B107.26) on the
hex shank of a tool bit, resulting in restricting axial freedom of the same.

Because of inherent features of the circumferential groove in the tool bits, the locking
mechanism in each case is of a binary nature. This means the conditions are either, on
20 or off, grabbed or released, locked or unlocked, etc.. Due to the stack-up of tolerances
in such bit holder devices, coupled with manufacturing tolerances of tool bits, there is
generally excessive axial and radial play between the tool bits and the tool bit holder.
Tradespersons and do-it-yourselfers accustomed to using solid screw drivers or
driver/drill bits directly chucked into a hand drill strongly dislike the resulting sloppy
25 functioning of these quick change holders.

SUMMARY OF THE INVENTION

The following presents a simplified summary of the general inventive concept(s)
described herein to provide a basic understanding of some aspects of the disclosure.
This summary is not an extensive overview of the disclosure. It is not intended to

restrict key or critical elements of embodiments of the disclosure or to delineate their scope beyond that which is explicitly or implicitly described by the following description and claims.

5 The quick change tool bit holder presented here offers quick interchangeability of tool bits without compromising the feel of a solid chuck, by providing a substantially no-play hold on the tool bit. The design is based upon at least one angularly guided locking element, the path of which makes a self-locking acute angle 'A' with the center axis of the bit holder. This locking element acts as a wedge against the outer surface of the tool bit, hence locking the bit against axial and radial freedom.

10 In one aspect, there is provided a bit holder having a shank at a proximal end thereof and a blind bit-accepting hole at a distal end thereof. The bit-accepting hole is shaped to receive a correspondingly-shaped tool bit. The bit holder has at least one locking mechanism comprising an angled path defined in the bit holder and opening into a side the of said bit-accepting hole and extending away from the bit-accepting hole in a
15 proximal direction at an acute angle A from a central axis of said bit holder. There is provided a locking element slideable in the path, such that a distal end of the locking element extends slightly into the bit-accepting hole. The bit holder further comprises a sleeve mounted around the shank, biased by a spring to urge the locking element towards the bit-accepting hole, connected to the locking element such that moving the
20 sleeve towards the proximal end of the bit holder retracts the locking element from the bit-accepting hole. Additionally, that locking element comprises a ball and wherein the sleeve has a hook portion extending therefrom to capture the ball.

Further details of the invention will be described or will become apparent in the course of the following detailed description and drawings of embodiments of the
25 invention, presented as examples only.

BRIEF DESCRIPTION OF THE DRAWINGS

Fig. 1 is a side cross-section of a first example of the invention, using a pin actuated by a spring-loaded sleeve, shown with a tool bit inserted;

Fig. 2A is a cross-section corresponding to Fig. 1, but without the tool bit;

Fig. 2B is an end view corresponding to Fig. 2A;

Fig. 3A is a top view at 90 degrees to Figs. 1 and 2A;

Fig. 3B is an end view corresponding to Fig. 3A;

Fig. 4A is a perspective view showing the sleeve and pin of Figs. 1 to 3B;

5 Fig. 4B is an exploded perspective view corresponding to Fig. 4A;

Fig. 5 is a side cross-section of a second example of the invention, using a pin and a roller actuated by the spring-loaded sleeve, shown with a tool bit inserted;

Fig. 6A is a cross-section corresponding to Fig. 5, without the tool bit;

Fig. 6B is an end view corresponding to Fig. 6A;

10 Fig. 7A is a top view at 90 degrees to Figs. 5 and 6A;

Fig. 7B is an end view corresponding to Fig. 7A;

Fig. 8 is a perspective view showing the sleeve, pin and roller of Figs. 5 to 7A;

Fig. 9 is a side cross-section of a third example of the invention, very similar to the second example, but with the bit-holder body in two pieces;

15 Fig. 10A is a side cross-section of a fourth example of the invention, very similar to the previous examples, but using a ball;

Fig. 10B is a side cross-section where the mechanism is identical to that of Fig. 10A, simply illustrating that for all embodiments the locking does not depend on the bit having a circumferential groove;

20 Fig. 11 is a side cross-section of a fifth example of the invention, using a ball holder and a ball actuated by a spring-loaded sleeve, shown with a tool bit inserted;

Fig. 12A is a cross-section corresponding to Fig. 11, without the tool bit;

Fig. 12B is an end view corresponding to Fig. 12A;

Fig. 13A is a top view at 90 degrees to Figs. 11 and 12A;

Fig. 13B is an end view corresponding to Fig. 13A;

Fig. 14 is a perspective view showing the sleeve, ball holder and ball of Figs. 11 to 13A;

5 Fig. 15A is a side cross-section of a sixth example of the invention, where the sleeve is placed in front of the open end of the body/housing, shown with a tool bit inserted;

Fig. 15B is an end view corresponding to Fig. 15A;

Fig. 16A is a side cross-section of a seventh example of the invention, showing two opposing bit-locking elements one acting in one direction and the other acting in the
10 opposite direction;

Fig. 16B is an end view corresponding to Fig. 16A;

Fig. 16C is a side cross-section of the seventh example, showing the sleeve moved forwardly from the holder;

Fig. 16D is a side cross-section of the seventh example, showing the sleeve moved
15 rearwardly;

Fig. 17A is a side cross-section of an eighth example of the invention, using a spring-loaded cam;

Fig. 17B is a detailed view corresponding to Fig. 17A;

Fig. 18 is a side cross-section showing a bit being inserted;

20 Fig. 19 is a side cross-section showing the bit locked in place;

Fig. 20 is a side cross-section of a ninth example of the invention, in which a wedge portion is provided on the inner diameter of a slideable sleeve;

Fig. 21 is a corresponding view, showing a bit being inserted;

Fig. 22 is a corresponding view, showing the bit locked in place;

Fig. 23 is a side cross-section of a tenth example of the invention, similar to the ninth example, but having a spring-loaded plunger to eject the tool bit when the locking mechanism is released;

5 Fig. 24 is a corresponding view, showing a bit fully inserted;

Fig. 25 is a corresponding view, showing the collar being pushed forward and the bit being ejected;

Fig. 26 is a side cross-section of an example of the mechanism combined with a typical screwdriver handle;

10 Fig. 27 is an end view showing three locking mechanisms offset by 120 degrees from each other;

Fig. 28 is an end view showing two locking mechanisms offset by 180 degrees from each other;

15 Fig. 29 is an end view showing two locking mechanisms offset by 120 degrees from each other;

Fig. 30 is an end view showing an alternative bit and bit holder cross-section, namely tri-centric; and

Fig. 31 is an end view showing another alternative bit and bit holder cross-section, namely ovaloid.

20 **DETAILED DESCRIPTION**

Figs. 1- 4B shows a first example of the invention. The main body of the bit holder 10 has a shank 11 and a bit-accepting end 12 with a blind bit-accepting hole 13 having a profile to match the profile of the tool bit 30. The profile will normally be hexagonal, but as stated above, the invention can be adapted for use with bits of basically any
25 non-circular cross-section. The shank 11 normally will be mounted in, for example, a screwdriver handle, as shown in Fig. 26.

At least one pin 15, preferably but not necessarily cylindrical for ease of manufacturing, acts as a locking element. In the drawings and throughout this description, generally only one locking element will be described, for convenience. However, to achieve maximum “no play” performance, there should preferably be more than one locking element. Preferably, there may be three of them, offset at 120 degrees from each other.

The pin 15 preferably has a semi-spherical tip 16, and is slideable and guided in an angularly formed path 14, the path 14 partially opening into the bit-accepting hole 13 such that the tip 16 extends slightly into the bit-accepting hole 13. As best seen in Figs. 4A and 4B, the pin 15 is anchored to a slideable sleeve 20, by a slot near 17 the end of the pin and a notch 17' in the sleeve. When the pin connects to the sleeve, the end of the pin sits in the notch and the outside of the notch sits in the slot so as to anchor the pin to the sleeve.

The angle A at which the path 14 is offset from the axis of the bit holder is preferably in the range of 5 to 13 degrees. Too large an angle increases the diameter of the mechanism excessively, and reduces the effectiveness of the locking. Conversely, too small an angle increase the length of the mechanism, and ultimately also reduces the effectiveness of the unlocking.

The sleeve 20 is biased towards the distal end of the holder, i.e. towards the open end of the bit-accepting hole 13, by a spring 21 that has its one flat face against the sleeve 20 while the other face is against a stop ring 22. The stop ring 22 is retained by lock ring 23 sitting in a recess in the main body 10. Axial sliding movement of sleeve 20 results in angularly sliding movement of element 15 within the guided path 14 of the body.

When a tool bit 30 is axially inserted into the bit-accepting hole 13, it engages with the tip 16 of the element 15, pushing the element 15 and in turn the sleeve 20 towards the shank 11. As the insertion of tool bit 30 continues, the element 15 is pushed fully out of the bit-accepting hole 13 and the tip 16 is in contact with the external surface 31 of the bit 30 until the bit stops against the terminating end of bit-accepting hole 13. Due to the spring biasing, the tip 16 of element 15 is continuously pushed against the outer surface 31 of the tool bit 30, resulting in wedging and clamping the bit 30 inside

the bit-accepting hole 13. Any effort to pull the tool bit 30 out from the bit-accepting hole 13 only further tightens the grip on the tool bit. This kind of locking ensures “no play” fitment of the tool bit in the holder. In order to release the tool bit 30, the sleeve 20 must be pulled back towards the shank 11 of the body 10, against the force of the spring 21, thus withdrawing the tip 16 from surface 31 and therefore freeing the tool bit 30 for removal.

As shown in Fig. 2A, the angular path makes an acute angle “A” with the center axis of the bit holder. Preferably, to make the pressing force between the pin 16 and the bit 30 more effective for preventing axial movement of the bit 30 in the bit-accepting hole 13, the acute angle “A” is less than 20 degrees, and preferably less than 15 degrees. In the drawings, a preferred angle of 10 degrees is shown.

A second example of the invention is shown in Figs. 5-8. The mechanism is essentially identical to that of Figs. 1-4B, except that the sliding element 15 has a freely rotating roller 18 that replaces tip 16 of the pin 15. This is most clearly seen in Fig. 8.

Fig. 9 shows a third example of the invention, which is a slightly modified version of the first and second examples. In this example, the angular path for the locking element is formed partially as a slot in portion 12 of the body 10 and partially into a coaxial collar 40 press fitted onto the end 12. With this split construction there is better access to the guide path during manufacturing, to produce a polished finish with less friction.

Figs. 10A and 10B show a fourth example of the invention, where the bit locking element is a spherical ball 42 positioned at the distal end of the pin 15 within the angular path 14. The bit locking function is the same as shown in the earlier examples of the invention.

Fig. 10B is identical to Fig. 10A, except that it illustrates that the invention can be used not only with bits having a conventional circumferential groove 43 near their proximal ends (Fig. 10A), but also with bits having no such groove.

Figs. 11-14 show a fifth example of the invention, which is similar to the fourth example (Figs. 10A and 10B). In this example, the locking element is a spherical ball 42, but it is anchored to an extended hook portion 24 of sleeve 20, as best seen in Fig. 14.

5 Figs. 15A and 15B show a sixth example, which is a variation of the fifth example (Figs. 11-14). In this sixth example, the sleeve 20 is placed in front of the open end of the body/housing. The locking function is the same as in the previous examples, but in this case, to release the bit, the movement of the sleeve pushes the ball 42 away from its locking position instead of pulling it away.

10

Figs. 16A and 16B show a seventh example of the invention, which is an enhanced version of the sixth example (Figs. 15A and 15B). In this enhanced version, the bit can be locked in both axial directions by a dual-biased sliding sleeve 20. One locking element 42 locks the bit against movement in one direction, and the other locking element 42' locks the bit against movement in the other direction. The locking elements can be operated for bit release in one direction at a time. The extended anchoring portions 24 of the sleeve 20 have an open ended slot and another closed slot anchoring the locking elements.

15

Fig. 16C shows the sleeve 20 pushed forward from the holder. This forward movement of the sleeve forces the locking element 42' angularly away from the tool bit and thus frees the bit to be pushed deeper into the blind hole. Fig. 16D shows sleeve 20 pushed rearwardly, moving the locking element 42 away from the bit, hence freeing the bit to be extracted from the holder.

20

Figs. 17A-19 show an eighth and somewhat different example, where the bit locking element is at least one rotatable eccentric cam 44. This cam is lightly spring biased in a counter-clockwise direction by a spring 45. Point 'B' is the highest on the peripheral surface of the eccentric cam while point 'C' is the lowest. A slideable sleeve 20 is strongly biased towards the open end of bit insertion bit-accepting hole 13, keeping the eccentric cam 44 pushed in a clockwise direction such that the highest portion 'B' extends into the bit-accepting hole 13. As the tool bit 30 is inserted into the matching bit-accepting hole 13 of the holder, the eccentric cam 44 is pushed into counter-clockwise rotation until it rides on the bit surface 31, at the same time pushing the

25

30

sleeve 26 back against its bias. Thus the cam 44 acts as a rotating wedge clamping the tool bit 30 within the bit-accepting hole 13 of the holder. Any effort to pull out the tool bit tends to rotate the eccentric cam 44 in a clockwise direction, resulting in further tightening the grip on the bit. In order to release the tool bit, the sleeve 26
5 must be pulled back against axial spring bias, allowing cam 44 to rotate counter-clockwise, thus releasing clamping force on the bit for removal.

Figs. 20-22 show a ninth example, in which the wedge portion 50 is provided on the inner diameter of a slideable sleeve 52, the sleeve being biased towards the shank of the bit holder. The axial bias of the slideable wedge causes radial movement of a
10 locking element 42 sitting in a radial hole 54 in the body, the hole communicating with the bit-accepting recess 13 in the holder body. The sleeve 52 is pushed against the bias of the spring, towards the front end of the holder to insert the tool bit into the accepting bit-accepting hole 13. Once the bit is fully inserted, the sleeve is released, resulting in locking of the tool bit due to the radial force of the locking element. To
15 release the bit 30, the sleeve is pushed forward.

Fig. 23-25 show a tenth example, similar to the ninth example (Figs. 20-22). This tenth example provides automatic locking of the bit 30 on insertion. In order to release the bit 30, the sleeve 52 is pushed against the spring bias, resulting in taking the radial force off the locking element 42, such that the tool bit is then ejected by a
20 spring-loaded plunger 56. Fig. 24 shows a bit fully inserted, and Fig. 25 shows the collar being pushed forward and the bit being ejected.

For clarity and simplicity, most drawings do not show where the mechanism is installed. However, the usual and typical application is to mount the mechanism in a screwdriver (bit-driver) handle. Fig. 26 is a side cross-section showing a mechanism
25 according to the invention, mounted in a typical screwdriver/bitdriver handle 100. Obviously any one of the described examples of the invention can be so mounted.

It will be evident to those knowledgeable in the field of the invention that many variations on the examples described above are conceivable within the scope of the invention. It should therefore be understood that the claims which define the invention
30 are not restricted to the specific examples described above. Possible variations

include, for example, the shape of the pin, the structure of the connectivity and the shape of the tool bit profile.

Most of the examples described above show a single locking mechanism, for clarity of illustration, and for most applications a single mechanism may suffice. However, it
5 should also be appreciated that there can be more than one bit-locking mechanism. For example, Fig. 27 shows three such mechanisms positioned at 120 degrees to each other, to engage three of the faces of a hexagonal tool bit. Obviously, two opposing mechanisms could also be used, as shown in Fig. 28. Fig. 29 shows another example, where there are two mechanisms, offset by 120 degrees. Theoretically there could be
10 six mechanisms, but clearly that would neither be necessary nor practical.

It should also be appreciated that although most of the tool bits illustrated in the accompanying drawings are shown with a conventional circumferential groove near the proximal end of the bit, it is an advantage of this invention that the groove is not required for locking, unlike most prior art locking mechanisms. The locking means,
15 whether a pin or a roller or a ball or other, engages a flat portion of the tool bit, such that no groove is required. See Figs. 10B and 16A for specific examples of tool bits without grooves. However, it should be seen that in the other drawings, even when the tool bit does have a conventional groove, that groove is not engaged.

It should also be appreciated, as stated previously, that the tool bit does not need to be
20 a conventional hexagonal cross-section. Other non-circular cross-sections can be used, such as those shown in Figs. 30 and 31 (tri-centric and ovaloid respectively).

Further variations may be apparent or become apparent to those knowledgeable in the field of the invention, within the scope of the invention as defined by the claims which follow.

CLAIMS:

1. A bit holder having a shank at a proximal end thereof and a blind bit-accepting hole at a distal end thereof, said bit-accepting hole being shaped to receive a correspondingly-shaped tool bit, the bit holder having at least one locking mechanism comprising an angled path defined in said bit holder, opening into a side of said bit-accepting hole, extending away from said bit-accepting hole in a proximal direction at an acute angle A from a central axis of said bit holder, and a locking element slideable in said path, such that a distal end of said locking element extends slightly into said bit-accepting hole, said bit holder further comprising a sleeve mounted around said shank, biased by a spring to urge said locking element towards said bit-accepting hole, connected to said locking element such that moving said sleeve towards the proximal end of said bit holder retracts said locking element from said bit-accepting hole; wherein said locking element comprises a ball and wherein said sleeve has a hook portion extending therefrom to capture said ball.
2. The bit holder of claim 1, wherein said locking element comprises a pin connected to said sleeve, for a distal end of said pin to contact a tool bit.
3. The bit holder of claim 1, wherein said locking element comprises a pin connected to said sleeve, said pin having a roller mounted at a distal end thereof to contact a tool bit.
4. The bit holder of claim 1, further comprising a second angled path defined in said bit holder, opening into a side of said bit-accepting hole, extending away from said bit-accepting hole in a distal direction at an acute angle A from a central axis of said bit holder, and comprising a second locking element, whereby said tool bit is locked against movement in both directions until said sleeve is moved.
5. The bit holder of any one of claims 1 to 4, comprising more than one said locking mechanism spaced apart radially.
6. The bit holder of any one of claims 1 to 5, further comprising a spring-loaded plunger mounted in a proximal end of said blind hole, to eject a said tool bit when said locking element is released by moving said sleeve.

7. The bit holder of any one of claims 1 to 6, wherein said bit and said bit-accepting hole are hexagonal in cross-section.
8. The bit holder of any one of claims 1 to 6, wherein said bit and said bit-accepting hole are non-circular in cross-section.
9. A bitdriver comprising the bit holder of any one of claims 1 to 8, and having a handle mounted on said shank.

1/9

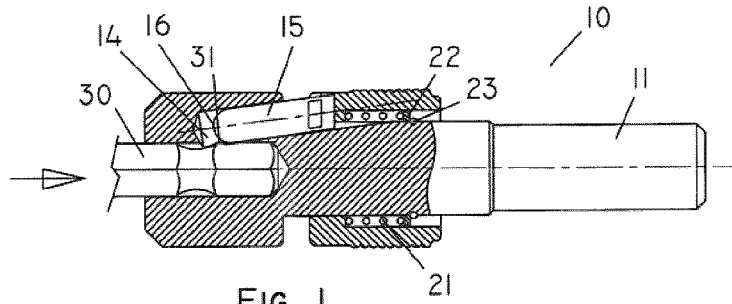

FIG. 1

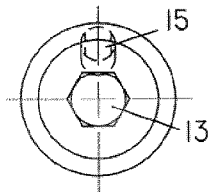

FIG. 2B

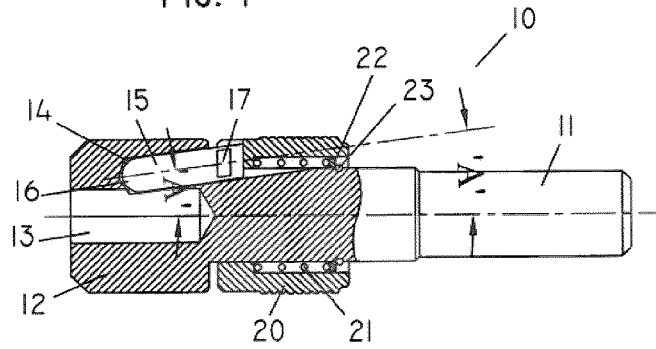

FIG. 2A

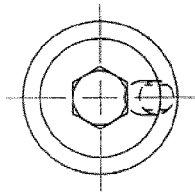

FIG. 3B

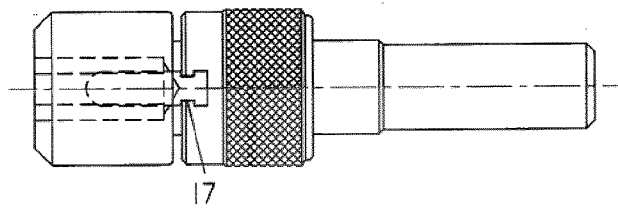

FIG. 3A

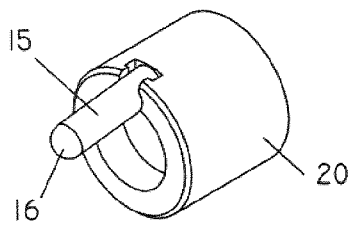

FIG. 4A

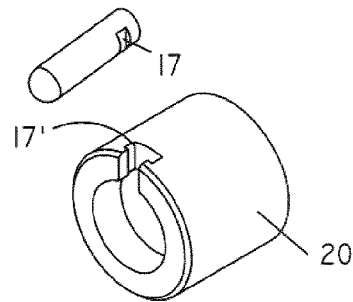

FIG. 4B

2/9

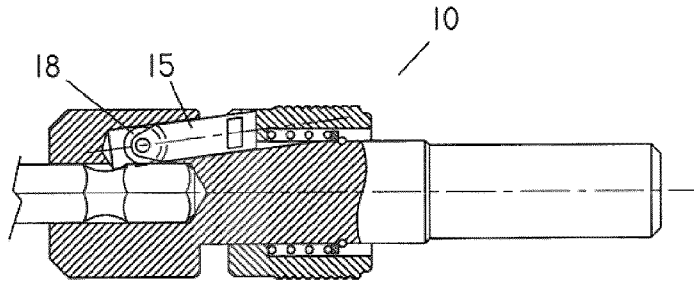

FIG. 5

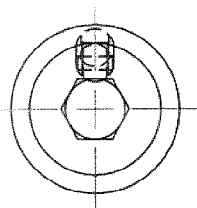

FIG. 6B

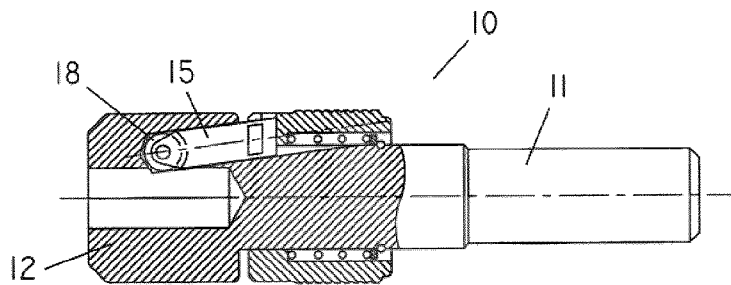

FIG. 6A

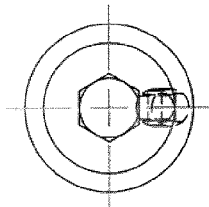

FIG. 7B

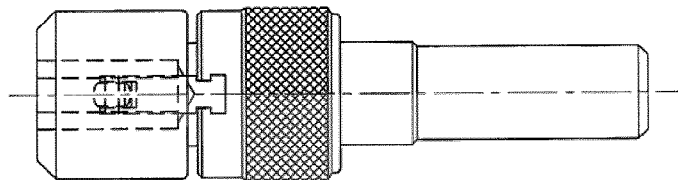

FIG. 7A

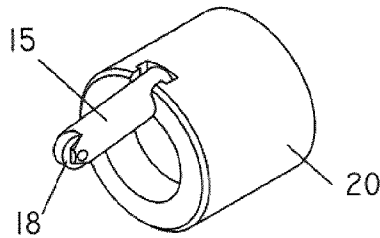

FIG. 8

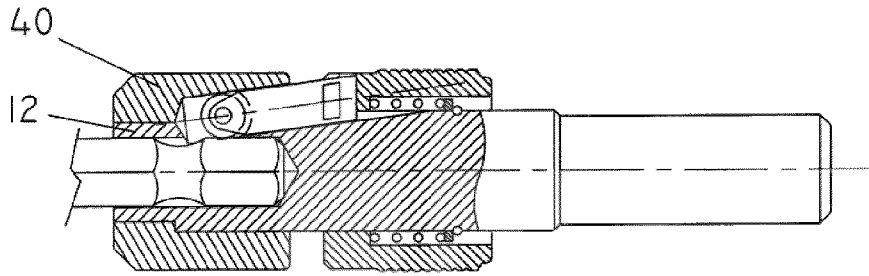

FIG. 9

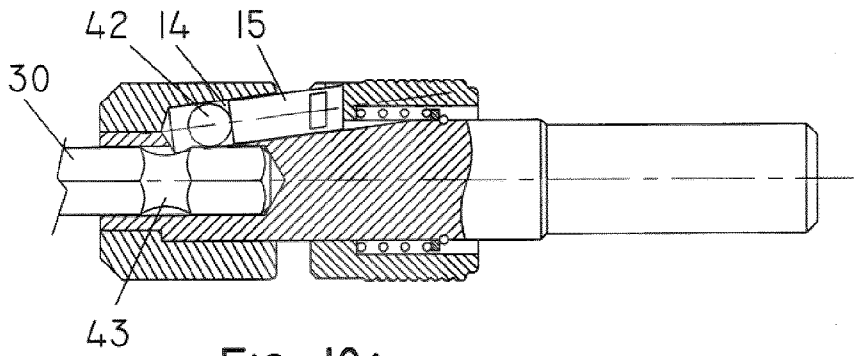

FIG. 10A

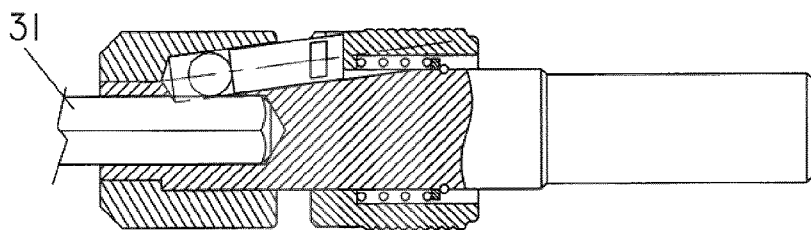

FIG. 10B

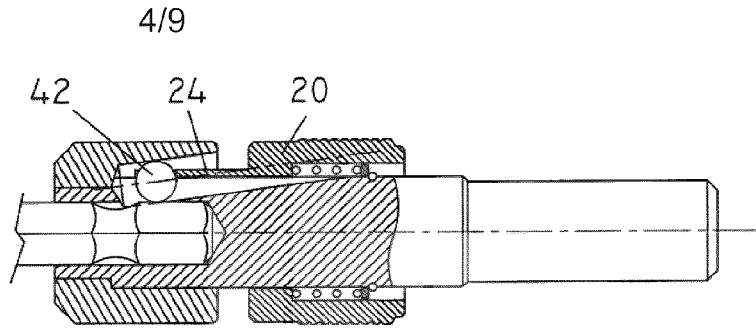

FIG. II

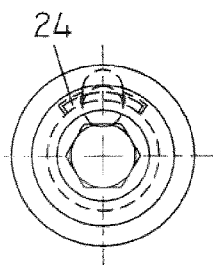

FIG. 12B

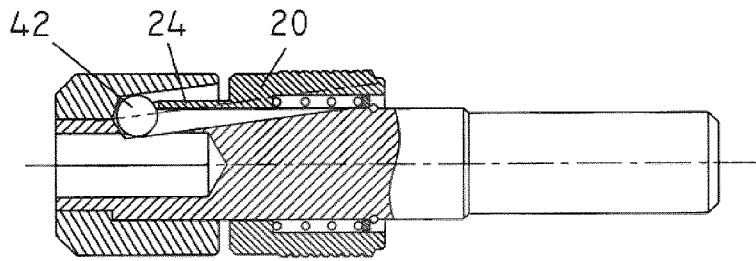

FIG. 12A

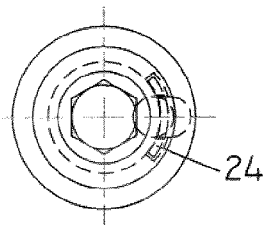

FIG. 13B

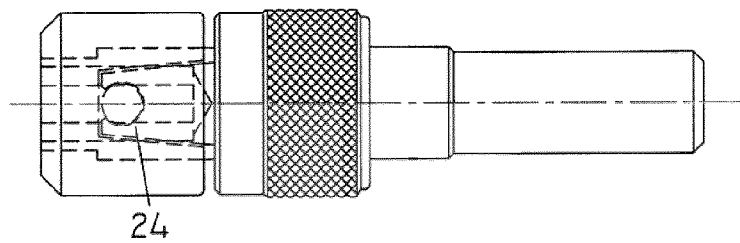

FIG. 13A

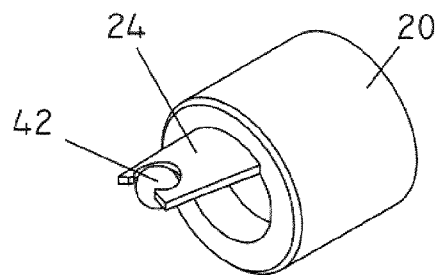

FIG. 14

5/9

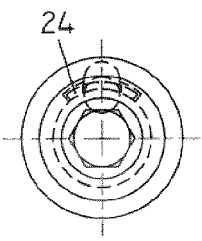

FIG. 15B

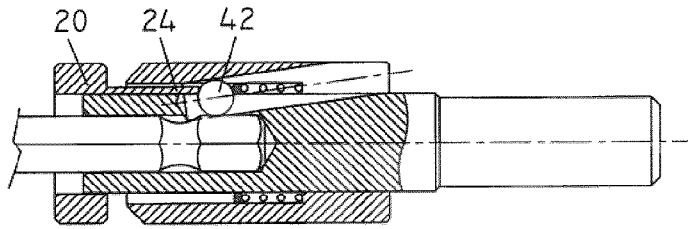

FIG. 15A

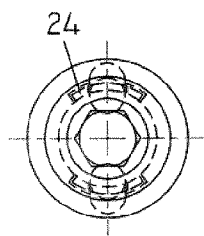

FIG. 16B

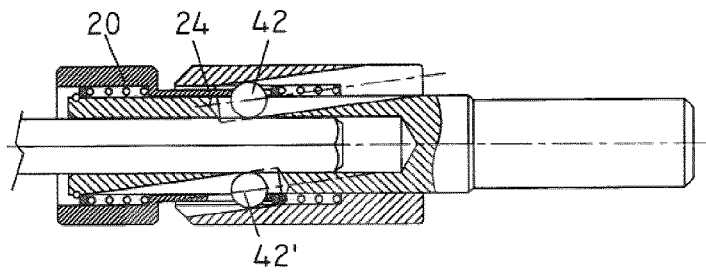

FIG. 16A

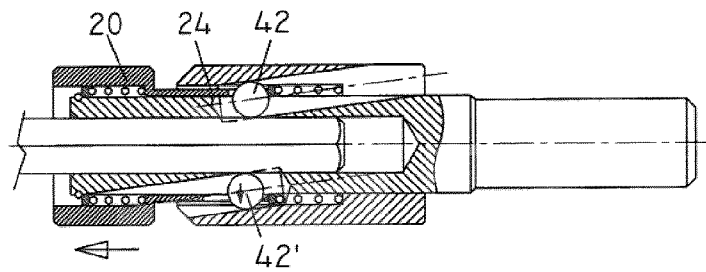

FIG. 16C

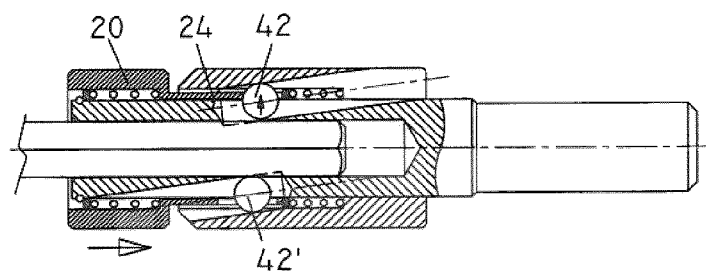

FIG. 16D

6/9

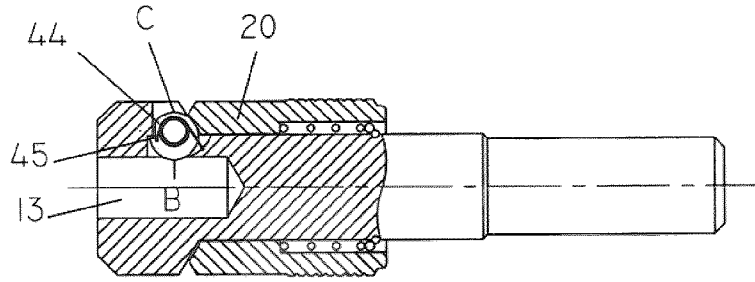

Fig. 17a

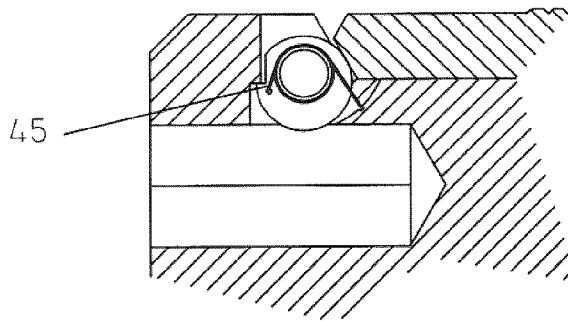

Fig. 17b

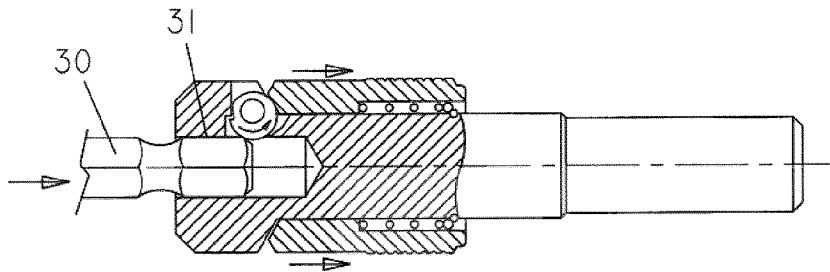

Fig. 18

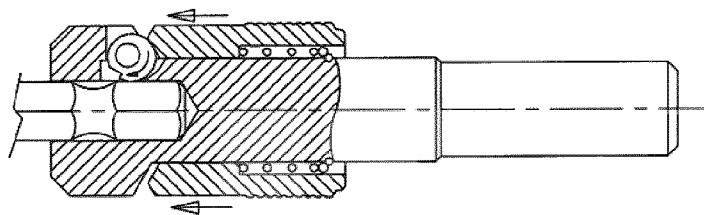

Fig. 19

7/9

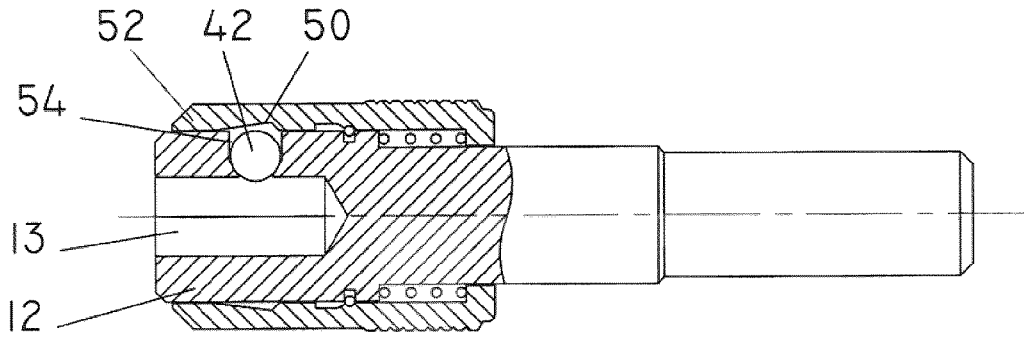

FIG. 20

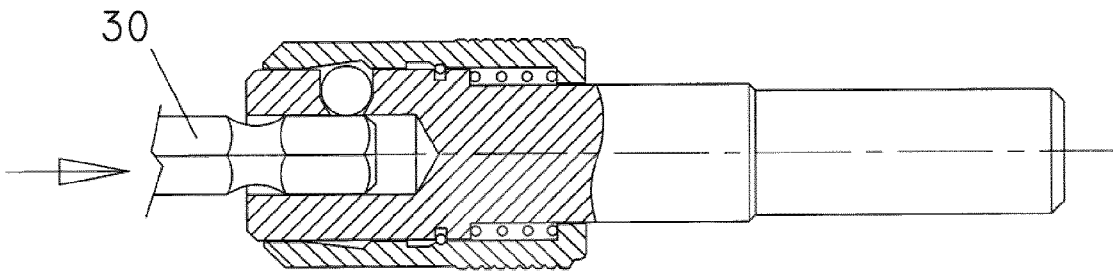

FIG. 21

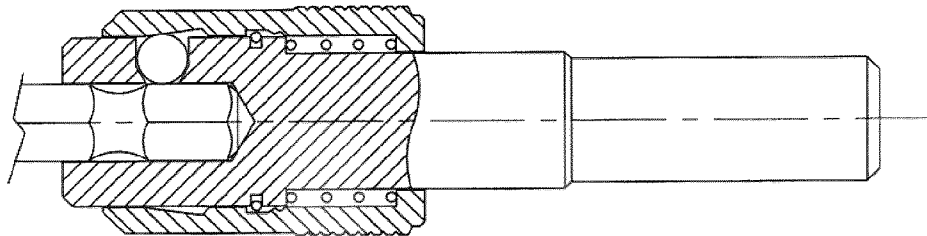

FIG. 22

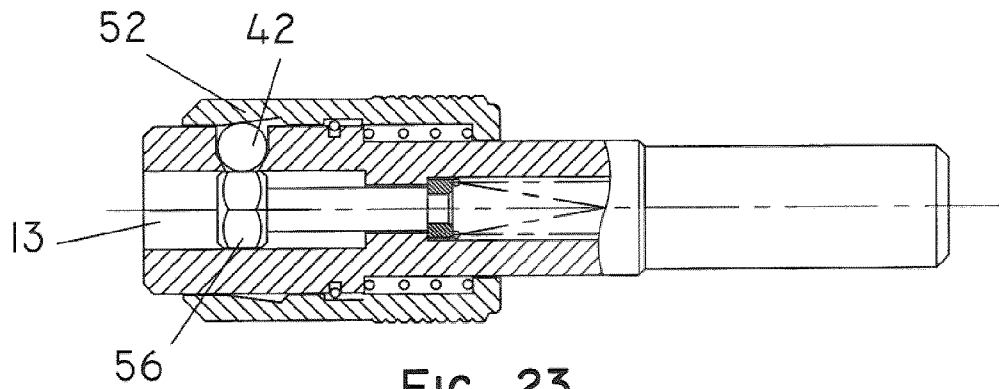

FIG. 23

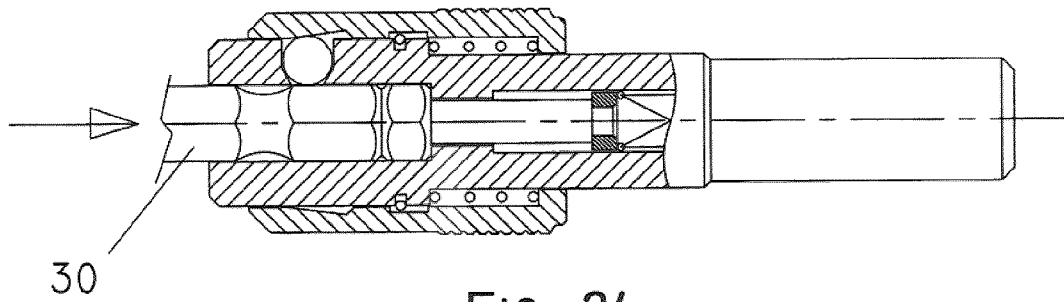

FIG. 24

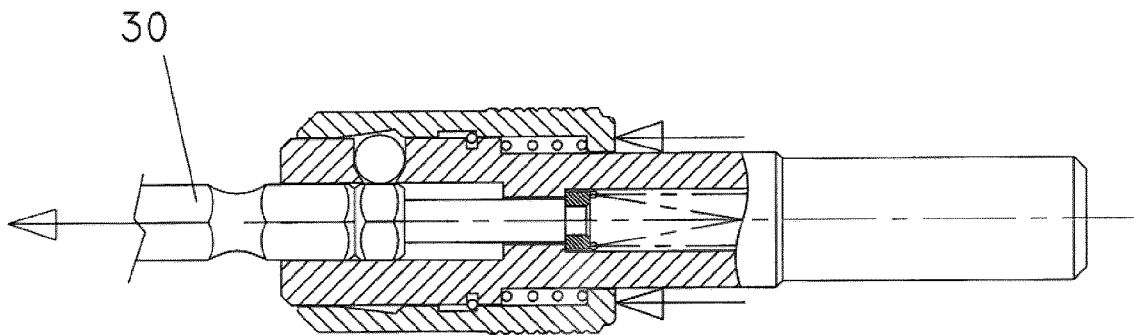

FIG. 25

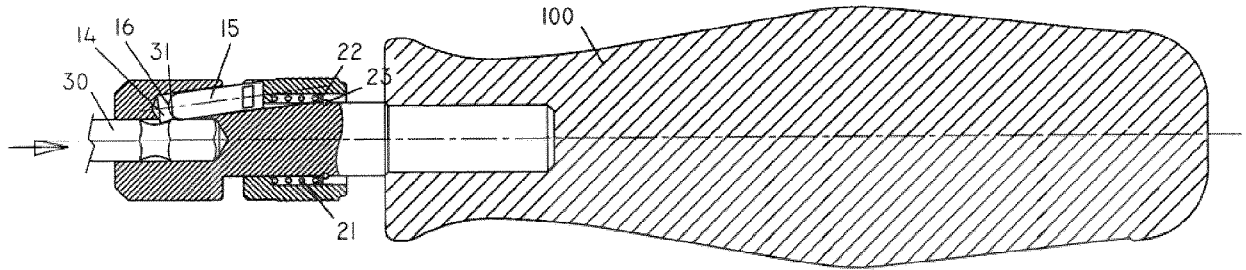

FIG. 26

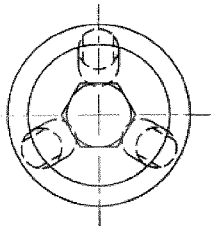

FIG. 27

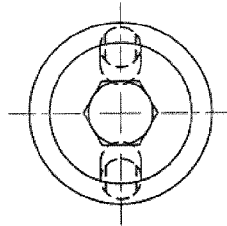

FIG. 28

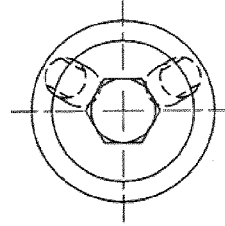

FIG. 29

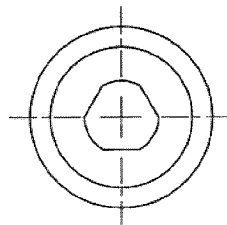

FIG. 30

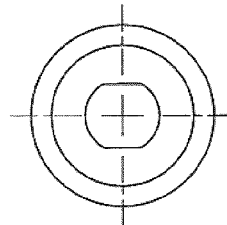

FIG. 31

