



(12) **EUROPEAN PATENT APPLICATION**

(88) Date of publication A3:  
**13.04.2005 Bulletin 2005/15**

(51) Int Cl.7: **G07F 7/06**

(43) Date of publication A2:  
**08.12.2004 Bulletin 2004/50**

(21) Application number: **04012698.9**

(22) Date of filing: **28.05.2004**

(84) Designated Contracting States:  
**AT BE BG CH CY CZ DE DK EE ES FI FR GB GR  
HU IE IT LI LU MC NL PL PT RO SE SI SK TR**  
Designated Extension States:  
**AL HR LT LV MK**

(72) Inventor: **Sordella, Giacomino**  
**12038 Savigliano (Cuneo) (IT)**

(74) Representative: **Buzzi, Franco**  
**Buzzi, Notaro & Antonielli d'Oulx S.r.l.**  
**Via Maria Vittoria 18**  
**10123 Torino (IT)**

(30) Priority: **03.06.2003 IT TO20030408**

(71) Applicant: **LA BOITA S.r.l.**  
**I-12035 Racconigi (Cuneo) (IT)**

(54) **Coin-operated lock for supermarket carts, luggage trolleys and the like**

(57) Coin-operated lock for supermarket carts, luggage trolleys and the like, comprising a case (1) with a slit (4) for the introduction/extraction of a coin or token (M) and an opening (5) for the introduction/extraction of

a key, and a mechanism housed inside the case (1) and formed by a single piece (7) able to achieve the locking, the unlocking and the extraction of the key (6) as well as to retain the coin or token (M) and to eject it.

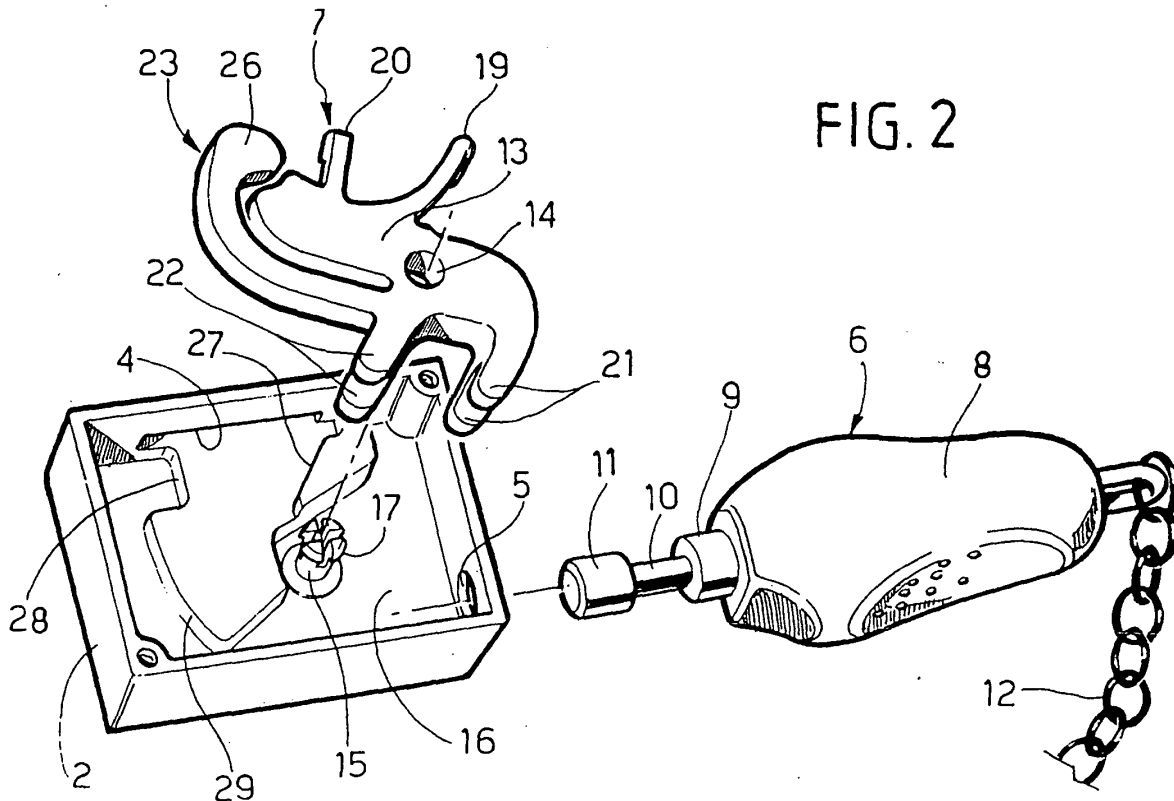



DOCUMENTS CONSIDERED TO BE RELEVANT			
Category	Citation of document with indication, where appropriate, of relevant passages	Relevant to claim	CLASSIFICATION OF THE APPLICATION (Int.Cl.7)
A	FR 2 645 306 A (MORS) 5 October 1990 (1990-10-05) * abstract * * figures 5-9 *	1-26	G07F7/06
A	FR 2 730 839 A (LEBOIME PIERRE RENE CHARLES) 23 August 1996 (1996-08-23) * abstract * * figures 1,2 *	1-26	
D,A	EP 1 035 523 A (SYSTEC POS-TECHNOLOGY GMBH) 13 September 2000 (2000-09-13) * the whole document *	1-26	
A	US 4 924 994 A (PINSSON ET AL) 15 May 1990 (1990-05-15) * the whole document *	1-26	
A	WO 92/20047 A (PROTONOR ENGINEERING OY) 12 November 1992 (1992-11-12) * page 1, line 1 - page 8, line 16 * * figures 1-4 *	1-26	
			TECHNICAL FIELDS SEARCHED (Int.Cl.7)
			G07F
The present search report has been drawn up for all claims			
Place of search		Date of completion of the search	Examiner
The Hague		11 February 2005	Diepstraten, M
<p>CATEGORY OF CITED DOCUMENTS</p> <p>X : particularly relevant if taken alone                      Y : particularly relevant if combined with another document of the same category                      A : technological background                      O : non-written disclosure                      P : intermediate document</p> <p>T : theory or principle underlying the invention                      E : earlier patent document, but published on, or after the filing date                      D : document cited in the application                      L : document cited for other reasons                      &amp; : member of the same patent family, corresponding document</p>			

3  
EPO FORM 1508 03.82 (F04C01)

**ANNEX TO THE EUROPEAN SEARCH REPORT  
ON EUROPEAN PATENT APPLICATION NO.**

EP 04 01 2698

This annex lists the patent family members relating to the patent documents cited in the above-mentioned European search report. The members are as contained in the European Patent Office EDP file on  
The European Patent Office is in no way liable for these particulars which are merely given for the purpose of information.

11-02-2005

Patent document cited in search report		Publication date	Patent family member(s)	Publication date
FR 2645306	A	05-10-1990	FR 2645306 A1	05-10-1990
FR 2730839	A	23-08-1996	FR 2730839 A1	23-08-1996
EP 1035523	A	13-09-2000	DE 19911013 A1	14-09-2000
			BR 0001276 A	31-10-2000
			CN 1267045 A	20-09-2000
			EP 1035523 A2	13-09-2000
			PL 338970 A1	25-09-2000
US 4924994	A	15-05-1990	FR 2612321 A1	16-09-1988
			AT 66079 T	15-08-1991
			AU 593466 B2	08-02-1990
			AU 1284388 A	15-09-1988
			CA 1285400 C	02-07-1991
			DE 3864057 D1	12-09-1991
			DK 127088 A	12-09-1988
			EP 0286460 A1	12-10-1988
			FI 881156 A ,B,	12-09-1988
			NO 881079 A ,B,	12-09-1988
WO 9220047	A	12-11-1992	FI 912225 A	09-11-1992
			AU 1654492 A	21-12-1992
			WO 9220047 A1	12-11-1992
			PT 100469 A	29-04-1994