



(86) **Date de dépôt PCT/PCT Filing Date:** 2014/06/05
(87) **Date publication PCT/PCT Publication Date:** 2014/12/11
(45) **Date de délivrance/Issue Date:** 2024/06/11
(85) **Entrée phase nationale/National Entry:** 2015/12/07
(86) **N° demande PCT/PCT Application No.:** US 2014/041010
(87) **N° publication PCT/PCT Publication No.:** 2014/197656
(30) **Priorités/Priorities:** 2013/06/07 (US61/832,512);
2014/06/04 (US14/295,953)

(51) **Cl.Int./Int.Cl. A61M 25/00** (2006.01),
A61M 25/06 (2006.01), **A61M 39/00** (2006.01)

(72) **Inventeurs/Inventors:**
ISAACSON, S. RAY, US;
BORNHOFT, STEPHEN T., US;
HARDING, WESTON F., US;
MA, YIPING, US;
SHEVGOOR, SIDDARTH K., US

(73) **Propriétaire/Owner:**
BECTON, DICKINSON AND COMPANY, US

(74) **Agent:** GOWLING WLG (CANADA) LLP

(54) **Titre : CATHETER INTRAVEINEUX PORTE AYANT UN PROTECTEUR D'AIGUILLE EXTERNE ET UNE CLOISON DE
REGULATION DE SANG INTERNE**

(54) **Title: PORTED IV CATHETER HAVING EXTERNAL NEEDLE SHIELD AND INTERNAL BLOOD CONTROL SEPTUM**

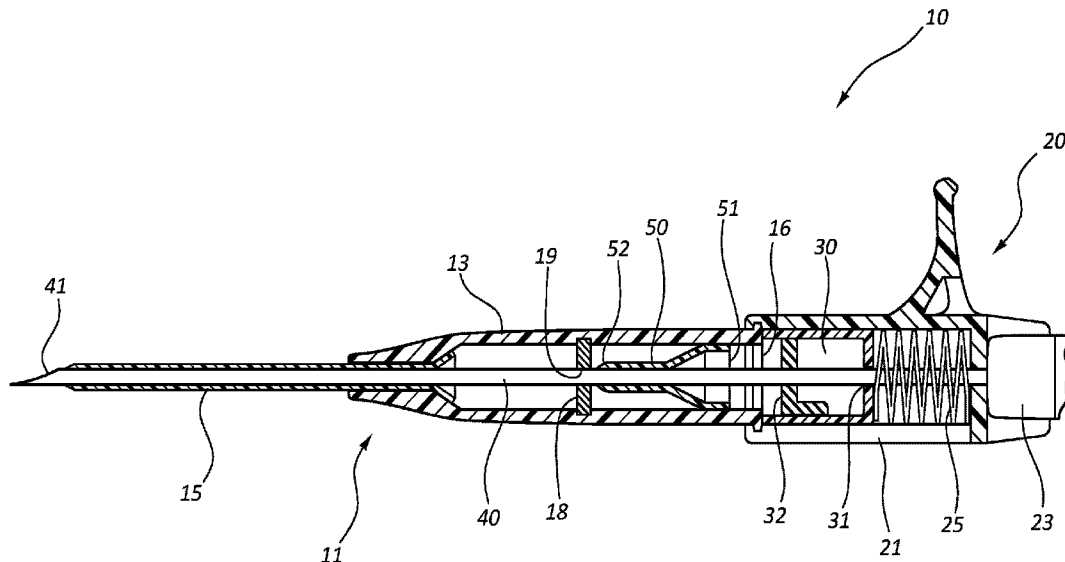

(57) **Abbrégé/Abstract:**

An extravascular system (10) is provided which includes a catheter adapter (13) having a blood control septum (18) configured to control flow of a fluid through the catheter adapter, the catheter adapter further having a catheter (15) configured for intravenous insertion. The extravascular system further includes a septum activator (50) slidably inserted within the catheter adapter and configured for advancement through the blood control septum to provide a fluid pathway through the blood control septum. Further still, the extravascular system includes an external safety mechanism comprising a needle hub (21) and a needle shield (30) interconnected via a tether (25), wherein the needle shield includes a safety clip (32) that is configured to retain a sharpened end of the introducer needle (40) within the needle shield.

(12) INTERNATIONAL APPLICATION PUBLISHED UNDER THE PATENT COOPERATION TREATY (PCT)

(19) World Intellectual Property
Organization
International Bureau



(10) International Publication Number
WO 2014/197656 A1

(43) International Publication Date
11 December 2014 (11.12.2014)

(51) International Patent Classification:

A61M 25/00 (2006.01) *A61M 25/06* (2006.01)
A61M 39/00 (2006.01)

(21) International Application Number:

PCT/US2014/041010

(22) International Filing Date:

5 June 2014 (05.06.2014)

(25) Filing Language:

English

(26) Publication Language:

English

(30) Priority Data:

61/832,512	7 June 2013 (07.06.2013)	US
14/295,953	4 June 2014 (04.06.2014)	US

(71) Applicant: BECTON, DICKINSON AND COMPANY
[US/US]; 1 Becton Drive, Mail Code 110, Franklin Lakes,
New Jersey 07417-1880 (US).

(72) Inventors; and

(71) Applicants : ISAACSON, S. Ray [US/US]; 4360 South
2175 West, Roy, Utah 84067 (US). BORNHOFT, Steph-
en T. [US/US]; 968 Descent Road, Apt. M208, Midvale,
Utah 84047 (US). HARDING, Weston F. [US/US]; 2421
North 910 West, Lehi, Utah 84043 (US). MA, Yiping
[US/US]; 2220 North 2300 East, Layton, Utah 84040
(US). SHEVGOOR, Siddarth K. [IN/US]; 9450 South
State Street, Sandy, Utah 84070 (US).

(74) Agents: HGHET, David W. et al.; Becton, Dickinson
and Company, 1 Becton Drive, Mail Code 110, Franklin
Lakes, New Jersey 07417-1880 (US).

(81) Designated States (*unless otherwise indicated, for every
kind of national protection available*): AE, AG, AL, AM,
AO, AT, AU, AZ, BA, BB, BG, BH, BN, BR, BW, BY,
BZ, CA, CH, CL, CN, CO, CR, CU, CZ, DE, DK, DM,
DO, DZ, EC, EE, EG, ES, FI, GB, GD, GE, GH, GM, GT,
HN, HR, HU, ID, IL, IN, IR, IS, JP, KE, KG, KN, KP, KR,
KZ, LA, LC, LK, LR, LS, LT, LU, LY, MA, MD, ME,
MG, MK, MN, MW, MX, MY, MZ, NA, NG, NI, NO, NZ,
OM, PA, PE, PG, PH, PL, PT, QA, RO, RS, RU, RW, SA,
SC, SD, SE, SG, SK, SL, SM, ST, SV, SY, TH, TJ, TM,
TN, TR, TT, TZ, UA, UG, US, UZ, VC, VN, ZA, ZM,
ZW.

(84) Designated States (*unless otherwise indicated, for every
kind of regional protection available*): ARIPO (BW, GH,
GM, KE, LR, LS, MW, MZ, NA, RW, SD, SL, SZ, TZ,
UG, ZM, ZW), Eurasian (AM, AZ, BY, KG, KZ, RU, TJ,
TM), European (AL, AT, BE, BG, CH, CY, CZ, DE, DK,
EE, ES, FI, FR, GB, GR, HR, HU, IE, IS, IT, LT, LU, LV,
MC, MK, MT, NL, NO, PL, PT, RO, RS, SE, SI, SK, SM,
TR), OAPI (BF, BJ, CF, CG, CI, CM, GA, GN, GQ, GW,
KM, ML, MR, NE, SN, TD, TG).

Published:

— with international search report (Art. 21(3))

(54) Title: PORTED IV CATHETER HAVING EXTERNAL NEEDLE SHIELD AND INTERNAL BLOOD CONTROL SEPTUM

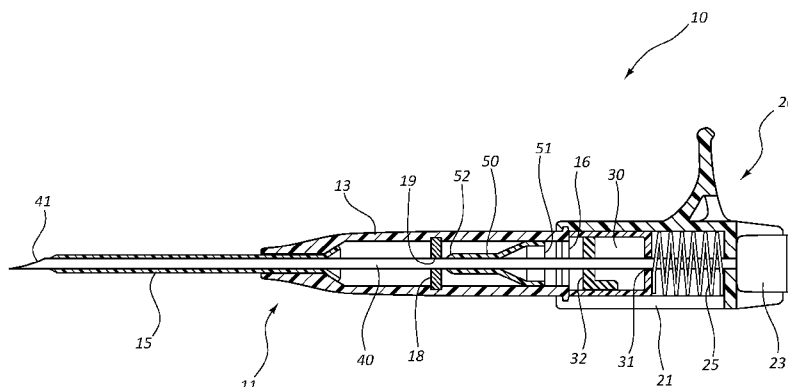

FIG. 2

(57) Abstract: An extravascular system (10) is provided which includes a catheter adapter (13) having a blood control septum (18) configured to control flow of a fluid through the catheter adapter, the catheter adapter further having a catheter (15) configured for intravenous insertion. The extravascular system further includes a septum activator (50) slidably inserted within the catheter adapter and configured for advancement through the blood control septum to provide a fluid pathway through the blood control septum. Further still, the extravascular system includes an external safety mechanism comprising a needle hub (21) and a needle shield (30) interconnected via a tether (25), wherein the needle shield includes a safety clip (32) that is configured to retain a sharpened end of the introducer needle (40) within the needle shield.

PORTED IV CATHETER HAVING EXTERNAL NEEDLE SHIELD AND INTERNAL BLOOD CONTROL SEPTUM

FIELD OF THE INVENTION

[0001] The present invention relates to various intravenous (IV) catheter devices having an integrated external needle safety mechanism, an internal blood control valve or septum, and integrated septum activator. More particularly, the present invention relates to an IV catheter assembly having a catheter adapter comprising a blood control septum, and a needle shield selectively coupled to a proximal end of the catheter adapter. The needle shield is configured to catch and retain the sharpened, distal point of an introducer needle following catheterization of a patient. The septum activator is advanced through the blood control septum to provide a fluid pathway therethrough. In some instances the septum activator is advanced through the blood control septum by inserting a Luer device into the catheter adapter as part of an infusion procedure. Some implementations of the present invention further comprise a needle shield that is tethered to a needle hub such that the needle hub, introducer needle, and needle shield form a unitary structure that is removed from the catheter adapter following a catheterization procedure.

BACKGROUND OF THE INVENTION

[0002] Generally, vascular access devices are used for communicating fluid with the vascular system of patients. For example, catheters are used for infusing fluid, such as normal saline solution, various medicaments, and total parenteral nutrition, into a patient, withdrawing blood from a patient, or monitoring various parameters of the patient's vascular system.

[0003] A common type of intravenous (IV) catheter is an over-the-needle peripheral IV catheter. As its name implies, an over-the-needle catheter is mounted over an introducer needle having a sharp distal tip. At least the inner surface of the distal portion of the catheter tightly engages the outer surface of the needle to prevent peelback of the catheter and thus facilitate insertion of the catheter into the blood vessel. The catheter and the introducer needle are assembled so that the distal tip of the introducer needle extends beyond the distal tip of the catheter with the bevel of the needle facing up away from the patient's skin. The catheter and introducer needle are generally inserted at a shallow angle through the patient's skin into a blood vessel.

[0004] In order to verify proper placement of the needle and/or catheter in the blood vessel, the clinician generally confirms that there is “flashback” of blood in a flashback chamber of the catheter assembly. Once proper placement of the catheter into the blood vessel is confirmed, the clinician may apply pressure to the blood vessel by pressing down on the patient’s skin over the blood vessel distal of the introducer needle and the catheter. This finger pressure occludes the vessel, minimizing further blood flow through the introducer needle and the catheter.

[0005] The clinician may then withdraw the introducer needle from the catheter. The introducer needle may be withdrawn into a needle tip shield device that covers the needle tip and prevents accidental needle sticks. In general, a needle shield includes a housing, a sleeve, or other similar device that is designed such that when the needle is withdrawn from the patient, the needle tip will be trapped/captured within the needle tip shield. The purpose of these needle tip shield devices is to house the tip of the needle in a secure location, thereby avoiding the possibility of needle sticks after the needle and needle shield device are separated from the catheter, which is left in place to provide intravenous access to the patient.

[0006] Various systems and methods are available that are designed to shield needle tips and then be separated from the remainder of a catheter assembly following catheterization. Some currently available tip shield systems locate the tip shield within the catheter assembly, thereby exposing various surfaces of the needle shield to blood present within the catheter assembly. Upon removal of the tip shield from the catheter assembly, blood may be flicked or splattered, thereby exposing the clinician to blood and blood borne pathogens. Accordingly, there is a need in the art for a catheter assembly having tip shielding features that overcomes the failings of present devices. Such a catheter assembly is provided herein.

BRIEF SUMMARY OF THE INVENTION

[0007] The present invention has been developed in response to problems and needs in the art that have not yet been fully resolved by currently available vascular access systems and methods. Thus, these systems and methods are developed to provide more efficient vascular access systems and methods capable of ensuring proper needle tip shield function.

[0008] An extravascular system for accessing the vasculature of a patient may include a catheter adapter having a distal end supporting a catheter, and further comprising a proximal opening, wherein the catheter adapter includes a lumen extending therebetween. The extravascular system further includes a blood control septum disposed within the lumen of

the catheter adapter and dividing the lumen into a proximal fluid chamber and a distal fluid chamber. In some instances, an extravascular system is provided having a septum activator slidably positioned within the proximal fluid chamber, wherein the septum activator includes a base and a probe end. The system further includes an external safety mechanism removably coupled to the proximal opening of the catheter adapter and comprising a safety clip configured to secure a sharpened tip of an introducer needle.

[0009] Some implementations of the present invention further include an external safety mechanism having a needle shield housing a safety clip that is configured to retain a sharpened tip of the introducer needle within the needle shield. The external safety mechanism may also include a needle hub having a first end for securing a proximal end of the introducer needle, and a second end configured to temporarily house the needle shield, wherein the needle shield is slidably housed within the second end. The needle hub may be temporarily coupled to the catheter adapter and configured to support an introducer needle, the introducer needle extending outwardly from the needle hub and through the catheter adapter, septum activator, blood control septum and catheter.

[0010] In some instances, the present invention includes a safety clip having a pawl or other structural feature configured to prevent the sharpened tip of the introducer needle from exiting a distal opening of the needle shield. The safety clip may also be configured to selectively interconnect the needle shield and the catheter adapter. In some instances, the external safety mechanism is configured to be removed from the proximal opening of the catheter adapter following removal of the sharpened tip of the introducer needle from the catheter and catheter adapter.

[0011] Some implementations of the present invention further include a tether that is configured to couple the needle shield to the needle hub. The tether includes a first end coupled to the needle hub and a second end coupled to the needle shield, the tether having a length that provides a maximum distance between the needle hub and the needle shield, wherein the maximum distance positions and retains the sharpened tip within the needle shield. Some implementations of the present invention further include a blood control septum having a self-sealing or self-closing opening, such as a slit. The blood control septum is further configured to control a flow of a fluid through the catheter adapter. The blood control septum may be activated or opened to selectively permit passage of fluids through the lumen of the catheter adapter.

[0012] Other implementations of the present invention comprise a catheter adapter having a proximal opening that is configured to receive a Luer adapter. Some embodiments include a proximal opening having a structural feature configured to receive a Luer adapter, such as a set of threads or a detent.

[0013] Some implementations of the present invention further include a septum activator or actuator that is configured to be selectively advanced through the blood control septum, to provide a fluid pathway therethrough. In some instances, the septum activator comprises a base configured to contact a Luer adapter that is inserted within the proximal opening of the catheter adapter. The septum activator is slidably inserted within the catheter adapter and configured for advancement through the blood control septum when contacted and advanced in a distal direction by the Luer adapter. The septum activator further comprises a pathway through which the introducer needle passes, and wherein the pathway provides fluid communication between the proximal and distal fluid chambers when the septum activator is advanced through the blood control septum.

[0014] Some implementations of the present invention further include a safety clip that is moveable between a first position and a second position, wherein the first position permits passage of the sharpened tip through a distal opening of the external safety mechanism, and the second position prevents passage of the sharpened tip through the distal opening of the external safety mechanism.

[0015] Some implementations of the present invention further include an access port that is coupled to, or forms a portion of the catheter adapter. The access port comprises an inner lumen that may be accessed via a needleless connector, such as a syringe or Luer adapter. The catheter adapter further includes a defeatable barrier that is seated within an annular groove formed on the inner surface of the catheter adapter and forms a sealed interface with the inner lumen of the access port. In some instances, the defeatable barrier is placed in the catheter adapter and immobilized solely via a friction fit. The defeatable barrier is defeated by inserting an external device into the inner lumen of the access port, whereby the external device contacts and temporarily defeats the barrier. In other instances, fluid pressure from the external device builds up within the access port until the barrier is defeated and the fluid is allowed to bypass the barrier and flow into the lumen of the catheter adapter. Once defeated, fluid communication is provided between the inner lumen of the access port and the lumen or fluid pathway of the catheter adapter. Upon removal of the external device, the resilient nature of the defeatable barrier causes the barrier to resume its tubular shape, thereby

reestablishing its sealed interface with the inner lumen of the access port. The sealed interface prevents active fluid communication between the inner lumen and the lumen of the catheter adapter. In some instances, the defeatable barrier comprises a non-tubular shape or configuration.

[0016] Some implementations of the present invention include a method for manufacturing an extravascular system, wherein the method includes steps for: 1) providing a catheter adapter having a distal end supporting a catheter, and further comprising a proximal opening, the catheter adapter having a lumen; 2) disposing a blood control septum within the lumen of the catheter adapter, the blood control septum dividing the lumen into a proximal fluid chamber and a distal fluid chamber; 3) slidably positioning a septum activator within the proximal fluid chamber, the septum activator having a base and a probe end; and 4) removably coupling an external safety mechanism to the proximal opening of the catheter adapter, the external safety mechanism having a safety clip that is configured to secure a sharpened tip of an introducer needle.

[0017] These and other features and advantages of the present invention may be incorporated into certain embodiments of the invention and will become more fully apparent from the following description and appended claims, or may be learned by the practice of the invention as set forth hereinafter. The present invention does not require that all the advantageous features and all the advantages described herein be incorporated into every embodiment of the invention.

BRIEF DESCRIPTION OF THE SEVERAL VIEWS OF THE DRAWINGS

[0018] In order that the manner in which the above-recited and other features and advantages of the invention are obtained will be readily understood, a more particular description of the invention briefly described above will be rendered by reference to specific embodiments thereof which are illustrated in the appended drawings. These drawings depict only typical embodiments of the invention and are not therefore to be considered to limit the scope of the invention.

[0019] Figure 1 is a perspective view of a catheter assembly in accordance with a representative embodiment of the present invention.

[0020] Figure 2 is a cross-section view of a catheter assembly in accordance with a representative embodiment of the present invention.

[0021] Figure 3 is an exploded view of the catheter assembly of Figure 1 in accordance with a representative embodiment of the present invention.

[0022] Figure 4 is a cross-section view of a catheter assembly following separation of the needle shield assembly from the catheter adapter in accordance with a representative embodiment of the present invention.

[0023] Figure 5 is a cross-section view of a catheter assembly coupled to a Luer device, wherein the septum activator is advanced through the blood control septum in accordance with a representative embodiment of the present invention.

[0024] Figure 6, shown in parts A-H, provides various plan and cross-section views of an extravascular access device in accordance with a representative embodiment of the present invention.

[0025] Figure 7, shown in parts A-E, provides various views of an extravascular access device in accordance with a representative embodiment of the present invention.

[0026] Figure 8, shown in parts A-F, provides various views of an extravascular access device in accordance with a representative embodiment of the present invention.

[0027] Figure 9, shown in parts A and B, provides a cross-section view of an extravascular access device in accordance with a representative embodiment of the present invention.

[0028] Figure 10, shown in parts A-D, provides various plan and cross-section views of an extravascular access device in accordance with a representative embodiment of the present invention.

[0029] Figure 11, shown in parts A-D, provides various plan and cross-section views of an extravascular access device in accordance with a representative embodiment of the present invention.

[0030] Figures 12A-17B provide various views of acceptable combinations of the features disclosed herein to provide an extravascular access device in accordance with a representative embodiment of the present invention.

DETAILED DESCRIPTION OF THE INVENTION

[0031] The presently preferred embodiments of the present invention will be best understood by reference to the drawings, wherein like reference numbers indicate identical or functionally similar elements. It will be readily understood that the components of the present invention, as generally described and illustrated in the figures herein, could be arranged and designed in a wide variety of different configurations. Thus, the following more detailed description, as represented in the figures, is not intended to limit the scope of the

invention as claimed, but is merely representative of presently preferred embodiments of the invention.

[0032] Referring to Figure 1, a perspective view illustrates an example of an extravascular system 10 incorporating an external safety mechanism. In this example the extravascular system 10 includes a catheter assembly 11 and an external safety mechanism comprising a needle assembly 20. The catheter assembly 11 includes a catheter adapter 13 having a distal end 14 configured to support an intravenous catheter 15. Intravenous catheter 15 is configured for insertion into the vasculature of a patient, and therefore may comprise any length and diameter sufficient to access a desired vein or artery of the patient. Catheter 15 may further comprise any material or combination of materials compatible for use with the vasculature of a patient. For example, in some embodiments catheter 15 comprises a polymer material, such as polyvinyl chloride, polypropylene, silicone, Teflon, nylon, and/or latex rubber.

[0033] Catheter adapter 13 further comprises a proximal end 16 having an opening whereby to access an interior lumen of catheter adapter 13. In some embodiments, proximal end 16 further comprises structural features to accommodate attachment of various Luer devices to catheter adapter 13. For example, in some embodiments proximal end 16 comprises a set of threads. Proximal end 16 is further configured to compatibly and selectively receive needle assembly 20.

[0034] Needle assembly 20 comprises a needle hub 21 having a distal opening 22 that is configured to compatibly and selectively receive proximal end 16 of catheter adapter 13. Needle hub 21 further comprises a distal end 23 that is configured to support and permanently retain a proximal end of an introducer needle 40. Introducer needle 40 further comprises a sharpened distal end 41 that is threaded through catheter adapter 13 and catheter 15 to provide extravascular system 10. Once fully assembled, sharpened distal end 41 of needle 40 extends distally beyond the tip 17 of catheter 15. As thus configured, sharpened distal end 41 is exposed and may be used to provide an opening through the skin and soft tissues of the patient, thus providing an opening through which tip 17 of catheter 15 may be inserted into the vasculature of the patient.

[0035] Referring now to Figure 2, catheter adapter 13 further comprises a blood control septum 18 that is positioned within an inner lumen of catheter adapter 13. Blood control septum 18 divides the inner lumen of catheter adapter 13 into proximal and distal fluid chambers, wherein blood control septum 18 prevents fluid communication between the

fluid chambers. In some instances, blood control septum 18 comprises a self-sealing slit 19 or small opening through which introducer needle 40 is inserted when assembled. Upon removal of needle 40 from catheter adapter 13, slit 19 automatically closes, thereby preventing fluid communication between the fluid chambers. Thus, blood control septum 18 prevents fluid within the catheter 15 and the distal fluid chamber from entering the proximal fluid chamber and leaking out of catheter adapter 13 via the opening in proximal end 16.

[0036] Catheter adapter 13 further comprises a septum activator 50 that is configured to be slidably advanced through blood control septum 18, thereby providing a fluid pathway through septum 18. Septum activator 50 is slidably positioned within the proximal fluid chamber. Septum activator 50 comprises a base 51 that is oriented towards proximal end 16 and is accessible via proximal end 16. Septum activator 50 further comprises a probe end 52 that is oriented towards, and proximal to blood control septum 18. Septum activator 50 is advanced through blood control septum 18 by inserting a Luer device through the opening of proximal end 16, as will be discussed in greater detail below.

[0037] Septum activator 50 may comprise any material or combination of materials that are compatible for use in an intravenous device. Generally, septum activator 50 comprises a rigid material. For example, in some embodiments septum activator 50 comprises a nylon material. Septum activator 50 may further comprise an antibacterial coating or anticoagulant coating to provide further benefits to the extravascular assembly 10.

[0038] With continued reference to Figure 2, needle assembly 20 further comprises a needle shield 30 that is slidably stored in a distal opening of needle hub 21. Needle shield 30 comprises a proximal aperture 31 through which introducer needle 40 is threaded. Needle shield 30 further comprises a needle clip 32 that is configured to block distal movement of sharpened tip 41 when positioned within needle shield 30.

[0039] In some embodiments, needle shield 30 is coupled to needle hub 21 via a tether 25. Tether 25 is configured to permit needle shield 30 to be slid distally along introducer needle 40, but prevents needle shield 30 from being completely removed from needle 40, as shown in Figure 3.

[0040] Referring now to Figures 3 and 4, extravascular system 10 is shown in an expanded configuration, which represents the configuration of the various components following a catheterization procedure. The catheterization procedure results in catheter 15 being inserted into the vasculature of a patient. Once catheter 15 is properly inserted into the patient's vasculature, needle hub 21 is moved in proximal direction 100 thereby removing

needle shield 30 from the distal opening of needle hub 21. Introducer needle 40 and sharpened tip 41 are withdrawn from catheter 15 and catheter adapter 13 as needle hub 21 is moved in proximal direction 100.

[0041] Tether 25 is unraveled from the distal opening of needle hub 21 as needle hub 21 moves in proximal direction 100, as shown in Figure 4. When a maximum distance 102 between needle hub 21 and needle shield 30 is achieved, tether 25 prevents further separation or distance between the two components. Sharpened tip 41 is entirely withdrawn from catheter adapter 13 and into needle shield 30 at a distance that is less than maximum distance 102.

[0042] In some embodiments, safety clip 32 is repositioned within needle shield 30 to block and prevent sharpened tip 41 from exiting needle shield 30 once tip 41 has been drawn proximally past safety clip 32, as shown in Figure 4. Thus, sharpened tip 41 is trapped within needle shield 30. In particular, needle shield 30 prevents sharpened tip 41 from exiting the distal end of needle shield 30, and tether 25 prevents sharpened tip 41 from exiting the proximal end of needle shield 30 by preventing separation of needle shield 30 and needle hub 21 in excess of maximum distance 102.

[0043] In some embodiments, safety clip 32 is further configured to securely retain the connection between needle shield 30 and catheter proximal end 16 of catheter adapter 13. In some instances, safety clip 32 further comprises a pawl or other feature that selectively and/or temporarily interconnects with a surface of proximal end 16 when safety clip 32 is held in a first position. The first position of safety clip 32 is maintained by contact between introducer needle 40 and safety clip 32. When introducer needle 40 is withdrawn past safety clip 32 in proximal direction 100, safety clip 32 is released from the first position and is repositioned to block sharpened tip 41 from exiting needle shield distally. When safety clip 32 is repositioned, the pawl or other feature releases the surface of proximal end 16, thereby permitting physical separation of catheter adapter 13 from needle shield 30, as shown.

[0044] Referring now to Figure 5, catheter adapter 13 is shown following separation from needle shield 30. In some embodiments, the vasculature of a patient is accessed via catheter assembly 11 by inserting a Luer adapter 110 or other device into the proximal end or opening 16 of catheter adapter 13. In some instances, Luer adapter 110 comprises a probe 112 that is inserted within opening 16 and contacts base 51 of septum activator 50. Upon insertion of probe 112 into opening 16, probe 112 contacts septum activator 50 and advances septum activator 50 within the proximal fluid chamber in distal direction 200. Upon further

insertion of probe 112 into opening 16, probe end 52 of septum activator is advanced through slit 19 of blood control septum 18, thereby providing fluid communication between Luer adapter 110 and catheter 15 via the distal fluid chamber.

[0045] Some embodiments of the present invention provide a single use septum activator, wherein the septum activator maintains a pathway through the blood control septum following removal of a Luer device from the catheter adapter. In other embodiments, the present invention provides a multiple use septum activator, wherein the septum activator is automatically removed from the blood control septum following removal of a Luer device from the catheter adapter, thereby closing a pathway through the blood control septum.

[0046] For example, in some embodiments upon removal of Luer adapter 110 from proximal end 16, septum activator 50 is moved in proximal direction 100 as slit 19 of septum 18 resumes its closed position. Thus, fluid in the distal fluid chamber and catheter 15 are prevented from bypassing septum 18 when Luer adapter 110 is disconnected. In other embodiments, upon removal of Luer adapter 110 from proximal end 16, septum activator 50 remains positioned within slit 19 of septum 18, thereby maintaining a fluid pathway through septum 18.

[0047] The various components and parts disclosed herein may comprise any shape or configuration that may be desired or necessary to achieve the benefits of the present invention. For example, needle shield 30 may achieve integrated tip protection using a transverse barrier containing a washer-like hole in the proximal end of safety clip 32 to catch a feature on the exterior surface of introducer needle 40, such as a crimp or a ferrule. Safety clip 32 may alternatively be divided into two or more pieces. For example, a first piece of clip 32 may provide the interlocking action between the needle shield 30 and catheter adapter 13. The second piece of clip 32 may provide the function of blocking sharpened tip 41 from exiting needle shield 40 in distal direction 200. Alternatively, the second piece of clip 32 may comprise a hole having a diameter that is greater than an outer diameter of needle 40, yet less than an outer diameter of a feature on the outer surface of the needle 40. As such, the second piece of clip 32 may prevent complete separation of needle shield 30 from needle 40, thereby trapping sharpened tip 41 within needle shield 30. Clip 32 may further include a non-friction coating to reduce drag forces on needle 40 when withdrawing needle 40 from catheter adapter 13 in proximal direction 100.

[0048] In some instances, blood control septum 18 further comprises various air vents and other features to permit controlled flashback in catheter 15 during catheterization. For

example, in some embodiments catheter adapter 13 comprises a recessed surface configured to receive and retain septum 18. In some instances, the recessed surface further comprises a plurality of grooves that form air channels between the outer, circumferential surface of septum 18 and the recessed surface. Further, in some instances the plurality of grooves interconnect the distal and proximal fluid chambers, thereby permitting air pressure in the distal fluid chamber to be released into the proximal fluid chamber by passing through the plurality of grooves. As such, excess buildup of air pressure in the distal fluid chamber is prevented, thereby allowing blood to enter into the distal fluid chamber as flashback during catheterization. Alternatively, the outer, circumferential surface of septum 18 may comprises a plurality of grooves, thereby forming a plurality of air channels between the outer surface of the septum and the recessed surface of catheter adapter 13.

[0049] Referring now generally to Figures 6A-9B, various alternative and representative embodiments of the present invention are shown. In particular, Figures 6A-9B demonstrate various alternative configurations of extravascular system 10. Figures 6A-9B further demonstrate various alternative components and structures for extravascular system 10.

[0050] Referring now to Figures 6A-6H, an assembled extravascular system 10 is shown in various plan and cross-section views, prior to catheterization. In some instances catheter adapter 13 further comprises a needle cap 102 that is configured to receive and shield needle tip 41 and catheter 15 prior to use. Needle cap 102 comprises a proximal end that is friction fit over the distal end of catheter adapter 13. Prior to catheterization, needle cap 102 is removed from catheter adapter 13 and disposed.

[0051] In some instances, system 10 further comprises a flashback chamber 110 that is in fluid communication with the proximal end of introducer needle 40. Flashback chamber 110 comprises a clear material that is capable of being used with biological fluids, such as blood. Introducer needle 40 further comprises a window 43 that is positioned near sharpened distal tip 41. When sharpened tip 41 is inserted into the vasculature of the patient, blood flows through window 43 and into the space between the outer surface of needle 40 and the inner wall surface of catheter 15. This blood may be seen through the clear wall of the catheter, thereby providing a visual signal to the caregiver that the sharpened tip 41 is in the patient's vein. Excess blood travels through the hollow interior of introducer needle 40 and into flashback chamber 110. Flashback chamber 110 collects the excess blood, providing further confirmation of accurate needle and catheter placement into the vessel, and preventing

undesired exposure to the caregiver. In some instances, flashback chamber 110 is coupled to needle hub 21 via a vented fitting whereby gas or air within flashback chamber 110 is vented as liquid enters from the proximal end and opening of needle 40.

[0052] In some instances, excess blood collected in flashback chamber 110 is preserved for clinical testing or other types of diagnostic procedures. For these instances, flashback chamber 110 may be selectively removed from needle hub 23 prior to disposal of needle 40 and the remaining disposable components of system 10.

[0053] In some embodiments, needle shield 30 comprises a washer 33 that forms the proximal aperture through which needle 40 is threaded. Needle 40 may further comprise a crimp or ferrule proximate to sharpened distal tip 41 that has a diameter that is greater than the diameter of the opening in washer 33. As such, the crimp or ferrule is prevented from passing through washer 33 in proximal direction 100. In some embodiments, the distance between sharpened tip 41 and the crimp or ferrule is configured so that sharpened tip 41 is entirely positioned within needle shield 30 when the crimp or ferrule contacts washer 33.

[0054] Referring now to Figures 7A-7E, various cross-section views of an extravascular system 10 is shown. In some embodiments, needle shield 30 comprises a clip 32 that is held in a compressed configuration by needle 40 prior to catheterization. When needle 40 is withdrawn from catheter 15 and tip 41 is drawn proximally past clip 32, clip 32 is released and flap or flag 37 covers and blocks aperture 39, thereby preventing sharpened distal tip 41 from exiting needle shield 30 via aperture 39. In some embodiments, clip 32 comprises a v-clip.

[0055] In some instances, a pawl 45 or other structure of clip 32 intersects and securely retains a portion of catheter adapter 13 when in the compressed configuration. For example, in some instances pawl 45 intersects the proximal rim of catheter adapter 13. When clip 32 is released following withdrawal of tip 41 into needle shield 30, pawl 45 of clip 32 releases catheter adapter 13, thereby permitting separation of the two components. Thus, needle shield 30 and catheter adapter 13 are securely interconnected prior to withdrawing distal tip 41, and capable of being separated once distal tip 41 is securely shielded within needle shield 30.

[0056] As discussed previously, in some embodiments blood control septum 18 comprises one or more air vents 181 which are formed in the outer circumferential surface of septum 18. Vents 181 provide a fluid and/or an air pathway between the inner surface of catheter adapter 13 and the outer surface of septum 18. Alternatively, air vents may be

provided by grooving the inner surface of catheter adapter 13 at the position where septum 18 is seated.

[0057] Blood control septum 18 may further comprise blood wicking apertures 183 formed on distal face of the septum. Apertures 183 are positioned and configured to wick excess blood from the outer surface of introducer needle 40 when needle 40 is being withdrawn from catheter adapter 13. Apertures 183 may also wick excess blood that leaks into catheter adapter 13 as flashback during catheterization.

[0058] Septum activator 50 comprises a proximal end 51 that is configured to be contacted and advanced through slit or opening 19 of septum 18 when an external object is inserted into the proximal opening of catheter adapter 13. Septum activator 50 comprises a distal end 53 that is positioned proximate to septum 18, and is sized to permit partial or complete penetration of slit 19. In some instances, distal end 53 merely contacts and deforms septum 18, which thereby causes slit 19 to be biased into an open conformation.

[0059] In some instances, septum activator 50 is incapable of being removed from septum 18 following insertion through slit 19. Once inserted, septum activator 50 provides and/or opens a permanent pathway through septum 18. Thus, septum activator 50 may be configured for one-time use. In other instances, septum activator 50 is configured to automatically be removed from or backed out of slit 19 when septum activator 50 is not actively advanced in distal direction 200, or held in place via an external device. For example, in some instances septum activator 50 is prevented from fully penetrating slit 19. Thus, when the external device is removed from catheter adapter 13, the elastic properties of septum 18 self-close slit 19 thereby backing distal end 53 out of slit 19. Thus, septum activator 50 may be configured for multiple-time usage.

[0060] Septum activator 50 may further comprise one or more flow disrupting features 55. Features 55 are configured to provide disruption to fluid passing through catheter adapter 13 in proximity to septum activator 50. In some instances, septum activator 50 comprises one or more fins and/or windows 55 that divert fluid between the interior and exterior surfaces or surroundings of septum activator 50. Fins 55 may further be configured to slidably seat within an annular groove 57 on the inner surface of catheter adapter 13. The interaction between fins 55 and annular groove 57 prevents septum activator 50 from being removed from the proximal opening of catheter adapter 13. Annular groove 57 may also be configured to prevent over-insertion of distal end 53 through septum 18.

[0061] In some instances, needle shield 30 comprises a clip 32 having a distal end configured to block a distal aperture of shield 30, and further comprises a proximal end forming washer 33, as shown in Figures 8A-8C. The distal end of clip 32 is biased away from the distal aperture by the presence of needle 40 in the distal aperture. Following catheterization and withdrawal of distal tip 41 into needle shield 30, the distal end of clip 32 is released from its biased position and blocks the distal aperture, thereby preventing distal tip 41 from exiting safety shield 30. The aperture of washer 33 comprises a diameter that permits needle 40 to slide therethrough, but prevents passage of a crimp 47 or ferrule that is located on needle 40 proximate to distal tip 41. Thus the distal and proximal ends of clip 32 trap distal tip 41 within needle shield 30, as shown in Figure 8C. Needle shield 30 may further comprise an extended distal nose 35 that securely and selectively interlocks needle shield 30 and catheter adapter 13 via a friction fit.

[0062] In some instances, clip 32 may be divided into two or more pieces. For example, a first piece may be configured to providing an interlocking action to release catheter adapter 13, and a second piece may be configured to trap a ferrule or crimp on needle 40, thereby preventing proximal or distal movement of needle 40. Referring now to Figures 9A and 9B, needle shield 30 may further include a first clip 32a and a second clip 32b, wherein first and second clips 32a and 32b are configured to retain distal tip 41 of needle 40 within needle shield 30. In some instances, first clip 32a is further configured to temporarily interconnect needle shield 30 and catheter adapter 13, as discussed previously.

[0063] In some instances, clip 32 is used with a second member as a housing. Clip 32 may also be used as only a safety mechanism, while the second member provides an interlocking feature. For example, in some embodiments a second member comprises a plurality of fingers that are configured to overlap the Luer connector of catheter adapter 13 to interlock catheter adapter 13 and needle shield 30 via a friction interface. .

[0064] Any of the embodiments of the present invention may further comprise an access port 302, as shown in Figures 10A-17B. Port 302 generally comprises a portion of catheter adapter 313. In some instances, access port 302 comprises a cylinder coupled to the outer surface of catheter adapter 313, the cylinder having an inner lumen 304 that is in fluid communication with an inner lumen or fluid pathway of catheter adapter 313. Access port 302 further comprises an inner diameter that is configured to receive an external device, such as a needleless connector. In some instances, access port 302 comprises a removable cap or

lid 306 that protects port 302 from contamination. In some instances, lid 306 is hingedly coupled to the base of access port 302.

[0065] In some embodiments, system 300 further comprises a defeatable barrier 310 that is seated into an annular groove formed on the inner surface of catheter adapter 313 and interposed between inner lumen 304 and the fluid pathway of catheter adapter 313. In some instances, barrier 310 comprises a tubular valve having an outer surface that forms an interface with inner lumen 304. Barrier 310 is defeated when an external device is inserted into inner lumen 304 and contacts the outer, exposed surface of barrier 310. When contacted by the external device, the tubular structure of barrier 310 slightly collapses thereby breaking the interface between the outer surface of barrier 310 and inner lumen 304. A fluid may then be added to the fluid pathway or lumen of catheter adapter 313. Alternatively, in some instances fluid pressure from the external device builds up within access port 302 until the interface between the outer surface of barrier 310 and inner lumen 304 is defeated. The fluid within access port 302 is then added to the fluid pathway or lumen of catheter adapter 313 via the temporarily defeated barrier 310. Upon removal of the external device, the resilient defeatable barrier 310 resumes its original shape thereby reestablishing the sealed interface with inner lumen 304.

[0066] Referring now to Figures 10A-10D, an assembly extravascular system 300 is shown in various plan and cross-section views, prior to catheterization. In some embodiments, system 300 comprises a blood control septum 18 that is placed within catheter adapter 313 at a position that is downstream or distal from access port 302. Thus, system 300 further comprises an elongated septum activator 350. Elongated septum activator 350 comprises an extended distal end 353 that is configured to pass through defeatable barrier 310 and reside in proximity to septum 18. This type of stacked or parallel configuration allows the overall length of catheter adapter 313 to be shortened.

[0067] In other embodiments, system 300 comprises a blood control septum 18 that is placed within catheter adapter 313 at a position that is upstream from access port 302, as shown in Figures 11A-11D. In these embodiments, system 300 includes a normal length septum activator 50. Unlike the shortened length of the catheter adapter 313, the linear or serial configuration of these embodiments may require that the overall length of catheter adapter 313 be extended.

[0068] System 300 may include any combination of external needle shield, internal blood control septum, and septum activator as disclosed herein. Examples of various

acceptable combinations are shown in Figures 12A-17B. As previously mentioned, any of the embodiments described in Figures 1-9B may be modified to include any of the features of the embodiments shown in Figures 10A-17B, and in particular these embodiments may be modified to include an access port 302 and defeatable barrier 310.

[0069] In some instances, system 300 may include a crimp or ferrule retention washer 33, as shown in Figure 14B and 14C. Access port 302 may further include one or more bumps or outward protrusions configured to retain cap 306 on the outer surface of port 302. .

[0070] The present invention may be embodied in other specific forms without departing from its structures, methods, or other essential characteristics as broadly described herein and claimed hereinafter. The described embodiments are to be considered in all respects only as illustrative, and not restrictive. The scope of the invention is, therefore, indicated by the appended claims, rather than by the foregoing description. All changes that come within the meaning and range of equivalency of the claims are to be embraced within their scope.

CLAIMS

1. An extravascular system for accessing the vasculature of a patient, comprising:
 - a catheter adapter having a distal end supporting a catheter, and further comprising a proximal opening, the catheter adapter having a lumen;
 - a blood control septum valve including a plurality of grooves forming air channels on an outer circumferential surface of the septum valve, said septum valve being the only valve disposed within the lumen of the catheter adapter and dividing the lumen into a proximal fluid chamber and a distal fluid chamber, the plurality of grooves communicating between the proximal and distal fluid chambers;
 - a septum activator movably positioned within the proximal fluid chamber, the septum activator having a base and a probe end;
 - an introducer needle configured to engage and disengage the blood control septum valve;
 - a safety mechanism removably coupled to the proximal opening of the catheter adapter and comprising a safety clip configured to secure a tip of the introducer needle, and
 - a housing for the safety mechanism having the introducer needle extending therethrough;
 wherein
 - the housing comprises a distal end and a proximal end;
 - an outer surface of the catheter adapter is disposed within the distal end of the housing;
 - the distal end of the housing extends distal to the base of the septum activator when the septum activator is in an initial position; and
 - the septum activator is configured to be engaged by a probe extension extending from a Luer adapter and moved from the initial position in which the probe end of the septum activator

is out of contact with the septum valve to a breach position in which the probe end of the septum activator breaches the septum valve as the Luer adapter is secured to the catheter adapter.

2. The system of claim 1, wherein the introducer needle further comprises a base supported by a needle hub and a body extending between the base and the tip of the introducer needle, the body of the introducer needle being inserted through the safety mechanism, the lumen of the catheter adapter, and the catheter such that the tip of the introducer needle is positioned external to a tip of the catheter, and the needle hub is adjacent to the safety mechanism prior to insertion of the catheter into the vasculature of the patient.
3. The system of claim 2, further comprising a tether having a first end coupled to the needle hub and a second end coupled to the safety mechanism.
4. The system of claim 2, wherein the housing of the safety mechanism comprises a needle shield.
5. The system of claim 2, wherein the body of the introducer needle passes through the safety mechanism to hold the safety clip in a first position prior to insertion of the catheter into the vasculature of the patient.
6. The system of claim 5, wherein following insertion of the catheter into the vasculature of the patient, the introducer needle is withdrawn from the lumen of the catheter adapter and through a pathway of the safety mechanism to bypass the safety clip, thereby releasing the safety clip from the first position to a second position, wherein the second position blocks the pathway of the safety mechanism to prevent the tip from passing therethrough.

7. The system of claim 3, wherein the tether comprises a length that is less than a distance between the tip and the base of the introducer needle.

8. The system of claim 3, wherein the tether prevents removal of the tip from the safety mechanism.

9. A method for manufacturing an extravascular system for accessing the vasculature of a patient, the method comprising steps for:

providing a catheter adapter having a distal end supporting a catheter, the catheter adapter further comprising a proximal opening and a lumen interposed between the proximal opening and the catheter;

disposing a blood control septum valve, including a plurality of grooves forming air channels on an outer circumferential surface of the septum valve, within the lumen of the catheter adapter and dividing the lumen into a proximal fluid chamber and a distal fluid chamber, the septum valve being the only valve within the lumen of the catheter adapter;

providing communication between the proximal and distal fluid chambers via the plurality of grooves;

inserting a moveable septum activator within the proximal fluid chamber, the septum activator having a base and a probe end; and

engaging a distal end of a housing of a safety mechanism to the proximal opening of the catheter adapter with an outer surface of the catheter adapter, the safety mechanism having a safety clip configured to secure a tip of an introducer needle extending through the housing, the

distal end of the housing extends distal to the base of the septum activator when the septum activator is in an initial position; wherein

the septum activator is configured to be engaged by a probe extension extending from a Luer adapter and moved from the initial position in which the probe end of the septum activator is out of contact with the septum valve to a breach position in which the probe end of the septum activator breaches the septum valve as the Luer adapter is secured to the catheter adapter.

10. The method of claim 9, further comprising providing a needle hub for supporting a base end of the introducer needle, the introducer needle further comprising a body extending between the base end and the tip.

11. The method of claim 10, further comprising inserting the body of the introducer needle through the safety mechanism, the lumen of the catheter adapter, and the catheter such that the tip of the introducer needle is positioned external to a tip of the catheter, and the needle hub is adjacent the safety mechanism.

12. The method of claim 10, further comprising providing a tether having a first end coupled to the needle hub and a second end coupled to the safety mechanism.

13. The method of claim 10, wherein the housing of the safety mechanism comprises a needle shield.

14. The method of claim 10, further comprising positioning the body of the introducer needle in the safety mechanism such that the safety clip is held in a first position by the body of the introducer needle.

15. The method of claim 14, wherein following insertion of the catheter into the vasculature of the patient, the introducer needle is withdrawn from the lumen of the catheter adapter and through a pathway of the safety mechanism to bypass the safety clip, thereby releasing the safety clip from the first position to a second position, wherein the second position blocks the pathway of the safety mechanism to prevent the tip from passing therethrough.
16. The method of claim 12, further comprising selecting a length of the tether that is less than a distance between the tip and the base end of the introducer needle.
17. The method of claim 16, wherein the tether prevents removal of the tip from the safety mechanism.
18. The method of claim 9, wherein an access port comprising a sealed interface is defeated by either injecting a fluid into the access port or by inserting a secondary infusion device into the access port to manually contact and displace a defeatable barrier.
19. An extravascular system for accessing the vasculature of a patient, comprising:
a catheter adapter having a distal end supporting a catheter, and further comprising a proximal opening, the catheter adapter having a lumen;
a blood control septum disposed within the lumen of the catheter adapter and dividing the lumen into a proximal fluid chamber and a distal fluid chamber;
a septum activator movably positioned within the proximal fluid chamber, the septum activator having a base and a probe end;

an introducer needle comprising a needle feature, the introducer needle configured to engage and disengage the blood control septum;

a safety mechanism removably coupled to the proximal opening of the catheter adapter and comprising a safety clip configured to secure a tip of the introducer needle, the introducer needle further comprising a base supported by a needle hub and having a body extending between the base and the tip, the body of the introducer needle being inserted through the safety mechanism, the lumen of the catheter adapter and the catheter such that the tip of the introducer needle is positioned external to a tip of the catheter prior to insertion of the catheter into the vasculature of the patient; and

a pawl forming a portion of the safety clip and positioned within a proximal rim of the catheter adapter to engage the safety mechanism and the catheter adapter, wherein upon removal of the introducer needle from the safety mechanism, the safety clip is released and the pawl is disengaged from the proximal rim, thereby disconnecting the safety mechanism from the catheter adapter, wherein the septum activator is configured to be engaged by a probe extension extending from a Luer adapter and moved from an initial position in which the probe end of the septum activator is out of contact with the blood control septum to a breach position in which the probe end of the septum activator breaches the blood control septum as the Luer adapter is secured to the catheter adapter.

20. The system of claim 19, wherein

the needle hub is coupled to the base of the introducer needle; and

a tether having a first end coupled to the needle hub and a second end coupled to the safety mechanism is provided, wherein the tether comprises a length that is less than a distance between the base and the tip of the introducer needle.

21. The system of claim 1, further comprising:

an access port coupled to the outer surface of the catheter adapter and having an inner lumen that is in fluid communication with the lumen of the catheter adapter; and

a defeatable barrier disposed within the lumen of the catheter adapter and forming a sealed interface with the inner lumen of the access port.

22. The system of claim 1, wherein:

the lumen is disposed between the distal end and the proximal opening of the catheter adapter; and

the catheter adapter is configured for the Luer adapter to be secured to the proximal opening, such that a lumen of the Luer adapter fluidically connects with the lumen of the catheter adapter.

23. The system of claim 1, wherein

the safety clip is disposed within the housing and configured to secure the tip of the introducer needle, wherein a pawl and a flag extend from a body of the safety clip;

the flag is biased away from a distal aperture disposed in a first wall of the housing into a biased position when the introducer needle is disposed within the distal aperture;

in response to the tip of the introducer needle being withdrawn into the housing beyond the distal aperture, the flag is released from the biased position and blocks the distal aperture thereby preventing the tip from exiting the distal end of the housing;

the pawl is positioned within a proximal rim of the catheter adapter to selectively maintain engagement between the housing and the catheter adapter; and

in response to the pawl being disengaged from the proximal rim, the housing is disconnected from the catheter adapter.

24. The system of claim 23, wherein:

a washer is disposed within the proximal end of the housing and separated from the safety clip by a second wall;

the washer comprises an aperture configured to prevent passage of a needle feature on the introducer needle, the washer and the needle feature thereby securing the tip of the introducer needle in the housing when the tip of the introducer needle is withdrawn into the housing;

the body of the safety clip is disposed between the first wall and the second wall; and

the pawl is disposed distal to the first wall.

25. The system of claim 1, wherein the catheter adapter is configured for the Luer adapter to be secured around surfaces of the catheter adapter at a proximal end thereof while the probe extension extending from the Luer adapter extends into the lumen of the catheter adapter and engages the base of the septum activator.

26. The system of claim 1, wherein:

the outer surface of the catheter adapter comprises threads, and

the catheter adapter is configured for the Luer adapter to be secured to a proximal end by being threaded onto the threads.

27. The system of claim 1, wherein the system is disconnected from a side port on the catheter adapter.
28. The system of claim 1, wherein the blood control septum valve has a cup shape.
29. The system of claim 1, wherein the plurality of grooves in the blood control septum valve are substantially equally spaced along the outer circumferential surface of the blood control septum valve.
30. The method of claim 9, further comprising:
coupling an access port to an outer surface of the catheter adapter, the access port having an inner lumen in fluid communication with the lumen of the catheter adapter; and
disposing a defeatable barrier within the lumen of the catheter adapter and forming a sealed interface with the inner lumen of the access port.
31. The method of claim 30, wherein the sealed interface is defeated by either injecting a fluid into the access port or by inserting a secondary infusion device into the access port to manually contact and displace the defeatable barrier.
32. An extravascular system for accessing the vasculature of a patient, comprising:
a catheter adapter having a distal end, a proximal opening and a lumen disposed therebetween, the distal end supporting a catheter;

an access port coupled to an outer surface of the catheter adapter and having an inner lumen that is in fluid communication with the lumen of the catheter adapter;

a blood control valve disposed within the lumen of the catheter adapter and dividing the lumen of the catheter adapter into a proximal fluid chamber and a distal fluid chamber;

a plurality of grooves forming air channels disposed on at least one of an outer surface of the valve and an inner surface of the lumen of the catheter adapter;

a defeatable barrier disposed within the lumen of the catheter adapter and selectively forming a sealed interface with the inner lumen of the access port; and

a septum activator having a base and a probe end, the activator being movably positioned within the proximal fluid chamber; wherein

the activator is configured to be engaged by a probe extension extending from a Luer adapter and moved from an initial position in which the probe end of the septum activator is out of contact with the valve to a breach position in which the probe end of the septum activator breaches the valve as the Luer adapter is secured to the catheter adapter.

33. The system of claim 32, further comprising:

a housing removably coupled to the proximal opening of the catheter adapter; and

a safety clip configured to secure a tip of an introducer needle.

34. The system of claim 33, wherein the safety clip is configured to engage and disengage the catheter adapter.

35. An extravascular system for accessing the vasculature of a patient, comprising:

a catheter adapter having a distal end supporting a catheter, and further comprising a proximal opening, the catheter adapter having a lumen;

an introducer needle comprising a tip and a needle feature;

a blood control septum disposed within the lumen of the catheter adapter and dividing the lumen into a proximal fluid chamber and a distal fluid chamber;

a septum activator movably positioned within the proximal fluid chamber, the septum activator having a base and a probe end; and

a needle shield removably coupled to the proximal opening of the catheter adapter and comprising a safety clip, the safety clip further forming a washer, wherein the safety clip is biased away from a distal aperture of the needle shield when the needle is disposed within the distal aperture,

characterized in that:

in response to the tip of the needle being withdrawn into the needle shield beyond the distal aperture, the safety clip is released from a biased position and blocks the distal aperture thereby preventing the tip from exiting a distal end of the needle shield; and

the washer of the safety clip is configured to prevent passage of the needle feature.

36. The system of claim 35, wherein the safety clip comprises a first portion and a second portion.

37. The system of claim 36, wherein the first portion of the safety clip is distal to the second portion of the safety clip.

38. The system of claim 36, wherein the first portion of the safety clip is configured to interconnect the needle shield to the catheter adapter.

39. The system of claim 36, wherein the second portion of the safety clip includes the washer to retain the needle feature in the needle shield.

40. The system of claim 35, wherein:
a housing for the needle shield has the introducer needle extending therethrough;
the housing comprises a distal end portion and a proximal end portion; and
the distal end portion of the housing is selectively engaged to an outer surface of the catheter adapter.

41. The system of claim 35, wherein the safety clip comprises a V-clip.

42. The system of claim 35, wherein a distal end of a housing extends distal to the base of the septum activator when the septum activator is in an initial position.

43. The system of claim 35, wherein:
the safety clip is disposed within a housing and configured to secure the tip of the introducer needle, wherein a pawl and a flag extend from a body of the safety clip;
the flag is biased away from the distal aperture disposed in a first wall of the housing into a biased position when the introducer needle is disposed within the distal aperture;
in response to the tip of the introducer needle being withdrawn into the housing beyond the distal aperture, the flag is released from the biased position and blocks the distal aperture thereby preventing the tip from exiting a distal end of the housing;
the pawl is positioned within a proximal rim of the catheter adapter to selectively maintain a second engaged connection between the housing and the catheter adapter; and

in response to the pawl being disengaged from the proximal rim, the housing is disconnected from the catheter adapter at the second engaged connection.

44. A method for manufacturing an extravascular system for accessing the vasculature of a patient, the method comprising steps for:

providing a catheter adapter having a distal end supporting a catheter, the catheter adapter further comprising a proximal opening and a lumen interposed between the opening and the catheter;

disposing a blood control septum valve within the lumen of the catheter adapter and dividing the lumen into a proximal fluid chamber and a distal fluid chamber;

inserting a movable septum activator within the proximal fluid chamber, the septum activator having a base and a probe end; and

removably coupling a needle shield to the proximal opening of the catheter adapter, wherein the needle shield comprises a safety clip, the safety clip further forming a washer, wherein the safety clip is biased away from a distal aperture of the needle shield when the needle is disposed within the distal aperture,

characterized in that:

in response to a tip of an introducer needle being withdrawn into the needle shield beyond the distal aperture, the safety clip is released from a biased position and blocks the distal aperture thereby preventing the tip from exiting a distal end of the needle shield, and

the washer of the safety clip is configured to prevent passage of a needle feature.

45. The method of claim 44, further comprising a step for providing a needle hub for supporting a base end of the introducer needle, the introducer needle further comprising a body extending between the base end and the tip.

46. The method of claim 44, further comprising a step for threadedly inserting a body of the introducer needle through the needle shield, the lumen of the catheter adapter, and the catheter such that the tip of the introducer needle is positioned external to a tip of the catheter, and a needle hub is adjacent the needle shield.

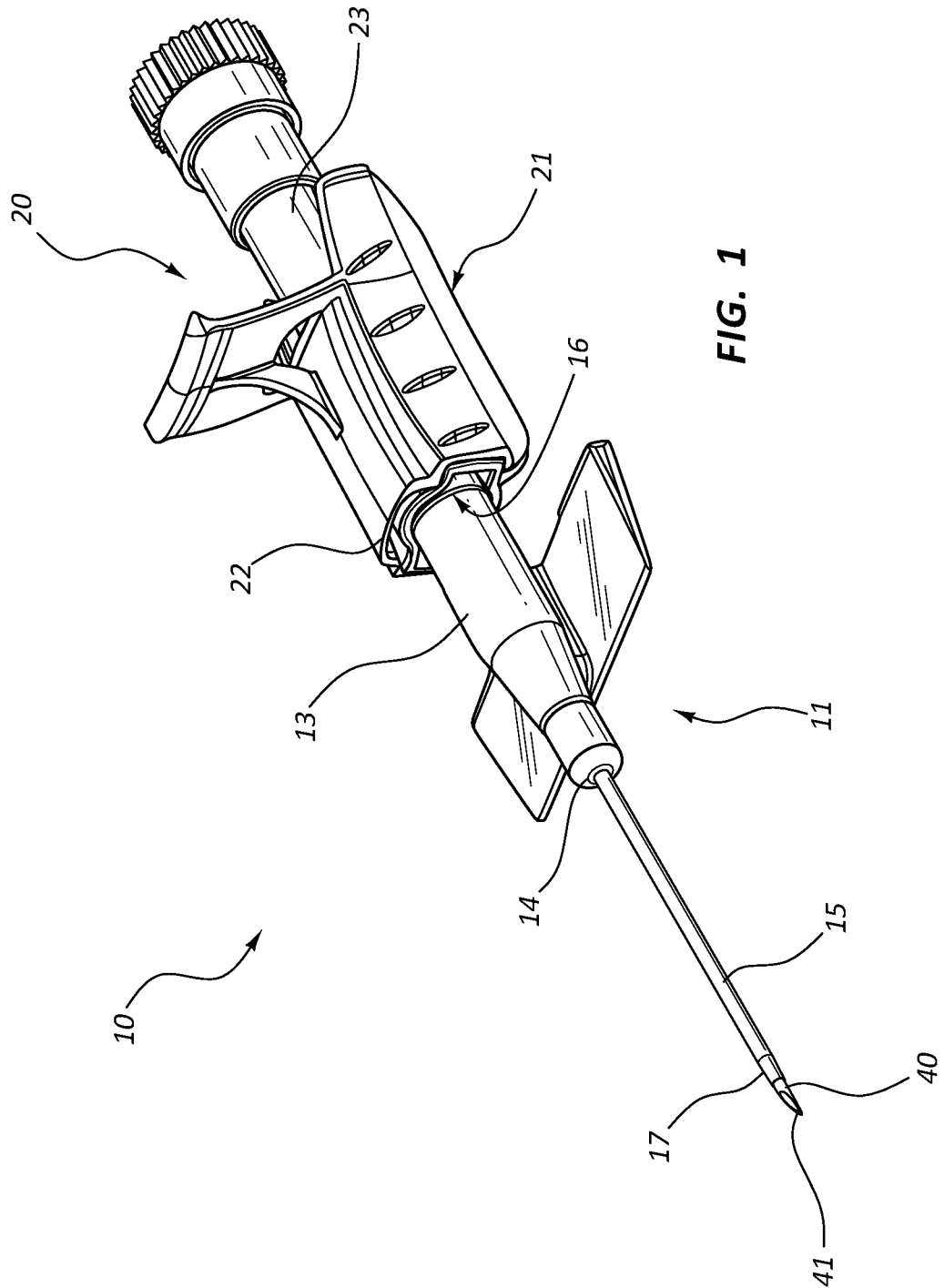

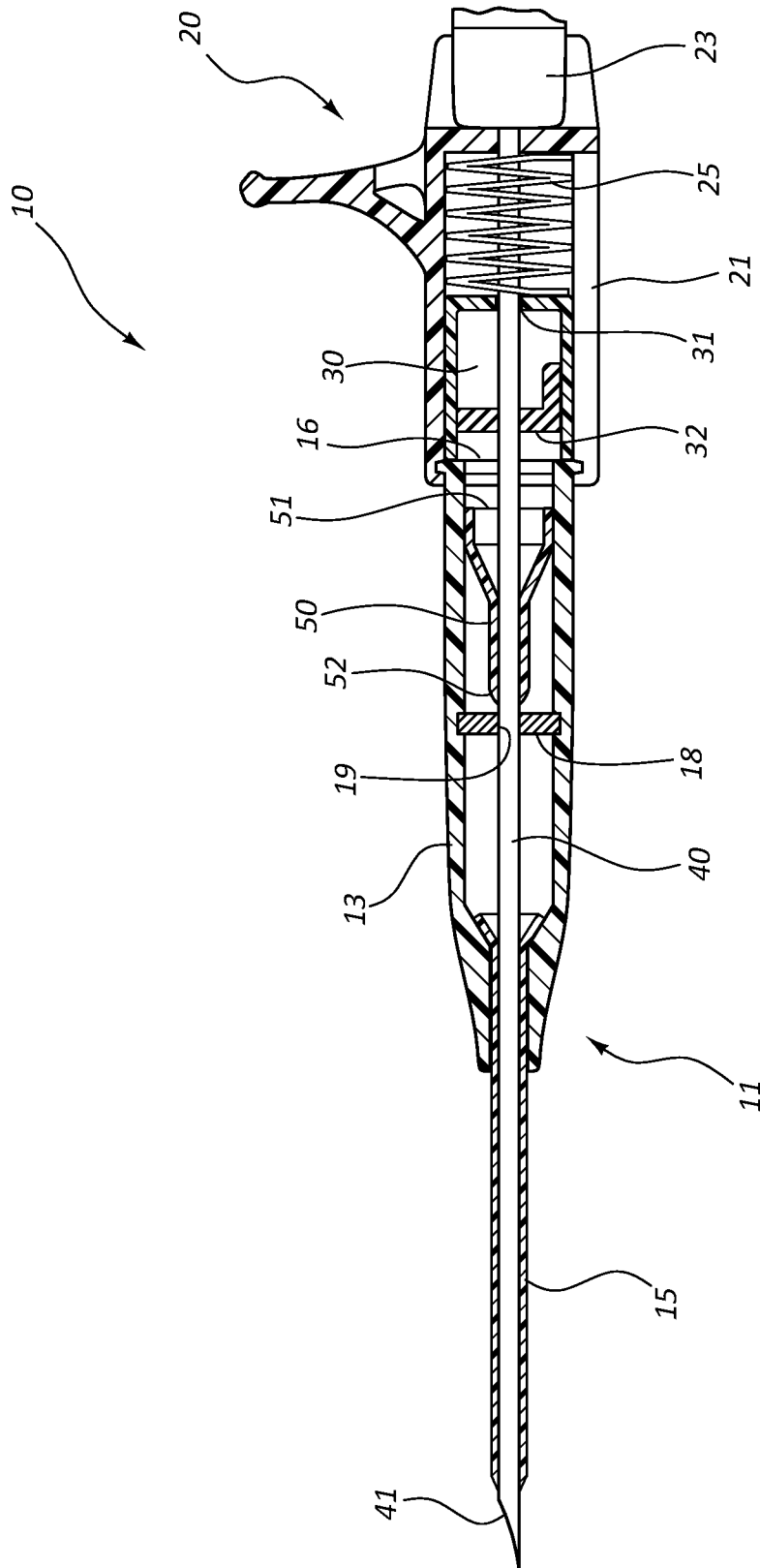
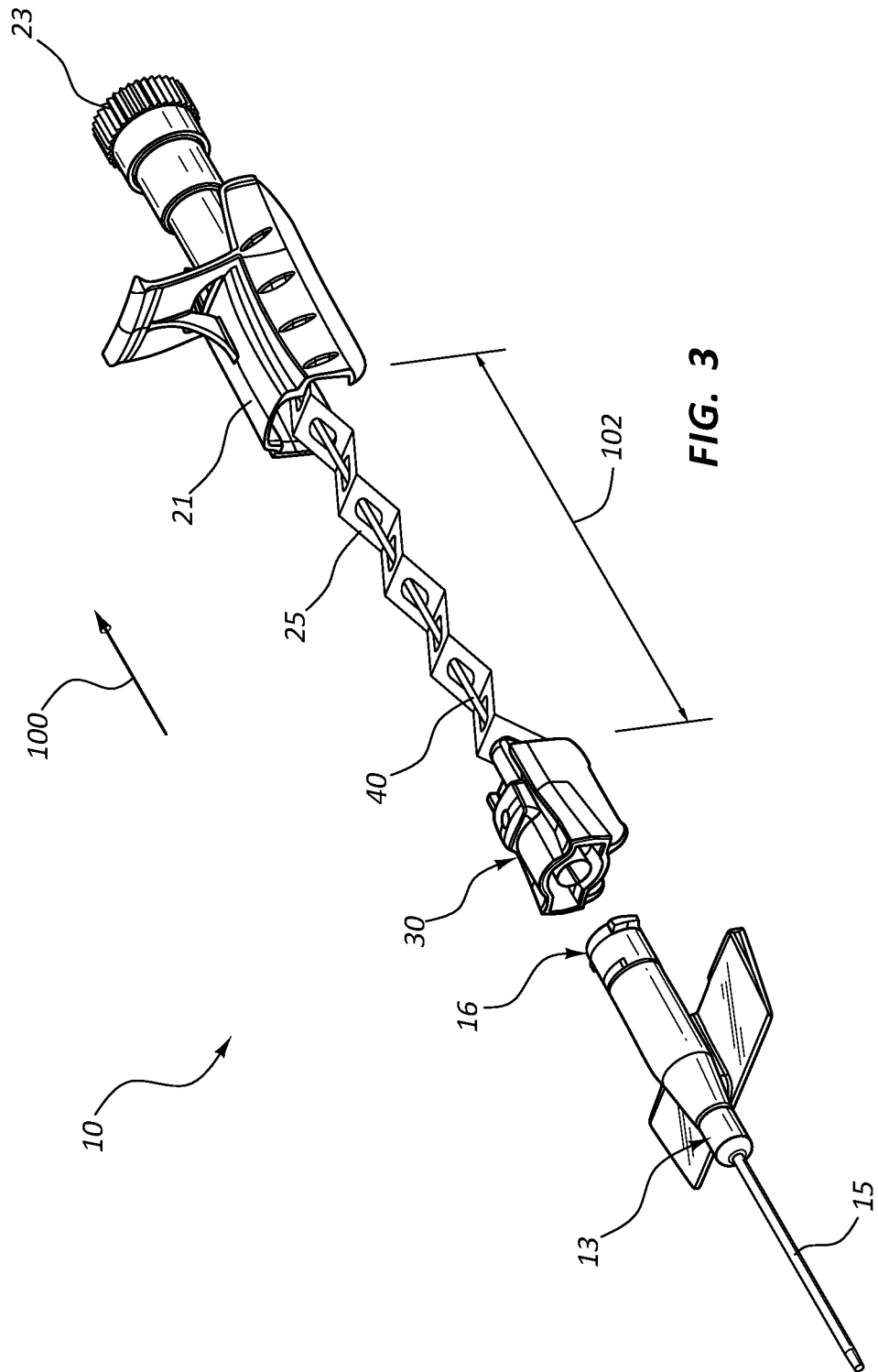
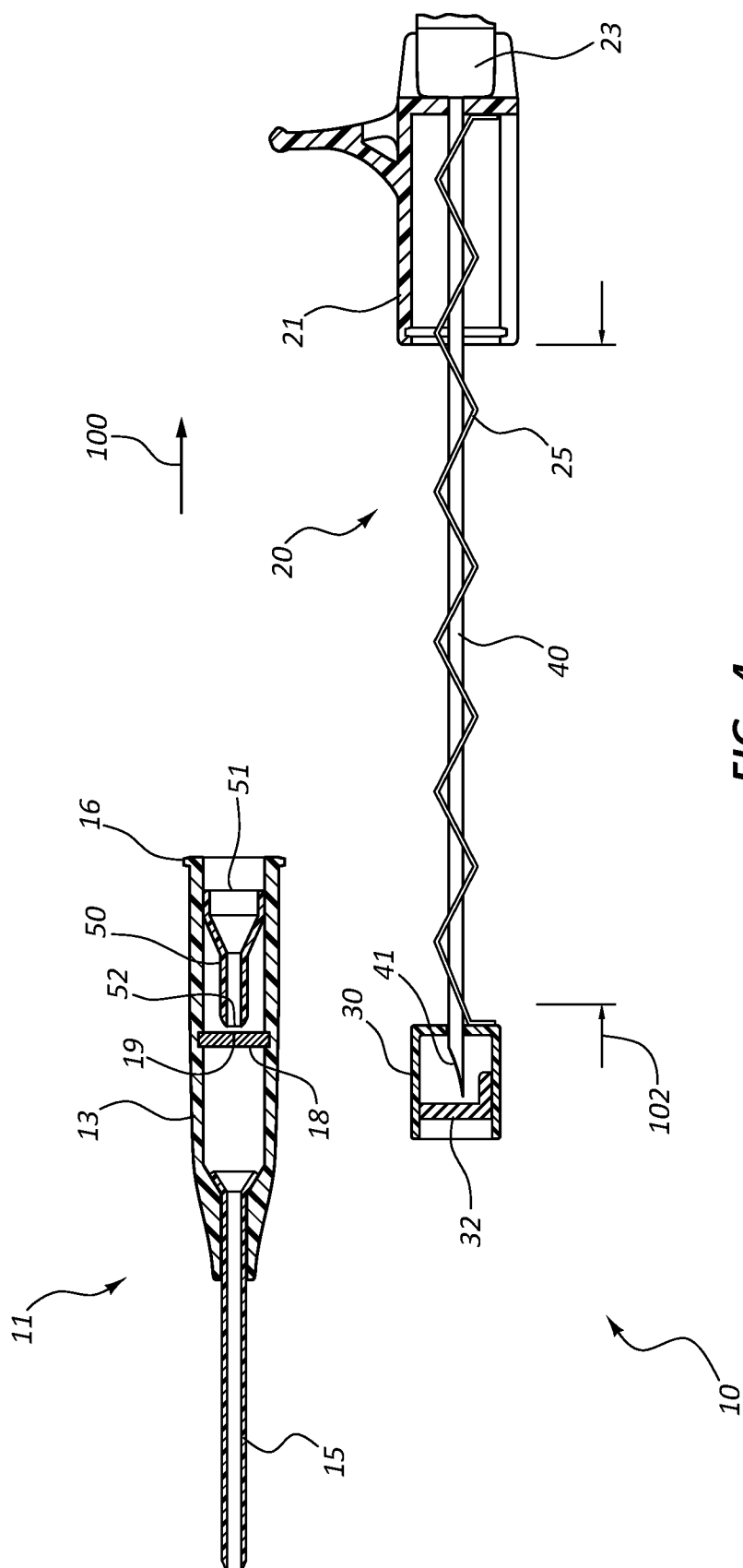

FIG. 2





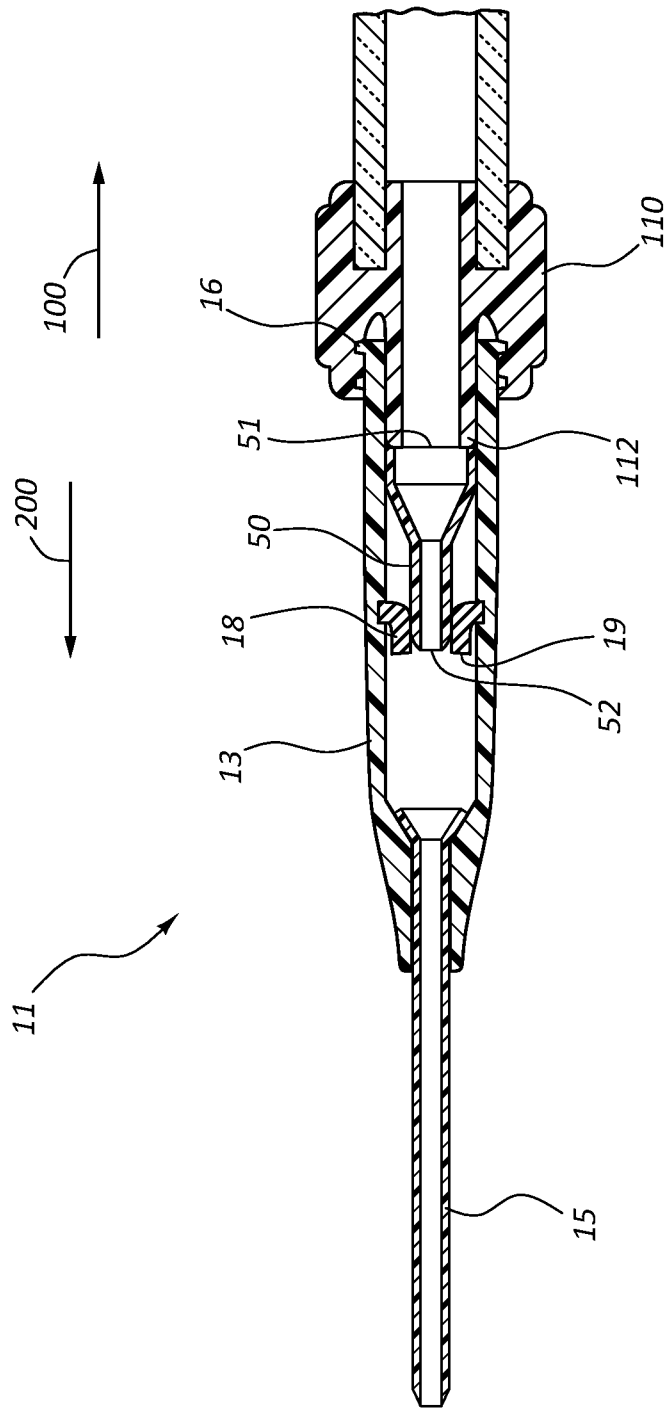

FIG. 5

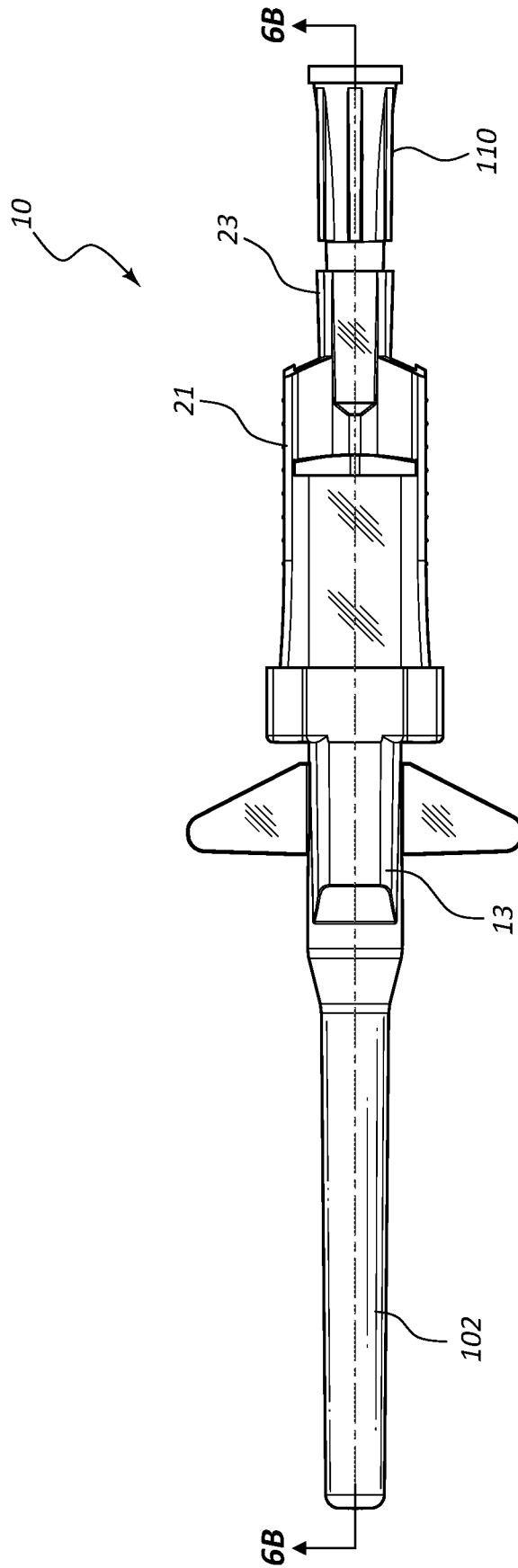

FIG. 6A

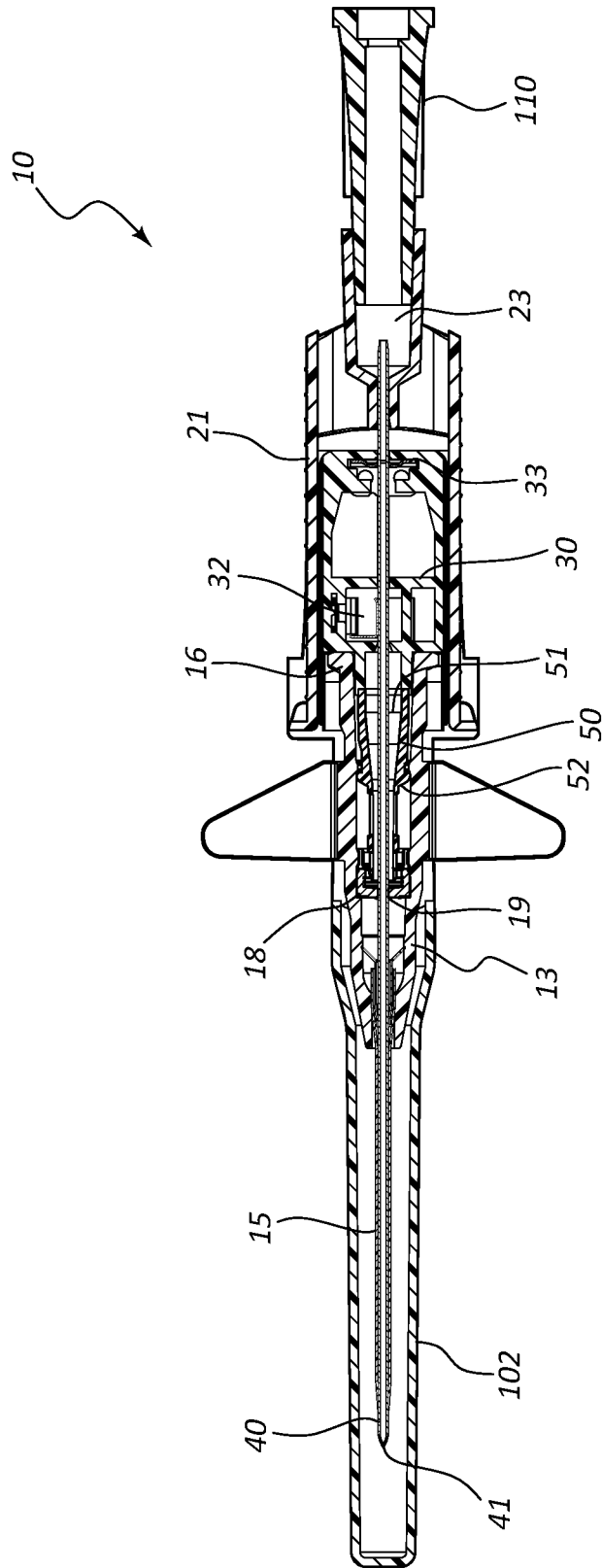

FIG. 6B

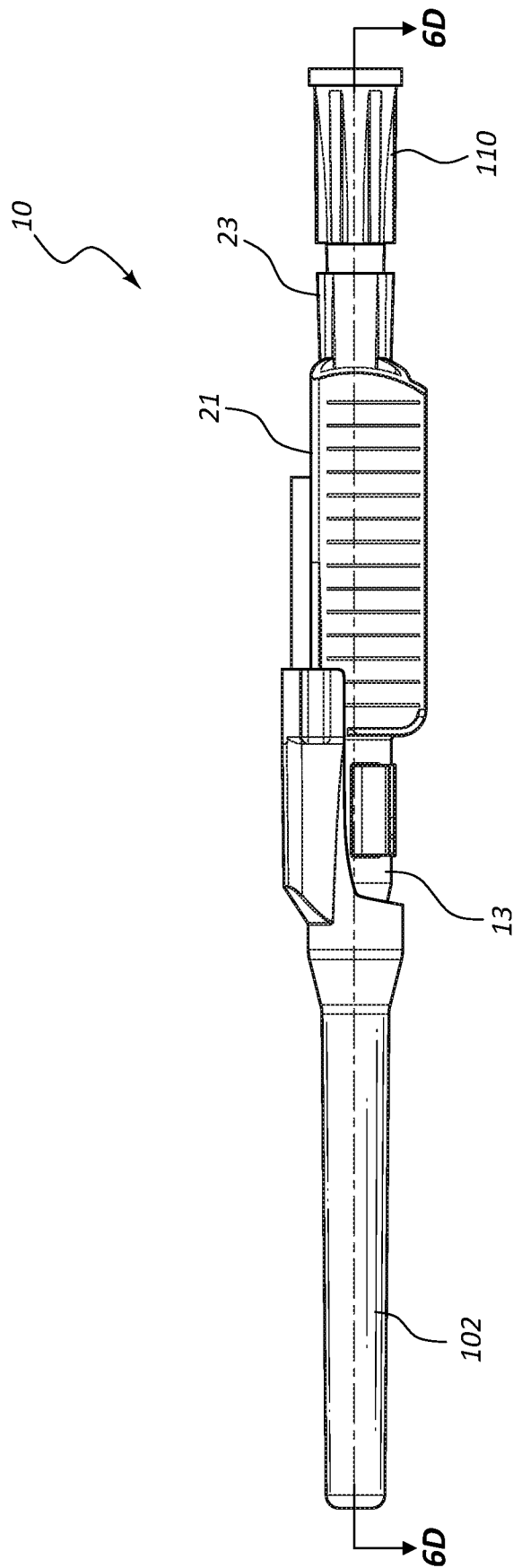

FIG. 6C

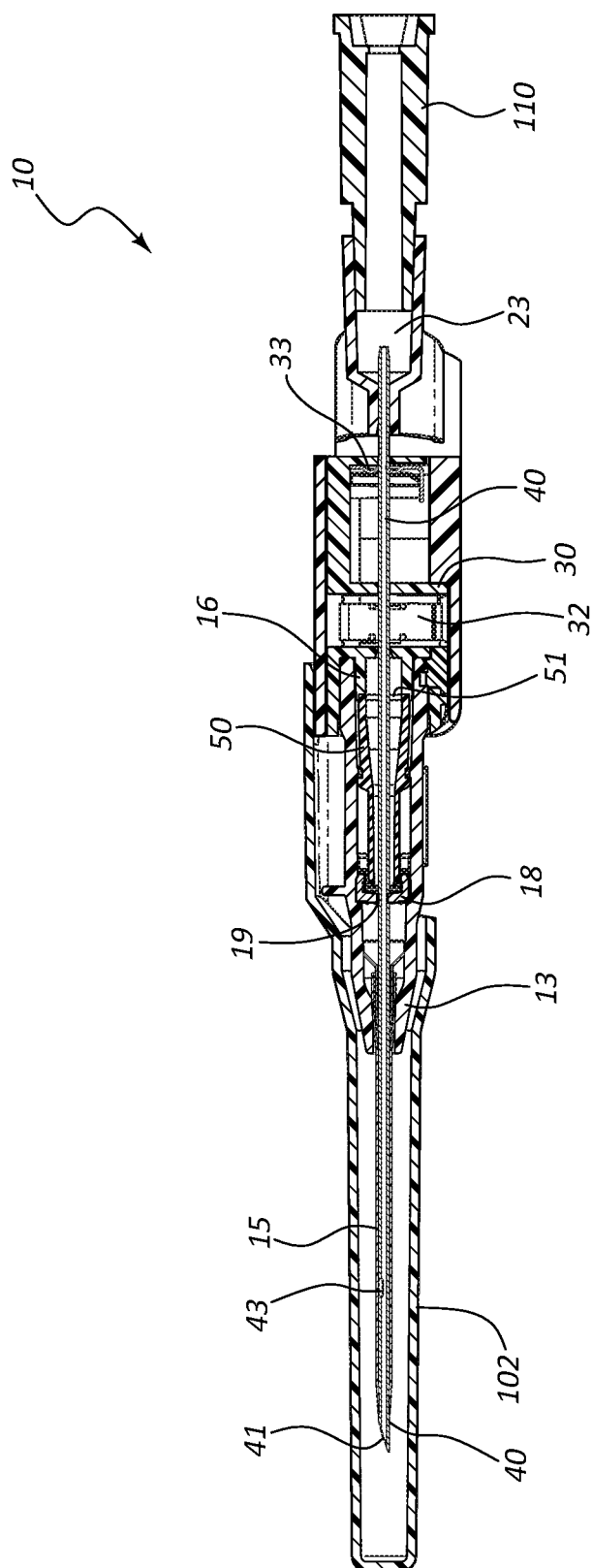

FIG. 6D

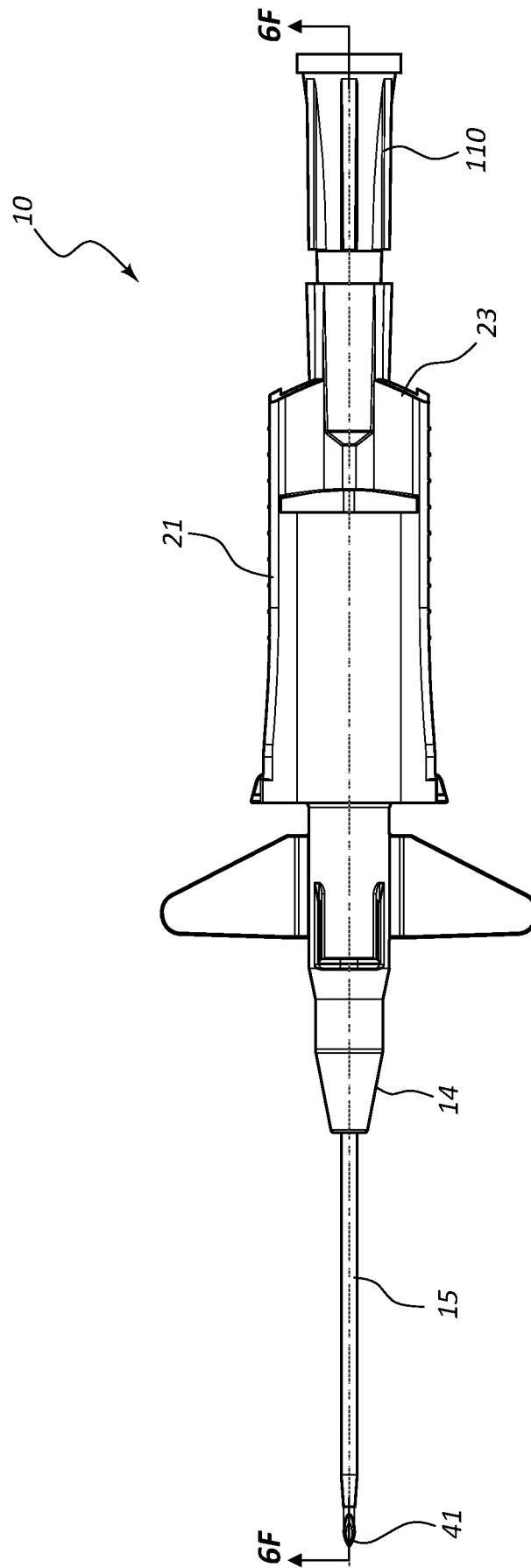

FIG. 6E

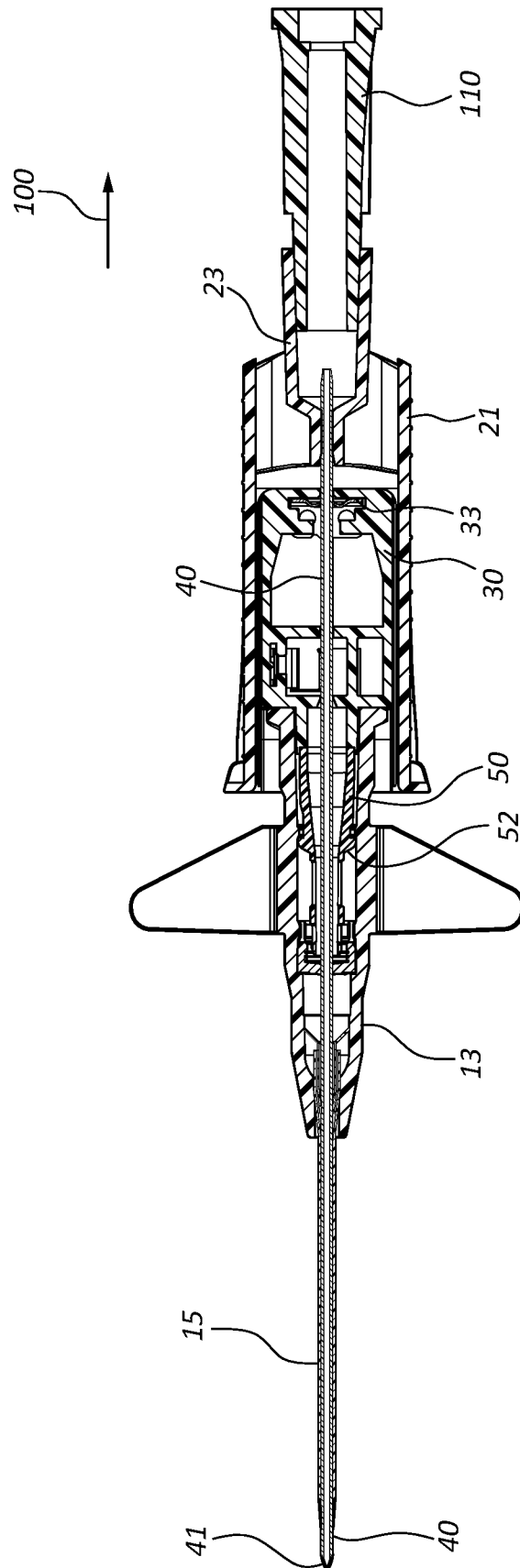

FIG. 6F

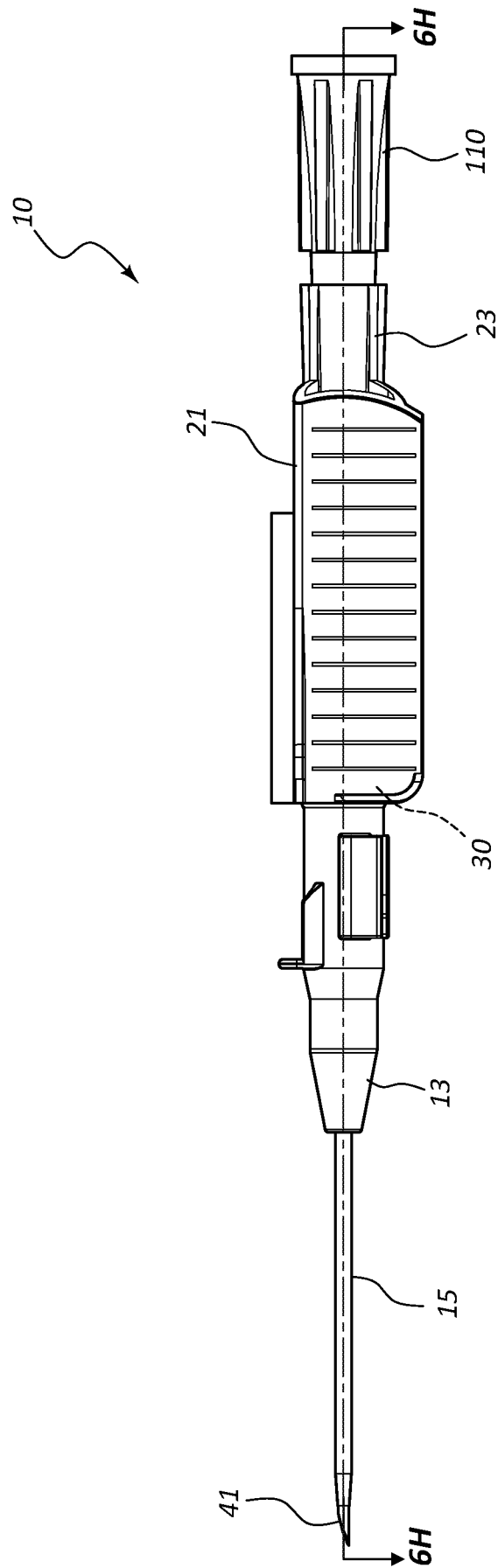
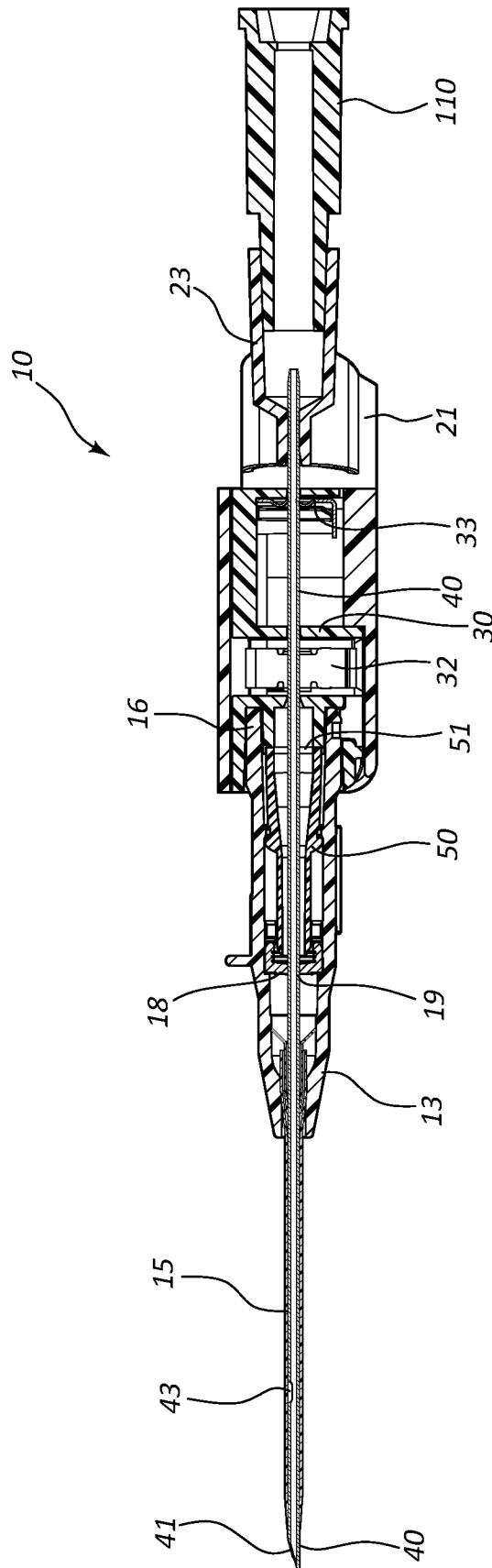

FIG. 6G

**FIG. 6H**

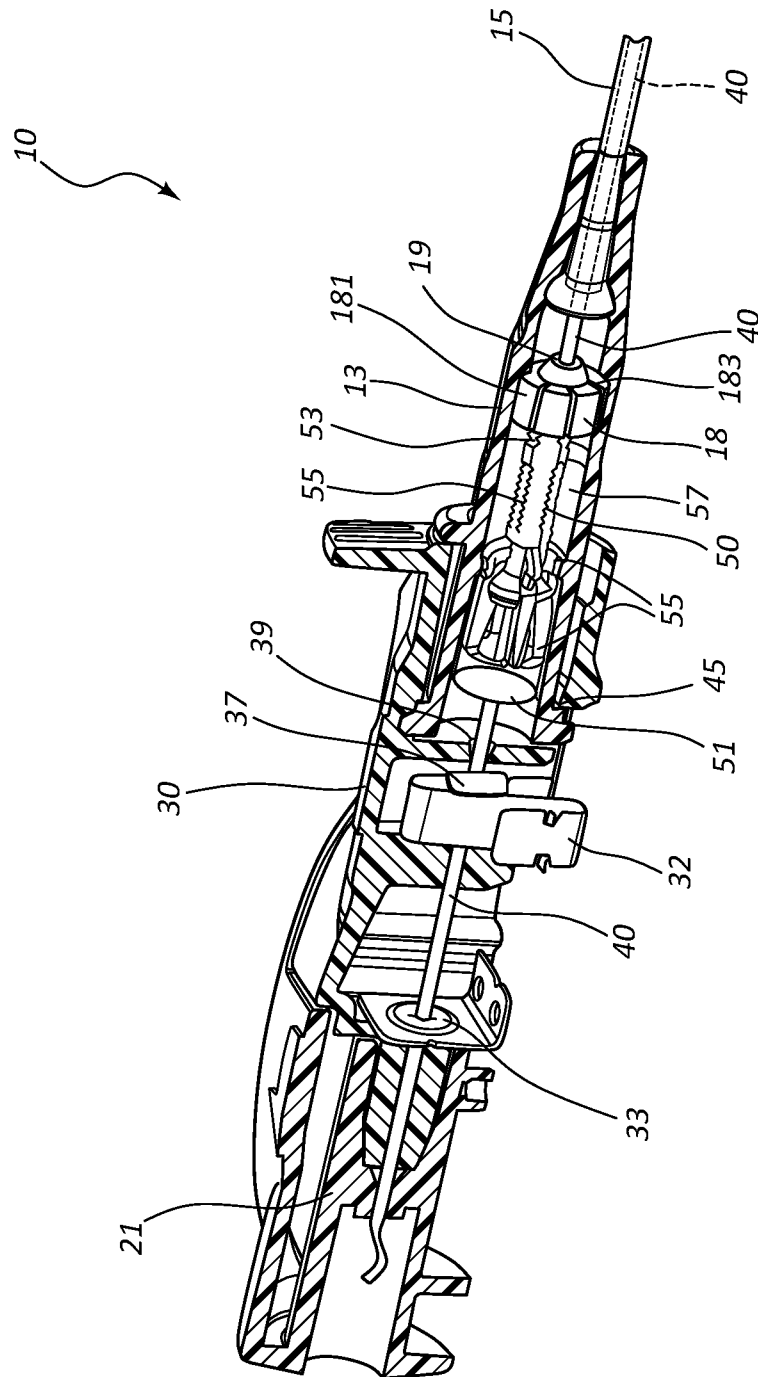
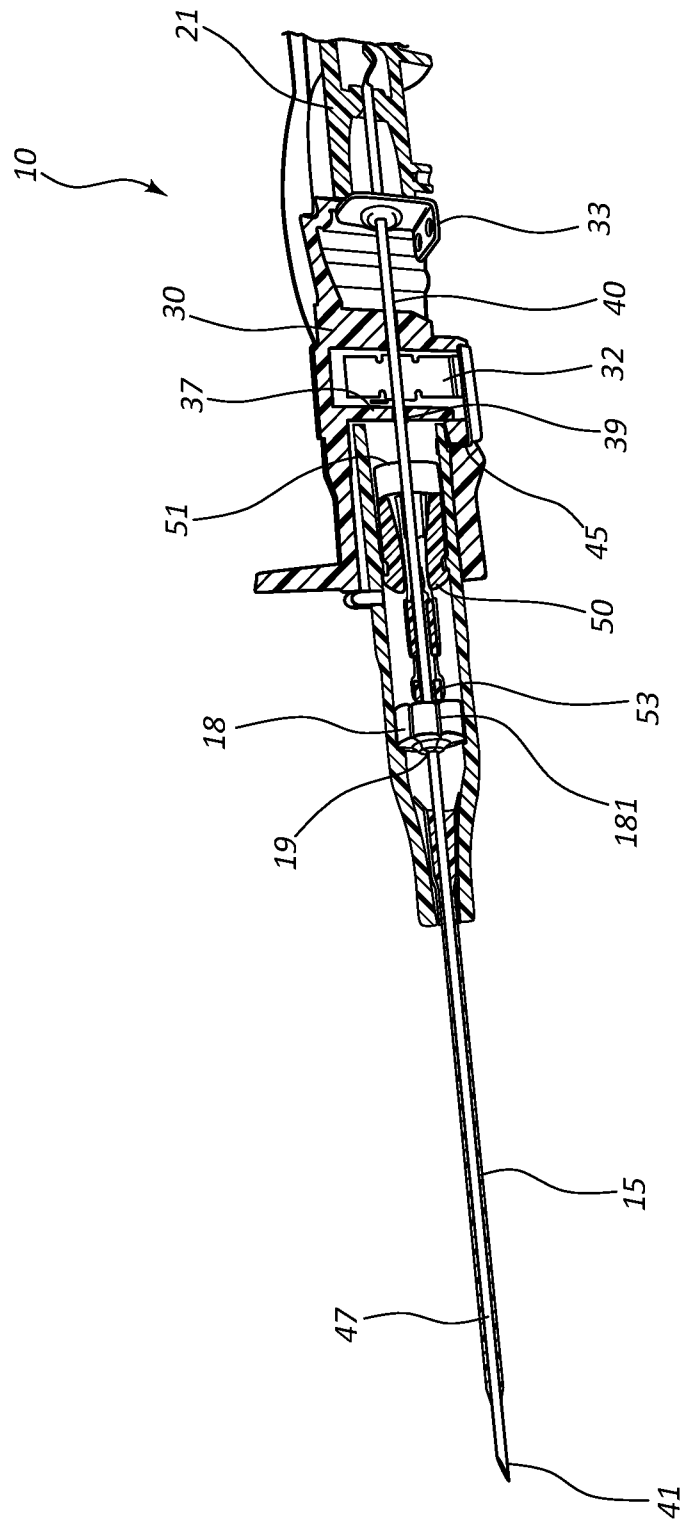
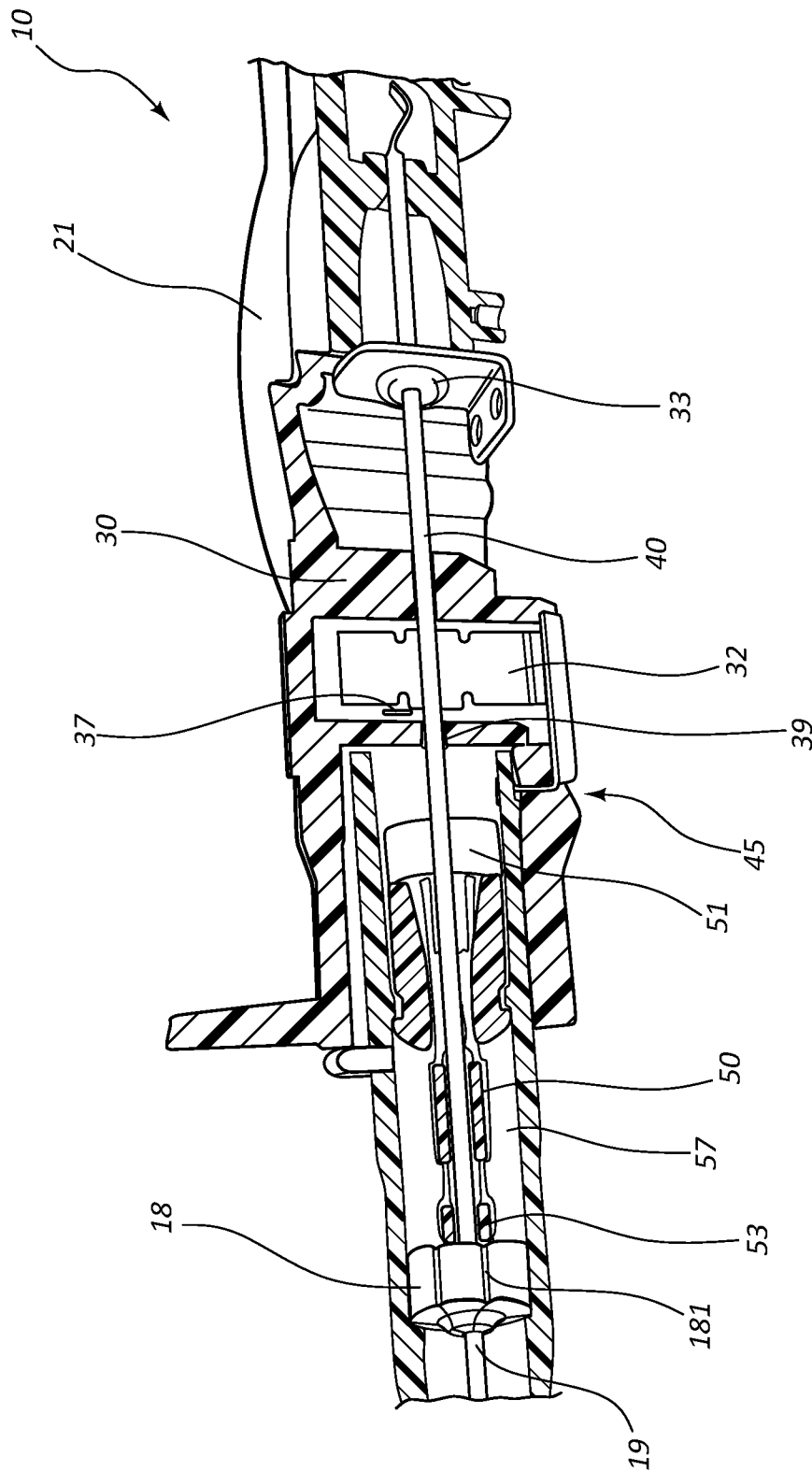

FIG. 7A

**FIG. 7B**

**FIG. 7C**

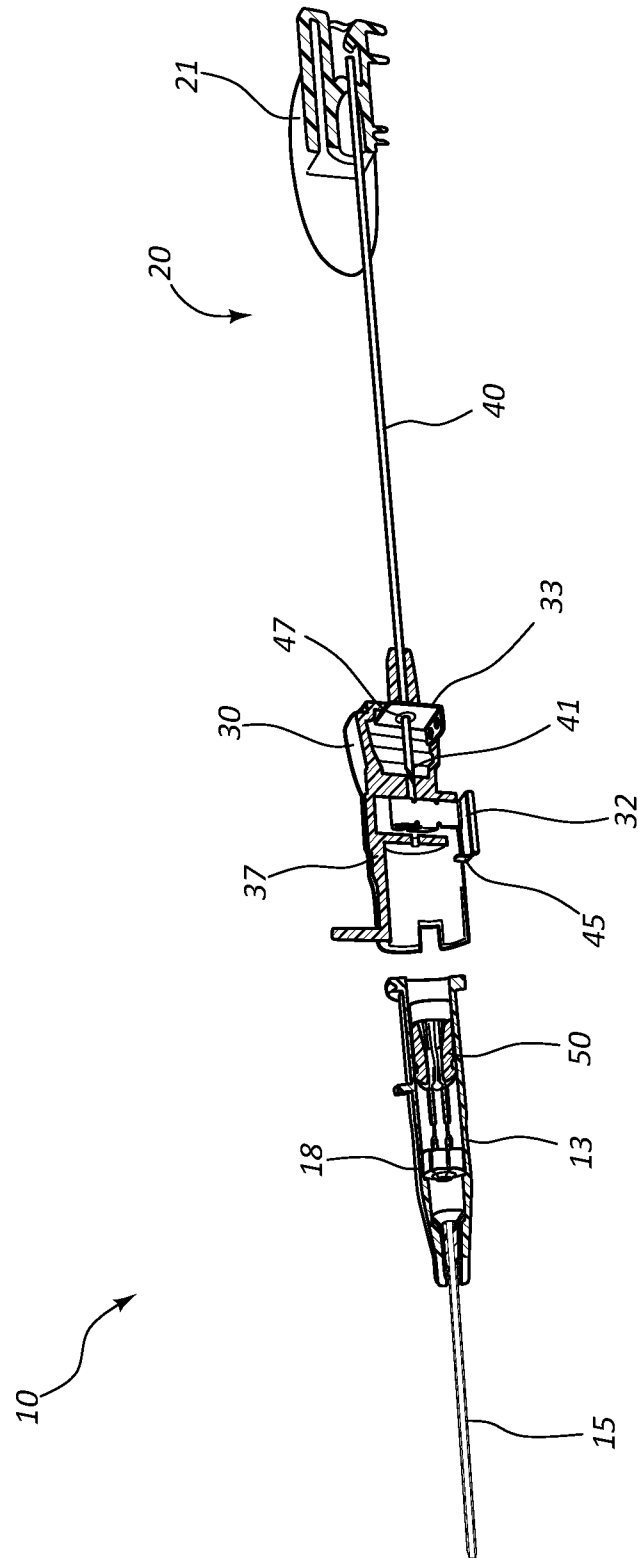

FIG. 7D

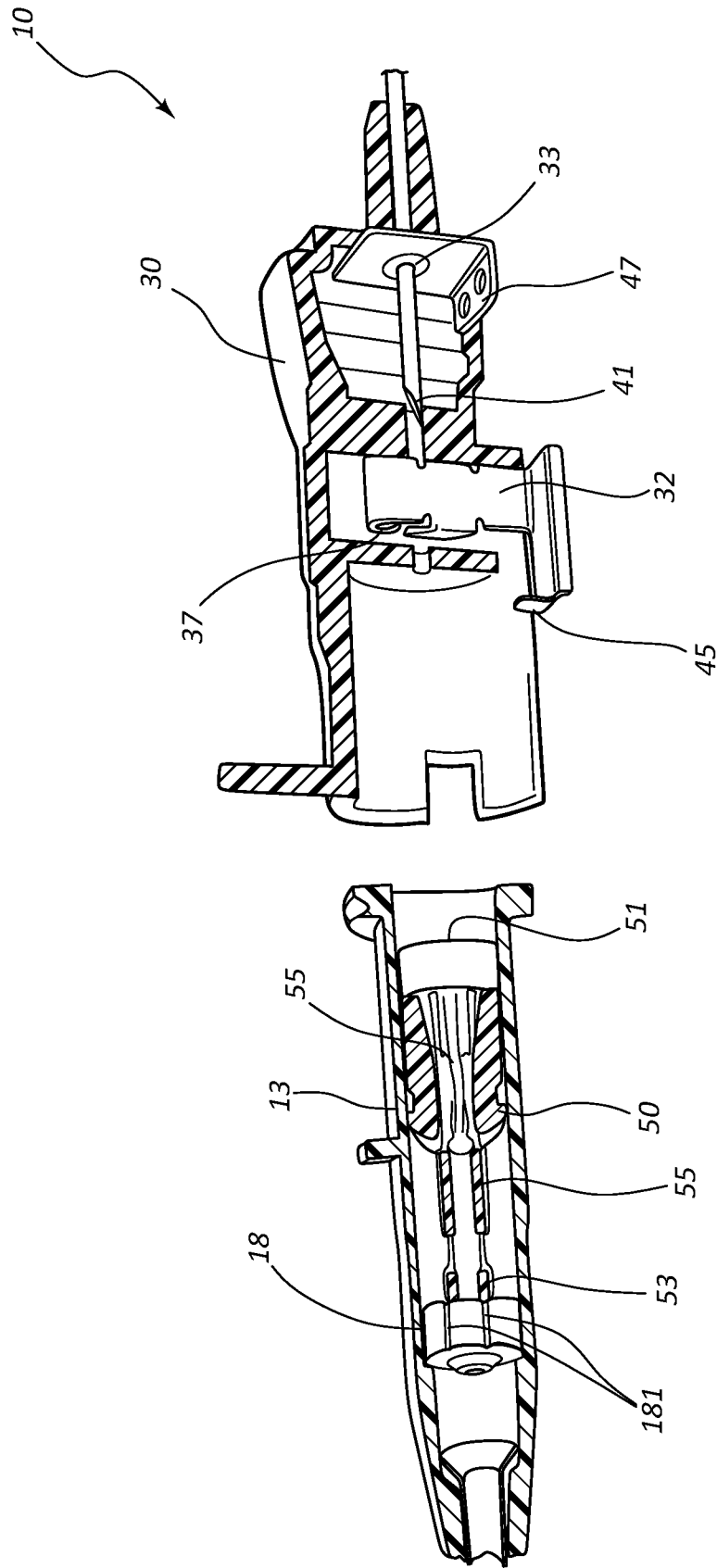

FIG. 7E

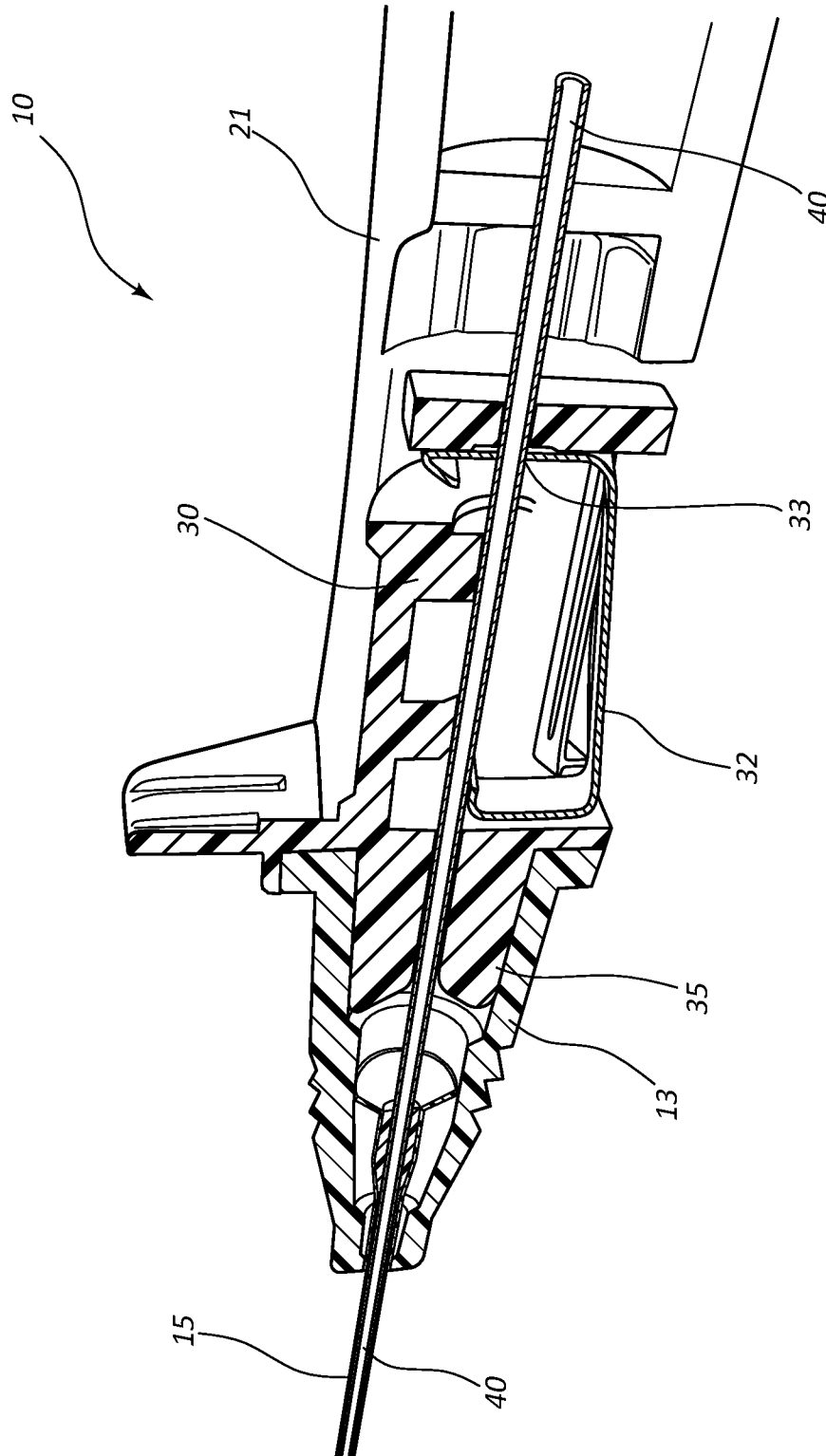
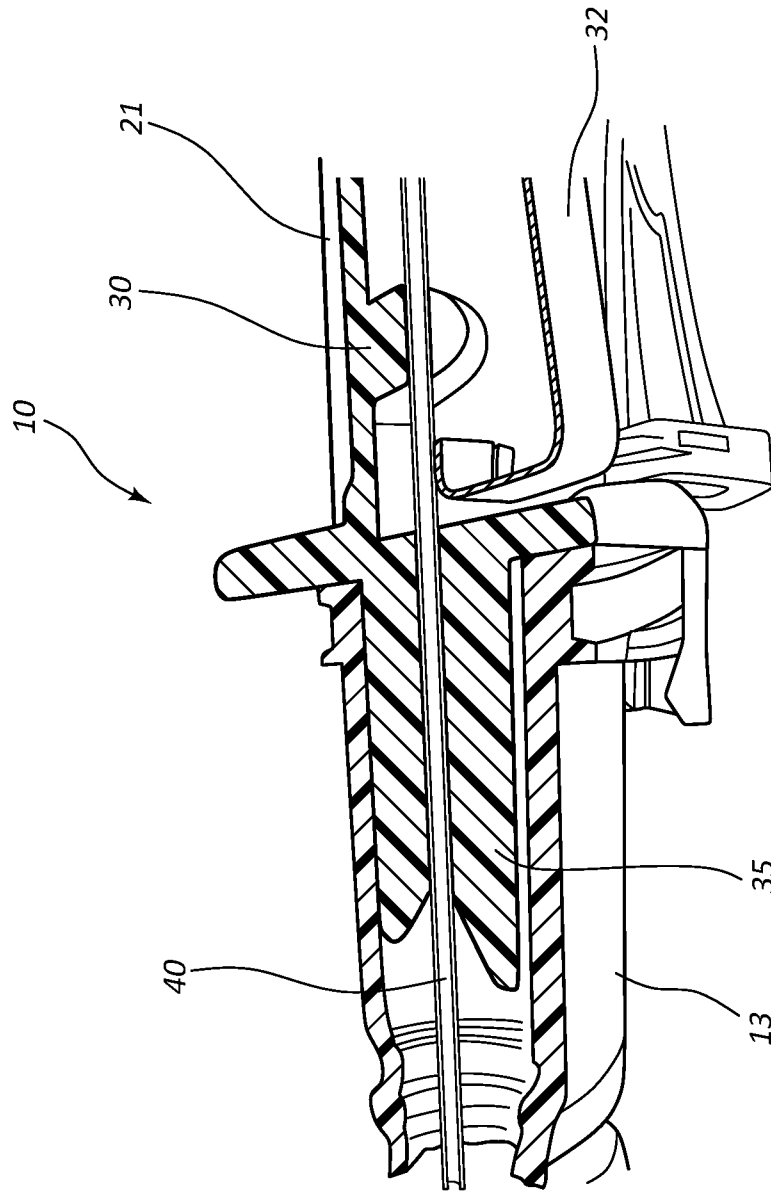

FIG. 8A

**FIG. 8B**

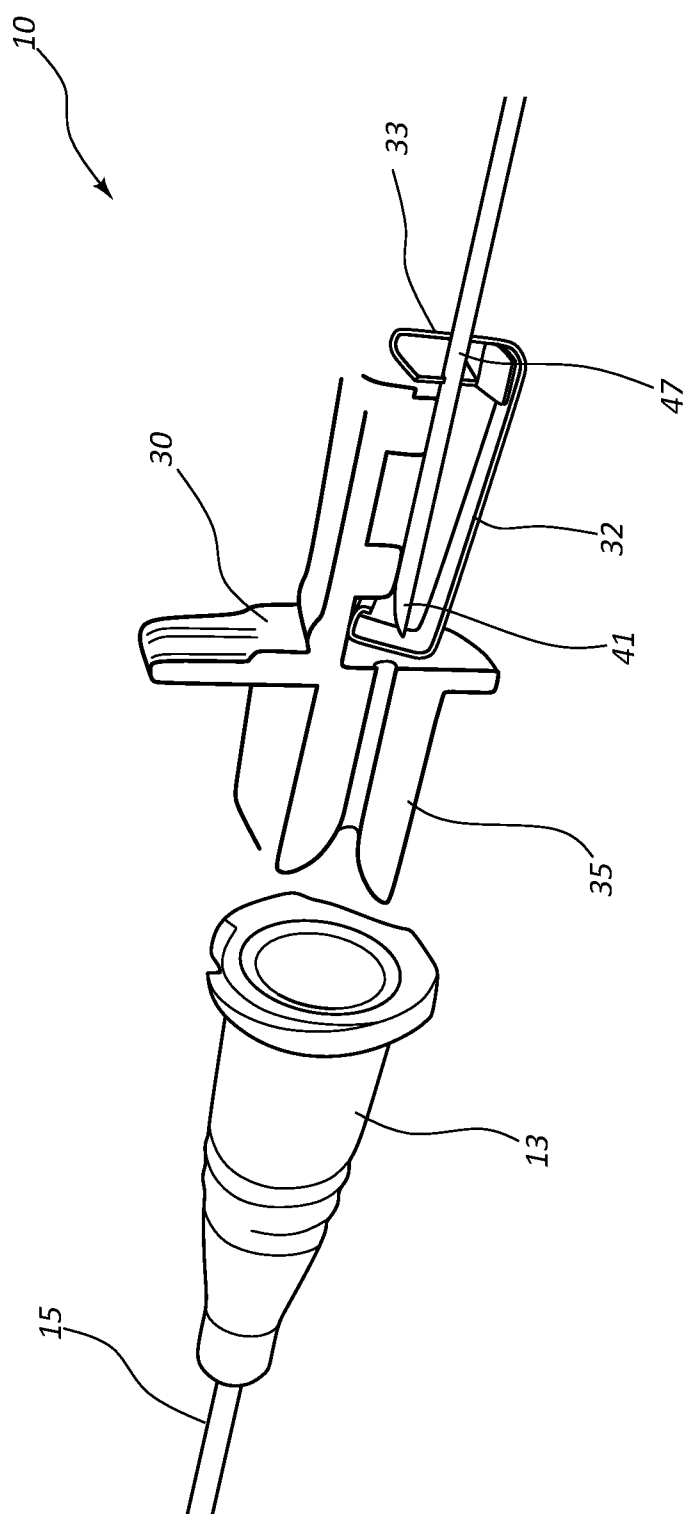

FIG. 8C

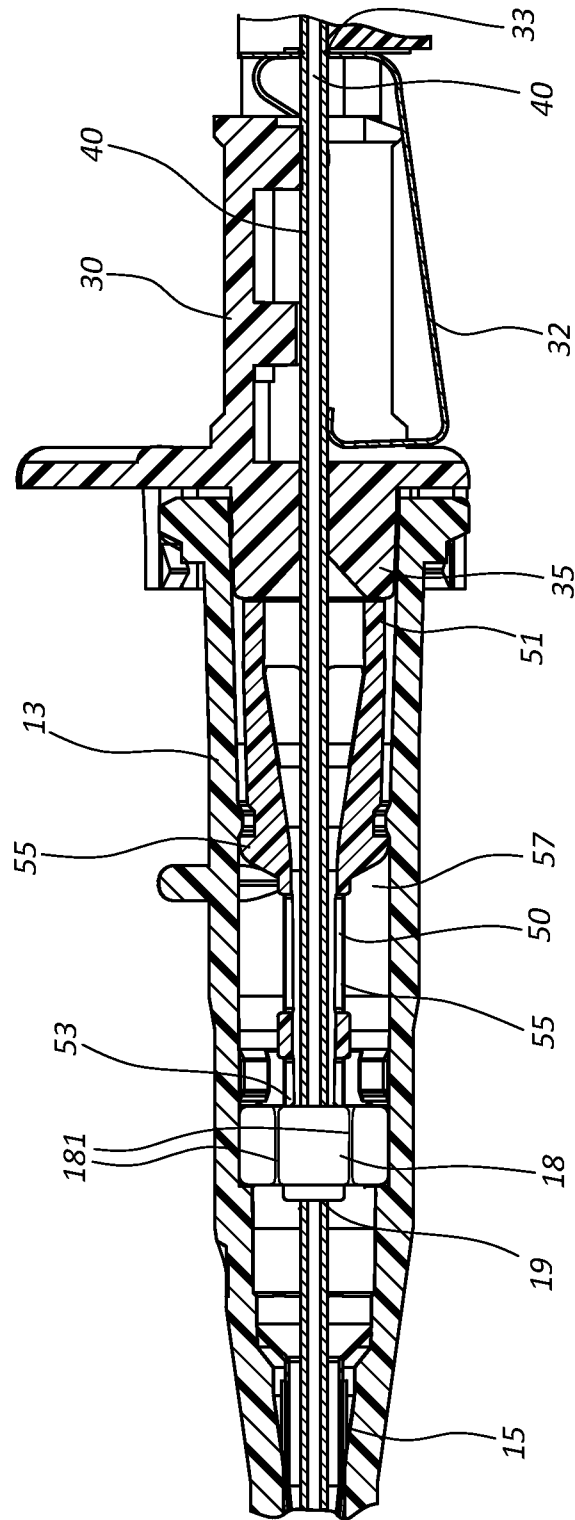

FIG. 8D

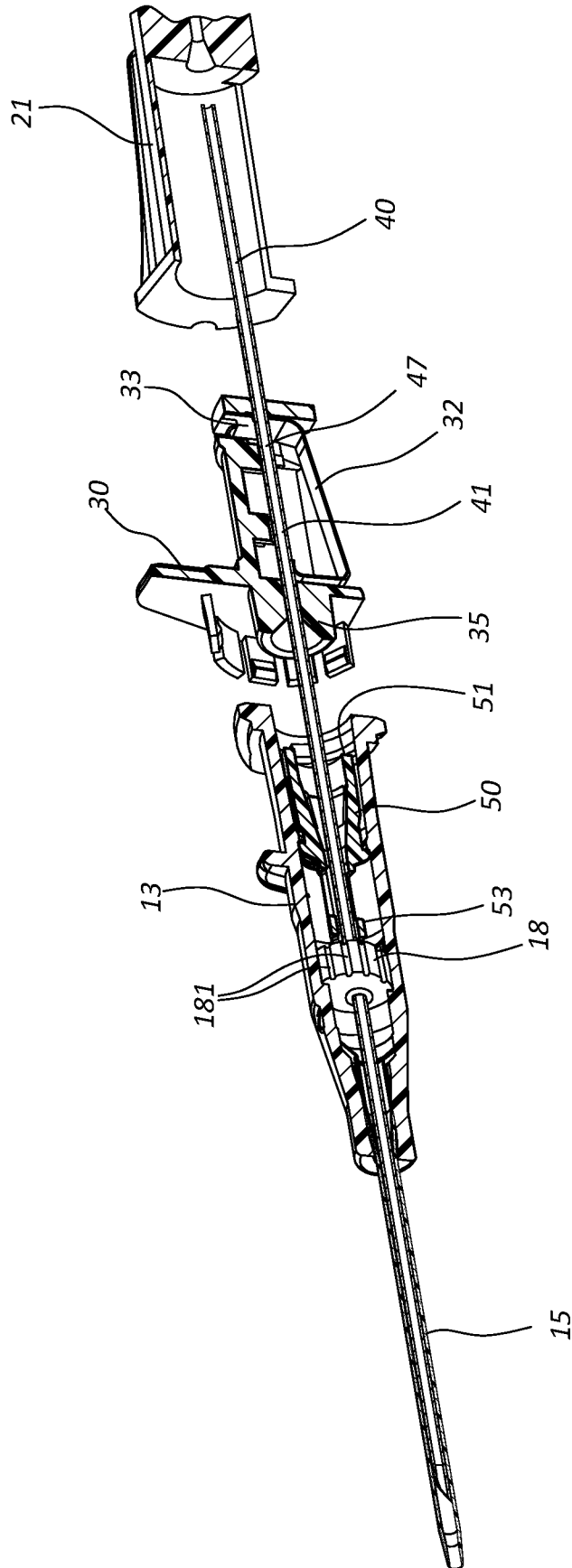

FIG. 8E

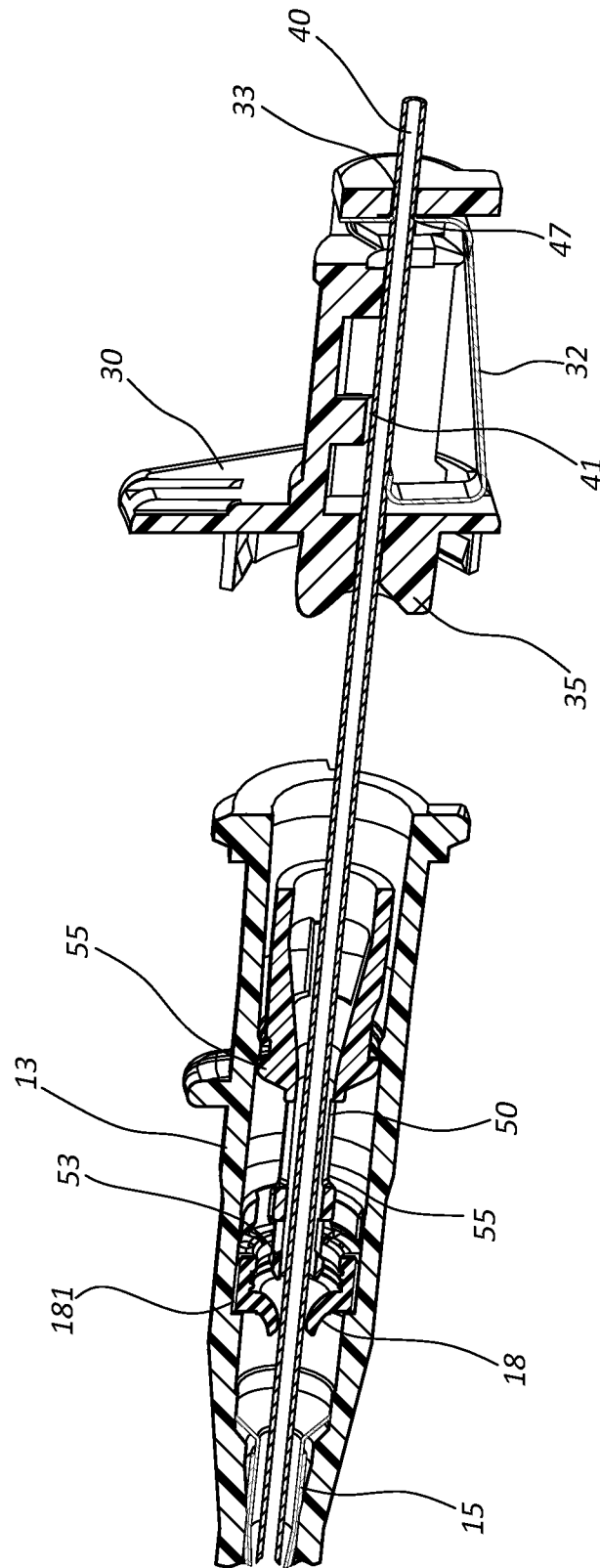

FIG. 8F

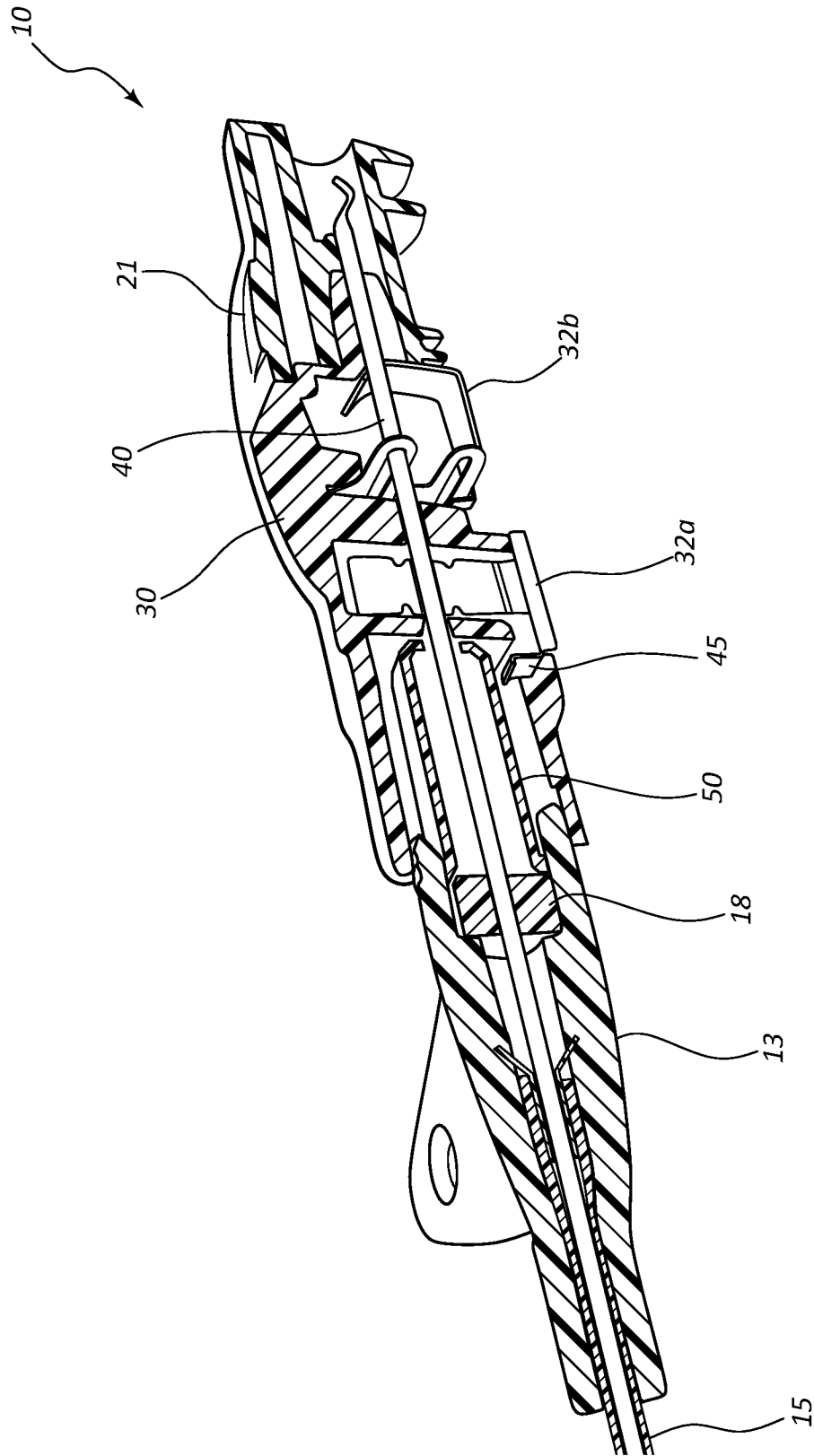

FIG. 9A

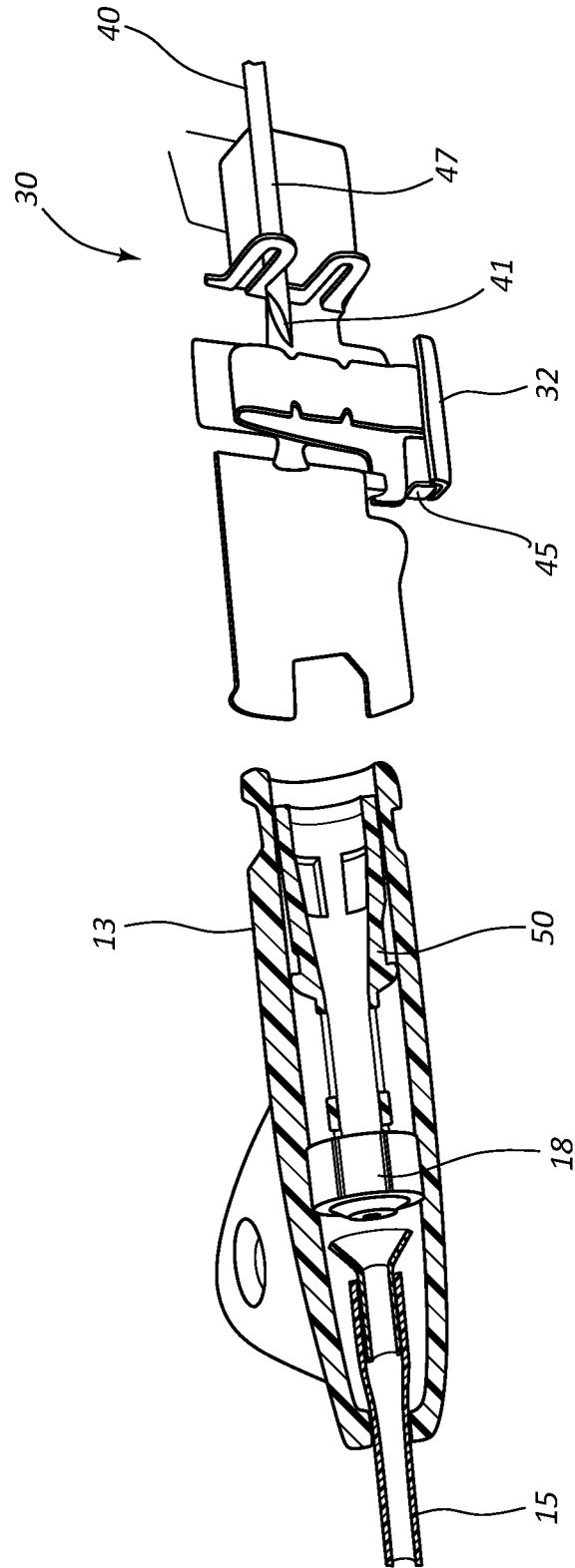

FIG. 9B

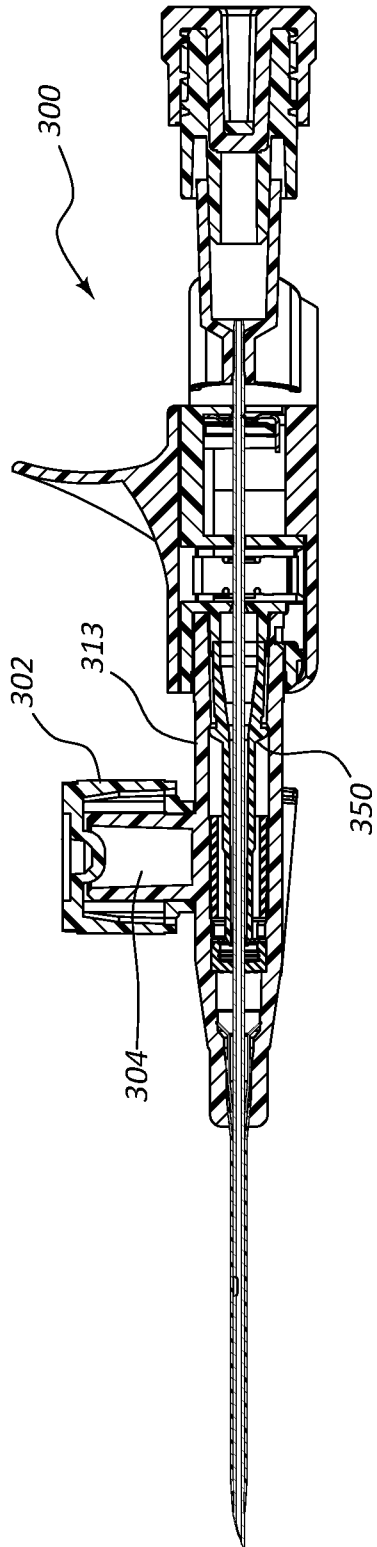

FIG. 10A

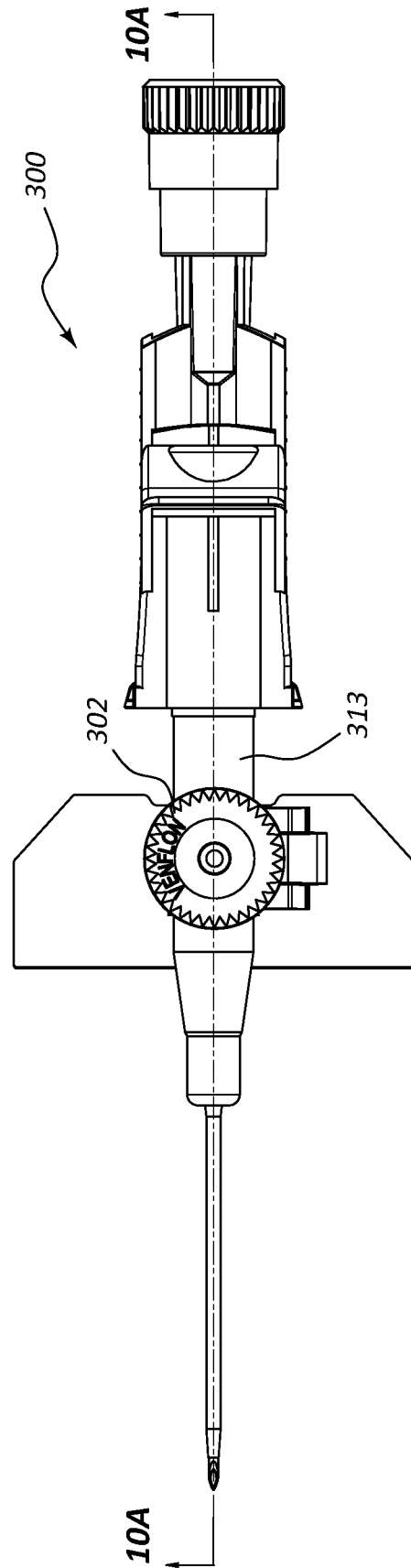
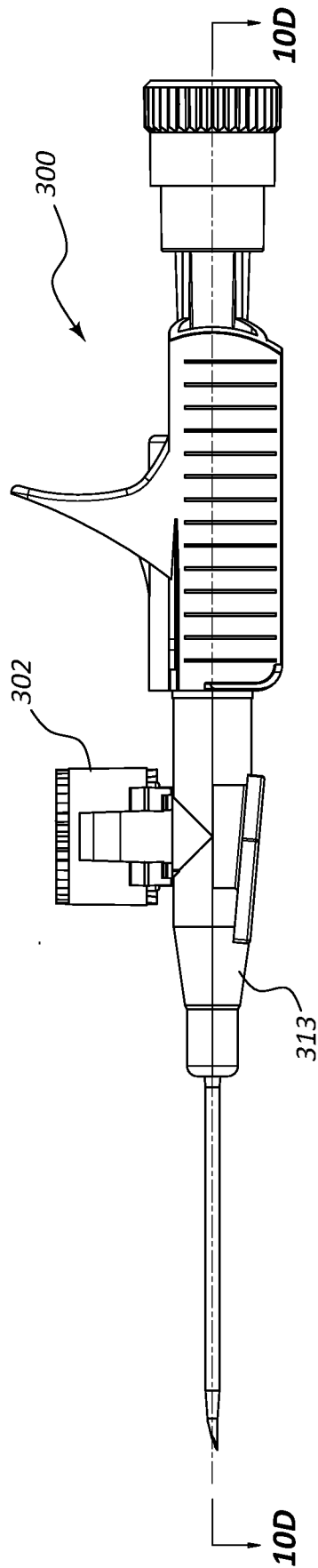
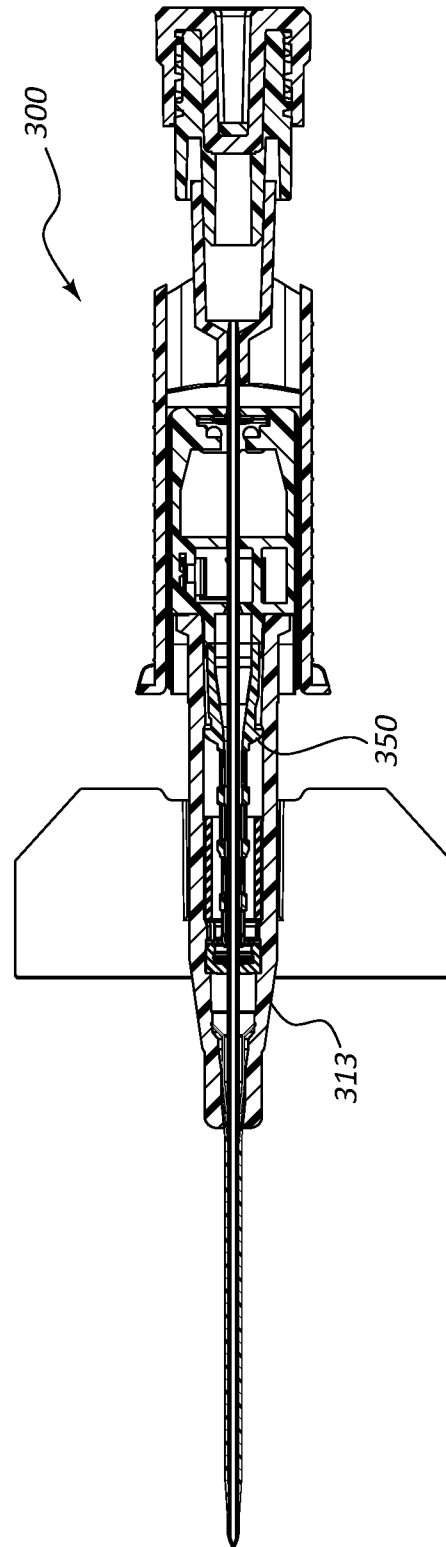

FIG. 10B

**FIG. 10C****FIG. 10D**

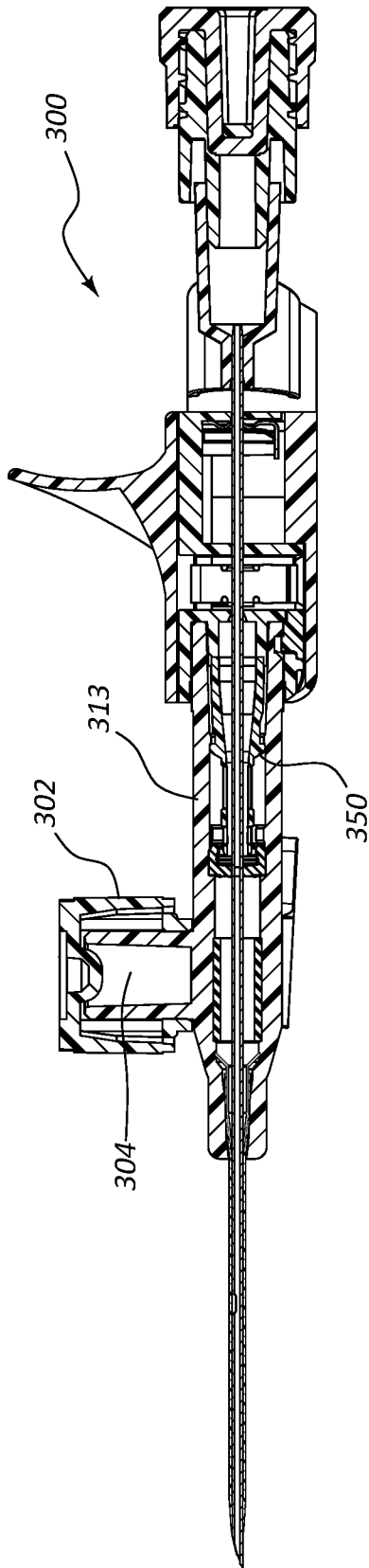

FIG. 11A

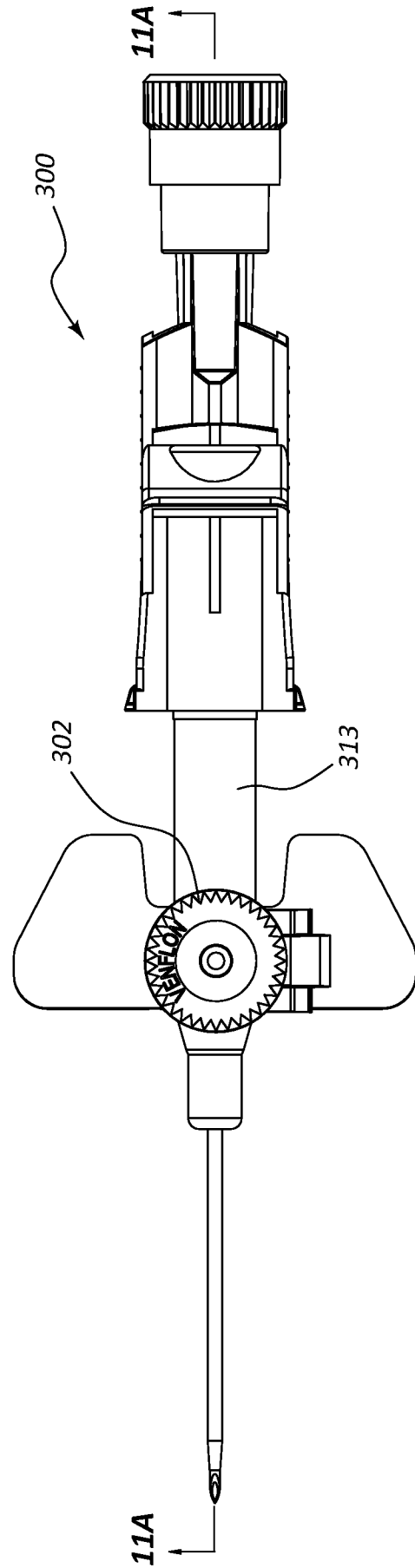

FIG. 11B

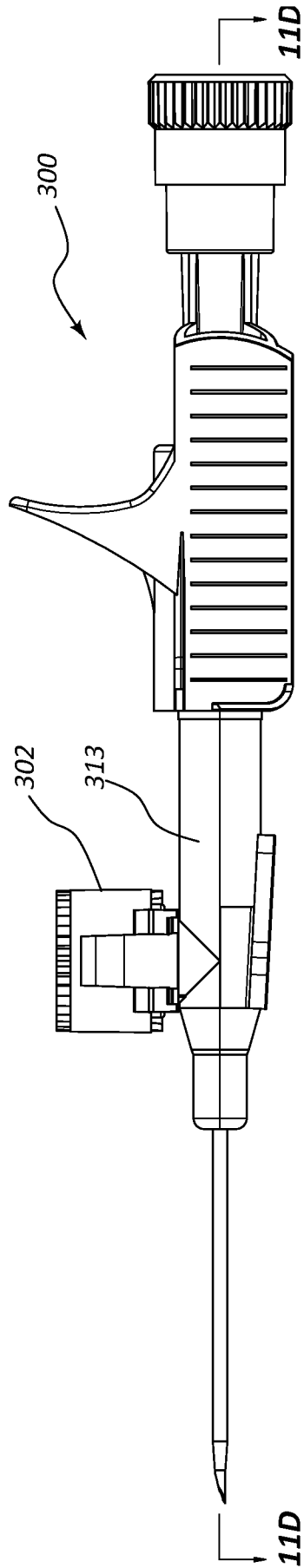

FIG. 11C

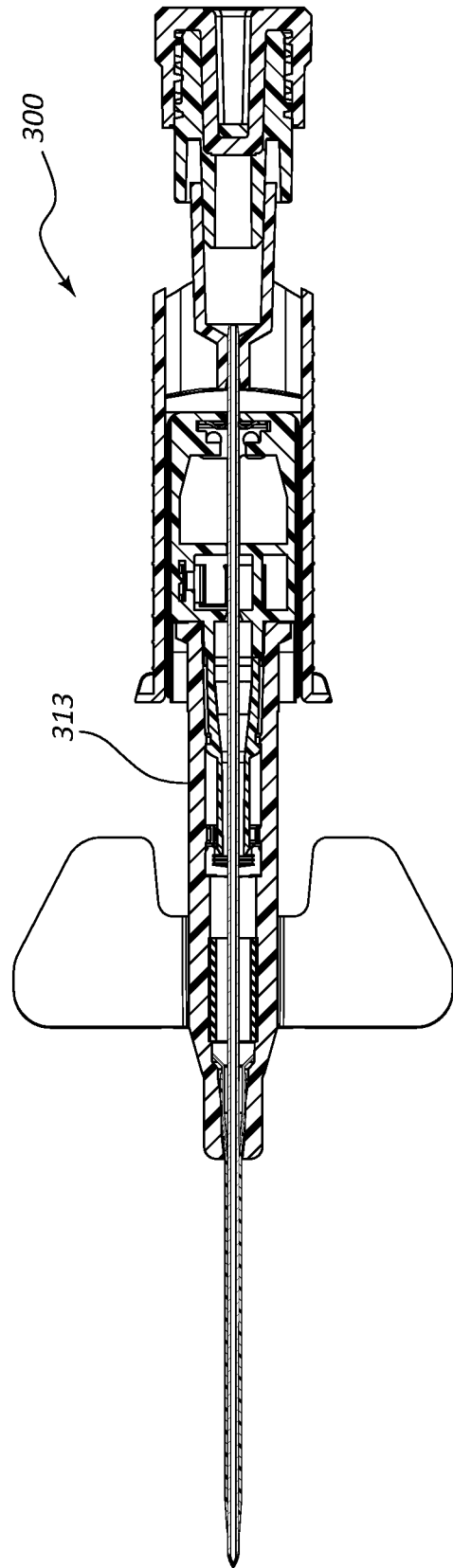
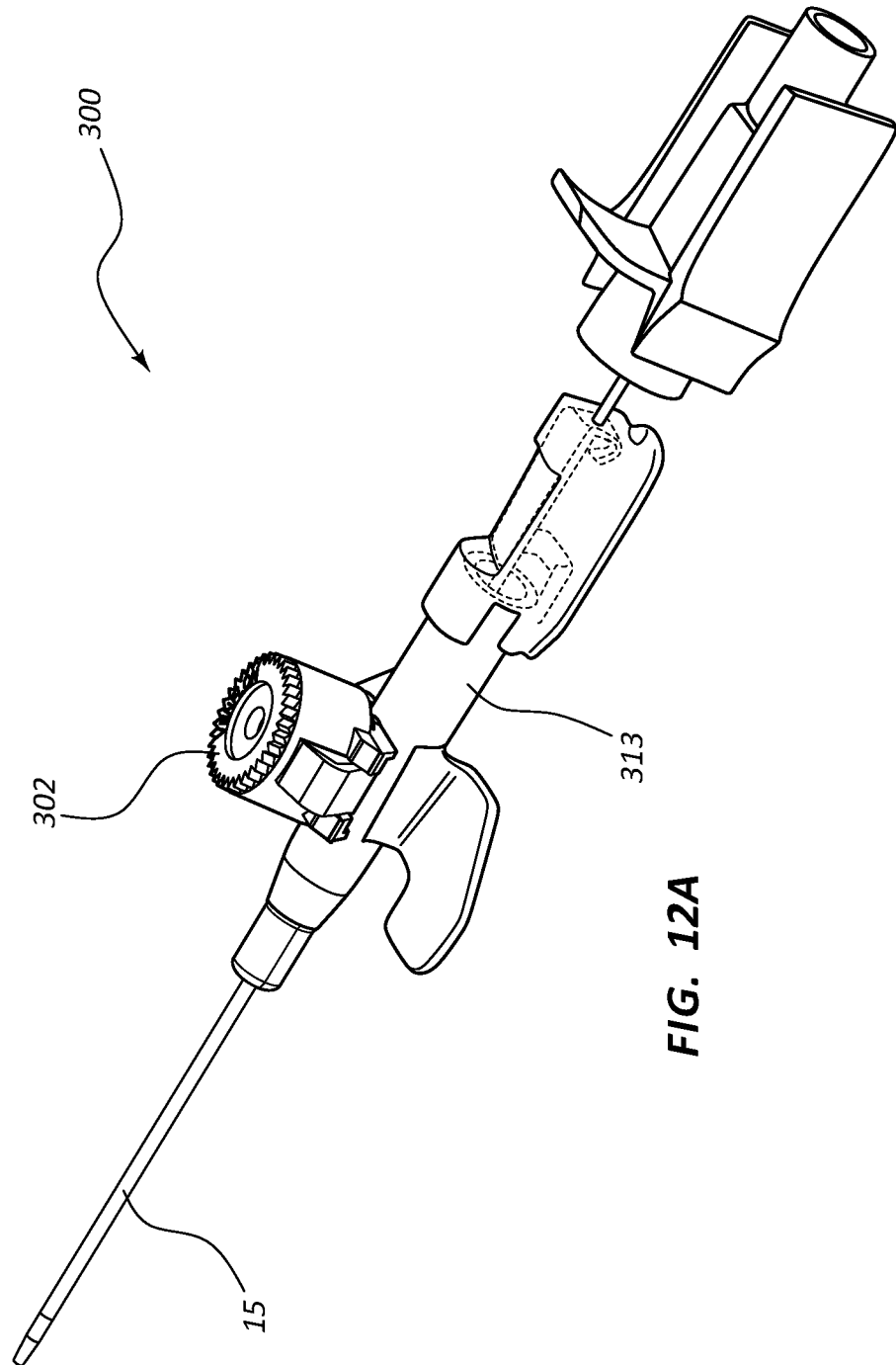

FIG. 11D



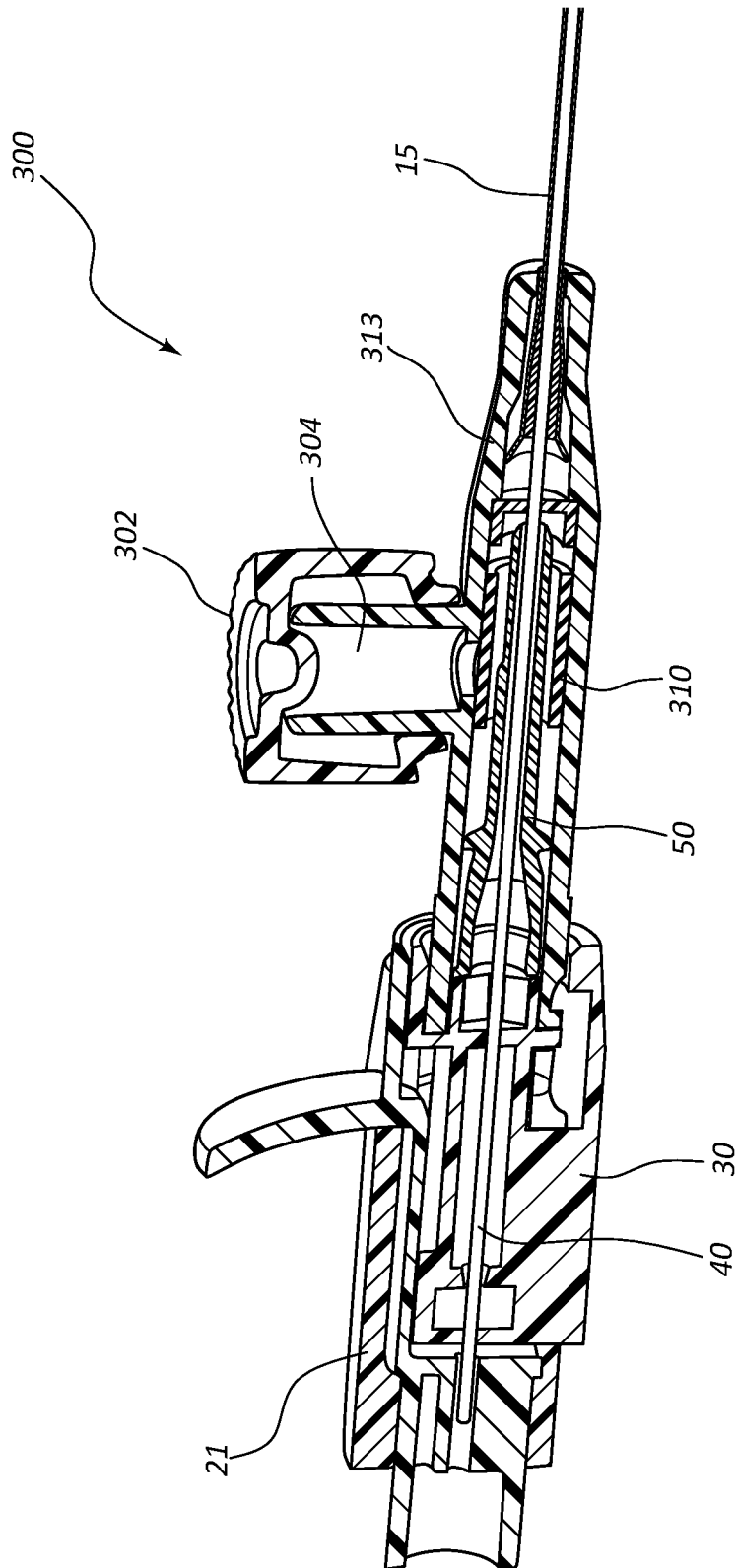
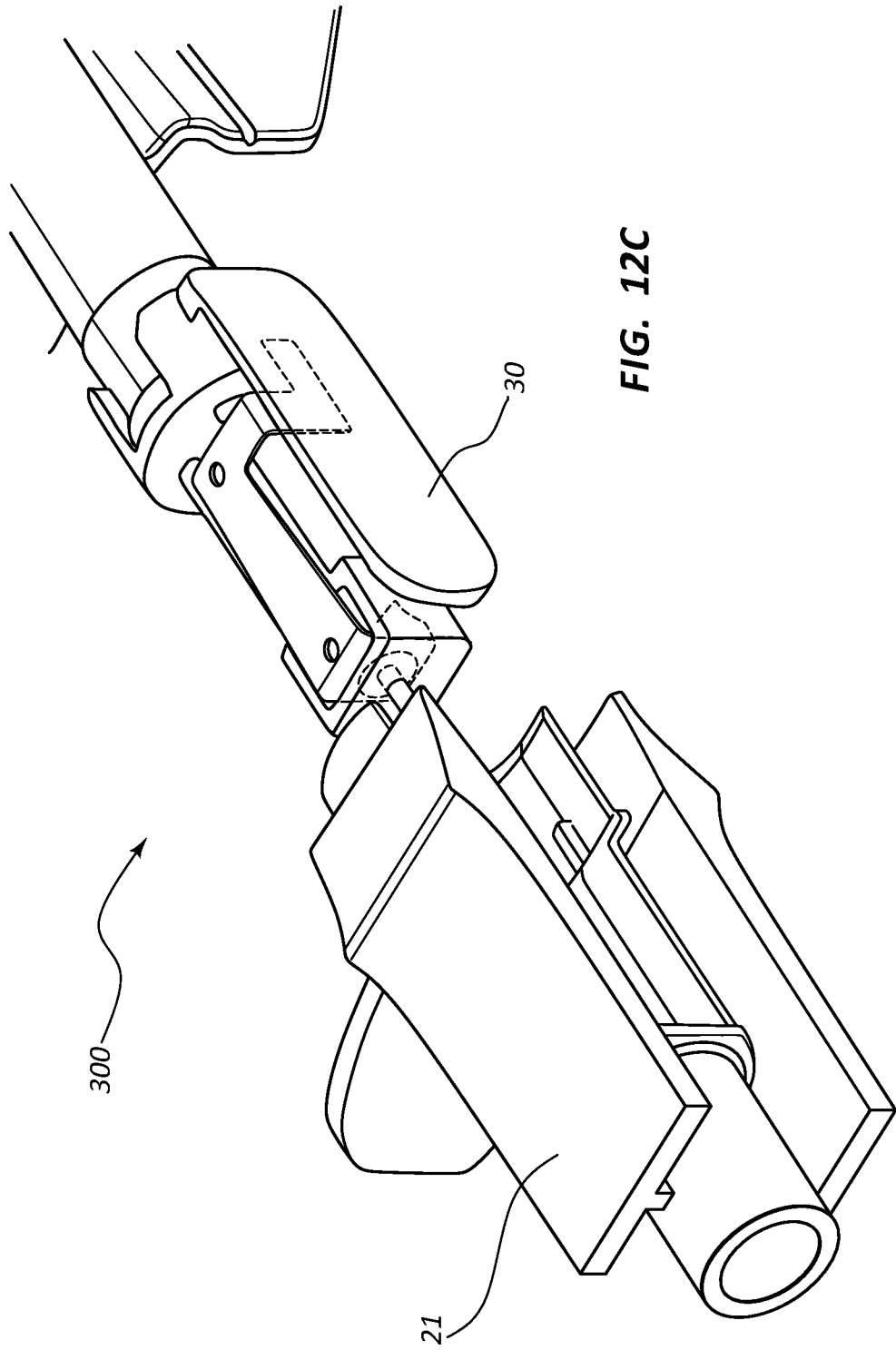
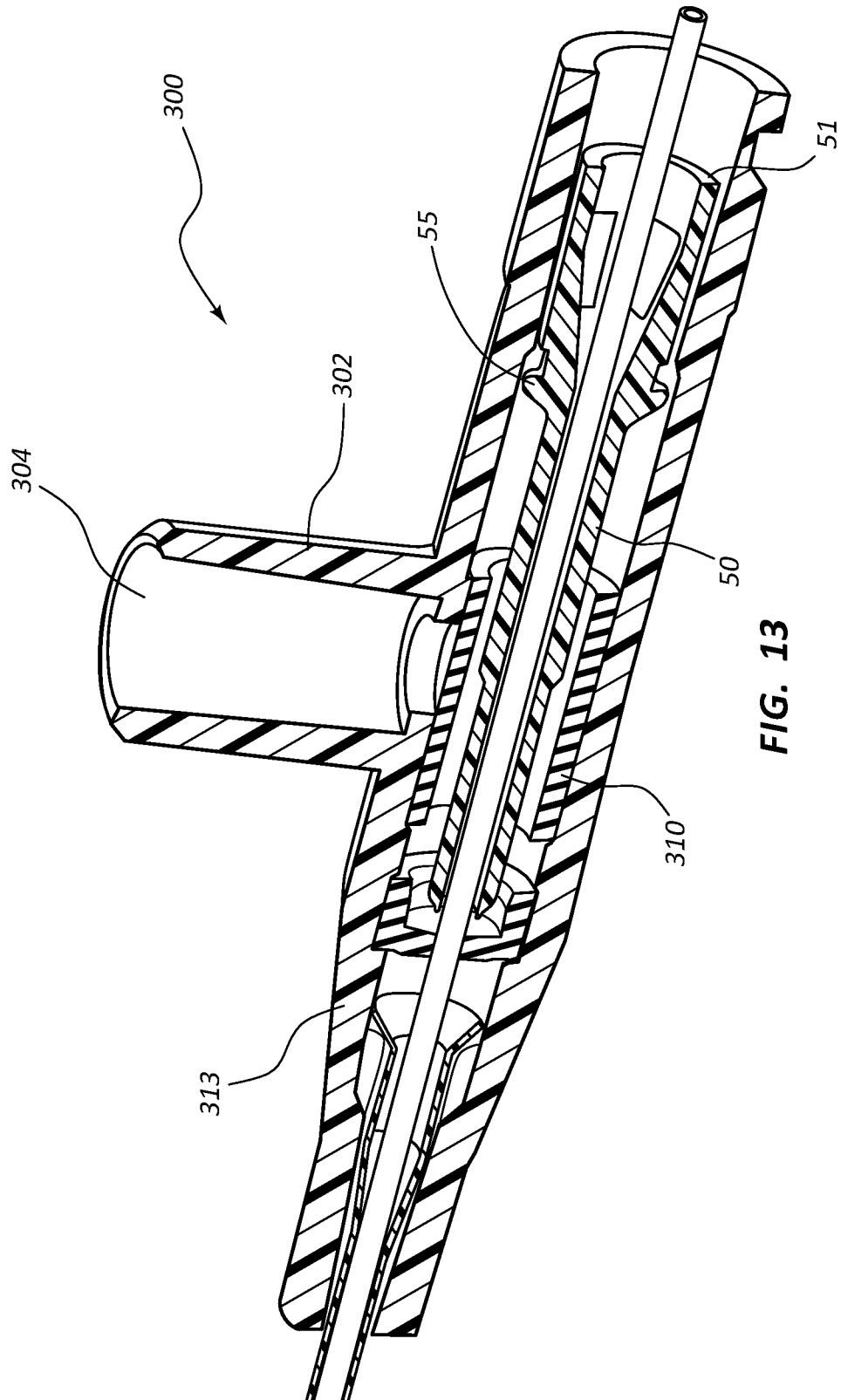

FIG. 12B





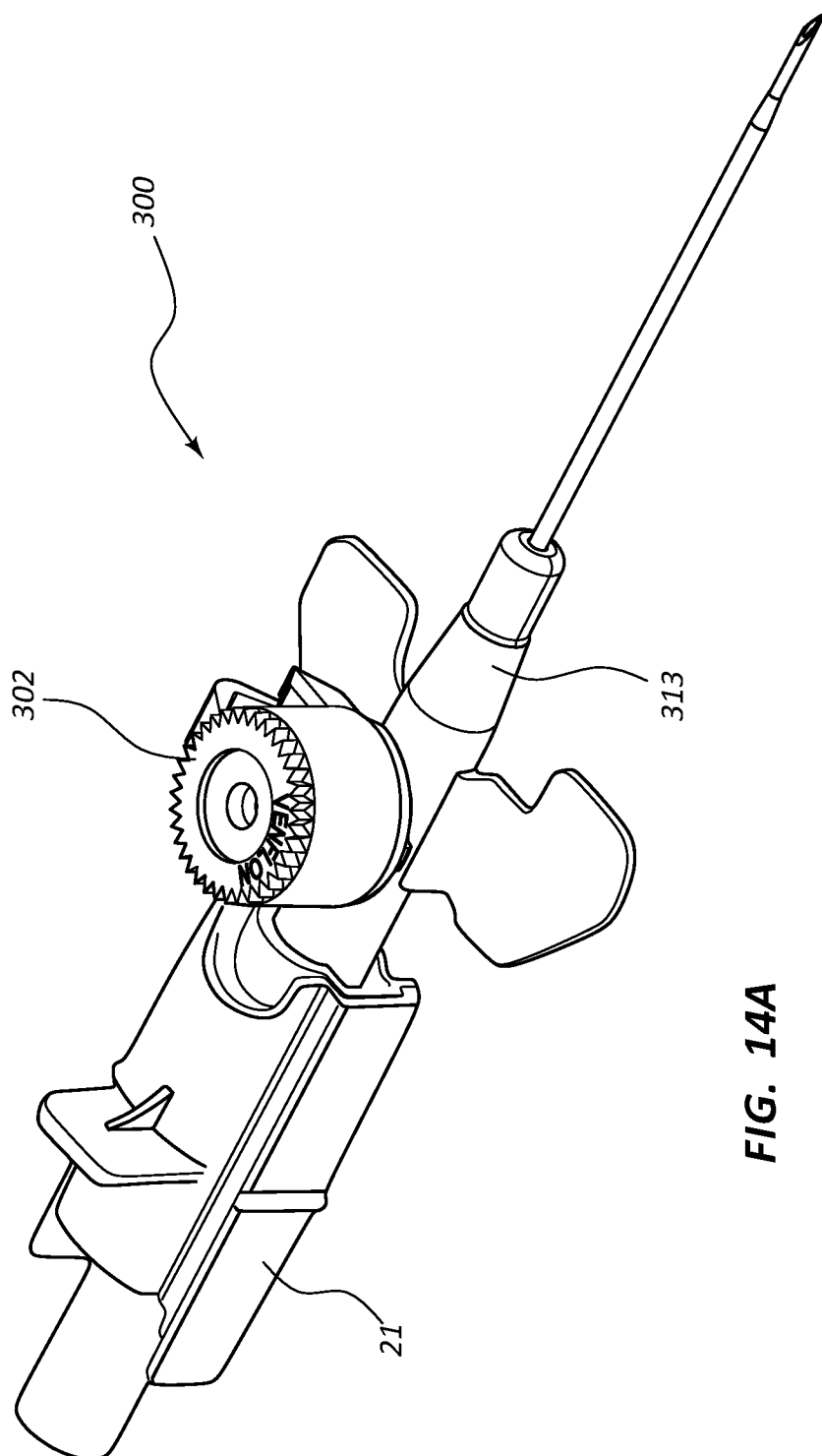
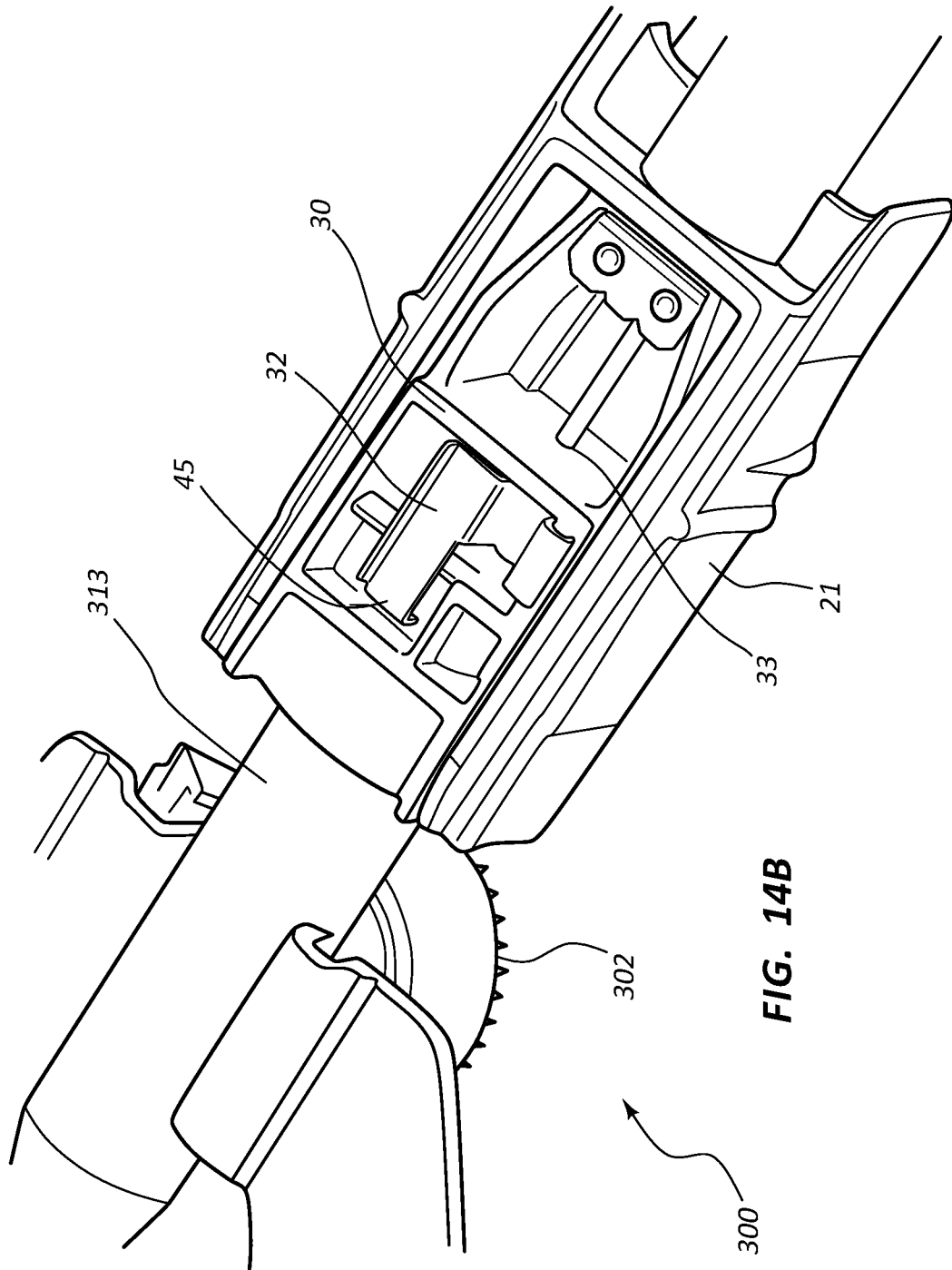

FIG. 14A



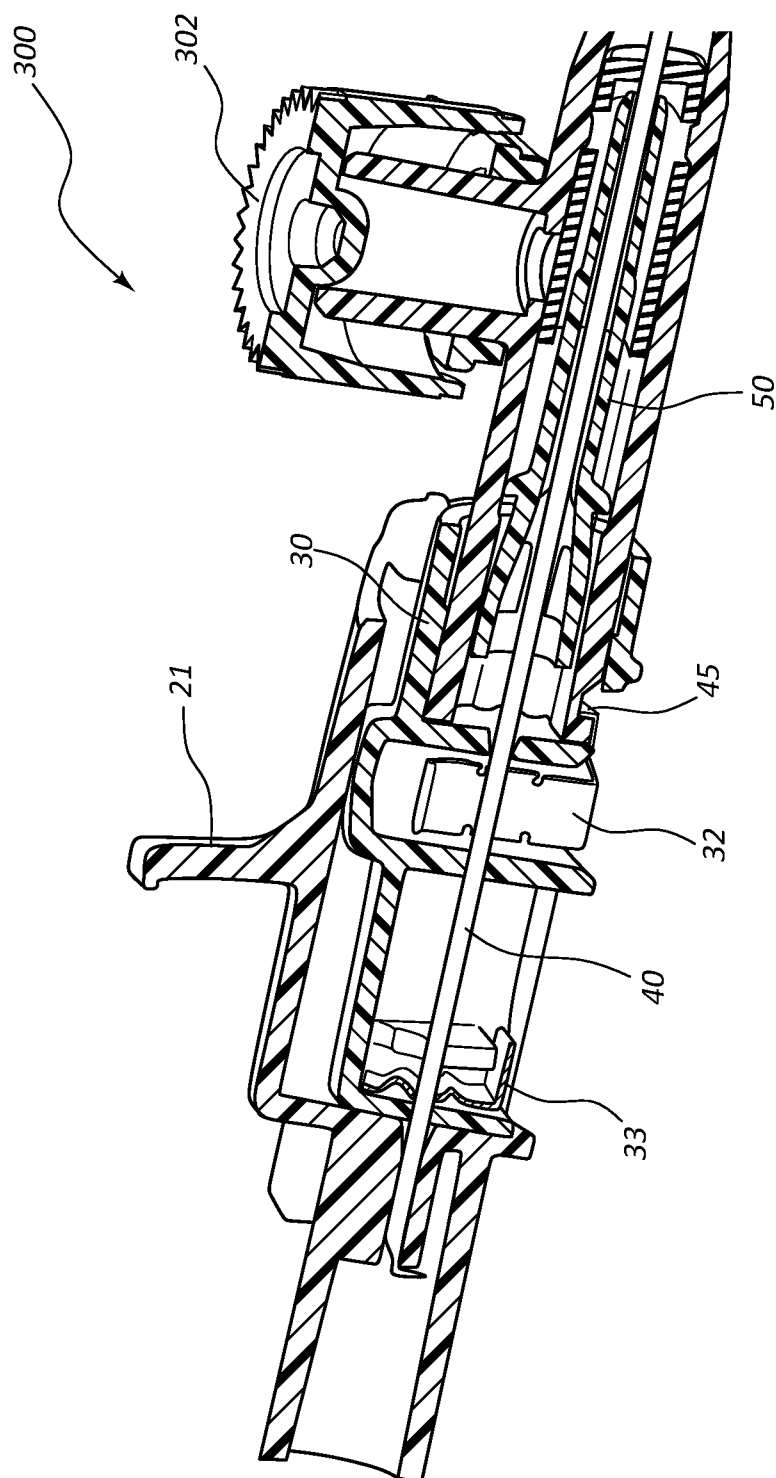
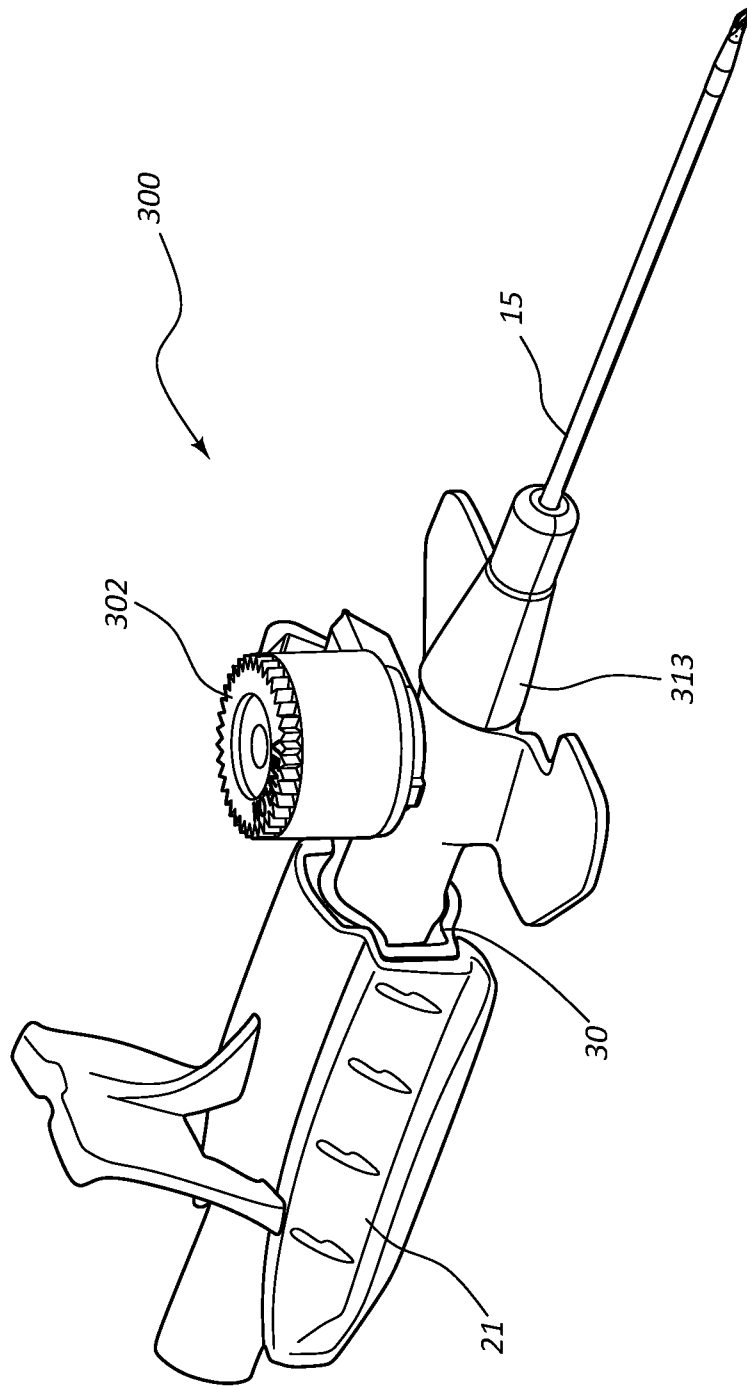
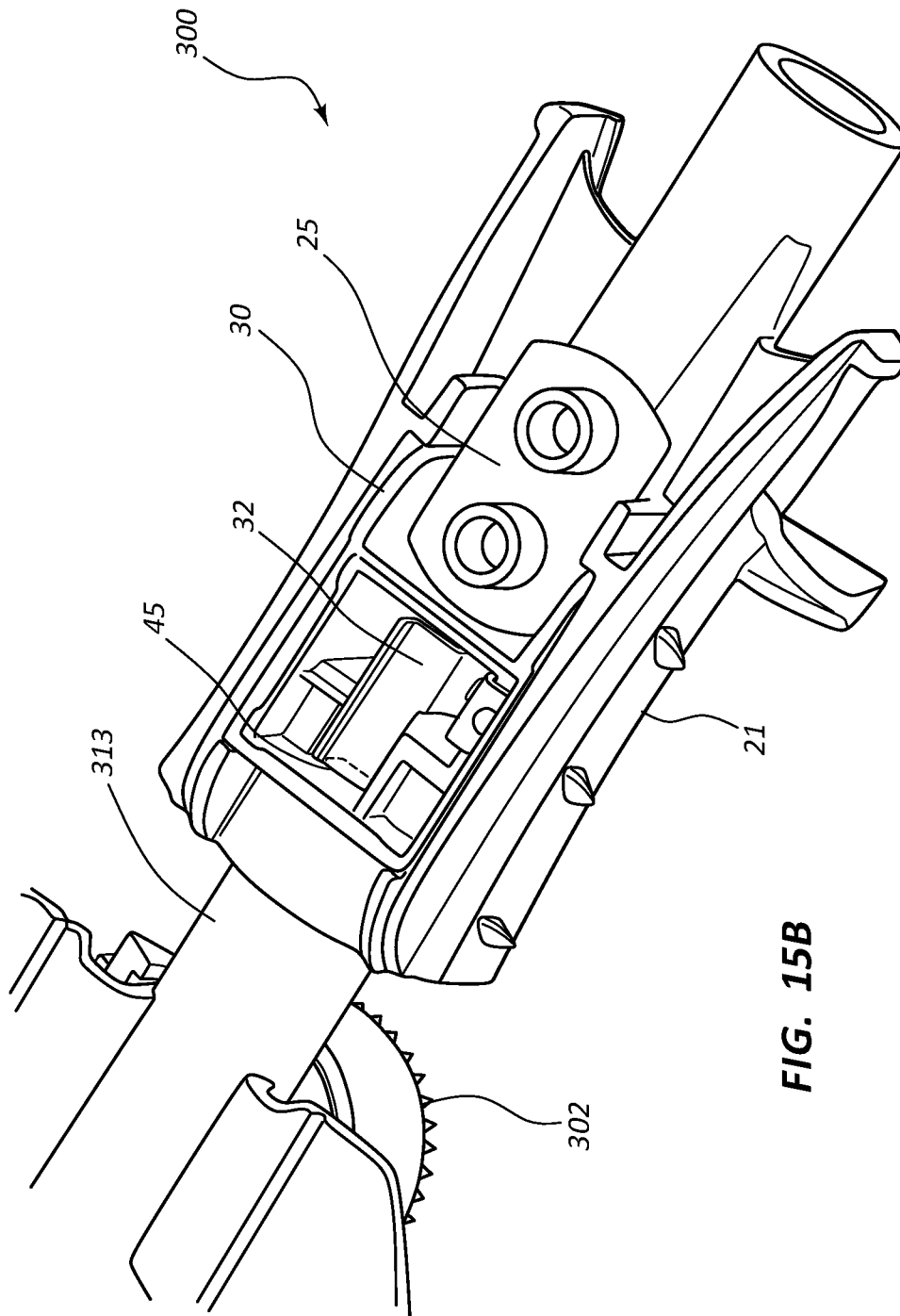
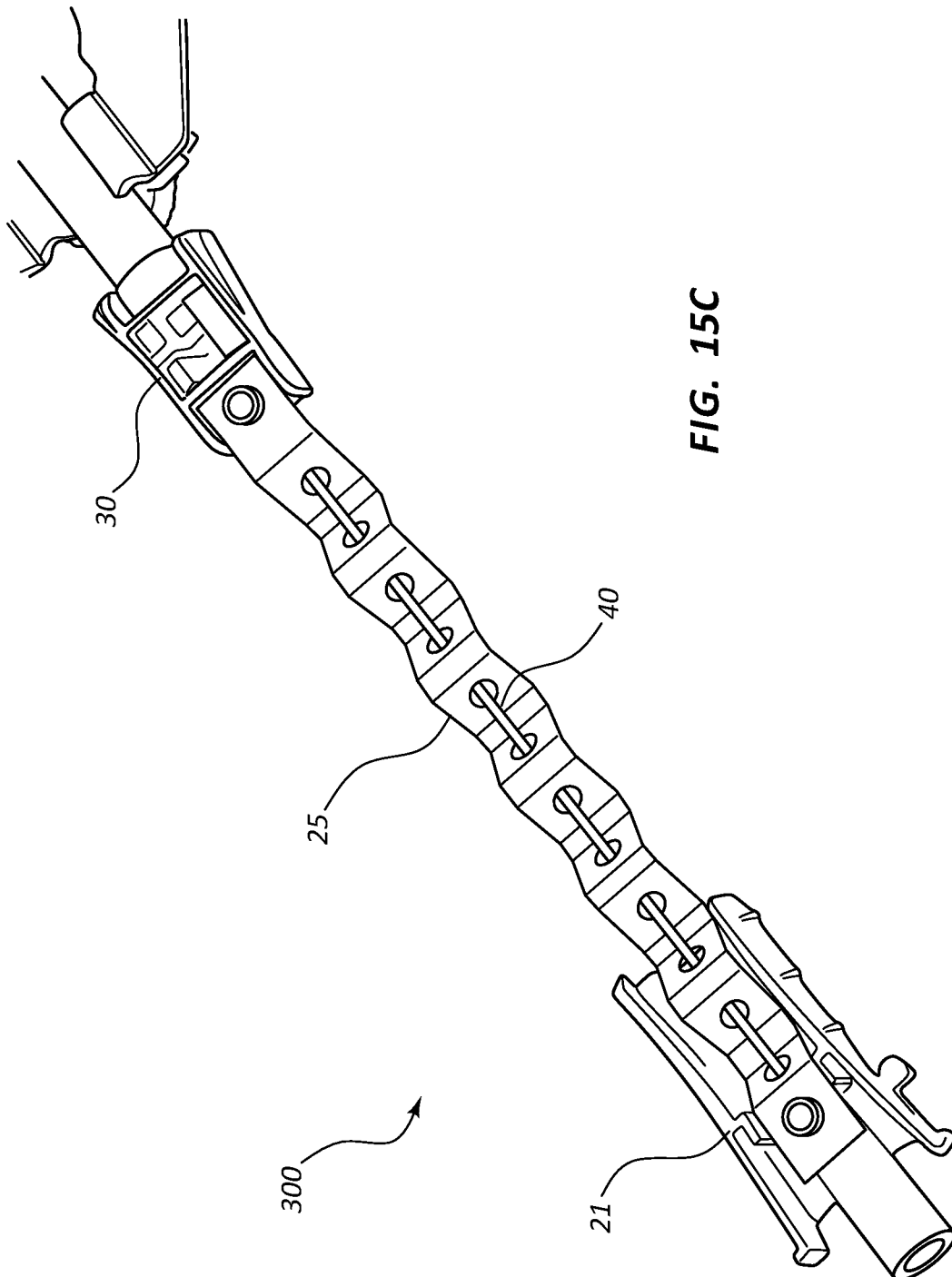
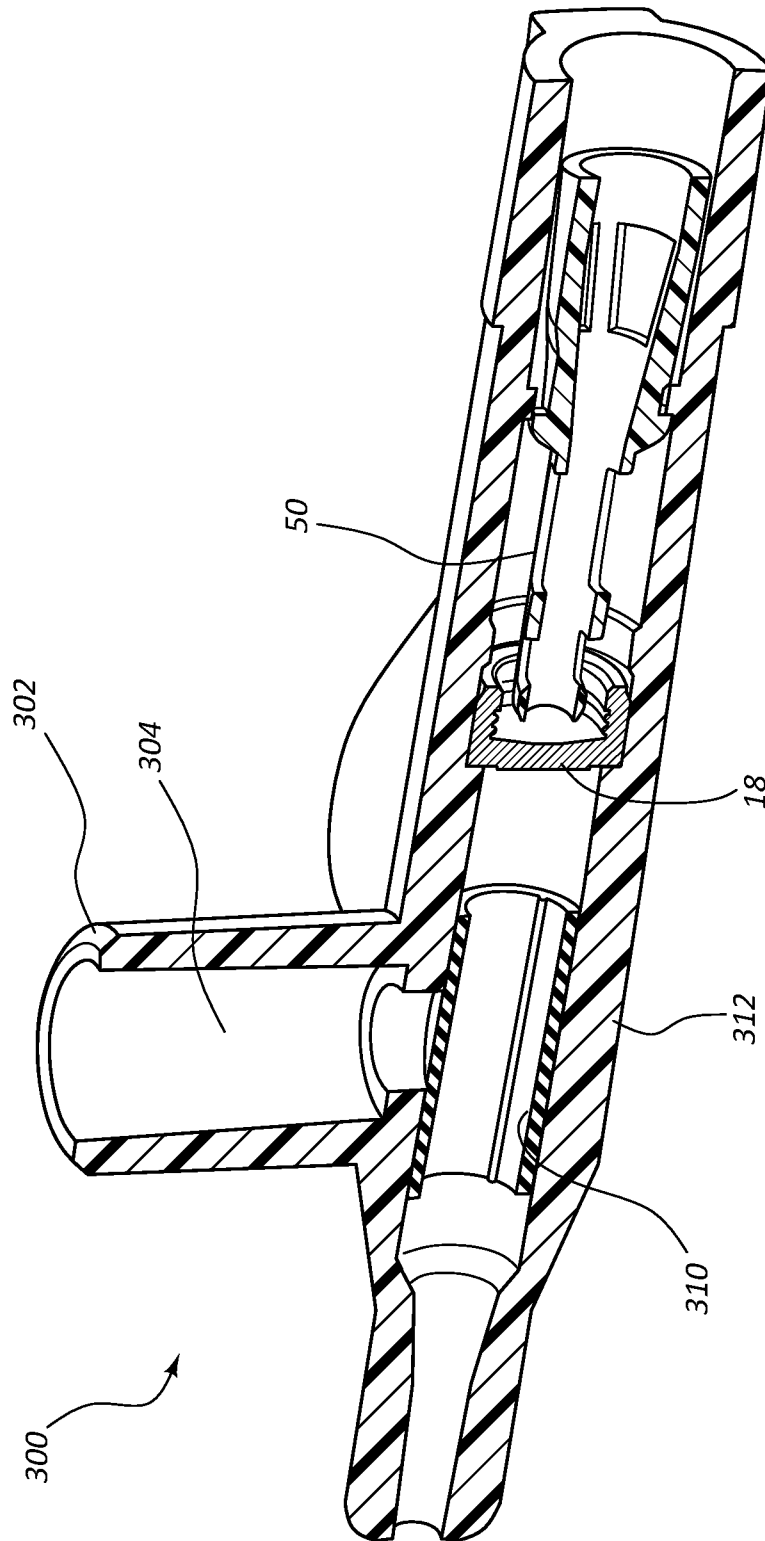

FIG. 14C

**FIG. 15A**

**FIG. 15B**



**FIG. 16**

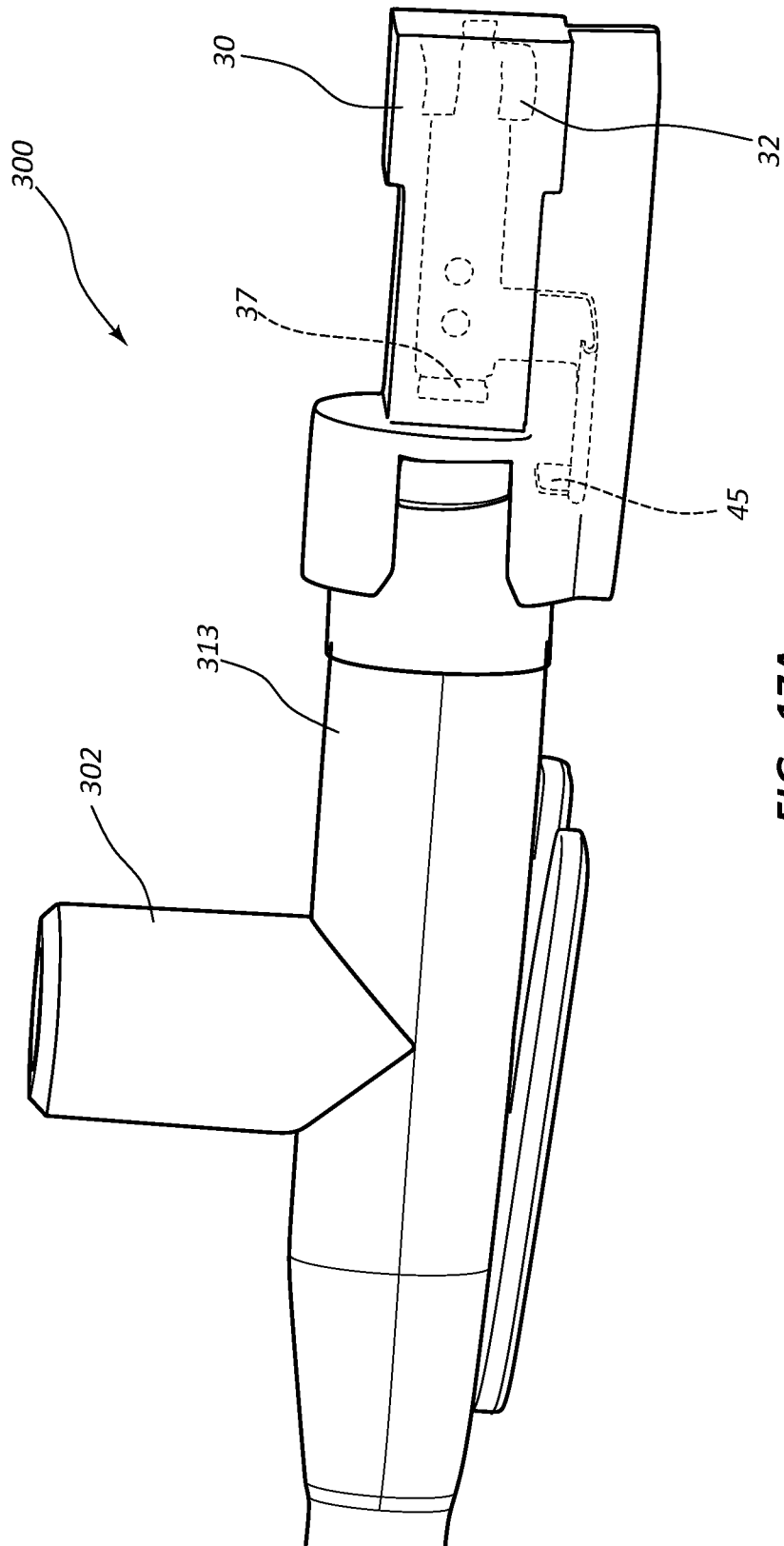

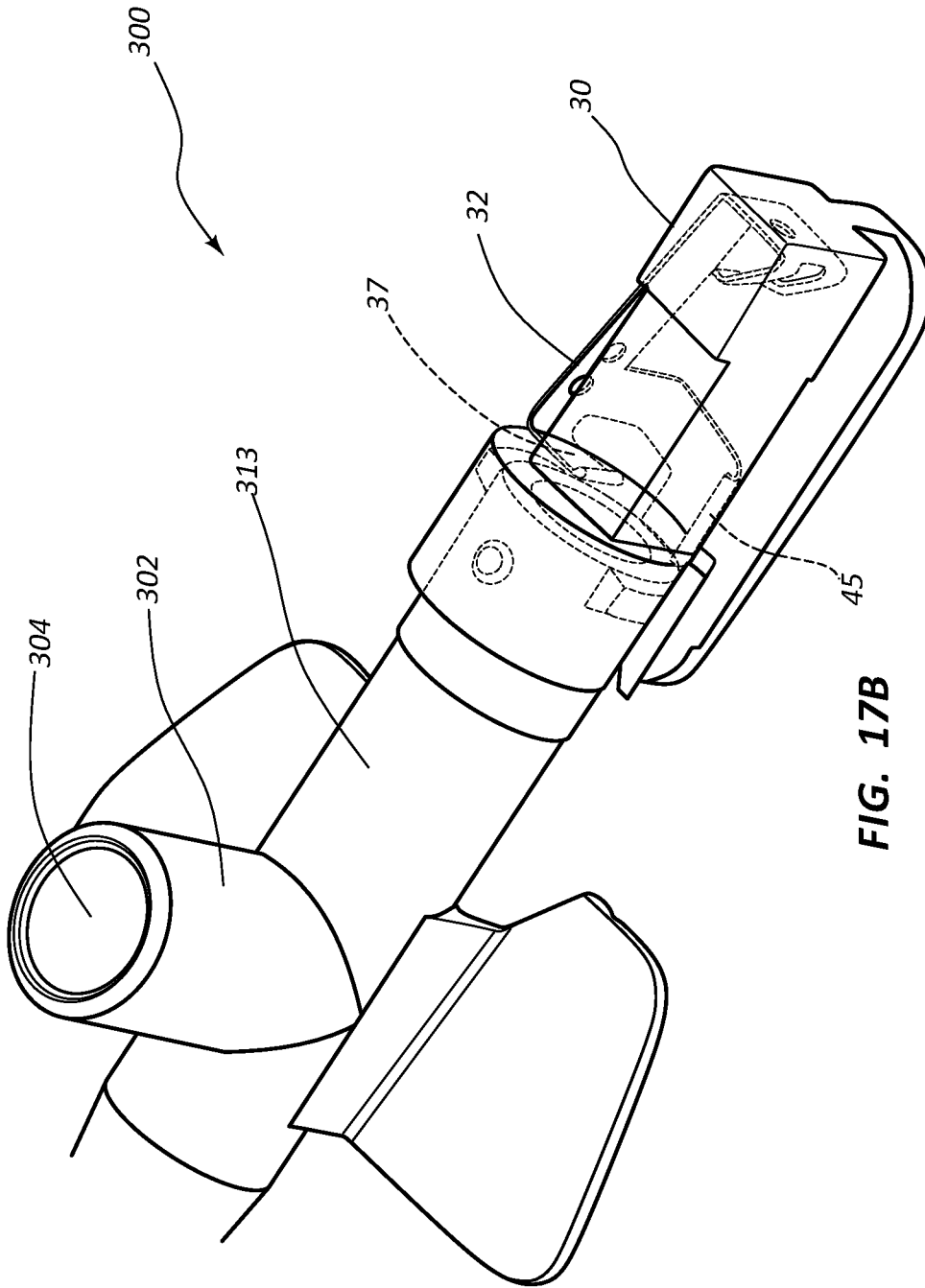
**FIG. 17B**

