

(12) STANDARD PATENT
(19) AUSTRALIAN PATENT OFFICE

(11) Application No. **AU 2004311459 B2**

(54) Title
Ultrasound therapy head with movement control

(51) International Patent Classification(s)
A61B 19/00 (2006.01) **A61N 7/02** (2006.01)
A61H 1/02 (2006.01)

(21) Application No: **2004311459** (22) Date of Filing: **2004.12.29**

(87) WIPO No: **WO05/065409**

(30) Priority Data

(31) Number (32) Date (33) Country
60/534,036 **2003.12.30** **US**

(43) Publication Date: **2005.07.21**

(44) Accepted Journal Date: **2011.07.14**

(71) Applicant(s)
Medicis Technologies Corporation

(72) Inventor(s)
Desilets, Charles S.;Quistgaard, Jens U.;Etchells, Tim;Darlington, Gregory Paul

(74) Agent / Attorney
Spruson & Ferguson, Level 35 St Martins Tower 31 Market Street, Sydney, NSW, 2000

(56) Related Art
US 4567895
US 6419648
US 5419327
AU 2003284096

(12) INTERNATIONAL APPLICATION PUBLISHED UNDER THE PATENT COOPERATION TREATY (PCT)

(19) World Intellectual Property Organization
International Bureau



(43) International Publication Date
21 July 2005 (21.07.2005)

PCT

(10) International Publication Number
WO 2005/065409 A3

(51) International Patent Classification⁷: **A61H 1/00**,
1/02, 5/00

(21) International Application Number:
PCT/US2004/044046

(22) International Filing Date:
29 December 2004 (29.12.2004)

(25) Filing Language: English

(26) Publication Language: English

(30) Priority Data:
60/534,036 30 December 2003 (30.12.2003) US

(71) Applicant (for all designated States except US): **LI-
POSONIX, INC.** [US/US]; 19021 120th Avenue NE,
Suite 101, Bothell, Washington 98011 (US).

(72) Inventors; and

(75) Inventors/Applicants (for US only): **QUISTGAARD,
Jens, U.** [US/US]; 4716 NE 187th Place, Seattle, Washing-
ton 98155 (US). **ETCHELLS, Tim** [GB/US]; 424 240th
Street, S.E., Bothell, Washington 98021 (US). **DAR-
LINGTON, Gregory, Paul** [US/US]; 7713 Interurban

Boulevard, Snohomish, Washington 98296-5332 (US).
DESILETS, Charles, S. [US/US]; 530 Dayton Street,
#202, Edmonds, Washington 98020 (US).

(74) Agents: **HESLIN, James, M.** et al.; TOWNSEND AND
TOWNSEND AND CREW LLP, Two Embarcadero Center,
8th Floor, San Francisco, California 94111-3834 (US).

(81) Designated States (unless otherwise indicated, for every
kind of national protection available): AE, AG, AL, AM,
AT, AU, AZ, BA, BB, BG, BR, BW, BY, BZ, CA, CH, CN,
CO, CR, CU, CZ, DE, DK, DM, DZ, EC, EE, EG, ES, FI,
GB, GD, GE, GH, GM, HR, HU, ID, IL, IN, IS, JP, KE,
KG, KP, KR, KZ, LC, LK, LR, LS, LT, LU, LV, MA, MD,
MG, MK, MN, MW, MX, MZ, NA, NI, NO, NZ, OM, PG,
PH, PL, PT, RO, RU, SC, SD, SE, SG, SK, SL, SM, SY,
TJ, TM, TN, TR, TT, TZ, UA, UG, US, UZ, VC, VN, YU,
ZA, ZM, ZW.

(84) Designated States (unless otherwise indicated, for every
kind of regional protection available): ARIPO (BW, GH,
GM, KE, LS, MW, MZ, NA, SD, SL, SZ, TZ, UG, ZM,
ZW), Eurasian (AM, AZ, BY, KG, KZ, MD, RU, TJ, TM),

[Continued on next page]

(54) Title: ULTRASOUND THERAPY HEAD WITH MOVEMENT CONTROL

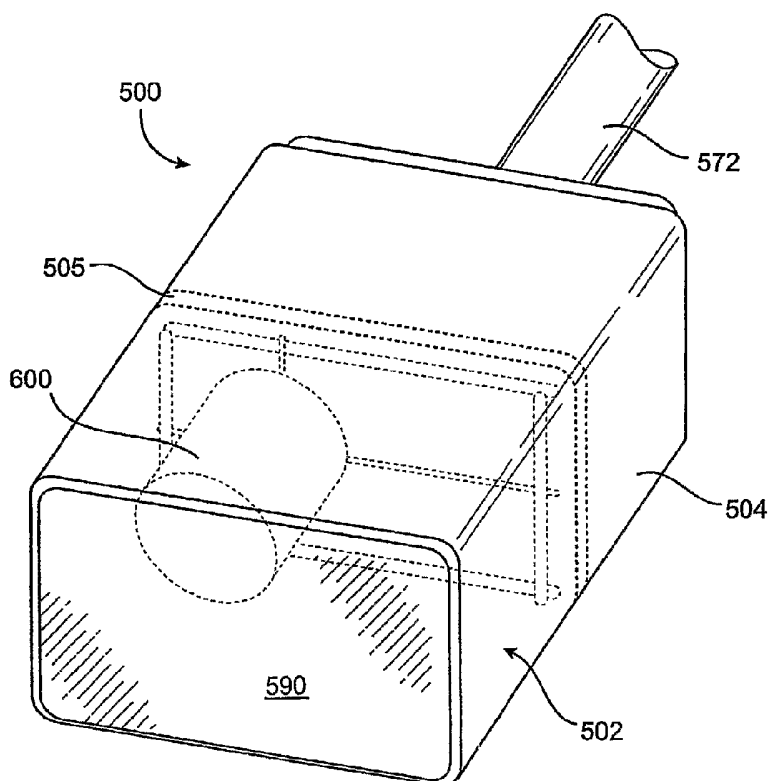

(57) Abstract: A therapy head for use in HIFU procedures is described. The therapy head has an enclosure with a window, an energy applicator and a means of moving the energy applicator within the enclosure. The therapy head uses motors and actuators to move the energy applicator, usually an ultrasound transducer, inside the enclosure. A controller is provided either internally or externally that allows the therapy head to identify and distinguish locations where the therapy head should be to radiate energy into a patient. The controller uses the motors and actuators to move the energy applicator into the desired locations.

WO 2005/065409 A3



European (AT, BE, BG, CH, CY, CZ, DE, DK, EE, ES, FI, FR, GB, GR, HU, IE, IS, IT, LT, LU, MC, NL, PL, PT, RO, SE, SI, SK, TR), OAPI (BF, BJ, CF, CG, CI, CM, GA, GN, GQ, GW, ML, MR, NE, SN, TD, TG).

Published:

- *with international search report*
- *before the expiration of the time limit for amending the claims and to be republished in the event of receipt of amendments*

(88) Date of publication of the international search report:

20 April 2006

For two-letter codes and other abbreviations, refer to the "Guidance Notes on Codes and Abbreviations" appearing at the beginning of each regular issue of the PCT Gazette.

ULTRASOUND THERAPY HEAD WITH MOVEMENT CONTROL

CROSS-REFERENCES TO RELATED APPLICATIONS

[0001] This application claims the benefit of provisional application no. 60/534,036 (Attorney Docket No. 021356-001100US), filed on December 30, 2003, the full disclosure of which is incorporated herein by reference.

[0002] The subject matter of the present application is related to that of the following applications: 10/750,370, entitled "Medical Device Inline Degasser" (Attorney Docket No. 02356-000500US); 10/751,344, entitled "Articulating Arm for Medical Procedures" (Attorney Docket No. 02356-000600US); 10/750,369, entitled "Disposable Transducer Seal" (Attorney Docket No. 02356-000700US); 60/533,528, entitled "Position Tracking Device" (Attorney Docket No. 021356-000900US); 60/533,988, entitled "Method for Planning and Performing Ultrasound Therapy" (Attorney Docket No. 021356-001000US); 60/533,958, entitled "Systems and Methods for the Destruction of Adipose Tissue" (Attorney Docket No. 021356-001200US); 60/534,034, entitled "Component Ultrasound Transducer" (Attorney Docket No. 021356-001300US); the full disclosure of each of these applications are incorporated herein by reference.

BACKGROUND OF THE INVENTION

[0003] 1. Field of the Invention. The present invention relates to a handheld medical device for delivering energy in precise locations into the human body. The device is principally for non-invasive therapies.

[0004] 2. Background of the present invention. A general problem in the application of high intensity focused ultrasound (HIFU) for therapeutic purposes is that it is often necessary to hold the therapeutic means stationary for some significant amount of time over the tissue to be treated. Alternatively, it may be necessary to scan the therapy beam at a slow, constant rate through the tissue to be treated. Both of these requirements present a barrier to a handheld therapeutic device, as it is often difficult or impossible for a person to either hold the device steady, or to scan at an acceptably slow and steady rate for the desired therapeutic effect.

2004311459 15 Jun 2011

[0005] A HIFU procedure may require that the ultrasound beam be scanned over the treatment volume at a constant rate (e.g. 5mm/sec +/- 1mm/sec) to achieve the desired therapeutic effect. Additionally, the treatment volume must be scanned so that there is never more than a 2mm spacing between adjacent focal lines of treatment. These requirements are beyond the capabilities of human beings. The solution in the past has been to incorporate a computer controlled motion device rigidly mounted to something that is stationary with respect to the patient (e.g. the floor, wall or bed). Such a device is either absolutely stationary, or is able to scan at a precise rate in a precise pattern without any human intervention. Such an arrangement has the disadvantages of size and bulk, complexity and reliability of the overall device.

[0006] Thus there remains a need in the art for a HIFU applicator that can be easily manipulated by a user while still providing reliable and uniform treatment.

[0007] There is also a need for a HIFU transducer that can keep track of the tissue volumes treated so as to prevent re-treatment of those same volumes.

[0008] There is still further a need for a therapy device that can assist the operator in identifying regions of tissue to be treated.

[0009] It is desirable to provide for a therapy head usable in HIFU procedures that can be easily manipulated and provide reliable and uniform treatment.

[0010] It is also desirable to track tissue in a library or map of the tissue to be treated.

[0011] It is also desirable to provide a means for alerting a physician to any problems or difficulties associated with a procedure using a HIFU generator of the present invention.

[0012] It is the object of the present invention to substantially overcome or at least ameliorate one or more of the prior art disadvantages or at least provide a useful alternative.

[0012A] In one aspect the present invention provides a therapy head comprising:
an enclosure having a window, said enclosure adapted to be manipulated by hand;

2a

at least one directional energy applicator suspended within said enclosure; and
a positioner for maneuvering the energy applicator within said enclosure, the
positioner including at least one motor and at least one actuator mechanically engaged to
said energy applicator, wherein the positioner maneuvers the energy applicator to emit
radiant energy through the window in order to deliver a precise energy dosage to patient
tissue adjacent the window, and wherein the positioner is adapted to maneuver the energy
applicator along a first axis and along a second axis perpendicular to the first axis.

[0012B] In another aspect the present invention provides a method of delivering
ultrasound energy to a body surface, said method comprising:

engaging a hand held enclosure against a body surface;
positioning the enclosure manually over one location on the body surface; and
controlling the movement of an energy applicator within the hand held enclosure
while the enclosure remains stationary relative to the body surface,

wherein controlling the movement of the energy applicator comprises controlling
the energy applicator along a first axis and along a second axis perpendicular to the first
axis.

[0013] Preferably the energy applicator is an ultrasound transducer however a variety of
other energy applicator may be used in combination with an ultrasound transducer.

[0014] The means for maneuvering the energy applicator preferably includes a means for determining the position of the energy applicator within the enclosure.

BRIEF DESCRIPTION OF THE DRAWINGS

[0015] Figure 1 illustrates a therapy head.

5 [0016] Figure 2 shows a therapy head on an articulating arm with external control elements.

[0017] Figures 3A-3B show internal views of actuators and motors in the therapy head.

[0018] Figure 4 provides a schematic of the elements of the present invention.

DETAILED DESCRIPTION OF THE INVENTION

10 [0019] Described herein is a device for use primarily in high intensity ultrasound procedures. A therapy head is disclosed having an enclosure with a window. The enclosure contains one or more energy applicators, and a means of moving the energy applicators within the enclosure. The energy applicators are positioned so the radiant energy passes through the window to a patient.

15 [0020] The enclosure is preferably small enough to be manipulated by hand. It can be operated by itself with a physician carrying the load of the therapy head, or it can be supported by an articulating arm or other mechanical device. The enclosure has a window that is oriented toward a patient. The window may be made from any material so long as it is essentially transparent to the energy applicator. The window may be incorporated into the
20 enclosure, or it may be a removable device. If the window is a removable device, then the window will cover an access port through which the interior components of the enclosure may be accessed. The window may also be a disposable device, such as a disposable transducer seal.

[0021] Within the enclosure is at least one energy applicator. Preferably this energy
25 applicator is an ultrasound transducer. More preferably the ultrasound transducer is a high intensity focused ultrasound transducer. However the transducer may be a component transducer assembly, or a device that incorporates multiple energy applicators, some of which may not be ultrasound transducers.

[0022] There is a means for maneuvering the energy applicator within the enclosure. The means for maneuvering the energy applicator requires two components. A first component is one or more actuators. The energy applicator is attached to the actuators. The attachment may be a slidable engagement, rotational engagement or through a series of traveler rods. The
5 actuators are driven by a force generating device, like an electric motor or the equivalent. Electric motors are preferred for their small size and reliability. One or more position sensing devices, such as rotational or optical encoders, are built into either the motor assembly, or the actuators, so the movement of the energy applicator within the enclosure is known. Alternatively the energy applicator may also contain a miniature location device (e.g. like
10 mini-GPS system) that an external sensor can identify to determine the location of the energy applicator within the enclosure.

[0023] The second component of the maneuvering means is a driver or controller. The driver or controller directs the movement of the motors, and thus the movement of the actuators and the maneuvering of the energy applicator. The controller may be a medical
15 appliance, a computer, or a specialized medical procedure controller. The controller may be positioned within the enclosure, or it may be a device outside the enclosure providing signal to the motors.

[0024] In operation, the controller has a library of data used to coordinate the movement of the energy applicator and the dosage of the radiant energy into the patient. By controlling the
20 movement of the energy applicator while radiant energy is emitted through the window, a precise energy dosage may be delivered into the patient. The controller can be programmed with the parameters needed to perform the task. Parameters may include the type of therapy to be administered and the maximum safe dosage that may be applied to a patient for a given area, volume or mass of tissue.

25 [0025] Once the therapy head has been completely prepared for a procedure, a physician can place the therapy head on a patient. The therapy head can move the energy applicator within the enclosure to treat the patient according to the procedure parameters programmed into the controller. If the procedure area is small, then the controller can move and activate the energy emitter without any additional input from a user.

30 [0026] If the treatment area exceeds the window of the enclosure, or exceeds the range of motion of the energy applicator within the enclosure, the therapy head must be moved to cover as much area as needed. Movement of the therapy head can be done manually, or

through a mechanical device. Data from the encoders is relayed to the controller so that the controller can identify the position of the energy applicator within the confines of the enclosure. This position information can be combined with a Position Tracking Device (Co-pending application, serial number unassigned), and an Articulating Arm (Co-pending application, serial number un-assigned). The controller can utilize position data from the present invention, combined with the data derived from the two aforementioned co-pending applications, to produce precise position data for the energy applicator with respect to the enclosure, the patient and a fixed external reference point. During the procedure if the controller reads the position or motion information from the encoders and other sensors and determines the energy applicator is not in the proper position, the controller can use the means for maneuvering the applicator, to correct the energy applicator's position.

[0027] Similarly the controller can identify the dosage of energy delivered with great precision to any particular area. The controller can track the amount of energy transmitted into the patient through out the treatment area and can cause the energy applicator to radiate or not radiate depending on the amount of energy already deposited into the patient at the particular place in the procedure.

[0028] Turning now to the drawings, in Figure 1 there is a therapy head 50 having an energy applicator 600 within an enclosure 500. The enclosure has a window 590 for allowing radiant energy to pass from the enclosure to a patient. The therapy head 50 is preferably small and light enough for a physician to move it comfortably with one hand. The therapy head 50 may increase in both size and weight if the physician is assisted by an articulating arm 200 in bearing the weight of the therapy head 50. There is a data link 572 extending between the therapy head 50 and an external computer 400 or a therapy controller 450.

[0029] The therapy head 50 may be mounted (Fig. 2) on an articulated arm 200 supported by a base 100. The articulating arm 200 would also have its movements and functions monitored or controlled by a computer 400 or therapy controller 450.

[0030] The enclosure 500 contains motor drives 508, 510 for moving the energy applicator 600 within the enclosure (Fig. 3A). The motor drives are connected directly, or through a gear assembly, to a pair of traveler rods 520, 528. The traveler rods in turn move a pair of slotted actuators 520', 528'. The slotted actuators travel along the traveler rods carrying the energy applicator at the intersection of the two slotted actuators. As the traveler rods rotate in response to movement from the motors, the slotted actuators carry the energy applicator

throughout the range of motion of the slotted traveler rods. Rotational encoders 530 are positioned on the traveler rods 520, 528 so that the movement of the energy applicator can be accurately measured.

[0031] Alternatively, the motor drives 508, 510 can directly drive rotational actuators 514, 516 to move the energy applicator 600 within the enclosure (Fig 3B). In this embodiment there is no need for a gear mechanism. As the motor drives move the axis of the motor assemblies back and forth, the actuators 514, 516 move in direct correlation to the motors. The sensitivity of the positioning of the energy applicator can be controlled through the motor drives, or the actuators used in response to the energy applicator. Three motors (not shown) may also be used to drive three articulating arms.

[0032] Figure 4 illustrates a schematic of the present invention. The therapy head 50 is shown in cross section with a partition 504 separating an upper enclosure from a lower enclosure. The partition is water tight so that fluid in the lower partition does not seep into the upper enclosure. There are a pair of motor drive units 508, 510 within the upper enclosure. The motor drive units pass rotational energy to the energy applicator 600 through a series of mechanical actuators 514, 516, 518. The actuators extend through the water tight partition 504 and are themselves water resistant. An acoustic window 590 is displaced at the bottom of the enclosure.

The claims defining the invention are as follows:

1. A therapy head comprising:
an enclosure having a window, said enclosure adapted to be manipulated by hand;
at least one directional energy applicator suspended within said enclosure; and
a positioner for maneuvering the energy applicator within said enclosure, the positioner including at least one motor and at least one actuator mechanically engaged to said energy applicator, wherein the positioner maneuvers the energy applicator to emit radiant energy through the window in order to deliver a precise energy dosage to patient tissue adjacent the window, and wherein the positioner is adapted to maneuver the energy applicator along a first axis and along a second axis perpendicular to the first axis.
2. The therapy head of claim 1, wherein said window is a transmissible window for said energy applicator.
3. The therapy head of claim 1, wherein said energy applicator is an ultrasound transducer.
4. The energy applicator of claim 3, wherein said ultrasound transducer is an imaging transducer.
5. The energy applicator of claim 3, wherein said ultrasound transducer is a high intensity focused ultrasound transducer.
6. The therapy head of claim 1, wherein the energy applicator is a component ultrasound transducer.
7. The therapy head of claim 1, wherein the positioner for maneuvering said energy applicator includes one or more position sensors.
8. The therapy head of claim 1, wherein said window is a disposable transducer seal.

2004311459 15 Jun 2011

9. The therapy head of claim 1, wherein the positioner comprises a plurality of actuators driven by one or more motors, wherein said energy applicator is moveably attached to said actuators.

10. The therapy head of claim 1, wherein said positioner further comprises a plurality of encoders for measuring movement within said enclosure.

11. The therapy head of claim 1, wherein said at least one motor is an electric motor.

12. The therapy head of claim 1, wherein said energy applicator is removable and interchangeable within the enclosure.

13. The therapy head of claim 1, wherein said positioner further comprises a plurality of encoders.

14. The therapy head of claim 1, wherein said enclosure further comprises a horizontal water tight partition defining an upper enclosure and a lower enclosure, said upper enclosure containing said positioner for maneuvering and said lower enclosure containing said energy applicator, said window being in said lower enclosure.

15. The therapy head of claim 14, further comprising a fluid circulation system for circulating a coupling fluid through said lower enclosure.

16. A method of delivering ultrasound energy to a body surface, said method comprising:
 engaging a hand held enclosure against a body surface;
 positioning the enclosure manually over one location on the body surface; and
 controlling the movement of an energy applicator within the hand held enclosure while the enclosure remains stationary relative to the body surface,
 wherein controlling the movement of the energy applicator comprises controlling the energy applicator along a first axis and along a second axis perpendicular to the first axis.

2004311459 15 Jun 2011

17. The method of claim 16, further comprising:
repositioning the enclosure manually to at least one additional location on the
body surface and controlling the movement of the energy applicator within the hand held
enclosure while the enclosure remains stationary relative to the body surface.

18. The therapy head of claim 1, wherein said positioner further comprises a
controller for controlling movement of the energy applicator within the enclosure.

19. A therapy head substantially as hereinbefore described with reference to
the accompanying drawings.

20. A method of delivering ultrasound energy to a body surface, the method
substantially as hereinbefore described with reference to the accompanying drawings.

Dated 15 June, 2011

Medicis Technologies Corporation

Patent Attorneys for the Applicant/Nominated Person

SPRUSON & FERGUSON

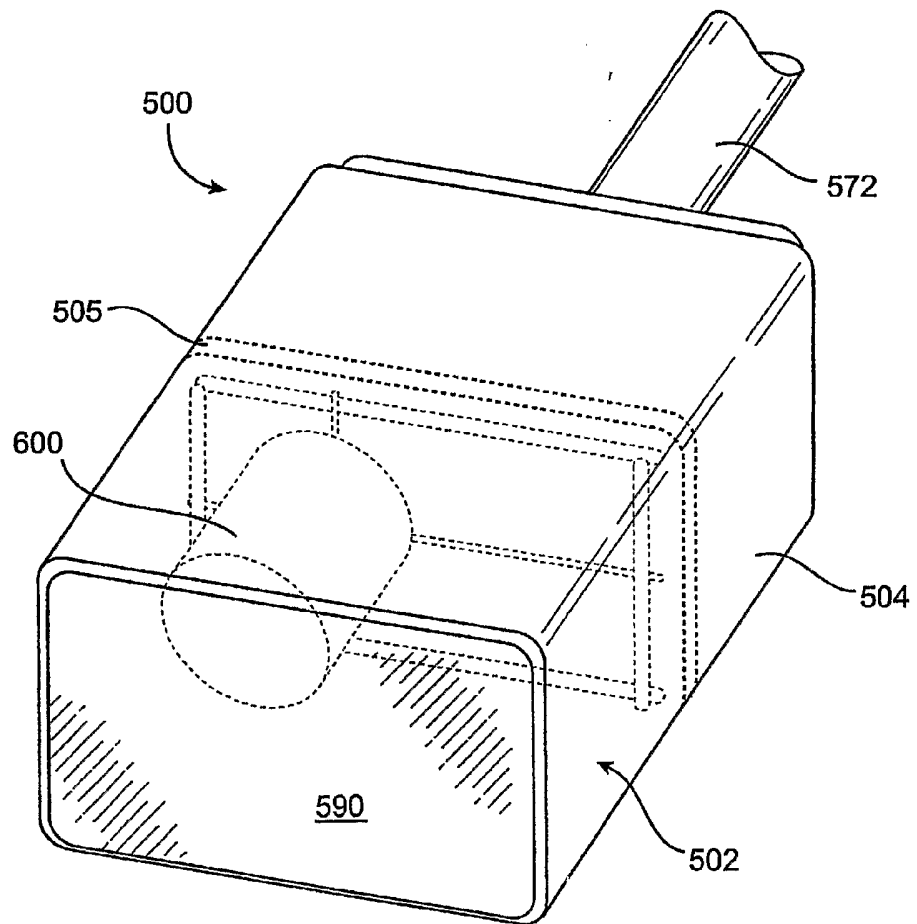

FIG. 1

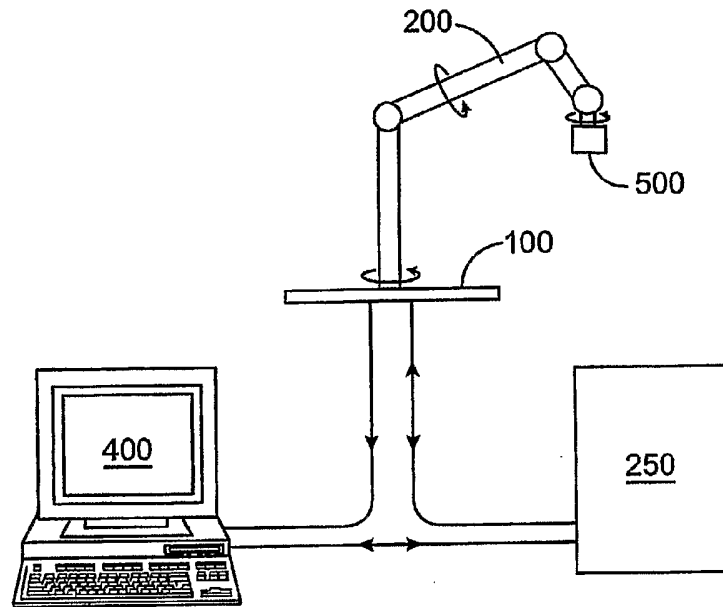

FIG. 2

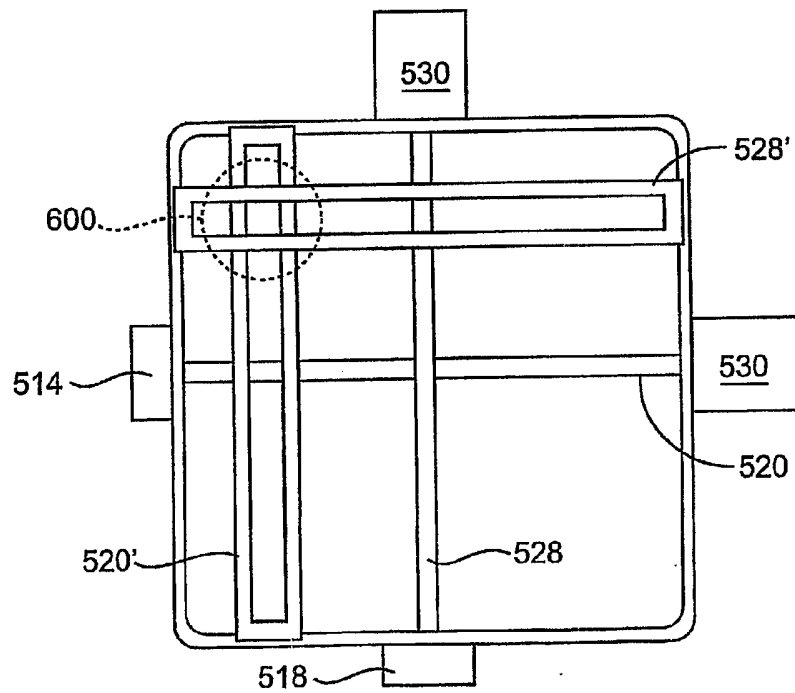

FIG. 3A

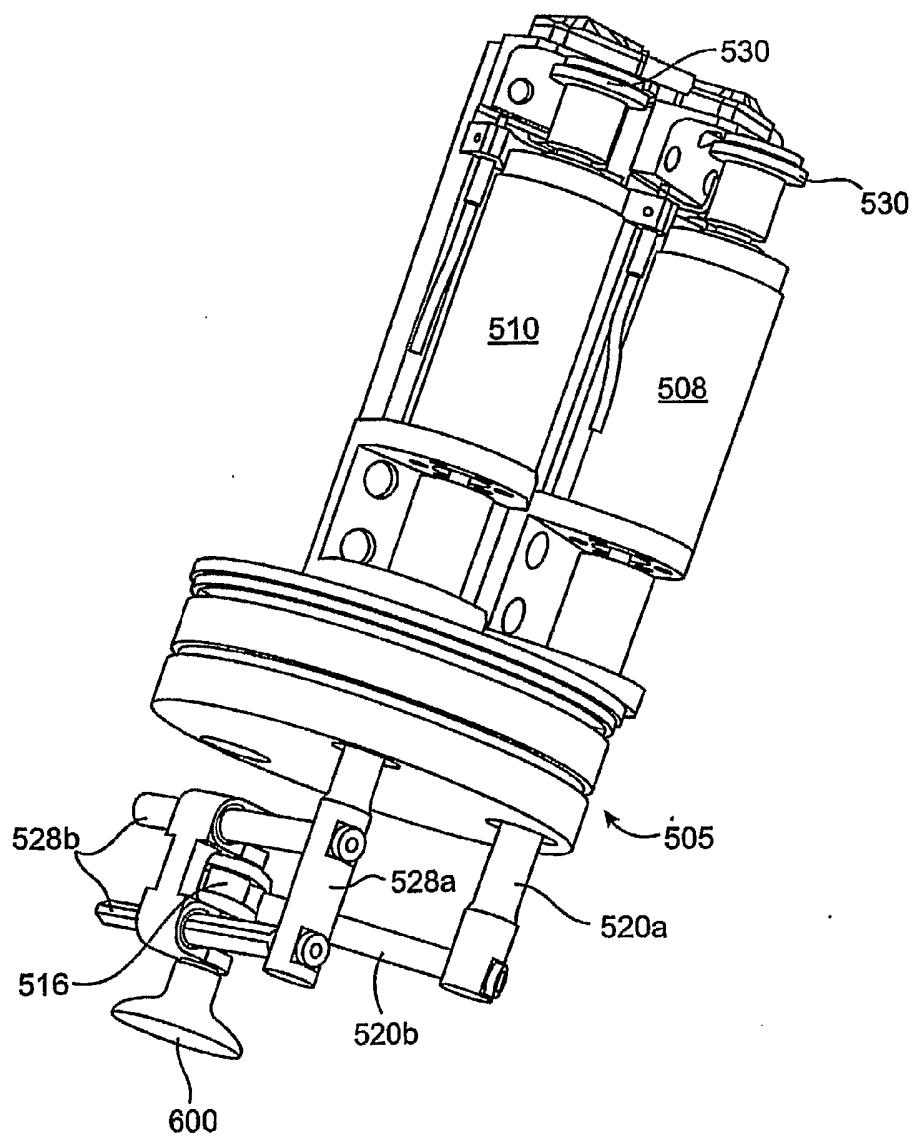

FIG. 3B

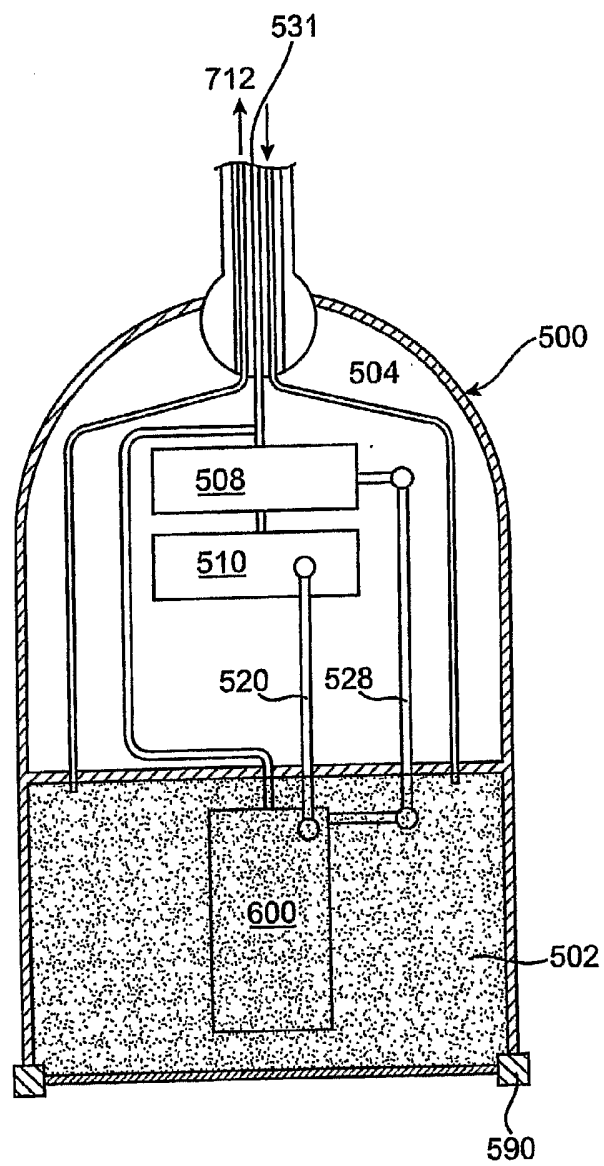

FIG. 4