

(19)



(11)

**EP 1 804 351 B1**

(12)

**EUROPEAN PATENT SPECIFICATION**

(45) Date of publication and mention of the grant of the patent:  
**09.09.2009 Bulletin 2009/37**

(51) Int Cl.:  
**H01T 13/06<sup>(2006.01)</sup> H01T 13/04<sup>(2006.01)</sup>**

(21) Application number: **06127000.5**

(22) Date of filing: **22.12.2006**

**(54) Plug cap attachment structure**

Anordnung zur Befestigung einer Zündkerzenkappe

Structure de fixation de capuchon d'une bougie d'allumage

(84) Designated Contracting States:  
**ES IT**

(30) Priority: **27.12.2005 JP 2005374794**

(43) Date of publication of application:  
**04.07.2007 Bulletin 2007/27**

(73) Proprietor: **HONDA MOTOR CO., LTD.**  
**Tokyo 107-8556 (JP)**

(72) Inventors:  
• **Nakatake, Junichi**  
**Wako-shi**  
**Saitama Saitama 351-0193 (JP)**

• **Tsuchiya, Ryuji**  
**Wako-shi**  
**Saitama Saitama 351-0193 (JP)**

(74) Representative: **Quinterno, Giuseppe et al**  
**Jacobacci & Partners S.p.A.**  
**Corso Emilia 8**  
**10152 Torino (IT)**

(56) References cited:  
**EP-A1- 0 470 938 EP-A2- 0 509 454**  
**EP-A2- 0 713 969 JP-A- 2002 151 231**  
**US-A1- 5 799 633**

**EP 1 804 351 B1**

Note: Within nine months of the publication of the mention of the grant of the European patent in the European Patent Bulletin, any person may give notice to the European Patent Office of opposition to that patent, in accordance with the Implementing Regulations. Notice of opposition shall not be deemed to have been filed until the opposition fee has been paid. (Art. 99(1) European Patent Convention).

## Description

**[0001]** The present invention relates to a plug cap attachment structure in an engine, and in particular to a plug cap attachment structure of the kind defined in the preamble of claim 1.

**[0002]** US-A1-5 799 633 discloses a plug cap attachment structure of this kind, comprising an outer seal seated over the outside edge of an outwardly protruding rim formed on the engine block, to seal the spark plug well.

**[0003]** It is an object of the present invention to provide a plug cap attachment structure capable of partially reducing the diameter of a plug cap while maintaining stability for holding the plug cap, and disposing an ignition plug at a position closer to an engine.

**[0004]** This and other objects are achieved according to the invention by a plug cap attachment structure having the features defined in claim 1.

**[0005]** The present invention is primarily characterized in that the constituent part of the engine is a cylinder head cover; the extension is a plate-like member which extends circumferentially outward of a cylindrical portion of the plug cap and is provided with a through-hole extending in a thickness direction; and the engaging member includes one engaging projection which projects from the cylinder head cover and passes through the through-hole and two engaging plates which are abutted or virtually abutted against two side end faces of the extension.

**[0006]** The present invention is secondarily characterized in that the plug cap is provided with a grip which is virtually located on a line extending along a longitudinal direction of the ignition plug so as to bend with respect to the longitudinal direction.

**[0007]** According to the primary aspect of the invention, the plate-like member with a through-hole is provided on the plug cap and the single engaging projection and the two engaging plate are provided on the cylinder head cover which is more easily molded than the cylinder head or the like. Only such provisions can suppress vibration of the plug cap, whereby the plug cap can be supported more stably.

**[0008]** According to the secondary aspect of the invention, the grip engaged with a tool, a finger or the like is provided on a line extending along the longitudinal direction of the ignition plug; therefore, the operation of pulling out the plug cap from the ignition plug can be facilitated.

**[0009]** A preferred embodiment of the present invention will be hereunder described in detail with reference to the drawings, in which:

Fig. 1 is a side view of a motorcycle comprising a plug cap attachment structure according to the present invention;

Fig. 2 is a cross-sectional view of an engine;

Fig. 3 is a perspective view of a cylinder head and a cylinder head cover;

Fig. 4 is a plan view of the cylinder head cover according to Fig. 3;

Fig. 5 is a front view of a plug cap;

Fig. 6 is a view as viewed from the direction of symbol A in Fig. 5;

Fig. 7a is a side view of the plug cap of Figs. 5 and 6; Fig. 7b is a cross-sectional view of the plug cap according to Fig. 7a;

Fig. 8 is a perspective view of a cylinder head and a cylinder head cover according to an embodiment of the present invention;

Fig. 9 is a plan view of the cylinder head cover according to the embodiment of the invention;

Fig. 10 is a perspective view of the cylinder head cover according to the embodiment of the invention;

Fig. 11 is a plan view of a plug cap according the embodiment of the invention;

Fig. 12 is a partial enlarged view of the plug cap according to the embodiment of the invention;

Fig. 13a is a side view of the plug cap according to the embodiment of the invention; and

Fig. 13b is a cross-sectional view of the plug cap according to the embodiment of the invention.

**[0010]** Fig. 1 is a side view of a motorcycle according to an embodiment of the invention. The motorcycle 1 is a scooter-type motorcycle including a unit-swing type power unit incorporating a continuously variable transmission. A pair of left and right main frames 8 are covered by a body cover 23 from the front of a vehicle body. A head pipe 4 together with gussets 6 as joint reinforcing members is fixedly joined to the main frames 8. A pair of left and right front forks 5 are turnably supported by the head pipe 4 and a front wheel WF is rotatably supported by the lower ends of the front forks 5. A stem shaft 2 is turnably supported in the cylindrical head pipe 4. The front forks 5 can be steered by handlebars 3 connected to the stem shaft 2. A pair of left and right handle grips 3a gripped by an operator are attached to the handlebars 3. A cross member 9 is attached vehicle-widthwise to the main frames 8 so as to connect left and right pipe members. A single center frame 7 is disposed on the rear side of the cross member 9 so as to be close to a leg shield 24 arranged forward of the legs of the operator. The center frame 7 is joined to a pair of left and right connection frames 13 at a lower portion of the vehicle body. These joints and the main frame 8 are connected by a pair of left and right pipe members 14. A guard pipe 15 for protecting a radiator 25 is disposed at a portion near the pipe members 14. The end of the connection frame 13 on the rear side of the vehicle body is joined to a side frame 10 formed integrally with the main frame 8.

**[0011]** A pair of left and right pivot plates 16 are each attached between a rising frame portion 11 formed integrally with the side frame 10 and a rear sub frame 18 joined to the rising frame portion 11. The pivot plates 16 turnably support a pivot shaft 17 for a power unit 22 described later. Seat rail portions 12 supporting a storage box 30 and a fuel tank 32 disposed below a seat 31 on which an occupant seats are joined to upper rear portions

of the rising frame portions 11. The power unit 22 including an engine 21, a carburetor 27 and an air cleaner box 26 is pivotally supported through the pivot shaft 20 by a link mechanism 19 turnably supported by the pivot shaft 17. The power unit 22 is suspended by rear cushions 28 attached to the seat rail portions 12 so that it can be swingable about the pivot shaft 17. A rear wheel WR as a drive wheel is rotatably supported by the rear end of the power unit 22.

**[0012]** Fig. 2 is a cross-sectional view of an engine 21. The four-cycle single cylinder engine 21 is of a rocker arm-used SOHC (single over head camshaft) type two-valve unit. Fig. 2 depicts only an upper portion of the engine including a crankshaft 40 housed in a crankcase 34. A continuously variable transmission is installed at an end of a crankshaft 40 as an output shaft 34 so as to transmit the power of the engine 21 to the rear wheel WR at an optional speed change ratio. The transmission includes a drive side movable pulley half 51, a drive side stationary pulley half 52 and an endless V-belt 50. A cylinder block 39 is fastened to the crankcase 34. A tubular piston 36 slidable inside a sleeve 38 fitted in the cylinder block 39 is connected to the crank shaft 40 via a connecting rod 37. A cylinder head 41 is fastened to the upper end of the cylinder block 39. The cylinder head 41, the cylinder block 39 and the piston 36 define a combustion chamber 42 in which an air-fuel mixture is burned. A cam shaft 44 is rotatably journaled by the cylinder head 41 so as to drive rocker arms 47 which open/close intake and exhaust valves (not shown in the figure). The cam shaft 44 and a cam sprocket 45 fixedly attached to one end thereof are drivingly rotated by an endless cam chain 46 connected to the crankshaft 40. A cylinder head cover 49 is disposed above the rocker arms 47 and the cam sprocket 45.

**[0013]** An ignition plug 43 adapted to ignite an air-fuel mixture compressed in the combustion chamber 42 is removably attached to the cylinder head 41. The ignition plug 43 is disposed so that its electrode 43a disposed at the tip thereof may face the combustion chamber 42. An insulator 43b and a terminal 43c are disposed adjacently to the outer wall of the cylinder head 41. A plug cap (not shown in the figure) is attached to the ignition plug 43 to insulation-protect a high voltage supply unit which applies high voltage required for ignition. Since this plug cap is configured to mostly cover the whole of the terminal 43c and the insulator 43b, if the outer diameter of this portion is large, it becomes difficult to dispose the ignition plug 43 at a position close to the center of the cylinder head 41. In other words, it becomes difficult to downsize an engine room and to bring the shape of the combustion chamber into an ideal hemisphere by reducing a tilt angle of the ignition plug 43 attached to the combustion chamber 42. In order to solve the problem, a plug cap attachment structure is applied to the plug cap attached to the plug 43 and the cylinder head cover 49.

**[0014]** Fig. 3 is a perspective view of the cylinder head 41 and the cylinder head cover 40 to which a plug cap

attachment structure is applied. Like reference numerals denote like or corresponding portions. The ignition plug 43 is arranged in a recessed portion 54 of the cylinder head 41 formed with an intake port 53. A plug hole (not shown in the figure) formed with an internal thread is provided in the bottom of the recessed portion 54. The internal thread is threadedly engaged with an external thread formed on the plug 43 so that the plug 43 is joined to the plug hole. A plug cap 60 is attached to the plug 43 so as to insulation-protect a joint between the terminal 43c (see Fig. 2) and a high-tension cord 65 used to supply electric power. The plug cap 60 is composed, as a single piece, of a cylindrical main body 64, an extension 63, a joint 61 with the high-tension cord 65, and a grip 62. The cylindrical main body 64 covers the insulation 43b and terminal 43c of the ignition plug 43. The extension 63 protrudes toward the circumferential outside of the main body 64. The grip 62 functions as a handle used when the plug cap 60 is removed from the ignition plug 43.

**[0015]** Attachment bolts 56, 57, 58 are attached to the cylinder head cover 49. An attachment bolt 56 is used to support a guide stay 55 adapted to dispose wiring cords and the like not shown at appropriate positions. The other attachment bolts 57, 58 are used to fixedly fasten the cylinder head cover 49 to the cylinder head 41. The cylinder head cover 49 is formed at its end with a ring-like engaging member 59 which is engaged with the extension 63 of the plug cap 60. The plug cap attachment structure is composed of the engaging member 59 formed on the cylinder head cover 49 and the plug cap 60 having the extension 63.

**[0016]** Fig. 4 is a plan view of the cylinder head cover 49. The engaging member 59 is formed of a thin plate integral with the cylinder head cover 49 at one end of the cylinder head cover 49 so as to define a support hole 59a adapted to support the extension 63. When the plug cap 60 is connected to the ignition plug 43, the engaging member 59 is engaged with the extension 63, whereby the plug cap 60 can stably be supported by the cylinder head cover 49. Incidentally, while the inner circumferential surface of the engaging member 59 is a smooth surface in this embodiment, the engaging member may be formed with a projection, groove or the like so as to be easily engaged with the extension 63. The cylinder head cover 49 is formed with through-holes 57a and 58a adapted to receive the attachment bolts 57 and 58, respectively, inserted therethrough.

**[0017]** Fig. 5 is a front view of the plug cap 60. Like reference numerals denote like or corresponding portions. As described above, the plug cap 60 of the embodiment is formed with the extension 63 as a plate member having a plurality of projections 63a. When the plug cap 60 is connected to the plug 43, the outer circumferential surface of the extension 63 is engaged with the inner circumferential surface of the engaging member 59. Thus, the plug cap 60 is supported at two points by the main body 64 and the extension 63 on the engine side; therefore, it can be more stably supported than by

the conventional method in which the plug cap is supported by only the main body 64. In the present embodiment, the outer diameter of the main body 64 can be made smaller than that of the conventional method correspondingly to the stability enhanced by the two-point support. The grip 62 formed near the joint 61 is bent at an angle of about 90 degrees with respect to the main body 64 so as to make it easy to pull the plug cap with a tool, a finger or the like engaged therewith. Since the extension 63 is almost elliptical and the engaging member 59 is formed to correspond thereto, when the extension 63 is engaged with the engaging member 59, the engagement position is established in a stable manner.

**[0018]** Fig. 6 is a view as viewed from the direction of symbol A in Fig. 5. Like reference numerals denote like or corresponding portions. The extension 63 is formed to have a thickness-wise dimension equal approximately to the height of the engaging member 59 of the cylinder head cover 49. The extension 63 is formed such that its diameter on the side of the connection 61 is greater than that on the side of the main body 64. On the other hand, the engaging member 59 is formed in a conical shape corresponding to the shape of the extension 63 mentioned above. Thus, when engaged with the engaging member 59, the extension 63 can stably be held in position. Incidentally, the plurality of projections 63a serves to make it easier to establish the engaging position by being brought into contact with the internal circumferential surface of the engaging member 59 at a plurality of lines. In addition, the projections 63a serve to make it hard for vibration of the engine to be transmitted to the main body 64. Although the projections 63a are formed half-columnar as depicted in the figure, they may be formed like triangular prisms or the number of the projections may optionally be selected. The extension 63 may be configured, without the projections 63a, such that the entire circumferential surface of the extension 63 comes into engagement with the inner circumferential surface of the engaging member 59. Alternatively, the extension 63 may be formed with a plurality of recesses.

**[0019]** Fig. 7a is a side view of the plug cap 60. Like reference numerals denote like or corresponding portions. The outer shell of the plug cap 60 according to the embodiment is integrally made of the same material, an elastic high-molecular material such as rubber so as to extend from the joint 61 having an insertion port 61a for the high-tension cord 65 (see Fig. 3) to the extension 63 and main body 64. The extension 63 is formed to have a predetermined angle relative to the longitudinal direction of the main body 64 so as to conform to the shape of the engaging member 59. Since the engagement relationship between the extension 63 and the engaging member 59 causes the plug cap 60 to be held stably, the main body 64 adapted to receive the ignition plug 43 inserted therethrough is remarkably reduced in outer diameter as compared with that of the conventional method.

**[0020]** Fig. 7b is a cross-sectional view of the plug cap

60. Like reference numerals denote like or corresponding portions. The present embodiment achieves the reduced diameter of the main body 64 by removing a strengthening agent applied to a portion adapted to receive the insulator 43b (see Fig. 2) therethrough in the conventional method. Incidentally, a cord setting screw 66 connected to the high-tension cord 65 is disposed on the bottom of the insertion port 61a. An electrode plate 67 connected to the cord setting screw 66 is connected to an electrode 68 to be in contact with the terminal 43c (see Fig. 2) of the ignition plug 43. The embodiment makes it possible that while a hard insulator 69 made of a synthetic resin or the like covers from the electrode plate 67 to the electrode 68, a portion of the plug cap 60 near the insertion hole 64a adapted to receive the ignition plug 43 inserted therethrough can be made of only an elastic high-molecular material such as rubber.

**[0021]** Fig. 8 is a perspective view of a cylinder head 88 and a cylinder head cover 70 to which a plug cap attachment structure according to an embodiment of the present invention is applied. As with the embodiment described earlier, an ignition plug 43 is disposed in a recessed portion 78 of a cylinder head 88 formed with an intake port 79. A high-tension cord 85 and the terminal 43c (see Fig. 2) are connected to the ignition plug 43 and a plug cap 80 is attached to the ignition plug 43 so as to insulation-protect the connected portion. The plug cap 80 is composed, as a single piece, of a cylindrical main body 84, a plate-like extension 82, and a joint 81 with the high-tension cord 85. The cylindrical main body 84 covers the insulation 43b and terminal 43c of the ignition plug 43. The extension 82 protrudes toward the circumferential outside of the main body 84. The extension 82 is formed at its almost-central portion with a through-hole 83 adapted to receive an engaging projection 77 inserted therethrough. The engaging projection 77 is formed on the cylinder head cover 70.

**[0022]** Attachment bolts 72, 73, 74 are attached to the cylinder head cover 70. An attachment bolt 72 is used to support a guide stay 71 adapted to dispose wiring cords and the like not shown at appropriate positions. The other attachment bolts 73, 74 are used to fixedly fasten the cylinder head cover 70 to the cylinder head 88. The cylinder head cover 70 is formed at its one end with the engaging projection 77, and a first engaging plate 75 and a second engaging plate 76 which sandwich the extension 82 therebetween. A plug cap attachment structure according to the present embodiment is composed of the extension 82, the engaging projection 77, the first engaging plate 75 and the second engaging plate 76.

**[0023]** Fig. 9 is a plan view of the cylinder head cover 70 according to the embodiment of the present invention. The engaging projection 77, the first engaging plate 75 and the second engaging plate 76 are integrally formed on one end of the cylinder head cover 70. When the plug cap 80 is connected to the ignition plug 43, the extension 82 is engaged with the engaging projection 77, the first engaging plate 75 and the second engaging plate 76,

whereby the plug cap 80 is stably held by the cylinder head 88. The cylinder head cover 70 is formed with through-holes 73a and 74a adapted to receive the attachment bolts 73 and 74 inserted therethrough, respectively.

**[0024]** Fig. 10 is a partial enlarged view of the cylinder head cover 70. Like reference numerals denote like or corresponding portions. The first engaging plate 75 and the second engaging plate 76 are to be abutted or approximately abutted against the extension 82 of the plug cap 80 so as to sandwich it therebetween from both sides. In addition, the first and second engaging plates 75, 76 are arranged approximately vertically with respect to a dividing plane between the cylinder head 88 (see Fig. 8) and the cylinder head cover 70. A rib 77a is formed to extend in the same direction as the first and second engaging plates 75, 76 so as to support the engaging projection 77. The engaging projection 77 has almost the same angle as the attachment angle of the ignition plug 43. Consequently, when the plug cap 80 is connected to the plug 43, the engaging projection 77 is smoothly engaged with the through-hole 83.

**[0025]** Fig. 11 is a plan view of the plug cap 80. Like reference numerals denote like or corresponding portion. The extension 82 is formed to have approximately linear lines so as to engage with the side surfaces of the first and second engaging plates 75 and 76. In addition, the extension 82 is formed with an oval through-hole 83 at its almost-central portion. Also in this embodiment, the plug cap 80 may be formed integrally with a grip in the vicinity of the joint 81. The grip functions as a handle used when the plug cap 80 is removed from the ignition plug 43.

**[0026]** Fig. 12 is a partial enlarged view of the plug cap 80. Like reference numerals denote like or corresponding portions. The outer shell of the plug cap 80 according to the embodiment is integrally made of the same material, an elastic high-molecular material such as rubber so as to extend from the joint 81 having an insertion port 81a for the high-tension cord 85 (see Fig. 8) to the extension 82 and main body 84. Since the plug cap attachment structure described above stably holds the plug cap 80, the main body 84 adapted to receive the ignition plug 43 inserted therethrough is remarkably reduced in outer diameter as compared with that of the conventional method.

**[0027]** Fig. 13a is a side view of the plug cap 80. Like reference numerals denote like or corresponding portions. In the present embodiment, the extension 82 is simply formed to extend vertically with respect to the longitudinal direction of the main body 84, which makes it possible to reduce manufacturing processes. This is because the angle of the engaging projection 77 extending from the cylinder head cover 70 (see Fig. 10) is made equal to the attachment angle of the ignition plug 43. As a result, when the plug cap 80 is connected to the ignition plug 43, the extension 82 is stably held by both sides of the first and second engaging plates 75 and 76, the en-

gaging projection 77 and the rib 77b.

**[0028]** Fig. 13b is a cross-sectional view of the plug cap 80. Like reference numerals denote like or corresponding portions. The present embodiment achieves the reduced diameter of the main body 84 by removing a strengthening agent applied to a portion adapted to receive the insulator 43b therethrough in the conventional method. Incidentally, a cord setting screw 89 to be connected to the high-tension cord 85 (see Fig. 8) is disposed on the bottom of the insertion hole 81a. An electrode plate 86 connected to the cord setting screw 89 is connected to an electrode 87 to be in contact with the terminal 43c (see Fig. 2) of the ignition plug 43. The embodiment also makes it possible that while a hard insulator 90 made of a synthetic resin or the like covers from the electrode plate 86 to the electrode 87, a portion of the plug cap 80 near the insertion hole 84a adapted to receive the ignition plug 43 inserted therethrough can be made of only an elastic high-molecular material such as rubber.

**[0029]** As described above, according to the plug cap attachment structure according to the present invention, the extension provided on the plug cap is brought into engagement with the engaging member provided on the cylinder head cover. That is, the plug cap is supported by the engine side components at two points. Thus, the plug cap can be supported with increased stability. In addition, the plug cap can be reduced in diameter by partially removing the strengthening agent made of a hard high-molecular material in response to the increased support-stability. Since the ignition plug can be located at a position closer to the engine with the reduced diameter of the plug cap, it becomes possible to increase the degree of freedom of design for the surrounding of the engine.

**[0030]** Needless to say, the shape of the plug cap and cylinder head cover and the internal structure of the plug cap are not limited to the embodiments described above and can be modified in various ways. For example, the engaging member provided on the cylinder head cover may be formed as a single piece or in a recessed shape.

## Claims

1. A plug cap attachment structure in an engine (21) in which an ignition plug (43) is located close to a cylinder head side surface wall of the engine (21) and obliquely inserted into a combustion chamber (42); the plug cap attachment structure comprises:

a cord (65; 85) adapted to supply electric power to the ignition plug (43) ;

- a plug cap (60; 80) disposed between the ignition plug (43) and the cord (65; 85) to connect the ignition plug (43) with the cord (65; 85),
- an extension (63; 82) provided on an outer shell of the plug cap (60; 80); and

an engaging member (59; 77) provided on a constituent part (49; 70) of the engine (21) and engaged with the extension (63; 82);

**characterized in that:**

the constituent part of the engine is a cylinder head cover (70) ;

the extension is a plate-like member (82) which extends circumferentially outward of a cylindrical portion (84) of the plug cap (80) and is provided with a through-hole (83) extending in a thickness direction; and

the engaging member includes one engaging projection (77) which projects from the cylinder head cover (70) and passes through the through-hole (83) and two engaging plates (75, 76) which are abutted or virtually abutted against two side end faces of the extension (82).

2. The plug cap attachment structure according to claim 1, wherein the plug cap (60; 80) is provided with a grip (62) which is virtually located on a line extending along a longitudinal direction of the ignition plug (43) so as to bend with respect to the longitudinal direction.

**Patentansprüche**

1. Anordnung zur Befestigung einer Zündkerzenkappe in einem Motor (21), bei dem eine Zündkerze (43) dicht an einer Zylinderkopf-Seitenflächenwand des Motors (21) angeordnet und schräg in einen Verbrennungsraum (42) eingesetzt ist, wobei die Anordnung zur Befestigung einer Zündkerzenkappe umfasst:

ein Kabel (65; 85), das dazu bestimmt ist, die Zündkerze (43) mit elektrischem Strom zu versorgen;

eine Zündkerzenkappe (60; 80), die zwischen der Zündkerze (43) und dem Kabel (65; 85) angeordnet ist, um die Zündkerze (43) mit dem Kabel (65; 85) zu verbinden;

ein Fortsatz (63; 82) der auf einem Außenmantel der Zündkerzenkappe (60; 80) vorgesehen ist; und

ein Eingriffselement (59; 77), das auf einem Bauteil (49; 70) des Motors (21) vorgesehen ist und mit dem Fortsatz (63; 82) in Eingriff ist;

**dadurch gekennzeichnet, dass:**

das Bauteil des Motors ein Zylinderkopfdeckel (70) ist;

der Fortsatz ein plattenartiges Element (82) ist, das sich von einem zylindrischen Teil (84) der

Zündkerzenkappe (80) ringsum nach außen erstreckt und mit einer Durchgangsbohrung (83) versehen ist, die sich in Dickenrichtung erstreckt; und

das Eingriffselement einen Eingriffsvorsprung (77), der aus dem Zylinderkopfdeckel (70) herausragt und durch die Durchgangsbohrung (83) läuft, und zwei Eingriffsplatten (75, 76) umfasst, die an zwei seitliche Endflächen des Vorsprungs (82) anstoßen oder praktisch anstoßen.

2. Anordnung zur Befestigung einer Zündkerzenkappe nach Anspruch 1, bei der die Zündkerzenkappe (60; 80) mit einem Griff (62) versehen ist, der sich praktisch auf einer Linie befindet, die sich entlang einer Längsrichtung der Zündkerzenkappe (43) erstreckt, derart, dass er in Bezug auf die Längsrichtung abgewinkelt ist.

**Revendications**

1. Structure de fixation de capuchon de bougie dans un moteur (21) dans lequel une bougie d'allumage (43) est située près d'une paroi de surface côté culasse du moteur (21) et est insérée obliquement dans une chambre de combustion (42) ; la structure de fixation de capuchon de bougie comprend :

un cordon (65 ; 85) apte à fournir de l'électricité à la bougie d'allumage (43) ;

un capuchon (60 ; 80) de bougie disposé entre la bougie d'allumage (43) et le cordon (65 ; 85) pour connecter la bougie d'allumage (43) avec le cordon (65 ; 85);

une rallonge (63 ; 82) disposée sur une enveloppe extérieure du capuchon (60 ; 80) de bougie ; et

un élément d'accouplement (59 ; 77) disposé sur une pièce (49 ; 70) du moteur (21) et accouplé avec la rallonge (63 ; 82) ;

**caractérisée en ce que :**

la pièce du moteur est un couvercle (70) de culasse ;

la rallonge est un élément analogue à une plaque (82) qui s'étend dans la direction circumférentielle vers l'extérieur d'une partie cylindrique (84) du capuchon (80) de bougie et est pourvu d'un trou traversant (83) s'étendant dans le sens de l'épaisseur ; et

l'élément d'accouplement comporte une saillie d'accouplement (77) qui dépasse du couvercle (70) de culasse et passe par le trou traversant (83) et deux plaques d'accouplement (75, 76) qui sont en butée ou sensiblement en butée contre deux faces d'extrémités latérales de la ral-

longe (82).

2. Structure de fixation de capuchon de bougie selon la revendication 1, dans laquelle le capuchon (60 ; 80) de bougie est pourvu d'une poignée (62) sensiblement située sur une ligne s'étendant dans une direction longitudinale de la bougie d'allumage (43) de manière à former un coude par rapport à la direction longitudinale.

5

10

15

20

25

30

35

40

45

50

55



FIG.2

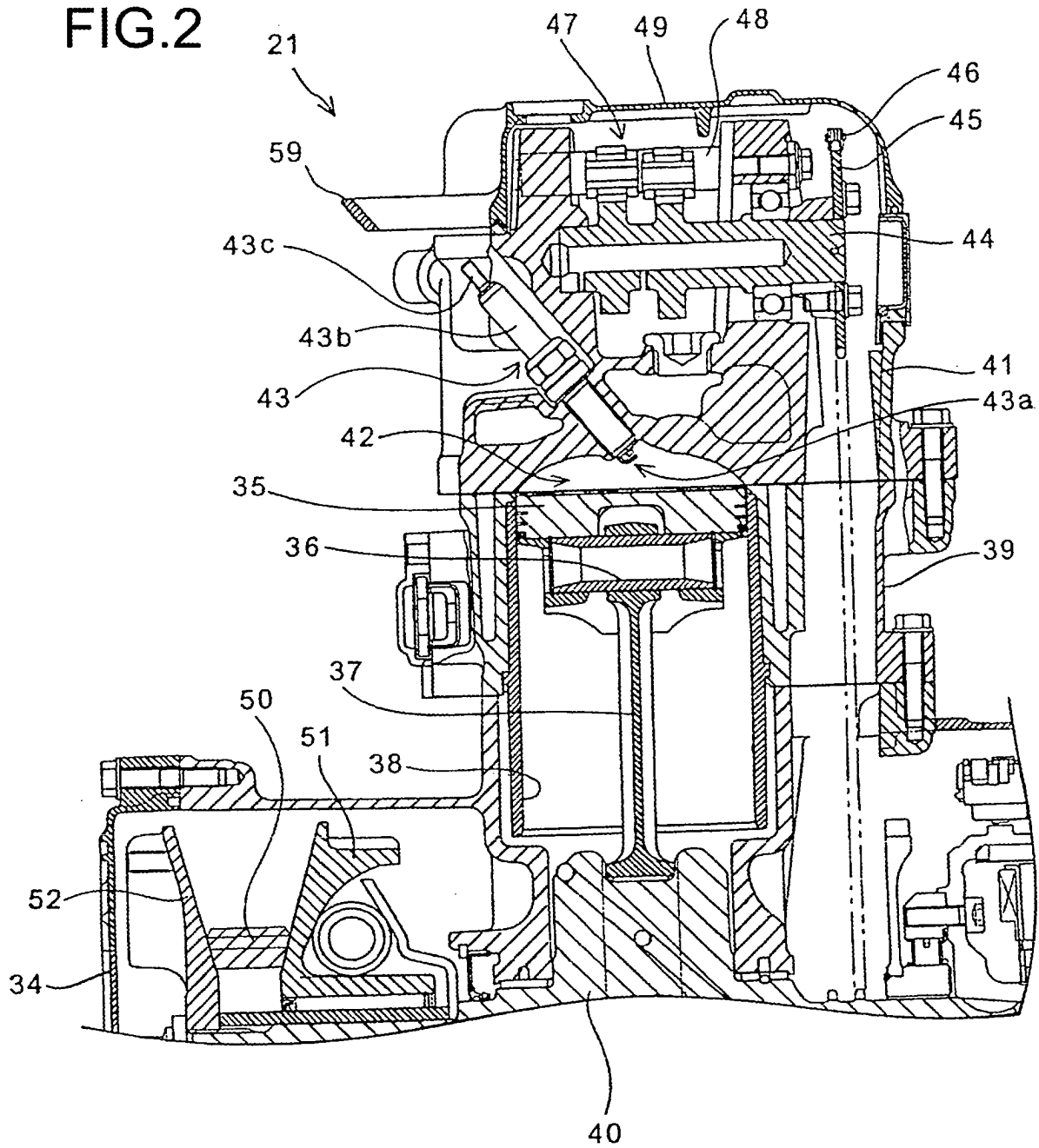

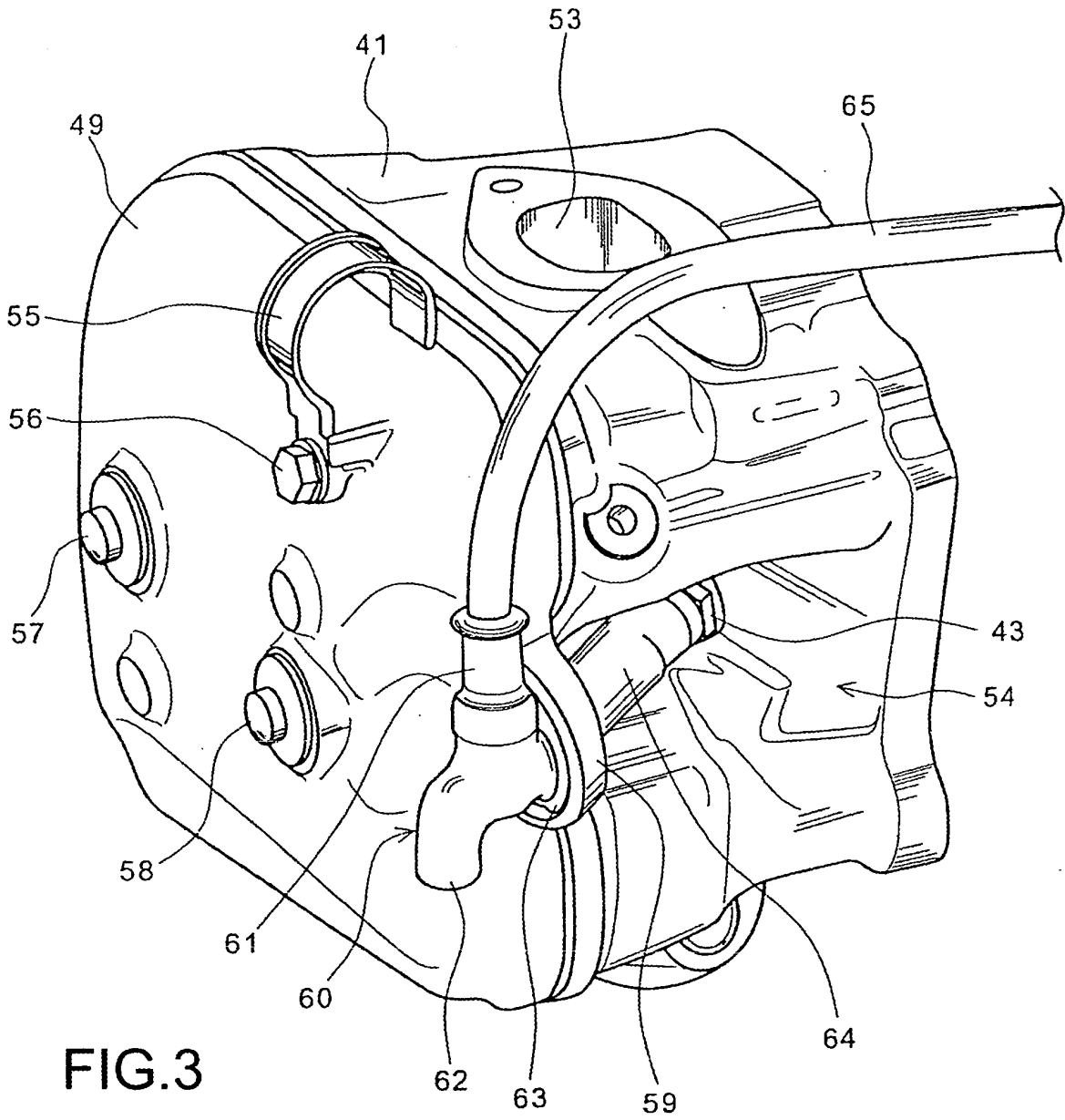

FIG.4

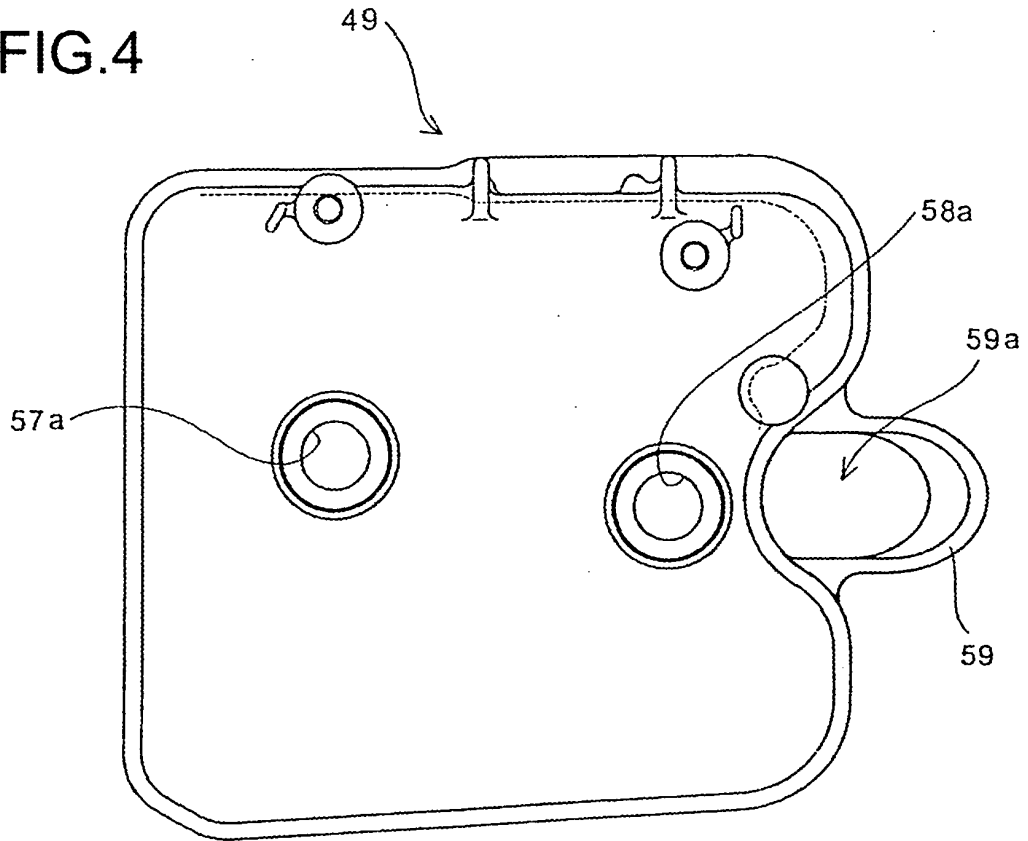

FIG.5

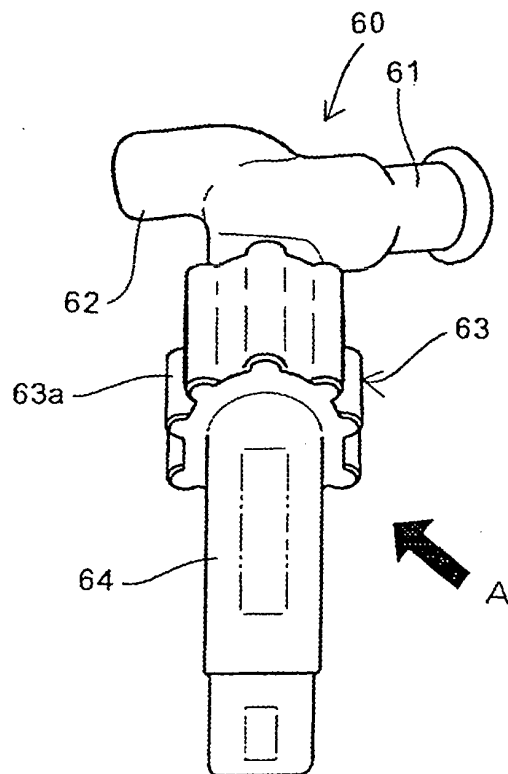

FIG.6

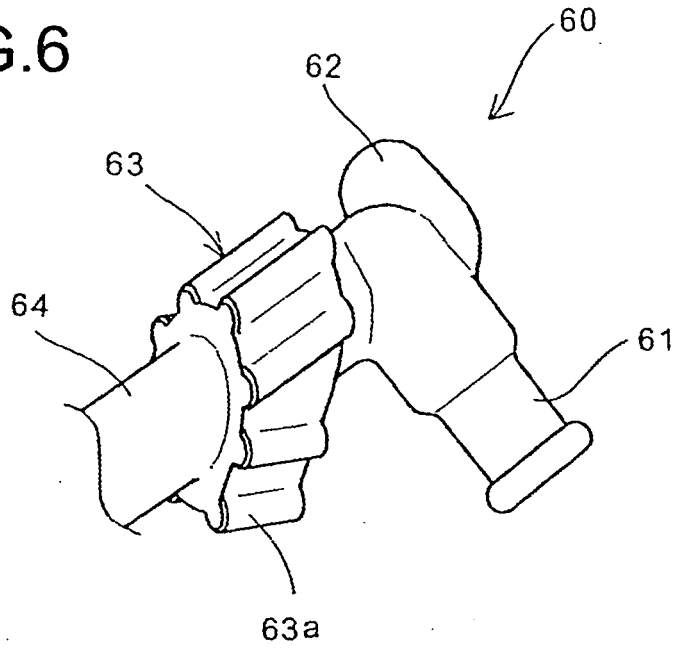
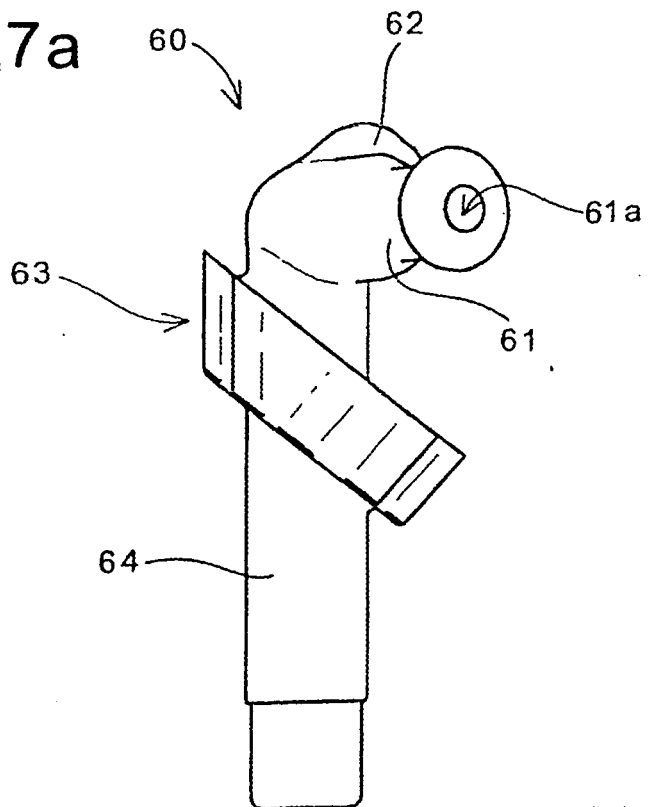

FIG.7a



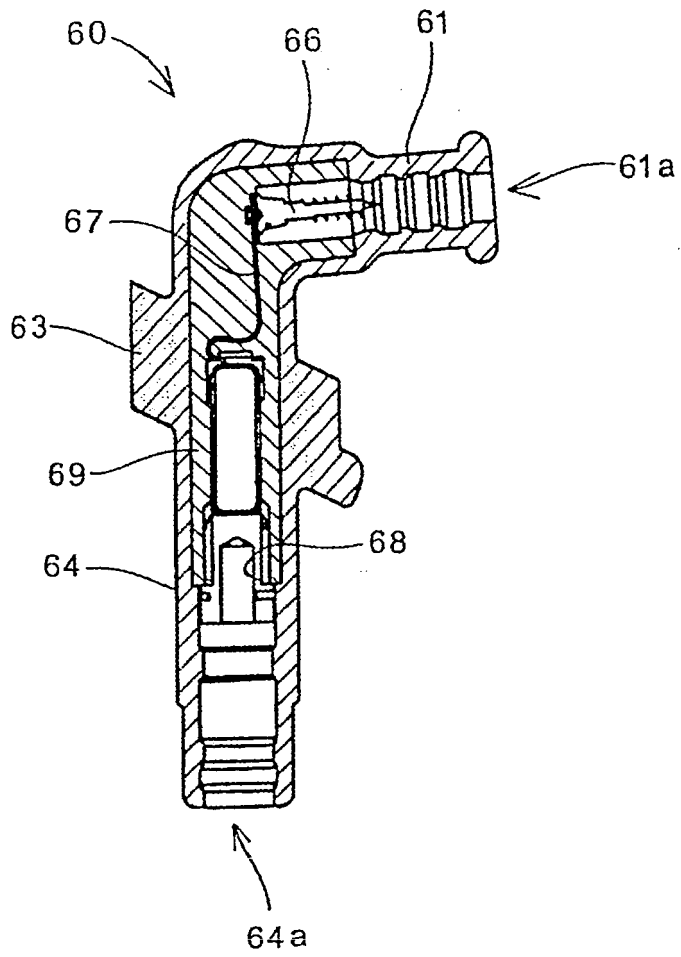
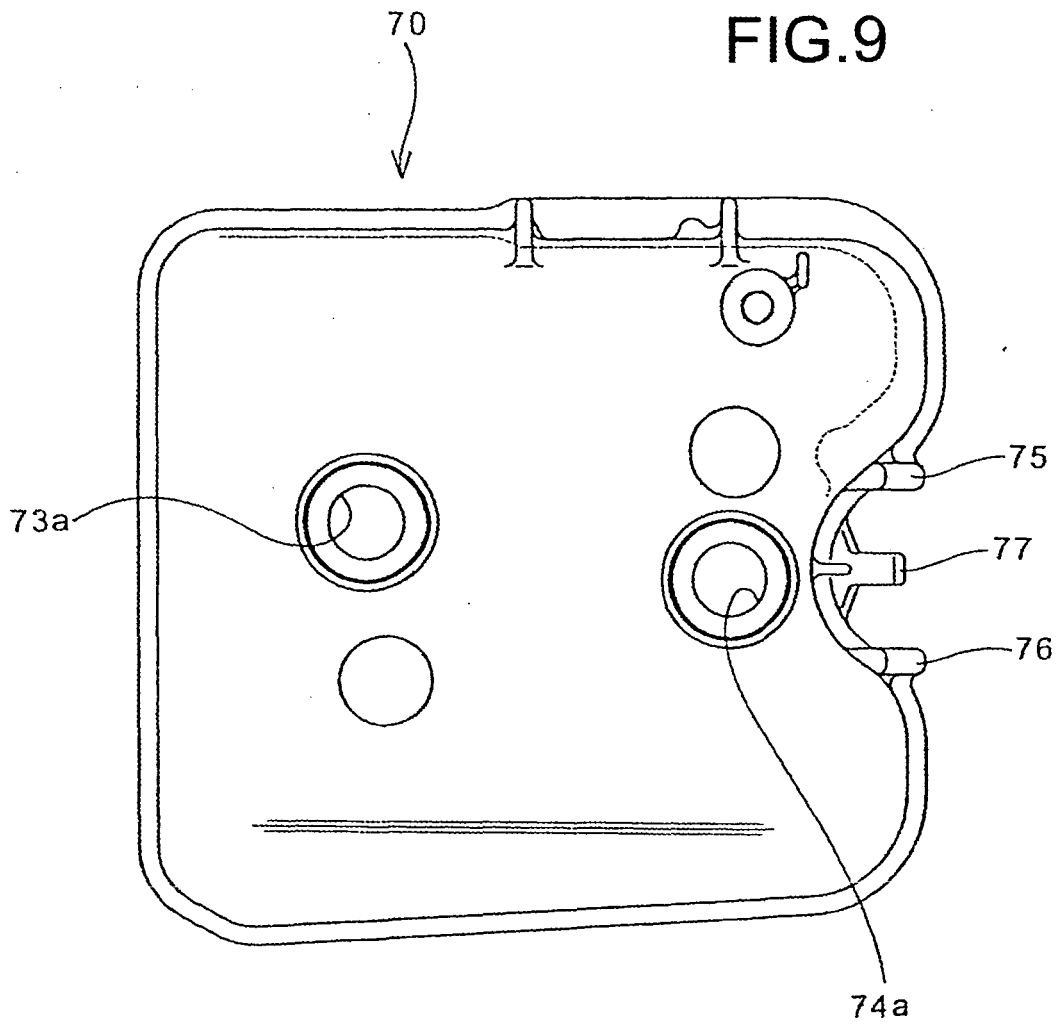

FIG. 7b





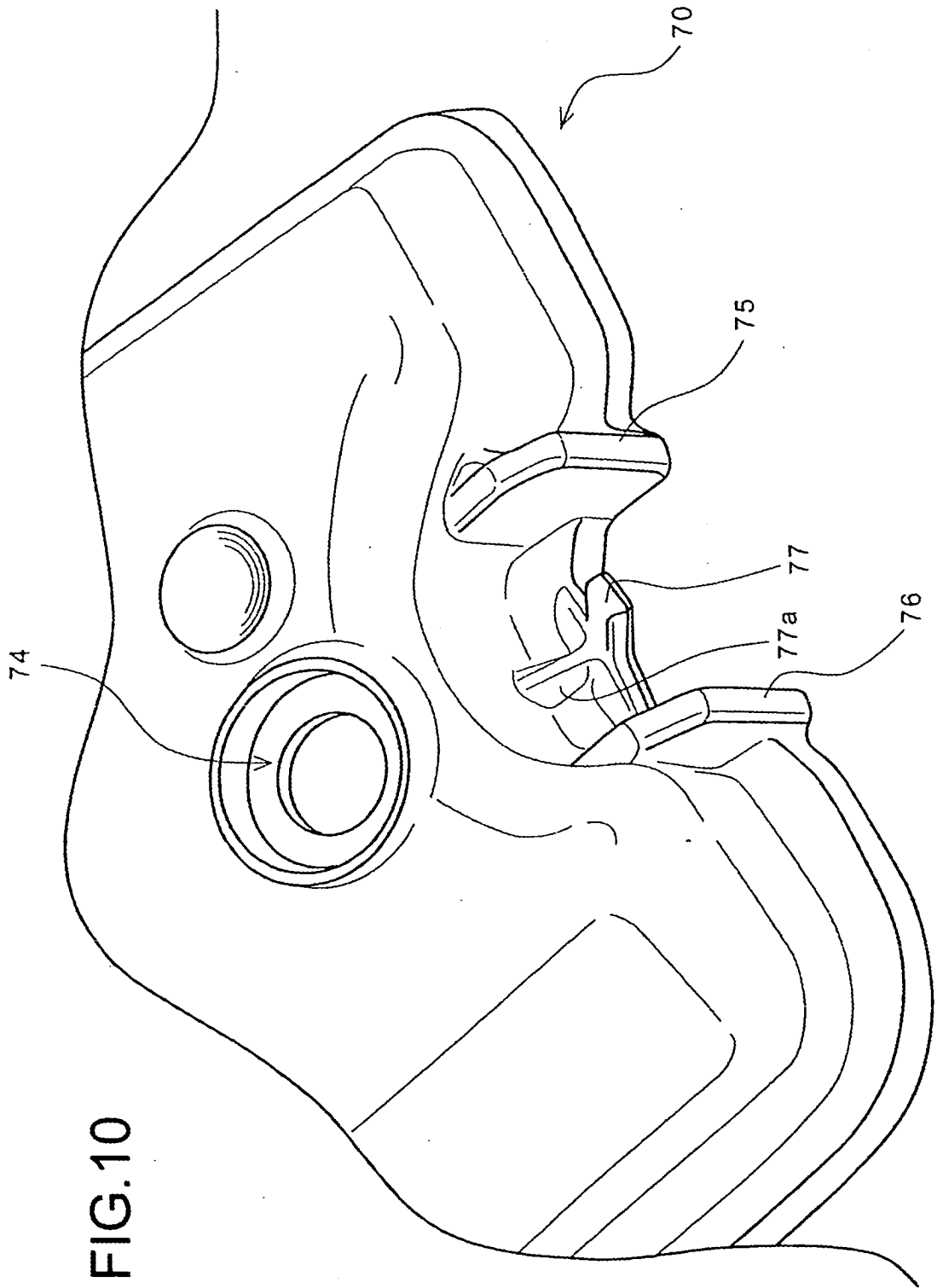

FIG.10

FIG.11

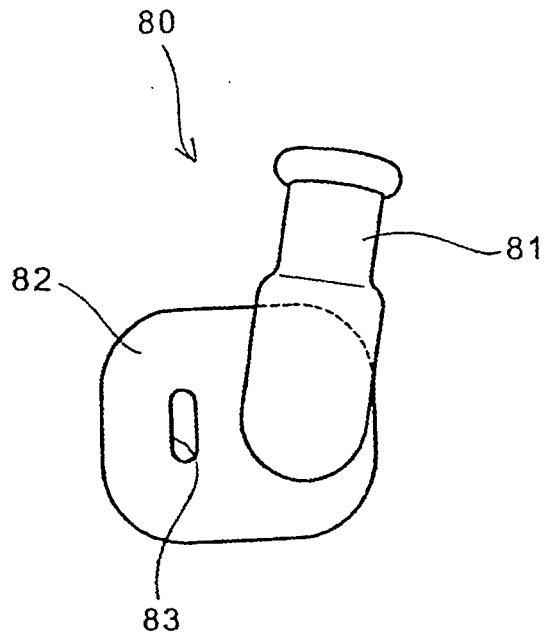

FIG.12

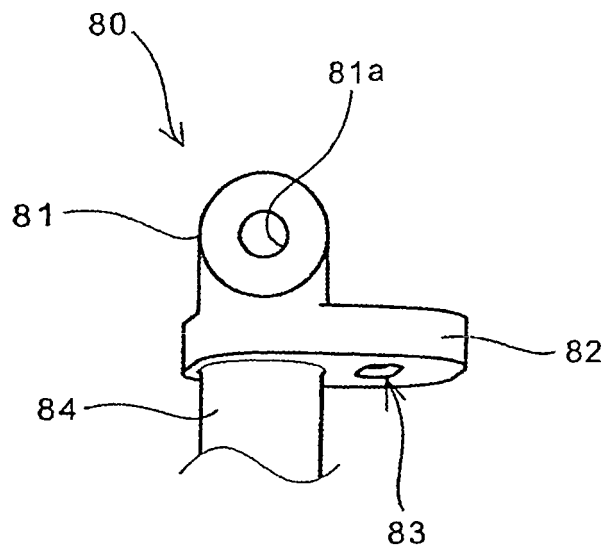

FIG.13a

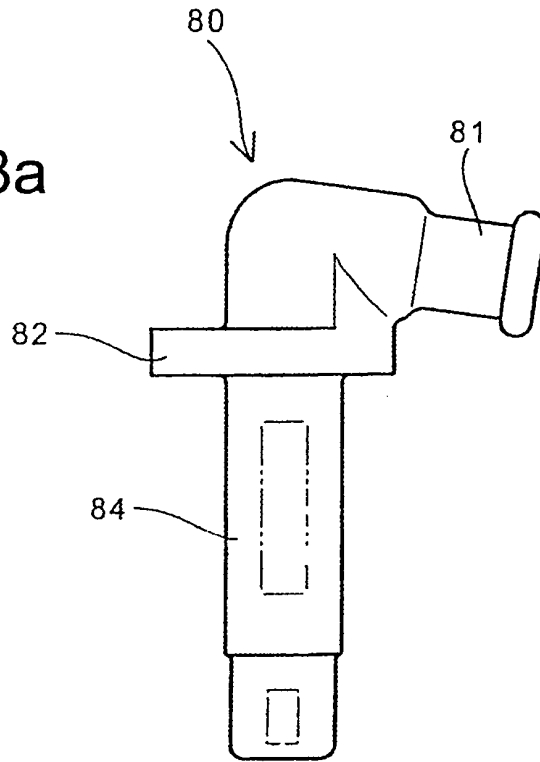
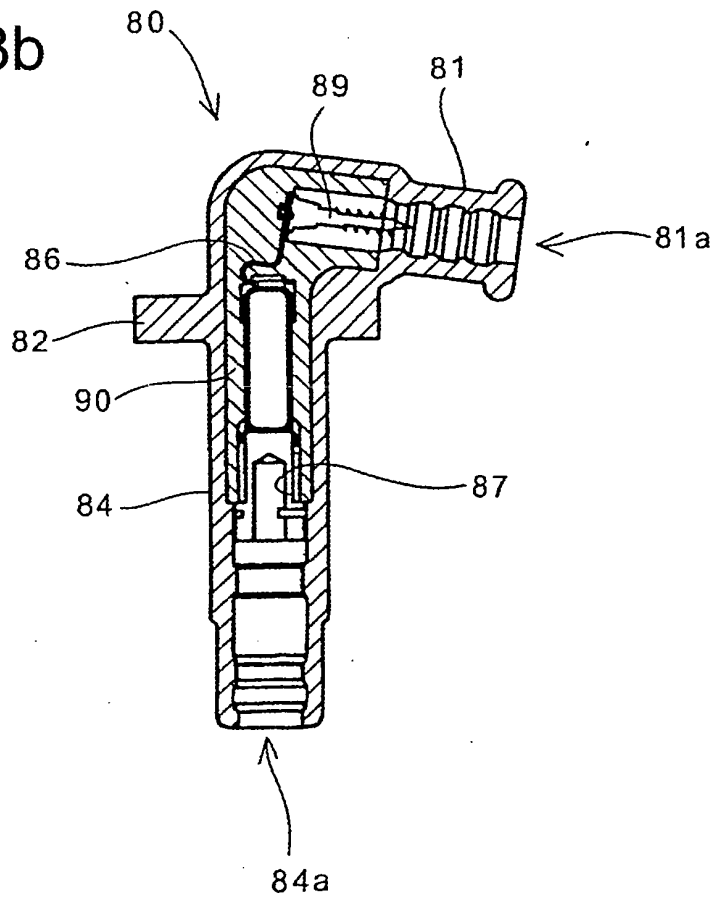

FIG.13b



**REFERENCES CITED IN THE DESCRIPTION**

*This list of references cited by the applicant is for the reader's convenience only. It does not form part of the European patent document. Even though great care has been taken in compiling the references, errors or omissions cannot be excluded and the EPO disclaims all liability in this regard.*

**Patent documents cited in the description**

- US 5799633 A1 [0002]