



- (51) International Patent Classification:  
*B65G 15/58* (2006.01)    *B60S 3/04* (2006.01)  
*B62D 65/18* (2006.01)
- (21) International Application Number:  
PCT/US2013/049842
- (22) International Filing Date:  
10 July 2013 (10.07.2013)
- (25) Filing Language: English
- (26) Publication Language: English
- (30) Priority Data:  
61/673,036    18 July 2012 (18.07.2012)    US
- (71) Applicant: LAITRAM, L.L.C. [US/US]; Legal Department, 200 Laitram Lane, Harahan, Louisiana 70123 (US).
- (72) Inventors: PEDERSEN, Soren A.; 100 Wilson Road, #34, Springfield, New Jersey 07081 (US). KOVACH, Miranda R.; 804 Audubon Trace, Jefferson, Louisiana 70121 (US). DAILEY, R. Scott; 51 Belle Grove Drive, Destrehan, Louisiana 70047 (US). WENZEL, John E.; 235 Deval Drive, Mandeville, Louisiana 70471 (US).
- (74) Agent: CRONVICH, James T.; Laitram, L.L.C., 200 Laitram Lane, Harahan, Louisiana 70123 (US).
- (81) Designated States (unless otherwise indicated, for every kind of national protection available): AE, AG, AL, AM, AO, AT, AU, AZ, BA, BB, BG, BH, BN, BR, BW, BY,

BZ, CA, CH, CL, CN, CO, CR, CU, CZ, DE, DK, DM, DO, DZ, EC, EE, EG, ES, FI, GB, GD, GE, GH, GM, GT, HN, HR, HU, ID, IL, IN, IS, JP, KE, KG, KN, KP, KR, KZ, LA, LC, LK, LR, LS, LT, LU, LY, MA, MD, ME, MG, MK, MN, MW, MX, MY, MZ, NA, NG, NI, NO, NZ, OM, PA, PE, PG, PH, PL, PT, QA, RO, RS, RU, RW, SC, SD, SE, SG, SK, SL, SM, ST, SV, SY, TH, TJ, TM, TN, TR, TT, TZ, UA, UG, US, UZ, VC, VN, ZA, ZM, ZW.

(84) Designated States (unless otherwise indicated, for every kind of regional protection available): ARIPO (BW, GH, GM, KE, LR, LS, MW, MZ, NA, RW, SD, SL, SZ, TZ, UG, ZM, ZW), Eurasian (AM, AZ, BY, KG, KZ, RU, TJ, TM), European (AL, AT, BE, BG, CH, CY, CZ, DE, DK, EE, ES, FI, FR, GB, GR, HR, HU, IE, IS, IT, LT, LU, LV, MC, MK, MT, NL, NO, PL, PT, RO, RS, SE, SI, SK, SM, TR), OAPI (BF, BJ, CF, CG, CI, CM, GA, GN, GQ, GW, KM, ML, MR, NE, SN, TD, TG).

**Declarations under Rule 4.17:**

- as to applicant's entitlement to apply for and be granted a patent (Rule 4.17(ii))
- as to the applicant's entitlement to claim the priority of the earlier application (Rule 4.17(iii))

**Published:**

- with international search report (Art. 21(3))

(54) Title: CONVEYOR BELT INCLUDING CHOCKING MODULE

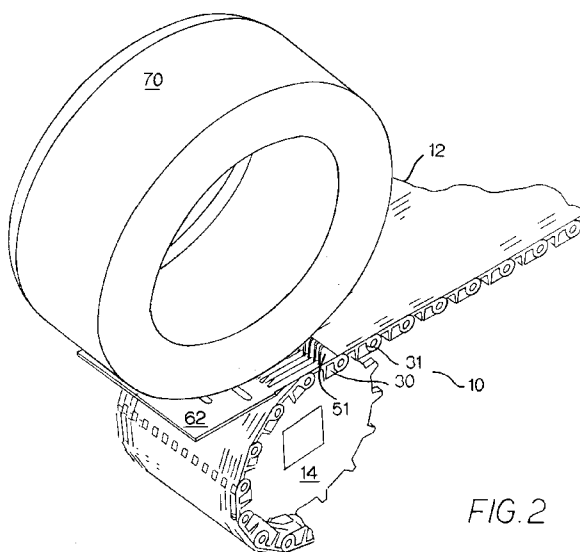

FIG. 2

(57) Abstract: A conveyor belt comprising a plurality of modules hinged together includes a first type of module including raised ribs arranged in columns and a second type of module including chock segments aligned with the columns. A transfer device includes fingers aligned with gaps between the chock segments and valleys between the columns. Each chock segment is substantially triangular in shape.



## CONVEYOR BELT INCLUDING CHOCKING MODULE

### BACKGROUND

The invention relates generally to power driven conveyor belts. More particularly, the present invention relates to industrial conveyor belts used to convey a car or other  
5 machine having wheels.

Conveyor belts may be used in assembly lines, car washes or other locations requiring conveyance of a car or other machine having wheels. Current car pusher conveyor belts have large openings at idle and drive ends that pose a safety hazard for people walking  
10 on the conveyor belts. In addition, the large openings create the risk of objects falling through the openings.

### SUMMARY

The present invention provides a conveyor belt comprising a plurality of modules hinged together. The conveyor belt includes a first type of module including raised ribs arranged in columns and a second type of module connected to the first type of  
15 module. The second type of module includes chock segments aligned with the columns of raised ribs. A transfer device includes fingers aligned with gaps between the chock segments and valleys between the columns. Each chock segment is substantially wedge shaped.

According to one aspect of the invention, a module for a conveyor belt comprises a deck extending in length from a first end to a second end and in width from a left side to a  
20 right side and having a top surface and an opposite bottom surface and a segmented chock extension extending from the top surface of the deck.

According to another aspect of the invention, a conveyor belt, comprises a first module comprising a first deck and an array of raised ribs arranged in a set of columns extending from a top surface of the first deck and a second module connected to the first  
25 module, the second module comprising a second deck and a segmented chock extension extending from a top side of the second deck. The segmented chock extension comprises a row of wedge-shaped chock segments, each chock segment aligned with a column of raised ribs.

According to another aspect of the invention, a conveyor comprises a conveyor belt  
30 having a first module and a second module connected to the first module, and a transfer platform. The first module has a first deck and an array of raised ribs arranged in a set of

columns extending from a top surface of the first deck. The second module comprises a second deck and a segmented chock extension extending from a top surface of the second deck. The segmented chock extension comprises a row of wedge-shaped chock segments separated by gaps, each chock segment aligned with a column of raised ribs. The transfer  
5 platform includes fingers extending from a plate, each fingers aligned with a gap between two chock segments.

#### BRIEF DESCRIPTION OF THE DRAWINGS

These features and aspects of the invention, as well as its advantages, are described in more detail in the following description, appended claims, and accompanying drawings,  
10 in which:

FIG. 1 illustrates an end portion of a conveyor belt including a chock module and a transfer device for transferring product off of the conveyor belt;

FIG. 2 illustrates the end portion of FIG. 1 illustrating the use of a chock module to position a wheel;

15 FIG. 3 is a detailed close up view of a chock module of the conveyor belt of FIG. 1;

FIG. 4 is a side view of the end portion of FIG. 1 as the chock module nears the transfer device;

FIG. 5 is a side view of the end portion of FIG. 1 as the chock module passes through the transfer device;

20 FIG. 6 is a side view of the end portion of FIG. 1 after the chock module passes through the transfer device.

#### DETAILED DESCRIPTION

A portion of a conveyor embodying features of the invention is shown in FIGS. 1–2. The conveyor 10 includes a conveyor belt 12 in the form of a belt loop wrapped around a  
25 pair of sprocket sets 14, or drums, defining opposite ends of the conveyor. A motor drives the belt in a direction of belt travel 26.

The conveyor belt 12 is preferably a modular plastic conveyor belt, such as one of those manufactured and sold by Intralox, L.L.C., of Harahan, La., USA. The modular belt is constructed of a series of rows of one or more belt modules. The modules are conventionally  
30 molded out of a thermoplastic polymer, such as polyethylene, polypropylene, acetal, or a composite polymeric material.

Each row, which may comprise one or more modules, extends longitudinally from a first end 38 to a second end 39, laterally from a first side 40 to a second side 41, and in thickness from a bottom 42 to a top surface 43. The bottom surface 42 may include drive structure, such as teeth, for engaging the sprocket 14. The top surface 43 forms a conveying surface for carrying conveyed products. Consecutive rows are connected together at hinge joints 47 that enable the belt to articulate about sprockets. Instead of a modular hinged belt, a slat conveyor belt constructed of slat modules between flanking roller chains could be used. The belt follows a conveying circuit including along a carryway atop a carryway pan or other support structure and along an opposite returnway below the carryway. Along the carryway, the belt defines a generally planar carryway path for transporting articles from one end of the conveyor to the other.

The illustrative conveyor belt is a heavy duty industrial belt suitable for transporting cars or other heavy machines through an assembly line, car wash or other environment. The conveyor belt includes at least two types of modules. Each illustrative module includes a central deck extending from a leading end to a trailing end and from a first side to a second side and hinge elements spaced apart on the leading and trailing ends, though alternative embodiments are possible. A first type of module 31 in the conveyor 10 is a raised rib module. Most of the modules in the conveyor comprise raised rib modules. Each raised rib module 31 includes an array of raised ribs extending from the top conveying surface of the module. The raised ribs are arranged in columns 32 separated by valleys 33 to form a non-skid surface. An example of the non-skid modules 31 is described in US Patent No. 7,111,725, the contents of which are incorporated by reference. The invention is not limited to the shown rib configuration. At select intervals, the belt 12 includes a chock-type module 30 that includes chock extensions 50 for chocking a wheel 70, as shown in FIG. 2.

Each chock extension 50, shown in detail in FIG. 3, comprises a plurality chock segments 51 extending from the top surface 43 of the module. The illustrative chock segments 51 are wedge-shaped, though the invention is not limited to a wedge or triangular shape. Gaps 52 separate the chock segments. The gaps 52 between the segments align with valleys 33 between the columns 32 of raised ribs and each segment 51 aligns with a column 32 of raised ribs. The illustrative gaps 52 extend to the top surface 43 of the module.

Although the chock segments 51 may have a variety of shapes, each illustrative chock segment has a generally triangular shape, including a substantially vertical (i.e.,

perpendicular to the top surface 43 of the module) front face 54, an angled back face 55 and a rounded tip 56. The base 57 of the segment may extend substantially from a first (leading) end of the module to a second (trailing) end of the module. The height of the segment H may be substantially equal to the length L of the segment at the base, and is sufficient to  
5 prevent a chocked wheel 70 from moving.

In one embodiment, the gaps 52 are between about 0.1inches and about 0.375 inches in width and preferably about 0.125 inches in width. The chock segments 51 may be between about 1.0 and about 3.0 inches in height H, and are preferably between about 1.5 inches and about 2.0 inches in height. The center-to-center distance between adjacent gaps 52 in a chock  
10 extension is between about 0.25 inches and about 0.75 inches and preferably between about 0.375 and about 0.5 inches. The dimensions of the chock segments 51 and size of the gaps 52 between the chock segments preferably complies with the safety codes set forth for escalators, elevators and/or people movers, such as ASME A17.1, Safety Code for Elevators and Escalators, and CSA B44 Safety Coded for Elevators.

The chock segments 51 are preferably unitarily molded with the modules from which  
15 they extend, so that the chock segments are integral with the deck of the module. In the examples shown, all the chock segments 51 are of the same height, but it would be possible for the chock segments to be of different heights, with the tallest one defining a maximum height.

Positioned at the exit end 17 of the conveyor 10 is a transfer device for offloading  
20 articles off the end of the conveyor. The device is a transfer platform 60 that includes fingers 61 extending outward from a plate 62. The fingers 61 are separated laterally by gaps 66 and extend to finger tips 68 close to the top surface 43 of the belt. Top finger surfaces 67 may be coplanar with a transfer plate top surface 63 so that articles transferred between the belt and  
25 the conveyor may transfer smoothly. Alternatively, the transfer plate surface 63 may be slightly offset from the top finger surfaces 67. The bottom finger surface 69 may be shaped to increase the strength of the fingers. For example, the fingers may taper in depth from the plate 62 towards the tips 68. The transfer platform 60 may be formed of steel or another suitable material.

The gaps 66 between the transfer device fingers 61 align with the chock segments  
30 51 and columns of ridges 32 on the modules. The fingers 61 align with the gaps 52 between chock segments in modules 30 and valleys 33 of the modules 31.

The chock module will prevent a wheel 70 or other product placed on the module from rolling backwards as a vehicle is conveyed towards the discharge end 17 of the conveyor. As the chock module 30 approaches the transfer device, as shown in FIG. 4, the chock segments 51 push an object positioned on the chock module onto the transfer device 5 60. The chock segments 51 pass through the fingers 61. As the portion of the conveyor belt containing the chock module 30 wraps around the sprocket 14, as shown in FIG. 5, the chock segments 51 pass downwards through the fingers 61, allowing transfer of the wheel or other conveyed product off of the belt. The fingers 61 are sized and configured to prevent the chock segments from hitting the plate 62. As shown, the fingers are longer in length than the 10 modules 30, 31. FIG. 6 shows the chock module 30 after it passes the transfer device 60. At this position, the fingers 61 of the transfer device extend through the valleys 32 of the ridged modules 30, with the columns of ridges passing through the gaps 66 between the fingers 61.

The segmented chock extension prevents large gaps in the transfer plate and combines with the non-skid raised rib modules to provide safety for people walking on the 15 conveyor belt and to prevent objects from falling through the conveyor belt.

Although the invention has been described with reference to specific versions, other versions are possible. The scope of the invention is not meant to be limited to the exemplary versions described in detailed.

What is claimed is:

## CLAIMS

1. A module for a conveyor belt comprising:  
a deck extending in length from a first end to a second end and in width from a left side to a right side and having a top surface and an opposite bottom surface; and  
5 a segmented chock extension extending from the top surface of the deck.
2. The module of claim 1, wherein the segmented chock extension comprises a row of wedge-shaped chock segments.
- 10 3. The module of claim 2, wherein each chock segment comprises a substantially vertical front face, an angled back face and a rounded tip.
4. The module of claim 2, wherein the base of each chock segment extends in length from the first end of the deck to the second end of the deck.
- 15 5. The module of claim 2, wherein each chock segment has a height substantially equal to a length of the chock segment at the base.
6. The module of claim 2, wherein the chock segments are separated by gaps that are  
20 between about 0.1 inches and about 0.375 inches.
7. The module of claim 6, wherein a center-to-center distance between adjacent gaps is between about 0.25 inches and about 0.75 inches.
- 25 8. The module of claim 6, wherein the gaps extend to the top surface of the deck.
9. The module of claim 1, wherein the segmented chock extension is integrally formed with the deck.
- 30 10. A conveyor belt, comprising:  
a first module comprising a first deck and an array of raised ribs arranged in a set of columns extending from a top surface of the first deck; and

a second module connected to the first module, the second module comprising a second deck and a segmented chock extension extending from a top side of the second deck, wherein the segmented chock extension comprises a row of wedge-shaped chock segments, each chock segment aligned with a column of raised ribs.

5

11. The conveyor belt of claim 10, wherein the columns in the first module are separated by valleys.

12. The conveyor belt of claim 11, wherein the wedge-shaped cock segments are separated by gaps that are between about 0.1 inches and about 0.375 inches.

10

13. The conveyor belt of claim 12, wherein the gaps are aligned with the valleys.

14. A conveyor, comprising:

15

a conveyor belt comprising

a first module comprising a first deck and an array of raised ribs arranged in a set of columns extending from a top surface of the first deck, and

a second module connected to the first module, the second module comprising a second deck and a segmented chock extension extending from a top surface of the second deck, wherein the segmented chock extension comprises a row of wedge-shaped chock segments separated by gaps, each chock segment aligned with a column of raised ribs; and

20

a transfer platform including fingers extending from a plate, each fingers aligned with a gap between two chock segments.

25

15. The conveyor of claim 14, wherein the columns in the first module are separated by valleys.

16. The conveyor of claim 15, wherein the fingers of the transfer platform and the gaps of the second module are aligned with the valleys of the first module.

30

17. The conveyor of claim 14, wherein the fingers taper in depth from the plate towards the tips of the fingers.

18. The conveyor of claim 14, wherein the fingers are longer in length than both the first  
5 module and the second module.

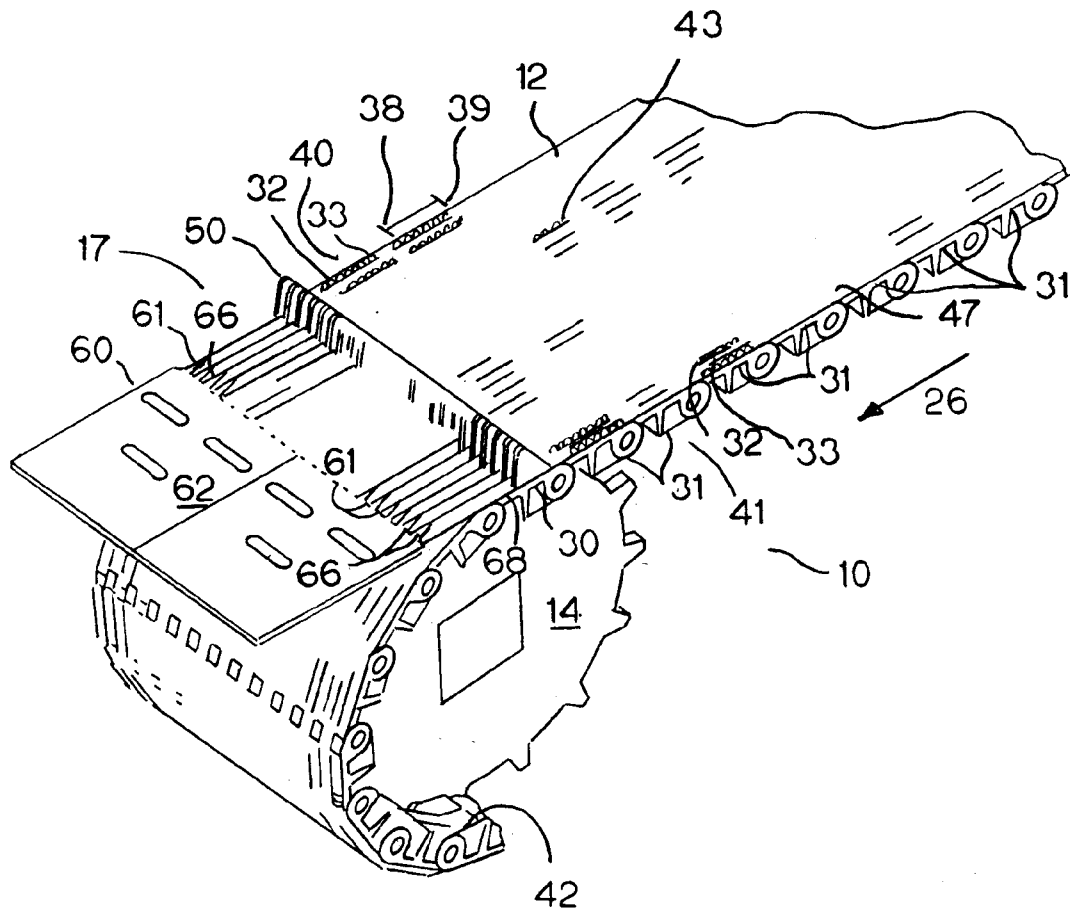

FIG. 1

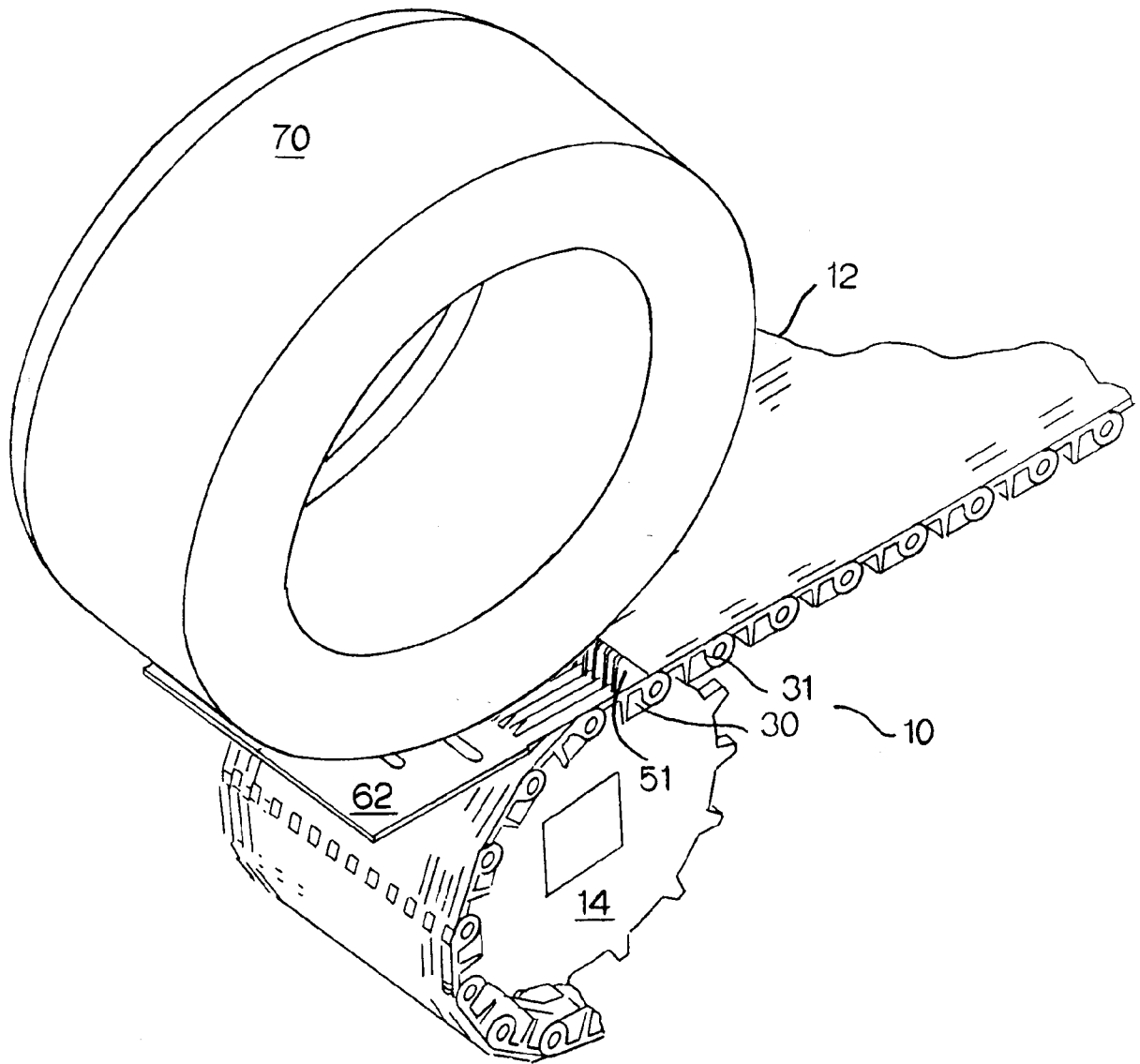

FIG. 2

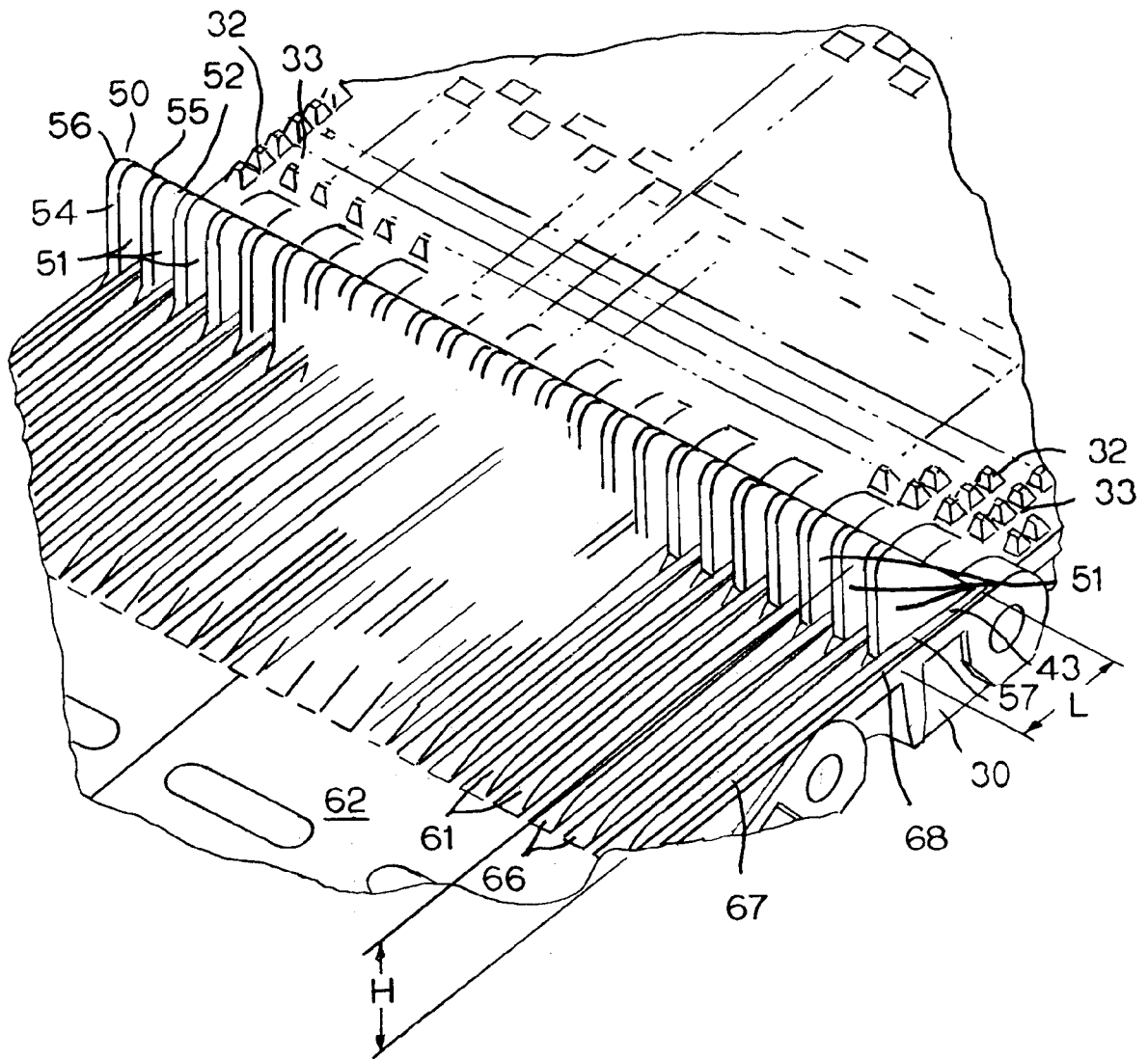

FIG. 3



5/5

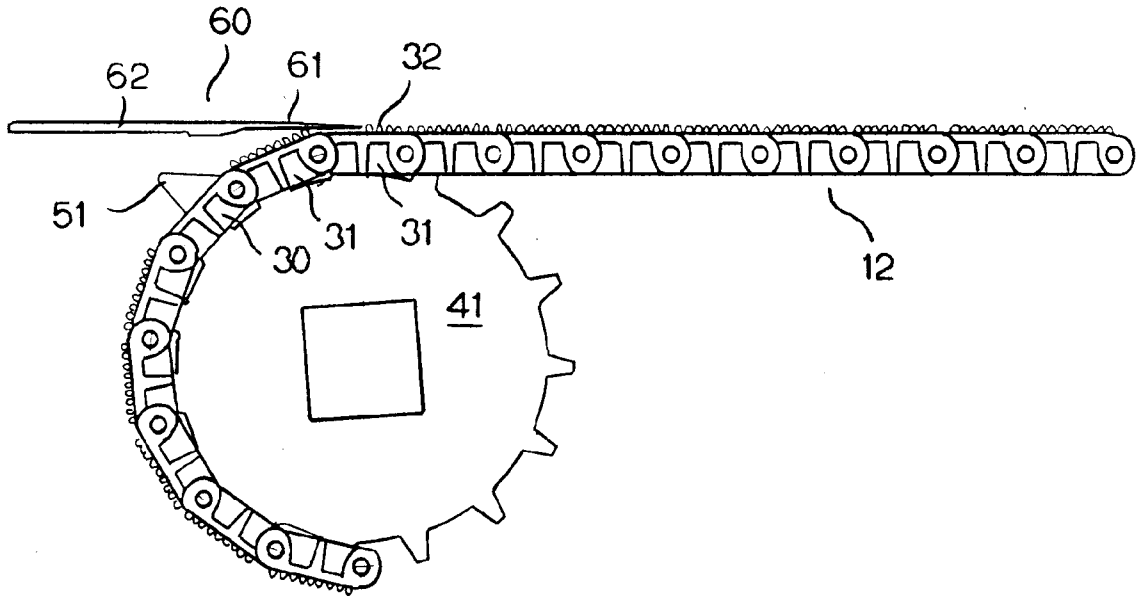

FIG.6

## INTERNATIONAL SEARCH REPORT

International application No.  
**PCT/US2013/049842****A. CLASSIFICATION OF SUBJECT MATTER****B65G 15/58(2006.01)i, B62D 65/18(2006.01)i, B60S 3/04(2006.01)i**

According to International Patent Classification (IPC) or to both national classification and IPC

**B. FIELDS SEARCHED**

Minimum documentation searched (classification system followed by classification symbols)

B65G 15/58; B65G 15/42; B65G 17/32; B65G 17/06; B62D 65/18; B60S 3/04

Documentation searched other than minimum documentation to the extent that such documents are included in the fields searched

Korean utility models and applications for utility models

Japanese utility models and applications for utility models

Electronic data base consulted during the international search (name of data base and, where practicable, search terms used)

eKOMPASS(KIPO internal) &amp; Keywords: conveyor, deck, chock, rib, and platform

**C. DOCUMENTS CONSIDERED TO BE RELEVANT**

Category*	Citation of document, with indication, where appropriate, of the relevant passages	Relevant to claim No.
Y	JP 10-025015 A (CENTRAL MOTOR CO., LTD.) 27 January 1998 See paragraphs [0010]-[0014] and figures 1,3.	1-12, 14-15, 17-18
A		13, 16
Y	US 2006-0076218 A1 (MARSHALL, ANGELA L. et al.) 13 April 2006 See paragraphs [0018]-[0020] and figures 1-2.	1-12, 14-15, 17-18
A	JP 2010-149981 A (DAIO PAPER CORPORATION) 8 July 2010 See paragraphs [0032]-[0034] and figure 3.	1-18
A	US 4911286 A (HERZKE, HARRY) 27 March 1990 See column 2, lines 53-68, column 3, lines 1-44, and figures 1,3.	1-18
A	US 2004-0178049 A1 (HERTZ, ROGER B. et al.) 16 September 2004 See paragraphs [0032]-[0033],[0047],[0050]-[0051] and figures 2,8,10.	1-18

 Further documents are listed in the continuation of Box C. See patent family annex.

\* Special categories of cited documents:

"A" document defining the general state of the art which is not considered to be of particular relevance

"E" earlier application or patent but published on or after the international filing date

"L" document which may throw doubts on priority claim(s) or which is cited to establish the publication date of citation or other special reason (as specified)

"O" document referring to an oral disclosure, use, exhibition or other means

"P" document published prior to the international filing date but later than the priority date claimed

"T" later document published after the international filing date or priority date and not in conflict with the application but cited to understand the principle or theory underlying the invention

"X" document of particular relevance; the claimed invention cannot be considered novel or cannot be considered to involve an inventive step when the document is taken alone

"Y" document of particular relevance; the claimed invention cannot be considered to involve an inventive step when the document is combined with one or more other such documents, such combination being obvious to a person skilled in the art

"&amp;" document member of the same patent family

Date of the actual completion of the international search

25 September 2013 (25.09.2013)

Date of mailing of the international search report

**04 October 2013 (04.10.2013)**

Name and mailing address of the ISA/KR

Korean Intellectual Property Office  
189 Cheongsu-ro, Seo-gu, Daejeon Metropolitan City,  
302-701, Republic of Korea

Facsimile No. +82-42-472-7140

Authorized officer

CHOI Hyun Goo

Telephone No. +82-42-481-8288

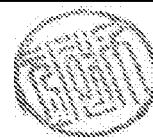

**INTERNATIONAL SEARCH REPORT**

Information on patent family members

International application No.

**PCT/US2013/049842**

Patent document cited in search report	Publication date	Patent family member(s)	Publication date
JP 10-025015 A	27/01/1998	JP 2785125 B2	13/08/1998
US 2006-0076218 A1	13/04/2006	AT 507182 T DE 602005027648 D1 DK 1647515 T3 EP 1647515 A1 EP 1647515 B1 JP 05172086 B2 JP 2006-111449 A US 7111725 B2	15/05/2011 09/06/2011 06/06/2011 19/04/2006 27/04/2011 27/03/2013 27/04/2006 26/09/2006
JP 2010-149981 A	08/07/2010	None	
US 4911286 A	27/03/1990	EP 0338193 A1 EP 0338193 B1 EP 0338193 B1 JP 01773247 C JP 02013510 A JP 04060884 B	25/10/1989 25/07/1990 23/04/1997 14/07/1993 17/01/1990 29/09/1992
US 2004-0178049 A1	16/09/2004	CA 2449719 A1 CA 2449719 C EP 1395506 A1 US 2002-0179411 A1 US 6761262 B2 US 7093708 B2 WO 02-096784 A1	05/12/2002 12/01/2010 10/03/2004 05/12/2002 13/07/2004 22/08/2006 05/12/2002