

(19) **DANMARK**

(10) **DK/EP 3468372 T3**



(12) **Oversættelse af  
europæisk patentskrift**

Patent- og  
Varemærkestyrelsen

- 
- (51) Int.Cl.: **A 22 C 7/00 (2006.01)**
- (45) Oversættelsen bekendtgjort den: **2020-05-11**
- (80) Dato for Den Europæiske Patentmyndigheds bekendtgørelse om meddelelse af patentet: **2020-02-12**
- (86) Europæisk ansøgning nr.: **17732250.0**
- (86) Europæisk indleveringsdag: **2017-06-06**
- (87) Den europæiske ansøgnings publiceringsdag: **2019-04-17**
- (86) International ansøgning nr.: **NL2017050367**
- (87) Internationalt publikationsnr.: **WO2017213496**
- (30) Prioritet: **2016-06-09 NL 2016928**
- (84) Designerede stater: **AL AT BE BG CH CY CZ DE DK EE ES FI FR GB GR HR HU IE IS IT LI LT LU LV MC MK MT NL NO PL PT RO RS SE SI SK SM TR**
- (73) Patenthaver: **Marel Further Processing B.V., Handelstraat 3, 5831 AV Boxmeer, Holland**
- (72) Opfinder: **VEROUDEN, Franciscus Quirinus Fredrik, De Lange Loop 3, 5845 GZ Sint Anthonis, Holland**  
**MESKENDAHL, Dirk, Hagenweg 8, 47559 Kranenburg, Tyskland**  
**MEULENDIJKS, Johannes Martinus, Atalanta 1, 5754 GP Deurne, Holland**  
**VAN DER STRAATEN, Wilhelmus Johannes Jacobus Maria, Torenstraat 7, 5836 AJ Sambeek, Holland**
- (74) Fuldmægtig i Danmark: **Chas. Hude A/S, H.C. Andersens Boulevard 33, 1780 København V, Danmark**
- (54) Benævnelse: **Formningsapparat og fremgangsmåde til formning**
- (56) Fremdragne publikationer:  
**WO-A1-00/30458**  
**WO-A1-98/12934**  
**WO-A2-2014/148897**  
**US-A- 3 490 391**



## DESCRIPTION

**[0001]** The present invention relates to a moulding device and a method for moulding food products from a mass of foodstuff which can be transferred by pumping, for example a mass of minced meat.

**[0002]** Such a moulding device is known e.g. from WO2004002229 and WO2010110655 and WO2014148897 of the same applicant. These known moulding devices comprise:

- a stationary frame;
- a revolving moulding drum assembly having a peripheral surface in which one or more mould cavities are provided, wherein the cavities each define a filling opening in the peripheral surface;
- a rotary bearing assembly supported by the stationary frame and rotatably supporting the moulding drum assembly about a longitudinal drum rotation axis;
- a drive motor to drive the moulding drum assembly;
- a mass feed device arranged in a filling position with respect to the peripheral surface of the moulding drum assembly; the mass feed device comprising:
  - an inlet member for feeding a pressurized mass of foodstuff;
  - a shoe member (19) in communication with the inlet member, comprising a filling mouth which adjoins the peripheral surface of the moulding drum assembly in such a way that the filling opening of the one or more mould cavities which move past during rotation of the moulding drum assembly come into communication with said filling mouth in order to fill said cavities with the foodstuff as they move past;

wherein, in operation, the pressurized mass of foodstuff introduced into a mould cavity causes an outward force onto said shoe member.

**[0003]** In the known devices, the mass feed device comprising the inlet member and shoe member, and possibly also a pump and a silo for receiving the mass of foodstuff, is supported by a stationary frame. The stationary frame is a fixed frame, and possibly the same stationary frame as the frame supporting the rotary bearing assembly. As the shoe member is part of the mass feed device, it is supported by the stationary frame to absorb the outward force generated by the foodstuff.

**[0004]** In WO2004002229 it is described that the mass feed device comprises a shoe member supported by a housing, which shoe member is designed to adapt to irregularities in the outer circumference of the drum, even when the drum is not perfectly cylindrical, so that loss of mass is limited and leakage during the application of a vacuum and/or pressure is avoided. For this purpose, the shoe member is flexible to a certain degree, so that it is able to follow any deviations. In particular, the shoe member comprises a flexible plate which is held against the peripheral surface under pressure produced by excess-pressure means. The excess-pressure

means e.g. comprise at least one pressure cushion and a number of lamellae, which are positioned transversely with respect to the direction of rotation of the moulding drum assembly, and which are arranged between the pressure cushion and the plate.

**[0005]** US 3490391 discloses a feeder which includes a pocketed rotor which continuously rotates and presents the pockets thereof first to an inlet of a housing in which the rotor is mounted for rotation and then to an outlet of that housing. Material is pulled into the pockets by a vacuum and compressed gasses are forced into the pockets to drive the material out of the pockets.

**[0006]** WO 00/30458 A1 provides methods and moulding devices for moulding three-dimensional products from a mass of foodstuff which is suitable for human consumption. The method comprises filling a mould cavity with a portion of the mass under the influence of a filling pressure exerted on the mass and for a filling period via a filling opening associated with the mould cavity, closing the filling opening of the mould cavity and holding the mass in the mould cavity for a fixed period. Then, the mould cavity is opened and the moulded product is removed from the mould cavity.

**[0007]** WO 98/12934 discloses a cooking aid having the shape of a pebble containing visual elements held together by a matrix made of fat and a dehydrated base.

**[0008]** A disadvantage of the known shoe members supported by a stationary rigid frame or housing is that the generation of outward forces and absorption by the rigid frame results in a net force exerted onto the relatively weak moulding drum assembly, resulting in deformation of the moulding drum assembly, in particular of the rotation axis of the moulding drum assembly. When the moulding drum assembly is supported at one end, the rotation axis may be deformed to be angled downwards towards the non-supported end. In case of a moulding drum supported at both ends, the rotation axis may be bent downwards in the central part thereof.

**[0009]** The aim of the present invention is to provide an alternative configuration.

**[0010]** According to the present invention, the moulding device comprises:

- a non-revolving component, concentrically supported by the moulding drum assembly adjacent to the peripheral surface thereof, comprising the shoe member and an interconnected moulding drum assembly engaging counterforce element to counteract the outward force exerted by the pressurized foodstuff on the shoe member;
- an anti-torque member to prevent rotation of the non-revolving component.

**[0011]** Further, a non-force transmitting flexible connection is provided between the shoe member and the inlet member, such that force transmittal from the shoe member to the inlet member is not possible.

**[0012]** In particular, the moulding device comprises:

- a non-revolving component, concentrically supported by the moulding drum assembly and not by the stationary frame, which non-revolving component is provided adjacent and movable in a radial direction to the peripheral surface; the non-revolving component comprising the shoe member and an interconnected moulding drum assembly engaging counterforce element to counteract the entire outward force exerted by the pressurized foodstuff on the shoe member;
- an anti-torque member to prevent rotation of the non-revolving component (25), while allowing flexibility in the radial direction;

**[0013]** The present invention further relates to a method for moulding food products from a mass of foodstuff which can be transferred by pumping, for example a meat mass of minced meat, wherein use is made of such a moulding device.

**[0014]** Hence, according to the claimed invention, the entire outward force generated by the foodstuff is counteracted by a counterforce element, instead of being absorbed by a fixed frame. The shoe member, which is known per se, is according to the claimed invention part of the non-revolving component, which is concentrically supported by the moulding drum assembly adjacent and movable in a radial direction to the peripheral surface thereof, and hence no longer by the frame. To ensure this, a non-force transmitting flexible connection is provided between the shoe member and the inlet member, such that force transmittal of the outward force exerted by the pressurized foodstuff on the shoe member to the inlet member is not possible.

**[0015]** The advantage of the configuration of the claimed invention is that there is no net force exerted onto the moulding drum assembly, resulting in a reduced load on the rotary bearing assemblies.

**[0016]** The anti-torque member is provided to prevent rotation of the non-revolving component. In embodiments, the anti-torque member is provided between the non-revolving component and the stationary frame. Alternatively the anti-torque member is provided between the non-revolving component and an alternative stationary element, such as a support onto which the moulding device is positioned, or part of the mass feed device which is provided stationary, e.g. a pump. It is noticed that no force transmittal of the outward force exerted by the pressurized foodstuff on the shoe member is possible via the anti-torque member.

**[0017]** In embodiments, the shoe member and the counterforce element of the non-revolving component are interconnected at one end only, forming an essentially C-shaped non-revolving element. Alternatively, the shoe member and the counterforce element are interconnected at both ends to form a ring-shaped non-revolving component.

**[0018]** According to the invention, the shoe member and counterforce element are interconnected to form the non-revolving component. In embodiments, the shoe member and counterforce element are directly connected. In alternative embodiments, connectors are provided to connect the shoe member and the counterforce element to form the non-revolving component. Possibly, one or more connection beams extending parallel to the drum rotation axis are provided to which one or more shoe members are connected on the one hand, and one or more counterforce element are connected on the other hand.

**[0019]** In order to effectively counteract the outward force exerted by the pressurized foodstuff on the shoe member, the counterforce element is provided generally opposite the shoe member. In embodiments, the shoe member and the counterforce element are positioned radially opposite one another. This configuration is advantageous in view of the distribution of forces, but alternative configurations wherein the counterforce element is not provided radially opposite the shoe member are also within the scope of the present invention. An exemplary alternative configuration of the non-revolving component is horse-shoe shaped, with the shoe member centrally at the upper end thereof, while two counterforce elements are formed at the distal legs thereof, thus provided generally opposite but not radially opposite the shoe member.

**[0020]** In embodiments, the shoe member and the counterforce element are positioned in line with each other, viewed in the direction of the rotation axis. With such a counterforce element opposite the shoe member, account has to be taken of the discharge of the moulded food products, as generally the discharge takes place radially opposite the filling. With the above-described horse-shoe-shaped non-revolving component the moulded food products can be discharged in the open end between the distal legs. In alternative embodiments, the counterforce element is provided with a discharge opening for moulded products.

**[0021]** In alternative embodiments, the shoe member and the counterforce element are positioned offset, viewed in direction of the rotation direction. A connection beam or pin, parallel to the direction of the rotation axis may connect the offset shoe member(s) and counterforce element(s). In such a configuration, the counterforce element can be positioned remote from a discharge region for discharging moulded food products.

**[0022]** In an advantageous embodiment, the non-revolving component comprises two counterforce elements, provided at opposed ends of the moulding drum assembly.

**[0023]** In an alternative advantageous embodiment, the non-revolving component comprises multiple counterforce elements, equally distributed over the length of the revolving moulding drum assembly.

**[0024]** In embodiments, between the counterforce element of the non-revolving component and the moulding drum assembly a bearing is provided, e.g. a roller bearing, ball bearing or plain bearing with a lubricant.

**[0025]** In embodiments, the bearing is pressurized, e.g. by a spring, to actively press the shoe

member to adjoin the peripheral surface of the moulding drum assembly. When pressurized, the shoe member is designed to adapt to irregularities in the outer circumference of the drum, even when the drum is not perfectly cylindrical, so that loss of mass is limited and leakage during the application of a vacuum and/or pressure is avoided. Alternative pressure devices are also conceivable, such as the cushions and lamellae configuration of WO2004002229.

**[0026]** Advantageously, the shoe member is flexible to a certain degree, so that it is able to follow any deviations. It is conceivable that the shoe member comprises a flexible plate which is held against the peripheral surface, and is pressurized by the bearing between the counterforce element and the moulding drum assembly.

**[0027]** In embodiments, the non-revolving component further comprises a moulding drum assembly engaging scraper, provided after discharge of a moulded product seen in direction of rotation, to scrape foodstuff remnants from the peripheral surface.

**[0028]** The frame of the moulding device of the invention is provided stationary, i.e. fixed to a support. The drive motor is generally supported by the frame, or provided in the frame. The moulding drum assembly is driven by means of the drive motor. A rotary bearing assembly, e.g. comprising roller bearings, is supported by the frame, and provided between the frame and a revolving moulding drum assembly.

**[0029]** In an embodiment, the moulding drum assembly comprises a rotating shaft, connected to the drive motor to allow rotation of the moulding drum assembly. The rotating shaft is rotatably supported relative to the frame via the rotary bearing assembly. Possibly, a rotating bearing is provided adjacent the drive motor in the frame. It is both conceivable that the rotating shaft is supported at one end only, or at both ends, or possibly also at an intermediate area.

**[0030]** In an alternative embodiment, a stationary spindle is fixed to the frame, and the rotary bearing assembly is provided between the spindle and the moulding drum assembly. The drive motor allows the moulding drum assembly to revolve about the spindle.

**[0031]** The rotary bearing assembly rotatably supports the moulding drum assembly about a longitudinal drum rotation axis. Generally, the rotation axis is substantially horizontal. Possibly, the rotation axis may be slightly angled with respect to the horizontal. In particular, it is conceivable that the rotation axis is slightly bended. When the moulding drum assembly is supported at one end, the rotation axis may be angled downwards towards the non-supported end. In case of a moulding drum supported at both ends, the rotation axis may be bent downwards in the central part thereof.

**[0032]** The moulding drum assembly has a peripheral surface in which one or more mould cavities are provided. The moulding drum assembly has a cylindrical outer contour with a peripheral surface, in which generally multiple mould cavities are provided. In embodiments, multiple mould cavities are arranged in the peripheral surface in a mould cavities pattern, e.g.

an array of mould cavities.

**[0033]** A row of cavities comprises cavities may be arranged at multiple longitudinal positions when seen in longitudinal (axial) direction of the moulding drum assembly, i.e. in the direction of the rotation axis. In embodiments, multiple rows of mould cavities are provided, e.g. 5-10 rows. Preferably, the filling openings of a row of cavities come into communication with a filling mouth of the shoe member.

**[0034]** A series of cavities comprises cavities may be arranged at multiple peripheral positions when seen in peripheral (circumferential) direction of the moulding drum assembly. In embodiments, multiple series of mould cavities extend in the peripheral direction, wherein said series extend substantially parallel to and at a distance from one another, viewed in the direction of the rotation axis. Each series may comprise multiple mould cavities which are at a distance from one another, viewed in the peripheral direction of the peripheral surface of the moulding drum assembly. Advantageously, the mould cavities of multiple series are aligned in rows.

**[0035]** The moulding device further comprises a mass feed device arranged in a filling position with respect to the peripheral surface of the moulding drum. In operation, the mass feed device feeds a pressurized mass of foodstuff to the one or more mould cavities.

**[0036]** The mass feed device comprises an inlet member for feeding a pressurized mass of foodstuff. Possibly, the mass feed device further comprises a pump to generate the pressurized mass of foodstuff, and a silo for receiving the mass of foodstuff. These parts of the mass feed device are generally supported by a stationary frame. The stationary frame is a fixed frame, and possibly the same stationary frame as the frame supporting the rotary bearing assembly.

**[0037]** The mass feed device further comprises a shoe member in communication with the inlet member, comprising a filling mouth which adjoins the peripheral surface of the moulding drum assembly. In embodiments, a shoe member comprises multiple filling mouth.

**[0038]** According to the invention, the shoe member is supported by the moulding drum assembly. In particular, a non-force transmitting flexible connection is provided between the shoe member and the inlet member, such that force transmittal from the shoe member to the inlet member is not possible. Such a flexible connection is e.g. formed by a flexible hose. During operation, the filling opening of the one or more mould cavities which move past during rotation of the moulding drum assembly come into communication with said filling mouth in order to fill said cavities with the foodstuff as they move past.

**[0039]** In embodiments, the mass feed device further comprises a distributor between the shoe member and the inlet member, wherein the inlet member is provided adjacent a pump. The flexible connection may be provided between the shoe member and the distributor, or between the distributor and the inlet member.

**[0040]** In embodiments, a single shoe member is provided extending over the longitudinal length of the peripheral surface of the moulding drum assembly. As such, it is possible that a single shoe member is adapted to come into communication with one row of cavities at the time.

**[0041]** In alternative embodiments, the non-revolving component comprises multiple shoe members, provided substantially parallel to and adjacent one another, viewed in the direction of the rotation axis, each shoe member having a filling mouth adjoining an associated section of the peripheral surface (63) of the moulding drum assembly in which a series of cavities is arranged at multiple peripheral positions when seen in peripheral direction of the moulding drum assembly. The filling mouth of each shoe member is preferably provided adjacent one or two series of cavities, which move past the associated shoe member during rotation of the moulding drum assembly come into communication with said associated shoe member in order to fill said cavities of said series with the foodstuff as they move past.

**[0042]** Preferably the multiple shoe members are provided floating in the direction of the rotation axis, such that each shoe member is free to align itself relative to the moulding drum assembly. This may e.g. compensate for misalignment caused by fitting errors and thermal expansion or contraction.

**[0043]** In embodiments, the peripheral surface of the moulding drum assembly is embodied as a profiled peripheral surface having a shaping profile which comprises, for each series of cavities arranged at multiple peripheral positions when seen in peripheral direction of the moulding drum assembly, projections between multiple pairs of successive cavities of said series and/or one or more peripheral grooves which extend in the peripheral direction between and through the successive cavities of said series.

**[0044]** Advantageously, an inner side of each shoe member which adjoins an associated section of the peripheral surface of the moulding drum assembly is embodied as a profiled inner side having a profile which section comprises, for each series of cavities, one or more grooves extending in the peripheral direction and/or ribs extending in the peripheral direction, which grooves and/or ribs are in meshing engagement with the profiled peripheral surface of said section of the moulding drum. As such, each floating shoe member is able to align itself relative to a section of the moulding drum via the meshing configuration.

**[0045]** The present invention further relates to a non-revolving component, adapted to be concentrically supported by a moulding drum assembly adjacent and movable in a radial direction to a peripheral surface thereof, comprising:

- one or more shoe members of a mass feed device which is adapted to be arranged in a filling position with respect to the peripheral surface of the moulding drum assembly to adjoin and be movable in a radial direction to the peripheral surface of the moulding drum assembly, wherein the one or more shoe members are in communication with an inlet member of the mass feed device, each of the one or more shoe members

comprising a filling mouth which is adapted to adjoin the peripheral surface of the moulding drum assembly in such a way that the filling opening of the one or more mould cavities which move past during rotation of the moulding drum assembly come into communication with said filling mouth in order to fill said cavities with the foodstuff as they move past; and

- an interconnected moulding drum assembly engaging counterforce element to counteract the entire outward force exerted by the pressurized foodstuff on the shoe member.

**[0046]** In embodiments, the non-revolving component further comprises connection beams extending parallel to the drum rotation axis, to which one or more shoe members are connected adjacent filling openings in the peripheral surface of the moulding drum assembly, and to which one or more moulding drum assembly engaging counterforce elements are connected. Possibly, two moulding drum assembly engaging counterforce elements are provided at the ends of the connection beams adjacent the peripheral surface at the ends of the moulding drum assembly, preferably remote from the filling openings.

**[0047]** The present invention further relates to the combination of the above-described non-revolving component and an anti-torque member to prevent rotation of the non-revolving component.

**[0048]** The present invention further relates to the combination of the above-described non-revolving component and a revolving moulding drum assembly having a peripheral surface in which one or more mould cavities are provided, wherein the cavities each define a filling opening in the peripheral surface.

**[0049]** The present invention also relates to the combination of a revolving moulding drum assembly and an associated non-revolving component for use in a moulding device for the moulding of food products, wherein the drum assembly has a rotation axis and a peripheral surface in which mould cavities are provided, wherein the cavities each define a filling opening in the peripheral surface, and wherein said moulding drum comprises first and second end parts, e.g. each embodied as a rotation symmetrical surface, at opposite axial ends of said peripheral surface in which mould cavities are provided, wherein the non-revolving component has a connection subframe with a first counterforce element and a second counterforce element at axial ends thereof, wherein said first counterforce element cooperates with said first end part via a first bearing, e.g. via one or more rollers that roll over a rotation symmetrical surface, and wherein said second counterforce element cooperates with said second end part via a second bearing, e.g. via one or more rollers that roll over a rotation symmetrical surface, wherein said subframe carries one or more shoe members. For example each of said first and second bearing comprises or is formed by a set of two rollers engaging a respective rotation symmetrical surface at a respective axial end of the drum, the two rollers of a set being spaced apart in circumferential direction.

**[0050]** Possible aspects of the non-revolving component described in relation to the invention directed to the moulding drum are also deemed to relate to the non-revolving component per se, or to the combination.

**[0051]** The present invention further relates to a non-revolving component for use in a moulding device according to any of claims 1-10.

**[0052]** The invention will be elucidated further in relation to the attached drawings, in which:

Fig. 1 is a perspective view of a first embodiment of a moulding device according to the present invention;

Fig. 2 is a perspective view of a second embodiment of a moulding device according to the present invention;

Fig. 3a is a perspective view of part of a third embodiment of a moulding device according to the present invention;

Fig. 3b shows part of the embodiment of fig. 3a;

Fig. 3c shows the non-revolving component of the embodiment of fig. 3a;

Fig. 4a is a perspective view of part of a fourth embodiment of a moulding device according to the present invention;

Fig. 4b shows part of the embodiment of fig. 4a;

Fig. 4c shows the embodiment of fig. 4a in a perspective view from below;

Fig. 5 shows a shoe member of a non-revolving component according to the embodiments of fig. 3 and fig 4.

**[0053]** In fig. 1 a first embodiment of a moulding device 10 for moulding food products from a mass of foodstuff which can be transferred by pumping, for example a meat mass of minced meat, is shown.

**[0054]** The moulding device 10 comprises a revolving moulding drum assembly 1 and a stationary frame 2. Here, stationary frame is provided with wheels so as to be transportable, e.g. for cleaning purposes. During moulding, the wheels are fixed such that frame 2 is stationary. In stationary frame 2 a drive motor (not shown) is provided to drive the moulding drum assembly 1.

**[0055]** The shown revolving moulding drum assembly 1 comprises a rotating shaft 7, rotatably supported relative to the frame 2 via a rotary bearing assembly 6, so as to rotatably support the moulding drum assembly 1 about a longitudinal drum rotation axis RA.

**[0056]** Revolving moulding drum assembly 1 has a peripheral surface 3 in which multiple mould cavities 4 are provided, wherein the cavities each define a filling opening in the peripheral surface. The mould cavities are arranged in an array of parallel rows, here 5-6, extending in the direction of the rotation axis, and parallel series, here 7, extending in the peripheral direction.

**[0057]** Moulding device 10 further comprise a mass feed device 15 arranged in a filling position with respect to the peripheral surface of the moulding drum assembly. Here, the mass feed device 15 comprises a pump unit 16 to generate the pressurized mass of foodstuff, and a silo 17 for receiving the mass of foodstuff. These parts of the mass feed device are supported by a stationary frame 20. The mass feed device 15 further comprises an inlet member 18 for feeding a pressurized mass of foodstuff, and a shoe member 19 in communication with the inlet member 18.

**[0058]** The shoe member 19 comprises a filling mouth (not visible) which adjoins the peripheral surface of the moulding drum assembly in such a way that the filling opening of the one or more mould cavities which move past during rotation of the moulding drum assembly come into communication with said filling mouth in order to fill said cavities with the foodstuff as they move past. In operation, the pressurized mass of foodstuff introduced into a mould cavity causes an outward force onto said shoe member 19. The moulded food products are discharged via a discharge conveyor 8.

**[0059]** According to the present invention, the moulding device 10 further comprises a non-revolving component 25, concentrically supported by the moulding drum assembly 1 adjacent to and movable in a radial direction to the peripheral surface 3 thereof. Non-revolving component 25 comprises the shoe member 19 and interconnected moulding drum assembly engaging counterforce elements 26a, 26b, 26c, to counteract the entire outward force exerted by the pressurized foodstuff on the shoe member. In the shown embodiment 3 counterforce elements are provided, at opposite ends of the moulding drum assembly 1 and at a central part thereof. The mould cavities are here provided between the counterforce elements. The counterforce elements are provided radially opposite the shoe member, i.e. in the shown embodiment a segment with a counterforce element and the shoe member form a closed ring in cross-section.

**[0060]** An anti-torque member 27 is provided to prevent rotation of the non-revolving component 25. Here, anti-torque member 27 is embodied as a rod mounted to shoe member 19, which is provided with a slit for receiving a frame mounted pin 28, mounted onto stationary frame 2. The slit does not allow the non-revolving component 25 to rotate, but does allow flexibility in the radial direction. Hose 21 provided between shoe member 19 and inlet member 18 is provided as a non-force transmitting flexible connection between the shoe member 19 and the inlet member 18, such that force transmittal from the shoe member to the inlet member is not possible.

**[0061]** In fig. 2 an alternative moulding device 30 is shown, for moulding food products from a mass of foodstuff which can be transferred by pumping. The moulding device 30 comprises a frame 32, which is provided with wheels so as to be transportable between a moulding location and a remote location, e.g. for storage or cleaning. During moulding food products, the frame 32 is provided stationary.

**[0062]** In the shown embodiment, frame 32 supports a drive motor 35 controllable by a control device 39 to drive moulding drum assembly 31. Not visible is a rotary bearing assembly supported by the stationary frame and rotatably supporting the moulding drum assembly about a longitudinal drum rotation axis RA.

**[0063]** Revolving moulding drum assembly 31 has a peripheral surface in which one or more mould cavities are provided, neither of which is visible in the shown embodiment. The cavities each define a filling opening in the peripheral surface.

**[0064]** The moulding device 30 further comprises a mass feed device 45 arranged in a filling position with respect to the peripheral surface of the moulding drum assembly 31. The mass feed device 45 comprises a pump unit 46 and a silo 47 supported by a frame 50, which in the shown embodiment is provided movable on wheels. During moulding the wheels are fixed such that frame 50 is stationary. The mass feed device further comprises an inlet member 48 for feeding a pressurized mass of foodstuff to a filling mouth (not visible) of a shoe member 49. in such a way that the filling opening of the one or more mould cavities which move past during rotation of the moulding drum assembly come into communication with said filling mouth in order to fill said cavities with the foodstuff as they move past..

**[0065]** The filling mouth of shoe member 49 adjoins the peripheral surface of the moulding drum assembly 31. The shoe member 49 is, according to the present invention, part of non-revolving component 55, concentrically supported by the moulding drum assembly 31 adjacent and movable in a radial direction to the peripheral surface thereof.

**[0066]** In operation, the pressurized mass of foodstuff introduced into a mould cavity causes an outward force onto said shoe member 49. According to the invention, said outward force is counteracted by an interconnected moulding drum assembly engaging counterforce element 56, which is connected to the shoe member 49 to form a closed ring-shaped non-revolving component 25. In the counterforce element, one or more discharge openings (not visible) are provided to discharge moulded products onto discharge belt 38.

**[0067]** An anti-torque member 57 is provided, comprising a hook connected to the non-revolving component 55 and a pin connected to the frame 32, here the drive motor 35, to prevent the non-revolving component 55 from rotating together with the moulding drum assembly 31. To allow some flexibility of the shoe member 49 in the radial direction, the hook is designed to allow some radial movement of the non-revolving component with respect to the pin.

**[0068]** In the shown embodiment, a non-force transmitting flexible connection 51 is provided between shoe member 49 and inlet member 48, such that shoe member 49 is provided telescopically with respect to the inlet member 48, allowing flexibility of the shoe member 49 with respect to the inlet member 48. This flexibility required as the shoe member is supported by the moulding drum assembly 31, and a rigid connection would result in undesired stresses and force transfer.

**[0069]** In figs. 3a-3c a third embodiment is shown of a revolving moulding drum assembly 61, rotatable about rotation axis RA, and a non-revolving component 85, which is shown per se in fig. 3c.

**[0070]** The revolving moulding drum assembly 61 has a peripheral surface 63 in which multiple mould cavities 64 are provided. The cavities 64 each define a filling opening in the peripheral surface.

**[0071]** In particular, in the shown embodiment, the peripheral surface 63 of the moulding drum assembly 61 is embodied as a profiled peripheral surface. In another embodiment the peripheral surface could be entirely cylindrical with a constant diameter of its axial length.

**[0072]** The cavities 64 are arranged in 14 series, at different peripheral positions when seen in peripheral direction of the moulding drum assembly. The cavities are, in this example, also arranged in 8 adjacent and parallel axial rows, when seen in the direction of the rotation axis RA. In another embodiment the cavities could be arranged in helical rows or in staggered rows as is known in the art.

**[0073]** The peripheral surface 63 has a non-cylindrical shaping profile which comprises, for each peripheral series of cavities 64 arranged at multiple peripheral positions when seen in peripheral direction of the moulding drum assembly, projections 63p. each Projection 63p is located between a pair of successive cavities 64 of said series. The projections 63p of a series protrude relative to a smaller diameter surface ring area 63g which extends in the peripheral direction about the drum. Between neighboring series of cavities 64 a surface ring area 63g is located.

**[0074]** Non-revolving component 85 is concentrically supported by the moulding drum assembly 31 adjacent and movable in a radial direction to the peripheral surface 63 thereof. In the shown embodiment it comprises multiple, here 7 shoe members 79, provided substantially parallel to and adjacent one another, viewed in the direction of the rotation axis. Each shoe member comprises a filling mouth which is in communication with an inlet member, here not shown, via a distributor 81. Each filling mouth 80 adjoins an associated section of the peripheral surface 63 of the moulding drum assembly in such a way that the filling openings of two mould cavities of adjacent series of mould cavities 64 which move past during rotation of the moulding drum assembly come into communication with said filling mouth in order to fill said cavities with the foodstuff as they move past.

**[0075]** Advantageously, the multiple shoe members 79 are provided floating in the direction of the rotation axis RA, such that each shoe member 79 is free to align itself relative to the moulding drum assembly, in particular relative to the projections 63p that correspond to a series of cavities 64, e.g. each shoe member 79 belonging to a single corresponding series of cavities 64.

**[0076]** In the shown embodiment, an inner side 79i of each shoe member 79 which adjoins an associated section of the peripheral surface 63 of the moulding drum assembly is embodied as a profiled inner side having a profile which section comprises, for each series of cavities, one or more (here two as best seen in figure 5) grooves 79a extending in the peripheral direction and ribs 79b extending in the peripheral direction, which grooves 79a and ribs 79b are in meshing engagement with the profiled peripheral surface 63 of said section of the moulding drum. The meshing engagement may include some play between the shoe member 79 and the drum surface 63 and projections 64 thereof.

**[0077]** According to the invention, in operation, a not-shown anti-torque member is provided to prevent rotation of the non-revolving component 85, which is advantageously connected to a stationary frame such that some radial flexibility is allowed.

**[0078]** As in particular visible in fig. 3c, the non-revolving component 85 may comprise one or more connection beams 85c and 85c', extending parallel to the drum rotation axis RA. The 7 shoe members 79 are connected to this connection beams, in operation adjacent filling openings in the peripheral surface of the moulding drum assembly.

**[0079]** Furthermore, one or more moulding drum assembly engaging counterforce elements 86 may be connected to these connection beams 85c and 85c', extending remote from the filling openings, to counteract the outward force exerted by the pressurized foodstuff on the shoe member.

**[0080]** Here each counterforce element 86 is positioned radially opposite a corresponding shoe member, so that a pair of a shoe member and counterforce element forms an assembly that encircles the drum, viewed in the direction of the rotation axis RA. Each assembly of shoe member and counterforce element may be separate from neighbouring such assemblies if desired, or they may be interconnected via said one or more connection beams.

**[0081]** In particular, two counterforce elements 86 are positioned opposite each shoe member 79. Between two counterforce elements 86 is a discharge opening 89 for moulded products.

**[0082]** In the shown embodiment, the non-revolving component 85 comprises mounting tools 86a, to individually mount each shoe member 79 to the connection beam 85c'. This allows an expedient exchange of shoe members 79. In fig. 5, the combination of mounting tool 86a and shoe member 79 is shown in detail.

**[0083]** In figs. 4a -4c a fourth embodiment of part of a moulding device is partially shown. The

shoe member 79 and mounting tool 86a of this fourth embodiment are the same as that of the third embodiment, and is thus not described in further detail. The same reference numerals have been used.

**[0084]** Also, the same revolving moulding drum assembly 61 is applied as in the third embodiment, given same reference numerals for the peripheral surface 63, mould cavities 64 etc. etc.

**[0085]** In the fourth embodiment, as in the third embodiment, the non-revolving component comprises a connection beam 85c', extending parallel to the drum rotation axis RA, to which the mounting tools 86a of multiple shoe members 79 are connected adjacent filling openings in the peripheral surface of the moulding drum assembly.

**[0086]** At the other end, the shoe members 79 in this fourth embodiment are connected to a beam 90a, extending parallel to drum rotation axis RA and connection beam 85c. This connection beam 90a is part of a connection subframe 90, to which also mounting tools 86a are mounted. To this connection subframe 90, at the end parts of the moulding drum, are two moulding drum assembly engaging counterforce elements 90c connected, adjacent the peripheral surface at the ends of the moulding drum assembly, remote from the filling openings. In this embodiment, bearings 95 are provided between the counterforce elements 90c and the moulding drum assembly 61. It is illustrated that the bearings 95 here comprise at each axial end of the drum a set of rollers 95, that roll on an axial end part 63h of the drum. As is preferred this end part 63h has a diameter equal or greater than the diameter of the drum surface provided with cavities 64, e.g. greater than the diameter defined by projections 63p of such a drum type.

**[0087]** Therefore figures 4a-c illustrate an example of a combination of a revolving moulding drum assembly and an associated non-revolving component for use in a moulding device for the moulding of food products. Herein the drum assembly has a rotation axis and a peripheral surface in which mould cavities are provided, wherein the cavities each define a filling opening in the peripheral surface. The moulding drum comprises first and second end parts, here each embodied as a rotation symmetrical surface 63h, at opposite axial ends of the peripheral surface in which mould cavities 64 are provided. The non-revolving component has a connection subframe with a first counterforce element 90c and a second counterforce element 90c at axial ends thereof. The subframe further comprises a first beam 90d along one side of the drum and a second beam 90e along the opposite side of the drum.

**[0088]** The first counterforce element 90c cooperates with the first end part 63h via a first bearing, here via two rollers that roll over a rotation symmetrical surface 63h of the drum. The second counterforce element 90c cooperates with the second end part 63h via a second bearing, here via two rollers 95 that roll over a rotation symmetrical surface 63h.

**[0089]** The subframe 90 carries the shoe members 79. For example one end of a semi-circular shoe member 79 is pivotally mounted to beam 90e, e.g. so as to allow for floating

motion in direction of the beam, with the other end of the shoe member 79 being connected to the other beam 90d via a mounting tool 86a, e.g. so as to set a desired play between the shoe member 79 and the drum surface.

## REFERENCES CITED IN THE DESCRIPTION

This list of references cited by the applicant is for the reader's convenience only. It does not form part of the European patent document. Even though great care has been taken in compiling the references, errors or omissions cannot be excluded and the EPO disclaims all liability in this regard.

### Patent documents cited in the description

- [WO2004002229A \[0002\] \[0004\] \[0025\]](#)
- [WO2010110655A \[0002\]](#)
- [WO2014148897A \[0002\]](#)
- [US3490391A \[0005\]](#)
- [WO0030458A1 \[0006\]](#)
- [WO9812934A \[0007\]](#)

**Patentkrav**

1. Formningsapparat (10) til formning af næringsmiddelprodukter ud fra en masse af næringsmiddel, som kan overføres ved pumpning, f.eks. en kødmasse  
5 af hakket kød, hvilket apparat omfatter:

- en stationær ramme (2),
- en roterende formningstromleindretning (1), som har en periferisk overflade (3), hvori der er tilvejebragt et eller flere formhulrum (4), hvorved formhulrummene hver afgrænser en fyldeåbning i den perifere overflade,  
10
- en roterende lejeindretning (6), som understøttes af den stationære ramme og roterbart understøtter formningstromleindretningen omkring en langsgående tromlerotationsakse (RA),
- en drivmotor til drivning af formningstromleindretningen,  
15
- en massetilføringsindretning (15), som er anbragt i en fyldeposition i forhold til den perifere overflade (3) på formningstromleindretningen, hvilken massetilføringsindretning omfatter:

- o en indføringskomponent (18) til tilføring af en under tryk værende masse af næringsmiddel,  
20
- o en skokomponent (19) i forbindelse med indføringskomponenten, og som omfatter en fyldemunding, som står således i forbindelse med formningstromleindretningens perifere overflade, at de en eller flere formhulrums fyldeåbning, som bevæger sig forbi under formningstromleindretningens rotation, kommer i forbindelse med fyldemundingen med henblik  
25 på at fylde formhulrummene med næringsmiddel, medens de passerer forbi,

hvorved under brug den under tryk værende masse af næringsmiddel, som  
30 føres ind i et formhulrum, bevirker en udadrettet kraft på skokomponenten, **kendetegnet ved**, at formningsapparatet yderligere omfatter:

- 5 - en ikke-roterende komponent (25), som understøttes koncentrisk ved hjælp af formningstromleindretningen (1) og ikke ved hjælp af den stationære ramme (2), hvilken ikke-roterende komponent er tilvejebragt i umiddelbar nærhed af og bevægeligt i en radial retning i forhold til formningstromlens perifer overflade (3), idet den ikke-roterende komponent omfatter skokomponenten (19) og et modkræftelement (26a, 26b, 26c), som er forbundet hermed, og som går i indgreb med formningstromleindretningen med henblik på at modvirke hele den udad rettede kraft, som udøves ved hjælp af det under tryk værende næringsmiddel på skokomponenten,
- 10 - en moddrejningskomponent (27) til at forhindre rotation af den ikke-roterende komponent (25), samtidig med at den tillader fleksibilitet i den radiale retning,
- 15 og at en ikke-kraftoverførende fleksibel forbindelse (21) er tilvejebragt imellem skokomponenten (19) og indføringskomponenten (18), således at der ikke er mulighed for nogen kraftoverføring fra skokomponenten til indføringskomponenten.
- 20 2. Formningsapparat ifølge krav 1, hvorved skokomponenten og moddrejningselementet er placeret radiale modsat hinanden.
3. Formningsapparat ifølge krav 1 eller 2, hvorved skoelementet (85) og modkræftelementet (86) er placeret på linje med hinanden, set i rotationsaksens retning, hvorved med fordel modkræftelementet (86) er forsynet med en udtømningsåbning (89) til de formede produkter.
- 25 4. Formningsapparat ifølge ethvert af de foregående krav, hvorved der er tilvejebragt et leje (85) imellem den ikke-roterende komponents (105) modkræftelement (86) og formningstromleindretningen (91), hvilket leje er eventuelt under tryk.
- 30 5. Formningsapparat ifølge ethvert af de foregående krav, hvorved den ikke-roterende komponent (85) yderligere omfatter en skraber, som går i indgreb med

formningstromleindretningen, og som tilvejebringes efter udtømmning af et formprodukt, set i rotationsretningen, med henblik på at skrabe resterende næringsmiddelrester fra den perifere overflade.

5 6. Formningsapparat ifølge ethvert af de foregående krav, hvorved der er tilvejebragt forbindelsesindretninger til at forbinde skokomponenten (79) og modkræftelementet (86) til dannelse af den ikke-roterende komponent (85).

7. Formningsapparat ifølge ethvert af de foregående krav, hvorved den ikke-  
10 roterende komponent (85) omfatter flere skokomponenter (79), som er tilvejebragt i alt væsentligt parallelt med og i umiddelbar nærhed af hinanden, set i rotationsaksens retning, idet hver skokomponent omfatter en fyldemunding, som står i forbindelse med en tilhørende sektion af formningstromleindretningens perifere overflade (63), hvori der er anbragt en række hulrum ved flere perifere positioner, set i formningstromleindretningens perifere retning, hvorved fortrinsvis  
15 de flere skokomponenter er tilvejebragt flydende i rotationsaksens retning, således at hver skokomponent står frit til at oprette sig selv i forhold til formningstromleindretningen.

20 8. Formningsapparat ifølge ethvert af de foregående krav, hvorved formningstromleindretningens (61) perifere overflade (63) har form af en profileret periferisk overflade, som har et profil, som for hver række af hulrum (64), som er anbragt ved flere perifere positioner, set i formningstromleindretningens periferiretning, har fremspring (63P), som hver befinder sig imellem et par af efter hinanden følgende hulrum (64) fra rækken, og/eller en eller flere perifere riller (63G), som strækker sig i periferiretningen imellem og igennem rækkerne af efter hinanden  
25 følgende hulrum.

9. Formningsapparat ifølge krav 7 og 8, hvorved en inderside (79i) af hver skokomponent, som står i forbindelse med en tilhørende sektion af formningstromleindretningens perifere overflade (63), har form af en profileret inderside, som har et profil, hvis tværsnit for hver række af hulrum har en eller flere riller (79a), som strækker sig i den perifere retning, og/eller ribber (79b), som strækker sig i den  
30

perifere retning, hvilke riller og/eller ribber er i indgreb med den profilerede perifere overflade på den pågældende sektion af formningstromlen.

10. Formningsapparat ifølge krav 7 eller 9, hvorved den ikke-roterende komponent (85) omfatter forbindelsesbjælker (85c, 85c'), som strækker sig parallelt med tromlens rotationsakse, og hvormed de flere skokomponenter (79) er forbundet i umiddelbar nærhed af fyldeåbninger i formningstromleindretningens perifere overflade, og hvormed et eller flere modkrattelementer, som er i indgreb med formningstromleindretningen, er forbundet, fortrinsvis to modkrattelementer, som er i indgreb med formningstromleindretningen, ved enderne af forbindelsesbjælkerne i umiddelbar nærhed af den perifere overflade ved formningstromleindretningens ender, fortrinsvis fjernt fra fyldeåbningerne.

11. Fremgangsmåde til formning af næringsmiddelprodukter ud fra en masse af næringsmiddel, som kan overføres ved pumpning, f.eks. en kødmasse af hakkekød, hvorved der drages brug af et formningsapparat ifølge et eller flere af de foregående krav.

# DRAWINGS

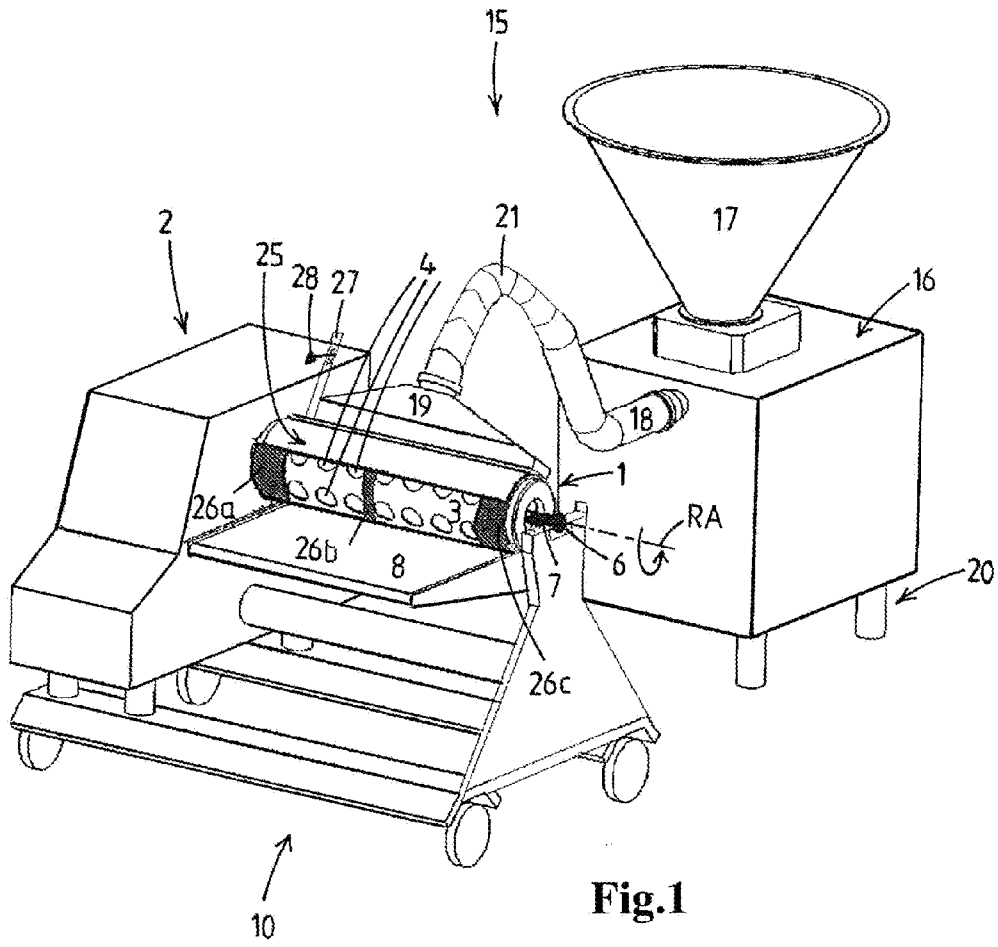

**Fig.1**

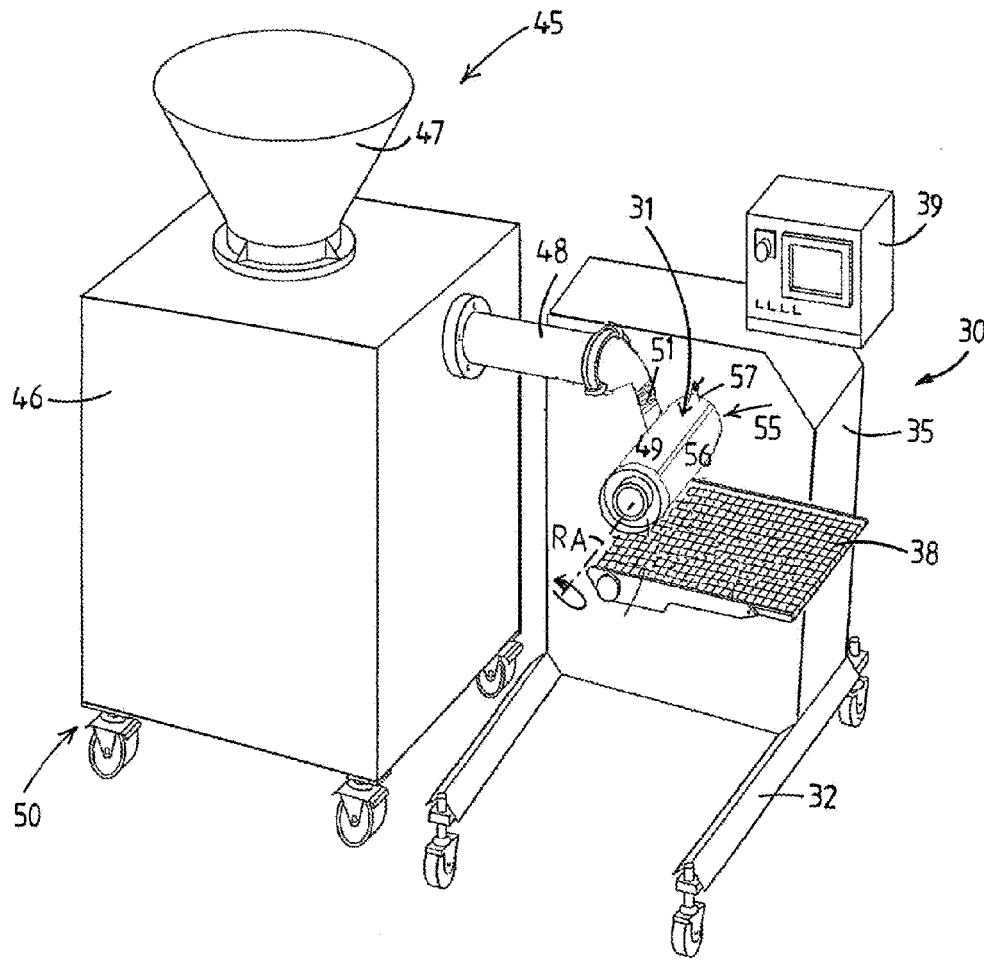
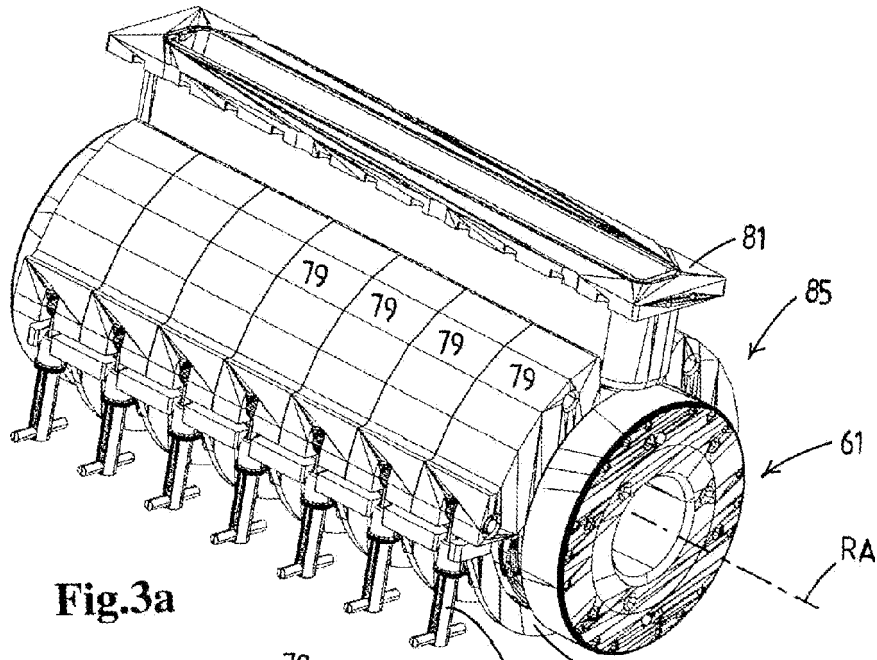
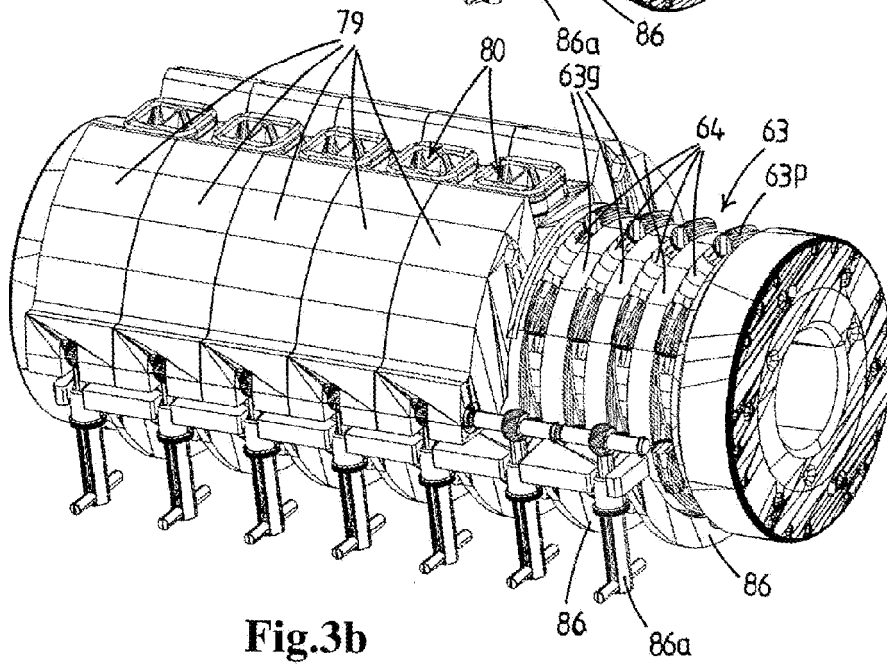

Fig.2



**Fig.3a**



**Fig.3b**

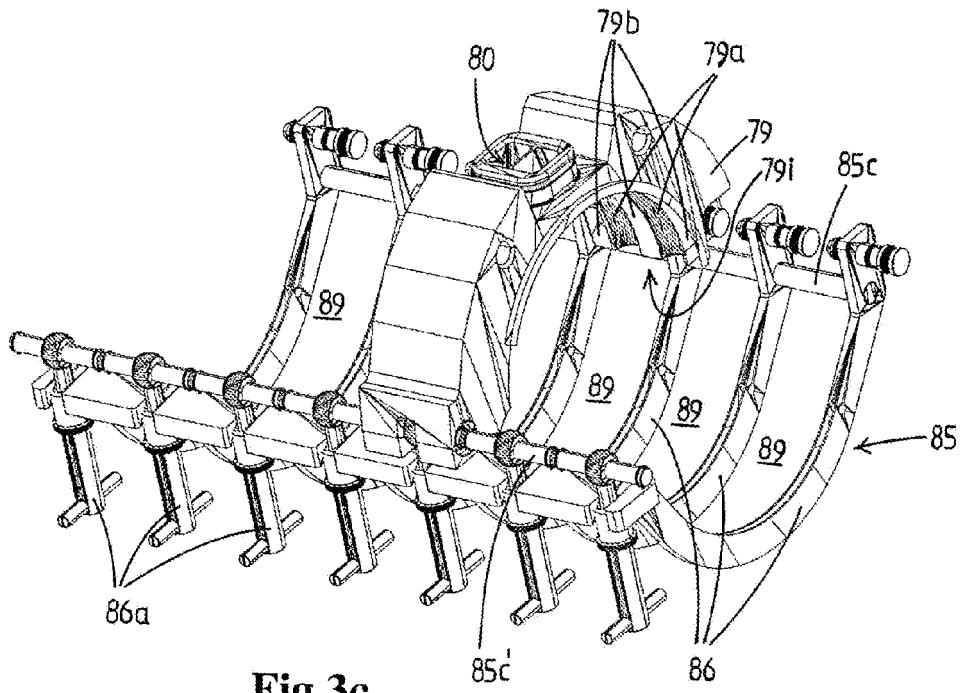

**Fig.3c**

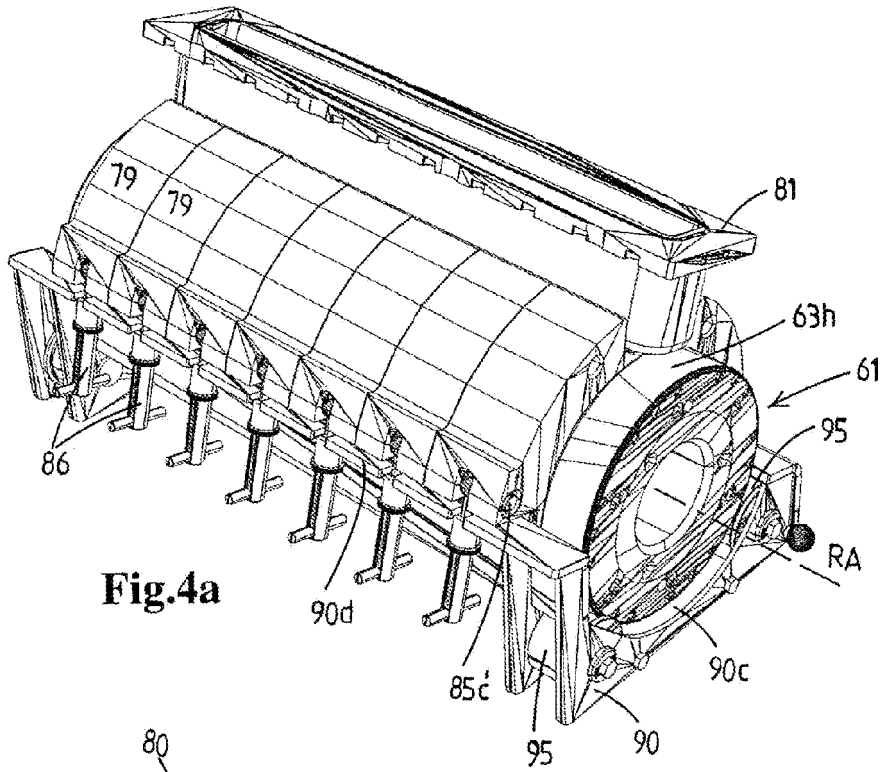

**Fig.4a**

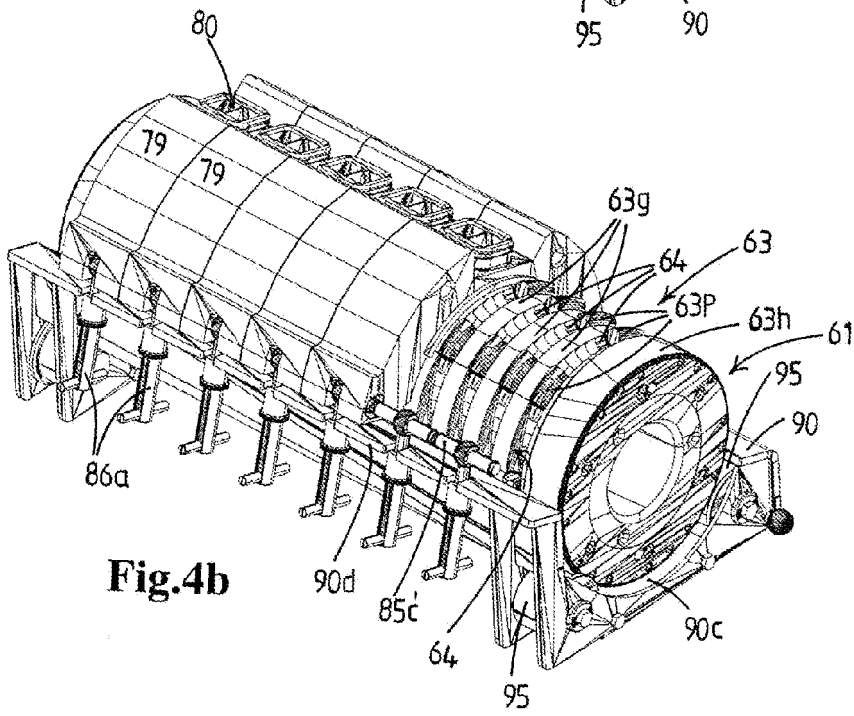

**Fig.4b**

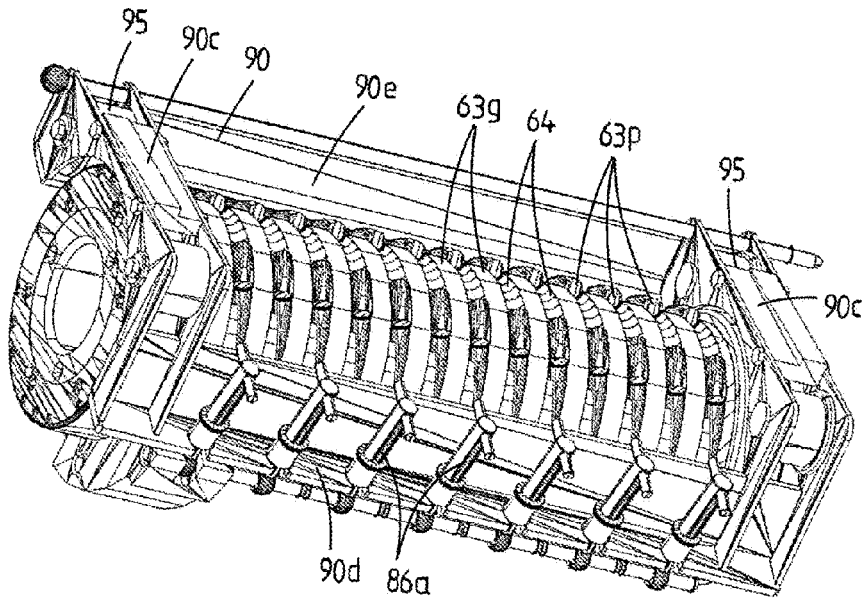

**Fig.4c**

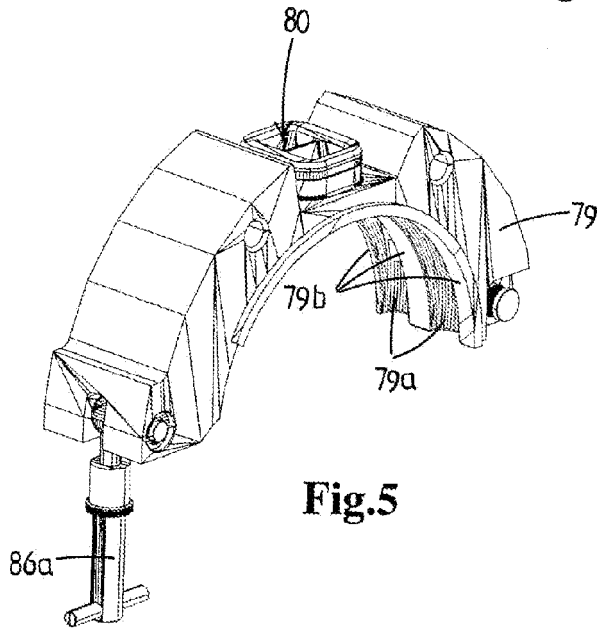

**Fig.5**