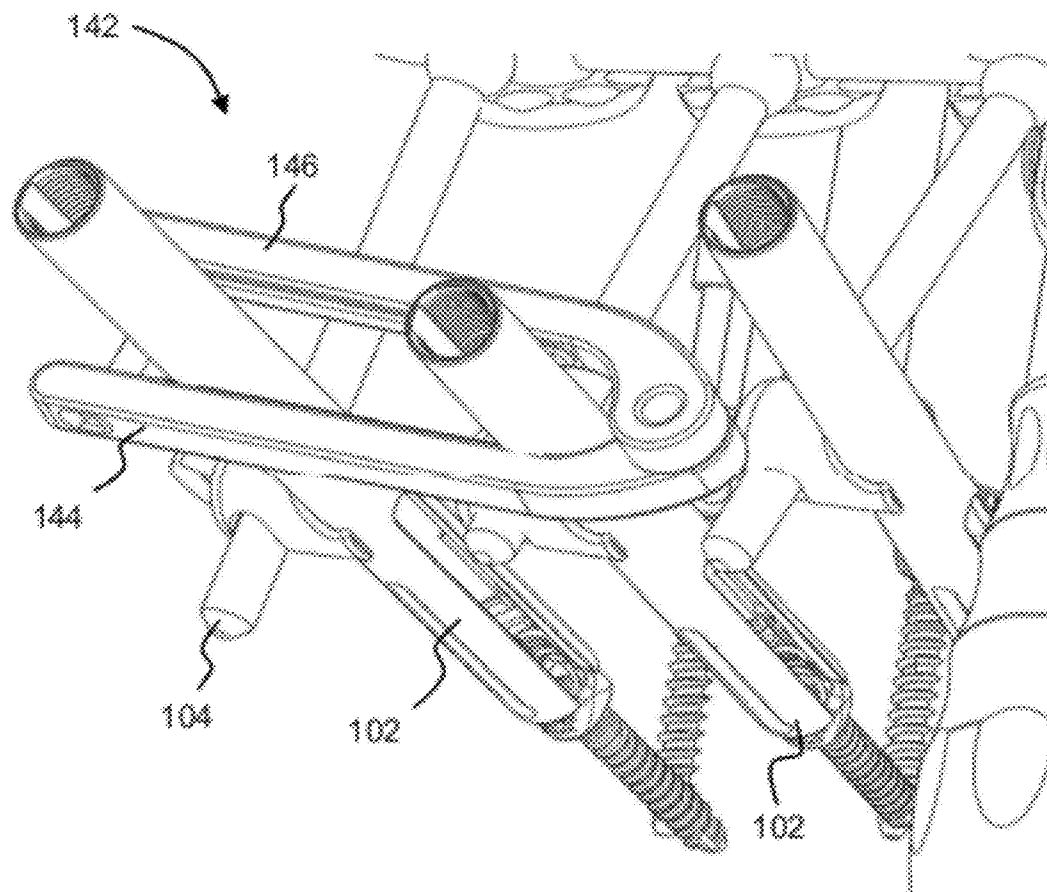


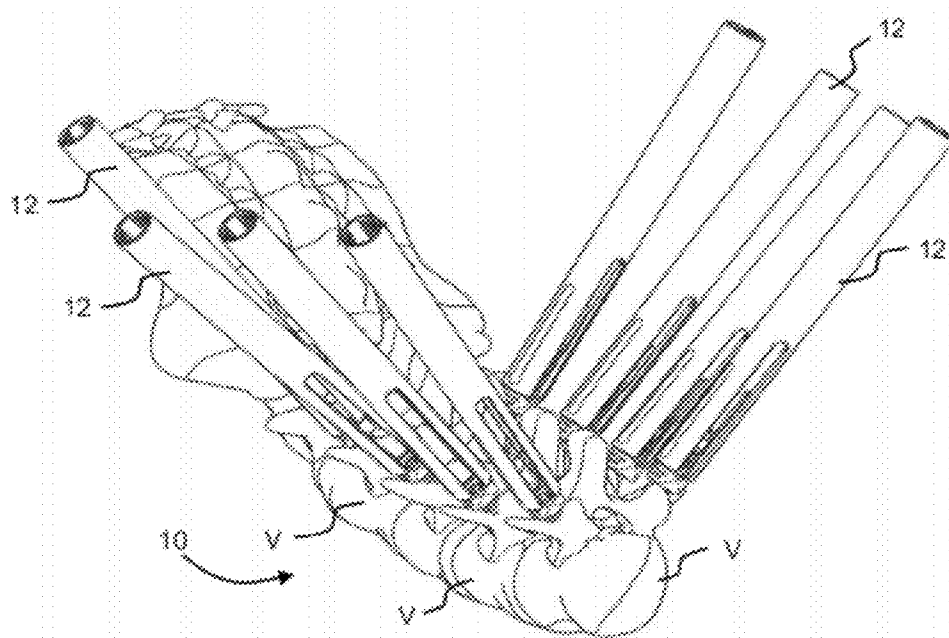


US 20120203279A1

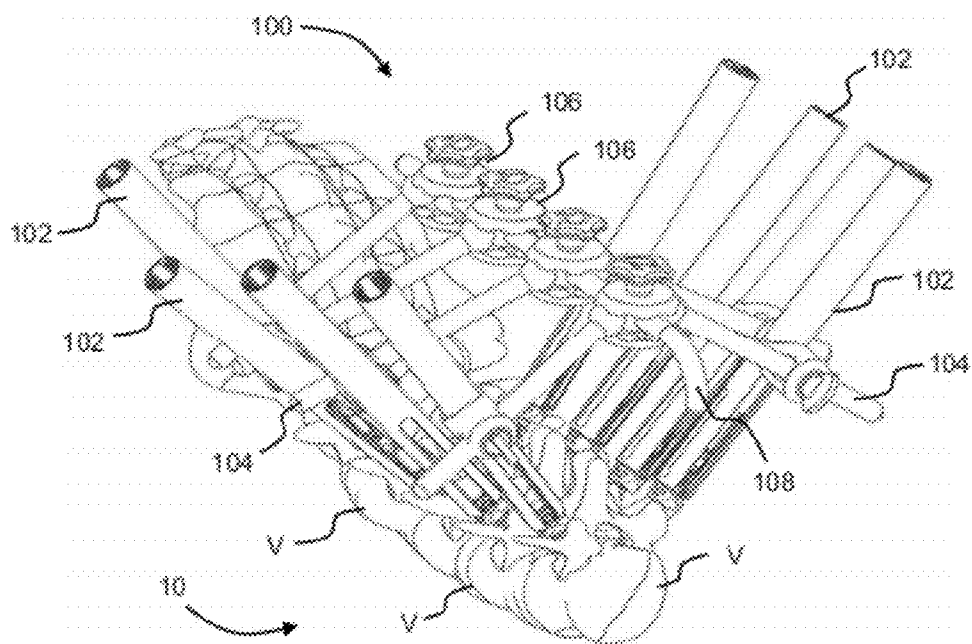
(19) **United States**(12) **Patent Application Publication**  
**Walters et al.**(10) **Pub. No.: US 2012/0203279 A1**(43) **Pub. Date: Aug. 9, 2012**(54) **SYSTEMS AND METHODS FOR  
CORRECTING SPINAL DEFORMITIES****Publication Classification**(75) Inventors: **Carmen Walters**, Carlsbad, CA  
(US); **Ketchen Smith**, Escondido,  
CA (US); **Benjamin Wang**,  
Carlsbad, CA (US)(51) **Int. Cl.**  
**A61B 17/70** (2006.01)  
**A61B 17/88** (2006.01)(52) **U.S. Cl.** ..... **606/252; 606/251; 606/279**(73) Assignee: **Alphatec Spine, Inc.**, Carlsbad, CA  
(US)(57) **ABSTRACT**(21) Appl. No.: **13/367,602**(22) Filed: **Feb. 7, 2012****Related U.S. Application Data**(60) Provisional application No. 61/440,640, filed on Feb.  
8, 2011.

An exemplary system for correcting a spinal deformity includes a plurality of transverse rods, a longitudinal rod, and at least one node. The plurality of transverse rods each includes a first end for coupling with an extension member of a spinal fixation system and a second end. The longitudinal rod extends transverse to the transverse rods. The at least one node receives the second ends of first and second transverse rods and the longitudinal rod within a receiving portion and an adjustment member selectively secures the second ends.

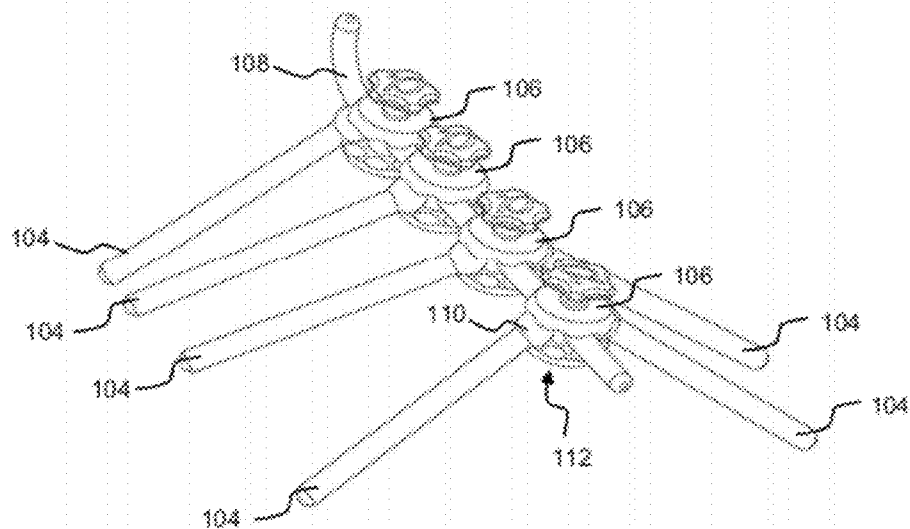




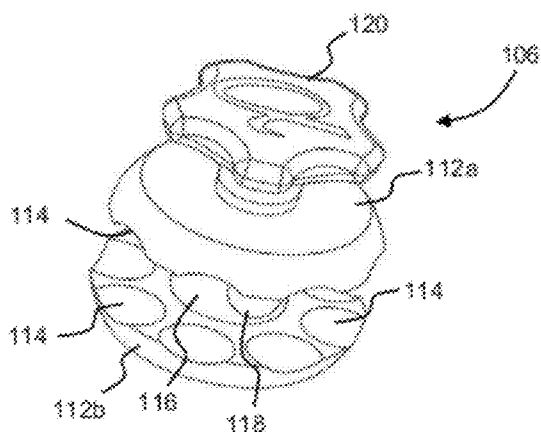
**FIG. 1**



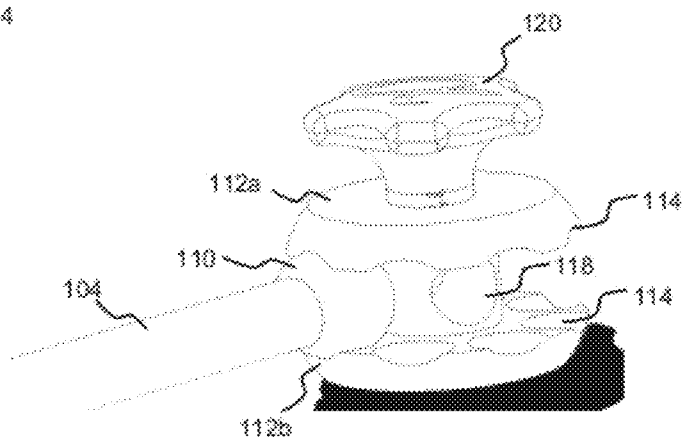
**FIG. 2**



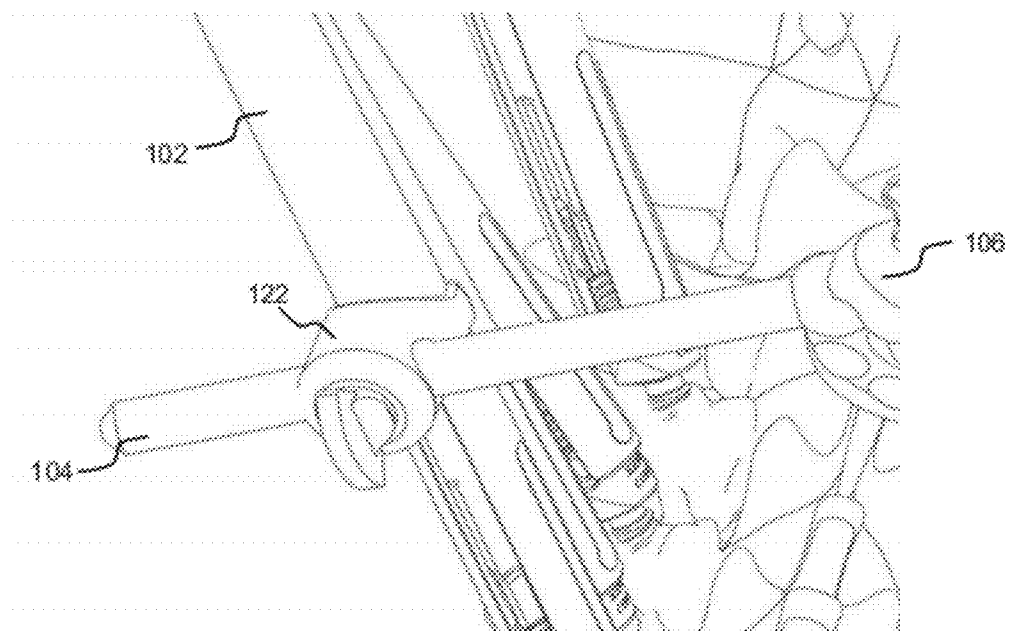
**FIG. 3**



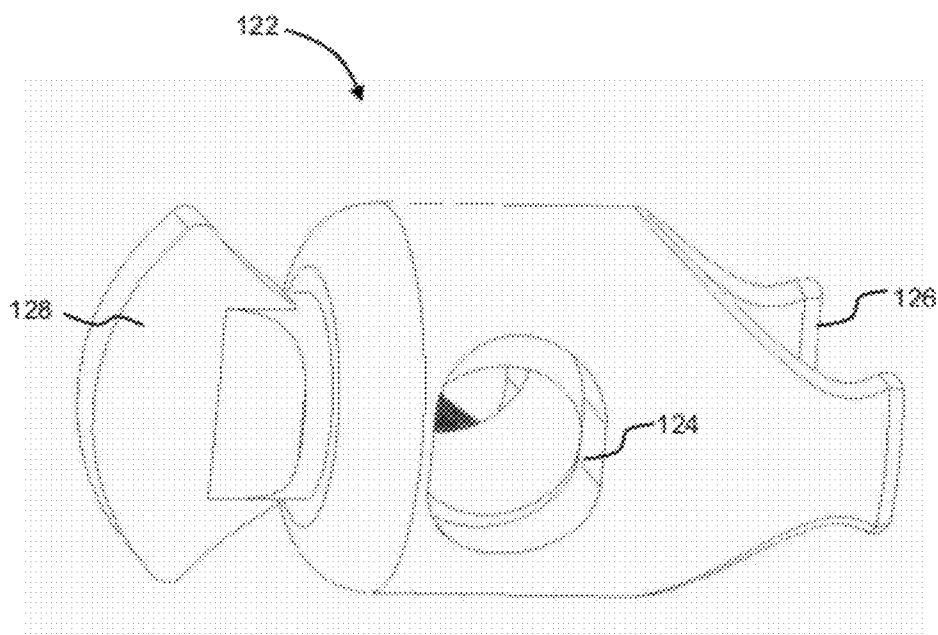
**FIG. 4A**



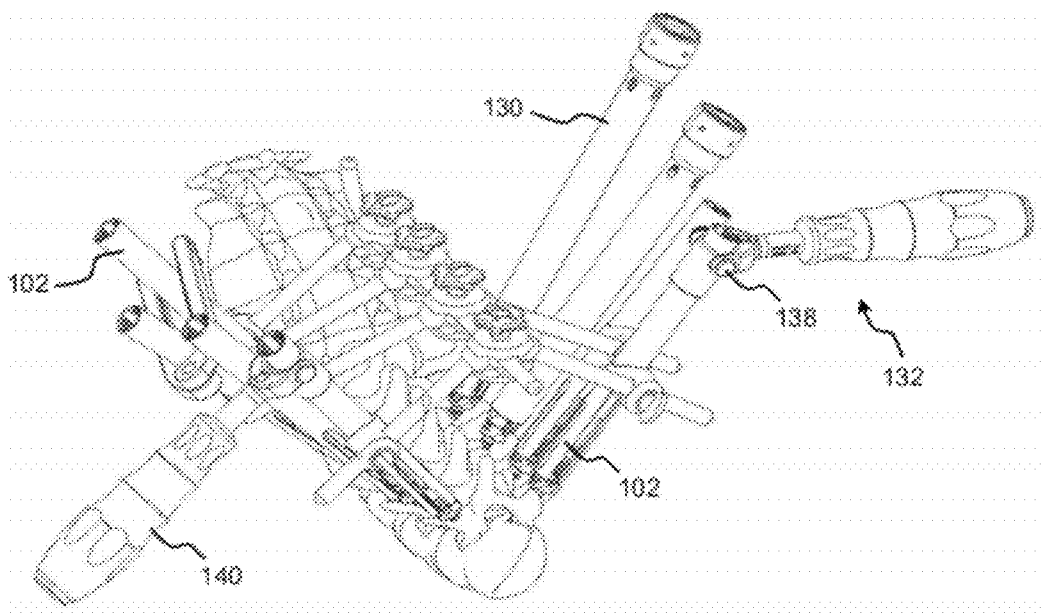
**FIG. 4B**



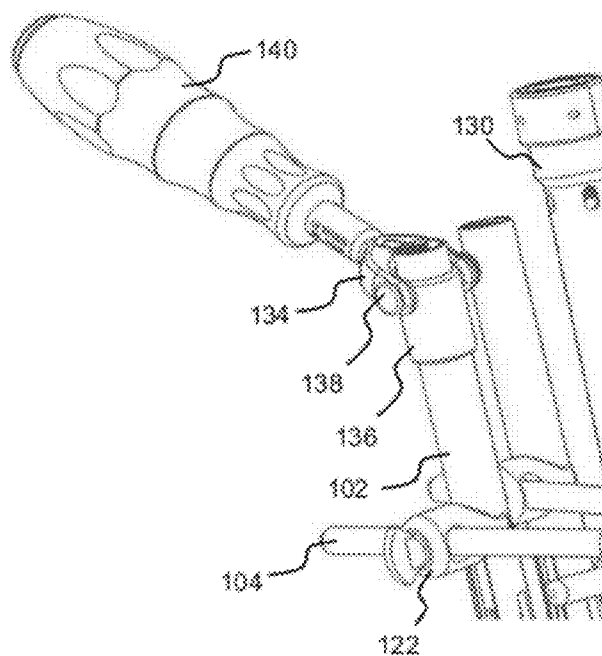
**FIG. 5A**



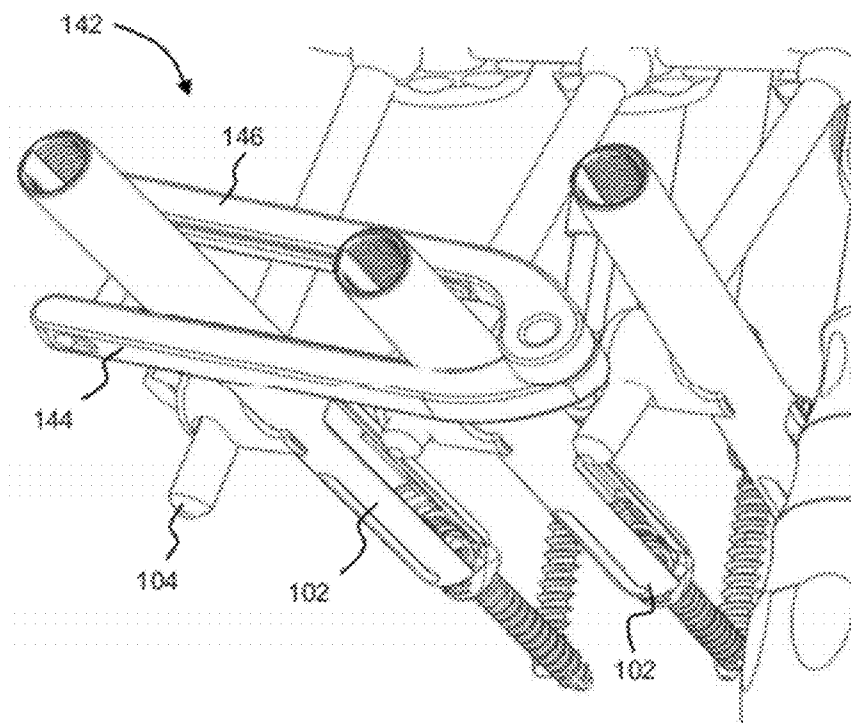
**FIG. 5B**



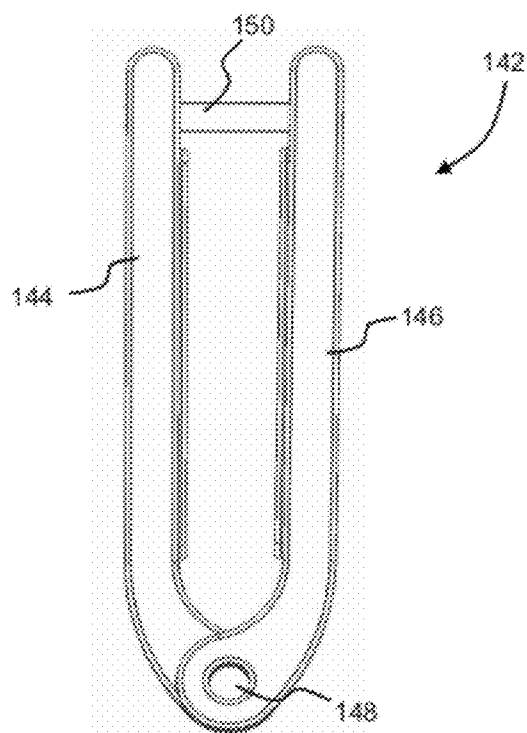
**FIG. 6A**



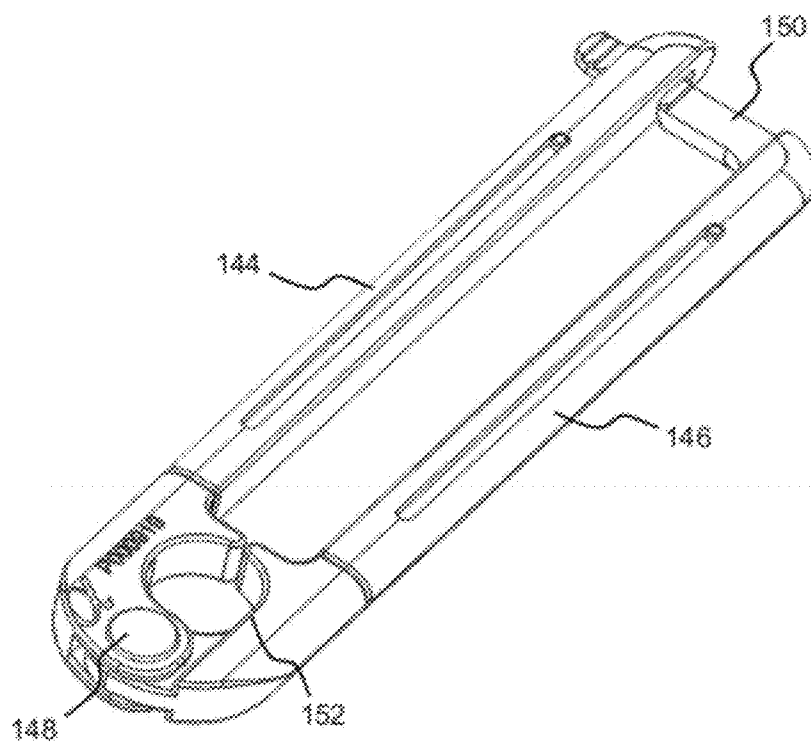
**FIG. 6B**



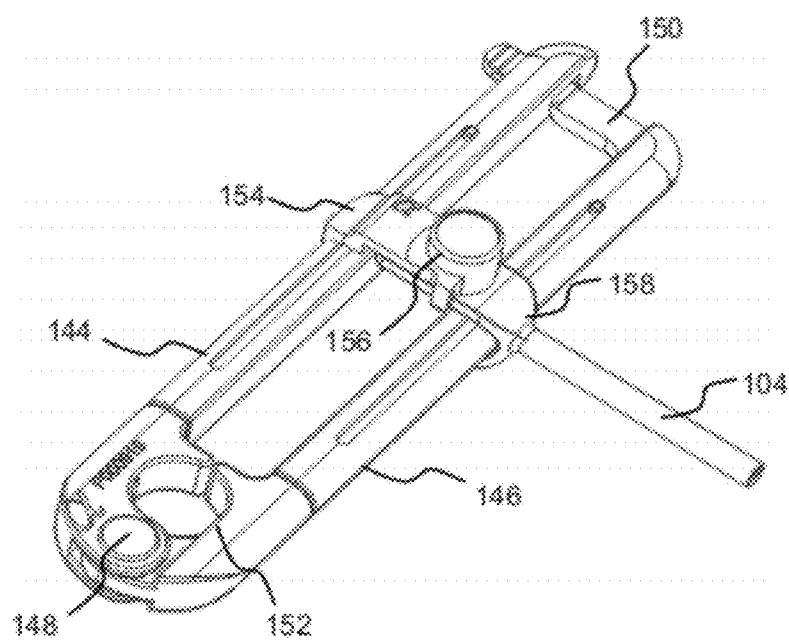
**FIG. 7A**



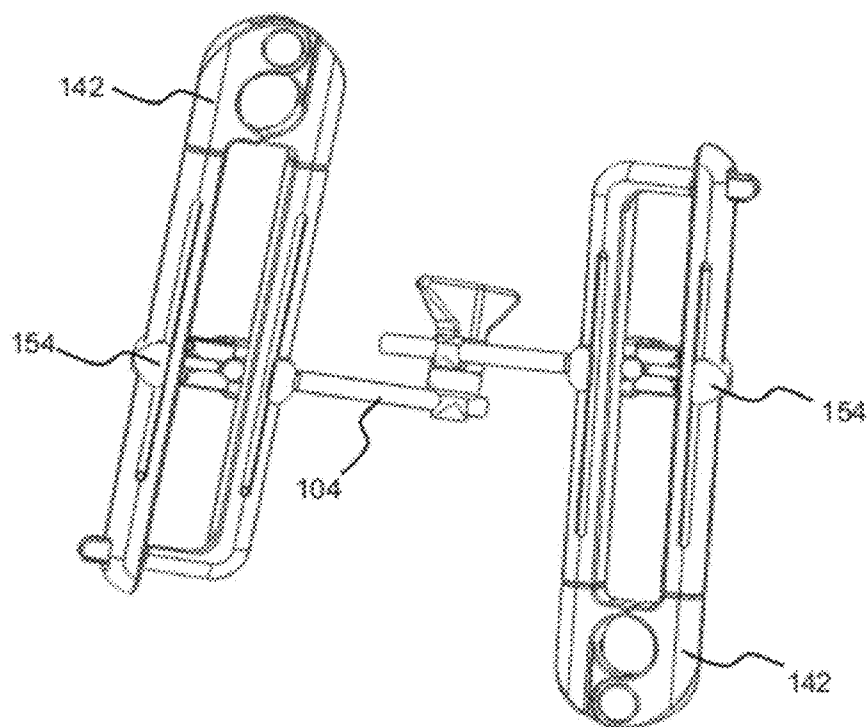
**FIG. 7B**



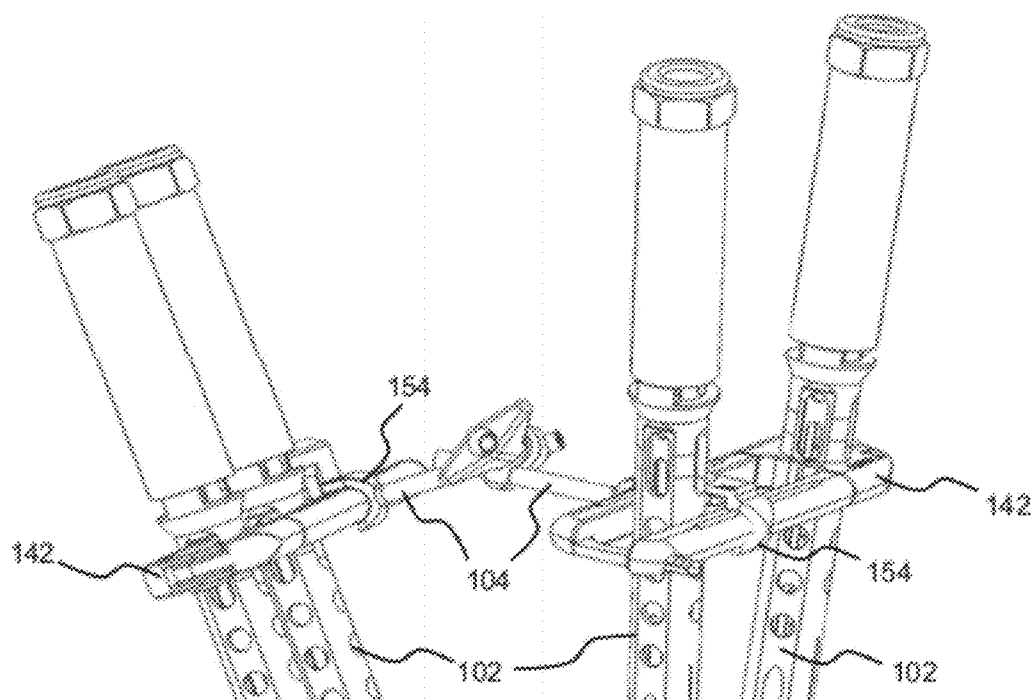
**FIG. 8A**



**FIG. 8B**

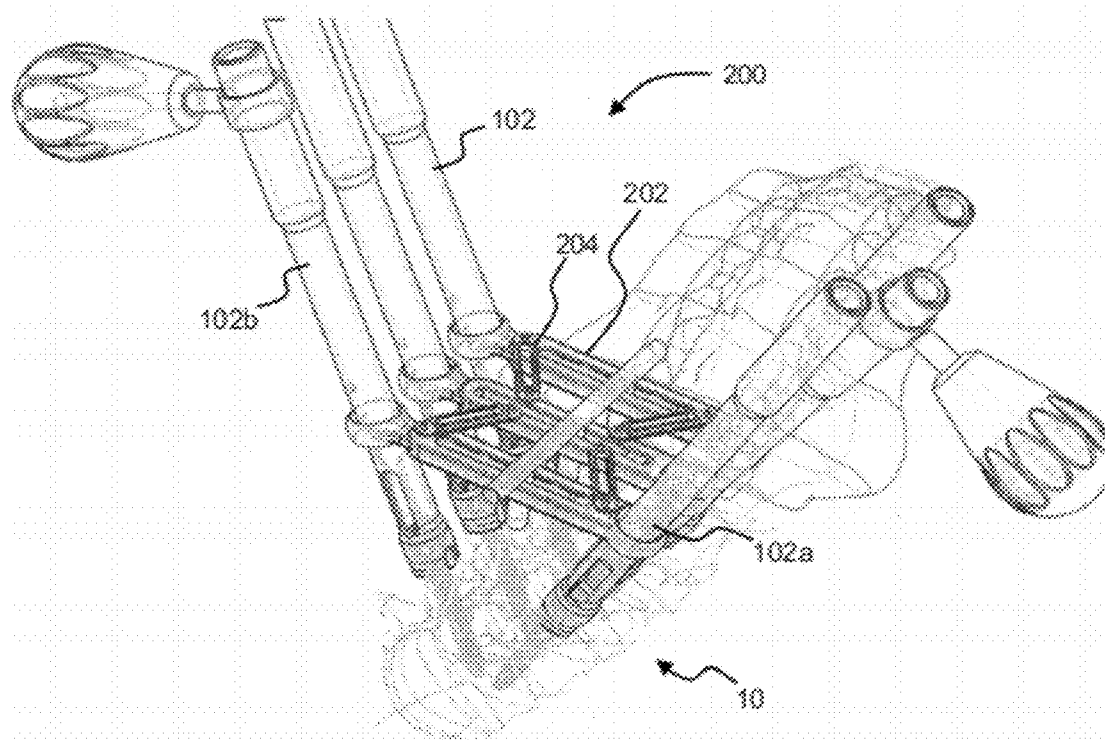


**FIG. 9A**

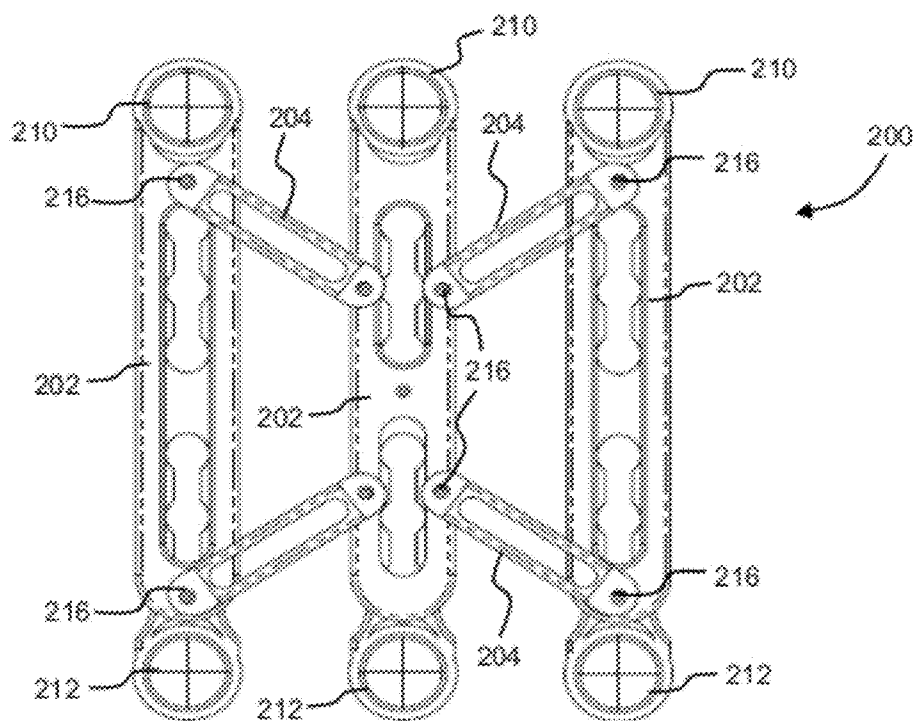


**FIG. 9B**

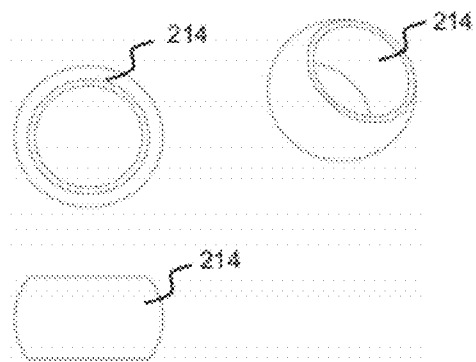




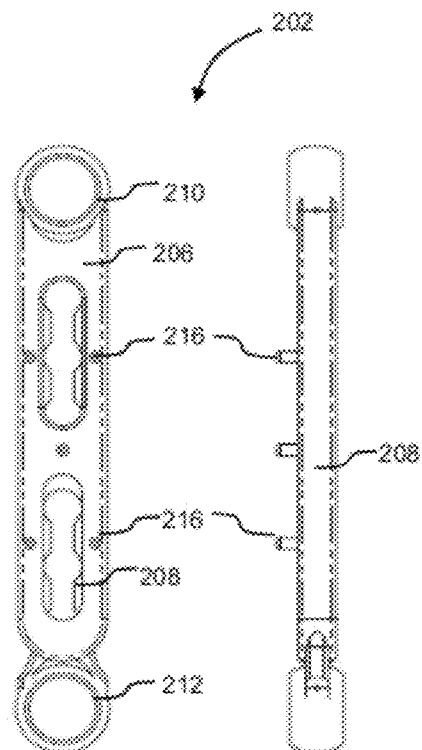
**FIG. 10**



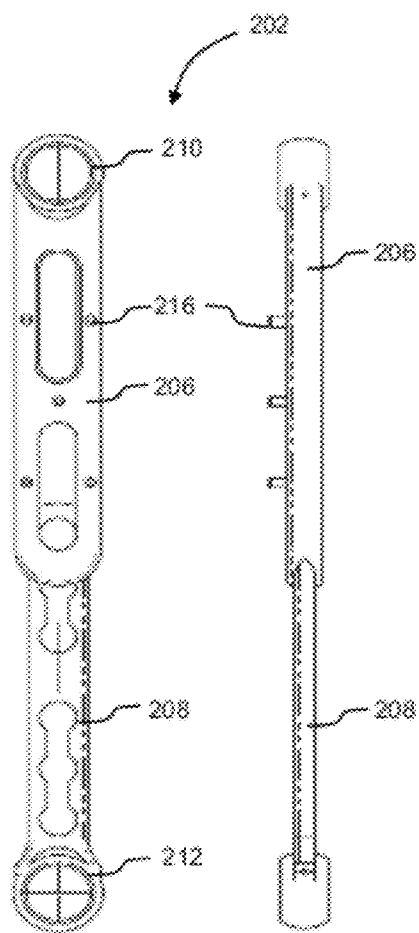
**FIG. 11**



**FIG. 12**



**FIG. 13**



**FIG. 14**

## SYSTEMS AND METHODS FOR CORRECTING SPINAL DEFORMITIES

### CROSS-REFERENCE TO RELATED APPLICATIONS

**[0001]** This application claims priority to U.S. Provisional Application Ser. No. 61/440,640 filed on Feb. 8, 2011 and incorporated herein by reference in its entirety.

### FIELD

**[0002]** The present disclosure generally relates to the field of spinal orthopedics, and more particularly to systems and methods for correcting spinal deformities.

### BACKGROUND

**[0003]** The spine is a series of individual bones called vertebrae, separated by cartilaginous disks. The spine includes seven cervical (neck) vertebrae, twelve thoracic (chest) vertebrae, five lumbar (lower back) vertebrae, and the fused vertebrae in the sacrum and coccyx that help to form the hip region. While the shapes of individual vertebrae differ among these regions, each is essentially a short hollow tube containing the bundle of nerves known as the spinal cord. Individual nerves, such as those carrying messages to the arms or legs, enter and exit the spinal cord through gaps between vertebrae. The spinal disks act as shock absorbers, cushioning the spine, and preventing individual bones from contacting each other. Disks also help to hold the vertebrae together. The weight of the upper body is transferred through the spine to the hips and the legs. The spine is held upright through the work of the back muscles, which are attached to the vertebrae. While the normal spine has no side-to-side curve and rotational misalignment, it does have a series of front-to-back curves, giving it a gentle "S" shape. If the proper shaping and/or curvature are not present due to scoliosis, neuromuscular disease, cerebral palsy, or other disorder, it may be necessary to straighten or adjust the spine into a proper curvature and alignment.

**[0004]** Generally the correct curvature and alignment are obtained by manipulating the vertebrae into their proper position and securing that position with screws and rods. The rods which are shaped to mimic the correct curvature and force the spine into proper alignment. Bone grafts are then placed between the vertebrae to aid in fusion of the individual vertebrae together to form a correctly aligned spine.

**[0005]** Spinal deformity correction procedures can require complex anatomical manipulation to restore proper anatomic form to the patient. Currently, some systems have non-linkable tubes with handles to perform vertebral column manipulation (VCM). VCM with a rotational force applied on bone anchors in the coronal plane (medial-laterally) is referred to as "derotation". Because correction of a large, complex 3-dimensional spinal deformity can exert a high stress concentration on the bone anchor element and anatomy, forces should be distributed between multiple levels and multiple bone anchors in order to reduce the occurrence of anatomical damage (i.e. screw breach through the vertebrae).

### SUMMARY

**[0006]** An exemplary system for correcting a spinal deformity includes a plurality of transverse rods, a longitudinal rod, and at least one node. The plurality of transverse rods each includes a first end for coupling with an extension mem-

ber of a spinal fixation system and a second end. The longitudinal rod extends transverse to the transverse rods. The at least one node receives the second ends of first and second transverse rods and the longitudinal rod within a receiving portion and an adjustment member selectively secures the second ends.

**[0007]** In other features, another node receives the second ends of third and fourth transverse rods and the longitudinal rod within another receiving portion and another adjustment member selectively secures the second ends. Each second end includes a rounded portion that pivots within a receiving portion of the node that includes one or more rounded recesses configured to receive the rounded portion. The adjustment member provides clamping force on an upper portion and a lower portion of the receiving portion to secure the transverse rods. Each first end includes a linking member that couples with the extension member. The linking member includes a first aperture that receives the first end and a second aperture that couples with the extension member.

**[0008]** In still other features, an alignment clip includes a pair of arms that extends around a first extension member of a first vertebral level and a second extension member of a second vertebral level to enable simultaneous movement of the first and second vertebral levels. The alignment clip includes an aperture for receiving one of the first extension member and the second extension member. The alignment clip includes a pin at a first end and a locking mechanism at a second end that selectively locks the pair of arms together. An inter-level connector includes a first coupling mechanism that attaches to the pair of arms and a second coupling mechanism for attachment to each first end of the transverse rods.

**[0009]** Another exemplary system for correcting a spinal deformity includes a plurality of transverse links and a plurality of linking arms. Each transverse link includes an adjustable length, a plurality of attachment points along the adjustable length, and first and second apertures for receiving first and second extension members of a spinal fixation system. Each linking arm includes a first mating feature that attaches to a first attachment point of a first transverse link and a second mating feature that attaches to a second attachment point of a second transverse link.

**[0010]** In other features, each transverse link includes a first plate that slidably receives a second plate. Each linking arm attaches to adjacent first and second transverse links. Each of the first and second apertures includes a rounded inner surface configured to receive a sleeve having a mating rounded outer surface. The attachment points and mating features include at least one of a peg, a pin, a slot, and an aperture.

**[0011]** An exemplary method of correcting a spinal deformity includes coupling a first end of a first transverse rod with a first extension member of a first vertebral level of a spinal fixation system, coupling a first node with a second end of the first transverse rod, coupling a first end of a second transverse rod with a second extension member of the first vertebral level of the spinal fixation system, and coupling the first node with a second end of the second transverse rod.

**[0012]** In other features, the method includes coupling a first end of a third transverse rod with a first extension member of a second vertebral level of the spinal fixation system, coupling a second node with a second end of the third transverse rod, coupling a first end of a fourth transverse rod with a second extension member of the second vertebral level of the spinal fixation system, and coupling the second node with a second end of the fourth transverse rod.

**[0013]** In still other features, the method includes inserting a longitudinal rod extending transversely to the transverse rods through the first node and the second node; rotating at least one of the second ends of the first, second, third, and fourth transverse rods within recesses formed in at least one of an upper portion and a lower portion of at least one of the first and second nodes; and adjusting a clamping force on the upper portion and the lower portion of at least one of the first and second nodes to secure the second ends therebetween.

#### BRIEF DESCRIPTION OF THE DRAWINGS

**[0014]** FIG. 1 is a perspective view of a screw extender system attached to a spinal column.

**[0015]** FIG. 2 is a perspective view of one example of a system for correcting spinal deformities as attached to the screw extender system according to the principles of the present disclosure.

**[0016]** FIG. 3 is a perspective view a portion of the system for correcting spinal deformities according to the principles of the present disclosure.

**[0017]** FIGS. 4A and 4B are perspective views of an exemplary node of the system for correcting spinal deformities according to the principles of the present disclosure.

**[0018]** FIGS. 5A and 5B are perspective views of an exemplary linking member of the system for correcting spinal deformities according to the principles of the present disclosure.

**[0019]** FIGS. 6A and 6B are perspective views of exemplary instruments associated with the system for correcting spinal deformities according to the principles of the present disclosure.

**[0020]** FIGS. 7A and 7B illustrate an exemplary alignment clip of the system for correcting spinal deformities according to the principles of the present disclosure.

**[0021]** FIGS. 8A and 8B illustrate another exemplary alignment clip and an inter-level connector of the system for correcting spinal deformities according to the principles of the present disclosure.

**[0022]** FIGS. 9A and 9B illustrate positioning of the alignment clips and inter-level connectors with the screw extender system according to the principles of the present disclosure.

**[0023]** FIG. 10 is a perspective view of another example of a system for correcting spinal deformities as attached to the screw extender system according to the principles of the present disclosure.

**[0024]** FIG. 11 is a top view of the system for correcting spinal deformities according to the principles of the present disclosure.

**[0025]** FIG. 12 is a sleeve of the system for correcting spinal deformities according to the principles of the present disclosure.

**[0026]** FIG. 13 is a portion of the system for correcting spinal deformities in an unexpanded position according to the principles of the present disclosure.

**[0027]** FIG. 14 is the portion of the system for correcting spinal deformities in an expanded position according to the principles of the present disclosure.

#### DETAILED DESCRIPTION

**[0028]** The systems and methods of this disclosure relate to a structural system which aids a surgeon in manipulating vertebrae in a spinal fusion procedure. Variations of the system may include one or more of the following: extension

members, extenders, transverse links, extension member remover instruments, derotation instruments, alignment clips, rod reducers, alignment nodes, transverse rods, longitudinal rods, and other components.

**[0029]** The systems and methods of the present disclosure allow a surgeon to selectively maneuver two or more vertebrae at a time. The system allows multiple vertebral levels to be coupled together both cephalad-caudally and contra-laterally. Coupling of the bone anchors allows VCM forces to be distributed across multiple levels and bone anchors thereby increasing the safety and efficacy of the deformity correction procedure. Additionally, the derotation tubes will function as axial rod reducers to allow for both active clamping onto the bone anchor element and rod reduction.

**[0030]** Embodiments of the invention will now be described with reference to the Figures, wherein like numerals reflect like elements throughout. The terminology used in the description presented herein is not intended to be interpreted in any limited or restrictive way, simply because it is being utilized in conjunction with detailed description of certain specific embodiments of the invention. Furthermore, embodiments of the invention may include several novel features, no single one of which is solely responsible for its desirable attributes or which is essential to practicing the invention described herein. The words proximal and distal are applied herein to denote specific ends of components of the instrument described herein. A proximal end refers to the end of an instrument nearer to an operator of the instrument when the instrument is being used. A distal end refers to the end of a component further from the operator and extending towards the surgical area of a patient and/or the implant.

**[0031]** Referring to FIG. 1, a portion of an exemplary spinal column 10 is shown. The spinal column 10 includes numerous vertebrae V including, lumbar, thoracic, and cervical vertebrae. Although the portion depicted primarily includes vertebrae of the lumbar region, the present disclosure relates systems and methods for any region of the spinal column 10. The vertebrae V are instrumented with screws (not shown) and extension members 12 such as screw extenders, derotation towers, and the like as known in the art. The extension members 12 may function as derotation tubes or extension members to provide leverage to align the vertebrae and facilitate insertion of fixation rods. Exemplary screws and extender systems may be found in U.S. Patent Pub. No. 2010/0036443. The screws may include polyaxial screws having threaded shafts and rounded heads. The screws may be attached to the pedicles of the vertebrae and polyaxial body members attached to the heads. The body members receive the fixation rods to rigidly secure the vertebrae for fusion. The extension members 12 may removably attach to the body members of the screws and provide leverage to manipulate the vertebrae prior to fusion. The extension members 12 may also include slots for insertion of the fixation rods.

**[0032]** As shown in FIGS. 1 and 2, in one embodiment, a system 100 for alignment of the spine 10 may be used with one or more screws installed in the pedicles of the vertebral bones. In this embodiment, extension members 102 are attached to the pedicle screws. The extension members 102 may attach in various ways such as with opposing mating protrusions, clip-on, snap-on, spring-biased attachment, or threaded attachment. The extension members 102 may include the extension members 12 as described above. The

system **100** may include a plurality of transverse alignment rods **104**, a plurality of alignment nodes **106**, and a longitudinal alignment rod **108**.

[0033] Continuing now also with FIG. 3, the transverse rods **104** may be substantially cylindrical from a first end proximate to the extension members **102** to a second end proximate to the longitudinal alignment rod **108**. The second end may form an end portion **110**, such as a rounded or spherical portion, that permits rotation and pivoting of the transverse rod **104** relative to the node **106**. The alignment nodes **106** may be substantially cylindrical or spherical and include receiving portions **112** for receiving the end portions **110** of the transverse rods **104**. The longitudinal rod **108** generally runs parallel to the spine **10** and transversely to the transverse rods **104**. The longitudinal rod **108** may be a singular rod or alternate means for stabilizing and connecting the nodes **106** to make a cohesive unit from the multiple alignment nodes **106**.

[0034] Referring now to FIGS. 4A and 4B, one of the nodes **106** is shown in greater detail. The receiving portion **112** of the node **106** may include a first upper portion **112a** and a second lower portion **112b**. The receiving portion **112** may include one or more recesses **114** configured to secure the end portion **110** of the alignment rod. For example, in the present embodiment, the recesses **114** include hemispherical profiles that conform to spherical profiles of the end portion **110**. Thus, the transverse rods **104** may freely rotate due to a ball and socket joint formed by the recesses **114** and end portion **110**. A linking member **116** links the upper portion **112a** and lower portion **112b** together and may include internal springs (not shown) to bias the upper portion **112a** and lower portion **112b** apart from one another. An aperture **118** in the linking member **116** receives the longitudinal rod **108**. The longitudinal rod **108** may freely rotate within the aperture **118**. An adjustment member **120** may adjust a clamping force provided by the upper portion **114** and the lower portion **116** of the node **106** on the end portion **110**.

[0035] Each node **106** adjustably connects the longitudinal rod **108** to the transverse rods **104**. Several nodes **106** may be joined together, or in pairs, or any other desired quantity. By joining segments of nodes **106** and transverse rods **104**, the nodes **106** can rotate to accommodate differing anatomy for each level of vertebrae. As shown in FIG. 5A, the transverse rod **104** connects the extension member **102** to the alignment nodes **106**. For example, a linking member **122**, as shown also in FIG. 5B, may include a first transverse aperture **124** for receiving the transverse rod **104**. The linking member **122** may include a second extension member aperture **126** for coupling with the extension member **102**. A lock **128**, such as a toggle screw, may lock the linking member **122** along any portion of the extension member **102** as desired. The linking members **122** may be moved along the extension member **102** and also allow for the adjustable attachment of the transverse rods **104** onto the construct. The extension members **102** may be moved in any desirable locked configuration by loosening the adjustment member **120** on the node **106** and the lock **128** on the linking member **122**. In another embodiment, the transverse rods **104**, nodes **106**, linking members **122**, and longitudinal rod **108** may join multiple extension members **102**. For example, after the extension members **102** are attached to the pedicle screws, the remainder of the construct may be attached to multiple extension members **102**.

[0036] In FIGS. 6A and 6B, additional tubes **130**, such as rod reducer tubes, derotation tubes, and the like, may be

inserted over the extension members **102** as needed during a deformity correction procedure. For example, the system **100** may include a rod reducer tube to aid in the insertion of the fixation rod into the pedicle screws by persuading the fixation rod into the head of the screw. The system **100** may be configured to accommodate any of screw extenders, derotation tubes, and rod reducer tubes.

[0037] Various instruments, such as derotation instruments **132**, may removably attach to the extension members **102** and or additional tubes **130** to allow the surgeon to grasp and manipulate the joined extension members **102**. In one embodiment, the instrument **132** includes a u-shaped distal end **134** connected to a hollow sleeve **136** which rotates on pins **138** protruding from either side of the distal end **134**. The hollow sleeve **136** can be attached to the extension member **102** in any desirable manner and released by a trigger or other similar mechanism. In one particular embodiment, the sleeve **136** can be attached to the extension member **102** by sliding the sleeve **136** onto the proximal end of the extension member **102**. The surgeon may use a handle **140** to manipulate the extension member **102** as required to rotate and align the spinal column.

[0038] Occasionally, it may be beneficial to move multiple levels of vertebrae in unison to facilitate proper alignment. The system **100** may include an alignment clip **142**, as shown in FIGS. 7A and 7B, to connect at least two extension members **102** together for simultaneous manipulation. The clip **142** may include two arms **144** and **146** linked by a pin **148**. The arms **144** and **146** spread apart to be inserted around the extension members **102**. In one embodiment the clip **142** is clamped around the extension members **102** and closed with a rack and pawl locking mechanism **150**. In some embodiments, the clip **142** can be scalloped to better conform to the external shape of the extension member **102**. In another embodiment, the clip **142** can have a non-slip surface such as rubber to better grip the extension member **102**. In yet another embodiment, as shown in FIGS. 8A and 8B, the clip **142** may include an extension member aperture **152** that receives a first of the extension members **102** for building up a complete system **100**. The opening **152** may rigidly secure the clip **142** to the first extension member before connecting with a second extension member.

[0039] Sometimes, it may be beneficial to couple a transverse rod **104** at a point between two levels of adjacent vertebrae, and thus, between two adjacent extension members **102**. FIG. 8B illustrates an inter-level connector **154** that may expand around two arms **144** and **146** of the clip **142**. The inter-level connector **154** couples at any point along the two arms **144** and **146** as shown in FIG. 9A. The inter-level connector **154** may be secured to the clip **142** by any of a rack and pawl mechanism, a ratcheting mechanism, or other known coupling mechanism **156**. For example, the coupling mechanism **156** may expand the connector **154** wider than the two arms **144** and **146** to release from the clip **142**. The coupling mechanism **156** may contract the connector **154** around the two arms **144** and **146** to attach to the clip **142**. The connector **154** may be integral with the transverse rod **104**. Alternatively, the connector **154** may attach to the transverse rod **104** with a second attachment mechanism **158** such as threading, a push pin lock, or other known mechanisms for locking rods. Thus, as illustrated in FIG. 9B, the inter-level connector **154** permits placement of transverse rods **104** between adjacent levels of vertebrae and corresponding extension members **102**.

[0040] FIGS. 10-14 illustrate another embodiment of a system 200 for alignment of the spine 10 that may be used with one or more screws installed in the pedicles of the vertebral bones. As shown in FIG. 11, the system 200 comprises expandable transverse links 202 and linking arms 204. Each transverse link 202 may include a first plate 206 and a second plate 208 as shown most clearly in FIG. 14. The first plate 206 may include a first extension member aperture 210 for connection with a first one of the extension members 102a. The second plate 208 may include a second extension member aperture 212 for connection with a second one of the extension members 102b extending from an opposite side of the same vertebra. The first plate 206 and second plate 208 slide relative to one another to enable variable positioning along the height of the extension members 102. For example, the transverse link 202 may include an unexpanded configuration shown in FIG. 13 and an expanded configuration shown in FIG. 14. A sleeve 214, as shown in FIG. 12, may be disposed within the apertures 210 and 212 to facilitate various angles formed by the intersection of the transverse link 202 and the extension member 102. The sleeve 214 may form a generally spherical shape and pivot about the apertures 210 and 212 as a ball and socket joint. For example, the apertures 210 and 212 may include rounded inner surfaces corresponding to the spherical shape of the sleeve 214.

[0041] Continuing with FIGS. 10-14, the transverse links 202 may include attachment points 216 such as pins, pegs, and the like, for attachment with mating features of the linking arms 204. In the present example, the linking arms 204 include mating features such as apertures and slots 218. The attachment points 216 allow the linking arm 104 to pivotally attach to the transverse links 202. Additionally, the linking arm 204 can swivel about the attachment point 216 thereby adjusting its position in relation to the transverse links 202.

[0042] As shown in FIG. 10, in one embodiment, a desired number of extension members 102 are connected to the vertebrae by attaching to a corresponding number of bone screws. The system 200 may subsequently be attached to the extension members 102. The surgeon may pre-assemble the system 200 or add one component at a time connecting the desired number of transverse links 202 with linking arms 204 as required to properly align the spine 10. If one link 202 is added at a time, each sleeve 214 is attached to the proximal end of the extension member 102 connected to the same vertebra thereby spanning the space perpendicular to the spine. Second and subsequent transverse links 202 can be added to the system 200 with sleeves 214 attached to the proximal ends of the adjacent extension members 102. Linking arms 204 may be added between the transverse links 202 to connect each adjacent transverse link 202 to all other links 202 of the system 200.

[0043] Once the entire system 200 is assembled, the linking arms 204, plates 206 and 208, and the extension members 102 are capable of movement as one unit. Each transverse link 202 is additionally and separately lockable in its individual expanded position allowing one link 202 to be adjusted while the others remain static. After the vertebrae have been manipulated into their desired positions during the derotation procedure, the position can be secured by inserting a fixation rod into the multiple extension members 102. The rod is inserted parallel to the spine, and secured in the bone screw with a set screw. One example of the rod and set screw placement is described in U.S. Patent Pub. No. 2010/

0036443. After the rods are secured, the system 200 can then be disassembled and the surgery completed.

[0044] Example embodiments of the methods and systems of the present invention have been described herein. As noted elsewhere, these example embodiments have been described for illustrative purposes only, and are not limiting. Other embodiments are possible and are covered by the invention. Such embodiments will be apparent to persons skilled in the relevant art(s) based on the teachings contained herein. Thus, the breadth and scope of the present invention should not be limited by any of the above-described exemplary embodiments, but should be defined only in accordance with the following claims and their equivalents.

The invention claimed is:

1. A system for correcting a spinal deformity, comprising: a plurality of transverse rods, each including a first end for coupling with an extension member of a spinal fixation system and a second end; a longitudinal rod extending transverse to the transverse rods; and at least one node that receives the second ends of first and second transverse rods and the longitudinal rod within a receiving portion, wherein an adjustment member selectively secures the second ends.
2. The system of claim 1, further comprising another node that receives the second ends of third and fourth transverse rods and the longitudinal rod within another receiving portion, wherein another adjustment member selectively secures the second ends.
3. The system of claim 1, wherein each second end includes a rounded portion that pivots within a receiving portion of the node that includes one or more rounded recesses configured to receive the rounded portion.
4. The system of claim 1, wherein the adjustment member provides clamping force on an upper portion and a lower portion of the receiving portion to secure the transverse rods.
5. The system of claim 1, wherein each first end includes a linking member that couples with the extension member.
6. The system of claim 5, wherein the linking member includes a first aperture that receives the first end and a second aperture that couples with the extension member.
7. The system of claim 1, further comprising an alignment clip having a pair of arms that extend around a first extension member of a first vertebral level and a second extension member of a second vertebral level to enable simultaneous movement of the first and second vertebral levels.
8. The system of claim 7, wherein the alignment clip includes an aperture for receiving one of the first extension member and the second extension member.
9. The system of claim 7, wherein the alignment clip includes a pin at a first end and a locking mechanism at a second end that selectively locks the pair of arms together.
10. The system of claim 7, further comprising an inter-level connector including a first coupling mechanism that attaches to the pair of arms and a second coupling mechanism for attachment to each first end of the transverse rods.
11. A system for correcting a spinal deformity, comprising: a plurality of transverse links, each transverse link having an adjustable length, a plurality of attachment points along the adjustable length, and first and second apertures for receiving first and second extension members of a spinal fixation system; and a plurality of linking arms, each linking arm having a first mating feature that attaches to a first attachment point of

a first transverse link and a second mating feature that attaches to a second attachment point of a second transverse link

**12.** The system of claim **11**, wherein each transverse link includes a first plate that slidably receives a second plate.

**13.** The system of claim **11**, wherein each linking arm attaches to adjacent first and second transverse links.

**14.** The system of claim **11**, wherein each of the first and second apertures includes a rounded inner surface configured to receive a sleeve having a mating rounded outer surface.

**15.** The system of claim **11**, wherein the attachment points and mating features include at least one of a peg, a pin, a slot, and an aperture.

**16.** A method of correcting a spinal deformity, comprising: coupling a first end of a first transverse rod with a first extension member of a first vertebral level of a spinal fixation system;

coupling a first node with a second end of the first transverse rod;

coupling a first end of a second transverse rod with a second extension member of the first vertebral level of the spinal fixation system; and

coupling the first node with a second end of the second transverse rod.

**17.** The method of claim **16**, further comprising:

coupling a first end of a third transverse rod with a first extension member of a second vertebral level of the spinal fixation system;

coupling a second node with a second end of the third transverse rod;

coupling a first end of a fourth transverse rod with a second extension member of the second vertebral level of the spinal fixation system; and

coupling the second node with a second end of the fourth transverse rod.

**18.** The method of claim **17**, further comprising inserting a longitudinal rod extending transversely to the transverse rods through the first node and the second node.

**19.** The method of claim **18**, further comprising rotating at least one of the second ends of the first, second, third, and fourth transverse rods within recesses formed in at least one of an upper portion and a lower portion of at least one of the first and second nodes.

**20.** The method of claim **19**, further comprising adjusting a clamping force on the upper portion and the lower portion of at least one of the first and second nodes to secure the second ends therebetween.

\* \* \* \* \*