



US 20040076725A1

(19) **United States**

(12) **Patent Application Publication**

Hayashi et al.

(10) **Pub. No.: US 2004/0076725 A1**

(43) **Pub. Date: Apr. 22, 2004**

(54) **APPARATUS AND METHOD FOR MANUFACTURING BREAD**

Dec. 27, 2002 (JP) 2002-379492
Mar. 11, 2003 (JP) 2003-065697

(76) Inventors: **Torahiko Hayashi**, Utsunomiya (JP);
Michio Morikawa, Utsunomiya (JP);
Sadao Ueno, Utsunomiya (JP);
Hiroyuki Okaizumi, Utsunomiya (JP)

Publication Classification
(51) **Int. Cl.⁷** **A21D 6/00**
(52) **U.S. Cl.** **426/503**

Correspondence Address:
Thomas E. Sisson
JACKSON WALKER L.L.P.
Suite 2100
112 E. Pecan Street
San Antonio, TX 78205 (US)

(21) Appl. No.: **10/465,419**

(22) Filed: **Jun. 19, 2003**

(30) **Foreign Application Priority Data**

Oct. 18, 2002 (JP) 2002-304049

(57) **ABSTRACT**

A method according to this invention is comprised of a forming step to form a sheet from a block of bread dough that is kneaded from the raw materials for bread, a further forming step to form a bar-like dough by rolling or folding the sheet, a cutting step to cut the bar-like dough, and a placing step to place the bar-like pieces of dough that were cut at the cutting step into a baking mold so that at least one cutting plane faces upward.

If there are air bubbles between layers of the bar-like pieces of dough, the air bubbles can escape from a cutting surface of the bar-like pieces of dough when they rise and expand at the fermenting and baking steps.

Fig. 1

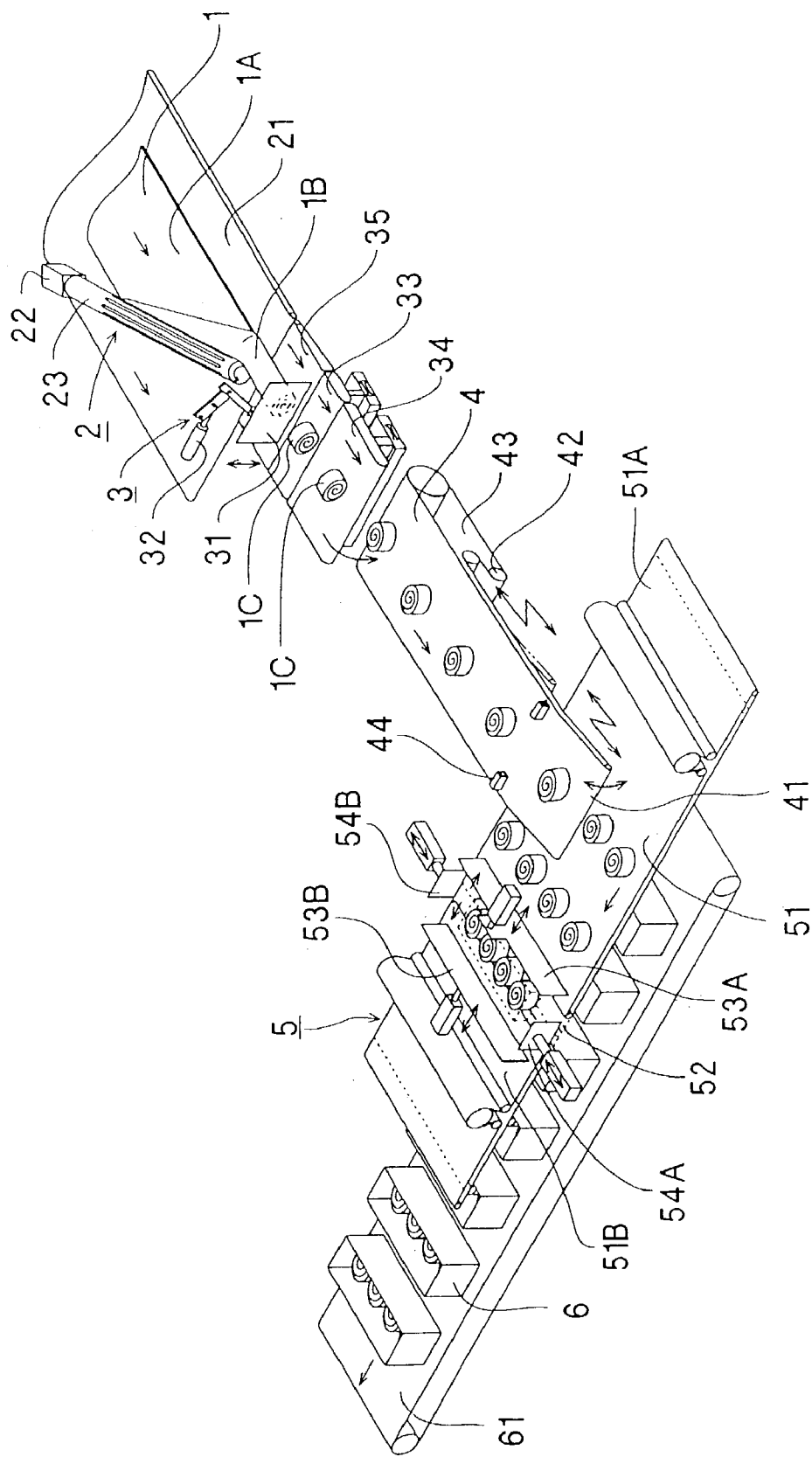

Fig. 2

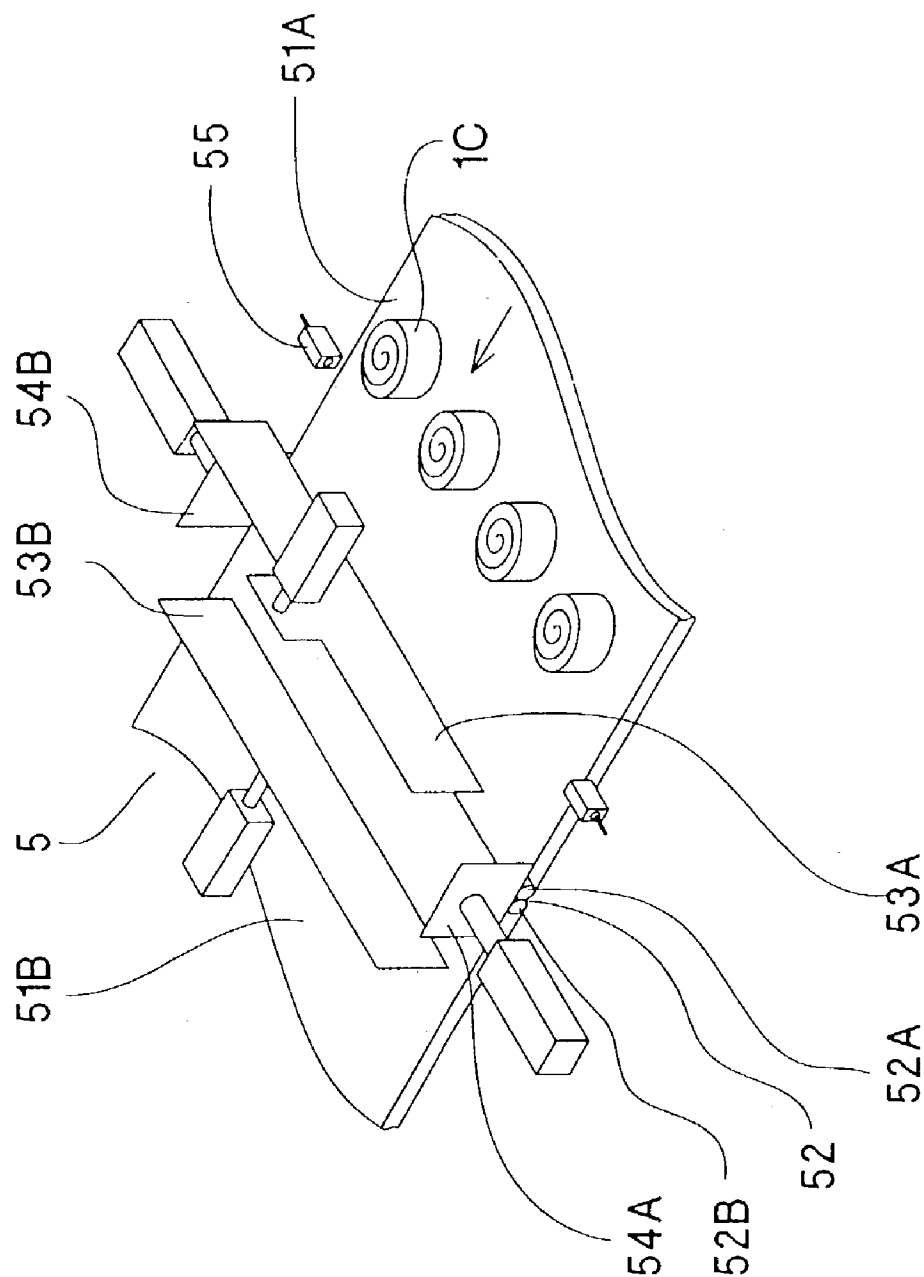

Fig. 3

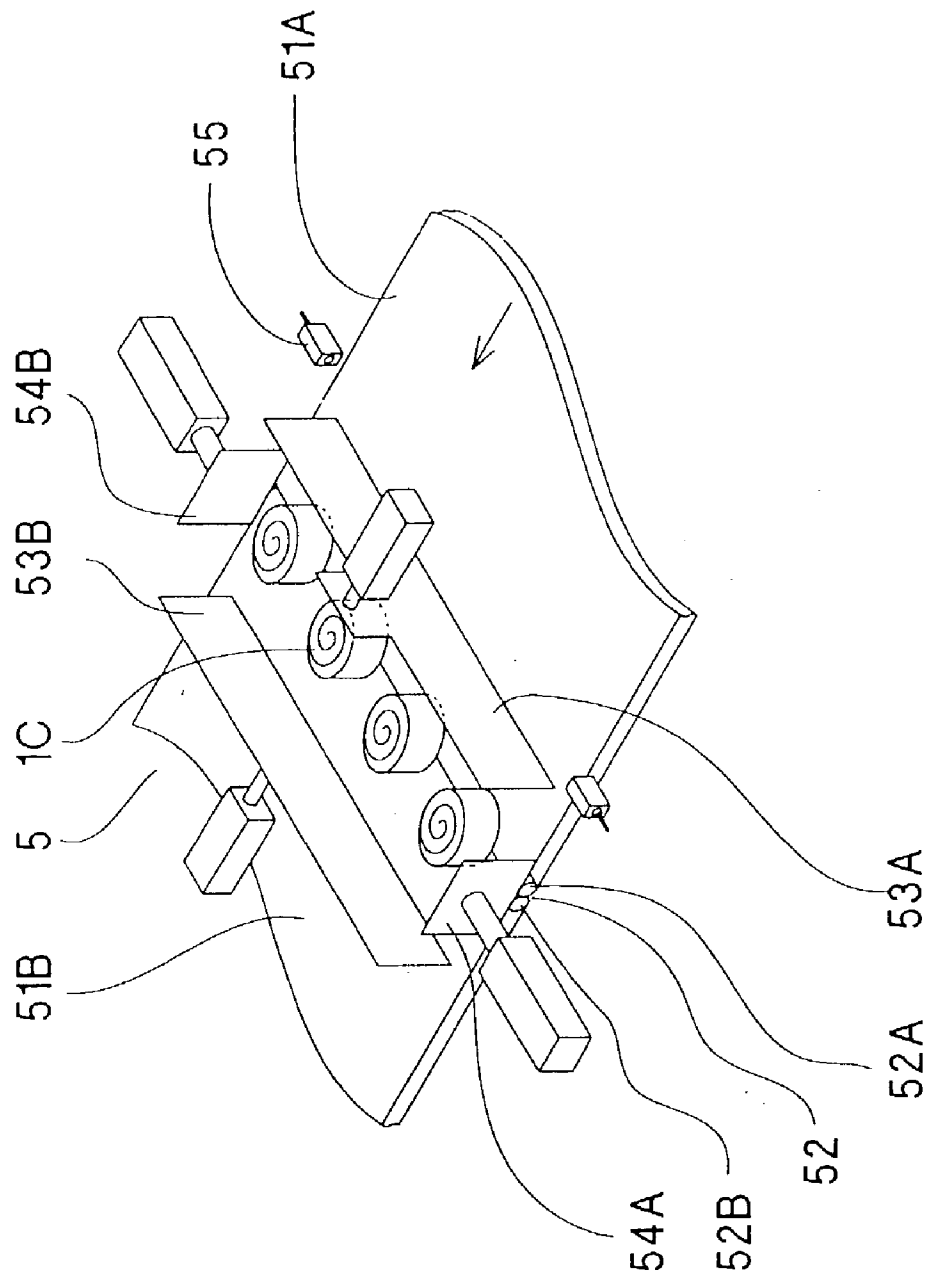

Fig. 4

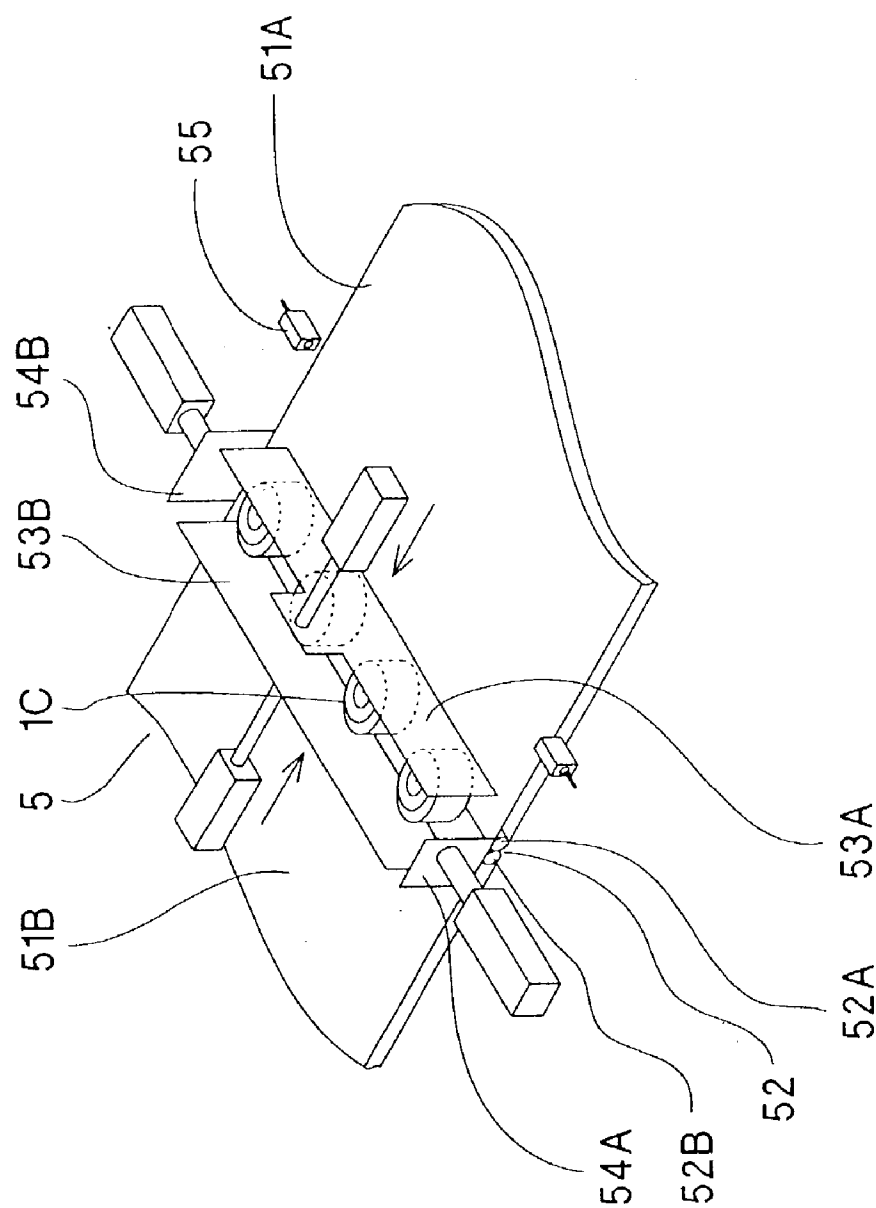

Fig. 6

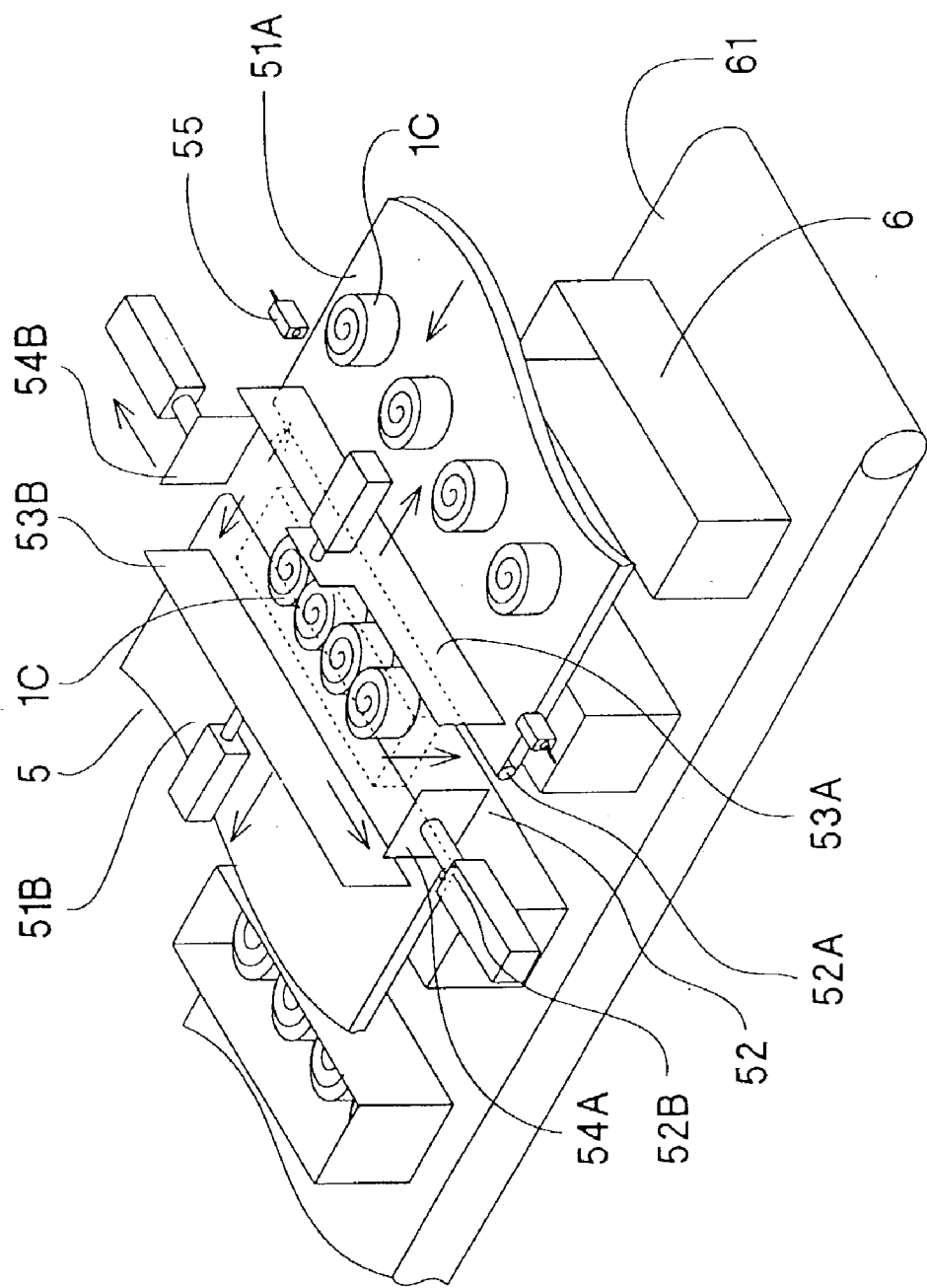

Fig. 7

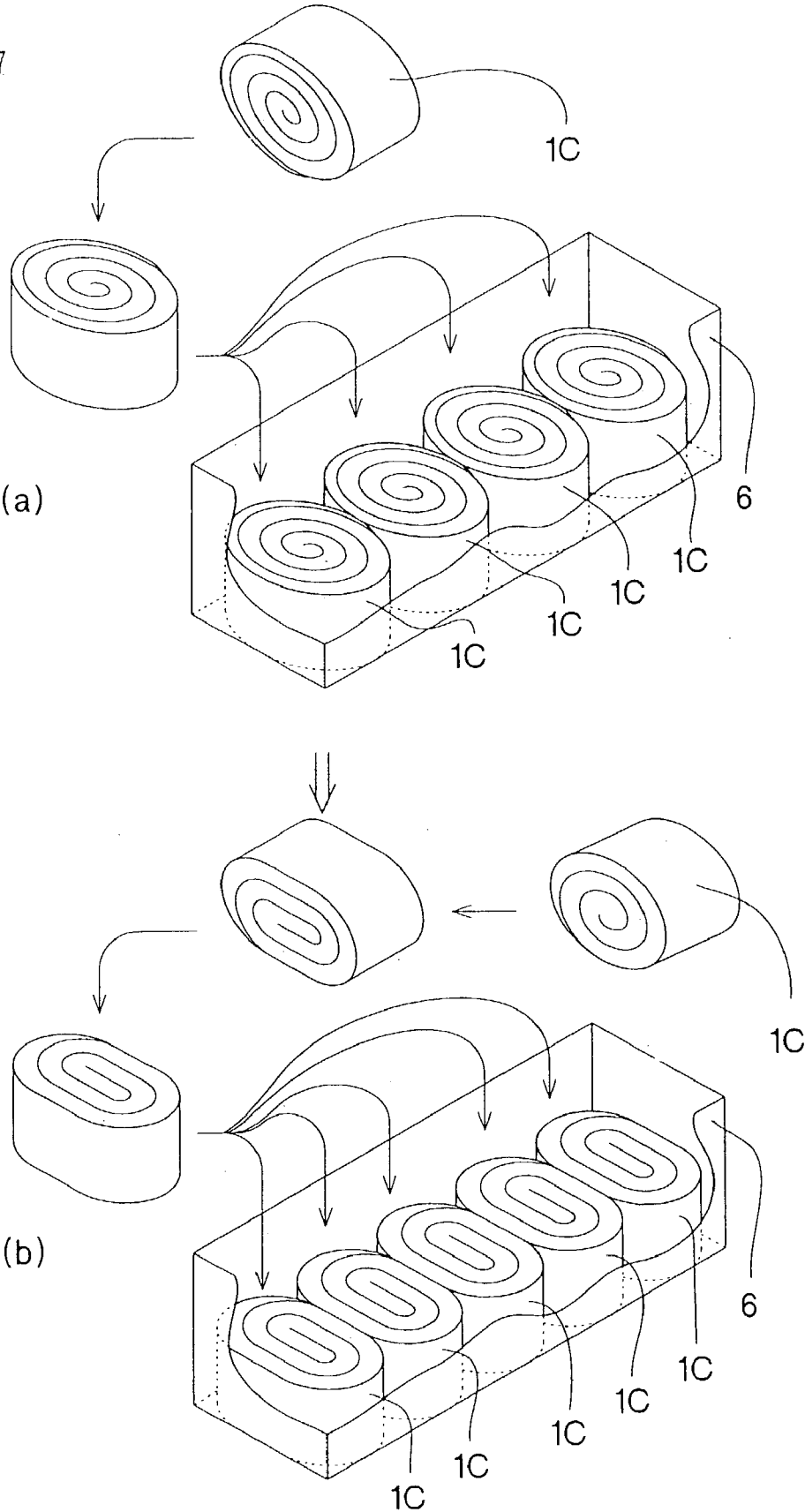

Fig. 8

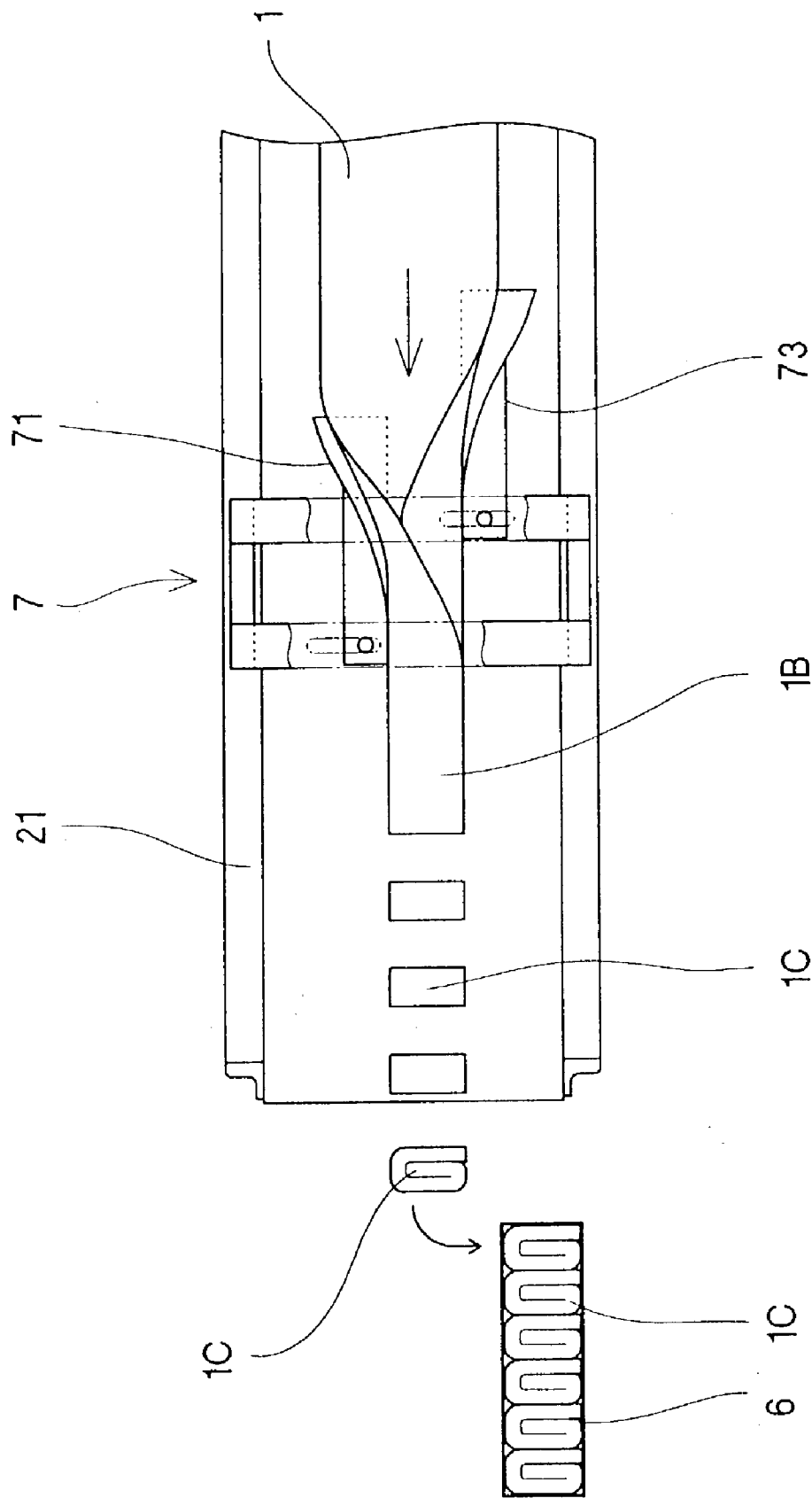

Fig. 9

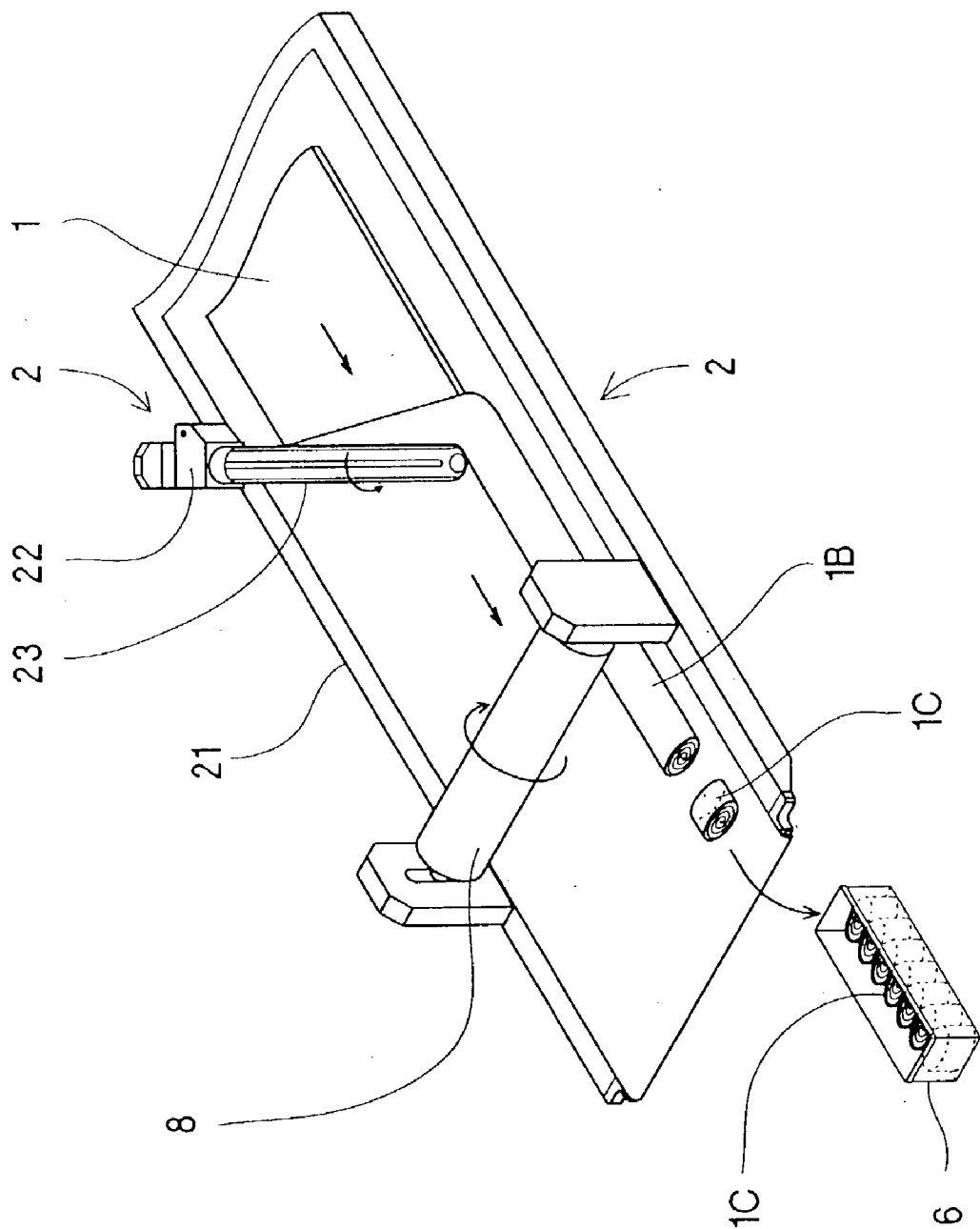

Fig. 10

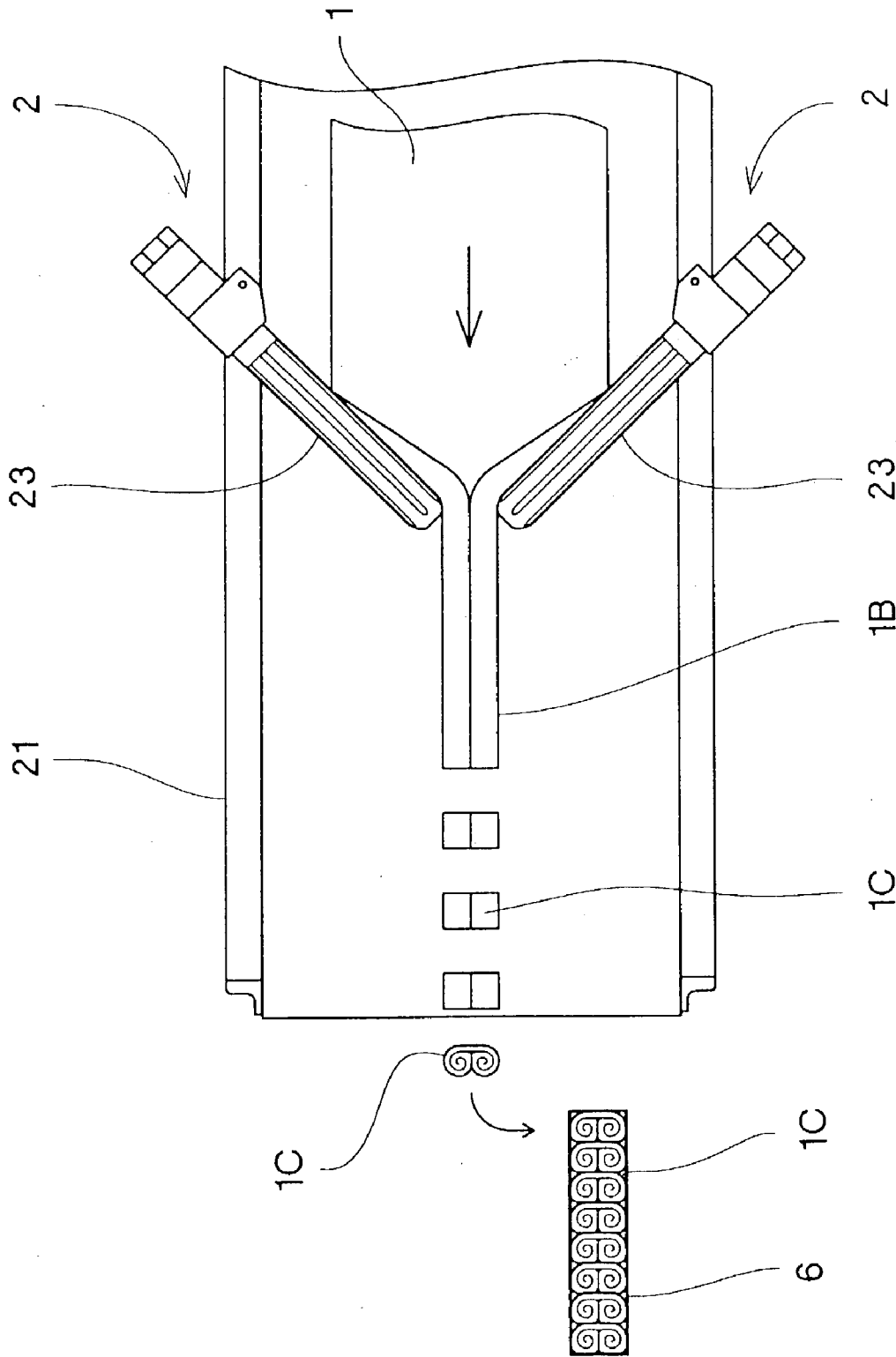

Fig. 11

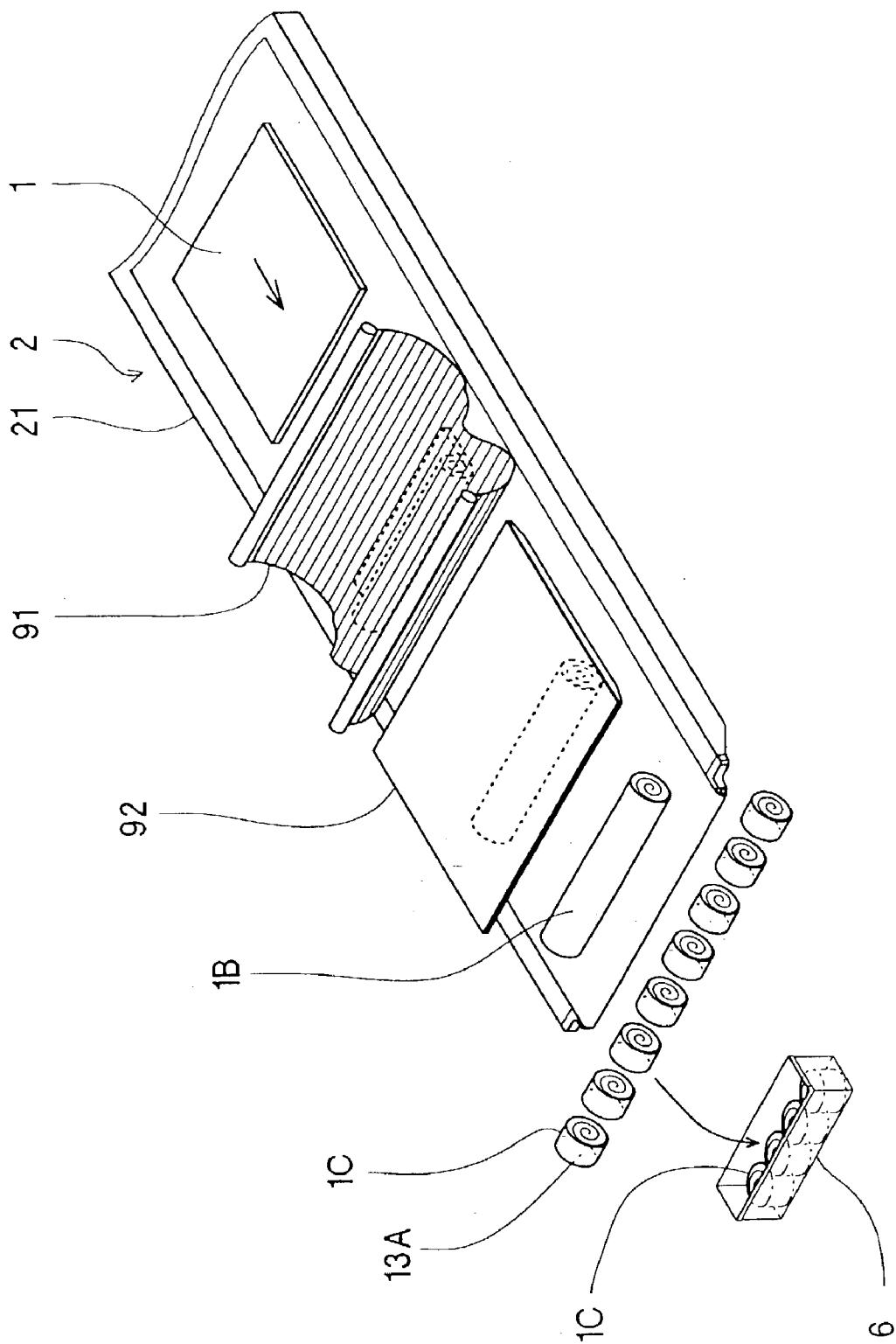

Fig. 12

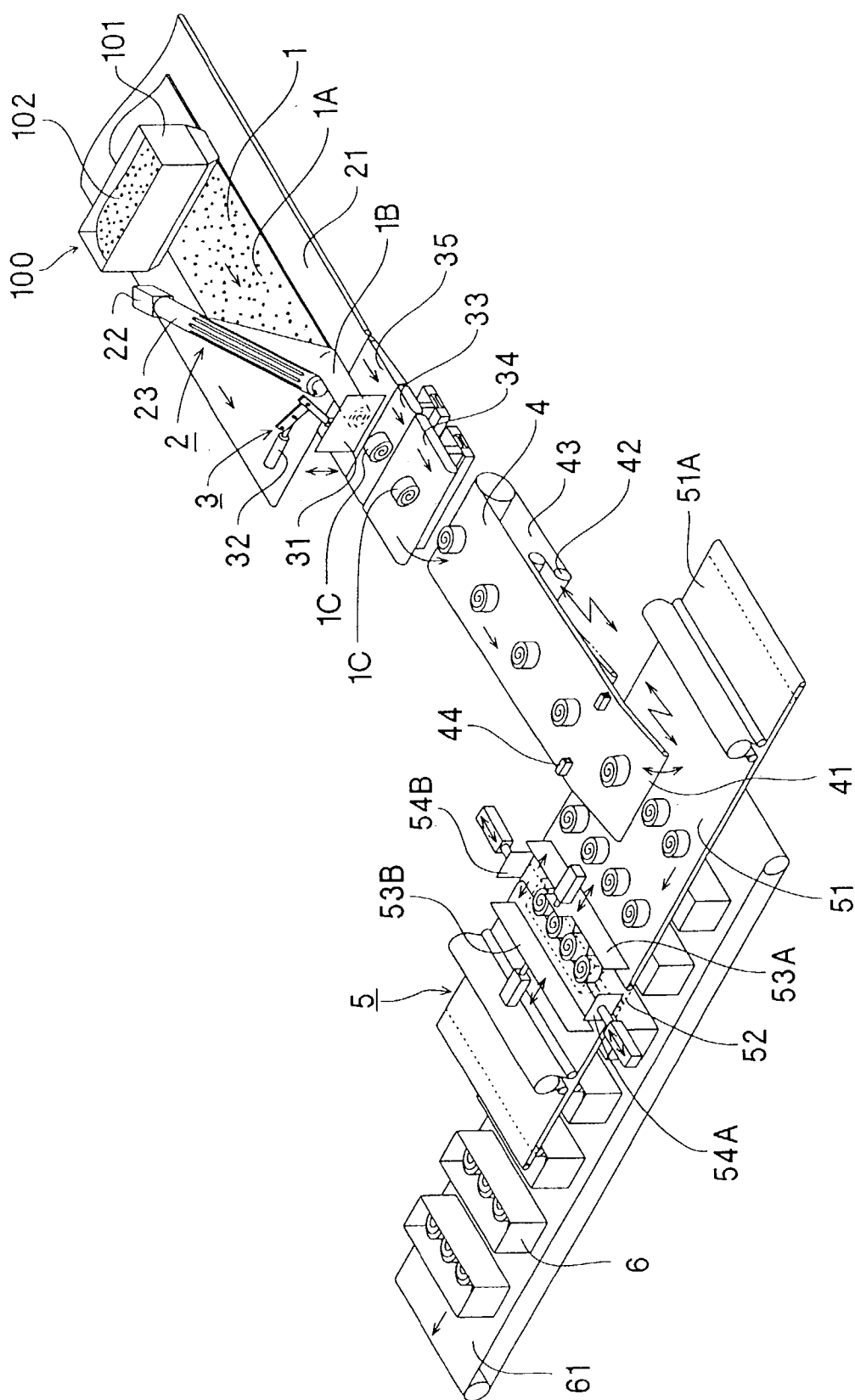
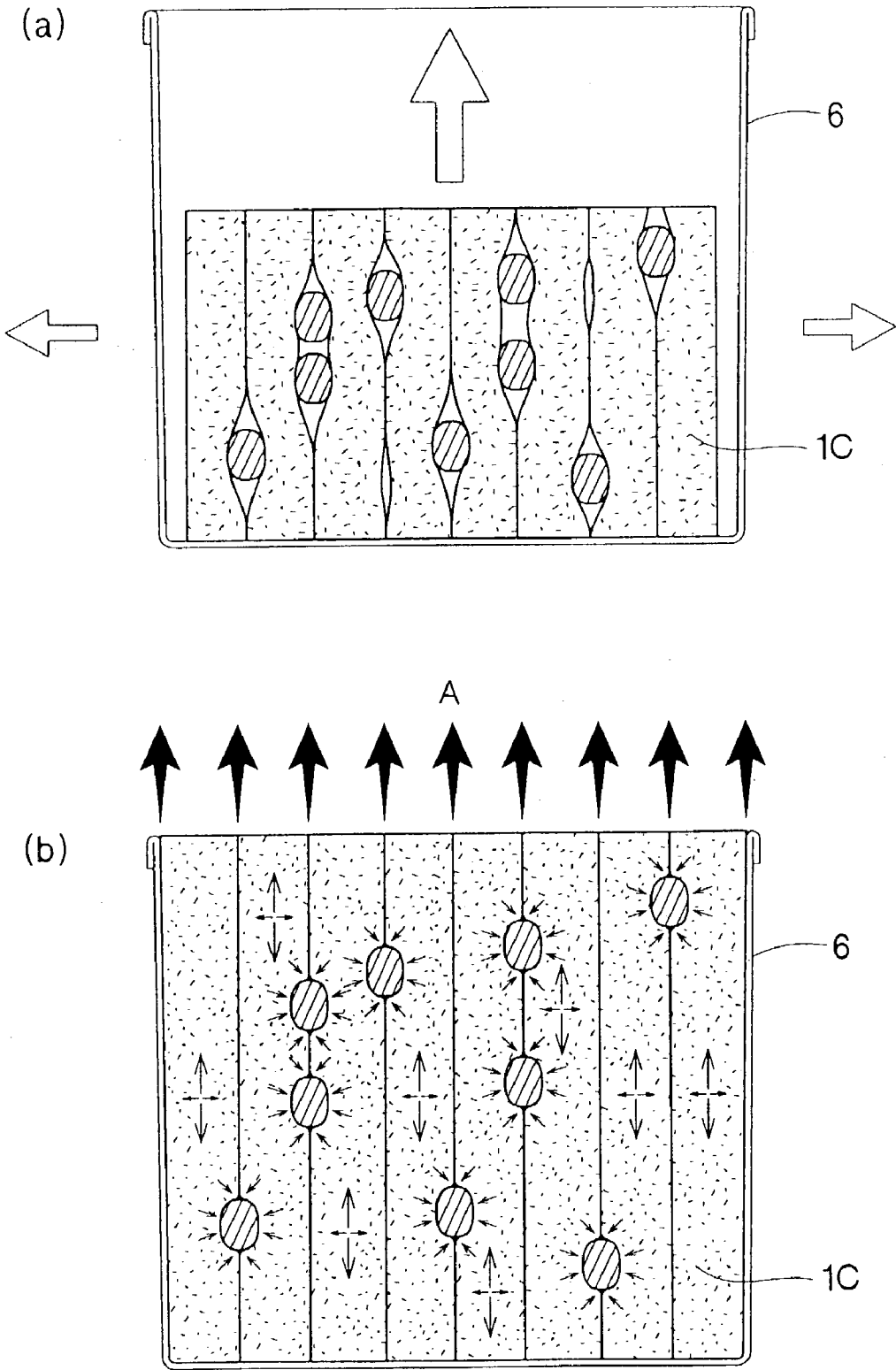

Fig. 13



APPARATUS AND METHOD FOR MANUFACTURING BREAD

TECHNICAL FIELD

[0001] This invention relates to an apparatus and a method for manufacturing bread. Particularly, it relates to an apparatus and a method for placing bread dough in a baking mold.

BACKGROUND OF INVENTION

[0002] Usually, in manufacturing bread, bread dough is cut in a suitable size and placed in a baking mold. Then it is baked in an oven after a final fermenting of the bread dough with yeast.

[0003] Generally, the quality of the internal structure of bread that is baked in an oven is dependent on the form and direction of the bread dough that is placed in a baking mold. Thus, research has been continued to improve the methods of placing bread dough.

[0004] Various placing methods are well known. For example, after a block of bread dough is extended and shaped into sheets, these sheets are rolled cylindrically (a bar-like form) by a molding machine, etc. Then, the rolled bread dough is curved and formed into a V-shape (disclosed in reference No. 1) and is placed in a baking mold. Placing methods for forming an M-shape (disclosed in reference No. 2), having an alternate placing direction for rolled bread dough (disclosed in reference No. 3), having a straight placing direction along a baking mold without any curving (disclosed in reference Nos. 4 and 5), and adding a twist to rolled bread dough (disclosed in reference No. 6) are also used so as to attain high-quality bread.

[0005] The references described above are as follows:

[0006] (1) Reference No. 1: Japanese Patent Gazette No. 61-19215. (See paragraph 7 and FIG. 1.)

[0007] (2) Reference No. 2: Japanese Utility Model Laid-open No. 60-62281. (See FIGS. 1-5.)

[0008] (3) Reference No. 3: Japanese Patent Gazette No. 8-4446. (See FIG. 10.)

[0009] (4) Reference No. 4: Japanese Patent Laid-open No. 11-127806. (See claim 1 and FIG. 2.)

[0010] (5) Reference No. 5: Japanese Patent No. 2876515. (See FIGS. 2, 3, and 4.)

[0011] (6) Reference No. 6: Japanese Patent Laid-open No. 2001-299259. (See claim 1.)

SUMMARY OF INVENTION

[0012] In the conventional technology described above, rolled bread dough is used that is formed by rolling sheets of bread dough. In this case, air bubbles may rise between layers of the rolled bread dough when layers of a formed roll are slackened or gaps are generated between them. Thus the rolled bread dough may be placed in a baking mold with the air bubbles in it.

[0013] As a result of the air bubbles in the rolled bread dough, large air holes may occur in baked bread and degrade the quality of it, because the air bubbles cannot escape from the rolled bread dough.

[0014] The present invention is intended to overcome these disadvantages and to provide manufacturing methods without any air holes being formed in the baked bread.

[0015] A method according to this invention is comprised of a conveying step to convey sheets or a continuous sheet that is formed from a block of bread dough that is kneaded from raw materials for bread, a forming step to form the sheets or the continuous sheet into a bar-like dough by rolling them in a direction transverse to them or folding them, a cutting step to cut the bar-like dough to a predetermined size, a conveying step to continuously transfer the bar-like pieces of dough that have been cut, and a placing step to place the bar-like pieces of dough in a baking mold so that at least one cutting plane faces upward, so as to solve the above problem.

[0016] Furthermore, an apparatus according to this invention is comprised of a conveyor to convey sheets or a continuous sheet that is formed from a block of bread dough that is kneaded from raw materials for bread, a forming apparatus to form the sheets or the continuous sheet into bar-like dough by rolling the sheets in a direction transverse to them or folding them, a cutting apparatus to cut the bar-like dough in a predetermined size, a conveyor to continuously transfer the bar-like pieces of dough that have been cut, and a placing apparatus to place the bar-like pieces of dough in a baking mold so that at least one cutting plane faces upward, so as to solve the above problem.

[0017] Before or during the cutting step to cut the bar-like dough, said bar-like dough may also be deformed so that it has an elliptic cross section.

[0018] The apparatus according to this invention may further be comprised of a scattering apparatus to scatter solid food particles on the sheets or the continuous sheet on the conveyor to convey them or it so that said bar-like dough includes solid food particles in it.

[0019] According to the apparatus and the method of this invention, if there are air bubbles between the layers of the bar-like dough that are rolled or folded, then as a result of placing the bar-like pieces of dough in the baking mold so that at least one cutting plane of them faces upward the air bubbles can escape from them when they rise and expand at the fermenting and baking steps. Thus the air bubbles do not remain in the bar-like pieces of dough.

[0020] As explained above, since the present invention includes the forming step to form the bar-like dough by rolling or folding the sheets of dough, includes the cutting step to cut the bar-like dough, and includes the placing step to place the bar-like pieces of dough in the baking mold so that at least one cutting plane of them faces upward, if there are air bubbles between the layers of the sheets they can easily escape from the bar-like pieces of dough, and high-quality bread may be manufactured efficiently.

BRIEF DESCRIPTIONS OF THE DRAWINGS

[0021] FIG. 1 shows a perspective view of an apparatus for manufacturing bread according to the present invention.

[0022] FIGS. 2-6 show diagrams of a placing apparatus while it is operating according to the present invention.

[0023] FIG. 7(a) shows the first embodiment placing bar-like pieces of dough of this invention.

[0024] FIG. 7(b) shows the second embodiment placing bar-like pieces of dough of this invention.

[0025] FIGS. 8-11 show another embodiment of the placing apparatus for placing bar-like pieces of dough of this invention.

[0026] FIG. 12 shows the perspective view of another apparatus for manufacturing bread according to the present invention.

[0027] FIG. 13 shows schematic diagrams illustrating how air bubbles escape from bar-like pieces of dough that include solid food particles.

PREFERRED EMBODIMENT OF THIS INVENTION

[0028] First, the present invention is explained based on an embodiment. FIG. 1 is a perspective view of an apparatus for manufacturing the bread of this invention. In this embodiment, a conveyor 21 conveys a continuous sheet of bread dough 1, a forming apparatus 2 forms the continuous sheet of bread dough 1A into bar-like dough 1B by rolling the sheets, and then a cutting apparatus 3 cuts the bar-like dough 1B into bar-like pieces of dough 1C having a predetermined size. The bar-like pieces of dough 1C are transferred to a placing apparatus 5 by a transfer conveyor 4. Then a predetermined number of the bar-like pieces of dough 1C are placed in a baking mold 6 by the placing apparatus 5.

[0029] Next, this embodiment is described in detail.

[0030] The continuous sheet of bread dough 1A is prepared in advance by any dough-sheet-forming apparatus that is well known. For example, a stretching apparatus for food dough provides sheets of bread dough (Japanese Patent Application No. 2002-28681, by this same patent applicant). Also, Japanese Patent Laid-open Nos. 9-172983 and 9-187213 both disclose an apparatus for supplying sheets of food dough. These apparatuses each have two groups of rollers that are arranged in a V-shape so that the distance between the upper rollers is greater than that between the lower rollers. In this present invention, a dough-sheet-forming apparatus can further form sheets having a predetermined thickness, if required.

[0031] The forming apparatus 2 forms the sheet of bread dough 1A into bar-like dough 1B by rolling the sheets from one side. A roller 23 is disposed diagonally across the sheet of bread dough 1A so that the head of the roller faces downstream of the conveyor. A motor 22 drives the roller 23 so that the direction of the rotation corresponds to lifting the sheet of bread dough up (counterclockwise from the front view).

[0032] Thus, the roller 23 contacts the sheet of bread dough 1A and gradually rolls it up cylindrically, and then it moves downstream on the conveyor, and bar-like dough 1B is finished when it comes down to the head of the roller 23. A cutting conveyor 35 conveys it. The diagonal angle of the roller 23 is adjusted according to the thickness, width, and properties of the sheet of bread dough, and the diameter or number of layers of the bar-like dough.

[0033] The diameter of the roller 23 may be gradually increased as it goes downstream, because the diameter of the bar-like dough at the foot of the roller 23 is different from

it when it was at the head of the roller. When the width of the sheet and diameter of the bar-like dough are large, plural rollers can also be used instead of a single roller 23. In this case, the diameter of the downstream roller may be larger than that of the upstream roller, or the rotation speed of the downstream roller may be higher than that of the upstream roller.

[0034] The bar-like dough 1B is cut to a predetermined size by the cutting apparatus 3. The cutting apparatus 3 is provided with a cutter 31, a driving unit for a cutter 32, a first weighing conveyor 33, and a second weighing conveyor 34. The first weighing conveyor 33 measures the weight of the continuous bar-like dough 1B. When the measured weight reaches a predetermined value, the cutter 31 operates to cut the bar-like dough 1B by the action of the driving unit of the cutter 32, which unit has mechanisms such as an air cylinder.

[0035] The bar-like pieces of dough 1C that have been cut are transferred from the first weighing conveyor 33 to the second weighing conveyor 34. The second weighing conveyor 34 measures the weight of the bar-like pieces of dough 1C again. According to the measurements of the second weighing conveyor 34, the timing of the cutting operation with the cutter 31 by the driving unit of the cutter 32 is controlled. When the length of the bar-like pieces of dough 1C exceeds the length of the first weighing conveyor 33, the cutting operation may be carried out according to the sum of the measurements of the first weighing conveyor 33 and the second weighing conveyor 34.

[0036] In this embodiment, the cutting method to cut the bar-like dough 1B according to the measurements of the weight of the bar-like pieces of dough 1C by the weighing conveyors 33 and 34 is used. But another cutting method to cut the bar-like dough 1B according to the length of the bar-like pieces of dough 1C also may be available. In this case, the cutting apparatus can cut the bar-like dough 1B into bar-like pieces of dough 1C having a predetermined length, according to means such as a rotary encoder, to detect when the distance moved by the conveyor belt is equal to the length of the bar-like pieces of dough 1C.

[0037] There is a difference in height between the transfer conveyor 4 and the second weighing conveyor 34. This causes the bar-like pieces of dough 1C to be turned over so that their cutting planes face the belt of the transfer conveyor 4 and face upward when the bar-like pieces of dough 1C are transferred from the second weighing conveyor 34 to the transfer conveyor 4. Then the transfer conveyor 4 conveys the bar-like pieces of dough 1C.

[0038] This difference in height is adjusted according to the length of the bar-like pieces of dough 1C so that they can be definitely turned over.

[0039] The downstream end 41 of the transfer conveyor 4 can move up and down and access or withdraw from a belt 51A of a conveying portion 51 of the placing apparatus that is disposed below the transfer conveyor 4. The downstream end 41 can move from one side to the other side of the conveying portion 51 along the transverse direction. Thus the transfer conveyor 4 can in turn transfer the bar-like pieces of dough 1C to the conveying portion 51. In doing so, the conveying portion 51 is assisted by the reverse movement of the downstream end 41.

[0040] FIG. 1 shows that four bar-like pieces of dough 1C are arranged in one sequence along the transverse direction

of the conveying portion 51. For example, since the downstream end 41 can move downward and backward with a predetermined time delay when sensors 44 detect the bar-like pieces of dough 1C that are to be transferred, the transfer conveyor 4 can in turn transfer them onto the conveying portion 51. When the intervals among the bar-like pieces of dough 1C on the transfer conveyor 4 are not equal, the intervals of the transferred bar-like pieces of dough 1C on the conveying portion 51 do not become equal. In this case, a method described below may be used so as to make the intervals of the bar-like pieces of dough 1C on the conveying portion 51 be equal. As another embodiment, Japanese Patent Laid-open No. 9-322718 discloses a method to vary the backward movement speed of the downstream end 41 depending on the intervals of the bar-like pieces of dough 1C on the transfer conveyor 4, so that the intervals of them on the conveying portion 51 are made equal.

[0041] As another embodiment to equalize the intervals of the bar-like pieces of dough 1C on the conveying portion 51, Japanese Utility Model Laid-open No. 1-147324 also discloses a method where the downstream end 41 is moved backward at a predetermined distance from the stationary position when the bar-like pieces of dough 1C are detected by the sensors 44 while a belt 43 of the transfer conveyor 4 is moving continuously. This sequence is repeated to complete their transfer.

[0042] An idle pulley is moved so as to apply tension to the belt when the downstream end 41 of the transfer conveyor 4 goes backward.

[0043] The placing apparatus is provided with the conveying portion 51, which has the belt 51A for receiving the bar-like pieces of dough 1C from the transfer conveyor 4 and a space 52 between the downstream end of the belt 51A and the upstream end of the belt 51B facing the end of the belt 51A.

[0044] The space 52 is defined by the end plates 52A and 52B, which can access or withdraw from each other. (See FIGS. 2-6.) There are guide plates 53A and 53B above the space 52, and they are able to access or withdraw from each other while closing or widening the space 52 by means of a driving means such as air cylinders. There are guide plates 54A and 54B at both sides of the guide plates 53A and 53B. They can access or withdraw from each other by means of a driving means such as air cylinders. There is a sensing apparatus 55 at the upstream side of the guide plate 53A to detect the bar-like pieces of dough 1C.

[0045] In addition, the guide plate 53A can move vertically so as to avoid interfering with the bar-like pieces of dough 1C being carried by the conveying portion 51.

[0046] There is a conveying portion 61 for molds 6 below the space 52. The conveying portion 61 supplies the baking molds 6 under the space 52 at suitable times.

[0047] The conveying portion 61 for the molds 6 can convey each baking mold 6 to the required position according to the construction or configuration of the baking molds 6. FIGS. 5 and 6 show that each baking mold is independent. For example, even if three baking molds 6 are connected to each other, the conveying portion 61 for the molds 6 can convey them suitably by the construction of the conveying portion 61 for the molds 6 being changed, if required.

[0048] Next, each step for manufacturing the bread is below described in detail based on the previously-discussed embodiments of the present invention.

[0049] First, the forming apparatus 2 forms the sheet of bread dough 1A into the bar-like dough 1B by rotating the roller 23. Then the cutting apparatus 3 cuts the bar-like dough 1B to a predetermined weight or size. The transfer conveyor 4 conveys the bar-like pieces 1C that have been cut so that the cutting planes of them face upward and downward of them.

[0050] In this embodiment, the downstream end 41 of the transfer conveyor 4 moves backward and transfers the bar-like pieces of dough 1C on the conveying portion 51 of the placing apparatus 5 so that four bar-like pieces of dough 1C are disposed side-by-side and at equal intervals across the conveying portion 51.

[0051] When the sensing apparatus 55 detects the arranged bar-like pieces of dough 1C, the conveying portion 51 is stopped so that the arranged bar-like pieces of dough 1C are disposed at the predetermined location at a space 52 between adjacent belts. The guide plates 53A and 53B, and 54A and 54B move to access and withdraw from each other respectively, so as to determine the position of the arranged bar-like pieces of dough 1C. This precise positioning allows them to be easily placed in the baking molds 6.

[0052] Then, when the end plates 52A and 52B at the space 52 between the belts move to withdraw from each other, the arranged bar-like pieces of dough 1C drop down and are placed in the baking molds. This sequence is repeated, to complete their placement in the baking molds.

[0053] In the embodiment described above, the number of bar-like pieces of dough 1C that are placed in a baking mold at one time is four. But this number is not limited. If more than four dough pieces are required to be placed in a baking mold, it is possible to place such a number of the bar-like pieces of dough 1C in a baking mold when the diameter of each of them is decreased. In this case, the bar-like pieces of dough 1C may be deformed so that they have elliptic cross sections (see FIG. 7(b)), so as to efficiently place them in the baking mold.

[0054] FIG. 9 shows the part of the apparatus for manufacturing bread that is further supplied with a deforming step to deform the bar-like dough 1B so that it has an elliptic cross section, among other steps shown in FIG. 1. A roller 8 is used to deform the bar-like dough 1B. The distance between the roller 8 and the surface of the belt of the conveyor is adjusted so that at least it becomes less than the diameter of the bar-like dough 1B conveyed by the conveyor. The roller 8 rotates in a direction so that the moving direction of the roller 8 at the contact surface with the bar-like dough 1B corresponds to the moving direction of the bar-like dough 1B.

[0055] The cutting apparatus (not shown in FIG. 9) cuts the deformed bar-like dough 1B, having an elliptic cross section, by the same method as in the embodiment shown in FIG. 1.

[0056] Deformed bar-like pieces of dough 1C can be placed in the baking mold more efficiently than in the embodiment shown in FIG. 1 because of the elliptic deformation of them.

[0057] The height of the bar-like pieces 1C in the baking mold is determined by the length of them, as is defined by the cutting apparatus that cuts the bar-like dough 1B. The length of the bar-like pieces 1C can be determined according to the depth of the baking molds 6. In this embodiment, the length of the bar-like pieces 1C corresponds to $\frac{1}{2}$ to $\frac{1}{3}$ of the depth of the baking molds.

[0058] The bar-like pieces 1C placed in the baking molds 6 will ferment with yeast and rise at the fermenting step (not shown in the figure), and they rise further at the baking step. In this case, quadrilateral-shaped bread can be made if a lid is used on the baking molds 6.

[0059] In the embodiment discussed above, the baking molds will be filled with the bar-like pieces 1C that are rising at the fermenting and baking steps. At this time, the bar-like pieces 1C rise in the baking molds and expand horizontally and vertically until they contact the side walls of the baking molds and adjacent bar-like pieces 1C (see FIG. 7(a)), and then they expand vertically.

[0060] In the embodiment discussed above, if the air bubbles rise between the layers of the bar-like pieces 1C when the layers are slackened or gaps are generated between them, the remaining air bubbles can move upward through the layers of the bar-like pieces 1C and easily escape from them when they rise at the fermenting and baking steps.

[0061] Namely, in the conventional placing method to place bread dough in a baking mold, large air holes may remain in the baked bread as a result of the air bubbles remaining between the layers of the bread dough. Because the perpendicular surfaces of the layers (including the cutting planes) do not face upward, the surfaces contact the side or bottom walls of the baking mold and the air bubbles cannot escape from the bread dough while it is rising.

[0062] But there is no such shortcoming in this invention.

[0063] Moreover, in the conventional placing method to place V-shaped or M-shaped bread dough in a baking mold, the inner structure of the curved portion of the bread dough differs from that of the other portions. Namely, the inner structure (such as the grain size and direction) of the curved portion of the bread dough is not uniform. Since there are no such curved portions in this invention, such problems do not arise.

[0064] This invention is not limited to the embodiments discussed above. It may take any number of suitable forms without departing from the scope of this invention.

[0065] For example, a single dough bar 1B is transferred in these embodiments, but plural dough bars 1B may be transferred to the placing apparatus.

[0066] It is intended that this invention release the air bubbles from the cutting plane by having the bar-like pieces of dough placed in the baking mold so that at least one cutting plane faces upward. Thus, this invention is not limited to the embodiments where both cutting planes of the bar-like pieces of dough face upward and downward. For example, when the bar-like pieces of dough having a U-shape are placed in the baking mold so that both cutting planes face upward, even if curved portions exist in the lower part of the baking mold, the air bubbles may escape from the bar-like pieces of dough, because the cutting planes exist at the upper side of the baking mold.

[0067] This embodiment shows the method where the bar-like dough 1B is cut on the cutting conveyor 35 by the moving-up-and-down motion of the cutter. Then, the bar-like pieces of dough 1C are turned over so that one cutting plane faces upward and one faces downward, and the pieces of dough 1C are transferred to be placed in the baking mold 6.

[0068] In another embodiment, the bar-like dough 1B that drops from the downstream end of the conveyor may be cut with the horizontal movement of the cutter, instead of the vertical movement (for example, see Japanese Patent No. 2558200 and Japanese Patent Laid-open Publication No. 5-268864, whose applicant is the same as that of this application). Namely, the bar-like pieces of dough 1C that have been cut with the horizontal movement of the cutter directly drop into the baking mold, so that at least one cutting plane faces upward.

[0069] In this case, since the bar-like pieces of dough drop into the baking mold one-by-one, the baking mold is intermittently moved to the predetermined suitable position by any known means, so that the bar-like pieces of dough are arranged in one sequence in the baking mold.

[0070] FIG. 8 shows the forming step to form the bar-like dough 1B by means of folding, instead of rolling.

[0071] The folding means for bread dough is provided with a folding apparatus 7 that is mounted on the conveyor frames. The folding apparatus 7 has right and left folding members 71, 73, and they are mounted alternately on it. These folding members 71, 73 fold the sheet of dough from each side in turn so that the bar-like dough 1B is formed. Then, the cutting apparatus (not shown in FIG. 8) cuts the bar-like dough 1B, and the bar-like pieces 1C are placed in the baking molds 6 so that the cutting plane faces upward.

[0072] FIG. 10 shows two rolling apparatuses 2 that are mounted symmetrically. These apparatuses can roll the sheet of dough from each side symmetrically, and can form spiral and symmetrical bar-like pieces of dough 1B as shown in FIG. 10. Then, the cutting apparatus cuts the bar-like dough 1B to a predetermined size, and the pieces of dough 1C are placed in the baking molds 6.

[0073] FIG. 11 shows a rolling means other than the rolling apparatus discussed above.

[0074] Namely, in this means, well known nets for rolling 91 and rolling plates 92 are used to roll the sheets of bread dough 1 that are cut to a predetermined size. In this case, the sheets of dough are rolled from the downstream end to the upstream end.

[0075] The sheets of bread dough 1 are rolled up by the nets for rolling 91, and bound tightly by the rolling plates 92 so as to form the bar-like dough 1B.

[0076] Then, the cutting apparatus cuts the bar-like dough 1B to a predetermined size, and the pieces of dough 1C are placed in the baking molds 6.

[0077] We discussed above the fact that in this invention the air bubbles between the layers of dough easily escape from the cut plane. In the embodiment shown in FIG. 11, neither side plane 13A of the bar-like dough 1B is a cut plane. But even if the plane 13A were to face upward in the baking mold, the air bubbles can still easily escape from it,

because the surfaces between the layers of the bar-like pieces 1C are connected to the plane 13A and allow the air bubbles to escape.

[0078] This invention is not limited to the embodiment that is discussed above. For example, this invention can be applied to bread dough that includes solid food particles such as chocolate chips, raisins, and beans. In this invention, the bread dough can receive the solid food particles at the kneading step, or the solid food particles can be scattered on the bread dough before the rolling step. Thus bread that includes solid food particles can be manufactured by forming the bar-like dough. Especially, when the solid food particles are scattered on the sheet of dough, since it is formed into bar-like dough later, it is possible to distribute them easily and uniformly.

[0079] FIG. 12 shows the apparatus for manufacturing bread according to the embodiment shown in FIG. 1, further comprising a scattering apparatus 100. The scattering apparatus 100, for scattering the solid food particles, is disposed above the conveyor 21 that conveys the continuous sheet of dough. The solid food particles 102, which are stored in a hopper 101 of the scattering apparatus 100, are scattered on the sheet of dough at a predetermined density. After the scattering, the sheet of dough is treated by means of the same apparatus and method as shown in FIG. 1. The bar-like pieces of dough that have been cut are placed in the baking molds 6 so that at least one cutting plane faces upward.

[0080] When the solid food particles are scattered on the sheet of dough and the bar-like dough is formed, large gaps may arise between the layers due to the solid food particles being formed during the forming or placing step, as shown in FIG. 13(a). However, in this invention, when the bar-like pieces 1C rise and expand vertically and horizontally, as shown by the arrows in FIG. 13(a), and contact the side walls of the baking mold and adjacent dough pieces, the interior pressure of the dough increases, as shown in FIG. 13(b), and it forces the air bubbles between the layers to escape from the dough (as shown by the arrows in FIG. 13(b)) through the layers. Thus, bread that includes solid food particles between the layers can be manufactured without air holes in it.

1. A method for manufacturing bread having a placing step to place bread dough in a baking mold, a fermenting step to ferment said bread dough, and a baking step to bake said bread dough, comprising:

a cutting step to cut bar-like dough which has layers of dough sheets to a predetermined length, and

a placing step to place bar-like pieces of dough which have been cut at said cutting step in a baking mold so that at least one cutting plane faces vertically up from said baking mold.

2. A method for manufacturing bread having a placing step to place bread dough in a baking mold, a fermenting step to ferment said bread dough, and a baking step to bake said bread dough, comprising:

a cutting step to cut bar-like dough to a predetermined length, said dough having layers of dough sheets and including solid food particles in it, and

a placing step to place bar-like pieces of dough which have been cut at said cutting step in a baking mold so that at least one cutting plane faces vertically up from said baking mold.

3. An apparatus for manufacturing bread, comprising:

a transfer conveyor to transfer bar-like pieces of dough which have been cut to a predetermined length, and

a placing apparatus to place said bar-like pieces of dough in a baking mold so that at least one cutting plane faces vertically up from said baking mold.

4. A method for manufacturing bread having a placing step to place bread dough in a baking mold, a fermenting step to ferment said bread dough, and a baking step to bake said bread dough, comprising:

forming and conveying steps to form a sheet of said bread dough and convey said sheet by a conveyor,

a forming step to form from said sheet of bread dough bar-like dough having layers of dough sheets,

a cutting step to cut said bar-like dough to a predetermined length, and

a placing step to place said bar-like pieces of dough which have been cut at said cutting step in a baking mold so that at least one cutting plane faces vertically up from said baking mold.

5. The method for manufacturing bread according to claim 4 wherein said forming and conveying steps further comprise a scattering step to scatter solid food particles on said sheet of bread dough.

6. An apparatus for manufacturing bread, comprising:

a conveying apparatus to convey a sheet of bread dough,

a forming apparatus to form from said sheet of bread dough bar-like dough having layers of dough sheets,

a cutting apparatus to cut said bar-like dough to a predetermined length,

a transfer conveyor to transfer bar-like pieces of dough which have been cut by said cutting apparatus, and

a placing apparatus to place said bar-like pieces of dough in a baking mold so that at least one cutting plane faces vertically up from said baking mold.

7. The apparatus for manufacturing bread according to claim 6 wherein said conveying apparatus further comprises a scattering apparatus to scatter solid food particles on said sheet of bread dough.

8. The method for manufacturing bread according to claim 4

wherein said forming step is to form continuous bar-like dough by rolling said sheet of bread dough from one side to the other side.

9. The method for manufacturing bread according to claim 1

further comprising a deforming step to deform said bar-like dough so that it has an elliptic cross section.

* * * * *