

2004 09 30
10-0449840
2004 09 13

(21)	10-2004-7004302 ()	(65)	10-2004-0053138
(22)	2004 03 25	(43)	2004 06 23
(62)	10-2001-7016369		
	: 2001 12 20		2002 01 12
	2004 03 25		
(86)	PCT/US2000/016422	(87)	WO 2000/78681
(86)	2000 06 14	(87)	2000 12 28

[illegible]

(30)	60/140,090	1999	06	21	(US)
	60/140,159	1999	06	21	(US)
	09/596,416	2000	06	12	(US)

[illegible]

(72) $\frac{49316}{.7086}$.

49331 1270

49408 6414

49301	2990
49417	1700
94947	.6
49505	.1054

(74)

:

(54)

system) (20) (22) WTS (20) UV (point-of-use) (24) 2 (WTS: water treatment
 (92) (26)가 1 (74) (90) (24)가
 2 1 2 (26) 2 가 가 (26),
 (24) (22) (84) (24) (bulb) (444)
 가 (24)가 (80)
 (82) (24)
 (400) 가 (24)가 가 (82, 402
) V 가 (250) (250) (24) () U
 (250)

5

, , , ,

1 WTS
 2 WTS
 3 WTS
 4 가 가 WTS

5 WTS
6a 6e , 6c 6E 6b 6C-6C , 6c 6D
7a 7f , , 7c 7D-7D ,
8a 8c ,
9a 9c , 9b 9C-9C
10a 10e , ,
11a 11c ,
12a 12c ,
13a 13c 2 , 13b 13C-13C
14
15a 15b
16
17
18
19
20a 20b
21a 21b
22 UV
23a 23d UV , UV ,
24 23b 23d UV
25a 25f , , , ,
26a 26c ,
27a 27f , , ,
28a 28d , , 28b 28C-28C , 28b
28D-28D
29a 29c , 29b 29C-29C
30a 30c ,
31a 31d , , 13b 31D-31D
32a 32c ,
33a 33c ,
34a 34e , ,
35a 35b
36a 36d , 36b 36C-36C
37 WTS 3 37-37
38 2 38-38
39 40 39-39
40 39 40-40
41 39 41-41
42 39 42-42
43 39 43-43

< >

20 :
22 :
24 :
26 :
90 :
92 :
96 :
100 :
102 :

35 U.S.C. § 199 (e) , 1999 6 21 가
60/140,090 , 1999 6 21 가
60/140,159 ,
가
가
(WTS:Water Treatment System) 가
UV
WTS , UV 가 가 WTS
UV 가 WTS
WTS
WTS 가
WTS UV
UV
UV
WTS WTS 가 WTS
가 WTS
가 WTS
WTS
WTS 가
가 WTS
UV WTS UV
가 UV
S WTS
WTS
WTS
WTS
2 , UV 2 , 1 2
2 가 2
가
가

The diagram illustrates a complex network of relationships. Key nodes and their connections include:

- 가** (Korean character) nodes are distributed throughout the network, often acting as central or peripheral points.
- UV** (Ultraviolet) nodes are connected to various **가** nodes, particularly in the upper and lower right sections.
- WTS** (Wireless Technology System) nodes are clustered in the lower left and center-right areas.
- RFID** (Radio Frequency Identification) nodes are located in the lower right section.
- Numbers 1 and 2** are used as labels for specific nodes or clusters, often associated with **가** or **UV** nodes.

The network is highly interconnected, with many nodes having multiple connections, suggesting a complex, multi-layered system.

(20) WTS (20) 1 (22), (24) 2 3 WTS (26)
(22) 가 가 (26) (22) (24)
(22) (24)가 (22) (24) WTS (20)
1 3 , WTS (20) (32), (34), (36) (40)
(42)가 (36) (42) WTS (20)

2 WTS (20) 3
 (44) (34) 4 (40)가 (26)
 (24)가 (22)
 5 , WTS (20) (22) 3
 (52), (54), (56), (62, 64)
 (32) (60) (66)가 (50)
 (32), (36) (42), (34) (40) (40)
 (68) (40) (70) (70) WTS (2
 0) (70) (66)
 WTS (20) 가
 (24) (72), 2 (74), (76), (78),
 (80), UV (82), (26)
 (90), (92), (94), (96) (98)
 WTS (20)
 A.
 6a 6e (26) (88), (96),
 (100), (102), (92), (94), (104)
 (98) (98) (96)
 가 (88) (106) (108) (110)
 (90) (88) (90)
 (110) (90)
 (112) (112) (92)
 (66)
 6c 6d (112) (88) (96) (104)
 (92) (104)
 (88) (94) (92)
 (92) (94) (96) (92)
 (100) (92) (88) (108) 가 (102)
 6d (106) (116) (114) 4 (114)
 (120)가 (114) (116) (116)
 122) (124, 126) (90) (116)
 (124, 126) (130), 6e (108)
 (132, 134) (136) (140)
 (130) (90) 4
 (108) (92) (102) 가 (144)
 (96) (142) (144) (146)가 6c 6d
 (148) (146) (92) (146)가 . EMA
 (92) 7a 7f (92) (150),
 (152) (154) (154) (160)가 (102)
 156) . 3 (162) (160) (164)가 (152)
 (24)() (166)
 6d (150) (104) , (174) (172) ,
 (100) 3 (176) (170)
 7a 7d , 3 (178) L (180)
 (26)가 (50) (26)가 (22)
 (178) (186) (186)
 (186) (112) (184) (22)
 (66) (150)
 (94) (192) (94) (94) 6c 6d (9
 2) (152) (92) (94) (150)
) (92)

(152) (26) (94) (150) (92)
 (100) (174) (176) (102)
 (164) (162) (104) (92) (150)
 (170) (102) (162) (26) (88) (108) (104)
 140) (88) (94) (96) (150) (15
 0) (88) (96) (146) EMA (148) (112)
 (184) 가 (172) 6c 6d (26)
 WTS (20) (100) (174) (25) (172)
 가 (100) (174) (88) (106) (90)
 (92) (150) (90) (90) (92) (136)
 가 (154) (102) (164) (26)가 (22)
) 가 (26) (26)가 (26)
 (24) (102) (164)
 (24) (26)
 B.
 8a 8c (24) (24) (72), 2 (74),
 (76), (78), (80), UV (82), O- (84),
 (86)
 9a 9c (72) (72) (200), O- (202),
 (204) (206) (200) (210) (212) (214) (2
 14) (212) (222) (220) (224) (21
 0) (206) (210) (226) (232) (212)
 212) (230) L (24) (58) 가
 (232) WTS (20) (234) (230)
 O- (202) (24)가 (22) 가 (24) 가
 (206) UV (204) 37 38 (72) (58)
 (76) O- (202)
 (76) 10a (244) 10b 10e (246)가
 (240) O- (250) (252) (242) (250) (24
 (242) (250) (66) UV 가 WTS (20)
 (76) (252) (24) UV 가 WTS (20)
) 가 WTS (20) WTS (20)
 O- (240) 11a 11c (260) O- (244)
 (286) 2 (74) (260) (264)가 8 (268)가 (240
) (200) (224) (240) (274) (240
 240) (242) (240) (240) (72)(9a)
 11c (214) (276) (282) (280) (276) 2
 (284, 286)가 T (284, 286)
 (74) (242) 12a 12c (260) (290) O- (244)
 (240) (260) (290) (292) (80)

) (8a). 6 (294) UV (82)
 (8a). (296) (250) (252)
 (15b). (296) 4 (300) (296)
 (300) (252) (296) (240)
 (302, 304) (306) (296) , 4
 (310) (306) (246) (290)
 (312) (240) (76)
 O- (10a).
 2 (74) 13a (74) (326) (320)
 (326) 55 (320) (322)
 (324) (330)가 (324) (322) 2
 (74) (76)(8a) (240) (266)(11a
 11c)
 (250) 14 (250) (342)
 (340) (340) (344) (346) (342)
 (344) (346) (296)
 (252) 15a 15b (252) (350) (352)
 (352) (354)가 (354) (252) (242)
 (296) 4 (302)(12a 12c) (350)
 (360) (24) UV UV (252)
 (362) (252) 가 UV (364) UV
 (82) (24)가 (36) UV
 (252) (24)
 16 (78) (78) (366), (36
 8), O- (370) O- (372) (366) (368) 17 18
 (368) (376) (26)가 (24) (26) (102)
 374) O- (370) (382) (380)가 (386)
 (374) (384) (384)
)가 (388)가 (366) (368) (384)
 (392)가 O- (372) (24) (390) (394) (368)
 (78) (384) (80) 가
 19 (24) (392) (400)
 (405) (86) (400) (402) (400)
 (408) (410) (407)가 가 , (400) (408) (
 410) (400) (400) (416) (400)
 (412, 414)가 (416) (24)가 (400)
 78) (420) O- (370) (424)가 (424)
 (400) (422) (422) (200) (406)
 (76) (400)
 (200) (400)
 (426) (402) (402) (430)
 21a 21b 가 (432) (434) (436) (434)
 (432) 90 ° () (432) , (43
 6) (430) (438) 가() UV (80)
 22 , UV (82) (440)
 (440) , (436) , (4
 438) (430) (436) UV
 40) (402) 가 , (402) (80) (440)
 (82) (402) 1 (402) 가 (402)
 (402) (80) , 3
 (440) , 40% 가

(402) UV (402) (facet) (440)

(402) (80)

23a UV (82) UV (82) 가 가 2 (440) (442)가 2 (440) (446) UV (82) (448) (446) (24) (446)

가 2 (74) UV (82) 가 99 : 1 (Ne-Ar) (Hg)

가 (440) 50 : 50 99.5 : 0.5 UV (82) 가 (440)

가 UV 가

WTS (20) UV 가

WTS (444) (442) (444)

가

Hg가 254 UV UV 가 (24)

(80) O- (84) UV (82) (80) O- (84) WTS

(20) UV (82)가 , O- (84) (440) (24)가

(440) O- (84) (440) O- (84) O- (84) (444)

(444) (82) (444)

23b 23d 3가 (444) UV UV (82) (82) Hg가

가 , O- (84) , 23b , UV (82) (82)

(448) , 23d , UV (82) UV (84) O- (82) 가

1 t 2 (t 2) UV (82)가 (t 2) 1.0 가

24 , 가

0.84 가 UV (84) O- (84)

가 UV / 가 UV 0.56 (84)가 (24)가 AI

가 가

(252) (252) 1% 가

, V826 60-3170 UV 25

(Uniform Color of Holland) 가

4 nm (252) 가 , UV (7

2) WTS (20) 가 가 (252) , UV (252) (24)가

, (252) UV (252) 가 (252)

, (252) (364) (360) (352)

(362) (360) (362) (444) (3)

64) 가 UV (82) (444)

25f 가 , (252) 25c
 , (360) (364) (262)
 (360) (402) (24)
 UV 가 UV 가 가 , (252)
 (252) (252)
 25f 가 (362) (252) UV
 (252) (24)
 , (362) 가 (82)
 (look up table) (362)
 UV 가 UV 가 UV
 가 UV 가 가
 (24) (252) 가
 UV 가 (82)가 UV , (362) 가
 가 (24) (76) 10a
 , O- (244) (240) (242) (250) (296)
 (252) (296) (240)
 (242)가 8a , 2 (74) (322) (330)가
 (76) (240) (266) (366) (368)
 (78)가 16 O- (372)
 UV (82) (440)가 (240) (270, 272) (76)
) 가 (294) (80) (440) (80)가 (206) O- (244)
 가 (82) , O- (372) (80) O- (84) UV
 , (78)가 (80) (402) (432) (402)가 (40)
 가 (400) (404) (86) (76, 78) 가 (86)
 0) UV (82), (80), (86) (408) (410) (407)
 , (86) . 2 (86) , (400)
 C.
 26a 26c (60) (60) (32),
 (588) (62, 64), 4 (582), (584), (586) C-
 C- (588) (62, 64) (590), (592), O- (594), (596) (598)
 (32)가 26c (602) (606) (604)
 . 3 (610) (50) (32) 4 (614) (66)
 (34, 36) (612) , (602) (606) , 4 (616) (66)
 . 2 (620) (58) (626) (66)
 622, 624) C- (62, 64) (632, 634)가 WTS (20)
 () (22)
 (66)가 27a 27f (66) (648),
 (650), (652), 1 (656), (654), (660), (flow hall effect)
 (662), VFD(664), (666) (668) (676) (672) (32)
 672), (662)가 (674) (676) (674, 676) (50) (56)
 (610)가 가 (648) (22) (616)
 가 (654) (674) (676) (674) (252) 가
 (112, 250) (668) (40) (70) (22)
 (650)

28a (710) 28d (712) (58) (58), (704), (706),
 (716, 720); (714) (724) 28b (714); (722) (726) (714)
 (714) L (728) (728) (24) (730, 7
 (232) (730, 732) (24)가 (56)
 32)가 (252) (296) (716) (734) (712) (7
 12) (24)가 (56) (252) (734) (736)
 (738)가 (712) 41 (676) (740)가 (736)
) (738) 4 (742) (742) (740)가 (736)
 (704, 710) (58) (704, 710) (742) (742) (740)가 (736)
) (704) 가 (740) (742) (740)가 (736)
 (24)가 (58) , (704) (24) (200) (206)
 가 (706) , (64)
 (24)가 (58) , (206) 가 (24)
 (704, 710) (706)
 , WTS (706)가 (20) (663)
 (32) (620) (744) (714) (750)가
 (50) (724) (50) (60) (54
 37 (62) (26) (172) 29a 29c (762),
) (764), (766), (768) O- (770) (760)
 (760) O- (775) (762) (772, 774) (776) (760) (7
 64) (762) (26)가 WTS (26)가 (20) (50) (764) (766) 가
 (54) (26) (768) (768) (766) (50)
 (780)가 (768) (784, 786) (56)가
 30a 30c (50) 3 31a 31d (806)
 (804) (50) (80) (810)가
 (80) (650) (50) (26) (180) 3
 L 30b 30c , (50) (26) (178) 3
 (813)가 (812) (812) (178) (26)가 (50) 가
 (812) (52) (814)가 (56)
 (56) (22) (50) 3
 (816) 3 (610) (610) (81
 6) (817) (50) 31d 37 (818)
 (818) (822) (824) (820) (768)
 54) (762) (764) , (822) (766) (56)
 가 (814) (726)가 (726) (766) (768)
 (724) (730)가 (42) (36)가 (766)
 32a 32c , 33a 33c (852) U (850) (856)
 36) (850) (854)가 (852) (852)
 (42) (850) (860)가 (852) (854)
 (862)가 (42) (854)
 (34)가 35a 35e (34) (902) (904)
 (904) (906)가 (906) (906)
 (36) (860) 가 (910)가 가

가 (34) 가 (34) (914) (24) (44) (902) 35a 35b (40), (68) (70) 36a 36d (40) (948) (40) (940), (942), (944) (946) (950) (950) (932) (66) (668) (68) (70) (668) (40)가 WTS (20) (22) (50) () (52) (50) (726) (704, 706) (58) (734) (706) (58) (734) (712) (830) (814) (54)가 (50) (50) (818) O- (770) (760) (768) 29a 29c 37 (760) (820) (818) (820) (818) (824) (58) (810) (42) 62) (766) (764) (780) (818) (818) (748) (62, 64) (32) (748) (66)가 (650) (36) (50) (36) (34)가 (50) (66) VFD (664)가 (42) (60)가 (66) (58) (62, 64) (744) (748) (32) (772) (5) 8) (736) (610) 40 41 (748) (748) (816) (817) (620) 0) 3 (850) (610) (816) (60) (22) (232) (812) (2) (34, 36) (24) (58) L (726) 가 (26) (180) L (26)가 (2) (40) (68) (70) (68) (20) 가 (40) (26) (34, 36) WTS (20) (70) (66) WTS (20) 37 가 (34) 가 (62) 가 (54) (50) (54) (172) (96) (100) (174) (106) (96) (90) (92) (90) (108) (136) (1) 08) (92) (154) (26) (24) (376) (102) (2) 6) (92) (164) (388) (24) (82) (66) 1 (656) UV (74) (82) UV (24) UV (252) (712) 가 (676) (112, 250) (65) 4) 38 (402) UV (76) UV (82) UV (76) (80) (264) (72) 가 UV

. (206) (704) (72) (228)
 . (662) WTS ()
 20) (706) WTS (20) .
 , 가 ,
 , , UV 2
 가 가 2 , 가 ,
 . 2 1
 가 2 , ,
 , , 가
 가

(57)

1. (24)
(388) , (228) (400, 78, 72) ,
(82) , (228) (80) ,
(402) (388) ,
(402) (80) (82)
(82) (80)

2. 1 , (86) (82) (80) (402)
가 (436) (432)

3. 1 , (86) (80) (402)

4. 1 , (402) , (432)
(430) 가

5. 1 , (86) (430) (432) (402)
, (432) (80)

6. 1 , (24) (72)

7. 6 , (72) , 가 (72)
(206, 228)

8. 7 , (206)

9. 1 , (388) (78)

10. 9 , (78) (82) (376)

11.

1

(402)

(400)

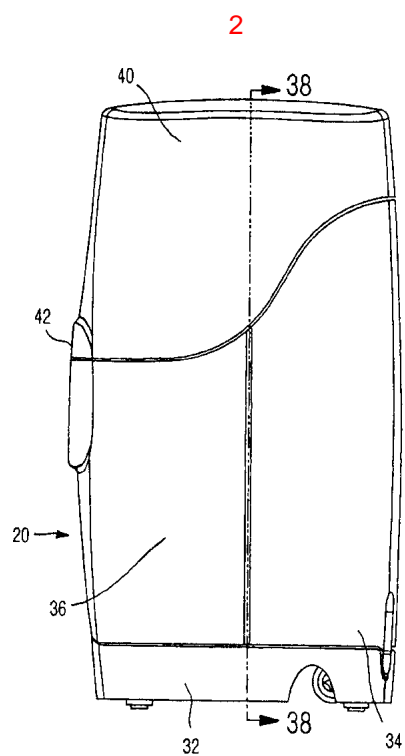
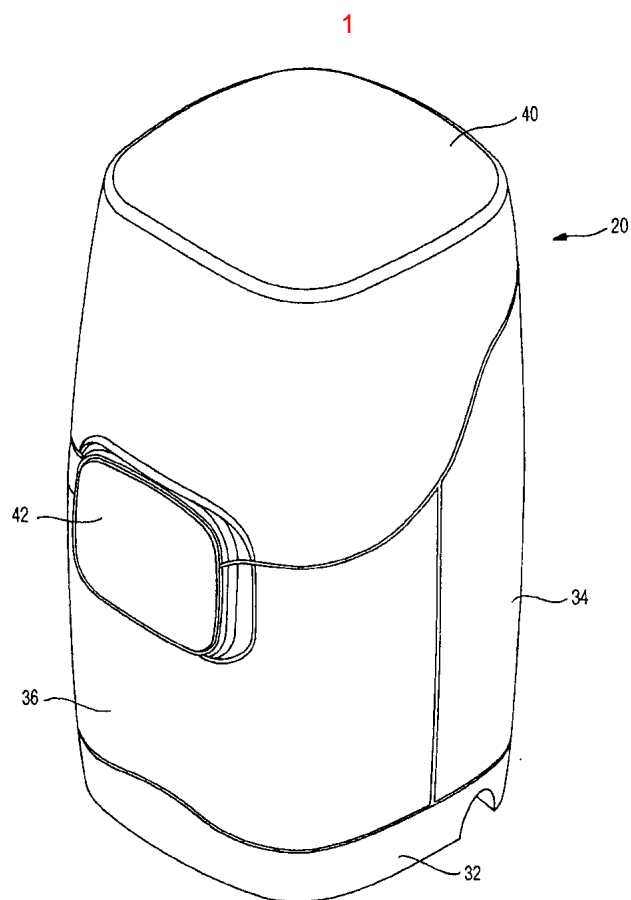

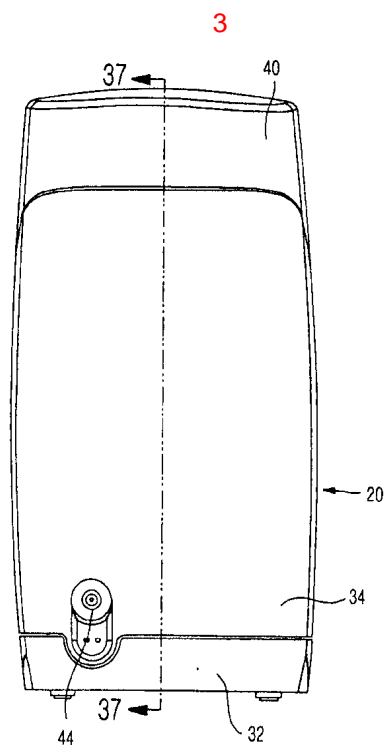

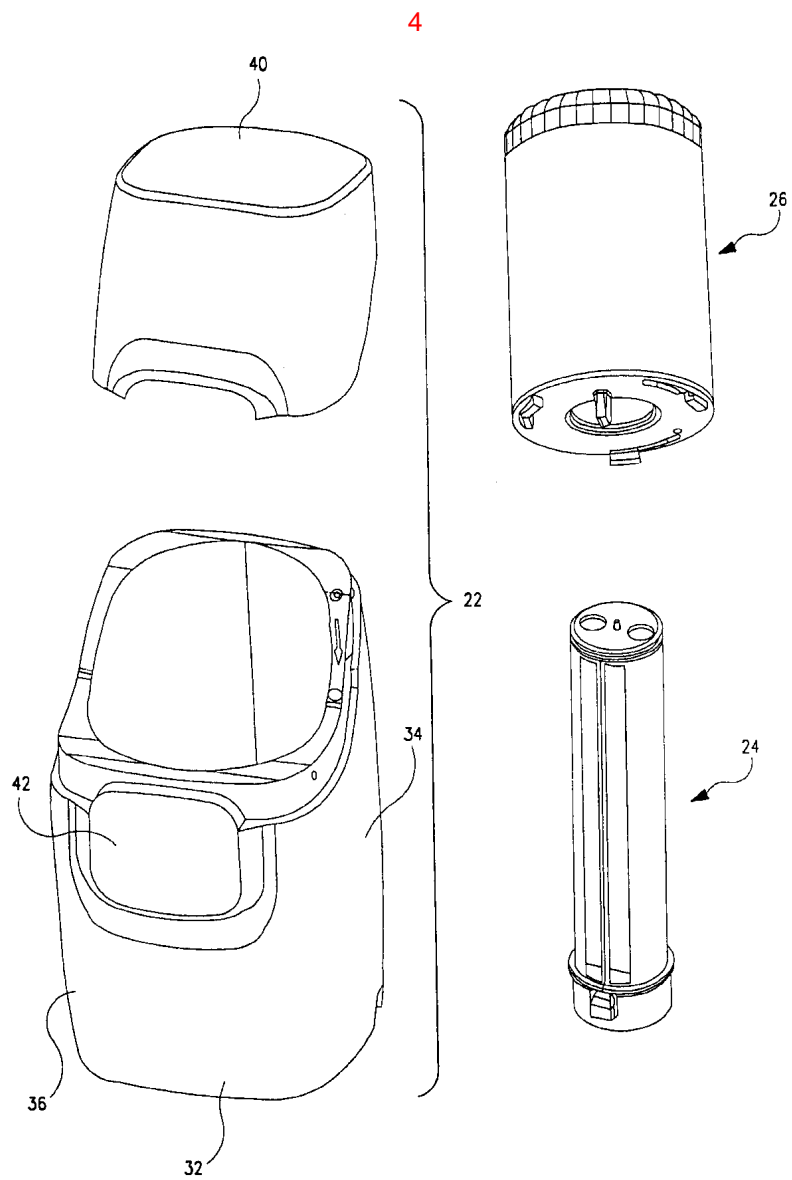

5

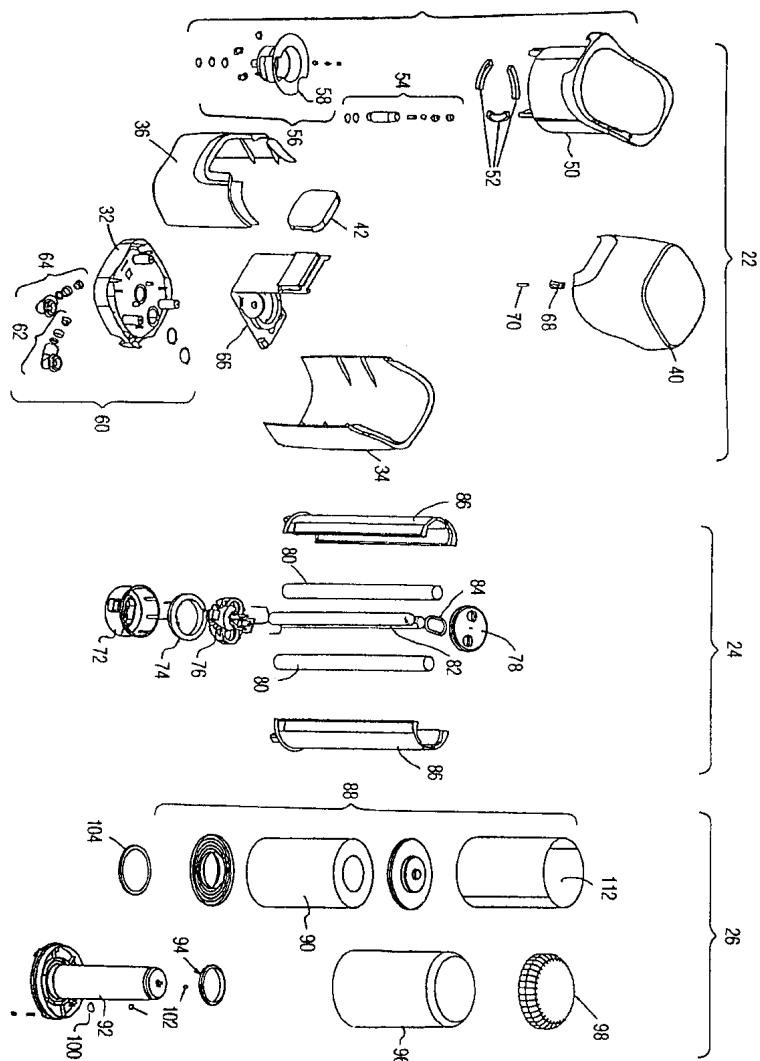

6a

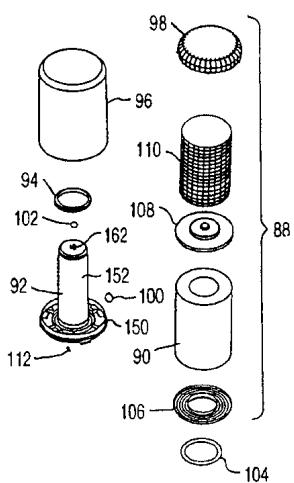

6b

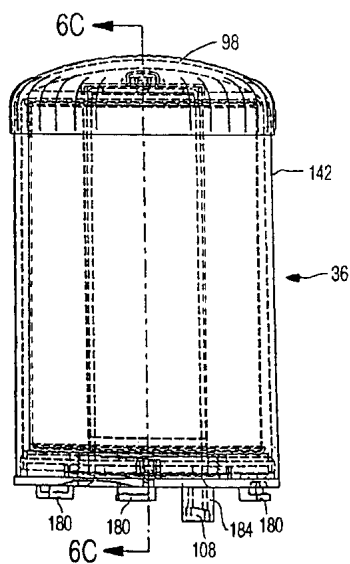

6c

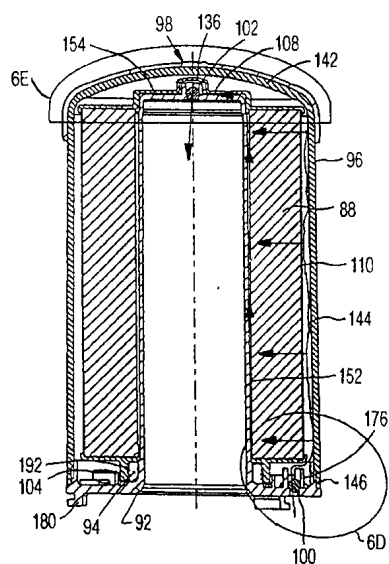

6d

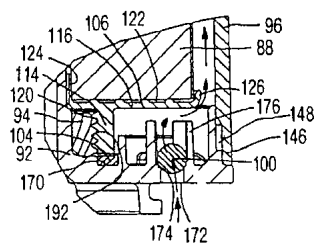

6e

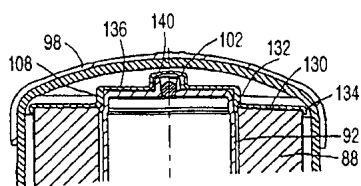

7a

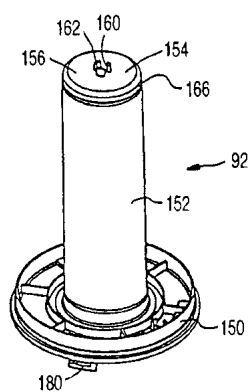

7b

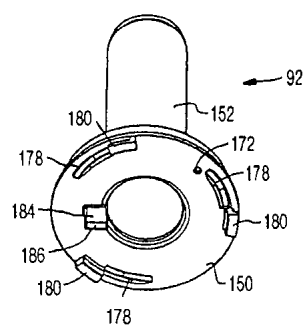

7c

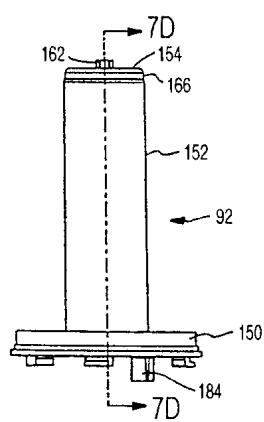

7d

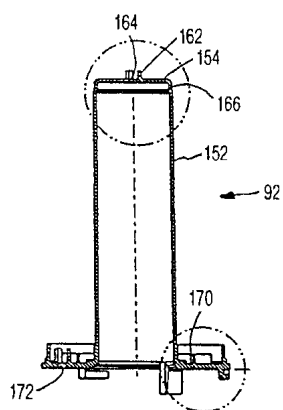

7e

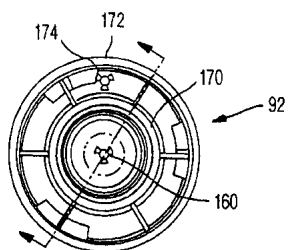

7f

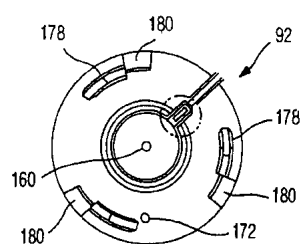

8a

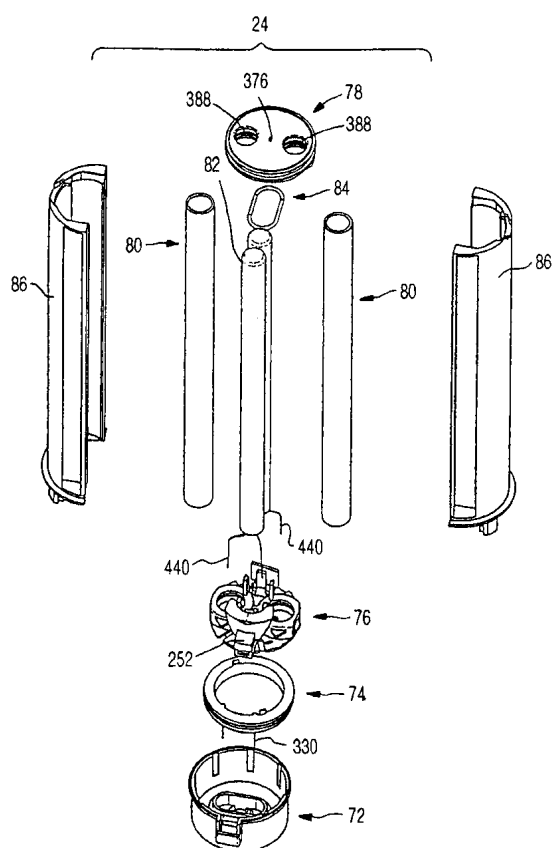

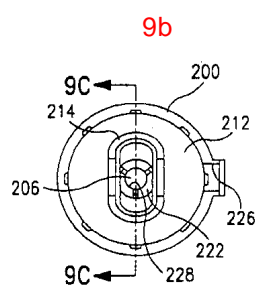
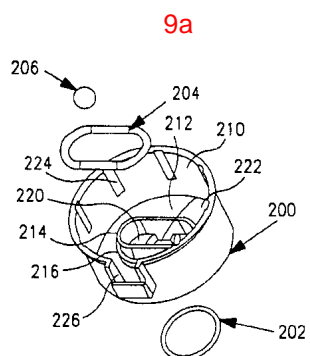
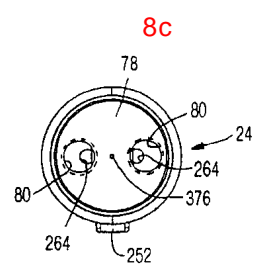
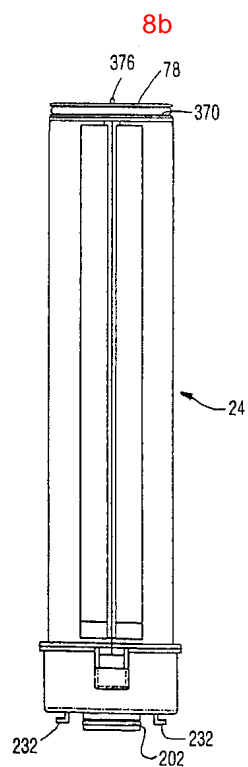

9c

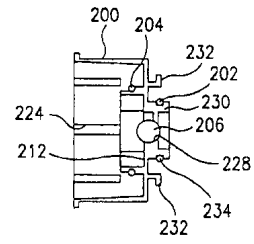

10a

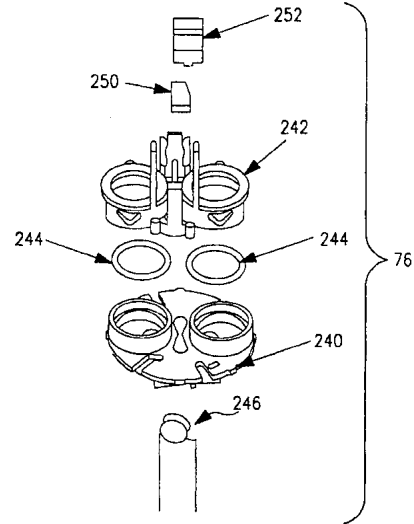

10b

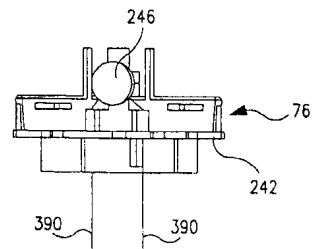

10c

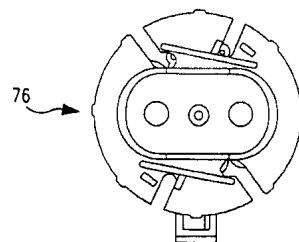

10d

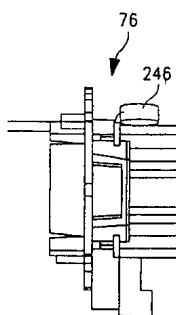

10e

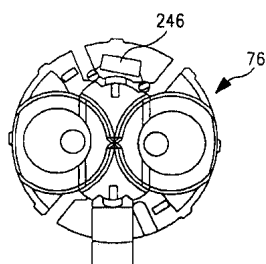

11a

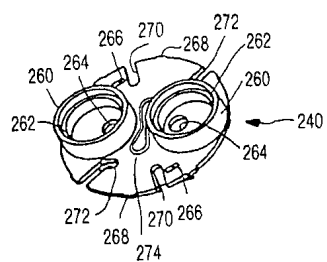

11b

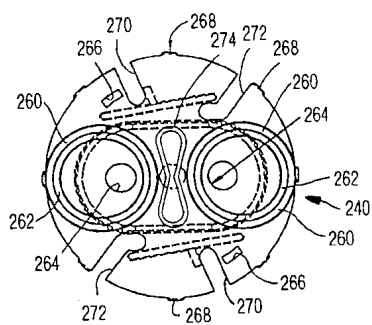

11c

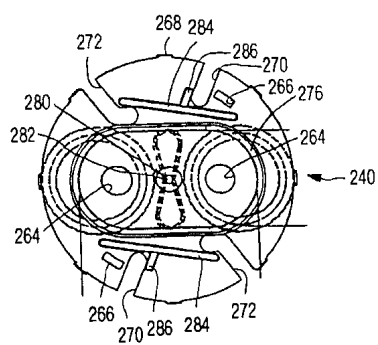

12a

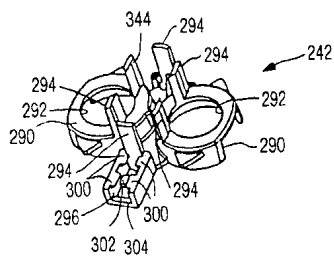

12b

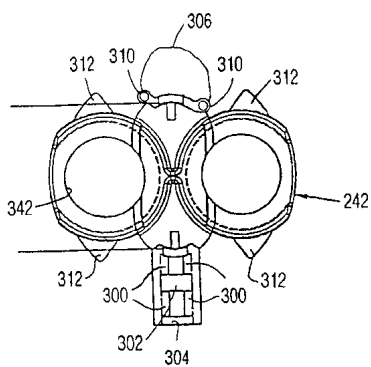

12c

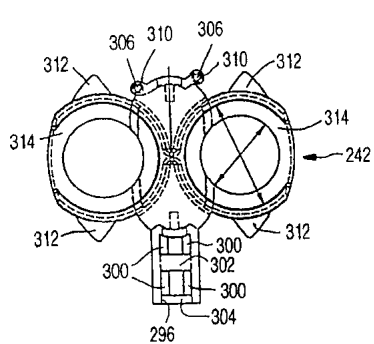

13a

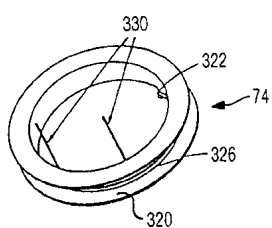

13b

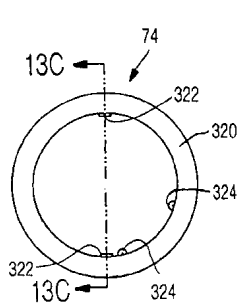

13c

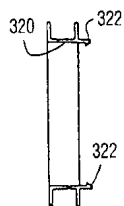

14

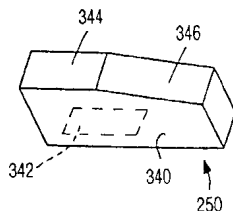

15a

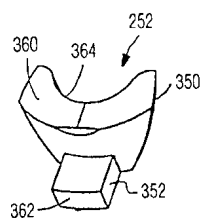

15b

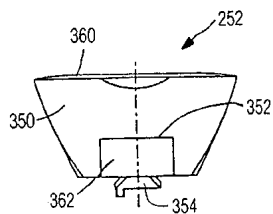

16

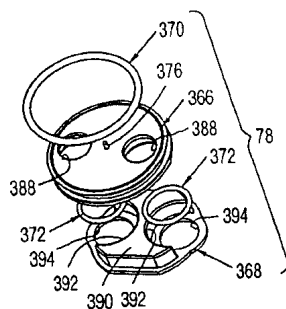

17

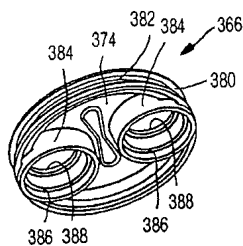

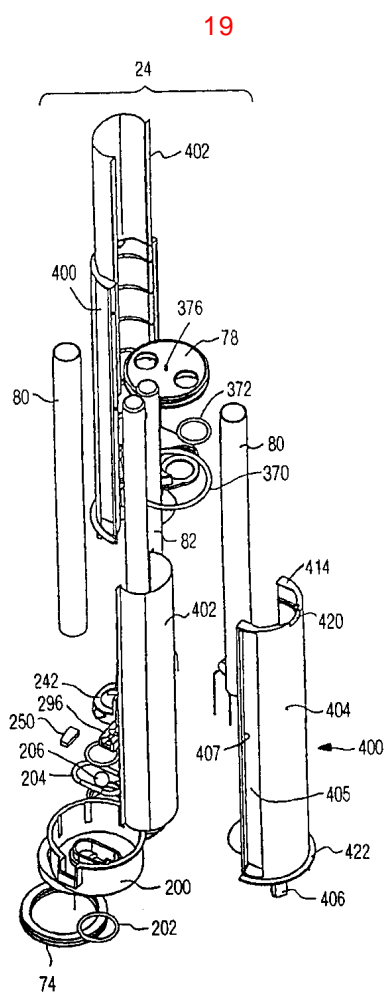
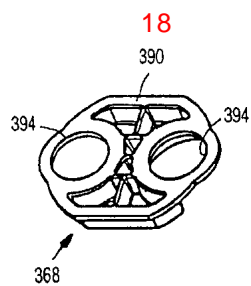

20a

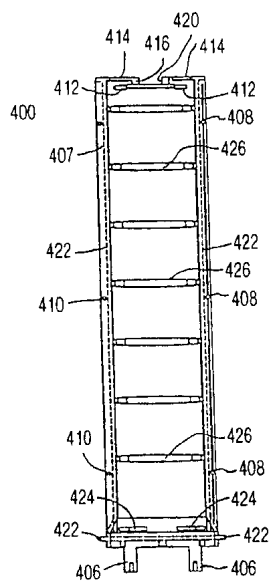

20b

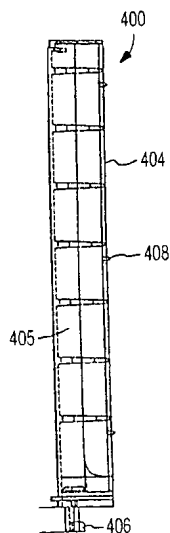

21a

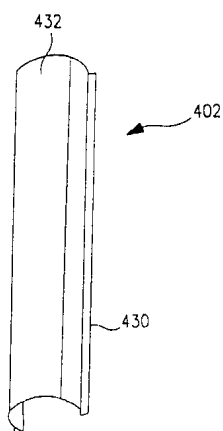

21b

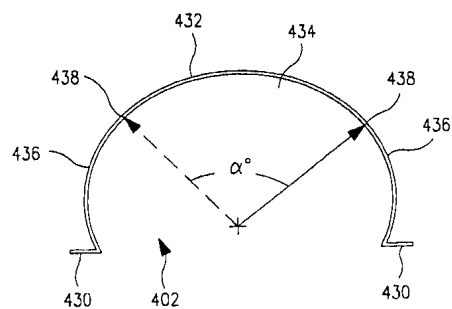

22

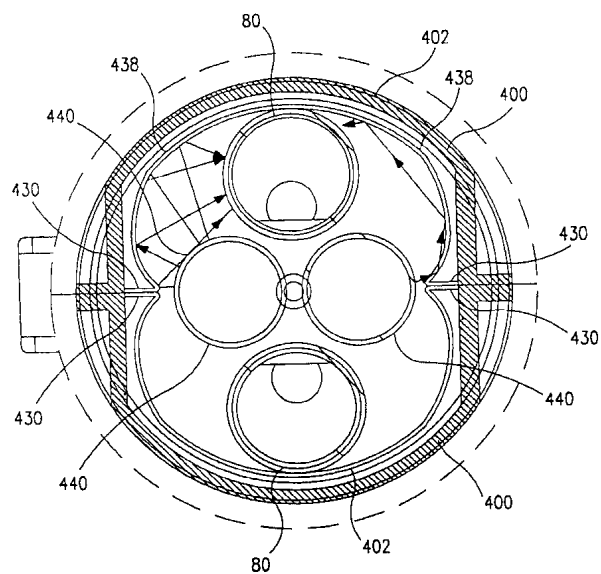

23a

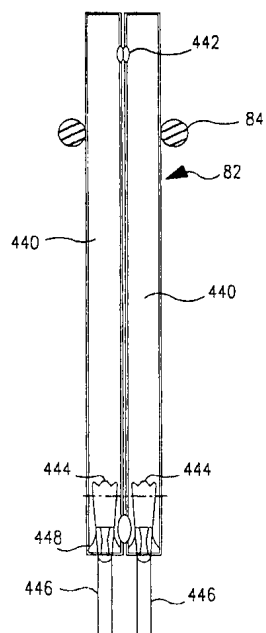

23b

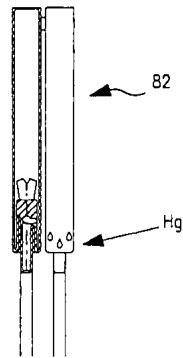

23c

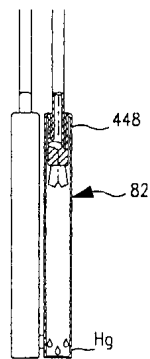

23d

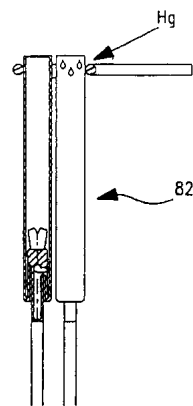

24

시동 세기 대 시간

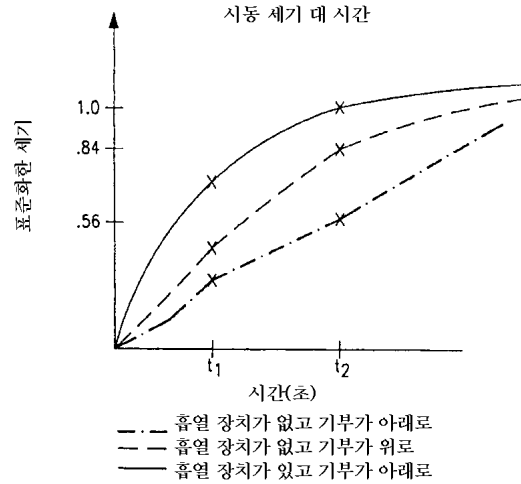

25a

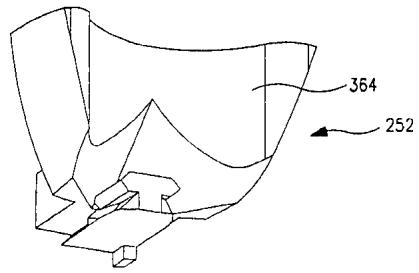

25b

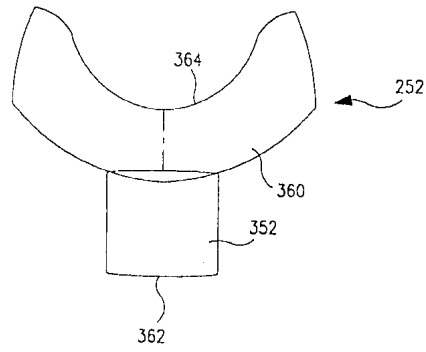

25c

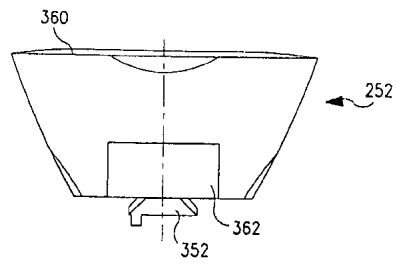

25d

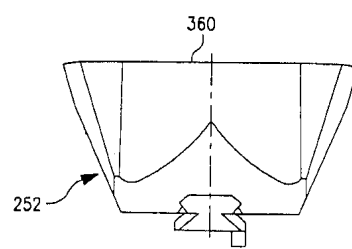

25e

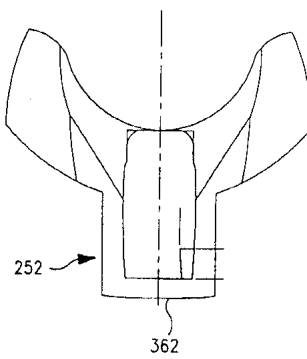

25f

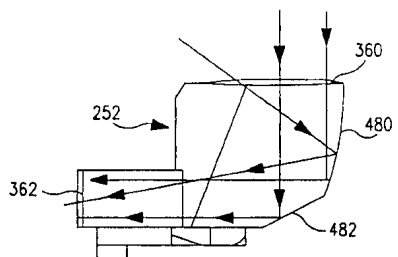

26a

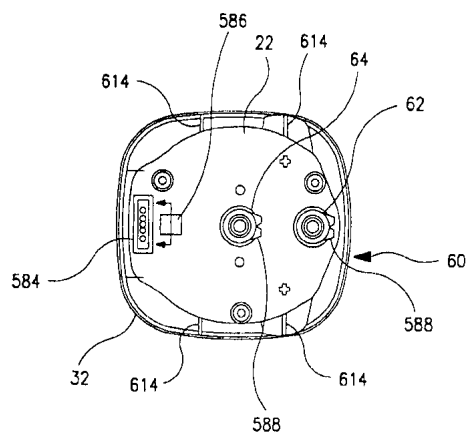

26b

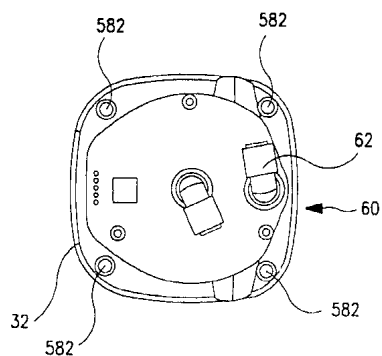

26c

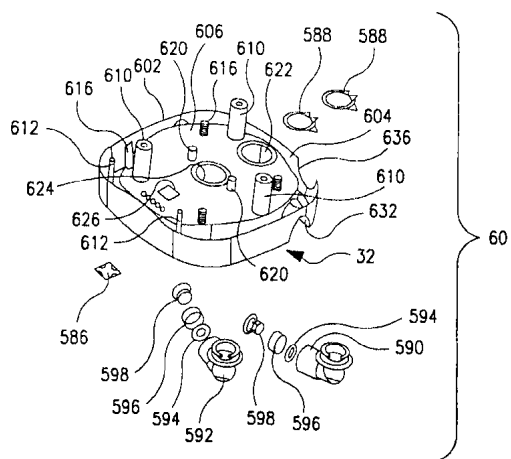

27a

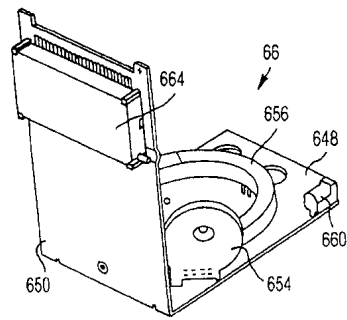

27b

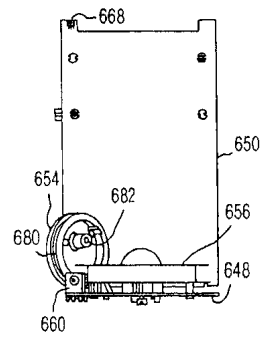

27c

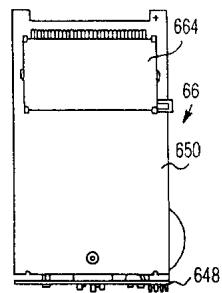

27d

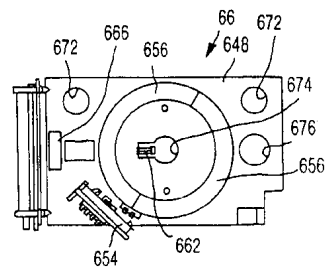

27e

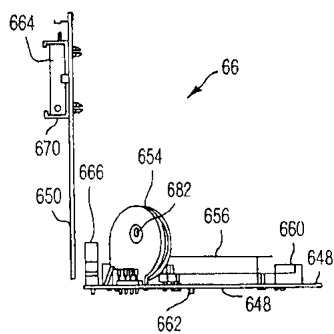

27f

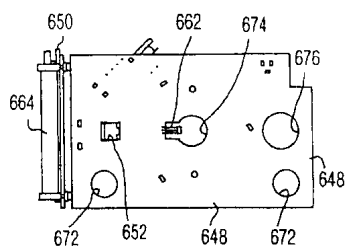

28a

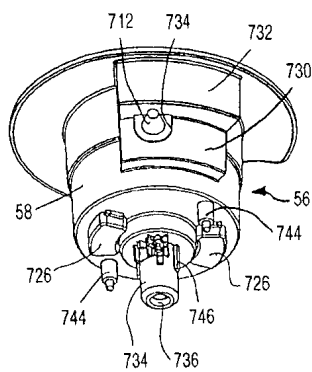

28b

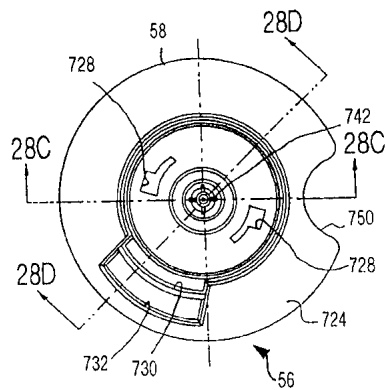

28c

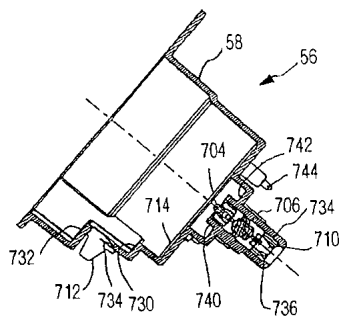

28d

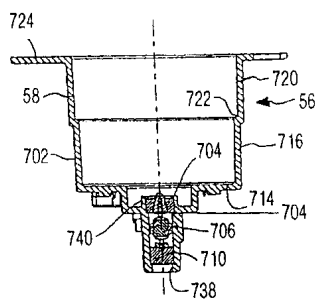

29a

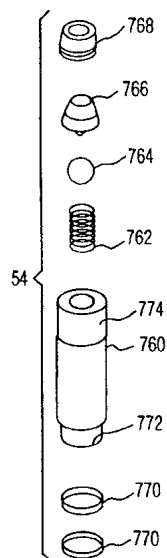

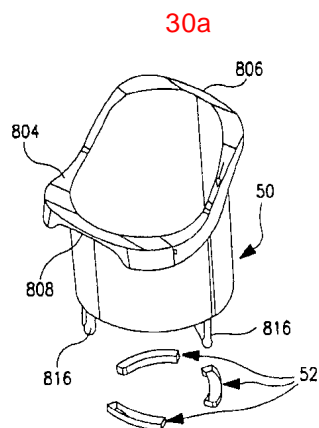
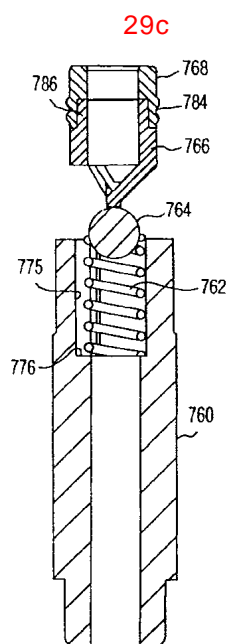
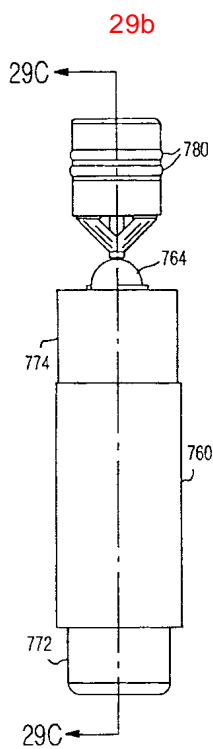

30b

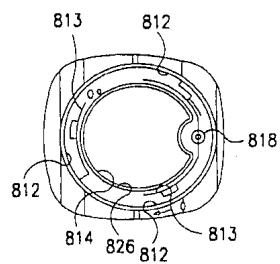

30c

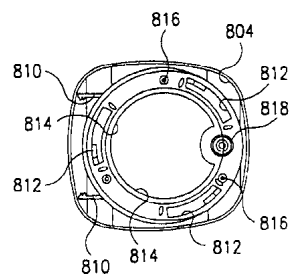

31a

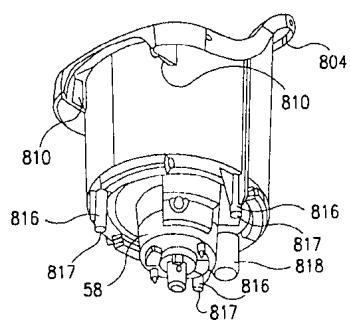

31b

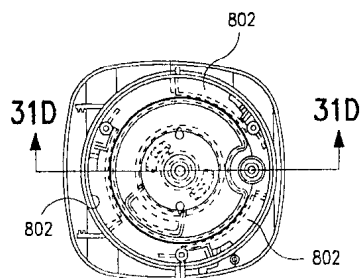

31c

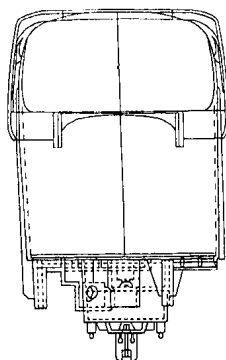

31d

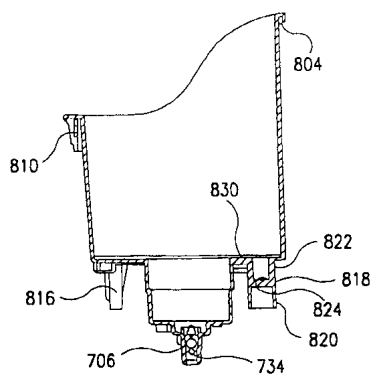

32a

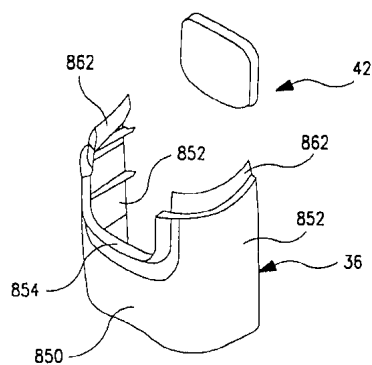

32b

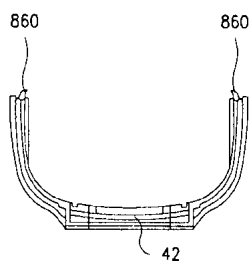

32c

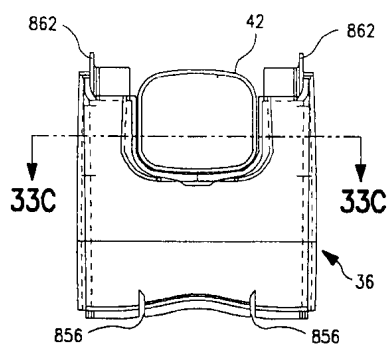

33a

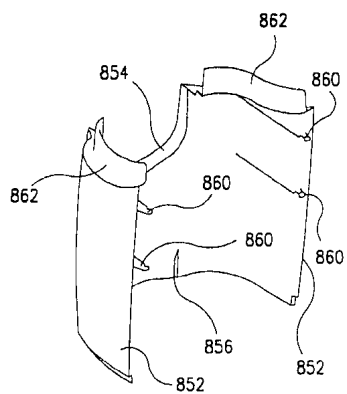

33b

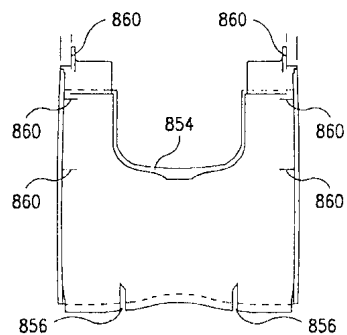

33c

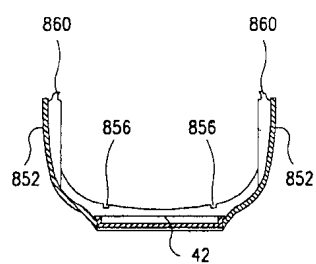

34a

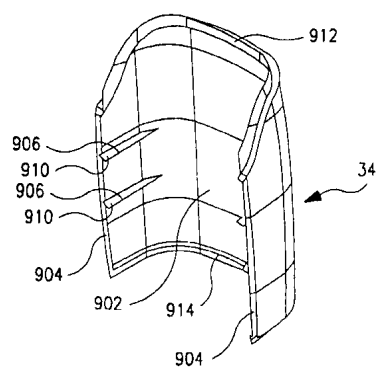

34b

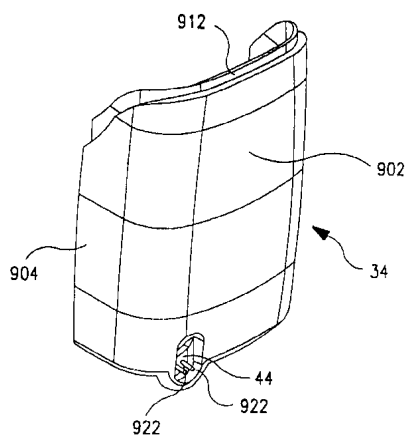

34c

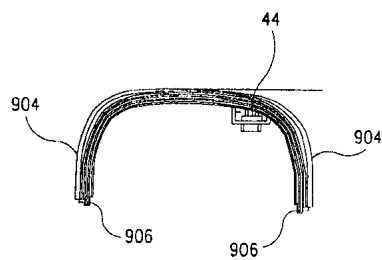

34d

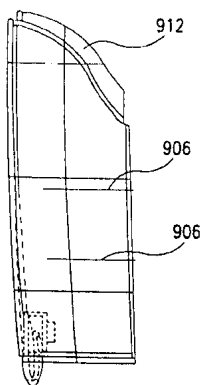

34e

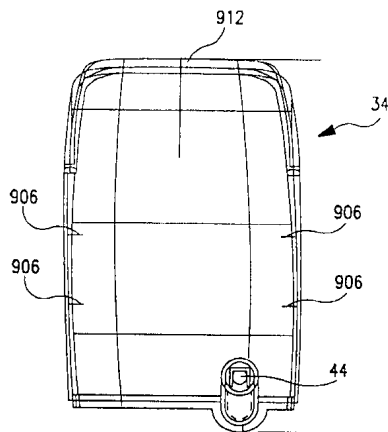

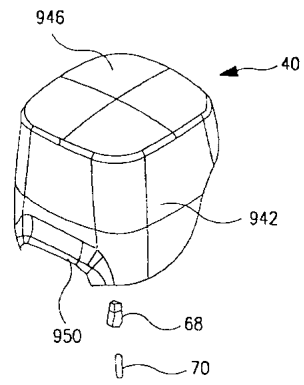
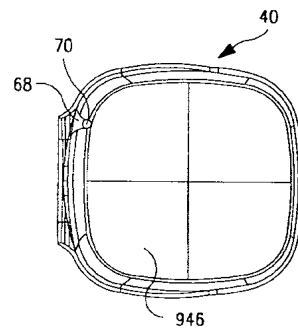
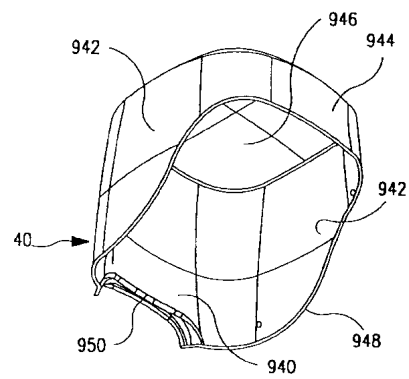
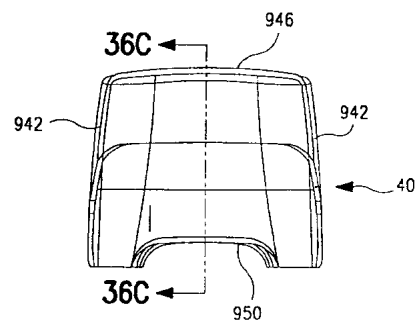
35a**35b****36a****36b**

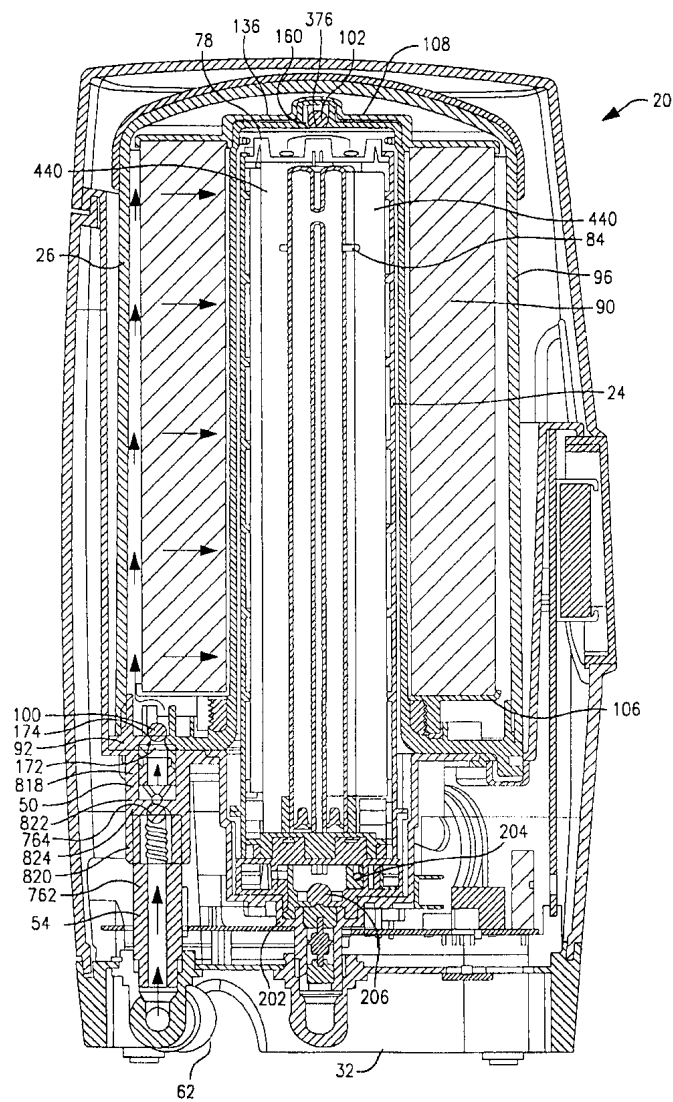
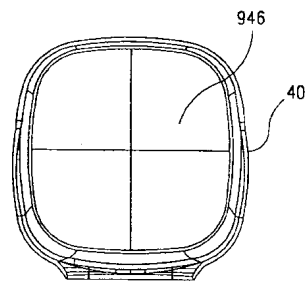
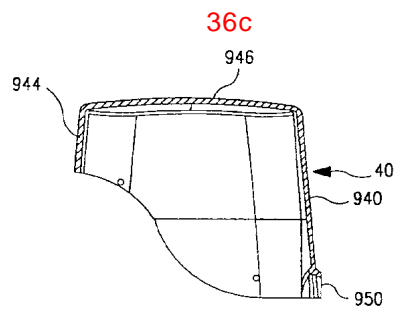

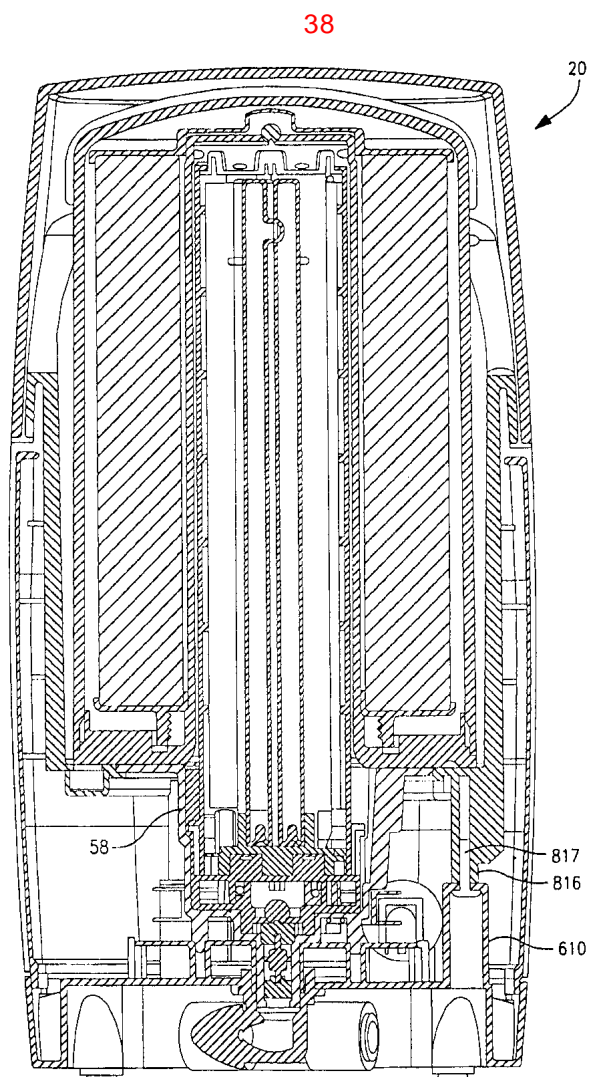

39

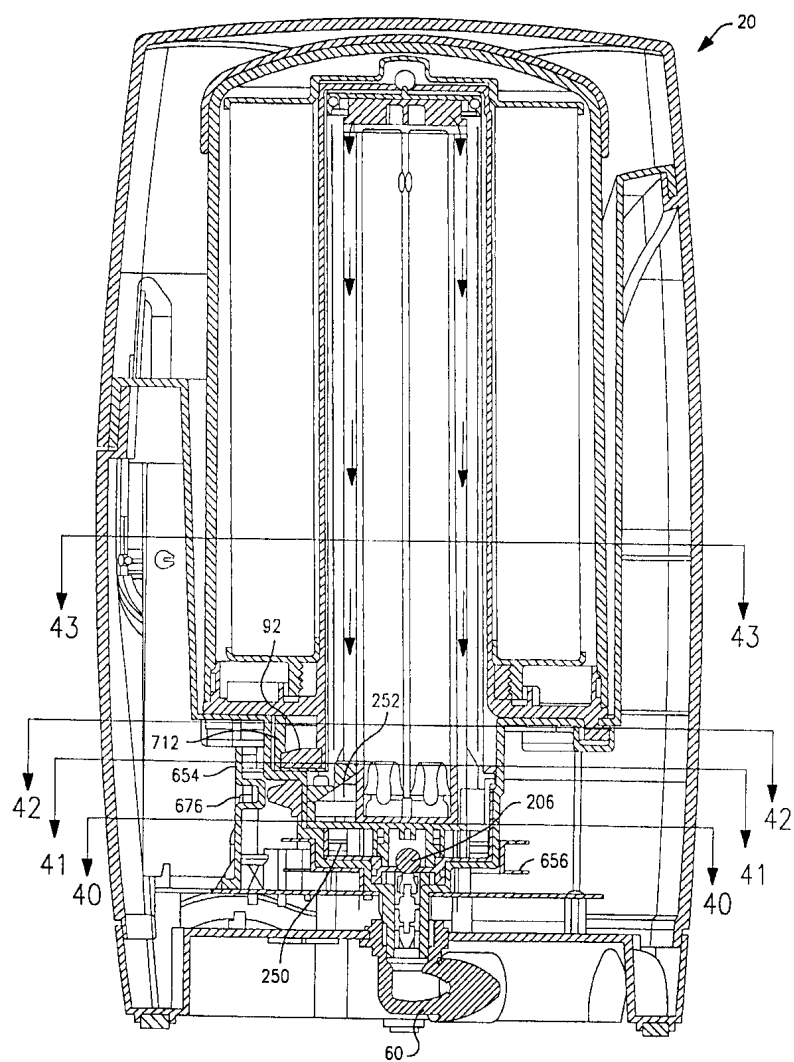

40

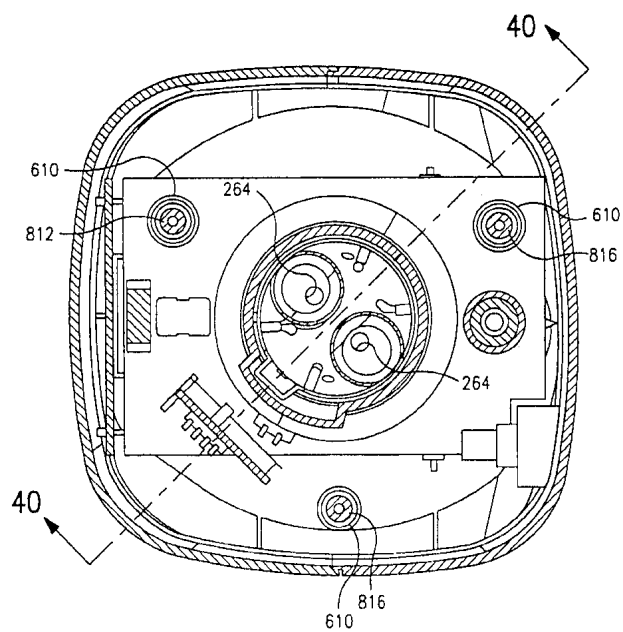

41

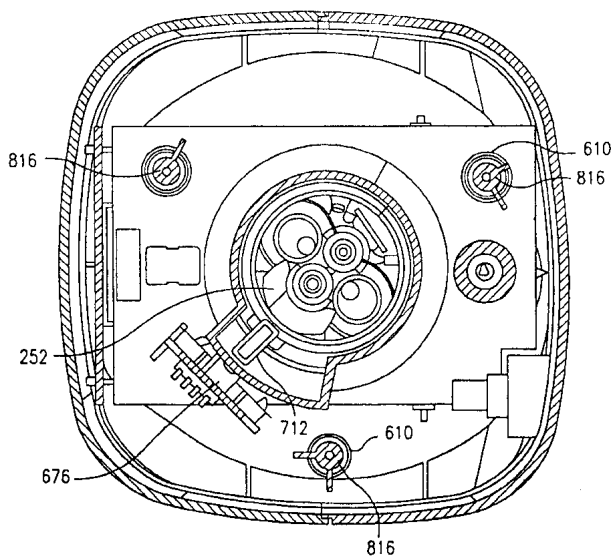

42

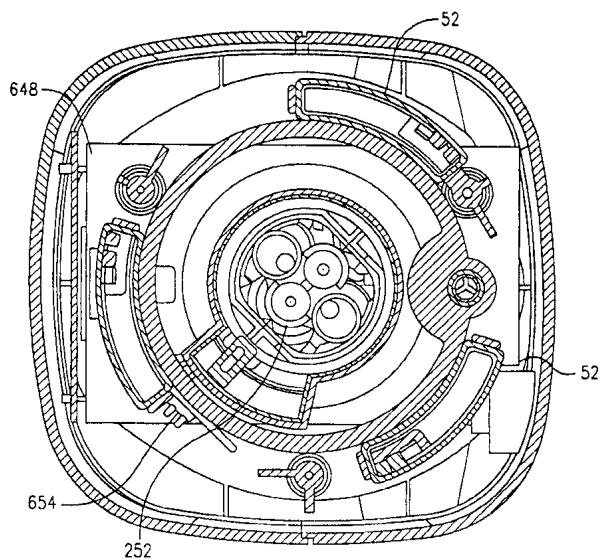

43

