

2004 09 30
10-0449842
2004 09 13

[illegible]

49408 6414

49301	2990
49417	1700
94947	.6
49505	.1054

(74)

:

(54)

system) (20) (22) . WTS (20) UV (point-of-use) (24) 2 (WTS: water treatment
 (92) (26)가 1 (74) (90) (24)가
 2 1 2 (26) 2 가 (24) (bulb) (26),
 (24) (22) (84) (24) (444)
 가 (24)가 (80)
 (82) (24)
 (400) 가 (24)가 가 (82, 402
) V 가 (250) (250) (24) () U
 (250)

5

, , , ,

1 WTS
 2 WTS
 3 WTS
 4 가 가 WTS

5 WTS
6a 6e , 6c 6E 6b 6C-6C , 6c 6D
7a 7f , , 7c 7D-7D ,
8a 8c ,
9a 9c , 9b 9C-9C
10a 10e , ,
11a 11c ,
12a 12c ,
13a 13c 2 , 13b 13C-13C
14
15a 15b
16
17
18
19
20a 20b
21a 21b
22 UV
23a 23d UV , UV ,
24 23b 23d UV
25a 25f , , , ,
26a 26c ,
27a 27f , , ,
28a 28d , , 28b 28C-28C , 28b
28D-28D
29a 29c , 29b 29C-29C
30a 30c ,
31a 31d , , 13b 31D-31D
32a 32c ,
33a 33c ,
34a 34e , ,
35a 35b
36a 36d , 36b 36C-36C
37 WTS 3 37-37
38 2 38-38
39 40 39-39
40 39 40-40
41 39 41-41
42 39 42-42
43 39 43-43

< >

20 :
22 :
24 :
26 :
90 :
92 :
96 :
100 :
102 :

35 U.S.C. § 199 (e) , 1999 6 21 가
60/140,090 , 1999 6 21 가
60/140,159 ,
가
가
(WTS:Water Treatment System) 가
UV
WTS 가 , UV 가 가 WTS
UV 가 WTS
WTS
가
WTS UV
UV
UV
WTS WTS 가 WTS
가 WTS
가 WTS
WTS
WTS 가
가 WTS
UV WTS UV
가 UV
S WTS
WTS
WTS
WTS
2 , UV 2 , 1 2
2 가 2
가
가

가 , 가 . 가 UV
 , 2 . 가
 , 가 가
 가 , 가 가
 , 가 가
 , 가 가
 , UV 가 UV 가 가 가
 UV 가 가 가
 가 , 가 가 ,
 가 UV ,
 (RFID: radio frequency identification) ,
 RFID
 가
 가 WTS
 1 2 WTS
 , 1 UV WTS 2
 WTS , UV UV
 가 가 가 가
 가 WTS WTS UV UV
 가 UV UV 가 WTS
 , UV UV 가가 가 가 가
 UV UV , UV 가
 가

(WTS) (20) 1 (22), (24) 2 3 WTS
 (20) WTS (20) 가 가 (26) (26)
 (22) (24)가 (22) (26) (22) (24)
 (22) (26) (24) WTS (20)
 1 3 (22) (bayonet) (32), (34), (36) (40)
 (42)가 (36) (42) WTS (20)

2 WTS (20) 3
 (44) (34) 4 (40)가 (26)
 (24)가 (22)
 5 , WTS (20) (22) 3
 (52), (54), (56), (62, 64)
 (32) (60) (66)가 (50)
 (32), (36) (42), (34) (40) (40)
 (68) (40) (70) (70) WTS (2
 0) (70) (66)
 WTS (20) 가
 (24) (72), 2 (74), (76), (78),
 (80), UV (82), (26)
 (90), (92), (94), (96) (98)
 WTS (20)
 A.
 6a 6e (26) (88), (96),
 (100), (102), (92), (94), (104)
 (98) (98) (96)
 가 (88) (106) (108) (110)
 (90) (88) (90)
 (110) (90)
 (112) (112) (92)
 (66)
 6c 6d (112) (88) (96) (104)
 (92) (104)
 (88) (94) (92)
 (92) (94)
 (100) (92) (96) 가 (92) (102)
 (92) (88) (108) 가 (114)
 6d (106) (116) (116) 4 (116)
 (120)가 (114) (90) (108)
 122) (124, 126) 6e (136)
 (132, 134) (130), (90) 4 (140)
 (108) (92) (102) 가 (144)
 (96) (142) (144) (146)가 6c 6d
 (148) (146) (92) (146)가 . EMA
 (92) 7a 7f (92) (150),
 (152) (154) (154) (160)가 (102)
 156) . 3 (162) (160) (164)가 (152)
 (24)() (166)
 6d (150) (104) , (174) (172) ,
 (100) 3 (176) (170)
 7a 7d , 3 (178) L (180)
 (26)가 (50) (26)가 (22)
 (178) (186) (186)
 (186) (112) (184) (22)
 (66) (150)
 (94) (192) (94) (94) 6c 6d (9
 2) (152) (92) (94) (150)
) (92)

(26) (94) (150) (92)
 (152) (94) (152) (102)
 (100) (174) (176) (104) (92) (150) (108) (104)
 (164) (162) (102) (162) (94) (26) (88) (150) (104)
 (170) (102) (92) (152) (26) (108) (104)
 140) (88) (88) (92) (94) (96) (148) (150) (15
 0) (88) (EMA WELD) (96) (146) EMA (112) (12)
 (184) 가 (20) 6c 6d (26)
 WTS (172) (100) (174) (25) (172)
 가 (100) (174) (88) (106) (90)
 (92) (150) (90) (90) (92) (136)
 가 (154) (102) (164) (26)가 (22) (26)
) 가 (26) (102) (164) (26)가 (26)
 (24) (24) (102) (164) (26)
 (26)
 B.
 8a 8c (24) (24) (72), 2 (74),
 (76), (78), (80), UV (82), O- (84),
 (86)
 9a 9c (72) (72) (200), O- (202),
 (204) (206) (200) (210) (212) (214) (21
 14) (212) (222) (220) (224) (228)
 (206) (210) (226) (232) (212)
 0) (230) L (24) (58) 가
 212) (232) WTS (20) (234) (230) 가 (24) 가
 O- (202) (24)가 (22) (24) (72)
 (206) UV (204) 37 38 O- (202) (72) (58)
 (76)
 (76) 10a (244) 10b 10e (246)가
 (240) O- (250) (252) (242) (250) (24
 (242) (250) (66) UV (250) (66)
 (76) (252) (24) WTS (20)
 가 WTS (20) WTS (20)
 O- (240) 11a 11c (260) O- (244)
 (286) 2 (74) (260) (264)가 8 (268)가 (240)
) (200) (224) (240) (274) (240)
 240) (242) (240) (240) (72)(9a)
 11c (214) (276) (282) (280) (276) 2
 (284, 286)가 T (284, 286)
 (74) (242) 12a 12c (290) O- (244)
 (240) (260) (290) (292) (80)

) (8a). 6 (294) UV (82)
 (8a). (296) (250) (252)
 (15b). (296) 4 (300)
 (300) (252) (296) (240)
 (302, 304) (306) (296) , 4
 (310) (306) (246) (290)
 (312) (240) (76) .
 O- (10a).
 2 (74) 13a (74) (326) (320) .
 (326) 55 (320) (322) (320)
 (324) (330)가 (324) (322) 2
 (74) (76)(8a) (240) (266)(11a
 11c)
 (250) 14 (250) (342)
 (340) (340) (344) (346) (342)
 (344) (346) (296)
 (252) 15a 15b (252) (350) (352)
 (352) (354)가 (354) (252) (242)
 (296) 4 (302)(12a 12c) (350)
 (360) (24) UV UV (252)
 (362) (252) 가 UV (364) UV
 (82) (24)가 (36) UV
 (252) (24)
 16 (78) (78) (366), (36
 8), O- (370) O- (372) (366) (368) 17 18
 (368) (376) (26)가 (24) (26) (102)
 O- (370) (382) (380)가 (386)
 (374) (384) (384)
)가 (374) (388)가 (366) (368) (384)
 (392)가 O- (372) (24) (390) (394) (368)
 O- (78) (384) (80) 가
 19 (24) (392) (400)
 (405) (86) 20a 20b (400)
 (408) (410) (407)가 가 , (400) (408) (
 410) (400) (400) (416) (400)
 (412, 414)가 (416) (24)가 (400)
 78) (420) O- (370) (424)가 (424)
 (400) (422) (422) (200) (406)
 (76) (400)
 (200) (400)
 (426) (402) (402) (430)
 21a 21b 가 (432) (434) (436) (434)
 (432) 90 ° () (432) , (43)
 6) (430) (438) 가() UV (80)
 22 , UV (82) (440)
 (440) , (436) , (4
 438) (430) (436) UV
 40) (402) 가 , (402) (80)
 (82) (402) 1 (402) (440)
 (440) (80) , 가 (402) 3
 (80) 40% 가

(402) UV (402) (facet) (440)

(402) (80)

23a UV (82) UV (82) 가 가 2 (440) (446)

(442)가 2 (440) (444) (446)

가 2 (446) UV (82) (448) (446) (24) (Ne-Ar)

가 2 (74) UV 99.5 : 0.5 가 99 : 1 (Hg)

(440) UV (82) 가 (440)

가 UV 가

WTS (20) UV 가

WTS (444) (442) (444)

가

Hg가 254 UV UV 가 (24)

(80) UV (82) (80) O- (84) WTS

(20) UV (82)가 , O- (84) (440) (24)가

(440) O- (84) (440) O- (84) O- (84) (444)

(444) (82) (444)

23b 23d 3가 UV (82) UV (82) Hg가

가 O- (84) (440) 23b 23c , UV (82) 가

(448) , 23d , UV (82) UV (84) O- (82) 2 , t

1 t 2 (t 2) UV (82)가 (t 2) 1.0 가

24 , 가

UV 가 0.84 가 UV (84) O- (84)

가 / 가 UV 0.56 (84)가 (24)가 AI

가 가 , O- (84)

(252) (252) 1% 가

, V826 60-3170 UV 25

(Uniform Color of Holland) 가

4 nm (252) 가 , UV (7

2) WTS (20) 가 가 (252) , UV (252) (24)가

(252) UV (252) 가 (252)

(24) (364) (360) (352)

(252) (362) (360) (362) (444) (3)

64) 가 UV (82) (444)

25f 가 , (252) 25c
 , (360) (364) (262)
 (360) (402) (24)
 UV 가 UV 가 가 , (252)
 (252) (252)
 25f 가 (362) (252) UV
 (252) (24)
 , (362) 가 (82)
 (look up table) (362)
 UV 가 UV 가 UV
 가 UV 가 가
 가 UV 가
 (24) (252) 가
 UV 가 (82)가 UV , (362) 가
 가 (24) (76) 10a
 , O- (244) (240) (242) (250) (296)
 (252) (296) (240)
 (242)가 8a , 2 (74) (322) (330)가
 (76) (240) (266) (366) (368)
 (78)가 16 O- (372)
 UV (82) (440)가 (240) (270, 272) (76)
) 가 (294) (80) (440) (80)가 (206) O- (244)
 가 (82) , O- (84) UV
 (78)가 (80) O- (372) (80)
 , 가 (400) (404) (402) (432) (402)가 (40)
 0) UV (82), (80), (86) (76, 78) 가 (86)
 , (86) , 2 (86) , (408) (410) (407)
 C.
 26a 26c (60) (60) (32),
 (588) (62, 64), 4 (582), (584), (586) C-
 C- (588) (62, 64) (590), (592), O- (594), (596) (598)
 (32)가 26c (602) (606) (604)
 . 3 (610) (50) (32) 4 (614) (66)
 (34, 36) (612) , (602) (606) , 4 (616) (66)
 . 2 (620) (58) (626) (66)
 622, 624) C- (62, 64) (632, 634)가 WTS (20)
 (66)가 27a 27f (66) (648),
 (650), (652), 1 (656), (654), (660), (flow hall effect)
 (662), VFD(664), (666) (668) (676) (672) (32)
 672), (662)가 (674) (676) (674, 676) (50) (56)
 (610)가 가 (648) (22) (616)
 가 (654) (674) (676) (674) (252) 가
 (112, 250) (668) (40) (70) (22)
 (650)

28a 28d (58), (704), (706),
 (710) (712) (58) (714); (722) (714)
 (716, 720); (724) 28b (726) (24)
 (714) L (728) (716, 720) (730, 7
 (232) (730, 732) (24)가 (56)
 32)가 (252) (296) (716) (734) (712)
 (24)가 (56) (252) (734) (7
 12) (712) 41 (676) (740)가 (736
) (738)가 (736) (714) (742)
 (704, 710) (738) 4 (742) (742)
) (704, 710) (704) 가 (740)
 (24)가 (58) (704) (24) (200) (206)
 가 (706) (64)
 (24)가 (58) (206) 가 (24)
 (704, 710) (706)
 (706)가 (663)
 , WTS (20) (714) (750)가
 (32) (620) (744) (60)
 (50) (724) (50) 29a 29c (54
 37 (62) (26) (172) (760), (762),
) (764), (766), (768) O- (770) (760)
 (760) O- (775) (762) (772, 774) (776) 가 (766) (7
 64) (762) (26)가 WTS (26)가 (20) (50) (764) 가
 (54) (26) (768) (766) (50)
 (780)가 (768) (766)
 (768) 30a 30c (50) 3 31a 31d (56)가
 (804) (50) (50) (80) (806)
 (80) (650) (80) (810)가
 L 30b 30c (50) (26) (180) 3
 (813)가 (812) (26) (178) (26)가 (50) 3
 (812) (178) (52) (50) 가
 (812) (814)가 (56)
 (56) (22) (50) 3
 (816) 3 (610) (610) (81
 6) (817) (50) 31d 37 (818)
 (818) (822) (824) (820) (818)
 54) (762) (764) (822) (766) (768)
 가 (814) (726)가 (726) (56)
 (724) (730)가 (42) (36)가 (36)
 36) 32a 32c , 33a 33c (852) U (850)
 (42) (850) (854)가 (856)
 (850) (860)가 (852) (852)
 (862)가 (42) (854)
 (34)가 35a 35e (34) (902) (904)
 (36) (904) (860) 가 (906)가 (906) 가
 (910)가

가 (34) 가 (34) (914) (24) (44) (902) 35a 35b (40), (68) (70) 36a 36d (40) (948) (40) (940), (942), (944) (946) (950) (950) (932) (668) (68) (70) (668) (40)가 WTS (20) (22) (50) () (52) (50) (726) (704, 706) (58) (734) (706) (58) (734) (712) (830) (814) (54)가 (50) (818) O- (770) (760) (768) 29a 29c 37 (760) (820) (818) (820) (818) (824) (58) (810) (42) 62) (766) (764) (780) (818) (818) (748) (50) (34)가 (66)가 (650) (36) (36) (62, 64) (32) (748) (60) VFD (60)가 (66) (62, 64) (744) (748) (760) (772) (5) (8) (736) (610) 40 41 (748) (32) (620) (61) 0) 3 (850) (610) (816) 가 (748) (816) (817) 3 (34, 36) 가 (610) (40) (22) 가 (232) (24) (58) L (726) (26) (180) L (812) (24) (26)가 (26) (2) (40) (68) (70) (68) (20) (40) (26) (34, 36) WTS (20) 가 37 가 (34) 가 (62) 가 (54) (50) (54) (172) (100) (174) (106) (96) (90) (92) (90) (108) (136) (1) 08) (92) (154) (26) (24) (376) (102) (2) 6) (92) (164) (388) (24) (160) (80) (656) UV (78) (82) UV (24) (82) UV (252) (252) (712) 가 (676) (112, 250) (65) 4) 38 (402) UV (76) UV (82) UV (76) (80) (264) (72) 가

(206) (704) (72) (228)
 (662) WTS (

20) (706) WTS (20)

(60)

가

UV 2

가

가 2

2

1

가 2

가

가

(57)

1. (20) , (22) , UV 가 (24)
 (682) 가 UV 가 (82) , UV 가 (24)
 (252) (86)
2. (682) 가 (24) (82) UV
 (252) 가 (82) UV
3. (252) 가
4. (252)
5. (82) 1 2 (444)가 1 2 , 1 2
 (440) , (252) (82) 1 (444)
 1 (364) , (440) 2 (350) 가 ,
 가 (682) 가 (360) UV (
6. (82) (252) (364) 1 2 (444)가
7. 2 (360) (82)
8. (252) 가 (682) (362) 가 , (252)
9. (24) (82) (24)
 (402)
10. (252)

11.
1 , .
12.
1 , 2 (360) (402)
.
13.
(82) UV , (82)
(444) 1 2 ,
, 가 , (360), (364) (362) , (360)
(362) (252)
(82) (360)
UV 가 (82)
1 2 가 (444) (364) (252)
가 (252) (362) (360)
(82) UV 가 ,
(252) (362)
14.
13 , (364) (362)
.
15.
14 , .
16.
15 , (24) UV (362) 가
.
17.
16 , (360) (82) .
18.
16 , (364) (440) .

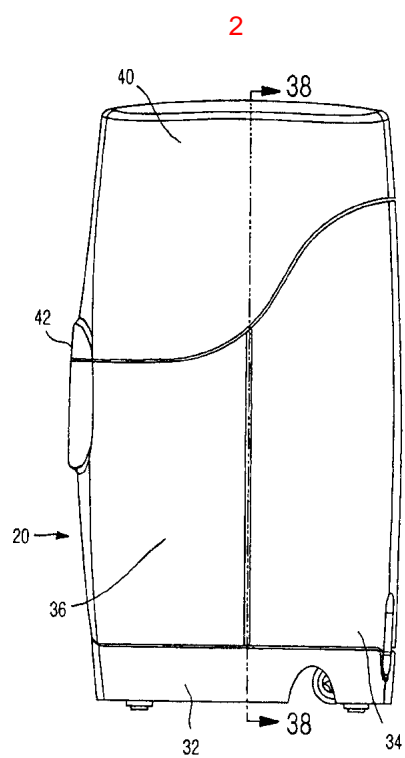
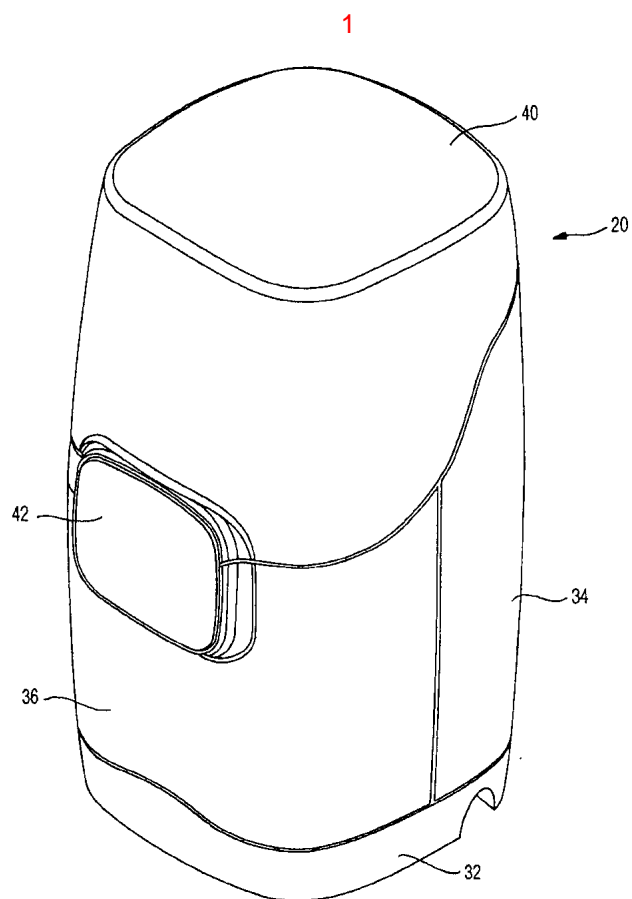

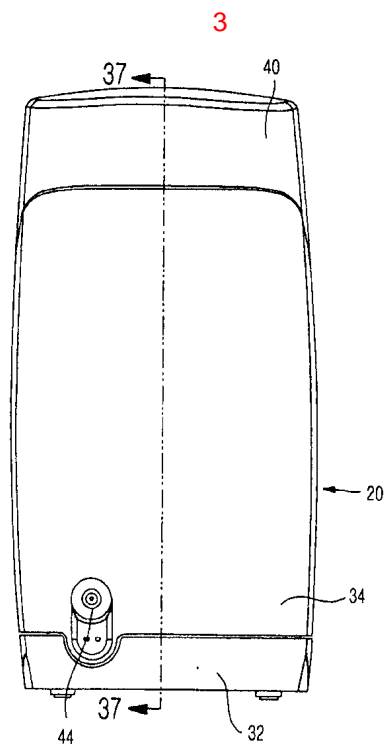

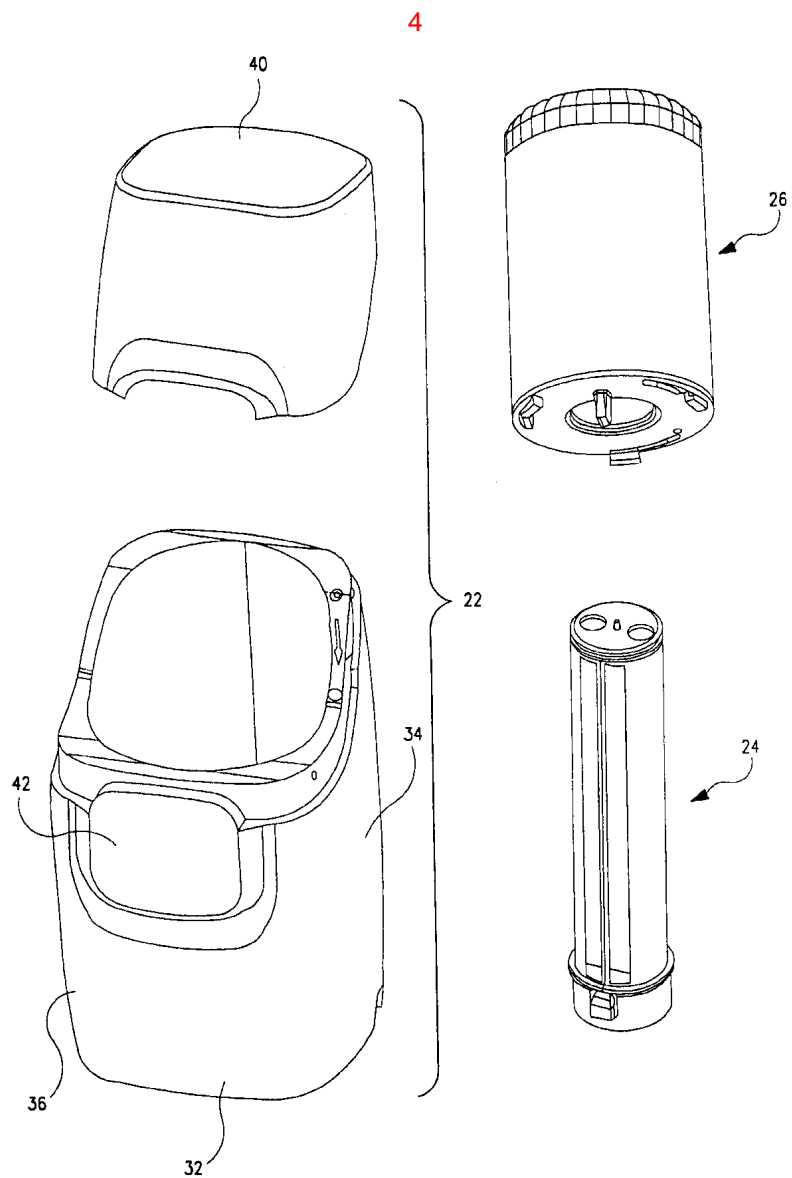

5

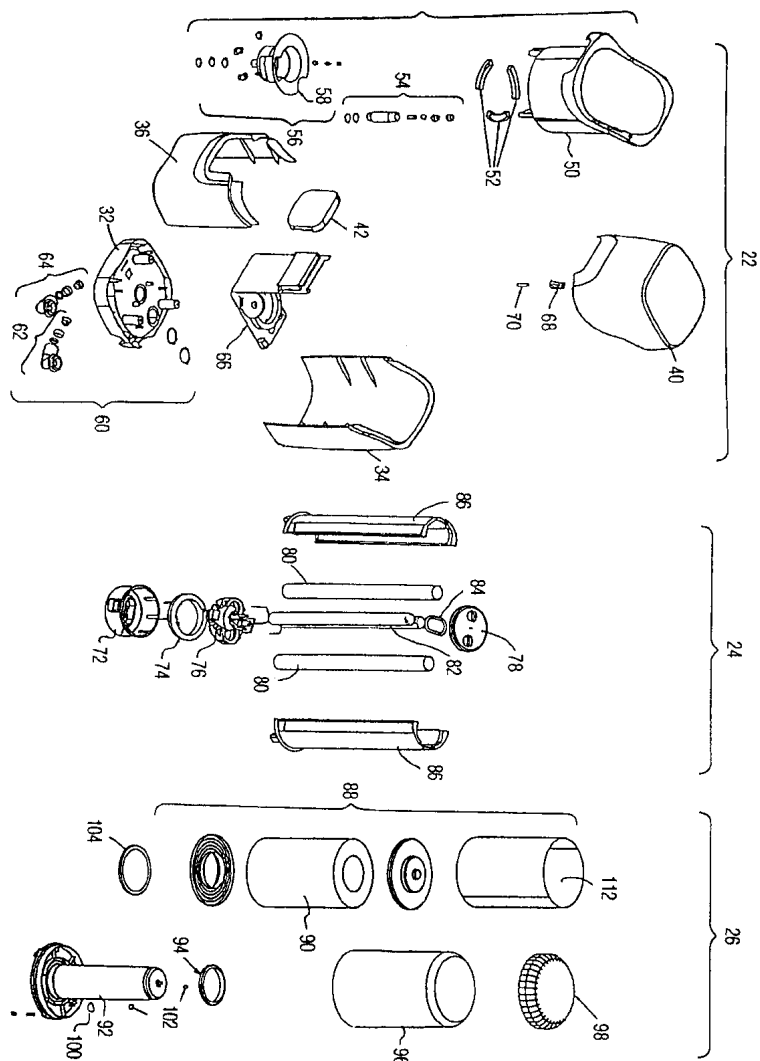

6a

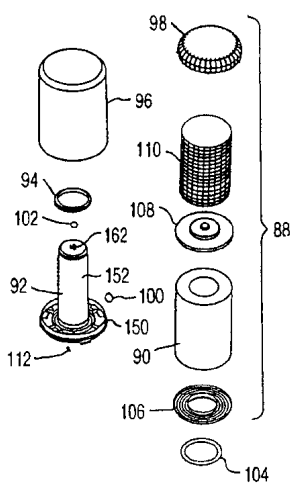

6b

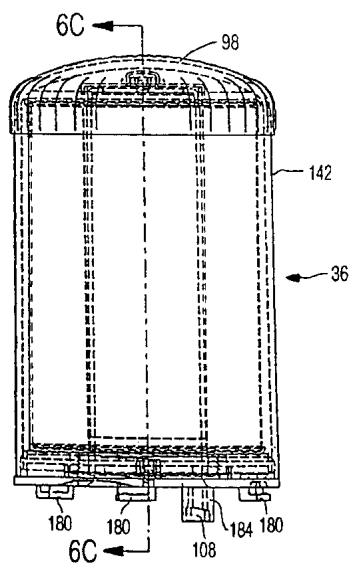

6c

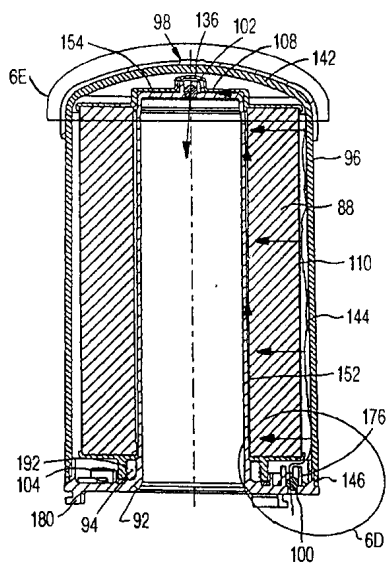

6d

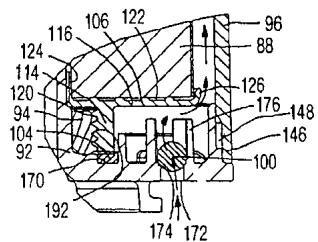

6e

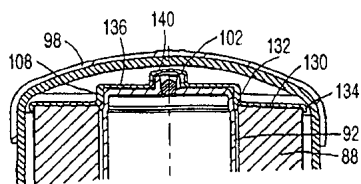

7a

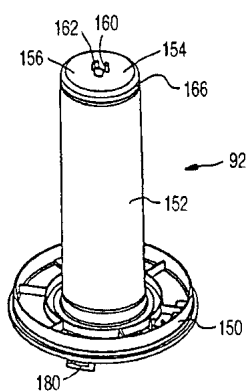

7b

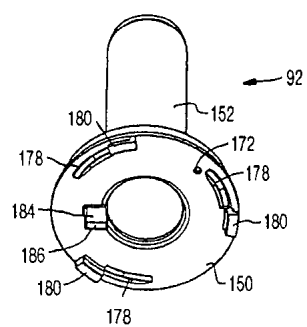

7c

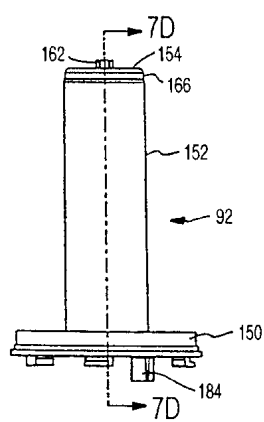

7d

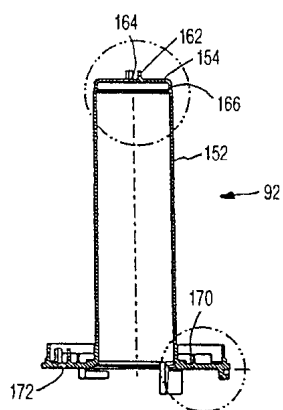

7e

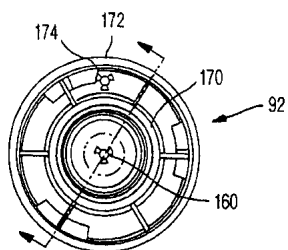

7f

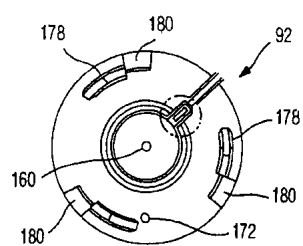

8a

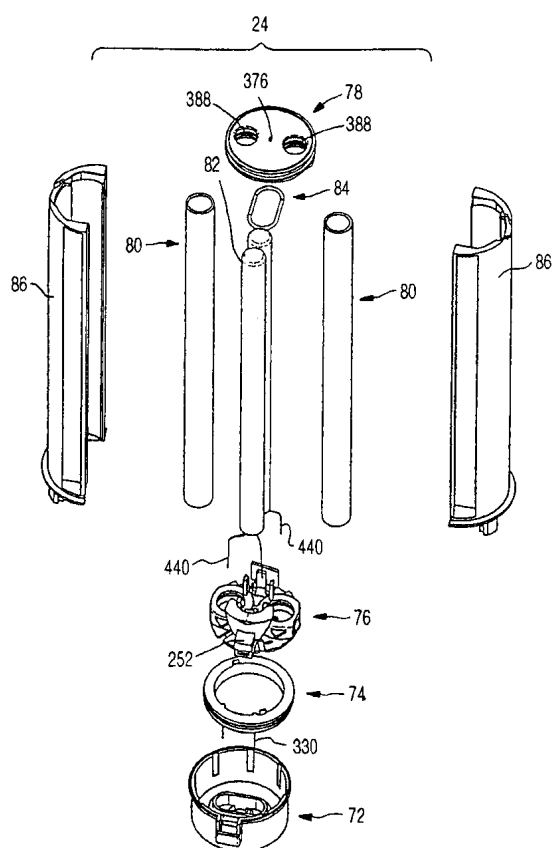

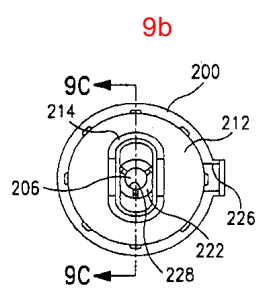
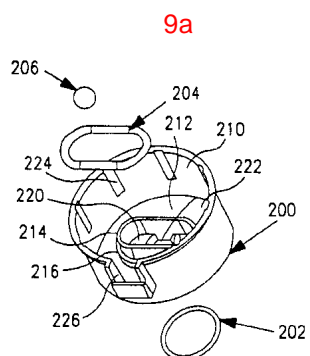
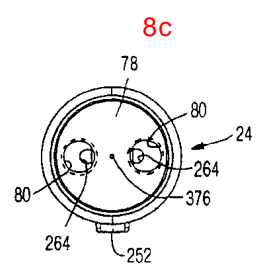
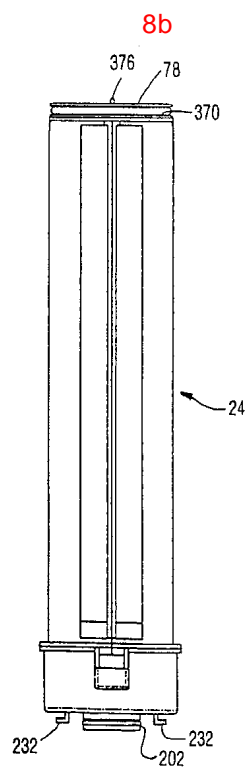

9c

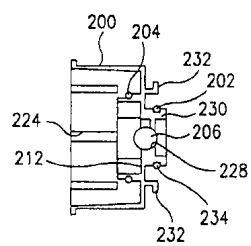

10a

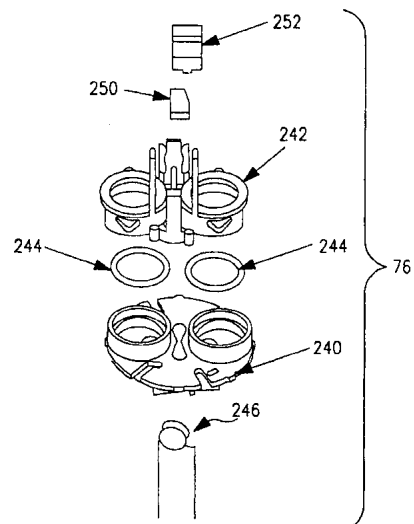

10b

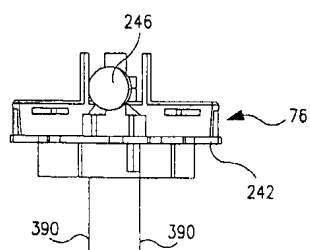

10c

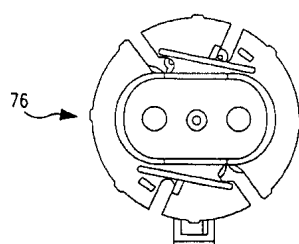

10d

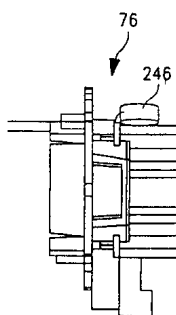

10e

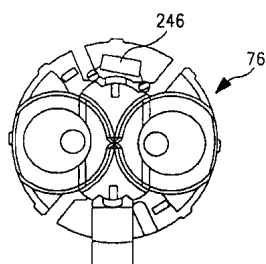

11a

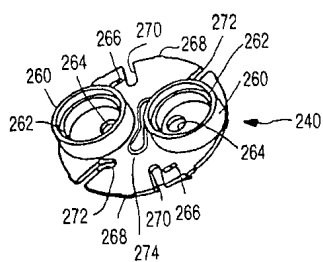

11b

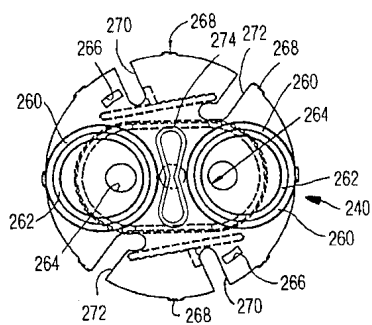

11c

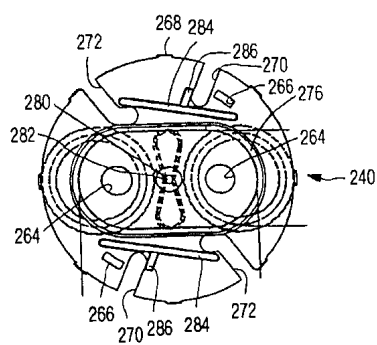

12a

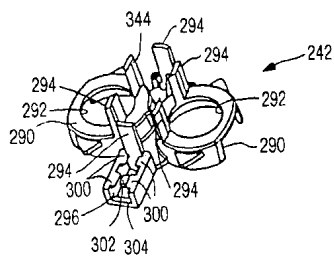

12b

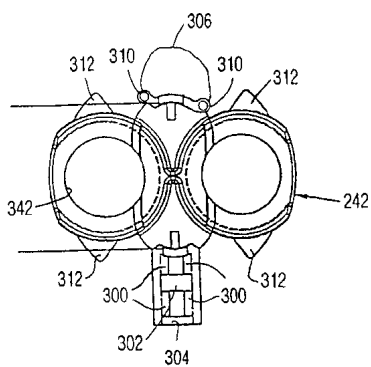

12c

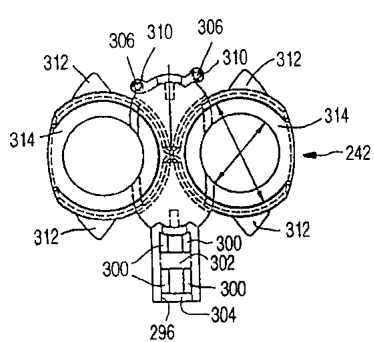

13a

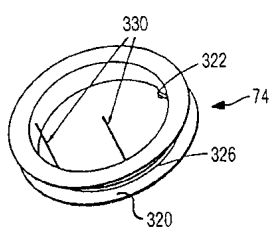

13b

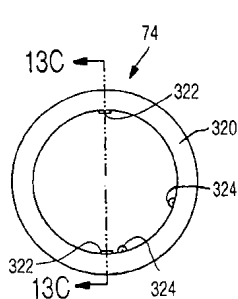

13c

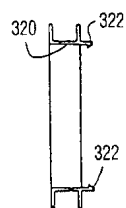

14

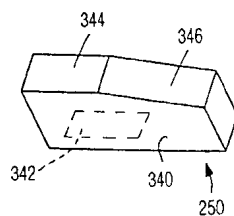

15a

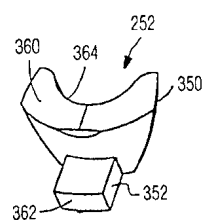

15b

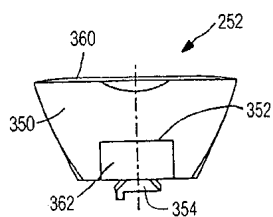

16

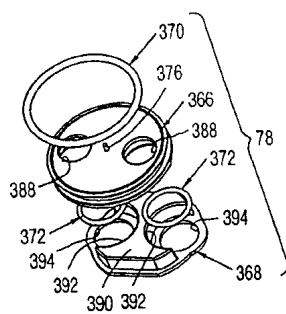

17

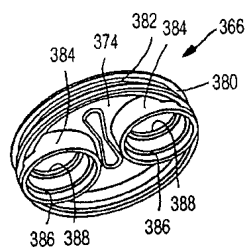

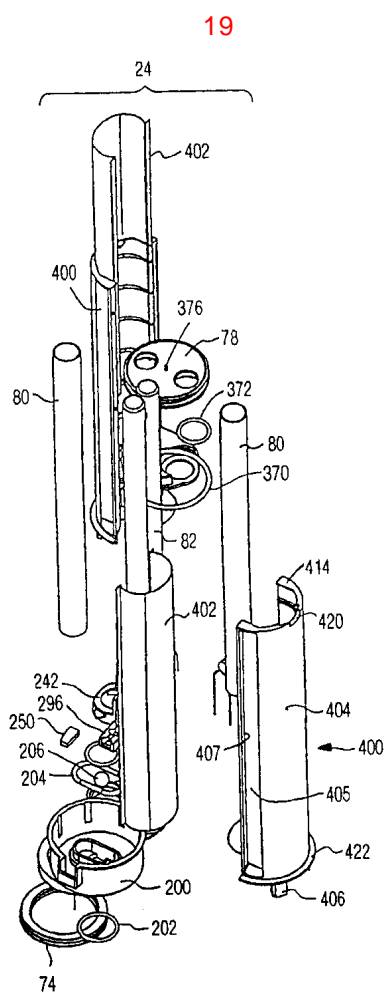
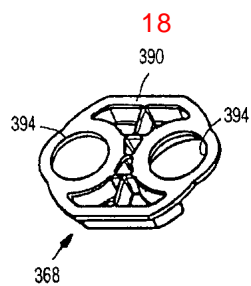

20a

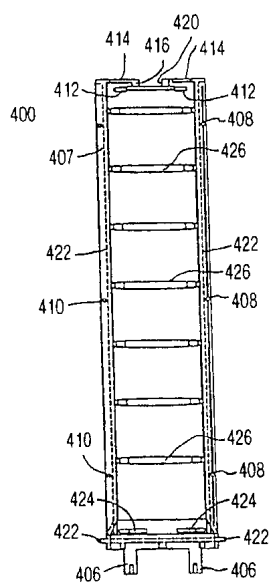

20b

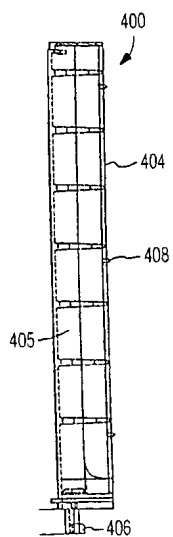

21a

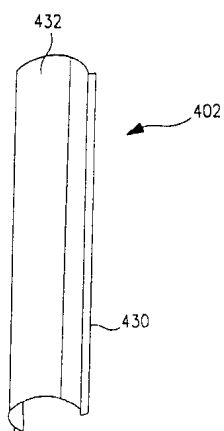

21b

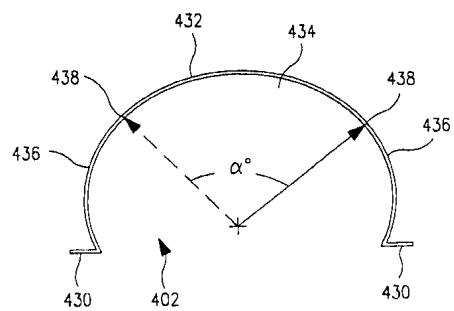

22

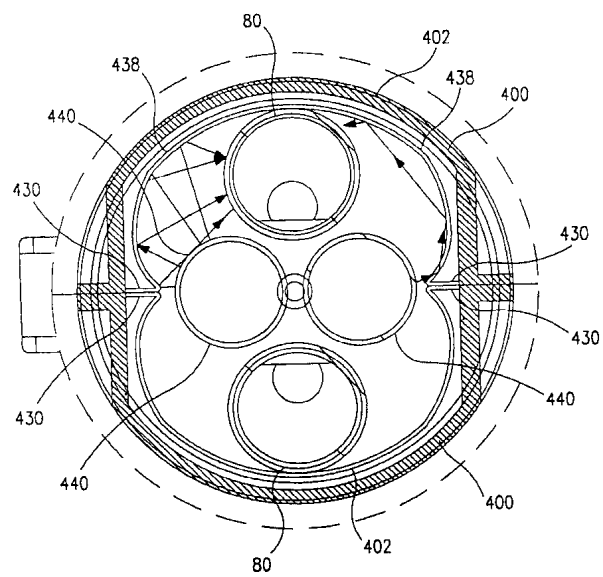

23a

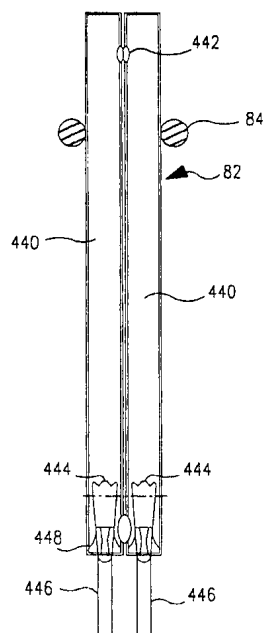

23b

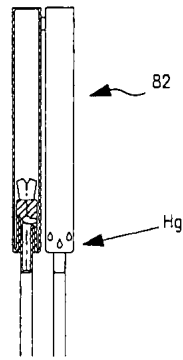

23c

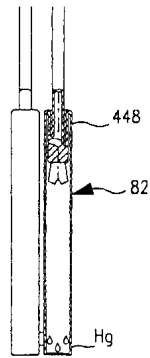

23d

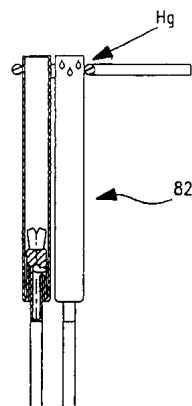

24

시동 세기 대 시간

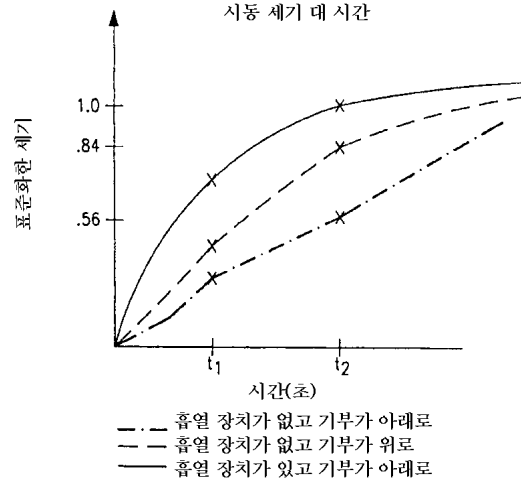

25a

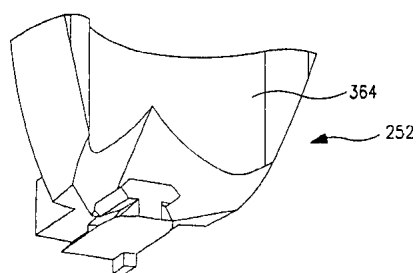

25b

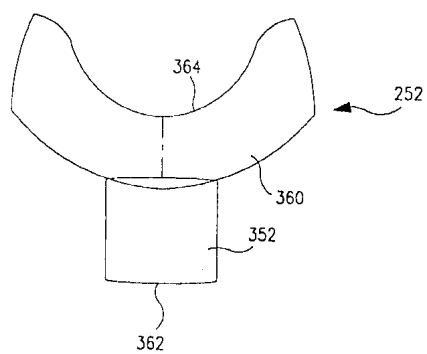

25c

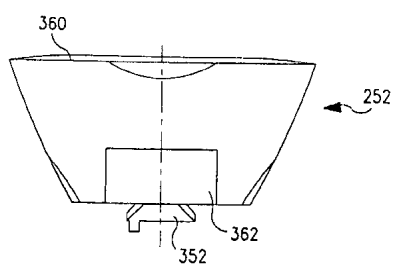

25d

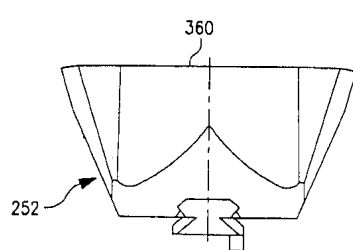

25e

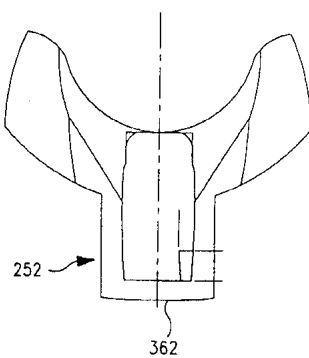

25f

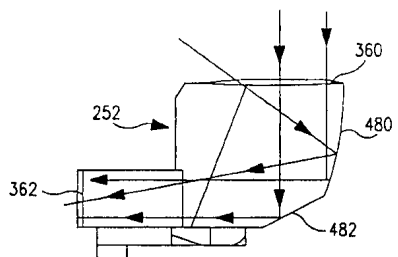

26a

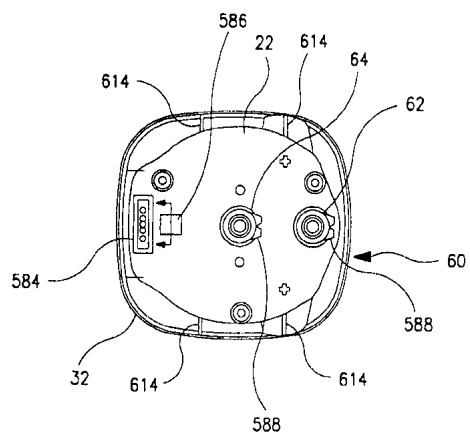

26b

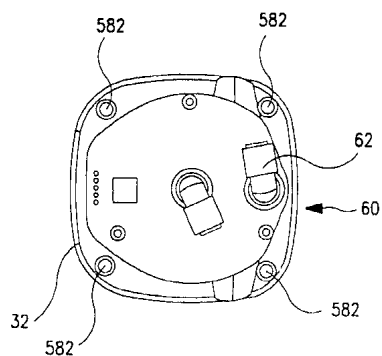

26c

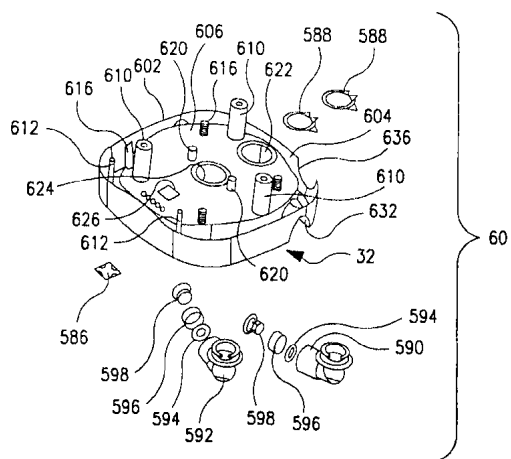

27a

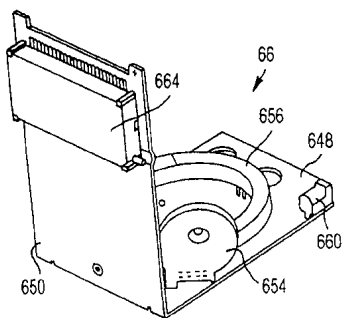

27b

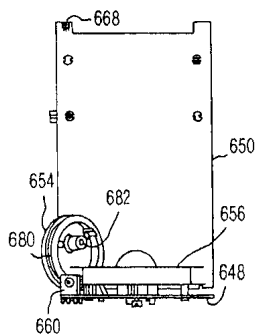

27c

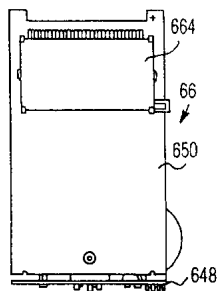

27d

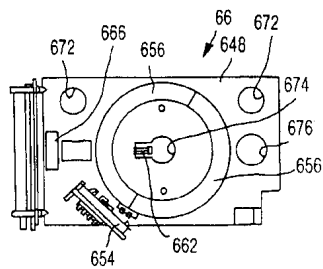

27e

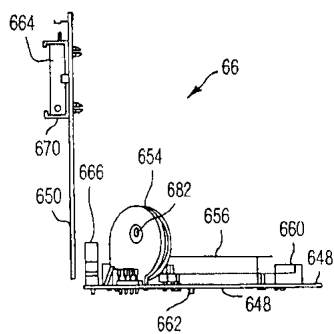

27f

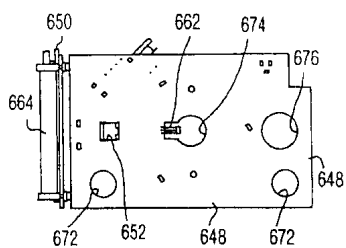

28a

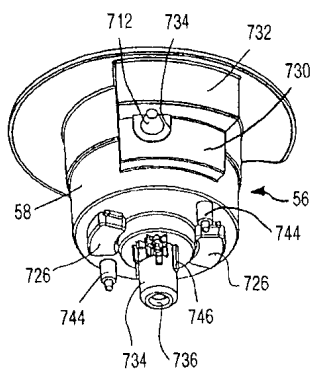

28b

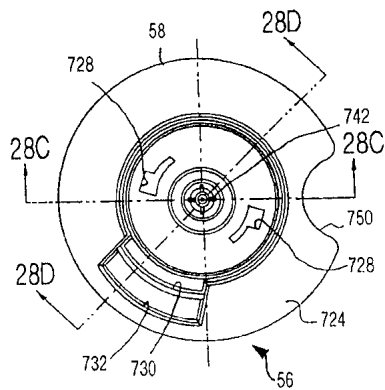

28c

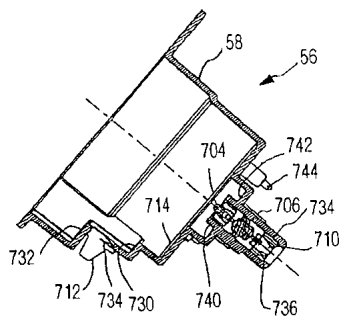

28d

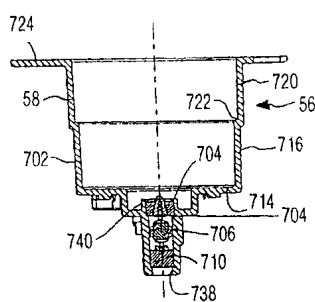

29a

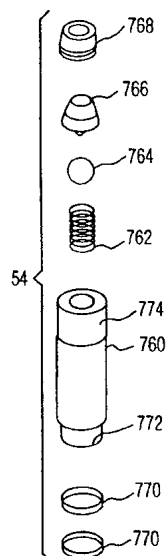

29b

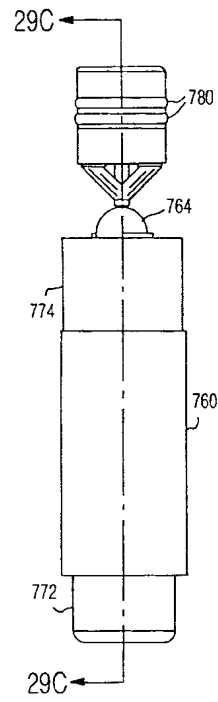

29c

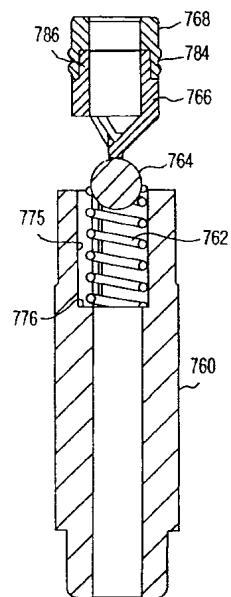

30a

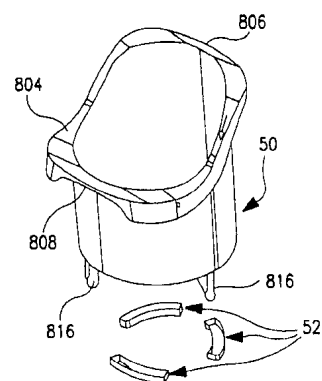

30b

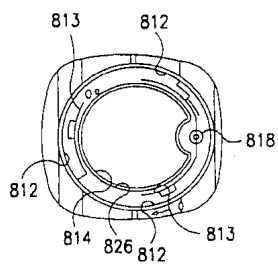

30c

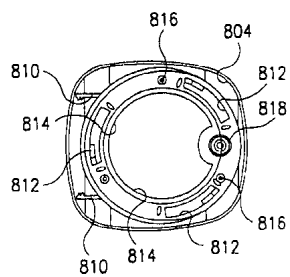

31a

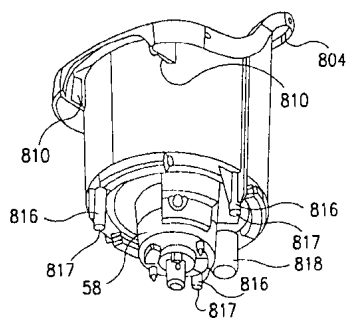

31b

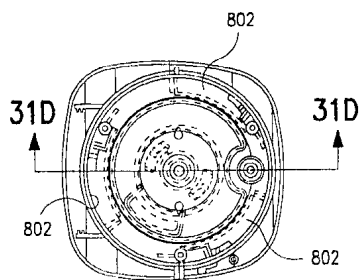

31c

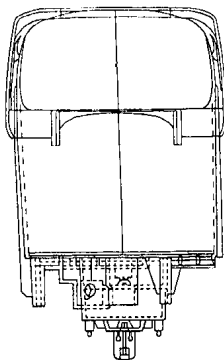

31d

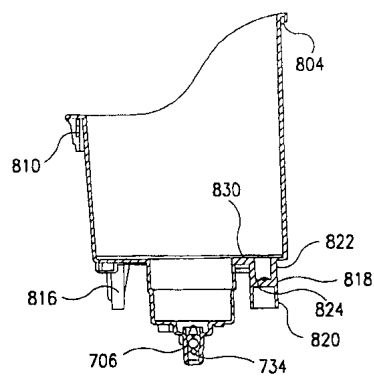

32a

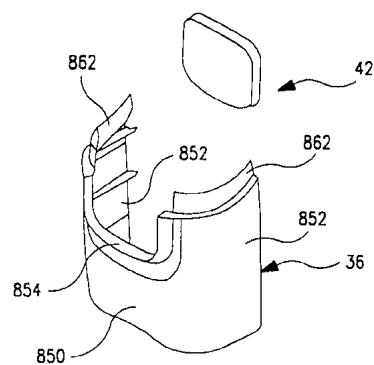

32b

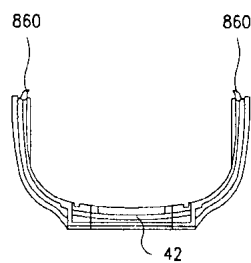

32c

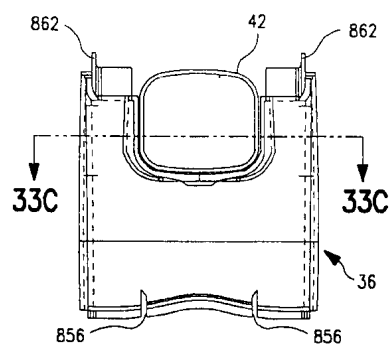

33a

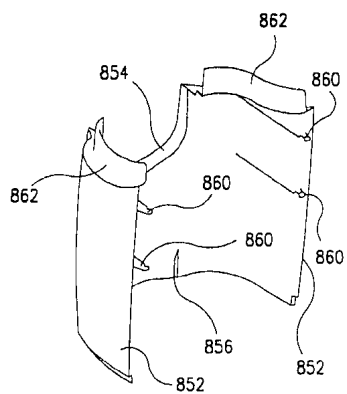

33b

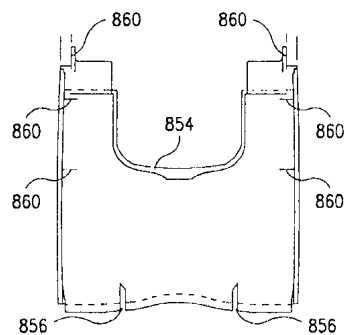

33c

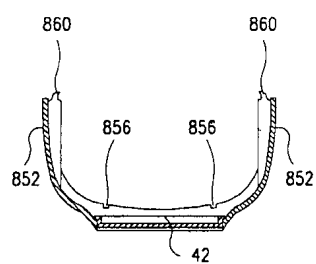

34a

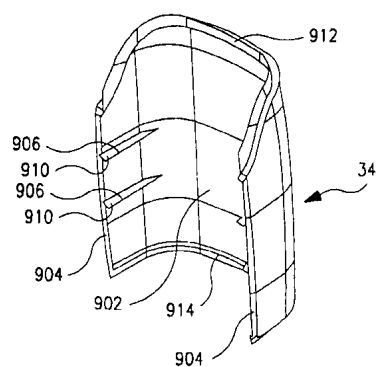

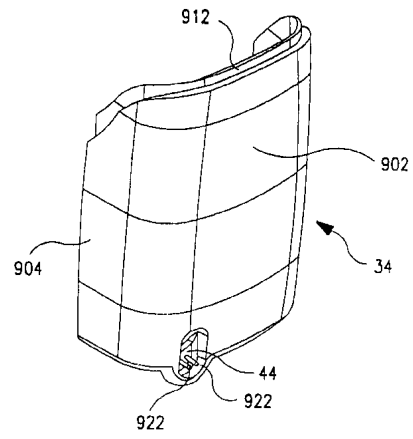
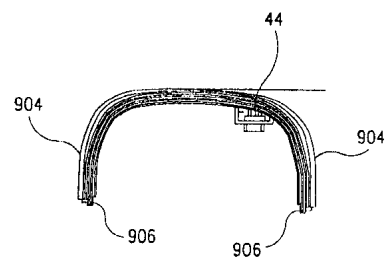
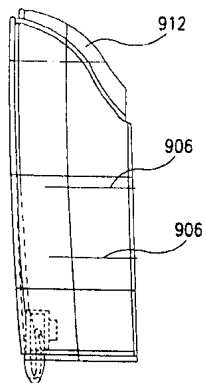
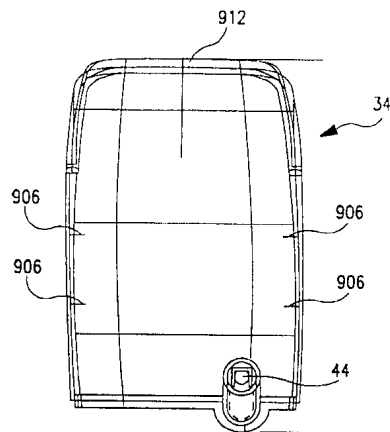
34b**34c****34d****34e**

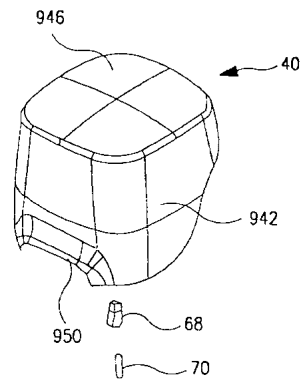
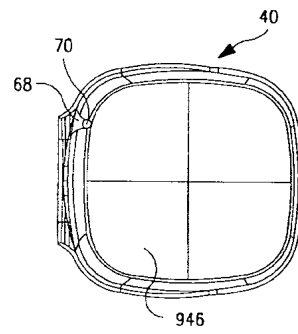
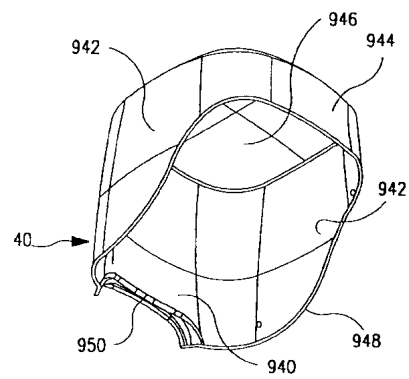
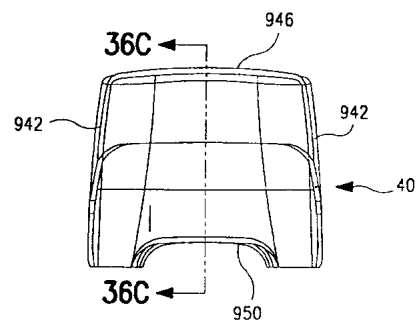
35a**35b****36a****36b**

36c

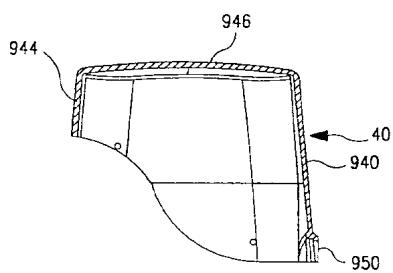

36d

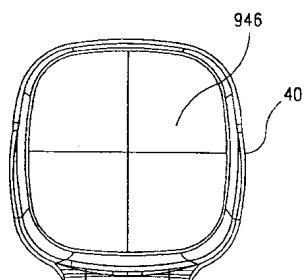

37

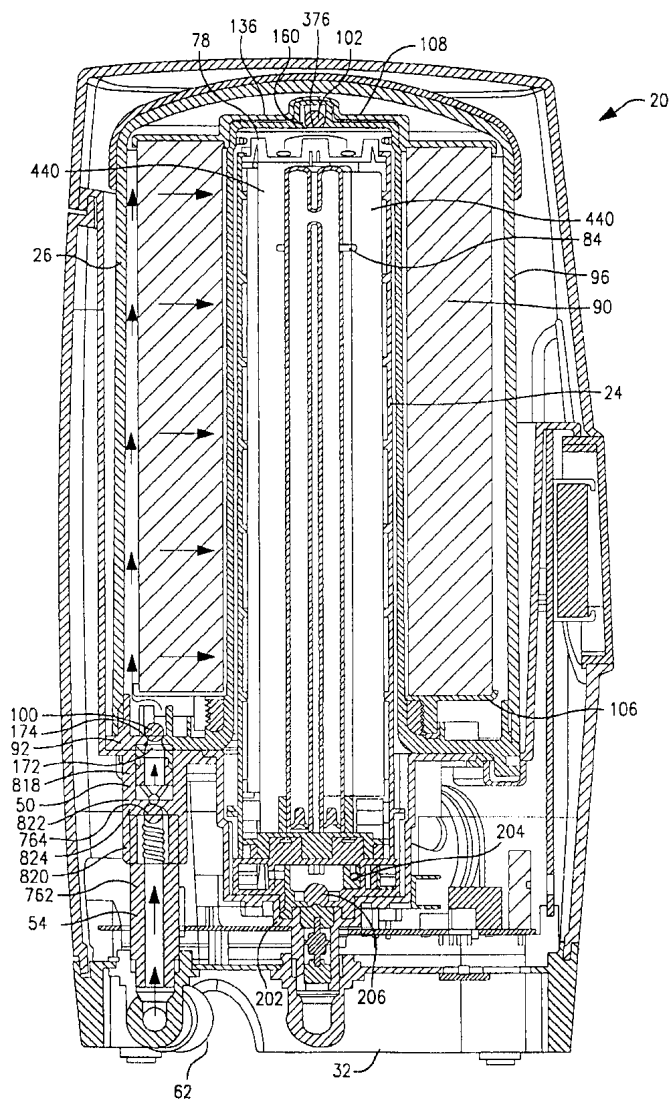

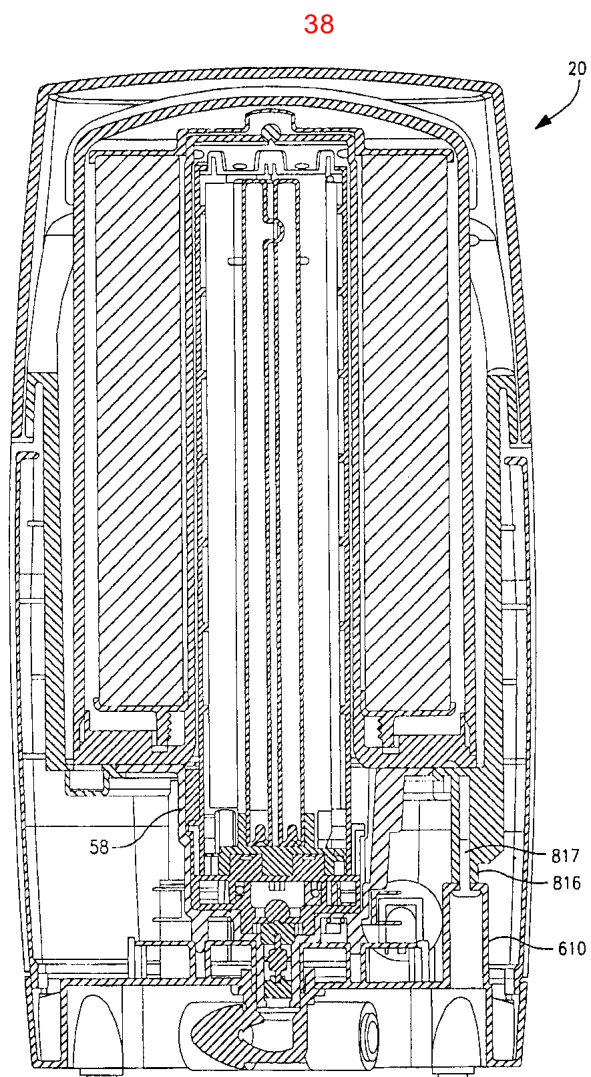

39

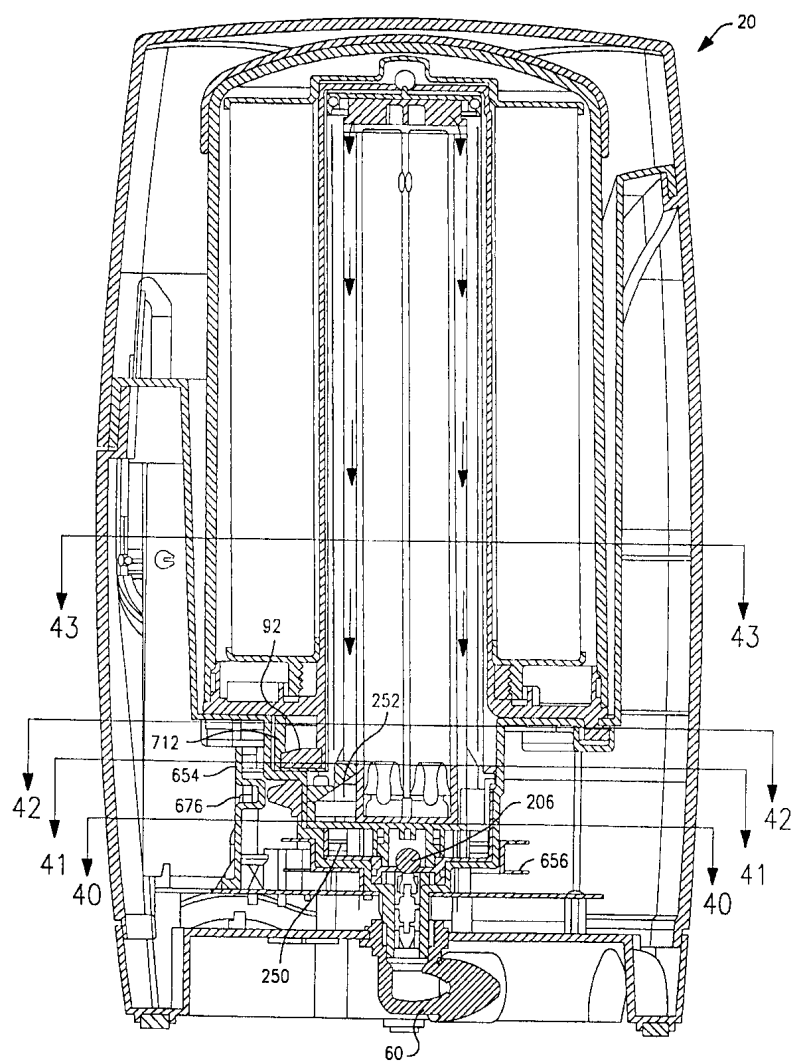

40

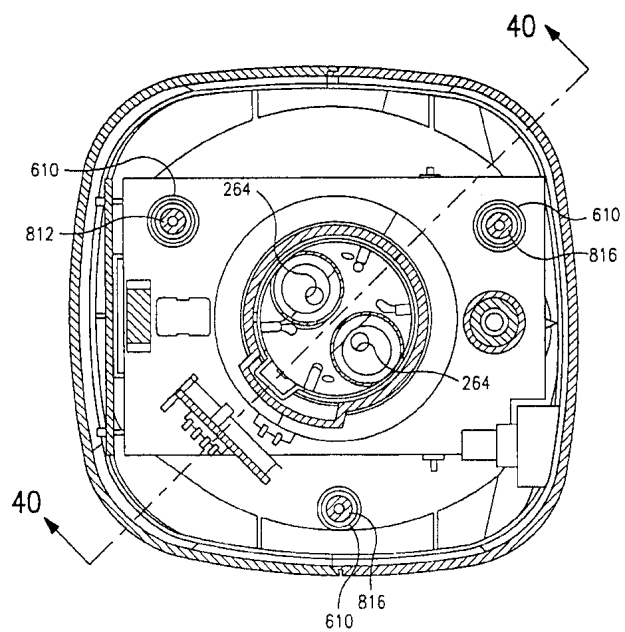

41

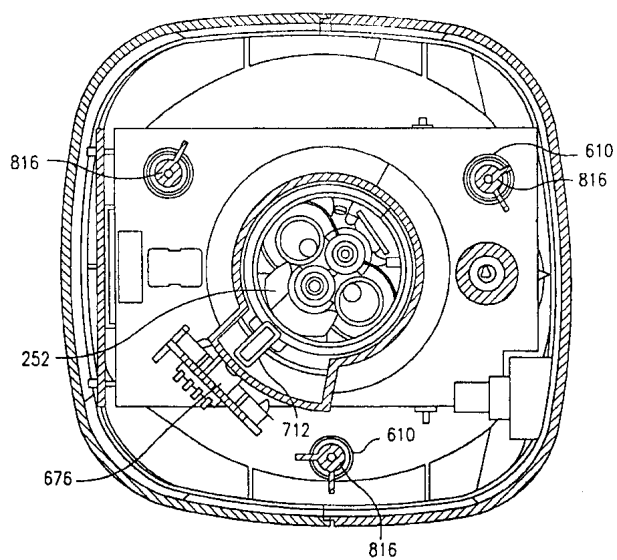

42

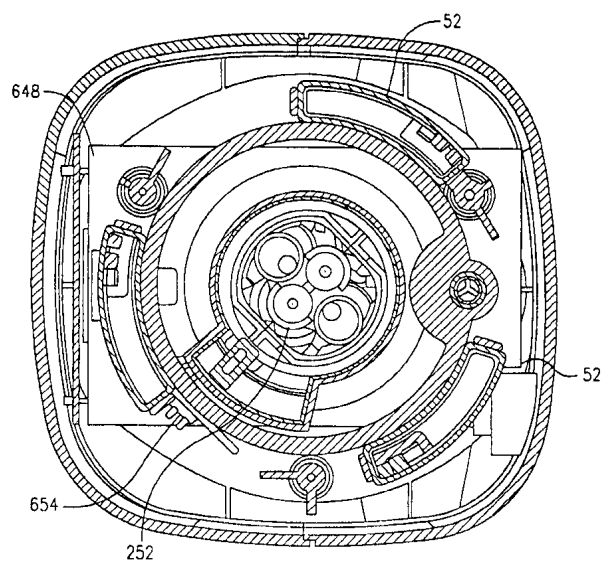

43

