

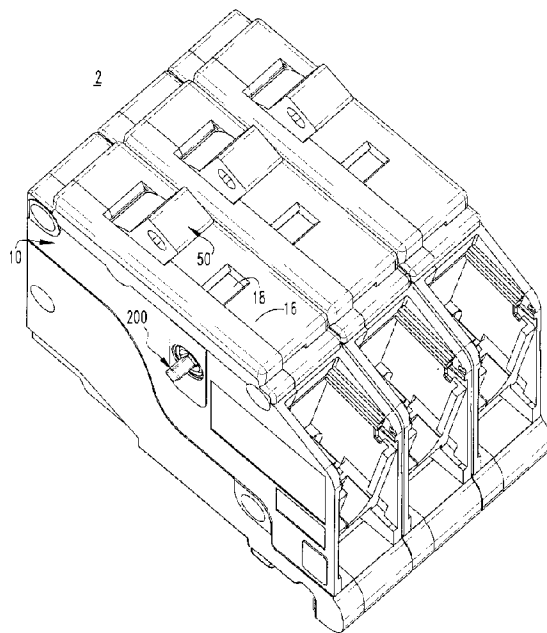

(22) Date de dépôt/Filing Date: 2015/11/04
 (41) Mise à la disp. pub./Open to Public Insp.: 2016/06/03
 (45) Date de délivrance/Issue Date: 2022/07/19
 (30) Priorité/Priority: 2014/12/03 (US14/558,928)

(51) Cl.Int./Int.Cl. *H01H 9/16* (2006.01),
H01H 71/04 (2006.01)
 (72) Inventeur/Inventor:
GIBSON, JEFFREY SCOTT, US
 (73) Propriétaire/Owner:
EATON INTELLIGENT POWER LIMITED, IE
 (74) Agent: BERESKIN & PARR LLP/S.E.N.C.R.L.,S.R.L.

(54) Titre : APPAREIL DE COMMUTATION ELECTRIQUE ET ENSEMBLE D'INDICATEUR ET CAME DE
DECLENCHEMENT ASSOCIEE
 (54) Title: ELECTRICAL SWITCHING APPARATUS, AND INDICATION ASSEMBLY AND TRIP CAM THEREFOR



(57) **Abrégé/Abstract:**

A trip cam is for an indication assembly of an electrical switching apparatus. The electrical switching apparatus includes a housing and a number of poles. Each of the number of poles includes a pair of separable contacts and an operating mechanism structured to open and close the separable contacts. The indication assembly includes a cradle member. The trip cam includes: a mounting portion; a transfer leg extending from the mounting portion, the transfer leg being structured to cooperate with each of the number of poles; a driving leg extending from the mounting portion in a first direction, the driving leg being structured to be driven by the cradle member; and a trip indicator leg including a base portion. The base portion extends from the mounting portion in a second direction generally opposite the first direction.

14-MCB-214

ABSTRACT OF THE DISCLOSURE

A trip cam is for an indication assembly of an electrical switching apparatus. The electrical switching apparatus includes a housing and a number of poles. Each of the number of poles includes a pair of separable contacts and an operating mechanism structured to open and close the separable contacts. The indication assembly includes a cradle member. The trip cam includes: a mounting portion; a transfer leg extending from the mounting portion, the transfer leg being structured to cooperate with each of the number of poles; a driving leg extending from the mounting portion in a first direction, the driving leg being structured to be driven by the cradle member; and a trip indicator leg including a base portion. The base portion extends from the mounting portion in a second direction generally opposite the first direction.

ELECTRICAL SWITCHING APPARATUS, AND INDICATION ASSEMBLY AND TRIP CAM THEREFOR

5

10

BACKGROUND**Field**

15

The disclosed concept pertains generally to electrical switching apparatus such as for example, circuit breakers. The disclosed concept also pertains to indication assemblies for electrical switching apparatus. The disclosed concept further relates to trip cams for indication assemblies.

Background Information

20

25

Electrical apparatus, such as electrical switching apparatus or electrical meters used in power distribution systems, are often mounted on or within an electrical enclosure (e.g., without limitation, a panelboard; a load center; a meter breaker panel) either individually or in combination with other electrical meters or switchgear (e.g., without limitation, circuit switching devices and circuit interrupters such as circuit breakers, contactors, motor starters, motor controllers and other load controllers). Such circuit breakers are used to protect electrical circuitry from damage due to a trip condition, such as, for example, an overcurrent condition, an overload condition, an undervoltage condition, a relatively high level short circuit or fault condition, a ground fault or arc fault condition.

Molded case circuit breakers, for example, include at least one pair of separable contacts which are operated either manually by way of a handle disposed on the outside of the case, or automatically by way of a trip unit in response to the trip condition. Generally, the trip unit includes a cradle assembly which is operable between a latched configuration during normal

14-MCB-214

-2-

circuit breaker operation, and an unlatched position in which the separable contacts are tripped open, in response to the trip condition.

Known circuit breakers include mechanisms that allow the tripping of one pole to cause other poles to trip, and further include mechanisms that provide a visual indication that the circuit breaker has tripped. Such mechanisms are complex and take up significant space within the circuit breaker.

There is thus room for improvement in electrical switching apparatus, and in indication assemblies and trip cams therefor.

10

SUMMARY

These needs and others are met by embodiments of the disclosed concept wherein a trip cam is provided which among other benefits, enables circuit status of an electrical switching apparatus to be determined.

In accordance with one aspect of the disclosed concept, a trip cam for an indication assembly of an electrical switching apparatus is provided. The electrical switching apparatus comprises a housing and a number of poles, each of the number of poles comprising a pair of separable contacts and an operating mechanism structured to open and close the separable contacts, the indication assembly comprising a cradle member, the trip cam comprising: a mounting portion; a transfer leg extending from the mounting portion, the transfer leg being structured to cooperate with each of the number of poles; a driving leg extending from the mounting portion in a first direction, the driving leg being structured to be driven by the cradle member; and a trip indicator leg comprising a base portion. The base portion extends from the mounting portion in a second direction generally opposite the first direction.

As another aspect of the disclosed concept, an indication assembly for an electrical switching apparatus is provided. The electrical switching apparatus comprises a housing and a number of poles, each of the number of poles comprising a pair of separable contacts and an operating mechanism structured to open and close the separable contacts, the indication assembly comprising: a cradle member structured to engage the housing; and a trip cam comprising: a mounting portion, a transfer leg extending from the mounting portion, the transfer leg being structured to be cooperate with each of the number of poles, a driving leg

14-MCB-214

-3-

extending from the mounting portion in a first direction, the driving leg being structured to be driven by the cradle member, and a trip indicator leg comprising a base portion. The base portion extends from the mounting portion in a second direction generally opposite the first direction.

5 As a further aspect of the disclosed concept, an electrical switching apparatus is provided. The electrical switching apparatus comprises: a housing; a number of poles, each of the number of poles comprising a pair of separable contacts and an operating mechanism structured to open and close the separable contacts; and at least one indication assembly comprising: a cradle member disposed in the housing, and a trip cam comprising: a mounting
10 portion, a transfer leg extending from the mounting portion, the transfer leg cooperating with each of the number of poles, a driving leg extending from the mounting portion in a first direction, the driving leg being structured to be driven by the cradle member, and a trip indicator leg comprising a base portion. The base portion extends from the mounting portion in a second direction generally opposite the first direction.

15

BRIEF DESCRIPTION OF THE DRAWINGS

A full understanding of the disclosed concept can be gained from the following description of the preferred embodiments when read in conjunction with the accompanying drawings in which:

20 Figure 1 is an isometric view of an electrical switching apparatus, in accordance with an embodiment of the disclosed concept;

 Figure 2 is an elevation view of the electrical switching apparatus of Figure 1, shown with the movable arm in the CLOSED position and with portions of the electrical switching apparatus removed to show hidden structures;

25 Figure 3 is an elevation view of the electrical switching apparatus of Figure 2, showing the movable arm in an open position;

 Figure 4 is an elevation view of the electrical switching apparatus of Figure 2, showing the movable arm in an EXTENDED OPEN position;

30 Figure 5 is an isometric view of a portion of the contact assembly for the electrical switching apparatus of Figure 4;

14-MCB-214

-4-

Figure 6 is an isometric view of a portion of the housing for the electrical switching apparatus of Figure 4;

Figures 7A-7F are different views of a trip cam for the electrical switching apparatus of Figure 1;

5 Figure 8 is an elevation view of an indication assembly for the electrical switching apparatus of Figure 1, shown in the loaded position;

Figure 9 is an elevation view of the indication assembly of Figure 8, shown in the unloaded position;

10 Figure 10 is an isometric view of an operating handle assembly for the electrical switching apparatus of Figure 1, showing the cradle member in the TRIPPED position;

Figure 11 is an elevation view of the operating handle assembly of Figure 10 as employed in a portion of the electrical switching apparatus, showing the cradle member in the CLOSED position; and

15 Figure 12 is an elevation view of the operating handle assembly of Figure 11, showing the cradle member in the TRIPPED position.

DESCRIPTION OF THE PREFERRED EMBODIMENTS

As employed herein, the term “number” shall mean one or an integer greater than one (*i.e.*, a plurality).

20 As employed herein, the statement that two or more parts are “connected” or “coupled” together shall mean that the parts are joined together either directly or joined through one or more intermediate parts.

As employed herein, the statement that two or more parts or components “engage” one another shall mean that the parts touch and/or exert a force against one another
25 either directly or through one or more intermediate parts or components.

Figure 1 shows an electrical switching apparatus (e.g., without limitation, circuit breaker 2) in accordance with the disclosed concept. The example circuit breaker 2 includes a housing 10, a number of operating handles (one operating handle 50 is indicated) extending into the housing 10, and a number of trip cams (only one trip cam 200 is partially visible in Figure 1)
30 located within the housing 10.

14-MCB-214

-5-

Figures 2 through 4 show different views of the circuit breaker 2 with portions removed in order to see internal components. As seen, the circuit breaker 2 further includes a cradle member 40 located in and engaging the housing 10, an operating mechanism (e.g., without limitation, spring 60) coupled to the cradle member 40, and a contact assembly 100. The circuit breaker 2 has a number of poles and a corresponding contact assembly (e.g., without limitation, substantially similar to or the same as the contact assembly 100) for each of the poles of the circuit breaker 2.

Continuing to refer to Figures 2 through 4, the contact assembly 100 includes a stationary contact 102 located in the housing 10, and a movable arm 110. The movable arm 110 has a movable contact 112 structured to engage the stationary contact 102. As will be discussed in greater detail hereinbelow, the movable arm 110 is structured to move between a CLOSED position (Figure 2) and an EXTENDED OPEN position (Figure 4). In order to maintain the movable arm 110 in the EXTENDED OPEN position (Figure 4), the contact assembly 100 advantageously further includes an extension apparatus 150 located on the housing 10.

As seen in Figure 5, the extension apparatus 150 includes a generally U-shaped link member 170 and an elongated extension 160 located on the movable arm 110. The link member 170 is coupled to the elongated extension 160 and further structured to be located on and engage the housing 10, as will be discussed below. The movable arm 110 includes a distal portion 120 located proximate the movable contact 112 and opposite the elongated extension 160. Furthermore, the movable arm 110 has a cutout 122 located between the elongated extension 160 and the distal portion 120. In operation, the operating handle 50 is structured to be located in the cutout 122, as shown in Figure 4. Additionally, the elongated extension 160 extends from the movable arm 110 proximate the cutout 122. In the example non-limiting embodiment, the elongated extension 160 is integral with the movable arm 110. Stated differently, the movable arm 110, and thus the elongated extension 160, preferably form a single unitary component composed of the same single piece of material (as opposed to a plurality of separate components being joined together). However, it will be appreciated that an elongated extension (not shown) may be an individual component separately coupled to a movable arm (not shown), without departing from the scope of the disclosed concept.

14-MCB-214

-6-

Continuing to refer to Figure 5, the link member 170 includes a pair of opposing legs 172 (partially shown in hidden line drawing), 174 and a middle portion 176 generally normal to the legs 172, 174 and connecting the leg 172 to the leg 174. As seen, the elongated extension 160 includes a pair of spaced apart and opposing end portions 161, 163. Furthermore, the elongated extension 160 has an aperture 162 located proximate the end portion 161. The leg 172 of the link member 170 at least partially extends into the aperture 162 of the elongated extension 160 in order to couple the link member 170 to the elongated extension 160, and thus the movable arm 110. Moreover, the movable contact 112 includes a contact surface 118 located in a plane (indicated generally as 118-1), and the elongated extension 160 has a longitudinal axis 160-1 at an angle 130 with the plane 118-1. As seen, the angle 130 is preferably greater than 90 degrees. It will be appreciated that when the movable arm 110 is in the EXTENDED OPEN position, the extension apparatus 150, and particularly the configuration of the elongated extension 160 and its relation with the link member 170, and internal portion 14 of housing 10, advantageously enables the movable arm 110 to be maintained in the EXTENDED OPEN position (Figure 4), as will be discussed in greater detail hereinbelow. It will also be appreciated that an extension apparatus (not shown) may have any known or suitable alternative shape and/or configuration to perform the desired function of maintaining the movable arm 110 in an EXTENDED OPEN position.

Figure 6 shows a portion of the example housing 10. As seen, the housing 10 includes a wall portion 12 and an internal portion 14 adjacent the wall portion 12. The internal portion 14 has a slot 20 that has a pair of opposing and spaced apart end portions 22, 24 and a center portion 26 located generally midway between the end portions 22, 24. The end portion 22 is adjacent the wall portion 12 and the end portion 24 is internal with respect to the wall portion 12.

Referring again to Figure 2, in which the movable arm 110 is in the CLOSED position, the leg 174 of the link member 170 is located on the housing 10 proximate the center portion 26 of the slot 20 (i.e., spaced from the end portion 22). Although the leg 174 partially extends into the slot 20, it is within the scope of the disclosed concept for an internal portion (not shown) to alternatively include a slot for a leg (not shown) to extend entirely therethrough. Additionally, the middle portion 176 of the link member 170 has a longitudinal axis 176-1 that is generally normal to the plane 118-1 of the contact surface 118, as shown.

14-MCB-214

-7-

Furthermore, Figure 2 shows the operating handle 50 is in an ON position. Responsive to the operating handle 50 moving from the ON position toward an OFF position (Figures 3 and 4), the movable arm 110 moves from the CLOSED position (Figure 2) toward the EXTENDED OPEN position (Figure 4). It will further be appreciated that responsive to the

5 movable arm 110 moving from the CLOSED position (Figure 2) toward the EXTENDED OPEN position (Figure 4), the cradle member 40 remains substantially stationary. In other words, the example extension apparatus 150 is significantly advantageous when the operating handle 50 is manually moved between ON and OFF positions.

Figure 3 shows the movable arm 110 in an open position. For ease of illustration and purposes of discussion, the contact assembly 100 is illustrated in Figure 3 without the link

10 member 170 (Figures 2, 4 and 5). As will be discussed below, by incorporating the link member 170 with the elongated extension 160, the movable arm 110 is advantageously able to be maintained in the EXTENDED OPEN position (Figure 4). Additionally, in the open position of Figure 3, the spring 60 is in a static position in which it does not tend to cause the movable arm

15 110 to rotate one direction or the other. Furthermore, as seen, the movable contact 112 is spaced a distance 114 from the stationary contact 102.

Figure 4 shows the movable arm 110 in the EXTENDED OPEN position. In this position, the movable contact 112 is spaced a distance 116 from the stationary contact 102. The distance 116 (Figure 4) is greater than the distance 114 (Figure 3). In other words, the movable

20 contact 112 is spaced a farther distance from the stationary contact 102 in the EXTENDED OPEN position than in the open position of Figure 3. Additionally, in the EXTENDED OPEN position (Figure 4), the elongated extension 160 extends from proximate the cutout 122 toward the stationary contact 102, and the middle portion 176 generally overlies and is parallel to the slot 20.

Furthermore, responsive to the operating handle 50 moving from the ON position (Figure 2) to the OFF position (Figure 4), the leg 174 of the link member 170 slides in the slot 20

25 from proximate the center portion 26 to the end portion 22 and exerts a force on the wall portion 12 of the housing 10. In this manner, the movable arm 110 to be maintained in the EXTENDED OPEN position (Figure 4). Thus, responsive to the movable arm 110 moving from the CLOSED

30 position (Figure 2) toward the EXTENDED OPEN position (Figure 4), the end portion 163 of

14-MCB-214

-8-

the elongated extension 160 moves toward the leg 174 of the link member 170, and the leg 174 of the link member 170 moves away from the distal portion 120 of the movable arm 110.

Moreover, as the operating handle 50 is rotated toward the OFF position (Figures 3 and 4), the stored energy of the spring 60 initially forces the movable arm 110 to move from the CLOSED position (Figure 2) toward the EXTENDED OPEN position (Figure 4). After the spring 60 passes its static position (also the OFF position)(Figure 3), inertia allows the movable arm 110 to continue rotating to the EXTENDED OPEN position (Figure 4). Typically, the movable arm 110 would rotate from the EXTENDED OPEN position (Figure 4) back toward the CLOSED position (Figure 2), and continue to oscillate until it became steady in the open position shown in Figure 3. However, when the movable arm 110 initially reaches the EXTENDED OPEN position (Figure 4), the leg 174 of the link member 170 engages and substantially presses against the wall portion 12 of the housing 10 in order to maintain the movable arm 110 in the EXTENDED OPEN position (Figure 4). The wall portion 12 exerts an opposing force on the link member 170, which in turn exerts a moment on the movable arm 110 to advantageously maintain the movable arm 110 in the EXTENDED OPEN position (Figure 4). Thus, the stored energy of the spring 60 forces the movable arm 110 to the EXTENDED OPEN position (Figure 4) and the extension apparatus 150 in turn advantageously maintains the movable arm 110 in the EXTENDED OPEN position (Figure 4). Stated differently, when the movable arm 110 is in the EXTENDED OPEN position, the extension apparatus 150 retains the movable arm 110 in the EXTENDED OPEN position until an operator moves the operating handle 50 from the OFF position toward the ON position, which causes the movable arm 110 to be released from the EXTENDED OPEN position and move toward the CLOSED position.

It is well known that a circuit breaker having minimal contact separation while moving from ON to OFF positions will have extended arcing times. This in turn results in excessive damage to the electrical contacts, which corresponds to elevated resistance and subsequent failure due to exceeding temperature rises when conducting current. Thus, it will be appreciated that the stationary contact 102 and the movable contact 112 are significantly well protected. Specifically, responsive to the operating handle 50 moving from the ON position (Figure 2) to the OFF position (Figure 4), the movable contact 112 moves past the open position shown in Figure 3 to the EXTENDED OPEN position (Figure 4), and is maintained at a farther

14-MCB-214

-9-

distance from the stationary contact 102 (i.e., the distance 116 is greater than the distance 114). Thus, arcing times, device resistance, and temperature rises are all decreased by employing the extension apparatus 150. Additionally, problematic oscillations associated with prior art equilibrium open positions, which result in momentary reduced contact gaps, are eliminated. In this manner, the circuit breaker 2, particularly the stationary contact 102 and the movable contact 112, are advantageously well protected.

Accordingly, it will be appreciated that the disclosed concept provides for an improved (e.g., without limitation, reduced electrical resistance and increased protection from damage due to temperature rises) electrical switching apparatus (e.g., without limitation, circuit breaker 2), and contact assembly therefor, which among other benefits, provides additional separation for electrical contacts (e.g., without limitation, stationary contact 102 and movable contact 112).

Figures 7A-7F show different views of the trip cam 200 for the circuit breaker 2 (Figures 1-4). In the illustrated embodiment, the trip cam 200 includes a generally cylindrical-shaped mounting portion 210, a transfer leg 212, a driving leg 214, and a trip indicator leg 220. Although the circuit breaker 2 (Figures 1-4) has been described hereinabove in association with the operating handle 50 being manually moved from ON to OFF positions, when the circuit breaker 2 (Figures 1-4) does undergo a tripping event (e.g., without limitation, an overcurrent condition), the transfer leg 212 cooperates with each of the poles of the circuit breaker 2 (Figures 1-4) in a manner generally well known in the art. Additionally, during the tripping operation, the cradle member 40 (Figures 2-4) drives the driving leg 214, as will be discussed in greater detail hereinbelow.

Referring to Figure 7B, the transfer leg 212 extends from the mounting portion 210 in a direction 213 and the driving leg 214 extends from the mounting portion 210 in a direction 215. Furthermore, the trip indicator leg 220 includes a base portion 222 that extends from the mounting portion 210 in a direction 223 generally opposite the direction 215. This position of the trip indicator leg 220 advantageously enables the trip cam 200 to provide a visual indication of circuit status within the circuit breaker 2 (Figures 1-4, 11 and 12), as will be discussed in greater detail hereinbelow.

14-MCB-214

-10-

Continuing to refer to Figures 7A and 7B, the base portion 222 includes a pair of opposing and spaced apart end portions 224,226. The end portion 224 extends from the mounting portion 210 and the trip indicator leg 220 further has a trip flag 228 that extends from the end portion 226 at an angle 229. As seen, the angle 229 is preferably less than 100 degrees.

5 The trip flag 228 has a generally rectangular-shaped trip indicating surface 230 (Figure 7A), the function of which will be described below. The trip indicator leg 220 further includes a support portion 232 that extends from the base portion 222 and further extends from the mounting portion 210 in a direction 233 (Figure 7C) generally opposite the direction 213. During the tripping operation, responsive to the cradle member 40 driving the driving leg 214, the trip cam

10 200 rotates about the mounting portion 210. Because of the relatively high rotational velocity of the trip cam 200, the support portion 232 advantageously provides support for the trip indicator leg 220.

The support portion 232 includes a pair of generally triangular-shaped parallel surfaces 234,236. The triangular-shaped surfaces 234,236 substantially extend along the base

15 portion 222 as well as the mounting portion 210 (see Figures 7A-7C). Thus, support for the trip indicator leg 220 is advantageously further increased. The triangular-shaped surface 234 is opposite and spaced apart from the triangular-shaped surface 236. Of course, it will be appreciated that a support portion (not shown) may have any known or suitable alternative shape and/or configuration and/or interaction with the base portion 222 and the mounting portion 210

20 in order to perform the desired function of supporting the trip indicator leg 220 during the tripping operation. Additionally, the mounting portion 210 includes a pair of generally parallel end surfaces 240,242 and the base portion 222 extends from proximate the end surface 240 to proximate the end surface 242. Thus, there is a relatively strong connection between the base portion 222 and the mounting portion 210.

25 Furthermore, the base portion 222 includes a pair of generally rectangular-shaped parallel side surfaces 244,246. The side surface 244 extends from proximate the end surface 242 of the mounting portion 210. The side surface 246 extends from proximate the end surface 240 of the mounting portion 210 and is opposite and spaced apart from the side surface 244. As seen in Figure 7D, the surfaces 234,236,240,242,244,246 are generally parallel to each other.

30 Additionally, the support portion 232 is located generally midway between the end surfaces

14-MCB-214

-11-

240,242. In this manner, as the trip cam 200 rotates during the tripping operation, the structure of the trip indicator leg 220 significantly enables the trip indicator leg 220 to remain relatively stable.

5 Figures 8 and 9 show an indication assembly 300 for the circuit breaker 2 (Figures 1-4). The indication assembly 300 includes the cradle member 40 and the trip cam 200. More specifically, the indication assembly 300 is structured to move between a loaded position (Figure 8) corresponding to the contacts 102,112 (Figures 2-4) being CLOSED and an unloaded position (Figure 9) corresponding to the contacts 102,112 (Figures 2-4) in the different position shown, after having TRIPPED OPEN.

10 Furthermore, the cradle member 40 includes a hook portion 42, a protrusion 44 and an extension arm 46. The protrusion 44 is located between the hook portion 42 and the extension arm 46. The hook portion 42 is opposite the extension arm 46 and engages the housing 10. As seen, responsive to the indication assembly 300 moving from the loaded position (Figure 8) toward the unloaded position (Figure 9), the protrusion 44 drives the driving leg 214
15 of the trip cam 200. As will be discussed below in connection with Figures 11 and 12, it follows that responsive to the driving leg 214 being driven by the cradle member 40, the trip indicator leg 220 rotates about the mounting portion 210.

20 Figures 11 and 12 show different views of the indication assembly 300 employed in a portion of the circuit breaker 2. Specifically, Figure 11 shows the circuit breaker 2 with the indication assembly 300 in the loaded position and Figure 12 shows the circuit breaker 2 with the indication assembly 300 in the unloaded position. The housing 10 includes a generally planar external surface 16 (see also, for example, Figures 1 and 6) that has a window 18. Although only the window 18 and the indication assembly 300 are described herein, it will be appreciated that the circuit breaker 2 includes a plurality of windows and a plurality of indication assemblies for
25 each of the poles. It will further be appreciated that responsive to any one of the indication assemblies (only one indication assembly 300 is shown) moving from the loaded position to the unloaded position, each of the other indication assemblies also moves from a corresponding loaded position to a corresponding unloaded position.

30 The side surfaces 244 (see Figures 7A and 7D for side surface 246) and the triangular-shaped surfaces 234 (see Figures 7A and 7D for triangular-shaped surface 236) of the

14-MCB-214

-12-

trip cam 200 are generally normal to the external surface 16. As seen, when the indication assembly 300 is in the unloaded position (Figure 12), the direction 233 is generally parallel to the extension arm 46 and is substantially normal to the external surface 16.

Continuing to refer to Figure 11, when looking through the window 18 at an
5 observation point 19 (i.e., an observation point directly above and looking into the window 18), the trip indicating surface 230 is not visible. Responsive to the indication assembly 300 moving from the loaded position (Figures 8 and 11) toward the unloaded position (Figures 9 and 12), the trip indicating surface 230 moves from a position where it is not visible through the window 18 from the observation point 19, toward a position where it is substantially located in the window
10 18. In this position (i.e., the unloaded position), the trip indicating surface 230 is visible through the window 18 from the observation point 19.

Stated differently, when the indication assembly 300 is in the unloaded position, an operator looking through the window 18 would observe the trip indicating surface 230. Thus, in the unloaded position the trip indicating surface 230 substantially faces the observation point
15 19 and there is nothing (e.g., housing 10) between the trip indicating surface 230 and the observation point 19. Stated differently, in the unloaded position light is able to pass directly from the observation point 19 to the trip indicating surface 230. By contrast, when the indication assembly 300 is in the loaded position, the operator looking through the window 18 from the observation point 19 would not be able to see the trip indicating surface 230. Specifically, in the
20 loaded position the trip indicating surface 230 substantially faces the housing 10, which is located between the observation point 19 and the trip indicating surface 230. Thus, in the loaded position light is not able to pass directly from the observation point 19 to the trip indicating surface 230.

Because the loaded position corresponds to the contacts 102,112 (Figures 2-4)
25 being CLOSED and the unloaded position corresponds to the contacts 102,112 (Figures 2-4) having TRIPPED OPEN, circuit status within the circuit breaker 2 is advantageously able to be determined by employing the trip indicator leg 220. Specifically, a visible trip indicating surface 230 from the observation point 19 signals that the contacts 102,112 (Figures 2-4) have TRIPPED OPEN. The absence of the trip indicating surface 230 from the observation point 19 signals that
30 the contacts 102,112 (Figures 2-4) are CLOSED, or that the circuit breaker 2 has been manually

14-MCB-214

-13-

opened. While the disclosed concept has been described in association with the base portion 222 extending in the direction 223 in order to have a visible trip indicating surface 230 when the contacts 102,112 (Figures 2-4) have TRIPPED OPEN, it will be appreciated that a base portion (not shown) may extend in a suitable alternative direction without departing from the scope of the disclosed concept, so long as different indications correspond to different positions (i.e., 5 CLOSED or manually being opened versus TRIPPED OPEN) of the contacts 102,112 (Figures 2-4). Additionally, the disclosed concept has been described in association with the generally rectangular-shaped trip indicating surface 230 and corresponding window 18. However, it will be appreciated that a trip indicating surface (not shown) and corresponding window (not shown) 10 may have any known or suitable alternative shape and/or configuration in order to perform the desired function of enabling circuit status to be visually determined.

As an additional benefit, by employing the trip indicator leg 220 in conjunction with the trip cam 200, manufacturing is able to be simplified. More specifically, separate assemblies and/or mechanisms which provide visual indication of circuit status (not shown) no 15 longer need to be employed because the separate function of indication of circuit status has been combined with the component (e.g., trip cam) whose primary function is to trip all poles of an electrical switching apparatus. This advantageously corresponds to a reduction in device cost and assembly time, as well as a more efficient use of available space. Additionally, the trip cam 200 is preferably a single piece of material (e.g., without limitation, an injection molded piece), 20 thus further simplifying manufacturing and reducing cost.

Accordingly, it will be appreciated that the disclosed concept provides for an improved (e.g., without limitation, less expensive, easier to assemble, more compact) electrical switching apparatus (e.g., without limitation, circuit breaker 2), and indication assembly 300 and trip cam 200 therefor, which among other benefits, combines the functions of providing visual 25 indication of circuit status with a means for tripping all poles of the circuit breaker 2.

Referring again to Figures 7A and 7B, the mounting portion 210 includes a first region 212-1, a second region 260-1 located generally opposite the first region 212-1, and a third region 214-1 located generally between the first region 212-1 and the second region 260-1. Each of the regions 212-1,214-1,260-1 generally extends from the end surface 240 of the mounting 30 portion 210 to the end surface 242 of the mounting portion 210. The transfer leg 212 extends

14-MCB-214

-14-

from the first region 212-1 and the driving leg 214 extends from the third region 214-1. Additionally, the trip cam 200 further includes a partially cylindrical-shaped operating handle protrusion 260 that extends from the second region 260-1 and is structured to engage the operating handle 50 (Figures 1-4 and 10-12). It will be appreciated that a trip cam may include
5 either one of, or both of the trip indicator leg 220 and the operating handle protrusion 260, without departing from the scope of the disclosed concept. As will be discussed below, the operating handle protrusion 260 advantageously enables the cradle member 40 to cooperate with the operating handle 50.

The operating handle protrusion 260 includes a pair of spaced apart generally
10 planar side surfaces 262,264 and a curved surface 266 connecting the first side surface 262 to the second side surface 264. The side surfaces 262,264 are located between and are preferably parallel to each of the end surfaces 240,242 of the mounting portion 210. As seen in Figure 7B, the operating handle protrusion 260 substantially extends from the second region 260-1 in a
15 direction 261 generally normal to the direction 215. Additionally, referring to Figures 7E and 7F, the operating handle protrusion 260 extends from proximate the end surface 240 to generally midway between the end surfaces 240,242. In this position, the operating handle protrusion 260 is advantageously able to substantially align with and engage a portion of the operating handle 50, as will be discussed in greater detail hereinbelow.

Figure 10 shows an isometric view of an example operating handle assembly 400
20 for the circuit breaker 2 (Figures 1-4), in accordance with the disclosed concept. It will be appreciated that the circuit breaker 2 may include a plurality of operating handle assemblies (i.e., substantially similar to or the same as the operating handle assembly 400) for each of the poles of the circuit breaker 2. As seen, the example operating handle assembly 400 includes the cradle member 40, the trip cam 200, and the operating handle 50.

25 Figures 11 and 12 show different views of the operating handle assembly 400 installed in a portion of the circuit breaker 2. More specifically, the cradle member 40 is structured to move from a CLOSED position (Figure 11) corresponding to the contacts 102,112 (Figures 2-4) being CLOSED to a TRIPPED position (Figure 12) corresponding to the contacts 102,112 (Figures 2-4) having TRIPPED OPEN. As will be discussed below, by employing the
30 operating handle protrusion 260, the operating handle 50 always moves from an ON position to a

14-MCB-214

-15-

TRIPPED position after the circuit breaker 2 (Figures 2-4, 11 and 12) experiences a tripping event.

As seen in Figure 10, the operating handle 50 includes an engaging surface 52 structured to engage the curved surface 266 of the operating handle protrusion 260. Because the operating handle protrusion 260 extends from proximate the end surface 240 to generally
5 midway between the end surfaces 240,242 (see for example Figures 7E and 7F), it will be appreciated that in operation, the engaging surface 52 is located between the end surface 240 and midway between the end surfaces 240,242. Furthermore, the engaging surface 52 is substantially normal to each of the first side surface 262 and the second side surface 264.

10 Referring to Figure 11, in which the cradle member 40 is in the CLOSED position, the operating handle protrusion 260 is spaced from the engaging surface 52. In this position, the operating handle 50 is at an angle 50-1 with the external surface 16 of the housing 10, as shown. Responsive to the cradle member 40 moving from the CLOSED position (Figure 11) toward the TRIPPED position (Figure 12), the operating handle protrusion 260 rotates about
15 the mounting portion 210. In this manner, the space between the operating handle protrusion 260 and the engaging surface 52 decreases until the operating handle protrusion 260 engages the engaging surface 52 of the operating handle 50. At this point, because the trip cam 200 is rotating relatively quick, and because of the relative position of the operating handle protrusion 260 (i.e., extending in the direction 261), the operating handle protrusion 260 gives the operating
20 handle 50 a “kick” and drives the operating handle 50 from the ON position to the TRIPPED position. It will however be appreciated that an operating handle protrusion (not shown) in accordance with an alternative embodiment of the disclosed concept may extend in any suitable alternative direction, and/or engage any suitable alternative surface (not indicated) other than the engaging surface 52, and/or be located in any suitable alternative position relative to the
25 mounting portion 210, in order to perform the desired function of driving the operating handle 50 from the ON position to the TRIPPED position.

Figure 12 shows the operating handle assembly 400 in a position in which the operating handle protrusion 260 is engaging the engaging surface 52 of the operating handle 50 and has caused the operating handle 50 to rotate to the TRIPPED position. Specifically, the

14-MCB-214

-16-

operating handle 50 is at an angle 50-2 with the external surface 16 of the housing 10, as shown. The angle 50-2 is greater than the angle 50-1 (Figure 11).

The operating handle protrusion 260 advantageously imparts an additional force to the operating handle 50 during the tripping operation that is significant enough to always
5 cause the operating handle 50 to rotate to the TRIPPED position. In this manner, frictional forces within the circuit breaker 2 are no longer able to cause the operating handle 50 to get stuck during a tripping operation. Thus, when the circuit breaker 2 undergoes a tripping event (e.g., without limitation, an overcurrent condition), the operating handle 50 always moves from the
10 ON position to the TRIPPED position, advantageously providing a more reliable means for an operator to know whether a circuit breaker has tripped or not, overcoming the disadvantages of known circuit breakers (not shown) which have operating handles (not shown) that often get stuck during a tripping operation due to frictional forces.

Additionally, while the disclosed concept has been described in association with the partially cylindrical-shaped operating handle protrusion 260, it will be appreciated that an
15 operating handle protrusion (not shown) may have any known or suitable alternative shape, and/or configuration with respect to a mounting portion (not shown), in order to perform the desired function of driving the operating handle 50 from the ON position to the TRIPPED position in response to a tripping event. Furthermore, while the trip cam 200 is preferably made of a single piece of material (e.g., without limitation, an injection molded piece), it will be
20 appreciated that an operating handle protrusion (not shown) may be a separate component coupled to a trip cam (not shown), without departing from the scope of the disclosed concept.

Accordingly, it will be appreciated that the disclosed concept provides for an improved (e.g., without limitation, more reliable in terms of correlation between operating handle position and electrical contact position) electrical switching apparatus (e.g., without
25 limitation, circuit breaker 2), and operating handle assembly 400 and trip cam 200 therefor, which among other benefits, provides a mechanism to ensure that the operating handle 50 always rotates to the TRIPPED position during after experiencing a tripping event.

While specific embodiments of the disclosed concept have been described in detail, it will be appreciated by those skilled in the art that various modifications and alternatives
30 to those details could be developed in light of the overall teachings of the disclosure.

14-MCB-214

-17-

Accordingly, the particular arrangements disclosed are meant to be illustrative only and not limiting as to the scope of the disclosed concept which is to be given the full breadth of the claims appended and any and all equivalents thereof.

What is claimed is:

1. A trip cam for an indication assembly of an electrical switching apparatus, said electrical switching apparatus comprising a housing and a number of poles, each of said number of poles comprising a pair of separable contacts and an operating mechanism structured to open and close said separable contacts, said indication assembly comprising a cradle member, said trip cam comprising:

a mounting portion;

a transfer leg extending from said mounting portion, said transfer leg being structured to cooperate with each of said number of poles;

a driving leg extending from said mounting portion in a first direction, said driving leg being structured to be driven by said cradle member; and

a trip indicator leg comprising a base portion,

wherein said base portion extends from said mounting portion in a second direction generally opposite the first direction.

2. The trip cam of claim 1 wherein said base portion comprises a first end portion and a second end portion opposite the first end portion; wherein the first end portion extends from said mounting portion; and wherein said trip indicator leg further comprises a trip flag extending from the second end portion.

3. The trip cam of claim 2 wherein said trip flag extends from the second end portion at an angle; and wherein the angle is less than 100 degrees.

4. The trip cam of claim 1 wherein said trip indicator leg further comprises a support portion extending from each of said mounting portion and said base portion.

5. The trip cam of claim 4 wherein said transfer leg extends from said mounting portion in a third direction; and wherein said support portion extends from said mounting portion in a fourth direction generally opposite the third direction.

6. The trip cam of claim 1 wherein said mounting portion is generally cylindrical-shaped and comprises a first end surface and a second end surface generally parallel to the first end surface; wherein said base portion extends from proximate the first end surface to proximate the second end surface; wherein said trip indicator leg further comprises a support portion; and wherein said support portion is disposed generally midway between the first end surface and the second end surface.

7. The trip cam of claim 6 wherein said support portion comprises a first generally triangular-shaped surface and a second generally triangular-shaped surface opposite and spaced apart from the first triangular-shaped surface; wherein the first triangular-shaped surface is parallel to each of the first end surface of said mounting portion and the second end surface of said mounting portion; and wherein the second triangular-shaped surface is parallel to each of the first end surface of said mounting portion and the second end surface of said mounting portion.

8. The trip cam of claim 7 wherein said base portion comprises a first generally rectangular-shaped surface and a second generally rectangular-shaped surface opposite and spaced apart from the first rectangular-shaped surface; wherein the first rectangular-shaped surface extends from proximate the first end surface of said mounting portion; wherein the second rectangular-shaped surface extends from proximate the second end surface of said mounting portion; wherein the first rectangular-shaped surface is parallel to each of the first end surface of said mounting portion and the second end surface of said mounting portion; and wherein the second rectangular-shaped surface is parallel to each of the first end surface of said mounting portion and the second end surface of said mounting portion.

9. The trip cam of claim 1 wherein said trip cam is a single piece of material.

10. An indication assembly for an electrical switching apparatus comprising a housing and a number of poles, each of said number of poles comprising a pair of separable contacts and an operating mechanism structured to open and close said separable contacts, said indication assembly comprising:

a cradle member structured to engage said housing; and

a trip cam comprising:
a mounting portion,
a transfer leg extending from said mounting portion, said transfer leg being structured to be cooperate with each of said number of poles,
a driving leg extending from said mounting portion in a first direction, said driving leg being structured to be driven by said cradle member, and
a trip indicator leg comprising a base portion, wherein said base portion extends from said mounting portion in a second direction generally opposite the first direction.

11. The indication assembly of claim 10 wherein said indication assembly is structured to move between a loaded position and an unloaded position; wherein, responsive to said indication assembly moving from the loaded position toward the unloaded position, said cradle member drives said driving leg; and wherein, responsive to said driving leg being driven by said cradle member, said trip indicator leg rotates about said mounting portion.

12. The indication assembly of claim 11 wherein said cradle member comprises a hook portion, a protrusion, and an extension arm opposite said hook portion; wherein said hook portion is structured to engage said housing; wherein said protrusion is structured to drive said driving leg; wherein said protrusion is disposed between said hook portion and said extension arm; wherein said trip indicator leg further comprises a support portion; and wherein in the unloaded position, said support portion extends from said mounting portion in a direction generally parallel to said extension arm.

13. An electrical switching apparatus comprising:
a housing;
a number of poles, each of said number of poles comprising a pair of separable contacts and an operating mechanism structured to open and close said separable contacts; and
at least one indication assembly comprising:
a cradle member disposed in said housing, and
a trip cam comprising:

a mounting portion,
a transfer leg extending from said mounting portion, said transfer leg cooperating with each of said number of poles,
a driving leg extending from said mounting portion in a first direction, said driving leg being structured to be driven by said cradle member, and
a trip indicator leg comprising a base portion,
wherein said base portion extends from said mounting portion in a second direction generally opposite the first direction.

14. The electrical switching apparatus of claim 13 wherein said housing comprises an external surface having a window; wherein said base portion comprises a pair of opposing and spaced apart side surfaces; wherein said trip indicator leg further comprises a support portion extending from each of said base portion and said mounting portion; wherein said support portion comprises a pair of opposing and spaced apart generally triangular-shaped surfaces; and wherein each of the side surfaces and the triangular-shaped surfaces is disposed normal to said external surface.

15. The electrical switching apparatus of claim 13 wherein said at least one indication assembly is structured to move between a loaded position corresponding to said separable contacts being CLOSED and an unloaded position corresponding to said separable contacts being TRIPPED OPEN; wherein, responsive to said at least one indication assembly moving from the loaded position toward the unloaded position, said cradle member drives said driving leg; and wherein, responsive to said driving leg being driven by said cradle member, said trip indicator leg rotates about said mounting portion.

16. The electrical switching apparatus of claim 15 wherein said base portion comprises a first end portion and a second end portion opposite the first end portion; wherein the first end portion extends from said mounting portion; wherein said trip indicator leg further comprises a trip flag extending from the second end portion; wherein said housing has at least one window; wherein in the loaded position said trip flag is not visible through said at least one window; and wherein in the unloaded position said trip flag is visible through said at least one window.

17. The electrical switching apparatus of claim 16 wherein said trip cam is a single piece of material.

18. The electrical switching apparatus of claim 16 wherein said trip flag comprises a generally rectangular-shaped trip indicating surface; and wherein in the unloaded position, said trip indicating surface is substantially disposed in said at least one window.

19. The electrical switching apparatus of claim 16 wherein said housing comprises a generally planar external surface; wherein said window is disposed in said external surface; wherein said trip indicator leg further comprises a support portion extending from said mounting portion; and wherein in the unloaded position, said support portion extends from said mounting portion in a direction substantially normal to said external surface.

20. The electrical switching apparatus of claim 16 wherein said electrical switching apparatus is a multi-pole circuit breaker; wherein said at least one window is a plurality of windows for each of the poles of the circuit breaker; wherein said at least one indication assembly is a plurality of indication assemblies for each of the poles of the circuit breaker; and wherein, responsive to one of the plurality of indication assemblies moving from the loaded position to the unloaded position, each of the plurality of indication assemblies moves from the loaded position to the unloaded position.

14-MCB-214

1/11

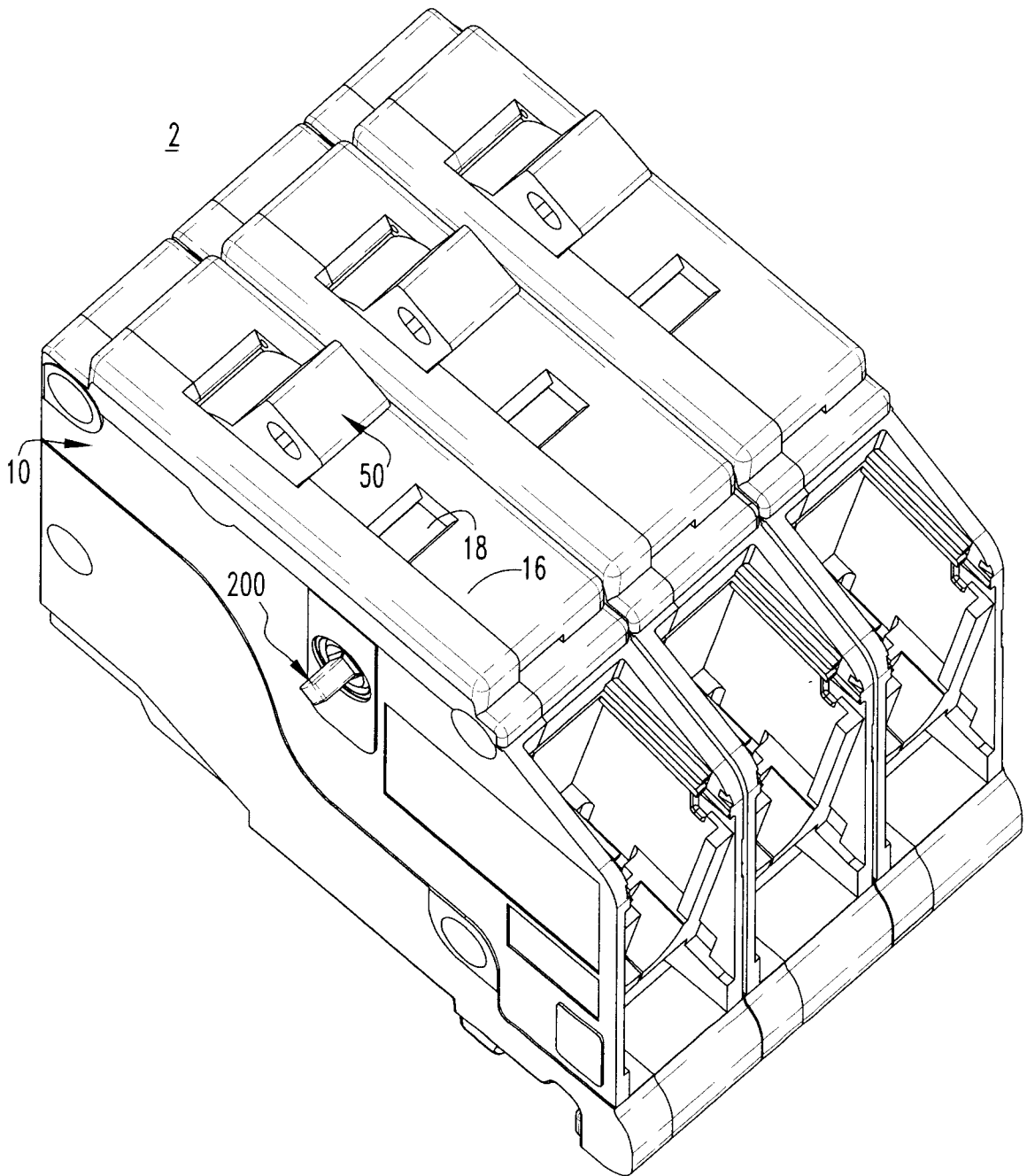

FIG.1

14-MCB-214

2/11

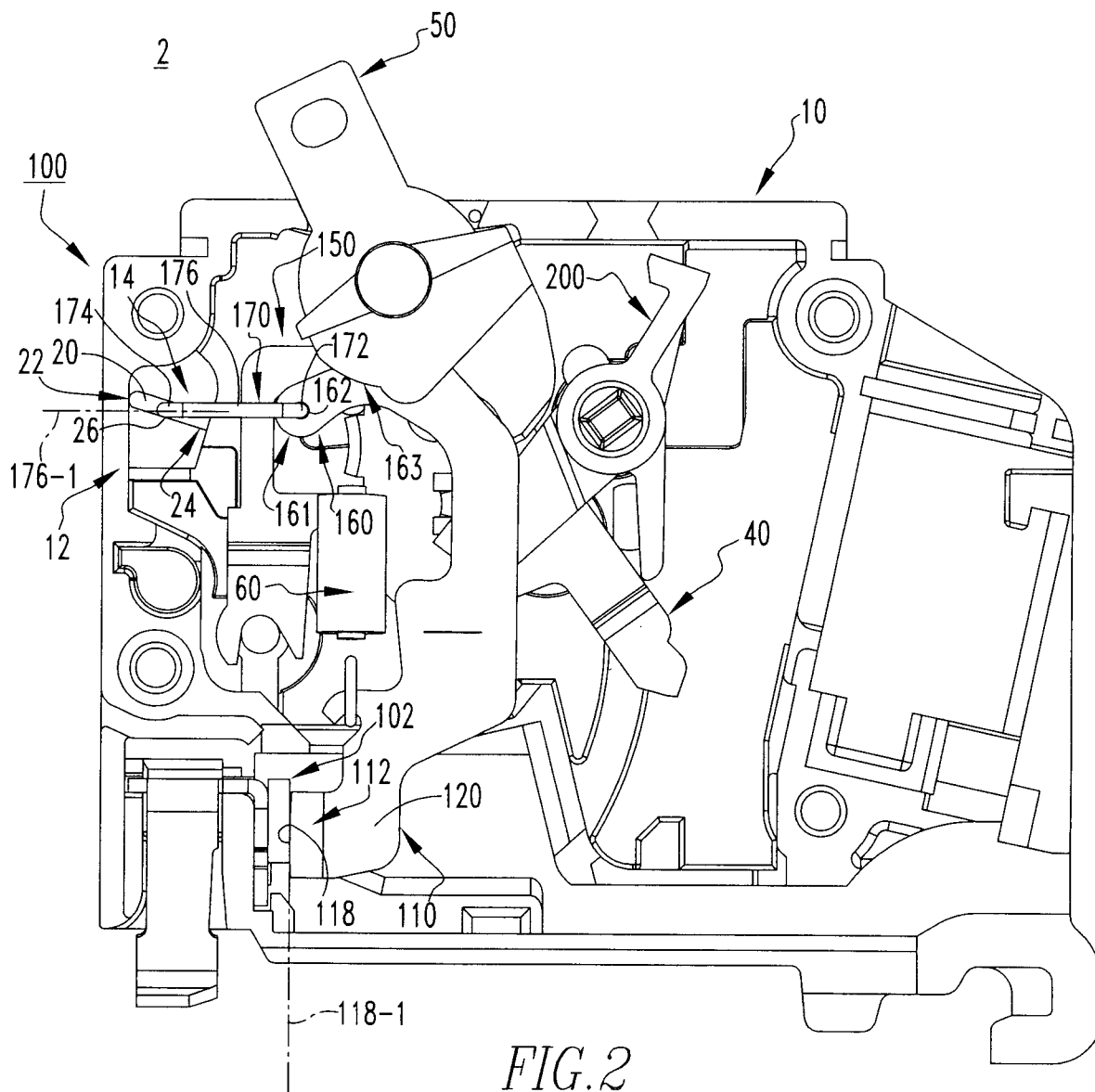

FIG. 2

14-MCB-214

3/11

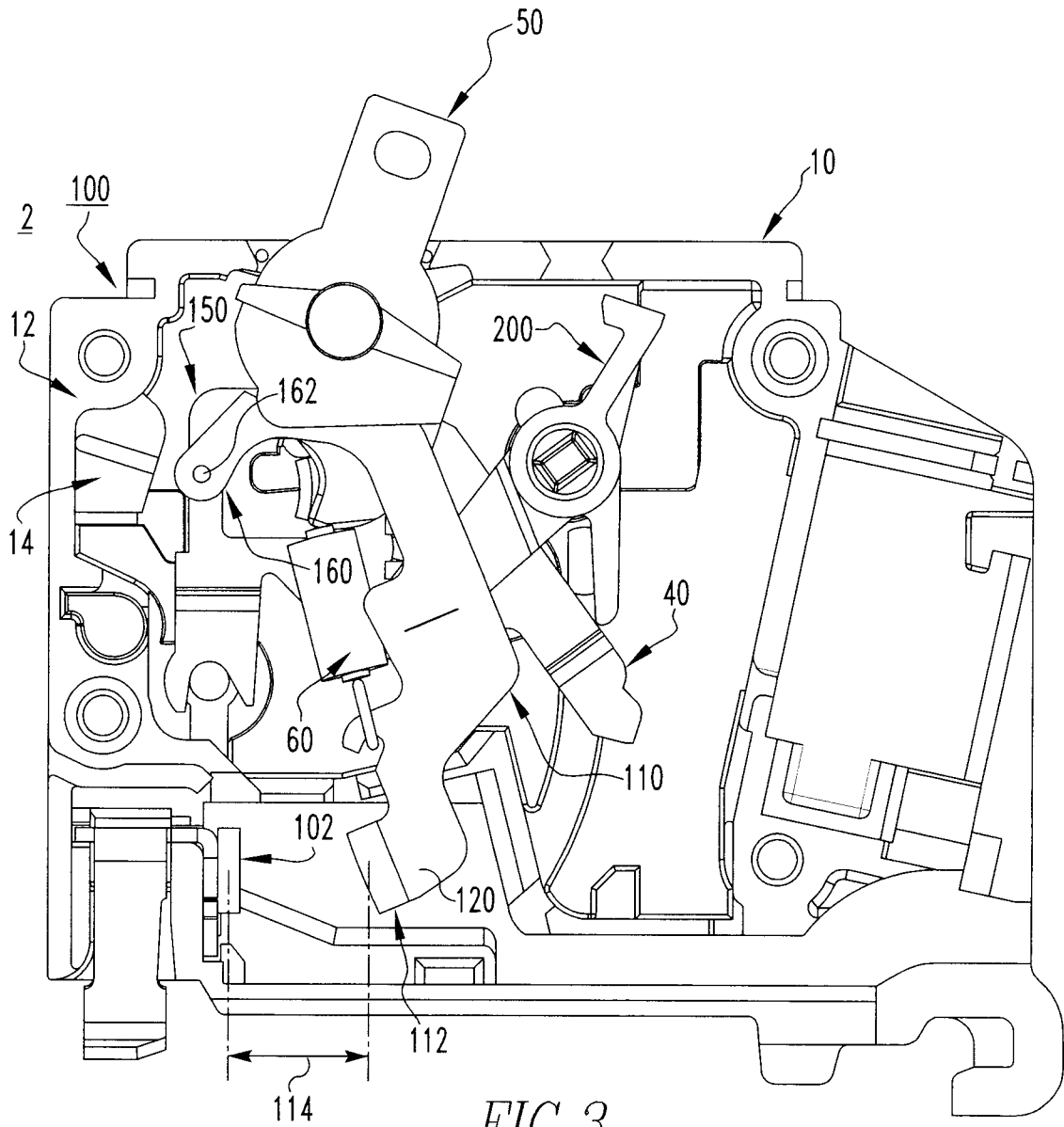
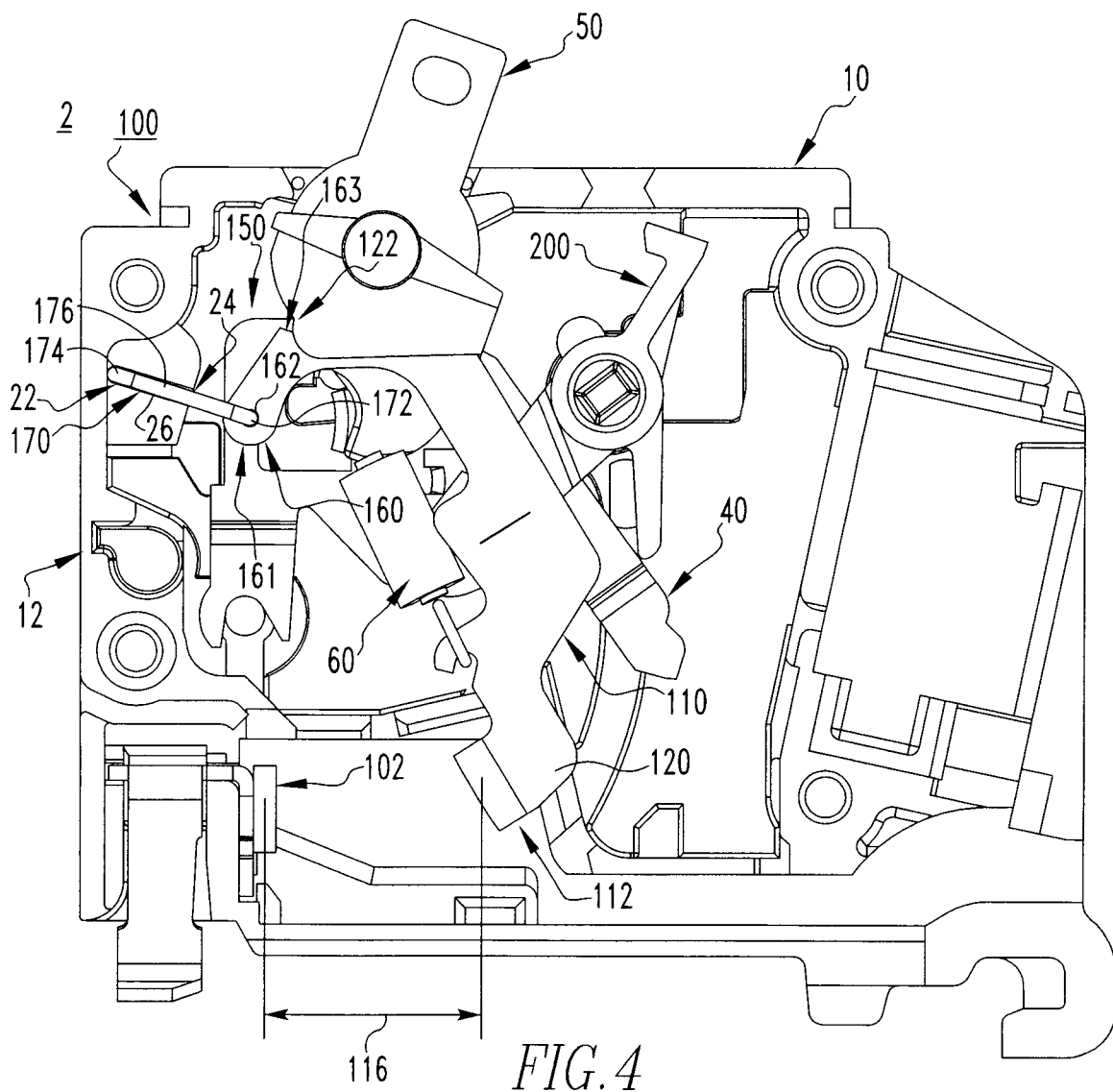

FIG. 3

14-MCB-214

4/11



14-MCB-214

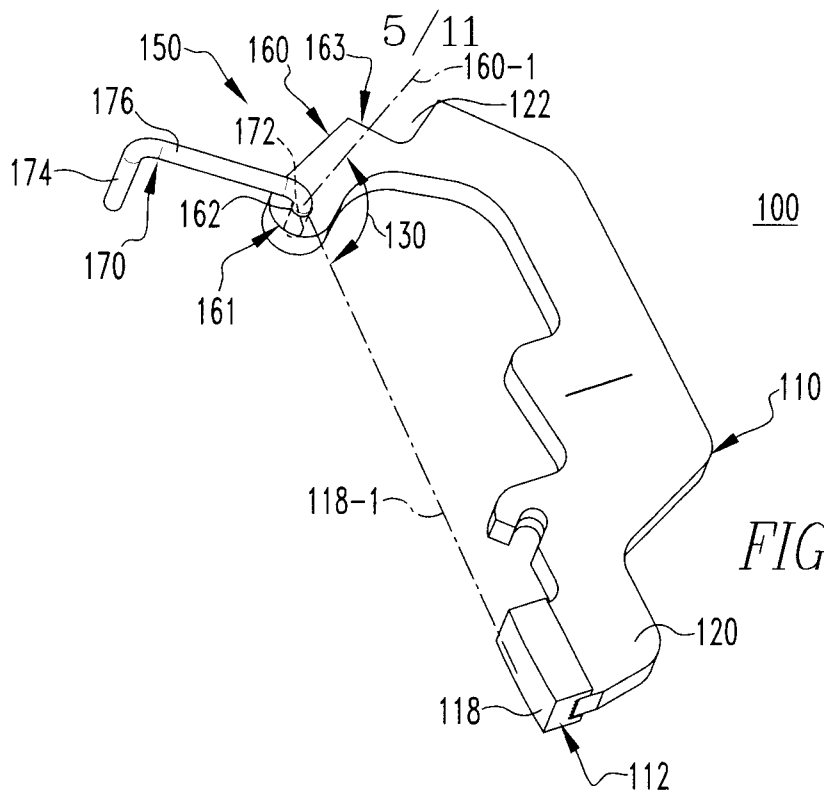

FIG. 5

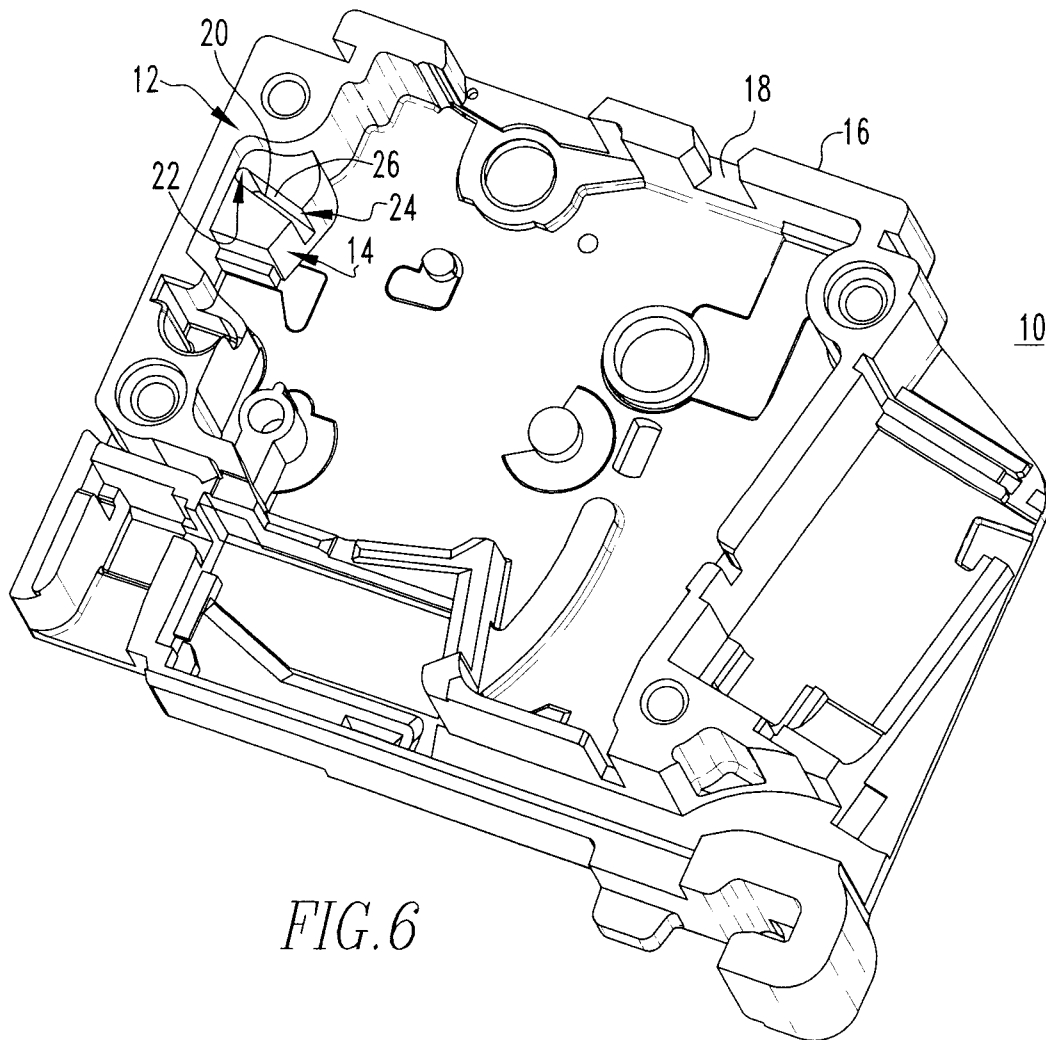
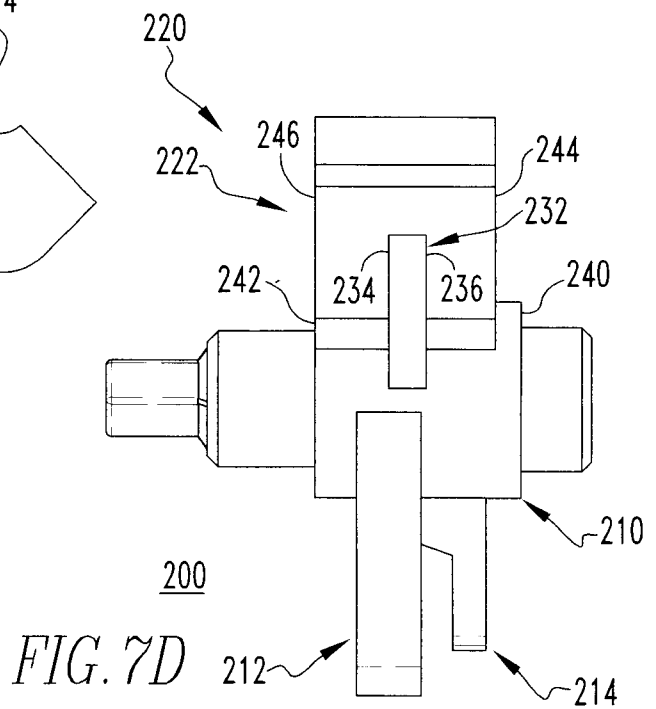
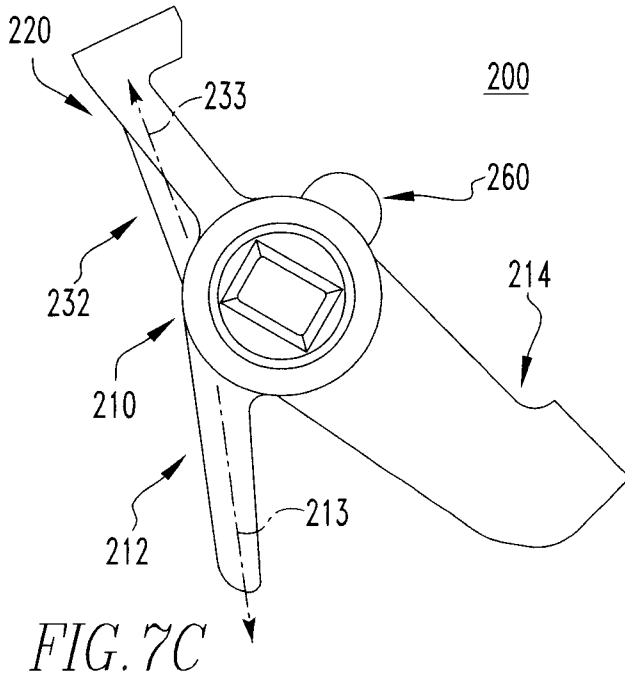
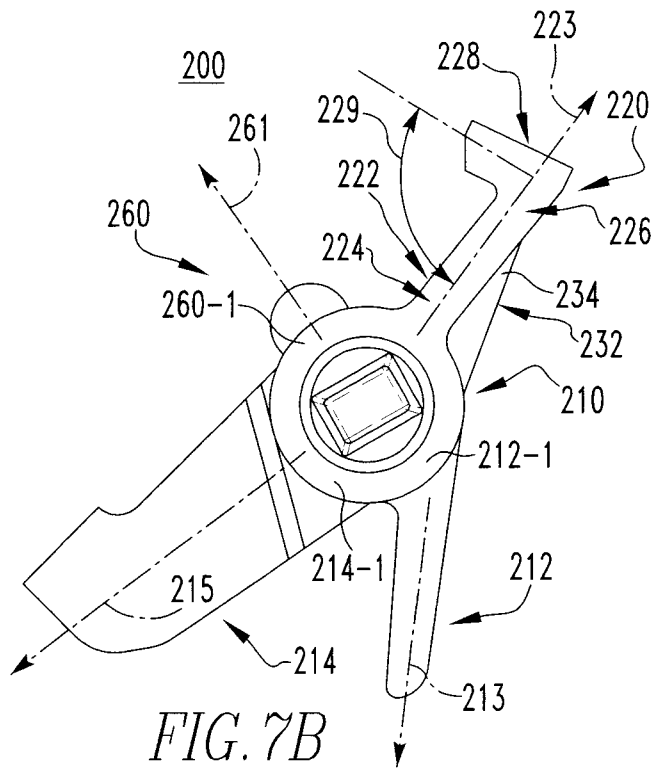
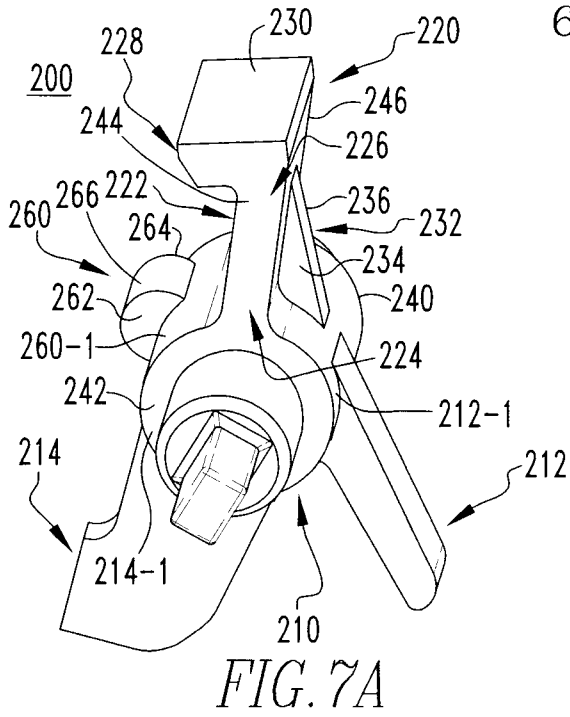

FIG. 6

14-MCB-214

6/11



14-MCB-214

7/11

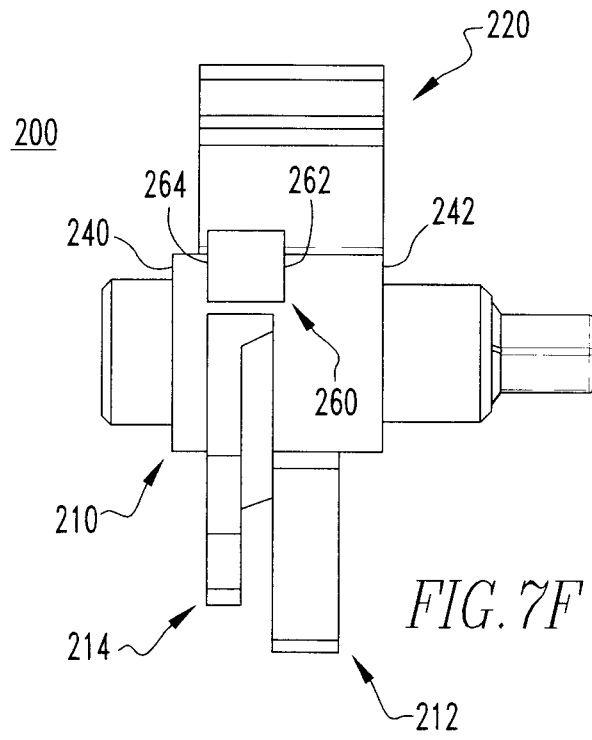
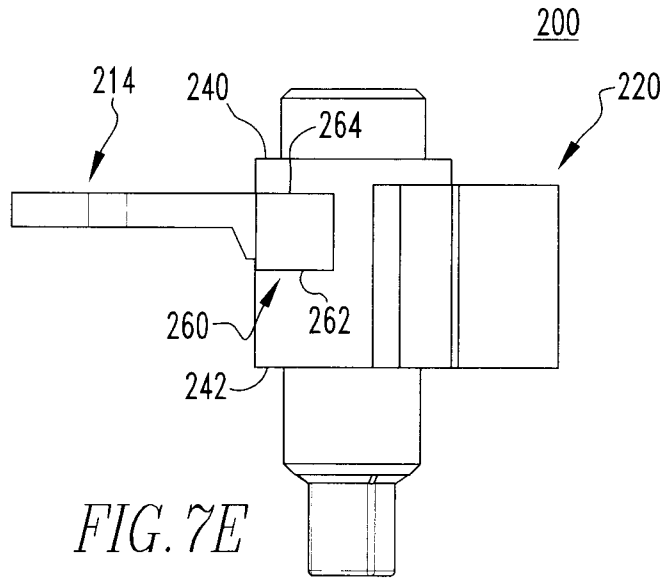

14-MCB-214

8/11

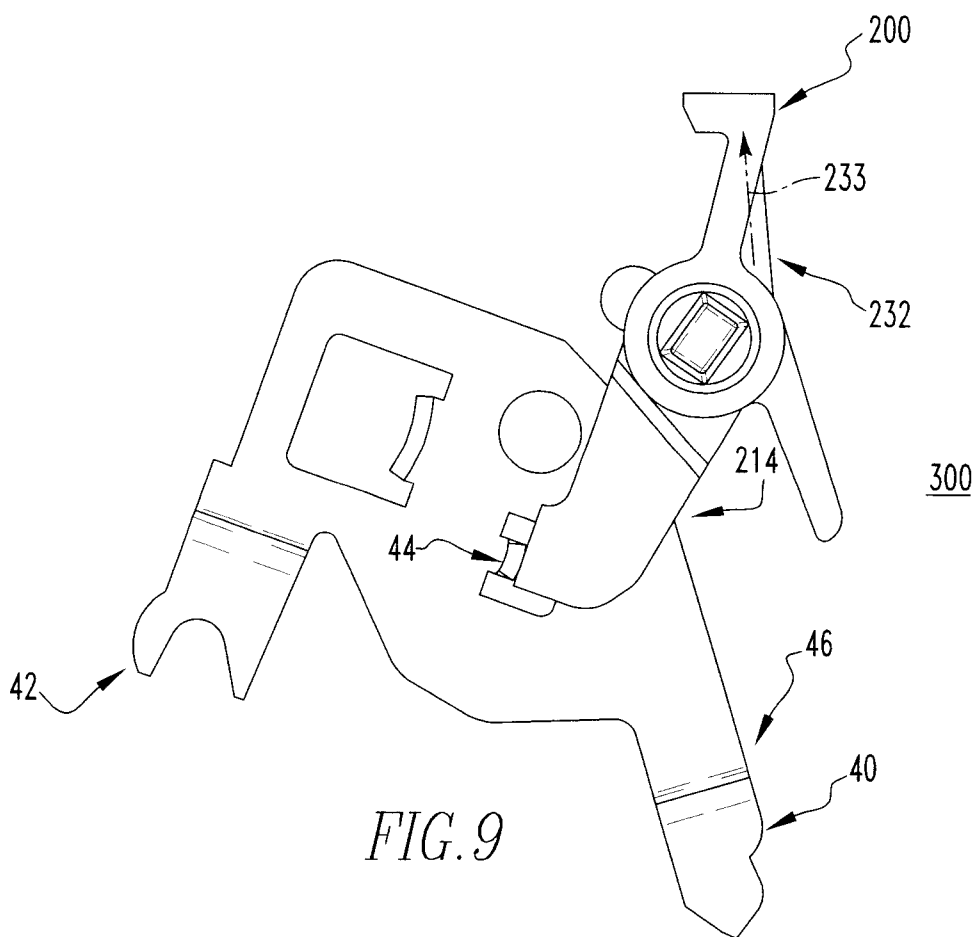
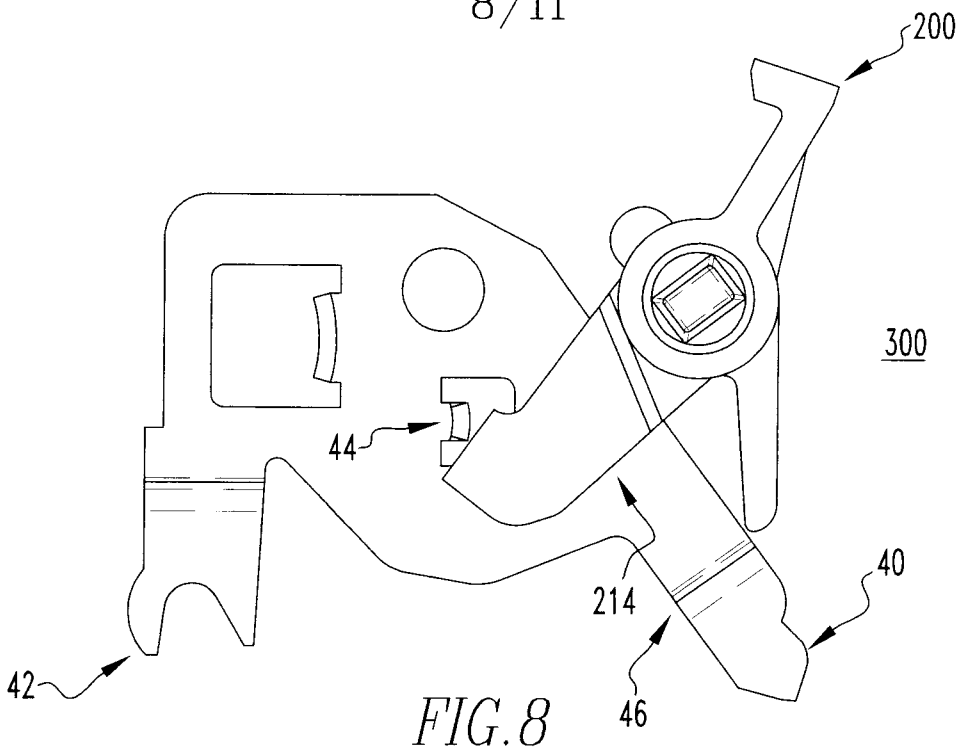

14-MCB-214

9/11

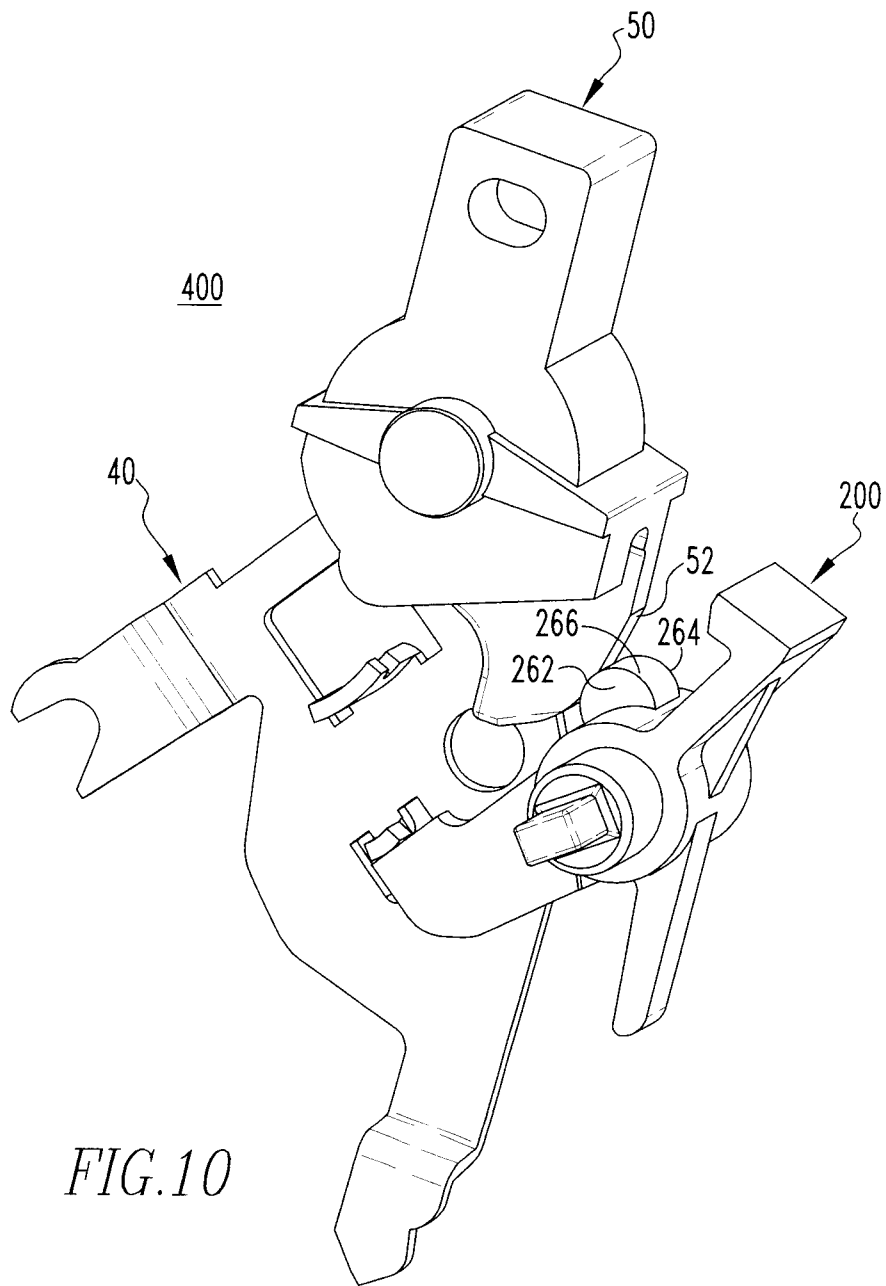

FIG. 10

14-MCB-214

10/11

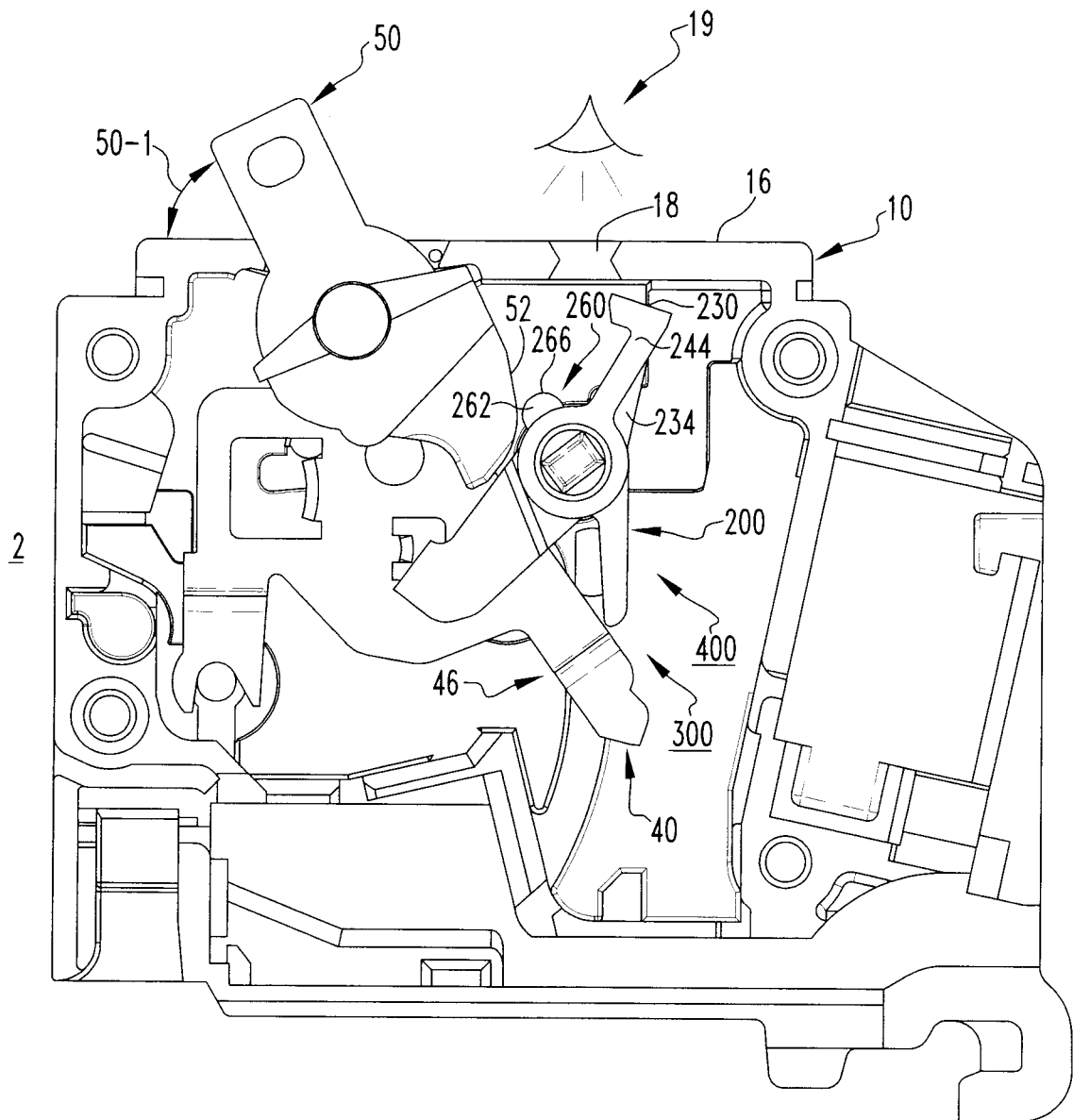

FIG. 11

14-MCB-214

11/11

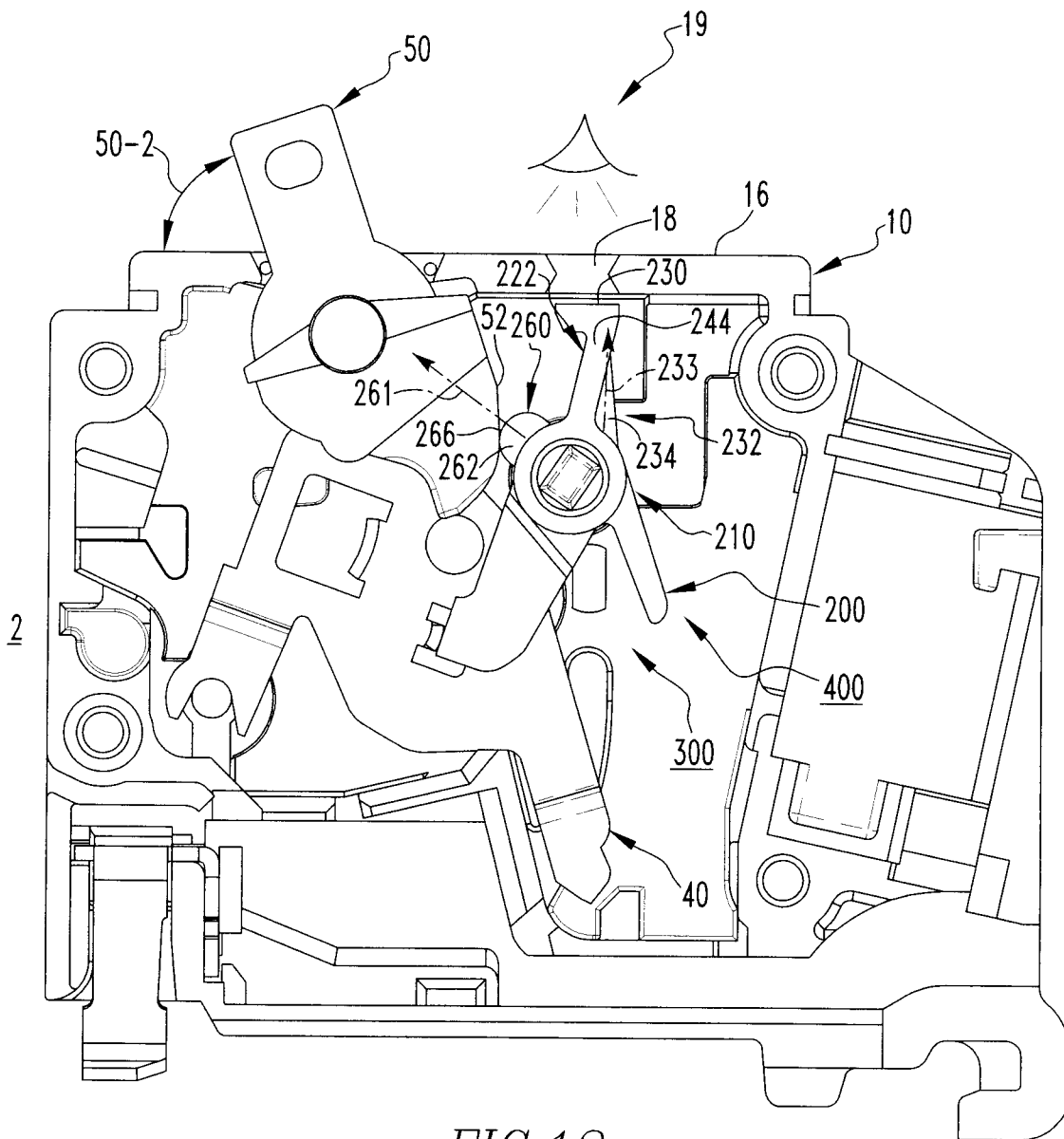

FIG.12

