

(19) World Intellectual Property
Organization
International Bureau



(43) International Publication Date
14 April 2005 (14.04.2005)

PCT

(10) International Publication Number
WO 2005/032628 A1

- (51) International Patent Classification⁷: **A61M 5/315**, 25/00 (74) Agent: **HIGHET, David, W.**; Becton Dickinson and Company, 1 Becton Drive, Franklin Lakes, NJ 07417-1880 (US).
- (21) International Application Number: PCT/US2004/028752 (81) Designated States (unless otherwise indicated, for every kind of national protection available): AE, AG, AL, AM, AT, AU, AZ, BA, BB, BG, BR, BW, BY, BZ, CA, CH, CN, CO, CR, CU, CZ, DE, DK, DM, DZ, EC, EE, EG, ES, FI, GB, GD, GE, GH, GM, HR, HU, ID, IL, IN, IS, JP, KE, KG, KP, KR, KZ, LC, LK, LR, LS, LT, LU, LV, MA, MD, MG, MK, MN, MW, MX, MZ, NA, NI, NO, NZ, OM, PG, PH, PL, PT, RO, RU, SC, SD, SE, SG, SK, SL, SY, TJ, TM, TN, TR, TT, TZ, UA, UG, US, UZ, VC, VN, YU, ZA, ZM, ZW.
- (22) International Filing Date: 3 September 2004 (03.09.2004)
- (25) Filing Language: English
- (26) Publication Language: English
- (30) Priority Data: 10/668,725 23 September 2003 (23.09.2003) US (84) Designated States (unless otherwise indicated, for every kind of regional protection available): ARIPO (BW, GH, GM, KE, LS, MW, MZ, NA, SD, SL, SZ, TZ, UG, ZM, ZW), Eurasian (AM, AZ, BY, KG, KZ, MD, RU, TJ, TM), European (AT, BE, BG, CH, CY, CZ, DE, DK, EE, ES, FI, FR, GB, GR, HU, IE, IT, LU, MC, NL, PL, PT, RO, SE, SI, SK, TR), OAPI (BF, BJ, CF, CG, CI, CM, GA, GN, GQ, GW, ML, MR, NE, SN, TD, TG).
- (71) Applicant (for all designated States except US): **BECTON, DICKINSON AND COMPANY** [US/US]; 1 Becton Drive, Franklin Lakes, NJ 07417-1880 (US).
- (72) Inventors; and
- (75) Inventors/Applicants (for US only): **ALHEIDT, Thomas, A.** [US/US]; 300 Holland Mountain Road, Stockholm, NJ 07460 (US). **TIMKO, James, John** [US/US]; 3 Sparrow Drive, Sparta, NJ 07871 (US).
- Published: — with international search report

[Continued on next page]

(54) Title: FLUSH SYRINGE HAVING ANTI-REFLUX STOPPER

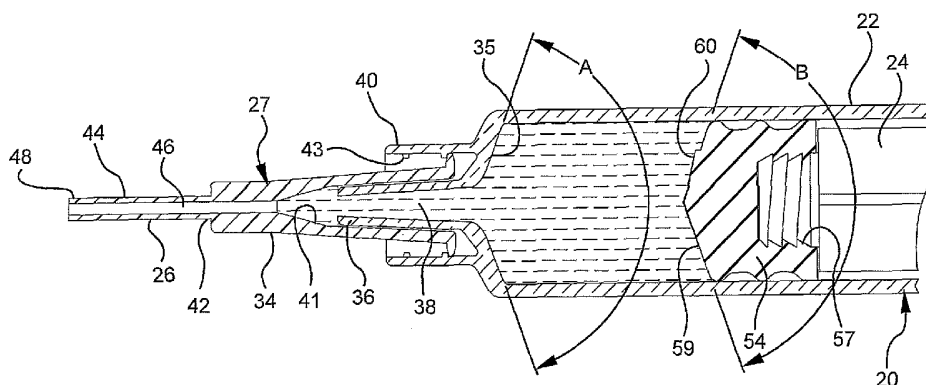

(57) Abstract: An I.V. flush syringe (20) assembly includes a barrel (22) having an inside surface (32) defining a chamber (33) for retaining fluid, an open proximal end (28) and a distal end (30) including a distal wall (31) with an elongate tip (36) extending distally therefrom having a passageway (38) therethrough in fluid communication with the chamber (33). A plunger (24) having an elongate body portion (25) and a stopper (54) slidably positioned in fluid-tight engagement with the inside surface (32) of the barrel (22) is provided. Anti-reflux structure for controlling stopper deflection when fluid has been delivered from the chamber (33) and the stopper (54) is in contact with the distal wall (31) is provided. The anti-reflux structure includes the stopper (54) having a conically shaped distal surface (59) and the inside surface (32) of the barrel (22) and the distal wall (31) being conically shaped (35) wherein the total included angle A of the inside surface (32) of the barrel (22) at the distal wall (31) is greater than the total included angle B of the distal surface (59) of the stopper (54) by at least 6°.



For two-letter codes and other abbreviations, refer to the "Guidance Notes on Codes and Abbreviations" appearing at the beginning of each regular issue of the PCT Gazette.

FLUSH SYRINGE HAVING ANTI-REFLUX STOPPER

BACKGROUND OF THE INVENTION

5 [0001] The present invention relates to syringe assemblies and particularly to syringe assemblies for use in I.V. flush procedures.

[0002] An I.V. catheter is a commonly used therapeutic device. Many patients, in accordance with their therapy, have an I.V. catheter connected to a vein ready for use in various procedures or in fluid communication with an I.V. system for infusing liquids and medication. Many I.V. sets have I.V. ports which are in fluid communication with a catheter and allow access for the purpose of injecting medication into the patient, and for use in flushing techniques to maintain catheter integrity. Healthcare facilities have flushing protocols which depend on the amount of time the catheter will remain in the patient and the type of catheter being used. For example, a peripherally inserted central catheter (PICC) is a long flexible catheter, which is typically inserted into the central venous system (optimally with the tip terminating in the superior vena cava) via the superficial veins of the antecubital fossa. PICC lines are designed for use when intermediate or long-term therapy is prescribed.

[0003] These catheter lines must be periodically flushed with saline flush solution and/or heparin lock flush solution depending on the protocol. Among other things, flushing saline solution removes blood from the catheter and heparin helps prevent the formation of future blood clots. The most common I.V. ports are covered by pierceable septums or pre-slit septums and are known in the art and sometimes referred to as "PRN" from the Latin *pro re nata* meaning "as the need arises". The septum is preferably made of rubber or another elastomeric material which permits insertion of a sharp needle cannula in order to infuse fluids into or to withdraw fluids from the catheter. Upon withdrawal of the needle cannula the septum seals itself. Ports having pre-slit septums are used with blunt cannula. Typically, the blunt cannula is attached to a syringe and the syringe is moved to place a gentle pressure on the pre-slit septum which is forced open by the blunt cannula to establish fluid communication. Also, some

I.V. sets have access valves which are responsive to the frusto-conically shaped tip of a syringe barrel for allowing fluid communication between the interior of the syringe and the catheter without the use of a cannula.

5 [0004] Catheters are flushed using syringe assemblies filled with various fluids. In some cases, different fluids are injected sequentially in accordance with the protocol. For example, a saline solution followed by an anticoagulant such as heparin. The size of the syringe used to flush I.V. lines varies by various factors including the size and length of the catheter. Typically syringes of 1ml, 3ml, 5ml and 10ml volume are used.

10 [0005] It is important in the flush procedure not to draw blood back into the catheter where it can clot and seal the catheter, commonly referred to as "reflux". In order to prevent blood reflux into the catheter the user is encouraged to maintain a positive pressure in the line during the flush procedure. This may involve slowly withdrawing the syringe and cannula from the I.V. port while still applying pressure to the syringe plunger rod during the flush procedure. When using a syringe with an elastomeric
15 stopper, the stopper is often compressed when it contacts the distal end of the syringe barrel at the completion of the flush procedure. When a user relieves the pressure to the plunger after the flush procedure is completed, the stopper will expand back to its normal size drawing liquid from the catheter into the syringe barrel. This is undesirable, since it can cause blood to enter the catheter at the catheter distal end
20 (reflux). Problems with reflux of blood into the catheter are on the rise because IV lines are now being flushed by a wide variety of health care workers not just those dedicated to catheter maintenance. These other health care workers, as a result of having many other aspects of patient care to be responsible for and who spend much less time flushing IV lines, are not as efficient as those dedicated to catheter maintenance.

25 [0006] Therefore there is a need for simple, straight forward easy-to-manufacture syringe assemblies which helps reduce or eliminate reflux of blood into the catheter during and after the flushing procedure has occurred even if flush protocols and procedures are not precisely followed. For example, prematurely releasing the compressive force on the stopper, which may cause reflux of blood into the catheter.

30

SUMMARY OF THE INVENTION

[0007] The present invention is directed to a syringe assembly for use in flush applications. The syringe assembly reduces or eliminates reflux of blood into the catheter by providing a conically shaped stopper surface having a total included angle less than the angle of the conically shaped distal wall of the barrel so that the stopper seals the barrel first at its center near the passageway which discharges flush solution. Further compression of the stopper will be independent of this seal so that reflux is reduced or eliminated.

[0008] An I.V. flush syringe assembly comprises a barrel including a cylindrical sidewall having an inside surface defining a chamber for retaining fluid. The barrel includes an open proximal end and a distal end having a distal wall with an elongate tip extending distally therefrom. The tip includes a passageway therethrough in fluid communication with the chamber. The plunger having an elongate body portion includes a proximal end, a distal end and a stopper slidably positioned in fluid-tight engagement with the inside surface of the barrel for drawing fluid into and driving fluid out of the chamber by movement of the stopper relative to the barrel. The elongate body portion of the plunger extends outwardly from the open proximal end of the barrel. Anti-reflux structure is provided for controlling stopper deflection when fluid has been delivered from the chamber and the stopper is in contact with the distal wall of the barrel. Anti-reflux structure includes the stopper having a conically shaped distal surface and the barrel having a conically shaped inside surface at its distal wall. The total included angle of the inside surface of the barrel at the distal wall is greater than the total included angle of the distal surface of the stopper by at least six degrees.

[0009] In one embodiment the total included angle of the distal surface of the stopper is about 110 degrees and the total included angle of the conically shaped inside surface of the distal wall of the barrel is about 120 degrees.

[00010] The syringe assembly may further include at least one projection on the distal surface of the stopper positioned mostly in the space between the distal surface of the stopper and the conically shaped inside surface of the distal wall of the barrel when the distal surface of the stopper first contacts the conically shaped inside surface.

[00011] The syringe assembly may also include flush solution in the chamber and a tip cap releasably connected to the tip of the syringe barrel for sealing the passageway. The flush solution may be selected from the group consisting of saline flush solution and heparin lock solution.

5 [00012] The syringe assembly may further include a needle assembly including a cannula having a proximal end, a distal end, and a lumen therethrough. A hub having an open proximal end containing a cavity and a distal end attached to the proximal end of the cannula so that the lumen is in fluid communication with the cavity of the hub. The needle assembly is removably attached to the tip of the barrel through engagement
10 of the tip to the cavity of the hub so that the lumen is in fluid communication with the chamber of the barrel.

[00013] Another embodiment of the I.V. flush syringe assembly of the present invention comprises a barrel including a cylindrical sidewall having an inside surface defining a chamber for retaining fluid. The barrel includes an open proximal end and a
15 distal end having a distal wall with an elongate tip extending distally therefrom having a passageway therethrough in fluid communication with the chamber. A plunger includes an elongate body portion having a proximal end, a distal end and a stopper slidably positioned in fluid-tight engagement with the inside surface of the barrel for drawing fluid into and driving fluid out of the chamber by movement of the stopper relative to
20 the barrel. The elongate body of the plunger extends outwardly from the open proximal end of the barrel. A tip cap is releasably connected to the elongate tip of the barrel for sealing the passageway. A quantity of flush solution is in the chamber between the stopper and the distal wall. Anti-reflux structure for controlling stopper deflection when fluid has been delivered from the chamber and the stopper is in contact
25 with the distal wall is provided. The anti-reflux structure may include the stopper having a conically shaped distal surface and the inside surface of the barrel at the distal wall being conically shaped wherein the total included angle of the inside surface of the barrel at the distal wall is greater than the total included angle of the distal surface of the stopper by at least six degrees and preferably at least about ten degrees. At least
30 one projection on the distal surface of the stopper is provided. The at least one

projection is positioned and/or sized so that when the stopper contacts the inside surface of the barrel any deflection of the projection will not store enough energy to move the stopper proximally to the extent the stopper is disengaged from the inside surface of the distal end of the barrel near the passageway.

- 5 [00014] A method of flushing a catheter of the present invention comprises the steps of providing a syringe assembly having a barrel including a cylindrical side wall having an inside surface defining a chamber for retaining fluid, an open proximal end and a distal end including a distal wall with an elongate tip extending distally therefrom having a passageway therethrough in fluid communication with the chamber, a plunger
- 10 including an elongate body portion having a proximal end, a distal end and a stopper slidably positioned in fluid-tight engagement with the inside surface of the barrel for drawing fluid into and driving fluid out of the chamber by movement of the stopper relative to the barrel, the elongate body portion extending outwardly from the open proximal end of the barrel, a quantity of flush solution in said chamber, and anti-reflux
- 15 means for minimizing stopper deflection when the flush solution has been delivered from the chamber and the stopper is in contact with and pressed against the distal wall. The method further includes providing a catheter having a proximal end, a distal end and a passageway therethrough and a housing having a hollow interior in fluid communication with the passageway, the housing having an access valve capable of
- 20 engaging the elongate tip of the barrel for allowing fluid communication with the hollow interior of the housing. The method further includes the steps of placing the distal end of the catheter in a blood vessel; engaging the elongate tip of the barrel with the access valve so that the passageway in the tip is in fluid communication with the hollow interior of the housing; applying force to the plunger to move the plunger in a distal
- 25 direction with respect to the barrel so that the flush solution in the chamber flows through the passageway into the hollow chamber of the housing and through the passageway of the catheter; continuing to apply force to the plunger until the stopper contacts and presses against the distal wall of the barrel; and disengaging said syringe assembly from said access valve.

[00015] An alternative method may include the step of attaching a needle assembly to the elongate tip of the barrel. The needle assembly includes a cannula having a proximal end, a distal end and a lumen therethrough and a hub having an open proximal end containing a cavity and a distal end attached to the proximal end of the cannula so that the lumen is in fluid communication with the cavity. The attachment of the needle assembly to the barrel is through frictional engagement between the cavity in the hub and the elongate tip. This alternative method is used with a catheter having a proximal end, a distal end and a passageway therethrough and a housing having a hollow interior connected to the catheter and in fluid communication with the passageway of the catheter. The housing further includes a septum for allowing fluid communication with the hollow interior. Fluid communication is established by forcing the distal end of the cannula through the septum so that the lumen of the cannula is in fluid communication with the hollow interior of the housing. Also, the cannula may be permanently attached to the barrel tip with or without the use of a hub. At completion of the flush procedure the cannula is withdrawn from the septum.

BRIEF DESCRIPTION OF THE DRAWINGS

[00016] FIG. 1 is a perspective view of a syringe assembly according to one embodiment of the invention.

[0010] FIG. 2 is a partially cross-sectioned side elevational view of the syringe assembly of FIG. 1 with a needle assembly attached.

[0011] FIG. 3 is a cross-sectional view of the syringe assembly of FIG. 1 taken along line 3-3.

[0012] FIG. 4 is a partial perspective view of the stopper and distal end of the plunger of the syringe assembly of FIG. 1.

[0013] FIG. 5 is an enlarged partial cross-sectional side elevation view of the distal end of the syringe assembly of FIG. 2.

[0014] FIG. 6 is an enlarged partial cross-sectional side elevational view of the distal end of the syringe assembly shown at the completion of a flush procedure.

[0015] FIG. 7 is a side-elevational view illustrating the syringe assembly in use with a catheter injection site.

[0016] FIG. 8 is a perspective view of a syringe assembly according to another embodiment of the invention.

5 [0017] FIG. 9 is partially cross-sectioned perspective view of the syringe assembly of FIG. 8, taken along line 9-9.

DETAILED DESCRIPTION

[0018] FIG. 1 shows a syringe 20 according to the present invention generally comprising a barrel 22 and a plunger 24. The barrel 22 has a generally cylindrical side wall 23 including an open proximal end 28 having finger grips 29, a distal end 30 having a distal wall 31 and an inside surface 32 defining a chamber 33 for retaining fluid. The inside surface of the barrel at the distal wall is conically shaped as indicated as numeral 35. The conically shaped inside surface of the distal wall of the barrel has a total included angle A as illustrated in FIG. 5. Distal end 30 further includes a tip 36 having a passageway 38 in fluid communication with the chamber. The distal end of barrel 22 preferably, but not necessarily includes a locking luer type collar 40 concentrically surrounding tip 36. The inside surface of the collar includes at least one thread 43. A cannula 26 includes a proximal end 42, a distal end 44 and a lumen 46 therethrough. The distal end may include a sharp tip or a blunt tip 48 as shown. The cannula may be connected directly to the tip of the syringe barrel to establish fluid communication between the lumen and the chamber. Also, the cannula may be part of a needle assembly 27 including a hub 34 having an open proximal end 37 containing a cavity 41 and a distal end 39 attached to the proximal end of the cannula so that the lumen of the cannula is in fluid communication with the cavity. The cavity of the hub can be removably frictionally engaged to the tip of the barrel as illustrated in Figs. 2, 5 and 6.

[0019] Plunger 24 includes an elongate body portion 25, a proximal end 50 having a flange 51, and a distal end 52. A stopper 54 is disposed on projection 53 at distal end 52 of the plunger, preferably via threading engagement. Stopper 54 includes at least one rib and preferably a plurality of ribs 56 on its outside diameter. The

stopper is slidably positioned in fluid-tight engagement with the inside surface of the barrel for drawing fluid into and drawing fluid out of the chamber, through the passageway, by movement of the stopper relative to the barrel. Stopper 54 includes a proximal end 55 having a cavity 57 therein for engaging projection 53 on the distal end 52 of the plunger. Stopper 54 further includes a distal end 58 having a conically shaped distal surface 59 thereon. Conically shaped distal surface 59 has a total included angle B as illustrated in FIG. 5. As will be explained in more detail hereinafter, total included angle A of the inside surface of the barrel at the distal wall is greater than total included angle B of the conically shaped distal surface of the stopper. Angle A is at least six degrees, and preferably at least about ten degrees more than angle B. In this preferred embodiment, angle A is about 120 degrees and angle B is about 110 degrees.

[0020] Stopper 54 preferably includes at least one projection or lug 60 on conically shaped distal surface 59. Projection 60 keeps the stoppers from nesting or sticking to each other during the assembly process. For example, the conically shaped distal surface of one stopper may position itself in the cavity of another stopper while the stoppers are together before assembly.

[0021] The stopper may be made of any material suitable for providing sealing characteristics while under compression. For example, the stopper may be made of thermoplastic elastomers, natural rubber, synthetic rubber or thermoplastic materials and combinations thereof. The plunger in this embodiment is preferably made of material which is more rigid than the stopper such as polypropylene, polyethylene and the like.

[0022] In operation, syringe 20 is connected to a needle assembly and filled with flush solution using known methods. The flush solution may be any solution intended for flushing. It is preferred that the flush solution be selected from the group consisting of saline flush solution and heparin lock flush solution. These solutions are known in the art and readily available. An example of a saline flush solution is 0.9% Sodium Chloride USP. An example of a heparin lock flush solution is 0.9% Sodium Chloride with 100 USP units of Heparin Sodium per ml or 10 USP units of Heparin Sodium per ml.

The syringe with needle assembly attached is used to pierce the pierceable septum or a blunt cannula may be inserted into a pre-split septum of a vial containing flush solution and the flush solution is drawn into the syringe barrel by pulling plunger rod flange 51 in the proximal direction while holding barrel 22, to draw fluid through the needle
5 cannula into fluid chamber 33.

[0023] Alternatively, the syringe may be filled with flush solution during the manufacturing of the syringe via a sterile filling method. Such prefilled syringes may be supplied with a tip cap, such as tip cap 45 releasably connected to tip 36 sealing
10 passageway 38. It is preferred that the tip cap is formed of material selected from the group of thermoplastic materials and elastomeric materials such as natural and synthetic rubber and thermoplastic elastomers.

[0024] The syringe is now ready for use in flushing a catheter of an I.V. set. I.V. sets can be very complicated and may include multiple injection ports, a valve and/or other components. For the purpose of illustrating the present invention a simplified I.V.
15 set 64 is illustrated in Fig. 7. I.V. set 64 comprises an I.V. site 65 which includes a housing 67 having a hollow interior 68 and a septum 69 at its proximal end. A catheter 70 having a conduit therethrough extends from the distal end of the housing. For this I.V. set septum 69 is pre-slit for use with blunt cannula. The I.V. site may be a valve having structure for accepting the syringe barrel tip and being activated by the insertion
20 of the tip to establish fluid communication with the catheter, such as the valve taught in U.S. Patent No. 6,171,287.

[0025] Blunt tip 48 of cannula 26 may be inserted through pre-split septum 69 of I.V. set 64. Alternatively, a sharp tip of a needle cannula may be used to pierce a septum that is not pre-split, or the tip of the barrel may be engaged with a valve in the
25 IV site. This establishes fluid communication between the interior 68 of the I.V. set and the chamber of the syringe barrel. The syringe barrel 22 is preferably held via finger grips 29. Pressure is then applied to flange 51 of the plunger, for example by a thumb, in the distal direction. This moves the plunger 24 having the stopper 54 on its distal end forcing the liquid such as flush solution 71 in the chamber 34 out of the chamber,
30 through cannula 26 and into interior 68 of the I.V. set and then through catheter 70.

[0026] Referring to Fig. 6 the position of the plunger and stopper at the completion of the flush procedure is shown. At the completion of the flush procedure conically shaped distal surface 59 of the stopper contacts conically shaped inside surface 35 of the distal end wall of the barrel near passageway 30 sealing the passageway so that further deflection of the stopper will have little or no effect on liquid in the passageway and the catheter. Accordingly, stopper deflection caused by additional unnecessary force applied to the plunger, at this time, which could cause reflux of blood into the catheter using prior art stoppers, is minimized or eliminated with the stopper of the present invention. The stopper may flex, however, this flexure will occur generally outside of the sealed area surrounding the entrance to the passageway. Further, projection 60 is shaped so that upon further deflection of the stopper through forces applied to the plunger, the projection will not be able to force the stopper to move proximally. That is, the projection cannot create enough force to move the stopper proximally to create reflux. It is preferred that the projection on the distal surface of the stopper be positioned mostly in space 61 between the conically shaped distal surface of the stopper and the conically shaped inside surface of the distal wall of the barrel as illustrated in Fig. 6. The projection should be sized and positioned so that it cannot absorb enough energy during deflection to move the stopper proximally and break the seal between the stopper and the barrel at the passageway. The projection can be angularly shaped having a distal surface at the same angle as inside surface 35 of the barrel as illustrated in FIG. 6.

[0027] FIGS. 8 and 9 illustrate an alternative embodiment of the syringe assembly of the present invention. In this embodiment syringe assembly 120 comprises a barrel 122 including a cylindrical sidewall 123 having an inside surface 132 defining a chamber 133 for retaining fluid. Distal end 130 of the barrel includes a distal wall 131 having an elongate tip 136 extending distally therefrom. The tip includes passageway 138 which is in fluid communication with the chamber. The distal wall includes conically shaped inside surface 135.

[0028] A plunger 124 includes an elongate body portion 125 having a distal end 152 and a resilient stopper 154 slidably positioned in fluid-tight engagement with the

inside surface of the barrel. The stopper includes at least one rib 156 and a conically shaped distal surface 159 at distal end 158. The total included angle of the conically shaped inside surface A of distal wall 131 is greater than conically shaped distal surface B on the stopper by at least eight degrees. In this embodiment the difference between angle A and angle B is about 20 degrees.

[0029] The distal surface of the stopper includes a plurality of projections or lugs 160 which are sized and positioned not to interfere with the sealing action of the conically shaped distal surface of the stopper as it contacts the conically shaped inside surface of the distal wall of the barrel. Further, the projections should be positioned such that and/or structured so that when they are in a partially compressed state they are not alone capable of forcing the stopper proximally in the barrel to disengage the seal between the conically shaped distal surface of the stopper and the barrel near the passageway.

[0030] Although the invention herein has been described with reference to particular embodiments, it is to be understood that these embodiments are merely illustrative of the principles and applications of the present invention. It is therefore to be understood that numerous modifications may be made to the illustrative embodiments and that other arrangements may be devised without departing from the spirit and scope of the present invention as disclosed.

20

WHAT IS CLAIMED IS:

1. An I.V. flush syringe assembly comprising:
a barrel including a cylindrical side wall having an inside surface defining a
5 chamber for retaining fluid, an open proximal end and a distal end including a distal
wall with an elongate tip extending distally therefrom having a passageway
therethrough in fluid communication with said chamber;
a plunger including an elongate body portion having a proximal end, a distal end
and a stopper slidably positioned in fluid-tight engagement with said inside surface of
10 said barrel for drawing fluid into and driving fluid out of said chamber by movement of
said stopper relative to said barrel, said elongate body portion extending outwardly
from said open proximal end of said barrel; and
anti-reflux means for controlling stopper deflection when fluid has been delivered
from said chamber and said stopper is in contact with said distal wall.
15
2. The syringe assembly of claim 1 wherein said anti-reflux means includes said
stopper having a conically shaped distal surface and said inside surface of said barrel at
said distal wall being conically shaped wherein said total included angle of said inside
surface of said barrel at said distal wall is greater than said total included angle of said
20 stopper distal surface by at least 6°.
3. The syringe assembly of claim 2 wherein said total included angle of said stopper
distal surface is about 110°.
- 25 4. The syringe assembly of claim 2 wherein the total included angle conically
shaped inside surface of said distal wall of said barrel is about 120°.
5. The syringe assembly of claim 2 further including at least one projection on said
distal surface of said stopper positioned mostly in the space between said distal surface

and said conically shaped inside surface of said distal wall when said distal surface of said stopper first contacts said conically shaped inside surface.

6. The syringe assembly of claim 1 including flush solution in said chamber.

7. The syringe assembly of claim 6 further including a tip cap releasably connected to said tip of said syringe barrel for sealing said passageway.

8. The syringe assembly of claim 6 wherein said flush solution is selected from the group consisting of saline flush solution and heparin lock flush solution.

9. The syringe assembly of claim 1 wherein said stopper is made of material selected from the list consisting of thermoplastic elastomers, natural rubber, synthetic rubber, thermoplastic materials and combinations thereof.

10. The syringe assembly of claim 1 further comprising a needle assembly including a cannula having a proximal end, a distal end and a lumen therethrough, and a hub having an open proximal end containing a cavity and a distal end attached to said proximal end of said cannula so that said lumen is in fluid communication with said cavity, said needle assembly being removably attached to said tip of said barrel through engagement of said tip to said cavity so that said lumen is in fluid communication with said chamber.

11. An I.V. flush syringe assembly comprising:

a barrel including a cylindrical side wall having an inside surface defining a chamber for retaining fluid, an open proximal end and a distal end including a distal wall with an elongate tip extending distally therefrom having a passageway therethrough in fluid communication with said chamber;

a plunger including an elongate body portion having a proximal end, a distal end and a stopper slidably positioned in fluid-tight engagement with said inside surface of

said barrel for drawing fluid into and driving fluid out of said chamber by movement of said stopper relative to said barrel, said elongate body portion extending outwardly from said open proximal end of said barrel; and

5 a tip cap releasably connected to said tip of said syringe barrel for sealing said passageway;

a quantity of flush solution in said chamber between said stopper and said distal wall;

10 anti-reflux means for controlling stopper deflection when fluid has been delivered from said chamber and said stopper is in contact with said distal wall, said anti-reflux means including said stopper having a conically shaped distal surface and said inside surface of said barrel at said distal wall being conically shaped wherein said total included angle of said inside surface of said barrel at said distal wall being greater than the total included angle of said distal surface of said stopper by at least 6°; and

15 at least one projection on said distal surface of said stopper positioned mostly in the space between said distal surface and said conically shaped inside surface of said distal wall when said distal surface first contacts said conically shaped inside surface.

12. A method of flushing a catheter comprising the steps of:

20 (a) providing a syringe assembly having a barrel including a cylindrical side wall having an inside surface defining a chamber for retaining fluid, an open proximal end and a distal end including a distal wall with an elongate tip extending distally therefrom having a passageway therethrough in fluid communication with said chamber, a plunger including an elongate body portion having a proximal end, a distal end, and a stopper slidably positioned in fluid-tight engagement with said inside surface of said barrel for
25 drawing fluid into and driving fluid out of said chamber by movement of said stopper relative to said barrel, said elongate body portion extending outwardly from said open proximal end of said barrel, a quantity of flush solution in said chamber, and anti-reflux means for controlling stopper deflection when said flush solution has been delivered from said chamber and said stopper is in contact with said distal wall;

(b) providing a catheter having a proximal end, a distal end a passageway therethrough and a housing having a hollow interior connected to said catheter and in fluid communication with said passageway, said housing having an access valve for allowing fluid communication with said hollow interior;

5 (c) placing said distal end of said catheter in a blood vessel;

(d) engaging said elongate tip of said barrel with said access valve so that said passageway of said syringe barrel is in fluid communication with said hollow interior of said housing;

10 (e) applying force to said plunger to move said plunger in a distal direction with respect to said barrel so that said flush solution in said chamber flows through said passageway into said hollow chamber of said housing and through said passageway of said catheter;

(f) continue applying force to the plunger until said stopper contacts and presses against said distal wall of said barrel; and

15 (g) disengaging said elongate tip from said access valve.

13. A method of flushing a catheter comprising the steps of:

(a) providing a syringe assembly having a barrel including a cylindrical sidewall including an inside surface defining a chamber for retaining fluid, an open proximal end and a distal end including a distal wall with an elongate tip extending distally therefrom having a passageway therethrough in fluid communication with said chamber, a plunger including an elongate body portion having a proximal end, a distal end, and a stopper slidably positioned in fluid-tight engagement with said inside surface of said barrel for drawing fluid into and driving fluid out of said chamber by movement of the stopper relative to said barrel, said elongate body portion extending outwardly from said open proximal end of said barrel, a quantity of flush solution in said chamber, a needle assembly including a cannula having a proximal end, a distal end and a lumen therethrough and a hub having an open proximal end containing a cavity and a distal end attached to said proximal end of said cannula so that said lumen is in fluid communication with said cavity, said needle assembly being attached to said tip of said

20
25
30

barrel so that said lumen is in fluid communication with said chamber, and anti-reflux means for controlling stopper deflection when said flush solution has been delivered from said chamber and said stopper is in contact with said distal wall;

5 (b) providing a catheter having a proximal end, a distal end and a passageway therethrough and a housing having a hollow interior connected to said catheter and in fluid communication with said passageway, said housing having a septum for allowing fluid communication with said hollow interior;

(c) placing said distal end of said catheter in a blood vessel;

10 (d) forcing said distal end of said cannula through said septum so that said lumen is in fluid communication with said hollow interior of said housing;

(e) applying force to said plunger to move said plunger in a distal direction with respect to said barrel so that said flush solution in said chamber flows through said passageway into said hollow chamber of said housing and through said passageway of said catheter;

15 (f) continue applying force to the plunger until said stopper contacts and presses against said distal wall of said barrel; and

(g) withdrawing said cannula from said septum.

FIG. 1

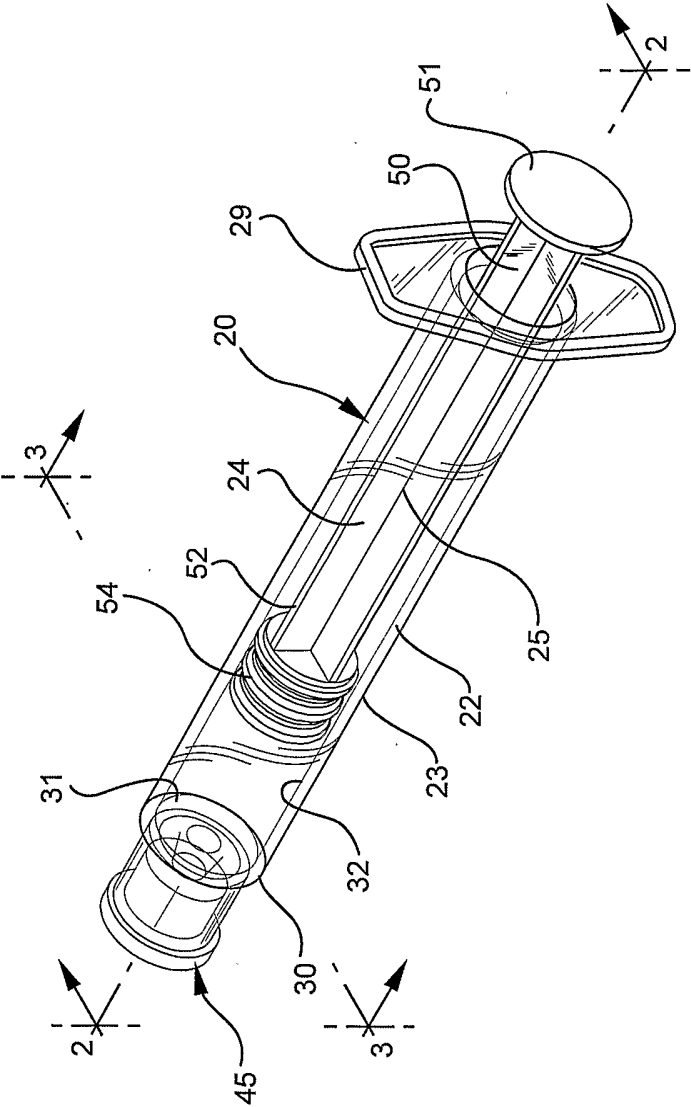

FIG. 2

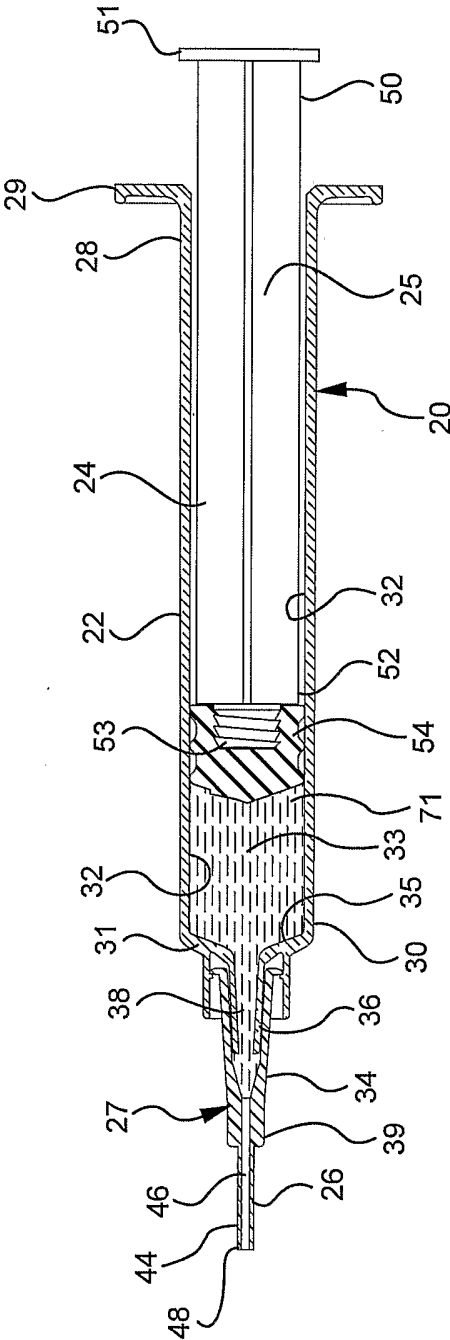

FIG. 3

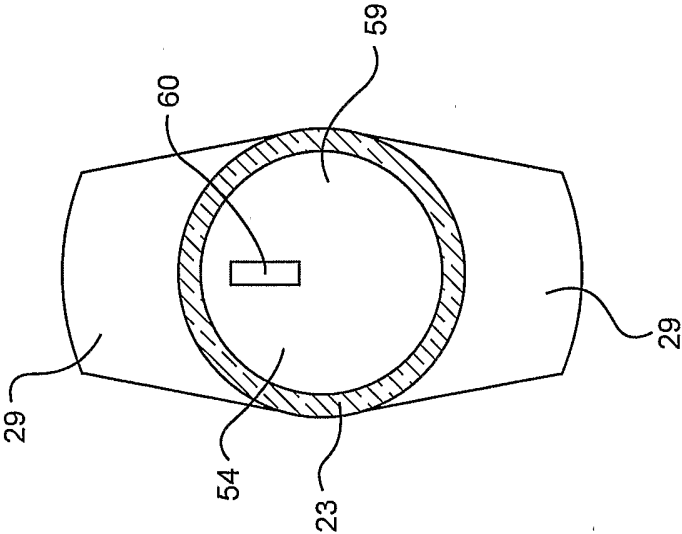

FIG. 4

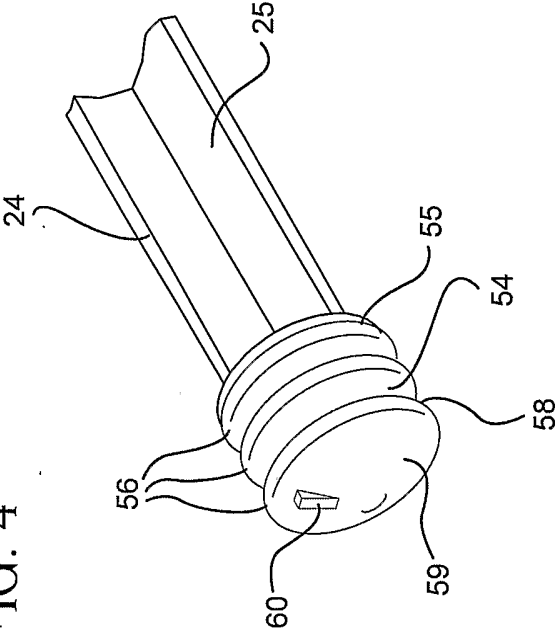

FIG. 5

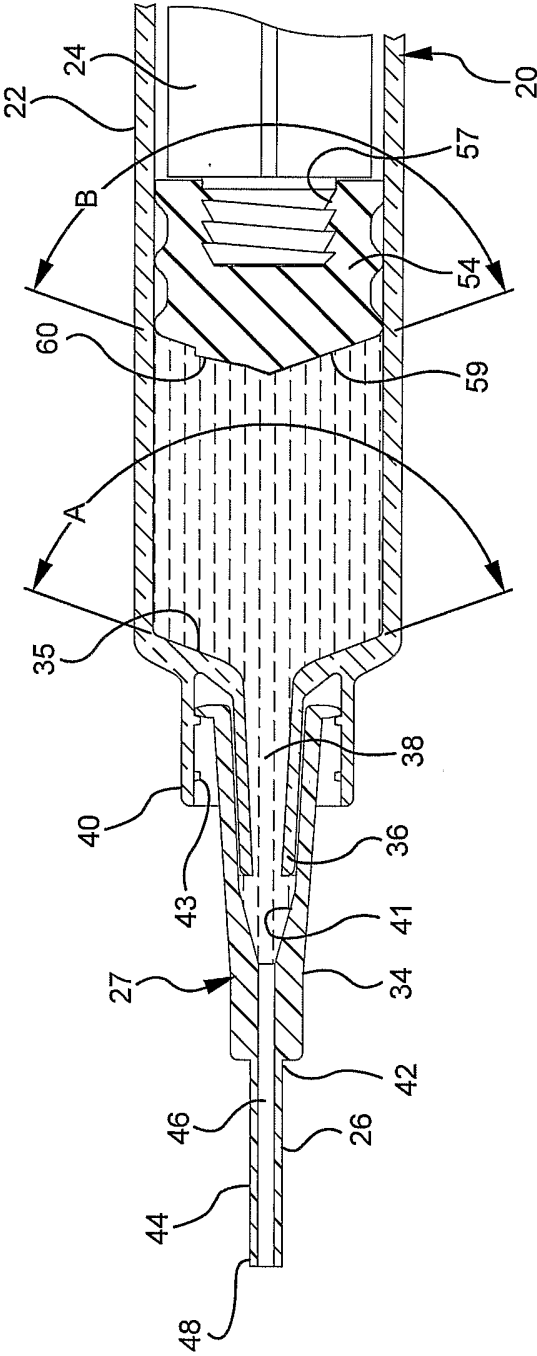

FIG. 6

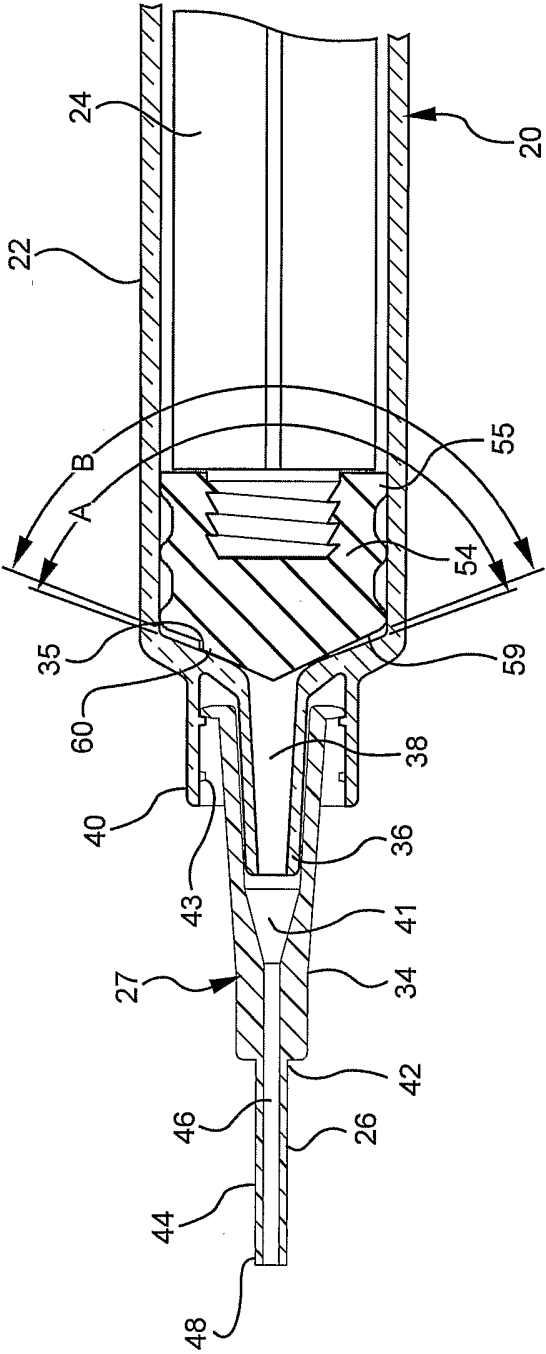

FIG. 7

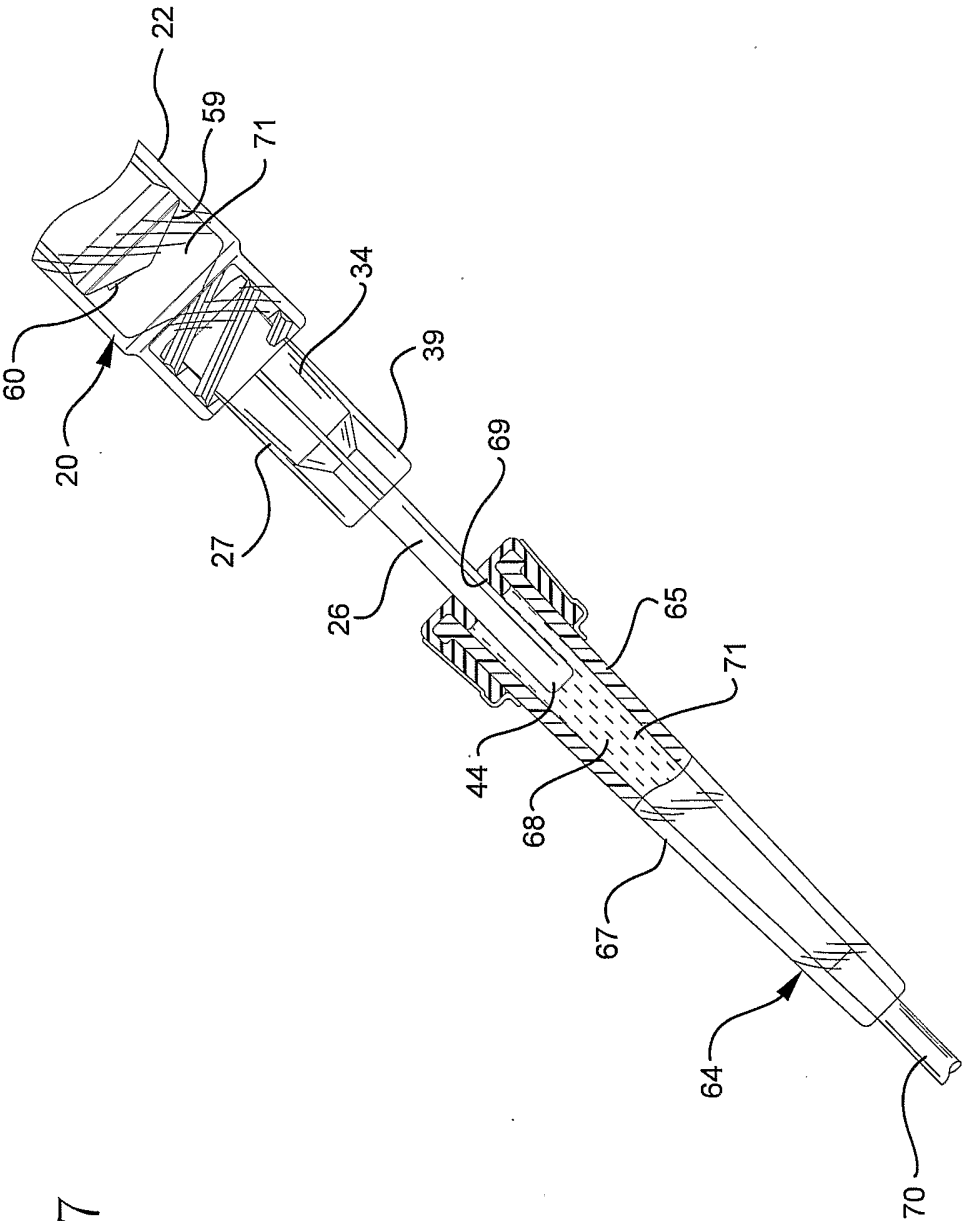

FIG. 8

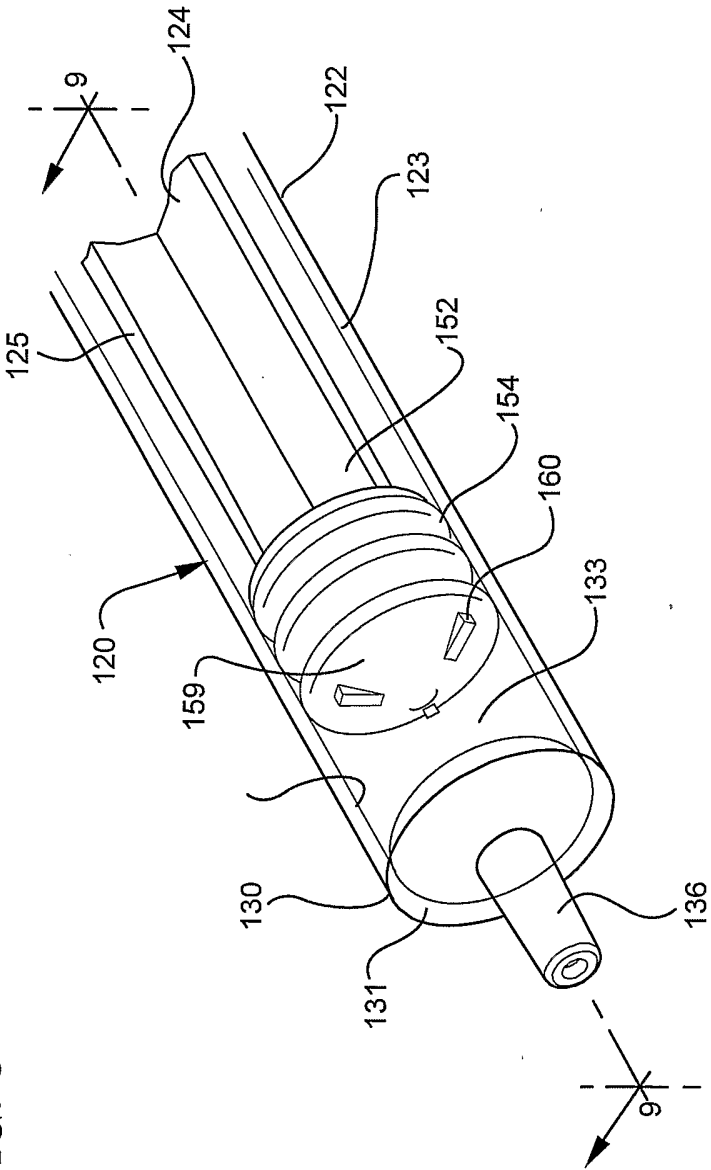
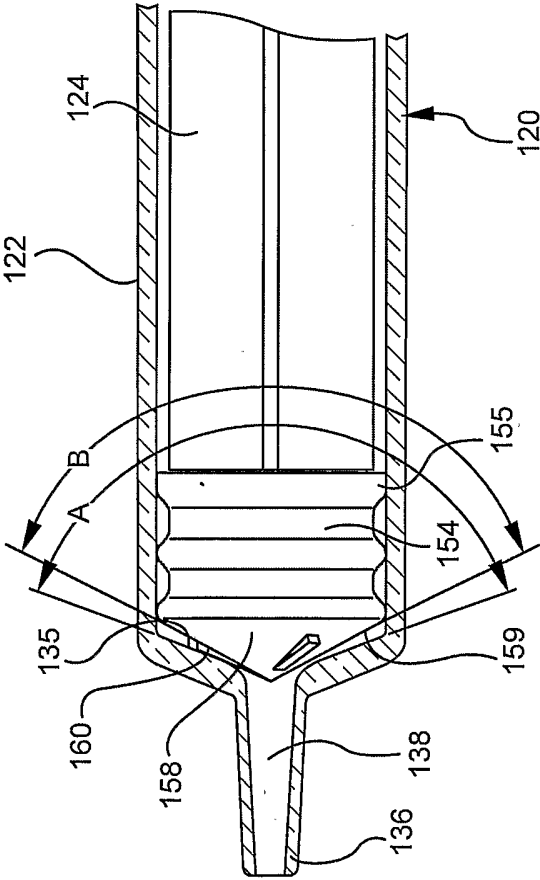

FIG. 9



INTERNATIONAL SEARCH REPORT

International Application No
PCT/US2004/028752

A. CLASSIFICATION OF SUBJECT MATTER

IPC 7 A61M5/315 A61M25/00

According to International Patent Classification (IPC) or to both national classification and IPC

B. FIELDS SEARCHED

Minimum documentation searched (classification system followed by classification symbols)

IPC 7 A61M

Documentation searched other than minimum documentation to the extent that such documents are included in the fields searched

Electronic data base consulted during the international search (name of data base and, where practical, search terms used)

EPO-Internal

C. DOCUMENTS CONSIDERED TO BE RELEVANT

Category *	Citation of document, with indication, where appropriate, of the relevant passages	Relevant to claim No.
X	US 5 795 337 A (GRIMARD JEAN PIERRE) 18 August 1998 (1998-08-18) column 3, line 12 - line 25 column 4, line 3 - line 15 column 4, line 50 - line 57 figure 6	1,9
A		2-5,10, 11
X	US 3 331 538 A (HIGGINS JOHN L) 18 July 1967 (1967-07-18) figure 1	1
A		2,11
A	WO 01/72356 A (ATRIX LAB INC) 4 October 2001 (2001-10-04) figure 13	1,11
	----- -/--	

☒ Further documents are listed in the continuation of box C.

☒ Patent family members are listed in annex.

* Special categories of cited documents:

"A" document defining the general state of the art which is not considered to be of particular relevance

"E" earlier document but published on or after the international filing date

"L" document which may throw doubts on priority claim(s) or which is cited to establish the publication date of another citation or other special reason (as specified)

"O" document referring to an oral disclosure, use, exhibition or other means

"P" document published prior to the international filing date but later than the priority date claimed

"T" later document published after the international filing date or priority date and not in conflict with the application but cited to understand the principle or theory underlying the invention

"X" document of particular relevance; the claimed invention cannot be considered novel or cannot be considered to involve an inventive step when the document is taken alone

"Y" document of particular relevance; the claimed invention cannot be considered to involve an inventive step when the document is combined with one or more other such documents, such combination being obvious to a person skilled in the art.

"&" document member of the same patent family

Date of the actual completion of the international search

18 January 2005

Date of mailing of the international search report

28/01/2005

Name and mailing address of the ISA

European Patent Office, P.B. 5818 Patentlaan 2
NL - 2280 HV Rijswijk
Tel. (+31-70) 340-2040, Tx. 31 651 epo nl,
Fax: (+31-70) 340-3016

Authorized officer

Sedy, R

INTERNATIONAL SEARCH REPORT

International Application No
PCT/US2004/028752

C.(Continuation) DOCUMENTS CONSIDERED TO BE RELEVANT

Category *	Citation of document, with indication, where appropriate, of the relevant passages	Relevant to claim No.
A	US 4 215 701 A (RAITTO RUSSELL G) 5 August 1980 (1980-08-05) figure 3 -----	1, 11

INTERNATIONAL SEARCH REPORT

International application No.
PCT/US2004/028752

Box II Observations where certain claims were found unsearchable (Continuation of item 2 of first sheet)

This International Search Report has not been established in respect of certain claims under Article 17(2)(a) for the following reasons:

1. ☒ Claims Nos.: 12, 13
because they relate to subject matter not required to be searched by this Authority, namely:
Rule 39.1(iv) PCT – Method for treatment of the human or animal body by surgery
2. ☐ Claims Nos.:
because they relate to parts of the International Application that do not comply with the prescribed requirements to such an extent that no meaningful International Search can be carried out, specifically:
3. ☐ Claims Nos.:
because they are dependent claims and are not drafted in accordance with the second and third sentences of Rule 6.4(a).

Box III Observations where unity of invention is lacking (Continuation of item 3 of first sheet)

This International Searching Authority found multiple inventions in this international application, as follows:

1. ☐ As all required additional search fees were timely paid by the applicant, this International Search Report covers all searchable claims.
2. ☐ As all searchable claims could be searched without effort justifying an additional fee, this Authority did not invite payment of any additional fee.
3. ☐ As only some of the required additional search fees were timely paid by the applicant, this International Search Report covers only those claims for which fees were paid, specifically claims Nos.:
4. ☐ No required additional search fees were timely paid by the applicant. Consequently, this International Search Report is restricted to the invention first mentioned in the claims; it is covered by claims Nos.:

Remark on Protest

- ☐ The additional search fees were accompanied by the applicant's protest.
- ☐ No protest accompanied the payment of additional search fees.

INTERNATIONAL SEARCH REPORT

Information on patent family members

International Application No

PCT/US2004/028752

Patent document cited in search report		Publication date	Patent family member(s)	Publication date
US 5795337	A	18-08-1998	NONE	
US 3331538	A	18-07-1967	NONE	
WO 0172356	A	04-10-2001	US 6626870 B1 AU 4949701 A CA 2404194 A1 EP 1267965 A2 JP 2003527935 T WO 0172356 A2	30-09-2003 08-10-2001 04-10-2001 02-01-2003 24-09-2003 04-10-2001
US 4215701	A	05-08-1980	CA 1131530 A1	14-09-1982