



US00D810052S

(12) **United States Design Patent**  
**Glezerman**

(10) **Patent No.:** **US D810,052 S**

(45) **Date of Patent:** **\*\* Feb. 13, 2018**

(54) **COMMUNICATION DEVICE**

(74) *Attorney, Agent, or Firm* — Andrew W. Chu; Craft Chu PLLC

(71) Applicant: **CARDO SYSTEMS, Inc.**, Pittsburgh, PA (US)

(72) Inventor: **Abraham Glezerman**, Tel Aviv (IL)

(57) **CLAIM**

(73) Assignee: **CARDO SYSTEMS, Inc.**, Pittsburgh, PA (US)

The ornamental design for a communication device, as shown and described.

(\*\*) Term: **15 Years**

(21) Appl. No.: **29/580,086**

**DESCRIPTION**

(22) Filed: **Oct. 5, 2016**

(51) **LOC (11) Cl.** ..... **14-01**

(52) **U.S. Cl.**

USPC ..... **D14/223**; D14/206

(58) **Field of Classification Search**

USPC ..... D14/223, 206, 205, 188, 192, 137, 138, D14/168, 191, 431; D13/108; 181/129, 181/130, 135; 379/430, 431; 381/380, 381/381, 375, 376, 382; 455/90.2, 575.1, 455/550.1

CPC ..... H04R 1/10; H04R 25/00; H04R 5/033; H04R 5/0335; H05K 5/03

See application file for complete search history.

FIG. 1 is an upper perspective view of the communication device showing my design in an assembled configuration with a headset component attached to a cradle component and with markings and attachments in broken lines;

FIG. 2 is a side elevation view thereof with markings and attachments in broken lines;

FIG. 3 is an opposite side elevation view with markings and attachments in broken lines;

FIG. 4 is a top plan view thereof with markings and attachments in broken lines;

FIG. 5 is a bottom plan view thereof with markings and attachments in broken lines;

FIG. 6 is an end elevation view thereof with attachments in broken lines;

FIG. 7 is an opposite end elevation view thereof with attachments in broken lines;

FIG. 8 is another perspective view thereof, showing my design in a disassembled configuration with the headset component separated from the cradle component with markings and attachments in broken lines; and,

FIG. 9 is still another perspective view thereof, showing my design in the disassembled configuration from another side with attachments in broken lines.

The communication device is a receiver and transmitter for attachment to a motorcycle helmet. The markings and attachments in broken lines represent environment and form no part of the claimed design.

(56) **References Cited**

**U.S. PATENT DOCUMENTS**

2,883,523	A *	4/1959	Meserow	.....	H04B 5/00 200/61.47
3,549,831	A *	12/1970	Forney	.....	H04M 1/05 2/8.1
3,763,434	A *	10/1973	Blesch	.....	H04B 1/3883 455/349
3,956,701	A *	5/1976	James, Jr.	.....	G08B 3/1058 224/197
4,083,481	A *	4/1978	Selinko	.....	A45F 5/02 224/269
4,397,513	A *	8/1983	Clark	.....	H01R 23/68 365/1

(Continued)

*Primary Examiner* — Paula Allen Greene

**1 Claim, 4 Drawing Sheets**

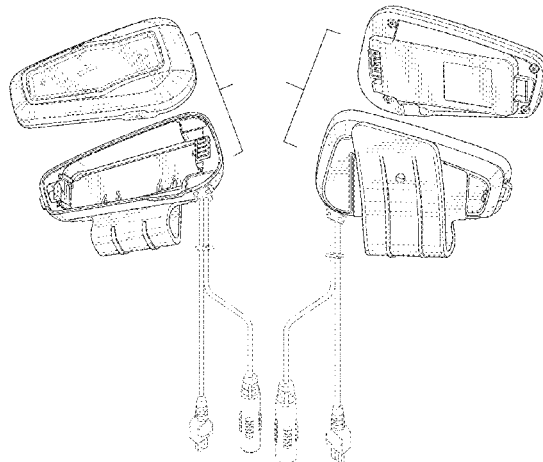

**US D810,052 S**

(56)

**References Cited**

U.S. PATENT DOCUMENTS

4,484,029	A *	11/1984	Kenney	.....	H04M 1/05 379/430
5,052,943	A *	10/1991	Davis	.....	G06F 1/1632 320/115
5,081,709	A *	1/1992	Benyo	.....	A45F 5/02 224/669
5,155,659	A *	10/1992	Kunert	.....	G06F 3/0238 220/375
5,189,358	A *	2/1993	Tomura	.....	B60R 11/0241 320/115
5,212,722	A *	5/1993	Murata	.....	H04M 1/6075 379/390.01
5,313,663	A *	5/1994	Norris	.....	H04B 1/086 455/347
5,356,060	A *	10/1994	Kuroda	.....	A45F 5/02 224/269
D352,706	S *	11/1994	Hong	.....	D14/137
5,414,596	A *	5/1995	Eaton	.....	H01M 2/1005 361/814
5,517,683	A *	5/1996	Collett	.....	H04B 1/3827 379/450
5,666,274	A *	9/1997	Corso	.....	H04M 1/0252 361/725
6,122,369	A *	9/2000	Hwang	.....	H04M 1/6058 379/420.03
D445,416	S	7/2001	Glezerman		
D456,384	S *	4/2002	Ng	.....	D14/192
D475,994	S *	6/2003	Schmidt	.....	D14/223
D479,222	S *	9/2003	Lu	.....	D14/192
D498,743	S *	11/2004	Robinson	.....	D14/188
6,898,448	B2 *	5/2005	Liao	.....	H04M 1/05 381/151
6,904,147	B2 *	6/2005	Lenz	.....	H04M 1/05 379/430
6,922,473	B2 *	7/2005	Turnbull	.....	H04M 1/05 381/110
D517,052	S *	3/2006	Skulley	.....	D14/223
D539,777	S *	4/2007	Pena Angarita	.....	D14/138 R
D558,742	S *	1/2008	Koller	.....	D14/225
D567,216	S *	4/2008	Densho	.....	D14/205
D575,771	S *	8/2008	Tolve	.....	D14/192
7,461,936	B2 *	12/2008	Jannard	.....	G02C 3/003 351/158
D584,293	S *	1/2009	Kim	.....	D14/223
D597,072	S *	7/2009	Asai	.....	D14/206
D602,002	S *	10/2009	Asai	.....	D14/206
D602,919	S *	10/2009	Bodley	.....	D14/225
D605,168	S *	12/2009	Jaakkola	.....	D14/205
D607,440	S *	1/2010	Yamakawa	.....	D14/206
D630,620	S *	1/2011	Lee	.....	D14/223
D635,962	S *	4/2011	Kelley	.....	D14/206
D646,280	S *	10/2011	Yano	.....	D14/188
D659,118	S *	5/2012	Watters	.....	D14/206
D661,281	S *	6/2012	Mahaffy	.....	D14/206
D663,715	S	7/2012	Glezerman		
8,706,043	B2	4/2014	Glezerman		
D725,626	S *	3/2015	Kalhok	.....	D14/205
D736,177	S *	8/2015	Winters	.....	D14/192
D737,796	S *	9/2015	Liu	.....	D14/205
D743,947	S *	11/2015	Yoshimura	.....	D14/223
D756,974	S	5/2016	Glezerman		
D757,683	S	5/2016	Glezerman		

\* cited by examiner

FIG. 1

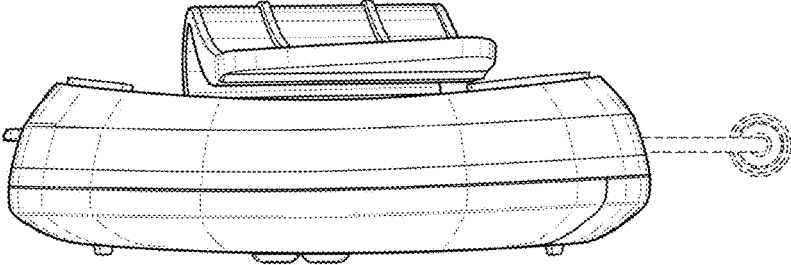
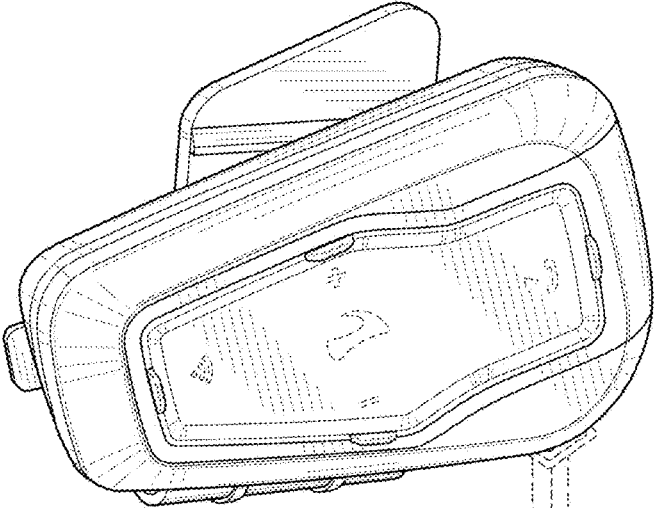

FIG. 2

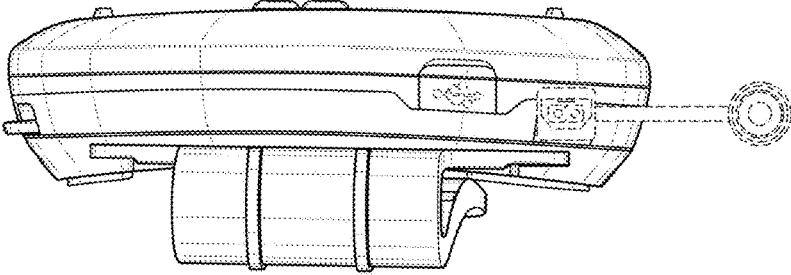

FIG. 3

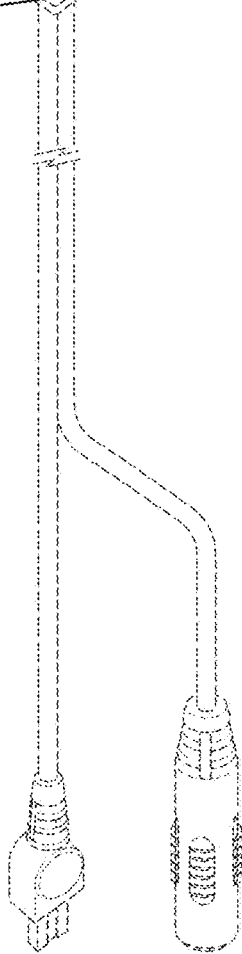

FIG. 4

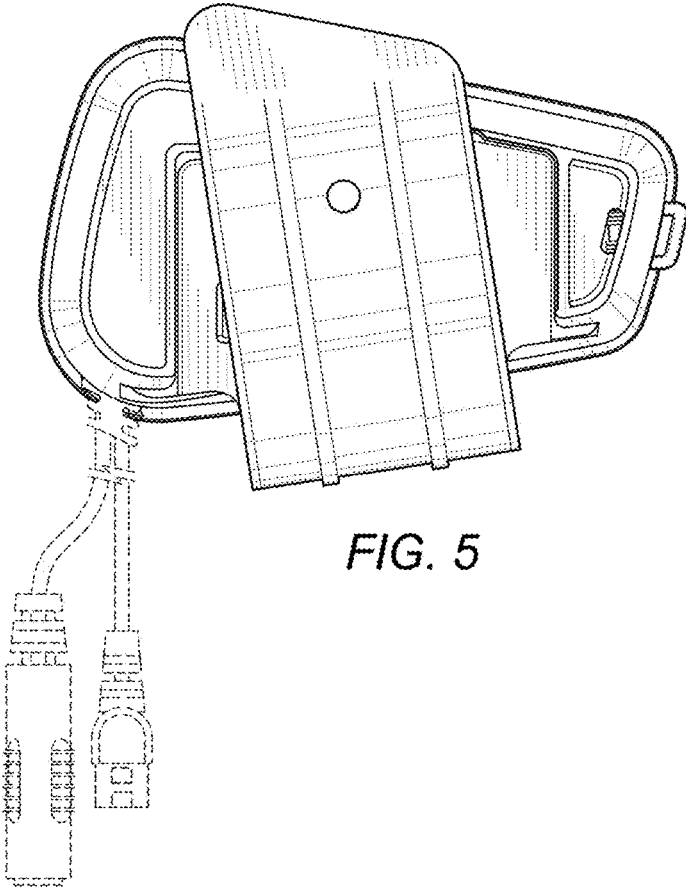
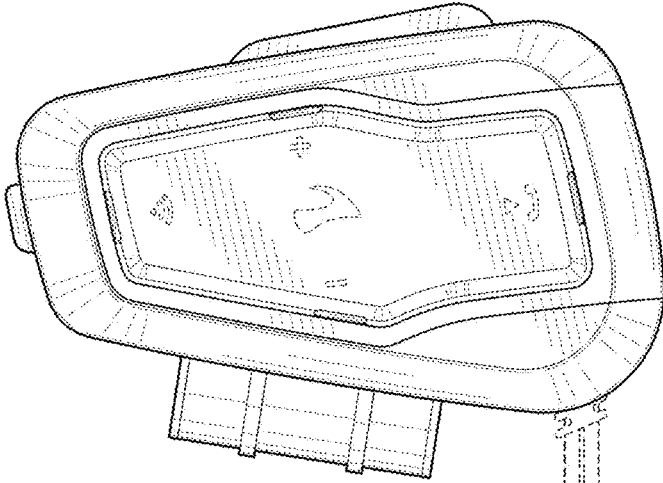

FIG. 5

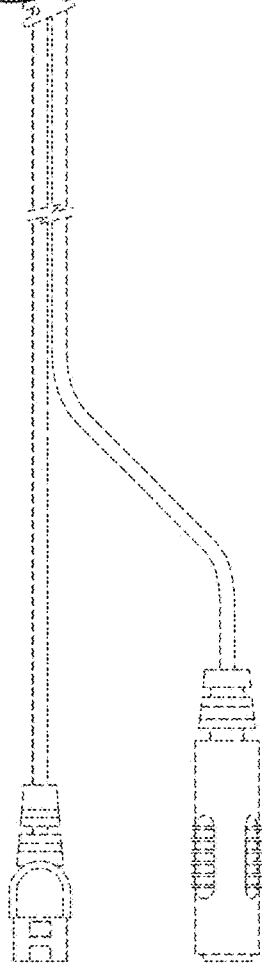
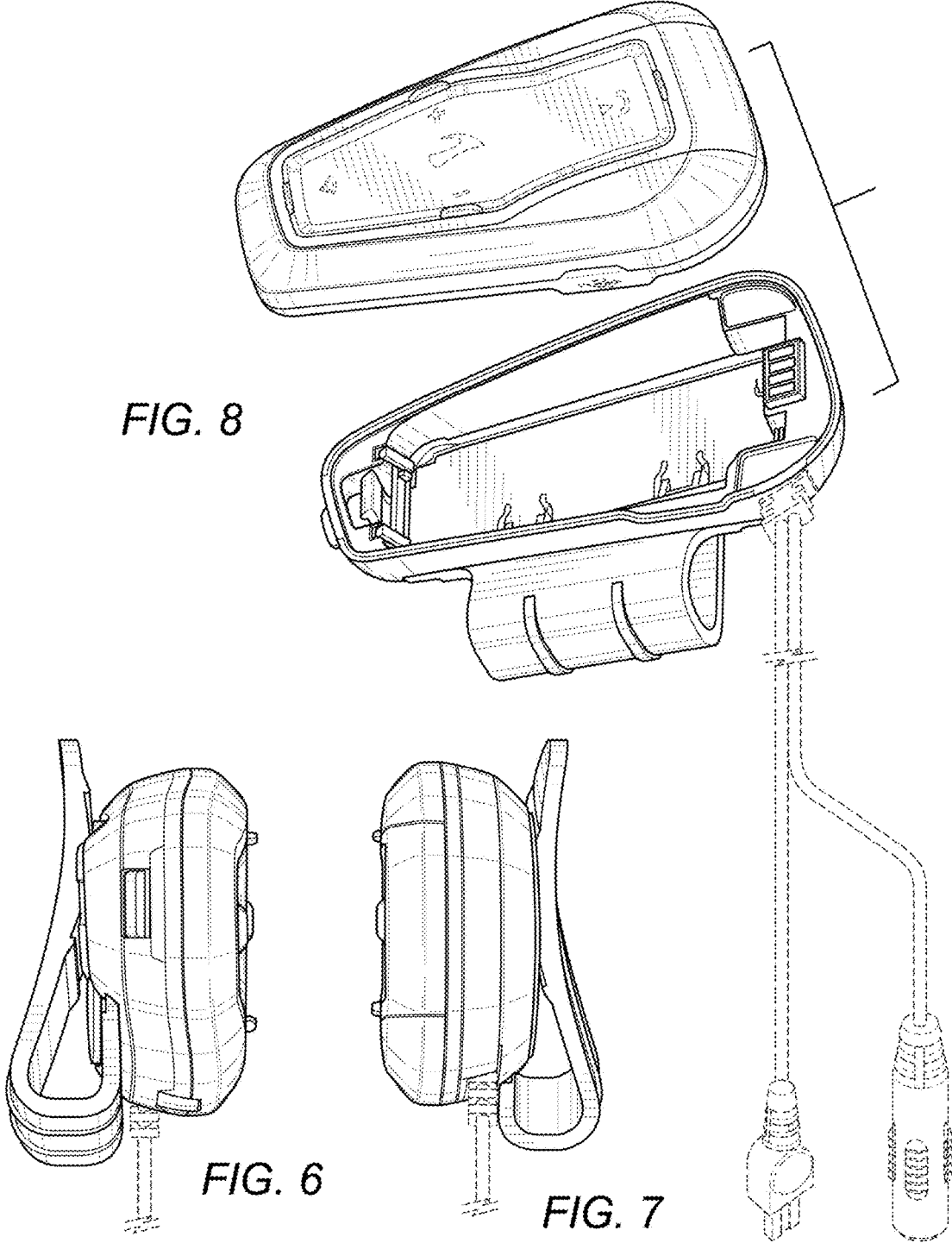

FIG. 8



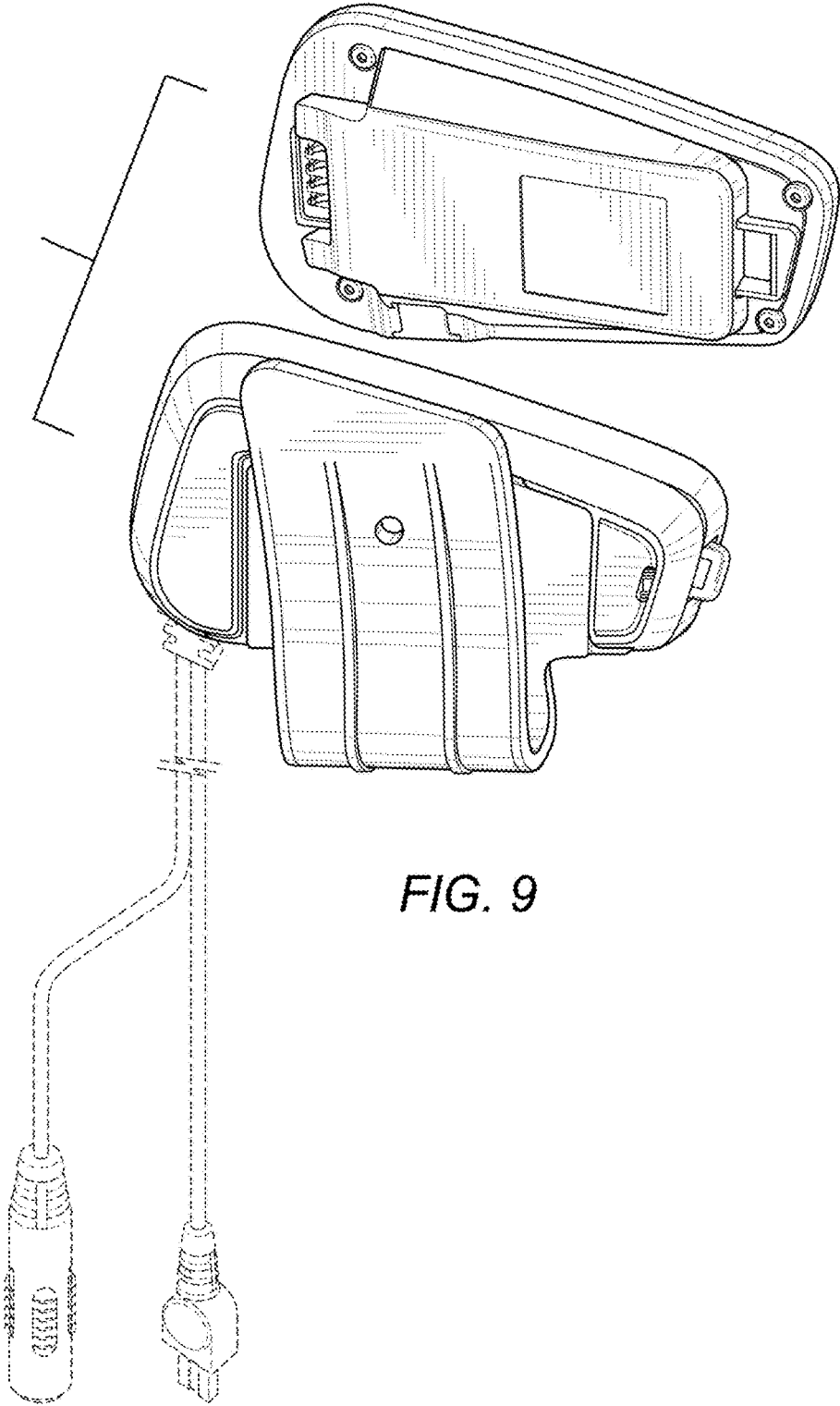

FIG. 9