



INTERNATIONAL APPLICATION PUBLISHED UNDER THE PATENT COOPERATION TREATY (PCT)

<p>(51) International Patent Classification <sup>6</sup> : <b>A61B 17/56</b></p>	<p><b>A1</b></p>	<p>(11) International Publication Number: <b>WO 98/04202</b> (43) International Publication Date: 5 February 1998 (05.02.98)</p>
<p>(21) International Application Number: PCT/US97/12956 (22) International Filing Date: 31 July 1997 (31.07.97) (30) Priority Data: 08/688,758 31 July 1996 (31.07.96) US (71)(72) Applicant and Inventor: MICHELSON, Gary, K. [US/US]; 438 Sherman Canal, Venice, CA 90291 (US). (74) Agent: SCHELLIN, Eric, P.; Suite 704, 2121 Crystal Drive, Arlington, VA 22202 (US).</p>	<p>(81) Designated States: AL, AM, AT, AU, AZ, BA, BB, BG, BR, BY, CA, CH, CN, CU, CZ, DE, DK, EE, ES, FI, GB, GE, GH, HU, IL, IS, JP, KE, KG, KP, KR, KZ, LC, LK, LR, LS, LT, LU, LV, MD, MG, MK, MN, MW, MX, NO, NZ, PL, PT, RO, RU, SD, SE, SG, SI, SK, SL, TJ, TM, TR, TT, UA, UG, UZ, VN, YU, ZW, ARIPO patent (GH, KE, LS, MW, SD, SZ, UG, ZW), Eurasian patent (AM, AZ, BY, KG, KZ, MD, RU, TJ, TM), European patent (AT, BE, CH, DE, DK, ES, FI, FR, GB, GR, IE, IT, LU, MC, NL, PT, SE), OAPI patent (BF, BJ, CF, CG, CI, CM, GA, GN, ML, MR, NE, SN, TD, TG).</p> <p><b>Published</b> <i>With international search report.</i></p>	

(54) Title: MILLING INSTRUMENTATION AND METHOD FOR PREPARING A SPACE BETWEEN ADJACENT VERTEBRAL BODIES

(57) Abstract

An apparatus and method for placing adjacent vertebrae at a fixed distance and angular relationship relative to each other, fixing the vertebrae in the position by use of a milling block (100) engaging each of the adjacent vertebrae, and then using a milling instrument (200), the depth, length and excursion of which from side to side are controlled by the apparatus to machine out a defined thickness of bone and a space of defined length, height, width and shape in preparation for receiving an inter-body spinal implant of graft or known size and configuration, are disclosed.

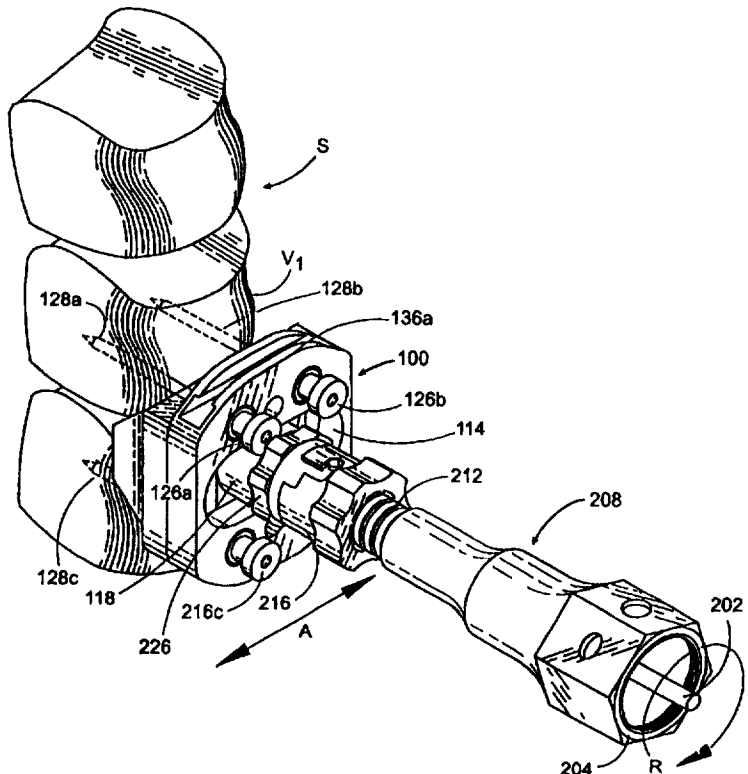

**FOR THE PURPOSES OF INFORMATION ONLY**

Codes used to identify States party to the PCT on the front pages of pamphlets publishing international applications under the PCT.

AL	Albania	ES	Spain	LS	Lesotho	SI	Slovenia
AM	Armenia	FI	Finland	LT	Lithuania	SK	Slovakia
AT	Austria	FR	France	LU	Luxembourg	SN	Senegal
AU	Australia	GA	Gabon	LV	Latvia	SZ	Swaziland
AZ	Azerbaijan	GB	United Kingdom	MC	Monaco	TD	Chad
BA	Bosnia and Herzegovina	GE	Georgia	MD	Republic of Moldova	TG	Togo
BB	Barbados	GH	Ghana	MG	Madagascar	TJ	Tajikistan
BE	Belgium	GN	Guinea	MK	The former Yugoslav Republic of Macedonia	TM	Turkmenistan
BF	Burkina Faso	GR	Greece			TR	Turkey
BG	Bulgaria	HU	Hungary	ML	Mali	TT	Trinidad and Tobago
BJ	Benin	IE	Ireland	MN	Mongolia	UA	Ukraine
BR	Brazil	IL	Israel	MR	Mauritania	UG	Uganda
BY	Belarus	IS	Iceland	MW	Malawi	US	United States of America
CA	Canada	IT	Italy	MX	Mexico	UZ	Uzbekistan
CF	Central African Republic	JP	Japan	NE	Niger	VN	Viet Nam
CG	Congo	KE	Kenya	NL	Netherlands	YU	Yugoslavia
CH	Switzerland	KG	Kyrgyzstan	NO	Norway	ZW	Zimbabwe
CI	Côte d'Ivoire	KP	Democratic People's Republic of Korea	NZ	New Zealand		
CM	Cameroon			PL	Poland		
CN	China	KR	Republic of Korea	PT	Portugal		
CU	Cuba	KZ	Kazakstan	RO	Romania		
CZ	Czech Republic	LC	Saint Lucia	RU	Russian Federation		
DE	Germany	LI	Liechtenstein	SD	Sudan		
DK	Denmark	LK	Sri Lanka	SE	Sweden		
EE	Estonia	LR	Liberia	SG	Singapore		

MILLING INSTRUMENTATION AND METHOD FOR PREPARING  
A SPACE BETWEEN ADJACENT VERTEBRAL BODIES

BACKGROUND OF THE INVENTION

Spinal fusion is defined as the joining together of two or more adjacent vertebrae through a bridge of bone for the purpose of eliminating motion between those vertebrae. One specific type of spinal fusion is known to those skilled in the art as interbody fusion and consists of fusing the adjacent vertebrae through the disc space (the space previously occupied by the spinal disc interposed between the adjacent vertebral bodies). When such a procedure is performed from the anterior aspect of the spine (from the front) that procedure is known as anterior interbody fusion.

Typically, bone grafts are placed into the disc space to position the vertebrae apart so as to create more space for the nerves, to restore the angular relationship between said adjacent vertebrae to be fused, and to provide for material that can participate in and promote the fusion process. Substrates, other than bone, such as hydroxyapatite and/or artificial spinal fusion implants may also be used.

In general the ability to achieve bone fusion appears to be related to certain metabolic biochemical factors, the quality and quantity of the osteogenic material present (bone forming material, most commonly bone itself), the surface area available for the fusion to occur over, and the stability of the construct being fused (the ability to resist unwanted motion at the fusion site).

Consistent with the foregoing, it is desirable

for the surgeon to place the largest fusion implant, generally bone, within the disc space as this provides for both the greatest surface area, and fusion mass. Furthermore, the greater the area of contact, the greater the stability of the bone-graft construct, such that the graft is less likely to migrate, to itself collapse, or conversely to penetrate into the adjacent vertebrae as the forces across the fusion site are distributed over a greater area.

The disc space can best be described as having a biological rather than a geometric shape in that the adjacent vertebral endplate surfaces are complexly biconcave in portions, convex in others, while in still other areas extremely dense portions of bone project like "pillars" almost perpendicularly from the plane of the vertebral endplates, thereby forming partial, but substantial, side walls about the posterolateral (toward the back and side) portions of the disc space, the latter being particularly pronounced in the cervical spine.

As the bone graft used for the purpose of interbody fusion must have sufficient structural integrity to support the superincumbent body weight and the forces present across the portion of the body in which the graft is inserted, generally only quite solid portions of bone can be used for this purpose. Such portions of bone can only be cut, such as with a saw, rather than molded to fit the disc space. Even for the most skilled surgeon, it is not possible to shape such grafts to precisely fit the complex contours of the vertebral endplates adjacent the disc space. Therefore, the bone grafts are generally considerably smaller in width and depth than the disc space

itself so as to confine such grafts to the more relatively flat area located about the mid portion of the vertebral endplates. The term "relatively flat" is a correct description of the mid portion of the endplate in that even this region of the vertebral endplate is not truly flat, such that it is relatively rare to achieve full congruency between the machined surface of the bone graft and the biologically determined shape of the vertebral endplate. This further compromises the quality of the fusion construct in that the area of contact between the vertebrae and the graft is suboptimal with a loss of both support area and correspondingly, graft and construct stability.

Further factors tending to limit the dimensions of the graft to less than that of the disc space include, for example in the cervical spine, the danger of the graft accidentally escaping the disc space laterally (to the side), damaging the vertebral arteries and causing a cerebral infarct and the danger of penetrating posteriorly (toward the back) and injuring the spinal cord causing paralysis. Furthermore, the previously described pillars of dense bone projecting from the overall plane of the vertebral endplates in the posterolateral portions of the disc space and commonly known as either uncinata processes or the joints of Luschka, tend to block the lateral and posterior placement of the graft(s) and tend to confine and limit the placement of the graft(s) to the anterior and central portions of the disc space.

To achieve fusion, it is necessary to at least vigorously scrape the outermost layer of the vertebral endplates until bleeding occurs to encourage the fusion, which invokes a healing process of the bone. Since the

vertebral endplates are generally quite strong, it is desirable to preserve this structure even while scraping into it which can not reliably be achieved by the means of the prior art. In the past, anterior interbody fusion would be performed by removing at least a portion of the intervertebral disc and then utilizing hand held, free-hand instruments including, but not limited to, osteotomes, chisels, curettes, rongeurs, and burrs to scrape and shape the vertebral endplates and vertebral bone stock, which operations would be performed generally by working on one vertebra at a time, and independent of the position of the adjacent vertebra.

As a final consideration, not only are the vertebral endplates complexly shaped, but so are the interposed discs themselves. That is, the vertebrae of the spine are generally aligned in curved, rather than straight patterns when viewed from the side. When such curves are convex forward, as they are in the cervical and lumbar spine, the vertebrae are said to be in lordosis. Such lordosis may be the result of wedging of the vertebral bodies, of the discs, or a combination of both. When lordosis is the result of a generally wedge shaped disc, it has generally proven difficult to reliably restore that overall wedged shape to the disc space itself for the purpose of fusing the adjacent vertebrae with precisely the correct amount of lordosis.

While the discussion above has been in regard to anterior interbody fusion, it may be desirable to replace a damaged or diseased disc with a flexible member, or mechanical "artificial disc", in which situation maximizing the surface area and congruency of contact, and controlling

the angular and spatial relationships of the vertebrae adjacent that disc space would still be of great importance. As to be discussed, the present invention pertains to a means and method for the preparation of the space between adjacent vertebral bodies ("the disc space") suitable for the implantation of an artificial disc or for interbody spinal fusions.

Attempts have been made in the past to create a guided milling apparatus for use in surgery of such appendicular joints as that of the knee. For example, U.S. Patent No. 5,486,180 issued to Dietz on January 23, 1996 teaches the use of a guided milling apparatus. The Dietz apparatus is not capable of working in the spine to prepare a space between adjacent vertebral bodies and differs from the present invention in the following ways:

1) The Dietz apparatus requires that the bone be exposed end on (Col. 1, lines 34-36, Col. 2, lines 46-47, Figs. 1,2, and 3). In the present invention, the "ends" of the vertebrae to be prepared are the vertebral endplates which can not be exposed on end except by dislocating the vertebrae which would cause the most grievous harm to the patient.

2) The Dietz apparatus is for the preparation of a single bone at a time (Col. 1, lines 34-36, Col. 1, lines 49-50; Figs. 1,2,3,5,7).

3) The milling end of the Dietz apparatus removes the bone parallel to the template surface (Col. 4, lines 7-9, Col. 4, lines 50-53, Figs 5 and 7). In the spine, there is insufficient space available within the disc space interposed between adjacent vertebrae to insert, accommodate or operate the Dietz mechanism; this would be

true regardless of actual size of the Dietz device for any size that would remain workable for use in the spine.

4) The Dietz apparatus is incapable of affixing the opposed bones on both sides of the joint simultaneously, or of preparing both joint surfaces with the opposed bones in fixed relationship with each other.

5) The Dietz apparatus teaches a means for cutting across two dimensions while controlling (fixing) for depth. (Figs 5,27).

6) Dietz teaches that the mill end is too large to pass through the template guide surface so as to confine the mill end beneath the guide means. (Col. 3, lines 8-19, Col. 4, lines 24-53; Figs. 5 and 7). This thus requires that the enlarged burr portion enters the bone not through its end or face, but rather on the front surface of the bone, which entrance occurs through a cut out slot, is deep to the guide plate, and with the burr spinning about an axis parallel to the longitudinal axis of the bone itself. (Col. 2 Line, 35-37, Figs. 1 and 2).

7) The Dietz apparatus is limited to the cutting by use of a burr along a nonlinear path. (Col. 2, lines 65; Col. 3, lines 4-6; Col. 4, line 2, Figs. 4 and 6). This is not arbitrary as the path of the burr is guided by either or both of a pivot, allowing only for a series of arcs, and/or a branched and serpentine slot system also configured to produce only a series of arcs. (Col. 2, lines 41-42, line 52, line 65 through Col. 3, line 4, and Figs. 1, 2, 4 and 26).

There is therefore a need for a method and means for preparing the vertebral bodies and the vertebral endplates adjacent to a disc space to be fused by interbody



fusion that:

1) allows for the safe preparation of the disc space to the optimal depth and width so as to allow for the correct use of the largest possible fusion implant which would be associated with the direct benefits of providing for the maximum mass of osteogenic material, the largest possible surface area for fusion to occur over, increased graft and construct stability secondary to the increased area of contact, and the greatest protection against implant collapse or penetration into the vertebral bodies from the distribution of the loads over the greatest surface area;

2) allows for the preparation of the vertebral endplates to a known and uniform surface configuration, which configuration can be matched by a corresponding surface of the fusion implant thereby providing for the greatest possible interface congruity between the vertebral endplates and fusion implant, and providing for the optimal contact surface, enhanced fusion area, enhanced graft and construct stability, and decreased load per surface area;

3) allows for the restoration of the correct vertebral alignment by preparing the vertebral endplates in fixed relationship to each other adjacent the disc space so as to three dimensionally shape the disc space-fusion implant site;

4) allows for an efficient and reliable means for scraping the central portions of the outer layer of the vertebral endplates without the danger of removing those structures entirely; and

5) allows for the extension of the fusion area into the extremely supportive and extremely dense bone of

the posterior lateral regions of the disc space.

#### SUMMARY OF THE INVENTION

The present invention is directed to an apparatus and method for use in spinal surgery for creating a space of selected shape and dimensions across the disc space between two adjacent vertebrae of the spine. The present invention comprises an integrated system of instrumentation and a surgical method that is capable of placing the adjacent vertebrae to be operated upon in proper angular relationship to each other, of locking the vertebrae in that position, of simultaneously preparing both vertebral endplates for the procedure, be it fusion or disc replacement, and specifically the creation of a space of a known shape and dimensions. The foregoing is achieved by the use of a power milling apparatus such that all free hand motions are eliminated and the site size, shape, and configuration, as well as the extent of vertebral endplate resection are made predictable, precise and reproducible. The instrumentation of the present invention allows for the safe controlled and protected preparation of the disc space to the optimal depth and width. The present invention allows for implant(s) or bone grafts to be placed onto the area of dense bone at the posterior lateral aspects of the disc space. The present invention allows for the maximum stability of the graft/implant, as well as the construct, by providing for the greatest possible interface surface area and congruency between the graft/implant and each of the adjacent vertebrae.

The present invention further provides for increased stability by creating butted corners, posterolaterally, into which the graft/implant may be

fitted which corners prevent further movement of the graft/implant either posteriorly or to either side of the created space. The present invention is capable of the uniform preparation (scraping) of the central portion of the vertebral endplate otherwise leaving that structure intact, if so desired. The present invention makes possible the preparation of the disc space to be prepared in anatomical angular conformation, and the disc space can be formed so as to correspond to the known shape of the graft/implant to be utilized.

In one embodiment, the apparatus of the present invention comprises a milling block having a front face configured for placement against a segment of the spine and having at least one aperture for accessing each of the two vertebral endplates of the vertebral adjacent the disc space. The adjacent vertebrae are placed in the appropriate spatial relationship to each other with a distractor means. Instrumentation is disclosed for selecting and calibrating the maximum safe penetration depth of the distractor means into the disc space and for locking the selected depth to prevent unwanted over penetration into the disc space. The distractor means may be part of the milling block or may be a separate member that is coupled to the milling block either directly or by a distractor holder.

Associated with the milling block is a bone removal means for removing a portion of bone from each of the vertebral endplates adjacent the disc space. The bone removal means is capable of accessing the vertebral endplates through the aperture in the milling block. The milling block is held firmly against a segment of the spine

by securing means, such as prongs, pins, screws and the like, or by the distractor means itself inserted into the disc space in contact with the endplates of the adjacent vertebrae. Instrumentation is disclosed for selecting, calibrating and limiting the penetration depth of the bone removal means into the disc space and/or vertebrae and to prevent unwanted over penetration into the disc space and/or vertebrae. The bone removal means may be guided with an instrument guiding means located in the aperture of the milling block and in slideable relation to the milling block permitting slideable transverse motion and/or vertical motion during operation of the bone removal means to remove a portion of bone from the vertebral endplates adjacent to the disc space.

The following is a brief outline of the steps of the surgical method of the present invention describing the use of the specific instrumentation in regard to the preferred embodiment:

1. The area of the spine to be fused is exposed and a partial disectomy is performed, whereby a portion and preferably a large portion of the disc is removed while preserving the annulus fibrosis portion of the disc along at least both sides of the disc space.

2. The interspace so created is distracted and while not requisite, preferably to its optimal height, which height is determined by the known normal spatial relationships for that area the adjacent soft tissue structures. The interspace is then measured

for height, depth, and width. The width of the interspace may be determined in reference to the inferior portion of the vertebral endplate of the superior vertebrae, and this determines the selection of the appropriate width

for the milling block. The measured depth of the interspace, that is the distance between the front and back of vertebrae, will determine the selection of a distractor and milling means of slightly lesser depth.

The height and depth of the interspace will determine the selection of the appropriate height and length of the distractor element, the shape of which is determined by both the need to either maintain or restore lordosis, as well as the shape of the implant which may or may not be wedged.

3. The correct distractor element is selected, having either a known fixed length, or preferably is adjustable and its optimal fixed length adjusted using a calibration gauge, integral markings or similar means.

4. The distractor apparatus is then attached to the milling block which has already been selected for the correct width.

5. The combined distractor apparatus and milling block assembly is then brought to

the fusion site and the distractor element is introduced into the disc space. The distractor element may be introduced into the disc space turned on its side so as to facilitate introduction and then turned 90 degrees to distract the space or the distractor element may be introduced perpendicular to the plane of the disc space relying on its bullet-shaped leading edge portion to distract the vertebrae apart. The angular relationship of the two vertebral bodies adjacent that disc space will then be determined by the shape of the distractor element. It is appreciated that while not preferred, a distractor could be inserted into the disc space first, then the milling block assembly is brought into place relative to the spine thereafter.

6. The milling block is then secured to the anterior aspect of the spine preferably, by engaging each of the adjacent vertebrae.

7. The width and depth of bone resection may then be easily confirmed visually prior to any actual bone resection.

8. The distractor element and distractor apparatus are removed from the disc space.

9. The proper dimensioned bone removal

means, corresponding to the previously employed distractor element, is selected and using the receiving depth gauge, the bone removal means is adjusted for depth and locked.

10. The bone removal means is secured to the milling port of the milling block, and the space is then milled to remove a portion of bone from the endplates adjacent to the disc space.

11. The milling apparatus is removed and the prepared space may be irrigated and suctioned through the milling block, or alternatively the entire milling assembly including the milling block may first be removed and the prepared space then irrigated and suctioned.

12. The prepared space is distracted utilizing conventional means and the appropriate implant or implants are then inserted into the prepared space.

In the alternative, the surgical method of the present invention may be performed by utilizing a separable milling block having a separable member with bilateral, lateral distractor elements such that the distractor elements are left in place in the disc space while steps 9-12 above of the method are performed. However, in this instance no distraction would be necessary in step 12 as the distractor elements remain in place while the appropriate implant(s) are inserted into the prepared space and the distractor elements are subsequently removed. The

placement of bilateral distractor elements also provides a safety means for preventing the bone removal means and implant from exiting from the sides of the disc space and out of the spine.

5

OBJECTS OF THE PRESENT INVENTION

It is an object of the present invention to provide for a surgical method and instrument means for performing interbody spinal fusion or in the alternative of inserting an "artificial disc implant" for the purpose of maximizing the width and optimizing the depth of the disc and the bone removed from front to back, or back to front, from the vertebral endplates adjacent the disc space to be fused or implanted while confining such bone resection safely within the lateral, anterior (front) and posterior (back) limits of the disc space.

It is another object of the present invention to provide for a surgical method and instrument means for performing interbody spinal fusion or "artificial disc" implantation that provides for the rapid creation of both a known surface contour of each of the vertebral endplates adjacent a disc space as well as a known and reproducible shape of the fusion or implantation site itself.

It is another object of the present invention to provide for a surgical method and instrument means for performing interbody spinal fusion that allows for the utilization of a larger interbody spinal fusion implant(s) than was possible with the prior art, such an implant having the capacity for providing increased amounts of osteogenic material, increased surface area, increased area of contact, increased stability and the ability to provide

30



for greater support through the fusion area.

It is another object of the present invention to provide for a surgical method and instrumentation for performing the preparation of the space between adjacent vertebrae for the purpose of implanting an artificial disc or fusion implant(s) having the optimal cross sectional area of contact with said adjacent vertebrae and where said cross sectional area may be as large as possible while remaining safely within the perimeter of the endplates of the adjacent vertebrae.

These and other objects of the present invention will become apparent from a review of the accompanying drawings and the detailed description of the drawings.

#### BRIEF DESCRIPTION OF THE DRAWINGS

FIGURE 1 is a front perspective view of the milling block of the present invention.

FIGURE 2 is a rear perspective view of the milling block of the present invention.

FIGURE 3 is a front elevation view of the milling block of the present invention.

FIGURE 4 is a top plan view of the milling block of the present invention.

FIGURE 5 is a side elevational view of the milling block of the present invention.

FIGURE 6 is a partial sectional view of the milling block of the present invention showing the sliding instrument guide within the milling block.

FIGURE 7A is a side perspective view of a pin driving instrument and a pin used to secure the milling block of the present invention to a segment of the spine.

FIGURE 7B is a top plan view of a pin used to

secure the milling block of the present invention to the vertebrae.

FIGURE 8 is a front perspective view of a handle used to hold the milling block of the present invention.

5 FIGURE 9 is an exploded view of a distractor and distractor holder of the present invention with the distractor shown about to be inserted into the milling block of the present invention.

10 FIGURE 10 is an exploded perspective view of the distractor holder of the present invention.

FIGURE 11A is an exploded view of the distractor holder, the distractor and the calibration gauge of the present invention.

15 FIGURE 11B is a side elevational view of the distractor of the present invention having a insertion end for placing two adjacent vertebrae in parallel relationship to each other.

20 FIGURE 11C is a side elevational view of the distractor of the present invention having a converging insertion end for placing two adjacent vertebrae in angular relationship to each other such as lordosis.

25 FIGURE 11D is a side elevational view of a segment of the spine with two distractors of the present invention placed at two adjacent disc levels illustrating the creation of lordosis with one distractor and the parallel spacing of the vertebrae by the other distractor.

30 FIGURE 12 is a partial cut away of a front elevational view of the calibration gauge of the present invention with the distractor inserted therein and the distractor holder coupled to the distractor insertion end of the calibration gauge.

FIGURE 13 is a side elevational view of the milling block of the present invention placed against the anterior aspect of a segment of the spine with the distractor holder coupled to the milling block and the distractor inserted in the disc space between two adjacent vertebrae and the handles attached to the milling block of the present invention.

FIGURE 14 is a side elevational view of the segment of the spine with the milling block of the present invention attached to the anterior aspect of the spine by a plurality of pins shown partially in hidden line and being driven by a pin driver.

FIGURE 15 is a side elevational view of a segment of the spine with the milling block of the present invention engaged to two adjacent vertebrae by a plurality of pins shown partially in hidden line.

FIGURE 16 is an exploded perspective view of the bone removal assembly and calibration gauge of the present invention.

FIGURE 17 is a partial cut-away of a front elevational view of the calibration gauge of the present invention with the bone removal assembly inserted therein to adjust the depth of the milling bit.

FIGURE 18A is an exploded perspective view of the bone removal assembly of the present invention about to be inserted into the milling block of the present invention.

FIGURE 18B is an exploded side elevational view of the bone removal assembly being inserted into the milling block of the present invention shown engaged to a segment of the spinal column.

FIGURE 19 is a side perspective view of the bone

removal assembly coupled to a milling block of the present invention that is engaged to a segment of the spinal column by a plurality of pins shown partially in hidden line.

5           FIGURE 20 is a side elevational view of a segment of the spinal column having an implant inserted in the space created across the disc space and into the adjacent vertebrae with the milling block instrumentation and method of the present invention.

10           FIGURE 21 is a front elevational view of a segment of the spine having an implant with flat side walls from top to bottom inserted in the space created across the disc space and into the adjacent vertebrae with the milling block instrumentation and method of the present invention.

15           FIGURE 22 is a sectional view of a vertebra taken along line 22--22 of Figure 21 illustrating the space created into the vertebrae by the milling block instrumentation and method of the present invention.

20           FIGURE 23 is a front elevational view of a segment of the spinal column having an implant with curved side walls from top to bottom inserted into the space created across the disc space and into the adjacent vertebrae by the milling block and instrumentation of the present invention.

25           FIGURE 24 is a side elevational view of a segment of the spinal column showing an implant inserted between two adjacent vertebrae with the methods and instrumentation of the prior art.

30           FIGURE 25 is a front elevational view an implant inserted between two adjacent vertebrae with the methods and instrumentation of the prior art.

          FIGURE 26 is a sectional view along lines 26--26

of Figure 25 illustrating the space created in the vertebrae by the methods and instrumentation of the prior art.

5           FIGURE 27 is a rear perspective view of an alternative embodiment of the milling block of the present invention.

          FIGURE 28 is a front perspective view of the alternative embodiment of the milling block of the present invention shown in Figure 27.

10           FIGURE 29 is a front elevational view of the alternative embodiment of the milling block of the present invention shown in Figure 27.

          FIGURE 30 is a top plan view of an alternative embodiment of the alternative embodiment of the milling block of the present invention shown in Figure 27.

          FIGURE 31 is a side elevational view of the alternative embodiment of the milling block of the present invention shown in Figure 27.

20           FIGURE 32 is a side sectional view of the alternative embodiment of the milling block of the present invention shown in Figure 27 with a distractor element inserted into the milling block.

          FIGURE 33 is a side perspective view of the alternative embodiment of the distractor element of the milling block of the present invention.

          FIGURE 34 is a side perspective view of an alternative embodiment of the handle used to hold the milling block of the present invention.

30           FIGURE 35 is a side elevational view of the alternative embodiment of the milling block of Figure 27 with a pair of detachable handles shown attached to the

milling block.

FIGURE 36 is an exploded perspective view of an alternative embodiment of the bone removal assembly and the milling block of the present invention shown in Figure 27.

5           FIGURE 37 is a perspective view of the adapter sleeve of the bone removal assembly of the present invention shown in Figure 36.

10           FIGURE 38 is a front elevational view of an alternative embodiment of the milling block of the present invention.

FIGURE 39 is a rear elevational view of the alternative embodiment of the milling block of the present invention shown in Figure 38.

15           FIGURE 40 is a top plan view of the alternative embodiment of the milling block of the present invention shown in Figure 38.

FIGURE 41 is a side elevational view of the alternative embodiment of the milling block of the present invention shown in Figure 38.

20           FIGURE 42 is a sectional view along lines 42--42 of Figure 39 of the milling block of the present invention having a bone removal member inserted therein for milling a space between two adjacent vertebrae.

25           FIGURE 43 is a rear elevational view of an alternative embodiment of the milling block of the present invention with two adjacent vertebrae shown in hidden line.

FIGURE 44 is a rear elevational view of an alternative embodiment of the milling block of the present invention with two adjacent vertebrae shown in hidden line.

30           FIGURE 45 is a anterior elevational view of a segment of the spinal column illustrating the space created

with the milling block of Figure 44 and an artificial disc implanted within the created space.

FIGURE 46 is a front perspective view of an alternative embodiment of the milling block of the present invention with a pair of distractor elements in place.

FIGURE 47 is a front perspective exploded view of the alternative embodiment of the milling block of Figure 46 and a pair of distractor elements of the present invention.

FIGURE 48 is a front perspective view of an alternative embodiment of the milling block of the present invention.

FIGURE 49 is a side perspective view of a pair of distractor elements of the present invention shown joined together at their tips.

FIGURE 50 is a front perspective view of an alternative embodiment of the milling block of the present invention.

FIGURE 51 is an exploded rear perspective view of an the preferred embodiment of the milling block and distractor holder of the present invention for use in the cervical spine.

FIGURE 52 is a front perspective view of the embodiment of the milling block shown in Figure 51.

FIGURE 53 is a front elevational view of the embodiment of the milling block shown in Figure 51.

FIGURE 54 is a side elevational view of the embodiment of the milling block shown in Figure 51.

FIGURE 55 is a top plan view of the embodiment of the milling block shown in Figure 51.

FIGURE 56 is a rear perspective fragmentary view

of the embodiment of the milling block shown in Figure 51.

FIGURE 57 is a fragmentary view of the distractor holder along line 57 of Figure 51.

5 FIGURE 58 is a side perspective view of an embodiment of a combined calibration gauge and handle of the present invention.

FIGURE 59 is a rear elevational view of an alternative embodiment of the milling block of the present invention with two adjacent vertebrae shown in hidden line.

10 FIGURE 60 is a front elevational view of the alternative embodiment of the milling block shown in Figure 59.

15 FIGURE 61 is a side elevational view of a cutting instrument for use with the alternative embodiment of the milling block apparatus shown in Figure 59.

FIGURE 62 is a side perspective view of an alternative embodiment of the milling block apparatus of the present invention.

20 FIGURE 63 is a sectional view along line 63--63 of Figure 62 of the milling block apparatus of the present invention.

25 FIGURE 64 is an exploded perspective view of a combined outer sleeve and distractor engaging two adjacent vertebrae and the milling block of Figure 62 about to be inserted into the outer sleeve.

30 FIGURE 65 is a side elevational view of the segment of the human spine with a milling instrument interposed between two adjacent vertebrae for preparing a disc space having anterior and posterior retaining walls for retaining an implant.

FIGURE 66 is an exploded rear perspective view of



an alternative embodiment of the milling block and bone removal assembly of the present invention.

FIGURE 67 is a front perspective view of the distractor portion of the milling block of Figure 66.

5           FIGURE 68 is a side elevational view of an alternative embodiment of the milling block and bone removal assembly of the present invention shown engaging two adjacent vertebrae.

10           FIGURE 69 is a rear elevational view of the milling block of Figure 68.

            FIGURE 70 is a rear perspective view of the milling block of Figure 68.

            FIGURE 71 is an elevational view along lines 71--71 of Figure 68.

15           FIGURE 72 is an elevational view along lines 72--72 of Figure 68.

#### DETAILED DESCRIPTION OF THE DRAWINGS

Referring to Figures 1-6, the instrumentation of the present invention comprises a milling block, generally referred to by the numeral 100. The milling block 100 has an overall generally rectangular configuration having a front face 102, an opposite rear face 104, a top side 106, a bottom side 108 and left and right sides 110 and 112, respectively. The front face 102 comprises a surface having a concave configuration that conforms to the natural curvature of the anterior aspect of a segment of the human spinal column and permits the placement of the milling block 100 in close proximity to the anterior aspect of the spinal column. The milling block 100 comprises a central aperture 114 through the center of the milling block 100. The aperture 114 is preferably oblong-shaped, having an

20

25

30

approximate width of 18-30mm for use in the cervical spine, 30-50mm for use in the lumbar spine, and if the milling block 100 is used on the left and right sides of the mid sagittal axis of a lumbar vertebrae separately, the  
5 approximate width of the aperture 114 is 15-25mm and the approximate height of the aperture 114 is 5-20mm. Located within the aperture 114 is a sliding mill guide 116 having a threaded port 118 for engaging various instrumentation as discussed in detail below. The mill guide 116 slides in a  
10 transverse motion from side to side within the central aperture 114 along the transverse axis of the aperture 114.

The milling block 100 comprises a plurality of pin holes 120a-d which pass through the milling block 100 from the rear face 104 through the front face 102. The pin  
15 holes 120a-d have a wider diameter entrance at the rear face 104 of the milling block 100 and have a narrower diameter passage at the front face 102 of the milling block 100. The wide diameter entrance of the pin holes 120a-d permit the countersinking of the head portion 126 of pin  
20 128 illustrated in Figures 7A and 7B and described in detail below.

The rear face 104 of the milling block 100 includes blind holes 130 and 132 centrally positioned and located between the pin holes 120a-b and 120c-d,  
25 respectively. The blind holes 130 and 132 receive posts 134a and 134b of the distractor holder 158 illustrated in Figure 9 and described in detail below. The top and bottom sides 106 and 108 of the milling block 100 comprise tracks 136a and 136b having an inverted T-shaped  
30 configuration for engaging a T-shaped rail member 138 of the handles 140 and 142 illustrated in Figure 8 and

described in detail below. Each of the tracks 136a and 136b have a depression 144 for engaging a detent means 146 on the handles 140 and 142 for centering the handles 140 and 142 relative to the milling block 100 and for locking the handles 140 and 142 in place once they are attached to the milling block 100.

Referring to Figure 8, the handle 140 is shown having a general L-shaped configuration with an inverted T-shaped rail member 138 for engaging the tracks 136a and 136b of the milling block 100. The handle 140 has detent means 146 located in the center of the rail member 138 which fits into the depression 144 of the tracks 136a and 136b and functions to center and lock the handle 140 to the milling block 100.

Referring to Figure 9, the distractor apparatus of the present invention generally referred to by the numeral 150 is shown in an exploded view in relation to milling block 100. The distractor apparatus 150 comprises a distractor 151 having a cylindrical shaft 152 with a bullet-shaped leading end 154. The distractor 151 is interposed in the disc space between two adjacent vertebrae and bears upon the endplates of the adjacent vertebrae to urge the vertebrae apart. The leading end 154 of the distractor 151 is a flattened member having a height that may correspond to the normal anatomic height of the disc space between two adjacent vertebrae in which the distractor 151 is to be inserted or may have a height that is less than the anatomic height of the disc space. It is appreciated that the distracted height of the disc space may be equal to, less or greater than the normal anatomic height of the disc space. The shaft 152 of the distractor

151 has a plurality of annular slots 156 for engaging the distractor holder 158.

The leading end 154 of the distractor 151 may have a height in the range of 4mm to 20mm, with 10mm to 14mm being the preferred height in the lumbar spine except for a collapsed and degenerated disc which may be less, 5.5mm to 7.5mm being the preferred height in the cervical spine. The distractor 151 may have a thickness in the range from 1mm to as great as 20mm in the cervical spine, with 2mm being the preferred thickness. In the lumbar spine the distractor 151 may be from 2mm to 50mm thick with a range of 2mm to 5mm being preferred. The length of the portion of the leading end 154 distractor 151 extending beyond the front face 102 of the milling block 100 (referred to herein as the "penetration depth") is less than the depth of the disc space in that location. The "depth" of the disc space is the distance between the anterior and posterior aspect of a vertebrae; the "width" of the disc space is the distance between the lateral aspects of a vertebrae; and the "height" of the disc space is the distance between two vertebral endplates adjacent to the disc space. For the cervical spine, the length of distractor 151 would range from 8mm to 20mm, with 10-15 mm being preferred as measured at the sagittal (left from right) midline; while in the lumbar spine the distractor 151 length would range from 15mm to 40mm, with 20mm to 35mm being preferred.

Referring to Figures 9-10 the distractor holder 158 has an inverted Y-configuration with a central tubular member 160 and a base member 160. The bottom portion 164 of the tubular member 160 has side slots 166 having a width

sufficient to accommodate the thickness of the leading end 154 of the distractor 151. Located over the bottom portion of the tubular member 160 is a sleeve 168 which engages the bottom portion 164 and rotates freely about the bottom portion 164 of the tubular member 160. The sleeve 168 has an external thread 170 for engaging the milling port 118 of the sliding mill guide 116 and knob 171 for rotating the sleeve 168. The sleeve 168 engages the opening 186 in the drill insertion end 184 of the calibration gauge 180 illustrated in Figure 11A and described in detail below.

Depending from the base member 162 of the distractor holder 158 are posts 134a and 134b for centering and engaging the distractor holder 158 to the milling block 100 and to the distractor insertion end 182 of the calibration gauge 180. The posts 134a and 134b fit into the blind holes 130 and 132 of the milling block 100 and also fit into the blind holes 188a and 188b of the calibration gauge 180.

The upper portion 172 of the tubular member 160 of the distractor holder 158 has a spring loaded locking collar 174 for locking the distractor 151 to the distractor holder 158 after the distractor 151 is inserted into the distractor holder 158. The distractor holder 158 holds the distractor 151 with a spring loaded gripping member 176 that is configured to engage the annular slots 156 in the shaft 152 of the distractor 151. The locking collar 174 is locked and unlocked by the partial rotation of the locking collar 174 about the upper portion 170 of the tubular member 160. The locking collar 174 is kept in a "locked" or "unlocked" position by slot 173 and pin 175.

In the locked position, the locking collar 174

forces the gripping member 176 into the annular slots 156 of the shaft 152 of the distractor 151 to hold the distractor 151 within the distractor holder 158. The gripping member 176 has tynes 177 with an enlarged head portion 178 which has a complimentary configuration for fitting the annular slots 156 of the distractor 151. The gripping member 176 is locked by sliding the locking collar 174 in a direction away from the base 162 such that the locking collar 174 slides over the gripping member 176 to compress the tynes 177 into the slots 156. To unlock the distractor holder 158, the locking collar 174 is rotated and slid in the direction toward the base 162 to release the tynes 177 as shown in Figure 9.

Referring to Figure 11A, a calibration gauge 180 is shown for setting the depth of the distractor 151 within the distractor holder 158 and for setting the depth of the milling instrument 200 in the coupling member 208 described in detail below. The calibration gauge 180 has a substantially rectangular configuration with a distractor insertion end 182 and a drill insertion end 184. The distractor insertion end 182 has an opening 186 of a sufficient diameter for receiving the leading end 154 of the distractor 151 and a portion of the sleeve 168 of the distractor holder 158. The distractor insertion end 182, has two blind holes 188a and 188b for receiving the posts 134a and 134b of the distractor holder 158. Similarly, the drill insertion end 184 has an aperture 190 of a sufficient diameter for receiving and setting the depth of a milling instrument 200.

Referring to Figures 11B and 11D, a side elevational view of a distractor 151 having parallel top

and bottom sides 153a and 153b is shown inserted in the disc space between adjacent vertebrae  $V_1$  and  $V_2$ . The distractor 151 is used to place and keep the two adjacent vertebrae  $V_1$  and  $V_2$  in parallel spatial relationship when the distractor 151 is inserted in the disc space with the top and bottom sides 153a and 153b placed against the vertebral endplates of the adjacent vertebrae  $V_1$  and  $V_2$ . As shown in Figure 11D, the distractor 151 is placed between two adjacent vertebral  $V_1$  and  $V_2$  to orient and maintain the vertebrae in parallel relationship to each other.

Referring to Figures 11C and 11D, a side elevational view of distractor 151' is shown having top and bottom sides 153a' and 153b' in a converging angular relationship to each other. The distractor 151' is used to place and keep two adjacent vertebrae  $V_2$  and  $V_3$  in angular relationship to each other, such as where the restoration of lordosis is desired at a specific disc level of the spine. As shown in Figure 11D, the distractor 151' is placed between two adjacent vertebrae  $V_2$  and  $V_3$  to orient and maintain the vertebrae in angular relationship to each other.

Referring to Figure 12, the calibration gauge 180 for calibrating the depth of the distractor 151 within the distractor holder 158 is shown. The calibrator gauge 180 is hollow and has a window 192 with graduated marks 194 indicating the depth in which the distractor 151 being held by the distractor holder 158 will penetrate the disc space between two adjacent vertebrae when the distractor 151 is subsequently inserted into the disc space as described in detail below.

In one embodiment of the calibration gauge 180,

for use in the cervical spine, the graduated marks 194 range from 11 to 21 mm to represent the length of insertion of the distractor 151 which penetrates the disc space. The distractor 151 is selected and inserted into the distractor holder 158 and remains in the unlocked position as shown in Figure 12. The leading end 154 of the distractor 151 is then placed within the aperture 186 of the calibration gauge 180 such that the leading end 154 of the distractor 151 becomes visible through the window 192. The desired depth of the distractor 151 may be selected in reference to the graduated marks 194 by adjusting the distractor 151 in relation to the distractor holder 158 such that the desired amount of the distractor 151 extends within the calibration gauge 180. The depth adjustment of the distractor 151 is accomplished by sliding the shaft 151 the distractor 151 up or down in relation to the distractor holder 158. Once the correct depth suitable for the disc space in which the distractor 151 is to be inserted has been selected for the distractor 151, the locking collar 174 on the distractor holder 158 is rotated and moved to compress the tynes 177 of the gripping member 176 into the annular slots 156 of the distractor 151 and the distractor 151 is held in fixed relationship to the distractor holder 158 at the desired depth. In the preferred embodiment, the annular slots 156 are spaced apart a distance corresponding to each of the graduated marks 194 to facilitate the depth selection and adjustment of the distractor 151 within the distractor holder 158. The distractor holder 158 is then dissociated from the calibration gauge 180 and the distractor 151 remains in fixed position in the distractor holder 158 since the distractor holder 158 is in the "locked"



position. In the alternative, as shown in Figures 9 and 11A-11C, each of the annular rings 156 is numbered for length which can be read directly from the shaft 152 as the number appearing beyond the gripping member 176.

5 Referring to Figures 13 and 14, the distractor holder 158 with the distractor 151 locked in place is coupled to the milling block 100 such that the leading end 154 of the distractor 151 passes through the threaded port 118 of the mill guide 116. The posts 134a and 134b of the  
10 distractor holder 158 are positioned within the blind holes 130 and 132 of the milling block 100 and the sleeve 168 of the distractor holder 158 is threadably coupled to the threaded collar port 118 of the milling block 100. The handles 140 and 142 are engaged to the milling block 100  
15 with the rail member 138 in the tracks 136a and 136b and the detent means 146 positioned within the depression 144 of the tracks 136a and 136b.

The combined distractor apparatus 150 and milling block 100 assembly is then brought to the fusion site of  
20 the spine S from the anterior aspect of the spine S and the leading end 154 of the distractor 151 is then introduced into the disc space D between two adjacent vertebrae  $V_1$  and  $V_2$ . It is appreciated that the distractor 151 may be introduced into the disc space D turned on its side (with  
25 the sides 153a and 153b parallel to the horizontal plane of the disc space D) so as to facilitate introduction of the distractor 151 into the disc space D and then turned 90 degrees position the sides 153a and 153b of the distractor 151 perpendicular to the horizontal plane of the disc space  
30 D to distract the vertebrae  $V_1$  and  $V_2$ . Alternatively, the distractor 151 may be introduced with the sides 153a and

153b perpendicular to the horizontal plane of the disc space D, relying on the bullet-shaped leading edge 154 to distract the vertebrae  $V_1$  and  $V_2$  apart during insertion. The angular relationship of the two vertebrae  $V_1$  and  $V_2$  adjacent to the disc space D will then be determined by the shape of the distractor 151 as illustrated in Figure 11D and previously described above.

Referring to Figures 14 and 15, the front face 102 of the milling block 100 is placed adjacent to the segment of the spine S in which the fusion or artificial disc implantation is being performed. The milling block 100 is then secured to the anterior aspect of the spine S by engaging each of the adjacent vertebrae  $V_1$  and  $V_2$  by inserting pins 128a-d with a pin driver 196. The pins 128a-d are inserted into the pin holes 120 a-d and pass through the milling block 100 and penetrate the bone of the vertebrae  $V_1$  and  $V_2$  to engage the milling block 100 to the spine S. It is appreciated that while two pins 128 into each of the adjacent vertebrae are shown, other engaging means such as a screw, or more or less of such engaging means to engage the milling block 100 to the spine, could also be used, such as prongs fixedly attached and extending forward from the milling block 100. After the milling block 100 is secured to the vertebrae  $V_1$  and  $V_2$  of the spinal column, the distractor holder 158 and the distractor 151 are removed from the disc space D and the handles 140 and 142 are removed from the milling block 100 as shown in Figure 15. It is now possible for the surgeon to view the vertebrae  $V_1$  and  $V_2$  through the central aperture 114 of the milling block 100 so that the width and depth of the desired bone resection from each of the adjacent vertebrae

may then be easily confirmed visually prior to performing any actual bone resection.

Referring to Figures 16-18B, the milling apparatus of the present invention, generally referred to by the numeral 200 is shown. The milling apparatus 200 is a bone removal device used to mill (remove a portion of bone from) the endplates of the vertebrae  $V_1$  and  $V_2$  adjacent to the disc space D in which a spinal implant is to be inserted. The milling apparatus 200 comprises a milling bit 202 having a shaft 204 terminating in a cutting portion 206 having a cutting end and a cutting perimeter for cutting bone. The shaft 204 is configured to fit within a driver coupling member 208 for coupling the milling bit 202 to a driving device, well known in the art, such as motorized drill or gas driven turbine (not shown). The driver coupling member 208 has a shaft receiving end 210 for receiving the shaft 204 of the milling bit 202, an annular segmented collar portion 212, and a driver coupling end 214 for coupling to a driving device. While gas driven turbines are known and are presently manufactured and sold by Midas Rex, Anspach, Zimmer, Inc. and others, all these units attach to a gas driven turbine and hold a burr, but lack any adjustable depth limiting means, such as the adjustable depth limiting means of the present invention so as to be able to be lockably engaged into a further apparatus such as is required in the present invention.

A locking adapter 216 functions to lock the milling bit 202 to the driver coupling member 208, to couple the milling bit 202 to the calibration gauge 180, and to couple the milling bit 202 to the port 118 of the mill guide 116 of the milling block 100. The locking

adapter 216 comprises a hollow tubular sleeve 218 and has a similar configuration to the locking collar 174 of the distractor holder 158 described above. The sleeve 218 has a locking collar 220 and a spring-loaded gripping member 222 similar to the locking collar 174 and gripping member 176 described above. The locking adapter 216 has a bottom portion 224 of the sleeve 218 for coupling to the drill insertion end 184 of the calibration gauge 180. An adaptor fitting 226 is provided having a threaded portion 228 for engaging the threaded port 118 of the milling guide 116.

The proper diameter milling bit 202, corresponding to the space to be created between the adjacent vertebrae is adjusted with the calibration gauge 180 to select the appropriate maximum safe penetration depth into the disc space of the milling bit 202 to prevent unwanted over penetration into the disc space. After the milling bit 202 is inserted into the calibration gauge 180, the length of the milling bit 202 that is capable of extending through the milling block 100 is adjusted in reference to the calibration marks 194 of the calibration gauge 180 and the milling bit 202 is then locked to the driver coupling member 208.

For example, if the desired length of the milling bit 202 extending into the milling block 100 is 15mm (determined by the dimensions of the vertebrae being milled), then the milling apparatus 200 would be coupled to the calibration gauge 180 and the driver coupling member would be advanced toward the calibration gauge 180 until the tip of the cutting portion 206 is aligned with the graduated marks 194 corresponding to 15mm. The locking adapter 216 is then rotated and placed in the locked

position with the gripping member 222 engaging the segment on the collar portion 212 corresponding to 15mm.

It is appreciated that other means for setting the depth of the milling bit 202 are contemplated to be within the scope of the present invention. For example, with reference to Figure 18A the segments of the collar portion 212 of the milling apparatus 200 can include calibration marks corresponding to the depth of the milling bit 202 extending through and protruding from the milling block 100. In this manner, the gripping member 222 is set to engage the appropriate segment of the collar 212 corresponding to the desired depth. Similarly, the annular slot 154 on the shaft 152 of the distractor 151 may include calibration marks for setting the desired depth of the distractor 151 without the use of a calibration gauge 180.

It is further appreciated that the milling apparatus may comprise any suitable bone removal means such as, but not limited to, burrs, router bits, abraders, grinders, rasps, drills, graters, saws, oscillating cutters, vibrating cutters, reciprocating cutters, orbital cutters, rotating cutters and lasers.

Referring to Figures 18B and 19, the milling apparatus 200 is then inserted through the adaptor fitting 226 and is screwed to the port 118 of the milling block 100. The milling bit 202 is then rotated at high speed as illustrated by arrow R in Figure 19. The milling apparatus 200 rotating at high speed is moved in the direction illustrated by arrow A and the portions of the vertebrae  $V_1$  and  $V_2$  adjacent to the disc space are then milled to create a space for receiving an implant. After the creation of the space for the implant, the milling apparatus 200 is

removed from the milling block 100 and the prepared space may be irrigated and suctioned through the port 118 of milling block 100, or alternatively the entire milling assembly including the milling block 100 may first be removed and the space then irrigated and suctioned. The disc space D is distracted utilizing conventional means and the appropriate implant or implants are then inserted into the newly prepared space.

Referring to Figures 20-22, a segment of the spinal column S is shown with an implant I inserted between the two adjacent vertebrae  $V_1$  and  $V_2$  in the space created with the milling instrumentation and method of the present invention. As shown in Figure 22, the space B created by the milling block 100 is substantially rectangular in shape and extends across the width and length of the vertebrae  $V_1$  and  $V_2$  to create a large area of contact between the vertebrae  $V_1$  and  $V_2$  and the implant I, which may have a curved (from side to side) trailing end to conform to the curvature of the vertebrae.

Referring to Figure 23, although implant I has been shown to have the substantially rectangular configuration it is appreciated that the implant I' can have a modified configuration with curved side walls (e.g. left and right) as shown in Figure 23.

Referring to Figure 24-26, the space C created with the instrumentation and method of the prior art is shown with an implant I' inserted therein. In comparing the size of the space C with the size of the space B shown in Figure 22 created by the method and instrumentation of the present invention, it is clear that the space B created with the instrumentation of the method of the present

invention is substantially greater than was possible with the instrumentation and methods of the past. As a result, the spinal implant I inserted in the space B can be substantially larger than implant I' and have a substantially greater surface area of contact with the vertebrae  $V_1$  and  $V_2$  providing greater stabilization to the segment of the spine S being fused.

Furthermore, it can be seen in Figure 22 that with the present invention the implant can not only engage the very strong bone of the vertebral body at the endplate located posteriorly (in the back) and laterally (to each side), but as shown in Figure 20, the implant may be embedded into sockets in the posterolateral corners of the vertebrae (dark shaded areas shown in Figures 20-26) providing enhanced stability to the implant which is blocked from moving more posteriorly or to either side.

Referring to Figures 27-35, an alternative embodiment of the milling block of the present invention is shown and generally referred to by the numeral 300. The milling block 300 has a similar configuration to the milling block 100 described above, and comprises a modified distractor element 351 for separating and orienting the adjacent vertebrae in the appropriate relationship to each other prior to milling the space in which an implant is to be inserted. The distractor element 351 is inserted in an inverted T-shaped slot 301 in the front face 302 of the milling block 300. The slot 301 comprises a spring loaded detent means 303 which functions to hold the distractor member 351 in place once it is inserted within the slot 301.

Referring to Figure 33 a perspective view of the

distractor element 351 is shown having an inverted T-shaped rail member 353 which corresponds in configuration to the inverted T-shaped slot 301. The distractor element 351 has an insertion end 355 that is tapered and bullet shaped to facilitate insertion into the disc space D between two adjacent vertebrae  $V_1$  and  $V_2$ . The distractor element 351 is inserted into the slot 301 of the milling block 300 prior to attaching the milling block 300 to the segment of the spine S in which the fusion is desired. The distractor element 351 has a biconcave configuration to conform to the curvature of the cutting end 206 of the milling bit 202 of the milling apparatus 200, as described above, such that the horizontal excursion of milling bit 202 on either side of the distractor element 351 is maximized when used to create a space in the adjacent vertebrae  $V_1$  and  $V_2$ . It is appreciated that the distractor element 351 may come in different lengths in order to accommodate for the different dimensions of the disc space between the two adjacent vertebrae in which the surgical procedure is to be performed.

Referring to Figures 30 and 35, the track members 336a and 336b are located on the sides of the milling block 300 such that handles 340 and 342 may be attached to the milling block 300 as previously described herein. The track members 336a and 336b each have a detent means 343a and 343b, respectively, for holding the handles 340 and 342 as shown in Figure 30.

Referring to Figure 36-37, an alternative embodiment of the milling apparatus generally referred to by the number 361 is shown. The milling apparatus 361 comprises a coupling member 308 which is identical to



coupling member 208 previously described. The milling apparatus 361 includes a milling bit 365 with a cutting portion 367 and a shaft portion 369 that are similar to the milling bit 202 previously described. Milling bits such as 365 are known and commercially available. The element of milling bit 365 as well as the use of an element such as milling bit 365 with a coupling means such as coupling member 308 are well known in the art. An adaptor sleeve 371 is used to couple the coupling member 308 and the milling bit 365 to the port 318 of the milling block 300. The sleeve 371 comes in a variety of lengths depending on the desired depth of the space to be created and functions to limit the excursion of the milling bit 365 into the milling block 300. The longer the sleeve 371, the less the excursion of the milling bit 365 into the disc space between two adjacent vertebrae in which the opening is desired to be created. Thus, the surgeon can predetermine the depth of the space being created by selecting the appropriate sleeve 371 length prior to performing the procedure.

Referring to Figures 38-42 an alternative embodiment of the milling block of the present invention is shown and generally referred to by the numeral 400. The milling block 400 comprises a central template 401 for creating a space of any desired shape and as an example, the space to be created may be a substantially rectangular space corresponding to the shape of the rectangular template 401. The template 401 has a track 407 passing through the milling block 400 from the rear face 404 to the front face 402 of the milling block 400. The track 407 is configured to receive a suitable bone removal means such as

a drill a router or a laser, and the like, to remove a portion of the bone of the adjacent vertebrae milling instrument 403 and serves as a guide for creating the desired space in the adjacent vertebrae with a suitable bone removal means including, but not limited to, a router, to remove a portion of the bone of the adjacent vertebrae. The milling instrument 403 is inserted into a collar 405 which fits into the track 407 and is retained in slidable relationship within the track 407 of the template 401 and functions to guide the travel of the milling instrument 403 within the track 407. The drilling instrument 403 is then activated and moved within the confines of the track 407 to create the desired space in the vertebrae, which space can be of a shape corresponding to the shape of track 407 of the template 401. This is particularly useful for creating a shape, such as that shown in Figure 45, which might be desirable for installing an artificial disc device 409 between two adjacent vertebrae.

Referring to Figures 43 and 44, alternative embodiments of the milling block 400 designated as 400' and 400'' are shown engaging two adjacent vertebrae  $V_1$  and  $V_2$  shown in hidden line. Tracks 401' and 407'' are configured to create a space such as shown in Figure 44 for receiving an artificial implant or an artificial joint as shown in Figure 45. It is appreciated that in addition to the foregoing configurations of the template 400, that other configurations are possible and contemplated to be part of the present invention.

Referring to Figures 46 and 47 an alternative embodiment of the milling block of the present invention is shown and generally referred to by the numeral 500. The

milling block 500 is similar in configuration to the milling block 300 previously described above and comprises a pair of removable distractor elements 551a and 551b which are inserted in complimentary inverted T-shaped slots 553a and 553b at opposite sides of the milling block 500. The distractor elements 551a and 551b are inserted in the disc space D and function to restore the height of the disc space D prior to the milling operation to create the desired space. The distractor elements 551a and 551b are oriented at the sides of the central aperture 514 and each have a concave surface facing the central aperture 514 to conform to the curvature of the milling instrument such as milling bit 206, used to create the space between the two adjacent vertebrae. The lateral placement of the distractor elements 551a and 551b allows for the full side-to-side motion of the milling guide 516 to permit the unimpeded milling and creation of the space and without the need for having to remove and reinsert the milling instrument in order to get around a centrally placed distractor element such as distractor element 351 shown in Figure 32.

Referring to Figures 48-49, an alternative embodiment of the milling block assembly of the present invention is shown and generally referred to by the numeral 600. The milling block 600 is substantially the same as the milling block 500 described above except that the pair of distractor elements 651a and 651b are joined at their distal ends by a cross bar 655. Cross bar 655 serves as a depth limiting means to any debris and to keep the pair of distractor elements 651a and 651b together as a unit.

Referring specifically to Figure 50, an

alternative embodiment of the milling block 600' is shown and generally referred to by the numeral 600'. The milling block 600' instead of utilizing pins 128a-128d to engage the vertebrae, a centrally placed prongs 603a and 603b to engage the milling block 600' to the adjacent vertebrae. The prongs 603a and 603b are an integral part of the milling block 600' or may also be removable, like pins 128a- d discussed above, as an example. It is further appreciated that the milling block 600 may engage the adjacent vertebrae via the distractor elements 651a and 651b positioned within the disc space to secure the milling block 600 to the spine. The tension forces generated by the distraction of the disc space from the insertion of the distractor elements 651a and 651b engage the vertebrae to the distractor elements 651a and 651b and functions to hold the milling block 600 to the spine.

Referring to Figures 51-57, the preferred embodiment of the milling block for use in the cervical spine of the present invention generally referred to by the number 700 is shown. The milling block 700 is shown with a distractor holder 758 which is capable of being coupled directly to the milling block 700. The distractor holder 758 has a pair of rotating post members 734a 734b and foot portions 737a and 737b, respectively, and handle portions 774a and 774b, respectively. The rear surface 704 of the milling block 700 comprises pin grooves 721a-721d for receiving pins, such as pins 128, previously described. The rear surface 704 also includes post grooves 723a and 723b for receiving the post members 734a and 734b in which the foot portions 737a and 737b of the post members 734a and 734b engage the lips of the post grooves 723a and 723b

to lock the distractor holder 758 to the milling block 700.

The distractor holder 758 comprises of a gripping portion 776, similar to gripping member 176 previously described, for engaging a distractor, such as distractor 150 previously described. The distractor holder 758 is capable of locking the distractor 150 in the desired position in order to limit the excursion of the distractor end 154 into the disc space.

Referring specifically to Figure 57, a fragmentary perspective view of the post member 734a is shown having a spring loaded detent means 790. The detent means 790 is seated in a recess 791 and is biased by spring 792, functions to lock the rotating post member 734a in place once engaged to the milling block 700. Prior to engaging the distractor holder 758 to the milling block 700, the desired length of the distractor 150 is set by engaging the calibration gauge 780 having one end capable of receiving the distractor holder 758. The depth of the distractor 750 is set according to the graduated marks 794 on the calibration gauge 780, or in the alternative as previously described by reference to the depth markings on the annular rings of the distractor. Once the desired length is selected, the distractor holder 758 is locked onto the distractor 750 in the same manner described above. The distractor holder 758 is then coupled to the milling block 700 with the sleeve 764 engaging the port 718 of the milling block 700. The post members 734a and 734b are then locked into place by rotating the handle portions 774a and 774b so that the foot portions 737a and 737b are engaging the post grooves 723a and 723b of the rear surface 704 of

the milling block 700. Once the distractor holder 758 is engaged to the milling block 700, the pins, such as pins 128a-d, are inserted into the pin holes 721a-721d and the milling block 700 is engaged to the adjacent vertebrae.

5           After the milling block 700 is engaged to the adjacent vertebrae, the distractor holder 758 is removed and the adjacent vertebrae are held in the correct spatial relationship by the milling block 700 and pins 128a-d. It is appreciated that to facilitate the engagement and  
10 removal of the distractor holder 758, the calibration gauge 780 has a receiving end 781 for engaging the shaft to the distractor 151 such that the distractor holder 758 and distractor can be manipulated with the calibration gauge 780 serving as a handle. In this embodiment the distractor  
15 151 has a flattened end portion 152 with a detent 155 as shown in Figure 11A, to couple the distractor 151 to the calibration gauge 780.

The preparation and creation of the space between the adjacent vertebrae with milling block 700 is performed  
20 in the similar manner described above with a milling apparatus such as milling apparatus 200 described above and shown in Figure 16.

Referring to Figures 59-61, an alternative embodiment of the milling block of the present invention is  
25 shown and generally referred to by the numeral 800. The milling block 800 comprises of a template 801 having a narrow track 807 for receiving a bone removal device such as an oscillating blade 809 as shown in Figure 61. The narrow track 807 functions to support and guide the motion  
30 of the oscillating blade 809 in the selected path of the track 807. Therefore, the track 807 can function as both

means for accessing the adjacent vertebrae  $V_1$  and  $V_2$  and as a guiding means for guiding a bone removal instrument. The oscillating blade 809 is used to cut the desired space in the adjacent vertebrae along the track 807 of the template 801. As shown in Figure 59 the template 800 is engaged to two adjacent vertebrae shown in hidden line. The milling block 801 maintains the vertebrae  $V_1$  and  $V_2$  in the correct spatial relationship and the cutting of the bone is performed with the oscillating blade 809 to create the desired space. While slotted cutting fixtures are known in the field of orthopedic surgery, their purpose is to resect the end of a long bone, and not a spinal vertebrae; and all examples known to this author work on but a single bone, do not attach to both of the bones that would form a joint and do not fix those bones in a desired spatial and angular relationship so as to create the optimal joint space and conformation.

Referring to Figure 61 the saw housing 812 lockably engages the saw blade 809 by screw 811 within slot 810, which coupling means allows the protruding portion of blade 809 to be adjusted for length.

Referring to Figure 62 and 63, an alternative embodiment of the milling block apparatus of the present invention is shown and generally referred to by the numeral 900. The milling block apparatus 900 is suitable for use in procedures in which the surgeon's hand is at a point remote from the site of the spinal fusion, such as for use in endoscopic procedures, or for performing procedures on the posterior aspect of the spine on either side of the mid-sagittal axis of the vertebrae avoiding the spinal cord and other delicate structures present at the posterior

aspect of the spine. The milling block apparatus 900 comprises an elongated member such as a hollow tube 901 having a front end 902 and a rear end 904 with milling guides 916a and 916b at each of its ends 902 and 904 for  
5 guiding a milling apparatus for creating and preparing the space between the two adjacent vertebrae. Such a milling apparatus would be similar to the milling bit 202 described above, and would have a shaft of sufficient length to span the distance between the milling guides 916a and 916b and  
10 have a cutting portion capable of passing through the ports 918a and 918b and extending into the disc space from the front end 902 of the milling block apparatus 900 for milling the bone of the adjacent vertebrae. In this manner, the desired space for receiving an implant may be  
15 created from a position remote from the spine such as would be useful for endoscopic spinal surgery.

The milling block apparatus 900 may be placed directly against the site of the spine in which the procedure is to be performed, with the front end 902 placed  
20 across the disc space and contacting the vertebrae adjacent to that disc space. The milling procedure for removing a portion of bone from the adjacent vertebrae to create a space for receiving an implant is performed with a bone removal means as discussed above for the other embodiments  
25 of the present invention.

Referring to Figure 64, the milling block apparatus 900 may be placed through a combination outer sleeve distractor 980 having a hollow sleeve portion 982 and having extensions members 984 and 986 extending from  
30 one end of the sleeve portion 982 for insertion into the disc space. The extension member 984 and 986 function to



distract the disc space to its normal height and to engage the combination outer sleeve distractor 980 to the spine. The combination outer sleeve distractor 980 is capable of receiving and guiding the milling block apparatus 900 to the appropriate site in which the milling procedure is to be performed. The elongated tubular body 901 of milling block apparatus 900 would in use pass through the combined outer sleeve distractor 980, which itself would engage the spine at or adjacent to the disc space to be milled and would itself extend from the spine to outside of the patient's body. Such a combined outer sleeve distractor is taught by Michelson in co-pending Application Serial No. 08/396,414 filed on February 27, 1995, incorporated herein by reference.

The bone removal from the adjacent vertebrae for creating the space for receiving an implant is performed with the milling block apparatus 900 positioned within the combination outer sleeve distractor 980 with a bone removal device passing through the ports 918a and 918b of the sliding mill guides 916a and 916b.

The milling block 900 as here taught need not be cylindrical and can be any shape, for example, square or rectangular to conform to the shape of the combination outer sleeve distractor 980. Furthermore, any such extended milling block 900 may have a flange proximally (rear end) or threads, or other means to fix, its position relative to said outer sleeve.

Referring to Figure 65, a side view of a segment of the human spine with two adjacent vertebrae having a milling apparatus 1000 having a shaft 1002 and a cutting portion 1004 for preparing a space for receiving an

implant, in which both the anterior and posterior aspects of the adjacent vertebral endplates have bone retaining walls 1000a and 1000b, respectively. The anterior and posterior retaining walls are created by the cutting portion 1004 having a larger diameter than the shaft 1002 of the milling apparatus 1000 and a length which fits within the depth of the adjacent vertebrae. Such a configuration permits the placement of substantially rectangular implant within the prepared space. The retaining walls 1000a and 1000b in the anterior and posterior aspects of the endplates function to lock and secure an implant or bone graft once installed between the two adjacent vertebrae.

While one particular type of bone milling instrument capable of cutting both on its leading end and along its sides has been shown a variety of bone cutting or abrading instruments including a drill rasp, burr, abraider or even a saw blade edge of the oscillating type or other could be used. Further, while the preferred embodiment bone milling means is shown as having a length extending at least as long as the depth of bone to be removed, the bone removal means can have a variety of shapes and lengths.

Referring to Figures 66 and 67, an alternative embodiment of the milling block, generally referred to by the numeral 1100 is shown. The milling block 1100 comprises two separable members: an instrument guiding member 1110 and a distractor base member 1112. The distractor base member 1112 has a generally rectangular upper portion 1113 having a front face 1102 and a rear face 1104. The front face 1102 has a concave configuration that conforms to the natural curvature of a segment of the human

spinal column and permits the placement of the front face 1102 of the milling block 1100 in close proximity to the spinal column. The upper portion 1113 of the distractor base member 1112 has a recess 1115 for receiving and holding a portion 1119 of the instrument guiding member 1110 of the milling block 1100 and a central opening 1117 through the center of upper portion 1113. The opening 1117 is preferably oblong-shaped, having an approximate width of 18-30mm for use in the cervical spine, 30-50mm for use in the lumbar spine, and if the milling block 1100 is used on the left and right sides of the mid-sagittal axis of a lumbar vertebrae separately, the approximate width of the opening 1114 is 15-25mm and the approximate height of the opening 1114 is 5-20mm.

Extending from the upper portion 1113 and extending beyond the front face 1102 are a pair of distractor elements 1151a and 1151b similar in configuration to the distractor elements 651a and 651b previously described above. The distractor elements 1151a and 1151b are capable of being introduced into the disc space between two adjacent vertebrae to place the vertebrae in a selected spatial relationship. The insertion of the distractor elements 1151a and 1151b into the disc space also functions to engage the distractor base member 1112 to the adjacent vertebrae.

The instrument guiding member 1110 of the milling block 1100 has a leading surface 1162, a trailing surface 1160, and a central aperture 1114 through its center having a suitable configuration corresponding to the central opening 1117 of the distractor base member 1112. Located within the aperture 1114 is a sliding mill guide 1116

having a threaded port 1118 for engaging various instrumentation as previously discussed in detail above. The mill guide 1116 slides in a transverse motion from side to side within the central aperture 1114 along the transverse axis of the aperture 1114.

The leading surface 1162 of the instrument guiding member 1110 is capable of interfacing with the rear face 1104 of the distractor base member 1112 and at least portion 1119 of the instrument guiding member 1110 is capable of being seated within the recess 1115 of the distractor base member 1112. After the distractor base member 1112 is engaged to the spine with the distractor elements 1151a and 1152b inserted into the disc space between two adjacent vertebrae and the instrument guiding member 1110 is seated into the distractor base member 1112, the removal of bone from the adjacent vertebrae is performed in the same manner as the milling procedure described above.

The milling block 1100 provides the added advantages of allowing the removal of the instrument guiding member 1110 while the distractor base member 1112 remains engaged to the spine maintaining the disc space distracted with the adjacent vertebrae in the appropriate spatial relationship to each other. With the distractor base member 1112 still engaged to the spine, it is possible to introduce an implant through the central opening 1117 and into the space for receiving the implant that has been created across the disc space and into the adjacent vertebrae. After the implant has been inserted into the disc space, the distractor base member 1112 is removed and the implant remains in the space created with the milling

apparatus of the present invention. Referring to Figures 68-72, an alternative embodiment of the milling block of the present invention is shown and generally referred to by the numeral 1200. The milling block 1200 has a body member 1201 that is capable of extending across the disc space D and capable of engaging at least one of the vertebrae adjacent to the disc space D. The body member 1201 has a front face 1202, an opposite rear face 1204 and a curved central portion 1205. It is appreciated that the central portion 1205 need not be curved. The front face 1202 has a surface that permits the placement of the milling block 1200 against the vertebrae. The milling block 1200 has a central aperture 1214 through the center of the body member 1201 for accessing the disc space D between two adjacent vertebrae. Located within the aperture 1214 is a sliding mill guide 1216 having a groove 1217 for slideably engaging the body member 1201 to permit slideable movement of the mill guide 1216 relative to the body member 1201. The mill guide 1216 has a central opening 1219 in communication with the central aperture 1214 and a sliding member 1221 within the central opening 1219 having a port 1218 for coupling the sliding member 1221 to an instrument such as a distractor previously described, or a bone removal device, such as milling apparatus 200 previously described. It is appreciated that the mill guide 1216 in addition to guiding a milling apparatus 200, is also capable of guiding other instruments into the disc space such as a distractor element used to align the vertebrae and to distract the disc space.

The sliding member 1221 of the mill guide 1216 is capable of transverse motion from one side to the other

side of the central opening 1219 along the transverse axis of the opening 1219 to guide and control a bone removal device, such as milling apparatus 200, in a selected transverse path relative to the vertebrae adjacent to the disc space D to remove at least a portion of bone from the vertebrae. The mill guide 1216 of the milling block 1200 is also capable of moving up and down in a vertical direction within the central aperture 1214 along the vertical axis of the aperture 1214, and along the curved central portion 1205 of the body member 1201. The vertical motion of the mill guide 1216 guides and controls the milling apparatus 200 in a selected path that may be at an angle to the vertebrae in order to remove an angular portion of bone from the vertebrae. The angular orientation of the milling apparatus 1216 relative to the vertebrae is a result of the position of the mill guide 1216 along the curved central portion 1205 of the body member 1201. In this manner, an opening having an angular configuration may be created, and with an appropriate implant placed within the prepared opening, the normal anatomic lordotic relationship of the vertebrae adjacent to the disc space D may be restored. Or in the alternative, the vertebrae adjacent to the disc space D could be placed in angular relationship prior to the removal of at least a portion of bone from the vertebrae, or a frusto-conical shaped bone removal device could be employed.

The milling block 1200 has a plurality of screw holes 1220a-b which pass through the milling block 1200 from the rear face 1204 through the front face 1202. The screw holes 1220a-b receive screws 1228a-b for engaging the milling block 1200 to the vertebrae adjacent to the

disc space D. Similarly, pins, pegs or other suitable means for attaching the milling block 1200 to the vertebrae adjacent to the disc space D could be utilized.

5 While the present invention has been described in detail with regards to the preferred embodiment, it is appreciated that other variations of the present invention may be devised which do not depart from the inventive concept of the present invention.

What is claimed is:

1. An apparatus used in spinal surgery for creating a space of selected shape and dimensions across the disc space between two adjacent vertebrae of the spine, each of the two adjacent vertebrae having a vertebral endplate adjacent to the disc space, said apparatus comprising:

a milling block configured at least in part for placement against at least one of the two adjacent vertebrae, said milling block having at least front and rear faces and accessing means for accessing at least one of the two adjacent vertebrae from said rear face and through said front face of said milling block;

bone removal means for removing at least a portion of bone from at least one of the vertebral endplates adjacent the disc space, said bone removal means capable of accessing the vertebral end plates through said accessing means; and

means for firmly holding at least a portion of said milling block against at least one of the two adjacent vertebrae.

2. The apparatus of claim 1 including distractor means for distracting and placing the adjacent vertebrae to be fused in selected spatial relationship to each other.

3. The apparatus of claim 1 including aligning means for aligning said milling block relative to the two adjacent vertebrae.

4. The apparatus of claim 2 in which said distractor



means comprises at least a first distractor member associated with said milling block extending beyond at least a portion of said front face of said milling block, said first distractor member capable of extending into the disc space between the two adjacent vertebrae when said milling block is placed against at least one of the two adjacent vertebrae.

5. The apparatus of claim 4 in which said first distractor member has a length that is less than the depth of the disc space in which said first distractor member is inserted.

6. The apparatus of claim 4 in which said first distractor member is centrally placed in said front face of said milling block.

7. The apparatus of claim 4 comprising at least a second distractor member extending beyond at least a portion of said front face of said milling block.

8. The apparatus of claim 7 in which said first and second distractor members are laterally placed at opposite sides of said milling block.

9. The apparatus of claim 7 in which said first and second distractor members are joined together.

10. The apparatus of claim 4 in which said first distractor member has a leading end, a trailing end associated with said milling block, upper and lower

surfaces for contacting each vertebral endplate adjacent to the disc space, and side walls extending from said upper surface to said lower surface, at least one of said side walls being at least in part concave.

5

11. The apparatus of claim 2 including distractor holder means for holding said distractor means in association with said milling block.

10 12. The apparatus of claim 11 in which said distractor holder means comprises depth limiting means for limiting the penetration depth of said distractor means into the disc space.

15 13. The apparatus of claim 12 including calibration means for selecting the penetration depth of said distractor means.

20 14. The apparatus of claim 13 in which said calibration means is integral to said apparatus.

15. The apparatus of claim 13 in which said calibration means engages at least a portion of said apparatus.

25 16. The apparatus of claim 12 including means for locking said distractor means at a selected penetration depth.

30 17. The apparatus of claim 11 in which said distractor holder means includes coupling means for coupling said distractor holder to said milling block.

18. The apparatus of claim 17 including means for aligning said distractor holder means relative to said milling block.

5 19. The apparatus of claim 11 in which at least a portion of said distractor means extends through said accessing means and extends beyond at least a portion of said front face and into the disc space when said milling block is placed against at least one of the two adjacent vertebrae.

10

20. The apparatus of claim 1 including guiding means associated with said milling block for guiding and controlling the path of motion of an instrument associated with said guiding means.

15

21. The apparatus of claim 20 in which said instrument is a bone removal means.

20

22. The apparatus of claim 20 in which said guiding means is in moveable relationship to said milling block for providing transverse motion of an instrument being guided by said guiding means.

25

23. The apparatus of claim 1 in which said milling block includes supporting means for supporting said bone removal means relative to said milling block.

30

24. The apparatus of claim 20 in which said accessing means is in a transverse orientation relative to said milling block, said accessing means having a transverse axis and said guiding means being oriented and capable of

traveling along said transverse axis.

25. The apparatus of claim 20 in which said accessing  
means is in a vertical orientation relative to said milling  
5 block, said accessing means having a vertical axis and said  
guiding means being oriented and capable of traveling along  
said vertical axis.

26. The apparatus of claim 25 in which said accessing  
10 means includes a vertical axis and said guiding means being  
oriented and capable of traveling along said transverse and  
vertical axes.

27. The apparatus of claim 1 including engagement means  
15 for engaging said milling block to at least one of the two  
adjacent vertebrae.

28. The apparatus of claims 27 in which said engagement  
means comprises a distractor means for distracting and  
20 placing the adjacent vertebrae to be fused in selected  
spatial relationship to each other.

29. The apparatus of claim 27 in which said engagement  
means includes means for fixedly securing said milling  
25 block to at least one of the two adjacent vertebrae.

30. The apparatus of claim 1 in which said front face of  
said milling block comprises at least a portion having a  
configuration capable of conforming to the shape of at  
30 least a portion of the anterior aspect of the adjacent  
vertebrae in contact with said milling block.

31. The apparatus of claim 1 in which said front face of said milling block comprises at least a portion having a configuration capable of conforming to the shape of the vertebrae along the posterior aspect of the lumbar spine on either side of the mid-sagittal axis of the adjacent vertebrae in contact with said milling block.

32. The apparatus of claim 1 in which said milling block comprises handle engagement means for engaging at least one handle.

33. The apparatus of claim 1 in which said accessing means is a track for guiding said bone removal means.

34. The apparatus of claim 33 including at least one track guide in moveable relationship with said track for guiding said bone removal means.

35. The apparatus of claim 1 in which said accessing means comprises at least one aperture.

36. The apparatus of claim 1 including depth limiting means for selecting and limiting the penetration depth of said bone removal means into the disc space.

37. The apparatus of claim 36 including means for locking said bone removal means at a selected penetration depth into the disc space.

38. The apparatus of claim 36 including calibration means for selecting the penetration depth of said bone removal

means into the disc space.

39. The apparatus of claim 38 in which said calibration means is integral to said apparatus.

5

40. The apparatus of claim 38 in which said calibration means engages at least a portion of said apparatus.

10

41. The apparatus of claim 1 in which said bone removal means comprises a multi-toothed rotating cutter.

15

42. The apparatus of claim 1 in which said bone removal means comprises a cutting member having a cutting end and perimeter capable of cutting bone.

43. The apparatus of claim 42 in which said bone removal means comprises an end and side mill.

20

44. The apparatus of claim 1 in which said bone removal means comprises a drill.

25

45. The apparatus of claim 1 in which said bone removal means comprises a shaft portion having a first diameter and a cutting end having a second diameter, said second diameter being greater than said first diameter, whereby said bone removal means is capable of creating a space with retaining walls on the anterior and posterior aspects of the vertebral endplates.

30

46. The apparatus of claim 1 in which said bone removal means comprises an oscillating saw.

47. The apparatus of claim 1 in which said bone removal means is selected from the group including burrs, mills, router bits, abraders, grinders, rasps, drills, graters and saws.

5

48. The apparatus of claim 1 in which said bone removal means is selected from a group including, oscillating cutters, vibrating cutters, reciprocating cutters and orbital cutters.

10

49. The apparatus of claim 1 in which said bone removal means comprises a laser.

15

50. The apparatus of claim 1 in which said bone removal means has a longitudinal central axis oriented perpendicular to the vertical axis of the spine when said bone removal means is placed within said accessing means and said milling block is placed against at least one of the two adjacent vertebrae.

20

51. The apparatus of claim 1 including aligning means for aligning the two adjacent vertebrae in a selected angular relationship to each other.

25

52. The apparatus of claim 4 including means for adjusting the length in which said distractor member extends beyond at least a portion of said front face of said milling block.

30

53. The apparatus of claim 20 in which said guiding means is associated at least in part with said accessing means.

54. The apparatus of claim 1 in which said accessing means is capable of guiding and supporting said bone removal means.

5 55. An apparatus used in spinal surgery for creating a space of selected shape and dimensions across the disc space between two adjacent vertebrae of the spine, each of the two adjacent vertebrae having a vertebral endplate adjacent to the disc space, said apparatus comprising:

10 a separable milling block having separable first and second members, said first member having at least leading and trailing surfaces and a first accessing means for accessing at least one of the two adjacent vertebrae from said trailing surface and through said leading surface of said first member, said first member having guiding means for guiding and controlling the movement of an instrument placed within said first accessing means;

15 said second member having a front face configured at least in part for placement against at least one of the two adjacent vertebrae and a rear face having a suitable configuration for interfacing with said leading surface of said first member, said second member having a second accessing means for accessing the disc space, said second accessing means being in communication with said first accessing means in said first member when said leading surface of said second member and said rear face of said first member are interfaced, said second member having at least one distractor element associated with said upper portion, said distractor element extending beyond at least a portion of said front face and capable of being inserted into the disc space for distracting and placing the

20

25

30



adjacent vertebrae in selected spatial relationship to each other;

means for removably coupling said first member to said second member;

5 bone removal means for removing at least a portion of bone from at least one of the vertebral endplates adjacent the disc space, at least a portion of said bone removal means extending through said first and second accessing means to access the vertebral endplates;  
10 and

means for firmly holding at least a portion of said second member against at least one of the two adjacent vertebrae.

15 56. The apparatus of claim 55 in which said first accessing means includes at least one aperture in said first member.

20 57. The apparatus of claim 55 in which said second accessing means includes at least one aperture in said second member.

58. The apparatus of claim 55 in which said instrument is a bone removal means.

25 59. The apparatus of claim 55 in which said holding means comprises said at least one distractor element.

30 60. The apparatus of claim 55 comprising at least a second distractor member extending beyond at least a portion of said front face of said milling block.

61. The apparatus of claim 60 in which said first and second distractor members are laterally placed at opposite sides of said milling block.

5 62. The apparatus of claim 60 in which said first and second distractor members are joined together.

10 63. The apparatus of claim 55 in which said guiding means is in moveable relationship to said milling block for providing transverse motion of an instrument being guided by said guiding means.

15 64. The apparatus of claim 55 in which said accessing means is in a transverse orientation relative to said milling block, said accessing means having a transverse axis and said guiding means being oriented and capable of traveling along said transverse axis.

20 65. The apparatus of claim 55 including engagement means for engaging said milling block to at least one of the two adjacent vertebrae.

25 66. The apparatus of claim 55 in which said accessing means is a track for guiding said bone removal means.

67. The apparatus of claim 66 including at least one track guide in moveable relationship with said track for guiding said bone removal means.

30 68. The apparatus of claim 55 including depth limiting means for selecting and limiting the penetration depth of

said bone removal means into the disc space.

69. The apparatus of claim 68 including means for locking  
said bone removal means at a selected penetration depth  
5 into the disc space.

70. The apparatus of claim 55 in which said bone removal  
means comprises a multi-toothed rotating cutter.

10 71. The apparatus of claim 55 in which said bone removal  
means comprises a cutting member having a cutting end and  
perimeter capable of cutting bone.

15 72. The apparatus of claim 71 in which said bone removal  
means comprises an end and side mill.

73. The apparatus of claim 55 in which said bone removal  
means comprises a drill.

20 74. The apparatus of claim 55 in which said bone removal  
means comprises a shaft portion having a first diameter and  
a cutting end having a second diameter, said second  
diameter being greater than said first diameter, whereby  
said bone removal means is capable of creating a space with  
25 retaining walls on the anterior and posterior aspects of  
the vertebral endplates.

75. The apparatus of claim 55 in which said bone removal  
means comprises an oscillating saw.

30

76. The apparatus of claim 55 in which said bone removal

means is selected from the group including burrs, mills, router bits, abraders, grinders, rasps, drills, graters and saws.

5 77. The apparatus of claim 55 in which said bone removal means is selected from a group including, oscillating cutters, vibrating cutters, reciprocating cutters and orbital cutters.

10 78. The apparatus of claim 58 in which said bone removal means comprises a laser.

15 79. An apparatus used in spinal surgery for creating a space of selected shape and dimensions across the disc space between two adjacent vertebrae of the spine, each of said vertebrae having an endplate adjacent to the disc space, said apparatus comprising:

20 an elongated body member dimensioned for accessing the spine from a position remote from the spine, said elongated body member having a front end, a rear end and accessing means for accessing the two adjacent vertebrae through said rear end and through said front end of said body member;

25 bone removal means for removing at least a portion of bone from each vertebral endplate adjacent the disc space, said bone removal means capable of accessing each vertebral endplate through said accessing means; and

30 guiding means for guiding and controlling the movement of an instrument placed within said accessing means, said guiding means associated in a moveable relationship with said front and rear ends of said

elongated body member.

5 80. The apparatus of claim 79 including an outer sleeve having a hollow tubular portion capable of supporting and containing at least a portion of said elongated body member.

10 81. The apparatus of claim 80 in which said outer sleeve is a combination outer sleeve and distractor in which said tubular portion comprises at least one distractor element extending from a first end of said tubular portion for insertion into the disc space between the two adjacent vertebrae.

15 82. The apparatus of claim 79 in which said rear end of said body member is positioned outside of a patient's body when said front end is placed against the spine.

20 83. The apparatus of claim 79 in which said accessing means is in a transverse orientation relative to said milling block, said accessing means having a transverse axis and said guiding means being oriented and capable of traveling along said transverse axis.

25 84. The apparatus of claim 79 in which said accessing means is a track for guiding said bone removal means.

30 85. The apparatus of claim 84 including at least one track guide in moveable relationship with said track for guiding said bone removal means.

86. The apparatus of claim 79 including depth limiting means for selecting and limiting the penetration depth of said bone removal means into the disc space.

5 87. The apparatus of claim 86 including means for locking said bone removal means at a selected penetration depth into the disc space.

10 88. The apparatus of claim 79 in which said bone removal means comprises a multi-toothed rotating cutter.

15 89. The apparatus of claim 79 in which said bone removal means comprises a cutting member having a cutting end and perimeter capable of cutting bone.

90. The apparatus of claim 89 in which said bone removal means comprises an end and side mill.

20 91. The apparatus of claim 79 in which said bone removal means comprises a drill.

25 92. The apparatus of claim 79 in which said bone removal means comprises a shaft portion having a first diameter and a cutting end having a second diameter, said second diameter being greater than said first diameter, whereby said bone removal means is capable of creating a space with retaining walls on the anterior and posterior aspects of the vertebral endplates.

30 93. The apparatus of claim 79 in which said bone removal means comprises an oscillating saw.

94. The apparatus of claim 79 in which said bone removal means is selected from the group including burrs, mills, router bits, abraders, grinders, rasps, drills, graters and saws.

5

95. The apparatus of claim 79 in which said bone removal means is selected from a group including, oscillating cutters, vibrating cutters, reciprocating cutters and orbital cutters.

10

96. The apparatus of claim 79 in which said bone removal means comprises a laser.

15

97. A surgical method for creating a space of selected shape and dimensions across a disc space between two adjacent vertebrae of the spine, each of the two adjacent vertebrae having an endplate adjacent to the disc space, comprising the steps of:

20

exposing the area of the spine to be operated upon;

25

placing at least a portion of a milling apparatus against at least one of the two adjacent vertebrae, said milling apparatus capable of holding the two adjacent vertebrae in a fixed position and having accessing means for accessing the two adjacent vertebrae through said milling apparatus, said milling apparatus including guiding means for guiding and controlling the motion of a bone removal means;

30

holding said milling apparatus against at least one of the two adjacent vertebrae; and

removing a portion of bone from the endplates of

the two adjacent vertebrae with said bone removal means utilizing said guiding means to guide said bone removal means in a selected path to create a space of selected shape and dimensions across the disc space and into the two adjacent vertebrae.

98. The surgical method of claim 97 including the step of distracting the two adjacent vertebrae in a selected spatial relationship to each other.

99. The surgical method of claim 98 in which the step of distracting includes preselecting the depth of excursion of a distractor means for insertion into the disc space and locking said preselected depth of excursion.

100. The surgical method of claim 98 including the step of attaching to said milling apparatus a distractor element selected for a length less than the depth of the disc space.

101. The surgical method of claim 98 including the step of determining the appropriate length of a distractor element and adjusting the length of the distractor to be less than the depth of the disc space.

102. The surgical method of claim 99 including the step of coupling said distractor means to said milling apparatus.

103. The surgical method of claim 97 in which the step of removing bone from said endplates includes preselecting the optimal depth of excursion of the bone removal means into



the disc space.

104. The surgical method of claim 97 in which the step of removing a portion of bone from the endplates includes  
5 accessing the adjacent vertebrae through said accessing means.

105. The surgical method of claim 97 including the step of inserting at least one spinal implant into said created  
10 space.

106. The surgical method of claim 97 including the step of inserting at least one bone graft into said created space.

15 107. The surgical method of claim 97 including the step of inserting at least one fusion implant into said created space.

20 108. The surgical method of claim 97 including the step of inserting at least one artificial disc into said created space.

25 109. The surgical method of claim 97 including the step of securing said milling apparatus to at least one of the two adjacent vertebrae.

30 110. The surgical method of claim 97 in which the step of removing a portion of bone from the endplates includes the step of moving the bone removal means at an angle relative to the plane of the endplates to remove an angular portion of bone from each of the endplates creating an angular-

shaped opening.

111. The surgical method of claim 97 in which said milling apparatus includes a separable milling block having  
5 separable first and second members, said surgical method including the steps of dissociating said first member from said second member, said second member remaining held against at least one of the two adjacent vertebrae keeping the adjacent vertebrae distracted while inserting at least  
10 one implant into the disc space through said accessing means.

112. The surgical method of claim 97 including the step of placing a hollow tubular member having one end in contact  
15 with at least a portion of at least one of the two adjacent vertebrae, said hollow tubular member capable of supporting and containing at least a portion of said milling apparatus; and inserting at least a portion of said milling apparatus through said hollow tubular member.

20  
113. The surgical method of claim 112 in which said hollow tubular member has at least one distractor element extending from said one end for insertion into the disc space, using said distractor element to distract said two  
25 vertebrae in a selected spatial relationship to each other.

114. The surgical method of claim 97 including the steps of approaching the human spine from the posterior aspect of the two adjacent vertebrae; retracting the dural sac and  
30 nerve roots; placing against the spine a hollow tubular member capable of supporting and containing at least a

portion of said milling apparatus, said hollow tubular member having one end in contact with at least a portion of the posterior aspect of the two adjacent vertebrae; and inserting into said hollow tubular member at least a portion of said milling apparatus.

115. The surgical method of claim 114 in which said milling apparatus comprises an elongated body member, said surgical method including the step of placing at least a portion of said elongated body member into said hollow tubular member.

116. The surgical method of claim 97 including the step of inserting a laparoscope into the human body for viewing at least a portion of the spine during at least a portion of said surgical method.

117. A power bone removal apparatus for use in human spinal surgery for creating a space across the disc space between two adjacent vertebrae of the spine, said bone removal apparatus comprising:

a bone cutting element capable of removing bone from the two vertebrae adjacent the disc space;

powered driving means for driving said bone cutting element, said power driving means having a driving end for imparting motion to said cutting element; and

length limiting means for selecting and limiting the penetration depth of said cutting element into the adjacent vertebrae and into the depth of the disc space between the two adjacent vertebrae, said length limiting means being associated with said driving end and remaining

stationarily fixed to said driving end while said cutting element is in motion.

5 118. The bone removal apparatus of claim 117 including means for locking said cutting element at a selected penetration depth into the disc space.

10 119. The bone removal apparatus of claim 117 including calibration means for selecting the penetration depth of said cutting element into the disc space.

120. The bone removal apparatus of claim 117 in which said cutting element is a multi-toothed rotating cutter.

15 121. The apparatus of claim 117 in which said cutting element has a cutting end and perimeter capable of cutting bone.

20 122. The bone removal apparatus of claim 121 in which said cutting element an end-side mill.

123. The bone removal apparatus of claim 120 in which said cutting element is a drill.

25 124. The bone removal apparatus of claim 120 in which said cutting element is selected from the group including burrs, mills, router bits, abraders, grinders, rasps, drills, and graters.

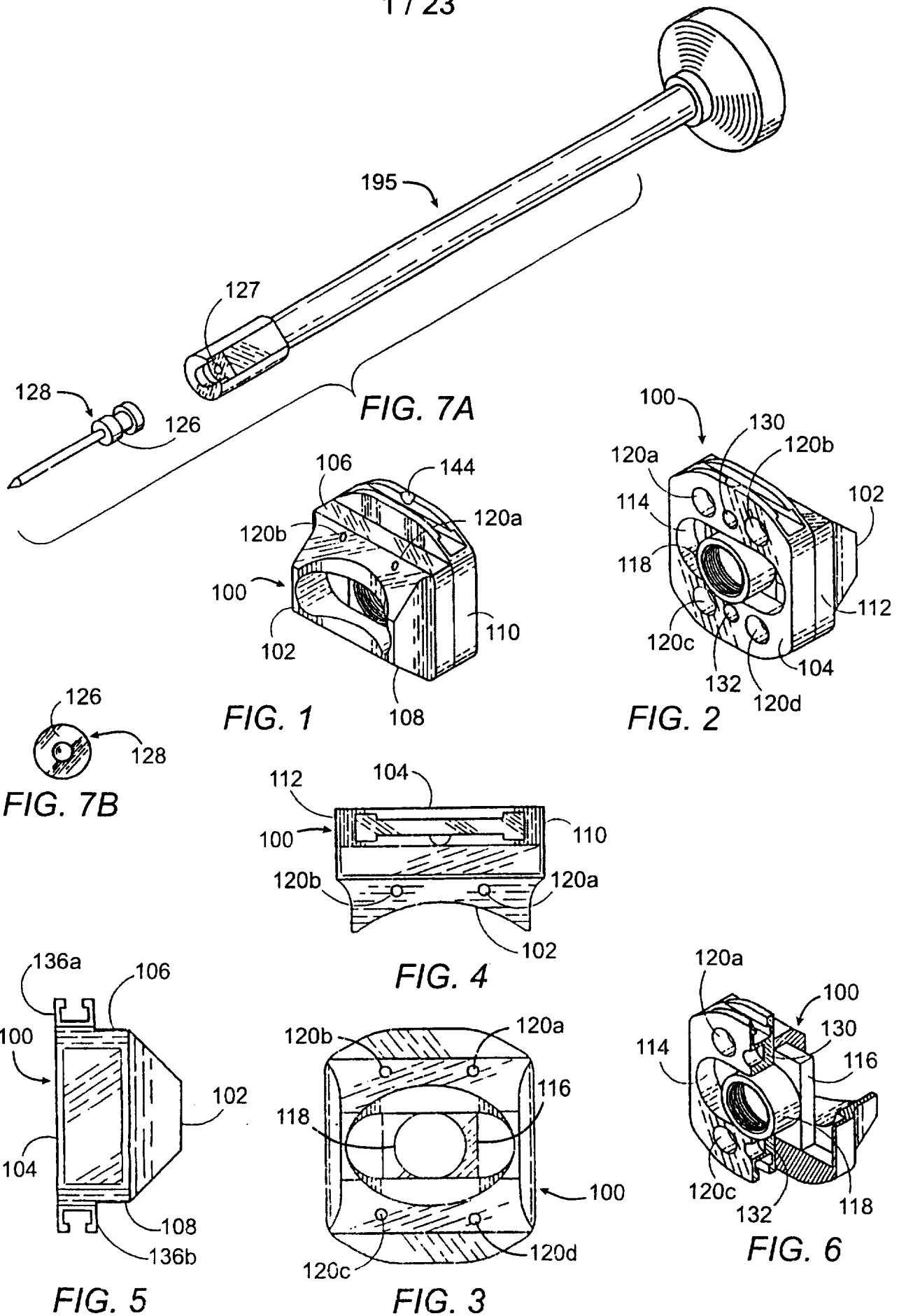

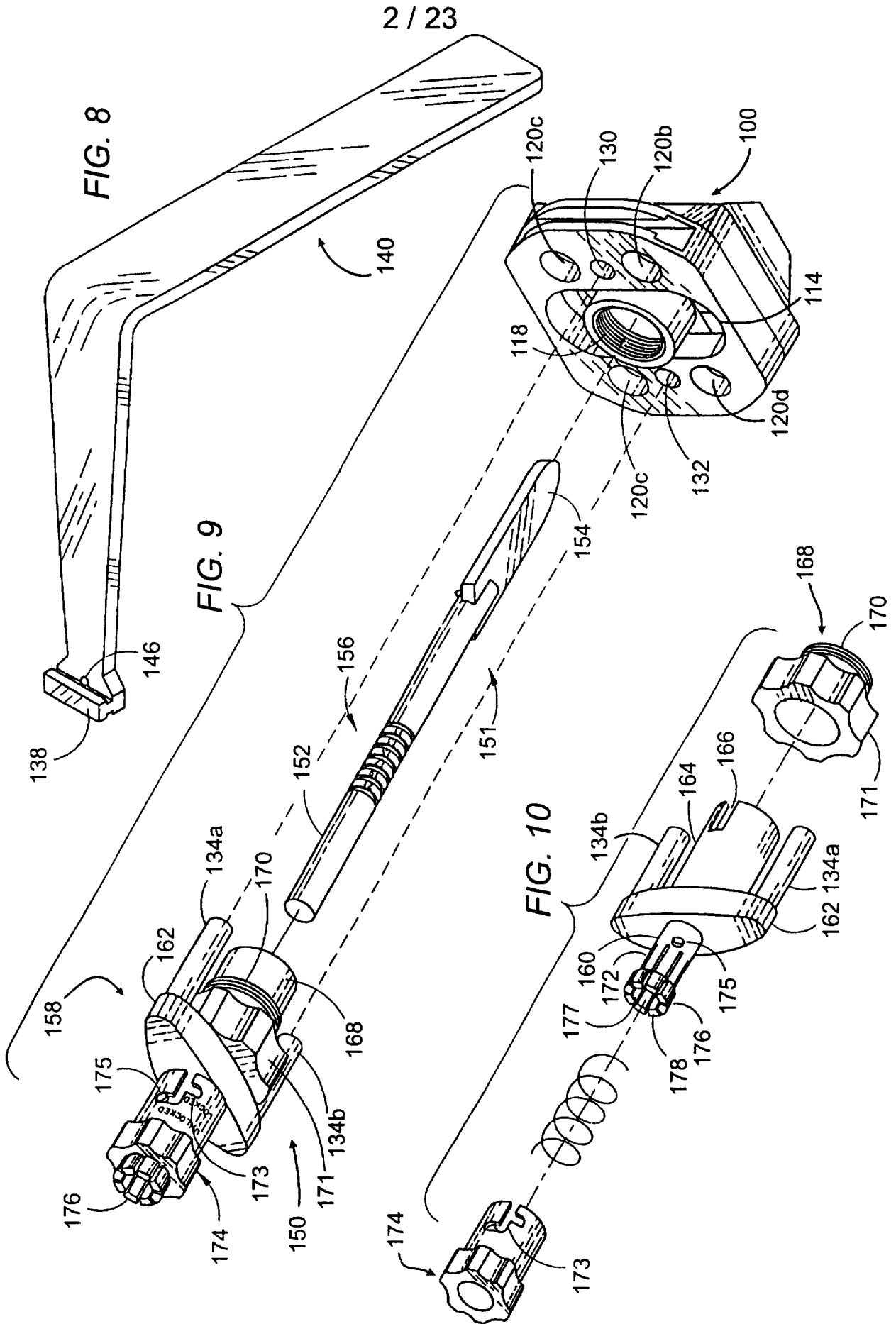

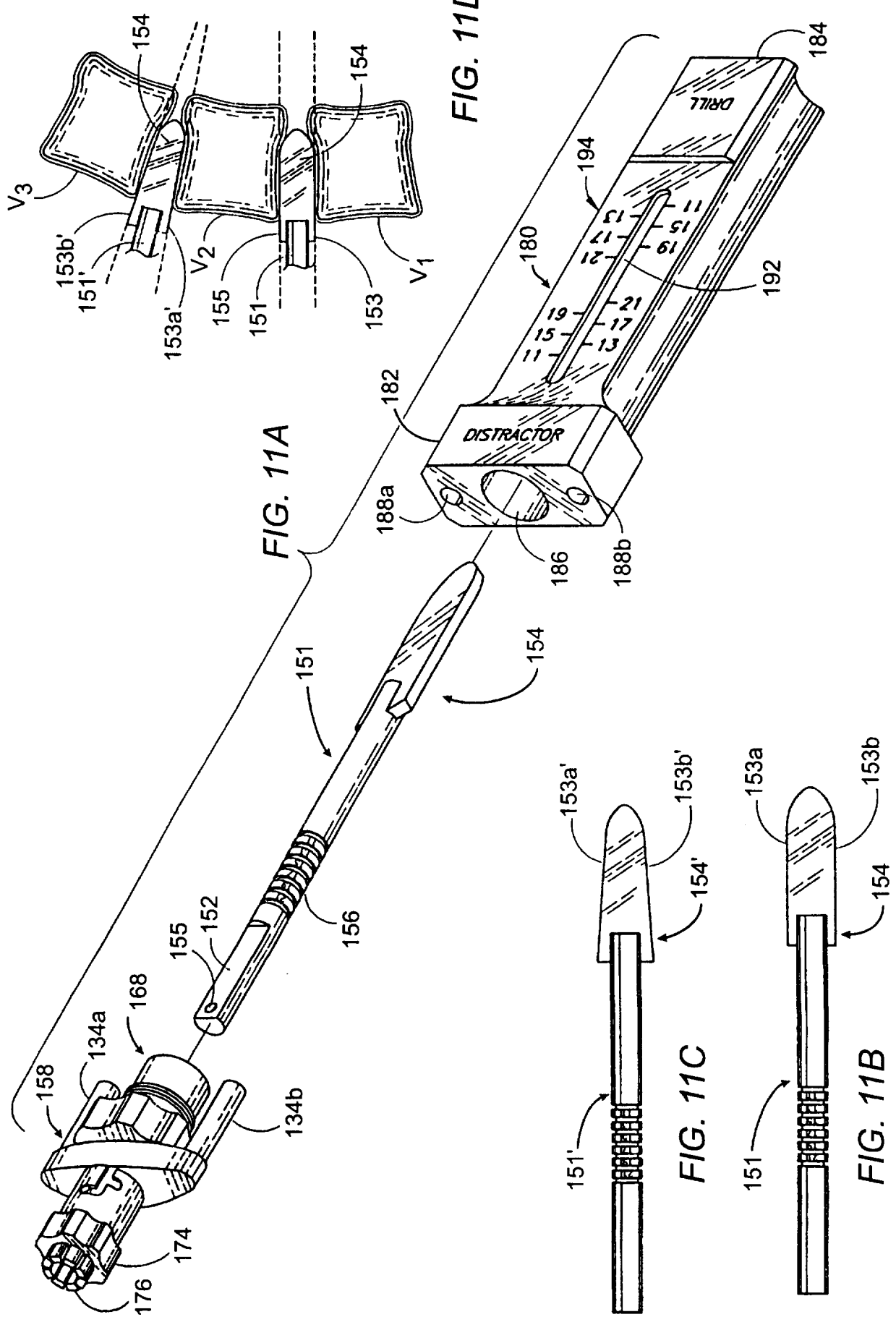

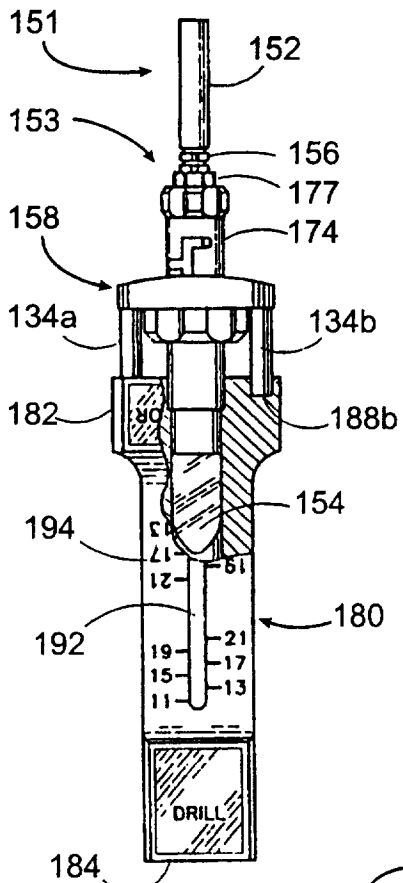

FIG. 12

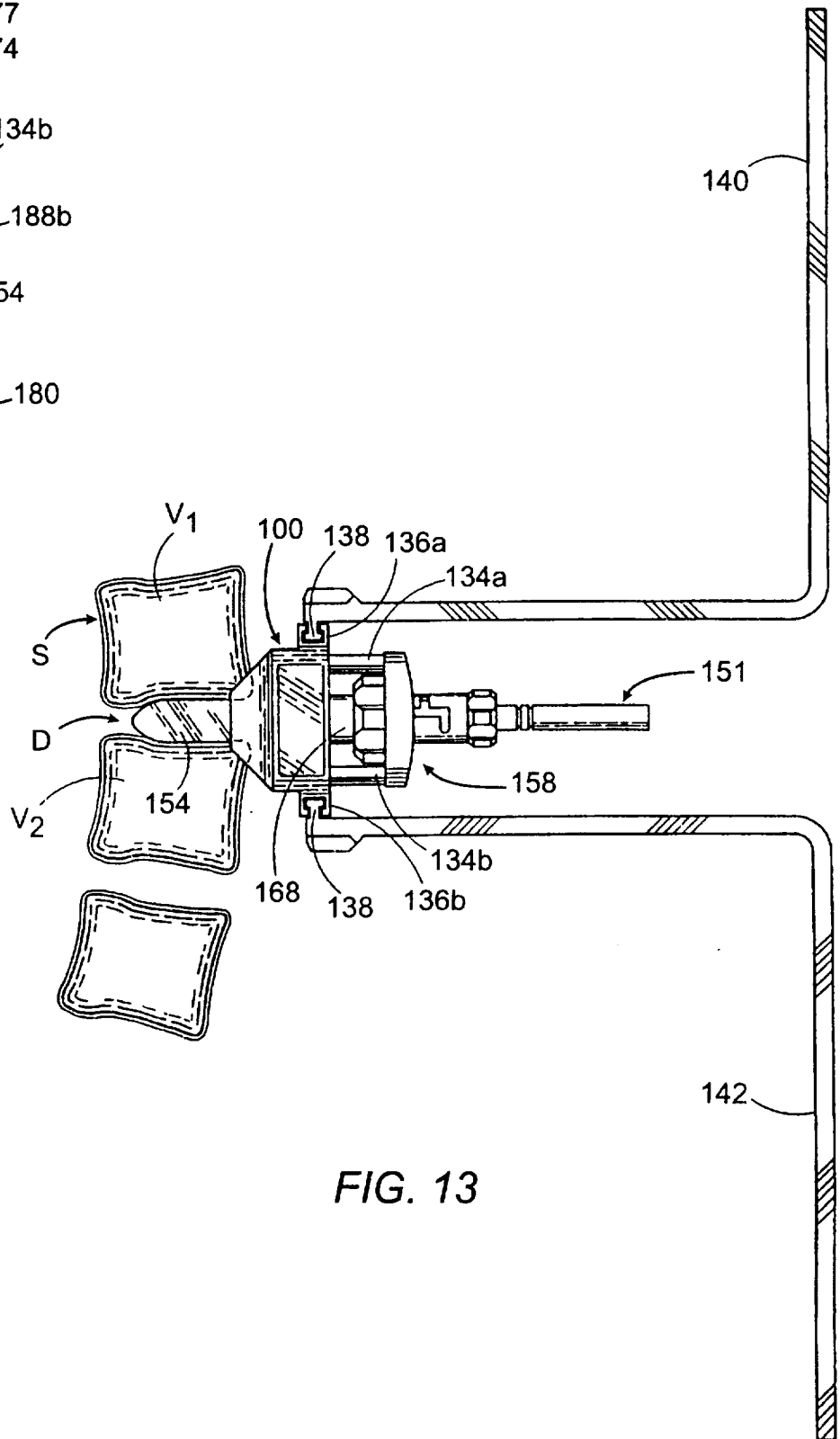

FIG. 13



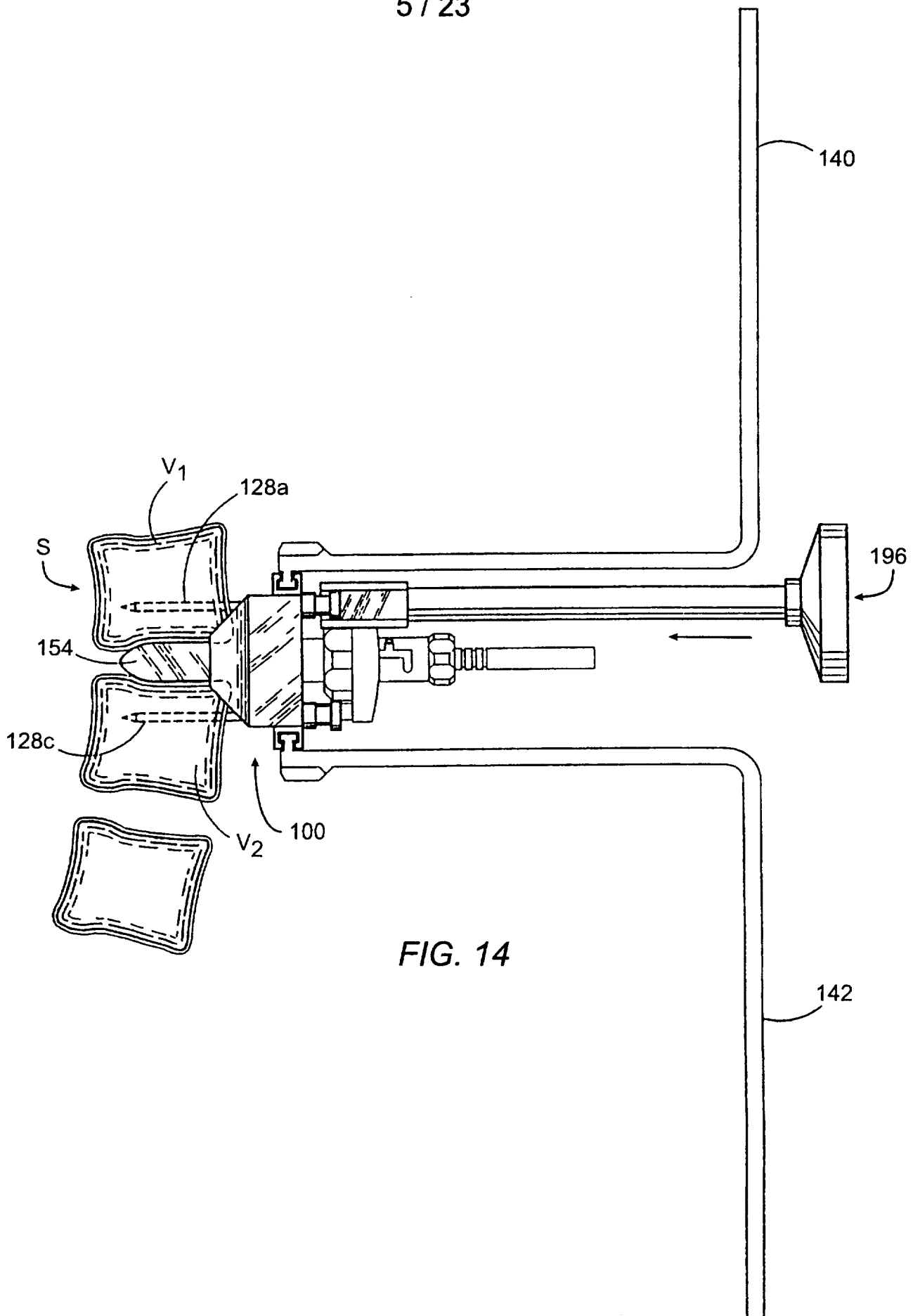
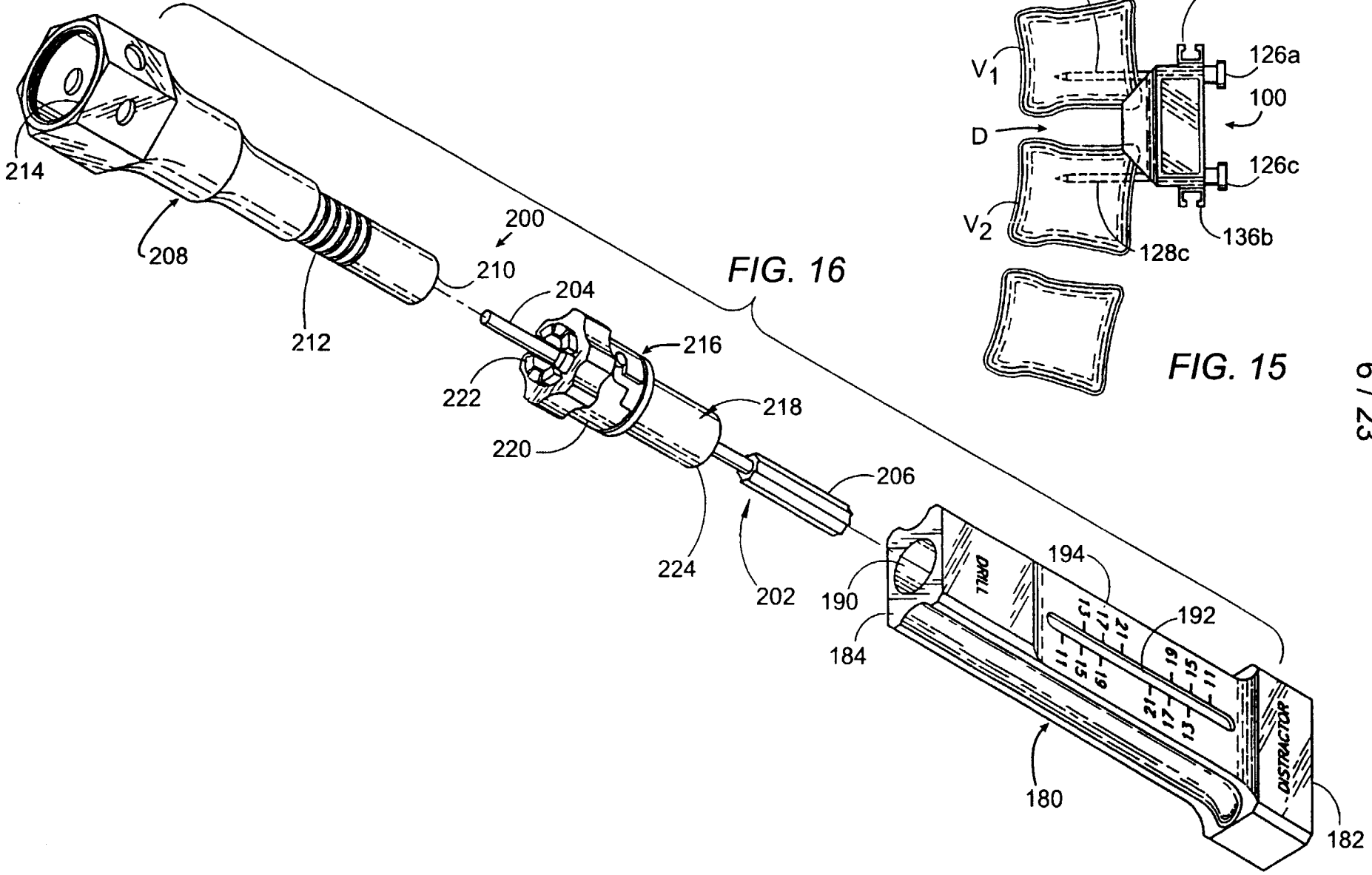
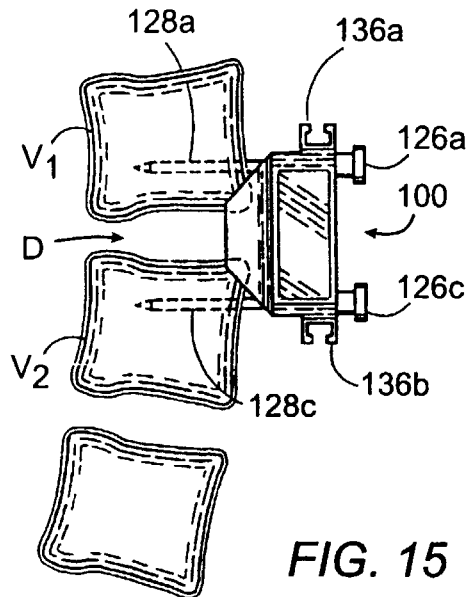

FIG. 14



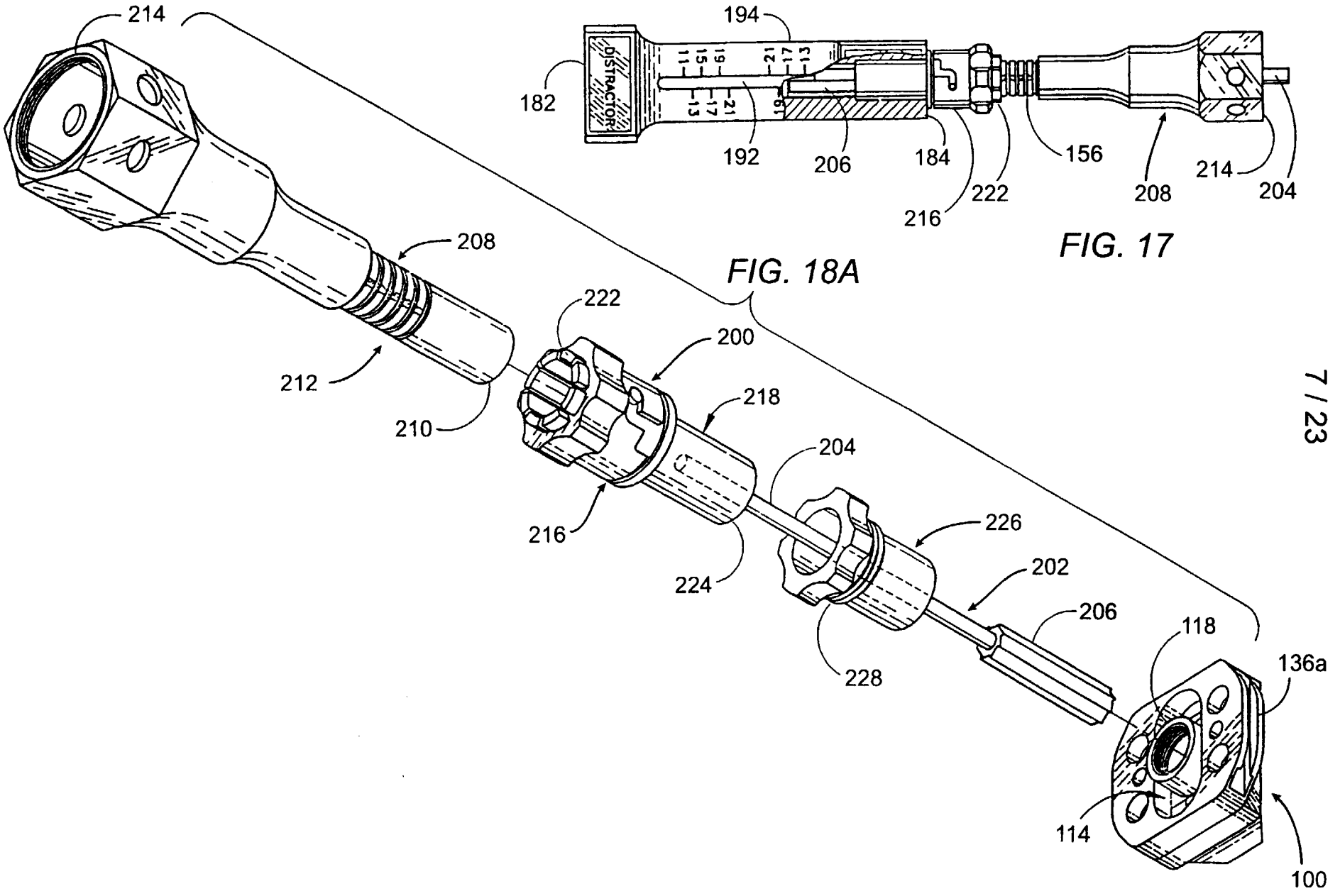
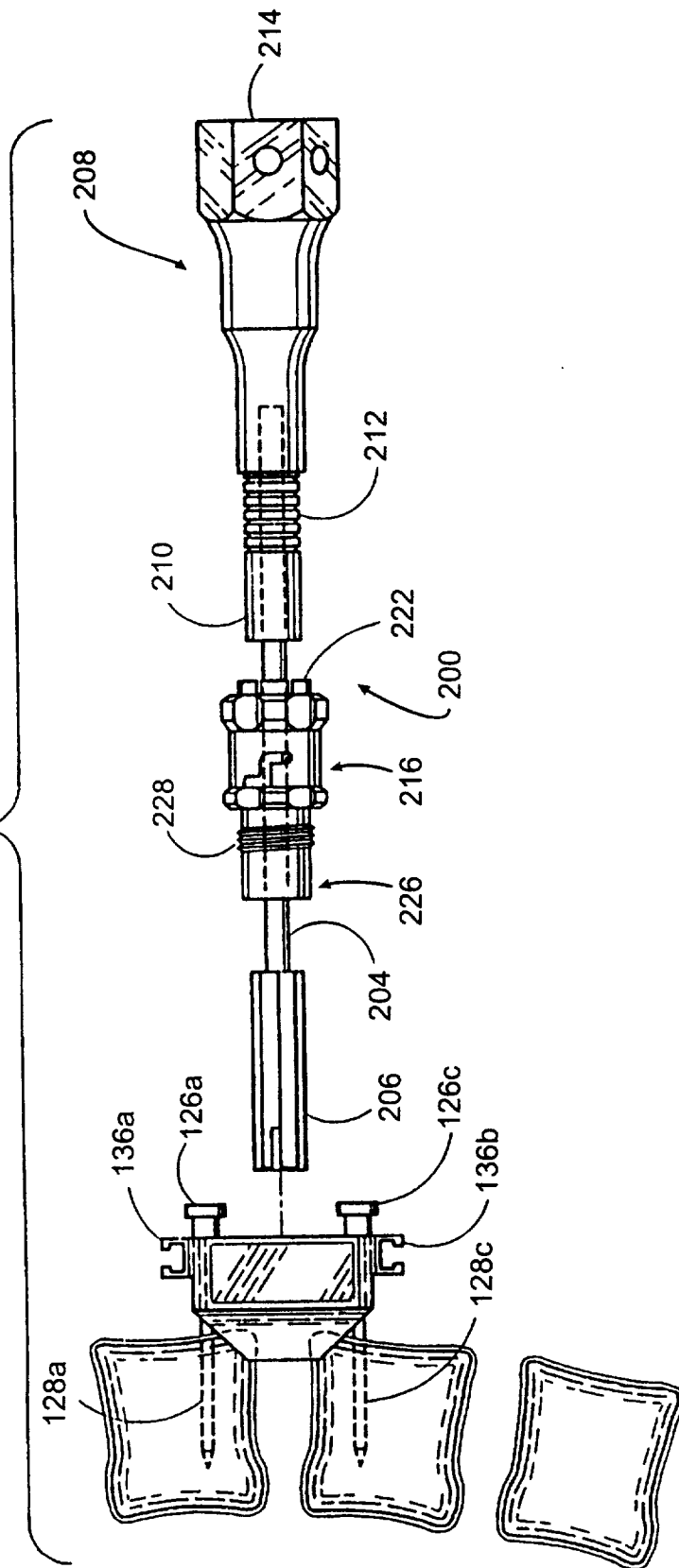

FIG. 18B



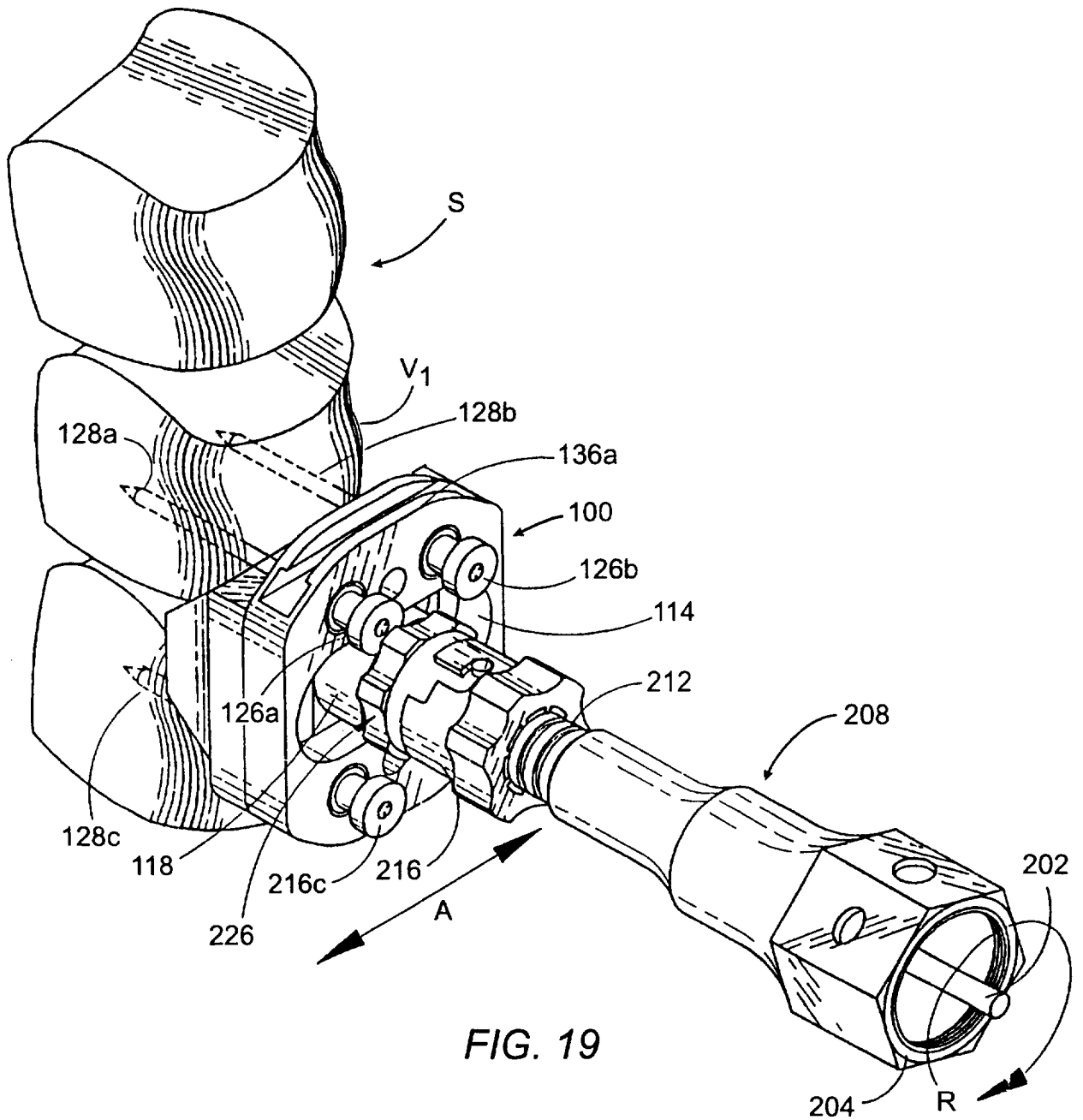

FIG. 19

PRIOR ART

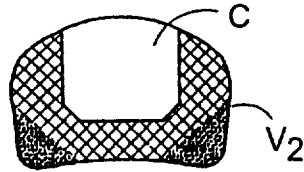

FIG. 26

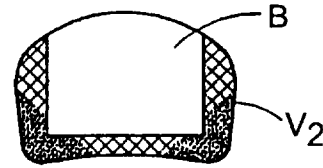

FIG. 22

PRIOR ART

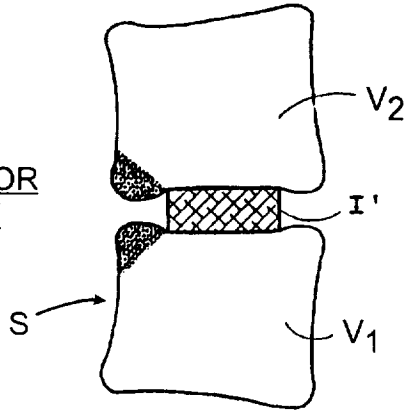

FIG. 24

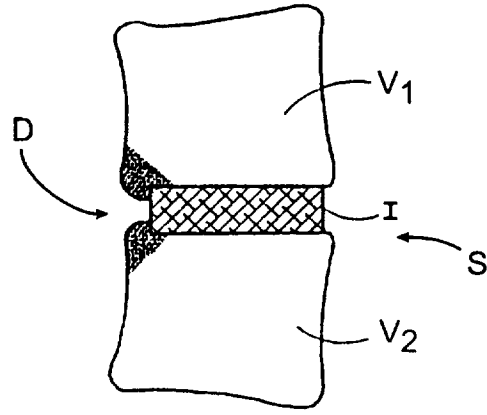

FIG. 20

PRIOR ART

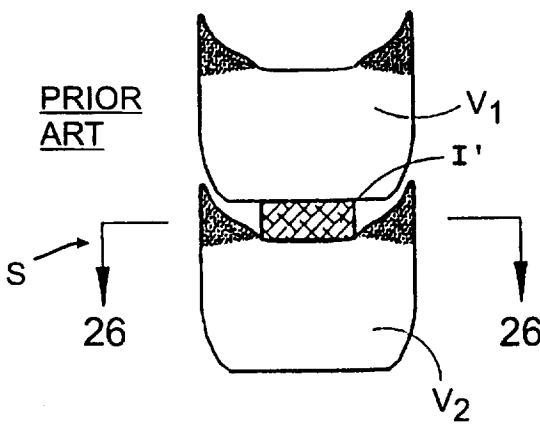

FIG. 25

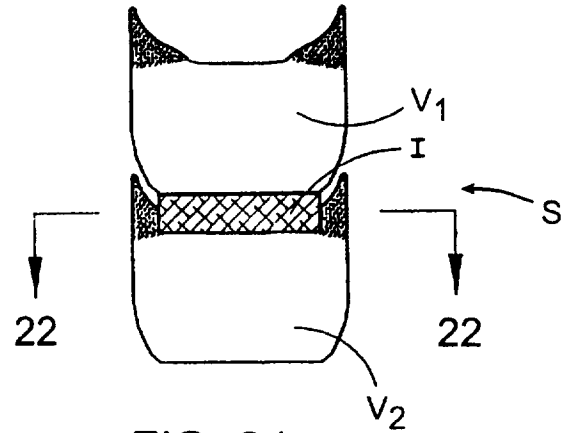

FIG. 21

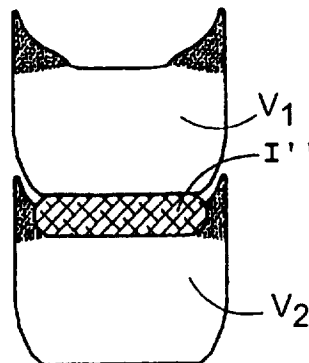

FIG. 23

11 / 23

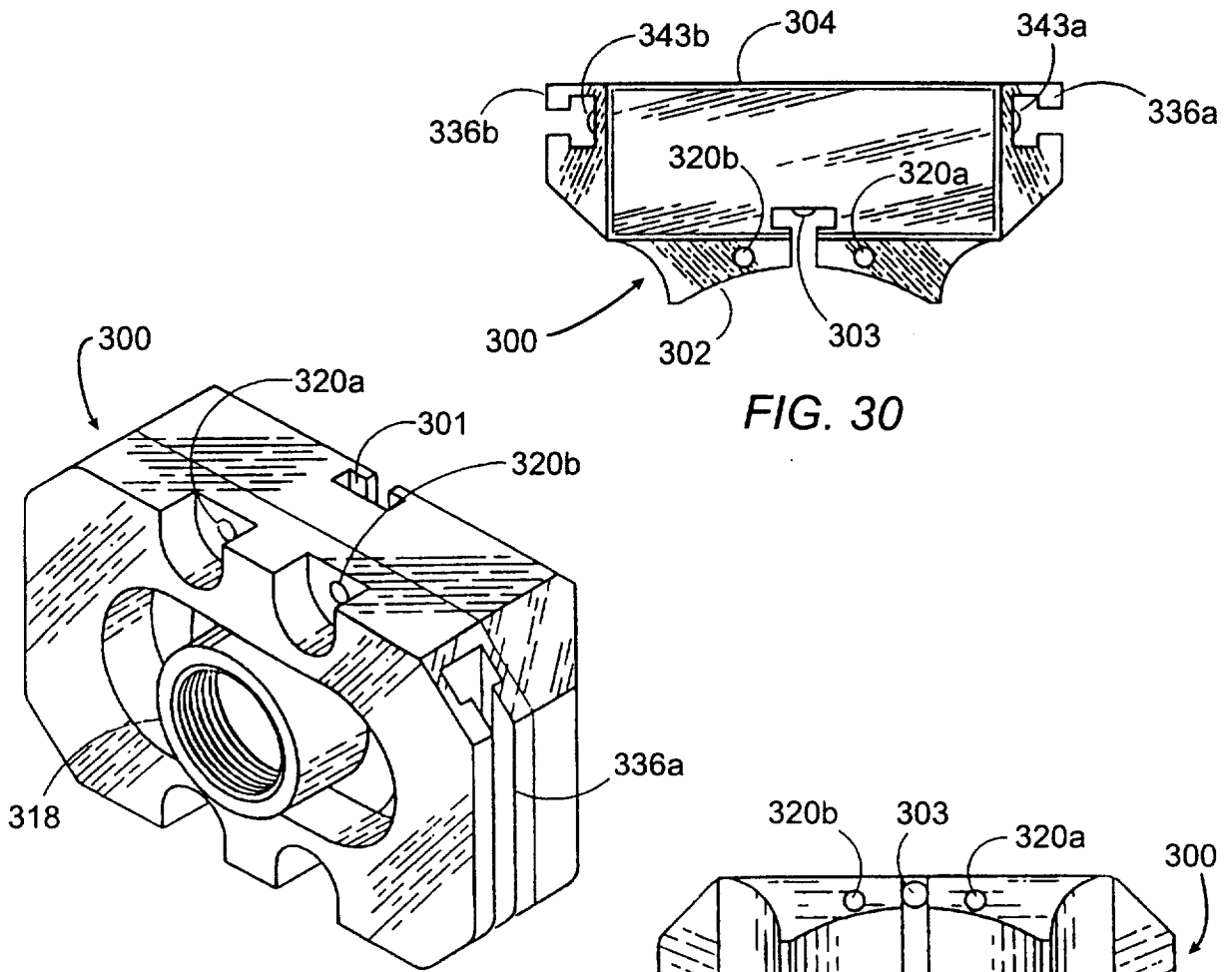

FIG. 27

FIG. 30

FIG. 29

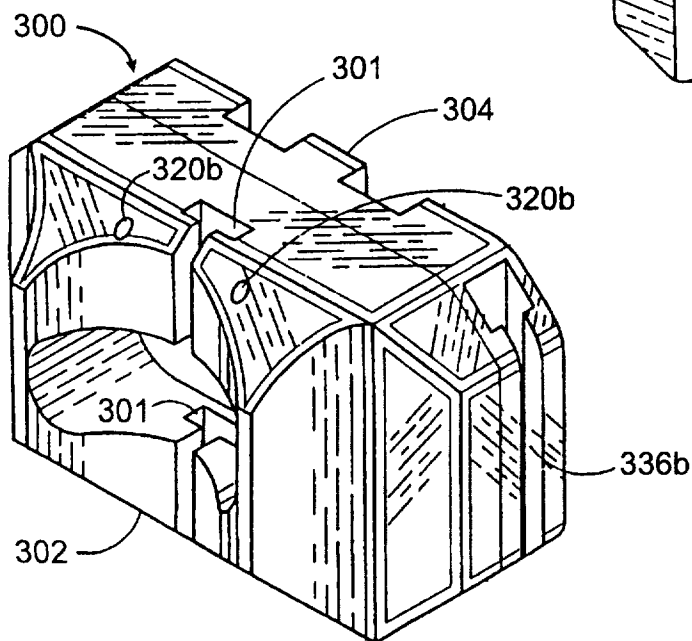

FIG. 28

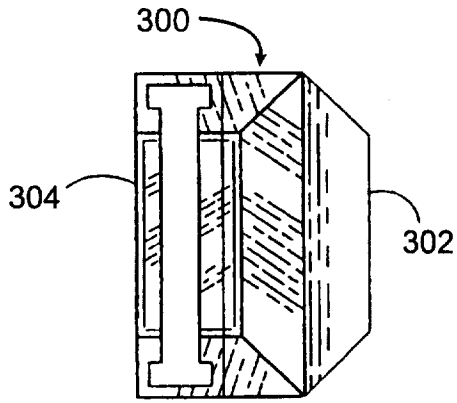

FIG. 31

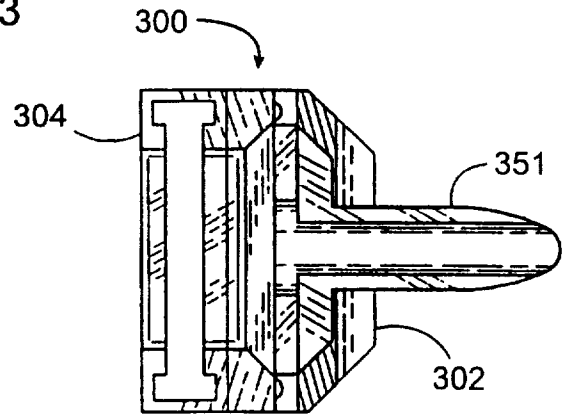

FIG. 32

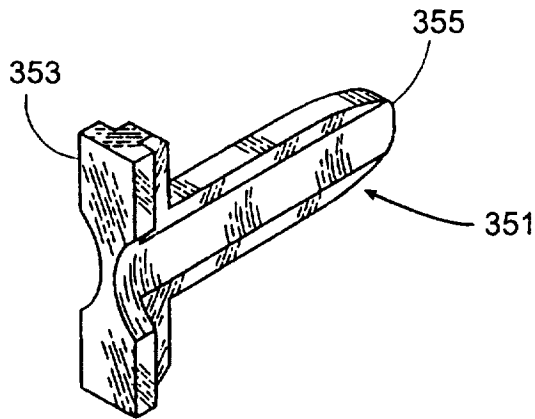

FIG. 33

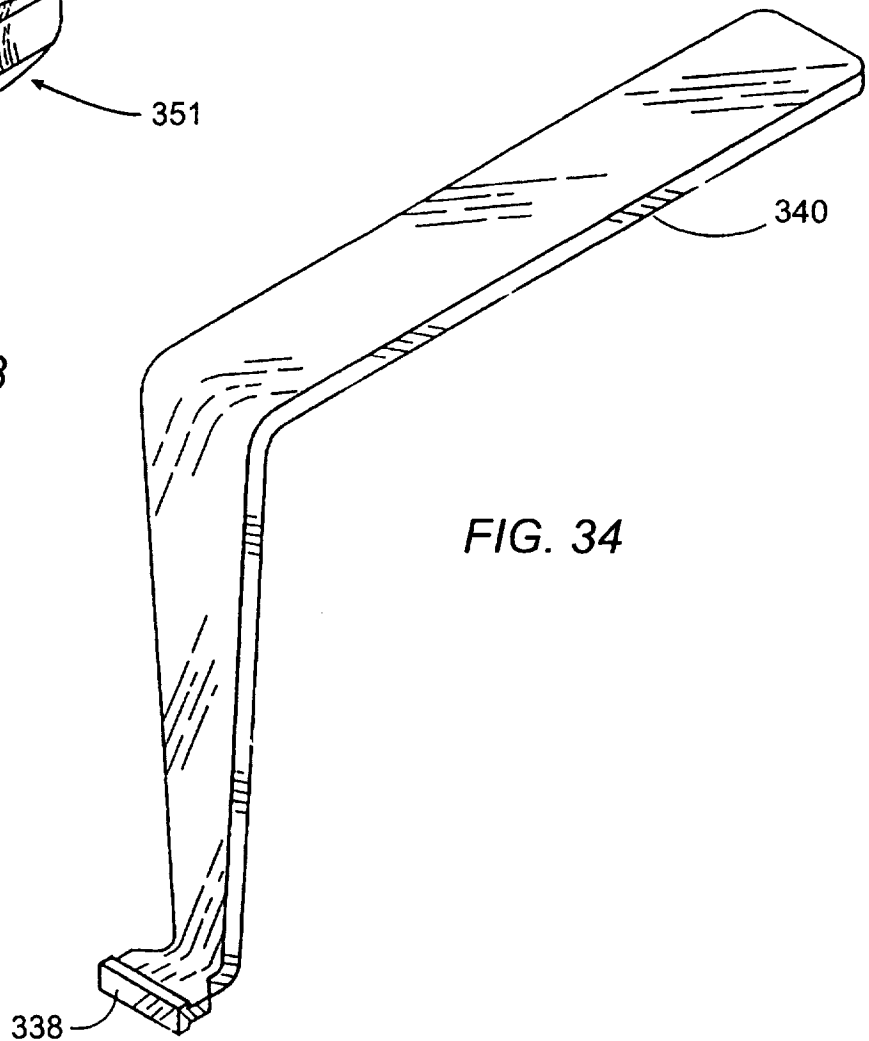

FIG. 34



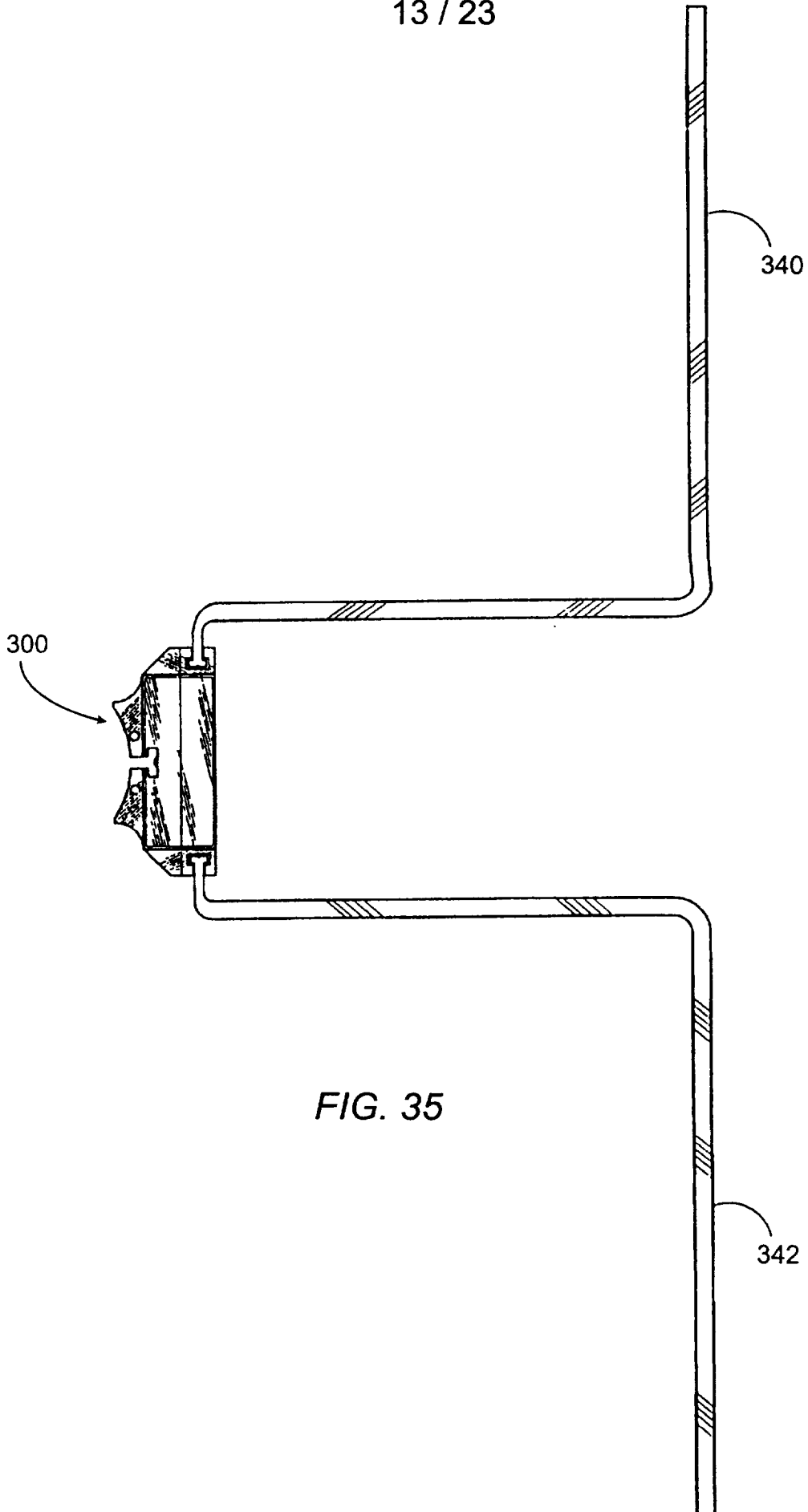

FIG. 35

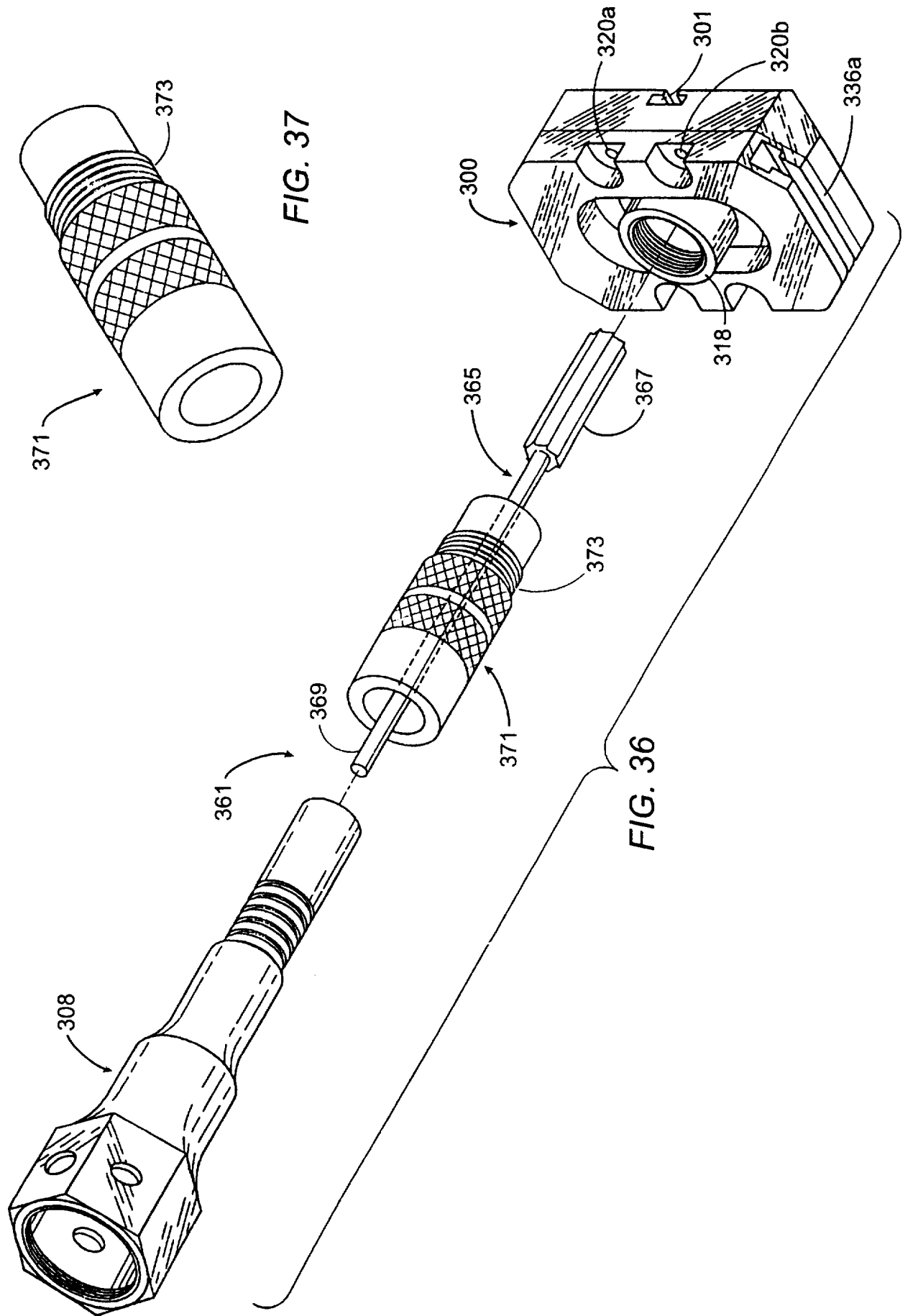

FIG. 37

FIG. 36

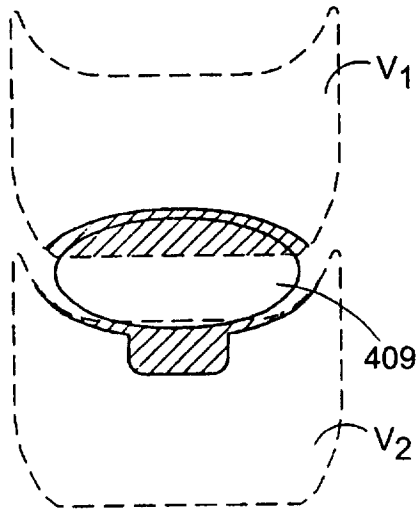

FIG. 45

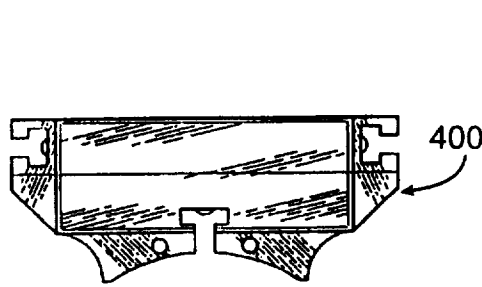

FIG. 40

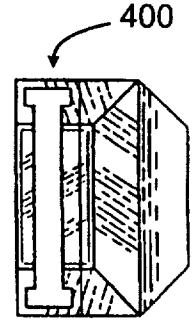

FIG. 41

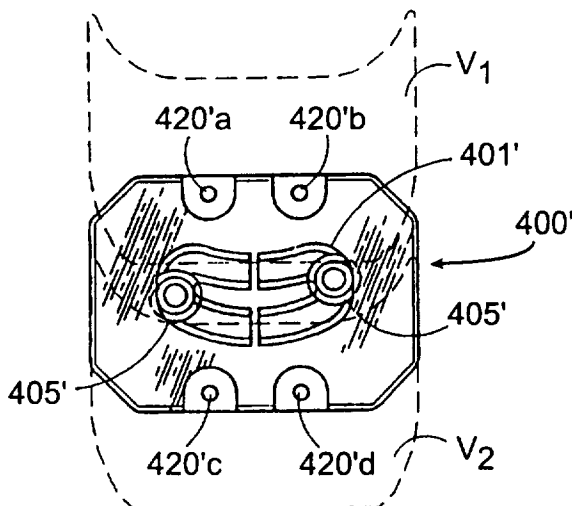

FIG. 43

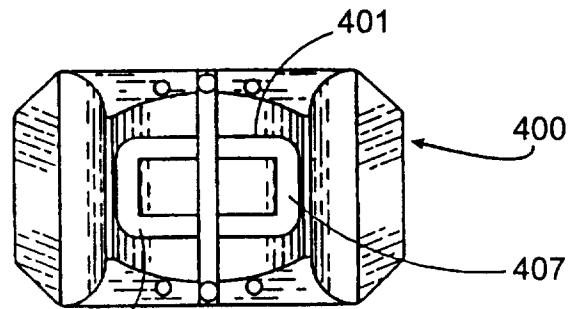

FIG. 38

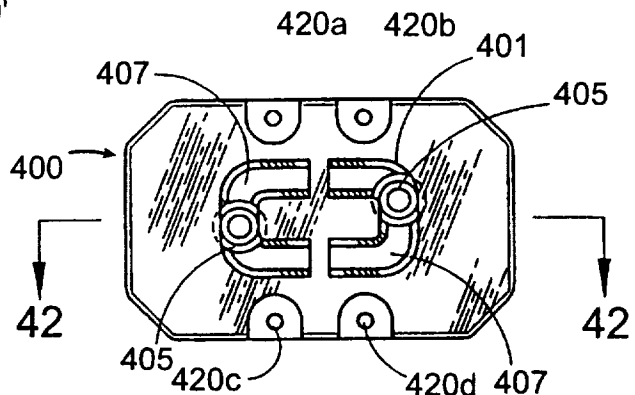

FIG. 39

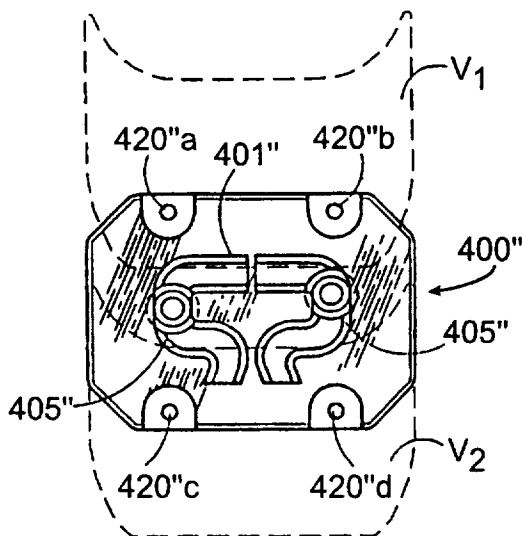

FIG. 44

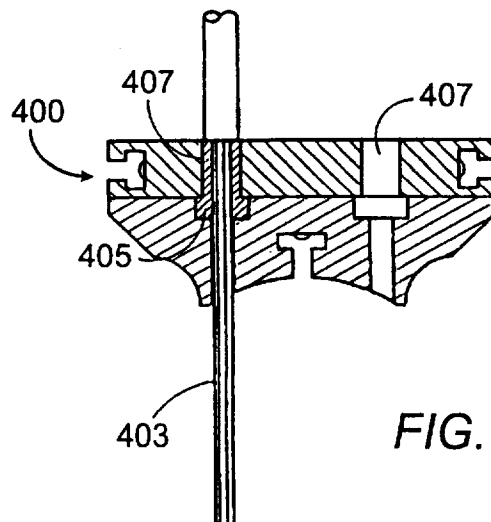

FIG. 42

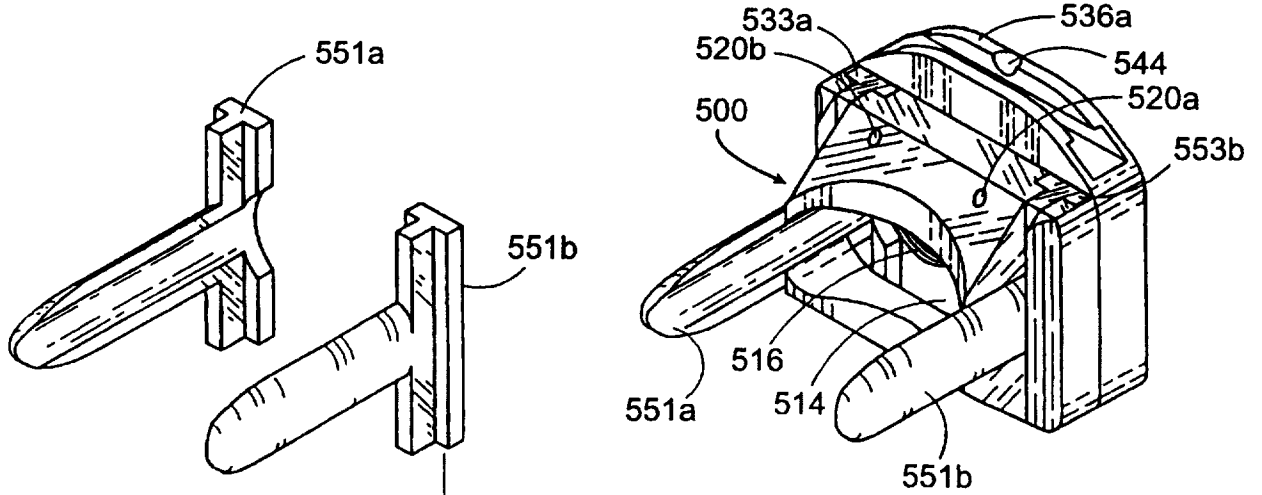

FIG. 46

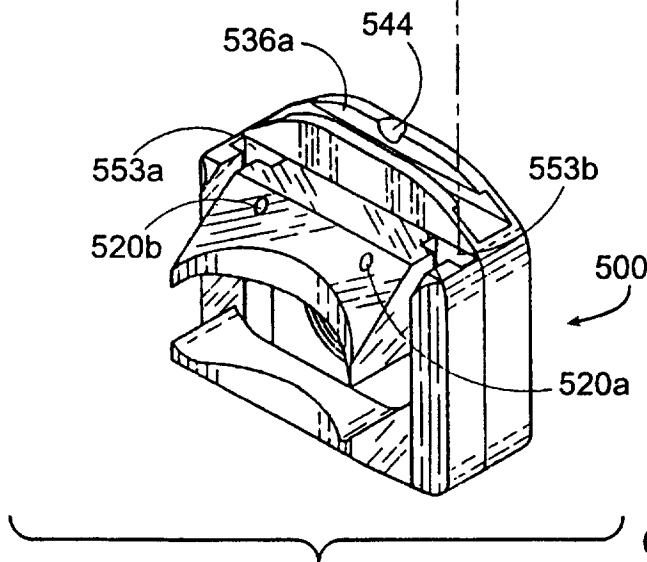

FIG. 47

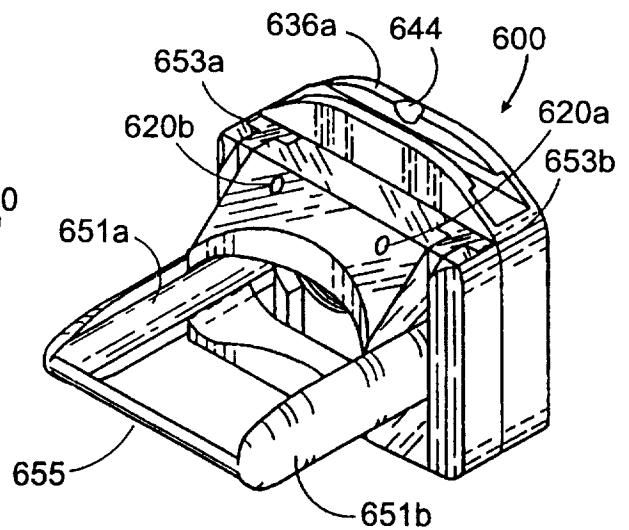

FIG. 48

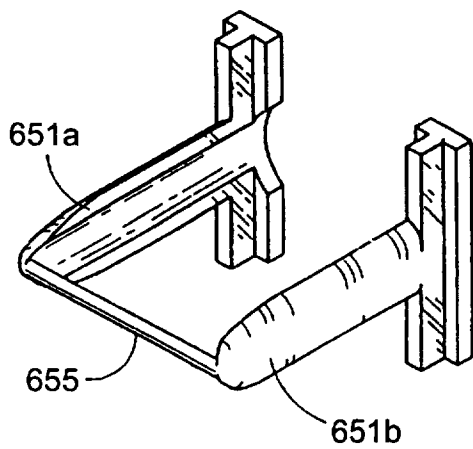

FIG. 49

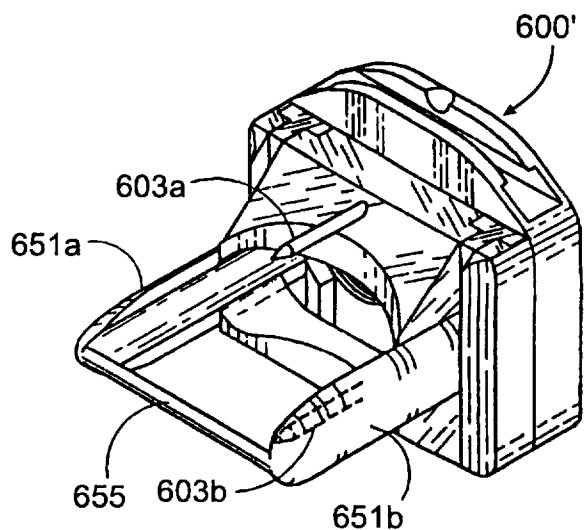
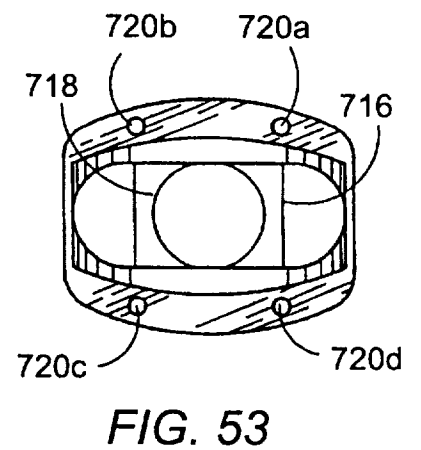
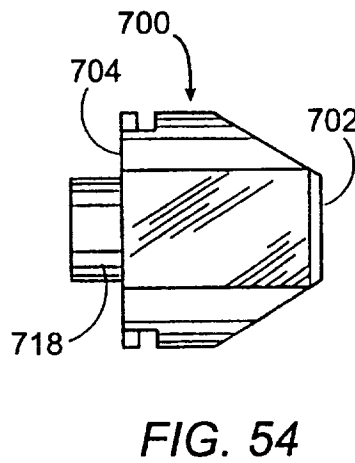
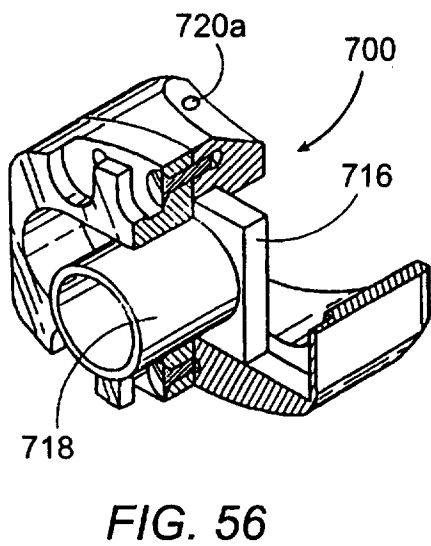
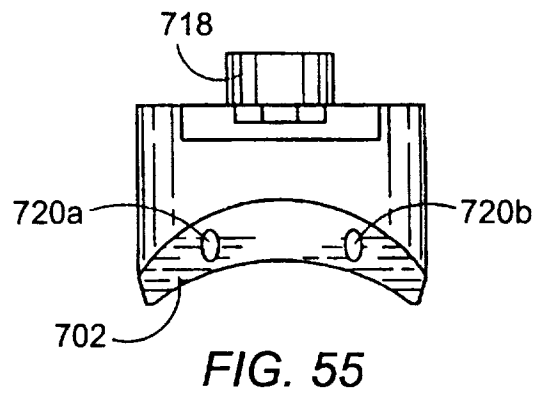
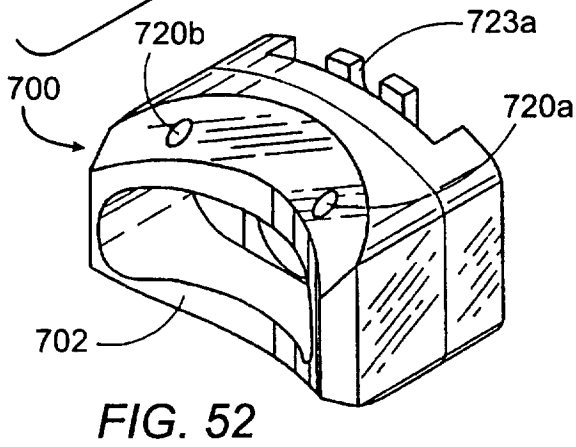
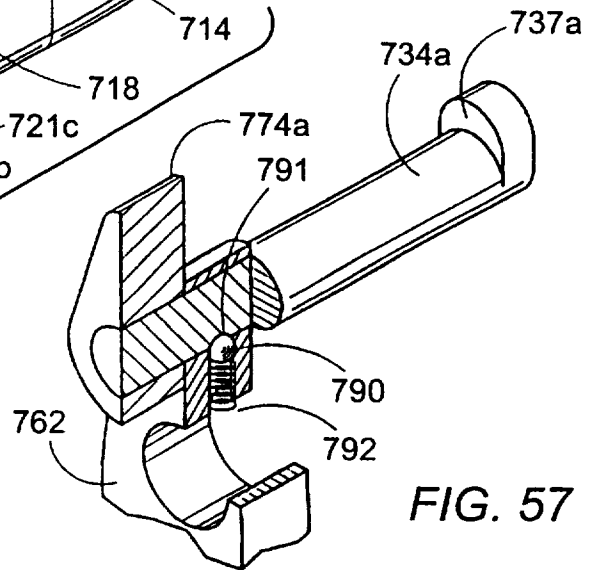
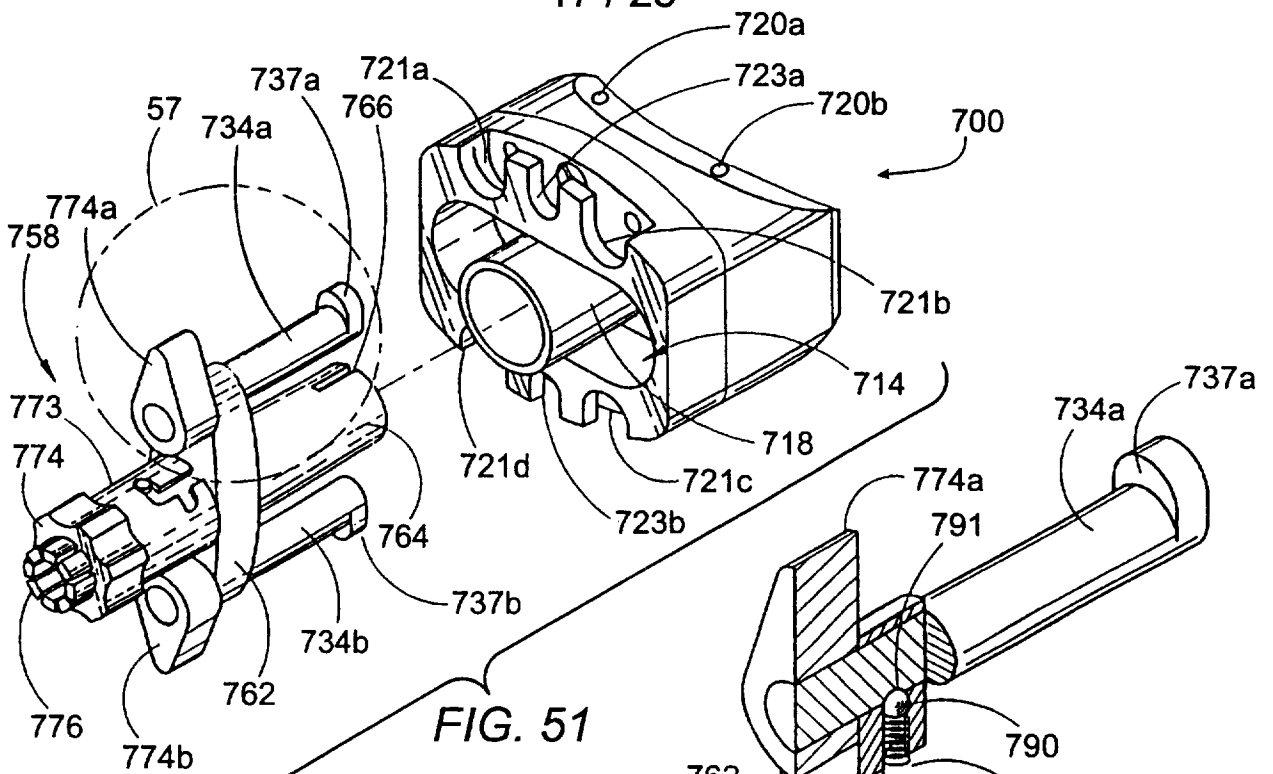
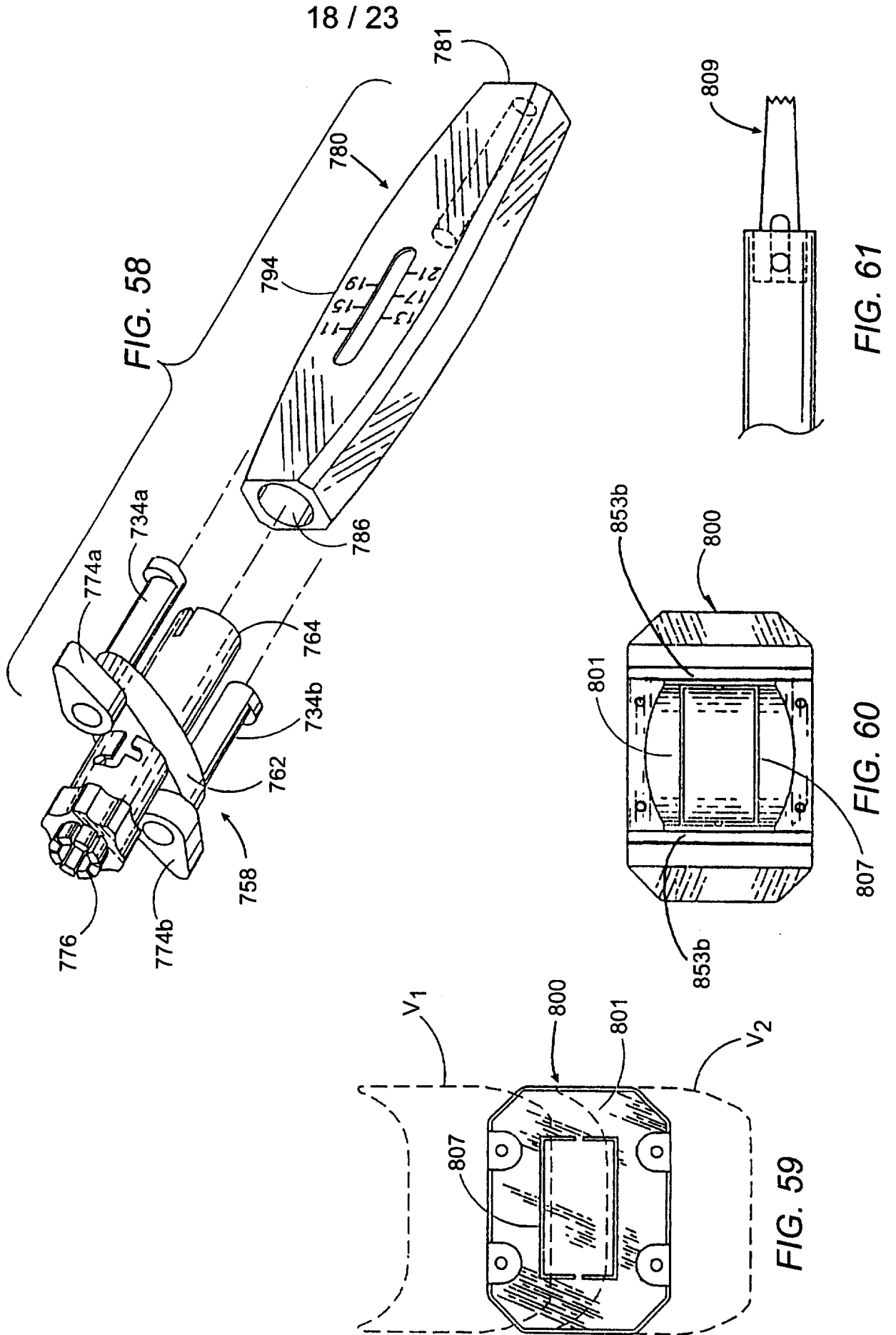

FIG. 50

17 / 23





19 / 23

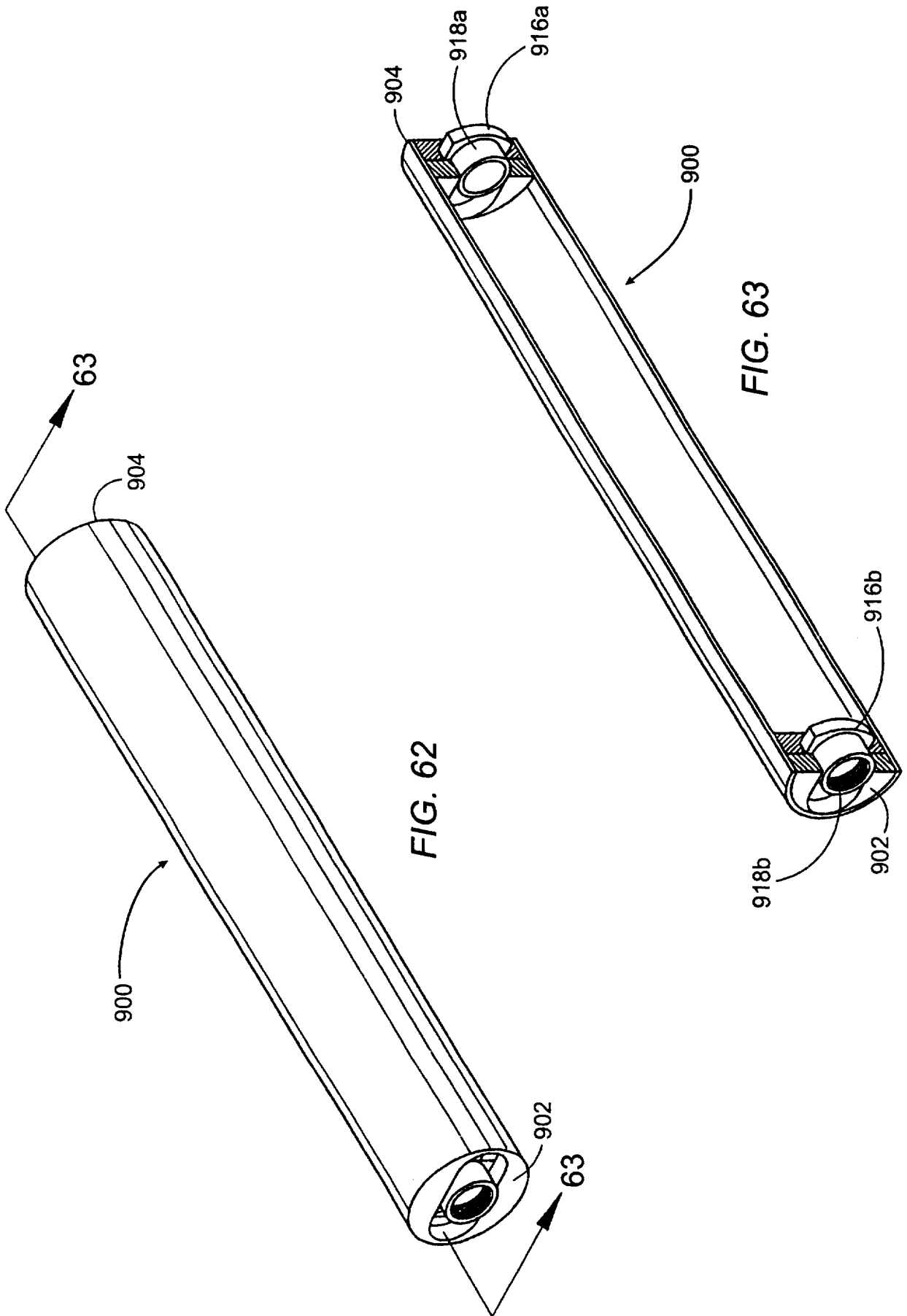

FIG. 62

FIG. 63

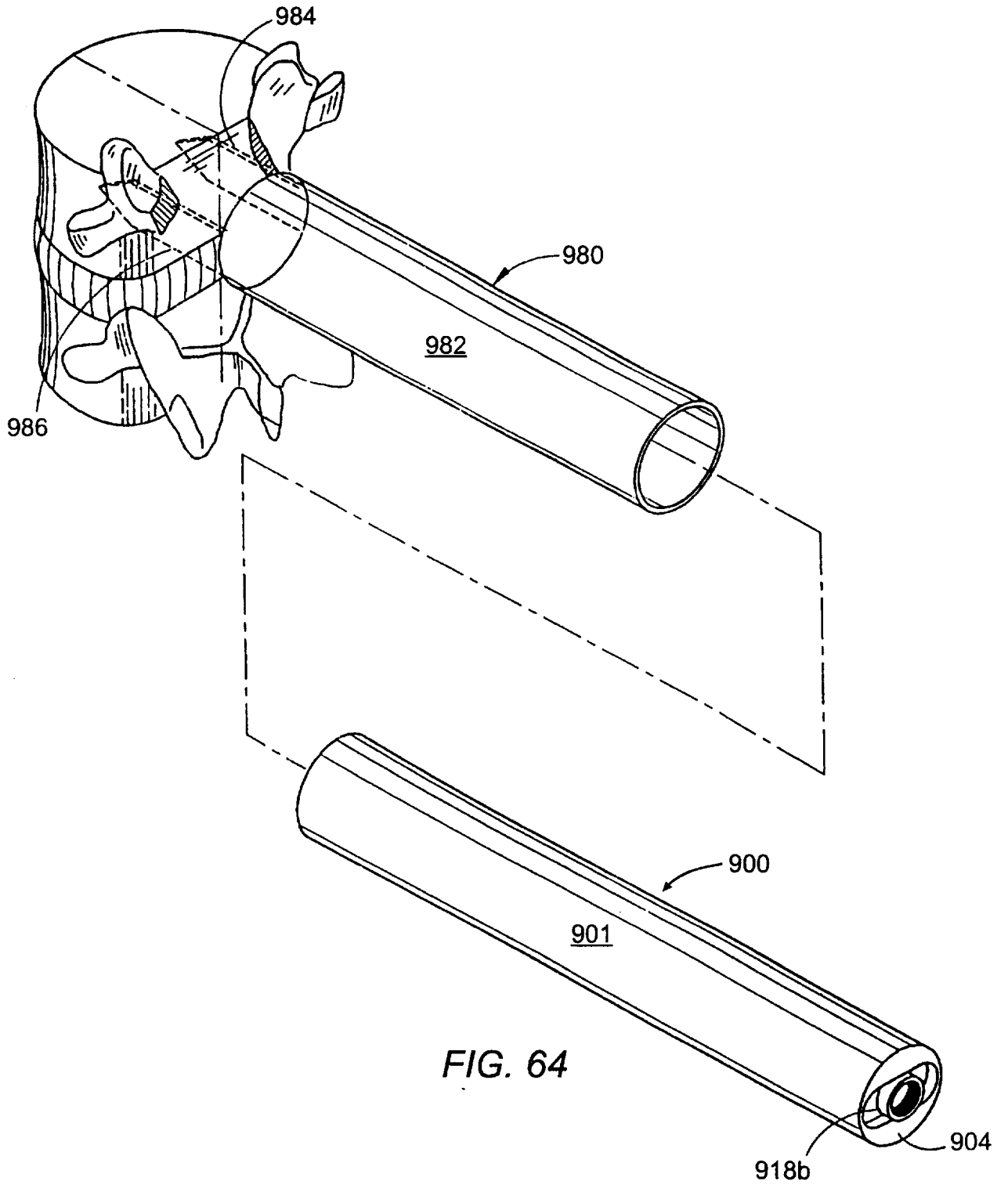

FIG. 64



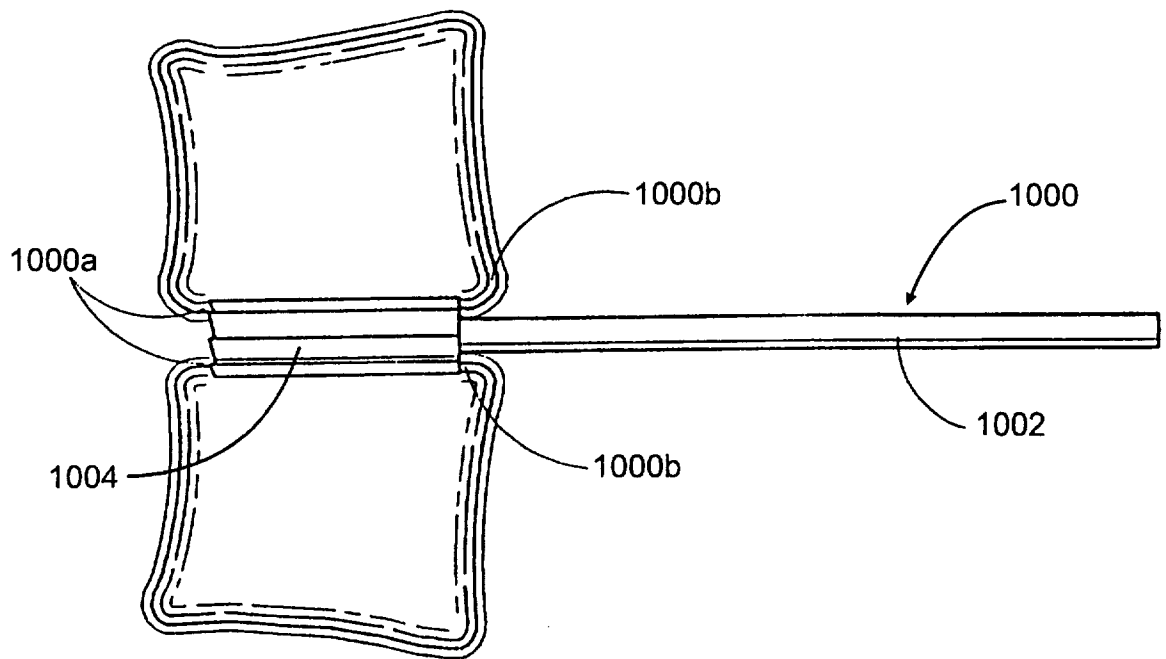

FIG. 65

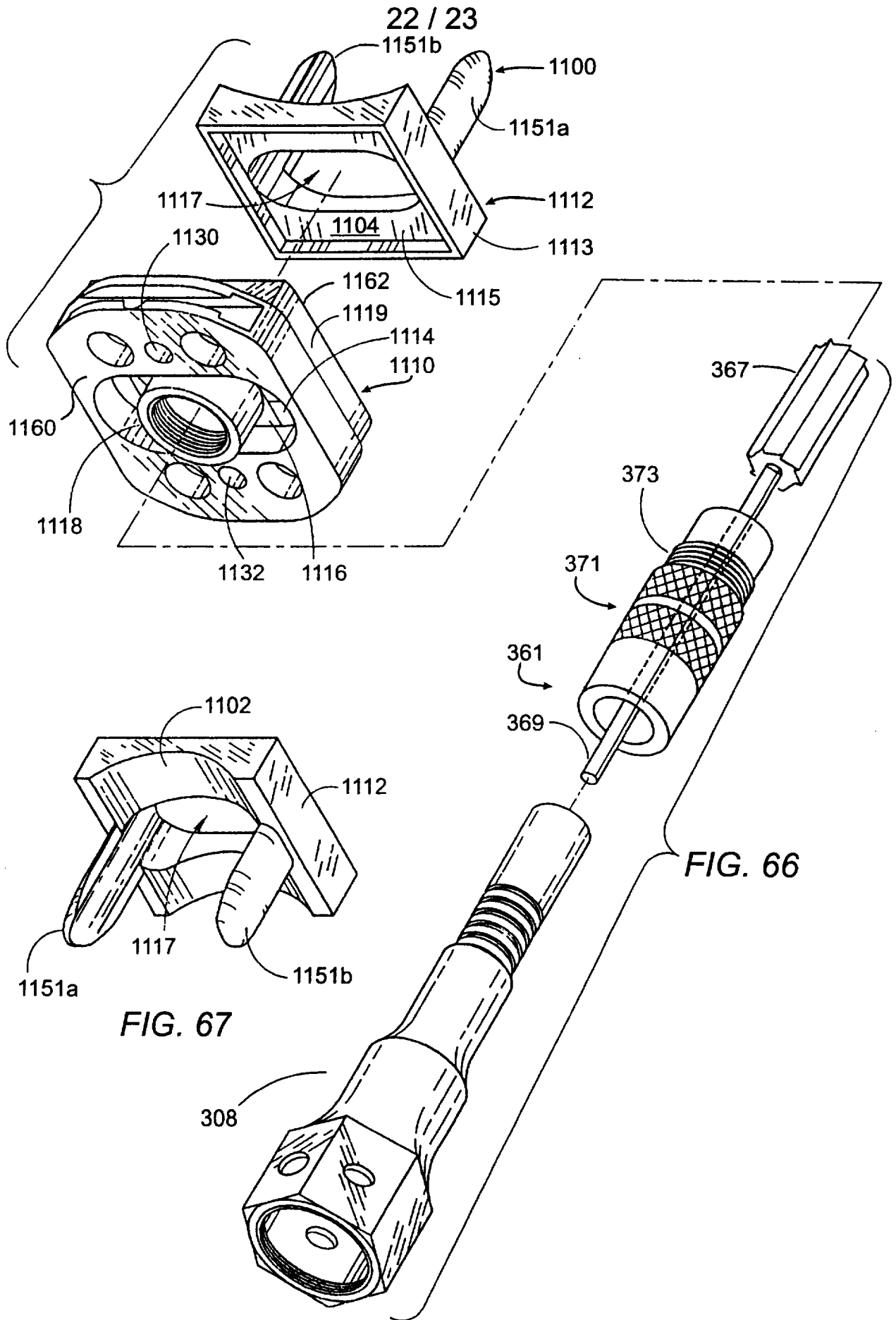

FIG. 68

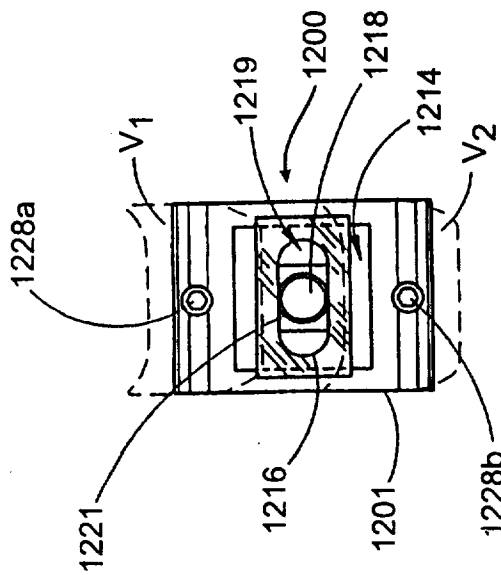
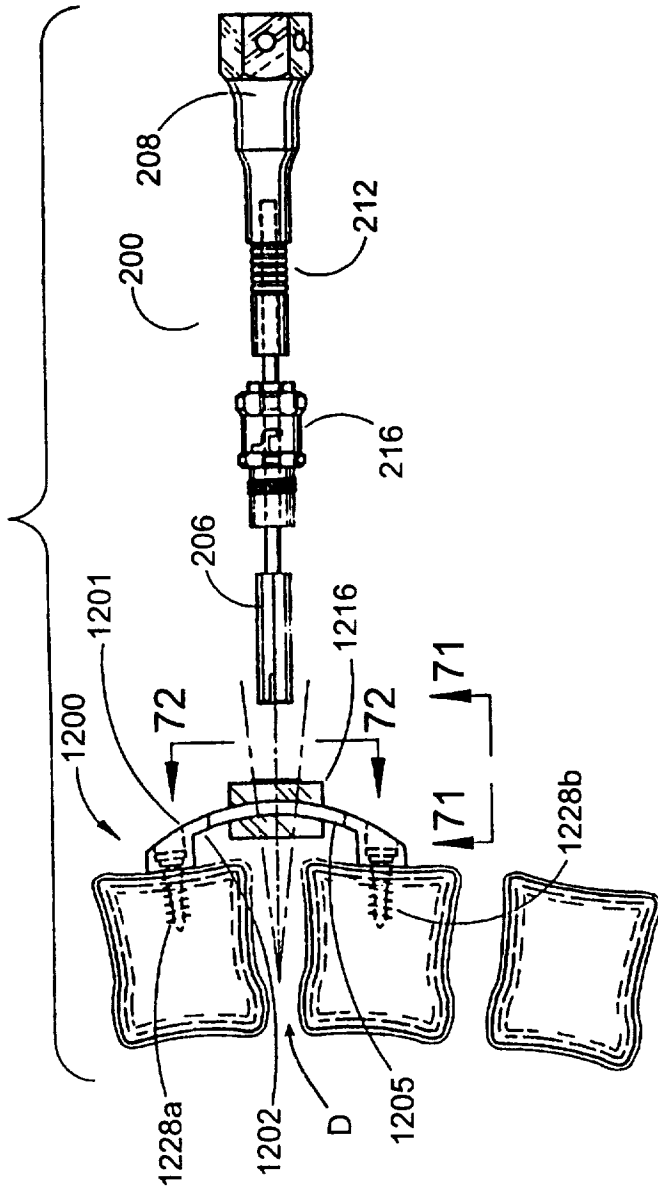

FIG. 69

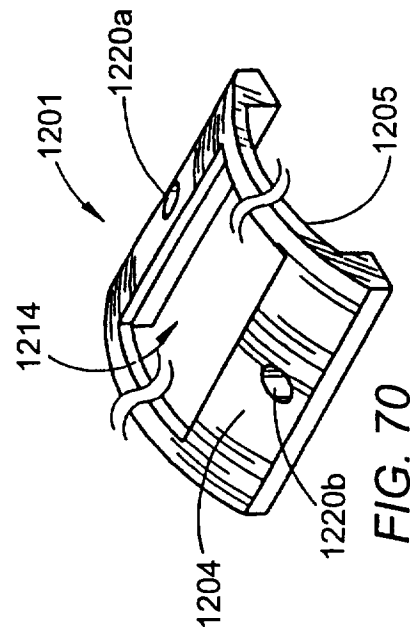

FIG. 70

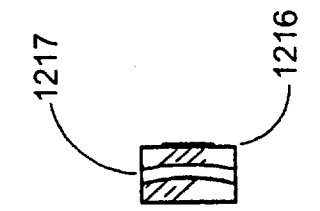

FIG. 71

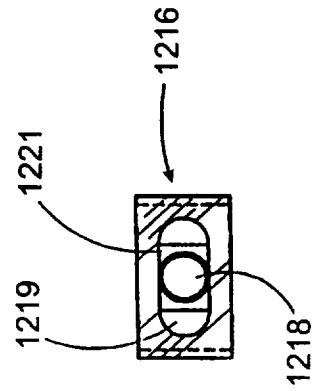

FIG. 72

INTERNATIONAL SEARCH REPORT

International application No.  
PCT/US97/12956

**A. CLASSIFICATION OF SUBJECT MATTER**  
 IPC(6) :A61B 17/56  
 US CL :606/87  
 According to International Patent Classification (IPC) or to both national classification and IPC

**B. FIELDS SEARCHED**  
 Minimum documentation searched (classification system followed by classification symbols)  
 U.S. : 606/61, 86, 87, 96, 102

Documentation searched other than minimum documentation to the extent that such documents are included in the fields searched

Electronic data base consulted during the international search (name of data base and, where practicable, search terms used)

**C. DOCUMENTS CONSIDERED TO BE RELEVANT**

Category*	Citation of document, with indication, where appropriate, of the relevant passages	Relevant to claim No.
X	US 5,505,732 A (MICHELSON) 09 April 1996, Fig. 11B.	1-3, 11, 12, 20, 21, 23, 27-36, 41-45 47, 48, 50, 51, 53, 54, 79-86, 88-92, 94, 95, 97-110, 112-117, 120-124
A	US 5,489,307 A (KUSLICH et al.) 06 February 1996, entire reference.	1

Further documents are listed in the continuation of Box C.  See patent family annex.

* Special categories of cited documents:	"T" later document published after the international filing date or priority date and not in conflict with the application but cited to understand the principle or theory underlying the invention
"A" document defining the general state of the art which is not considered to be of particular relevance	"X" document of particular relevance; the claimed invention cannot be considered novel or cannot be considered to involve an inventive step when the document is taken alone
"E" earlier document published on or after the international filing date	"Y" document of particular relevance; the claimed invention cannot be considered to involve an inventive step when the document is combined with one or more other such documents, such combination being obvious to a person skilled in the art
"L" document which may throw doubts on priority claim(s) or which is cited to establish the publication date of another citation or other special reason (as specified)	"&" document member of the same patent family
"O" document referring to an oral disclosure, use, exhibition or other means	
"P" document published prior to the international filing date but later than the priority date claimed	

Date of the actual completion of the international search 09 SEPTEMBER 1997	Date of mailing of the international search report 06 OCT 1997
--	---

Name and mailing address of the ISA/US Commissioner of Patents and Trademarks Box PCT Washington, D.C. 20231 Facsimile No. (703) 305-3230	Authorized officer <i>Diana Smith for</i> GUY V. TUCKER Telephone No. (703) 308-3271
---	--