

(19) **DANMARK**

(10) **DK/EP 2871312 T3**



(12) **Oversættelse af
europæisk patentskrift**

Patent- og
Varemærkestyrelsen

-
- (51) Int.Cl.: *E 05 C 17/60 (2006.01)* *E 05 B 65/08 (2006.01)* *E 05 C 17/52 (2006.01)*
E 05 C 17/62 (2006.01) *E 05 C 19/06 (2006.01)* *E 05 D 15/10 (2006.01)*
E 05 F 11/14 (2006.01)
- (45) Oversættelsen bekendtgjort den: **2017-06-06**
- (80) Dato for Den Europæiske Patentmyndigheds bekendtgørelse om meddelelse af patentet: **2017-04-12**
- (86) Europæisk ansøgning nr.: **13192304.7**
- (86) Europæisk indleveringsdag: **2013-11-11**
- (87) Den europæiske ansøgnings publiceringsdag: **2015-05-13**
- (84) Designerede stater: **AL AT BE BG CH CY CZ DE DK EE ES FI FR GB GR HR HU IE IS IT LI LT LU LV MC MK MT NL NO PL PT RO RS SE SI SK SM TR**
- (73) Patenthaver: **ROTO FRANK AG, Wilhelm-Frank-Platz 1, 70771 Leinfelden-Echterdingen, Tyskland**
- (72) Opfinder: **PETER, Markus, Frauenwiesenweg 19, 70771 Leinfelden-Echterdingen, Tyskland**
- (74) Fuldmægtig i Danmark: **Zacco Denmark A/S, Arne Jacobsens Allé 15, 2300 København S, Danmark**
- (54) Benævnelse: **Spalteventilationsindretning til skydedør eller -vindue og skydedør eller -vindue**
- (56) Fremdragne publikationer:
EP-A1- 0 443 303
WO-A1-2008/031472
DE-A1- 2 700 598
DE-U1-202005 016 773

DESCRIPTION

The invention relates to a sliding door or sliding window.

5 In sliding doors and sliding windows, there is the problem of sealing the sliding leaf with respect to the fixed surround, in particular a fixed frame. If a seal is arranged between the fixed surround and the sliding leaf and if the sliding leaf cannot be displaced transversely relative to the main
10 plane of the window or the door, opening the sliding leaf is possible only with great difficulty since the displacement thereof is impeded by the seal which is arranged between the leaf and fixed surround.

15 In order to make opening and closing the leaf easier, it is therefore intended to be able to be released perpendicularly to the main plane of the window or the door in order to be able to be displaced without being impeded by the seal. Such a sliding door or sliding window is known, for example, from
20 WO 2007/075075 A1.

DE 20 2005 016 773 U1 discloses a sliding door which is guided in a U-shaped rail by means of rollers. The rollers are constructed as rubber rollers. They cooperate with a
25 slotted element which is secured in the rail base and which has a ramp in the end regions thereof and a recess for the rubber rollers and resilient beads in the central region.

From EP 0 443 303 A1, it is known to provide a positioning
30 brake on a sliding door. This comprises a securing portion and a portion which can be moved with respect thereto in a resilient manner.

In particular, DE 20 2005 016 773 U1 and EP 0 443 303 A1 disclose inline sliding doors without release of the sliding leaf. During the sliding opening operation, the leaf always has to be guided by means of a resilient/non-positive-locking retention device.

DE 27 00 598 A1 discloses a sliding window according to the preamble of claim 1 whose leaf can be released in a parallel manner and subsequently displaced. Furthermore, a gap ventilation position is described. For the gap ventilation position, however, the sliding leaf is only released in a parallel manner, not displaced.

The non-published European Patent Application 13 177 345.9 discloses a displacement arrangement for displacing a sliding leaf transversely, in particular perpendicularly, to the main plane of the window or the door.

It is desirable to provide such sliding windows or sliding doors with a gap ventilation function. This means that it should be possible to secure the leaf relative to the fixed surround, but to release a defined gap between the fixed surround and sliding leaf so that a ventilation function can be carried out.

An object of the present invention is therefore to provide a sliding door or sliding window with a gap ventilation arrangement by means of which such a gap ventilation function can be carried out.

This object is achieved according to the invention by means of a sliding door or a sliding window having the features of claim 1. In this instance, the gap ventilation arrangement

can also be retrofitted in existing sliding doors or sliding windows. Furthermore, it is at the discretion of a user where the gap ventilation arrangement is positioned. In particular it can thereby be determined how large the gap for the gap
5 ventilation is intended to be.

A gap ventilation position is in this instance intended to be understood to be a position of the sliding leaf in which it has been displaced slightly in the sliding opening direction.
10 In this position, it can be released from the fixed surround or tightened against it. In the tightened position, it is secured in the gap ventilation position.

A sliding door or sliding window which is constructed
15 according to the invention may be operated with the actuation handle which is provided in any case. In order to assume and secure the gap ventilation position or to release the gap ventilation position, no additional actuation handle is required. The operation is thereby very simple and
20 comfortable. A gap ventilation arrangement may be provided at the top and at the bottom on the sliding door or on the sliding window so that the sliding leaf can be retained and locked in an even more reliable manner in the gap ventilation position.

25
The gap ventilation arrangement may be provided with a gap ventilation component which has a securing portion for securing the gap ventilation component to the sliding leaf or the fixed surround and a stop or engagement component for
30 cooperating with a gap ventilation counter-piece, wherein the stop or engagement component can be moved counter to a restoring force relative to the securing portion, wherein the

gap ventilation component is at least partially constructed from a resilient material.

Using the gap ventilation arrangement according to the invention, it is possible to release a sliding leaf of a sliding window or a sliding door slightly parallel from the fixed surround and subsequently to displace it in the sliding opening direction until the gap ventilation component and the gap ventilation counter-piece move into engagement with each other or strike each other and a further opening movement of the sliding leaf is thereby prevented. Subsequently, the sliding leaf can again be displaced transversely relative to the fixed surround, that is to say, moved towards the fixed surround.

The gap ventilation counter-piece may be a separate component which is arranged on the fixed surround or on the leaf. However, there may also be provision for the gap ventilation counter-piece to be a component of the fixed surround, for example, a fixed frame, or to be constructed thereon.

If the sliding leaf is released completely from the fixed surround, the stop or engagement component moves out of engagement with the gap ventilation counter-piece so that the sliding leaf can either be closed or completely opened, but in any case can be displaced relative to the fixed surround.

If the sliding leaf is completely released from the fixed surround after the unlocking of the sliding leaf, the spacing between the gap ventilation component and the gap ventilation counter-piece is so large that the sliding leaf can be simply opened in a sliding manner without the gap ventilation

component moving into abutment with the gap ventilation counter-piece.

5 The use of a resilient material has the advantage that no additional restoring element, such as, for example, a spring, has to be used. Furthermore, the use of a resilient material has the advantage that the stop or engagement component returns to its original position when, for example, it has passed over a ramp of a gap ventilation counter-piece. It can
10 thereby be ensured that the leaf is "caught" in a gap opening position, that is to say, the additional sliding movement is reliably blocked.

15 It is particularly preferable in this context for the gap ventilation component to be at least partially constructed from spring steel. In particular, the securing portion and the stop or engagement component may be constructed integrally from spring steel.

20 Other advantages are afforded when the gap ventilation component has a projection which extends transversely relative to the main plane. In this instance, the projection may be provided in the region of the stop or engagement component and may additionally ensure securing of the sliding
25 leaf in a gap ventilation position. In particular, the stop or engagement component may strike the gap ventilation counter-piece and the projection may engage in a corresponding receiving member on the gap ventilation counter-piece and thereby provide additional locking.

30

Furthermore, the projection has the advantage that it can slide along a portion of the fixed surround without damaging the fixed surround and in particular thereby also retaining

the stop or engagement component with spacing from the fixed surround. Consequently, damage to the stop or engagement component during a normal sliding opening operation or closing of the sliding leaf can also be prevented.

5

According to a preferred development, there may be provision for the projection to be constructed from flexible material or to have a cover of flexible material. Flexible materials include, for example, plastics material or rubber.

10 Occurrences of damage can thereby be prevented in an even more effective manner.

According to an embodiment of the invention, there may be provided a gap ventilation counter-piece which can be secured
15 to the fixed surround or the sliding leaf and which has a stop and/or a recess for the stop or engagement component of the gap ventilation component. In this instance, the gap ventilation counter-piece may be arranged on the fixed surround when the gap ventilation component is arranged on
20 the leaf, and vice versa. The gap ventilation counter-piece can be positioned almost freely so that different positions for the leaf in the gap ventilation position can be adjusted. A plurality of gap ventilation counter-pieces may also be provided so that different gap ventilation positions can be
25 selectively adjusted.

Preferably, the gap ventilation counter-piece has a receiving member for the projection of the gap ventilation component. If the projection can engage in the receiving member, the
30 sliding leaf can be secured in the gap ventilation position in a more reliable manner.

The gap ventilation counter-piece may have an inclined leading member which leads to the stop and/or to the recess. The stop or engagement means can thereby be reliably guided to the stop and/or the recess when the sliding leaf is opened
5 in a sliding manner. As a result of the inclined leading member or ramp, a portion of the gap ventilation component can be redirected counter to a restoring force transversely relative to the main plane.

10 The gap ventilation counter-piece may further have for the projection an inclined redirection member which, when viewed in the sliding opening direction, is arranged downstream of the receiving member for the projection. Accordingly, if a sliding leaf is intended to be displaced from a gap opening
15 position in the sliding opening direction, the projection can slide along the inclined redirection member. The projection is thereby prevented from becoming trapped or caught on the stop of the gap ventilation counter-piece and thereby impeding a sliding opening of the sliding leaf. Also in this
20 context, it is advantageous for the gap ventilation component to be at least partially constructed from resilient material.

The gap ventilation counter-piece, when viewed in the sliding closing direction, may have upstream of the stop and/or the
25 recess an inclined leading member for the stop or engagement component. Consequently, it is ensured that, in the event of the sliding leaf being closed, the gap ventilation component travels past the gap ventilation counter-piece, in particular does not become caught on it.

30 It is particularly preferable for the gap ventilation arrangement to be arranged in a region of the sliding leaf facing away from a ventilation gap. The components of the gap

ventilation arrangement can thereby be arranged in a concealed manner and in particular cannot be visible when the sliding leaf is completely opened.

5 The gap ventilation component can be secured in a particularly simple manner when the sliding leaf has a C-shaped groove. The gap ventilation component can be secured to this C-shaped groove. To this end, at least one clamping piece may be provided on the gap ventilation component.

10

The fixed surround may have a guiding web on which the gap ventilation counter-piece is arranged. In particular, the guiding web may be provided with holes into which the gap ventilation counter-piece is clip-fitted. Alternatively or
15 additionally, the gap ventilation counter-piece may be riveted or screwed or otherwise secured to the guiding web.

Other features and advantages of the invention will be appreciated from the following description of embodiments of
20 the invention, with reference to the Figures of the drawings, which set out inventively significant details and from the claims. The individual features may be implemented individually per se or together in any combination in a variant of the invention.

25

Preferred embodiments of the invention are schematically illustrated in the drawings and are explained in greater detail below with reference to the Figures of the drawings, in which:

30

Figure 1 is a schematic view of a sliding door;
Figure 2 is a plan view of a gap ventilation component;
Figure 3 is a view of the rear side of the gap ventilation component;

Figure 4 is a front view of the gap ventilation component;
Figure 5 is a perspective illustration of a gap ventilation
counter-piece;

Figure 6 is a view in the arrow direction VI. of Figure 5;

5 Figure 7a is a cut-out of the lower corner region of the
sliding door in a released position of the sliding leaf;
Figure 7b is an enlarged illustration of the detail A from
Figure 7a;

Figure 8a shows the lower corner region of the sliding door
10 in a partially released position of the sliding leaf;
Figure 8b is an enlarged illustration of the detail A of
Figure 8a;

Figure 9 shows the lower corner region of the sliding door in
a closed position;

15 Figure 10 is a perspective view of a displacement arrangement
for a sliding door;

Figure 11 is an enlarged illustration of the detail A of
Figure 10;

Figure 12 is an enlarged illustration of the detail B of
20 Figure 10;

Figure 13 is a perspective illustration of a guiding
component which is arranged on a leaf securing component;

Figure 14 is a perspective illustration of a guiding
component which has a roller arrangement and which is
25 arranged on a leaf securing component;

Figure 15 is a view of a leaf securing component;

Figure 16 is a view of the guiding component of Figure 14;

Figure 17a is a view from below of a guiding component in the
closed position;

30 Figure 17b is a plan view of the leaf securing component in a
closed position;

Figure 18a is an illustration corresponding to Figure 17a in
a sliding position;

Figure 18b is an illustration corresponding to Figure 17b in a sliding position.

Figure 1 shows a sliding door 1 with a fixed leaf 2 and a sliding leaf 3 and a fixed surround 4 which is constructed as a blind frame. The sliding leaf 3 can be opened in a sliding manner in the arrow direction 5 and closed in the arrow direction 6. By means of an actuation handle 7, different switching positions can be adjusted. In particular, there can be produced a locking position, in which the sliding leaf 3 is tightened against the fixed surround 4, a partially released position (intermediate position), in which the sliding leaf 3 is unlocked and can be displaced into the gap ventilation position, and a (completely) released position (open position), in which the sliding leaf can be freely displaced. If the leaf has been displaced into the gap ventilation position, it can be tightened by means of the actuation handle 7 against the fixed surround 4 and thereby secured in its position.

20

The gap ventilation arrangement according to the invention may be installed at different locations, for example, the locations 8 and 9 are illustrated. An installation in the region of the location 9 is preferred since the gap ventilation arrangement is thereby not visible, even when the sliding leaf 3 is open. The gap ventilation arrangement may be installed at the top and/or at the bottom.

Figure 2 shows a gap ventilation component 10 which has a securing portion 11 for securing to the sliding leaf 3 or the fixed surround 4. Furthermore, the gap ventilation component 10 has a stop or engagement component 12. The stop or engagement component 12 can be moved perpendicularly to the

30

- 11 -

plane of the drawing counter to a restoring force relative to the securing portion 11. The stop or engagement component 12 is preferably constructed from spring steel. There is provided on the stop or engagement component 12 a projection 5 13 which is produced from resilient material or comprises the like.

Figure 3 shows the rear side of the gap ventilation component 10. In this instance, it is possible to see two clamping 10 pieces which are constructed as clamping discs 14, 15 and which are rotatably arranged in an eccentric manner. The clamping discs 14, 15 can be rotated by means of the tool engagement locations 16, 17 in order to thus secure the gap ventilation component 10 in a clamping manner to a C-groove, 15 for example, of the sliding leaf 3. As a result of the fact that clamping discs 14, 15 are provided for the securing, the gap ventilation component 10 can also be released in a simple manner from the sliding leaf 3 or the fixed surround 4 and moved relative thereto, can be newly positioned and secured 20 in the new position.

Figure 4 is a front view of the gap ventilation component 10. The components previously described are referred to with reference numerals.

25

Figure 5 is a perspective illustration of a gap ventilation counter-piece 20. The gap ventilation counter-piece 20 has a stop 21 and a recess 22. When the sliding leaf 3 is moved into the gap ventilation position (sliding leaf is located in an intermediate position), the stop or engagement component 30 12 strikes the stop 21 and thereby comes to rest in the recess 22. A further movement of the sliding leaf 3 in the opening direction is thereby blocked. There is a positive-

locking connection. Furthermore, a receiving member 23 for the projection 13 is provided on the gap ventilation counter-piece 20. The receiving member 23 is in particular constructed as a through-opening.

5

So that the stop or engagement component 12 is reliably guided against the stop 21 during a movement of the sliding leaf 3 into the gap ventilation position, an inclined leading member 24 is provided. In this instance, the inclined leading member 24 may redirect the stop or engagement component 12 counter to a restoring force. After the inclined leading member 24, the stop or engagement component 12 springs as a result of the restoring force into the recess 22. When viewed in the sliding opening direction, downstream of the receiving member 23 an inclined redirection member 25 for redirecting the projection 13 is provided. The projection 13 can thereby be redirected when the sliding leaf 3 is completely released in a gap ventilation position and is then pushed completely open. The inclined redirection member 25 prevents a sliding opening movement from being prevented by the projection 13.

In order to ensure that, in the event of a closure movement of the sliding leaf 3 from an open position, there is no blocking of the sliding leaf 3 by the gap ventilation arrangement, another inclined leading member 26 is provided. In particular, it can be seen in Figure 5 that the gap ventilation counter-piece 20 tapers towards both ends or becomes narrower in terms of width.

Figure 6 is a plan view in the arrow direction VI of the gap ventilation counter-piece 20. In this instance, it can be seen that at the rear side of the gap ventilation counter-piece 20 there are provided studs 27, 28 by means of which

30

the gap ventilation counter-piece 20 can be clip-fitted into corresponding holes in the fixed surround 4 or the sliding leaf 3.

5 Figure 7a shows the lower corner region of the sliding door 1 in an unlocked position completely released from the fixed surround 4. This position can be identified by the upper edge 30 of the sliding leaf 3 being clearly spaced apart from the sealing groove 31 on the fixed surround 4, in the embodiment
10 shown, by approximately 13 mm. This results in the gap ventilation component 10 also being clearly spaced apart from the gap ventilation counter-piece 20 and being able to be moved past it in an unimpeded manner. The sliding leaf 3 can consequently be displaced in an unimpeded manner. In the
15 embodiment shown, the gap ventilation component 10 is secured to the sliding leaf 3 and the gap ventilation counter-piece 20 is arranged on the fixed surround 4, in particular on a horizontally orientated web 32. The web 32 also acts in this instance as a guide for a transverse roller 33 whose function
20 will be described below.

Figure 8a is an illustration corresponding to Figure 7a with the sliding leaf 3 partially released. The spacing between the upper edge 30 of the sliding leaf 3 and the sealing
25 groove 31 is smaller than in Figure 7a. In the embodiment shown, it is approximately 7 mm. If the sliding leaf 3 with this transverse release (corresponds to the intermediate position) is displaced from the fixed surround 4 in a sliding opening direction, the gap ventilation component 10 strikes
30 the gap ventilation counter-piece 20 so that an additional sliding movement of the sliding leaf 3 is prevented. It is now located in a partially open position which corresponds to a gap ventilation position. In order to secure the sliding

leaf 3 in the gap ventilation position, the actuation handle 7 can be actuated in such a manner that the sliding leaf 3 is displaced towards the fixed surround 4.

5 The locking position is shown in Figure 9. It can be identified by the spacing between the upper edge 30 of the leaf 3 and sealing groove 31 being smaller, in particular only approximately 5 mm. If the sliding leaf 3 is moved from the position shown away from the fixed surround 4 again (see
10 Figure 7a), the gap ventilation component 10 is lifted off the gap ventilation counter-piece 20 so that the sliding leaf 3 can be freely displaced.

Figure 10 shows a displacement arrangement 100 having an
15 actuation mechanism 102 which is constructed as a peripheral connection rod fitting and which can be actuated by means of an actuation handle 7. The actuation mechanism 102 is mounted on the pivot leaf 3 of the window or the door and extends in the peripheral direction of the rebate. In the embodiment
20 shown, the displacement arrangement has four locations 104 - 107 at which a guiding component can be displaced transversely relative to the peripheral direction of the rebate with respect to the sliding leaf 3 or with respect to the actuation mechanism 102.

25 In the enlarged illustration of the detail A in Figure 11, the guiding component 108 is illustrated without any leaf securing component arranged between the guiding component 108 and actuation mechanism 102. It can be seen that the
30 actuation mechanism 102 has a control element 109 which is constructed as a control projection and which can engage in a control element 110 of the guiding component 108, which control element is constructed as a control contour, in

particular a control slot. The control slot is in this instance orientated in an oblique manner relative to the peripheral rebate direction 111. When the actuation mechanism 102 is displaced in the peripheral rebate direction 111, the guiding component 108 is consequently displaced
5 perpendicularly relative to the peripheral rebate direction 111 with respect to the actuation mechanism 102 and consequently the leaf.

10 The guiding component 108 of Figure 11 has a roller arrangement 112 which will be described in greater detail below. Below the roller arrangement 112, there can be seen a transverse roller 33 which can be rotated about a rotation axis which is orientated perpendicularly to the peripheral
15 rebate direction 111 and parallel with the main plane of a door or a window. The transverse roller 33 has a diameter which is greater than the width of the roller arrangement 112. In cooperation with the fixed surround 4, it is thereby possible to prevent transverse forces from acting on the
20 roller arrangement 112.

Figure 12 is an exploded view of the detail B of Figure 10. The guiding component 115 also has a transverse roller 116 which is rotatably arranged about a vertical rotation axis.
25 The rotation axis of the transverse roller 116 is consequently also orientated perpendicularly to the peripheral rebate direction 111 and parallel with the main plane. The transverse roller 116 is intended for cooperation with a fixed surround. The guiding component 115 does not
30 have any roller arrangement. There is again provided opposite the guiding component 115 a control element 117 which is constructed as a control projection and arranged on the actuation mechanism 102. In particular, the control

projection may be constructed as a roller which is arranged on a connection rod. The control element 117 engages through a leaf securing component 118 on which the guiding element 115 is arranged so as to be able to be displaced transversely relative to the peripheral rebate direction 111. The control element 117 engages in a control element 110 of the guiding element 115.

The slightly enlarged perspective illustration of the guiding element 115 according to Figure 13 shows that the leaf securing component 118 has transverse guides 119, 120 along which the guiding component 115 can be displaced relative to the leaf securing component 118. It can further be seen that the leaf securing component 118 engages over the guiding component 115 in the regions 121, 122. The guiding component 115 is thereby retained on the leaf securing component 118.

Figure 14 shows the guiding component 108 in an illustration corresponding to Figure 13. The arrangement of Figure 14 corresponds to the arrangement of Figure 13 with the exception that a roller arrangement 112 is arranged on the guiding component 108. The roller arrangement 112 has two rollers 125, 126 which are rotatably arranged on a roller retention member 127. The roller retention member 127 itself is pivotably connected to the guiding component 108 by means of a rotation axis 128. This means that the roller arrangement 112 is arranged so as to be able to be pivoted in a limited manner about the pivot axis 128. Occurrences of unevenness of a rail or also curvature of a leaf strut can thereby be compensated for. In a direction parallel with the pivot axis 128, the roller arrangement 112 is supported with little play, in particular in the range from 5/10 to 8/10 mm. Consequently, a slight displacement of the roller arrangement

112 transversely relative to the guiding component 108 is also possible. Loads on the rollers 125, 126 can thereby be kept small. In this instance, it can again be seen that the diameter of the transverse roller 33 is greater than the
5 width of the roller arrangement 112.

Figure 15 shows a leaf securing component 118 which can be used both in the arrangement according to Figure 14 and in the arrangement according to Figure 13. In this instance, it
10 can be seen that the leaf securing component 118 has a linear longitudinal slot 130 through which the control element 109 or 117 can protrude in order to move into engagement with the control element 110. The transverse guides 119, 120 can also be seen. The transverse guides 131, 132 are constructed in
15 such a manner that there is produced between them a region 133 which is dovetail-like in cross-section. The region 133 again constitutes a transverse guide for the guiding components 108, 115. As a result of the dovetail-like configuration, a tilting of the guiding components 108, 115
20 relative to the leaf securing component 118 can be prevented. A securing opening 134 is provided in the region of the transverse guide 133. A screw can be screwed into the leaf frame through the securing opening 134. Other securing openings 135-138 can also be seen.

25
Figure 16 shows a view of the guiding component 108. In this instance, it can be seen that the control element 110 has two portions 110.1, 110.2 which are orientated differently with respect to the peripheral rebate direction. In particular,
30 the portion 110.1 has a larger angle with respect to the peripheral rebate direction or longitudinal direction of the leaf component 108 than the portion 110.2. As a result of the portion 110.1, a larger transverse movement of the leaf can

be carried out whilst, as a result of the portion 110.2, a gentle pressing of the leaf against a seal can be ensured. The transverse guide 133 of the leaf securing component 118 is guided in the region 135 of the guiding component 108.

5

Figure 17a is a view from below of the guiding component 108 and the leaf securing component 118. The guiding component 108 is located in a right-hand extreme position which corresponds to a closure position of the leaf. The view of the leaf securing component 118 according to Figure 17b shows that the control element 109 is located in the portion 110.2 of the control element 110. If the control element 109 is now displaced in the peripheral rebate direction, that is to say, displaced in an upward direction in accordance with Figure 17b, the control element 109 reaches the region 110.1 of the control element 110, as shown in Figure 18b. This leads to the guiding component 108 being displaced to the left, as can be seen in Figure 18a. This position corresponds to a sliding position. This means that the sliding leaf 3 in this position can be displaced relative to the fixed surround 4. In this position, the sliding leaf 3 is completely released from the fixed surround. However, if the control element 109 is located in the portion 110.3, the sliding leaf 3 is in a partially released position in which the gap ventilation component 10 and gap ventilation counter-piece 20 can cooperate, in particular can block the sliding leaf 3 in a gap ventilation position.

10

15

20

25

Patentkrav

1. Skydedør (1) eller skydevindue med en fast indfatning (4) og en skydefløj (3), som ved hjælp af en forskydningsindretning (100) kan forskydes på tværs af skydevinduets eller skydedørens (1) hovedplan i forhold til den faste indfatning (4), og med en spalteventilationsindretning omfattende en spalteventilationsdel (10), hvor forskydningsindretningen (100) kan betjenes via et aktiveringshåndtag (7), hvor der til en første aktiveringshåndtagsstilling er knyttet en fuldstændigt frigjort stilling af skydefløjen (3), i hvilken den kan forskydes i skydedørens (1) eller skydevinduets skydeåbningsretning frit i forhold til den faste indfatning (4), og der til en anden aktiveringshåndtagsstilling er knyttet en lukkestilling af skydefløjen (3), i hvilken skydefløjen (3) er trykket ind mod den faste indfatning (4), og der til en tredje aktiveringshåndtagsstilling er knyttet en mellemstilling mellem fuldstændigt frigjort stilling og lukkestilling, **kendetegnet ved, at** skydefløjen (3) i den tredje aktiveringshåndtagsstilling kan forskydes i skydedørens (1) eller skydevinduets skydeåbningsretning i forhold til den faste indfatning (4), indtil en spalteventilationsdel (10) slår imod et spalteventilationsmodstykke og blokerer for den fortsatte skydebevægelse af skydefløjen (3) i skydeåbningsretningen.

20

2. Skydedør eller skydevindue ifølge krav 1 **kendetegnet ved, at** spalteventilationsdelen (10) har en fastgørelsessektion (11) til fastgørelse af spalteventilationsdelen (10) på skydefløjen (3) eller den faste indfatning (4) og en stop- eller indgrebsdel (12) til samvirkning med et spalteventilationsmodstykke (20), hvor stop- eller indgrebsdelen (12) kan bevæges mod en tilbagestillingskraft i forhold til fastgørelsessektionen (11), idet spalteventilationsdelen (10) i det mindste afsnitsvis er udformet af et elastisk materiale.

25

3. Skydedør eller skydevindue ifølge krav 2, **kendetegnet ved, at** spalteventilationsdelen (10) i det mindste afsnitsvis er udformet af fjederstål.

30

4. Skydedør eller skydevindue ifølge et af de foregående krav, **kendetegnet ved, at** spalteventilationsdelen (10) har en næse (13), som strækker sig på tværs af hovedplanet.

35

5. Skydedør eller skydevindue ifølge krav 4, **kendetegnet ved, at** næsen (13) er udformet af eftergivende materiale eller har et belægning af eftergivende materiale.
- 5 **6.** Skydedør eller skydevindue ifølge et af de foregående krav, **kendetegnet ved, at** der er tilvejebragt et spalteventilationsmodstykke (20), som kan fastgøres på den faste indfatning (4) eller skydefløjen (3), og som har en stopper (21) og/eller en udsparring (22) til spalteventilationsdelens (10) stop- eller indgrebsdel (12).
- 10 **7.** Skydedør eller skydevindue ifølge krav 6, **kendetegnet ved, at** spalteventilationsmodstykket (20) har en optagelse (23) til spalteventilationsdelens (10) næse (13).
- 15 **8.** Skydedør eller skydevindue ifølge et af de foregående krav 6 eller 7, **kendetegnet ved, at** spalteventilationsmodstykket (20) har en anløbsskråning (24), der fører mod stopperen (21) og/eller mod udsparringen (22).
- 20 **9.** Skydedør eller skydevindue ifølge et af de foregående krav 6 til 8, **kendetegnet ved, at** spalteventilationsmodstykket (20) har en omdirigeringskråning (25) til næsen (13), hvilken set i skydeåbningsretningen er placeret efter optagelsen (23) til næsen (13).
- 25 **10.** Skydedør eller skydevindue ifølge et af de foregående krav 6 til 9, **kendetegnet ved, at** spalteventilationsmodstykket (20) set i skydelukkeretningen foran stopperen (21) og/eller udsparringen (22) har en anløbsskråning (26) til stop- eller indgrebsmidlet (12).
- 30 **11.** Skydedør eller skydevindue ifølge et af de foregående krav, **kendetegnet ved, at** spalteventilationsindretningen er anbragt i et område af skydefløjen (3), der vender bort fra en ventilationsspalte.
- 12.** Skydedør eller skydevindue ifølge et af de foregående krav, **kendetegnet ved, at** skydefløjen (3) har en C-formet not, som spalteventilationsdelen (10)

er fastgjort på.

- 5 **13.** Skydedør eller skydevindue ifølge et af de foregående krav, **kendetegnet ved, at** den faste indfatning (4) har et føringsstykke (32), som spalteventilationsmodstykket (20) er anbragt på.

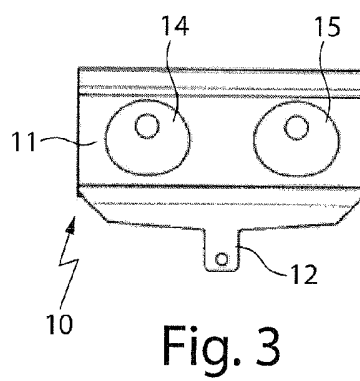
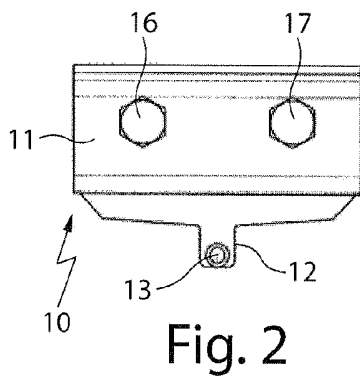
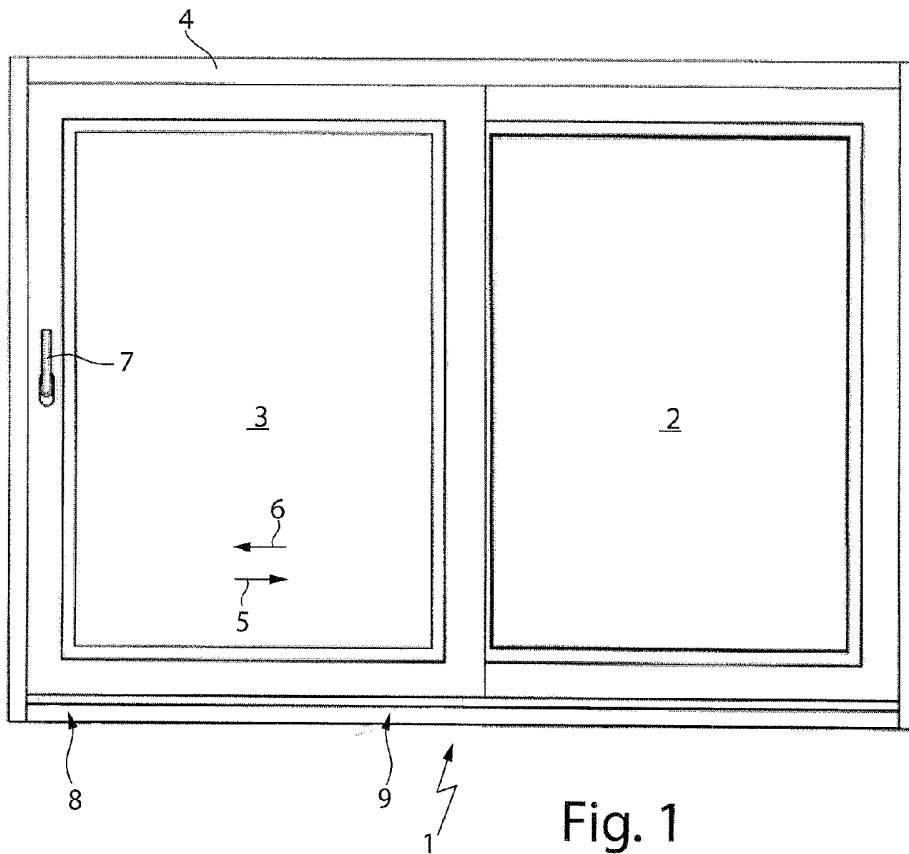

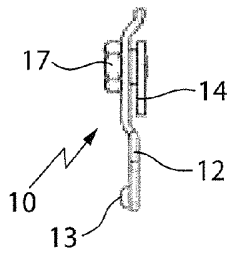

Fig. 4

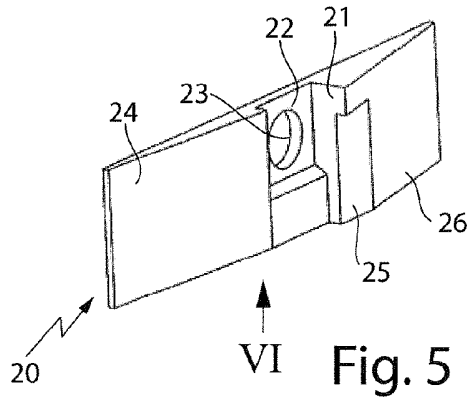

Fig. 5

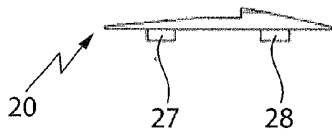

Fig. 6

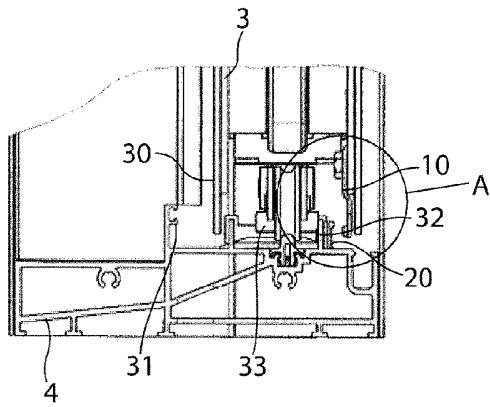

Fig. 7a

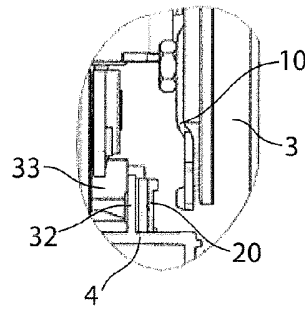

Fig. 7b

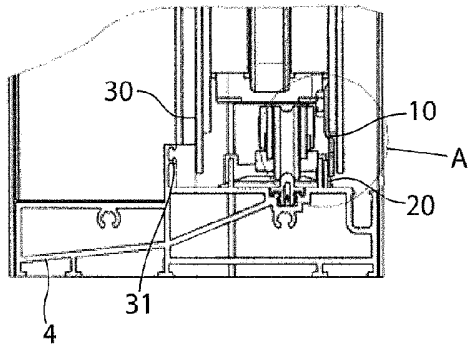

Fig. 8a

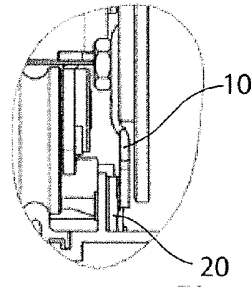

Fig. 8b

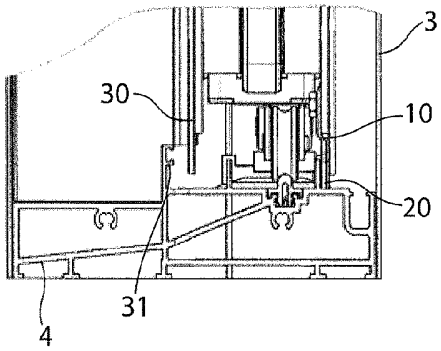

Fig. 9

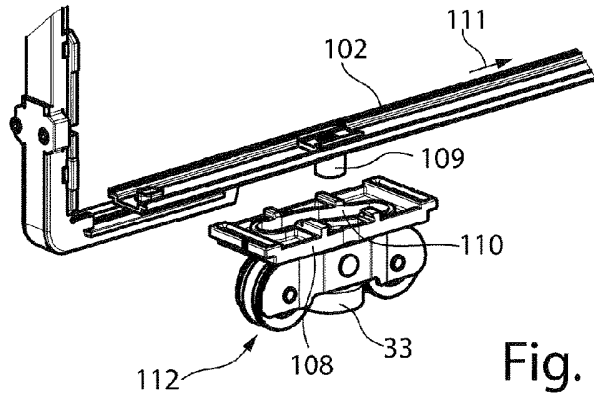

Fig. 11

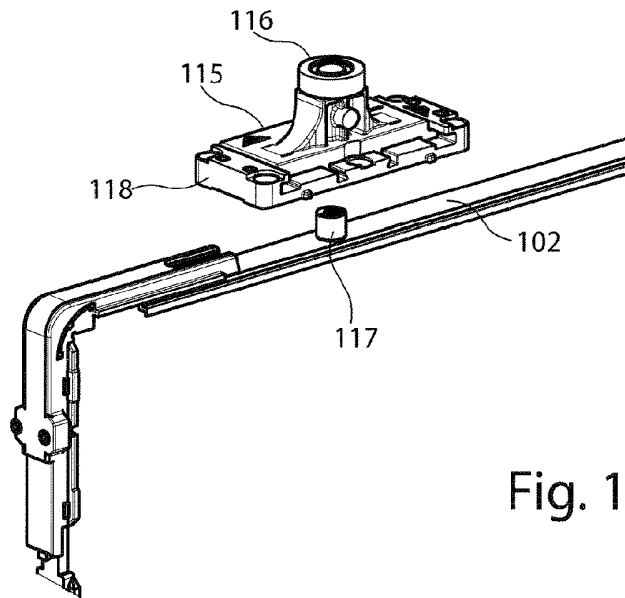

Fig. 12

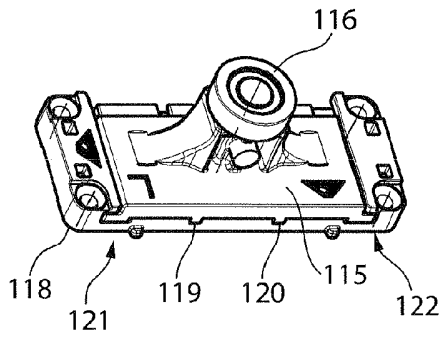

Fig. 13

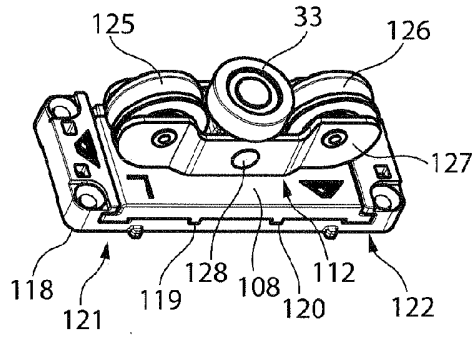

Fig. 14

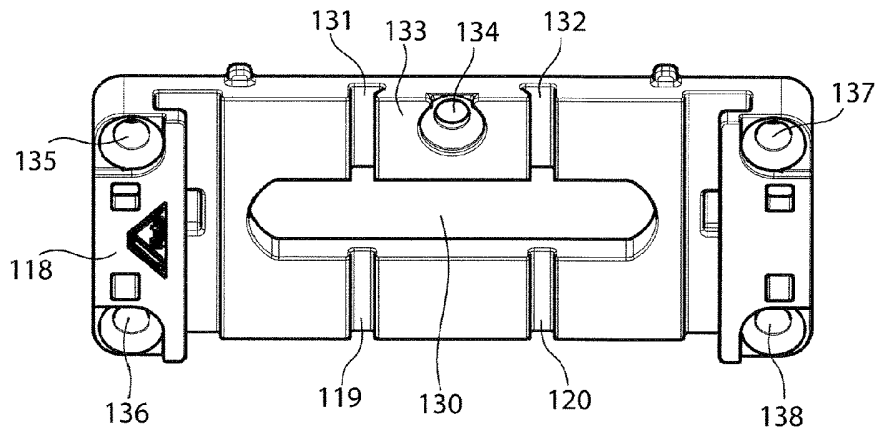

Fig. 15

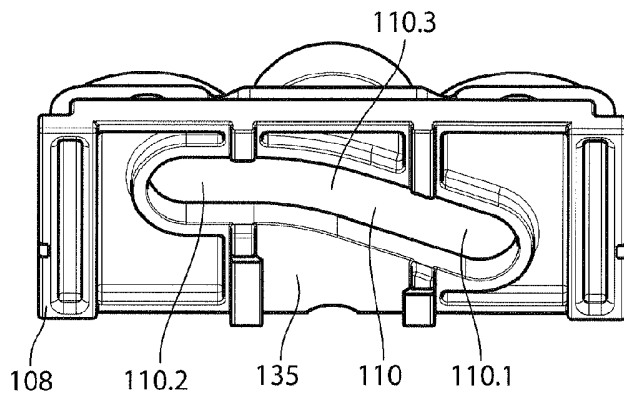

Fig. 16

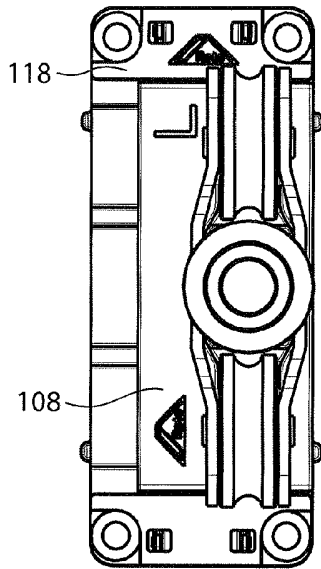

Fig. 17a

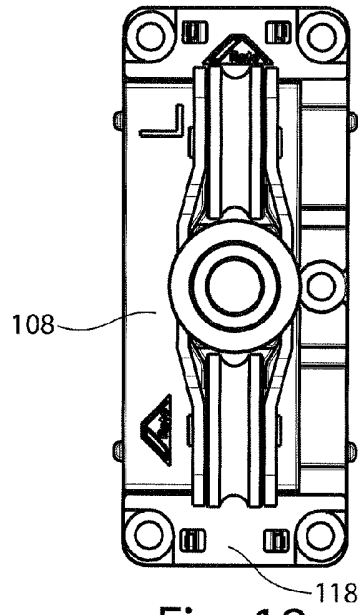

Fig. 18a

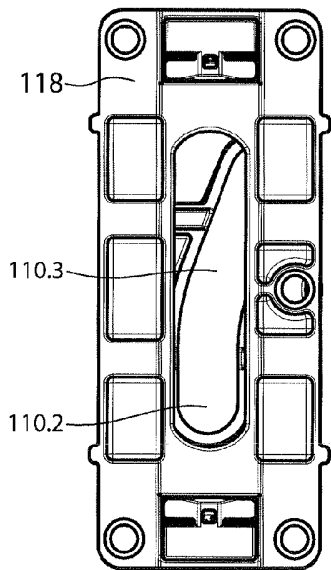

Fig. 17b

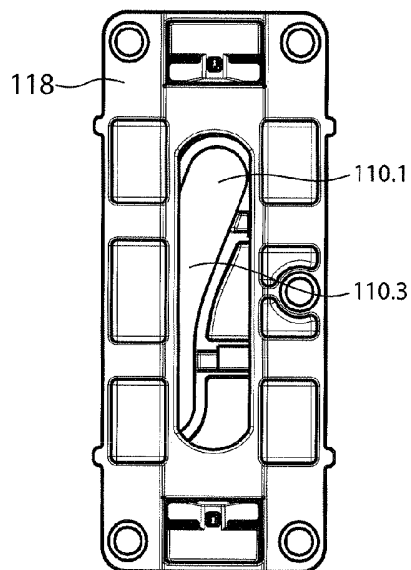

Fig. 18b