

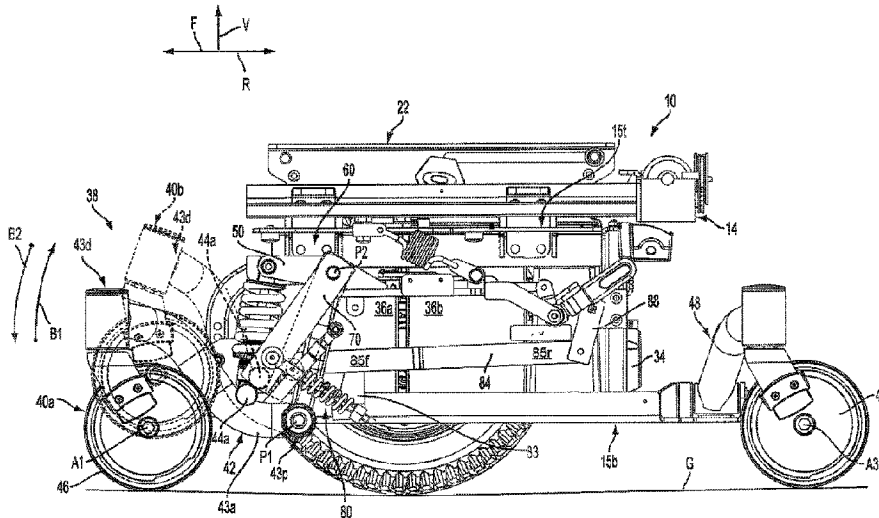

(22) Date de dépôt/Filing Date: 2014/12/16
 (41) Mise à la disp. pub./Open to Public Insp.: 2015/06/25
 (45) Date de délivrance/Issue Date: 2024/05/21
 (62) Demande originale/Original Application: 2 933 851
 (30) Priorités/Priorities: 2013/12/16 (US61/916,500);
 2014/02/12 (US61/938,880)

(51) Cl.Int./Int.Cl. *A61G 5/04* (2013.01),
A61G 5/06 (2006.01), *A61G 5/10* (2006.01),
A61G 5/12 (2006.01)
 (72) Inventeurs/Inventors:
 MULHERN, JAMES P., US;
 ANTONISHAK, STEPHEN J., US
 (73) Propriétaire/Owner:
 PRIDE MOBILITY PRODUCTS CORPORATION, US
 (74) Agent: GOWLING WLG (CANADA) LLP

(54) Titre : FAUTEUIL ROULANT DONT LA HAUTEUR PEUT ETRE ELEVEE
 (54) Title: ELEVATED HEIGHT WHEELCHAIR



(57) **Abrégé/Abstract:**

A powered wheelchair (10) configured to reposition an occupant between a lowered and a raised position includes a frame (14), a seat (22) moveable relative to the frame (14), a drive wheel (32), a lift mechanism (18) and one or more pairs of arm assemblies (38). The arm assembly (38) includes a wheel (46) configured to move from a first spatial location when the wheelchair (10) is operating on flat, level ground to a second spatial location that is different than the first spatial location. Arm limiters (70) can selectively engage the arm assembly (38) based on at least one of a seat position, position of the arm assembly (38) and surface conditions of ground surface. The arm limiters (70) can limit the range of motion of the arm assembly (38) and sometimes other operational aspects of the chair (10).

ABSTRACT

A powered wheelchair (10) configured to reposition an occupant between a lowered and a raised position includes a frame (14), a seat (22) moveable relative to the frame (14), a drive wheel (32), a lift mechanism (18) and one or more pairs of arm assemblies (38).

The arm assembly (38) includes a wheel (46) configured to move from a first spatial location when the wheel chair (10) is operating on flat, level ground to a second spatial location that is different than the first spatial location. Arm limiters (70) can selectively engage the arm assembly (38) based on at least one of a seat position, position of the arm assembly (38) and surface conditions of ground surface. The arm limiters (70) can limit the range of motion of the arm assembly (38) and sometimes other operational aspects of the chair (10).

ELEVATED HEIGHT WHEELCHAIR

[0001]

TECHNICAL FIELD

[0002] The present application relates to a wheelchair, and in particular to a power wheelchair configured to operate at least in an elevated mode where an occupant is elevated.

BACKGROUND

[0003] Wheelchairs are an important means of transportation for a significant portion of society. Whether manually propelled or powered, wheelchairs provide an important degree of independence for those they assist. However, this degree of independence can be limited if the wheelchair is required to traverse obstacles such as, for example, curbs that are commonly present at sidewalks and other paved surface interfaces, and door thresholds. Accordingly, power wheelchairs have been the subject of increasing development efforts to provide handicapped and disabled persons with independent mobility to assist them in leading even more normal and active lives.

[0004] To aid in climbing curbs, some power wheelchairs typically have a pair of forward extending anti-tip assemblies that are rotatably coupled to the wheelchair frame. The arm members of the anti-tip assemblies are rotatably coupled to the wheelchair frame such that when the wheelchair encounters a curb, the anti-tip assemblies will pivot upwardly to thereby allow the wheelchair to traverse the curb. Some power wheelchairs also have elevatable seats that permit the occupant to move at "eye-level" with persons walking with them. However, wheelchairs operating with seats at elevated positions are susceptible to instability under certain conditions, and anti-tip assemblies, while beneficial for climbing obstacles such as curbs, may contribute to the instability when the wheelchair is operating on other than flat, level ground.

SUMMARY

[0005] Embodiments of the present disclosure include a wheelchair configured to reposition an occupant between a lowered and a raised position. The wheelchair can include a frame, a seat moveable relative to the frame, a drive wheel, and one or more pairs of arm

assemblies. The arm assembly includes a wheel configured to move from a first spatial location when the wheel chair is operating on flat, level ground, to a second spatial location that is different than the first spatial location. Arm limiters can selectively engage the arm assembly based on at least one of a seat position, position of the arm assembly, and surface conditions of ground. The arm limiters can limit the range of motion of the arm assembly and sometimes other operational aspects of the chair.

BRIEF DESCRIPTION OF THE DRAWINGS

[0006] The foregoing summary, as well as the following detailed description of example embodiments of the application, will be better understood when read in conjunction with the appended drawings, in which there is shown in the drawings example embodiments for the purposes of illustration. It should be understood, however, that the application is not limited to the precise systems and methods shown. In the drawings:

[0007] Figure 1 is a top perspective view of a powered wheelchair in accordance with an embodiment of the present disclosure;

[0008] Figure 2A is a side elevation view of the powered wheelchair shown in Figure 1, with a portion of the seat removed and illustrating the seat in a raised position;

[0009] Figure 2B is a side elevation view of the powered wheelchair shown in Figure 2A, showing the seat in the lowered position;

[0010] Figure 3A is a side elevation view of the powered wheelchair shown in Figure 2B, with a drive wheel removed to illustrate a forward arm assembly and an arm limiter according to an embodiment of the present disclosure;

[0011] Figure 3B is a rear perspective of a portion of the powered wheelchair shown in Figure 3A;

[0012] Figure 4A is a side elevation view of a portion of the powered wheelchair shown in Figure 3A, illustrating the arm limiter in the locked configuration;

[0013] Figure 4B is a side elevation view of a portion of the powered wheelchair shown in Figure 3A, illustrating the arm limiter in an open configuration;

[0014] Figure 4C is a side elevation view of a portion of the powered wheelchair shown in Figure 3A, illustrating the arm limiter that is blocked from transitioning into the locked configuration as the powered wheelchair traverses an obstacle;

[0015] Figure 5 is a block diagram illustrating a control system for operating the powered wheelchair illustrated in Figures 1 through 4C, according to an embodiment of the present disclosure;

[0016] Figures 6A and 6B are process flow diagrams illustrating operation of powered wheelchair in standard operating mode and an elevated motion mode (a portion of the diagram is shown in Figure 6A and another portion of the diagram is shown in Figure 6B);

[0017] Figure 7 is a perspective view of an arm limiter assembly for the powered wheelchair according to another embodiment of an aspect of the present disclosure;

[0018] Figures 8A-8D are sides views of rotatable members according to alternative embodiments of aspects of the present disclosure;

[0019] Figure 9A is a side elevation view of a powered wheelchair according to another embodiment of an aspect of the present disclosure, illustrating the arm limiter shown Figure 7;

[0020] Figure 9B is a side elevation view of a portion of the powered wheelchair shown in Figure 9A, illustrating the front wheel ascending an obstacle;

[0021] Figure 10A is a side elevation view of a powered wheelchair according to another embodiment of an aspect of the present disclosure, illustrating the arm limiter in the locked configuration;

[0022] Figure 10B is a side elevation view of a portion of the powered wheelchair shown in Figure 10A, illustrating the arm limiter in an open configuration;

[0023] Figure 10C is a side elevation view of a portion of the powered wheelchair shown in Figure 10A, illustrating the arm limiter being inhibited from transitioning into the locked configuration as the powered wheelchair ascends an obstacle;

[0024] Figure 11A is a schematic side elevation view of a powered wheelchair according to another embodiment of an aspect of the present disclosure, illustrating an arm limiter in the locked configuration;

[0025] Figure 11B is an end view of the arm limiter illustrated in Figure 11A;

[0026] Figure 12A is a schematic side elevation view of a powered wheelchair according to another embodiment of the present disclosure, illustrating the arm limiter in the locked configuration;

[0027] Figure 12B is a side elevation view of a portion of the powered wheelchair shown in Figure 12A, illustrating the arm limiter in an open configuration with a portion thereof retracted;

[0028] Figure 12C is a side elevation view of a portion of the powered wheelchair shown in Figure 12A, illustrating the arm limiter being inhibited from transitioning into the locked configuration as the powered wheelchair ascends an obstacle;

[0029] Figure 13A is a schematic side elevation view of a portion of a powered wheelchair according to another embodiment of the present disclosure, illustrating a rear arm assembly and a rear arm limiter assembly in an open configuration;

[0030] Figure 13B is a side elevation view of a portion of the powered wheelchair shown in Figure 13A, illustrating the rear arm limiter assembly being inhibited from transitioning into the locked configuration as the powered wheelchair descends an obstacle;

[0031] Figure 14A is a schematic side elevation view of a portion of the powered wheelchair, illustrating the arm assembly on flat, level ground and an arm limiter assembly in an open configuration; and

[0032] Figure 14B is a side elevation view a portion of the powered wheelchair shown in Figure 14A, illustrating the arm assembly translated upwardly as the powered wheelchair ascends an obstacle.

[0033] Figure 15A is a schematic side elevation view of a portion of a powered wheelchair according to another embodiment of an aspect of the present disclosure, illustrating an arm limiter assembly in an open configuration;

[0034] Figure 15B is a side elevation view a portion of the powered wheelchair shown in Figure 15A, illustrating the arm assembly ascending an obstacle and the arm limiter in a locked configuration;

[0035] Figure 15C is a side elevation view a portion of the powered wheelchair shown in Figure 15A, illustrating the arm attempting to ascend an obstacle and with arm limiter in another locked configuration;

[0036] Figure 16A is a schematic side elevation view of a portion of a powered wheelchair according to another embodiment of an aspect of the present disclosure, illustrating the arm limiter in the locked configuration; and

[0037] Figure 16B is a side elevation view a portion of the powered wheelchair shown in Figure 15A, illustrating the arm assembly translated upwardly as the powered wheelchair ascends an obstacle.

DETAILED DESCRIPTION OF ILLUSTRATIVE EMBODIMENTS

[0038] Referring to Figures 1-2B, an embodiment of the present disclosure includes a wheelchair 10 configured to elevate a seat 22 between a conventional lowered position and a raised position that allows an occupant to operate the wheelchair 10 with the seat at the raised position, which in some circumstances can be at a conversational height with others. The wheelchair 10 may be a powered wheelchair. In some embodiments, wheelchair 10 is configured to selectively limit certain operational aspects when, for example, the wheelchair 10 is in the process of traversing an obstacle, is on un-level ground, and/or when the seat is raised. Likewise, the wheelchair 10 may prevent the raising of the seat when the wheelchair is climbing an obstacle or is on unlevel ground. An "obstacle" as the term is used herein includes any relatively raised or lowered structure on the ground surface G that the wheel must ascend or descend to cross over. Operating a wheelchair when the seat is in the raised position can create instability, especially when climbing curbs or transitioning to a descent when appropriate safety features are not deployed. For instance, when the seat is in the fully raised position, the center of gravity of the occupied wheelchair is elevated and/ or shifted forward or rearward (depending, for example, on the lift mechanism associated with the chair). The risk of tipping can increase on an incline and overall wheelchair stability can be compromised, especially when traversing or attempting to traverse an obstacle. The wheelchair 10 as described herein improves stability when the seat 22 is in the raised position and the individual is at a conversational height. As a result of improved stability chair travelling speeds can be increased. Increased traveling speeds may include walking speeds, jogging speeds or running speeds. Conversational height as used herein refers to when the occupant is elevated above the ground surface G to make

communication with others (e.g., average height adult males or females) standing or walking next to wheelchair easier. For example, conversational height could be “eye-level.”

[0039] The wheelchair 10 includes a frame 14, a pair of drive wheels 32 coupled to the frame 14 and driven by at least one drive motor 34 (Figure 2A). A pair of anti-tip arm assemblies 38 extend from the frame 14 in a forward direction F relative to the drive wheels 32. A pair of rear arm assemblies 48 extend from the frame 14 in a rearward direction R that is opposite to the forward direction F. As used herein the forward-rearward direction F-R may refer the horizontal direction when the wheelchair is operating on flat, level ground. In accordance with the illustrated embodiment, the power wheelchair 10 is a mid-wheel drive wheel chair and includes front wheels 46 and rear wheels 49 disposed in the forward and rearward directions F and R relative to the drive wheels 32, respectively. The drive motor 34 causes the drive wheels 32 to rotate about the drive wheel axis A2 to advance the wheelchair along the surface G. The front wheel 46 is rotatable about the front wheel axis A1 and the rear wheel 47 is rotatable about the rear wheel axis A3. The present disclosure, however, is not limited to mid-wheel powered wheel chairs.

[0040] The wheelchair 10 also includes a lift mechanism 18 mounted to the frame 14 with the seat 22 supported by the lift mechanism 18. The lift mechanism 18 is configured to, in response to inputs an occupant applies to an input device 8, move the seat 22 between a lowered position 5L (Figs. 1 and 2B) and a raised position 5R (Fig. 2A) generally along a vertical direction V that is perpendicular the forward and rearward directions F and R. While a scissor-type lift mechanism that is actuated by a lead screw mechanism is illustrated and described below, any type of lift mechanism may be employed. Further, the powered wheelchair can be configured to move the seat into the raised position and tilt the seat base and seat back relative to each other in the raised position. In an embodiment, the powered wheelchair can include a lift and tilt mechanism, such as the lift and tilt mechanism disclosed in U.S. Patent App. Pub. No. 2014/0262566, entitled “Lift Mechanism And Tilt Mechanism For A Power Wheelchair”.

[0041] The wheelchair 10 also includes one or more arm limiter assemblies 60, shown for example in Figure 3A, coupled the frame 14 and configured to selectively engage the anti-tip assemblies 38 so as to inhibit relative motion between the anti-tip assemblies 38 and frame 14 in certain instances during operation of the wheelchair 10. An arm limiter assembly as used herein may be referred to as an arm limiter or limiter. Preventing relative motion between anti-tip

assemblies 38 and the frame 14 can limit certain operations of the wheelchair 10 in order to improve stability and occupant safety. The arm limiter assemblies 60 transition between a first or disengaged configuration and a second or locked configuration where operation of the anti-tip assemblies 38 are limited. Further, operation of arm limiter assemblies 60 may be limited, inhibited, impaired or delayed when the wheelchair is traversing an obstacle. For instance, the arm limiter assemblies 60 may not transition into locked configuration if the anti-tip assemblies are already attempting to traverse an obstacle, as will be further discussed below. For just one instance, operation of the lift mechanism 18 can be limited so that the seat cannot be moved to the raised position when the wheelchair is climbing an obstacle or descending along an incline. The wheelchair 10 is configured to safely operate in a mode whereby the seat 22 of the wheelchair 10 is raised to a raised position at the conversational height with walking companions and the wheelchair 10 is capable of safely advancing along the surface G, for instance a normal speed, such as normal walking speed.

[0042] The power wheelchair 10 has different operational modes, such as a standard mode and one or more elevated motion modes. In some embodiments, a control system 90 (Figure 5) includes a controller 92 configured to operate the wheelchair 10 in the different operational modes, an input device 8 in electronic communication with the controller 92, and a plurality of sensors 96a-96c in electronic communication with the controller 92. The controller 92 is responsive to inputs from the input device 8 and one or more of the sensors 96a-96c in order to cause the wheelchair 10 to operate at least in (i) a standard mode when the seat 22 is in the lowered position such that the wheelchair is moveable along the surface G in accordance with standard drive parameters (that is, conventional parameters that are not limited for elevated seat operation), and (ii) one or more elevated motion modes whereby the seat is in the raised position and drive parameters are limited to some extent. The elevated motion modes may include A) a first or normal elevated motion mode where the wheelchair is capable operating according to a first set of limited drive parameters, and B) a second elevated motion mode (sometimes referred to as an elevated-inhibited mode) whereby the wheelchair 10 is capable of operating according to a second set of limited drive parameters that have limits that are typically less than upper limits of the first set of limited drive parameters. The phrase “drive parameters” as used herein (whether in standard or elevated modes) include at least a speed (miles/hr), acceleration, and deceleration of the wheelchair. In some embodiments, the drive parameters include directional components, such as forward speed, reverse speed, and turn speed, forward acceleration, forward deceleration, reverse acceleration, and reverse deceleration. For brevity

and ease of illustration, the standard and elevated modes below are described with reference to the speed of the wheelchair. However, it should be appreciated that the ranges and limits discussed below with respect to speed are applicable to the other drive parameters such as turn speed, acceleration, and deceleration described above.

[0043] In accordance with the illustrated embodiment, the standard mode is when the seat 22 is in the lowered position such that the wheelchair is moveable along the surface G at typical wheelchair speeds. The first elevated motion mode can be when the wheelchair is capable of moving at a first speed range, up to a maximum raised-seat drive speed, which is less than the typical wheelchair speeds. The second elevated motion mode (or an elevated-inhibited mode) is when the wheelchair 10 is capable of moving at a second elevated mode speed range, up to a maximum raised-inhibited drive speed that is less than the upper limit of the first speed range.

[0044] In the standard mode the wheelchair can move at a standard or lowered-seat drive speed range that is typical of conventional wheelchairs, such as between 0.0 mph and about 10.0 mph. Accordingly, it should be appreciated that the fully lowered-seat drive speed can have an upper limit that is anywhere in the conventional range of between a practical minimum (or at rest at 0 mph) and, for example, 10.0 mph as indicated. Furthermore, it should be appreciated that when the wheelchair is operating in the standard mode, the wheelchair 10 can be configured to move at any speed as desired and is not limited to a speed that is between the practical minimum and 10.0 mph. The wheelchair 10 would typically be in the standard mode (that is, with the seat in the fully-lowered position) when the wheelchair is traversing obstacles O (Figure 4C) such as a curb. The term “standard mode” includes a mode that has no speed restrictions by the controller that are related to seat position.

[0045] When in the elevated motion modes, the wheelchair 10 can be configured to move at a speed that has a limit that is less than the standard mode drive speed upper limit. In the elevated motion modes, the power wheelchair preferably is capable of moving at a walking speed (or perhaps faster) while seat 22 is in the raised position such that the occupant is at the conversational height with a person walking next the powered wheelchair. In an exemplary embodiment, when in the normal elevated motion mode, the first speed range is between a practical minimum and 5.0 mph, preferably between the practical minimum and 3.75 mph. That is, the wheelchair 10 can be configured to move at a maximum raised-seat drive speed that is no more than 5.0 mph, preferably no more than 3.75 mph. It should be appreciated that the raised-

seat drive speed can have an upper limit that is anywhere between first speed range of the practical minimum to 5.0 mph. Furthermore, when the wheelchair 10 is operating in the normal elevated motion mode, there may be circumstances in which the upper limit may be set higher than 5.0 mph. The term “practical minimum” speed as used herein means that the lower limit of the range is chosen according to the parameters understood by persons familiar with power wheelchair structure and function, and may be close to zero mph under some conditions.

[0046] In an instance in which wheelchair 10 is operating in the elevated motion mode, and at least one safety criteria is not met, the controller will cause the wheelchair 10 to operate in some mode other than the first, normal elevated motion mode. For example, the controller may cause the wheelchair 10 to operate in the second elevated motion mode or elevated inhibited mode at least until all of the safety criteria are met. For example, in some embodiments, if the seat 22 is in the raised position and one of the safety criteria is not met, the controller will allow the wheelchair 10 to move within the second, elevated-inhibited speed range, up to the reduced maximum raised-inhibited speed that is less than maximum raised-seat drive speed. The maximum raised-inhibited drive speed can be a speed that is no more than 3.0 mph, preferably no more than 1.5 mph. It should be appreciated, however, that the raised-inhibited drive speed can have any upper limit as desired so long as it is less than an upper limit of the first, normal speed range.

[0047] Accordingly, in order for the wheelchair 10 to operate in the elevated motion modes, certain safety criteria should be satisfied as will be discussed further below. The sensors 96a-96c can collectively detect information indicative of when the wheelchair 10 is in a position to safely operate in the elevated motion modes. If the sensors 96a-96c detect a condition that indicates that it is not safe to operate the wheelchair in the elevated motion mode, the controller 92 will operate the wheelchair 10 in some other mode such as the elevated inhibited mode or standard mode (that is, by requiring the seat to be in the lowermost position). In certain instances, for example, the wheelchair 10 will not operate in the elevated motion modes, i.e., the seat 22 will not move into the raised position if the seat 22 is initially in the lowered position and the wheelchair 10 is ascending an obstacle or descending down an incline.

[0048] Turning to Figures 2A-2B, the frame 14 supports the drive wheels 32, anti-tip assemblies 38, rear assemblies 48, the lift mechanism 18 and seat 22. As illustrated, the frame 14 includes a front end 14f, a rear end 14r spaced from the front end 14f in a forward direction F, a bottom 15b, and a top 15t spaced from the bottom 15b in the vertical direction V. The frame

14 further supports one or more batteries 36a and 36b, the drive motors 34, and various control modules that are used to operate the powered wheelchair.

[0049] The lift mechanism 18, in some embodiments, includes left and right of scissor assemblies 16 operatively connected to frame 14, a lift motor 20, and a lift control system (which preferably is integrated with the controller described herein) that can be used to impart a lifting force and rate by which the seat 22 moves from the lowered position to the raised position. One scissor assembly will be described below for ease of illustration. The other scissor assembly is constructed similarly. The scissor assembly 16 includes first and second scissor bars 17 and 19 that extend between the seat 22 and the frame 14 and are rotatably coupled to each other. The first scissor bar 17 has an upper end 17u fixed to the seat 22 and a lower end 17l that is moveably coupled to the top 15t of the frame 14. For instance, the lower end 17l can be movably coupled to a support rack 14s attached to or extending monolithically from the top 15t of the frame 14. The second scissor bar 19 includes an upper end 19u that is moveably coupled to the seat 22. As illustrated, the upper end 19u extends partly into an elongate slot 21 defined in the seat frame 23a. The lower end 19l of the scissor bar 19 is fixed to the frame 14, for instance to the support rack 14s.

[0050] The motor 20 is operatively coupled to the lower end 17l of the scissor bar 17 and is configured to cause the lower end 17l to translate along the frame 14 in the forward and rearward directions F and R. The lift motor 20 is operatively coupled to a drive actuator, such as a threaded shaft, that is connected to the lower end 17l of the scissor bar 17. For instance, a threaded nut (not shown) is fixed, directly or indirectly, to the lower end 17l and the drive screw extends through the threaded nut. Operation of the motor turns the drive screw in the drive nut, which causes translation of the lower end 17l to advance along the drive screw depending on rotational direction of the drive screw. In operation, when the seat is raised, the lower end 17l of the scissor bar 17 is disposed toward the central region of the frame 14 and when the seat 22 is in the lowered position, the lower end 17l of the scissor bar 17 is has translated closer to the rear end 14r of the frame 14. As the lower end 17l translates along the frame 14, the upper end 19u of the second scissor bar 19 translates along the elongated slot 21 of the seat 22 as the seat 22 is lowered toward the frame 14. The seat 22 is a seat assembly that includes a base, a seat back (base and seat back not numbered or shown in Figures 2A and 2B), seat frame 23a that supports the base. The seat frame 23a defines a seat bottom 23b that faces the frame 14. The distance D extends from the top 15t of the frame 14 to the bottom 23b of the seat 22 along a vertical

direction V. The distance D increases as the seat 22 is moved from the lowered position 5L to the raised position 5R, and decreases the seat 22 is moved from the raised position 5R to the lowered position 5L. The lift mechanism illustrated is exemplary only. And it should be appreciated that the lift mechanism is not limited to scissor-type mechanisms or the use of screw-type actuators as described above.

[0051] Turning to Figures 3A and 3B, as noted above, the wheelchair 10 includes a pair of anti-tip arm assemblies 38. For ease of illustration only one anti-tip arm assembly 38 will be described below. The other anti-tip assembly 38 in the pair preferably has the same structure but oriented on the opposite hand. The anti-tip arm assembly is also referred to in this disclosure as an arm assembly 38. The arm assembly 38 includes an arm member 42 moveably coupled to the frame 14, a front wheel 46 coupled to the arm member 42, and at least one stop member 44a disposed along the arm member 42. In the illustrated embodiment, the arm member 42 includes an arm body 43a that defines an arm proximal end 43p and an arm distal end 43d spaced from the arm proximal end 43p along an arm body axis 45. The arm member body 43a is curved along the arm axis 45 such that distal end 43d is spaced a greater vertical distance from the surface G compared to the vertical distance that the proximal end 43p is spaced from the surface G. The curved arm body 43a provide clearance for the wheel assembly. It should be appreciated that the arm member body 43a could be linear along the arm axis 45 in other embodiments. The distal end 43d of the arm member 42 includes a distal housing (not numbered) that receives a front wheel assembly 46. The proximal end 43p defines a proximal housing (not numbered) that holds and/or defines a connector (not numbered) that is coupled to the frame 14. The arm member body 43a can be any structure, such as an elongate tube, bar, rod or plate and may or may not have uniform or substantially uniform cross section between proximal end 43p and distal end 43d. As illustrated, the arm member body 43a is tubular and is exemplary only. In other embodiments, the arm member body 43a can be or may include a bar or plate with a substantially rectilinear cross-section perpendicular the arm axis 45. The arm member 42 can be formed of multiple components that are connected together with fasteners or welds, or pivotally attached together, without limitation. In other embodiments, the arm member body can be a monolithic structure, such as a cast or extruded material.

[0052] The front wheel 46 is coupled to the distal end 43d and is rotatable about the front wheel axis A1. As illustrated, the front wheel 46 is in contact with ground or surface G during normal operation. The distal end 43d of arm member includes a caster assembly (not

numbered) supported by the distal housing. The caster assembly rotatably couples the front wheel 46 to the arm member 42 such that wheel 46 is rotatable about an axis (not shown) that is normal to the ground surface G and perpendicular the wheel axis A1. It should be appreciated, however, that in some embodiments, the front wheel 46 can be an anti-tip wheel that is raised or otherwise spaced from the ground or surface G during normal operation in a configuration that does not include a caster. The term “anti-tip” wheel as used herein encompasses caster wheel assemblies (such as front wheel 46) and anti-tip wheels that are raised during normal operation and encompasses wheels in the front and the rear of the wheelchair. In such embodiments, the raised anti-tip wheels can have a first or rest position 40a when the wheelchair 10 is operating on flat, level ground.

[0053] Continuing with Figures 3A and 3B, the arm assembly 38 is coupled to the frame 14 and configured to move the wheel 46 relative to the frame 14 upon encountering an obstacle. The arm assembly 38 illustrated in Figures 3A and 3B is pivotably coupled the frame 14 such that the arm assembly 38 and wheel axis A1 pivots about the pivot axis P1. It should be appreciated, however, that the arm assemblies can be coupled to the frame 14 such that the arm member 42 and wheel axis A1 translates relative to the frame 14, e.g. as illustrated in wheelchair 610 shown in Figures 14A and 14B. Accordingly, the powered wheelchair is configured such that the spatial location of the arm member 42 and front wheel axis A1 are moveable, rotationally and/or translatably (e.g., relative to the frame and/or drive axis as opposed to spinning about its axle or caster kingpin). The words “move,” “moveable”, or “movement” when used in reference to motion of the arm member and front wheel includes rotational movement (Figures 3A and 3B) and translational movement (Figures 14A and 14B) (and is not intended to include rotation about a front wheel axis A1 or wheel axle.

[0054] In the embodiment illustrated in Figures 3A and 3B, the arm assembly 38 is coupled to the frame 14 and configured to pivot such that the arm member 42 and wheel axis A1 is pivotable about the axis P1 along a rotational direction B1-B2. For instance, the arm assembly 38 is configured to pivot about the pivot axis P1 as the wheelchair 10 traverses obstacles along the surface G, such as a curb. The arm assembly 38 is configured so that arm member 42 is in a first or rest position 40a relative to the frame 14 when the wheelchair 10 is operating on flat, level ground (that is, “normal operation”). When the wheelchair encounters an obstacle, the arm member 42 pivots upwardly about axis P1 in a first or upward rotational direction B1 toward a second position 40b that is different from the first position 40a. In this regard, the second

position 40b is different from the first position 40a along 1) both the vertical direction V and the forward-rearward direction F-R, or 2) only the vertical direction V. When the front wheel 46 encounters a descent down a curb, however, the arm member 42 pivots downwardly about the axis P1 in a second or downward rotational direction B2 that is opposite the first rotational direction B1 (which movement below ground G is not shown in the figures). The second position 40b as used herein can mean a position that is different from the first position 40a in an upward or downward direction. When viewing the figures, the first rotational direction is clockwise and the second rotational direction is counterclockwise. The extent that the arm member 42 pivots about the pivot axis P1 is referred to herein as the range of rotation or range of motion as further described below. Further, while reference is made to the arm member 42 having a first position 40a and a second position 40b that is different than the first position 40a, the first and second positions 40a and 40b also refer to the relative locations of the wheel axis A1 when encountering an obstacle. In regard, it should be appreciated that the wheel axis A1 can be repositioned from a first position 40a into a second position 40b.

[0055] As noted above, the arm assembly can be configured such that the arm member 42 and wheel axis A1 is translatable between the first position 40a to the second position 40b. For example, as illustrated in Figures 14A and 14B, arm assemblies 638 are coupled to the frame 14 such that the arm member 42 and wheel axis A1 is translatable between the first position 40a and the second position 40b along a linear direction C that is offset with respect to the vertical direction V and forward-rearward direction F-R. In such an embodiment, the second position 40b is different from the first position 40a along 1) the vertical direction V or the forward-rearward direction F-R. Operation of the wheel chair 610 and arm assembly 638 is further detailed below. The translating arm assemblies 638 can be similar to the arm assemblies disclosed in U.S. Patent No. 7,232,008, entitled, "Active anti-tip wheels for power wheelchair," (the 008 patent) assigned to Pride Mobility Products Corporation.

[0056] Continuing with Figures 3A and 3B, the proximal end 43p of the arm member 42 is pivotably coupled to the frame 14 such that the proximal end 43p defines the pivot axis P1. However, the arm member 42 can be pivotably coupled to the frame 14 at a location disposed forward from the proximal end 43p. In other words, the pivot P1 can be defined at any location along the arm member 42 between the proximal end 43p and distal end 43d. In addition, in some embodiments, the pivot axis P1 is disposed below a line L1 (Figures 2A and 2B) that intersects

the front wheel rotational axis A1 and the drive wheel rotational axis A2. The wheelchair 10 can be considered a “low pivot” axis type wheelchair, such as that disclosed in U.S. Patent No. 8,181,992, (the 992 patent) entitled “Anti-tip system for a power wheelchair.”

However, the wheelchair 10 is not required to be a low-pivot axis type wheelchair.

[0057] Continuing with Figures 3A and 3B, the stop member 44a is located on or is part of the arm member 42 so as to, in some circumstances, engage the arm limiter assembly 60. In the illustrated embodiment, the distance from the pivot axis P1 to the stop member 44a along the arm axis 45 is less than the distance from the stop member 44a to the distal end 43d of the arm member 42. In certain embodiments, the position of the stop member 44a toward the distal end 43d permits engagement with the illustrated arm limiter assembly 60 (when in locking configuration) when the front wheel 46 encounters moderately sized obstacles. However, the stop member 44a could be disposed along any portion of the arm member 42 as needed. The stop member 44a includes a first or upper engagement surface 44u (Figure 4A) on a portion of the upper side of stop member 44a. The upper engagement surface 44u faces upwardly opposite the ground surface G when the arm member 42 is in the first position 40a. The stop member 44a also includes a second or rear surface 44r (Figure 4B) on a rearward side of stop member 44a. The rear surface 44r faces the rearward direction R when the arm member 42 is in the first position 40a. The stop member 44a is shown as a cylindrical body disposed along the arm member 42. However, the stop member 44a can be monolithic with the arm member body 43a such that the arm member 42 defines the upper and rear engagement surfaces 44u and 44r. For instance, an upwardly facing surface of the arm member can define a curved or stepped profile. In certain embodiments, arm member 42 can include a projection that defines the stop member 44a.

[0058] Continuing with Figures 3A and 3B, each arm assembly 38 can further include at least one linkage 50 that operatively connects the arm member 42 to a respective drive motor 34. Motor torque from the drive motors 34 will influence or cause the forward arm members 42 to pivot about their respective pivots P1 as the wheelchair 10 traverses an obstacle to thereby aid the wheelchair during obstacle traversal. It should be appreciated, however, that the anti-tip assemblies 38 can alternatively be passive (*i.e.* not coupled to the drives) as desired.

[0059] Wheelchair 10 further includes a pair of arm limiter assemblies 60 that are each associated with a respective arm assembly 38. Each arm limiter assembly 60 is configured to selectively inhibit the range of motion of the arm assembly 38 relative to the frame 14. In the illustrated embodiment (see Figures 3A and 3B), the arm limiter assembly 60 is configured to selectively inhibit the extent that the arm assembly 38, specifically the arm member 42 or wheel 46, can pivot about the pivot axis P1 in the upward direction B1. The arm limiter assembly 60 has a first or disengaged or open configuration as shown in Figure 4B (shown in dashed lines in Figure 3A) in which the arm limiter assembly 60 does not restrict the upward range of motion of arm member 42. Accordingly, in the disengaged or open configuration, the arm assembly 38 is rotatable from the first position 40a (that is, it's normal state) through a first range of rotation about the pivot axis P1.

[0060] In addition, the arm limiter assembly 60 has a second or engaged or locked configuration as shown in Figure 4A (shown in solid lines in Figure 3A) in which arm limiter limits the upward range of motion of the arm member 42. In the engaged or locked configuration, the arm assembly 38 is rotatable through a second range of rotation that is less than the first range of rotation. Accordingly, when the arm limiter assembly 60 is in the locked configuration, the arm member 42 is not rotatable about the pivot axis P1 to the same extent that the arm member 42 is rotatable about the pivot axis P1 when the arm limiter assembly 60 is in the open configuration. The wheelchair 10 is configured to transition the arm limiter assembly 60 between the open and locked configurations based on position of the seat 22 and/or condition of the ground surface G that the wheelchair 10 is traveling along, as will be further detailed below.

[0061]

[0062] The range of rotation as used herein refers to rotation of the arm member 42 to a position that is different than the first position 40a. When the arm member 42 is in the first position 40a, such that the wheelchair 10 is operating on flat, level ground, a first, fixed reference line I1 intersects the pivot axis P1 and the front wheel axis A1. The first line I1 is coaxial with an arm reference line I2 that also intersects the pivot axis P1 and wheel axis A1 only when the wheelchair 10, for example the front wheel 46 and drive wheels 32, are on a flat, level ground surface G. The arm reference line I2 represents the first position 40a of the arm assembly 38 (Figures 4A, 4B). The lines I1 and I2 define an angle α that is about zero (0) degrees when the arm assembly 38 is in the first position 40a. In the illustrated embodiment, in the first range of rotation (that is, without upward limit by arm limiter assembly 60) angle α can

be up to, for example, about 20 degrees of rotation relative to the first position 40a in either the upward (first) rotational direction B1 or the downward (second) rotational direction B2. The range of arm rotation when arm limiter assembly 60 is in the open configuration is bounded merely by the wheelchair structure and its corresponding function. For instance, in the first range of rotation angle α can extend from -10 degrees (that is, in the downward direction) from the line I1 at the first position 40a to +10 degrees in the upward rotation direction B2 from the line I1 at the first position 40a.

[0063] The second range of rotation (that is, the rotation capable when the arm limiter is engaged with the arm) can be any desired range that is less than the first range of rotation. In the second range of rotation angle α can be, for example, up to about 10 degrees of rotation relative to the first position 40a in the upward (first) rotational direction B1 and/or the downward (second) rotational direction B2. For instance, in the second range of rotation angle α can extend from -5 degrees (that is, in the downward direction) from the line I1 at the first position 40a to +5 degrees in the upward rotation direction B2 from the line I1 at the first position 40a. When the arm limiter assembly 60 is in the locked configuration, the second range of rotation includes the angle α equal to about zero (0) degrees such that the arm member 42 is fixed relative to the frame 14. In other words, the second range of rotation includes arm member 42 fixed against pivotable movement (especially upward movement) relative to frame 14. It should be appreciated that the second range of rotation can be partially within the first range of rotation, such the upper and lower limits are 0 degrees and + 10 degrees. In the exemplary embodiment shown, the arm limiter assembly 60 is inhibited from transitioning into the second configuration when the position of the arm assembly is rotationally different from the first position 40A relative to the frame 14 by more than four (4) degrees. In some embodiments, the arm limiter assembly 60 is prevented from transitioning into the second configuration under selected trigger conditions of the wheelchair. One trigger configurations may include when the position of the arm assembly is different from the first position 40A relative to the frame 14 by more than one degree, two degrees, three degrees or four or more degrees. Other trigger conditions may include the position of the seat, inclination of the wheelchair, and speed of the wheelchair. In one embodiment, limiter assembly 60 is prevented from transitioning into the second configuration when the position of the arm assembly is different from the first position 40A relative to the frame 14 by more than one degrees. In one embodiment, limiter assembly 60 is prevented from transitioning into the second configuration when the position of the arm assembly is different from the first position 40A relative to the frame 14 by more than two degrees. In one

embodiment, limiter assembly 60 is prevented from transitioning into the second configuration when the position of the arm assembly is different from the first position 40A relative to the frame 14 by more than three degrees. In other exemplary embodiments, the arm limiter assembly 60 is inhibited from transitioning into the second configuration when the position of the arm assembly is rotationally different from the first position 40A relative to the frame 14 by less than four (4) degrees.

[0064] Arm limiter assembly 60 is in the open configuration when the wheelchair 10 is operating in the standard motion mode, i.e., when the seat is in the lowered position. When the controller 92 receives an input from the input device 8 to operate the wheelchair 10 in the elevated motion mode, the controller 92 causes arm limiter assembly 60 to transition into the second or engaged configuration. However, if certain conditions are not met the arm limiter assembly 60 may be inhibited from moving into the second configuration. For example, the arm limiter assembly 60 may be able to move into the second configuration only when the front wheel 46 and drive wheel 32 are on flat, level ground. Further, the arm limiter assembly 60 may be able to move into the second configuration only when front wheel 46 is in a different position from the first position 40a, but still within the second range of motion as noted above. In the embodiment shown, if the front wheels 46 are on uneven ground relative to the drive wheels 32 such that a forward arm member 42 is pivoted upwards into the second position 40b as shown in Fig. 4C, then the arm limiter assembly 60 is physically blocked from moving into the locking configuration. In alternative embodiments, the controller 92 may be configured to inhibit the arm limiter assembly 60 from transitioning into the second configuration when the front wheel 46 and drive wheel are on flat, level ground.

[0065] The arm limiter assembly 60 is configured to transition between the open configuration and the locking configuration so as to limit the range of rotation of the arm member 42 as described above. In the embodiment illustrated in Figures 3A-4C, the arm limiter assembly 60 includes a rotatable member 70 that is rotatably mounted to the frame 14, an actuator 88, a transfer linkage 84 coupled to actuator 88, and a biasing member, such as spring 80 operably connected to the linkage 84 and the rotatable member 70. The actuator 88 is operable to cause movement of the transfer linkage 84, which in turn causes movement of the rotatable member 70 as further detailed below.

[0066] Referring to Figure 3B-4B, the rotatable member 70 is pivotably coupled to the frame 14 at a connection 69 and rotatable about the pivot axis P2 between the open configuration

(Figure 4B) and the locked configuration (Figures 3B, 4A). In the illustrated embodiment, the rotatable member 70 is a beam or brace in the form of a bar. Other elongate shapes, such as without limitation a plate, rod, tube, are contemplated in further embodiments. The rotatable member 70 defines a body 74 having a first or proximal end 74a rotatably coupled to the frame 14 and a second or distal end 74b that is opposed to proximal end 74a along an axis 71. The body 74 includes a forward edge 75a and a rearward edge 75b opposed to the forward edge 75a. The edges 75a and 75b extend at least partially from the proximal end 74a to the distal end 74b. The distal end 74b defines a distal-most contact surface 78, that can be curved, and is configured to engage the stop member 44a to thereby limit the pivotal movement of the arm member 42 in the upward direction B1. As illustrated, when the rotatable member 70 is in locking configuration, the distal surface 78 of the rotatable member 70 abuts the upper engagement surface 44u of the stop member 44a, thus preventing further upward rotational movement of the arm member 42. Contact surface 78 can be in contact with stop member 44a when rotatable body 74 is in the locked position and arm member 42 is oriented at its rest or first position in which angle α is zero. Alternatively when angle α is zero, arm limiter 60 and arm member 42 may also be configured to provide a clearance between contact surface 78 and stop member 44a for ease of rotation of body 74 into and out of the locked configuration, for manufacturing tolerances, and like factors. In one embodiment, if arm member 42 has a different position from first position 40a, the selected geometric configuration of at least one of the arm member 42, stop member 44, and rotatable member 70 can prevent rotatable member 70 from transitioning into the second configuration. For example, if the arm member 42 is rotationally different from the first position 40a (that is, angle α —illustrated in Figure 4C— is non-zero) by a predetermined amount as further discussed below, the edge 75a of the rotatable member abuts the rear surface 44r which prevents the rotatable member 70 from transitioning into the second configuration.

[0067] Turning to Figures 3A and 3B, in accordance with the illustrated embodiment, the actuator 88 rotates member 70 between the open configuration and the locking configuration via movement of the transfer linkage 84 along the forward and rearward directions F and R. As shown, the transfer linkage 84 is an elongate rod or bar that includes a rearward portion 85r and a forward portion 85f spaced from the rearward portion 85r in the forward direction F. The rearward portion 85r is coupled to the actuator 88 and the forward portion 85f slides within an elongated slot 13 that is defined by a plate extending from the frame 14.

[0068] As shown in Figure 3B, the biasing member 80 preferably is a strut that includes a rod 82a and a biasing element 82b, such as a coil spring, disposed about the rod 82a between a moveable stop element 82c and a fixed stop element 82d. The biasing member 80 defines a forward end 81f and a rearward end 81r disposed rearwardly with respect to the forward end 81f. As illustrated, opposed ends of the rod 82a define the forward and rearward ends 81f and 81r, respectively. The forward end 81f of the biasing member 80 is fixed to the rotatable member 70. A coupling plate 83 connects the transfer linkage 84 to the rearward end 81r of the biasing member 80 at the fixed stop element 82d. A distal end 83e of the rod 82a is slidable through a bore (not numbered) defined by the fixed stop element 82d. As the transfer linkage 84 is moved in the forward direction F by the actuator 88, the forward and rearward motion of the transfer linkage 84 is transferred to the rotatable member 70. In particular, when the controller 92 receives input from the input device 8 to operate the wheelchair 10 in the elevated motion mode, the controller 92 attempts to put arm limiter assembly 60 in the locked configuration by actuating the actuator 88 causing the transfer linkage 84 to move in the forward direction F and slide through the slot 13 along with the coupling plate 83. Movement of the coupling plate 83 urges the biasing member 80 toward the front of wheelchair 10, which in turn causes the rotatable member 70 to pivot about pivot axis P2 toward the second configuration (see Figure 4A). The spring 82b is selected so that the force required to compress the spring 82b is greater than the force required to urge the rotatable member 70 into the second configuration uninhibited. Spring 82b is configured to bias arm limiter assembly 60 toward the locked configuration.

[0069] Figures 4A, 4B, 4C illustrate an arm limiter assembly 60 in the locking configuration 71C (Figure 4A), the open configuration 71O (Figure 4B), and a blocked configuration 71B (Figure 4C), whereby the arm member 42 is preventing transition of the arm limiter assembly 60 from the open configuration 71O into the locking configuration 71C. Referring first to Figure 4B, during normal operation and when the seat 22 is in the lowered position, the arm limiter assembly 60 is in the open configuration. The actuator 88 has been actuated to retract the transfer linkage 84 and thus move the rotatable member 70 into the open configuration. As noted above, in the open configuration, the arm member 42 is rotatable through its maximum range of rotation, such that the wheelchair 10 is operable to traverse an obstacle O or a descent along the surface G.

[0070] Turning to Figure 4A, when wheelchair 10 is operated in an elevated mode—when the seat 22 is in the raised position—the arm limiter assembly 60 has transitioned into the

locked configuration, with one exception discussed below. For instance, the actuator 88 cause the transfer linkage 84 to move along the forward direction F, which in turn causes the rotatable member 70 to transition into the locking configuration as shown in Figure 4A. Because the rotatable member 70 has pivoted into locking configuration, the distal surface 78 of the rotatable member abuts the upper engagement surface 44u of the stop member 44a, thus preventing further upward rotational movement of the arm member 42. Accordingly, as the seat 22 is elevated into the raised position, the forward arm member 42 will have a limited range of rotation such that the wheelchair 10 is not operable to ascend an obstacle O along the surface G. When seat 22 is moved into a lowered position, the arm limiter assembly 60 transitions back into the open configuration such that range of motion of the arm member 42 is restored. In some embodiments, the wheelchair 10 is configured to require operation in the standard mode, when the seat 22 is lowered, before the full range of motion to the arm assembly 38 is restored and the obstacle can be safely traversed.

[0071] Referring now to Figure 4C, if front wheel 46 is on uneven ground surface G relative to the drive wheels 32, such as when the wheelchair begins traversing the obstacle O, the forward extending arm member 42 is pivoted in an upward rotational direction B1 (that is, angle α is positive) away from the first position 40a toward the second position 40b. For example, the second position 40b illustrated in Figure 4C can be when the arm member 42 is rotationally different from the first position 40a by a predetermined angle. In some embodiments the predetermined angle is by at least six (6) degrees, at least (5) degrees, at least four (4) degrees, at least three (3) degrees or at least two (2) degrees. In other embodiments, the predetermined angle is at least about six (6) degrees, at least about five (5) degrees, at least about four (4) degrees, at least about three (3) degrees or at least about two (2) degrees. As illustrated, the angle α_2 between the first line I1 and the fixed line I2 is about 4 degrees. If the controller 92 receives a request to operate the wheelchair in the elevated mode and elevate the seat 22 into the raised position (e.g., an elevated position that is pre-determined or selected to merit engagement of an anti-tip safety feature such as one or more of the features described herein), the actuator 88 causes or attempts to cause the transfer linkage 84 to move in forward direction F, which in turn causes or attempts to cause the rotatable member 70 to advance toward the locking configuration. Because the arm member 42 is pivoted upwards, the rear surface 44r of the stop member 44a abuts the forward edge 75a of the rotatable member 70, preventing further rotation of the rotatable member 70 into the locking configuration. However, even when the forward extending arm member 42 is pivoted upwards away from the first position 40a into the second

position 40b, the actuator 88 causes the transfer linkage 84 to bias the rotatable member 70 toward the locking configuration. More specifically, displacement of the transfer linkage 84 and the coupling plate 83 causes the biasing element 82b to compress as shown in Figure 4C. The compressed spring 82b applies a force to the moveable stop element 82c urging the rotatable member 70 toward the locked configuration, which as shown is abutting the stop 44a. Once wheelchair 10 has moved to a location on the surface G such that the front wheel 46 and the drive wheels 32 are on flat, level ground (i.e. the first position 40a), the compressed biasing element 82b will automatically urge the rotatable member 70 into the second configuration as shown in Figure 4A.

[0072] The wheelchair 10 in some embodiments can further include a linkage assembly that operatively connects the lift mechanism 18 to the arm limiter assembly 60 such that as the seat 22 is moved from the lowered position 5L to the raised position 5R, the linkage assembly automatically causes the arm limiter assembly 60 to move from the first or open configuration toward the second or locked configuration. The linkage assembly (not illustrated) can be configured such that the link can be capable of connecting to the lift mechanism 18 only when the front wheels 46 and the drive wheels 32 are on substantially even ground, for instance when the front wheels 46 are in the first position 40A as described above with respect to Figure 2A-4C. In an embodiment, the linkage can include a hook member that is movable between an engaged position whereby the hook member is capable of connecting to the lift mechanism 18 and a disengaged position hereby the hook member is incapable of connecting to the lift mechanism 18. It should be appreciated, however, that in such embodiments, the link can have configurations other than the hook member as desired. For instance, the linkage assembly may include one or more elongate legs secured to the rotatable member 70, 170, a connection member that operatively connects the lift mechanism 18 to the one or more elongate legs, and one or more springs connected to the one or more elongate legs and the rotatable member which are configured to bias the rotatable member 70, 170 into the second configuration. The connection member include a cable or assembly of rods or connection bars that engage the lift mechanism and selectively engage the one or more elongated legs. When the lift mechanism causes the seat 22 to move from the raised position into the lowered position, the linkage assembly may cause the rotatable member 70, 170 to rotate from the locking configuration into the open configuration. Movement of the seat 22 from the lowered position to the raised position, permits the rotatable member 70, 170 to move from the open configuration into the locking configuration.

[0073] Referring to Figure 5, the wheelchair 10 includes control system 90 that includes a controller 92 configured to operate the wheelchair 10 in different operational modes (e.g., one or more of the operation modes described herein). The controller 92 in some embodiments is in electronic communication with the lift mechanism motor 20, the drive motors 34 (or multiple drive motors if present), and the actuator or actuators 88. As noted above, the input device 8 is also in electronic communication with the controller 92. Further, a plurality of sensors 96a-96c can include, for example, one or more position sensors 96a that can determine the position of the components of the arm assembly 38 and arm limiter assembly 60, a seat-position sensor 96b, and an inclination sensor 96c.

[0074] The controller 92 can be configured as a computing device configured to process input signals and control operation of the wheelchair 10. The controller can include a processing portion 94a, a memory portion 94b, an input/output portion 94c, and a user interface (UI) portion 94d. It is emphasized that the block diagram depiction of the computing device control system 90 is exemplary and not intended to imply a specific implementation and/or configuration. The processing portion 94a, a memory portion 94b, an input/output portion 94c, and a user interface (UI) portion 94d can be coupled together to allow communications therebetween. As should be appreciated, any of the above components may be distributed across one or more separate control boards as needed.

[0075] In various embodiments, the input/output portion 94c includes electronic connectors for wired connections to the lift motor 20, drive motors 34, and actuators 88. The input/output portion 94c is capable of receiving and/or sending signals information pertaining to operation of the lift mechanism, drive motors 34 and actuators 88. The input/output portion is configured to receive information or signals from the input device 8 or sensors 96a-96b. The signals can include inputs, such as instructions to cause the actuator 88 to move the transfer linkage 84 in the forward and rearward direction F and R, or data, such as the position of the seat 22. Depending upon the exact configuration and type of processor, the memory portion 94b can be volatile (such as some types of RAM), non-volatile (such as ROM, flash memory, etc.), or a combination thereof. The controller 92 can include additional storage (e.g., removable storage and/or non-removable storage) including, but not limited to, tape, flash memory, smart cards, CD-ROM, digital versatile disks (DVD) or other optical storage, magnetic cassettes, magnetic tape, magnetic disk storage or other magnetic storage devices, universal serial bus (USB) compatible memory, or any other medium which can be used to store information and which can

be accessed by the controller 92. The user interface portion 94d can include an input device 8 and allows a user to communicate with the controller 92 and control operation of wheelchair as further detailed below.

[0076] Each arm limiter assembly 60 can further include one or more position sensors 96a in communication with the controller 92. For example, each arm limiter assembly 60 can include a first position sensor that is configured to detect when the rotatable member 70 is in the locking configuration. In some embodiments, a second position sensor is configured to detect the position of the arm member 42. For instance, the arm position sensor can include a limit switch that detects when the arm member 42 is in the first position 40a or the position sensor can detect the second position 40b as well as any incremental positions between the first and second positions 40a and 40b. Based on the detected positions, the controller is configured to determine, based on the detected positions of the arm member 42, if the arm member 42 is locked such that it is within the second, more limited range of rotation. Furthermore, the position data can be used by the controller 92 to cause the rotatable member 70 to progressively restrict the range of rotation of the forward arm member 42 relative to the frame 14. Preferably, controller 92 enables operation in the normal elevated mode only when arm limiter 60 is in the locking configuration. The actuator 88 can be configured to progressively move the rotatable member 70 based on at least one of speed of the wheelchair 10, the distance the seat is spaced from the frame 14, and the position of the arm member 42 as the wheelchair moves down an obstacle.

[0077] The seat-lift sensor 96b can be a limit switch that is configured to detect when the seat 22 has been moved out of the lowered position. For example, the seat-lift sensor detects when the seat 22 is in contact with the frame 14. If the seat 22 is not in contact with the frame 14, the sensor 96b can transmit a signal to the controller 92. In certain embodiments, the seat-lift sensor 96b can be a limit switch that is configured to detect when seat is moved out the lowered position. The controller 92 can cause a message to display on the input device 8 or cause some other operation as needed and based on inputs from the other sensors.

[0078] The inclination sensor 96c is configured to detect whether the frame 14 is in a level position with respect to a horizontal plane or an inclined or unlevelled position with respect to the horizontal plane along forward-rearward direction F-R and along a lateral direction C that is perpendicular to the forward-rearward direction F-R. The lateral direction C is not illustrated in the figures. The horizontal plane extends through the frame 14 is parallel to the surface G

when the wheelchair 10 is on a flat, level ground surface G. In accordance with the illustrated embodiment, the inclination sensors 96c can be secured to the frame 14 and oriented roughly parallel to the surface G. The inclination sensor 96c can measure the angular position data of the frame 14 relative to horizontal along the forward-rearward direction F-R and along the lateral direction C. The angular position data can be sent to the controller 92. The processing portion 94 determines, based on the angular position data, if the angular position of the frame 14 is within a predetermined threshold with respect to the horizontal plane in both the forward-rearward direction F-R and lateral direction C. The predetermined threshold is the range of inclination that is slight enough such that operation of the wheelchair 10 in the elevated motion mode would not cause a significant risk of instability due to the elevated center of gravity. The predetermined threshold depends on the particular parameters of the wheelchair and may be empirically chosen as will be understood by persons familiar with wheelchair design. For the embodiment shown in the figures, the inclination threshold may be about 1 degrees of inclination. If the frame 14 is inclined with respect to the horizontal plane (the inclination exceeds the predetermined threshold) compared with its at-rest state, the controller 92 may prevent operation of the wheelchair in the elevated motion mode or may restrict operation to an elevated-inhibited mode. For instance, if the controller 92 receives an input from the input device 8 to operate the wheelchair 10 in the elevated motion mode and the frame 14 is inclined with respect to the horizontal plane, the controller 92 will only operate the wheelchair 10 in an elevated motion mode if the arm limiter assemblies 60 are in the locking configuration. If, however, the frame 14 is not inclined with respect to the horizontal plane (the inclination is within the predetermined threshold) and the controller 92 receives an input to operate in the elevated motion mode, the controller 92 causes the lift mechanism to elevate the seat 22 to the raised position. As discussed earlier, the arm limiter assembly 60 would be moved into the locking configuration as well. In an embodiment, the inclination sensor 96c can include an accelerometer and/or gyroscope, or others as needed.

[0079] The input device 8 is in communication with the controller 92 and configured to be operated by the occupant of the wheelchair 10. The input device 8 can include a joystick, a keypad and a display. The joystick can cause the wheel chair to move forward, rearward, or turn to change directions. The keypad includes input buttons that control operation of the wheelchair 10. The display can cause the display of notifications regarding wheelchair operation. The keypad and display can be integrated into a touch screen that receives user inputs and cause the display of various messages regarding wheelchair operation. The display or keypad and/or

display can include input buttons that control various operational aspects of the wheelchair. For instance, the keypad include buttons that when depressed cause the wheelchair 10 to operate in the elevated motion mode. The controller 92 is configured to, in response to inputs from the input device 8 to operate the wheelchair 10 in the elevated motion mode, cause the input device 8 to display a message or otherwise indicate that the elevated motion mode is permitted. If the elevated motion mode is permitted, controller 92 causes the lift mechanism to move the seat 22 into the raised position when the frame 14 is level and the arm limiter assembly 60 is in the locking configuration.

[0080] The wheelchair 10 is, in some embodiments, configured to operate in the elevated motion mode only when one or more safety criteria are satisfied. As noted above, the safety criteria can include the position of the seat 22 (e.g., raised from its lowermost position), inclination of the frame 14, and the configuration of the arm limiter assemblies 60. If the seat 22 is in raised position, the center of gravity is elevated which decreases wheelchair stability. Further, the risk of tipping the wheelchair 10 increases when wheelchair 10 is attempting to ascend an obstacle and the seat is elevated. Further, stability is adversely affected when the frame 14 is inclined. The arm limiter assemblies 60 are configured to limit the ability of the wheelchair 10 to ascend an obstacle along the surface G if the seat is in raised position. Accordingly, if the controller 92 determines that fewer than all of the safety criteria are met, the controller 92 causes the input device 8 to display a message or otherwise indicate that the elevated motion mode is not permitted or is restricted to the elevated-inhibited mode.

[0081] An embodiment of the present disclosure includes methods for operating wheelchair 10 in the standard mode, as shown in Figure 6A, and the elevated motion modes, as shown in Figure 6B. Turning to Figure 6A, assuming that wheelchair 10 is on flat, level ground and the seat is in the fully lowered position, a method according to an embodiment includes steps 300-320. In step 300 the occupant of the wheelchair 10 can request to operate the wheelchair 10 in the elevated motion mode via the input device. At step 304, the controller in response to this input from the occupant causes the arm limiter assemblies 60 to move toward the locked configuration.

[0082] At step 308, the controller 92 receives angular position data from inclination sensor (e.g., inclination sensor 96c). The controller 92 will determine, based on the angular position data obtained from the inclination sensor, whether the frame 14 is level. At step 312, if the frame 14 is not level, the controller 92 causes an indication to display on the display device

that the elevated motion mode is not permitted. The controller 92 can also cause the display of message indicating that the occupant should drive the wheelchair 10 to level, flat ground. If, in step 308, the controller determines that the frame 14 is level, process control is transferred to step 316.

[0083] In step 316, the arm limiter position sensors (e.g., position sensors 96a) send a signal to the controller 92 regarding the arm limiter position data for the arm limiter assemblies 60. The controller 92 determines, based on the arm limiter position data, whether the arm limiter assemblies 60 are in the locked configuration. If the controller 92 determines that the arm limiter assemblies 60 are not in the locked configuration, the controller 92 causes an indication to display on the display device that the elevated motion mode is not permitted. The controller can also cause the display of message indicating that the occupant should drive the wheelchair 10 to level, flat ground. At this instance, the arm member 42 may be in the second position 40b such that stop member 44a inhibits rotation of the rotatable member 70 into the second configuration (see Figure 4C). When the wheelchair 10 has moved to level, flat ground, the arm member 42 is moved back toward the first position and the biasing member 80 will automatically urge the arm limiter assembly 60 into the locked configuration as discussed above.

[0084] At step 320, the controller 92 determines, based on inputs from each sensor, that all safety criteria are met. For instance, the controller 92 determines if the seat 22 is in the lowered position and the arm limiter assembly 60 is in the locked configuration. The controller 92 will indicate via the display device that operation of wheelchair 10 in the elevated motion mode is permitted. Process control is transferred to step 330 shown in Figure 6B.

[0085] Turning now to Figure 6B, a method for operating the wheelchair 10 in the elevated motion mode is illustrated. At step 330, controller 92 can, based on input from the input device 8 or automatically, cause the lift mechanism 18 to raise the seat 22 from the lowered position into the raised position. At step 334, the controller can cause the actuators 88 to move the rotatable members 70 toward the locked configuration.

[0086] At step 338, the controller 92, based on inputs from the inclination sensors (e.g., inclination sensor 96c) and arm limiter position sensors (e.g., position sensors 96a), can determine if the frame 14 is level and if the rotatable members 70 are in the locked configuration. In other words, in step 338, the controller 92 determines if all safety criteria are met. At step 342, if all safety criteria are met, the wheelchair 10 is permitted to operate in the elevated motion

mode and the controller 92 powers the drive motors 34 such that the wheelchair 10 is capable of moving within the maximum raised-seat drive speed (e.g., 0 mph to 5 mph). In this regard, the controller 92 operates the drives up to the maximum raised-seat drive speed when the seat 22 is in the raised position and the rotatable member 70 is in the locked configuration. At step 342, if the controller 92 determines that less than all of the safety criteria are met when the wheelchair 10 is in the elevated motion mode, the controller 92 powers the drive motors 34 such that the wheelchair is capable of moving within the maximum raised-inhibited drive speed range (e.g., 0 mph to 3.75 mph). In this regard, the controller 92 operates the drive motors 34 so as to advance the wheelchair 10 up to the maximum raised-inhibited seat drive speed when the seat 22 is in the raised position and the rotatable member 70 is in the open or first configuration. As noted above, the upper limit of the maximum raised-inhibited seat drive speed range is less than the upper limit of the maximum raised-seat drive speed range. Accordingly, the wheelchair 10 is configured to limit the maximum attainable speed when the rotatable members 70 are in the open configuration and the arm members 42 are pivotable so as to traverse an obstacle.

[0087] At step 346, if the controller determines that all of safety criteria are not met, the controller 92 causes the display device to display a message to the occupant that the elevated motion mode is not permitted. The controller 92 can also cause the display of message indicating that the occupant should drive the wheelchair 10 to level, flat ground. If during operation of wheelchair 10 in the elevated motion mode the wheelchair 10 traverses an inclined surface or some other obstacle, the inclination sensor obtains the angular position data for the frame 14 as discussed above. At step 348, if the controller 92 determines, based on angular position data, that the frame 14 has transitioned from a level position to an inclined position that exceeds the predetermined threshold, the controller 92 automatically causes the drive motors 34 to reduce the speed of the wheelchair 10 to within the maximum raised-inhibited drive speed range.

[0088] Accordingly, in response to input from an input device to operate the wheelchair in an elevated motion mode and in response to data obtained from the inclination sensors and arm limiter position sensors, the controller 92 according to some embodiments is configured to: (i) power the drive motors 34 such that the wheelchair is capable of moving within the maximum raised-seat drive speed range when the seat is in the raised position, the locking mechanism is in the locked configuration, and the frame 14 is level. Further, the controller is configured to power the drive motors 34 such that the wheelchair 10 is capable of moving at the maximum

raised-inhibited drive speed when the seat 22 is in the raised position and either A) the rotatable member is in the open configuration, and/or B) the frame is in the unlevelled position. It should be appreciated, however, that the controller can be configured to operate the wheelchair 10 in an desired mode based on data obtained from the sensors in any order desired and after any desired criteria are met.

[0089] Figures 7-13B illustrate wheelchairs according to alternate embodiments of the present disclosure. Turning to Figures 9A and 9B, a powered wheel chair 110 is configured similar to the wheelchair 10 described above and illustrated in Figures 1-5. Accordingly, the description below regarding wheelchair 110 will use similar reference signs to identify elements common to wheelchair 10 and wheelchair 110. Powered wheelchair 110 includes a frame 14, drive wheels 32 coupled to the frame 14, forward arm assemblies 38, rear arm assemblies 48, a lift mechanism 18 and a seat 22 supported by the lift mechanism 18. Further, the powered wheel chair 110 includes control system 90 and associated sensors 96a, 96b, 96c.

[0090] Continuing with Figures 9A and 9B, in the alternative embodiment, the powered wheel chair 110 includes a pair of arm limiter assemblies 160. Only one arm limiter assembly will be described below, as the opposite arm limiter assembly in the pair is similarly constructed. The arm limiter assembly 160 includes a rotatable member 170 pivotably coupled to the frame 14, a compressible or moveable end 174b, an actuator 88 (not shown in Figures 9A and 9B), a linkage 84 coupled to the actuator, and a biasing member 80 coupled to the linkage 84 and the rotatable member 170. Actuation of the actuator 88 translates the linkage 84, which in turn, causes the biasing member 80 to advance the rotatable member 70 from the open configuration 71O (Figure 9A) into the locked configuration 71C (Figure 9A). At least a portion of the rotatable member 170 is configured to at least partially compress or move along an axis 71 in response to upward movements of the arm member 42 against the end 174b when the rotatable member 70 is in the locking configuration, as further detailed below. The biasing member 80 can be directly or indirectly coupled to the linkage 84 and the rotatable member 170

[0091] Referring to Figure 7 and 9B, the rotatable member 170 includes a body 173b, a translating member 176 moveably coupled to the body 173b, and a biasing member 178. As shown in Figure 9B, when the rotatable member 170 is in the locking configuration 70L and the wheelchair 10 ascends over an obstacle O, the biasing member 178 allows the arm member 42 to partially rotate upwards against the force of biasing member 178 so as to prevent the wheelchair from high-centering (*e.g.* drive wheels are able to contact the ground when the chair ascends a

low obstacle). Continuing with Figure 7, the rotatable member 170 has a first or proximal portion 170a and a second or distal portion 170b spaced from the proximal portion 170a along the axis 71 in a distal direction 4. The distal direction 4 is aligned with and parallel to the axis 71. The proximal portion 170a includes a proximal end 174a and the distal portion 170b includes the moveable or distal end 174b. As illustrated, the translating member 176 defines the moveable end 174b. The biasing member 178 is disposed at least partially between the proximal portion 170a and the distal portion 170b. The biasing member 178 is illustrated as a spring 170c. And while a helical compression spring is illustrated, other spring types could be used as well. Further, the biasing member 170c can have other configurations, such as for example, a hydraulic piston as desired, a compressible material, such as gel or foam, or other device or structure than provide a counter force against force applied to translating member 176 to cause the translating member to advance along axis 71.

[0092] Continuing with Figure 7, the body 173b is configured to couple to the frame 14 and support the translating member 176 and biasing member 178. The body 173b defines the proximal end 174a, a forward side 175a, a rearward side 175b opposed to the forward side 175a along a transverse direction 6 that is perpendicular to the axis 71. The body 173b defines a width W1 (not shown) that extends from the forward side 175a to the a rearward side 175b in the transverse direction 6. The body 173b includes a pair of arms 173e and 173f defining a gap (not numbered). The body 173 defines a surface 173s that extends from arm 173e to arm 173f along the transverse direction 6, and a channel 171a extends from the surface 173s into the body 173b along the axis 71 toward the proximal end 174a. An elongate slot 173d extends through the body 173b and is in communication with the channel 171a. The body 173b can be a rigid plate or rod. As illustrated, the body 173b is an elongate plate with extending arms 173e and 173f.

[0093] As noted above and illustrated in Figure 7, the translating member 176 is configured to compress or move in response to force applied to it by the arm member 42. More specifically, in accordance with the illustrated embodiment, the translating member is translatable 1) toward the body 173b in an upward or proximal direction 2 that is opposite to distal direction 4, and 2) away from the body 173b in the distal direction 4. The translating member 176 includes a connection member 171b, such as a rod, that is moveably coupled to the body 173b with a fastener 171c. The rod 171b is received by the channel 171a and moveable within the channel 171a along the axis 71. The fastener 171c extends through the slot 173d and is fixed to the portion of the rod 171b in the channel 171c. As the rod 171b moves within the

channel 171a, the fastener slides within the slot 173b. It should be appreciated, however, that the translating member 176 and the body 173b can be coupled together in other ways. For example, the proximal portion 170a can include the rod and the distal portion 170b can define the channel as desired. Further, the connection member 171b is not limited to a rod but can be a plate or other elongate structure.

[0094] Continuing with Figure 7, the distal end 174b, such as the translating member 176, can define an outer surface with any shape or profile that is configured to engage the arm member 42 as the arm member 42 pivots relative to the frame 14 during operation of the wheelchair. Accordingly, the distal end 174b can have a surface that is configured to abut the arm member 42 only when the rotatable member 70 or the arm member 42 is in specific orientations relative to the frame 14, e.g. when the rotatable member 70 is the locking configuration. In addition, the distal end 174b can be configured to progressively restrict rotational movement of the arm member 42 dependent upon the orientation of the rotatable member 70 relative to the frame 14. For instance, the rotational limit the rotatable member 70 applies to the arm member 42 can vary as the position of the rotatable member 70 varies with respect to the frame 14.

[0095] In accordance with the embodiment illustrated in Figure 7, the translating member 176 further defines an outer surface 179a that is configured to engage the stop member 44a of the arm member 42. For instance, the outer surface 179a includes a forward surface portion 179f, a rearward surface portion 179r opposite to the forward surface portion along a transverse direction 6, and a distal-most surface portion 179d that extends from the forward surface portion 179f to the rearward surface portion 179r. The forward surface portion 179f is configured to engage the rear surface 44r of the arm assembly 42 if the arm member 42 is ascending an obstacle before the rotatable member 170 has transitioned into the locking configuration (see e.g. Figure 4C). And while the forward and rearward surface portions 179f and 179r are illustrated parallel to the axis 71, the forward and rearward surface portions 179f and 179r can have any shape, curvature, or inclination as needed. The distal-most surface portion 179d, or distal surface 179d, is configured to abut the upper surface 44u of the stop member 44a when the rotatable member 170 is in the locking configuration. The translating member 176 defines a width W1 (not shown) that extends from the forward surface portion 179f to the rearward surface portion 179r in the transverse direction 6. The body 173b defines a width W2 (not shown) that extends from the forward side 175a to the rearward side 175b in the

transverse direction 6. As illustrated the width W1 of the translating member 176 is about equal to the width W2 of the body 173b. However, it should be appreciated that the width W1 of the translating member 176 can be greater than the width W2 of the body 173b. For example, in embodiments where the translating member 176 is configured for progressive restriction of rotational motion of the arm member 42, the translating member width W1 could be greater than the width W2 of the body 173b.

[0096] Figures 8A-8D schematically illustrate various alternate embodiments of the translating member 176. As noted above, the translating member can define any particular shape and/or surface profile to engage the arm member 42 during operation of the wheelchair. For instance, the translating member 192a (Figure 8A) defines first and second distal surfaces 199a and 198a. The first surface 199a is inclined at an oblique angle with respect to the axis 71 and the transverse direction 6, the second surface 198a is normal to the axis 71. Translating member 192b (Figure 8B) defines a distal surface 198b that is slightly curved with respect to the axis 71 and is inclined along the transverse direction 6. Translating member 192c (Figure 8C) defines a distal surface 198c that is curved with respect to the axis 71 and the surface extends from the intersection of the axis 71 and surface 198c toward edges 175a and 175b. The leading surfaces 192a, 192b, and 192c provide a ramp or cam surface for engaging stop member 44a. Translating member 192d shown in Figure 8D defines a distal surface 198d that inclines toward the rearward side 175b of the rotatable member 170.

[0097] Turning to Figures 10A-10D, a powered wheelchair 210 according to an alternative embodiment of the present disclosure is configured similar to the wheelchair 10, 110 described above and illustrated in Figures 1-5 and 9A-9B. For instance, the powered wheelchair 210 includes a frame 14, drive wheels 32 coupled to the frame 14, a pair of forward arm assemblies 38, a pair of rear arm assemblies 48, and a lift mechanism 18 mounted to the frame 14 and configured to move the seat 22 between the lowered and raised positions 5R. The powered wheelchair 210 includes control system 90 and sensors 96a, 96b, 96c similar to the wheelchair 10 described above. Accordingly, the description below regarding wheelchair 210 will use similar reference signs to identify elements common to wheelchair 10 and wheelchair 210.

[0098] In accordance with the alternative embodiment, the powered wheelchair 210 includes a pair of arm limiter assemblies 260 configured to selectively engage the forward arm assemblies 38 so as to inhibit relative motion between the arm assemblies 38 and frame 14 in

certain instances during operation of the wheelchair 210. As illustrated in Figures 10A-10C, the arm limiter assembly 260 includes a first mating member 264 supported by the arm assembly 38 and a second mating member 268 supported by the frame 14 that is configured to mate with the first mating member 264 only when the front wheel 46 and drive wheel 32 are on substantially flat, level ground, for instance when the arm member 42 is in the first position 40a (Figure 10A, (similar to Figure 3A).

[0099] Further, the arm limiter assembly 260 has a first or open configuration and a second or locked configuration. When the arm limiter assembly 160 is in the open configuration as shown in Figures 10B and 10C, the first and second mating members are not engaged and the arm assembly 38 can pivot through the first range of rotation. When the arm limiter assembly 260 is in the second or locked configuration as shown in Figure 10A, the first and second mating members are engaged with each other and the arm assembly 38 is permitted to pivot through the second range of rotation that is less than the first range of rotation. In the locked configuration, the arm assembly 38 may still pivot to a limited extent, such as 4 degrees away from the first position 40a, because the mating member may be a slotted opening as explained more fully below. Alternatively, when the arm assembly 38 is in locked configuration, the arm assembly 38 may not pivot at all away from the first position 40a. In the illustrated embodiment, the first mating member 264 can be an aperture 272 and the second mating member 268 can be a pin 276 that is configured to be received by the aperture 272. It should be appreciated, however, that the pin 276 can be supported by the arm assembly 38 and the aperture 272 supported by the frame 14 as desired.

[0100] Continuing with Figures 10A-10D, the arm limiter assembly 260 includes an actuator 88, a linkage 284, and a pin assembly 286 coupled to linkage 284. The pin assembly 286 includes a projection in the form a pin 276. In the illustrated embodiment, the pin 276 is the first mating member 264. The arm limiter assembly 260 further includes a leg 274 fixed to the arm member 42 and a plate 290 directly or indirectly coupled to the leg 274. The actuator 88 is in the position to maintain the pin 276 in a retracted position when the seat 22 is in the lowered position as shown in Fig. 10B to enable standard mode operation of the wheelchair. The actuator 88 moves the pin 276 toward an engaged position whereby the pin 276 is received by the aperture 272 when the controller 92 receives an input to move the wheelchair 210 in the elevated motion mode and the seat 22 is in raised position as shown in Figure 10A, or otherwise to lock the front arm assembly 38.

[0101] The leg 274 is coupled to the arm member 42 proximate the pivot axis P1. As the arm member 42 rotates about the pivot axis P1, the leg 274 and the plate 290 rotates about pivot axis P1. If the arm member 42 rotates in a first rotation direction B1, the plate 290 rotates in the second rotational direction B2 (Fig. 10B). The plate 290 includes a plate body 292, a first surface 293, a second surface 294 opposed to the first surface 293, and a thickness T (not shown) that extends from the first surface 293 to the second surface 294. The plate can define an upper edge 295 and a lower edge 296. The plate is curved as it extends from the upper edge 295 to the lower edge 296. In addition, the plate 290 defines at least one aperture 272 (Fig. 10D) that extends along a direction aligned or parallel to the thickness T. The aperture 272 is sized and configured to receive the pin 276. More specifically, the plate 290 defines an aperture edge 275. The aperture edge 275 defines the aperture 272. For instance, the aperture 272 can be an elongate slot elongate along a direction that is angularly offset with respect to the thickness either vertically with respect to forward-rearward direction. In other embodiments, the aperture can be circular, oval, or other shaped opening. Further, in alternative embodiments, the plate 290 is configured so that the pin 276 can ride along its surface until pin 276 extends beyond an edge of the plate 290, such as the aperture edge 275 or the lower edge in accordance with certain embodiments.

[0102] Continuing with Figures 10A-10D, in operation, controller 92 receives an input to operate wheelchair 210 with the seat 22 in the raised position. In response, the controller 92 causes the actuator 88 move the pin 276 to move into an extended configuration toward the plate 290. As shown in Figure 10A, when the plate 290 is in an aligned position whereby the aperture 272 is aligned with the pin 276, for example due to orientation of the arm member 42 along along flat, level ground G, the pin 276 extends into the aperture 272. When the pin 276 extends along the edge 275 into the aperture 272, the arm limiter assembly 260 is in the locked configuration and movement of the arm member 42 is limited. If, however, the wheelchair 210 is traversing an obstacle O as shown in Figure 10C and the seat 22 is in the lowered position, the arm member 42 is pivoted upwards in a first rotational direction B1 and the plate 290 moves downward toward the surface G. This in turn causes the plate 290 to slide along the pin 276 such that the pin 276 is disposed adjacent the surface 294 and positioned upward with respect to aperture edge 275. The plate 290 in this position blocks the pin 276 from extending into the engaged position. Because the pin 276 is prevented from moving into the engaged position in the aperture 272, the arm limiter assembly 260 is prevented from transitioning into the second or locked configuration. The wheelchair 210 operates similar in some respects as to how the

wheelchair 10, 110 operates when the arm limiter assembly 60, 160 is prevented from the transitioning to the locked configuration. For instance, the controller 92 may prevent operation of one or more aspects of the wheelchair 210 in the elevated motion mode, for example, if the condition of the arm limiter being in the locking condition is not met. After the wheelchair 210 traverses the obstacle O, the arm member 42 pivots downwardly until the front wheel 46 and the drive wheels 32 are on flat, level ground as shown in Figures 10A and 10B. At this point, the plate 290 is moved upwardly sliding along the pin 276 until the pin 276 is aligned with the aperture 272. The pin 276, via the actuator as noted above, urges the pin 276 to extend along the aperture edge 275 into the aperture 272 placing the arm limiter assembly 260 in the locked configuration. In this regard, the plate 290 is configured as a sliding member.

[0103] The aperture 272 can be elongate along the direction the pin 276 slides along the plate 290. In such embodiments, the arm member 42 can pivot through the second range of rotation (less than the first range of rotation) when the arm limiter assembly 260 is in the locked configuration while pin 276 is located in slotted aperture 272. In this regard, the plate 290 is configured to permit the arm member 42 to pivot up to 4 or 5 degrees away from its initial position 40a even when the arm limiter 260 is in the locked configuration. This particular embodiment permits the arm assembly 38 to traverse slight obstacles and prevent the arm assembly 38 and the arm limiter assembly 260 from locking out, and permits arm assembly 38 to be limited in its downward (direction B2) movement. It should be appreciated, however, that the aperture 272 can have a diameter or other dimension that is substantially equal to that of the pin 276 such that when the pin 276 is received by the aperture 272, the forward extending arm 42 is fixed relative to the frame 14 with little or no movement.

[0104] As illustrated, the aperture 272 is disposed between the upper and lower plate edges 295 and 296 such that the pin 276 can extend along the aperture edge 275. It should be appreciated, however, that plate 290 can be configured without an aperture that receives the pin 276. For instance, the lower edge 296 can define a surface along which the pin 276 extends along in order to transition the arm limiter assembly 260 into the second configuration. In other words, the plate 290 can be moved into the locked or an aligned position when pin 276 is moveable along the lower edge 296 into its engaged position.

[0105] Turning to Figures 11A and 11B another embodiment of wheelchair 310 is schematically illustrated including an arm limiter assembly 360 according to yet another alternate embodiment of present disclosure. The powered wheelchair 310 according to an

alternative embodiment of the present disclosure is configured similar to the wheelchair 10 described above. Accordingly, the description below regarding wheelchair 310 will use similar reference signs to identify elements common to wheelchair 10 and wheelchair 310, such as the frame 14, drive wheels 32 (not shown), forward arm assemblies 38, rear arm assemblies 48 (not shown), lift mechanism 18 (not shown), seat 22, and control system 90 and sensors.

[0106] Continuing with Figures 11A and 11B, the arm limiter assembly 360 can be used on any one of the wheelchairs 10, 110, or 210 described above. Further, the wheelchair incorporating arm limiter assembly 360 may include similar components and operation characteristics described above except as noted otherwise. The arm limiter assembly 360 includes a disc 362 or a segment of a disc that is supported by the frame 14 and operatively engaged with arm assembly 38, and in particular to the proximal end 43p of the arm member 42. The arm limiter assembly 260 includes a caliper or clamp 370 that is supported by the frame 14 of the wheelchair 310 (frame and wheelchair not shown in Figures 11A and 11B). The clamp 370 can have a pair of moveable pads 372a and 372b spaced apart with respect to each other to define a gap 373. The gap 373 is sized to receive a portion of the disc 362 therein such there is no contact or light contact between the pads 372a and 372b and the corresponding surfaces of disk 362. The clamp 370 is configured to selectively engage the disc 362 to thereby restrict movement of the disc 362 and the arm member 42. For instance, the clamp 370 can be coupled to the actuator 88 such that when the actuator 88 is activated, the moveable arms 372a, 372b move toward each other in directions 385a and 385b against opposite surfaces 364 and 366 of the disc 362. In a first or open configuration, the disc 362 is moveable in the gap 373 and the arm member 42 is moveable through the first range of rotation or motion. When the wheelchair 310 operates in an elevated motion mode, the actuator 88 closes the clamp 370 tightening against the disc 362. Because the disc 362 is thus fixed to the arm member 42, movement of the arm member 42 is stopped. In an alternative embodiment, the disc 326 can have a protrusion or stop 368 that is positioned to align between the clamp arms 372a, 372b in the gap 373 when the arm member 42 is rotationally different from the first position 40a by more than 4 or 5 degrees. In this position, the disc 362, via the stop 368 in the gap 373, prevent the clamp arms 372a, 372b from transitioning into the clamped configuration against the surface 364 and 366, which in turn prevents arm limiter assembly 360 from locking movement of the disc and arm member 42.

[0107] Turning to Figures 12A-12C, a wheelchair 410 is illustrated including an arm limiter assembly 460 according to yet another alternate embodiment. The powered wheelchair

410 is configured similar to the wheelchair 10 described above and illustrated in Figures 1-5. Accordingly, the description below regarding wheelchair 410 will use similar reference signs to identify elements common to wheelchair 10 and wheelchair 410, such as the frame 14, drive wheels 32 (not shown), forward arm assemblies 38, rear arm assemblies 48 (not shown), lift mechanism 18 (not shown), seat 22, and control system 90 and sensors. In the alternative embodiment, the arm limiter assembly 460 can be configured as rear-ward arm limiter assembly.

[0108] Figures 12A, 12B, 12C schematically illustrate the arm limiter assembly 460 in the locking configuration 71C (Figure 12A), the open configuration 71O (Figure 12B), and a blocked configuration 71B (Figure 12C), whereby the arm member 42 is preventing transition of the arm limiter assembly 460 from the open configuration 71O into the locking configuration 71C. In the illustrated embodiment, the arm limiter assembly 460 can be configured as rearward arm limiter assembly. The arm limiter assembly 460 includes an actuatable unit 462 coupled between the frame 14 and the arm member 42. The actuatable unit 462 can have a housing 464 and an elongate member 466 in the form of a rod or bar that extends out from the housing 464 and is movable with respect to the housing 464. Figure 12B shows the elongate member 466 in its retracted position. The extended position of elongate member 466 is shown in dashed lines in Figure 12B. The elongate member 466 defines an end 468 spaced from the housing 464 along a direction 469 that is aligned with and parallel to the forward direction F of the wheelchair 410. The arm limiter assembly 460 has 1) a first or open configuration, whereby the elongate member 466 is retracted partially into the housing 464 such that the arm member 42 is pivotable through the first range of rotation as discussed above, 2) a second or locked configuration where the elongate member 466 abuts the stop 44a of the arm member 42, thereby preventing the arm member 42 from pivoting upwardly with respect to the frame 14, and 3) a blocked configuration where the arm limiter assembly is prevented from transitioning into the locked configuration. The actuatable unit 462 can be a hydraulic strut, magnetorheological strut, gas strut, or other device configured to allow one component to move relative to another component to selectively engage the arm member 42 as described herein.

[0109] Referring first to Figure 12B, during normal operation and when the seat 22 is in the lowered position, the arm limiter assembly 460 is in the open configuration. The actuator 88 has been actuated to cause the elongate member 466 to retract into the open configuration. Turning to Figure 12A, when wheelchair 10 is operated in an elevated mode—when the seat 22 is in the raised position—the arm limiter assembly 460 transitions into locked configuration such

that elongate member 466 is extended to block upward movement of the arm member 42. Accordingly, as the seat 22 is elevated into the raised position, the forward arm member 42 will have a limited range of rotation such that the wheelchair 410 is not operable to ascend an obstacle O along the surface G. Referring now to Figure 12C, if front wheel 46 is on uneven ground surface G relative to the drive wheels 32, such as when the wheelchair 410 begins ascent of the obstacle O, the arm member 42 is pivoted in an upward rotational direction B1 away from the first position 40a into the second position 40b that is rotationally different than the first position 40a. Because the arm member 42 is pivoted upwards, the stop member 44a abuts the forward end 468 of the elongate member 466, preventing further progression of the elongate member 466 into the locking configuration. Once wheelchair 410 has moved to a location on the surface G such that the front wheel 46 and the drive wheels 32 are on flat, level ground (i.e. the first position 40a), the actuatable unit 462 is configured to automatically urge the elongate member 466 into the locking configuration as shown in Figure 12A.

[0110] Turning to Figures 13A and 13B, a powered wheelchair 510 according to an alternative embodiment of the present disclosure is configured similar to the wheelchair 10 described above and illustrated in Figures 1-5. Accordingly, the description below regarding wheelchair 510 will use similar reference numerals to identify elements common to wheelchair 10 and wheelchair 510, such as the frame 14, drive wheels 32 (not shown), lift mechanism 18 (not shown), seat 22, and control system 90 and sensors. The forward arm assemblies 38 are as described above except for the stop member. In the alternate embodiment, the powered wheelchair 510 includes a pair of rearward arm assemblies 548 configured to pivot relative to the frame 14 between a first position 540a when the wheelchair is operating on flat, level ground, and any number of different positions depending on if the wheelchair 510 is ascending an obstacle or initiating a descent down an incline. The rearward arm assembly 548 is configured similar to the forward arm assembly 38 describe above with reference to Figures 1-5 and this paragraph, and includes an arm member 542, a rear wheel 47 coupled to the arm member 542. The arm member 542 can include a stop member 544a located in the same place on the arm member 542 as stop member 44a in wheelchair 10. The stop member 544a of the arm member 542 in the embodiment shown in Figures 13A and 13B is not rounded, but has a vertical contact face and a horizontal top surface. The rearward arm assembly 548 can move in a first rotational direction B1, e.g., upward, when the wheelchair 510 encounters an ascent, or a second rotational direction B1, e.g., downward, when the wheelchair 510 descends down an inclined surface.

[0111] The powered wheelchair 510 can be configured to limit relative movement of the rearward arm assembly 548 depending on the surface G the wheelchair 510 is operating along. For instance, the arm limiter assembly 560 has an open or first configuration in which the rearward arm assembly 548 is moveable relative to frame 14 through a first range of rotation relative to the pivot axis P1, and a second or locked configuration in which the rearward arm assembly 548 is prevented from moving relative to the frame 14 as needed. For instance, in the locked configuration, the arm limiter assembly 560 limits movement of the arm assembly 546 through a second range of rotation that is less than the first range of rotation. It should be appreciated that the second range of rotation can include the rearward arm assembly 548 being rotationally fixed relative to the frame 14. In the with the illustrated embodiment, the arm limiter assembly 560 shown in Figures 13A and 13B is configured similar to the actuatable unit type arm limiter assembly 460 described above with reference to Figures 12A-12C. For example, the arm limiter assembly 560 includes an actuatable unit 562 coupled between the frame 14 and the arm member 42. The actuatable unit 562 can have a housing 564 and an elongate member 566 in the form of a rod or bar that extends out from the housing 564 and is movable with respect to the housing 564. Figure 13B shows the elongate member 566 in its retracted position.

However, it should be appreciated that wheelchair 510 can include anyone of the arm limiter assemblies 60, 160, 260, and 360 as described above.

[0112] Turning to Figures 14A and 14B, an alternative embodiments of a powered wheelchair 610, the arm assembly 638 can be configured such that the wheel 46 or wheel axis A1 is translatably from the first position 40a to the second position 40b. In the embodiment shown in Figures 14A and 14B, powered wheelchair 610 is configured similar to the wheelchair 10 described above and illustrated in Figures 1-5. Accordingly, the description below regarding wheelchair 610 will use similar reference numerals to identify elements common to wheelchair 10 and wheelchair 610, such as the frame 14, drive wheels 32 (not shown), lift mechanism 18 (not shown), seat 22, arm limiter assembly 60, control system 90 and sensors. In an alternate embodiment, the powered wheelchair 610 includes a pair of forward arm assemblies 638 moveably coupled to a track 650 that extends forwardly from the frame 14. The track 650 receives the proximal end 43p (shown in dashed lines in Figures 14A and 14B) of the arm member 42. As illustrated, the proximal end 43p is slidable within the track 650 via a bearing or roller mechanism (not shown) so that arm member 42 and wheel 46 are translatably along the

track 650 upwardly or downwardly relative to the frame 14 in a linear direction C. The linear direction C can extend along the vertical direction V or may be angularly offset (as illustrated) with respect to the vertical direction V. Accordingly, the arm assemblies 638 are coupled to the frame 14 such that the wheel 46 is translatable from between the first position 40a and the second position 40b depending on the obstacle the wheel 46 is traversing. As noted above, operation of the arm assembly 638 is similar to operation of the arm assembly as the 008 patent noted above.

[0113] Continuing with Figures 14A and 14B, in alternative embodiments when the arm limiter assembly 60 is in the disengaged or open configuration the arm member 42 is translatable from the first position 40a through a first range of motion. When the arm limiter assembly 60 is in the engaged or locked configuration, the arm member 42 is translatable through a second range of motion that is less than the first range of motion. While arm member 42 is translatable along the linear direction C, the positional difference of the wheel 46 in the first and second positions 40a and 40b can have an angular component. The first position 40a in Figure 14A can be defined by first reference and second lines (not shown) that intersect the front wheel axis A1 and a forward-most point (651) located on the bottom 14b of the frame 14. When the arm assembly 638 translates the wheel 46 from the first position 40a to the second position 40b, the second reference line defines an angle $\alpha 1$ (not shown) with the first reference line (not shown). Accordingly, the range of motion as described with respect to wheelchair 16 can correspond to range of rotation described with respect to the wheelchair 10.

[0114] Figures 8A-8D schematically illustrate various alternate embodiments of the translating member 176. As noted above, the translating member can define any particular shape and/or surface profile to engage the arm member 42 during operation of the wheelchair. For instance, the translating member 192a (Figure 8A) defines first and second distal surfaces 199a and 198a. The first surface 199a is inclined at an oblique angle with respect to the axis 71 and the transverse direction 6, the second surface 198a is normal to the axis 71. Translating member 192b (Figure 8B) defines a distal surface 198b that is slightly curved with respect to the axis 71 and is inclined along the transverse direction 6. Translating member 192c (Figure 8C) defines a distal surface 198c that is curved with respect to the axis 71 and the surface extends from the intersection of the axis 71 and surface 198c toward edges 175a and 175b. The leading surfaces 192a, 192b, and 192c provide a ramp or cam surface for engaging stop member 44a. Translating

member 192d shown in Figure 8D defines a distal surface 198d that inclines toward the rearward side 175b of the rotatable member 170.

[0115] Turning to Figures 10A-10D, a powered wheelchair 210 according to an alternative embodiment of the present disclosure is configured similar to the wheelchair 10,110 described above and illustrated in Figures 1-5 and 9A-9B. For instance, the powered wheelchair 210 includes a frame 14, drive wheels 32 coupled to the frame 14, a pair of forward arm assemblies 38, a pair of rear arm assemblies 48, and a lift mechanism 18 mounted to the frame 14 and configured to move the seat 22 between the lowered and raised positions 5R. The powered wheelchair 210 includes control system 90 and sensors 96a, 96b, 96c similar to the wheelchair 10 described above. Accordingly, the description below regarding wheelchair 210 will use similar reference signs to identify elements common to wheelchair 10 and wheelchair 210.

[0116] In accordance with the alternative embodiment, the powered wheelchair 210 includes a pair of arm limiter assemblies 260 configured to selectively engage the forward arm assemblies 38 so as to inhibit relative motion between the arm assemblies 38 and frame 14 in certain instances during operation of the wheelchair 210. As illustrated in Figures 10A-10C, the arm limiter assembly 260 includes a first mating member 264 supported by the arm assembly 38 and a second mating member 268 supported by the frame 14 that is configured to mate with the first mating member 264 only when the front wheel 46 and drive wheel 32 are on substantially flat, level ground, for instance when the arm member 42 is in the first position 40a (Figure 10A, (similar to Figure 3A).

[0117] Further, the arm limiter assembly 260 has a first or open configuration and a second or locked configuration. When the arm limiter assembly 160 is in the open configuration as shown in Figures 10B and 10C, the first and second mating members are not engaged and the arm assembly 38 can pivot through the first range of rotation. When the arm limiter assembly 260 is in the second or locked configuration as shown in Figure 10A, the first and second mating members are engaged with each other and the arm assembly 38 is permitted to pivot through the second range of rotation that is less than the first range of rotation. In the locked configuration, the arm assembly 38 may still pivot to a limited extent, such as 4 degrees away from the first position 40a, because the mating member may be a slotted opening as explained more fully below. Alternatively, when the arm assembly 38 is in locked configuration, the arm assembly 38 may not pivot at all away from the first position 40a. In the illustrated embodiment, the first

mating member 264 can be an aperture 272 and the second mating member 268 can be a pin 276 that is configured to be received by the aperture 272. It should be appreciated, however, that the pin 276 can be supported by the arm assembly 38 and the aperture 272 supported by the frame 14 as desired.

[0118] Continuing with Figures 10A-10D, the arm limiter assembly 260 includes an actuator 88, a linkage 284, and a pin assembly 286 coupled to linkage 284. The pin assembly 286 includes a projection in the form a pin 276. In the illustrated embodiment, the pin 276 is the first mating member 264. The arm limiter assembly 260 further includes a leg 274 fixed to the arm member 42 and a plate 290 directly or indirectly coupled to the leg 274. The actuator 88 is in the position to maintain the pin 276 in a retracted position when the seat 22 is in the lowered position as shown in Fig. 10B to enable standard mode operation of the wheelchair. The actuator 88 moves the pin 276 toward an engaged position whereby the pin 276 is received by the aperture 272 when the controller 92 receives an input to move the wheelchair 210 in the elevated motion mode and the seat 22 is in raised position as shown in Figure 10A, or otherwise to lock the front arm assembly 38.

[0119] The leg 274 is coupled to the arm member 42 proximate the pivot axis P1. As the arm member 42 rotates about the pivot axis P1, the leg 274 and the plate 290 rotates about pivot axis P1. If the arm member 42 rotates in a first rotation direction B1, the plate 290 rotates in the second rotational direction B2 (Fig. 10B). The plate 290 includes a plate body 292, a first surface 293, a second surface 294 opposed to the first surface 293, and a thickness T (not shown) that extends from the first surface 293 to the second surface 294. The plate can define an upper edge 295 and a lower edge 296. The plate is curved as it extends from the upper edge 295 to the lower edge 296. In addition, the plate 290 defines at least one aperture 272 (Fig. 10D) that extends along a direction aligned or parallel to the thickness T. The aperture 272 is sized and configured to receive the pin 276. More specifically, the plate 290 defines an aperture edge 275. The aperture edge 275 defines the aperture 272. For instance, the aperture 272 can be an elongate slot elongate along a direction that is angularly offset with respect to the thickness either vertically with respect to forward-rearward direction. In other embodiments, the aperture can be circular, oval, or other shaped opening. Further, in alternative embodiments, the plate 290 is configured so that the pin 276 can ride along its surface until pin 276 extends beyond an edge of the plate 290, such as the aperture edge 275 or the lower edge in accordance with certain embodiments.

[0120] Continuing with Figures 10A-10D, in operation, controller 92 receives an input to operate wheelchair 210 with the seat 22 in the raised position. In response, the controller 92 causes the actuator 88 to move the pin 276 to move into an extended configuration toward the plate 290. As shown in Figure 10A, when the plate 290 is in an aligned position whereby the aperture 272 is aligned with the pin 276, for example due to orientation of the arm member 42 along flat, level ground G, the pin 276 extends into the aperture 272. When the pin 276 extends along the edge 275 into the aperture 272, the arm limiter assembly 260 is in the locked configuration and movement of the arm member 42 is limited. If, however, the wheelchair 210 is traversing an obstacle O as shown in Figure 10C and the seat 22 is in the lowered position, the arm member 42 is pivoted upwards in a first rotational direction B1 and the plate 290 moves downward toward the surface G. This in turn causes the plate 290 to slide along the pin 276 such that the pin 276 is disposed adjacent the surface 294 and positioned upward with respect to aperture edge 275. The plate 290 in this position blocks the pin 276 from extending into the engaged position. Because the pin 276 is prevented from moving into the engaged position in the aperture 272, the arm limiter assembly 260 is prevented from transitioning into the second or locked configuration. The wheelchair 210 operates similar in some respects as to how the wheelchair 10, 110 operates when the arm limiter assembly 60, 160 is prevented from the transitioning to the locked configuration. For instance, the controller 92 may prevent operation of one or more aspects of the wheelchair 210 in the elevated motion mode, for example, if the condition of the arm limiter being in the locking condition is not met. After the wheelchair 210 traverses the obstacle O, the arm member 42 pivots downwardly until the front wheel 46 and the drive wheels 32 are on flat, level ground as shown in Figures 10A and 10B. At this point, the plate 290 is moved upwardly sliding along the pin 276 until the pin 276 is aligned with the aperture 272. The pin 276, via the actuator as noted above, urges the pin 276 to extend along the aperture edge 275 into the aperture 272 placing the arm limiter assembly 260 in the locked configuration. In this regard, the plate 290 is configured as a sliding member.

[0121] The aperture 272 can be elongate along the direction the pin 276 slides along the plate 290. In such embodiments, the arm member 42 can pivot through the second range of rotation (less than the first range of rotation) when the arm limiter assembly 260 is in the locked configuration while pin 276 is located in slotted aperture 272. In this regard, the plate 290 is configured to permit the arm member 42 to pivot up to 4 or 5 degrees away from its initial position 40a even when the arm limiter 260 is in the locked configuration. This particular embodiment permits the arm assembly 38 to traverse slight obstacles and prevent the arm

assembly 38 and the arm limiter assembly 260 from locking out, and permits arm assembly 38 to be limited in its downward (direction B2) movement. It should be appreciated, however, that the aperture 272 can have a diameter or other dimension that is substantially equal to that of the pin 276 such that when the pin 276 is received by the aperture 272, the forward extending arm 42 is fixed relative to the frame 14 with little or no movement.

[0122] As illustrated, the aperture 272 is disposed between the upper and lower plate edges 295 and 296 such that the pin 276 can extend along the aperture edge 275. It should be appreciated, however, that plate 290 can be configured without an aperture that receives the pin 276. For instance, the lower edge 296 can define a surface along which the pin 276 extends along in order to transition the arm limiter assembly 260 into the second configuration. In other words, the plate 290 can be moved into the locked or an aligned position when pin 276 is moveable along the lower edge 296 into its engaged position.

[0123] Turning to Figures 11A and 11B another embodiment of wheelchair 310 is schematically illustrated including an arm limiter assembly 360 according to yet another alternate embodiment of present disclosure. The powered wheelchair 310 according to an alternative embodiment of the present disclosure is configured similar to the wheelchair 10 described above. Accordingly, the description below regarding wheelchair 310 will use similar reference signs to identify elements common to wheelchair 10 and wheelchair 310, such as the frame 14, drive wheels 32 (not shown), forward arm assemblies 38, rear arm assemblies 48 (not shown), lift mechanism 18 (not shown), seat 22, and control system 90 and sensors.

[0124] Continuing with Figures 11A and 11B, the arm limiter assembly 360 can be used on any one of the wheelchairs 10, 110, or 210 described above. Further, the wheelchair incorporating arm limiter assembly 360 may include similar components and operation characteristics described above except as noted otherwise. The arm limiter assembly 360 includes a disc 362 or a segment of a disc that is supported by the frame 14 and operatively engaged with arm assembly 38, and in particular to the proximal end 43p of the arm member 42. The arm limiter assembly 260 includes a caliper or clamp 370 that is supported by the frame 14 of the wheelchair 310 (frame and wheelchair not shown in Figures 11A and 11B). The clamp 370 can have a pair of moveable pads 372a and 372b spaced apart with respect to each other to define a gap 373. The gap 373 is sized to receive a portion of the disc 362 therein such there is no contact or light contact between the pads 372a and 372b and the corresponding surfaces of disk 362. The clamp 370 is configured to selectively engage the disc 362 to thereby restrict

movement of the disc 362 and the arm member 42. For instance, the clamp 370 can be coupled to the actuator 88 such that when the actuator 88 is activated, the moveable arms 372a, 372b move toward each other in directions 385a and 385b against opposite surfaces 364 and 366 of the disc 362. In a first or open configuration, the disc 362 is moveable in the gap 373 and the arm member 42 is moveable through the first range of rotation or motion. When the wheelchair 310 operates in an elevated motion mode, the actuator 88 closes the clamp 370 tightening against the disc 362. Because the disc 362 is thus fixed to the arm member 42, movement of the arm member 42 is stopped. In an alternative embodiment, the disc 326 can have a protrusion or stop 368 that is positioned to align between the clamp arms 372a, 372b in the gap 373 when the arm member 42 is rotationally different from the first position 40a by more than 4 or 5 degrees. In this position, the disc 362, via the stop 368 in the gap 373, prevent the clamp arms 372a, 372b from transitioning into the clamped configuration against the surface 364 and 366, which in turn prevents arm limiter assembly 360 from locking movement of the disc and arm member 42.

[0125] Turning to Figures 12A-12C, a wheelchair 410 is illustrated including an arm limiter assembly 460 according to yet another alternate embodiment. The powered wheelchair 410 is configured similar to the wheelchair 10 described above and illustrated in Figures 1-5. Accordingly, the description below regarding wheelchair 410 will use similar reference signs to identify elements common to wheelchair 10 and wheelchair 410, such as the frame 14, drive wheels 32 (not shown), forward arm assemblies 38, rear arm assemblies 48 (not shown), lift mechanism 18 (not shown), seat 22, and control system 90 and sensors. In the alternative embodiment, the arm limiter assembly 460 can be configured as rear-ward arm limiter assembly.

[0126] Figures 12A, 12B, 12C schematically illustrate the arm limiter assembly 460 in the locking configuration 71C (Figure 12A), the open configuration 71O (Figure 12B), and a blocked configuration 71B (Figure 12C), whereby the arm member 42 is preventing transition of the arm limiter assembly 460 from the open configuration 71O into the locking configuration 71C. In the illustrated embodiment, the arm limiter assembly 460 can be configured as rearward arm limiter assembly. The arm limiter assembly 460 includes an actuatable unit 462 coupled between the frame 14 and the arm member 42. The actuatable unit 462 can have a housing 464 and an elongate member 466 in the form of a rod or bar that extends out from the housing 464 and is movable with respect to the housing 464. Figure 12B shows the elongate member 466 in its retracted position. The extended position of elongate member 466 is shown in dashed lines in Figure 12B. The elongate member 466 defines an end 468 spaced from the housing 464 along a

direction 469 that is aligned with and parallel to the forward direction F of the wheelchair 410. The arm limiter assembly 460 has 1) a first or open configuration, whereby the elongate member 466 is retracted partially into the housing 464 such that the arm member 42 is pivotable through the first range of rotation as discussed above, 2) a second or locked configuration where the elongate member 466 abuts the stop 44a of the arm member 42, thereby preventing the arm member 42 from pivoting upwardly with respect to the frame 14, and 3) a blocked configuration where the arm limiter assembly is prevented from transitioning into the locked configuration. The actuatable unit 462 can be a hydraulic strut, magnetorheological strut, gas strut, or other device configured to allow one component to move relative to another component to selectively engage the arm member 42 as described herein.

[0127] Referring first to Figure 12B, during normal operation and when the seat 22 is in the lowered position, the arm limiter assembly 460 is in the open configuration. The actuator 88 has been actuated to cause the elongate member 466 to retract into the open configuration. Turning to Figure 12A, when wheelchair 10 is operated in an elevated mode—when the seat 22 is in the raised position—the arm limiter assembly 460 transitions into locked configuration such that elongate member 466 is extended to block upward movement of the arm member 42. Accordingly, as the seat 22 is elevated into the raised position, the forward arm member 42 will have a limited range of rotation such that the wheelchair 410 is not operable to ascend an obstacle O along the surface G. Referring now to Figure 12C, if front wheel 46 is on uneven ground surface G relative to the drive wheels 32, such as when the wheelchair 410 begins ascent of the obstacle O, the arm member 42 is pivoted in an upward rotational direction B1 away from the first position 40a into the second position 40b that is rotationally different than the first position 40a. Because the arm member 42 is pivoted upwards, the stop member 44a abuts the forward end 468 of the elongate member 466, preventing further progression of the elongate member 466 into the locking configuration. Once wheelchair 410 has moved to a location on the surface G such that the front wheel 46 and the drive wheels 32 are on flat, level ground (i.e. the first position 40a), the actuatable unit 462 is configured to automatically urge the elongate member 466 into the locking configuration as shown in Figure 12A.

[0128] Turning to Figures 13A and 13B, a powered wheelchair 510 according to an alternative embodiment of the present disclosure is configured similar to the wheelchair 10 described above and illustrated in Figures 1-5. Accordingly, the description below regarding wheelchair 510 will use similar reference numerals to identify elements common to wheelchair

10 and wheelchair 510, such as the frame 14, drive wheels 32 (not shown), lift mechanism 18 (not shown), seat 22, and control system 90 and sensors. The forward arm assemblies 38 are as described above except for the stop member. In the alternate embodiment, the powered wheelchair 510 includes a pair of rearward arm assemblies 548 configured to pivot relative to the frame 14 between a first position 540a when the wheelchair is operating on flat, level ground, and any number of different positions depending on if the wheelchair 510 is ascending an obstacle or initiating a decent down an incline. The rearward arm assembly 548 is configured similar to the forward arm assembly 38 describe above with reference to Figures 1-5 and this paragraph, and includes an arm member 542, a rear wheel 47 coupled to the arm member 542. The arm member 542 can include a stop member 544a located in the same place on the arm member 542 as stop member 44a in wheelchair 10. The stop member 544a of the arm member 542 in the embodiment shown in Figures 13A and 13B is not rounded, but has a vertical contact face and a horizontal top surface. The rearward arm assembly 548 can move in a first rotational direction B1, e.g., upward, when the wheelchair 510 encounters an ascent, or a second rotational direction B1, e.g., downward, when the wheelchair 510 descends down an inclined surface.

[0129] The powered wheelchair 510 can be configured to limit relative movement of the rearward arm assembly 548 depending on the surface G the wheelchair 510 is operating along. For instance, the arm limiter assembly 560 has an open or first configuration in which the rearward arm assembly 548 is moveable relative to frame 14 through a first range of rotation relative to the pivot axis P1, and a second or locked configuration in which the rearward arm assembly 548 is prevented from moving relative to the frame 14 as needed. For instance, in the locked configuration, the arm limiter assembly 560 limits movement of the arm assembly 546 through a second range of rotation that is less than the first range of rotation. It should be appreciated that the second range of rotation can include the rearward arm assembly 548 being rotationally fixed relative to the frame 14. In the with the illustrated embodiment, the arm limiter assembly 560 shown in Figures 13A and 13B is configured similar to the actuatable unit type arm limiter assembly 460 described above with reference to Figures 12A-12C. For example, the arm limiter assembly 560 includes an actuatable unit 562 coupled between the frame 14 and the arm member 42. The actuatable unit 562 can have a housing 564 and an elongate member 566 in the form of a rod or bar that extends out from the housing 564 and is movable with respect to the housing 564. Figure 13B shows the elongate member 566 in its retracted position. However, it should be appreciated that wheelchair 510 can include anyone of the arm limiter assemblies 60,

160, 260, and 360 as described above, or the arm limiter assemblies 660, 760, 860, or 760 described below.

[0130] Turning to Figures 14A and 14B, a wheelchair 710 is illustrated including an arm limiter assembly 760 according to yet another alternate embodiment. The powered wheelchair 710 is configured similar to the wheelchair 10 described above and illustrated in Figures 1-5. Accordingly, the description below regarding wheelchair 710 will use similar reference signs to identify elements common to wheelchair 10 and wheelchair 710, such as the frame 14, drive wheels 32 (not shown), forward arm assemblies 38, rear arm assemblies 48 (not shown), lift mechanism 18 (not shown), seat 22, and control system 90 and sensors. In accordance with the alternative embodiment, the arm limiter assembly 760 can be configured as rear-ward arm or forward arm limiter assembly as noted above.

[0131] Figures 14A and 14B schematically illustrates operation of the arm limiter assembly 760. The arm limiter assembly 760 can have a first or open configuration where the arm member 42 has a first range of rotation, and a second or locked configuration where the arm member has a second range of rotation that is smaller than the first range of rotation. The arm limiter assembly 760 can include an actuatable unit 770 and an actuator 88. The wheelchair 710 can further include one or more the arm position sensors described above to detect the position of the arm member 42 relative the frame 14. The actuatable unit 770 is coupled to the frame 14 and the arm member 42.

[0132] Continuing with Figures 14A and 14B, the actuatable unit 770 can be configured as a strut and may include a first component or housing 772 and a second component or piston 774 moveably coupled to the first component 772. The second component includes a rod or bar that extends out from the housing 772 and is movable with respect to the housing 772. The strut 770 includes proximal end (not numbered) and a distal end (not numbered) spaced from the proximal end along the axis 71. The proximal end of the strut 770 is pivotably coupled to frame 14 via connector 776. The distal end of the strut 770 is pivotably coupled to arm member 42 via connector 778. The pivotable connections between the actuatable unit 770 and the arm member 42 and frame 14 account for the pivotable connection of the arm member 42 to the frame 14 as illustrated. For translating type arm members (See Figures 15A and 15B), it should be appreciated that the actuatable unit 770 may be pivotably connected to the frame 14 only. Further, the actuatable unit 770 defines a length 780 that extends from a point defined by connector 776 to the point (not shown) defined by connector 778. As the arm member 42 pivots

upwardly away from the first position 40a (Figure 14A) into the second position 40b (Figure 14B), the length 780 decreases to a second, shorter length 780'. If the arm member 42 pivots downwardly away from the position 40a, the length 780 will increase. During normal operation when the seat is in the lowered position, the actuatable unit 770 is in the first or open configuration such that its length 780 can be adjusted to account for movement of the arm member 42 in an upward and downward direction. When the seat is moved into the raised configuration, the actuator 88 can cause the strut to lock or increase resistance to length adjustment, thereby inhibiting the ability of the actuatable unit 770 to compress or retract based on the position of the arm member 42. The actuatable unit 770 can be a hydraulic strut, magnetorheological strut, gas strut, or other device configured to allow one component to move relative to another component to selectively engage the arm member as described herein.

[0133] Turning to Figures 15A -15C, an alternative embodiments of a powered wheelchair 810. In the embodiment shown in Figures 15A-15C, powered wheelchair 810 is configured similar to the wheelchair 10 described above and illustrated in Figures 1-5. Accordingly, the description below regarding wheelchair 610 will use similar reference numerals to identify elements common to wheelchair 10 and wheelchair 810, such as the frame 14, drive wheels 32 (not shown), lift mechanism 18 (not shown), seat 22, arm assembly 38, control system 90 and sensors. In the illustrated embodiments, the powered wheelchair includes an arm limiter assembly 860 configured to progressively restrict the range of rotation which the arm member 42 and wheel axis A1. The arm limiter assembly 860 includes a rotatable member 870 rotatably mounted to the frame 14, an actuator 88, a transfer linkage 84 coupled to actuator 88, and a biasing member, such as spring 80 operably connected to the linkage 84 and the rotatable member 870. The actuator 88 is operable to cause movement of the transfer linkage 84, which in turn causes movement of the rotatable member 870 similar to the embodiment of the arm limiter assembly 60 described above.

[0134] Continuing with Figure 15A, the rotatable member 870 is configured as a cam and defines a body 874 having a proximal end 874a rotatably coupled to the frame 14 at pivot axis P2, and a distal end 874b opposed to proximal end 874a along an axis 71. The proximal end 874a is rotatably coupled to the frame 14 at pivot axis P2. The body 874 includes a forward edge 875a and a rearward edge 875b opposed to the forward edge 875a. The body 874 defines a curved distal edge 878. As illustrated, the curved distal edge 878 includes a surface that is curved with respect to the axis 71 as it extends from the forward edge 875a to the rearward edge

875b. The curved distal edge 878 is configured to selectively engage the stop member 44a depending on the rotational position of the rotatable member 870 about pivot axis P1 and the position of the arm member 42.

[0135] As illustrated, the curved distal edge 878 progressively restricts the range of rotation (or motion) which the arm member 42 can move relative to the frame 14. For instance, when the rotatable member 870 is in a first orientation 879a, the rotatable member 870 permits the arm member 42 to move through a first range of rotation that is equivalent to full range of movement of the arm member 42 and wheel axis A1 relative to the frame 14. As shown in Figure 15A, the distal contact edge 878 is disengaged from the arm member 42 when the rotatable member 870 is in the first orientation 879a.

[0136] As shown in Figure 15B, when the rotatable member 870 is in a second rotational orientation 879b that is slightly offset in a rotational direction (e.g. clockwise in Figures 3A-4D) with respect to the first rotational orientation 879a, the distal contact surface 878 is advanced forward to engage the stop member 44a when the arm member 42 is in a select positioned that may or may not be the first position 40a as described above. In the second rotational orientation 879b, the rotatable member 870 permits the arm member 42 to move through a second range of rotation that is less than the first range of rotation. As shown in Figure 15C, when the rotatable member 870 is in a third rotational orientation 879c that is further offset clockwise with respect to the second rotational orientation 879b, the rotatable member 870 permits the arm member 42 to move through a third range of rotation that is less than the second range of rotation. In the third orientation, the distal contact surface 878 is further advance so that the portion of the contact surface rearward of the axis 71 abuts the stop member 44a. As shown comparing Figures 15A and 15B, the orientation of the rotatable member can limit the ability of the arm assembly to ascend an obstacles of difference elevations. The actuator 88 and biasing member 80 can control orientation of the rotatable member 870. For instance, if the controller receives an instruction to raise the seat, a control signal is sent the actuator 88. In response the control signal, the actuator 88 urges the rotatable member 870 into a desired orientation.

[0137] Turning to Figures 16A and 16B, an alternative embodiments of a powered wheelchair 610, the arm assembly 638 can be configured such that the arm member 42 and wheel axis A1 is translatable from the first position 40a to the second position 40b. In the embodiment shown in Figures 16A and 16B, powered wheelchair 610 is configured similar to the wheelchair 10 described above and illustrated in Figures 1-5. Accordingly, the description

below regarding wheelchair 610 will use similar reference numerals to identify elements common to wheelchair 10 and wheelchair 610, such as the frame 14, drive wheels 32 (not shown), lift mechanism 18 (not shown), seat 22, arm limiter assembly 60, control system 90 and sensors. In the alternate embodiment, the powered wheelchair 610 includes a pair of forward arm assemblies 638 moveably coupled to a track 650 that extends forwardly from the frame 14. The track 650 receives the proximal end 43p (shown in dashed lines in Figures 16A and 16B) of the arm member 42. As illustrated, the proximal end 43p is slidable within the track 650 via a bearing or roller mechanism (not shown) so that arm member 42 and wheel 46 are translatable along the track 650 upwardly or downwardly relative to the frame 14 in a linear direction C. The linear direction C can extend along the vertical direction V or may be angularly offset (as illustrated) with respect to the vertical direction V. Accordingly, the arm assemblies 638 are coupled to the frame 14 such that the wheel 46 is translatable from between the first position 40a and the second position 40b depending on the obstacle the wheel 46 is traversing. As noted above, operation of the arm assembly 638 is similar to operation of the arm assembly as the 008 patent noted above.

[0138] Continuing with Figures 16A and 16B, in alternative embodiments when the arm limiter assembly 60 is in the disengaged or open configuration the arm member 42 is translatable from the first position 40a through a first range of motion. When the arm limiter assembly 60 is in the engaged or locked configuration, the arm member 42 is translatable through a second range of motion that is less than the first range of motion. While arm member 42 is translatable along the linear direction C, the positional difference of the wheel 46 in the first and second positions 40a and 40b can have an angular component. The first position 40a in Figure 16A can be defined by first reference and second lines (not shown) that intersect the front wheel axis A1 and a forward-most point (651) located on the bottom 14b of the frame 14. When the arm assembly 638 translates the wheel 46 from the first position 40a to the second position 40b, the second reference line defines an angle $\alpha 1$ (not shown) with the first reference line (not shown). Accordingly, the range of motion as described with respect to wheelchair 16 can correspond to range of rotation described with respect to the wheelchair 10.

[0139] The safety features described in present disclosure are not limited to the powered wheelchair configurations specifically disclosed and illustrated in the accompanying drawings. The wheelchair as described herein can include any one of the arm limiter assemblies 60, 160,

260, 360, 460, 560, and 610 described herein, a forward arm assembly moveably, i.e. rotatably and/or translatably, coupled to the frame 14, and a rearward arm assembly moveable coupled to the frame 14. More specifically, such a wheelchair includes a forward arm member 42 and a rearward arm member 49 (see Figure 2A) that are both moveable relative to the frame such that the front wheel 46 and rear wheel 49, respectively, are moveable relative to the frame 14 away (upwardly or downwardly) from their respective first or rest positions. Movement of the wheels 46 and 49 away from the first positions are dependent on the features on the ground G that wheelchair is traversing. In certain embodiments, the forward arm member 42 and the rearward arm members 49 can be linked, directly or indirectly, such that movement of one arm member causes movement of the other arm member. In such an embodiment, arm limiter assemblies 60, 160, 260, 360, 560, and 610 as described herein selectively permit or prevent movement of 1) the forward arm member 42, 2) the rearward arm member 49, or 3) both the forward and rearward arm member 49 upwardly or downwardly with respect to the first position of each respective wheel 46 and 47. More specifically, any one of arm limiter assemblies 60, 160, 260, 360, 560, and 610 can be positioned toward the front 14f of the frame 14 to selectively inhibit movement of the front arm assembly 38. And because the forward arm member 42 is linked to the rear arm member 49, when the front arm member 42 has a limited range of motion due to engagement with the arm limiter assembly, the rear arm member 49 has a limited range of motion as well. The reverse is contemplated—that the arm limiter assembly engaged with rear arm member 47 and limiting its range of motion also limits the range of motion of the forward arm member 42. In addition, if one of the front arm member 42 or the rear arm member 49 is moved out of its first or rest position prior to the arm limiter assembly transitioning into the locking configuration, stop members along each arm member 42 or 49 inhibits the arm limiter assembly from transitioning into the locked configuration. When the wheelchair returns to flat, level ground, the front and rear arm members 42 and 49 return to the first position and the arm limiter assembly transitions into the locking configuration.

[0140] Various embodiments of wheelchairs have been described. It should be appreciated that the features and elements from one wheelchair can be combined with features and elements of another wheelchair. For instance, any wheelchair 10, 110, 210, 310, 410, 510, 610, 710, 810 may include any one of the arm limiter assemblies 60, 160, 260, 360, 460, 560, 660, 760, or 860. Further, any components for each arm limiter assemblies 60, 160, 260, 360, 460, 560, 660, 760, or 860 may be combined with other components from each arm limiter assembly 60, 160, 260, 360, 460, 560, 660, 760, or 860, as needed.

[0141] While the foregoing description and drawings represent the various exemplary embodiments of the present disclosure, it will be understood that various additions, modifications, combinations and/or substitutions may be made therein without departing from the spirit and scope of the invention as defined in the accompanying claims. In particular, it will be clear to those skilled in the art that the invention may be embodied in other specific forms, structures, arrangements, proportions, and with other elements, materials, and components, without departing from the spirit or essential characteristics thereof. One skilled in the art will appreciate that the invention may be used with many modifications of structure, arrangement, proportions, materials, and components, which are adapted to specific environments and operative requirements without departing from the principles of the invention. In addition, features described herein may be used singularly or in combination with other features. For example, features described in connection with one component or embodiment may be used and/or interchanged with features described in another component or embodiment. The presently disclosed embodiments are therefore to be considered in all respects as illustrative and not restrictive, the scope of the invention being indicated by the appended claims, and not limited to the foregoing description.

CLAIMS:

1. A powered wheelchair comprising:
5 a frame;
a drive wheel coupled to the frame and rotatable about a drive wheel axis;
a drive configured to apply a torque to the drive wheel;
a front wheel coupled to the frame at a pivot axis, the front wheel being rotatable about a
front wheel axis positioned forward of the drive wheel and moveable relative to the drive wheel
10 axis, wherein, when the powered wheelchair is operating on level ground, the pivot axis is below
a line that intersects the front wheel axis and the drive wheel axis;
a rear wheel coupled to the frame, the rear wheel being rotatable about a rear wheel axis
positioned rearward of the drive wheel and moveable relative to the drive wheel axis; and
a limiter configured to restrict movement of the front wheel relative to the drive wheel
15 axis in an engaged configuration and not restrict movement of the front wheel relative to the
drive wheel axis in a disengaged configuration, the limiter transitionable from the disengaged
configuration to the engaged configuration when the front wheel is in a first position relative to
the drive wheel axis and prevented from transitioning from the disengaged configuration to the
engaged configuration when the front wheel is in a second position relative to the drive wheel
20 axis.
2. The powered wheelchair of claim 1, further comprising:
a lift coupled to the frame and having a raised position and a lowered position, the lift
extending further from the frame in the raised position than in the lowered position, wherein
having the lift in the raised position causes the limiter to transition from the disengaged
25 configuration to the engaged configuration when the front wheel is in the first position.
3. The powered wheelchair of claim 2, further comprising at least one sensor
configured to detect whether the limiter is in the engaged configuration.
4. The powered wheelchair of claim 3, wherein the limiter includes the at least one
sensor.

5. The powered wheelchair of claim 3, further comprising at least one controller in communication with the at least one sensor.

6. The powered wheelchair of claim 5, wherein the controller is configured to receive input from an input device and the at least one sensor, and based on the input from the input device and from the at least one sensor, to selectively operate the powered wheelchair in (i) a standard mode when a seat coupled to the lift is in the lowered position such that the wheelchair is moveable in accordance with standard drive parameters, and (ii) one or more elevated motion modes whereby the seat is in the raised position and the wheelchair is moveable in accordance with limited drive parameters, which are limited relative to the standard drive parameters.

7. The powered wheelchair of claim 5, further comprising a seat coupled to the lift, and a seat lift sensor in communication with the controller, the seat lift sensor configured to detect whether the seat is elevated from the lowest position.

8. The powered wheelchair of claim 1, further comprising a front arm assembly, the front arm assembly having a front arm member to which the front wheel is coupled, and the limiter is an elongate structure that is coupled to the frame at a pivot, such that (i) in the disengaged configuration the limiter is not engaged with the front arm assembly and the limiter provides no limitation of the motion of the front arm member, and (ii) in the engaged configuration the limiter is pivoted relative to the disengaged configuration to a position that limits movement of the front arm assembly.

9. The powered wheelchair of claim 8, wherein the front arm assembly includes a caster assembly and the front wheel is in contact with the ground during steady speed operation on flat and level ground.

10. The powered wheelchair of claim 8, wherein when the limiter is in the disengaged configuration, a wheelchair speed of the powered wheelchair is unrestricted by a controller while a seat coupled to the lift is in a lowermost position.

11. The powered wheelchair of claim 10, wherein when the limiter is in the engaged configuration and the seat is not in the lowermost position, the wheelchair speed is limited to a maximum raised-seat drive speed.

12. The powered wheelchair of claim 11, wherein the maximum raised-seat drive speed is no more than 5.0 mph.

13. The powered wheelchair of claim 11, wherein the maximum raised-seat drive speed is no more than 3.75 mph.

14. The powered wheelchair of claim 11, wherein when the limiter is not in the engaged configuration and the seat is not in the lowermost position, the wheelchair speed is limited to a reduced raised-seat drive speed that is less than the maximum raised-seat drive speed.

15. The powered wheelchair of claim 14, wherein the reduced raised-seat drive speed is no more than 3.0 mph.

16. The powered wheelchair of claim 14, wherein the reduced raised-seat drive speed is no more than 1.5 mph.

17. The powered wheelchair of claim 8, wherein the arm member is elongate along an axis, and the arm member is curved as the arm member extends along the axis.

18. The powered wheelchair of claim 6, wherein the controller is configured to receive the input from the input device and the at least one sensor, and based on the input from the input device and from the at least one sensor, to selectively operate the powered wheelchair in at least one of (i) a maximum raised-seat drive speed range, and (ii) a maximum raised-inhibited drive speed range that is less than the maximum raised-seat drive speed range.

19. The powered wheelchair of claim 18, wherein the maximum raised-seat drive speed range is 0 miles per hour to 5.0 miles per hour.

20. The powered wheelchair of claim 18, wherein the maximum raised-seat drive speed range is 0 miles per hour to 3.75 miles per hour.

21. The powered wheelchair of claim 6, wherein the controller is configured to receive input from the at least one sensor to permit operation of the powered wheelchair only up to a maximum raised-inhibited drive speed range that is less than the maximum drive speed of the wheelchair.

5 22. The powered wheelchair of claim 1, wherein the limiter is transitionable between the engaged configuration and the disengaged configuration when the front wheel is in the first position.

10 23. The powered wheelchair of claim 1, further comprising a biasing member coupled to the frame and coupled to the limiter, the biasing member configured to urge the limiter toward the engaged position when the limiter is prevented from transitioning from the disengaged configuration to the engaged configuration.

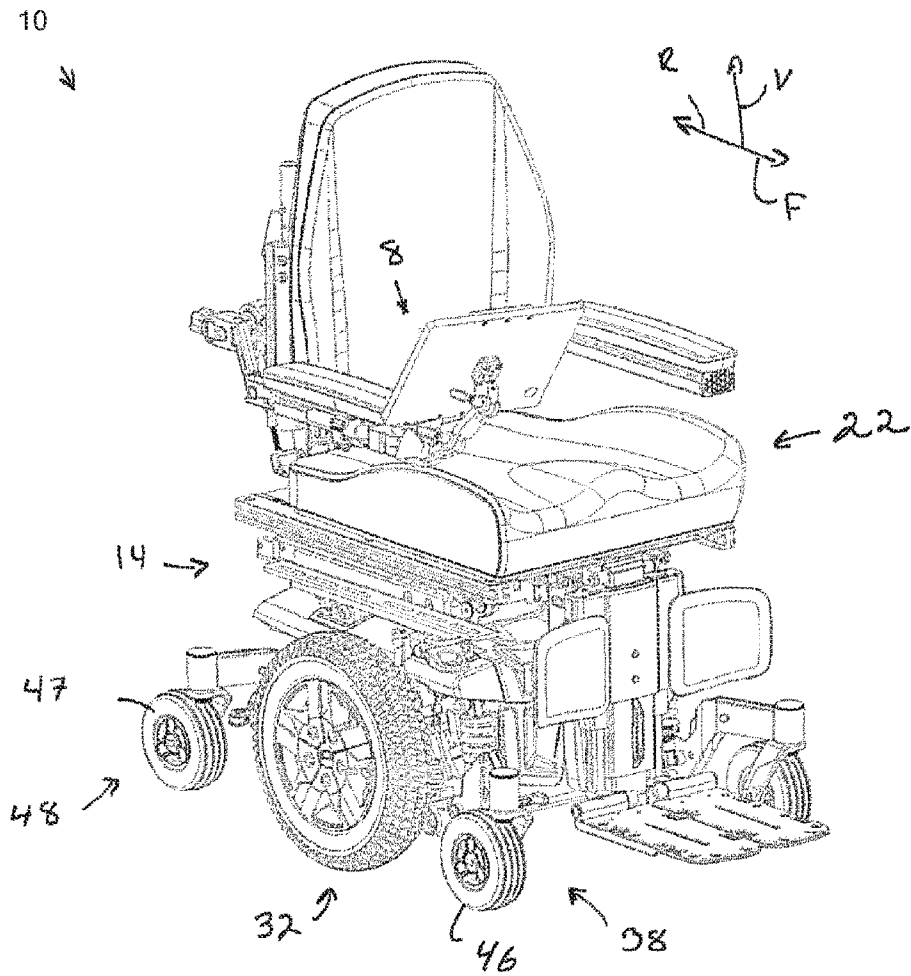

FIG. 1

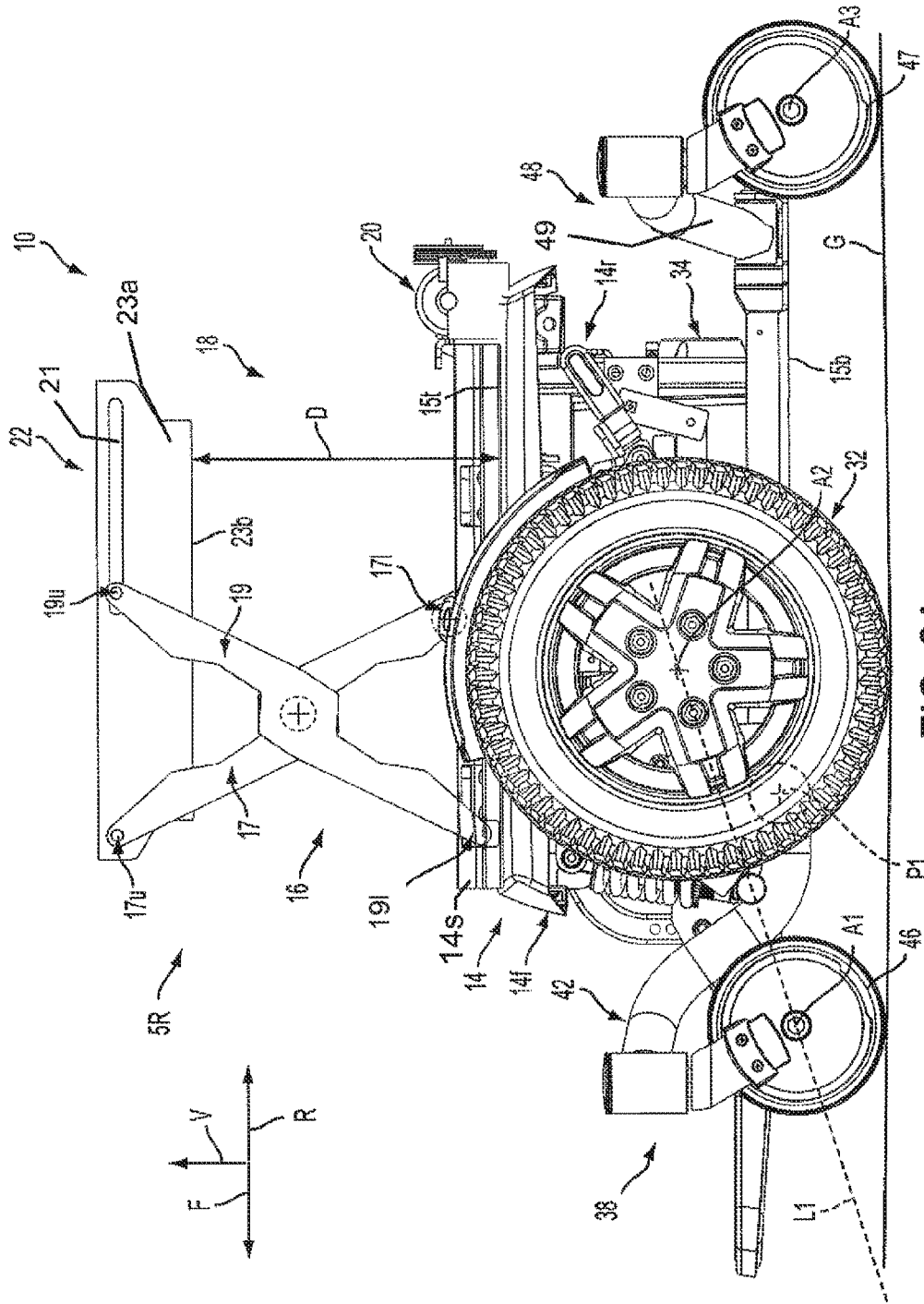

FIG. 2A

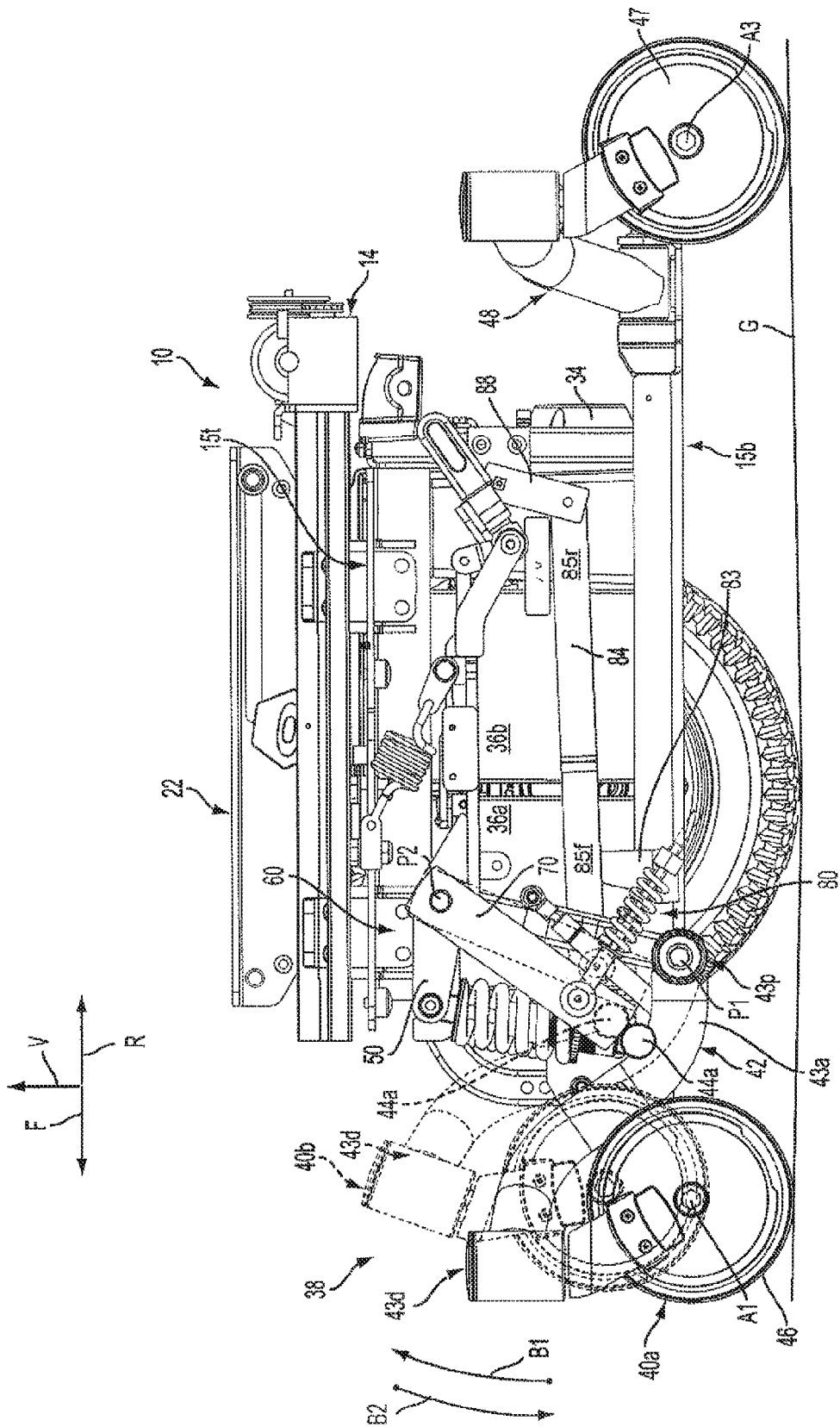

FIG. 3A

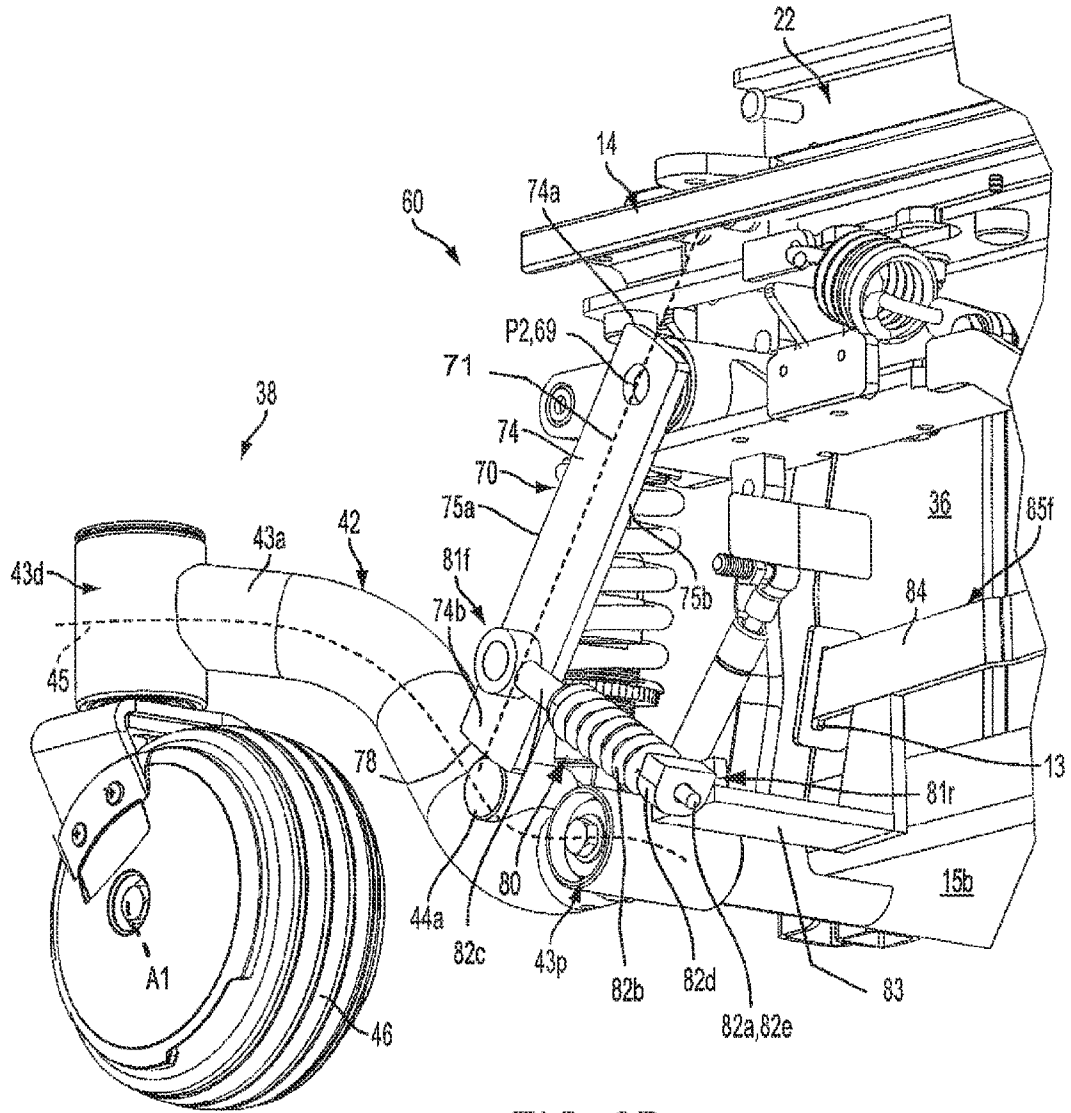

FIG. 3B

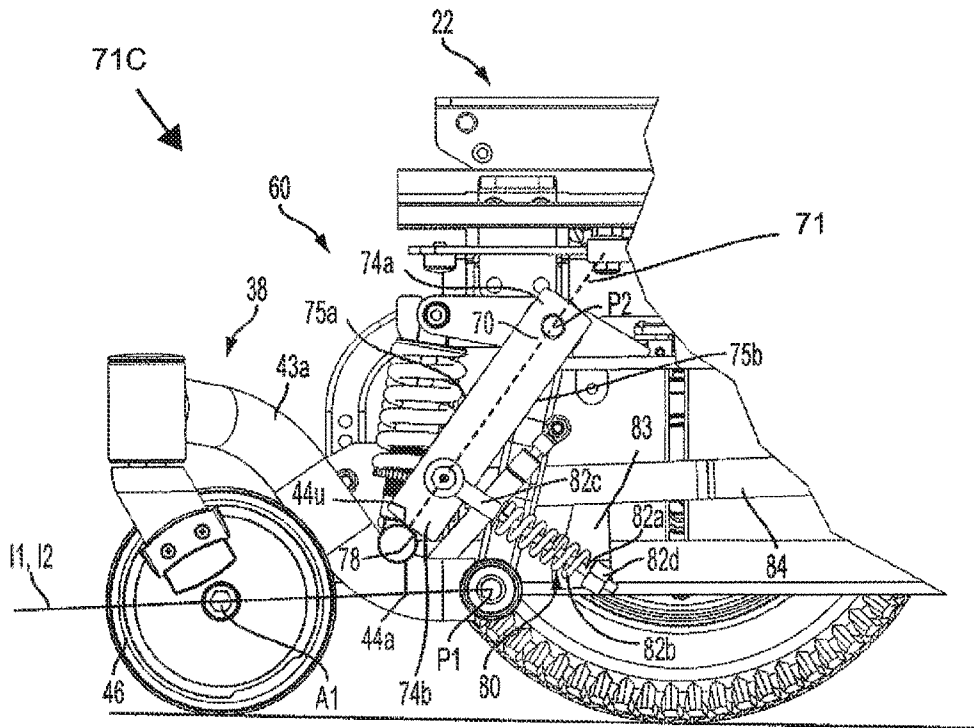

FIG. 4A

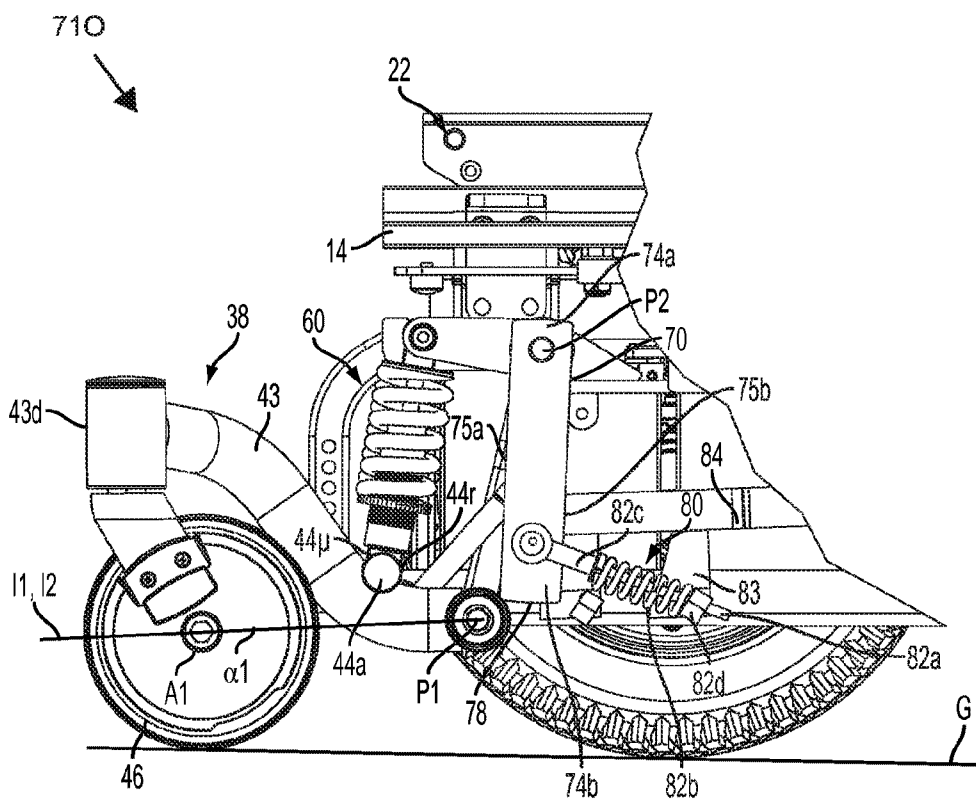

FIG. 4B

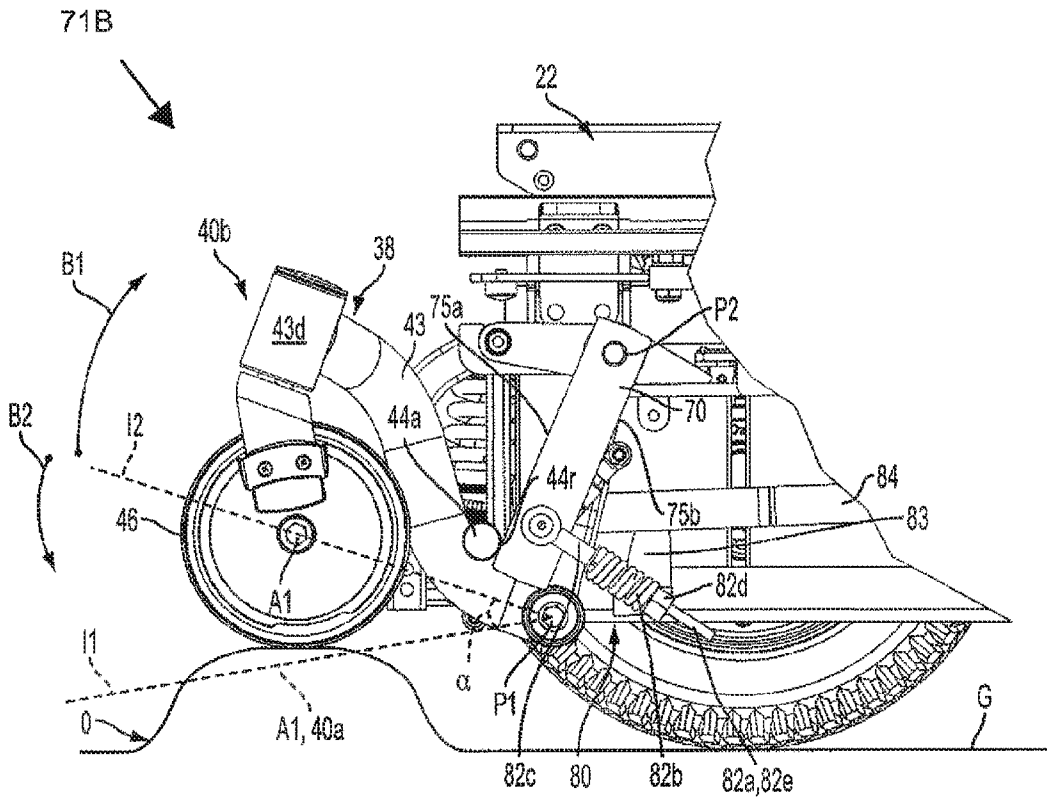

FIG. 4C

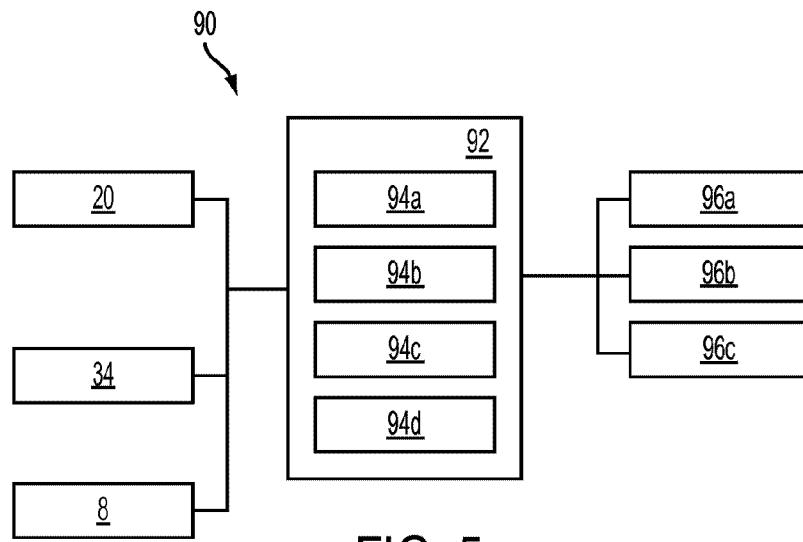

FIG. 5

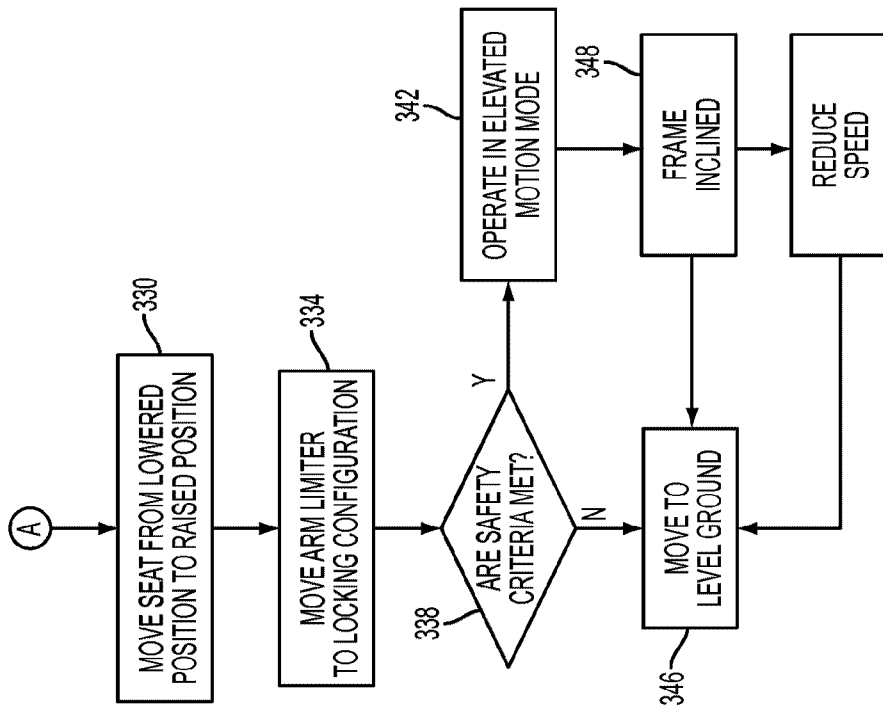

FIG. 6B

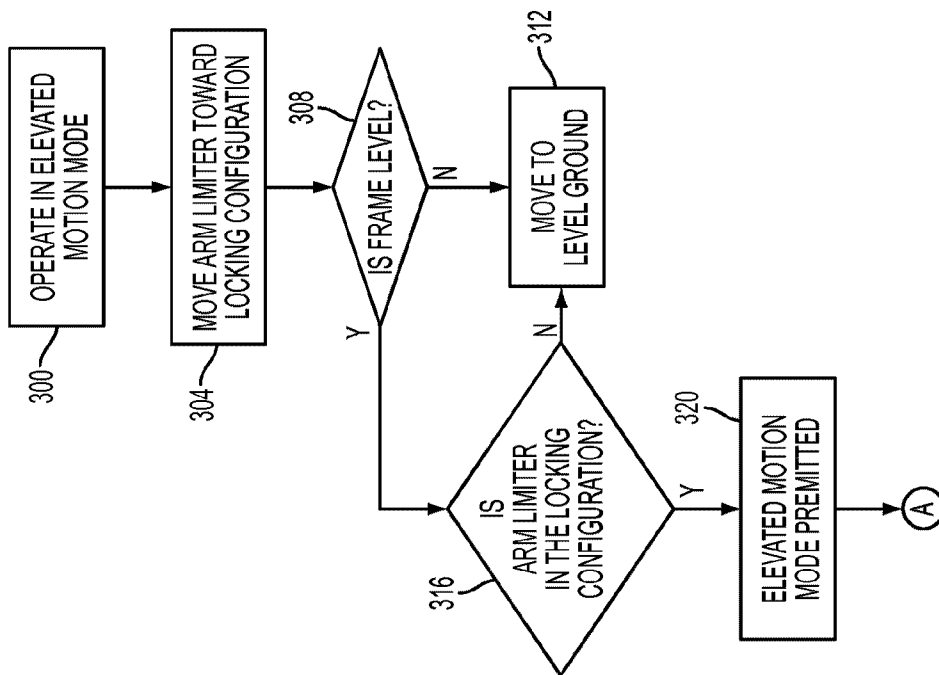

FIG. 6A

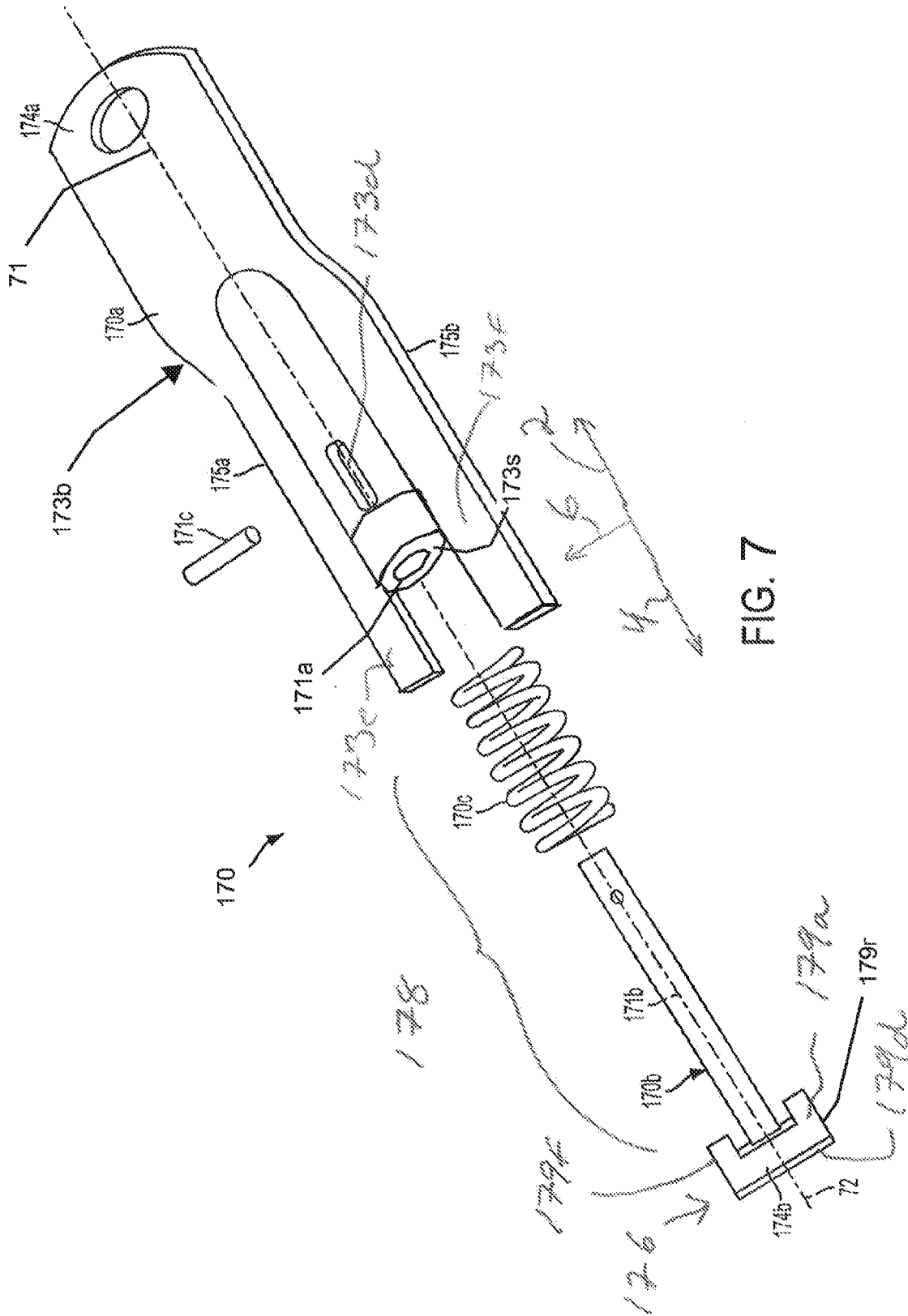

FIG. 7

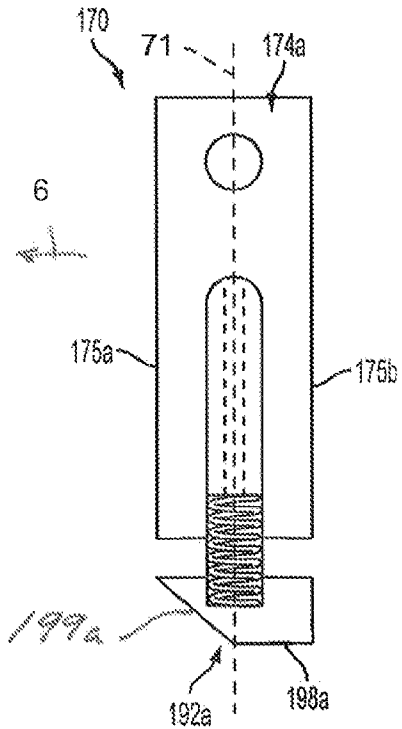

FIG. 8A

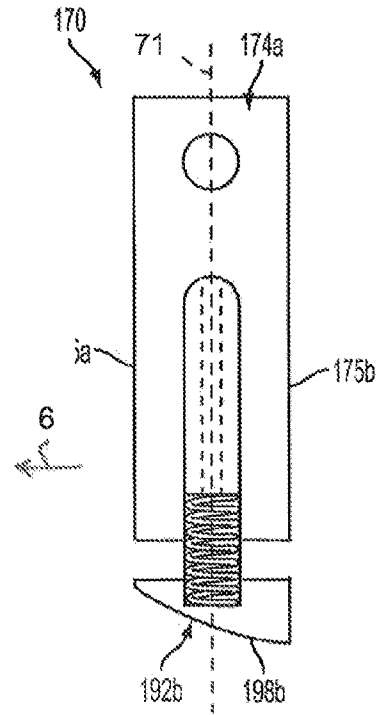

FIG. 8B

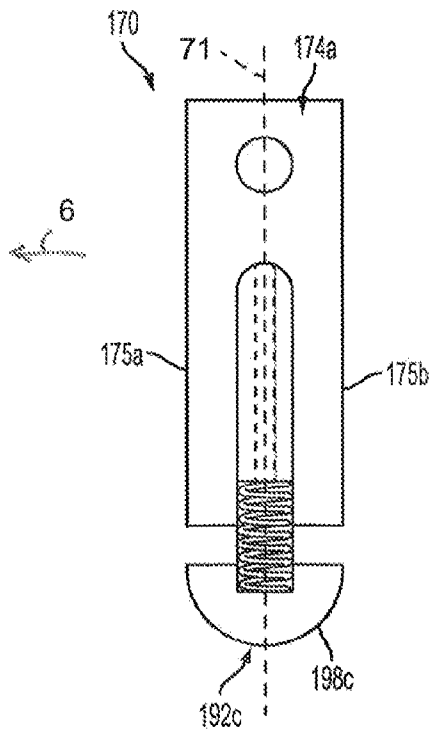

FIG. 8C

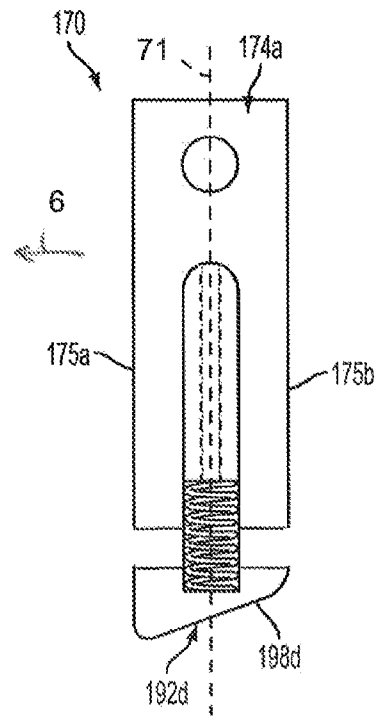

FIG. 8D

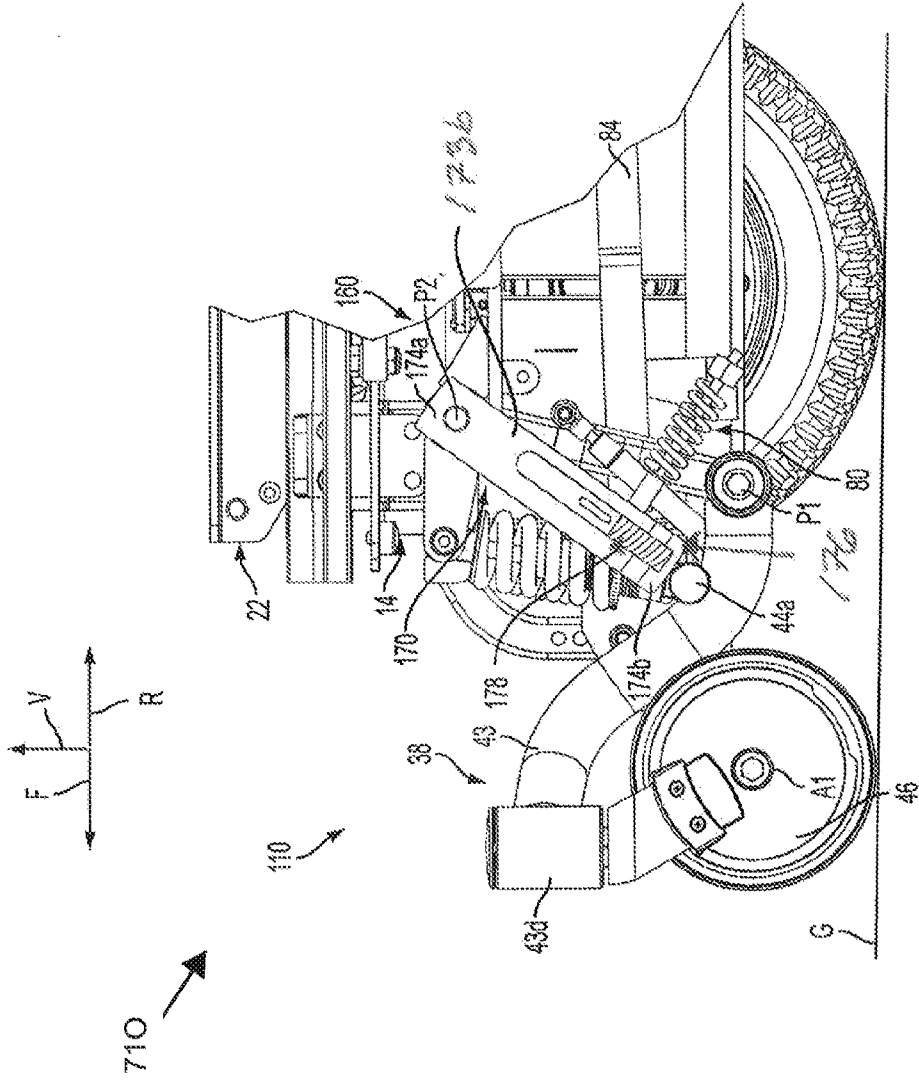

FIG. 9A

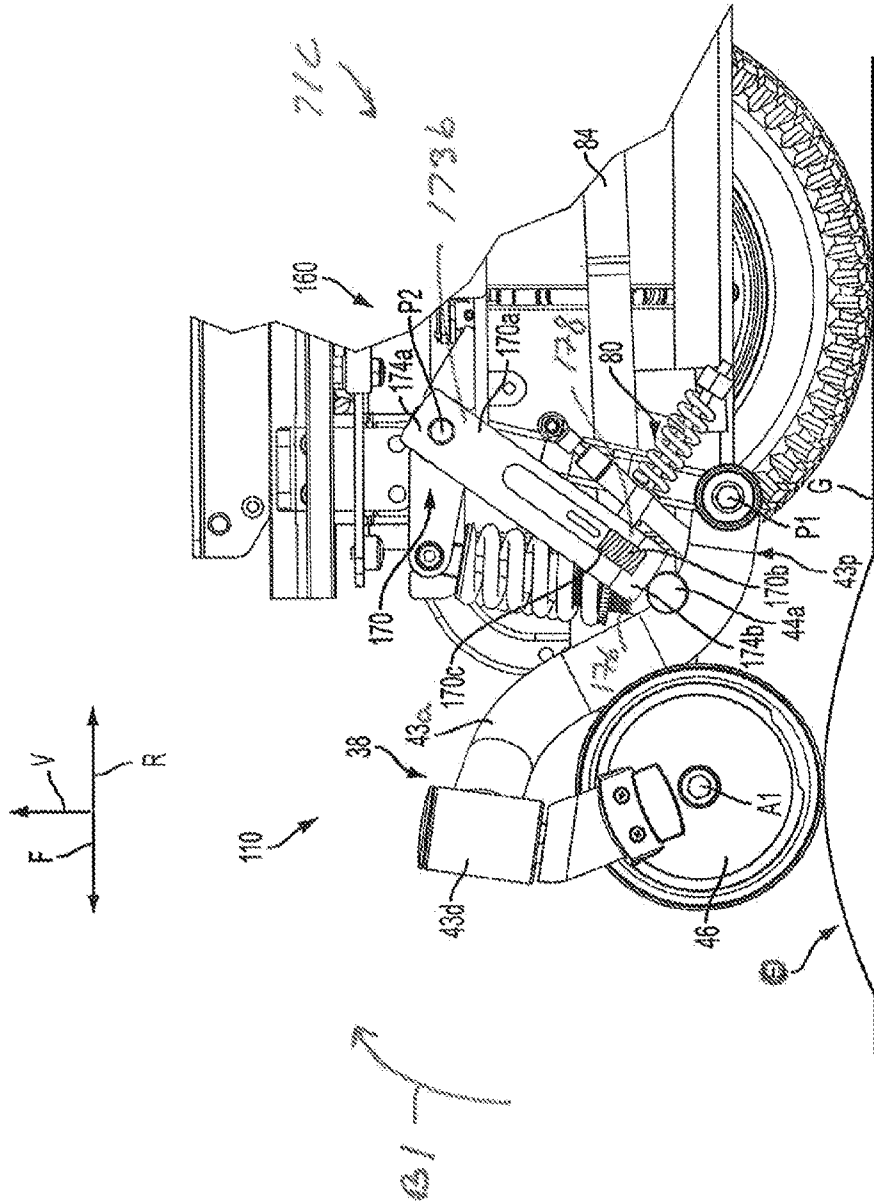

FIG. 9B

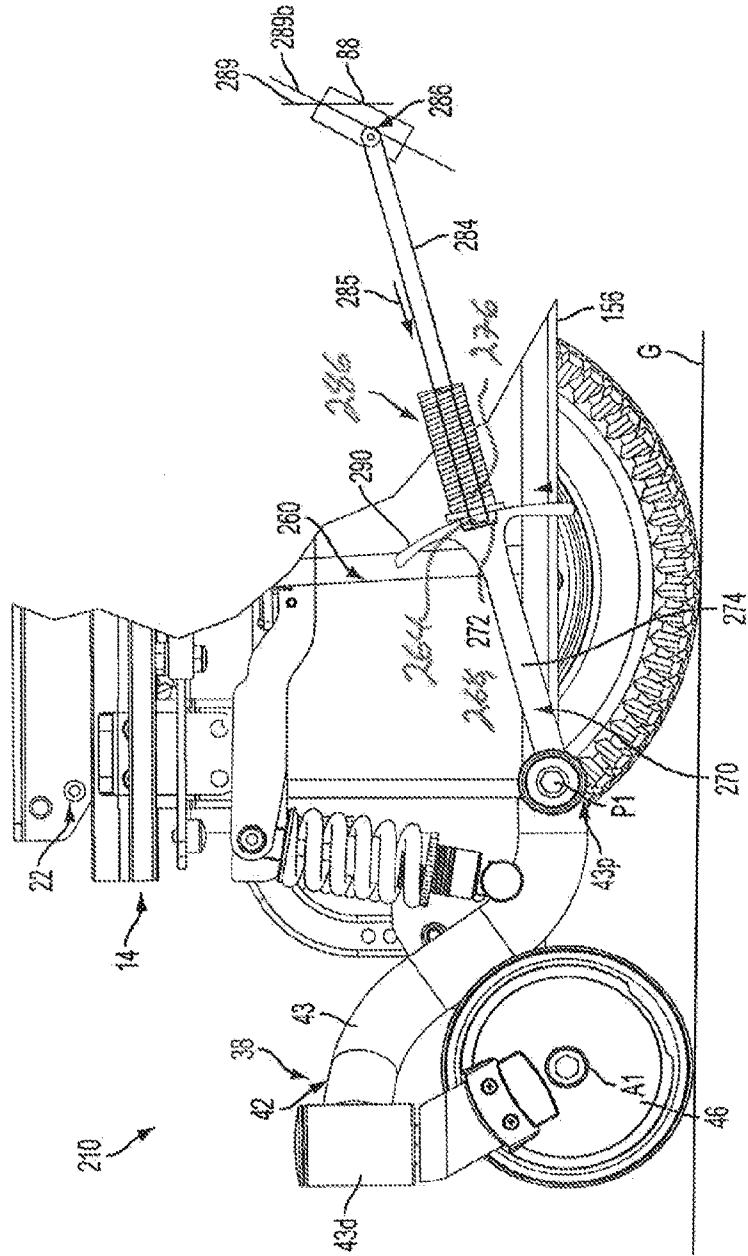

FIG. 10A

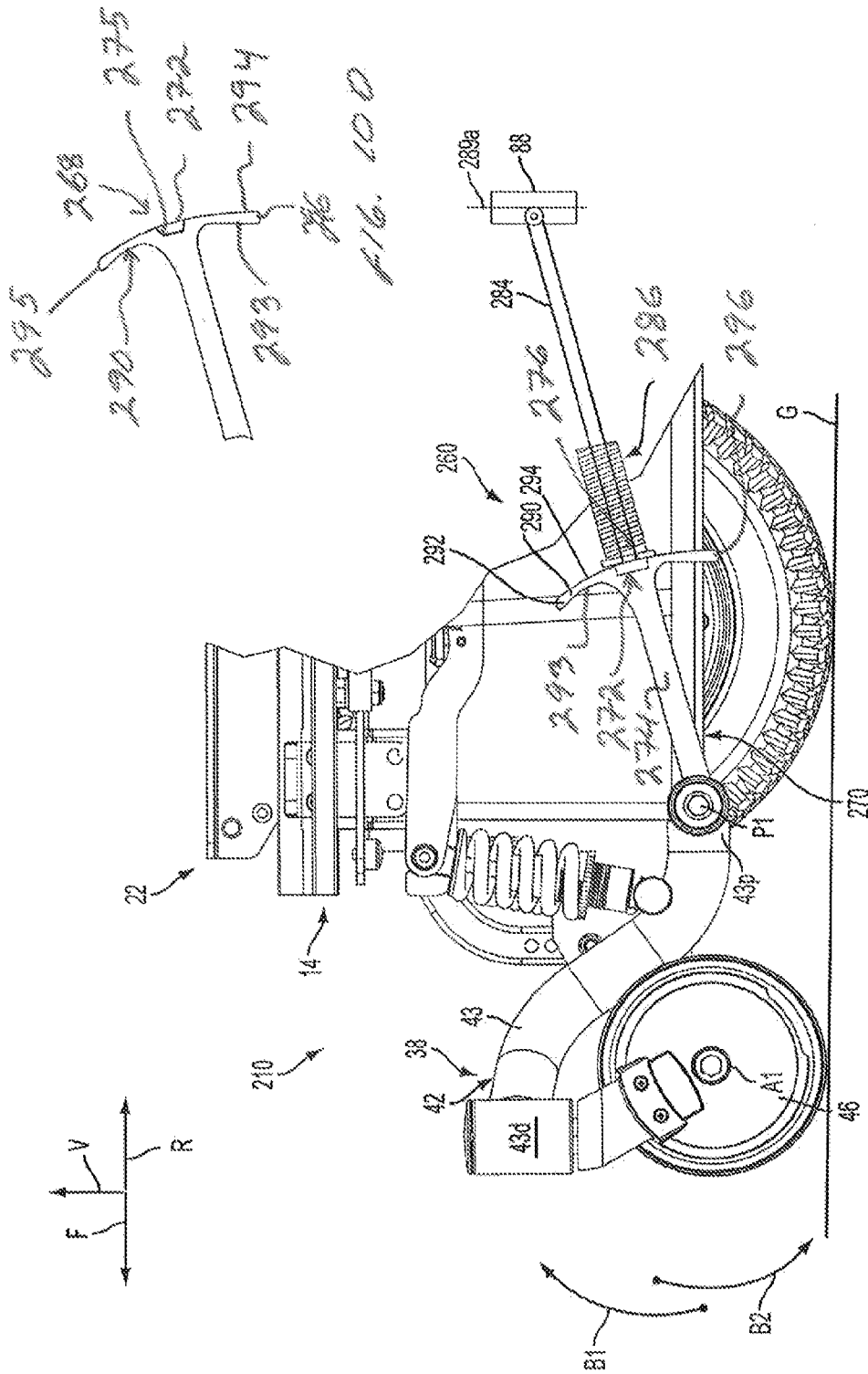

FIG. 10B

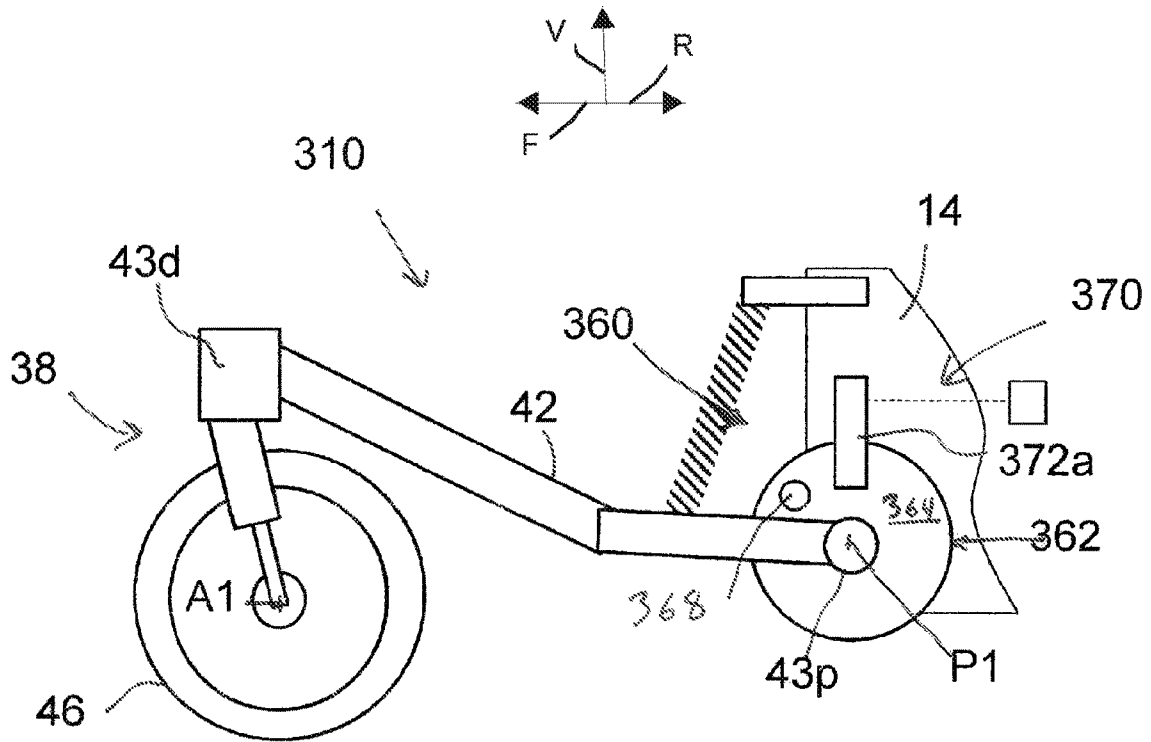

FIG. 11A

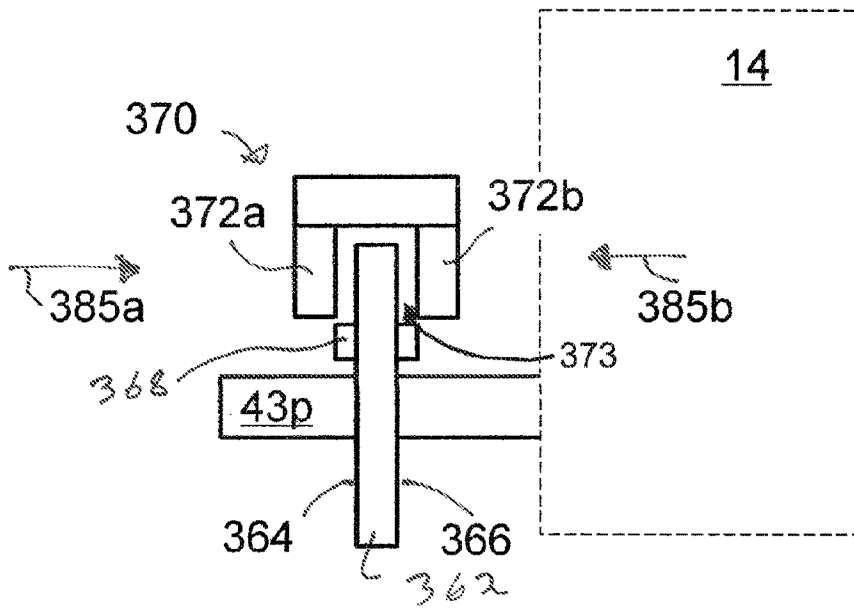

FIG. 11B

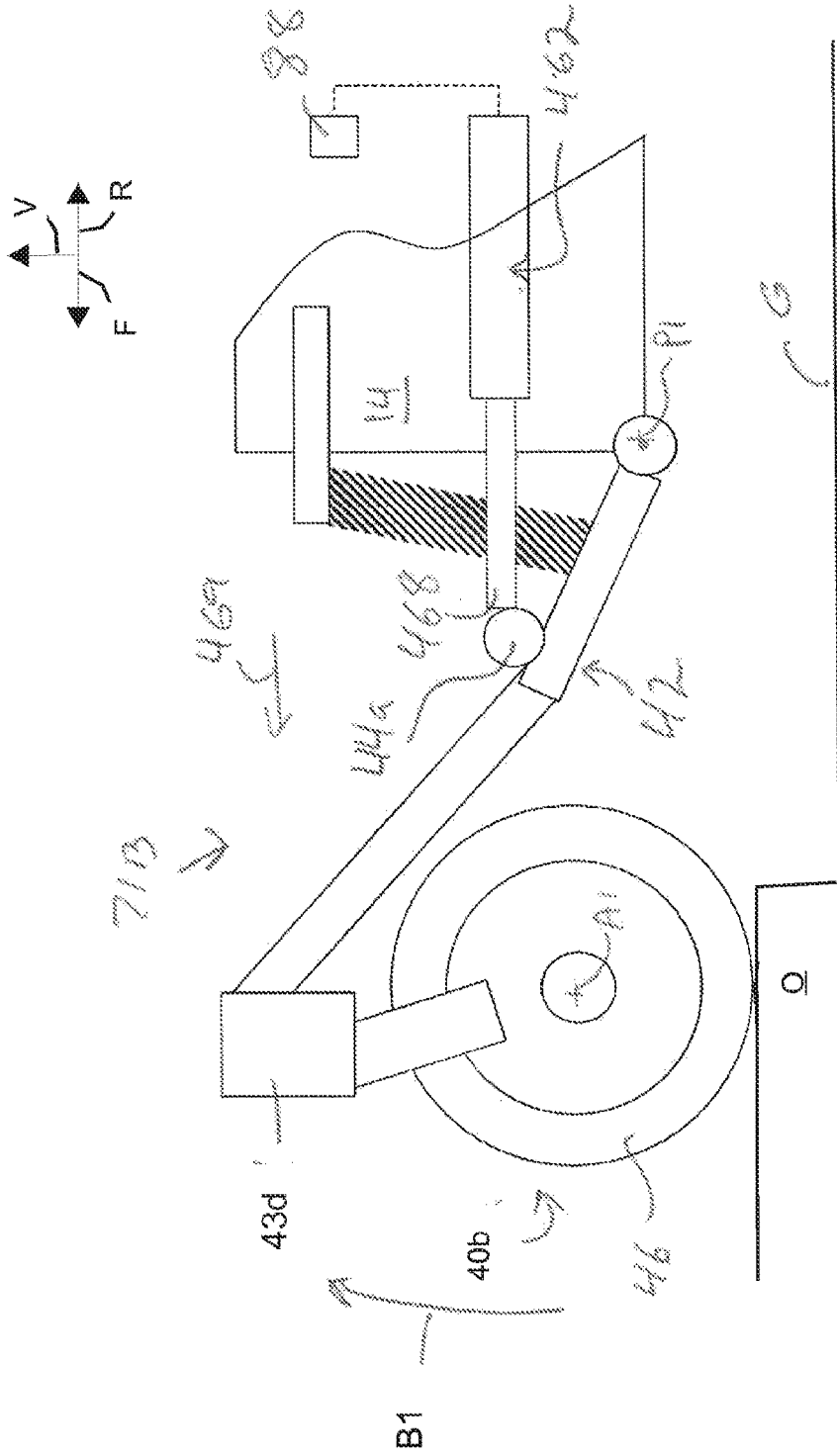

FIG. 12C

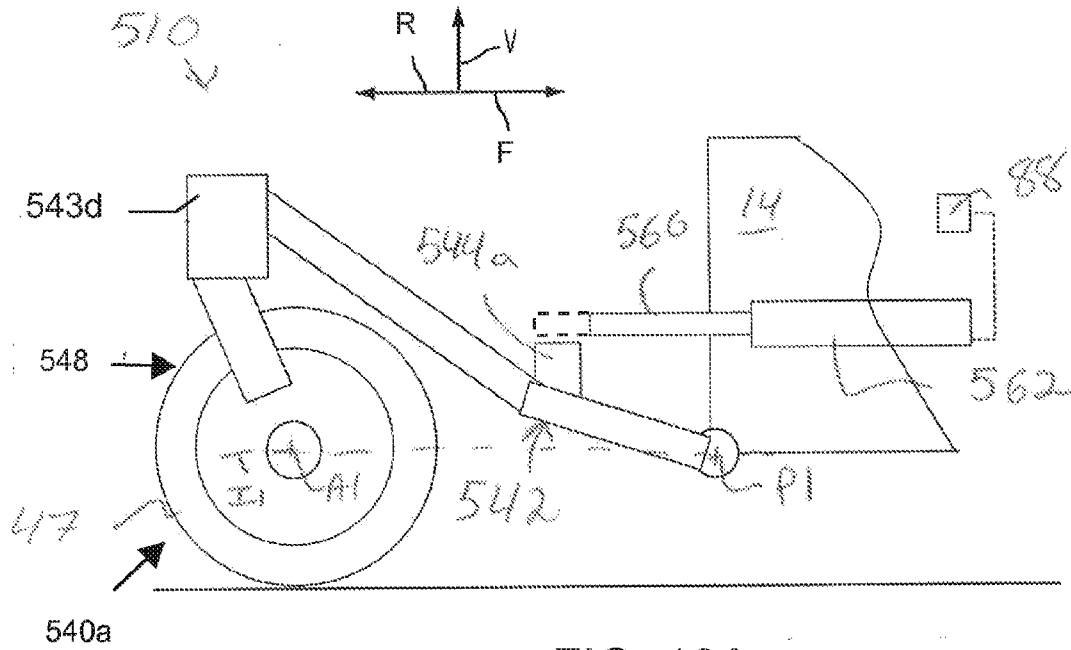

FIG. 13A

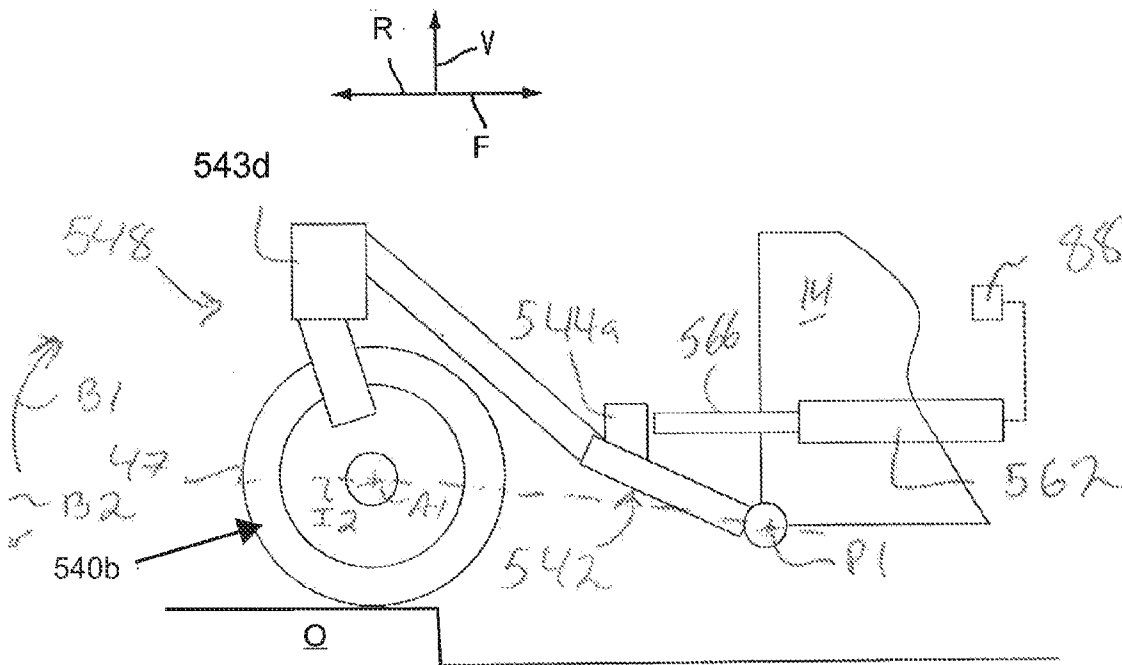

FIG. 13B

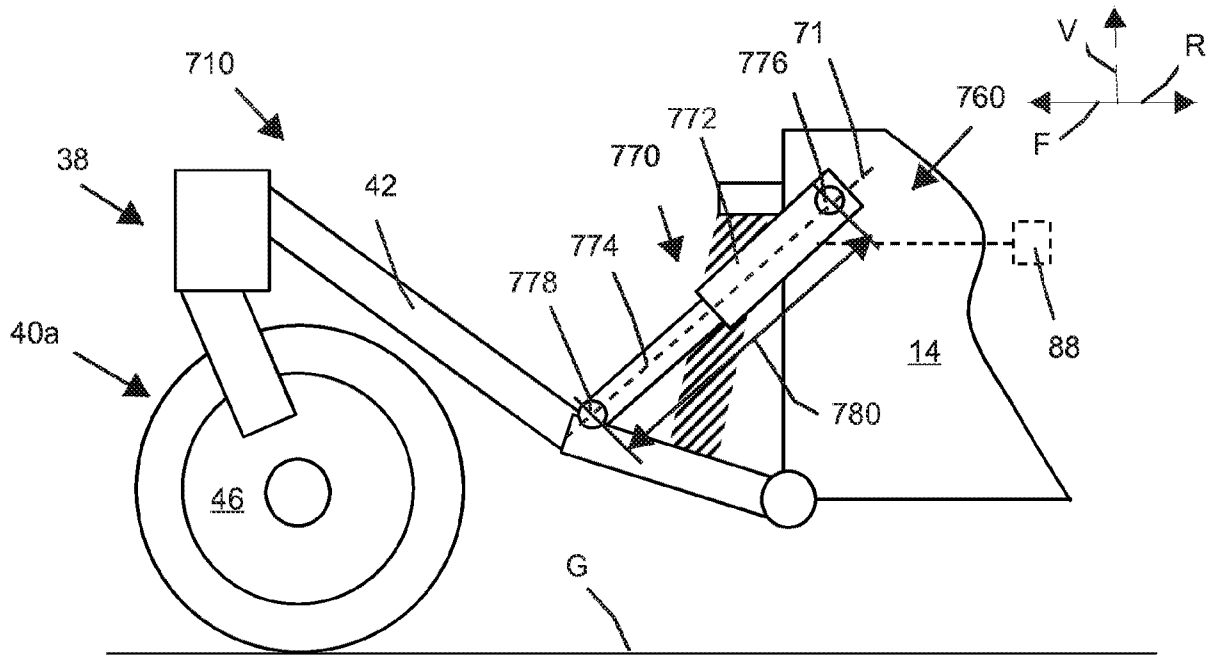

FIG. 14A

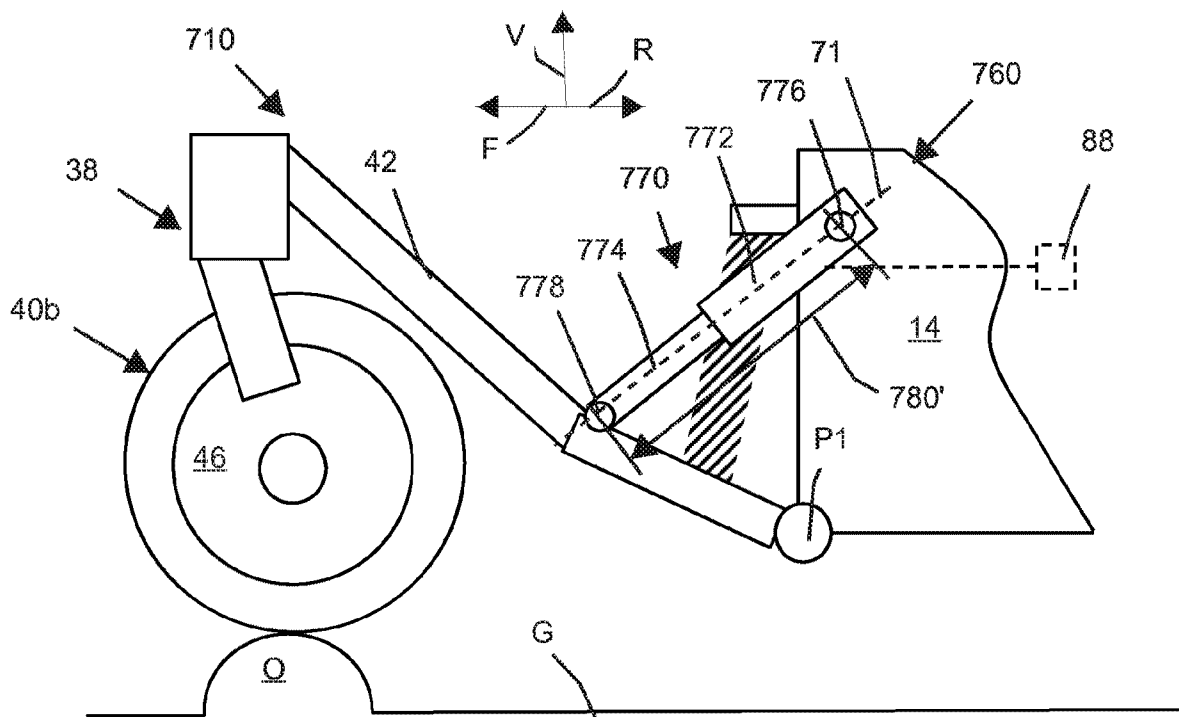

FIG. 14B

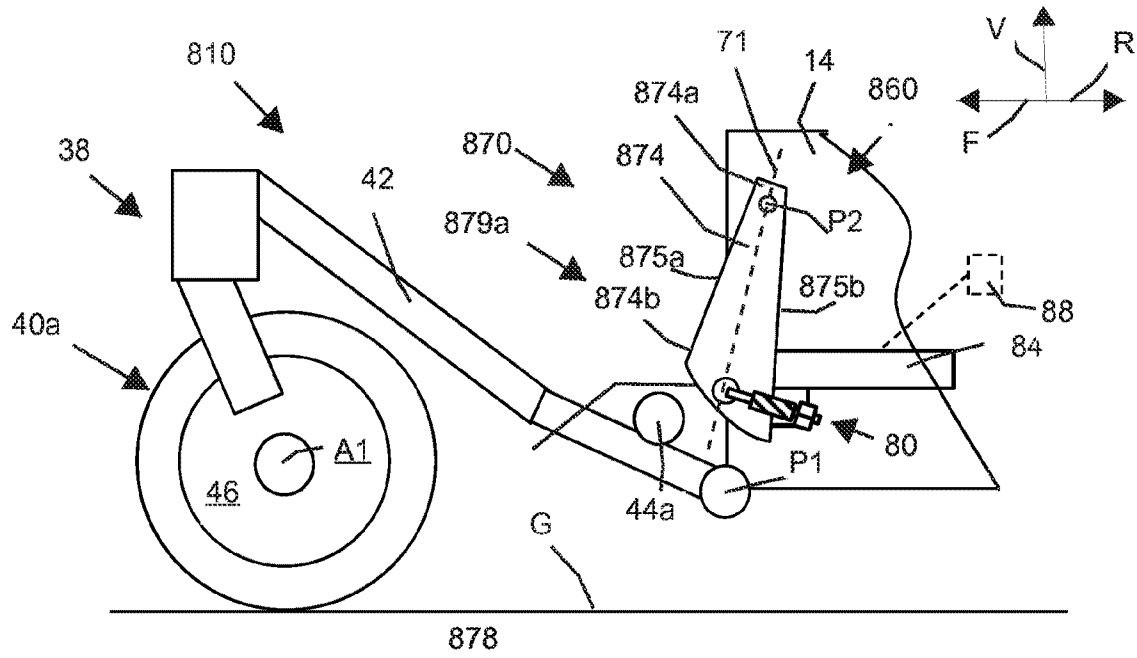

FIG. 15A

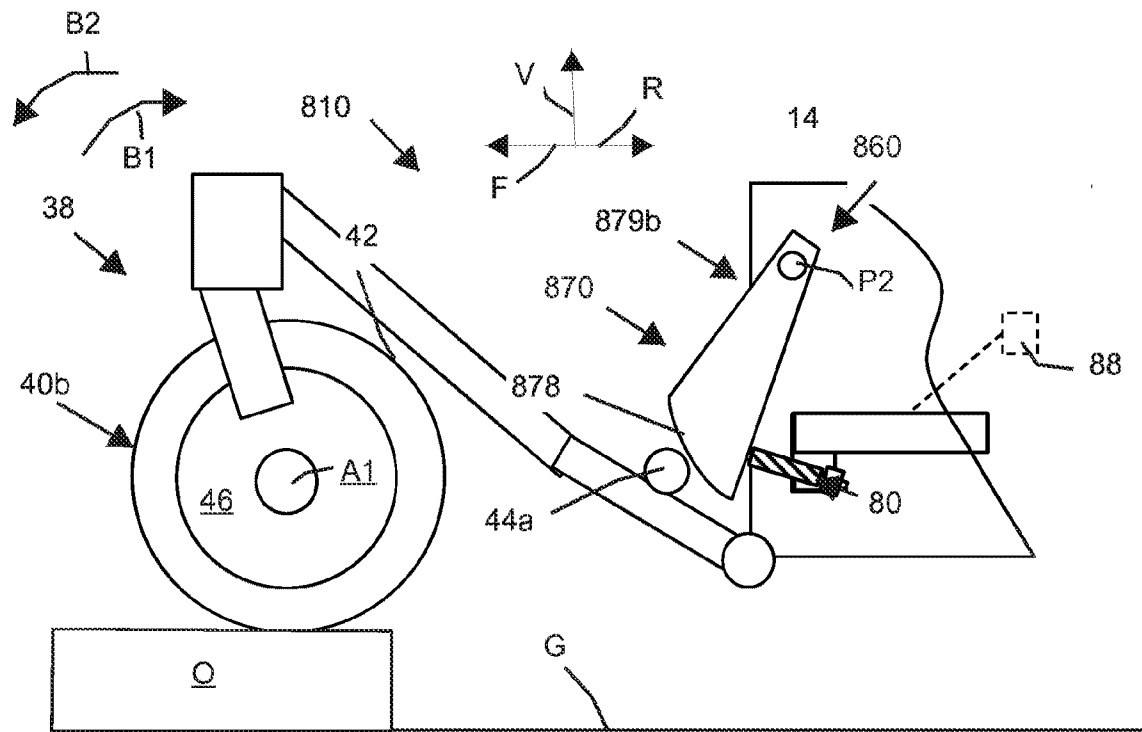

FIG. 15B

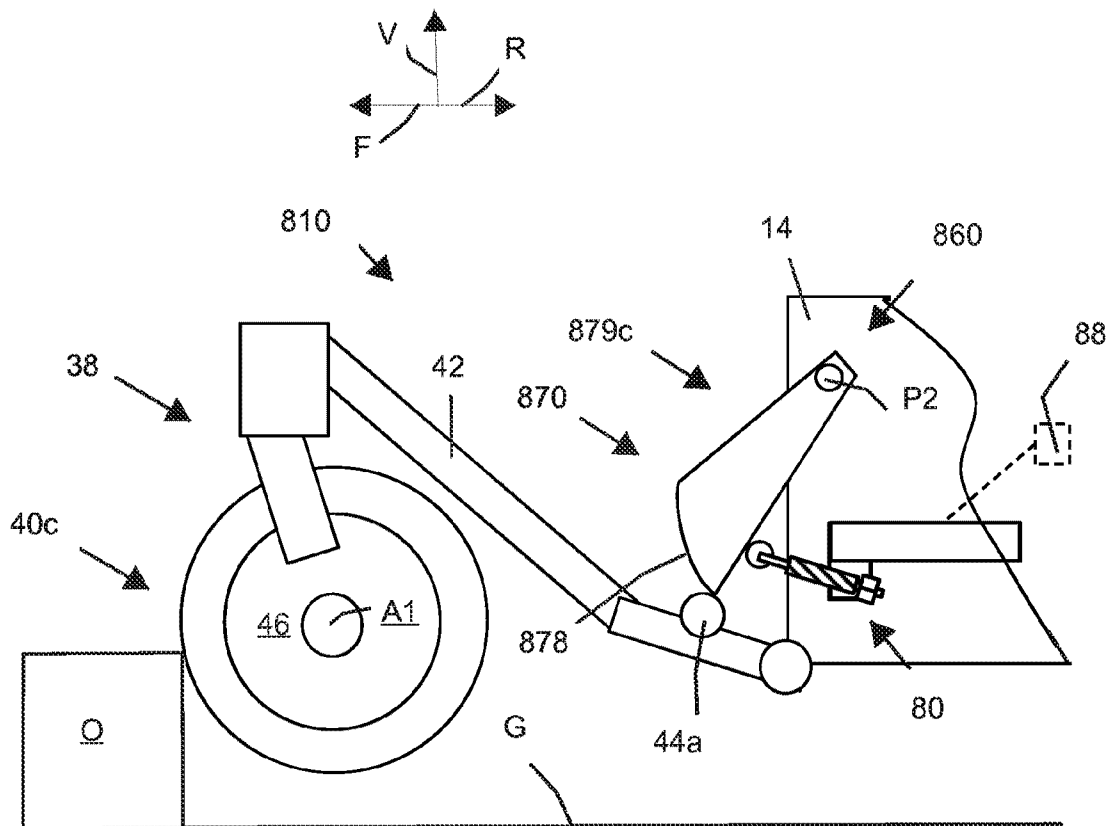

FIG. 15C

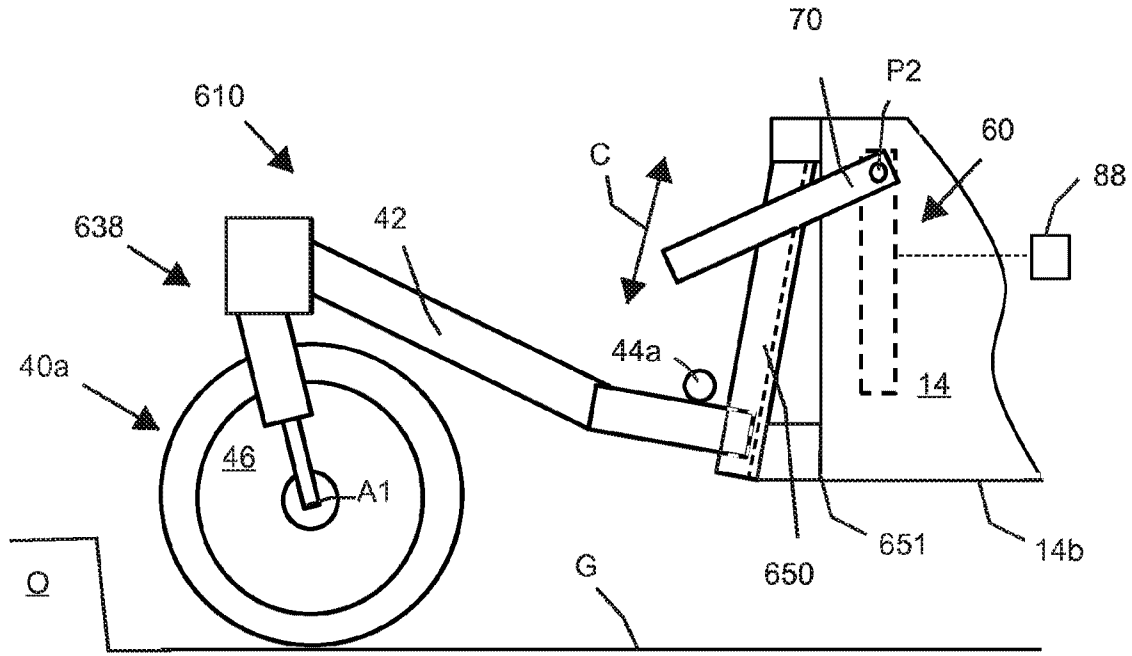

FIG. 16A

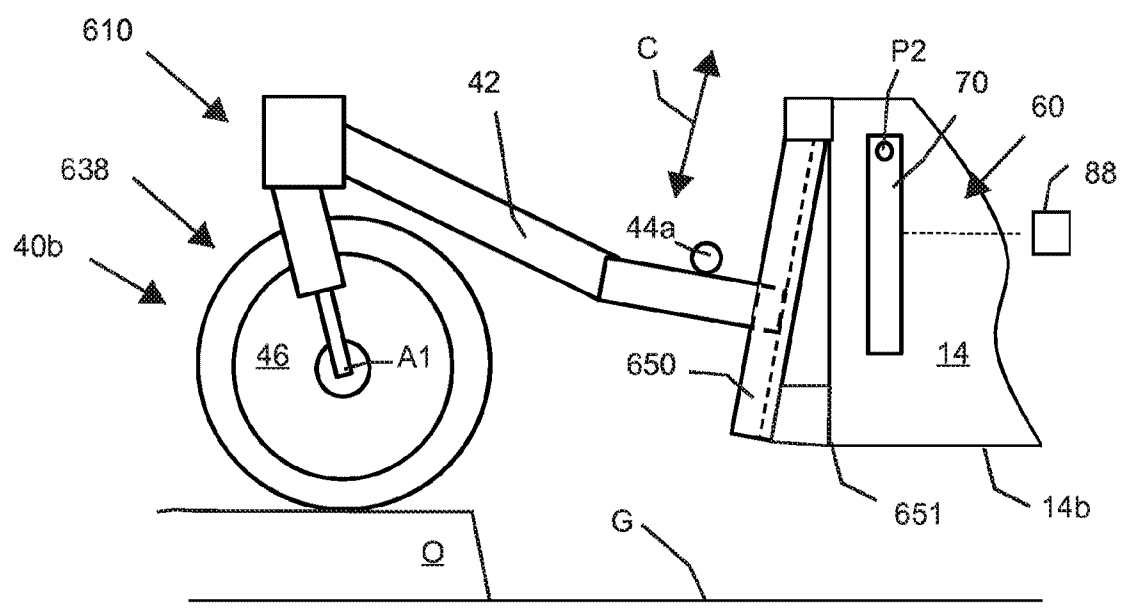

FIG. 16B

