

Sept. 9, 1952

M. N. WELLS

2,609,938

BEDSIDE STAND AND TRAY

Filed April 6, 1951

3 Sheets-Sheet 1

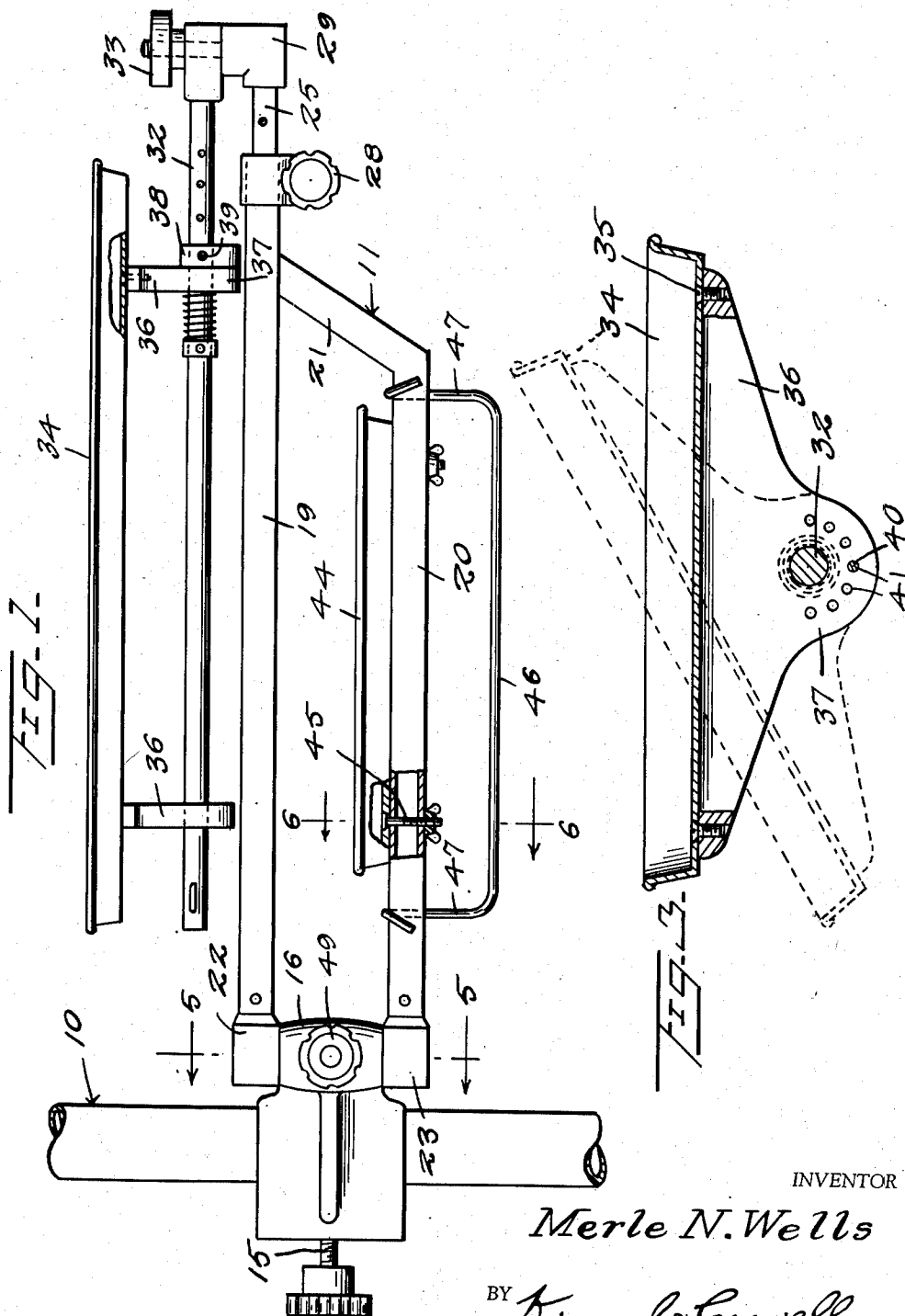

INVENTOR

Merle N. Wells

BY

Kimmel & Crowell

ATTORNEYS

Sept. 9, 1952

M. N. WELLS  
BEDSIDE STAND AND TRAY

2,609,938

Filed April 6, 1951

3 Sheets-Sheet 2

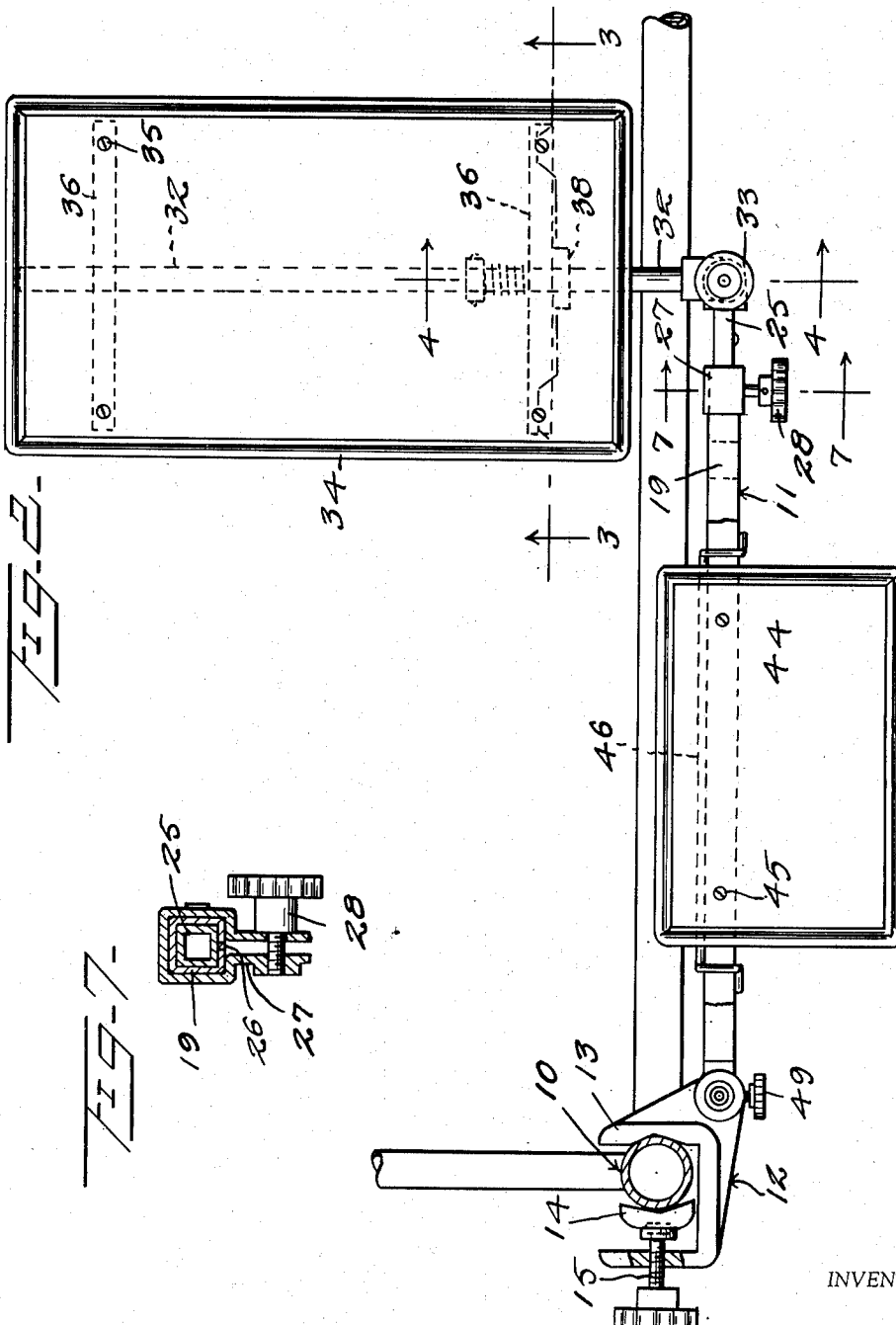

INVENTOR

Merle N. Wells

BY *Kimmel & Lowell*  
ATTORNEYS

Sept. 9, 1952

M. N. WELLS

2,609,938

BEDSIDE STAND AND TRAY

Filed April 6, 1951

3 Sheets-Sheet 3

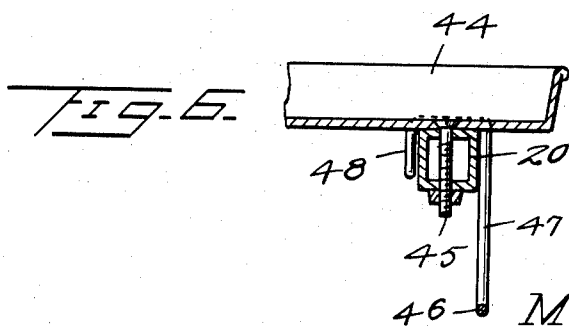
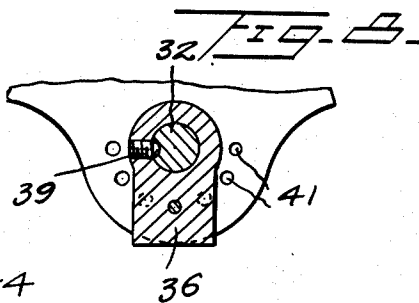
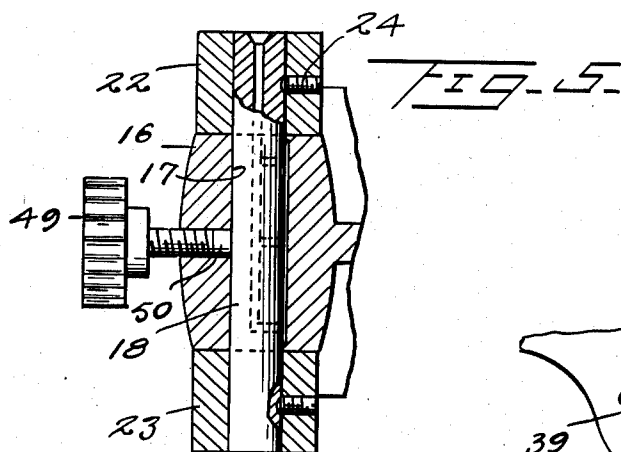
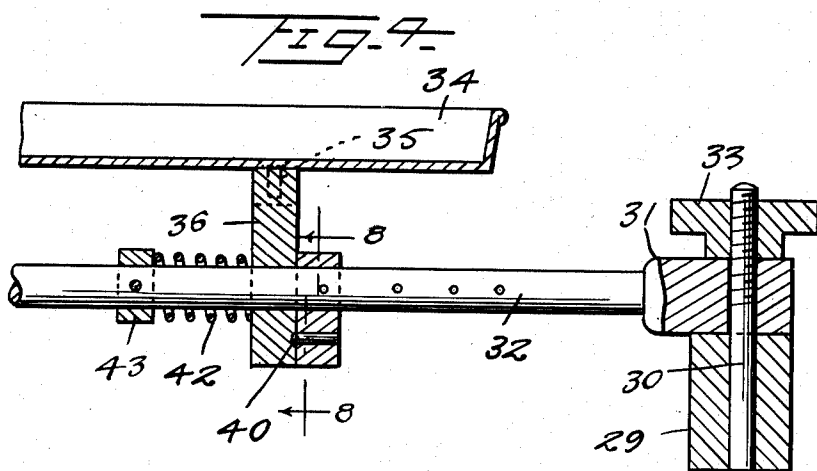

INVENTOR

Merle N. Wells

BY

Kimmel & Crowell

ATTORNEYS

## UNITED STATES PATENT OFFICE

2,609,938

## BEDSIDE STAND AND TRAY

Merle N. Wells, Fairview, Pa.

Application April 6, 1951; Serial No. 219,695

1 Claim. (Cl. 211—131)

1

This invention relates to swinging bracket construction.

An object of this invention is to provide an improved tray supporting bracket designed for mounting on a bed, such as a hospital bed, for supporting one or more trays in adjusted position relative to a patient.

A further object of this invention is to provide an improved bracket structure including means supporting a tray whereby the tray may be disposed in either a horizontal position for supporting dishes or other articles, or the tray may be tilted to a selected reading position.

A further object of this invention is to provide a swinging bracket structure wherein at least one of the bracket arms is extensible so that the tray carried by the other arm may be disposed in the proper position overlying the bed.

With the above and other objects in view, my invention consists in the arrangement, combination and details of construction disclosed in the drawings and specification, and then more particularly pointed out in the appended claim.

In the drawings:

Figure 1 is a detailed side elevation partly broken away and in section of a swinging tray supporting bracket structure constructed according to an embodiment of this invention.

Figure 2 is a plan view of the device showing the bracket structure in operative position with respect to a bed.

Figure 3 is a sectional view taken on the line 3—3 of Figure 2.

Figure 4 is a fragmentary sectional view taken on the line 4—4 of Figure 2.

Figure 5 is a sectional view taken on the line 5—5 of Figure 1.

Figure 6 is a fragmentary sectional view taken on the line 6—6 of Figure 1.

Figure 7 is a sectional view taken on the line 7—7 of Figure 2.

Figure 8 is a sectional view taken on the line 8—8 of Figure 4.

Referring to the drawings the numeral 10 designates a vertically disposed post such a post forming a part of the head of a bed or the like. A bracket structure generally designated as 11 is adapted to be secured to the post 10 and includes a clamp 12 formed of a fixed jaw 13 and a movable pressure applying jaw 14 which is swivelly carried by an adjusting pressure screw 15.

The jaw 13 has projecting therefrom a boss or bushing 16 formed with a vertically disposed bore 17 within which a pivot pin or shaft 18 is mounted. The bracket structure 11 includes

2

an inner bracket arm formed of parallel upper and lower bars 19 and 20 with the latter arm having an upwardly inclined extension 21 secured to the outer portion of the arm 19. Arm 19 is formed at its inner end with a bushing 22, and arm 20 is formed at its inner end with a bushing 23. The opposite ends of the shaft 18 are disposed in the bushings 22 and 23 and secured therein by fastening members 24.

The arm 19 which is the upper arm has telescoping into the outer end thereof an extensible arm 25. The outer end portion of arm 19 is lengthwise split as indicated at 26, and a clamp 27 engages about the split portion of arm 19 and is adapted to be contracted by means of a threaded bolt 28. The outer end of the extension arm 25 has secured thereto a right angle fitting 29 within which a vertically disposed bolt 30 is secured and a bushing 31 carried by one end of a swinging outer arm engages over bolt 30, and outer arm 32 is locked in angularly adjusted position with respect to arm 19 by means of a nut 33 which is threaded onto bolt 30.

A tray member 34 is secured by fastening devices 35 to a pair of tray supporting brackets 36. The brackets 36 are formed with downwardly projecting bosses 37 through which the outer arm loosely engages. A fixed block or body 38 is secured by fastening means 39 on the outer arm 32 and has projecting from one side thereof as shown in Figure 4 a pin 40. The inner one of the bracket members 36 is provided with a plurality of circumferentially spaced apart sockets or keepers 41 within a selected one of which pin 40 is adapted to engage for holding the tray 34 in either a horizontal or a vertically inclined position.

A spring 42 engages about the outer arm 32 bearing at one end against the inner bracket member 36 and bearing at its other end against a collar 43 which is adjustably secured on the outer arm 32. A lower or inner tray 44 is secured by wing bolts 45 to the lower arm 20. A towel supporting bar or rack 46 having upwardly projecting arms 47 at the opposite ends thereof is removably secured on the lower arm or bar 20 by means of hooks 48 carried by the extensions 47 which engage over the lower bar 20.

In the use and operation of this bracket structure the bracket assembly is secured by means of the clamp 12 to a vertical post 10 carried by the head of a bed. The vertical position of the bracket structure is initially determined so that the outer bracket arm 32 may be swung inwardly with respect to the bed and over the mattress and

3

the person or patient reclining in the bed. The relative position of the outer arm 32 with respect to the patient may be adjusted by the extensible arm 25.

The tray 34 may be used in a horizontal position to support dishes or other articles used by the patient and when it is desired to use the tray 34 for supporting a book or magazine for reading purposes the tray 34 may be rocked downwardly at its inner edge so as to dispose the pin 40 in a selected one of the keeper sockets 41. The inner tray 44 may be used for supporting medicines and other articles, and this latter tray may be removed from the bracket arm 20 by releasing the wing bolts 42.

The tray 34 may be disconnected from the bracket structure for cleaning the tray by unthreading nut 33 from bolt 30. The angular position of the inner bracket arms 19 and 20 with respect to the bed is adjusted by means of a clamping screw 49 which is threaded through the bushing 16 and bears against a pressure pin 50 which is adapted to engage against the shaft or pin 18.

What is claimed is:

A bracket and tray structure comprising a clamp adapted to be engaged with a vertical support, said clamp including a bushing having a vertical bore therethrough, a pivot pin extending through said bore, upper and lower parallel tubular arms secured to opposite ends of said pin for pivotal movement therewith, set screw means for securing said pin and hence said arms in a selected position, an extension connecting said lower arms with said upper arm, a tray fixedly carried by said lower arm, a telescopically extensible arm slidable within said upper arm, clamping means for securing said last-mentioned arm in

4

a desired position of extension, an upright at the outer end of said extensible arm, a swinging arm pivotally mounted for rotation on said upright, clamp means for securing said swinging arm at a desired point in its arc of rotation, a locking block slidable on said swinging arm, set screw means for securing said block in a desired position, a pin projecting from the face of said block, a pair of spaced tray supporting brackets slidable and rotatable on said swinging arm, a tray carried by said brackets, one of said brackets including a quadrant having a plurality of apertures rockably disposed about the periphery thereof, each of said apertures being selectively engageable with said pin for locking said tray in a desired position of angular adjustment, and spring means biasing said one bracket towards said block.

MERLE N. WELLS.

REFERENCES CITED

The following references are of record in the file of this patent:

UNITED STATES PATENTS

Number	Name	Date
672,573	Sidway	Apr. 23, 1901
1,024,804	Mergner	Apr. 30, 1912
1,218,923	Bogdanski	Mar. 13, 1917
1,220,578	Wise	Mar. 27, 1917
1,272,015	Davis	July 9, 1918
1,275,311	Schumacher et al.	Aug. 13, 1918
1,283,869	Nelson et al.	Nov. 5, 1918
1,894,991	Hayes	Jan. 24, 1933

FOREIGN PATENTS

Number	Country	Date
521,087	Great Britain	May 10, 1940