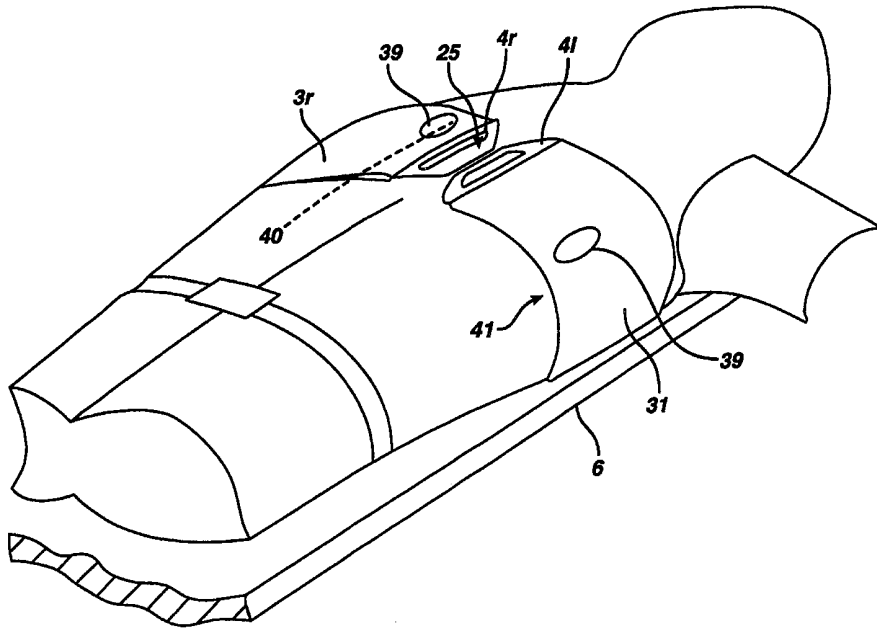

INTERNATIONAL APPLICATION PUBLISHED UNDER THE PATENT COOPERATION TREATY (PCT)

<p>(51) International Patent Classification ⁶ : A61H 31/00</p>	A1	<p>(11) International Publication Number: WO 99/09929</p> <p>(43) International Publication Date: 4 March 1999 (04.03.99)</p>						
<div style="display: flex; justify-content: space-between;"> <div style="width: 48%; vertical-align: top;"> <p>(21) International Application Number: PCT/US98/17502</p> <p>(22) International Filing Date: 24 August 1998 (24.08.98)</p> <p>(30) Priority Data:</p> <table style="width: 100%; border: none;"> <tr> <td style="width: 30%;">08/922,723</td> <td style="width: 30%;">27 August 1997 (27.08.97)</td> <td style="width: 40%;">US</td> </tr> <tr> <td>08/924,555</td> <td>27 August 1997 (27.08.97)</td> <td>US</td> </tr> </table> <p>(71) Applicant: EMERGENCY MEDICAL SYSTEMS, INC. [US/US]; 3260 Alpine Road, Portola Valley, CA 94028 (US).</p> <p>(72) Inventors: MOLLENAUER, Kenneth, H.; 3260 Alpine Road, Portola Valley, CA 94028 (US). SHERMAN, Darren, R.; 3260 Alpine Road, Portola Valley, CA 94028 (US). BYSTROM, Steven, R.; 3260 Alpine Road, Portola Valley, CA 94028 (US). MINER, Cameron; 3260 Alpine Road, Portola Valley, CA 94028 (US).</p> <p>(74) Agent: CROCKETT, K., David; Crockett & Fish, 22363 Rosebriar, Mission Viejo, CA 92692 (US).</p> </div> <div style="width: 48%; vertical-align: top;"> <p>(81) Designated States: AL, AM, AT, AU, AZ, BA, BB, BG, BR, BY, CA, CH, CN, CU, CZ, DE, DK, EE, ES, FI, GB, GE, GH, GM, HR, HU, ID, IL, IS, JP, KE, KG, KP, KR, KZ, LC, LK, LR, LS, LT, LU, LV, MD, MG, MK, MN, MW, MX, NO, NZ, PL, PT, RO, RU, SD, SE, SG, SI, SK, SL, TJ, TM, TR, TT, UA, UG, UZ, VN, YU, ZW, ARIPO patent (GH, GM, KE, LS, MW, SD, SZ, UG, ZW), Eurasian patent (AM, AZ, BY, KG, KZ, MD, RU, TJ, TM), European patent (AT, BE, CH, CY, DE, DK, ES, FI, FR, GB, GR, IE, IT, LU, MC, NL, PT, SE), OAPI patent (BF, BJ, CF, CG, CI, CM, GA, GN, GW, ML, MR, NE, SN, TD, TG).</p> <p>Published <i>With international search report.</i></p> </div> </div>			08/922,723	27 August 1997 (27.08.97)	US	08/924,555	27 August 1997 (27.08.97)	US
08/922,723	27 August 1997 (27.08.97)	US						
08/924,555	27 August 1997 (27.08.97)	US						
<p>(54) Title: RESUSCITATION DEVICE</p> <div style="text-align: center; margin-top: 20px;">  </div>								
<p>(57) Abstract</p> <p>A resuscitation device (1) for automatic compression of victim's chest using a compression belt (3) which exerts force evenly over the entire thoracic cavity. The belt (3) is constricted and relaxed through a motorized spool assembly (7) which repeatedly tightens the belt and relaxes the belt to provide repeated and rapid chest compression. An assembly includes various resuscitation devices including chest compression devices (2), defibrillation devices (39), and sensors (36) which initiate communications with emergency medical personnel automatically upon use of the device.</p>								

FOR THE PURPOSES OF INFORMATION ONLY

Codes used to identify States party to the PCT on the front pages of pamphlets publishing international applications under the PCT.

AL	Albania	ES	Spain	LS	Lesotho	SI	Slovenia
AM	Armenia	FI	Finland	LT	Lithuania	SK	Slovakia
AT	Austria	FR	France	LU	Luxembourg	SN	Senegal
AU	Australia	GA	Gabon	LV	Latvia	SZ	Swaziland
AZ	Azerbaijan	GB	United Kingdom	MC	Monaco	TD	Chad
BA	Bosnia and Herzegovina	GE	Georgia	MD	Republic of Moldova	TG	Togo
BB	Barbados	GH	Ghana	MG	Madagascar	TJ	Tajikistan
BE	Belgium	GN	Guinea	MK	The former Yugoslav Republic of Macedonia	TM	Turkmenistan
BF	Burkina Faso	GR	Greece	ML	Mali	TR	Turkey
BG	Bulgaria	HU	Hungary	MN	Mongolia	TT	Trinidad and Tobago
BJ	Benin	IE	Ireland	MR	Mauritania	UA	Ukraine
BR	Brazil	IL	Israel	MW	Malawi	UG	Uganda
BY	Belarus	IS	Iceland	MX	Mexico	US	United States of America
CA	Canada	IT	Italy	NE	Niger	UZ	Uzbekistan
CF	Central African Republic	JP	Japan	NL	Netherlands	VN	Viet Nam
CG	Congo	KE	Kenya	NO	Norway	YU	Yugoslavia
CH	Switzerland	KG	Kyrgyzstan	NZ	New Zealand	ZW	Zimbabwe
CI	Côte d'Ivoire	KP	Democratic People's Republic of Korea	PL	Poland		
CM	Cameroon	KR	Republic of Korea	PT	Portugal		
CN	China	KZ	Kazakhstan	RO	Romania		
CU	Cuba	LC	Saint Lucia	RU	Russian Federation		
CZ	Czech Republic	LI	Liechtenstein	SD	Sudan		
DE	Germany	LK	Sri Lanka	SE	Sweden		
DK	Denmark	LR	Liberia	SG	Singapore		
EE	Estonia						

Resuscitation Device

Field of the Invention

This invention relates to emergency medical devices and methods.

5 Background of the Invention

Cardiopulmonary resuscitation (CPR) is a well known and valuable method of first aid. CPR is used to resuscitate people who have suffered from cardiac arrest after heart attack, electric shock, chest injury and many other causes. During
10 cardiac arrest, the heart stops pumping blood, and a person suffering cardiac arrest will soon suffer brain damage from lack of blood supply to the brain. Thus, CPR requires repetitive chest compression to squeeze the heart and the thoracic cavity to pump blood through the body. Very often, the victim is not
15 breathing, and mouth to mouth artificial respiration or a bag valve mask is used to supply air to the lungs while the chest compression pumps blood through the body.

It has been widely noted that CPR and chest compression can save cardiac arrest victims, especially when applied immediately
20 after cardiac arrest. Chest compression requires that the person providing chest compression repetitively push down on the sternum of the victim at 80-100 compressions per minute. CPR and closed chest compression can be used anywhere, wherever the cardiac arrest victim is stricken. In the field, away from the
25 hospital, it may be accomplished by ill-trained by-standers or highly trained paramedics and ambulance personnel.

When a first aid provider performs chest compression well, blood flow in the body is typically about 25-30% of normal blood flow. This is enough blood flow to prevent brain damage.
30 However, when chest compression is required for long periods of time, it is difficult if not impossible to maintain adequate

compression of the heart and rib cage. Even experienced
paramedics cannot maintain adequate chest compression for more
than a few minutes. Hightower, et al., Decay In Quality Of
Chest Compressions Over Time, 26 Ann. Emerg. Med. 300 (Sep.
5 1995). Thus, long periods of CPR, when required, are not often
successful at sustaining or reviving the victim. At the same
time, it appears that, if chest compression could be adequately
maintained, cardiac arrest victims could be sustained for
extended periods of time. Occasional reports of extended CPR
10 efforts (45-90 minutes) have been reported, with the victims
eventually being saved by coronary bypass surgery. See Tovar,
et al., Successful Myocardial Revascularization and Neurologic
Recovery, 22 Texas Heart J. 271 (1995).

In efforts to provide better blood flow and increase the
15 effectiveness of bystander resuscitation efforts, modifications
of the basic CPR procedure have been proposed and used. Of
primary concern in relation to the devices and methods set forth
below are the various mechanical devices proposed for use in
main operative activity of CPR, namely repetitive compression of
20 the thoracic cavity.

The device shown in Barkolow, Cardiopulmonary resuscitator
Massager Pad, U.S. Patent 4,570,615 (Feb. 18, 1986), the
commercially available Thumper device, and other such devices,
provide continuous automatic closed chest compression. Barkolow
25 and others provide a piston which is placed over the chest
cavity and supported by an arrangement of beams. The piston is
placed over the sternum of a patient and set to repeatedly push
downward on the chest under pneumatic power. The victim must
first be installed into the device, and the height and stroke
30 length of the piston must be adjusted for the patient before
use, leading to delay in chest compression. Other analogous
devices provide for hand operated piston action on the sternum.
Everette, External Cardiac Compression Device, U.S. Patent
5,257,619 (Nov. 2, 1993), for example, provides a simple chest
35 pad mounted on a pivoting arm supported over a patient, which
can be used to compress the chest by pushing down in the

pivoting arm. These devices are not clinically more successful³ than manual chest compression. See Taylor, et al., External Cardiac Compression, A Randomized Comparison of Mechanical and Manual Techniques, 240 JAMA 644 (Aug. 1978). Other devices for
5 mechanical compression of the chest provide a compressing piston which is secured in place over the sternum via vests or straps around the chest. Woudenberg, Cardiopulmonary Resuscitator, U.S. Patent 4,664,098 (May 12, 1987) shows such a device which is powered with an air cylinder. Waide, et al., External
10 Cardiac Massage Device, U.S. Patent 5,399,148 (Mar. 21, 1995) shows another such device which is manually operated. In another variation of such devices, a vest or belt designed for placement around the chest is provided with pneumatic bladders which are filled to exert compressive forces on the chest.
15 Scarberry, Apparatus for Application of Pressure to a Human Body, U.S. Patent 5,222,478 (Jun. 29, 1993) and Halperin, Cardiopulmonary Resuscitation and Assisted Circulation System, U.S. Patent 4,928,674 (May 29, 1990) show examples of such devices.

20 Several operating parameters must be met in a successful resuscitation device. Chest compression must be accomplished vigorously if it is to be effective. Very little of the effort exerted in chest compression actually compresses the heart and large arteries of the thorax and most of the effort goes into
25 deforming the chest and rib cage. The force needed to provide effective chest compression creates risk of other injuries. It is well known that placement of the hands over the sternum is required to avoid puncture of the heart during CPR. Numerous other injuries have been caused by chest compression. See Jones
30 and Fletter, Complications After Cardiopulmonary Resuscitation, 12 AM. J. Emerg. Med. 687 (Nov. 1994), which indicates that lacerations of the heart, coronary arteries, aortic aneurysm and rupture, fractured ribs, lung herniation, stomach and liver lacerations have been caused by CPR. Thus the risk of injury
35 attendant to chest compression is high, and clearly may reduce the chances of survival of the victim vis-à-vis a resuscitation

technique that could avoid those injuries. Chest compression will be completely ineffective for very large or obese cardiac arrest victims because the chest cannot be compressed enough to cause blood flow. Chest compression via pneumatic devices is hampered in its application to females due to the lack of provision for protecting the breasts from injury and applying compressive force to deformation of the thoracic cavity rather than the breasts.

CPR and chest compression should be initiated as quickly as possible after cardiac arrest to maximize its effectiveness and avoid neurologic damage due to lack of blood flow to the brain. Hypoxia sets in about two minutes after cardiac arrest, and brain damage is likely after about four minutes without blood flow to the brain, and the severity of neurologic defect increases rapidly with time. A delay of two or three minutes significantly lowers the chance of survival and increases the probability and severity of brain damage. However, CPR and ACLS are unlikely to be provided within this time frame. Response to cardiac arrest is generally considered to occur in four phases, including action by Bystander CPR, Basic Life Support, Advanced Life Support, and the Emergency Room. By-stander CPR occurs, if at all, within the first few minutes after cardiac arrest. Basic Life Support is provided by First Responders who arrive on scene about 4-6 minutes after being dispatched to the scene. First responders include ambulance personnel, emergency medical technicians, fireman and police. They are generally capable of providing CPR but cannot provide drugs or intravascular access, defibrillation or intubation. Advanced Life Support is provided by paramedics or nurse practitioners who generally follow the first responders and arrive about 8-15 minutes after dispatch. ALS is provided by paramedics, nurse practitioners or emergency medical doctors who are generally capable of providing CPR, drug therapy including intravenous drug delivery, defibrillation and intubation. The ALS providers may work with a victim for twenty to thirty minutes on scene before transporting the victim to a nearby hospital. Though defibrillation and drug therapy is

often successful in reviving and sustaining the victim, CPR is often ineffective even when performed by well trained first responders and ALS personnel because chest compression becomes ineffective when the providers become fatigued. Thus, the initiation of CPR before arrival of first responders is critical to successful life support. Moreover, the assistance of a mechanical chest compression device during the Basic Life Support and Advanced Life Support stages is needed to maintain the effectiveness of CPR.

Summary

The devices described below provide for circumferential chest compression with a device which is compact, portable or transportable, self-powered with a small power source, and easy to use by by-standers with little or no training. Additional features may also be provided in the device to take advantage of the power source and the structural support board contemplated for a commercial embodiment of the device.

In its simplest form, the device includes a broad belt which wraps around the chest and is buckled in the front of the cardiac arrest victim. The belt is repeatedly tightened around the chest to cause the chest compression necessary for CPR. The buckles and/or front portion of the belt are anatomically accommodating for the female breast, or for the obese person, so that the device is effective for women as well as men. The buckle may include an interlock which must be activated by proper attachment before the device will activate, thus preventing futile belt cycles. The operating mechanism for repeatedly tightening the belt is provided in a support board, and comprises a rolling mechanism which takes up the intermediate length of the belt to cause constriction around the chest. The roller is powered by a small electric motor, and the motor powered by batteries and/or standard electrical power supplies such as 120V household electrical sockets or 12V DC automobile power sockets (car cigarette lighter sockets). (An initial prototype used a power drill with a single 9.6V

rechargeable battery, and provided powerful chest compression for about ten minutes.) The batteries and any necessary transformers may be housed in the support board, and the support board may be made in sizes useful for supporting the victim's head, adequate for storing batteries and other accessories, and convenient for mounting within office buildings, factories, airplanes and other areas of potential need. Thus, numerous inventions are incorporated into the portable resuscitation device described below.

10 The portable resuscitation device may incorporate a number of features and accessories that aid in the administration of CPR and other therapy. By-standers may be unable to confidently determine if chest compression is needed, or when it should be stopped. Accordingly, the device may be combined with an
15 interlock system including a heart monitor or EKG which diagnoses the condition of the patient, and circuitry or a computer which initiates, permits or forbids belt operation accordingly. The power supply provided for belt constriction may also be used to provide power for defibrillation (an
20 appropriate treatment for many cardiac arrests). Again, bystanders will most likely not be capable of determining when defibrillation is appropriate, and the defibrillation portion of the device may be provided with an interlock system including the heart monitor or EKG which diagnoses the condition of the
25 patient and circuitry which initiates, permits, or forbids defibrillation. Expert systems implemented through the circuitry or computer modules can accomplish these functions.

Automatic, computer driven therapy of this nature may provide early and appropriate life saving response to many
30 cardiac arrest patients who would otherwise die. However, some situations in which the device might be used may call for expert supervision of the CPR process by emergency medical technicians, emergency room doctors, or cardiologists. To this end, the expert systems mentioned above may be replaced with the expert
35 diagnosis and decision-making of medical personnel through a telemetry system housed within the support board of the device.

The support board can include a telemetry system which automatically dials medical personnel in a nearby hospital, emergency medical crew, ambulance, or even a central diagnostic and control facility. Interlocks, limit switches and other
5 typical sensors can be used to sense the proper position and closure of the belt about the chest of the patient. Heart monitors and EKG electrodes can sense the heart rate and EKG of the victim. Using communication equipment within the device, this information can be communicated from the device to medical
10 personnel remote from the victim. Through the same system, the medical personnel can communicate the device to initiate, permit or prohibit belt constriction or defibrillation, as dictated by preferred medical procedures. Communication can be established through normal telephone lines and a cordless telephone, or
15 through a cellular telephone system, paging system, internet or any other communications system. The device can be programmed with location information, or provided with GPS capabilities to determine the location of the device, and this information can be automatically transmitted to an emergency response system
20 such as the 911 system when the system is placed in use.

Brief Description of The Drawings

Figure 1 is an overview of the resuscitation device, showing the inner and outer vests partially open.

Figure 2 is an overview of the resuscitation device in the
25 buckled configuration.

Figure 3 is an detail view of the buckle used to close the device about a victim.

Figure 4 shows the spool assembly used to operate the compression belt.

30 Figure 5 shows an alternative embodiment of the spool assembly used to operate the compression belt.

Figure 6 is a view of the resuscitation device properly positioned on a victim.

Figure 7 shows the resuscitation device fitted with a number of additional devices for use during resuscitation.

5 Figure 8 shows a detail view of the CRP module of Figure 7.

Figure 9 shows a detail view of the defibrillation module of Figure 7.

Figure 10 shows a detail view of the airway management module of Figure 7.

10 Figure 11 shows a detail view of the control and communications module of Figure 7.

Figure 12 shows a block diagram of the communications system.

Figure 13 is a block diagram of the motor control system.

15

Detailed Description of the Invention

Figure 1 shows a simplified version of the resuscitation device **1**. The mechanisms used for compressing the chest includes compression assembly **2** which includes a chest
20 compression belt **3** with buckles **4l** and **4r**, a friction liner **5**, a support board **6** and a motor driven spool assembly **7**. The support board **6** is placed under a cardiac arrest victim, and the compression belt **3** and friction liner **5** are wrapped around the victim's chest. The chest compression belt, having a left side
25 **3l** and a right side **3r**, is buckled over the victims chest by latching the buckles **4l** and **4r** together. In this configuration, the friction liner **5** will fit between the chest compression belt **3** and the victim and any clothes worn by the victim. The compression belt may be made of any strong
30 material, and sail cloth has proven adequate for use. The

compression belt may also be referred to as a vest, corset, girdle, strap or band. The friction liner may be made of Teflon®, tyvek™ or any other low friction material (by low friction, we mean a material that will permit sliding of the compression belt with less friction than expected between the belt and the victims clothing or bare skin). The friction liner may be made with any suitable lining material, as its purpose is to protect the victim from rubbing injury caused by the compression belt, and it may also serve to limit frictional forces impeding the compression belt operation. The friction liner can be provided in the form of a belt, vest, corset, girdle, strap or band, and may partially or completely encircle the chest.

The front of the compression belt 3, including the buckles 4l and 4r, are configured to provide a broad pressure point over the sternum of the victim. This is illustrated in Figure 2. Large openings 8 may be provided to accommodate female breasts and obese male breasts. The underside of the buckles 4l and 4r are smooth and broad, to distribute compressive force evenly over a wide area of the chest corresponding to the sternum. The point at which the buckle attaches to the chest compression belt may vary considerably, from the front of the chest to the back of the compression assembly, and the openings 8 may be provided in the buckles rather than the belt itself. Figure 3 shows a detail of the buckles 4 used to fasten the compression belt about the chest of the victim. The buckle may be of any type, and preferably includes a latch sensing switch 9 operably connected through wire 10 to the motor control system (see Figure 13) to indicate that the device has been buckled about the victims chest and is ready for the initiation of compression cycles. The buckles shown in Figure 3 are D-ring shaped buckles with large openings 8, attached to the compression belt 3. Other fasteners and fastening means may be used.

The chest compression belt 3 is repeatedly tightened about the chest of a victim through the action of one or more

tightening spools which make up the spool assembly 7 located within the support board 6. The spool assembly, illustrated in Figure 4, includes at least one spool or reel connected to the compression belt 3 at the back of the belt, preferably near the center or saggital line **11** of the compression belt (although it

may be located on the front or side of compression belt). Figure 4 shows a view of the spool assembly and its attachment to the compression belt. A spool assembly includes a single drive spool **12** operably connected to the motor **14** through drive shaft **15**. The compression belt is secured to the drive spool in any suitable manner. In this case a longitudinal slot **16** provided in the drive spool **12**. The slot extends radially or chordally through the drive spool, and extends axially for a length corresponding to the width of the compression belt, leaving the ends **17** solid for connection to the drive shaft **15** and journal shaft **18**. The belt is slipped through the slot to created a secure connection between the belt and the drive spool. When secured in this manner, the rotation of the drive spool **12** will take up the right side of the compression belt **3r** and the left side of the compression belt **3l** and roll them up onto the spool, thus tightening the compression belt about the chest of the victim wearing the device. Spindles or alignment rollers **19** provide for alignment and low friction feed of the belt onto the roll created by operation of the drive shaft.

Many alternative embodiments can be envisioned for the rolling mechanism, and one such alternative is illustrated in Figure 5. Spools **12l** and **12r** are aligned in parallel and interconnected by a transmission gear **20** and planetary gear **21** and journaled upon shafts **18l** and **18r**. The drive shaft **15** is attached to spool **12r** (or spool **12l**) and operably attached to motor **14**. The motor turns the shaft **18r** and spool **12r** in a counterclockwise direction to pull the right side of the compression belt **3r** to the left and roll onto the spool. The transmission gear **20** acts upon the planetary gear **21** to cause clockwise rotation of spool **12l**, which in turn pulls and wraps the left side of the compression belt **3l** onto the spool **12l**.

Thus, many embodiments of mechanisms which can cause repeated cyclic tightening of the compression vest about the chest of the victim may be envisioned. The compression belt serves to radially compress the chest through the cooperative
5 action of the belt, board, and buckle, and to disperse the compressive force around the chest.

The motor is energized to rotate the spools and cause the compression belt to constrict around the chest of a victim. A motor such as a battery operated hand drill motor provides
10 adequate chest compression for the purposes of CPR. To cause repetitive constriction of the compression belt 3, the motor 14 must be attached via a clutch **22** or other such mechanism. The motor 14 may be attached to the drive shaft 15 through a torque slipping clutching mechanism which engages the drive shaft until
15 a high torque is achieved (indicating great resistance to further constriction, and thus indicating that the victim's chest has been compressed), and releases automatically upon such high torque, only to re-engage after the belt has been expanded in response to the normal elastic expansion of the victim's
20 chest. In this manner, repetitive compression is achieved without need to repeatedly energize and de-energize the motor, thereby extending the length of operating time for any given battery supply. Alternatively, the motor may be repeatedly energized and de-energized, with the spools spinning freely
25 during periods in which the belt is de-energized, wherein the clutch mechanism 22 will be similar to clutch mechanisms used on electric drills (which engage during operation of the drill but spin freely when the drill is de-energized). While the natural elastic expansion of the chest should make it unnecessary to
30 drive the belt toward a loose condition, positive loosening may be achieved by reversing the motor or reversing the action of the motor through appropriate clutch or gear mechanisms. Timing of compressions is regulated through a computer module or a simple relay (windshield wiper style relays), and preferably
35 will conform to standard of the Advanced Cardiac Life Support guidelines or Cardiopulmonary Resuscitation guidelines, or any

other medically acceptable resuscitation regime. Current guidelines put forth by the American Heart Association call for 60-100 chest compressions per minute.

The motor is preferably battery powered, with provisions for taking power from any available power source. Batteries **23** may be stored within the support board **6**. Three volt batteries of convenient size, already available for use with numerous power tools, provide about five minutes of compression per battery, while twelve volt batteries (1700mA-h per battery) have provided about ten minutes of compression per battery. A thirty minute total battery capacity is desirable (corresponding to the estimated average time between cardiac arrest and transport to the hospital). Accordingly, several batteries may be installed within the support board and electrically connected to the motor and its controller. The batteries are provided with a trickle charge through a charger socket and charger plugged into 120V AC power when the device is not in use. (It is intended that the device be installed in factories, office buildings, airplanes and other facilities with relatively stable sources of power, and that the unit remain plugged in and charging when not in use.) If AC power is readily available at the site of use, the device may continue to run on AC power to preserve the batteries for later use. The unit may also be plugged into an automobile power jack with an appropriate auto adapter, thus providing for use where an automobile is the only source of power, and for extended use in an ambulance.

Figure 6 shows the resuscitation device installed on a cardiac arrest victim. The support board is placed under the victim, and the right and left portions of the compression belt are wrapped around the victim's chest and buckled over the front of the chest, indicated by arrow **25**. Once in place, the system may be put into operation by manually starting the motors or by automatic initiation given the proper feedback from sensors located on the device, including the buckle latch sensors.

A number of features may be combined with the basic system described above. The structure necessary for housing the operating mechanism for the belt, referred to as the support board above, can serve also as storage for additional devices used during resuscitation. Figure 7 illustrates the resuscitation device 1 in a potential commercial embodiment. The support board 6 is sized to reach approximately from the lower lumbar region to the shoulders of a victim. The compression module 26 is separable from the support board 6, and includes the compression belt and friction vest stored within the compression module. The spool assembly and motor are also stored within the compression module, although the motor may also be installed in the support board. In this figure, the compression module comprises a small support board 27 which fits into the larger system support board 28. Taking advantage of available space in the system support board, a compartment 29 for storage of airway management devices (bag masks, oxygen masks, etc.), and a compartment 30 for storage of defibrillation equipment (electrodes and paddles, etc.) are included with the support board. A control and communication module 31 may also be incorporated into the support board. A small oxygen bottle 32 may be included, along with hoses routed to an accessible point on the board, and any connector desired for connection between the oxygen bottle and devices provided in the airway management compartment. Batteries 23 are stored within the support board (the number of the batteries chosen according the desired operating time, and the placement of the batteries dictated by available space). Batteries are operably connected to the motor in the compression module through electrical connectors 33 and appropriate wiring throughout the support board. The batteries can also be operably connected to the defibrillation module and control and communications module. Although long life batteries can be used, rechargeable batteries may be preferred. Accordingly, charging connection 34 on the support board is provided for charging the batteries or operating the device through outside power supplies.

The device is intended to be stored for long periods of time between uses, and storage holder **35** is provide for this purpose. The storage holder can include such necessities as power supply connectors, power plug, a charging transformer. A removal sensor **36** is included in the support board to sense when the support board is removed from the storage holder (which, as described below, can be used as a condition indicating use of the device, and therefore the need to alert emergency medical personnel). The removal sensor can comprise a simple limit switch which senses physical removal of the system, and the limit switch can be used as a power switch or awaken switch which starts initiation of the system. The removal sensor can comprise a current sensor on the charging lines which treat cessation of charging current, increase in current draw through the charging system, or motor current as an indication of use. The choice of sensor may be made with many practical considerations in mind, such as the desire to avoid treating power outages as indications of use and other such unintended initiations. The state in which the device is deemed to be "in use" can be chosen according to the practical considerations, and in most instances it is expected that mere removal of the resuscitation device from the holder will constitute a clear signal someone has determined that a victim requires its use, and that emergency medical personnel should be dispatched to the location of the device. There are some environments in which later conditions will be used to indicate that the device is "in use," such as when installed in ambulances, airplanes, hospitals or other environments where it might be advisable to remove the device from its storage holder as a precaution or preparatory measure, and delay initiation of communications until the device is deployed or installed on the victim. In such cases, the buckle latch shown in Figure 3 can be used as the sensor that indicates that the resuscitation device is in use.

Figure 8 shows the details of the compression module **26**. When not in use, the module is covered with a tear sheet **37** which protects the compression belt from wear. The buckles are

readily visible under the tear sheet. The electrical connectors **38** connect the batteries in the support board with the motor inside the compression module. The inside of the compression belt is fitted with penetrating electrodes **39** in the right sternum parasagittal location **40** and left rib medial location **41** for establishing the electrode contact needed for EKG sensing. These electrodes may be dispensed with in environments where proper placement of the defibrillation electrodes can be assumed due to a high level of training amongst likely bystanders and first responders. The friction vest **5** is secured to the compression module above the spool assembly location.

Figure 9 shows a detail view of the defibrillation module **30**. The defibrillation module includes a pair of defibrillation electrodes **42** connected to the batteries through the power connections **43**. The defibrillation electrodes will be controlled by circuitry housed within the defibrillation module, and may be connected to the control module through the data port **44**. The defibrillation module is releasably attached to the support board **28** with quick release latches **45**. Tear sheet **46** protects the components of the defibrillation module during storage and provides ready access for use. Figure 10 shows the detail view of the airway management module **29**, which includes an oxygen mask **47**, a length of tubing **48** and an air fitting **49** connecting the oxygen mask to the oxygen bottle within the support board. The oxygen mask serves as a blood gas exchange means, supplying oxygen to the lungs for exchange with blood gas such as CO₂. Optional medicine injectors **50** may be operably connected to the masks or hose to provide for automatic injection of ACLS medications into the airway. The defibrillation module is releasably attached to the support board **28** with quick release latches **51**. Tear sheet **46** protects the components of the airway management module during storage and provides ready access for use. An end-tidal CO₂ monitor **52** can be included in the mask to provide for biological feedback and monitoring of the success of the CPR. A skin mounted blood oxygen level monitor **53** can also be mounted on the mask for the

same purpose (fingertip blood oxygen sensors may also be used, and supplied in the overall assembly to be readily available). The biological data obtained by the sensors is transmitted to the control module via appropriate wiring in the mask and support board.

Figure 11 shows a detail view of the control and communications module. The control unit **54** is connected to the compression module, defibrillation module and the airway management module through appropriate wiring through the support board. The control unit is optionally connected to the communications unit **55**. The communications unit includes means for communicating the EKG and other measured medical parameters sensed on the board to the screen **56** and via telephone to remote medical personnel. The communications unit can include a telephone handset or speaker phone. Because the device is most likely to be used at a location separate from the storage holder, the communications module preferably includes a wireless communication device, such as wireless telephone, radio telephone or cellular, and any necessary telephone base will be installed in the storage holder.

The communications unit and control unit are set up to operate in the following manner, also illustrated in the block diagram of Figure 12. The device may remain mounted in a charging unit for months between use, and will be removed from the charging unit for use. Upon removal of the device from its storage location, a sensor in the control unit senses the removal (through limit switches, magnetic switches, or motion sensors, current sensors in the charging system, or otherwise) and initiates the system, checking functions, energizing a display unit and accomplishing other typical warm-up functions. As a first step, the system initiates a telephone communication with a medical facility through the communications unit. The communication may use any communication medium, whether it be standard telephone lines, cellular telephone system, paging system or radio transmitter. The system may be set up to initiate communications with central medical facility, such as a

local 911 emergency system, a nearby hospital or ambulance service, or a central facility staffed with medical personnel trained specifically on the remote use of the device (all generally referred to as medical personnel). Upon establishing
5 communication, the communications unit informs medical personnel of the location or identification of the device (which may be stored in computer memory in the communications unit, or determined through GPS or other such system), and this information can be used to dispatch an emergency medical team to
10 the location of the device. In a simple embodiment which does not require a computer to control the actions of the alert feature, the removal sensor may comprise a limit switch, while the communications module may comprise a simple telephone unit installed in the storage holder together with a tape recorded
15 message, where the operation of the relay in response to removal of the resuscitation device includes initiation of the telephone call to 911 and playback of an alert message providing alert information such as the location of the board. The communications unit may also be provided with an alert button
20 which may be operated by a bystander regardless of the use of the board to summon an emergency team to the location regardless of the condition of the resuscitation device.

Before the emergency medical team arrives, a bystander will place the board under the victim, buckle the compression belt
25 around the victim and apply defibrillation and/or sensing electrodes (or vice versa) (alternatively, sensing electrodes can be included on the inner surface of the compression belt). The system monitors the installation of the belt through signals provided through latching sensors in the buckle. The system
30 monitors biological input, which can comprise monitoring of EKG signals from the EKG electrode patches of the defibrillation module, monitoring EKG signals belt mounted electrodes, monitoring signals from an end-tidal CO₂ monitor from the airway management module, and any other biological signal sensor
35 incorporated into the device. The system can also monitor or respond to manually inputted instruction from the control unit,

in order to provide on-site emergency medical personnel with control of the device when they arrive on scene. During operation, the system transmits all available biological information, including EKG signals, blood pressure, end-tidal CO₂ and any other monitored biological parameter to the remote medical facility, and it can also transmit information regarding the configuration of the device, including battery life, system operating limit settings (i.e., whether the system is set for automatic operation, permissive operation, or disabled in any function) so that medical personnel can ensure that the appropriate configuration is in effect.

Communication with the medical facility will allow emergency medical personnel to diagnose the condition of the patient and, through signals sent from the medical personnel to the communications unit, permit, initiate or prohibit certain additional therapeutic ACLS actions. For example, upon diagnosing the EKG conditions which indicate the need for defibrillation, the medical personnel can send a signal to the communications unit which acts upon the control unit to permit manual operation of the defibrillation electrodes by the bystander. The system also provides for application of a defibrillation shock via remote signal from the medical personnel. The device can incorporate the expert system such as the Automatic External Defibrillator. The medical personnel can also communicate other actions, and ensure that certain acts are undertaken by the bystander through the communication system. For example, the medical personnel may communicate verbally with the bystander to ascertain the cause of the cardiac arrest, the proper placement of the oxygen mask, appropriate clearing of the airway, and other information. Where the airway management module is provided with medication such as epinephrine, lidocaine, bretylium or other drugs called for in the ACLS guidelines (or newly proposed drugs such as T3), the medical personnel can instruct by-standers to inject appropriate medication through the airway. Where automatic injectors such as those described in Kramer, Interactive External

Defibrillation and Drug Injection System, U.S. Patent 5,405,362³ (Apr. 11, 1995) are provided, or similar system with non-osseous injectors are provided, the medical personnel can instruct by-

5 injectors. Where the injectors are provided with means for automatic operation based on measured EKG signals, blood pressure and end-tidal CO₂, the medical personnel can send signals to the system to initiate injection by remote control of the medical personnel, permit injection by local control as
10 determined by the expert system, permit injection by bystanders, or prohibit injection by the system or bystanders. For example, the system can be initially set up to forbid any injection. Medical personnel, having diagnosed ventricular fibrillation through the information provided by the
15 communications unit, can send an appropriate signal to permit or initiate injection of epinephrine, and also send a signal to prohibit injection of atropine until called for under the ACLS guidelines. A newly proposed drug T3 can be administered through the airway, into the lungs, as a therapy for cardiac
20 arrest. Controlled injection into the airway can be initiated or prohibited in the same manner. Thus, all actions in the ACLS, including compression, defibrillation, drug injection can be accomplished through the system under the guidance of medical personnel from a remote location, or they may be accomplished
25 through expert systems installed in the control module. Each of these functions is incorporated in a system that automatically initiates communication with medical personnel and informs medical personnel of the location of the device so that emergency medical personnel may be dispatched to the location.

30 The repeated compression will be initiated upon buckling of the compression belt (automatically) or a switch can be provided for the bystander to initiate compression. The system will continue compression cycles, until de-activated, according to the motor control block diagram of Figure 13. Upon initiation
35 of the system, the control unit will monitor installation of the belt via appropriate sensors in the buckles or through other

sensors. When the motor control **57** receives the initiate compression signal from the control unit, the motor is started. The motor is preferably run continuously, rather than stopped and started, to avoid repeated application of startup current and thus conserve battery power. When the motor is up to speed, the clutch is engaged. As a baseline, the clutch is engaged every second for one-half second. This cyclic engagement of the clutch continues repeatedly for five cycles, as recommended by current CPR guidelines, and then is interrupted for a respiration pause, if desired. To avoid excessive drain on the batteries, the motor controller includes a torque sensor (sensing current supply to the motor, for example), and monitors the torque or load on the motor. A threshold is established above which further compression is not desired or useful, and if this occurs during the half second of clutch engagement, then the clutch is disengaged and the cycle continues. The system can monitor the effectiveness of the compression stroke by monitored the CO₂ content of the victim's exhalant. Where CO₂ content is low, indicating inadequate circulation, the control system increases the torque limit until the CO₂ levels are acceptable (or until the maximum torque of the motor is achieved.) This is another example of the device's use of biological signals to control operation of the system. The cycle time and period, number of cycles between respiration pauses, and the torque limit, can be set according to current guidelines, and can also be varied by the remote medical personnel via the remote control capabilities of the control unit.

Thus, while the preferred embodiments of the devices and methods have been described in reference to the environment in which they were developed, they are merely illustrative of the principles of the inventions. Other embodiments and configurations may be devised without departing from the spirit of the inventions and the scope of the appended claims.

We claim:

1. A chest compression device comprising:

a compression belt sized and dimensioned to wrap around the chest of a human;

5 a rotating spool operatively connected to the compression belt to take up a portion of the compression belt upon rotation of the spool; and

a motor operatively connected to the rotating spool to rotate the spool thereby causing the compression belt to
10 constrict around the chest of a human.

a clutch connecting the motor to the spool, said clutch being operable to disconnect the motor from the spool while the motor is operating, and being operable to connect the motor to the spool while the motor is
15 running; and

wherein said motor and clutch are operable to alternately rotate the spool in a direction causing the compression belt to constrict around the chest of a human, and permit the spool to spin in a direction causing the
20 compression belt to loosen around the chest of a human, wherein said alternate rotations of the spool in the direction causing constriction and rotations of the spool in the direction permitting relaxation occur while the motor is running.

25 2. A chest compression device comprising:

a compression belt sized and dimensioned to wrap around the chest of a human;

a rotating spool operatively connected to the compression belt to take up a portion of the compression belt upon
30 rotation of the spool; and

a motor operatively connected to the rotating spool to rotate the spool thereby causing the compression belt to constrict around the chest of a human.

5 a clutch connecting the motor to the spool, said clutch being operable to disconnect the motor from the spool while the motor is operating, and being operable to connect the motor to the spool while the motor is running; and

10 wherein said motor and clutch are operable to alternately rotate the spool in a direction causing the compression belt to constrict around the chest of a human, and permit the spool to spin in a direction causing the compression belt to loosen around the chest of a human, wherein said alternate rotations of the spool in the
15 direction causing constriction and rotations of the spool in the direction permitting relaxation occur without reversing the motor.

3. A chest compression device comprising:

20 a belt which is adapted to extend at least partially around the chest of a human;

a rotating member operatively connected to the belt to constrict the belt about the chest; and

25 a friction liner adapted to be disposed between the belt and the chest of the human when the belt is extended around the chest of the patient.

4. A chest compression device comprising:

a belt which is adapted to encircle the chest of a human;

a rotating member operatively connected to the belt to constrict the belt about the chest; and

a friction liner adapted to be disposed between the belt and the chest of the human when the belt is extended around the chest of the patient.

5. A chest compression device according to claim 2 or 3 wherein the rotating member is a spool, and the belt is connected to the spool whereby rotation of the spool takes up the belt to pull the belt tightly about the chest.

6. A chest compression device comprising:

10 a belt which is adapted to extend at least partially around the chest of a human;

a rotating member operatively connected to the belt to constrict the belt about the chest, and further comprising;

an electric motor for rotating the rotating member;

15 a clutch for operatively connecting the motor to the rotating member;

a controller for repeatedly engaging and disengaging the clutch;

20 a torque sensor operatively connected to the motor to sense the torque applied by the motor;

wherein the controller is capable of disengaging the clutch when the torque sensed by the torque sensor reaches a specified limit.

7. The device of claim 5 wherein the torque sensor is a current sensor which senses current supplied to the electric motor.

8. A chest compression device comprising:

a belt which extends at least partially around the chest of a human;

a rotating spool connected to the belt whereby rotation of the spool takes up the belt to pull the belt tightly about the chest.

an electric motor for rotating the rotating spool;

5 a clutch system for operatively connecting the motor to the rotating spool;

a motor controller for repeatedly engaging and disengaging the clutch;

10 a torque sensor operatively connected to the motor to sense the torque applied by the motor;.

wherein the motor controller is capable of disengaging the clutch when the torque sensed by the torque sensor reaches a specified limit.

9. A resuscitation system for resuscitating a victim of cardiac arrest, said resuscitation system comprising;

resuscitation means including at least one of the following: chest compression means, defibrillation means, blood gas exchange means and injection means;

control means for controlling the resuscitation means;

20 sensing means for sensing biological signals from the victim;

communications means for communicating the biological signals to remote medical personnel, said communications means capable of receiving instructions transmitted to the communications means and transmitting those instruction to the control means;

25 wherein the control means controls the resuscitation means in response to the instructions.

10. A resuscitation and alert system comprising:

a resuscitation device comprising one of the following:
chest compression means, defibrillation means, and
injection means;

sensing means for determining when the resuscitation device
is in use;

computer storage means for storing information
corresponding to the location of the resuscitation
device;

communicating means for communicating with emergency
medical personnel and informing the emergency medical
personnel that the device is in use and communicating
the location information to the emergency medical
personnel.

11. The system of claim 10, wherein the communicating means
comprises a computer control system and a telephone controlled
by the computer control system, wherein said computer control
system is programmed to initiate a telephone call to a 911
emergency system and communicates the information corresponding
to the location of the resuscitation device to the 911 emergency
medical system.

12. The system of claim 10 wherein the communicating means
automatically initiates contact with a 911 emergency system when
the device is in use.

13. The system of claim 10 further comprising:

at least one rechargeable battery operatively connected to
the resuscitation device, said rechargeable battery
having charging connections for connection to an
electrical power supply for charging the battery when
not in use;

wherein the sensing means senses the removal of the device
from the charging connection when the device is
disconnected from the electrical power supply and

provides input to the communicating means indicating that the device has been removed from the charging connection; and

the communication means initiates a communication to emergency medical personnel upon receiving input from the sensing means that the device has been removed from the charging connection.

14. The system of claim 10 further comprising:

a storage holder for the resuscitation device, in which the resuscitation device is stored when not in use; and

wherein the sensing means comprises a sensor which senses when the resuscitation device has been removed from the storage holder, thereby treating removal from the storage holder as an indication that the resuscitation device is in use.

15. The system of claim 10 wherein:

the resuscitation device comprises a chest compression device having a compression belt and a buckle for securing the compression belt around the chest of the victim; and

wherein the sensing means comprises a sensor which senses when the buckle has been latched, thereby treating the buckled condition of the compression belt as an indication that the resuscitation device is in use.

1/12

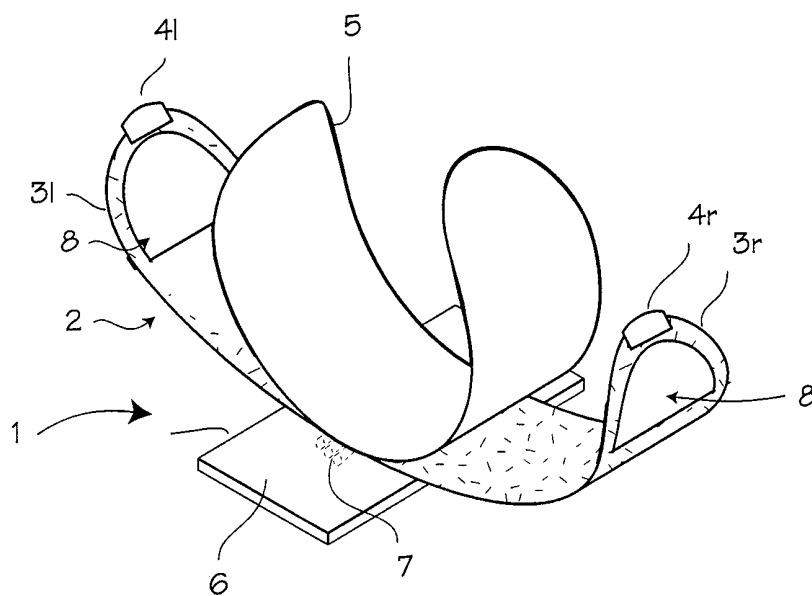

Fig. 1

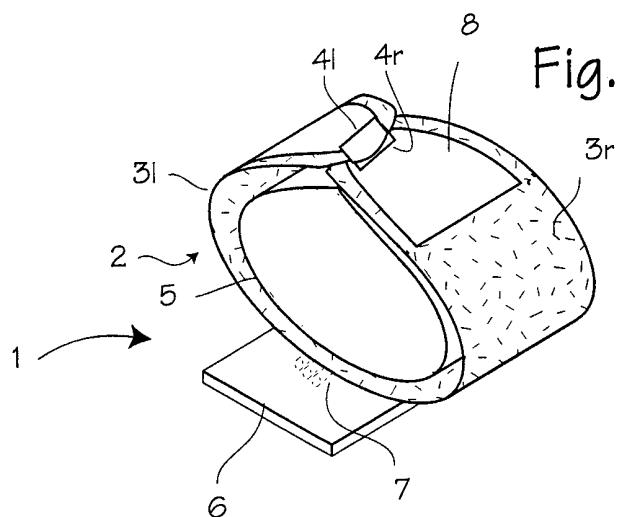
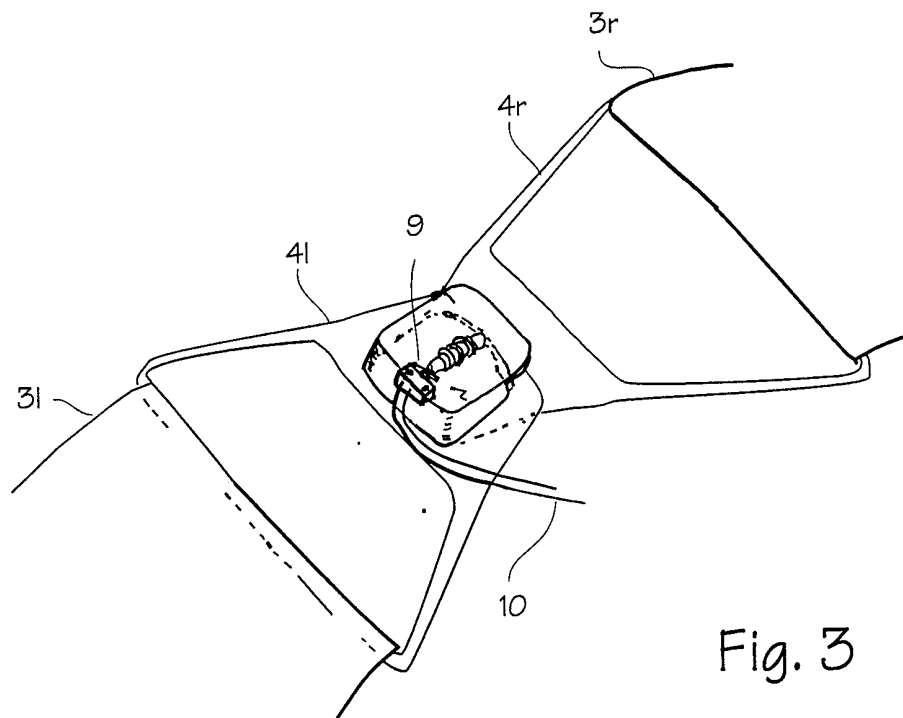
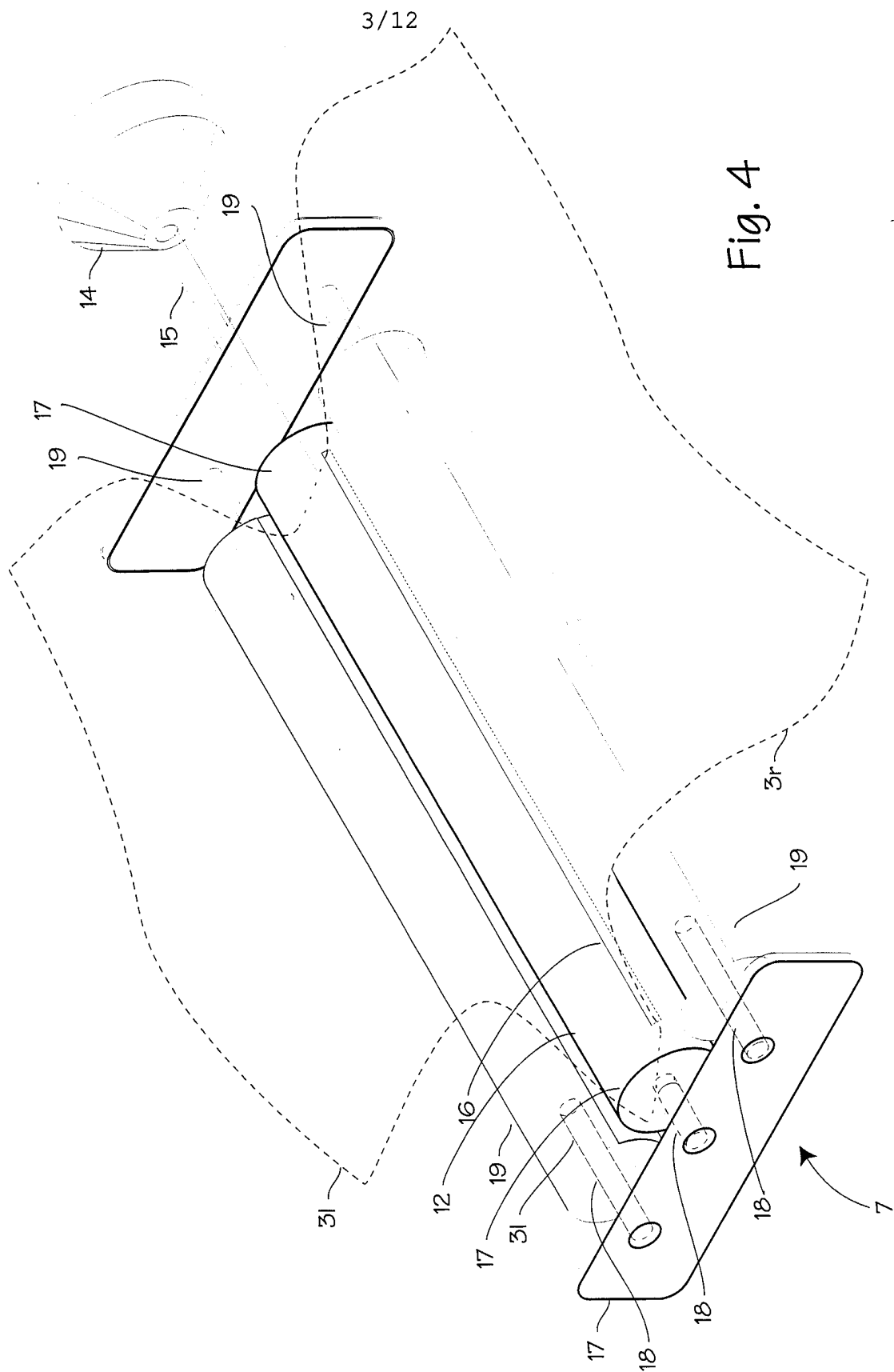

Fig. 2

2/12





4/12

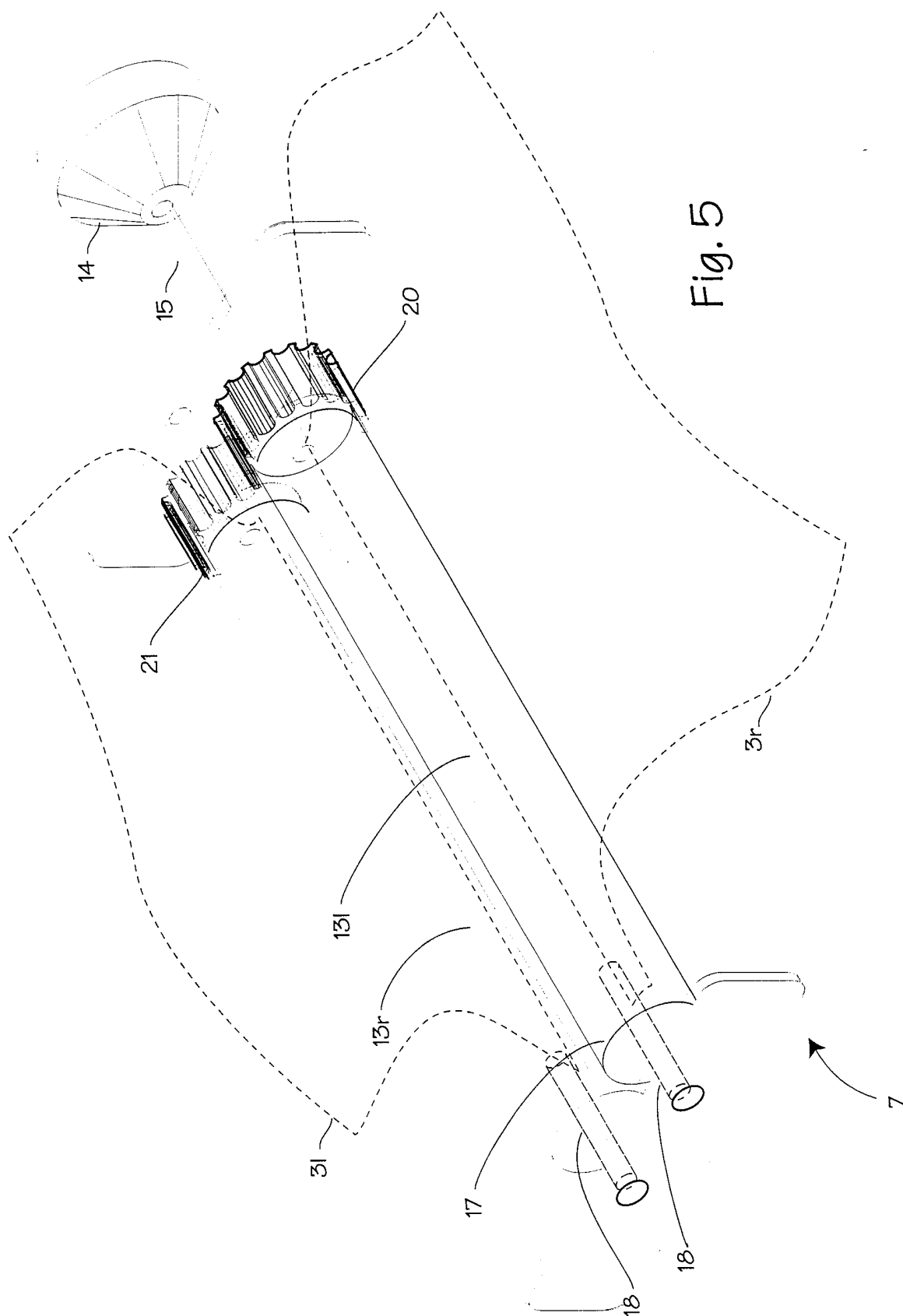

Fig. 5

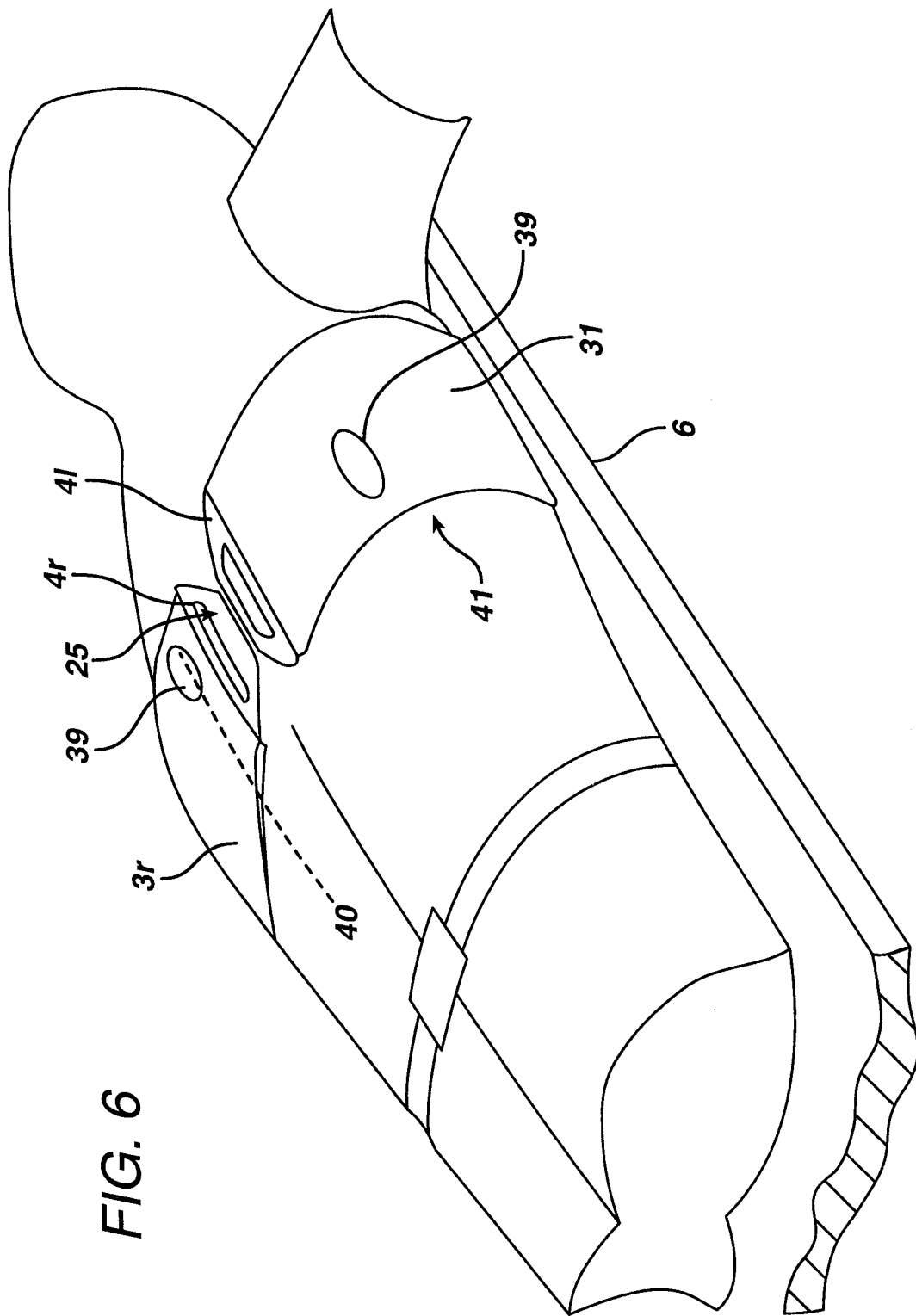

FIG. 6

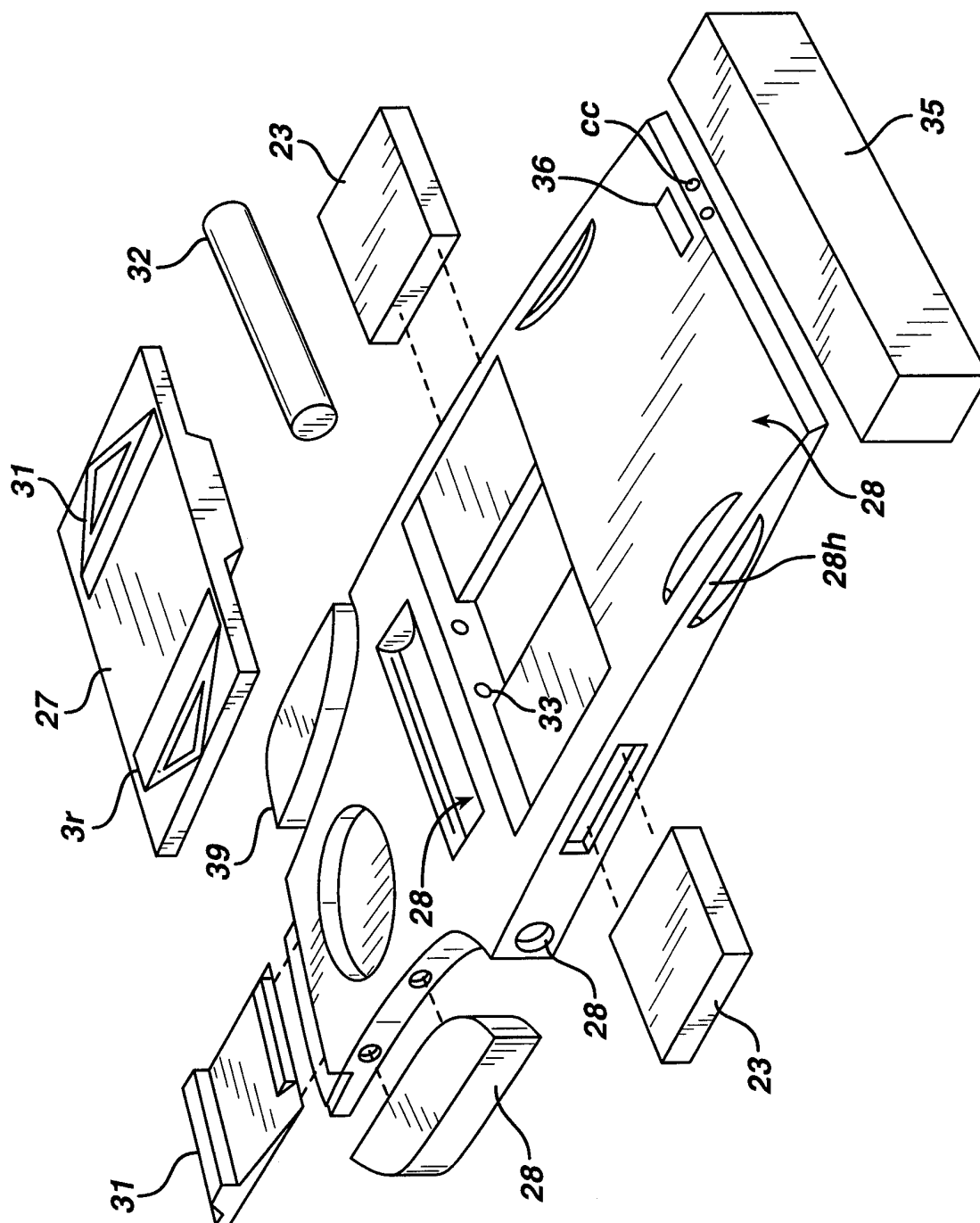

FIG. 7

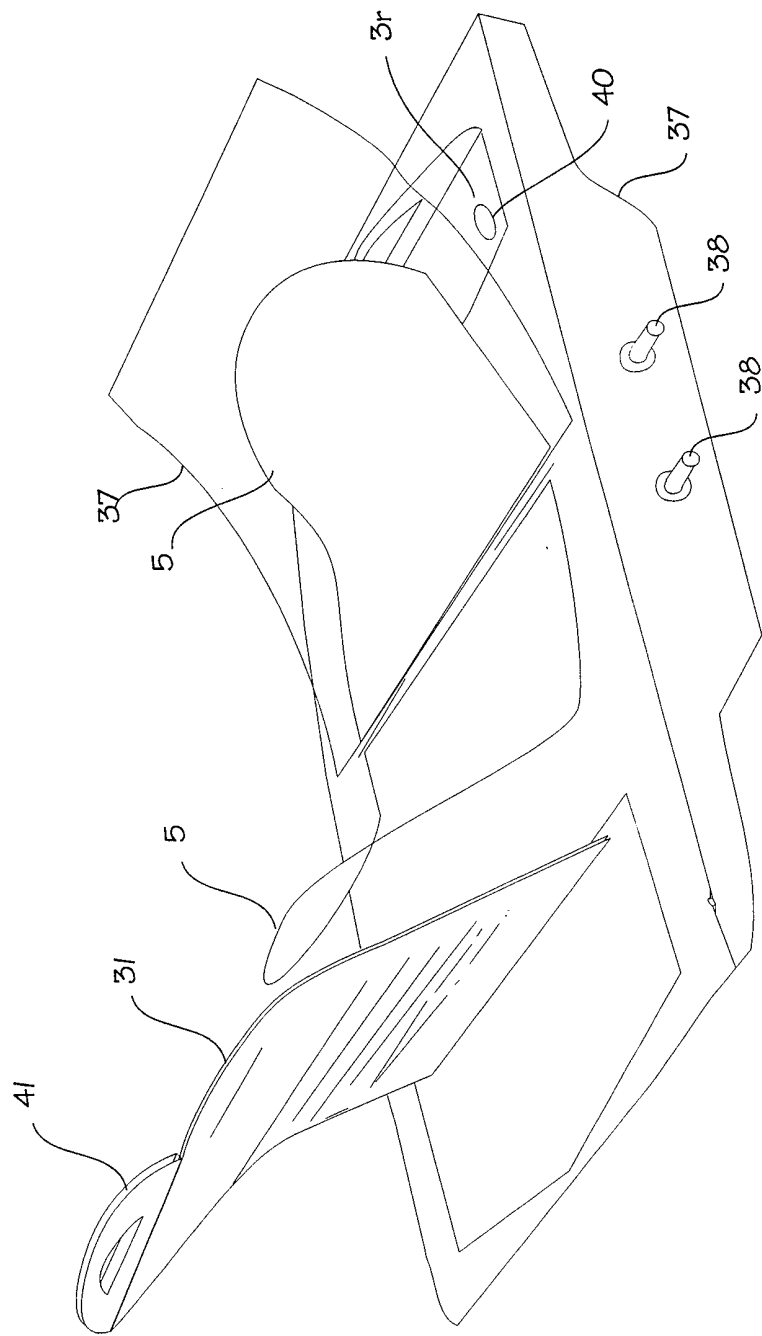
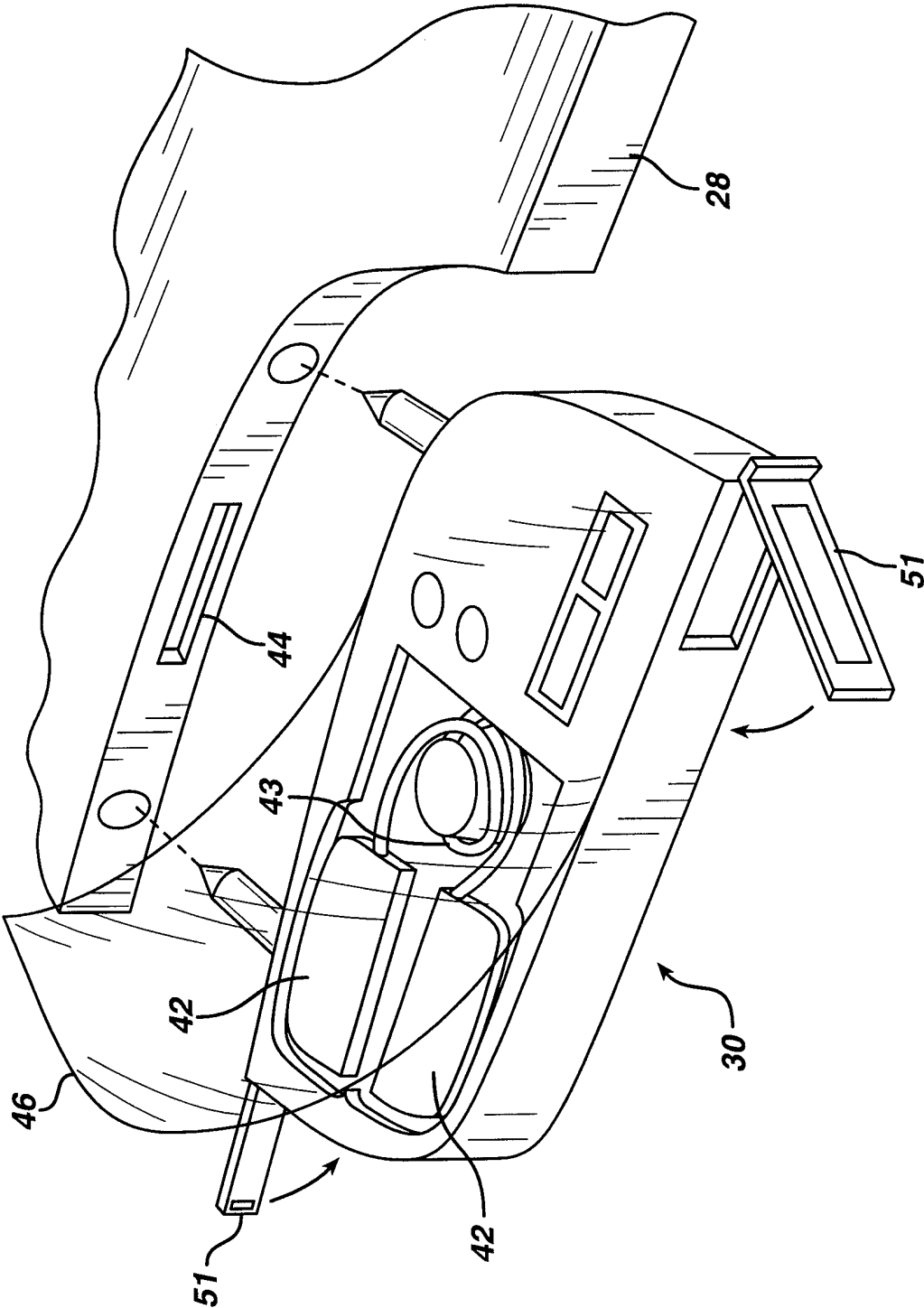

Fig. 8

FIG. 9



9/12

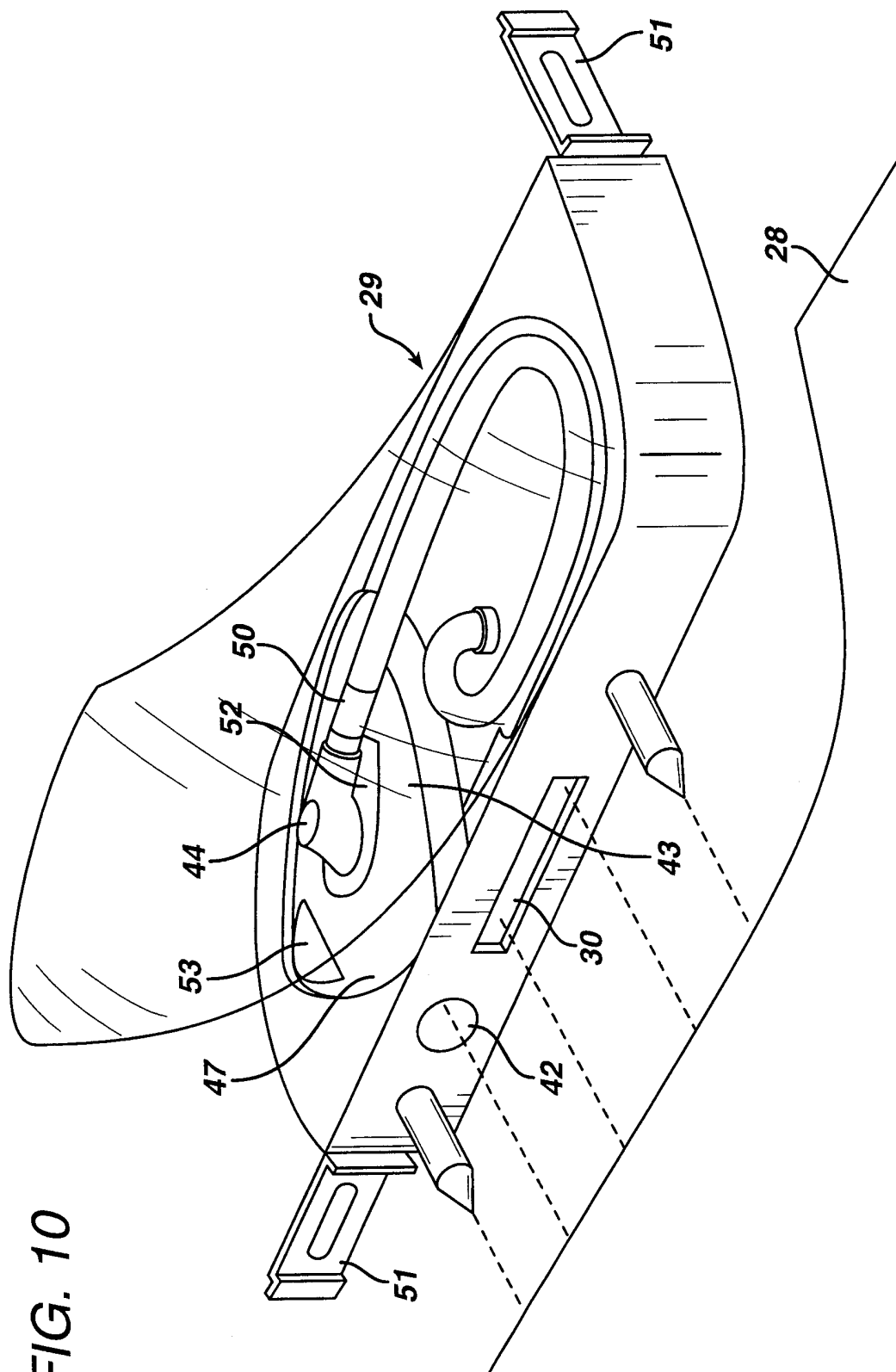

FIG. 10

10/12

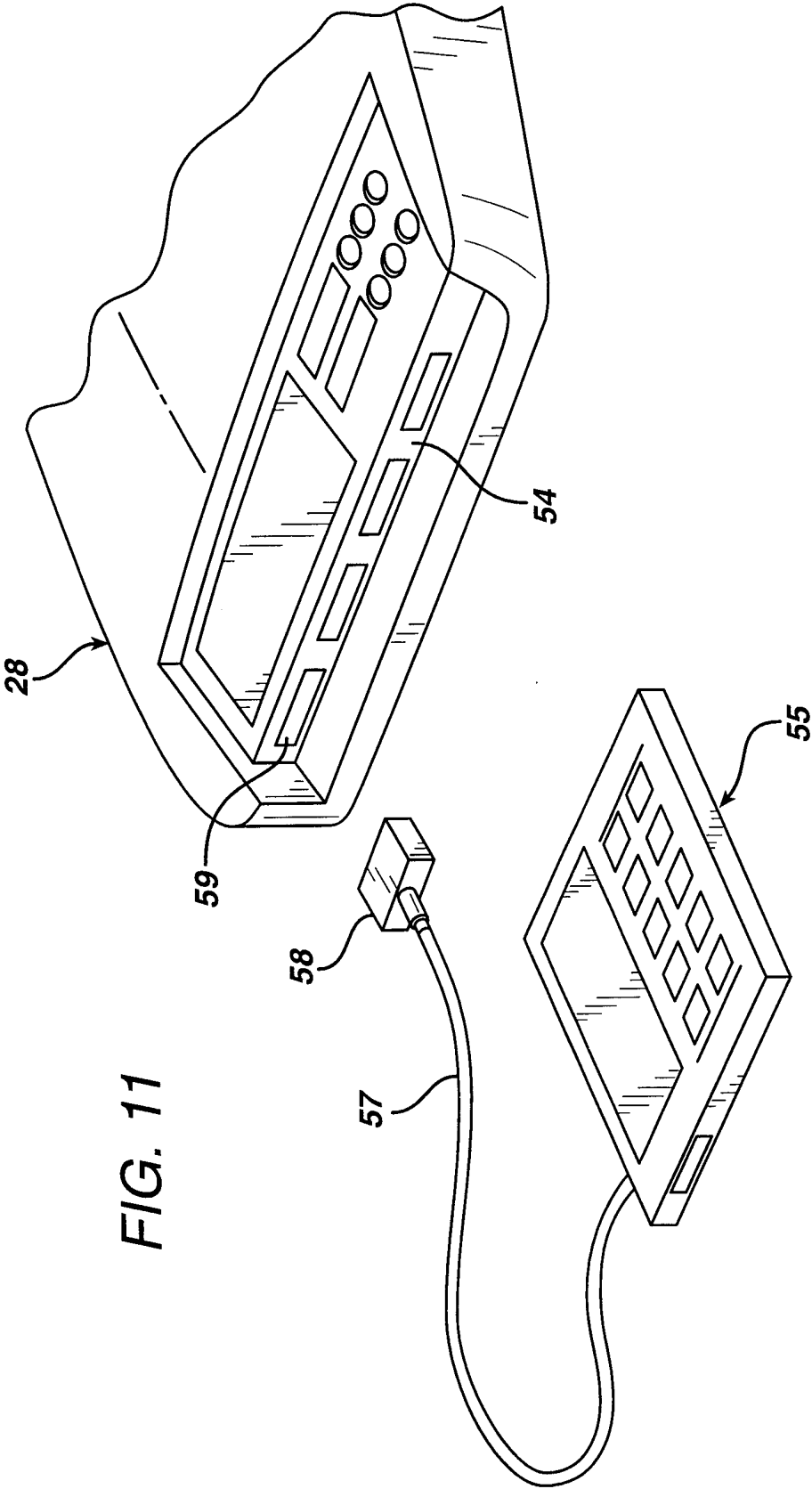

FIG. 11

11/12

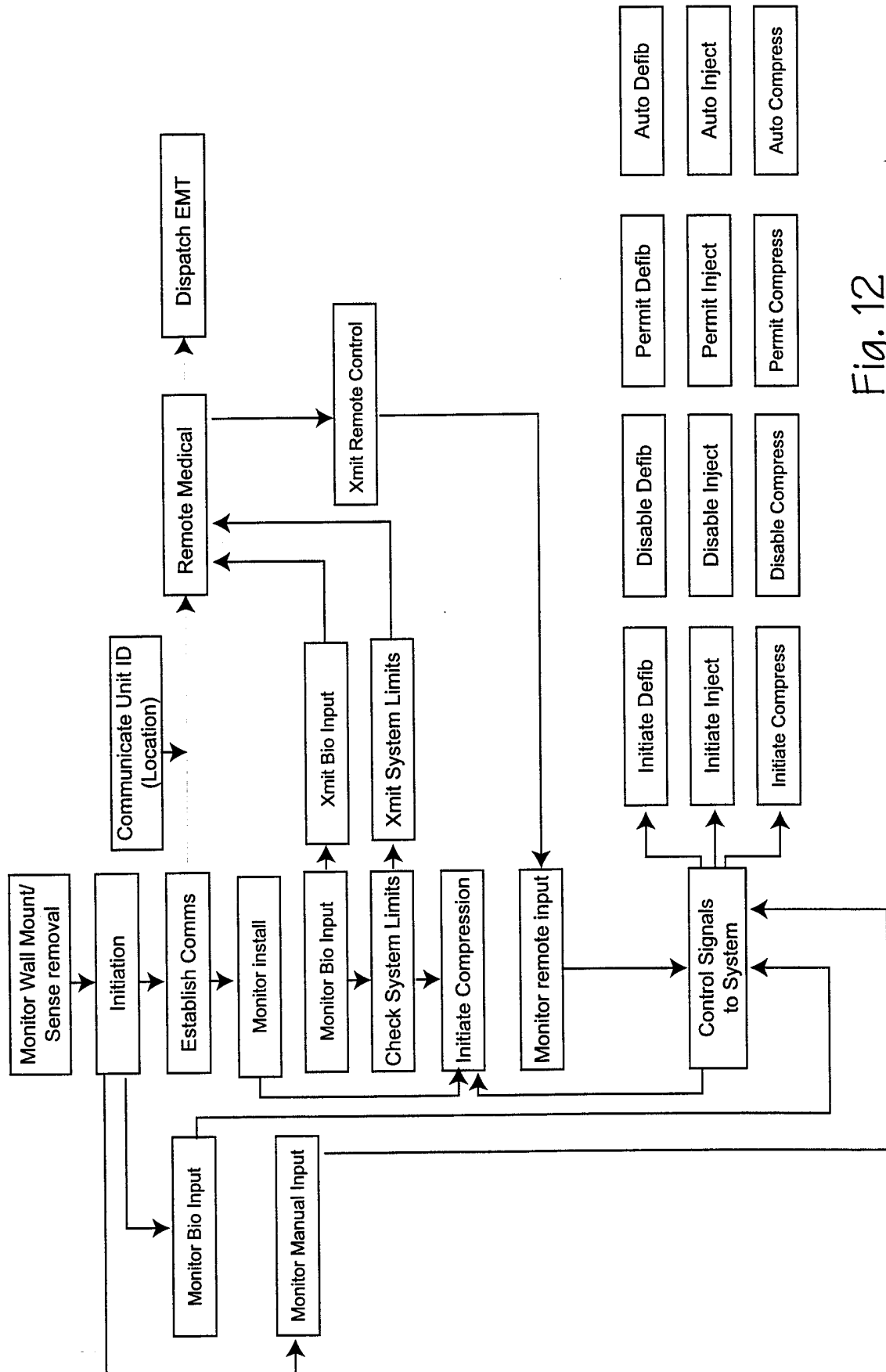
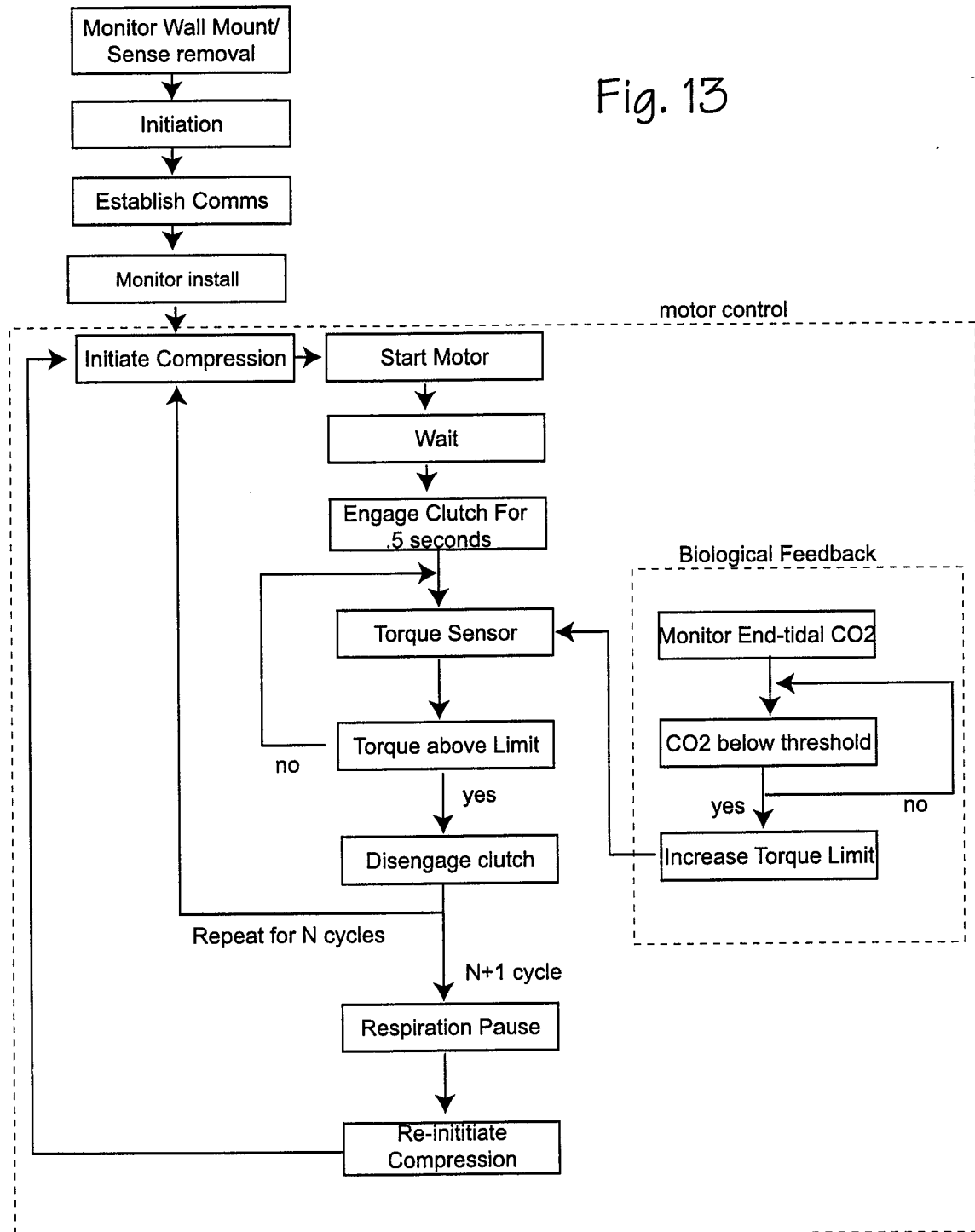

Fig. 12

12/12

Fig. 13



INTERNATIONAL SEARCH REPORT

 International application No.
 PCT/US98/17502

A. CLASSIFICATION OF SUBJECT MATTER

IPC(6) : A61H 31/00

US CL : 601/41

According to International Patent Classification (IPC) or to both national classification and IPC

B. FIELDS SEARCHED

Minimum documentation searched (classification system followed by classification symbols)

U.S. : 434/265; 601/1, 41-44, 134, 135

Documentation searched other than minimum documentation to the extent that such documents are included in the fields searched

Electronic data base consulted during the international search (name of data base and, where practicable, search terms used)

C. DOCUMENTS CONSIDERED TO BE RELEVANT

Category*	Citation of document, with indication, where appropriate, of the relevant passages	Relevant to claim No.
X --- Y	US 4,770,164 A (LACH) 13 September 1988, Figs. 1-3.	1-5, 7, 8 -----6

☐

Further documents are listed in the continuation of Box C.

☐

See patent family annex.

* Special categories of cited documents:

A document defining the general state of the art which is not considered to be of particular relevance

E earlier document published on or after the international filing date

L document which may throw doubts on priority claim(s) or which is cited to establish the publication date of another citation or other special reason (as specified)

C document referring to an oral disclosure, use, exhibition or other means

P document published prior to the international filing date but later than the priority date claimed

T later document published after the international filing date or priority date and not in conflict with the application but cited to understand the principle or theory underlying the invention

X document of particular relevance; the claimed invention cannot be considered novel or cannot be considered to involve an inventive step when the document is taken alone

Y document of particular relevance; the claimed invention cannot be considered to involve an inventive step when the document is combined with one or more other such documents, such combination being obvious to a person skilled in the art

G document member of the same patent family

Date of the actual completion of the international search

17 NOVEMBER 1998

Date of mailing of the international search report

09 DEC 1998

 Name and mailing address of the ISA/US
 Commissioner of Patents and Trademarks
 Box PCT
 Washington, D.C. 20231

Facsimile No. (703) 305-3230

Authorized officer

JEANNE CLARK

Telephone No. (703) 308-0063

INTERNATIONAL SEARCH REPORT

International application No.

PCT/US98/17502

Box I Observations where certain claims were found unsearchable (Continuation of item 1 of first sheet)

This international report has not been established in respect of certain claims under Article 17(2)(a) for the following reasons:

1. ☐ Claims Nos.:
because they relate to subject matter not required to be searched by this Authority, namely:

2. ☐ Claims Nos.:
because they relate to parts of the international application that do not comply with the prescribed requirements to such an extent that no meaningful international search can be carried out, specifically:

3. ☐ Claims Nos.:
because they are dependent claims and are not drafted in accordance with the second and third sentences of Rule 6.4(a).

Box II Observations where unity of invention is lacking (Continuation of item 2 of first sheet)

This International Searching Authority found multiple inventions in this international application, as follows:

Please See Extra Sheet.

1. ☐ As all required additional search fees were timely paid by the applicant, this international search report covers all searchable claims.
2. ☐ As all searchable claims could be searched without effort justifying an additional fee, this Authority did not invite payment of any additional fee.
3. ☐ As only some of the required additional search fees were timely paid by the applicant, this international search report covers only those claims for which fees were paid, specifically claims Nos.:

4. ☒ No required additional search fees were timely paid by the applicant. Consequently, this international search report is restricted to the invention first mentioned in the claims; it is covered by claims Nos.:
1-8

Remark on Protest

☐

The additional search fees were accompanied by the applicant's protest.

☐

No protest accompanied the payment of additional search fees.

INTERNATIONAL SEARCH REPORT

International application No.
PCT/US98/17502

BOX II. OBSERVATIONS WHERE UNITY OF INVENTION WAS LACKING

This ISA found multiple inventions as follows:

This application contains the following inventions or groups of inventions which are not so linked as to form a single inventive concept under PCT Rule 13.1. In order for all inventions to be searched, the appropriate additional search fees must be paid.

Group I, claims 1-8, drawn to chest compression device comprising a belt, a rotating member, an electric motor, a clutch, and a controller.

Group II, claims 9-15, drawn to a resuscitation system comprising a resuscitation means, a control means, a sensing means, and a communication means for sending information to remote medical personnel.

Groups I and II, the inventions listed as these groups do not relate to a single inventive concept under PCT Rule 13.1 because under PCT Rule 13.2 they lack the same or corresponding special technical features for the following reasons:

Group I, the inventions of this group have the inventive concept of using a clutch system with a motor controller, and torque sensor to apply controlled tension to a belt surrounding the user.

Group II, the inventions of this group have the inventive concept of a communication means which automatically calls, and transmits information to remote medical personnel.