

W. B. McBEE.
Casing for Stoves.

No. 227,556.

Patented May 11, 1880.

Fig. 1.

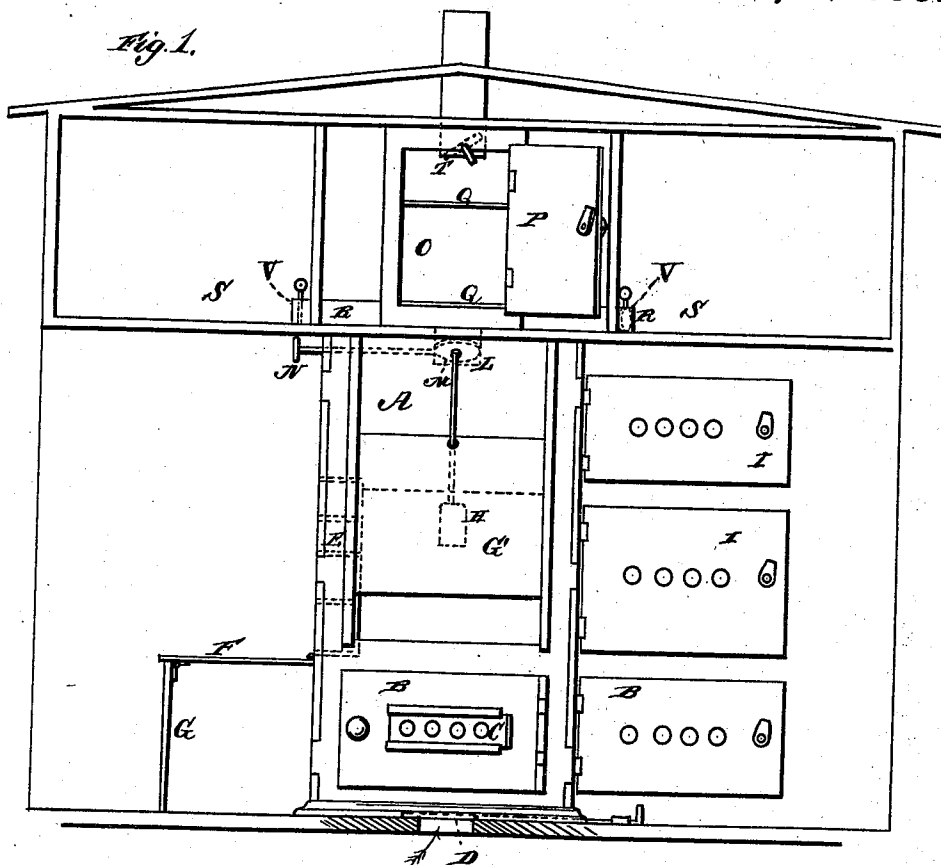

Fig. 2.

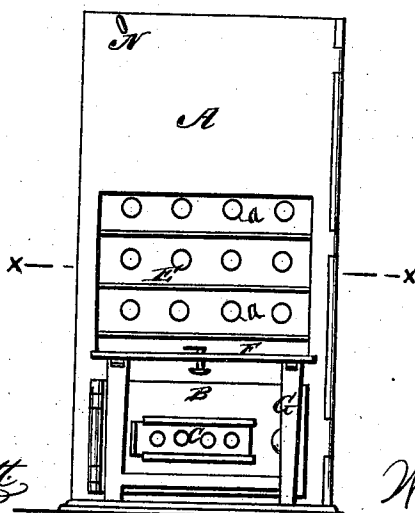
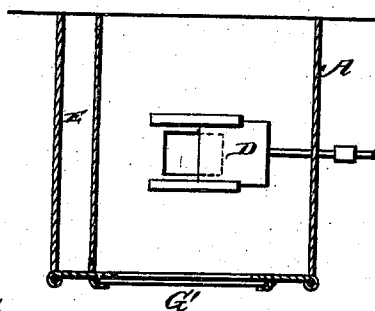

Fig. 3.



WITNESSES

Photo Engraving

Chas. & Page

INVENTOR

Wiley B. McBee.
Gilman, Smith & Co.,
ATTORNEYS

UNITED STATES PATENT OFFICE.

WILEY B. McBEE, OF ST. LOUIS, MISSOURI.

CASING FOR STOVES.

SPECIFICATION forming part of Letters Patent No. 227,556, dated May 11, 1880.

Application filed February 26, 1880.

To all whom it may concern:

Be it known that I, WILEY B. McBEE, of St. Louis, in the county of St. Louis and State of Missouri, have invented certain new and useful Improvements in Casings for Stoves; and I do hereby declare that the following is a full, clear, and exact description of the construction and operation of the same, reference being had to the annexed drawings, making a part of this specification, and to the letters and figures of reference marked thereon.

Figure 1 of the drawings is a representation of a front of my kitchen cooler and ventilator. Fig. 2 is a side view, and Fig. 3 is a horizontal sectional view taken through line *xx* in Fig. 2.

The nature of my invention relates to a refrigerator for stoves, as hereinafter set forth and claimed.

A designates a casing which surrounds the stove. B B B are three lower doors, with slide-valves or dampers C for the admission of air to the interior of casing A. D is a valve, which is designed to let air up from the cellar through the floor, so as to ventilate the cellar. E E are shelves upon the inside of the casing A, extending from the front to the rear wall of the same, having a back wall provided with perforations *a* to admit hot air to the shelves, by which the various articles of food that may be placed thereon may be kept warm. F is a door which closes the front of these shelves, and G is a leg hinged to said door, so that it may be let down and converted into a table. G' is a front sliding door, balanced by a cord and weight, H, and I are upper side doors, which may be opened to let out heat into the kitchen, or closed in warm weather to prevent the room from becoming

too hot. L is a flue leading through the ceiling of the kitchen to the room above, and M is a valve controlled by a rod, N, so as to regulate the passage of the heated air which rises from the interior of the casing. The flue opens into a drying-compartment, which consists of a casing, O, with a door, P, and suitable drying-shelves Q. R are flues leading from this drying-compartment to the side rooms, S, so that by closing a valve, T, in the flue which leads from the drying-compartment up through the roof and opening the dampers V in the flues R the rooms S may be supplied with heated air.

The system of doors shown may be manipulated in a variety of ways, the object being to keep the apartment or kitchen at a proper temperature.

What I claim is—

1. The combination, with a casing for inclosing a stove, of a compartment at one side thereof having shelves E, and a rear wall provided with perforations *a*, and a door, F, having a hinged leg, G, substantially as and for the purposes set forth.

2. The combination of the casing A and drying-chamber O, connected by a flue, L, provided with a damper, M N, with the compartments S S, which are connected by flues R, having dampers V, to the drying-chamber O, substantially as and for the purpose set forth.

In testimony that I claim the above I have hereunto subscribed my name in the presence of two witnesses.

WILEY BLUFORD McBEE.

Witnesses:

DAVID WOODS,
D. F. COFFMAN.